

CASE NOS. 22338 and 22339

APPLICATIONS OF MEWBOURNE OIL COMPANY FOR COMPULSORY POOLING,
EDDY COUNTY, NEW MEXICO

MEWBOURNE OIL COMPANY'S EXHIBIT LIST

- PART II

1. Applications and Proposed Notices
2. Landman's Affidavit
3. Geologist's Affidavit
4. Affidavit of Mailing
5. Affidavit of Publication
6. Pooling Checklists

STATE OF NEW MEXICO
ENERGY, MINERALS AND NATURAL RESOURCES DEPARTMENT
OIL CONSERVATION DIVISION

APPLICATIONS OF MEWBOURNE OIL COMPANY
FOR COMPULSORY POOLING, EDDY COUNTY,
NEW MEXICO.

Case Nos. 22338 - 22339

SELF-AFFIRMED STATEMENT OF CHARLES CROSBY

COUNTY OF MIDLAND

STATE OF TEXAS

Charles Crosby deposes and states:

1. I am over the age of 18, and have personal knowledge of the matters stated herein.
2. I am a geologist for Mewbourne Oil Company ("Mewbourne"), and I am familiar with the geological matters involved in these cases. I have been qualified by the Division as an expert petroleum geologist.
3. The following geological plats are attached hereto:
 - (a) Attachment A is a structure map on the base of the Second Bone Spring Sand, which is the target formation for the Puma Blanca wells. It accurately reflects the structure of the base of the Second Bone Spring Sand. It shows that structure dips gently to the southeast. It also shows Second Bone Spring Sand wells in the immediate area, and a line of cross-section.
 - (b) Attachment B is a Lower Second Bone Spring Sand Gross Thickness Map, which is the completion zone of the Puma Blanca wells.
 - (c) Attachment C is a cross section of the Second Bone Spring Sand. The well logs on the cross-section give a representative sample of the Second Bone Spring Sand in this area. The target zones for the wells are continuous and uniformly thick across the well units.
4. I conclude from the maps that:
 - (a) The horizontal spacing units are justified from a geologic standpoint.
 - (b) The target zone is continuous and of relatively uniform thickness across the well units.

EXHIBIT

3

(c) Each quarter section in each well unit will contribute more or less equally to production from the target zone.

(d) There is no faulting or other geologic impediment in the area which will affect the drilling of the subject well.

5. Attachment D contains information from nearby Second Bone Spring Sand wells drilled in this area. The drilled and completed wells indicate that laydown wells are a reasonable method to develop the reservoir in these sections.

6. Attachment E contains the horizontal drilling plans for the proposed wells. The producing intervals of the wells will be orthodox.

7. I understand that this Self-Affirmed Statement will be used as written testimony in these cases. I affirm that my testimony in paragraphs 1 through 6 above is true and correct and is made under penalty of perjury under the laws of the State of New Mexico. My testimony is made as of the date handwritten next to my signature below.

Date: 11/30/21

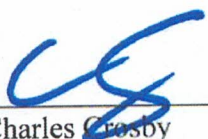

Charles Crosby

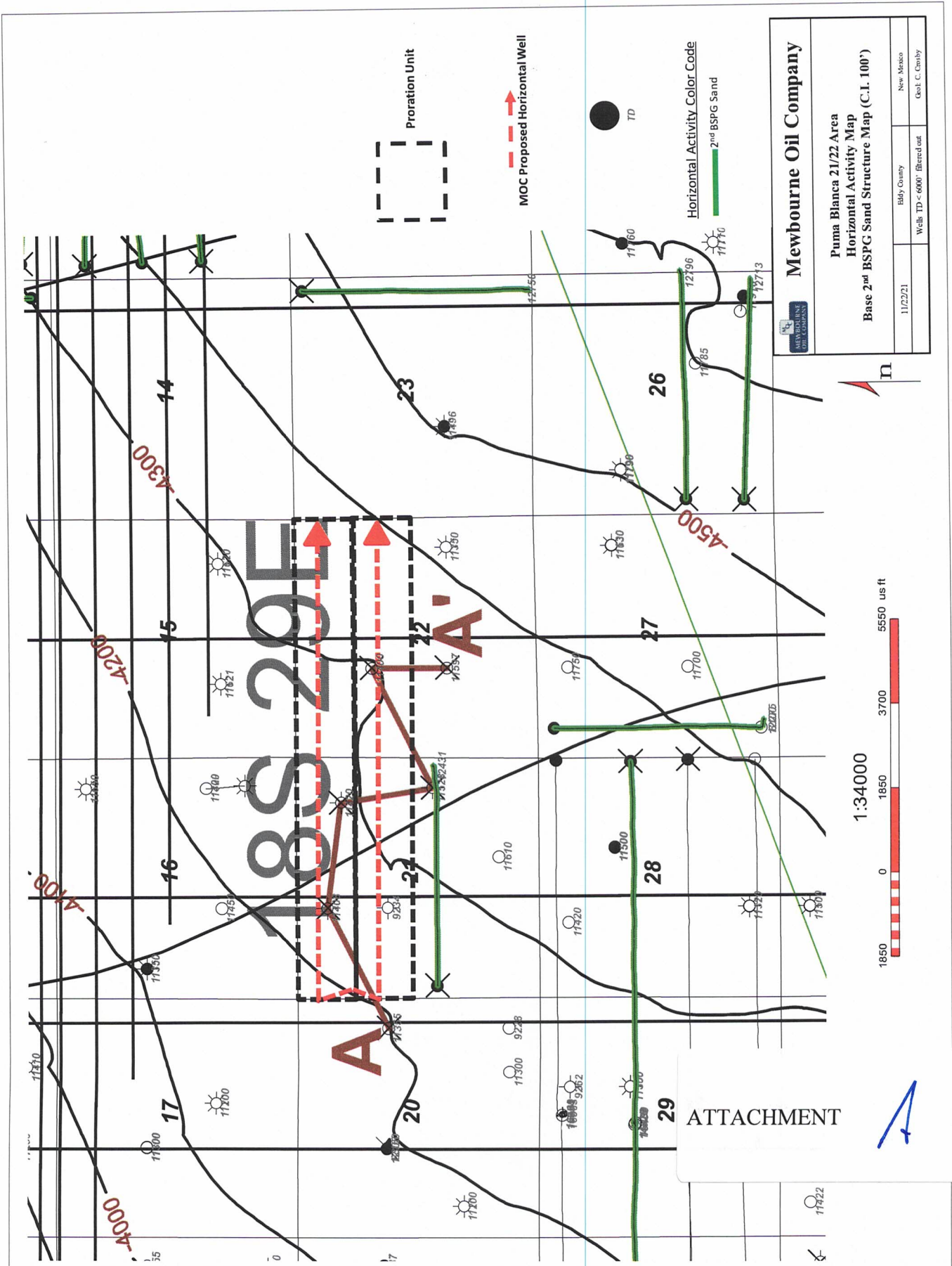

Puma Blanca Area 2nd BSPG SD Horizontal Production Table

Well Name	Operator	API	Location	Completion Date	Cum Oil (Mbo)	Cum Gas (Bcf)	Cum Water (Mbw)	NS/EW	Production Zone
East Turkey Federal Com 5H	EOG	30015384150000	26P/18S/29E	3/2/2012	79.8	0.25	81.1	EW	2nd Bone Spring Sand
East Turkey Federal Com 6H	EOG	30015384160000	26I/18S/29E	4/11/2012	40.5	0.18	81.0	EW	2nd Bone Spring Sand
Grateful BOD Federal Com 2H	EOG	30015385180000	13H/18S/29E	7/12/2012	95.1	0.47	96.8	EW	2nd Bone Spring Sand
Sialom BPZ Federal 1H	EOG	30015385410000	13I/18S/29E	8/12/2012	120.5	0.53	125.8	EW	2nd Bone Spring Sand
Empire A Federal Com 3H	Cimarex	30015386590100	27M/18S/29E	11/4/2011	28.7	0.08	46.5	NS	2nd Bone Spring Sand
Grateful BOD Federal Com 1H	EOG	30015389900000	13A/18S/29E	12/8/2011	134.9	0.53	71.1	EW	2nd Bone Spring Sand
War Horse Federal Com 3H	Tap Rock	30015412270000	21I/18S/29E	5/17/2014	222.1	0.65	288.4	EW	2nd Bone Spring Sand
Terlingua 23 State 501H	EOG	30015440520000	23P/18S/29E	5/28/2017	80.8	0.28	317.0	NS	2nd Bone Spring Sand
Pavo Frio 29/28 B2GH Federal Com 1H	Mewbourne	30015454040000	29E/18S/29E	3/1/2019	141.0	0.27	354.6	EW	2nd Bone Spring Sand

ATTACHMENT

D

Puma Blanca 21/22 B2DA Fed Com #1H

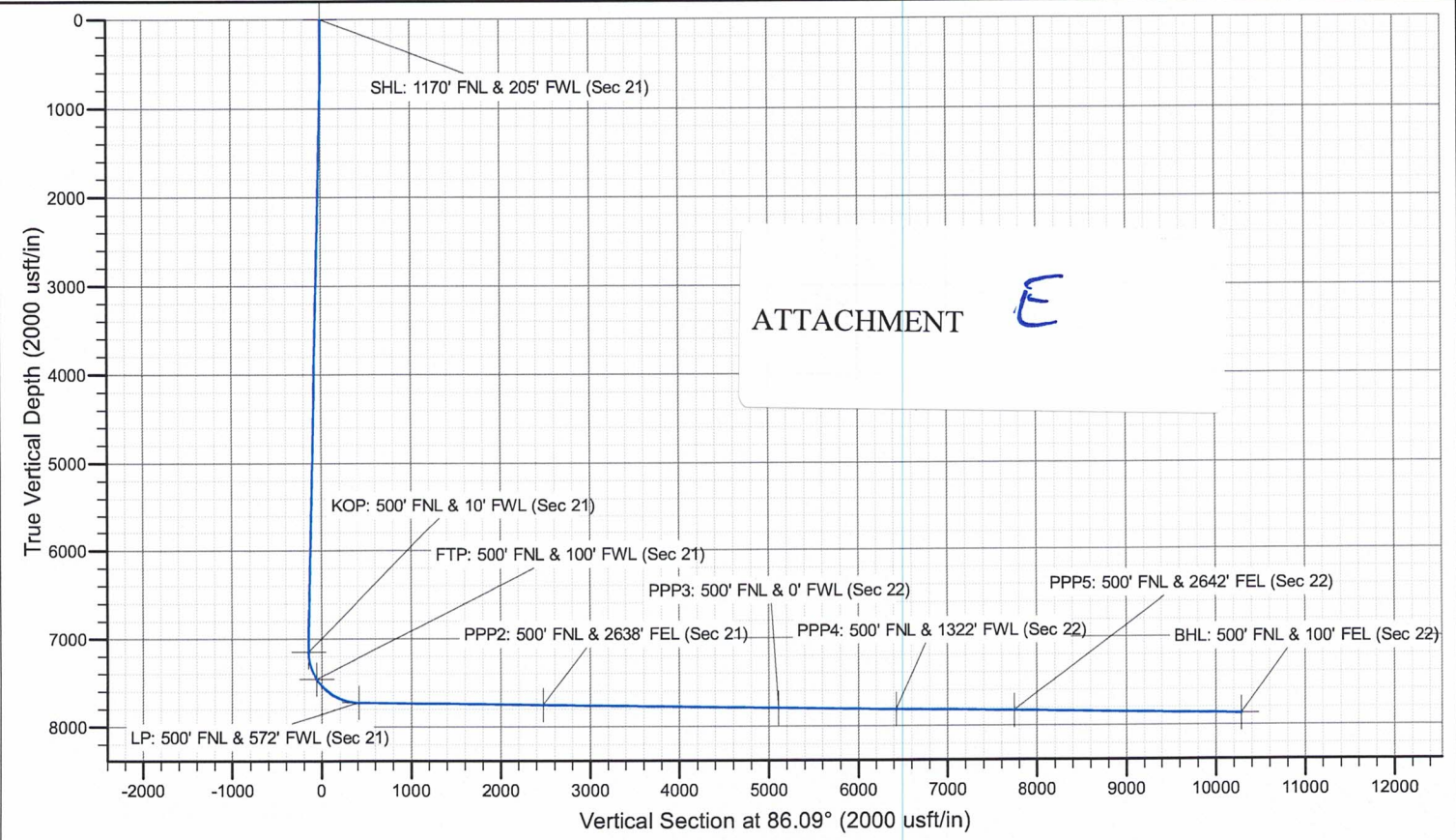
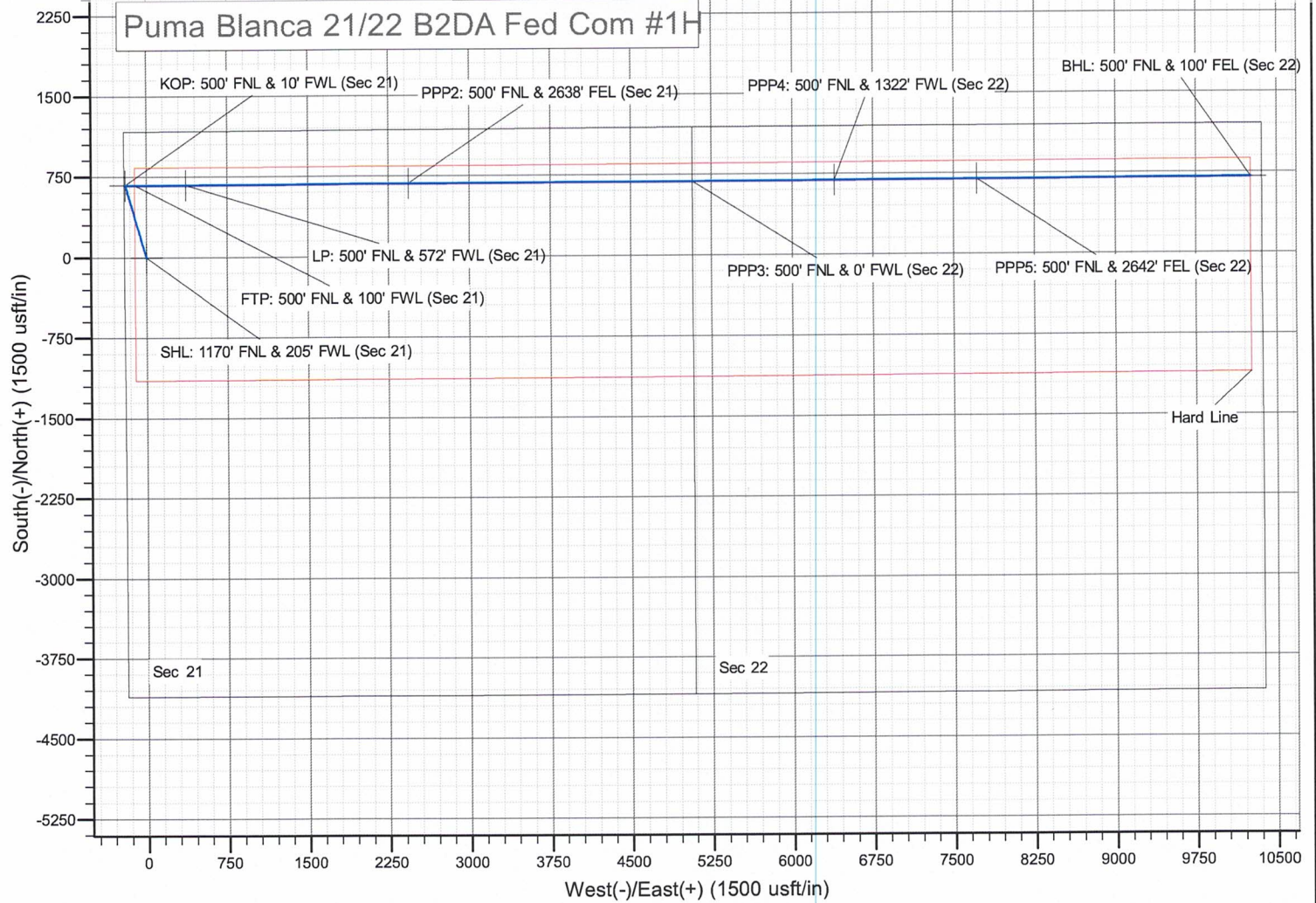

Puma Blanca 21/22 B2EH Fed Com #1H

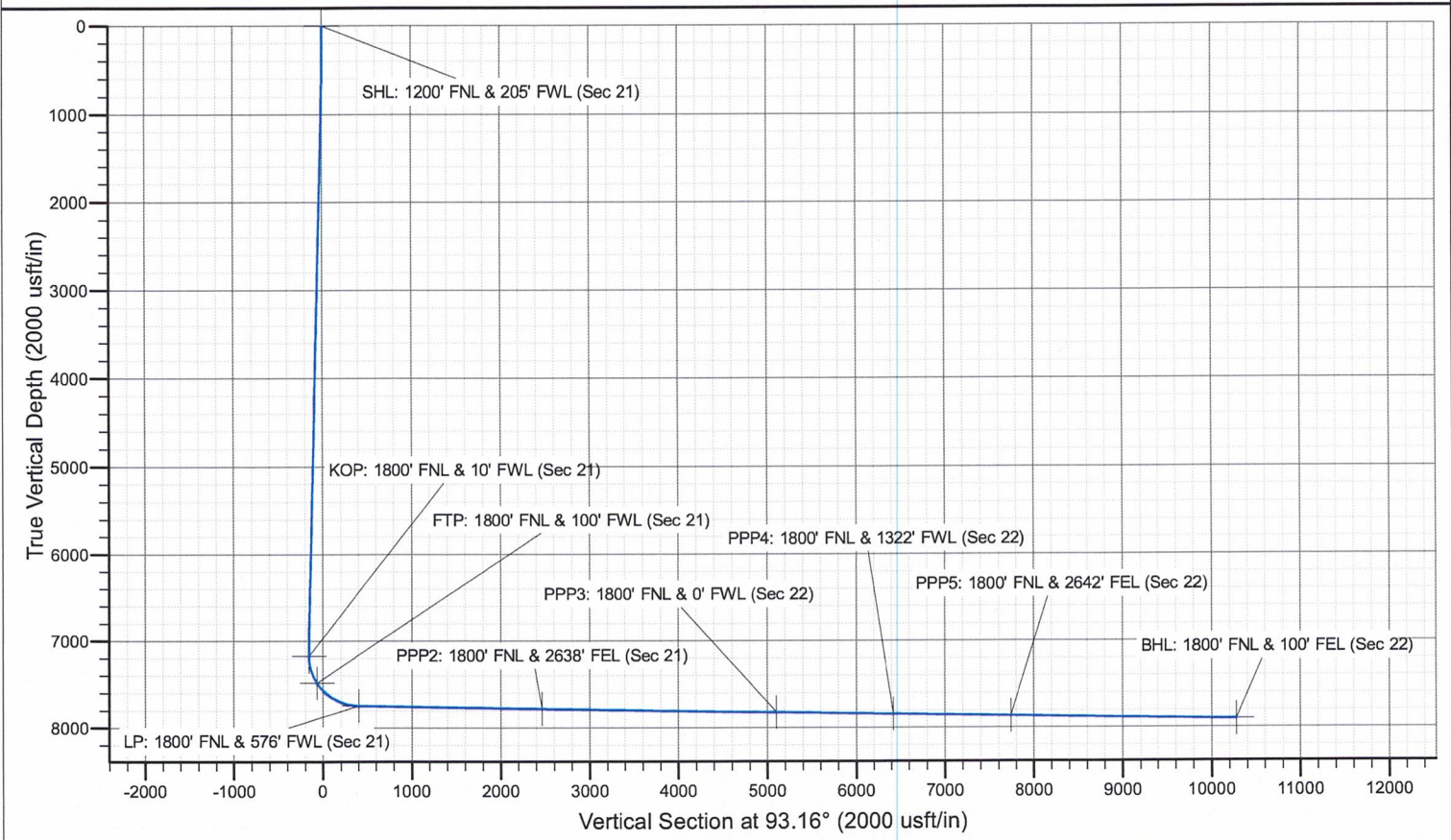
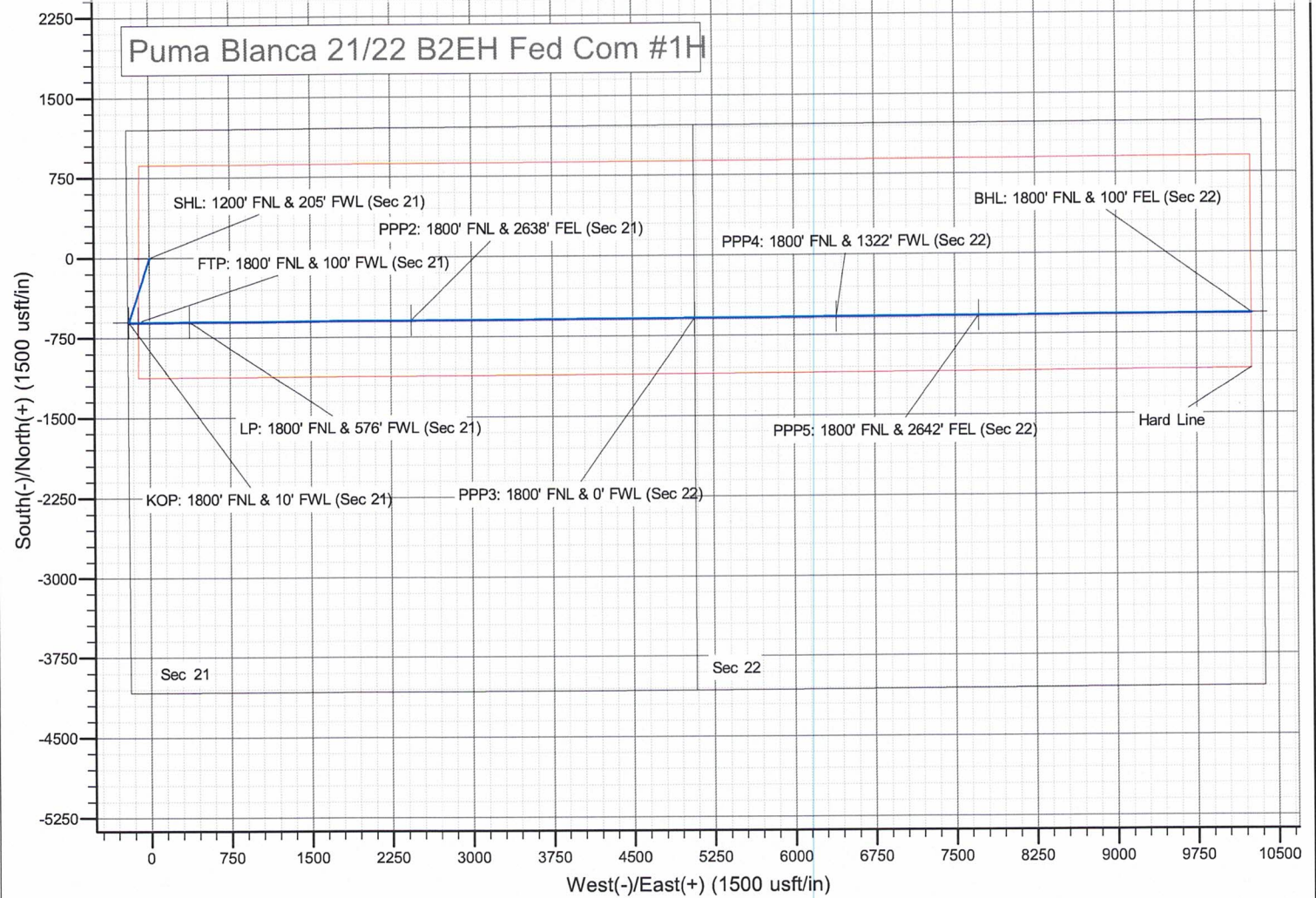

STATE OF NEW MEXICO
ENERGY, MINERALS AND NATURAL RESOURCES DEPARTMENT
OIL CONSERVATION DIVISION

APPLICATIONS OF MEWBOURNE OIL COMPANY
FOR COMPULSORY POOLING, EDDY COUNTY,
NEW MEXICO.

Case Nos. 22338 & 22339

SELF-AFFIRMED STATEMENT

COUNTY OF SANTA FE)
) ss.
STATE OF NEW MEXICO)

James Bruce deposes and states:

1. I am over the age of 18, and have personal knowledge of the matters stated herein.
2. I am an attorney for Mewbourne Oil Company.
3. Mewbourne has conducted a good faith effort to locate the names and addresses of all interest owners in the proposed wells.
4. Notice of the pooling applications was provided to the interest owners, at their last known addresses, by certified mail. Copies of the notice letter and certified return receipts are attached hereto as Attachment A.
5. Applicant has complied with the notice provisions of Division Rules.
6. I understand that this Self-Affirmed Statement will be used as written testimony in this case. I affirm that my testimony in paragraphs 1 through 5 above is true and correct and is made under penalty of perjury under the laws of the State of New Mexico. My testimony is made as of the date handwritten next to my signature below.

Date: 11/30/21

James Bruce
James Bruce

EXHIBIT 4

JAMES BRUCE
ATTORNEY AT LAW

POST OFFICE BOX 1056
SANTA FE, NEW MEXICO 87504

369 MONTEZUMA, NO. 213
SANTA FE, NEW MEXICO 87501

(505) 982-2043 (Phone)
(505) 660-6612 (Cell)
(505) 982-2151 (Fax)

jamesbruc@aol.com

November 10, 2021

CERTIFIED MAIL - RETURN RECEIPT REQUESTED

To: Persons on Exhibit A

Ladies and gentlemen:

Enclosed are copies of two applications, filed with the New Mexico Oil Conservation Division by Mewbourne Oil Company, seeking orders pooling all mineral interest owners in the horizontal spacing units described below:

1. Case 22338: The Bone Spring formation underlying the N/2N/2 of Section 21 and the N/2N/2 of Section 22, Township 18 South, Range 29 East, NMPM; and
2. Case 22339: The Bone Spring formation underlying the S/2N/2 of Section 21 and the S/2N/2 of Section 22, Township 18 South, Range 29 East, NMPM.

These matters are scheduled for hearing at 8:15 a.m. on Thursday, December 2, 2021. During the COVID-19 Public Health Emergency, state buildings are closed to the public and the hearing will be conducted remotely. To determine the location of the hearing or to participate in an electronic hearing, go to emnrd.state.nm.us/OCD/hearings or see the instructions posted on the Division's website, <http://emnrd.state.nm.us/OCD/announcements.html>. You are not required to attend this hearing, but as an owner of an interest who may be affected by the applications, you may appear and present testimony. Failure to appear at that time and become a party of record will preclude you from contesting these matters at a later date.

A party appearing in a Division case is required by Division Rules to file a Pre-Hearing Statement no later than Thursday, November 25, 2021. This statement may be filed online with the Division at ocd.hearings@state.nm.us, and should include: The name of the party and his or her attorney; a concise statement of the case; the name(s) of the witness(es) the party will call to testify at the hearing; the approximate time the party will need to present his or her case; and identification of any procedural matters that need to be resolved prior to the hearing. The Pre-Hearing Statement must also be provided to the undersigned.

ATTACHMENT

A

Very truly yours,

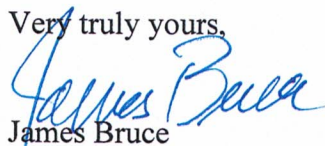
A handwritten signature in blue ink that reads "James Bruce". The signature is written in a cursive style with a large initial "J".

James Bruce

Attorney for Mewbourne Oil Company

Devon Energy Production Company, L.P.
333 W. Sheridan Ave.
Oklahoma City, Oklahoma 73102
Attn: Aaron Young

Barry Lee Bradford d/b/a
Crossland Oil & Gas
P.O. Box 6000070
Dallas, Texas 75360

EOG Resources, Inc.
5509 Champions Drive
Midland, Texas 79706
Attn: Katie McBryde

Yates Energy Corporation
P.O. Box 2323
Roswell, NM 88202
Attn: Becky Pemberton

Magnum Hunter Production, Inc.
600 N. Marienfeld St., Suite 600
Midland, Texas 79701
Attn: John Coffman

MRC Delaware Resources, LLC
5400 LBJ Freeway, Suite 1500
Dallas, Texas 75240
Attn: David Johns

Murchison Oil and Gas, LLC
7250 Dallas Pkwy, #1400
Plano, Texas 75024

Murchison Bone Springs
Drilling Program 1, LLC
7250 Dallas Pkwy, #1400
Plano, Texas 75024

OXY Y-1 Company
5 Greenway Plaza, Suite 110
Houston, Texas 77046
Attn: NM Permian Land Manager

Silverton Petroleum, Inc.
P.O. Box 26
Graham, Texas 76450

Todd E. Westmoreland
P.O. Box 10107
Midland, Texas 79702

Vladin, LLC
P.O. Box 100
Artesia, NM 88211

EXHIBIT

A

U.S. Postal Service™
CERTIFIED MAIL® RECEIPT®
 Domestic Mail Only

For delivery information, visit our website at www.usps.com®.

OFFICIAL USE

2020 2450 0002 1364 7908

Certified Mail Fee

Extra Services & Fees (check box, add fee as appropriate)

Return Receipt (hardcopy) \$

Return Receipt (electronic) \$

Certified Mail Restricted Delivery \$

Adult Signature Required \$

Adult Signature Restricted Delivery \$

Postage \$

Total Postage and Fees \$

Sent To Todd E. Westmoreland
P.O. Box 10107
Midland, Texas 79702

Street and Apt. No., or PO Box #

City, State, ZIP+4®

PS Form 3800, April 2015 PSN 7530-02-000-9047 See Reverse for Instructions

Postmark
Here

SENDER: COMPLETE THIS SECTION

Complete items 1, 2, and 3.
 Print your name and address on the reverse so that we can return the card to you.
 Attach this card to the back of the mailpiece, or on the front if space permits.

1. Article Addressed to:

Devon Energy Production Company, L.P.
333 W. Sheridan Ave.
Oklahoma City, Oklahoma 73102
 Attn: Aaron Young

COMPLETE THIS SECTION ON DELIVERY

A. Signature Agent Addressee

S. Alford

B. Received by (Printed Name) S. Alford C. Date of Delivery

D. Is delivery address different from item 1? Yes No
 If YES, enter delivery address below:

3. Service Type

Priority Mail Express®

Adult Signature Registered Mail™

Adult Signature Restricted Delivery Registered Mail Restricted Delivery

Certified Mail® Delivery

Certified Mail Restricted Delivery Signature Confirmation™

Collect on Delivery Signature Confirmation Restricted Delivery

Collect on Delivery Restricted Delivery Restricted Delivery

PS Form 3811, July 2020 PSN 7530-02-000-9053

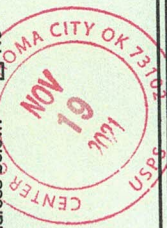

U.S. Postal Service™
CERTIFIED MAIL® RECEIPT®
 Domestic Mail Only

For delivery information, visit our website at www.usps.com®.

OFFICIAL USE

Certified Mail Fee

Extra Services & Fees (check box, add fee as appropriate)

Return Receipt (hardcopy) \$

Return Receipt (electronic) \$

Certified Mail Restricted Delivery \$

Adult Signature Required \$

Adult Signature Restricted Delivery \$

Postage \$

Total Postage and Fees \$

Sent To Devon Energy Production Company, L.P.
333 W. Sheridan Ave.
Oklahoma City, Oklahoma 73102
 Attn: Aaron Young

Street and Apt. No., or PO Box #

City, State, ZIP+4®

PS Form 3800, April 2015 PSN 7530-02-000-9047 See Reverse for Instructions

2020 2450 0002 1364 7908

SENDER: COMPLETE THIS SECTION

Complete items 1, 2, and 3.
 Print your name and address on the reverse so that we can return the card to you.
 Attach this card to the back of the mailpiece, or on the front if space permits.

1. Article Addressed to:

Todd E. Westmoreland
P.O. Box 10107
Midland, Texas 79702

COMPLETE THIS SECTION ON DELIVERY

A. Signature Agent Addressee

Todd E. Westmoreland

B. Received by (Printed Name) Todd E. Westmoreland C. Date of Delivery

D. Is delivery address different from item 1? Yes No
 If YES, enter delivery address below:

3. Service Type

Priority Mail Express®

Adult Signature Registered Mail™

Adult Signature Restricted Delivery Registered Mail Restricted Delivery

Certified Mail® Delivery

Certified Mail Restricted Delivery Signature Confirmation™

Collect on Delivery Signature Confirmation Restricted Delivery

Collect on Delivery Restricted Delivery Restricted Delivery

PS Form 3811, July 2020 PSN 7530-02-000-9053

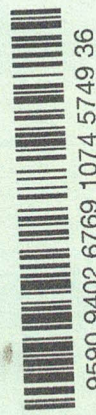

2. AI 7020 2450 0002 1364 7823

PS Form 3811, July 2020 PSN 7530-02-000-9053

U.S. Postal Service™
CERTIFIED MAIL® RECEIPT
 Domestic Mail Only

For delivery information, visit our website at www.usps.com®.

OFFICIAL USE

Certified Mail Fee \$ _____

Extra Services & Fees (check box, add fee as appropriate)

Return Receipt (hardcopy) \$ _____

Return Receipt (electronic) \$ _____

Certified Mail Restricted Delivery \$ _____

Adult Signature Required \$ _____

Adult Signature Restricted Delivery \$ _____

Postage \$ _____

Total Postage and Fees \$ _____

Sent To Murchison Oil and Gas, LLC
 7250 Dallas Pkwy, #1400
 Plano, Texas 75024

Street and Apt. No., or PO Box _____

City, State, ZIP+4® _____

PS Form 3800, April 2015 PSN 7530-02-000-9047 See Reverse for Instructions

7982 49ET 2000 0542 0202

SENDER: COMPLETE THIS SECTION

1. Complete items 1, 2, and 3.
 Print your name and address on the reverse so that we can return the card to you.
 Attach this card to the back of the mailpiece, or on the front if space permits.

1. Article Addressed to:

Viadin, LLC
 P.O. Box 100
 Artesia, NM 88211

2. Article Number (Transfer from service label)
 7020 2450 0002 1364 7836

PS Form 3811, July 2020 PSN 7530-02-000-9053

COMPLETE THIS SECTION ON DELIVERY

A. Signature Agent Addressed
 B. Received by (Printed Name) Rona Haynes C. Date of Delivery 1-19-21

D. Is delivery address different from item 1? Yes No
 If YES, enter delivery address below:

3. Service Type
 Priority Mail Express®
 Registered Mail™
 Registered Mail Restricted Delivery
 Certified Mail®
 Certified Mail Restricted Delivery
 Signature Confirmation™
 Signature Confirmation Restricted Delivery
 Insured Mail Restricted Delivery (over \$500)

Domestic Return Receipt

U.S. Postal Service™
CERTIFIED MAIL® RECEIPT
 Domestic Mail Only

For delivery information, visit our website at www.usps.com®.

OFFICIAL USE

Certified Mail Fee \$ _____

Extra Services & Fees (check box, add fee as appropriate)

Return Receipt (hardcopy) \$ _____

Return Receipt (electronic) \$ _____

Certified Mail Restricted Delivery \$ _____

Adult Signature Required \$ _____

Adult Signature Restricted Delivery \$ _____

Postage \$ _____

Total Postage and Fees \$ _____

Sent To Viadin, LLC
 P.O. Box 100
 Artesia, NM 88211

Street and Apt. No., or PO Box _____

City, State, ZIP+4® _____

PS Form 3800, April 2015 PSN 7530-02-000-9047 See Reverse for Instructions

SENDER: COMPLETE THIS SECTION

1. Article Addressed to:
 Murchison Oil and Gas, LLC
 7250 Dallas Pkwy, #1400
 Plano, Texas 75024

2. Article Number (Transfer from service label)
 7020 2450 0002 1364 786J

PS Form 3811, July 2020 PSN 7530-02-000-9053

COMPLETE THIS SECTION ON DELIVERY

A. Signature Agent Addressed
 B. Received by (Printed Name) C. Date of Delivery 1-19-21

D. Is delivery address different from item 1? Yes No
 If YES, enter delivery address below:

3. Service Type
 Priority Mail Express®
 Registered Mail™
 Registered Mail Restricted Delivery
 Certified Mail®
 Certified Mail Restricted Delivery
 Signature Confirmation™
 Signature Confirmation Restricted Delivery

Domestic Return Receipt

7982 49ET 2000 0542 0202

SENDER: COMPLETE THIS SECTION

- Complete items 1, 2, and 3.
- Print your name and address on the reverse so that we can return the card to you.
- Attach this card to the back of the mailpiece, or on the front if space permits.

1. Article Addressed to:

Murchison Bone Springs
Drilling Program 1, LLC
7250 Dallas Pkwy, #1400
Plano, Texas 75024

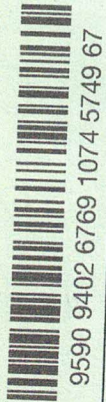

Article Number (Transfer from envelope label)

7020 2450 0002 1364 7854

Article Delivery

PS Form 3811, July 2020 PSN 7530-02-000-9053

Domestic Return Receipt

M PB

COMPLETE THIS SECTION ON DELIVERY

- A. Signature Agent
 Addressee
- B. Received by (Printed Name) C. Date of Delivery
- D. Is delivery address different from item 1? Yes
If YES, enter delivery address below: No

3. Service Type
- Adult Signature
 - Adult Signature Restricted Delivery
 - Certified Mail®
 - Certified Mail Restricted Delivery
 - Collect on Delivery
 - Collect on Delivery Restricted Delivery
 - Priority Mail Express®
 - Registered Mail™
 - Registered Mail Restricted Delivery
 - Signature Confirmation™
 - Signature Confirmation Restricted Delivery

U.S. Postal Service™
CERTIFIED MAIL® RECEIPT
Domestic Mail Only

For delivery information, visit our website at www.usps.com®.

OFFICIAL USE

Certified Mail Fee

Extra Services & Fees (check box, add fee as appropriate)

- Return Receipt (hardcopy) \$
- Return Receipt (electronic) \$
- Certified Mail Restricted Delivery \$
- Adult Signature Required \$
- Adult Signature Restricted Delivery \$

Postmark
Here

Total Postage and Fees

Sent To
OXY Y-1 Company
5 Greenway Plaza, Suite 110
Houston, Texas 77048
Attn: NM Permian Land Manager

City, State, ZIP+4®

PS Form 3800, April 2015 PSN 7530-02-000-9047 See Reverse for Instructions

U.S. Postal Service™
CERTIFIED MAIL® RECEIPT
Domestic Mail Only

For delivery information, visit our website at www.usps.com®.

OFFICIAL USE

Certified Mail Fee

- Extra Services & Fees (check box, add fee as appropriate)
- Return Receipt (hardcopy) \$
- Return Receipt (electronic) \$
- Certified Mail Restricted Delivery \$
- Adult Signature Required \$
- Adult Signature Restricted Delivery \$

Postmark
Here

Total Postage and Fees

Murchison Bone Springs
Drilling Program 1, LLC
7250 Dallas Pkwy, #1400
Plano, Texas 75024

Sent To

Street and Apt. No., or F

City, State, ZIP+4®

PS Form 3800, April 2015 PSN 7530-02-000-9047 See Reverse for Instructions

SENDER: COMPLETE THIS SECTION

- Complete items 1, 2, and 3.
- Print your name and address on the reverse so that we can return the card to you.
- Attach this card to the back of the mailpiece, or on the front if space permits.

1. Article Addressed to:

OXY Y-1 Company
5 Greenway Plaza, Suite 110
Houston, Texas 77048
Attn: NM Permian Land Manager

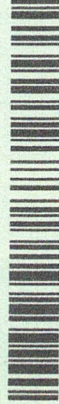

2. Article N

7020 2450 0002 1364 7847

(over \$500) Delivery

PS Form 3811, July 2020 PSN 7530-02-000-9053

Domestic Return Receipt

M PB

COMPLETE THIS SECTION ON DELIVERY

- A. Signature Agent
 Addressee
- B. Received by (Printed Name) C. Date of Delivery
- D. Is delivery address different from item 1? Yes
If YES, enter delivery address below: No

3. Service Type
- Adult Signature
 - Adult Signature Restricted Delivery
 - Certified Mail®
 - Certified Mail Restricted Delivery
 - Collect on Delivery
 - Collect on Delivery Restricted Delivery
 - Priority Mail Express®
 - Registered Mail™
 - Registered Mail Restricted Delivery
 - Signature Confirmation™
 - Signature Confirmation Restricted Delivery

(over \$500) Delivery

Domestic Return Receipt

M PB

**U.S. Postal Service™
CERTIFIED MAIL® RECEIPT®
Domestic Mail Only**

For delivery information, visit our website at www.usps.com®.

OFFICIAL USE

Certified Mail Fee \$ _____

Extra Services & Fees (check box, add fee as appropriate)

Return Receipt (hardcopy) \$ _____

Return Receipt (electronic) \$ _____

Certified Mail Restricted Delivery \$ _____

Adult Signature Required \$ _____

Adult Signature Restricted Delivery \$ _____

Postage \$ _____

Total Postage and Fees \$ _____

Sent To _____

Street and Apt. No., or PO Box _____

City, State, ZIP+4® _____

Yates Energy Corporation
P.O. Box 2323
Roswell, NM 88202
Attn: Becky Pemberton

PS Form 3800, April 2015 PSN 7530-02-000-9047 See Reverse for Instructions

5762 4967 2000 0542 0202

SENDER: COMPLETE THIS SECTION

1. Article Addressed to:

Complete items 1, 2, and 3.

Print your name and address on the reverse so that we can return the card to you.

Attach this card to the back of the mailpiece, or on the front if space permits.

Article Addressed to:

EOG Resources, Inc.
5609 Champions Drive
Midland, Texas 79706
Attn: Katie McByde

9590 9402 6769 1074 5657 74

7020 2450 0002 1364 7892

PS Form 3811, July 2020 PSN 7530-02-000-9053

COMPLETE THIS SECTION ON DELIVERY

A. Signature Agent Addressee

B. Received by (Printed Name) _____ C. Date of Delivery _____

D. Is delivery address different from item 1? Yes No

If YES, enter delivery address below:

3. Service Type

Priority Mail Express®

Registered Mail™

Adult Signature Restricted Delivery

Certified Mail®

Signature Confirmation™

Signature Confirmation Restricted Delivery

Collect on Delivery

Collect on Delivery Restricted Delivery

restricted Delivery

Domestic Return Receipt

COMPLETE THIS SECTION

1. Article Addressed to:

Complete items 1, 2, and 3.

Print your name and address on the reverse so that we can return the card to you.

Attach this card to the back of the mailpiece, or on the front if space permits.

Article Addressed to:

Yates Energy Corporation
P.O. Box 2323
Roswell, NM 88202
Attn: Becky Pemberton

9590 9402 6769 1074 5657 98

7020 2450 0002 1364 7915

PS Form 3811, July 2020 PSN 7530-02-000-9053

SENDER: COMPLETE THIS SECTION

1. Article Addressed to:

Complete items 1, 2, and 3.

Print your name and address on the reverse so that we can return the card to you.

Attach this card to the back of the mailpiece, or on the front if space permits.

Article Addressed to:

Yates Energy Corporation
P.O. Box 2323
Roswell, NM 88202
Attn: Becky Pemberton

9590 9402 6769 1074 5657 98

7020 2450 0002 1364 7915

PS Form 3811, July 2020 PSN 7530-02-000-9053

COMPLETE THIS SECTION ON DELIVERY

A. Signature Agent Addressee

B. Received by (Printed Name) _____ C. Date of Delivery _____

D. Is delivery address different from item 1? Yes No

If YES, enter delivery address below:

3. Service Type

Priority Mail Express®

Registered Mail™

Adult Signature Restricted Delivery

Certified Mail®

Signature Confirmation™

Signature Confirmation Restricted Delivery

Collect on Delivery

Collect on Delivery Restricted Delivery

restricted Delivery

Domestic Return Receipt

2692 4967 2000 0542 0202

7020 2450 0002 1364 7878

U.S. Postal Service™
CERTIFIED MAIL® RECEIPT
Domestic Mail Only

For delivery information, visit our website at www.usps.com®.

OFFICIAL USE

Certified Mail Fee
\$

Extra Services & Fees (check box, add fee as appropriate)

<input type="checkbox"/> Return Receipt (hardcopy)	\$
<input type="checkbox"/> Return Receipt (electronic)	\$
<input type="checkbox"/> Certified Mail Restricted Delivery	\$
<input type="checkbox"/> Adult Signature Required	\$
<input type="checkbox"/> Adult Signature Restricted Delivery	\$

Postage
\$

Total Postage and Fees
\$

Sent To
MRC Delaware Resources, LLC
5400 LBJ Freeway, Suite 1500
Dallas, Texas 75240
Attn: David Johns

Street and Apt. No., or P.O. Box No.
City, State, ZIP+4®

PS Form 3800, April 2015 PSN 7530-02-000-9047 See Reverse for Instructions

7020 2450 0002 1364 7885

U.S. Postal Service™
CERTIFIED MAIL® RECEIPT
Domestic Mail Only

For delivery information, visit our website at www.usps.com®.

OFFICIAL USE

Certified Mail Fee
\$

Extra Services & Fees (check box, add fee as appropriate)

<input type="checkbox"/> Return Receipt (hardcopy)	\$
<input type="checkbox"/> Return Receipt (electronic)	\$
<input type="checkbox"/> Certified Mail Restricted Delivery	\$
<input type="checkbox"/> Adult Signature Required	\$
<input type="checkbox"/> Adult Signature Restricted Delivery	\$

Postage
\$

Total Postage and Fees
\$

Sent To
Magnum Hunter Production, Inc.
600 N. Marientfeld St., Suite 600
Midland, Texas 79701
Attn: John Coffman

Street and Apt. No., or P.O. Box No.
City, State, ZIP+4®

PS Form 3800, April 2015 PSN 7530-02-000-9047 See Reverse for Instructions

7020 2450 0002 1364 7830

U.S. Postal Service™
CERTIFIED MAIL® RECEIPT
Domestic Mail Only

For delivery information, visit our website at www.usps.com®.

OFFICIAL USE

Certified Mail Fee
\$

Extra Services & Fees (check box, add fee as appropriate)

<input type="checkbox"/> Return Receipt (hardcopy)	\$
<input type="checkbox"/> Return Receipt (electronic)	\$
<input type="checkbox"/> Certified Mail Restricted Delivery	\$
<input type="checkbox"/> Adult Signature Required	\$
<input type="checkbox"/> Adult Signature Restricted Delivery	\$

Postage
\$

Total Postage and Fees
\$

Sent To
Silverton Petroleum, Inc.
P.O. Box 26
Graham, Texas 76450

Street and Apt. No., or PO Box No.
City, State, ZIP+4®

PS Form 3800, April 2015 PSN 7530-02-000-9047 See Reverse for Instructions

7020 2450 0002 1364 7809

U.S. Postal Service™
CERTIFIED MAIL® RECEIPT
Domestic Mail Only

For delivery information, visit our website at www.usps.com®.

OFFICIAL USE

Certified Mail Fee
\$

Extra Services & Fees (check box, add fee as appropriate)

<input type="checkbox"/> Return Receipt (hardcopy)	\$
<input type="checkbox"/> Return Receipt (electronic)	\$
<input type="checkbox"/> Certified Mail Restricted Delivery	\$
<input type="checkbox"/> Adult Signature Required	\$
<input type="checkbox"/> Adult Signature Restricted Delivery	\$

Postage
\$

Total Postage and Fees
\$

Sent To
Barry Lee Bradford d/b/a
Crossland Oil & Gas
P.O. Box 8000070
Dallas, Texas 75360

Street and Apt. No., or PO Box No.
City, State, ZIP+4®

PS Form 3800, April 2015 PSN 7530-02-000-9047 See Reverse for Instructions

Carlsbad Current Argus.

PART OF THE USA TODAY NETWORK

Affidavit of Publication

Ad # 0005006686

This is not an invoice

JAMES BRUCE ATTORNEY AT LAW
POBOX 1056

SANTA FE, NM 87504

I, a legal clerk of the **Carlsbad Current Argus**, a newspaper published daily at the City of Carlsbad, in said county of Eddy, state of New Mexico and of general paid circulation in said county; that the same is a duly qualified newspaper under the laws of the State wherein legal notices and advertisements may be published; that the printed notice attached hereto was published in the regular and entire edition of said newspaper and not in supplement thereof in editions dated as follows:

11/18/2021

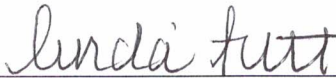

Legal Clerk

Subscribed and sworn before me this November 18, 2021:

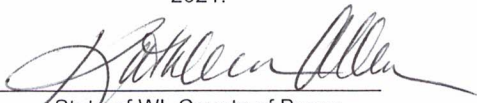

State of WI, County of Brown
NOTARY PUBLIC

1-7-25

My commission expires

KATHLEEN ALLEN
Notary Public
State of Wisconsin

Ad # 0005006686
PO #: 5006686
of Affidavits 1

This is not an invoice

NOTICE

To: Barry Lee Bradford d/b/a Crossland Oil & Gas, Devon Energy Production Company, L.P., EOG Resources, Inc., Magnum Hunter Production Inc. c/o Cimarex Energy Co., MRC Delaware Resources, LLC, Murchison Oil & Gas, LLC, Murchison Bone Springs Drilling Program 1, LLC, OXY Y-1 Company, Silverton Petroleum, Inc., Todd E. Westmoreland, Vladin, LLC, and Yates Energy Corporation, or your heirs, devisees, successors, or assigns: Mewbourne Oil Company has filed applications with the New Mexico Oil Conservation Division seeking orders pooling all uncommitted mineral interest owners in the Bone Spring formation underlying: (i) a horizontal spacing unit comprised of the N/2N/2 of Section 21 and the N/2N/2 of Section 22, Township 18 South, Range 29 East, NMPM. The unit will be dedicated to the Puma Blanca 21/22 B2DA Fed. Com. Well No. 1H (Case No. 22338); and (ii) a horizontal spacing unit comprised of the S/2N/2 of Section 21 and the S/2N/2 of Section 22, Township 18 South, Range 29 East, NMPM. The unit will be dedicated to the Puma Blanca 21/22 B2EH Fed. Com. Well No. 1H (Case No. 22339). Also to be considered will be the cost of drilling, completing, and equipping the wells and the allocation of the cost thereof, as well as actual operating costs and charges for supervision, designation of applicant as operator of the wells, and a 200% charge for the risk involved in drilling, completing, and equipping the wells. This matter is scheduled for hearing at 8:15 a.m. on Thursday, December 2, 2021. During the COVID-19 Public Health Emergency, state buildings are closed to the public and the hearing will be conducted remotely. To determine the location of the hearing or to participate in an electronic hearing, go to: emnrd.state.nm.us/OCD/hearings or see the instructions posted on the Division's website, <http://emnrd.state.nm.us/OCD/announcements.html>. You are not required to attend this hearing, but as an owner of an interest that may be affected by this application, you may appear and present testimony. A party appearing in a Division case is required by Division Rules to file a Pre-Hearing Statement no later than Thursday, November 25, 2021. This statement may be filed online with the Division at ocd.hearings@state.nm.us. Failure to appear at that time and become a party of record will preclude you from contesting this matter at a later date. The attorney for applicant is James Bruce, P.O. Box 1056, Santa Fe, New Mexico 87504, jamesbruc@aol.com. The units are located approximately 8 miles southwest of Loco Hills, New Mexico. #5006686, Current Argus, Nov. 18, 2021

EXHIBIT 5

COMPULSORY POOLING APPLICATION CHECKLIST**ALL INFORMATION IN THE APPLICATION MUST BE SUPPORTED BY SIGNED AFFIDAVITS**

Case:	22338
Date:	December 2, 2021
Applicant	Mewbourne Oil Company
Designated Operator & OGRID (affiliation if applicable)	Mewbourne Oil Company/OGRID No.14744
Applicant's Counsel:	James Bruce
Case Title:	Application of Mewbourne Oil Company for Compulsory Pooling, Eddy County, New Mexico
Entries of Appearance/Intervenors:	MRC Permian Company/Holland & Hart LLP Cimarex Energy Co./Abadie & Schill
Well Family	Puma Blanca wells
Formation/Pool	
Formation Name(s) or Vertical Extent:	Bone Spring Formation
Primary Product (Oil or Gas):	Oil
Pooling this vertical extent:	Entire Bone Spring formation
Pool Name and Pool Code:	Wildcat G-04 S182972M; Bone Spring/Pool Code 97908
Well Location Setback Rules:	Statewide rules and current horizontal well rules
Spacing Unit Size:	Quarter-quarter sections/40 acres
Spacing Unit	
Type (Horizontal/Vertical)	Horizontal
Size (Acres)	320 acres
Building Blocks:	
Orientation:	West - East
Description: TRS/County	N/2N/2 §21 and N/2N/2 §22-18S-29E, NMPM, Eddy County
Standard Horizontal Well Spacing Unit (Y/N), If No, describe	Yes
Other Situations	
Depth Severance: Y/N. If yes, description	No
Proximity Tracts: If yes, description	No
Proximity Defining Well: if yes, description	
Applicant's Ownership in Each Tract	Exhibit 2-A1
Well(s)	
Name & API (if assigned), surface and bottom hole location, footages, completion target, orientation, completion status (standard or non-standard)	Puma Blanca 21/22 B2DA Fed. Com. Well No. 1H API No. 30-015-Pending SHL: 1270 FNL & 205 FWL §21 BHL: 500 FNL & 100 FEL §22 FTP: 500 FNL & 100 FWL §21 LTP: 500 FNL & 100 FEL §22 Bone Spring/TVD 7720 feet/MD 17775 feet

EXHIBIT

6

Horizontal Well First and Last Take Points	See above
Completion Target (Formation, TVD and MD)	See above
AFE Capex and Operating Costs	
Drilling Supervision/Month \$	\$8000
Production Supervision/Month \$	\$800
Justification for Supervision Costs	Exhibit 2, page 2
Requested Risk Charge	Cost + 200%/Exhibit 2, page 2
Notice of Hearing	
Proposed Notice of Hearing	Exhibit 1
Proof of Mailed Notice of Hearing (20 days before hearing)	Exhibit 4
Proof of Published Notice of Hearing (10 days before hearing)	Exhibit 5
Ownership Determination	
Land Ownership Schematic of the Spacing Unit	Exhibit 2-A1
Tract List (including lease numbers and owners)	Exhibits 2-A1
Pooled Parties (including ownership type)	Exhibit 2-A1
Unlocatable Parties to be Pooled	
Ownership Depth Severance (including percentage above & below)	None
Joinder	
Sample Copy of Proposal Letter	Exhibit 2-B
List of Interest Owners (<i>i.e.</i> Exhibit A of JOA)	Exhibit 2-A1
Chronology of Contact with Non-Joined Working Interests	Exhibit 2-B
Overhead Rates In Proposal Letter	Exhibit 2-B
Cost Estimate to Drill and Complete	Exhibit 2-C1
Cost Estimate to Equip Well	Exhibit 2-C1
Cost Estimate for Production Facilities	Exhibit 2-C1
Geology	
Summary (including special considerations)	Exhibit 3
Spacing Unit Schematic	Exhibits 2-A1 and 3-A
Gunbarrel/Lateral Trajectory Schematic	Exhibit 3--A
Well Orientation (with rationale)	Laydown/Exhibit 3
Target Formation	Bone Spring
HSU Cross Section	Exhibit 3-C
Depth Severance Discussion	Not Applicable
Forms, Figures and Tables	
C-102	Exhibit 2-A1

Tracts	Exhibit 2-A1	
Summary of Interests, Unit Recapitulation (Tracts)	Exhibit 2-A1	
General Location Map (including basin)	Exhibits 2-A1 and 3-A	
Well Bore Location Map	Exhibits 2-A1 and 3-A	
Structure Contour Map - Subsea Depth	Exhibit 3-A	
Cross Section Location Map (including wells)	Exhibits 3-B and 3-C	
Cross Section (including Landing Zone)	Exhibit 3-C	
Additional Information		
CERTIFICATION: I hereby certify that the information provided in this checklist is complete and accurate.		
Printed Name (Attorney or Party Representative):	James Bruce	
Signed Name (Attorney or Party Representative):		
Date:	November 30, 2021	

COMPULSORY POOLING APPLICATION CHECKLIST**ALL INFORMATION IN THE APPLICATION MUST BE SUPPORTED BY SIGNED AFFIDAVITS**

Case:	22339
Date:	December 2, 2021
Applicant	Mewbourne Oil Company
Designated Operator & OGRID (affiliation if applicable)	Mewbourne Oil Company/OGRID No.14744
Applicant's Counsel:	James Bruce
Case Title:	Application of Mewbourne Oil Company for Compulsory Pooling, Eddy County, New Mexico
Entries of Appearance/Intervenors:	MRC Permian Company/Holland & Hart LLP Cimarex Energy Co./Abadie & Schill
Well Family	Puma Blanca wells
Formation/Pool	
Formation Name(s) or Vertical Extent:	Bone Spring Formation
Primary Product (Oil or Gas):	Oil
Pooling this vertical extent:	Entire Bone Spring formation
Pool Name and Pool Code:	Wildcat G-04 S182972M; Bone Spring/Pool Code 97908
Well Location Setback Rules:	Statewide rules and current horizontal well rules
Spacing Unit Size:	Quarter-quarter sections/40 acres
Spacing Unit	
Type (Horizontal/Vertical)	Horizontal
Size (Acres)	320 acres
Building Blocks:	
Orientation:	West - East
Description: TRS/County	S/2N/2 §21 and S/2N/2 §22-18S-29E, NMPM, Eddy County
Standard Horizontal Well Spacing Unit (Y/N), If No, describe	Yes
Other Situations	
Depth Severance: Y/N. If yes, description	No
Proximity Tracts: If yes, description	No
Proximity Defining Well: if yes, description	
Applicant's Ownership in Each Tract	Exhibit 2-A2
Well(s)	
Name & API (if assigned), surface and bottom hole location, footages, completion target, orientation, completion status (standard or non-standard)	Puma Blanca 21/22 B2EH Fed. Com. Well No. 1H API No. 30-015-Pending SHL: 1300 FNL & 205 FWL §21 BHL: 1800 FNL & 100 FEL §22 FTP: 1800 FNL & 100 FWL §21 LTP: 1800 FNL & 100 FEL §22 Bone Spring/TVD 7750 feet/MD 17805 feet

EXHIBIT

6

Horizontal Well First and Last Take Points	See above
Completion Target (Formation, TVD and MD)	See above
AFE Capex and Operating Costs	
Drilling Supervision/Month \$	\$8000
Production Supervision/Month \$	\$800
Justification for Supervision Costs	Exhibit 2, page 2
Requested Risk Charge	Cost + 200%/Exhibit 2, page 2
Notice of Hearing	
Proposed Notice of Hearing	Exhibit 1
Proof of Mailed Notice of Hearing (20 days before hearing)	Exhibit 4
Proof of Published Notice of Hearing (10 days before hearing)	Exhibit 5
Ownership Determination	
Land Ownership Schematic of the Spacing Unit	Exhibit 2-A2
Tract List (including lease numbers and owners)	Exhibits 2-A2
Pooled Parties (including ownership type)	Exhibit 2-A2
Unlocatable Parties to be Pooled	
Ownership Depth Severance (including percentage above & below)	None
Joinder	
Sample Copy of Proposal Letter	Exhibit 2-B
List of Interest Owners (<i>i.e.</i> Exhibit A of JOA)	Exhibit 2-A2
Chronology of Contact with Non-Joined Working Interests	Exhibit 2-B
Overhead Rates In Proposal Letter	Exhibit 2-B
Cost Estimate to Drill and Complete	Exhibit 2-C2
Cost Estimate to Equip Well	Exhibit 2-C2
Cost Estimate for Production Facilities	Exhibit 2-C2
Geology	
Summary (including special considerations)	Exhibit 3
Spacing Unit Schematic	Exhibits 2-A2 and 3-A
Gunbarrel/Lateral Trajectory Schematic	Exhibit 3-A
Well Orientation (with rationale)	Laydown/Exhibit 3
Target Formation	Bone Spring
HSU Cross Section	Exhibit 3-C
Depth Severance Discussion	Not Applicable
Forms, Figures and Tables	
C-102	Exhibit 2-A2

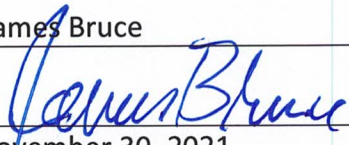
Tracts	Exhibit 2-A2
Summary of Interests, Unit Recapitulation (Tracts)	Exhibit 2-A2
General Location Map (including basin)	Exhibits 2-A2 and 3-A
Well Bore Location Map	Exhibits 2-A2 and 3-A
Structure Contour Map - Subsea Depth	Exhibit 3-A
Cross Section Location Map (including wells)	Exhibits 3-B and 3-C
Cross Section (including Landing Zone)	Exhibit 3-C
Additional Information	
CERTIFICATION: I hereby certify that the information provided in this checklist is complete and accurate.	
Printed Name (Attorney or Party Representative):	James Bruce
Signed Name (Attorney or Party Representative):	
Date:	November 30, 2021