

**STATE OF NEW MEXICO
ENERGY, MINERALS AND NATURAL RESOURCES DEPARTMENT
OIL CONSERVATION DIVISION**

**APPLICATION OF MEWBOURNE OIL
TO RE-OPEN CASE NO. 22639 FOR
COMPULSORY POOLING, EDDY
COUNTY, NEW MEXICO.**

Case No. 23300

NOTICE OF FILING ADDITIONAL EXHIBIT

Mewbourne Oil Company submits for filing Replacement Exhibit 2-B, which identifies the parties being pooled (at page 3). COG Operating LLC is not being pooled.

Respectfully submitted,

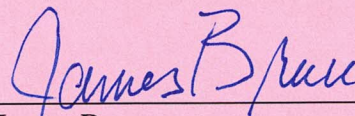

James Bruce
Post Office Box 1056
Santa Fe, New Mexico 87504
(505) 982-2043
jamesbruc@aol.com

Attorney for Mewbourne Oil Company

Section Plat
Bondurant 1/12 B2BO Fed Com #1H
W/2E/2 of Section 1 & W/2E/2 of Section 12-T19S-R32E, Lea County, NM

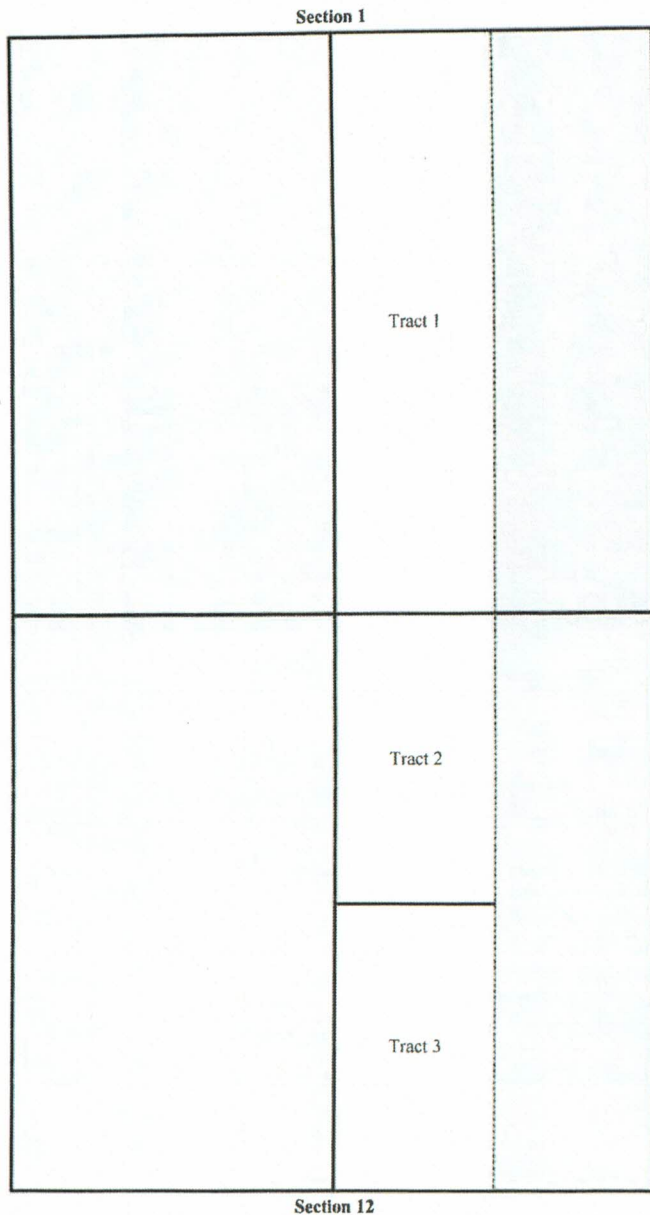

Tract 1: W/2E/2 of Section 1 - Fed Lease NMNM 12568-A
Mewbourne Oil Company

Tract 3: W/2SE/4 of Section 12 - Fed Lease NMNM 89820
COG Operating, LLC

Tract 2: W/2NE/4 of Section 12 - Fed Lease NMNM 56251
COG Operating, LLC
WPX Energy Permian, LLC
Michael Lynn Taylor, individually and as independent executor of the Estate of Neal A. Taylor
Ann H. Taylor, deceased, Michael Lynn Taylor, Attorney-in-Fact Under Power of Attorney dated 3/20/1995

Replacement
EXHIBIT 2-B

RECAPITULATION FOR Bondurant 1/12 B2BO FED COM #1H

Tract Number	Number of Acres Committed	Percentage of Interest in Communitized Area
1	160	50.000000%
2	80	25.000000%
3	80	25.000000%
TOTAL	320	100.000000%

T19S-R32E, Lea County, NM

Section 1

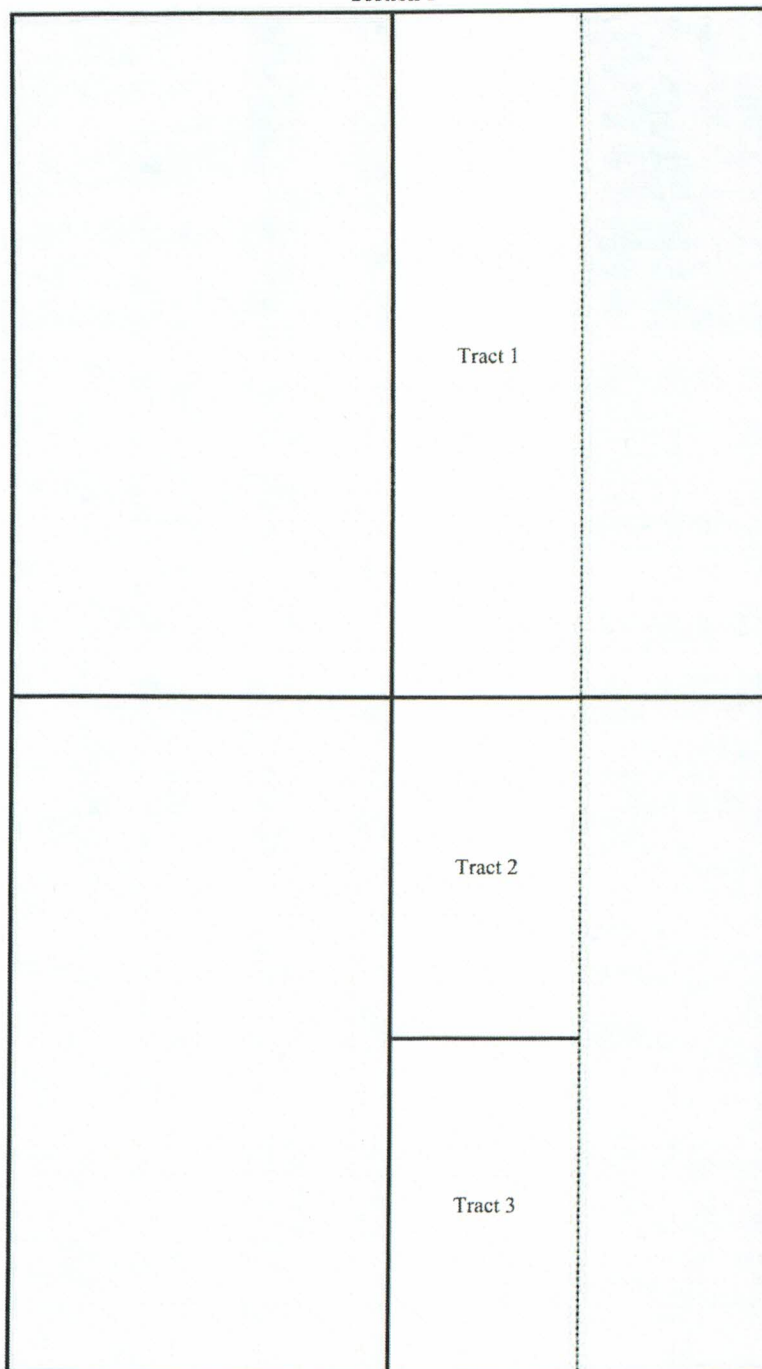

Section 12

2

TRACT OWNERSHIP
 Bondurant 1/12 B2BO Fed Com #1H
 W/2E/2 of Section 1 & W/2E/2 of Section 12

W/2E/2 of Section 1 & W/2E/2 of Section 12
Bone Spring Formation:

(indicates party being pooled)*

Owner	% of Leasehold Interest
Mewbourne Oil Company	50.000000%
*COG Operating, LLC 600 W. Illinois Ave. Midland, TX 79701 Attn: Outside Operated Properties	44.750000%
*WPX Energy Permian, LLC 333 W. Sheridan Ave. Oklahoma City, OK 73102	4.937500%
*Michael Lynn Taylor, individually & as independent executor of the Estate of Neal A. Taylor 2868 Red Bluff Circle San Angelo, TX 76904	0.156250%
*Ann H. Taylor, deceased Michael Lynn Taylor, Attorney-in-Fact Under POA dated 3/20/1995 2868 Red Bluff Circle San Angelo, TX 76904	0.156250%
TOTAL	100.000000%

Total Interest Being Pooled: 50.000000%

OWNERSHIP BY TRACT

W/2E/2 of Section 1

Owner	% of Leasehold Interest
Mewbourne Oil Company	100.000000%
TOTAL	100.000000%

W/2NE/4 of Section 12

Owner	% of Leasehold Interest
COG Operating, LLC	78.000000%
WPX Energy Permian, LLC	19.500000%
Michael Lynn Taylor	1.250000%
Ann H. Taylor	1.250000%
TOTAL	100.000000%

W/2SE/4 of Section 12

Owner	% of Leasehold Interest
COG Operating, LLC	100.000000%
TOTAL	100.000000%