

CASE NO. 23710

**APPLICATION OF MEWBOURNE OIL COMPANY
FOR COMPULSORY POOLING,
EDDY COUNTY, NEW MEXICO**

EXHIBIT LIST

1. Application and Proposed Notice
2. Landman's Affidavit
3. Affidavit of Mailing

BEFORE THE NEW MEXICO OIL CONSERVATION DIVISION

**APPLICATION OF MEWBOURNE OIL COMPANY
TO RE-OPEN CASE NO. 21887 FOR COMPULSORY
POOLING, EDDY COUNTY, NEW MEXICO.**

Case No. 23710

APPLICATION

Mewbourne Oil Company applies for an order re-opening Case No. 21887 and pooling all uncommitted mineral interest owners in the Bone Spring formation underlying a horizontal spacing unit comprised of the S/2S/2 of Section 18 and the S/2S/2 of Section 17, Township 18 South, Range 31 East, N.M.P.M., Eddy County, New Mexico, and in support thereof, states:

1. Applicant is an interest owner in the S/2S/2 of Section 18 and the S/2S/2 of Section 17, and has the right to drill a well thereon.
2. Applicant proposes to drill the Local Legend 18/17 B2MP Fed. Com. Well No. 1H to a depth sufficient to test the Bone Spring formation, and to dedicate S/2S/2 of Section 18 and the S/2S/2 of Section 17 thereto. The well is a horizontal well, with a first take point in the SW/4SW/4 of 18 and a last take point in the SE/4SE/4 of Section 17.
3. Applicant has in good faith sought to obtain the voluntary joinder of all other mineral interest owners in the S/2S/2 of Section 18 and the S/2S/2 of Section 17 for the purposes set forth herein.
4. Although applicant attempted to obtain voluntary agreements from all mineral interest owners to participate in the drilling of the well or to otherwise commit their interests to the well, certain interest owners have failed or refused to join in dedicating their interests. Therefore, applicant seeks an order pooling all uncommitted mineral interest owners in the Bone

EXHIBIT /

Spring formation underlying the S/2S/2 of Section 18 and the S/2S/2 of Section 17, pursuant to NMSA 1978 §70-2-17.

5. The pooling of all uncommitted mineral interest owners in the Bone Spring formation underlying the S/2S/2 of Section 18 and the S/2S/2 of Section 17 will prevent the drilling of unnecessary wells, prevent waste, and protect correlative rights.

WHEREFORE, applicant requests that, after notice and hearing, the Division enter its order:

- A. Re-opening Case No. 21887 and pooling all uncommitted mineral interest owners in the Bone Spring formation underlying the S/2S/2 of Section 18 and the S/2S/2 of Section 17;
- B. Designating applicant as operator of the well;
- C. Considering the cost of drilling, completing, testing, and equipping the well, and allocating the cost among the well's working interest owners;
- D. Approving actual operating charges and costs charged for supervision, together with a provision adjusting the rates pursuant to the COPAS accounting procedure; and
- E. Setting a 200% charge for the risk involved in drilling, completing, testing and equipping the well in the event a working interest owner elects not to participate in the well.

Respectfully submitted,

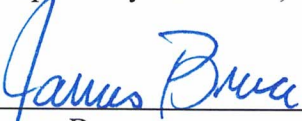
James Bruce
Post Office Box 1056
Santa Fe, New Mexico 87504
(505) 982-2043

Attorney for Mewbourne Oil Company

Application of Mewbourne Oil Company to Re-open Case No. 21887 for compulsory pooling, Eddy County, New Mexico. Mewbourne Oil Company seeks an order re-opening Case No. 21887 and pooling all uncommitted mineral interest owners in the Bone Spring formation underlying a horizontal spacing unit comprised of the S/2S/2 of Section 18 and the S/2S/2 of Section 17, Township 18 South, Range 31 East, NMPM, for the purpose of drilling the Local Legend 18/17 B2MP Fed. Com. Well No. 1H. The well has a first take point in the SW/4SW/4 of 18 and a last take point in the SE/4SE/4 of Section 17. Also to be considered will be the cost of drilling, completing, testing, and equipping the well and the allocation of the cost thereof, as well as actual operating costs and charges for supervision, designation of applicant as operator of the wells, and a 200% charge for the risk involved in drilling, completing, testing, and equipping the well. The unit is located approximately 7 miles southeast of Loco Hills, New Mexico.

**STATE OF NEW MEXICO
ENERGY, MINERALS AND NATURAL RESOURCES DEPARTMENT
OIL CONSERVATION DIVISION**

**APPLICATION OF MEWBOURNE OIL COMPANY
RO RE-OPEN CASE NO. 21887 FOR COMPULSORY
POOLING, EDDY COUNTY, NEW MEXICO.**

Case No. 23710

SELF-AFFIRMED STATEMENT OF MITCH ROBB

Mitch Robb deposes and states:

1. I am a landman for Mewbourne Oil Company (“Mewbourne”), and have personal knowledge of the matters stated herein. I have been qualified by the Division as an expert petroleum landman.

2. Pursuant to Division Rules, the following information is submitted in support of the compulsory pooling application:

3. The purpose of this application is to force pool and additional working interest owner into the horizontal spacing unit described below, and in wells to be drilled in the unit.

4. In this case, Mewbourne seeks an order re-opening Case No. 21887 and pooling all uncommitted mineral interest owners in the Bone Spring formation underlying a horizontal spacing unit comprised of the S/2S/2 of Section 18 and the S/2S/2 of Section 17, Township 18 South, Range 31 East, NMPM, for the purpose of drilling the Local Legend 18/17 B2MP Fed. Com. Well No. 528H (f/k/a the Local Legend 18/17 B2MP Fed. Com. Well No. 1H).

The well name was changed to conform to current government-required well naming conventions.

5. A land plat outlining the unit being pooled is submitted as Attachment A. A Form C-102 for the well is also part of the attachment. The C-102 was submitted at the original hearing.

6. Attachment B contains (i) a plat showing the tracts and interest owners involved, and (ii) a plat showing the percentage of each tract in the unit.

The interest owners who voluntarily joined or were pooled in the original case are shown as “Mewbourne Oil Company, *et al.*”

7. Attachment C a copy of the proposal letter mailed to the additional owner. In addition, a list of contacts is included.

EXHIBIT 2

8. The additional working interest owner is locatable.
9. Mewbourne has made a good faith effort to obtain the voluntary joinder of the additional working interest owner in the proposed well.
10. Attachment D is the Authorization for Expenditure for the proposed well. The estimated cost of the well is fair and reasonable, and is comparable to the cost of other wells of similar depths and length drilled in this area of Eddy County.
11. Mewbourne requests overhead and administrative rates of \$8000/month for a drilling well and \$800/month for a producing well. These rates are fair, and comparable to the rates charged by other operators for wells of these types in this area of Eddy County. They are also the rates set forth in the Joint Operating Agreements for the well units. Mewbourne requests that these rates be adjusted periodically as provided in the COPAS Accounting Procedure.
12. Mewbourne requests that the maximum cost plus 200% risk charge be assessed against non-consenting working interest owners.
13. Mewbourne requests that it be designated operator of the well.
14. The attachments to this affidavit were prepared by me or under my supervision, or compiled from company business records.
15. The granting of this application is in the interests of conservation and the prevention of waste.

I understand that this Self-Affirmed Statement will be used as written testimony in this case. I affirm that my testimony in paragraphs 1 through 15 above is true and correct and is

made under penalty of perjury under the laws of the State of New Mexico. My testimony is made as of the date handwritten next to my signature below.

Date: 07/27/2023



Mitch Robb

Section Plat

Local Legend 18/17 Fed Com #528H
S/2S/2 of Section 18 & S/2S/2 of Section 17-T18S-R31E
Eddy County, NM

Section 18

Section 17

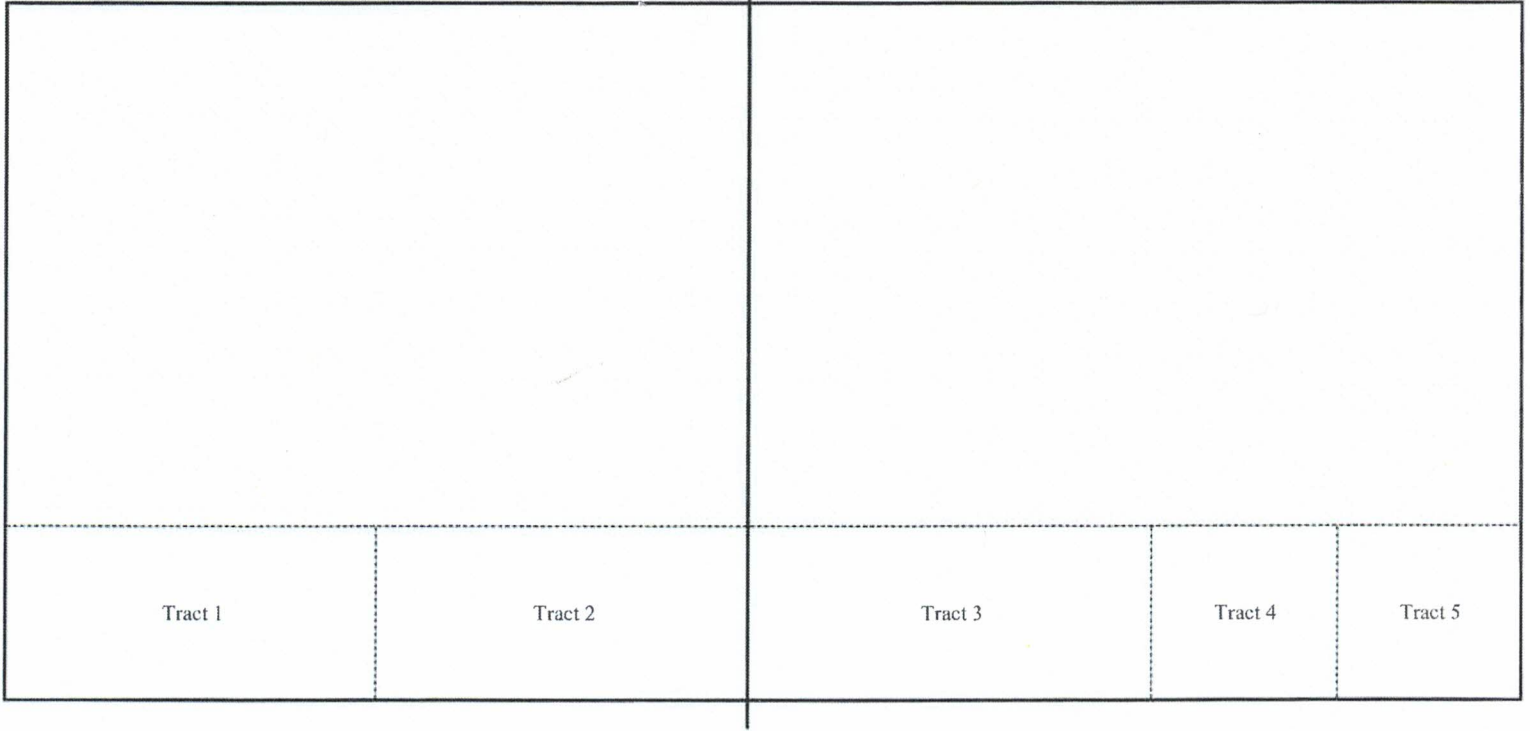

Tract 1

Tract 2

Tract 3

Tract 4

Tract 5

Tract 1: S/2SW/4 of Section 18 - Federal Lease NMNM 134871

Mewbourne Oil Company, et al.

Tract 2: S/2SE/4 of Section 18 - Federal Lease NMLC 029393B

Mewbourne Oil Company, et al.

Tract 3: S/2SW/4 of Section 17 - Federal Lease NMNM 139369

Mewbourne Oil Company, et al.

Tract 4: SW/4SE/4 of Section 17 - Federal Lease NMNM 0263331

Mewbourne Oil Company, et al.

Michael Harrison Moore, Trustee of the Michael Harrison Moore Trust under Third Amendment and Restatement of The Moore Trust dated December 15, 1998

Tract 5: SE/4SE/4 of Section 17 - Federal Lease NMNM 83601

Mewbourne Oil Company, et al.

ATTACHMENT

A

District I
 1625 N French Dr., Hobbs, NM 88240
 Phone: (575) 393-6161 Fax: (575) 393-0720
 District II
 811 S First St., Artesia, NM 88210
 Phone: (575) 748-1283 Fax: (575) 748-9720
 District III
 1000 Rio Brazos Road, Aztec, NM 87410
 Phone: (505) 334-6178 Fax: (505) 334-6170
 District IV
 1220 S St. Francis Dr., Santa Fe, NM 87505
 Phone: (505) 476-3460 Fax: (505) 476-3462

State of New Mexico
 Energy, Minerals & Natural Resources Department
OIL CONSERVATION DIVISION
 1220 South St. Francis Dr.
 Santa Fe, NM 87505

Form C-102
 Revised August 1, 2011
 Submit one copy to appropriate
 District Office

AMENDED REPORT

WELL LOCATION AND ACREAGE DEDICATION PLAT

¹ API Number 30-015-Vending		² Pool Code 56405		³ Pool Name Shugart North; Bone Spring					
⁴ Property Code		⁵ Property Name LOCAL LEGEND 18/17 B2MP FED COM				⁶ Well Number 1H			
⁷ GRID NO 14774		⁸ Operator Name MEWBOURNE OIL COMPANY				⁹ Elevation 3645'			
¹⁰ Surface Location									
UL or lot no I	Section 13	Township 18S	Range 30E	Lot Idn	Feet from the 2020	North/South line SOUTH	Feet From the 240	East/West line EAST	County EDDY
¹¹ Bottom Hole Location If Different From Surface									
UL or lot no P	Section 17	Township 18S	Range 31E	Lot Idn	Feet from the 660	North/South line SOUTH	Feet from the 100	East/West line EAST	County EDDY
¹² Dedicated Acres 3.20		¹³ Joint or Infill		¹⁴ Consolidation Code		¹⁵ Order No			

No allowable will be assigned to this completion until all interest have been consolidated or a non-standard unit has been approved by the division.

CORNER DATA
NAD 83 GRID - NM EAST

A: FOUND BRASS CAP "1916" N: 633234.8 - E: 664106.3	I: FOUND BRASS CAP "1916" N: 633315.2 - E: 679778.5
B: FOUND BRASS CAP "1916" N: 638512.4 - E: 664088.3	J: FOUND BRASS CAP "1916" N: 633299.3 - E: 677133.9
C: FOUND BRASS CAP "1916" N: 638522.2 - E: 666727.9	K: FOUND BRASS CAP "1916" N: 633284.4 - E: 674492.0
D: FOUND BRASS CAP "1916" N: 638531.3 - E: 669365.9	L: FOUND BRASS CAP "1916" N: 633266.5 - E: 671854.3
E: FOUND BRASS CAP "1916" N: 638545.8 - E: 671820.8	M: FOUND BRASS CAP "1916" N: 633253.0 - E: 669383.5
F: FOUND BRASS CAP "1916" N: 638562.7 - E: 674461.7	N: FOUND BRASS CAP "1916" N: 633243.7 - E: 666744.7
G: FOUND BRASS CAP "1916" N: 638597.2 - E: 679742.5	O: FOUND BRASS CAP "1916" N: 635892.2 - E: 669374.2
H: FOUND BRASS CAP "1916" N: 635956.7 - E: 679757.2	P: FOUND BRASS CAP "1916" N: 635923.5 - E: 674476.9

GEODETIC DATA
NAD 83 GRID - NM EAST

SURFACE LOCATION
N: 635271.7 - E: 669136.5
LAT: 32.7457098° N
LONG: 103.9176649° W

GEODETIC DATA
NAD 83 GRID - NM EAST

BOTTOM HOLE
N: 633974.4 - E: 679673.2
LAT: 32.7420257° N
LONG: 103.8834127° W

17 OPERATOR CERTIFICATION
I hereby certify that the information contained herein is true and complete to the best of my knowledge and belief, and that this organization either owns a working interest or unleased mineral interest in the land including the proposed bottom hole location or has a right to drill this well at this location pursuant to a contract with an owner of such a mineral or working interest, or to a voluntary pooling agreement or a compulsory pooling order heretofore entered by the division

Signature _____ Date _____
 Printed Name _____
 E-mail Address _____

18 SURVEYOR CERTIFICATION
I hereby certify that the well location shown on this plat was plotted from field notes of actual surveys made by me or under my supervision, and that the same is true and correct to the best of my belief.

09-22-2020
 Date of Survey
 Signature and Seal of Professional Surveyor _____
 19680
 Certificate Number

Job: No: LS20090477

RECAPITULATION FOR LOCAL LEGEND 18/17 FED COM #52011

Tract Number	Number of Acres Committeed	Percentage of Interst in Communitized Area
1	74.79	23.758696%
2	80	25.413768%
3	80	25.413768%
4	40	12.706884%
5	40	12.706884%
TOTAL	314.79	100.000000%

T18S-R31E, Eddy County, NM

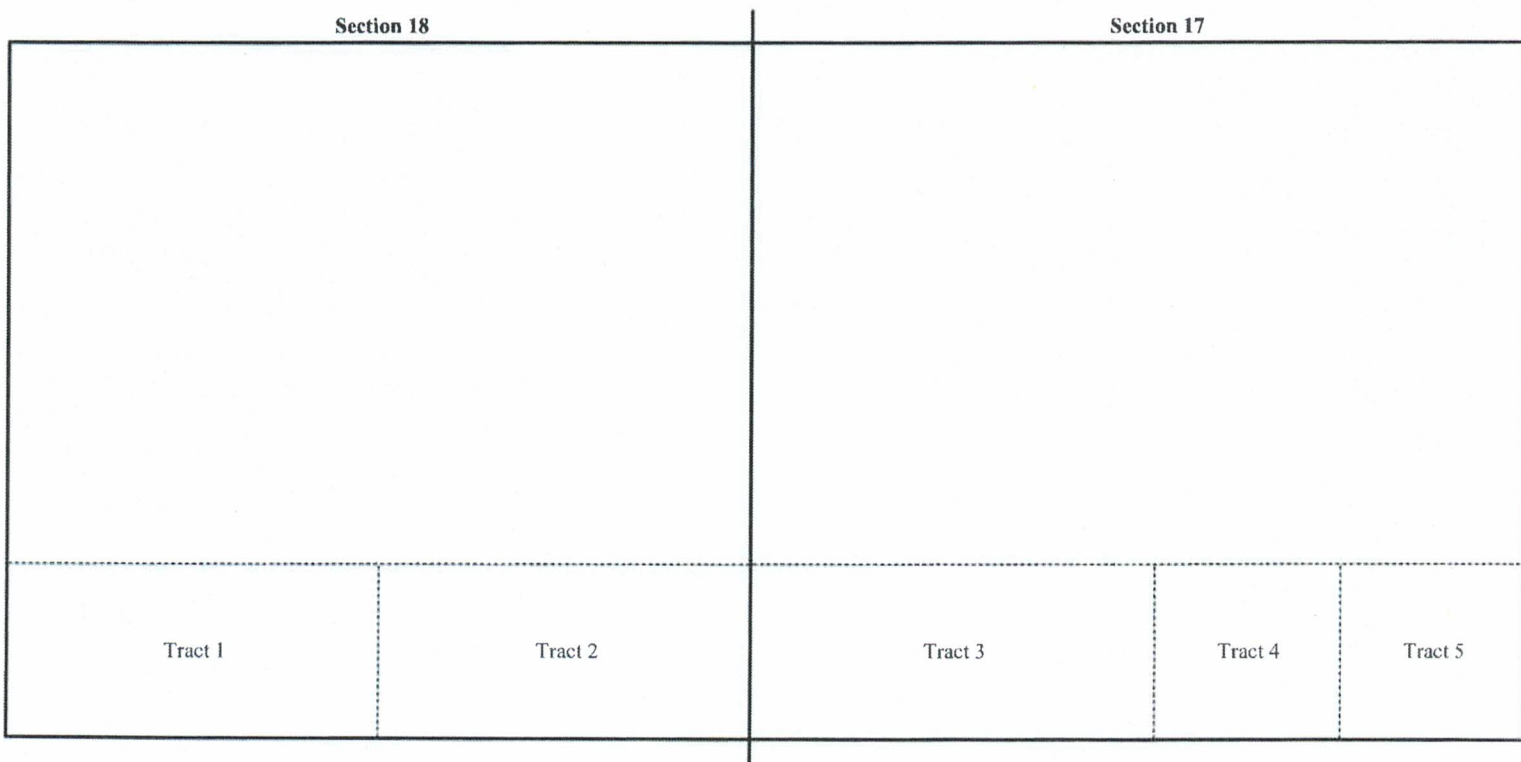

ATTACHMENT *B*

TRACT OWNERSHIP

Local Legend 18/17 Fed Com #528H
 S/2S/2 of Section 18 & S/2S/2 of Section 17-T18S-R31E
 Eddy County, NM

S/2S/2 of Section 18 & S/2S/2 of Section 17

Bone Spring Formation:

Owner	% of Leasehold Interest
Mewbourne Oil Company, et al.	87.293116%
*The Michael Harrison Moore Trust P.O. Box 51570 Midland, TX 79701-1570	6.353442%
TOTAL	100.000000%

Total Interest Being Pooled: 6.353442%

OWNERSHIP BY TRACT

S/2S/2 of Section 18

Owner	% of Leasehold Interest
Mewbourne Oil Company, et al.	100.000000%
TOTAL	100.000000%

S/2SW/4 of Section 17

Owner	% of Leasehold Interest
Mewbourne Oil Company, et al.	100.000000%
TOTAL	100.000000%

SW/4SE/4 of Section 17

Owner	% of Leasehold Interest
Mewbourne Oil Company, et al.	50.000000%
The Michael Harrison Moore Trust	50.000000%
TOTAL	100.000000%

SE/4SE/4 of Section 17

Owner	% of Leasehold Interest
Mewbourne Oil Company, et al.	100.000000%
TOTAL	100.000000%

Summary of Communications
Local Legend 18/17 B2MP Fed Com #1H
S/2S/2 of Section 18&S/2S/2 of Section 17
T18S-R31E, Eddy County, NM

The Michael Harrison Moore Trust:

3/30/2023: Mailed Working Interest Unit, Well Proposal and Joint Operating Agreement to the above listed party.

6/27/2023: Correspondence with above listed party regarding Working Interest Unit and Well Proposal. Was informed that the trust wouldn't do anything until an Assignment was approved by the BLM.

Ongoing: Waiting on approved Assignment from BLM

ATTACHMENT

C

MEWBOURNE OIL COMPANY

FASKEN CENTER
500 WEST TEXAS, SUITE 1020
MIDLAND, TX 79701

TELEPHONE (432) 682-3715

March 30, 2023

Via Certified Mail

Michael Harrison Moore, Trustee of the
Michael Harrison Moore Trust under
Third Amendment and Restatement of
The Moore Trust dated December 15, 1998
P.O. Box 51570
Midland, TX 79701-1570

Re: Local Legend 18/17 Fed Com #525H
SL: 2050' FSL & 240' FEL (Section 13);
BHL: 2050' FSL & 100' FEL (Section 17)

Local Legend 18/17 Fed Com #528H
SL: 2020' FSL & 240' FEL (Section 13);
BHL: 660' FSL & 100' FEL (Section 17)

Sections 18 & 17, T18S, R31E
Eddy County, New Mexico

Ladies and Gentlemen:

Mewbourne Oil Company ("Mewbourne") as Operator hereby proposes to drill the captioned Local Legend 18/17 Fed Com #525H well at the above referenced surface location (SL) to the referenced bottom hole location (BHL). The proposed well will be drilled to an approximate true vertical depth (TVD) of 8,600 feet subsurface to evaluate the Bone Spring Formation. The proposed well will have a measured depth (MD) of approximately 19,100 feet. The N/2S/2 of the captioned Sections 18 & 17 will be dedicated to the well as the spacing unit.

In addition, Mewbourne as Operator hereby proposes to drill the captioned Local Legend 18/17 Fed Com #528H well at the above referenced surface location (SL) to the referenced bottom hole location (BHL). The proposed well will be drilled to an approximate true vertical depth (TVD) of 8,670 feet subsurface to evaluate the Bone Spring Formation. The proposed well will have a measured depth (MD) of approximately 19,270 feet. The S/2S/2 of the captioned Sections 18 & 17 will be dedicated to the well as the spacing unit.

Please sign and return said AFEs at your earliest convenience if you elect to participate in the captioned wells and return to me within thirty (30) days.

Should you have any questions regarding the above, please email me at mrobb@mewbourne.com or call me at (432) 682-3715.

Sincerely,

MEWBOURNE OIL COMPANY

Mitch Robb
Landman



April 14, 2023

Dear Simple Certified:

The following is in response to your request for proof of delivery on your item with the tracking number: **9414 8361 0426 2654 7231 51.**

Item Details

Status: Delivered to Agent for Final Delivery
Status Date / Time: April 14, 2023, 12:06 pm
Location: MIDLAND, TX 79705
Postal Product: First-Class Mail®
Extra Services: Certified Mail™
 Return Receipt Electronic

Recipient Name: Michael Harrison Moore Trustee of the Michael

Recipient Signature

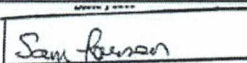
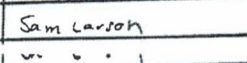
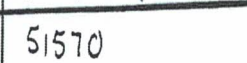
Signature of Recipient: (Authorized Agent)	  
Address of Recipient:	51570

Note: Scanned image may reflect a different destination address due to Intended Recipient's delivery instructions on file.

Thank you for selecting the United States Postal Service® for your mailing needs. If you require additional assistance, please contact your local Post Office™ or a Postal representative at 1-800-222-1811.

Sincerely,
United States Postal Service®
475 L'Enfant Plaza SW
Washington, D.C. 20260-0004

Michael Harrison Moore, Trustee of the Michael
 P.O. Box 51570
 Midland, TX 79701
 Reference #: Local Legend

MEW URNE OIL COMPANY

AUTHORIZATION FOR EXPENDITURE

Well Name: LOCAL LEGEND 18/17 FED COM #528H (B2MP) Prospect: Barrel Crusher 19/20
 Location: SL: 2020 FSL & 240 FEL (13); BHL: 660 FSL & 100 FEL (17) County: Eddy ST: NM
 Sec. 18 Blk: Survey: TWP: 18S RNG: 31E Prop. TVD: 8670 TMD: 19270

INTANGIBLE COSTS 0180		CODE	TCP	CODE	CC
Regulatory Permits & Surveys		0180-0100	\$20,000	0180-0200	
Location / Road / Site / Preparation		0180-0105	\$70,000	0180-0205	\$35,000
Location / Restoration		0180-0106	\$200,000	0180-0206	\$50,000
Daywork / Turnkey / Footage Drilling	32 days drlg / 3 days comp @ \$30000/d	0180-0110	\$1,025,300	0180-0210	\$96,100
Fuel	1700 gal/day @ \$3.9/gal	0180-0114	\$226,600	0180-0214	\$318,200
Alternate Fuels		0180-0115		0180-0215	\$96,300
Mud, Chemical & Additives		0180-0120	\$40,000	0180-0220	
Mud - Specialized		0180-0121	\$225,000	0180-0221	
Horizontal Drillout Services				0180-0222	\$200,000
Stimulation Toe Preparation				0180-0223	\$40,000
Cementing		0180-0125	\$120,000	0180-0225	\$45,000
Logging & Wireline Services		0180-0130	\$34,000	0180-0230	\$377,000
Casing / Tubing / Snubbing Services		0180-0134	\$30,000	0180-0234	\$15,000
Mud Logging		0180-0137	\$15,000		
Stimulation	51 Stg 20.2 MM gal / 25.3 MM lb			0180-0241	\$3,049,600
Stimulation Rentals & Other				0180-0242	\$278,000
Water & Other	100% FW @ \$0.85/bbl f/ Mesquite	0180-0145	\$40,000	0180-0245	\$434,500
Bits		0180-0148	\$117,500	0180-0248	
Inspection & Repair Services		0180-0150	\$50,000	0180-0250	\$5,000
Misc. Air & Pumping Services		0180-0154		0180-0254	\$10,000
Testing & Flowback Services		0180-0158	\$12,000	0180-0258	\$24,000
Completion / Workover Rig				0180-0260	\$10,500
Rig Mobilization		0180-0164	\$150,000		
Transportation		0180-0165	\$30,000	0180-0265	\$60,000
Welding, Construction & Maint. Services		0180-0168	\$4,000	0180-0268	\$16,500
Contract Services & Supervision		0180-0170	\$220,500	0180-0270	\$71,000
Directional Services	Includes Vertical Control	0180-0175	\$493,000		
Equipment Rental		0180-0180	\$213,100	0180-0280	\$37,500
Well / Lease Legal		0180-0184	\$5,000	0180-0284	
Well / Lease Insurance		0180-0185	\$5,000	0180-0285	
Intangible Supplies		0180-0188	\$7,000	0180-0288	\$1,000
Damages		0180-0190	\$10,000	0180-0290	\$10,000
Pipeline Interconnect, ROW Easements		0180-0192		0180-0292	\$5,000
Company Supervision		0180-0195	\$126,000	0180-0295	\$36,000
Overhead Fixed Rate		0180-0196	\$10,000	0180-0296	\$20,000
Contingencies	5% (TCP) 5% (CC)	0180-0199	\$175,000	0180-0299	\$267,100
TOTAL			\$3,674,000		\$5,608,300

TANGIBLE COSTS 0181		CODE	TCP	CODE	CC
Casing (19.1" - 30")		0181-0793			
Casing (10.1" - 19.0")	700' - 13 3/8" 54.5# J-55 ST&C @ \$76.3/ft	0181-0794	\$57,000		
Casing (8.1" - 10.0")	2150' - 9 5/8" 40# J-55 LT&C @ \$55.54/ft	0181-0795	\$127,500		
Casing (6.1" - 8.0")	8320' - 7" 29# HPP110 BT&C @ \$59.83/ft	0181-0796	\$531,600		
Casing (4.1" - 6.0")	11150' - 4 1/2" 13.5# HCP-110 CDC-HTQ @ \$33.47/ft			0181-0797	\$398,600
Tubing	8100' - 2 7/8" 6.5# L-80 IPC Tbg @ \$17/ft			0181-0798	\$147,100
Drilling Head		0181-0860	\$50,000		
Tubing Head & Upper Section				0181-0870	\$30,000
Horizontal Completion Tools	Completion Liner Hanger			0181-0871	\$75,000
Subsurface Equip. & Artificial Lift				0181-0880	\$25,000
Service Pumps	(1/4) TP/CP/Circ pump			0181-0886	\$7,500
Storage Tanks	(1/4) 6 OT/5 WT/GB			0181-0890	\$99,500
Emissions Control Equipment	(1/4) (3)VRT/(1)VRU/(1)FLARE/(3)KO/(1)AIR			0181-0892	\$60,500
Separation / Treating Equipment	(1/4) 4 H SEP/(1)VSEP/(3)VHT			0181-0895	\$70,100
Automation Metering Equipment	Automation			0181-0898	\$62,200
Oil/Gas Pipeline-Pipe/Valves&Misc	GAS LINE PIPE/FITTINGS + GL INJECTION			0181-0900	\$38,100
Water Pipeline-Pipe/Valves & Misc	SWDL PIPE/FITTINGS			0181-0901	\$1,000
On-site Valves/Fittings/Lines&Misc				0181-0906	\$140,000
Wellhead Flowlines - Construction	WELLHEAD FLOWLINES & CONSTRUCTION			0181-0907	\$62,100
Cathodic Protection				0181-0908	
Electrical Installation				0181-0909	\$125,000
Equipment Installation				0181-0910	\$100,000
Oil/Gas Pipeline - Construction	Gas Line Construction			0181-0920	\$17,000
Water Pipeline - Construction	SWDL Construction			0181-0921	\$3,000
TOTAL			\$766,100		\$1,461,700
SUBTOTAL			\$4,440,100		\$7,070,000

TOTAL WELL COST \$11,510,100

Extra Expense Insurance
 I elect to be covered by Operator's Extra Expense Insurance and pay my proportionate share of the premium.
Operator has secured Extra Expense Insurance covering costs of well control, clean up and redrilling as estimated in Line Item 0180-0185.
 I elect to purchase my own well control insurance policy.
If neither box is checked above, non-operating working interest owner elects to be covered by Operator's well control insurance.
 Joint owner agrees that item 0180-0245 will be provided by operator, if available, at the specified rate. Operator reserves the right to adjust the rate due to a change in market conditions.

Prepared by: Ryan McDaniel Date: 3/14/2023
 Company Approval: *M. Whittier* Date: 3/15/2023
 Joint Owner Interest: _____ Amount: _____
 Joint Owner Name: _____ Signature: _____

ATTACHMENT D

**STATE OF NEW MEXICO
ENERGY, MINERALS AND NATURAL RESOURCES DEPARTMENT
OIL CONSERVATION DIVISION**

**APPLICATION OF MEWBOURNE OIL COMPANY
FOR COMPULSORY POOLING, EDDY COUNTY,
NEW MEXICO.**

Case No. 23710

SELF-AFFIRMED STATEMENT OF NOTICE

COUNTY OF SANTA FE)
) ss.
STATE OF NEW MEXICO)

James Bruce deposes and states:

1. I am over the age of 18, and have personal knowledge of the matters stated herein.
2. I am an attorney for Mewbourne Oil Company.
3. Mewbourne Oil Company has conducted a good faith, diligent effort to find the names and correct addresses of the interest owners entitled to receive notice of the application filed herein.
4. Notice of the application was provided to the interest owner, at its last known address, by certified mail. Copies of the notice letter and certified return receipt are attached hereto as Attachment A.
5. Applicant has complied with the notice provisions of Division Rules.

I understand that this Self-Affirmed Statement will be used as written testimony in this case. I affirm that my testimony in paragraphs 1 through 5 above is true and correct and is made under penalty of perjury under the laws of the State of New Mexico. My testimony is made as of the date handwritten next to my signature below.

Date: 8/1/23

James Bruce
James Bruce

JAMES BRUCE
ATTORNEY AT LAW

POST OFFICE BOX 1056
SANTA FE, NEW MEXICO 87504

369 MONTEZUMA, NO. 213
SANTA FE, NEW MEXICO 87501

(505) 982-2043 (Phone)
(505) 660-6612 (Cell)
(505) 982-2151 (Fax)

jamesbruc@aol.com

July 13, 2023

CERTIFIED MAIL - RETURN RECEIPT REQUESTED

To: Persons on Exhibit A

Ladies and gentlemen:

Enclosed is a copy of an application for to re-open Case No. 21887 for compulsory pooling, filed with the New Mexico Oil Conservation Division by Mewbourne Oil Company (Case No. 23710), regarding the Local Legend 18/17 B2MP Fed. Com. Well No. 1H, located in a horizontal well unit comprised of the S/2S/2 of Section 18 and the S/2S/2 of Section 17, Township 18 South, Range 31 East, NMPM, Eddy County, New Mexico.

This matter is scheduled for hearing at 8:15 a.m. on Thursday, August 3, 2023. During the current circumstances, state buildings are closed to the public and the hearing will be conducted remotely. To view the hearing docket and to determine how to participate in an electronic hearing, go to <https://www.emnrd.nm.gov/ocd/hearing-info/>, or contact Marlene Salvidrez at Marlene.Salvidrez@emnrd.nm.gov. You are not required to attend this hearing, but as an owner of an interest who may be affected by the application, you may appear and present testimony. Failure to appear at that time and become a party of record will preclude you from contesting this matter at a later date. A party appearing in a Division case is required by Division Rules to file a Pre-Hearing Statement no later than five business days before the hearing date. This statement may be filed online with the Division at ocd.hearings@emnrd.nm.gov, and should include: The name of the party and his or her attorney; a concise statement of the case; the name(s) of the witness(es) the party will call to testify at the hearing; the approximate time the party will need to present his or her case; and identification of any procedural matters that need to be resolved prior to the hearing. The Pre-Hearing Statement must also be provided to the undersigned.

Very truly yours,

James Bruce

Attorney for Mewbourne Oil Company

ATTACHMENT *A*

EXHIBIT A

Michael Harrison Moore, Trustee of
the Michael Harrison Moore Trust
Under the Third Amendment and
Restatement of the Moore Trust d.
December 15, 1998
P.O. Box 51570
Midland, TX 79710-1570

U.S. Postal Service™
CERTIFIED MAIL® RECEIPT
Domestic Mail Only

For delivery information, visit our website at www.usps.com

OFFICIAL USE

7022 1670 0002 1188 2090

<p>Certified Mail Fee \$ _____</p> <p>Extra Services & Fees (check box, add fee as appropriate)</p> <p><input type="checkbox"/> Return Receipt (hardcopy) \$ _____</p> <p><input type="checkbox"/> Return Receipt (electronic) \$ _____</p> <p><input type="checkbox"/> Certified Mail Restricted Delivery \$ _____</p> <p><input type="checkbox"/> Adult Signature Required \$ _____</p> <p><input type="checkbox"/> Adult Signature Restricted Delivery \$ _____</p> <p>Postage \$ _____</p> <p>Total Postage and Fees \$ _____</p> <p>Sent To _____</p> <p>Street and Apt. No., _____</p> <p>City, State, ZIP+4® _____</p>	<p style="text-align: center;">Postmark Here</p> <p>Michael Harrison Moore, Trustee of the Michael Harrison Moore Trust Under the Third Amendment and Restatement of the Moore Trust d. December 15, 1998 P.O. Box 51570 Midland, TX 79710-1570</p>
---	---

PS Form 3800, April 2015 PSN 7530-02-000-9047 See Reverse for Instructions

SENDER: COMPLETE THIS SECTION	COMPLETE THIS SECTION ON DELIVERY												
<ul style="list-style-type: none"> ■ Complete items 1, 2, and 3. ■ Print your name and address on the reverse so that we can return the card to you. ■ Attach this card to the back of the mailpiece, or on the front if space permits. <p>1. Article Addressed to:</p> <p style="margin-left: 20px;">Michael Harrison Moore, Trustee of the Michael Harrison Moore Trust Under the Third Amendment and Restatement of the Moore Trust d. December 15, 1998 P.O. Box 51570 Midland, TX 79710-1570</p> <div style="text-align: center;">  9590 9402 7635 2122 6589 44 </div> <p>2. 7022 1670 0002 1188 2090</p>	<p>A. Signature <input type="checkbox"/> Agent <input type="checkbox"/> Addressee</p> <p>X <i>Kacey Broadway</i></p> <p>B. Received by (Printed Name) <input type="checkbox"/> Agent <input type="checkbox"/> Addressee</p> <p><i>Kacey Broadway</i> C. Date of Delivery <i>7/21/23</i></p> <p>D. Is delivery address different from item 1? <input type="checkbox"/> Yes <input type="checkbox"/> No If YES, enter delivery address below: _____</p> <p>3. Service Type</p> <table style="width: 100%; border: none;"> <tr> <td><input type="checkbox"/> Adult Signature</td> <td><input type="checkbox"/> Priority Mail Express®</td> </tr> <tr> <td><input type="checkbox"/> Adult Signature Restricted Delivery</td> <td><input type="checkbox"/> Registered Mail™</td> </tr> <tr> <td><input checked="" type="checkbox"/> Certified Mail®</td> <td><input type="checkbox"/> Registered Mail Restricted Delivery</td> </tr> <tr> <td><input type="checkbox"/> Certified Mail Restricted Delivery</td> <td><input type="checkbox"/> Signature Confirmation™</td> </tr> <tr> <td><input type="checkbox"/> Collect on Delivery</td> <td><input type="checkbox"/> Signature Confirmation Restricted Delivery</td> </tr> <tr> <td><input type="checkbox"/> Collect on Delivery Restricted Delivery</td> <td></td> </tr> </table> <p>restricted Delivery</p> <p>PS Form 3811, July 2020 PSN 7530-02-000-9053 <i>M Loc Los Respon</i> Domestic Return Receipt</p>	<input type="checkbox"/> Adult Signature	<input type="checkbox"/> Priority Mail Express®	<input type="checkbox"/> Adult Signature Restricted Delivery	<input type="checkbox"/> Registered Mail™	<input checked="" type="checkbox"/> Certified Mail®	<input type="checkbox"/> Registered Mail Restricted Delivery	<input type="checkbox"/> Certified Mail Restricted Delivery	<input type="checkbox"/> Signature Confirmation™	<input type="checkbox"/> Collect on Delivery	<input type="checkbox"/> Signature Confirmation Restricted Delivery	<input type="checkbox"/> Collect on Delivery Restricted Delivery	
<input type="checkbox"/> Adult Signature	<input type="checkbox"/> Priority Mail Express®												
<input type="checkbox"/> Adult Signature Restricted Delivery	<input type="checkbox"/> Registered Mail™												
<input checked="" type="checkbox"/> Certified Mail®	<input type="checkbox"/> Registered Mail Restricted Delivery												
<input type="checkbox"/> Certified Mail Restricted Delivery	<input type="checkbox"/> Signature Confirmation™												
<input type="checkbox"/> Collect on Delivery	<input type="checkbox"/> Signature Confirmation Restricted Delivery												
<input type="checkbox"/> Collect on Delivery Restricted Delivery													