

**STATE OF NEW MEXICO
ENERGY, MINERALS AND NATURAL RESOURCES DEPARTMENT
OIL CONSERVATION DIVISION**

**APPLICATION OF MEWBOURNE OIL COMPANY
FOR COMPULSORY POOLING,
EDDY COUNTY, NEW MEXICO**

CASE NO. 24177

EXHIBIT INDEX

Compulsory Pooling Checklist

| | |
|-----------|--|
| Exhibit A | Self-Affirmed Statement of Ariana Rodrigues |
| A-1 | Application & Proposed Notice of Hearing |
| A-2 | C-102 |
| A-3 | Plat of Tracts, Tract Ownership, Applicable Lease Numbers, Unit Recapitulation, Pooled Parties |
| A-4 | Sample Well Proposal Letter & AFE |
| A-5 | Chronology of Contact |
| Exhibit B | Self-Affirmed Statement of Charles Crosby |
| B-1 | Location Map |
| B-2 | Wolfcamp Subsea Structure Map |
| B-3 | Stratigraphic Cross-Section |
| B-4 | Production Table of Wells Producing from Third Bone Spring Sand and Wolfcamp Formations |
| B-5 | Preliminary Horizontal Survey Reports for the Proposed Wells |
| Exhibit C | Self-Affirmed Statement of Dana S. Hardy |
| C-1 | Notice Letters to All Interested Parties |
| C-2 | Chart of Notice to All Interested Parties |
| C-3 | Copies of Certified Mail Receipts and Returns |
| C-4 | Affidavit of Publication for February 8, 2024 |

COMPULSORY POOLING APPLICATION CHECKLIST**ALL INFORMATION IN THE APPLICATION MUST BE SUPPORTED BY SIGNED AFFIDAVITS**

| | |
|--|---|
| Case: 24177 | APPLICANT'S RESPONSE |
| Date | March 7, 2023 |
| Applicant | Mewbourne Oil Company |
| Designated Operator & OGRID (affiliation if applicable) | OGRID No. 14744 |
| Applicant's Counsel: | Hinkle Shanor LLP |
| Case Title: | Application of Mewbourne Oil Company for Compulsory Pooling, Eddy County, New Mexico. |
| Entries of Appearance/Intervenors: | EOG Resources, Inc.; Sabinal Energy Operating, LLC |
| Well Family | Cripple Creek |
| Formation/Pool | |
| Formation Name(s) or Vertical Extent: | Wolfcamp |
| Primary Product (Oil or Gas): | Oil |
| Pooling this vertical extent: | Wolfcamp |
| Pool Name and Pool Code: | Alacran Hills; Upper Wolfcamp Oil Pool (Code 98314) |
| Well Location Setback Rules: | Statewide |
| Spacing Unit | |
| Type (Horizontal/Vertical) | Horizontal |
| Size (Acres) | 320 acres |
| Building Blocks: | quarter-quarter |
| Orientation: | East/West |
| Description: TRS/County | N/2 S/2 of Sections 35 and 34, Township 20 South, Range 27 East, Eddy County, New Mexico. |
| Standard Horizontal Well Spacing Unit (Y/N), If No, describe <u>and is approval of non-standard unit requested in this application?</u> | Yes. |
| Other Situations | |
| Depth Severance: Y/N. If yes, description | No |
| Proximity Tracts: If yes, description | No. |
| Proximity Defining Well: if yes, description | N/A |
| Applicant's Ownership in Each Tract | Exhibit A-3 |
| Well(s) | |
| Name & API (if assigned), surface and bottom hole location, footages, completion target, orientation, completion status (standard or non-standard) | Add wells as needed |
| Well #1 | Cripple Creek 35/34 Fed Com #716H (API # ---) SHL: 1820' FSL & 205' FEL (Unit I), Section 35, T20S, R27E BHL: 1980' FSL & 100' FWL (Unit L), Section 34, T20S, R27E Completion Target: Wolfcamp (Approx. 8,400' TVD) |
| Horizontal Well First and Last Take Points | Exhibit A-2 |
| Completion Target (Formation, TVD and MD) | Exhibit A-4 |

| | |
|--|---------------------------------------|
| AFE Capex and Operating Costs | |
| Drilling Supervision/Month \$ | \$9,000.00 |
| Production Supervision/Month \$ | \$900.00 |
| Justification for Supervision Costs | Exhibit A |
| Requested Risk Charge | 200% |
| Notice of Hearing | |
| Proposed Notice of Hearing | Exhibit A-1 |
| Proof of Mailed Notice of Hearing (20 days before hearing) | Exhibit C-1, Exhibit C-2, Exhibit C-3 |
| Proof of Published Notice of Hearing (10 days before hearing) | Exhibit C-4 |
| Ownership Determination | |
| Land Ownership Schematic of the Spacing Unit | Exhibit A-3 |
| Tract List (including lease numbers and owners) | Exhibit A-3 |
| If approval of Non-Standard Spacing Unit is requested, Tract List (including lease numbers and owners) of Tracts subject to notice requirements. | N/A |
| Pooled Parties (including ownership type) | Exhibit A-3 |
| Unlocatable Parties to be Pooled | N/A |
| Ownership Depth Severance (including percentage above & below) | N/A |
| Joinder | |
| Sample Copy of Proposal Letter | Exhibit A-4 |
| List of Interest Owners (ie Exhibit A of JOA) | Exhibit A-3 |
| Chronology of Contact with Non-Joined Working Interests | Exhibit A-5 |
| Overhead Rates In Proposal Letter | Exhibit A-4 |
| Cost Estimate to Drill and Complete | Exhibit A-4 |
| Cost Estimate to Equip Well | Exhibit A-4 |
| Cost Estimate for Production Facilities | Exhibit A-4 |
| Geology | |
| Summary (including special considerations) | Exhibit B |
| Spacing Unit Schematic | Exhibit B-1 |
| Gunbarrel/Lateral Trajectory Schematic | N/A |
| Well Orientation (with rationale) | Exhibit B |
| Target Formation | Exhibit B |
| HSU Cross Section | Exhibit B-3 |
| Depth Severance Discussion | N/A |
| Forms, Figures and Tables | |
| C-102 | Exhibit A-2 |
| Tracts | Exhibit A-3 |
| Summary of Interests, Unit Recapitulation (Tracts) | Exhibit A-3 |
| General Location Map (including basin) | Exhibit B-1 |
| Well Bore Location Map | Exhibit B-2 |
| Structure Contour Map - Subsea Depth | Exhibit B-2 |

| | |
|--|-------------------|
| Cross Section Location Map (including wells) | Exhibit B-3 |
| Cross Section (including Landing Zone) | Exhibit B-3 |
| Additional Information | |
| Special Provisions/Stipulations | N/A |
| CERTIFICATION: I hereby certify that the information provided in this checklist is complete and accurate. | |
| Printed Name (Attorney or Party Representative): | Dana S. Hardy |
| Signed Name (Attorney or Party Representative): | /s/ Dana S. Hardy |
| Date: | 3/5/2024 |

**STATE OF NEW MEXICO
DEPARTMENT OF ENERGY, MINERALS AND NATURAL RESOURCES
OIL CONSERVATION DIVISION**

**APPLICATION OF MEWBOURNE OIL COMPANY
FOR COMPULSORY POOLING,
EDDY COUNTY, NEW MEXICO.**

CASE NO. 24177

**SELF-AFFIRMED STATEMENT
OF ARIANA RODRIGUES**

1. I am a landman for Mewbourne Oil Company (“Mewbourne”). I am over 18 years of age, have personal knowledge of the matters addressed herein and am competent to provide this Self-Affirmed Statement. I have previously testified before the New Mexico Oil Conservation Division (“Division”) and my credentials as an expert in petroleum land matters were accepted and made a matter of record.

2. I am familiar with the land matters involved in the above-referenced case. Copies of Mewbourne’s Application and proposed hearing notice are attached as **Exhibit A-1**.

3. None of the parties proposed to be pooled in this case indicated opposition to this matter proceeding by affidavit, therefore I do not expect any opposition at hearing.

4. Mewbourne applies for an order pooling all uncommitted mineral interests in the Wolfcamp formation underlying a 320-acre, more or less, standard horizontal spacing unit comprised of the N/2 S/2 of Sections 35 and 34, Township 20 South, Range 27 East, Eddy County, New Mexico (“Unit”).

5. Mewbourne seeks to dedicate the Unit to the Cripple Creek 35/34 Fed Com #716H well (“Well”), which will be completed in the Alacran Hills; Upper Wolfcamp Oil pool (Code 98314). The Well will be drilled from a surface hole location in the NE/4 SE/4 (Unit I) of Section 35 to a bottom hole location in the NW/4 SW/4 (Unit L) of Section 34.

6. The completed interval of the Well will be orthodox.

**Mewbourne Oil Company
Case No. 24177
Exhibit A**

7. **Exhibit A-2** contains the C-102 for the Well.
8. **Exhibit A-3** contains a plat that identifies ownership by tract in the Unit. This exhibit also includes any applicable lease numbers, a unit recapitulation, and the interests Mewbourne seeks to pool highlighted in yellow. All of the interest owners are locatable.
9. **Exhibit A-4** contains a sample well proposal letter and AFE sent to the working interest owners for the Well. The estimated costs reflected on the AFE is a fair and reasonable and comparable to the cost of other wells of similar depth and length drilled in the subject formation in the area.
10. Mewbourne has conducted a diligent search of all county public records including phone directories and computer databases.
11. In my opinion, Mewbourne made a good-faith effort to reach voluntary joinder of uncommitted interests in the Wells as indicated by the chronology of contact described in **Exhibit A-5**.
12. Mewbourne requests overhead and administrative rates of \$9,000.00 per month while the Well is being drilled and \$900.00 per month while the Well is producing. These rates are fair and are comparable to the rates charged by Mewbourne and other operators in the vicinity.
13. The attached exhibits were either prepared by me or under my supervision or were compiled from company business records.
14. In my opinion, the granting of Mewbourne's application would serve the interests of conservation, the protection of correlative rights, and the prevention of waste.
15. I understand this Self-Affirmed Statement will be used as written testimony in the subject cases. I affirm that my testimony above is true and correct and is made under penalty of

perjury under the laws of the State of New Mexico. My testimony is made as of the date
handwritten next to my signature below.

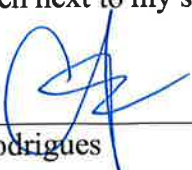

Ariana Rodrigues

3/4/2024

Date

**STATE OF NEW MEXICO
ENERGY, MINERALS AND NATURAL RESOURCES DEPARTMENT
OIL CONSERVATION DIVISION**

**APPLICATION OF MEWBOURNE OIL COMPANY
FOR COMPULSORY POOLING,
EDDY COUNTY, NEW MEXICO**

CASE NO. 24177

APPLICATION

In accordance with NMSA 1978, § 70-2-17, Mewbourne Oil Company (“Mewbourne” or “Applicant”) (OGRID No. 14744), through its undersigned attorneys, applies for an order pooling all uncommitted interests in the Wolfcamp formation underlying a 320-acre, more or less, standard horizontal spacing unit comprised of the N/2 S/2 of Sections 35 and 34, Township 20 South, Range 27 East, Eddy County, New Mexico (“Unit”). In support of this application, Mewbourne states the following.

1. Mewbourne is a working interest owner in the Unit and has the right to drill thereon.
2. Applicant seeks to dedicate the Unit to the proposed **Cripple Creek 35/34 Fed Com #716H** well (“Well”), to be drilled from a surface hole location in the NE/4 SE/4 (Unit I) of Section 35 to a bottom hole location in the NW/4 SW/4 (Unit L) of Section 34.
3. The completed interval of the Well will be orthodox.
4. Applicant has undertaken diligent, good-faith efforts to obtain voluntary agreements from all interest owners to participate in the drilling of the Well but has been unable to obtain voluntary agreements from all interests owners in the Unit.
5. The pooling of uncommitted interests will avoid the drilling of unnecessary wells, prevent waste, and protect correlative rights.

**Mewbourne Oil Company
Case No. 24177
Exhibit A-1**

6. In order to allow Applicant to obtain its just and fair share of the oil and gas underlying the subject lands, all uncommitted interests in the Unit should be pooled and Applicant should be designated the operator of the proposed horizontal Well and the Unit.

WHEREFORE, Applicant requests that this application be set for hearing before an Examiner of the Oil Conservation Division on March 7, 2024, and, after notice and hearing as required by law, the Division enter an order:

- A. Pooling all uncommitted interests in the Unit;
- B. Approving the Well in the Unit;
- C. Designating Applicant as operator of the Unit and the Well to be drilled thereon;
- D. Authorizing Applicant to recover its costs of drilling, equipping and completing the Well;
- E. Approving the actual operating charged and costs of supervision while drilling and after completion, together with a provision adjusting the rates pursuant to the COPAS accounting procedures; and
- F. Imposing a 200% penalty for the risk assumed by Applicant in drilling and completing the Well against any working interest owner who does not voluntarily participate in the drilling of the Well.

Respectfully submitted,

HINKLE SHANOR LLP

/s/ Dana S. Hardy
Dana S. Hardy
Jaclyn M. McLean
P.O. Box 2068
Santa Fe, NM 87504-2068
Phone: (505) 982-4554

Facsimile: (505) 98208623
dhardy@hinklelawfirm.com
jmclean@hinklelawfirm.com
Counsel for Mewbourne Oil Company

Application of Mewbourne Oil Company for Compulsory Pooling, Eddy County, New Mexico. Mewbourne Oil Company (“Applicant”) applies for an order pooling all uncommitted interests in the Wolfcamp formation underlying a 320-acre, more or less, standard horizontal spacing unit comprised of the N/2 S/2 of Sections 35 and 34, Township 20 South, Range 27 East, Eddy County, New Mexico (“Unit”). The Unit will be dedicated to the proposed **Cripple Creek 35/34 Fed Com #716H** well (“Well”), to be drilled from a surface hole location in the NE/4 SE/4 (Unit I) of Section 35 to a bottom hole location in the NW/4 SW/4 (Unit L) of Section 34. The completed interval of the Well will be orthodox. Also to be considered will be the cost of drilling and completing the Well and the allocation of the costs, the designation of Applicant as the operator of the Well, and a 200% charge for the risk involved in drilling and completing the Well. The Well is located approximately eight miles north of Carlsbad, New Mexico.

District I
1625 N French Dr., Hobbs, NM 88240
Phone: (575) 393-6161 Fax: (575) 393-0720
District II
811 S. First St., Artesia, NM 88210
Phone: (575) 748-1283 Fax: (575) 748-9720
District III
1000 Rio Brazos Road, Aztec, NM 87410
Phone: (505) 334-6178 Fax: (505) 334-6170
District IV
1220 S. St. Francis Dr., Santa Fe, NM 87505
Phone: (505) 476-3460 Fax: (505) 476-3462

State of New Mexico
Energy, Minerals & Natural Resources Department
OIL CONSERVATION DIVISION
1220 South St. Francis Dr.
Santa Fe, NM 87505

Form C-102
Revised August 1, 2011
Submit one copy to appropriate
District Office

AMENDED REPORT

WELL LOCATION AND ACREAGE DEDICATION PLAT

| | | | | | | | | | |
|--|-------------------------------|--|---------------------|---|------------------------------|----------------------------------|-----------------------------|---|-----------------------|
| ¹ API Number | | ² Pool Code 98314 | | ³ Pool Name ALACRAN HILLS; UPPER WOLFCAMP OIL | | | | | |
| ⁴ Property Code | | ⁵ Property Name CRIPPLE CREEK 35/34 FEDERAL | | | | | | ⁶ Well Number 716H | |
| ⁷ OGRID NO. 14744 | | ⁸ Operator Name MEWBOURNE OIL COMPANY | | | | | | ⁹ Elevation 3216' | |
| ¹⁰ Surface Location | | | | | | | | | |
| UL or lot no. I | Section 35 | Township 20S | Range 27E | Lot Idn | Feet from the 1820 | North/South line SOUTH | Feet From the 205 | East/West line EAST | County EDDY |
| ¹¹ Bottom Hole Location If Different From Surface | | | | | | | | | |
| UL or lot no. L | Section 34 | Township 20S | Range 27E | Lot Idn | Feet from the 1980 | North/South line SOUTH | Feet from the 100 | East/West line WEST | County EDDY |
| ¹² Dedicated Acres 320.00 | ¹³ Joint or Infill | ¹⁴ Consolidation Code | | ¹⁵ Order No. | | | | | |

No allowable will be assigned to this completion until all interest have been consolidated or a non-standard unit has been approved by the division.

| | | | | | | | | | | | | | |
|--|---|--|--|--|--|--|--|--|--|--|--|--|--|
| <p>¹⁶ GEODETIC DATA NAD 83 GRID - NM EAST</p> <p>SURFACE LOCATION N: 555674.1 - E: 568856.4 LAT: 32.5275753° N LONG: 104.2440444° W</p> <p>KICK OFF POINT (KOP) 1980' FSL - 10' FFL (SEC.35) N: 555834.1 - E: 569050.5 LAT: 32.5280146° N LONG: 104.2434139° W</p> <p>FIRST TAKE POINT (FTP) 1980' FSL - 100' FFL (SEC.35) N: 555834.1 - E: 568960.6 LAT: 32.5280148° N LONG: 104.2437058° W</p> <p>BOTTOM HOLE N: 555834.5 - E: 558579.8 LAT: 32.5280354° N LONG: 104.2773880° W</p> | <p>CORNER DATA NAD 83 GRID - NM EAST</p> <table border="0"> <tr> <td>A: FOUND BRASS CAP "1942" N: 553855.1 - E: 558481.4</td> <td>G: FOUND BRASS CAP "1942" N: 559124.8 - E: 569044.6</td> </tr> <tr> <td>B: FOUND BRASS CAP "1942" N: 556480.8 - E: 558479.3</td> <td>H: FOUND BRASS CAP "1942" N: 556490.2 - E: 569057.3</td> </tr> <tr> <td>C: FOUND BRASS CAP "1942" N: 559153.2 - E: 558477.3</td> <td>I: FOUND BRASS CAP "1942" N: 553854.6 - E: 569070.2</td> </tr> <tr> <td>D: FOUND BRASS CAP "1942" N: 559161.8 - E: 561127.5</td> <td>J: FOUND BRASS CAP "1942" N: 553854.2 - E: 563772.9</td> </tr> <tr> <td>E: FOUND BRASS CAP "1942" N: 559145.3 - E: 563765.8</td> <td>K: FOUND BRASS CAP "1942" N: 553851.2 - E: 561124.2</td> </tr> <tr> <td>F: FOUND BRASS CAP "1942" N: 559128.5 - E: 566415.8</td> <td>L: FOUND BRASS CAP "1942" N: 556504.6 - E: 563749.7</td> </tr> </table> | A: FOUND BRASS CAP "1942" N: 553855.1 - E: 558481.4 | G: FOUND BRASS CAP "1942" N: 559124.8 - E: 569044.6 | B: FOUND BRASS CAP "1942" N: 556480.8 - E: 558479.3 | H: FOUND BRASS CAP "1942" N: 556490.2 - E: 569057.3 | C: FOUND BRASS CAP "1942" N: 559153.2 - E: 558477.3 | I: FOUND BRASS CAP "1942" N: 553854.6 - E: 569070.2 | D: FOUND BRASS CAP "1942" N: 559161.8 - E: 561127.5 | J: FOUND BRASS CAP "1942" N: 553854.2 - E: 563772.9 | E: FOUND BRASS CAP "1942" N: 559145.3 - E: 563765.8 | K: FOUND BRASS CAP "1942" N: 553851.2 - E: 561124.2 | F: FOUND BRASS CAP "1942" N: 559128.5 - E: 566415.8 | L: FOUND BRASS CAP "1942" N: 556504.6 - E: 563749.7 |
| A: FOUND BRASS CAP "1942" N: 553855.1 - E: 558481.4 | G: FOUND BRASS CAP "1942" N: 559124.8 - E: 569044.6 | | | | | | | | | | | | |
| B: FOUND BRASS CAP "1942" N: 556480.8 - E: 558479.3 | H: FOUND BRASS CAP "1942" N: 556490.2 - E: 569057.3 | | | | | | | | | | | | |
| C: FOUND BRASS CAP "1942" N: 559153.2 - E: 558477.3 | I: FOUND BRASS CAP "1942" N: 553854.6 - E: 569070.2 | | | | | | | | | | | | |
| D: FOUND BRASS CAP "1942" N: 559161.8 - E: 561127.5 | J: FOUND BRASS CAP "1942" N: 553854.2 - E: 563772.9 | | | | | | | | | | | | |
| E: FOUND BRASS CAP "1942" N: 559145.3 - E: 563765.8 | K: FOUND BRASS CAP "1942" N: 553851.2 - E: 561124.2 | | | | | | | | | | | | |
| F: FOUND BRASS CAP "1942" N: 559128.5 - E: 566415.8 | L: FOUND BRASS CAP "1942" N: 556504.6 - E: 563749.7 | | | | | | | | | | | | |
| <p>17 OPERATOR CERTIFICATION <i>I hereby certify that the information contained herein is true and complete to the best of my knowledge and belief, and that this organization either owns a working interest or unleased mineral interest in the land including the proposed bottom hole location or has a right to drill this well at this location pursuant to a contract with an owner of such a mineral or working interest, or to a voluntary pooling agreement or a compulsory pooling order heretofore entered by the division.</i></p> <p>Signature _____ Date _____</p> <p>Printed Name _____</p> <p>E-mail Address _____</p> | | | | | | | | | | | | | |
| <p>18 SURVEYOR CERTIFICATION <i>I hereby certify that the well location shown on this plat was plotted from field notes of actual surveys made by me or under my supervision, and that the same is true and correct to the best of my belief.</i></p> <p>05/24/2023 Date of Survey</p> <p>Signature and Seal of Professional Surveyor</p> <p>19680 Certificate Number</p> <p>REV: ADD WELL CALLS 06/14/23</p> | | | | | | | | | | | | | |
| <p style="text-align: right;">Job No: LS23050472</p> | | | | | | | | | | | | | |

Section Plat
Cripple Creek 35/34 Fed Com #716H
N2S2 of Section 35 & N2S2 of Section 34

T20S, R27E, Eddy County, New Mexico

T20S, R27E, Eddy County, New Mexico

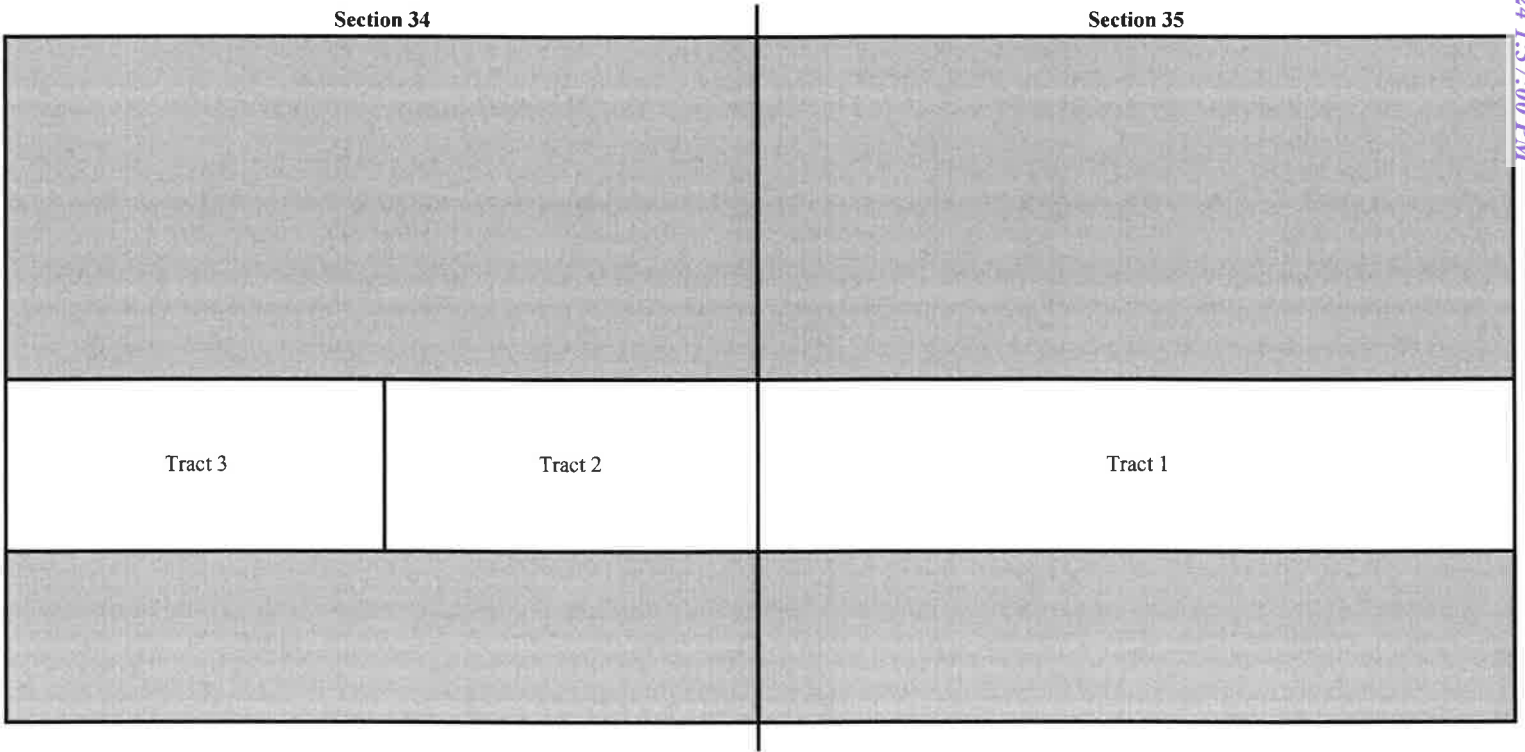

RECAPITULATION

| Tract Number | Number of Acres Committed | Percentage of Interest in Communitized Area |
|--------------|---------------------------|---|
| 1 | 160.00 | 50.000000% |
| 2 | 80.00 | 25.000000% |
| 3 | 80.00 | 25.000000% |
| TOTAL | 320.00 | 100.000000% |

TRACT OWNERSHIP
Cripple Creek Fed Com #716H
N2S2 of Section 35 & N2S2 of Section 34
T20S, R27E, Eddy County, New Mexico

Ownership by Tract

Tract 1: N2S2 of Section 35 - Federal Lease LC 0072015 C

| Entity/Individual | Interest | Gross Acres | Net Acres |
|-------------------------------|--------------------|-------------|-------------------|
| Mewbourne Oil Company et. al. | 76.668207% | 160.00 | 122.669131 |
| Marathon Oil Permian LLC | 22.554950% | 160.00 | 36.087920 |
| Sabinal Energy Operating, LLC | 0.776843% | 160.00 | 1.242949 |
| Total | 100.000000% | | 160.000000 |

Tract 2: N2SE4 of Section 34 - Federal Lease LC 0072015 C

| Entity/Individual | Interest | Gross Acres | Net Acres |
|-------------------------------|--------------------|-------------|------------------|
| Mewbourne Oil Company et. al. | 82.589392% | 80.00 | 66.071513600 |
| EOG Resources Assets LLC | 11.607072% | 80.00 | 9.285657600 |
| Santo Legado LLLP | 5.803536% | 80.00 | 4.642828800 |
| Total | 100.000000% | | 80.000000 |

Tract 3: N2SW4 of Section 34 - Federal Lease LC 0072015 C

| Entity/Individual | Interest | Gross Acres | Net Acres |
|-------------------------------|--------------------|-------------|------------------|
| Mewbourne Oil Company et. al. | 73.38587400% | 80.00 | 58.708699200 |
| Pacer Energy, Ltd. | 17.908822% | 80.00 | 14.327057600 |
| EOG Resources Assets LLC | 5.803536% | 80.00 | 4.642828800 |
| Santo Legado LLLP | 2.901768% | 80.00 | 2.321414400 |
| Total | 100.000000% | | 80.000000 |

Spacing Unit Ownership

| | Percentage | |
|-------------------------------|--------------------|-------------------|
| Mewbourne Oil Company, et al. | 77.327920% | 247.449344 |
| Marathon Oil Permian LLC | 11.277475% | 36.087920 |
| Pacer Energy, Ltd. | 4.477206% | 14.327058 |
| EOG Resources Assets LLC | 4.352652% | 13.928486 |
| Santo Legado LLLP | 2.176326% | 6.964243 |
| Sabinal Energy Operating, LLC | 0.388422% | 1.242949 |
| Total | 100.000000% | 320.000000 |

*Parties highlighted in yellow are being pooled

MEWBOURNE OIL COMPANY

500 West Texas, Suite 1020
Midland, Texas 79701
Phone (432) 682-3715

June 26, 2023

Certified Mail

«Owners»
«Attn»
«Address_Line_1»
«Address_Line_2»
«City», «State» «Zip_Code»

Re: Cripple Creek 35/34 Working Interest Unit and Well Proposals
All of Section 34 and 35, T20S, R27E
Eddy County, New Mexico

Ladies and Gentlemen:

Mewbourne Oil Company (“MOC”), as Operator, hereby proposes creating a working interest unit comprising of All of Section 34 and Section 35, T20S, R27E, Eddy County, New Mexico. As part of the initial development of this unit, MOC hereby proposes the following wells targeting the Bone Spring and Wolfcamp formations:

- 1) CRIPPLE CREEK 35/34 FED #613H – API # - pending
Surface Location: 1980 FNL & 205 FEL, Section 35, T20S, R27E
Bottom Hole Location: 1980 FNL & 100 FWL, Section 34, T20S, R27E
Proposed Total Vertical Depth: 8160’
Proposed Total Measured Depth: 18320’
Spacing Unit: S2N2 of Section 34 & Section 35 – Bone Spring
- 2) CRIPPLE CREEK 35/34 FED #618H – API # - pending
Surface Location: 1800 FSL & 205 FEL, Section 35, T20S, R27E
Bottom Hole Location: 660 FSL & 100 FWL, Section 34, T20S, R27E
Proposed Total Vertical Depth: 8160’
Proposed Total Measured Depth: 18320’
Spacing Unit: S2S2 of Section 34 & Section 35 – Bone Spring
- 3) CRIPPLE CREEK 35/34 FED #711H – API # - pending
Surface Location: 1960 FNL & 205 FEL, Section 35, T20S, R27E
Bottom Hole Location: 660 FNL & 100 FWL, Section 34, T20S, R27E
Proposed Total Vertical Depth: 8400’
Proposed Total Measured Depth: 18560’
Spacing Unit: N2N2 of Section 34 & Section 35 – Wolfcamp
- 4) CRIPPLE CREEK 35/34 FED #716H – API # - pending
Surface Location: 1820 FSL & 205 FEL, Section 35, T20S, R27E
Bottom Hole Location: 1980 FSL & 100 FWL, Section 34, T20S, R27E
Proposed Total Vertical Depth: 8400’
Proposed Total Measured Depth: 18560’
Spacing Unit: N2S2 of Section 34 & Section 35 – Wolfcamp

Regarding the above, enclosed for your further handling is our Operating Agreement dated June 1, 2023, along with an extra set of signature pages and our AFEs dated April 28, 2023 for the captioned proposed wells.

In the event your firm elects to participate in the proposed wells, please execute the enclosed extra set of JOA signature/notary pages and the AFEs before mailing them back to my attention to the address on the letterhead above within thirty (30) days.

Please contact me at (432) 682-3715 or arodrigues@mewbourne.com if you have any questions or need additional information.

Very truly yours,

MEWBOURNE OIL COMPANY

Ariana Rodrigues
Landman

MEWBOURNE OIL COMPANY

AUTHORIZATION FOR EXPENDITURE

Well Name: CRIPPLE CREEK 35/34 FED #716H **Prospect:** _____
Location: SL: 1820 FSL & 205 FEL (35); BHL: 1980 FSL & 100 FWL (34) **County:** EDDY **ST:** NM
Sec. 35 **Blk:** _____ **Survey:** _____ **TWP:** 20S **RNG:** 27E **Prop. TVD:** 8400 **TMD:** 18560

| INTANGIBLE COSTS 0180 | CODE | TCP | CODE | CC |
|--|-----------|--------------------|-----------|--------------------|
| Regulatory Permits & Surveys | 0180-0100 | \$25,000 | 0180-0200 | |
| Location / Road / Site / Preparation | 0180-0105 | \$100,000 | 0180-0205 | \$35,000 |
| Location / Restoration | 0180-0106 | \$200,000 | 0180-0206 | \$30,000 |
| Daywork / Turnkey / Footage Drilling 22 days drlg / 3 days comp @ \$30000/d | 0180-0110 | \$704,000 | 0180-0210 | \$96,100 |
| Fuel 1700 gal/day @ \$3.9/gal | 0180-0114 | \$158,000 | 0180-0214 | \$319,000 |
| Alternate Fuels | 0180-0115 | | 0180-0215 | \$97,000 |
| Mud, Chemical & Additives | 0180-0120 | \$50,000 | 0180-0220 | |
| Mud - Specialized | 0180-0121 | \$270,000 | 0180-0221 | |
| Horizontal Drillout Services | | | 0180-0222 | \$200,000 |
| Stimulation Toe Preparation | | | 0180-0223 | \$40,000 |
| Cementing | 0180-0125 | \$190,000 | 0180-0225 | \$50,000 |
| Logging & Wireline Services | 0180-0130 | \$30,900 | 0180-0230 | \$375,000 |
| Casing / Tubing / Snubbing Services | 0180-0134 | \$35,000 | 0180-0234 | \$15,000 |
| Mud Logging | 0180-0137 | \$15,000 | | |
| Stimulation 51 Stg 20.2 MM gal / 20.2 MM lb | | | 0180-0241 | \$2,820,000 |
| Stimulation Rentals & Other | | | 0180-0242 | \$264,000 |
| Water & Other 100% PW @ \$0.25/BBL F/ SLWMS | 0180-0145 | \$35,000 | 0180-0245 | \$121,000 |
| Bits | 0180-0148 | \$94,000 | 0180-0248 | |
| Inspection & Repair Services | 0180-0150 | \$50,000 | 0180-0250 | \$5,000 |
| Misc. Air & Pumping Services | 0180-0154 | | 0180-0254 | \$10,000 |
| Testing & Flowback Services | 0180-0158 | \$12,000 | 0180-0258 | \$20,000 |
| Completion / Workover Rig | | | 0180-0260 | \$10,500 |
| Rig Mobilization | 0180-0164 | \$154,000 | | |
| Transportation | 0180-0165 | \$30,000 | 0180-0265 | \$20,000 |
| Welding, Construction & Maint. Services | 0180-0168 | \$4,000 | 0180-0268 | \$16,500 |
| Contract Services & Supervision | 0180-0170 | \$189,000 | 0180-0270 | \$59,500 |
| Directional Services Includes Vertical Control | 0180-0175 | \$374,000 | | |
| Equipment Rental | 0180-0180 | \$185,000 | 0180-0280 | \$15,000 |
| Well / Lease Legal | 0180-0184 | \$5,000 | 0180-0284 | |
| Well / Lease Insurance | 0180-0185 | \$5,700 | 0180-0285 | |
| Intangible Supplies | 0180-0188 | \$7,000 | 0180-0288 | \$1,000 |
| Damages | 0180-0190 | | 0180-0290 | |
| Pipeline Interconnect, ROW Easements | 0180-0192 | | 0180-0292 | \$5,000 |
| Company Supervision | 0180-0195 | \$108,000 | 0180-0295 | \$32,400 |
| Overhead Fixed Rate | 0180-0196 | \$10,000 | 0180-0296 | \$20,000 |
| Contingencies 5% (TCP) 5% (CC) | 0180-0199 | \$157,800 | 0180-0299 | \$233,800 |
| TOTAL | | \$3,198,400 | | \$4,910,800 |

| TANGIBLE COSTS 0181 | CODE | TCP | CODE | CC |
|--|-----------|--------------------|-----------|---------------------|
| Casing (19.1" - 30") | 0181-0793 | | | |
| Casing (10.1" - 19.0") 425' - 13 3/8" 54.5# J-55 ST&C @ \$76.3/ft | 0181-0794 | \$32,400 | | |
| Casing (8.1" - 10.0") 2250' - 9 5/8" 36# J-55 LT&C @ \$51.16/ft | 0181-0795 | \$115,000 | | |
| Casing (6.1" - 8.0") 7925- 7" 29# HPP110 BT&C @ \$59.83/ft | 0181-0796 | \$474,200 | | |
| Casing (4.1" - 6.0") 10850' - 4 1/2" 13.5# P-110 CDC-HTQ @ \$33.47/ft | | | 0181-0797 | \$363,100 |
| Tubing 7825' - 2 7/8" 6.5# L-80 IPC Tbg @ \$17/ft | | | 0181-0798 | \$133,300 |
| Drilling Head | 0181-0860 | \$50,000 | | |
| Tubing Head & Upper Section | | | 0181-0870 | \$30,000 |
| Horizontal Completion Tools Completion Liner Hanger | | | 0181-0871 | \$75,000 |
| Subsurface Equip. & Artificial Lift | | | 0181-0880 | \$25,000 |
| Service Pumps (1/4) TP/CP/CIRC PUMP | | | 0181-0886 | \$9,000 |
| Storage Tanks (1/4) (6)OT/(5)WT/(1)GB | | | 0181-0890 | \$115,000 |
| Emissions Control Equipment (1/4) (3)VRT/(1)VRU/(1)FLARE/(3)KO/(1)AIR | | | 0181-0892 | \$93,000 |
| Separation / Treating Equipment (1/4) (4)H SEP/(1)V SEP/(2)VHT/(1)HHT | | | 0181-0895 | \$88,000 |
| Automation Metering Equipment AUTOMATION/METERS | | | 0181-0898 | \$39,000 |
| Oil/Gas Pipeline -Pipe/Valves&Misc (1/4) Gas Line & GL Injection | | | 0181-0900 | \$54,000 |
| Water Pipeline -Pipe/Valves&Misc SWDL PIPE/FITTINGS | | | 0181-0901 | \$12,000 |
| On-site Valves/Fittings/Lines&Misc | | | 0181-0906 | \$91,000 |
| Wellhead Flowlines - Construction | | | 0181-0907 | \$106,000 |
| Cathodic Protection | | | 0181-0908 | |
| Electrical Installation | | | 0181-0909 | \$66,000 |
| Equipment Installation | | | 0181-0910 | \$48,000 |
| Oil/Gas Pipeline - Construction GAS LINE CONSTRUCTION | | | 0181-0920 | \$8,000 |
| Oil/Gas Pipeline - Construction SWDL CONSTRUCTION | | | 0181-0921 | \$4,000 |
| TOTAL | | \$671,600 | | \$1,359,400 |
| SUBTOTAL | | \$3,870,000 | | \$6,270,200 |
| TOTAL WELL COST | | | | \$10,140,200 |

Extra Expense Insurance

I elect to be covered by Operator's Extra Expense Insurance and pay my proportionate share of the premium.
 Operator has secured Extra Expense Insurance covering costs of well control, clean up and redrilling as estimated in Line Item 0180-0185.

I elect to purchase my own well control insurance policy.

If neither box is checked above, non-operating working interest owner elects to be covered by Operator's well control insurance.

Prepared by: J. Chaney Coffman Date: 4/28/2023
 Company Approval: _____ Date: _____
 Joint Owner Interest: _____ Amount: _____
 Joint Owner Name: _____ **Signature:** _____

Summary of Communications
Cripple Creek 35/34 Fed Com #716H
N2S2 of Section 35 & N2S2 of Section 34
T20S, R27E, Eddy County, New Mexico

Marathon Oil Permian LLC:

6/29/2023: Mailed Working Interest Unit and Well Proposal to the above listed party.
3/5/2024: Correspondence with above listed party regarding Working Interest Unit and Well Proposal.

Pacer Energy, Ltd.:

6/29/2023: Mailed Working Interest Unit and Well Proposal to the above listed party.
7/10/2023: Phone call with above listed party regarding Working Interest Unit and Well Proposal.
2/16/2024: Phone call and correspondence with above listed party regarding Working Interest Unit and Well Proposal.

EOG Resources Inc.:

6/29/2023: Mailed Working Interest Unit and Well Proposal to the above listed party.
1/23/2024: Correspondence with above listed party regarding Working Interest Unit and Well Proposal.

Santo Legado LLC:

6/29/2023: Mailed and Emailed Working Interest Unit and Well Proposal to the above listed party.
7/19/2023: Correspondence with above listed party regarding Working Interest Unit and Well Proposal.
7/26/2023: Correspondence with above listed party regarding Working Interest Unit and Well Proposal.
12/13/2023: Correspondence with above listed party regarding Working Interest Unit and Well Proposal.
1/22/2024: Correspondence with above listed party regarding Working Interest Unit and Well Proposal.

Sabinal Energy Operating, LLC:

6/29/2023: Mailed and Emailed Working Interest Unit and Well Proposal to the above listed party.
12/12/2023: Voicemail and correspondence with above listed party regarding Working Interest Unit and Well Proposal.
1/3/2024: Correspondence with above listed party regarding Working Interest Unit and Well Proposal.
1/8/2024: Correspondence with above listed party regarding Working Interest Unit and Well Proposal.
2/13/2024: Correspondence with above listed party regarding Working Interest Unit and Well Proposal.

**STATE OF NEW MEXICO
DEPARTMENT OF ENERGY, MINERALS AND NATURAL RESOURCES
OIL CONSERVATION DIVISION**

**APPLICATION OF MEWBOURNE OIL COMPANY
FOR COMPULSORY POOLING,
EDDY COUNTY, NEW MEXICO.**

CASE NOS. 24174 - 24177

**SELF-AFFIRMED STATEMENT
OF CHARLES CROSBY**

1. I am a geologist at Mewbourne Oil Company (“Mewbourne”) and am over 18 years of age. I have personal knowledge of the matters addressed herein and am competent to provide this Self-Affirmed Statement. I have previously testified before the New Mexico Oil Conservation Division (“Division”), and my credentials as an expert in petroleum geology matters were accepted and made a matter of record.

2. I am familiar with the geological matters that pertain to the above-referenced case.

3. **Exhibit B-1** is a location map of the proposed Cripple Creek horizontal spacing units (“Units”). The approximate wellbore paths for the proposed Cripple Creek 35/34 Fed Com #613H well, Cripple Creek 35/34 Fed Com #618H well, Cripple Creek 35/34 Fed Com #711H well, and Cripple Creek 35/34 Fed Com #716H well (“Wells”) are represented by dashed purple and red arrows.

4. **Exhibit B-2** is a subsea structure map for the top of the Wolfcamp formation that is representative of the targeted intervals. The approximate wellbore path for the Wells are depicted by dashed arrows. Existing producing wells in the targeted interval are represented by solid purple and red lines. The map demonstrates the formation is gently dipping to the east in this area. I do not observe any faulting, pinch-outs, or geologic impediments to developing the targeted intervals with horizontal wells.

**Mewbourne Oil Company
Case No. 24177
Exhibit B**

5. **Exhibit B-2** also identifies six wells penetrating the targeted intervals used to construct a stratigraphic cross-section from A to A'. I used these well logs because they penetrate the targeted intervals, are of good quality, and are representative of the geology in the area.

6. **Exhibit B-3** is a stratigraphic cross-section using the representative wells identified on Exhibit B-2. It contains gamma ray, resistivity and porosity logs. The proposed landing zones for the wells are labeled on the exhibit. This cross-section demonstrates the target intervals are continuous across the Units.

7. **Exhibit B-4** is a production table showing other horizontal wells in the area that are producing from the 3rd Bone Spring Sand and Wolfcamp Sand formations.

8. **Exhibit B-5** are preliminary horizontal survey reports for the proposed Wells.

9. In my opinion, a laydown orientation for the proposed wells is appropriate to properly develop the subject acreage because of an established directional pattern and the known regional stress regime in the area.

10. Based on my geologic study of the area, the targeted interval underlying the Units is suitable for development by horizontal wells and the tracts comprising the Units will contribute more or less equally to the production of the Wells.

11. In my opinion, the granting of Mewbourne's application will serve the interests of conservation, the protection of correlative rights, and the prevention of waste.

12. The attached exhibits were either prepared by me or under my supervision or were compiled from company business records.

13. I understand this Self-Affirmed Statement will be used as written testimony in this case. I affirm my testimony above is true and correct and is made under penalty of perjury under

the laws of the State of New Mexico. My testimony is made as of the date identified next to my signature below.







Charles Crosby

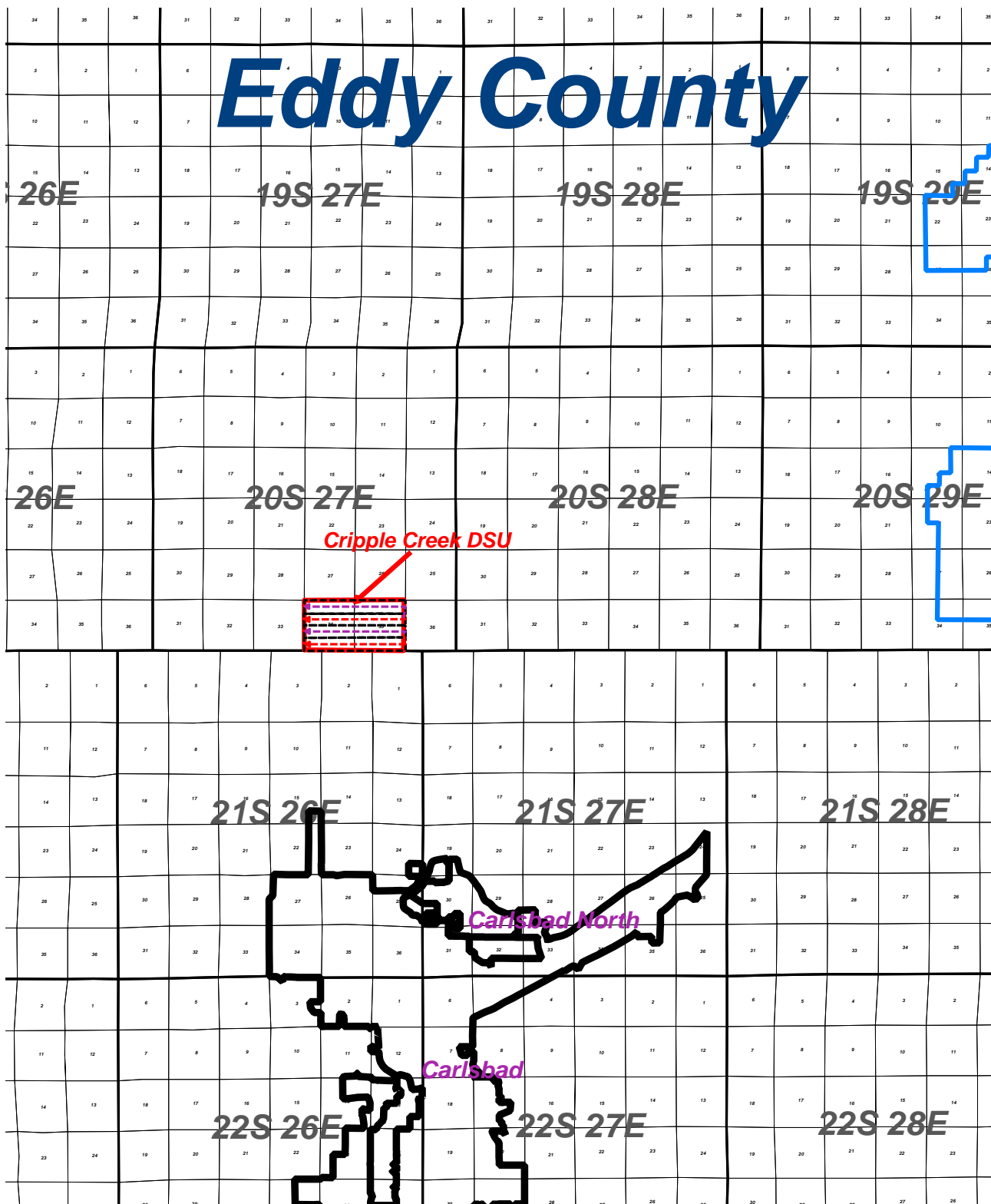

Date

Eddy County



-  Potash Area
-  MOC Unit
-  Proration Unit

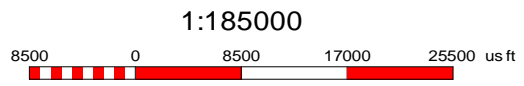

Mewbourne Oil Company

Regional Locator Map
Cripple Creek 35/34 Area

| | | |
|-------------------------------|-------------|-----------------|
| 2/22/24 | Eddy County | New Mexico |
| Wells TD < 5000' Filtered out | | Geol. C. Crosby |

O gy dqwt pg'QklE qo rcpf
 Ecug'P q046397
 Gzj kdk'D/3

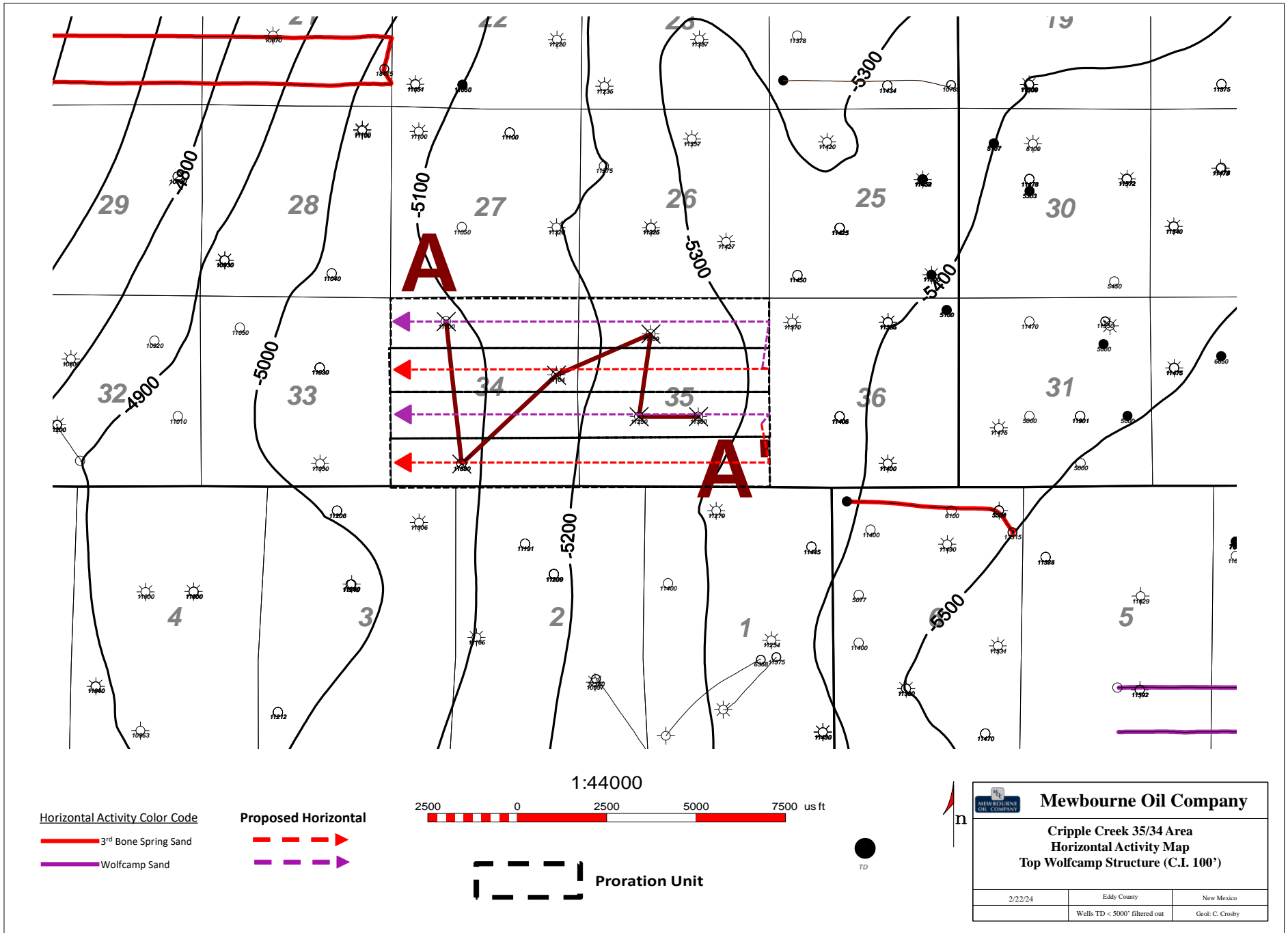

30015316510000 4000 ft
 FASKEN OIL & RANCH LTD
 MARALO 34 FEDERAL 4
 Datum=3216.00
 1890 FSL/1890 FVL
 NE NW
 TWP: 20 S - Range: 27 E - Sec. 34

30015303310000 3628 ft
 MARALO INC
 HANSON FEDERAL 1
 Datum=3246.00
 690 FSL/1890 FVL
 NE NW
 TWP: 20 S - Range: 27 E - Sec. 34

30015303310000 2878 ft
 MEWBORNE OIL CO
 MARALO 34 FEDERAL 3
 Datum=3274.00
 2150 FSL/690 FVL
 S2 NE NW
 TWP: 20 S - Range: 27 E - Sec. 34

30015356950000 2334 ft
 FASKEN OIL & RANCH LTD
 MARALO 35 FEDERAL 005
 Datum=3239.00
 S2 NE NW
 TWP: 20 S - Range: 27 E - Sec. 35

30015237480000 1661 ft
 FASKEN OIL & RANCH LTD
 MARALO FEDERAL 002
 Datum=3250.00
 1890 FSL/1890 FVL
 TWP: 20 S - Range: 27 E - Sec. 35

30015233020000
 FASKEN OIL & RANCH LTD
 MARALO FEDERAL 001
 Datum=3243.00
 1890 FSL/1890 FVL
 TWP: 20 S - Range: 27 E - Sec. 35

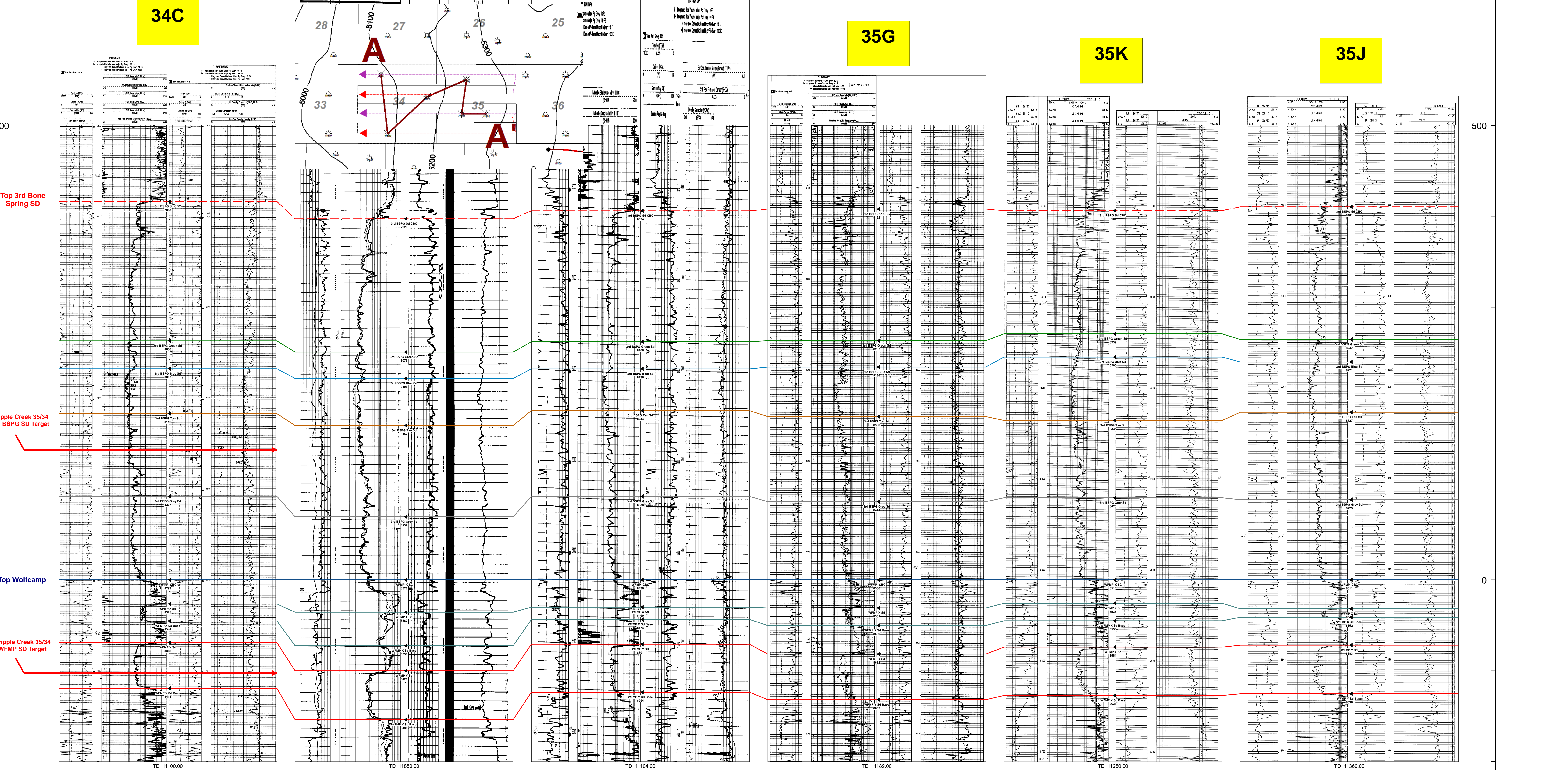

Cripple Creek 35/34 3rd BSPG SD-WFMP SD
 Cross Section Exhibit (A-A')

Cripple Creek 35/34 3rd Bone Spring Sand - Wolfcamp Sand Production Table

| Well Name | Operator | API | Location | Comp Date | Cum Oil (MBO) | Cum Gas (BCF) | Cum Water (MBW) | NS/EW | HZ Target |
|----------------------------------|------------------|----------------|-------------|-----------|---------------|---------------|-----------------|-------|-------------|
| Roscoe 6 B3AD Fed Com 1H | Mewbourne Oil Co | 30015431680000 | 6A/21S/27E | 6/23/2017 | 257.5 | 0.5 | 673.5 | EW | 3rd BSPG SD |
| Wine Mixer 21/20 B3PM Fed Com 1H | Mewbourne Oil Co | 30015499470000 | 21P/20S/27E | 7/1/2023 | 143.1 | 0.3 | 406.4 | EW | 3rd BSPG SD |
| Wine Mixer 21/20 B3IL Fed Com 1H | Mewbourne Oil Co | 30015499480000 | 21P/20S/27E | 7/1/2023 | 173.7 | 0.3 | 392.2 | EW | 3rd BSPG SD |
| Tough Ombres 4/5 W0XW Fed Com 1H | Mewbourne Oil Co | 30015531830000 | 4I/21S/27E | 4/1/2023 | 207.5 | 0.6 | 188.9 | EW | WFMP SD |
| Tough Ombres 4/5 W0QR Fed Com 1H | Mewbourne Oil Co | 30015531840000 | 4I/21S/27E | 4/25/2023 | 231.1 | 0.6 | 189.6 | EW | WFMP SD |

Mewbourne Oil Company
 Case No. 24177
 Exhibit B-4

| | | | | | | | | | | | | | | | | | |
|-----|----------|-------|--------|--------|--------|---------|---------|----------|---------|-------|-------|-------|--------|-------|-----------|------|-------|
| 57 | 13400.00 | 91.66 | 263.99 | 100 | 8287.8 | 5222.0 | -546.4 | -5193.3 | 5222.0 | 264.0 | 0.0 | 0.0 | 8438.8 | -16.8 | 1.5997021 | 4.61 | 1E-10 |
| 58 | 13500.00 | 91.66 | 263.99 | 100 | 8284.9 | 5321.9 | -556.9 | -5292.7 | 5321.9 | 264.0 | 0.0 | 0.0 | 8438.8 | -16.8 | 1.5997021 | 4.61 | 1E-10 |
| 59 | 13600.00 | 91.66 | 263.99 | 100 | 8282.0 | 5421.9 | -567.4 | -5392.1 | 5421.9 | 264.0 | 0.0 | 0.0 | 8438.8 | -16.8 | 1.5997021 | 4.61 | 1E-10 |
| 60 | 13700.00 | 91.66 | 263.99 | 100 | 8279.1 | 5521.9 | -577.8 | -5491.5 | 5521.9 | 264.0 | 0.0 | 0.0 | 8438.8 | -16.8 | 1.5997021 | 4.61 | 1E-10 |
| 61 | 13800.00 | 91.66 | 263.99 | 100 | 8276.3 | 5621.8 | -588.3 | -5590.9 | 5621.8 | 264.0 | 0.0 | 0.0 | 8438.8 | -16.8 | 1.5997021 | 4.61 | 1E-10 |
| 62 | 13900.00 | 91.66 | 263.99 | 100 | 8273.4 | 5721.8 | -598.7 | -5690.4 | 5721.8 | 264.0 | 0.0 | 0.0 | 8438.8 | -16.8 | 1.5997021 | 4.61 | 1E-10 |
| 63 | 14000.00 | 91.66 | 263.99 | 100 | 8270.5 | 5821.7 | -609.2 | -5789.8 | 5821.7 | 264.0 | 0.0 | 0.0 | 8438.8 | -16.8 | 1.5997021 | 4.61 | 1E-10 |
| 64 | 14100.00 | 91.66 | 263.99 | 100 | 8267.6 | 5921.7 | -619.6 | -5889.2 | 5921.7 | 264.0 | 0.0 | 0.0 | 8438.8 | -16.8 | 1.5997021 | 4.61 | 1E-10 |
| 65 | 14200.00 | 91.66 | 263.99 | 100 | 8264.7 | 6021.6 | -630.1 | -5988.6 | 6021.6 | 264.0 | 0.0 | 0.0 | 8438.8 | -16.8 | 1.5997021 | 4.61 | 1E-10 |
| 66 | 14300.00 | 91.66 | 263.99 | 100 | 8261.8 | 6121.6 | -640.6 | -6088.0 | 6121.6 | 264.0 | 0.0 | 0.0 | 8438.8 | -16.8 | 1.5997021 | 4.61 | 1E-10 |
| 67 | 14400.00 | 91.66 | 263.99 | 100 | 8258.9 | 6221.6 | -651.0 | -6187.4 | 6221.6 | 264.0 | 0.0 | 0.0 | 8438.8 | -16.8 | 1.5997021 | 4.61 | 1E-10 |
| 68 | 14500.00 | 91.66 | 263.99 | 100 | 8256.0 | 6321.5 | -661.5 | -6286.8 | 6321.5 | 264.0 | 0.0 | 0.0 | 8438.8 | -16.8 | 1.5997021 | 4.61 | 1E-10 |
| 69 | 14600.00 | 91.66 | 263.99 | 100 | 8253.1 | 6421.5 | -671.9 | -6386.2 | 6421.5 | 264.0 | 0.0 | 0.0 | 8438.8 | -16.8 | 1.5997021 | 4.61 | 1E-10 |
| 70 | 14700.00 | 91.66 | 263.99 | 100 | 8250.2 | 6521.4 | -682.4 | -6485.6 | 6521.4 | 264.0 | 0.0 | 0.0 | 8438.8 | -16.8 | 1.5997021 | 4.61 | 1E-10 |
| 71 | 14800.00 | 91.66 | 263.99 | 100 | 8247.4 | 6621.4 | -692.9 | -6585.0 | 6621.4 | 264.0 | 0.0 | 0.0 | 8438.8 | -16.8 | 1.5997021 | 4.61 | 1E-10 |
| 72 | 14900.00 | 91.66 | 263.99 | 100 | 8244.5 | 6721.4 | -703.3 | -6684.5 | 6721.4 | 264.0 | 0.0 | 0.0 | 8438.8 | -16.8 | 1.5997021 | 4.61 | 1E-10 |
| 73 | 15000.00 | 91.66 | 263.99 | 100 | 8241.6 | 6821.3 | -713.8 | -6783.9 | 6821.3 | 264.0 | 0.0 | 0.0 | 8438.8 | -16.8 | 1.5997021 | 4.61 | 1E-10 |
| 74 | 15100.00 | 91.66 | 263.99 | 100 | 8238.7 | 6921.3 | -724.2 | -6883.3 | 6921.3 | 264.0 | 0.0 | 0.0 | 8438.8 | -16.8 | 1.5997021 | 4.61 | 1E-10 |
| 75 | 15200.00 | 91.66 | 263.99 | 100 | 8235.8 | 7021.2 | -734.7 | -6982.7 | 7021.2 | 264.0 | 0.0 | 0.0 | 8438.8 | -16.8 | 1.5997021 | 4.61 | 1E-10 |
| 76 | 15300.00 | 91.66 | 263.99 | 100 | 8232.9 | 7121.2 | -745.2 | -7082.1 | 7121.2 | 264.0 | 0.0 | 0.0 | 8438.8 | -16.8 | 1.5997021 | 4.61 | 1E-10 |
| 77 | 15400.00 | 91.66 | 263.99 | 100 | 8230.0 | 7221.1 | -755.6 | -7181.5 | 7221.1 | 264.0 | 0.0 | 0.0 | 8438.8 | -16.8 | 1.5997021 | 4.61 | 1E-10 |
| 78 | 15500.00 | 91.66 | 263.99 | 100 | 8227.1 | 7321.1 | -766.1 | -7280.9 | 7321.1 | 264.0 | 0.0 | 0.0 | 8438.8 | -16.8 | 1.5997021 | 4.61 | 1E-10 |
| 79 | 15600.00 | 91.66 | 263.99 | 100 | 8224.2 | 7421.1 | -776.5 | -7380.3 | 7421.1 | 264.0 | 0.0 | 0.0 | 8438.8 | -16.8 | 1.5997021 | 4.61 | 1E-10 |
| 80 | 15700.00 | 91.66 | 263.99 | 100 | 8221.3 | 7521.0 | -787.0 | -7479.7 | 7521.0 | 264.0 | 0.0 | 0.0 | 8438.8 | -16.8 | 1.5997021 | 4.61 | 1E-10 |
| 81 | 15800.00 | 91.66 | 263.99 | 100 | 8218.5 | 7621.0 | -797.5 | -7579.1 | 7621.0 | 264.0 | 0.0 | 0.0 | 8438.8 | -16.8 | 1.5997021 | 4.61 | 1E-10 |
| 82 | 15900.00 | 91.66 | 263.99 | 100 | 8215.6 | 7720.9 | -807.9 | -7678.5 | 7720.9 | 264.0 | 0.0 | 0.0 | 8438.8 | -16.8 | 1.5997021 | 4.61 | 1E-10 |
| 83 | 16000.00 | 91.66 | 263.99 | 100 | 8212.7 | 7820.9 | -818.4 | -7778.0 | 7820.9 | 264.0 | 0.0 | 0.0 | 8438.8 | -16.8 | 1.5997021 | 4.61 | 1E-10 |
| 84 | 16100.00 | 91.66 | 263.99 | 100 | 8209.8 | 7920.8 | -828.8 | -7877.4 | 7920.8 | 264.0 | 0.0 | 0.0 | 8438.8 | -16.8 | 1.5997021 | 4.61 | 1E-10 |
| 85 | 16200.00 | 91.66 | 263.99 | 100 | 8206.9 | 8020.8 | -839.3 | -7976.8 | 8020.8 | 264.0 | 0.0 | 0.0 | 8438.8 | -16.8 | 1.5997021 | 4.61 | 1E-10 |
| 86 | 16300.00 | 91.66 | 263.99 | 100 | 8204.0 | 8120.8 | -849.8 | -8076.2 | 8120.8 | 264.0 | 0.0 | 0.0 | 8438.8 | -16.8 | 1.5997021 | 4.61 | 1E-10 |
| 87 | 16400.00 | 91.66 | 263.99 | 100 | 8201.1 | 8220.7 | -860.2 | -8175.6 | 8220.7 | 264.0 | 0.0 | 0.0 | 8438.8 | -16.8 | 1.5997021 | 4.61 | 1E-10 |
| 88 | 16500.00 | 91.66 | 263.99 | 100 | 8198.2 | 8320.7 | -870.7 | -8275.0 | 8320.7 | 264.0 | 0.0 | 0.0 | 8438.8 | -16.8 | 1.5997021 | 4.61 | 1E-10 |
| 89 | 16600.00 | 91.66 | 263.99 | 100 | 8195.3 | 8420.6 | -881.1 | -8374.4 | 8420.6 | 264.0 | 0.0 | 0.0 | 8438.8 | -16.8 | 1.5997021 | 4.61 | 1E-10 |
| 90 | 16700.00 | 91.66 | 263.99 | 100 | 8192.4 | 8520.6 | -891.6 | -8473.8 | 8520.6 | 264.0 | 0.0 | 0.0 | 8438.8 | -16.8 | 1.5997021 | 4.61 | 1E-10 |
| 91 | 16800.00 | 91.66 | 263.99 | 100 | 8189.6 | 8620.6 | -902.1 | -8573.2 | 8620.6 | 264.0 | 0.0 | 0.0 | 8438.8 | -16.8 | 1.5997021 | 4.61 | 1E-10 |
| 92 | 16900.00 | 91.66 | 263.99 | 100 | 8186.7 | 8720.5 | -912.5 | -8672.6 | 8720.5 | 264.0 | 0.0 | 0.0 | 8438.8 | -16.8 | 1.5997021 | 4.61 | 1E-10 |
| 93 | 17000.00 | 91.66 | 263.99 | 100 | 8183.8 | 8820.5 | -923.0 | -8772.0 | 8820.5 | 264.0 | 0.0 | 0.0 | 8438.8 | -16.8 | 1.5997021 | 4.61 | 1E-10 |
| 94 | 17100.00 | 91.66 | 263.99 | 100 | 8180.9 | 8920.4 | -933.4 | -8871.5 | 8920.4 | 264.0 | 0.0 | 0.0 | 8438.8 | -16.8 | 1.5997021 | 4.61 | 1E-10 |
| 95 | 17200.00 | 91.66 | 263.99 | 100 | 8178.0 | 9020.4 | -943.9 | -8970.9 | 9020.4 | 264.0 | 0.0 | 0.0 | 8438.8 | -16.8 | 1.5997021 | 4.61 | 1E-10 |
| 96 | 17300.00 | 91.66 | 263.99 | 100 | 8175.1 | 9120.3 | -954.4 | -9070.3 | 9120.3 | 264.0 | 0.0 | 0.0 | 8438.8 | -16.8 | 1.5997021 | 4.61 | 1E-10 |
| 97 | 17400.00 | 91.66 | 263.99 | 100 | 8172.2 | 9220.3 | -964.8 | -9169.7 | 9220.3 | 264.0 | 0.0 | 0.0 | 8438.8 | -16.8 | 1.5997021 | 4.61 | 1E-10 |
| 98 | 17500.00 | 91.66 | 263.99 | 100 | 8169.3 | 9320.3 | -975.3 | -9269.1 | 9320.3 | 264.0 | 0.0 | 0.0 | 8438.8 | -16.8 | 1.5997021 | 4.61 | 1E-10 |
| 99 | 17600.00 | 91.66 | 263.99 | 100 | 8166.4 | 9420.2 | -985.7 | -9368.5 | 9420.2 | 264.0 | 0.0 | 0.0 | 8438.8 | -16.8 | 1.5997021 | 4.61 | 1E-10 |
| 100 | 17700.00 | 91.66 | 263.99 | 100 | 8163.5 | 9520.2 | -996.2 | -9467.9 | 9520.2 | 264.0 | 0.0 | 0.0 | 8438.8 | -16.8 | 1.5997021 | 4.61 | 1E-10 |
| 101 | 17800.00 | 91.66 | 263.99 | 100 | 8160.7 | 9620.1 | -1006.7 | -9567.3 | 9620.1 | 264.0 | 0.0 | 0.0 | 8438.8 | -16.8 | 1.5997021 | 4.61 | 1E-10 |
| 102 | 17900.00 | 91.66 | 263.99 | 100 | 8157.8 | 9720.1 | -1017.1 | -9666.7 | 9720.1 | 264.0 | 0.0 | 0.0 | 8438.8 | -16.8 | 1.5997021 | 4.61 | 1E-10 |
| 103 | 18000.00 | 91.66 | 263.99 | 100 | 8154.9 | 9820.1 | -1027.6 | -9766.1 | 9820.1 | 264.0 | 0.0 | 0.0 | 8438.8 | -16.8 | 1.5997021 | 4.61 | 1E-10 |
| 104 | 18100.00 | 91.66 | 263.99 | 100 | 8152.0 | 9920.0 | -1038.0 | -9865.6 | 9920.0 | 264.0 | 0.0 | 0.0 | 8438.8 | -16.8 | 1.5997021 | 4.61 | 1E-10 |
| 105 | 18200.00 | 91.66 | 263.99 | 100 | 8149.1 | 10020.0 | -1048.5 | -9965.0 | 10020.0 | 264.0 | 0.0 | 0.0 | 8438.8 | -16.8 | 1.5997021 | 4.61 | 1E-10 |
| 106 | 18300.00 | 91.66 | 263.99 | 100 | 8146.2 | 10119.9 | -1059.0 | -10064.4 | 10119.9 | 264.0 | 0.0 | 0.0 | 8438.8 | -16.8 | 1.5997021 | 4.61 | 1E-10 |
| 107 | 18400.00 | 91.66 | 263.99 | 100 | 8143.3 | 10219.9 | -1069.4 | -10163.8 | 10219.9 | 264.0 | 0.0 | 0.0 | 8438.8 | -16.8 | 1.5997021 | 4.61 | 1E-10 |
| 108 | 18467.59 | 91.66 | 263.99 | 67.586 | 8141.4 | 10287.4 | -1076.5 | -10231.0 | 10287.4 | 264.0 | 0.0 | 0.0 | 8438.8 | -16.8 | 1.5997021 | 4.61 | 1E-10 |
| 109 | 18467.59 | 91.66 | 263.99 | 0 | 8141.4 | 10287.4 | -1076.5 | -10231.0 | 10287.4 | 264.0 | ##### | ##### | 8438.8 | -16.8 | 1.5997021 | 4.61 | 1E-10 |

**STATE OF NEW MEXICO
ENERGY, MINERALS AND NATURAL RESOURCES DEPARTMENT
OIL CONSERVATION DIVISION**

**APPLICATIONS OF MEWBOURNE OIL COMPANY
FOR COMPULSORY POOLING,
EDDY COUNTY, NEW MEXICO**

CASE NOS. 24174 – 24177

**SELF-AFFIRMED STATEMENT
OF DANA S. HARDY**

1. I am attorney in fact and authorized representative of Mewbourne Oil Company, the Applicant herein.

2. I am familiar with the Notice Letters attached as **Exhibit C-1** and caused the Notice Letters, along with the Application in this case, to be sent to the parties set out in the chart attached as **Exhibit C-2**.

3. Exhibit C-2 also provides the date each Notice Letter was sent and the date each return was received.

4. Copies of the certified mail green cards and white slips are attached as **Exhibit C-3** as supporting documentation for proof of mailing and the information provided on Exhibit C-2.

5. On February 8, 2024, I caused a notice to be published to all interested parties in the Carlsbad Current Argus. An Affidavit of Publication from the Legal Clerk of the Carlsbad Current Argus, along with a copy of the notice publication, is attached as **Exhibit C-4**.

6. I understand this Self-Affirmed Statement will be used as written testimony in the subject cases. I affirm that my testimony above is true and correct and it made under penalty of perjury under the laws of the State of New Mexico. My testimony is made as of the date handwritten next to my signature below.

/s/ Dana S. Hardy
Dana S. Hardy

March 05, 2024
Date

**Mewbourne Oil Company
Case No. 24177
Exhibit C**



hinklelawfirm.com

HINKLE SHANOR LLP

ATTORNEYS AT LAW

P.O. BOX 2068

SANTA FE, NEW MEXICO 87504

505-982-4554 (FAX) 505-982-8623

WRITER:
Dana S. Hardy, Partner
dhardy@hinklelawfirm.com

February 5, 2024

VIA CERTIFIED MAIL
RETURN RECEIPT REQUESTED

TO ALL PARTIES ENTITLED TO NOTICE

Re: Case Nos. 24174, 24175, 24176, & 24177 – Applications of Mewbourne Oil Company for Compulsory Pooling, Eddy County, New Mexico.

To whom it may concern:

This letter is to advise you that the enclosed applications were filed with the New Mexico Oil Conservation Division. The hearing will be conducted on **March 7, 2024**, beginning at 8:15 a.m.

The hearing will be conducted in a hybrid fashion, both in-person at the Energy, Minerals, Natural Resources Department, Wendell Chino Building, Pecos Hall, 1220 South St. Francis Drive, 1st Floor, Santa Fe, NM 87505 and via the WebEx virtual meeting platform. To participate virtually, see the instructions posted on the OCD Hearings website: <https://www.emnrd.nm.gov/ocd/hearing-info/>. You are not required to attend this hearing, but as an owner of an interest that may be affected by this application, you may appear and present testimony. Failure to appear at that time and become a party of record will preclude you from challenging the matter at a later date.

Pursuant to Division Rule 19.15.4.13.B, a party who intends to present evidence at the hearing shall file a pre-hearing statement and serve copies on other parties, or the attorneys of parties who are represented by counsel, at least four business days in advance of a scheduled hearing, but in no event later than 5:00 p.m. Mountain Time, on the Thursday preceding the scheduled hearing date. The statement must be submitted through the OCD E-Permitting system (<https://wwwapps.emnrd.nm.gov/ocd/ocdpermitting/>) or via e-mail to ocd.hearings@emnrd.nm.gov and should include: the names of the parties and their attorneys, a concise statement of the case, the names of all witnesses the party will call to testify at the hearing, the approximate time the party will need to present its case, and identification of any procedural matters that are to be resolved prior to the hearing.

Please contact Ariana Rodrigues, Landman, Mewbourne Oil Company, at (432) 682-3715, or via email at arodrigues@mewbourne.com, if you have questions regarding these matters.

Sincerely,

/s/ Dana S. Hardy

Dana S. Hardy

Mewbourne Oil Company
Case No. 24177
Exhibit C-1

Enclosure

PO BOX 10
ROSWELL, NEW MEXICO 88202
(575) 622-6510
FAX (575) 623-9332

7601 JEFFERSON ST NE - SUITE 180
ALBUQUERQUE, NEW MEXICO 87109
505-858-8320
FAX (505) 858-8321

PO BOX 2068
SANTA FE, NEW MEXICO 87504
(505) 982-4554
FAX (505) 982-8623

**STATE OF NEW MEXICO
ENERGY, MINERALS AND NATURAL RESOURCES DEPARTMENT
OIL CONSERVATION DIVISION**

**APPLICATIONS OF MEWBOURNE OIL COMPANY
FOR COMPULSORY POOLING,
EDDY COUNTY, NEW MEXICO**

CASE NOS. 24174 - 24177

NOTICE LETTER CHART

| PARTY | NOTICE LETTER SENT | RETURN RECEIVED |
|--|---------------------------|--|
| EOG Resources Inc. Attn: Brian Pond 5509 Champions Drive Midland, TX 79706 | 02/05/24 | 02/14/24 |
| Marathon Oil Permian LLC Attn: Samuel Cox 990 Town and Country Blvd. Houston, TX 77024 | 02/05/24 | 02/12/24 |
| Pacer Energy, Ltd. Attn: Dennis Ferstler 12600 Hill Country Blvd, Ste R-270 Austin, TX 78738 | 02/05/24 | 02/15/24 No signature. |
| Sabinal Energy Operating, LLC Attn: Nicole Reeves 1780 Hughes Landing Blvd. The Woodlands, TX 77380 | 02/05/24 | Per USPS Tracking (Last Checked 03/04/24): 02/08/24 – Delivered to individual at the address. |
| Santo Legado LLC Attn: Nicole Singer 11 Greenway Plaza, Suite 535 Houston, TX 77046 | 02/05/24 | 02/21/24 |

**Mewbourne Oil Company
Case No. 24177
Exhibit C-2**

U.S. Postal Service™
CERTIFIED MAIL® RECEIPT
Domestic Mail Only



For delivery information, visit our website at www.usps.com®.

OFFICIAL USE

| | |
|---|--|
| Certified Mail Fee \$ _____ | Postmark Here  |
| Extra Services & Fees (check box, add fee as appropriate) | |
| <input type="checkbox"/> Return Receipt (hardcopy) \$ _____ | |
| <input type="checkbox"/> Return Receipt (electronic) \$ _____ | |
| <input type="checkbox"/> Certified Mail Restricted Delivery \$ _____ | |
| <input type="checkbox"/> Adult Signature Required \$ _____ | |
| <input type="checkbox"/> Adult Signature Restricted Delivery \$ _____ | |
| Postage \$ _____ | |
| Total Postage and Fees \$ _____ | |
| Ser: EOG Resources Inc. Attn: Brian Pond 5509 Champions Drive Midland, TX 79706 24174 - 24177 Mewbourne Cripple Creek | |

PS Form 3800, January 2023 PSN 7530-02-000-9047 See Reverse for Instructions

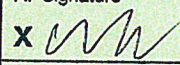
9589 0710 5270 0725 3449 67

| SENDER: COMPLETE THIS SECTION | COMPLETE THIS SECTION ON DELIVERY |
|---|--|
| <ul style="list-style-type: none"> ■ Complete items 1, 2, and 3. ■ Print your name and address on the reverse so that we can return the card to you. ■ Attach this card to the back of the mailpiece, or on the front if space permits. | <p>A. Signature <input checked="" type="checkbox"/>  <input checked="" type="checkbox"/> Agent <input type="checkbox"/> Addressee</p> <p>B. Received by (Printed Name) <u>Ken Bern</u> C. Date of Delivery <u>2/14</u></p> <p>D. Is delivery address different from item 1? <input type="checkbox"/> Yes If YES, enter delivery address below: <input checked="" type="checkbox"/> No</p> <p style="text-align: center; font-size: 2em; font-weight: bold;">RECEIVED</p> <p style="text-align: center; font-size: 1.5em;">FEB 14 2024</p> |
| <p>1. Article Addressed to:</p> <p style="text-align: center;">EOG Resources Inc. Attn: Brian Pond 5509 Champions Drive Midland, TX 79706 24174 - 24177 Mewbourne Cripple Creek</p> <p style="text-align: center;">  9590 9402 8595 3244 3693 74 </p> | <p>3. Service Type</p> <p><input checked="" type="checkbox"/> Adult Signature <u>Hinkle Shanor LLC</u> <input type="checkbox"/> Priority Mail Express®</p> <p><input checked="" type="checkbox"/> Adult Signature <u>Santa Fe NM 87504</u> <input type="checkbox"/> Registered Mail™</p> <p><input type="checkbox"/> Certified Mail® <input type="checkbox"/> Registered Mail Restricted Delivery</p> <p><input type="checkbox"/> Certified Mail Restricted Delivery <input type="checkbox"/> Signature Confirmation™</p> <p><input type="checkbox"/> Collect on Delivery <input type="checkbox"/> Signature Confirmation Restricted Delivery</p> <p><input type="checkbox"/> Collect on Delivery Restricted Delivery</p> <p><input type="checkbox"/> Insured Mail</p> <p><input type="checkbox"/> Insured Mail Restricted Delivery (over \$500)</p> |
| <p>2. Article Number (Transfer from service label)</p> <p style="font-size: 1.2em;">9589 0710 5270 0725 3449 67</p> | |
| PS Form 3811, July 2020 PSN 7530-02-000-9053 Domestic Return Receipt | |

Mewbourne Oil Company
Case No. 24177
Exhibit C-3

9589 0710 5270 0725 3449 74

U.S. Postal Service™ CERTIFIED MAIL® RECEIPT Domestic Mail Only

For delivery information, visit our website at www.usps.com®.

OFFICIAL USE

Certified Mail Fee \$ _____

Extra Services & Fees (check box, add fee as appropriate)

Return Receipt (hardcopy) \$ _____

Return Receipt (electronic) \$ _____

Certified Mail Restricted Delivery \$ _____

Adult Signature Required \$ _____

Adult Signature Restricted Delivery \$ _____

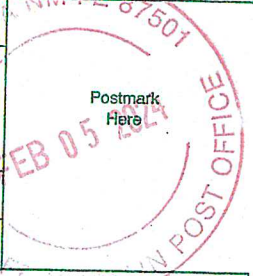

Postage \$ _____

Total Postage and Fees \$ _____

Send To
 St Marathon Oil Permian LLC
 Attn: Samuel Cox
 990 Town and Country Blvd.
 Houston, TX 77024
 Cr 24174 - 24177 Mewbourne Cripple Creek

PS Form 3800, January 2023 PSN 7530-02-000-9047 See Reverse for Instructions

SENDER: COMPLETE THIS SECTION

- Complete items 1, 2, and 3.
- Print your name and address on the reverse so that we can return the card to you.
- Attach this card to the back of the mailpiece, or on the front if space permits.

1. Article Addressed to:

Marathon Oil Permian LLC
 Attn: Samuel Cox
 990 Town and Country Blvd.
 Houston, TX 77024
 24174 - 24177 Mewbourne Cripple Creek



9590 9402 8595 3244 3694 73

2. Article Number (Transfer from service label)
 9589 0710 5270 0725 3449 74

COMPLETE THIS SECTION ON DELIVERY

A. Signature Agent Addressee

B. Received by (Printed Name) _____ C. Date of Delivery 2/8/24

D. Is delivery address different from item 1? Yes No
 If YES, enter delivery address below: _____

RECEIVED

FEB 12 2024

3. Service Type Hinkle Shanor LLC Priority Mail Express®

Adult Signature Santa Fe NM 87501 Registered Mail™

Adult Signature Restricted Delivery Registered Mail Restricted Delivery

Certified Mail® Signature Confirmation™

Certified Mail Restricted Delivery Signature Confirmation Restricted Delivery

Collect on Delivery

Collect on Delivery Restricted Delivery

Insured Mail

Insured Mail Restricted Delivery (over \$500)

PS Form 3811, July 2020 PSN 7530-02-000-9053

Domestic Return Receipt

9589 0710 5270 0725 3449 36

U.S. Postal Service™
CERTIFIED MAIL® RECEIPT
Domestic Mail Only

For delivery information, visit our website at www.usps.com®.

OFFICIAL USE

Certified Mail Fee
 \$ _____

Extra Services & Fees (check box, add fee as appropriate)

| | |
|--|----------|
| <input type="checkbox"/> Return Receipt (hardcopy) | \$ _____ |
| <input type="checkbox"/> Return Receipt (electronic) | \$ _____ |
| <input type="checkbox"/> Certified Mail Restricted Delivery | \$ _____ |
| <input type="checkbox"/> Adult Signature Required | \$ _____ |
| <input type="checkbox"/> Adult Signature Restricted Delivery | \$ _____ |

Postage
 \$ _____

Total Postage and Fees
 \$ _____

Postmark Here

Santa Fe NM 87501
 FEB 15 2024

Se: Pacer Energy, Ltd.
 Attn: Dennis Ferstler
 St: 12600 Hill Country Blvd, Ste R-270
 Austin, TX 78738
 Ci: 24174 - 24177 Mewbourne Cripple Creek

PS Form 3800, January 2023 PSN 7530-02-000-9047 See Reverse for Instructions

| SENDER: COMPLETE THIS SECTION | | COMPLETE THIS SECTION ON DELIVERY | |
|--|--|--|--|
| <ul style="list-style-type: none"> Complete items 1, 2, and 3. Print your name and address on the reverse so that we can return the card to you. Attach this card to the back of the mailpiece, or on the front if space permits. | | <p>A. Signature X <input type="checkbox"/> Agent <input type="checkbox"/> Addressee</p> | |
| <p>1. Article Addressed to:</p> <p>Pacer Energy, Ltd. Attn: Dennis Ferstler 12600 Hill Country Blvd, Ste R-270 Austin, TX 78738 24174 - 24177 Mewbourne Cripple Creek</p> | | <p>B. Received by (Printed Name) C. Date of Delivery</p> | |
| <p>2. Article Number (Transfer from service label)</p> <p>9589 0710 5270 0725 3449 36</p> | | <p>D. Is delivery address different from item 1? <input type="checkbox"/> Yes If YES, enter delivery address below: <input type="checkbox"/> No</p> <p>RECEIVED FEB 15 2024</p> | |
| <p>3. Service Type</p> <p><input type="checkbox"/> Adult Signature <input type="checkbox"/> Adult Signature Restricted Delivery <input type="checkbox"/> Certified Mail® <input type="checkbox"/> Certified Mail Restricted Delivery <input type="checkbox"/> Collect on Delivery <input type="checkbox"/> Collect on Delivery Restricted Delivery <input type="checkbox"/> Insured Mail <input type="checkbox"/> Insured Mail Restricted Delivery (over \$500)</p> | | <p>Hinkle Shanor Santa Fe NM 87501</p> <p><input type="checkbox"/> Priority Mail Express® <input type="checkbox"/> Registered Mail™ <input type="checkbox"/> Registered Mail Restricted Delivery <input type="checkbox"/> Signature Confirmation™ <input type="checkbox"/> Signature Confirmation Restricted Delivery</p> | |
| PS Form 3811, July 2020 PSN 7530-02-000-9053 | | Domestic Return Receipt | |

U.S. Postal Service™
CERTIFIED MAIL® RECEIPT
Domestic Mail Only

For delivery information, visit our website at www.usps.com®.

9589 0710 5270 0725 3448 06

| | |
|--|----|
| Certified Mail Fee | |
| \$ | |
| Extra Services & Fees (check box, add fee as appropriate) | |
| <input type="checkbox"/> Return Receipt (hardcopy) | \$ |
| <input type="checkbox"/> Return Receipt (electronic) | \$ |
| <input type="checkbox"/> Certified Mail Restricted Delivery | \$ |
| <input type="checkbox"/> Adult Signature Required | \$ |
| <input type="checkbox"/> Adult Signature Restricted Delivery | \$ |
| Postage | |
| \$ | |
| Total Postage and Fees | |
| \$ | |
| Sent To | |
| Santo Legado LLC | |
| Attn: Nicole Singer | |
| 11 Greenway Plaza, Suite 535 | |
| Houston, TX 77046 | |
| 24174 - 24177 Mewbourne Cripple Creek | |

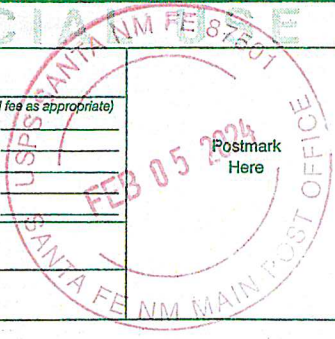

PS Form 3800, January 2023 PSN 7530-02-000-9047 See Reverse for Instructions

| | | | |
|---|--|--|--|
| SENDER: COMPLETE THIS SECTION | | COMPLETE THIS SECTION | |
| Complete items 1, 2, and 3. | | A. Signature | |
| ■ Print your name and address on the reverse so that we can return the card to you. | | | |
| ■ Attach this card to the back of the mailpiece, or on the front if space permits. | | B. Received by (Print name) | |
| 1. Article Addressed to: | | Megan H | |
| Santo Legado LLC | | C. Delivery address (If YES, enter delivery address) | |
| Attn: Nicole Singer | | FEB 21 2024 | |
| 11 Greenway Plaza, Suite 535 | | Hinkle Shanor LLP | |
| Houston, TX 77046 | | Santo Fe NM 97504 | |
| 24174 - 24177 Mewbourne Cripple Creek | | 3. Service Type | |
| | | <input type="checkbox"/> Adult Signature | |
| 9590 9402 8595 3244 3694 66 | | <input type="checkbox"/> Adult Signature Restricted Delivery | |
| 2. Article Number (Transfer from service label) | | <input type="checkbox"/> Certified Mail® | |
| 9589 0710 5270 0725 3448 06 | | <input type="checkbox"/> Certified Mail Restricted Delivery | |
| PS Form 3811, July 2020 PSN 7530-02-000-9053 | | <input type="checkbox"/> Collect on Delivery | |
| | | <input type="checkbox"/> Collect on Delivery Restricted Delivery | |
| | | <input type="checkbox"/> Insured Mail | |
| | | <input type="checkbox"/> Insured Mail Restricted Delivery (over \$500) | |

9589 0710 5270 0725 3449 43

U.S. Postal Service™
CERTIFIED MAIL® RECEIPT
Domestic Mail Only

For delivery information, visit our website at www.usps.com®

OFFICIAL USE

| | |
|--|----|
| Certified Mail Fee | \$ |
| Extra Services & Fees (check box, add fee as appropriate) | |
| <input type="checkbox"/> Return Receipt (hardcopy) | \$ |
| <input type="checkbox"/> Return Receipt (electronic) | \$ |
| <input type="checkbox"/> Certified Mail Restricted Delivery | \$ |
| <input type="checkbox"/> Adult Signature Required | \$ |
| <input type="checkbox"/> Adult Signature Restricted Delivery | \$ |
| Postage | \$ |
| Total Postage and Fees | \$ |



| | |
|--------|---|
| Sent | Sabinal Energy Operating, LLC |
| Street | Attn: Nicole Reeves 1780 Hughes Landing Blvd. The Woodlands, TX 77380 |
| City | 24174 - 24177 Mowbourn Cripple Creek |

PS Form 3800, January 2023 PSN 7530-02-000-9047 See Reverse for Instructions

USPS Tracking®

[FAQs >](#)

Tracking Number:

[Remove X](#)

9589071052700725344943

[Copy](#)

[Add to Informed Delivery \(https://informedelivery.usps.com/\)](https://informedelivery.usps.com/)

Latest Update

Your item was delivered to an individual at the address at 10:42 am on February 8, 2024 in SPRING, TX 77380.

Get More Out of USPS Tracking:

USPS Tracking Plus®

Feedback

Delivered

Delivered, Left with Individual

SPRING, TX 77380

February 8, 2024, 10:42 am

In Transit to Next Facility

February 7, 2024

Departed USPS Facility

ALBUQUERQUE, NM 87101

February 6, 2024, 8:34 am

Arrived at USPS Facility

ALBUQUERQUE, NM 87101

February 5, 2024, 11:26 pm

[Hide Tracking History](#)

[What Do USPS Tracking Statuses Mean? \(https://faq.usps.com/s/article/Where-is-my-package\)](https://faq.usps.com/s/article/Where-is-my-package)

Text & Email Updates



USPS Tracking Plus®



Product Information



See Less

Track Another Package

Enter tracking or barcode numbers

Need More Help?

Contact USPS Tracking support for further assistance.

FAQs

Carlsbad Current Argus.

PART OF THE USA TODAY NETWORK

Affidavit of Publication

Ad # 0005878879

This is not an invoice

HINKLE SHANOR, LLP
POBOX 2068

SANTA FE, NM 87504

I, a legal clerk of the **Carlsbad Current Argus**, a newspaper published daily at the City of Carlsbad, in said county of Eddy, state of New Mexico and of general paid circulation in said county; that the same is a duly qualified newspaper under the laws of the State wherein legal notices and advertisements may be published; that the printed notice attached hereto was published in the regular and entire edition of said newspaper and not in supplement thereof in editions dated as follows:

02/08/2024



Legal Clerk

Subscribed and sworn before me this February 8, 2024:



State of WI, County of Brown
NOTARY PUBLIC

1-7-25

My commission expires

KATHLEEN ALLEN
Notary Public
State of Wisconsin

Ad # 0005878879
PO #:
of Affidavits 1

This is not an invoice

This is to notify all interested parties, including EOG Resources Inc.; Marathon Oil Permian LLC; Pacer Energy, Ltd.; Sabinal Energy Operating, LLC; Santo Legado LLC; and their successors and assigns, that the New Mexico Oil Conservation Division will conduct a hearing on an application submitted by Mewbourne Oil Company (Case No. 24177). The hearing will be conducted on March 7, 2024 in a hybrid fashion, both in-person at the Energy, Minerals, Natural Resources Department, Wendell Chino Building, Pecos Hall, 1220 South St. Francis Drive, 1st Floor, Santa Fe, NM 87505 and via the WebEx virtual meeting platform. To participate virtually, see the instructions posted on the OCD Hearings website: <https://www.emnrd.nm.gov/ocd/hearing-info/>. Mewbourne Oil Company ("Applicant") applies for an order pooling all uncommitted interests in the Wolfcamp formation underlying a 320-acre, more or less, standard horizontal spacing unit comprised of the N/2 S/2 of Sections 35 and 34, Township 20 South, Range 27 East, Eddy County, New Mexico ("Unit"). The Unit will be dedicated to the proposed Cripple Creek 35/34 Fed Com #716H well ("Well"), to be drilled from a surface hole location in the NE/4 SE/4 (Unit I) of Section 35 to a bottom hole location in the NW/4 SW/4 (Unit L) of Section 34. The completed interval of the Well will be orthodox. Also to be considered will be the cost of drilling and completing the Well and the allocation of the costs, the designation of Applicant as the operator of the Well, and a 200% charge for the risk involved in drilling and completing the Well. The Well is located approximately 8 miles north of Carlsbad, New Mexico.
#5878879, Current Argus, February 8, 2024

Mewbourne Oil Company
Case No. 24177
Exhibit C-4