

**STATE OF NEW MEXICO  
DEPARTMENT OF ENERGY, MINERALS AND NATURAL RESOURCES  
OIL CONSERVATION DIVISION**

**APPLICATION OF MEWBOURNE OIL COMPANY  
FOR COMPULSORY POOLING,  
EDDY COUNTY, NEW MEXICO.**

**CASE NO. 24177**

**NOTICE OF AMENDED EXHIBITS**

In accordance with the Division's request at the March 7, 2024 hearing, Mewbourne Oil Company is providing the attached amended exhibit packet, which includes the following amended exhibits:

- 1) Compulsory Pooling Checklist, which is amended to correct the Pool Name and Pool Code;
- 2) Exhibit A (Self-Affirmed Statement of Ariana Rodrigues), which is revised at paragraph 5 to correct the Pool Name and Pool Code; and
- 3) Exhibit A-2 (C-102), which is amended to correct the Pool Name and Pool Code.

Respectfully submitted,

HINKLE SHANOR, LLP

/s/ Dana S. Hardy

Dana S. Hardy

Jaclyn M. McLean

P.O. Box 2068

Santa Fe, NM 87504-2068

Phone: (505) 982-4554

Facsimile: (505) 982-8623

dhardy@hinklelawfirm.com

jmclean@hinklelawfirm.com

*Counsel for Mewbourne Oil Company*

**CERTIFICATE OF SERVICE**

I hereby certify that on March 8, 2024, I served a true and correct copy of the foregoing pleading on the following counsel of record by electronic mail:

Jordan L. Kessler  
125 Lincoln Avenue, Suite 213  
Santa Fe, NM 87501  
Phone: (432) 488-6108  
jordan\_kessler@eogresources.com  
*Counsel for EOG Resources, Inc.*

Steptoe & Johnson PLLC  
Blake C. Jones  
1780 Hughes Landing Blvd., Suite 750  
The Woodlands, TX 77380  
Phone: (281) 203-5730  
blake.jones@steptoe-johnson.com  
*Counsel for Sabinal Energy Operating, LLC*

/s/ Dana S. Hardy

**STATE OF NEW MEXICO  
ENERGY, MINERALS AND NATURAL RESOURCES DEPARTMENT  
OIL CONSERVATION DIVISION**

**APPLICATION OF MEWBOURNE OIL COMPANY  
FOR COMPULSORY POOLING,  
EDDY COUNTY, NEW MEXICO**

**CASE NO. 24177**

**EXHIBIT INDEX**

Compulsory Pooling Checklist

Exhibit A	Self-Affirmed Statement of Ariana Rodrigues
A-1	Application & Proposed Notice of Hearing
A-2	C-102
A-3	Plat of Tracts, Tract Ownership, Applicable Lease Numbers, Unit Recapitulation, Pooled Parties
A-4	Sample Well Proposal Letter & AFE
A-5	Chronology of Contact
Exhibit B	Self-Affirmed Statement of Charles Crosby
B-1	Location Map
B-2	Wolfcamp Subsea Structure Map
B-3	Stratigraphic Cross-Section
B-4	Production Table of Wells Producing from Third Bone Spring Sand and Wolfcamp Formations
B-5	Preliminary Horizontal Survey Reports for the Proposed Wells
Exhibit C	Self-Affirmed Statement of Dana S. Hardy
C-1	Notice Letters to All Interested Parties
C-2	Chart of Notice to All Interested Parties
C-3	Copies of Certified Mail Receipts and Returns
C-4	Affidavit of Publication for February 8, 2024

**COMPULSORY POOLING APPLICATION CHECKLIST****ALL INFORMATION IN THE APPLICATION MUST BE SUPPORTED BY SIGNED AFFIDAVITS**

<b>Case: 24177</b>	<b>APPLICANT'S RESPONSE</b>
<b>Hearing Date</b>	<b>March 7, 2023</b>
Applicant	<b>Mewbourne Oil Company</b>
Designated Operator & OGRID (affiliation if applicable)	<b>OGRID No. 14744</b>
Applicant's Counsel:	Hinkle Shanor LLP
Case Title:	Application of Mewbourne Oil Company for Compulsory Pooling, Eddy County, New Mexico.
Entries of Appearance/Intervenors:	EOG Resources, Inc.; Sabinal Energy Operating, LLC
Well Family	Cripple Creek
<b>Formation/Pool</b>	
Formation Name(s) or Vertical Extent:	Wolfcamp
Primary Product (Oil or Gas):	Oil
Pooling this vertical extent:	Wolfcamp
Pool Name and Pool Code:	Avalon; Wolfcamp Southwest Pool (Code 97068)
Well Location Setback Rules:	Statewide
<b>Spacing Unit</b>	
Type (Horizontal/Vertical)	Horizontal
Size (Acres)	320 acres
Building Blocks:	quarter-quarter
Orientation:	East/West
Description: TRS/County	N/2 S/2 of Sections 35 and 34, Township 20 South, Range 27 East, Eddy County, New Mexico.
Standard Horizontal Well Spacing Unit (Y/N), If No, describe <u>and is approval of non-standard unit requested in this application?</u>	Yes.
<b>Other Situations</b>	
Depth Severance: Y/N. If yes, description	No
Proximity Tracts: If yes, description	No.
Proximity Defining Well: if yes, description	N/A
Applicant's Ownership in Each Tract	Exhibit A-3
<b>Well(s)</b>	
Name & API (if assigned), surface and bottom hole location, footages, completion target, orientation, completion status (standard or non-standard)	Add wells as needed
Well #1	Cripple Creek 35/34 Fed Com #716H (API # ---) SHL: 1820' FSL & 205' FEL (Unit I), Section 35, T20S, R27E BHL: 1980' FSL & 100' FWL (Unit L), Section 34, T20S, R27E Completion Target: Wolfcamp (Approx. 8,400' TVD)
Horizontal Well First and Last Take Points	Exhibit A-2
Completion Target (Formation, TVD and MD)	Exhibit A-4

<b>AFE Capex and Operating Costs</b>	
Drilling Supervision/Month \$	\$9,000.00
Production Supervision/Month \$	\$900.00
Justification for Supervision Costs	Exhibit A
Requested Risk Charge	200%
<b>Notice of Hearing</b>	
Proposed Notice of Hearing	Exhibit A-1
Proof of Mailed Notice of Hearing (20 days before hearing)	Exhibit C-1, Exhibit C-2, Exhibit C-3
Proof of Published Notice of Hearing (10 days before hearing)	Exhibit C-4
<b>Ownership Determination</b>	
Land Ownership Schematic of the Spacing Unit	Exhibit A-3
Tract List (including lease numbers and owners)	Exhibit A-3
If approval of Non-Standard Spacing Unit is requested, Tract List (including lease numbers and owners) of Tracts subject to notice requirements.	N/A
Pooled Parties (including ownership type)	Exhibit A-3
Unlocatable Parties to be Pooled	N/A
Ownership Depth Severance (including percentage above & below)	N/A
<b>Joinder</b>	
Sample Copy of Proposal Letter	Exhibit A-4
List of Interest Owners (ie Exhibit A of JOA)	Exhibit A-3
Chronology of Contact with Non-Joined Working Interests	Exhibit A-5
Overhead Rates In Proposal Letter	Exhibit A-4
Cost Estimate to Drill and Complete	Exhibit A-4
Cost Estimate to Equip Well	Exhibit A-4
Cost Estimate for Production Facilities	Exhibit A-4
<b>Geology</b>	
Summary (including special considerations)	Exhibit B
Spacing Unit Schematic	Exhibit B-1
Gunbarrel/Lateral Trajectory Schematic	N/A
Well Orientation (with rationale)	Exhibit B
Target Formation	Exhibit B
HSU Cross Section	Exhibit B-3
Depth Severance Discussion	N/A
<b>Forms, Figures and Tables</b>	
C-102	Exhibit A-2
Tracts	Exhibit A-3
Summary of Interests, Unit Recapitulation (Tracts)	Exhibit A-3
General Location Map (including basin)	Exhibit B-1
Well Bore Location Map	Exhibit B-2
Structure Contour Map - Subsea Depth	Exhibit B-2

Cross Section Location Map (including wells)	Exhibit B-3
Cross Section (including Landing Zone)	Exhibit B-3
<b>Additional Information</b>	
Special Provisions/Stipulations	N/A
<b>CERTIFICATION: I hereby certify that the information provided in this checklist is complete and accurate.</b>	
<b>Printed Name</b> (Attorney or Party Representative):	Dana S. Hardy
<b>Signed Name</b> (Attorney or Party Representative):	/s/ Dana S. Hardy
<b>Date:</b>	3/8/2024

**STATE OF NEW MEXICO  
DEPARTMENT OF ENERGY, MINERALS AND NATURAL RESOURCES  
OIL CONSERVATION DIVISION**

**APPLICATION OF MEWBOURNE OIL COMPANY  
FOR COMPULSORY POOLING,  
EDDY COUNTY, NEW MEXICO.**

**CASE NO. 24177**

**SELF-AFFIRMED STATEMENT  
OF ARIANA RODRIGUES**

1. I am a landman for Mewbourne Oil Company (“Mewbourne”). I am over 18 years of age, have personal knowledge of the matters addressed herein and am competent to provide this Self-Affirmed Statement. I have previously testified before the New Mexico Oil Conservation Division (“Division”) and my credentials as an expert in petroleum land matters were accepted and made a matter of record.
2. I am familiar with the land matters involved in the above-referenced case. Copies of Mewbourne’s Application and proposed hearing notice are attached as Exhibit A-1.
3. None of the parties proposed to be pooled in this case indicated opposition to this matter proceeding by affidavit, therefore I do not expect any opposition at hearing.
4. Mewbourne applies for an order pooling all uncommitted mineral interests in the Wolfcamp formation underlying a 320-acre, more or less, standard horizontal spacing unit comprised of the N/2 S/2 of Sections 35 and 34, Township 20 South, Range 27 East, Eddy County, New Mexico (“Unit”).
5. Mewbourne seeks to dedicate the Unit to the Cripple Creek 35/34 Fed Com #716H well (“Well”), which will be completed in the Avalon; Wolfcamp Southwest Pool (Code 97068). The Well will be drilled from a surface hole location in the NE/4 SE/4 (Unit I) of Section 35 to a bottom hole location in the NW/4 SW/4 (Unit L) of Section 34.
6. The completed interval of the Well will be orthodox.

**Mewbourne Oil Company  
Case No. 24177  
Exhibit A**

7. **Exhibit A-2** contains the C-102 for the Well.
8. **Exhibit A-3** contains a plat that identifies ownership by tract in the Unit. This exhibit also includes any applicable lease numbers, a unit recapitulation, and the interests Mewbourne seeks to pool highlighted in yellow. All of the interest owners are locatable.
9. **Exhibit A-4** contains a sample well proposal letter and AFE sent to the working interest owners for the Well. The estimated costs reflected on the AFE is a fair and reasonable and comparable to the cost of other wells of similar depth and length drilled in the subject formation in the area.
10. Mewbourne has conducted a diligent search of all county public records including phone directories and computer databases.
11. In my opinion, Mewbourne made a good-faith effort to reach voluntary joinder of uncommitted interests in the Wells as indicated by the chronology of contact described in **Exhibit A-5**.
12. Mewbourne requests overhead and administrative rates of \$9,000.00 per month while the Well is being drilled and \$900.00 per month while the Well is producing. These rates are fair and are comparable to the rates charged by Mewbourne and other operators in the vicinity.
13. The attached exhibits were either prepared by me or under my supervision or were compiled from company business records.
14. In my opinion, the granting of Mewbourne's application would serve the interests of conservation, the protection of correlative rights, and the prevention of waste.
15. I understand this Self-Affirmed Statement will be used as written testimony in the subject cases. I affirm that my testimony above is true and correct and is made under penalty of



perjury under the laws of the State of New Mexico. My testimony is made as of the date  
handwritten next to my signature below.

  
\_\_\_\_\_  
Ariana Rodrigues

3/4/2024  
\_\_\_\_\_  
Date

**STATE OF NEW MEXICO  
ENERGY, MINERALS AND NATURAL RESOURCES DEPARTMENT  
OIL CONSERVATION DIVISION**

**APPLICATION OF MEWBOURNE OIL COMPANY  
FOR COMPULSORY POOLING,  
EDDY COUNTY, NEW MEXICO**

**CASE NO. 24177**

**APPLICATION**

In accordance with NMSA 1978, § 70-2-17, Mewbourne Oil Company (“Mewbourne” or “Applicant”) (OGRID No. 14744), through its undersigned attorneys, applies for an order pooling all uncommitted interests in the Wolfcamp formation underlying a 320-acre, more or less, standard horizontal spacing unit comprised of the N/2 S/2 of Sections 35 and 34, Township 20 South, Range 27 East, Eddy County, New Mexico (“Unit”). In support of this application, Mewbourne states the following.

1. Mewbourne is a working interest owner in the Unit and has the right to drill thereon.
2. Applicant seeks to dedicate the Unit to the proposed **Cripple Creek 35/34 Fed Com #716H** well (“Well”), to be drilled from a surface hole location in the NE/4 SE/4 (Unit I) of Section 35 to a bottom hole location in the NW/4 SW/4 (Unit L) of Section 34.
3. The completed interval of the Well will be orthodox.
4. Applicant has undertaken diligent, good-faith efforts to obtain voluntary agreements from all interest owners to participate in the drilling of the Well but has been unable to obtain voluntary agreements from all interests owners in the Unit.
5. The pooling of uncommitted interests will avoid the drilling of unnecessary wells, prevent waste, and protect correlative rights.

**Mewbourne Oil Company  
Case No. 24177  
Exhibit A-1**

6. In order to allow Applicant to obtain its just and fair share of the oil and gas underlying the subject lands, all uncommitted interests in the Unit should be pooled and Applicant should be designated the operator of the proposed horizontal Well and the Unit.

WHEREFORE, Applicant requests that this application be set for hearing before an Examiner of the Oil Conservation Division on March 7, 2024, and, after notice and hearing as required by law, the Division enter an order:

- A. Pooling all uncommitted interests in the Unit;
- B. Approving the Well in the Unit;
- C. Designating Applicant as operator of the Unit and the Well to be drilled thereon;
- D. Authorizing Applicant to recover its costs of drilling, equipping and completing the Well;
- E. Approving the actual operating charged and costs of supervision while drilling and after completion, together with a provision adjusting the rates pursuant to the COPAS accounting procedures; and
- F. Imposing a 200% penalty for the risk assumed by Applicant in drilling and completing the Well against any working interest owner who does not voluntarily participate in the drilling of the Well.

Respectfully submitted,

HINKLE SHANOR LLP

/s/ Dana S. Hardy  
Dana S. Hardy  
Jaclyn M. McLean  
P.O. Box 2068  
Santa Fe, NM 87504-2068  
Phone: (505) 982-4554

Facsimile: (505) 98208623  
dhardy@hinklelawfirm.com  
jmclean@hinklelawfirm.com  
*Counsel for Mewbourne Oil Company*

**Application of Mewbourne Oil Company for Compulsory Pooling, Eddy County, New Mexico.** Mewbourne Oil Company (“Applicant”) applies for an order pooling all uncommitted interests in the Wolfcamp formation underlying a 320-acre, more or less, standard horizontal spacing unit comprised of the N/2 S/2 of Sections 35 and 34, Township 20 South, Range 27 East, Eddy County, New Mexico (“Unit”). The Unit will be dedicated to the proposed **Cripple Creek 35/34 Fed Com #716H** well (“Well”), to be drilled from a surface hole location in the NE/4 SE/4 (Unit I) of Section 35 to a bottom hole location in the NW/4 SW/4 (Unit L) of Section 34. The completed interval of the Well will be orthodox. Also to be considered will be the cost of drilling and completing the Well and the allocation of the costs, the designation of Applicant as the operator of the Well, and a 200% charge for the risk involved in drilling and completing the Well. The Well is located approximately eight miles north of Carlsbad, New Mexico.

District I  
1625 N French Dr., Hobbs, NM 88240  
Phone: (575) 393-6161 Fax: (575) 393-0720  
District II  
811 S. First St., Artesia, NM 88210  
Phone: (575) 748-1283 Fax: (575) 748-9720  
District III  
1000 Rio Brazos Road, Aztec, NM 87410  
Phone: (505) 334-6178 Fax: (505) 334-6170  
District IV  
1220 S. St. Francis Dr., Santa Fe, NM 87505  
Phone: (505) 476-3460 Fax: (505) 476-3462

State of New Mexico  
Energy, Minerals & Natural Resources Department  
**OIL CONSERVATION DIVISION**  
1220 South St. Francis Dr.  
Santa Fe, NM 87505

Form C-102  
Revised August 1, 2011  
Submit one copy to appropriate  
District Office

AMENDED REPORT

**WELL LOCATION AND ACREAGE DEDICATION PLAT**

<sup>1</sup> API Number		<sup>2</sup> Pool Code 97068		<sup>3</sup> Pool Name AVALON; WOLFCAMP SOUTHWEST					
<sup>4</sup> Property Code		<sup>5</sup> Property Name CRIPPLE CREEK 35/34 FEDERAL						<sup>6</sup> Well Number 716H	
<sup>7</sup> GRID NO. 14744		<sup>8</sup> Operator Name MEWBOURNE OIL COMPANY						<sup>9</sup> Elevation 3216'	
<sup>10</sup> Surface Location									
UL or lot no. <b>I</b>	Section <b>35</b>	Township <b>20S</b>	Range <b>27E</b>	Lot Idn	Feet from the <b>1820</b>	North/South line <b>SOUTH</b>	Feet from the <b>205</b>	East/West line <b>EAST</b>	County <b>EDDY</b>
<sup>11</sup> Bottom Hole Location If Different From Surface									
UL or lot no. <b>L</b>	Section <b>34</b>	Township <b>20S</b>	Range <b>27E</b>	Lot Idn	Feet from the <b>1980</b>	North/South line <b>SOUTH</b>	Feet from the <b>100</b>	East/West line <b>WEST</b>	County <b>EDDY</b>
<sup>12</sup> Dedicated Acres 320.00	<sup>13</sup> Joint or Infill	<sup>14</sup> Consolidation Code		<sup>15</sup> Order No.					

No allowable will be assigned to this completion until all interest have been consolidated or a non-standard unit has been approved by the division.

<p><b>16</b></p> <p><b>GEODETIC DATA</b> NAD 83 GRID - NM EAST</p> <p><b>SURFACE LOCATION</b> N: 555674.1 - E: 568856.4 LAT: 32.5275753° N LONG: 104.2440444° W</p> <p><b>KICK OFF POINT (KOP)</b> <u>1980' FSL - 100' FEL (SEC. 35)</u> N: 555834.1 - E: 569050.5 LAT: 32.5280146° N LONG: 104.2434139° W</p> <p><b>FIRST TAKE POINT (FTP)</b> <u>1980' FSL - 100' FEL (SEC. 35)</u> N: 555834.1 - E: 568960.6 LAT: 32.5280148° N LONG: 104.2437058° W</p> <p><b>BOTTOM HOLE</b> N: 555834.5 - E: 568579.8 LAT: 32.5280354° N LONG: 104.2773880° W</p>	<p><b>CORNER DATA</b> NAD 83 GRID - NM EAST</p> <p>A: FOUND BRASS CAP "1942" N: 553855.1 - E: 558481.4</p> <p>B: FOUND BRASS CAP "1942" N: 556480.8 - E: 558479.3</p> <p>C: FOUND BRASS CAP "1942" N: 559153.2 - E: 558477.3</p> <p>D: FOUND BRASS CAP "1942" N: 559161.8 - E: 561127.5</p> <p>E: FOUND BRASS CAP "1942" N: 559145.3 - E: 563765.8</p> <p>F: FOUND BRASS CAP "1942" N: 559128.5 - E: 566415.8</p> <p>G: FOUND BRASS CAP "1942" N: 559124.8 - E: 569044.6</p> <p>H: FOUND BRASS CAP "1942" N: 556490.2 - E: 569057.3</p> <p>I: FOUND BRASS CAP "1942" N: 553854.6 - E: 569070.2</p> <p>J: FOUND BRASS CAP "1942" N: 553854.2 - E: 563772.9</p> <p>K: FOUND BRASS CAP "1942" N: 553851.2 - E: 561124.2</p> <p>L: FOUND BRASS CAP "1942" N: 556504.6 - E: 563749.7</p>	<p><b>17 OPERATOR CERTIFICATION</b></p> <p><i>I hereby certify that the information contained herein is true and complete to the best of my knowledge and belief, and that this organization either owns a working interest or unleased mineral interest in the land including the proposed bottom hole location or has a right to drill this well at this location pursuant to a contract with an owner of such a mineral or working interest, or to a voluntary pooling agreement or a compulsory pooling order heretofore entered by the division.</i></p> <p>Signature _____ Date _____</p> <p>Printed Name _____</p> <p>E-mail Address _____</p>
<p><b>18 SURVEYOR CERTIFICATION</b></p> <p><i>I hereby certify that the well location shown on this plat was plotted from field notes of actual surveys made by me or under my supervision, and that the same is true and correct to the best of my belief.</i></p> <p><b>05/24/2023</b> Date of Survey</p> <p>Signature and Seal of Professional Surveyor _____</p> <p><b>19680</b> Certificate Number</p> <p>REV: ADD WELL CALLS 06/14/23</p>		
<p><b>Job No: LS23050472</b></p>		

Mewbourne Oil Company  
Case No. 24177  
Exhibit A-2

Section Plat  
Cripple Creek 35/34 Fed Com #716H  
N2S2 of Section 35 & N2S2 of Section 34

T20S, R27E, Eddy County, New Mexico

T20S, R27E, Eddy County, New Mexico

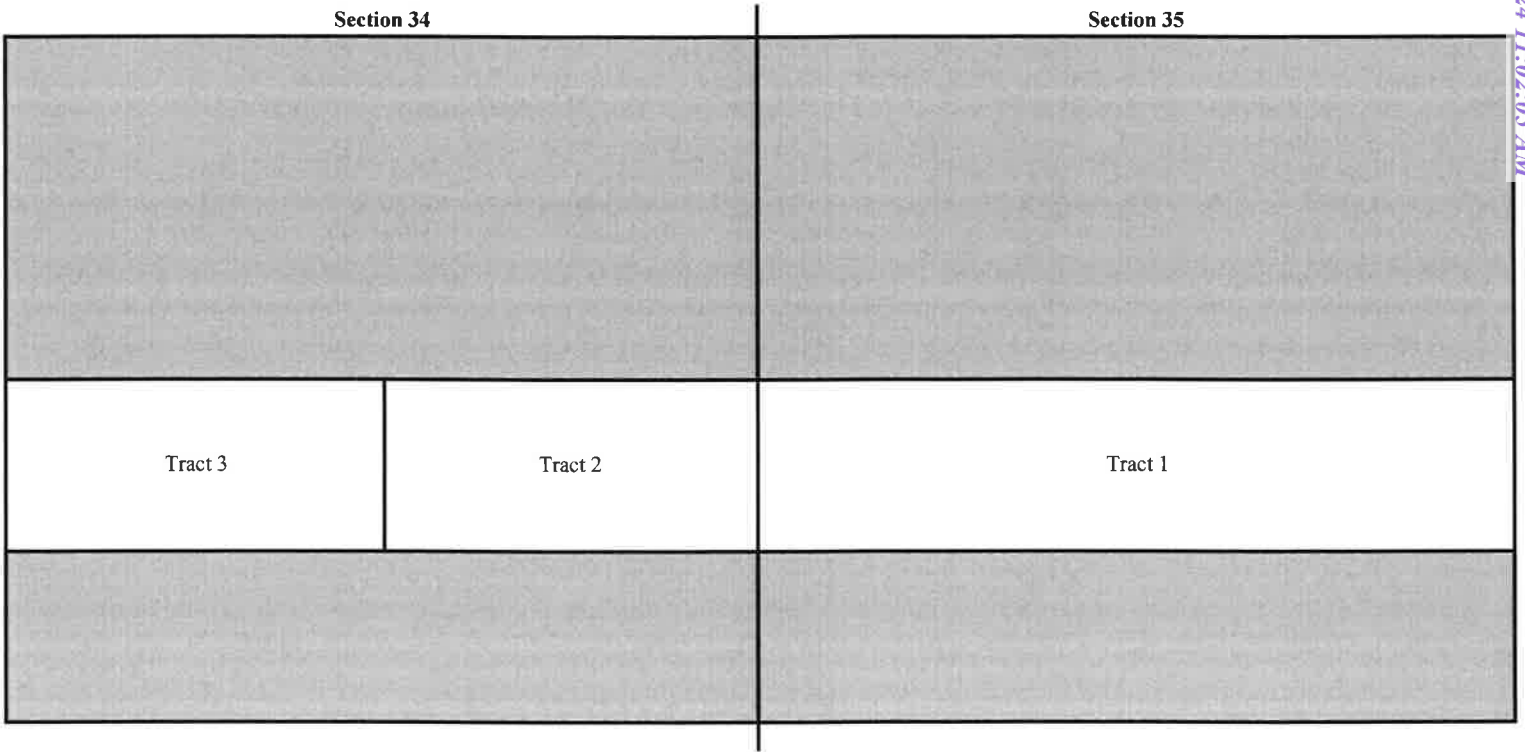

RECAPITULATION

Tract Number	Number of Acres Committed	Percentage of Interest in Communitized Area
1	160.00	50.000000%
2	80.00	25.000000%
3	80.00	25.000000%
<b>TOTAL</b>	<b>320.00</b>	<b>100.000000%</b>

**TRACT OWNERSHIP**  
**Cripple Creek Fed Com #716H**  
**N2S2 of Section 35 & N2S2 of Section 34**  
**T20S, R27E, Eddy County, New Mexico**

**Ownership by Tract**

**Tract 1: N2S2 of Section 35 - Federal Lease LC 0072015 C**

Entity/Individual	Interest	Gross Acres	Net Acres
Mewbourne Oil Company et. al.	76.668207%	160.00	122.669131
Marathon Oil Permian LLC	22.554950%	160.00	36.087920
Sabinal Energy Operating, LLC	0.776843%	160.00	1.242949
<b>Total</b>	<b>100.000000%</b>		<b>160.000000</b>

**Tract 2: N2SE4 of Section 34 - Federal Lease LC 0072015 C**

Entity/Individual	Interest	Gross Acres	Net Acres
Mewbourne Oil Company et. al.	82.589392%	80.00	66.071513600
EOG Resources Assets LLC	11.607072%	80.00	9.285657600
Santo Legado LLLP	5.803536%	80.00	4.642828800
<b>Total</b>	<b>100.000000%</b>		<b>80.000000</b>

**Tract 3: N2SW4 of Section 34 - Federal Lease LC 0072015 C**

Entity/Individual	Interest	Gross Acres	Net Acres
Mewbourne Oil Company et. al.	73.38587400%	80.00	58.708699200
Pacer Energy, Ltd.	17.908822%	80.00	14.327057600
EOG Resources Assets LLC	5.803536%	80.00	4.642828800
Santo Legado LLLP	2.901768%	80.00	2.321414400
<b>Total</b>	<b>100.000000%</b>		<b>80.000000</b>

**Spacing Unit Ownership**

	Percentage	
Mewbourne Oil Company, et al.	77.327920%	247.449344
Marathon Oil Permian LLC	11.277475%	36.087920
Pacer Energy, Ltd.	4.477206%	14.327058
EOG Resources Assets LLC	4.352652%	13.928486
Santo Legado LLLP	2.176326%	6.964243
Sabinal Energy Operating, LLC	0.388422%	1.242949
<b>Total</b>	<b>100.000000%</b>	<b>320.000000</b>

\*Parties highlighted in yellow are being pooled



**MEWBOURNE OIL COMPANY**

500 West Texas, Suite 1020  
Midland, Texas 79701  
Phone (432) 682-3715

June 26, 2023

Certified Mail

«Owners»  
«Attn»  
«Address\_Line\_1»  
«Address\_Line\_2»  
«City», «State» «Zip\_Code»

Re: Cripple Creek 35/34 Working Interest Unit and Well Proposals  
All of Section 34 and 35, T20S, R27E  
Eddy County, New Mexico

Ladies and Gentlemen:

Mewbourne Oil Company (“MOC”), as Operator, hereby proposes creating a working interest unit comprising of All of Section 34 and Section 35, T20S, R27E, Eddy County, New Mexico. As part of the initial development of this unit, MOC hereby proposes the following wells targeting the Bone Spring and Wolfcamp formations:

- 1) CRIPPLE CREEK 35/34 FED #613H – API # - pending  
Surface Location: 1980 FNL & 205 FEL, Section 35, T20S, R27E  
Bottom Hole Location: 1980 FNL & 100 FWL, Section 34, T20S, R27E  
Proposed Total Vertical Depth: 8160’  
Proposed Total Measured Depth: 18320’  
Spacing Unit: S2N2 of Section 34 & Section 35 – Bone Spring
- 2) CRIPPLE CREEK 35/34 FED #618H – API # - pending  
Surface Location: 1800 FSL & 205 FEL, Section 35, T20S, R27E  
Bottom Hole Location: 660 FSL & 100 FWL, Section 34, T20S, R27E  
Proposed Total Vertical Depth: 8160’  
Proposed Total Measured Depth: 18320’  
Spacing Unit: S2S2 of Section 34 & Section 35 – Bone Spring
- 3) CRIPPLE CREEK 35/34 FED #711H – API # - pending  
Surface Location: 1960 FNL & 205 FEL, Section 35, T20S, R27E  
Bottom Hole Location: 660 FNL & 100 FWL, Section 34, T20S, R27E  
Proposed Total Vertical Depth: 8400’  
Proposed Total Measured Depth: 18560’  
Spacing Unit: N2N2 of Section 34 & Section 35 – Wolfcamp
- 4) CRIPPLE CREEK 35/34 FED #716H – API # - pending  
Surface Location: 1820 FSL & 205 FEL, Section 35, T20S, R27E  
Bottom Hole Location: 1980 FSL & 100 FWL, Section 34, T20S, R27E  
Proposed Total Vertical Depth: 8400’  
Proposed Total Measured Depth: 18560’  
Spacing Unit: N2S2 of Section 34 & Section 35 – Wolfcamp

Regarding the above, enclosed for your further handling is our Operating Agreement dated June 1, 2023, along with an extra set of signature pages and our AFEs dated April 28, 2023 for the captioned proposed wells.

In the event your firm elects to participate in the proposed wells, please execute the enclosed extra set of JOA signature/notary pages and the AFEs before mailing them back to my attention to the address on the letterhead above within thirty (30) days.

Please contact me at (432) 682-3715 or [arodrigues@mewbourne.com](mailto:arodrigues@mewbourne.com) if you have any questions or need additional information.

Very truly yours,

**MEWBOURNE OIL COMPANY**

Ariana Rodrigues  
Landman

## MEWBOURNE OIL COMPANY

### AUTHORIZATION FOR EXPENDITURE

<b>Well Name:</b> CRIPPLE CREEK 35/34 FED #716H		<b>Prospect:</b> _____	
<b>Location:</b> SL: 1820 FSL & 205 FEL (35); BHL: 1980 FSL & 100 FWL (34)		<b>County:</b> EDDY	<b>ST:</b> NM
<b>Sec.</b> 35	<b>Blk:</b> _____	<b>Survey:</b> _____	<b>TWP:</b> 20S <b>RNG:</b> 27E <b>Prop. TVD:</b> 8400 <b>TMD:</b> 18560

INTANGIBLE COSTS 0180	CODE	TCP	CODE	CC
Regulatory Permits & Surveys	0180-0100	\$25,000	0180-0200	
Location / Road / Site / Preparation	0180-0105	\$100,000	0180-0205	\$35,000
Location / Restoration	0180-0106	\$200,000	0180-0206	\$30,000
Daywork / Turnkey / Footage Drilling 22 days drlg / 3 days comp @ \$30000/d	0180-0110	\$704,000	0180-0210	\$96,100
Fuel 1700 gal/day @ \$3.9/gal	0180-0114	\$158,000	0180-0214	\$319,000
Alternate Fuels	0180-0115		0180-0215	\$97,000
Mud, Chemical & Additives	0180-0120	\$50,000	0180-0220	
Mud - Specialized	0180-0121	\$270,000	0180-0221	
Horizontal Drillout Services			0180-0222	\$200,000
Stimulation Toe Preparation			0180-0223	\$40,000
Cementing	0180-0125	\$190,000	0180-0225	\$50,000
Logging & Wireline Services	0180-0130	\$30,900	0180-0230	\$375,000
Casing / Tubing / Snubbing Services	0180-0134	\$35,000	0180-0234	\$15,000
Mud Logging	0180-0137	\$15,000		
Stimulation 51 Stg 20.2 MM gal / 20.2 MM lb			0180-0241	\$2,820,000
Stimulation Rentals & Other			0180-0242	\$264,000
Water & Other 100% PW @ \$0.25/BBL F/ SLWMS	0180-0145	\$35,000	0180-0245	\$121,000
Bits	0180-0148	\$94,000	0180-0248	
Inspection & Repair Services	0180-0150	\$50,000	0180-0250	\$5,000
Misc. Air & Pumping Services	0180-0154		0180-0254	\$10,000
Testing & Flowback Services	0180-0158	\$12,000	0180-0258	\$20,000
Completion / Workover Rig			0180-0260	\$10,500
Rig Mobilization	0180-0164	\$154,000		
Transportation	0180-0165	\$30,000	0180-0265	\$20,000
Welding, Construction & Maint. Services	0180-0168	\$4,000	0180-0268	\$16,500
Contract Services & Supervision	0180-0170	\$189,000	0180-0270	\$59,500
Directional Services Includes Vertical Control	0180-0175	\$374,000		
Equipment Rental	0180-0180	\$185,000	0180-0280	\$15,000
Well / Lease Legal	0180-0184	\$5,000	0180-0284	
Well / Lease Insurance	0180-0185	\$5,700	0180-0285	
Intangible Supplies	0180-0188	\$7,000	0180-0288	\$1,000
Damages	0180-0190		0180-0290	
Pipeline Interconnect, ROW Easements	0180-0192		0180-0292	\$5,000
Company Supervision	0180-0195	\$108,000	0180-0295	\$32,400
Overhead Fixed Rate	0180-0196	\$10,000	0180-0296	\$20,000
Contingencies 5% (TCP) 5% (CC)	0180-0199	\$157,800	0180-0299	\$233,800
<b>TOTAL</b>		<b>\$3,198,400</b>		<b>\$4,910,800</b>

TANGIBLE COSTS 0181	CODE	TCP	CODE	CC
Casing (19.1" - 30")	0181-0793			
Casing (10.1" - 19.0") 425' - 13 3/8" 54.5# J-55 ST&C @ \$76.3/ft	0181-0794	\$32,400		
Casing (8.1" - 10.0") 2250' - 9 5/8" 36# J-55 LT&C @ \$51.16/ft	0181-0795	\$115,000		
Casing (6.1" - 8.0") 7925- 7" 29# HPP110 BT&C @ \$59.83/ft	0181-0796	\$474,200		
Casing (4.1" - 6.0") 10850' - 4 1/2" 13.5# P-110 CDC-HTQ @ \$33.47/ft			0181-0797	\$363,100
Tubing 7825' - 2 7/8" 6.5# L-80 IPC Tbg @ \$17/ft			0181-0798	\$133,300
Drilling Head	0181-0860	\$50,000		
Tubing Head & Upper Section			0181-0870	\$30,000
Horizontal Completion Tools Completion Liner Hanger			0181-0871	\$75,000
Subsurface Equip. & Artificial Lift			0181-0880	\$25,000
Service Pumps (1/4) TP/CP/CIRC PUMP			0181-0886	\$9,000
Storage Tanks (1/4) (6)OT/(5)WT/(1)GB			0181-0890	\$115,000
Emissions Control Equipment (1/4) (3)VRT/(1)VRU/(1)FLARE/(3)KO/(1)AIR			0181-0892	\$93,000
Separation / Treating Equipment (1/4) (4)H SEP/(1)V SEP/(2)VHT/(1)HHT			0181-0895	\$88,000
Automation Metering Equipment AUTOMATION/METERS			0181-0898	\$39,000
Oil/Gas Pipeline -Pipe/Valves&Misc (1/4) Gas Line & GL Injection			0181-0900	\$54,000
Water Pipeline -Pipe/Valves&Misc SWDL PIPE/FITTINGS			0181-0901	\$12,000
On-site Valves/Fittings/Lines&Misc			0181-0906	\$91,000
Wellhead Flowlines - Construction			0181-0907	\$106,000
Cathodic Protection			0181-0908	
Electrical Installation			0181-0909	\$66,000
Equipment Installation			0181-0910	\$48,000
Oil/Gas Pipeline - Construction GAS LINE CONSTRUCTION			0181-0920	\$8,000
Oil/Gas Pipeline - Construction SWDL CONSTRUCTION			0181-0921	\$4,000
<b>TOTAL</b>		<b>\$671,600</b>		<b>\$1,359,400</b>
<b>SUBTOTAL</b>		<b>\$3,870,000</b>		<b>\$6,270,200</b>
<b>TOTAL WELL COST</b>				<b>\$10,140,200</b>

**Extra Expense Insurance**

I elect to be covered by Operator's Extra Expense Insurance and pay my proportionate share of the premium.  
Operator has secured Extra Expense Insurance covering costs of well control, clean up and redrilling as estimated in Line Item 0180-0185.

I elect to purchase my own well control insurance policy.

If neither box is checked above, non-operating working interest owner elects to be covered by Operator's well control insurance.

Prepared by: J. Chaney Coffman Date: 4/28/2023

Company Approval: \_\_\_\_\_ Date: \_\_\_\_\_

Joint Owner Interest: \_\_\_\_\_ Amount: \_\_\_\_\_

Joint Owner Name: \_\_\_\_\_ Signature: \_\_\_\_\_

**Summary of Communications**  
**Cripple Creek 35/34 Fed Com #716H**  
**N2S2 of Section 35 & N2S2 of Section 34**  
**T20S, R27E, Eddy County, New Mexico**

**Marathon Oil Permian LLC:**

**6/29/2023:** Mailed Working Interest Unit and Well Proposal to the above listed party.

**3/5/2024:** Correspondence with above listed party regarding Working Interest Unit and Well Proposal.

**Pacer Energy, Ltd.:**

**6/29/2023:** Mailed Working Interest Unit and Well Proposal to the above listed party.

**7/10/2023:** Phone call with above listed party regarding Working Interest Unit and Well Proposal.

**2/16/2024:** Phone call and correspondence with above listed party regarding Working Interest Unit and Well Proposal.

**EOG Resources Inc.:**

**6/29/2023:** Mailed Working Interest Unit and Well Proposal to the above listed party.

**1/23/2024:** Correspondence with above listed party regarding Working Interest Unit and Well Proposal.

**Santo Legado LLC:**

**6/29/2023:** Mailed and Emailed Working Interest Unit and Well Proposal to the above listed party.

**7/19/2023:** Correspondence with above listed party regarding Working Interest Unit and Well Proposal.

**7/26/2023:** Correspondence with above listed party regarding Working Interest Unit and Well Proposal.

**12/13/2023:** Correspondence with above listed party regarding Working Interest Unit and Well Proposal.

**1/22/2024:** Correspondence with above listed party regarding Working Interest Unit and Well Proposal.

**Sabinal Energy Operating, LLC:**

**6/29/2023:** Mailed and Emailed Working Interest Unit and Well Proposal to the above listed party.

**12/12/2023:** Voicemail and correspondence with above listed party regarding Working Interest Unit and Well Proposal.

**1/3/2024:** Correspondence with above listed party regarding Working Interest Unit and Well Proposal.

**1/8/2024:** Correspondence with above listed party regarding Working Interest Unit and Well Proposal.

**2/13/2024:** Correspondence with above listed party regarding Working Interest Unit and Well Proposal.

**STATE OF NEW MEXICO  
DEPARTMENT OF ENERGY, MINERALS AND NATURAL RESOURCES  
OIL CONSERVATION DIVISION**

**APPLICATION OF MEWBOURNE OIL COMPANY  
FOR COMPULSORY POOLING,  
EDDY COUNTY, NEW MEXICO.**

**CASE NOS. 24174 - 24177**

**SELF-AFFIRMED STATEMENT  
OF CHARLES CROSBY**

1. I am a geologist at Mewbourne Oil Company (“Mewbourne”) and am over 18 years of age. I have personal knowledge of the matters addressed herein and am competent to provide this Self-Affirmed Statement. I have previously testified before the New Mexico Oil Conservation Division (“Division”), and my credentials as an expert in petroleum geology matters were accepted and made a matter of record.

2. I am familiar with the geological matters that pertain to the above-referenced case.

3. **Exhibit B-1** is a location map of the proposed Cripple Creek horizontal spacing units (“Units”). The approximate wellbore paths for the proposed Cripple Creek 35/34 Fed Com #613H well, Cripple Creek 35/34 Fed Com #618H well, Cripple Creek 35/34 Fed Com #711H well, and Cripple Creek 35/34 Fed Com #716H well (“Wells”) are represented by dashed purple and red arrows.

4. **Exhibit B-2** is a subsea structure map for the top of the Wolfcamp formation that is representative of the targeted intervals. The approximate wellbore path for the Wells are depicted by dashed arrows. Existing producing wells in the targeted interval are represented by solid purple and red lines. The map demonstrates the formation is gently dipping to the east in this area. I do not observe any faulting, pinch-outs, or geologic impediments to developing the targeted intervals with horizontal wells.

**Mewbourne Oil Company  
Case No. 24177  
Exhibit B**

5. **Exhibit B-2** also identifies six wells penetrating the targeted intervals used to construct a stratigraphic cross-section from A to A'. I used these well logs because they penetrate the targeted intervals, are of good quality, and are representative of the geology in the area.

6. **Exhibit B-3** is a stratigraphic cross-section using the representative wells identified on Exhibit B-2. It contains gamma ray, resistivity and porosity logs. The proposed landing zones for the wells are labeled on the exhibit. This cross-section demonstrates the target intervals are continuous across the Units.

7. **Exhibit B-4** is a production table showing other horizontal wells in the area that are producing from the 3<sup>rd</sup> Bone Spring Sand and Wolfcamp Sand formations.

8. **Exhibit B-5** are preliminary horizontal survey reports for the proposed Wells.

9. In my opinion, a laydown orientation for the proposed wells is appropriate to properly develop the subject acreage because of an established directional pattern and the known regional stress regime in the area.

10. Based on my geologic study of the area, the targeted interval underlying the Units is suitable for development by horizontal wells and the tracts comprising the Units will contribute more or less equally to the production of the Wells.

11. In my opinion, the granting of Mewbourne's application will serve the interests of conservation, the protection of correlative rights, and the prevention of waste.

12. The attached exhibits were either prepared by me or under my supervision or were compiled from company business records.

13. I understand this Self-Affirmed Statement will be used as written testimony in this case. I affirm my testimony above is true and correct and is made under penalty of perjury under

the laws of the State of New Mexico. My testimony is made as of the date identified next to my signature below.







\_\_\_\_\_  
Charles Crosby



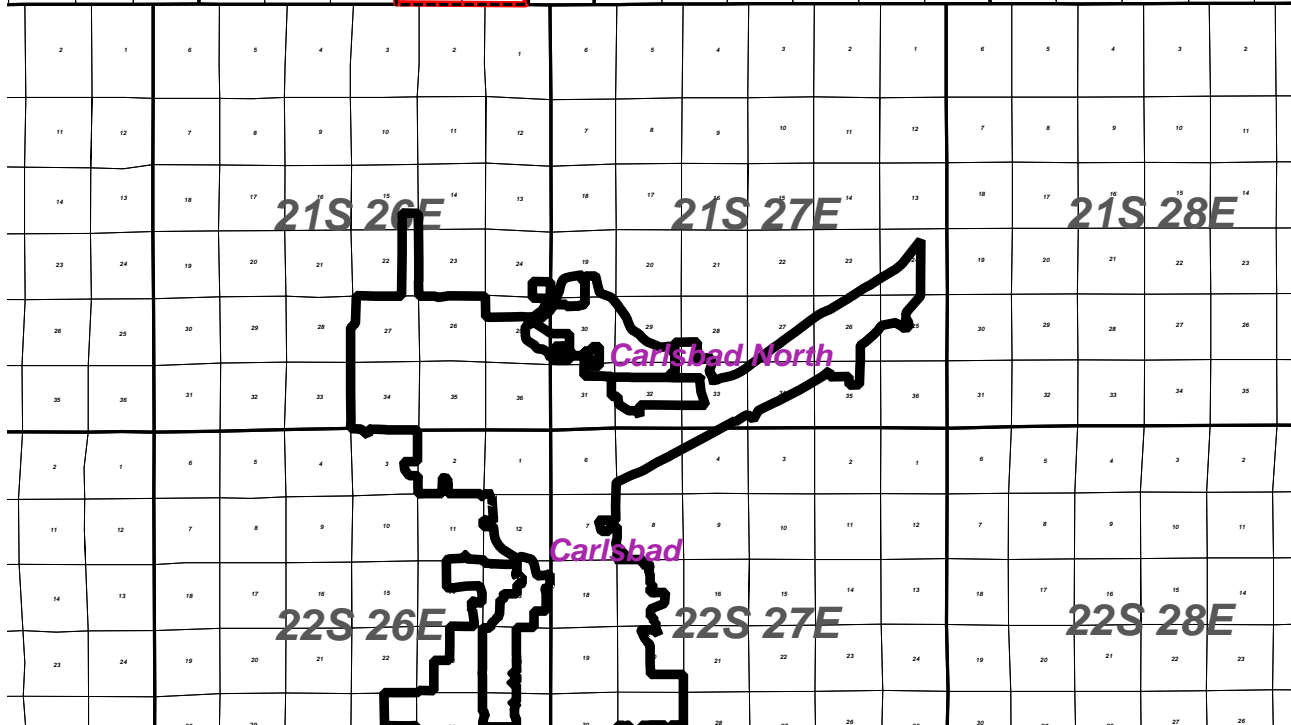
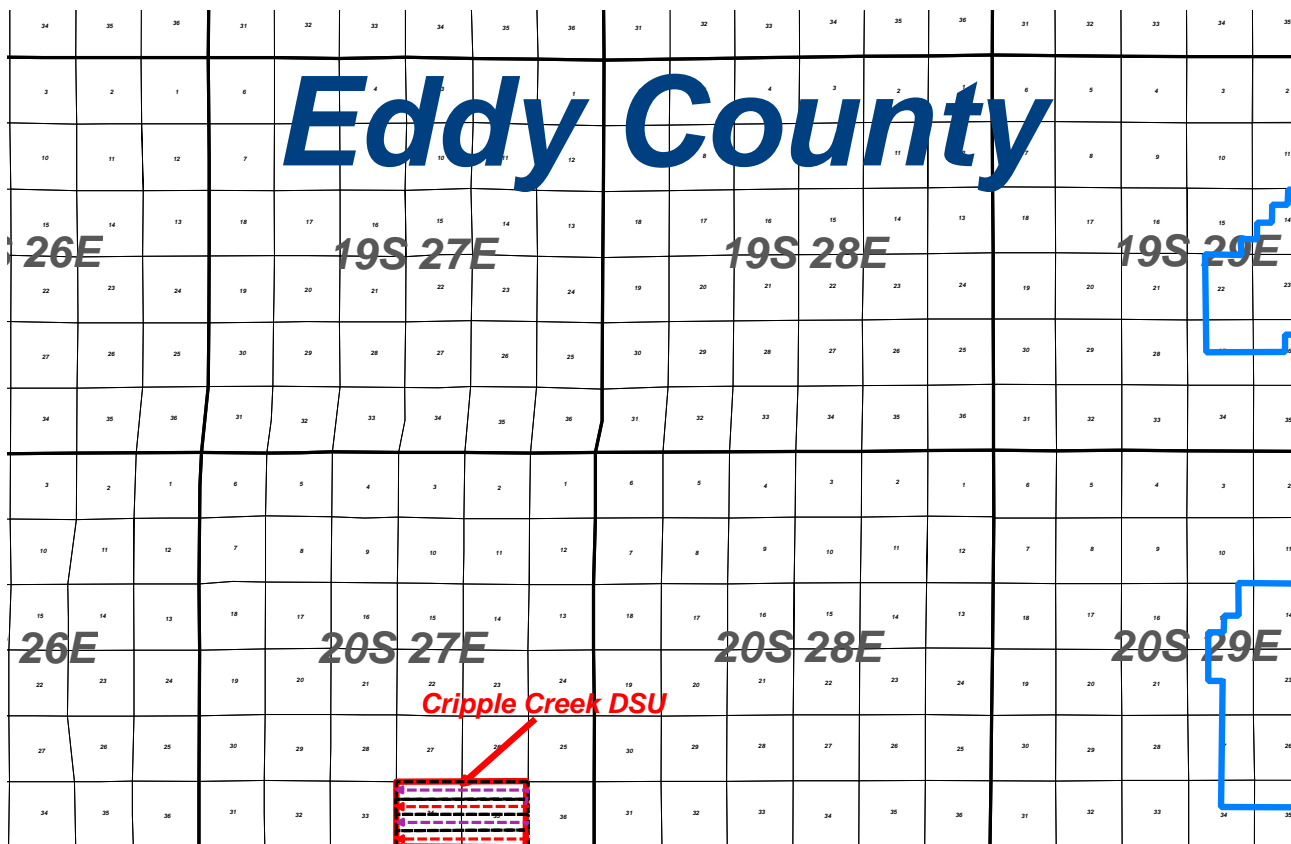

\_\_\_\_\_  
Date

# Eddy County

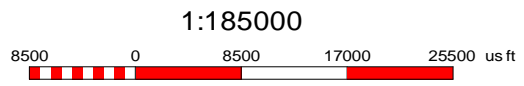

-  Potash Area
-  MOC Unit
-  Proration Unit



 Mewbourne Oil Company		
<b>Regional Locator Map</b> Cripple Creek 35/34 Area		
2/22/24	Eddy County	New Mexico
Wells TD < 5000' Filtered out		Geol. C. Crosby

O gy dqwt pg'QklE qo rcpf  
 Ecug'P q046397  
 Gzj kdk'D/3



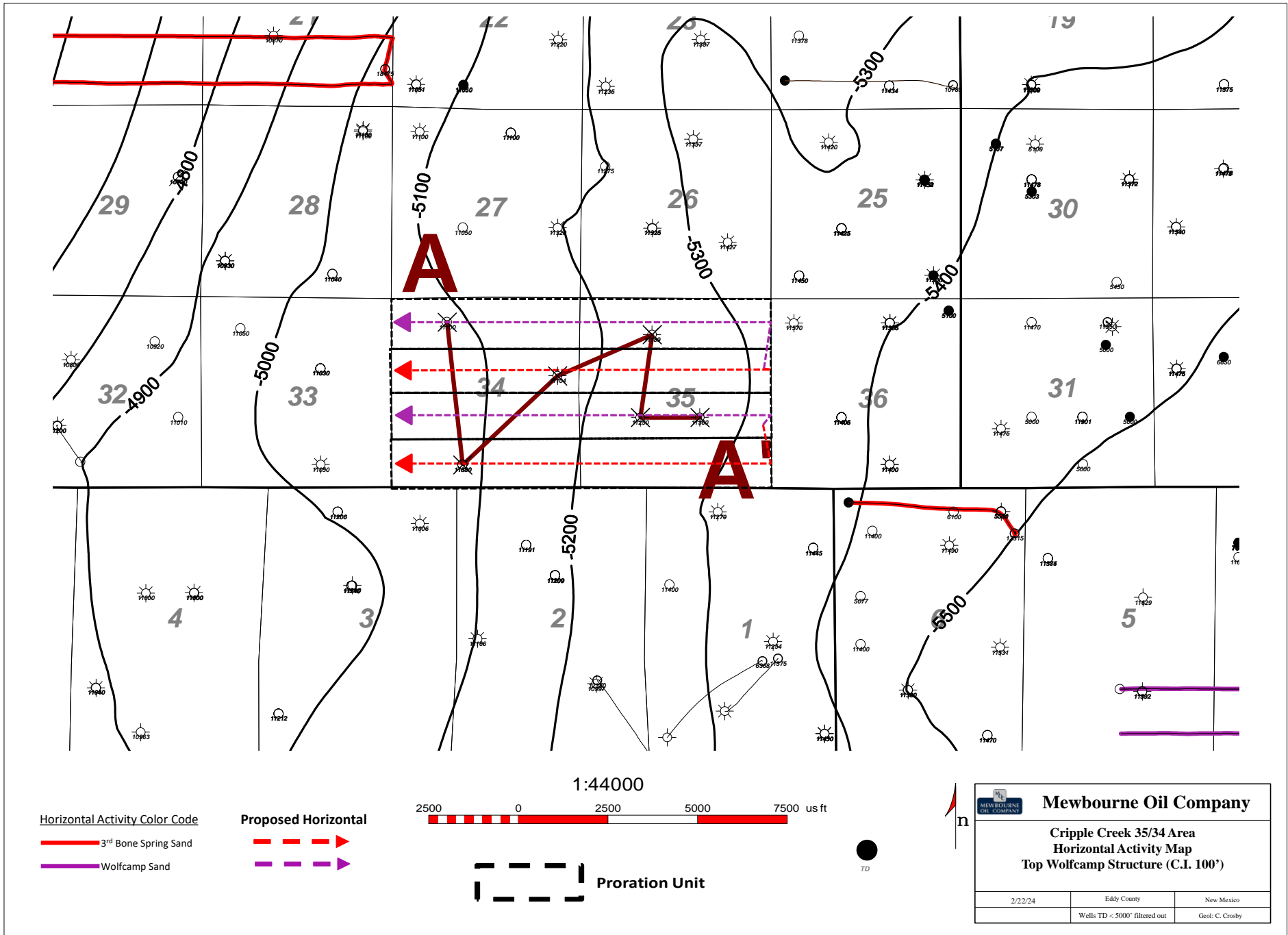

Horizontal Activity Color Code

- 3<sup>rd</sup> Bone Spring Sand
- Wolfcamp Sand

Proposed Horizontal

- Proposed Horizontal (Red)
- Proposed Horizontal (Purple)

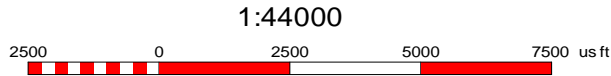

1:44000

Proration Unit

<b>Mewbourne Oil Company</b>		
<b>Cripple Creek 35/34 Area Horizontal Activity Map Top Wolfcamp Structure (C.I. 100')</b>		
2/22/24	Eddy County	New Mexico
Wells TD < 5000' filtered out		Geol: C. Crosby

**Mewbourne Oil Company**  
**Case No. 24177**  
**Exhibit B-2**

3001531651000 4000 ft 3001510068000 3628 ft 3001530331000 2878 ft 3001535695000 2334 ft 3001523748000 1661 ft 3001523302000

FASKEN OIL & RANCH LTD MARALO 34 FEDERAL 4 Datum=3216.00 1890 FSL/1890 FWL NE NW TWP: 20 S - Range: 27 E - Sec. 34

MARALO INC HANSON FEDERAL 1 Datum=3246.00 1890 FSL/1890 FWL NE NW TWP: 20 S - Range: 27 E - Sec. 34

MEWBORNE OIL CO MARALO 34 FEDERAL 3 Datum=3274.00 2150 FSL/1890 FWL S2 NE NW TWP: 20 S - Range: 27 E - Sec. 34

FASKEN OIL & RANCH LTD MARALO 35 FEDERAL 005 Datum=3239.00 1890 FSL/1890 FWL S2 NE NW TWP: 20 S - Range: 27 E - Sec. 35

FASKEN OIL & RANCH LTD MARALO FEDERAL 002 Datum=3250.00 1890 FSL/1890 FWL NE NW TWP: 20 S - Range: 27 E - Sec. 35

FASKEN OIL & RANCH LTD MARALO FEDERAL 001 Datum=3243.00 1890 FSL/1890 FWL NE NW TWP: 20 S - Range: 27 E - Sec. 35

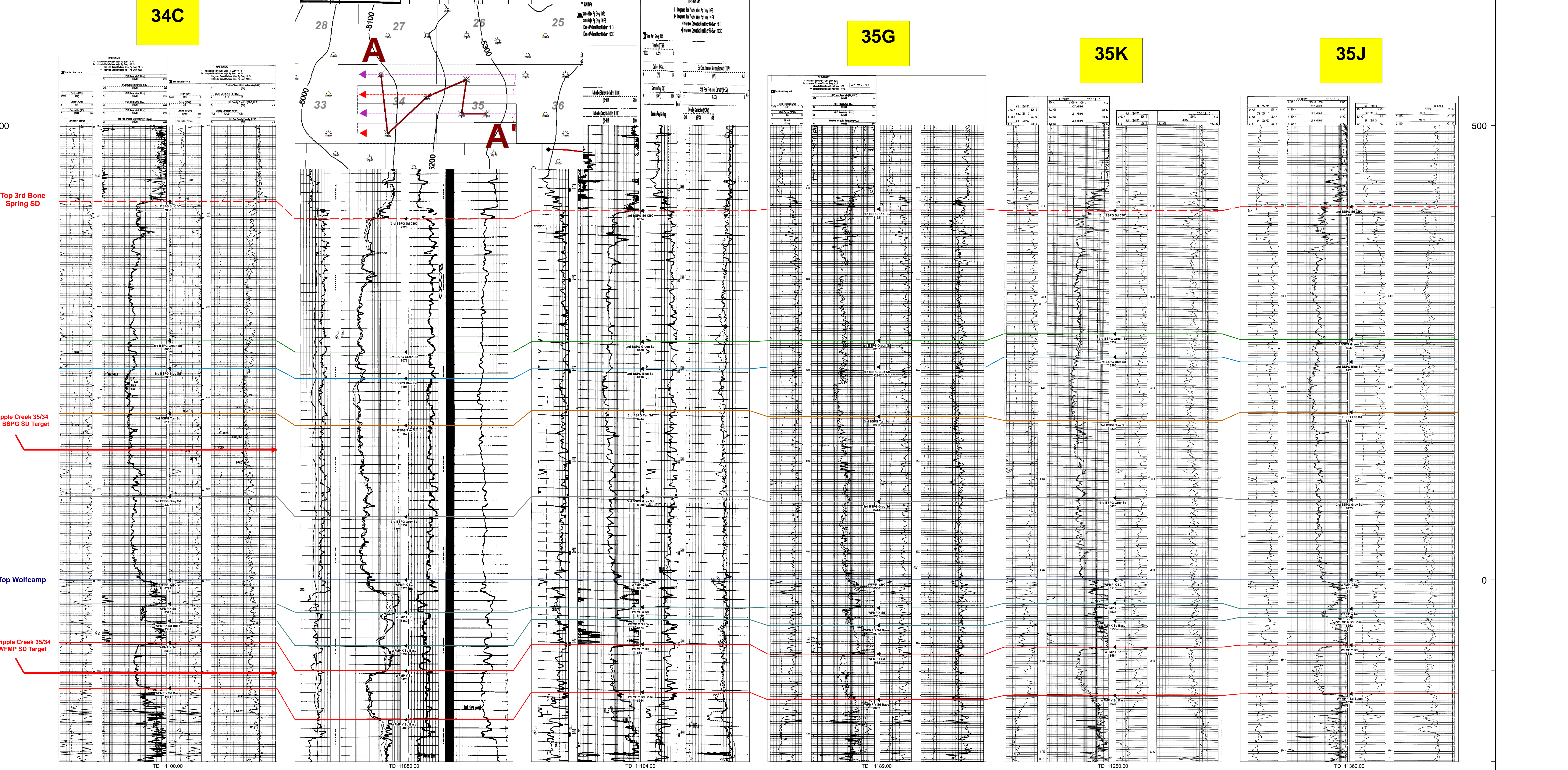

Cripple Creek 35/34 3rd BSPG SD-WFMP SD Cross Section Exhibit (A-A)

Cripple Creek 35/34 3rd Bone Spring Sand - Wolfcamp Sand Production Table

Well Name	Operator	API	Location	Comp Date	Cum Oil (MBO)	Cum Gas (BCF)	Cum Water (MBW)	NS/EW	HZ Target
Roscoe 6 B3AD Fed Com 1H	Mewbourne Oil Co	30015431680000	6A/21S/27E	6/23/2017	257.5	0.5	673.5	EW	3rd BSPG SD
Wine Mixer 21/20 B3PM Fed Com 1H	Mewbourne Oil Co	30015499470000	21P/20S/27E	7/1/2023	143.1	0.3	406.4	EW	3rd BSPG SD
Wine Mixer 21/20 B3IL Fed Com 1H	Mewbourne Oil Co	30015499480000	21P/20S/27E	7/1/2023	173.7	0.3	392.2	EW	3rd BSPG SD
Tough Ombres 4/5 W0XW Fed Com 1H	Mewbourne Oil Co	30015531830000	4I/21S/27E	4/1/2023	207.5	0.6	188.9	EW	WFMP SD
Tough Ombres 4/5 W0QR Fed Com 1H	Mewbourne Oil Co	30015531840000	4I/21S/27E	4/25/2023	231.1	0.6	189.6	EW	WFMP SD

Mewbourne Oil Company  
 Case No. 24177  
 Exhibit B-4

### Mewbourne Oil Company

SURVEY CALCULATION REPORT  
Minimum Curvature Calculations

Operator: Mewbourne Oil Company  
Lease Name: Cripple Creek 35/34 Federal 613H  
KOP 7880.04  
SL: 1980 FNL & 205 FEL; Sec 35/20S/27E  
PBHL: 1980 FNL & 100 FWL; Sec 34/20S/27E

Target KBTVD: 8,453 Feet      8453.00  
Target Angle: 91.66 Degrees      91.66  
Section Plane: 270.15 Degrees  
Declination Corrected to True North: 6.63 Degrees  
Bit to Survey Offset: 44 Feet

Survey No.	Measured Depth-ft	Drift (Deg.)	Azimuth (Deg.)	Course Length	TVD (Feet)	Vertical Section	+N/-S (Feet)	+E/-W (Feet)	Closure Distance	Closure Direction	BUR	DLS	KBTVD	+Above			
														-Below Target	DRIFT (RADIANS)	AZIMUTH (RADIANS)	
T/I	7880.04	0.00	270.15	N/A	7880.0	0.0	0.0	0.0	0.0	0.0	N/A	N/A	7880.0	573.0	1E-12	4.72	#VALUE!
1	7971.71	9.17	270.15	91.663	7971.3	7.3	0.0	-7.3	7.3	270.2	10.0	10.0	7971.5	481.5	0.1599829	4.72	0.1599829
2	8063.37	18.33	270.15	91.663	8060.3	29.1	0.1	-29.1	29.1	270.2	10.0	10.0	8061.1	391.9	0.3199658	4.72	0.1599829
3	8155.03	27.50	270.15	91.663	8144.6	64.7	0.2	-64.7	64.7	270.2	10.0	10.0	8146.5	306.5	0.4799487	4.72	0.1599829
4	8246.70	36.67	270.15	91.663	8222.2	113.4	0.3	-113.4	113.4	270.2	10.0	10.0	8225.5	227.5	0.6399315	4.72	0.1599829
5	8338.36	45.83	270.15	91.663	8291.0	173.7	0.5	-173.7	173.7	270.2	10.0	10.0	8296.1	156.9	0.7999144	4.72	0.1599829
6	8430.02	55.00	270.15	91.663	8349.4	244.3	0.6	-244.3	244.3	270.2	10.0	10.0	8356.5	96.5	0.9598973	4.72	0.1599829
7	8521.69	64.16	270.15	91.663	8395.7	323.3	0.8	-323.3	323.3	270.2	10.0	10.0	8405.1	47.9	1.1198802	4.72	0.1599829
8	8613.35	73.33	270.15	91.663	8428.9	408.6	1.1	-408.6	408.6	270.2	10.0	10.0	8440.8	12.2	1.2798631	4.72	0.1599829
9	8705.01	82.50	270.15	91.663	8448.1	498.1	1.3	-498.1	498.1	270.2	10.0	10.0	8462.6	-9.6	1.439846	4.72	0.1599829
10	8796.68	91.66	270.15	91.663	8452.8	589.6	1.5	-589.6	589.6	270.2	10.0	10.0	8469.9	-16.9	1.5998289	4.72	0.1599829
11	8800.00	91.66	270.15	3.3234	8452.7	592.9	1.6	-592.9	592.9	270.2	0.0	0.0	8469.9	-16.9	1.5998289	4.72	1E-10
12	8900.00	91.66	270.15	100	8449.8	692.9	1.8	-692.9	692.9	270.2	0.0	0.0	8469.9	-16.9	1.5998289	4.72	1E-10
13	9000.00	91.66	270.15	100	8446.9	792.8	2.1	-792.8	792.8	270.2	0.0	0.0	8469.9	-16.9	1.5998289	4.72	1E-10
14	9100.00	91.66	270.15	100	8444.0	892.8	2.3	-892.8	892.8	270.2	0.0	0.0	8469.9	-16.9	1.5998289	4.72	1E-10
15	9200.00	91.66	270.15	100	8441.1	992.7	2.6	-992.7	992.7	270.2	0.0	0.0	8469.9	-16.9	1.5998289	4.72	1E-10
16	9300.00	91.66	270.15	100	8438.1	1092.7	2.9	-1092.7	1092.7	270.2	0.0	0.0	8469.9	-16.9	1.5998289	4.72	1E-10
17	9400.00	91.66	270.15	100	8435.2	1192.7	3.1	-1192.7	1192.7	270.2	0.0	0.0	8469.9	-16.9	1.5998289	4.72	1E-10
18	9500.00	91.66	270.15	100	8432.3	1292.6	3.4	-1292.6	1292.6	270.2	0.0	0.0	8469.9	-16.9	1.5998289	4.72	1E-10
19	9600.00	91.66	270.15	100	8429.4	1392.6	3.7	-1392.6	1392.6	270.2	0.0	0.0	8469.9	-16.9	1.5998289	4.72	1E-10
20	9700.00	91.66	270.15	100	8426.5	1492.5	3.9	-1492.5	1492.5	270.2	0.0	0.0	8469.9	-16.9	1.5998289	4.72	1E-10
21	9800.00	91.66	270.15	100	8423.6	1592.5	4.2	-1592.5	1592.5	270.2	0.0	0.0	8469.9	-16.9	1.5998289	4.72	1E-10
22	9900.00	91.66	270.15	100	8420.7	1692.4	4.4	-1692.4	1692.4	270.2	0.0	0.0	8469.9	-16.9	1.5998289	4.72	1E-10
23	10000.00	91.66	270.15	100	8417.8	1792.4	4.7	-1792.4	1792.4	270.2	0.0	0.0	8469.9	-16.9	1.5998289	4.72	1E-10
24	10100.00	91.66	270.15	100	8414.9	1892.4	5.0	-1892.4	1892.4	270.2	0.0	0.0	8469.9	-16.9	1.5998289	4.72	1E-10
25	10200.00	91.66	270.15	100	8412.0	1992.3	5.2	-1992.3	1992.3	270.2	0.0	0.0	8469.9	-16.9	1.5998289	4.72	1E-10
26	10300.00	91.66	270.15	100	8409.1	2092.3	5.5	-2092.3	2092.3	270.2	0.0	0.0	8469.9	-16.9	1.5998289	4.72	1E-10
27	10400.00	91.66	270.15	100	8406.2	2192.2	5.8	-2192.2	2192.2	270.2	0.0	0.0	8469.9	-16.9	1.5998289	4.72	1E-10
28	10500.00	91.66	270.15	100	8403.3	2292.2	6.0	-2292.2	2292.2	270.2	0.0	0.0	8469.9	-16.9	1.5998289	4.72	1E-10
29	10600.00	91.66	270.15	100	8400.4	2392.2	6.3	-2392.2	2392.2	270.2	0.0	0.0	8469.9	-16.9	1.5998289	4.72	1E-10
30	10700.00	91.66	270.15	100	8397.5	2492.1	6.5	-2492.1	2492.1	270.2	0.0	0.0	8469.9	-16.9	1.5998289	4.72	1E-10
31	10800.00	91.66	270.15	100	8394.6	2592.1	6.8	-2592.1	2592.1	270.2	0.0	0.0	8469.9	-16.9	1.5998289	4.72	1E-10
32	10900.00	91.66	270.15	100	8391.7	2692.0	7.1	-2692.0	2692.0	270.2	0.0	0.0	8469.9	-16.9	1.5998289	4.72	1E-10
33	11000.00	91.66	270.15	100	8388.8	2792.0	7.3	-2792.0	2792.0	270.2	0.0	0.0	8469.9	-16.9	1.5998289	4.72	1E-10
34	11100.00	91.66	270.15	100	8385.9	2891.9	7.6	-2891.9	2891.9	270.2	0.0	0.0	8469.9	-16.9	1.5998289	4.72	1E-10
35	11200.00	91.66	270.15	100	8383.0	2991.9	7.9	-2991.9	2991.9	270.2	0.0	0.0	8469.9	-16.9	1.5998289	4.72	1E-10
36	11300.00	91.66	270.15	100	8380.1	3091.9	8.1	-3091.8	3091.9	270.2	0.0	0.0	8469.9	-16.9	1.5998289	4.72	1E-10
37	11400.00	91.66	270.15	100	8377.2	3191.8	8.4	-3191.8	3191.8	270.2	0.0	0.0	8469.9	-16.9	1.5998289	4.72	1E-10
38	11500.00	91.66	270.15	100	8374.3	3291.8	8.6	-3291.8	3291.8	270.2	0.0	0.0	8469.9	-16.9	1.5998289	4.72	1E-10
39	11600.00	91.66	270.15	100	8371.4	3391.7	8.9	-3391.7	3391.7	270.2	0.0	0.0	8469.9	-16.9	1.5998289	4.72	1E-10
40	11700.00	91.66	270.15	100	8368.5	3491.7	9.2	-3491.7	3491.7	270.2	0.0	0.0	8469.9	-16.9	1.5998289	4.72	1E-10
41	11800.00	91.66	270.15	100	8365.6	3591.6	9.4	-3591.6	3591.6	270.2	0.0	0.0	8469.9	-16.9	1.5998289	4.72	1E-10
42	11900.00	91.66	270.15	100	8362.7	3691.6	9.7	-3691.6	3691.6	270.2	0.0	0.0	8469.9	-16.9	1.5998289	4.72	1E-10
43	12000.00	91.66	270.15	100	8359.8	3791.6	10.0	-3791.6	3791.6	270.2	0.0	0.0	8469.9	-16.9	1.5998289	4.72	1E-10
44	12100.00	91.66	270.15	100	8356.9	3891.5	10.2	-3891.5	3891.5	270.2	0.0	0.0	8469.9	-16.9	1.5998289	4.72	1E-10
45	12200.00	91.66	270.15	100	8354.0	3991.5	10.5	-3991.5	3991.5	270.2	0.0	0.0	8469.9	-16.9	1.5998289	4.72	1E-10
46	12300.00	91.66	270.15	100	8351.1	4091.4	10.7	-4091.4	4091.4	270.2	0.0	0.0	8469.9	-16.9	1.5998289	4.72	1E-10
47	12400.00	91.66	270.15	100	8348.2	4191.4	11.0	-4191.4	4191.4	270.2	0.0	0.0	8469.9	-16.9	1.5998289	4.72	1E-10
48	12500.00	91.66	270.15	100	8345.3	4291.4	11.3	-4291.3	4291.4	270.2	0.0	0.0	8469.9	-16.9	1.5998289	4.72	1E-10
49	12600.00	91.66	270.15	100	8342.4	4391.3	11.5	-4391.3	4391.3	270.2	0.0	0.0	8469.9	-16.9	1.5998289	4.72	1E-10
50	12700.00	91.66	270.15	100	8339.5	4491.3	11.8	-4491.3	4491.3	270.2	0.0	0.0	8469.9	-16.9	1.5998289	4.72	1E-10
51	12800.00	91.66	270.15	100	8336.6	4591.2	12.1	-4591.2	4591.2	270.2	0.0	0.0	8469.9	-16.9	1.5998289	4.72	1E-10
52	12900.00	91.66	270.15	100	8333.6	4691.2	12.3	-4691.2	4691.2	270.2	0.0	0.0	8469.9	-16.9	1.5998289	4.72	1E-10
53	13000.00	91.66	270.15	100	8330.7	4791.1	12.6	-4791.1	4791.1	270.2	0.0	0.0	8469.9	-16.9	1.5998289	4.72	1E-10
54	13100.00	91.66	270.15	100	8327.8	4891.1	12.8	-4891.1	4891.1	270.2	0.0	0.0	8469.9	-16.9	1.5998289	4.72	1E-10
55	13200.00	91.66	270.15	100	8324.9	4991.1	13.1	-4991.0	4991.1	270.2	0.0	0.0	8469.9	-16.9	1.5998289	4.72	1E-10
56	13300.00	91.66	270.15	100	8322.0	5091.0	13.4	-5091.0	5091.0	270.2	0.0	0.0	8469.9	-16.9	1.		

57	13400.00	91.66	270.15	100	8319.1	5191.0	13.6	-5191.0	5191.0	270.2	0.0	0.0	8469.9	-16.9	1.5998289	4.72	1E-10
58	13500.00	91.66	270.15	100	8316.2	5290.9	13.9	-5290.9	5290.9	270.2	0.0	0.0	8469.9	-16.9	1.5998289	4.72	1E-10
59	13600.00	91.66	270.15	100	8313.3	5390.9	14.2	-5390.9	5390.9	270.2	0.0	0.0	8469.9	-16.9	1.5998289	4.72	1E-10
60	13700.00	91.66	270.15	100	8310.4	5490.8	14.4	-5490.8	5490.8	270.2	0.0	0.0	8469.9	-16.9	1.5998289	4.72	1E-10
61	13800.00	91.66	270.15	100	8307.5	5590.8	14.7	-5590.8	5590.8	270.2	0.0	0.0	8469.9	-16.9	1.5998289	4.72	1E-10
62	13900.00	91.66	270.15	100	8304.6	5690.8	14.9	-5690.7	5690.8	270.2	0.0	0.0	8469.9	-16.9	1.5998289	4.72	1E-10
63	14000.00	91.66	270.15	100	8301.7	5790.7	15.2	-5790.7	5790.7	270.2	0.0	0.0	8469.9	-16.9	1.5998289	4.72	1E-10
64	14100.00	91.66	270.15	100	8298.8	5890.7	15.5	-5890.7	5890.7	270.2	0.0	0.0	8469.9	-16.9	1.5998289	4.72	1E-10
65	14200.00	91.66	270.15	100	8295.9	5990.6	15.7	-5990.6	5990.6	270.2	0.0	0.0	8469.9	-16.9	1.5998289	4.72	1E-10
66	14300.00	91.66	270.15	100	8293.0	6090.6	16.0	-6090.6	6090.6	270.2	0.0	0.0	8469.9	-16.9	1.5998289	4.72	1E-10
67	14400.00	91.66	270.15	100	8290.1	6190.6	16.3	-6190.5	6190.6	270.2	0.0	0.0	8469.9	-16.9	1.5998289	4.72	1E-10
68	14500.00	91.66	270.15	100	8287.2	6290.5	16.5	-6290.5	6290.5	270.2	0.0	0.0	8469.9	-16.9	1.5998289	4.72	1E-10
69	14600.00	91.66	270.15	100	8284.3	6390.5	16.8	-6390.4	6390.5	270.2	0.0	0.0	8469.9	-16.9	1.5998289	4.72	1E-10
70	14700.00	91.66	270.15	100	8281.4	6490.4	17.0	-6490.4	6490.4	270.2	0.0	0.0	8469.9	-16.9	1.5998289	4.72	1E-10
71	14800.00	91.66	270.15	100	8278.5	6590.4	17.3	-6590.4	6590.4	270.2	0.0	0.0	8469.9	-16.9	1.5998289	4.72	1E-10
72	14900.00	91.66	270.15	100	8275.6	6690.3	17.6	-6690.3	6690.3	270.2	0.0	0.0	8469.9	-16.9	1.5998289	4.72	1E-10
73	15000.00	91.66	270.15	100	8272.7	6790.3	17.8	-6790.3	6790.3	270.2	0.0	0.0	8469.9	-16.9	1.5998289	4.72	1E-10
74	15100.00	91.66	270.15	100	8269.8	6890.3	18.1	-6890.2	6890.3	270.2	0.0	0.0	8469.9	-16.9	1.5998289	4.72	1E-10
75	15200.00	91.66	270.15	100	8266.9	6990.2	18.4	-6990.2	6990.2	270.2	0.0	0.0	8469.9	-16.9	1.5998289	4.72	1E-10
76	15300.00	91.66	270.15	100	8264.0	7090.2	18.6	-7090.1	7090.2	270.2	0.0	0.0	8469.9	-16.9	1.5998289	4.72	1E-10
77	15400.00	91.66	270.15	100	8261.1	7190.1	18.9	-7190.1	7190.1	270.2	0.0	0.0	8469.9	-16.9	1.5998289	4.72	1E-10
78	15500.00	91.66	270.15	100	8258.2	7290.1	19.1	-7290.1	7290.1	270.2	0.0	0.0	8469.9	-16.9	1.5998289	4.72	1E-10
79	15600.00	91.66	270.15	100	8255.3	7390.0	19.4	-7390.0	7390.0	270.2	0.0	0.0	8469.9	-16.9	1.5998289	4.72	1E-10
80	15700.00	91.66	270.15	100	8252.4	7490.0	19.7	-7490.0	7490.0	270.2	0.0	0.0	8469.9	-16.9	1.5998289	4.72	1E-10
81	15800.00	91.66	270.15	100	8249.5	7590.0	19.9	-7589.9	7590.0	270.2	0.0	0.0	8469.9	-16.9	1.5998289	4.72	1E-10
82	15900.00	91.66	270.15	100	8246.6	7689.9	20.2	-7689.9	7689.9	270.2	0.0	0.0	8469.9	-16.9	1.5998289	4.72	1E-10
83	16000.00	91.66	270.15	100	8243.7	7789.9	20.5	-7789.9	7789.9	270.2	0.0	0.0	8469.9	-16.9	1.5998289	4.72	1E-10
84	16100.00	91.66	270.15	100	8240.8	7889.8	20.7	-7889.8	7889.8	270.2	0.0	0.0	8469.9	-16.9	1.5998289	4.72	1E-10
85	16200.00	91.66	270.15	100	8237.9	7989.8	21.0	-7989.8	7989.8	270.2	0.0	0.0	8469.9	-16.9	1.5998289	4.72	1E-10
86	16300.00	91.66	270.15	100	8234.9	8089.8	21.2	-8089.7	8089.8	270.2	0.0	0.0	8469.9	-16.9	1.5998289	4.72	1E-10
87	16400.00	91.66	270.15	100	8232.0	8189.7	21.5	-8189.7	8189.7	270.2	0.0	0.0	8469.9	-16.9	1.5998289	4.72	1E-10
88	16500.00	91.66	270.15	100	8229.1	8289.7	21.8	-8289.6	8289.7	270.2	0.0	0.0	8469.9	-16.9	1.5998289	4.72	1E-10
89	16600.00	91.66	270.15	100	8226.2	8389.6	22.0	-8389.6	8389.6	270.2	0.0	0.0	8469.9	-16.9	1.5998289	4.72	1E-10
90	16700.00	91.66	270.15	100	8223.3	8489.6	22.3	-8489.6	8489.6	270.2	0.0	0.0	8469.9	-16.9	1.5998289	4.72	1E-10
91	16800.00	91.66	270.15	100	8220.4	8589.5	22.6	-8589.5	8589.5	270.2	0.0	0.0	8469.9	-16.9	1.5998289	4.72	1E-10
92	16900.00	91.66	270.15	100	8217.5	8689.5	22.8	-8689.5	8689.5	270.2	0.0	0.0	8469.9	-16.9	1.5998289	4.72	1E-10
93	17000.00	91.66	270.15	100	8214.6	8789.5	23.1	-8789.4	8789.5	270.2	0.0	0.0	8469.9	-16.9	1.5998289	4.72	1E-10
94	17100.00	91.66	270.15	100	8211.7	8889.4	23.3	-8889.4	8889.4	270.2	0.0	0.0	8469.9	-16.9	1.5998289	4.72	1E-10
95	17200.00	91.66	270.15	100	8208.8	8989.4	23.6	-8989.3	8989.4	270.2	0.0	0.0	8469.9	-16.9	1.5998289	4.72	1E-10
96	17300.00	91.66	270.15	100	8205.9	9089.3	23.9	-9089.3	9089.3	270.2	0.0	0.0	8469.9	-16.9	1.5998289	4.72	1E-10
97	17400.00	91.66	270.15	100	8203.0	9189.3	24.1	-9189.3	9189.3	270.2	0.0	0.0	8469.9	-16.9	1.5998289	4.72	1E-10
98	17500.00	91.66	270.15	100	8200.1	9289.2	24.4	-9289.2	9289.2	270.2	0.0	0.0	8469.9	-16.9	1.5998289	4.72	1E-10
99	17600.00	91.66	270.15	100	8197.2	9389.2	24.7	-9389.2	9389.2	270.2	0.0	0.0	8469.9	-16.9	1.5998289	4.72	1E-10
100	17700.00	91.66	270.15	100	8194.3	9489.2	24.9	-9489.1	9489.2	270.2	0.0	0.0	8469.9	-16.9	1.5998289	4.72	1E-10
101	17800.00	91.66	270.15	100	8191.4	9589.1	25.2	-9589.1	9589.1	270.2	0.0	0.0	8469.9	-16.9	1.5998289	4.72	1E-10
102	17900.00	91.66	270.15	100	8188.5	9689.1	25.4	-9689.0	9689.1	270.2	0.0	0.0	8469.9	-16.9	1.5998289	4.72	1E-10
103	18000.00	91.66	270.15	100	8185.6	9789.0	25.7	-9789.0	9789.0	270.2	0.0	0.0	8469.9	-16.9	1.5998289	4.72	1E-10
104	18100.00	91.66	270.15	100	8182.7	9889.0	26.0	-9889.0	9889.0	270.2	0.0	0.0	8469.9	-16.9	1.5998289	4.72	1E-10
105	18200.00	91.66	270.15	100	8179.8	9989.0	26.2	-9988.9	9989.0	270.2	0.0	0.0	8469.9	-16.9	1.5998289	4.72	1E-10
106	18300.00	91.66	270.15	100	8176.9	10088.9	26.5	-10088.9	10088.9	270.2	0.0	0.0	8469.9	-16.9	1.5998289	4.72	1E-10
107	18400.00	91.66	270.15	100	8174.0	10188.9	26.8	-10188.8	10188.9	270.2	0.0	0.0	8469.9	-16.9	1.5998289	4.72	1E-10
108	18456.12	91.66	270.15	56.122	8172.4	10245.0	26.9	-10244.9	10245.0	270.2	0.0	0.0	8469.9	-16.9	1.5998289	4.72	1E-10
109	18456.12	91.66	270.15	0	8172.4	10245.0	26.9	-10244.9	10245.0	270.2	#####	#####	8469.9	-16.9	1.5998289	4.72	1E-10

### Mewbourne Oil Company

#### SURVEY CALCULATION REPORT Minimum Curvature Calculations

Operator: Mewbourne Oil Company  
Lease Name: Cripple Creek 35/34 Federal 711H  
KOP 8137.04  
SL: 1960 FNL & 205 FEL; Sec 35/20S/27E  
PBHL: 660 FNL & 100 FWL; Sec 34/20S/27E

Target KBTVD: 8,710 Feet 8710.00  
Target Angle: 91.62 Degrees 91.62  
Section Plane: 277.37 Degrees  
Declination Corrected to True North: 6.63 Degrees  
Bit to Survey Offset: 44 Feet

Survey No.	Measured Depth-ft	Drift (Deg.)	Azimuth (Deg.)	Course Length	TVD (Feet)	Vertical Section	+N/-S (Feet)	+E/-W (Feet)	Closure Distance	Closure Direction	BUR	DLS	KBTVD	+Above			
														-Below Target	DRIFT (RADIANS)	AZIMUTH (RADIANS)	
T/I	8137.04	0.00	277.37	N/A	8137.0	0.0	0.0	0.0	0.0	0.0	N/A	N/A	8137.0	573.0	1E-12	4.84	#VALUE!
1	8228.66	9.16	277.37	91.619	8228.3	7.3	0.9	-7.2	7.3	277.4	10.0	10.0	8228.5	481.5	0.1599051	4.84	0.1599051
2	8320.28	18.32	277.37	91.619	8317.2	29.1	3.7	-28.8	29.1	277.4	10.0	10.0	8318.0	392.0	0.3198102	4.84	0.1599051
3	8411.90	27.49	277.37	91.619	8401.5	64.7	8.3	-64.1	64.7	277.4	10.0	10.0	8403.3	306.7	0.4797153	4.84	0.1599051
4	8503.52	36.65	277.37	91.619	8479.0	113.3	14.5	-112.3	113.3	277.4	10.0	10.0	8482.2	227.8	0.6396203	4.84	0.1599051
5	8595.14	45.81	277.37	91.619	8547.9	173.6	22.3	-172.1	173.6	277.4	10.0	10.0	8552.8	157.2	0.7995254	4.84	0.1599051
6	8686.76	54.97	277.37	91.619	8606.2	244.1	31.3	-242.1	244.1	277.4	10.0	10.0	8613.1	96.9	0.9594305	4.84	0.1599051
7	8778.37	64.13	277.37	91.619	8652.6	323.0	41.5	-320.3	323.0	277.4	10.0	10.0	8661.7	48.3	1.1193356	4.84	0.1599051
8	8869.99	73.30	277.37	91.619	8685.8	408.3	52.4	-404.9	408.3	277.4	10.0	10.0	8697.4	12.6	1.2792407	4.84	0.1599051
9	8961.61	82.46	277.37	91.619	8705.0	497.7	63.9	-493.6	497.7	277.4	10.0	10.0	8719.1	-9.1	1.4391458	4.84	0.1599051
10	9053.23	91.62	277.37	91.619	8709.8	589.1	75.6	-584.3	589.1	277.4	10.0	10.0	8726.4	-16.4	1.5990509	4.84	0.1599051
11	9100.00	91.62	277.37	46.769	8708.5	635.9	81.6	-630.6	635.9	277.4	0.0	0.0	8726.4	-16.4	1.5990509	4.84	1E-10
12	9200.00	91.62	277.37	100	8705.6	735.9	94.4	-729.8	735.9	277.4	0.0	0.0	8726.4	-16.4	1.5990509	4.84	1E-10
13	9300.00	91.62	277.37	100	8702.8	835.8	107.3	-828.9	835.8	277.4	0.0	0.0	8726.4	-16.4	1.5990509	4.84	1E-10
14	9400.00	91.62	277.37	100	8700.0	935.8	120.1	-928.0	935.8	277.4	0.0	0.0	8726.4	-16.4	1.5990509	4.84	1E-10
15	9500.00	91.62	277.37	100	8697.1	1035.7	132.9	-1027.2	1035.7	277.4	0.0	0.0	8726.4	-16.4	1.5990509	4.84	1E-10
16	9600.00	91.62	277.37	100	8694.3	1135.7	145.8	-1126.3	1135.7	277.4	0.0	0.0	8726.4	-16.4	1.5990509	4.84	1E-10
17	9700.00	91.62	277.37	100	8691.5	1235.7	158.6	-1225.4	1235.7	277.4	0.0	0.0	8726.4	-16.4	1.5990509	4.84	1E-10
18	9800.00	91.62	277.37	100	8688.7	1335.6	171.4	-1324.6	1335.6	277.4	0.0	0.0	8726.4	-16.4	1.5990509	4.84	1E-10
19	9900.00	91.62	277.37	100	8685.8	1435.6	184.2	-1423.7	1435.6	277.4	0.0	0.0	8726.4	-16.4	1.5990509	4.84	1E-10
20	10000.00	91.62	277.37	100	8683.0	1535.5	197.1	-1522.8	1535.5	277.4	0.0	0.0	8726.4	-16.4	1.5990509	4.84	1E-10
21	10100.00	91.62	277.37	100	8680.2	1635.5	209.9	-1622.0	1635.5	277.4	0.0	0.0	8726.4	-16.4	1.5990509	4.84	1E-10
22	10200.00	91.62	277.37	100	8677.4	1735.5	222.7	-1721.1	1735.5	277.4	0.0	0.0	8726.4	-16.4	1.5990509	4.84	1E-10
23	10300.00	91.62	277.37	100	8674.5	1835.4	235.6	-1820.2	1835.4	277.4	0.0	0.0	8726.4	-16.4	1.5990509	4.84	1E-10
24	10400.00	91.62	277.37	100	8671.7	1935.4	248.4	-1919.4	1935.4	277.4	0.0	0.0	8726.4	-16.4	1.5990509	4.84	1E-10
25	10500.00	91.62	277.37	100	8668.9	2035.3	261.2	-2018.5	2035.3	277.4	0.0	0.0	8726.4	-16.4	1.5990509	4.84	1E-10
26	10600.00	91.62	277.37	100	8666.1	2135.3	274.0	-2117.6	2135.3	277.4	0.0	0.0	8726.4	-16.4	1.5990509	4.84	1E-10
27	10700.00	91.62	277.37	100	8663.2	2235.3	286.9	-2216.8	2235.3	277.4	0.0	0.0	8726.4	-16.4	1.5990509	4.84	1E-10
28	10800.00	91.62	277.37	100	8660.4	2335.2	299.7	-2315.9	2335.2	277.4	0.0	0.0	8726.4	-16.4	1.5990509	4.84	1E-10
29	10900.00	91.62	277.37	100	8657.6	2435.2	312.5	-2415.0	2435.2	277.4	0.0	0.0	8726.4	-16.4	1.5990509	4.84	1E-10
30	11000.00	91.62	277.37	100	8654.8	2535.1	325.4	-2514.2	2535.1	277.4	0.0	0.0	8726.4	-16.4	1.5990509	4.84	1E-10
31	11100.00	91.62	277.37	100	8651.9	2635.1	338.2	-2613.3	2635.1	277.4	0.0	0.0	8726.4	-16.4	1.5990509	4.84	1E-10
32	11200.00	91.62	277.37	100	8649.1	2735.1	351.0	-2712.4	2735.1	277.4	0.0	0.0	8726.4	-16.4	1.5990509	4.84	1E-10
33	11300.00	91.62	277.37	100	8646.3	2835.0	363.8	-2811.6	2835.0	277.4	0.0	0.0	8726.4	-16.4	1.5990509	4.84	1E-10
34	11400.00	91.62	277.37	100	8643.5	2935.0	376.7	-2910.7	2935.0	277.4	0.0	0.0	8726.4	-16.4	1.5990509	4.84	1E-10
35	11500.00	91.62	277.37	100	8640.6	3034.9	389.5	-3009.8	3034.9	277.4	0.0	0.0	8726.4	-16.4	1.5990509	4.84	1E-10
36	11600.00	91.62	277.37	100	8637.8	3134.9	402.3	-3109.0	3134.9	277.4	0.0	0.0	8726.4	-16.4	1.5990509	4.84	1E-10
37	11700.00	91.62	277.37	100	8635.0	3234.9	415.2	-3208.1	3234.9	277.4	0.0	0.0	8726.4	-16.4	1.5990509	4.84	1E-10
38	11800.00	91.62	277.37	100	8632.2	3334.8	428.0	-3307.2	3334.8	277.4	0.0	0.0	8726.4	-16.4	1.5990509	4.84	1E-10
39	11900.00	91.62	277.37	100	8629.3	3434.8	440.8	-3406.4	3434.8	277.4	0.0	0.0	8726.4	-16.4	1.5990509	4.84	1E-10
40	12000.00	91.62	277.37	100	8626.5	3534.7	453.6	-3505.5	3534.7	277.4	0.0	0.0	8726.4	-16.4	1.5990509	4.84	1E-10
41	12100.00	91.62	277.37	100	8623.7	3634.7	466.5	-3604.6	3634.7	277.4	0.0	0.0	8726.4	-16.4	1.5990509	4.84	1E-10
42	12200.00	91.62	277.37	100	8620.9	3734.7	479.3	-3703.8	3734.7	277.4	0.0	0.0	8726.4	-16.4	1.5990509	4.84	1E-10
43	12300.00	91.62	277.37	100	8618.0	3834.6	492.1	-3802.9	3834.6	277.4	0.0	0.0	8726.4	-16.4	1.5990509	4.84	1E-10
44	12400.00	91.62	277.37	100	8615.2	3934.6	505.0	-3902.0	3934.6	277.4	0.0	0.0	8726.4	-16.4	1.5990509	4.84	1E-10
45	12500.00	91.62	277.37	100	8612.4	4034.5	517.8	-4001.2	4034.5	277.4	0.0	0.0	8726.4	-16.4	1.5990509	4.84	1E-10
46	12600.00	91.62	277.37	100	8609.6	4134.5	530.6	-4100.3	4134.5	277.4	0.0	0.0	8726.4	-16.4	1.5990509	4.84	1E-10
47	12700.00	91.62	277.37	100	8606.7	4234.5	543.4	-4199.4	4234.5	277.4	0.0	0.0	8726.4	-16.4	1.5990509	4.84	1E-10
48	12800.00	91.62	277.37	100	8603.9	4334.4	556.3	-4298.6	4334.4	277.4	0.0	0.0	8726.4	-16.4	1.5990509	4.84	1E-10
49	12900.00	91.62	277.37	100	8601.1	4434.4	569.1	-4397.7	4434.4	277.4	0.0	0.0	8726.4	-16.4	1.5990509	4.84	1E-10
50	13000.00	91.62	277.37	100	8598.3	4534.3	581.9	-4496.8	4534.3	277.4	0.0	0.0	8726.4	-16.4	1.5990509	4.84	1E-10
51	13100.00	91.62	277.37	100	8595.4	4634.3	594.8	-4596.0	4634.3	277.4	0.0	0.0	8726.4	-16.4	1.5990509	4.84	1E-10
52	13200.00	91.62	277.37	100	8592.6	4734.3	607.6	-4695.1	4734.3	277.4	0.0	0.0	8726.4	-16.4	1.5990509	4.84	1E-10
53	13300.00	91.62	277.37	100	8589.8	4834.2	620.4	-4794.2	4834.2	277.4	0.0	0.0	8726.4	-16.4	1.5990509	4.84	1E-10
54	13400.00	91.62	277.37	100	8587.0	4934.2	633.2	-4893.4	4934.2	277.4	0.0	0.0	8726.4	-16.4	1.5990509	4.84	1E-10
55	13500.00	91.62	277.37	100	8584.1	5034.1	646.1	-4992.5	5034.1	277.4	0.0	0.0	8726.4	-16.4	1.5990509	4.84	1E-10
56	13600.00	91.62	277.37	100	8581.3	5134.1	65										

57	13700.00	91.62	277.37	100	8578.5	5234.1	671.7	-5190.8	5234.1	277.4	0.0	0.0	8726.4	-16.4	1.5990509	4.84	1E-10
58	13800.00	91.62	277.37	100	8575.7	5334.0	684.6	-5289.9	5334.0	277.4	0.0	0.0	8726.4	-16.4	1.5990509	4.84	1E-10
59	13900.00	91.62	277.37	100	8572.8	5434.0	697.4	-5389.0	5434.0	277.4	0.0	0.0	8726.4	-16.4	1.5990509	4.84	1E-10
60	14000.00	91.62	277.37	100	8570.0	5533.9	710.2	-5488.2	5533.9	277.4	0.0	0.0	8726.4	-16.4	1.5990509	4.84	1E-10
61	14100.00	91.62	277.37	100	8567.2	5633.9	723.1	-5587.3	5633.9	277.4	0.0	0.0	8726.4	-16.4	1.5990509	4.84	1E-10
62	14200.00	91.62	277.37	100	8564.4	5733.9	735.9	-5686.4	5733.9	277.4	0.0	0.0	8726.4	-16.4	1.5990509	4.84	1E-10
63	14300.00	91.62	277.37	100	8561.5	5833.8	748.7	-5785.6	5833.8	277.4	0.0	0.0	8726.4	-16.4	1.5990509	4.84	1E-10
64	14400.00	91.62	277.37	100	8558.7	5933.8	761.5	-5884.7	5933.8	277.4	0.0	0.0	8726.4	-16.4	1.5990509	4.84	1E-10
65	14500.00	91.62	277.37	100	8555.9	6033.7	774.4	-5983.8	6033.7	277.4	0.0	0.0	8726.4	-16.4	1.5990509	4.84	1E-10
66	14600.00	91.62	277.37	100	8553.1	6133.7	787.2	-6083.0	6133.7	277.4	0.0	0.0	8726.4	-16.4	1.5990509	4.84	1E-10
67	14700.00	91.62	277.37	100	8550.2	6233.7	800.0	-6182.1	6233.7	277.4	0.0	0.0	8726.4	-16.4	1.5990509	4.84	1E-10
68	14800.00	91.62	277.37	100	8547.4	6333.6	812.9	-6281.2	6333.6	277.4	0.0	0.0	8726.4	-16.4	1.5990509	4.84	1E-10
69	14900.00	91.62	277.37	100	8544.6	6433.6	825.7	-6380.4	6433.6	277.4	0.0	0.0	8726.4	-16.4	1.5990509	4.84	1E-10
70	15000.00	91.62	277.37	100	8541.8	6533.5	838.5	-6479.5	6533.5	277.4	0.0	0.0	8726.4	-16.4	1.5990509	4.84	1E-10
71	15100.00	91.62	277.37	100	8538.9	6633.5	851.3	-6578.6	6633.5	277.4	0.0	0.0	8726.4	-16.4	1.5990509	4.84	1E-10
72	15200.00	91.62	277.37	100	8536.1	6733.5	864.2	-6677.8	6733.5	277.4	0.0	0.0	8726.4	-16.4	1.5990509	4.84	1E-10
73	15300.00	91.62	277.37	100	8533.3	6833.4	877.0	-6776.9	6833.4	277.4	0.0	0.0	8726.4	-16.4	1.5990509	4.84	1E-10
74	15400.00	91.62	277.37	100	8530.5	6933.4	889.8	-6876.0	6933.4	277.4	0.0	0.0	8726.4	-16.4	1.5990509	4.84	1E-10
75	15500.00	91.62	277.37	100	8527.6	7033.3	902.7	-6975.2	7033.3	277.4	0.0	0.0	8726.4	-16.4	1.5990509	4.84	1E-10
76	15600.00	91.62	277.37	100	8524.8	7133.3	915.5	-7074.3	7133.3	277.4	0.0	0.0	8726.4	-16.4	1.5990509	4.84	1E-10
77	15700.00	91.62	277.37	100	8522.0	7233.3	928.3	-7173.4	7233.3	277.4	0.0	0.0	8726.4	-16.4	1.5990509	4.84	1E-10
78	15800.00	91.62	277.37	100	8519.2	7333.2	941.1	-7272.6	7333.2	277.4	0.0	0.0	8726.4	-16.4	1.5990509	4.84	1E-10
79	15900.00	91.62	277.37	100	8516.3	7433.2	954.0	-7371.7	7433.2	277.4	0.0	0.0	8726.4	-16.4	1.5990509	4.84	1E-10
80	16000.00	91.62	277.37	100	8513.5	7533.1	966.8	-7470.8	7533.1	277.4	0.0	0.0	8726.4	-16.4	1.5990509	4.84	1E-10
81	16100.00	91.62	277.37	100	8510.7	7633.1	979.6	-7570.0	7633.1	277.4	0.0	0.0	8726.4	-16.4	1.5990509	4.84	1E-10
82	16200.00	91.62	277.37	100	8507.9	7733.1	992.5	-7669.1	7733.1	277.4	0.0	0.0	8726.4	-16.4	1.5990509	4.84	1E-10
83	16300.00	91.62	277.37	100	8505.0	7833.0	1005.3	-7768.2	7833.0	277.4	0.0	0.0	8726.4	-16.4	1.5990509	4.84	1E-10
84	16400.00	91.62	277.37	100	8502.2	7933.0	1018.1	-7867.4	7933.0	277.4	0.0	0.0	8726.4	-16.4	1.5990509	4.84	1E-10
85	16500.00	91.62	277.37	100	8499.4	8032.9	1030.9	-7966.5	8032.9	277.4	0.0	0.0	8726.4	-16.4	1.5990509	4.84	1E-10
86	16600.00	91.62	277.37	100	8496.6	8132.9	1043.8	-8065.6	8132.9	277.4	0.0	0.0	8726.4	-16.4	1.5990509	4.84	1E-10
87	16700.00	91.62	277.37	100	8493.7	8232.9	1056.6	-8164.8	8232.9	277.4	0.0	0.0	8726.4	-16.4	1.5990509	4.84	1E-10
88	16800.00	91.62	277.37	100	8490.9	8332.8	1069.4	-8263.9	8332.8	277.4	0.0	0.0	8726.4	-16.4	1.5990509	4.84	1E-10
89	16900.00	91.62	277.37	100	8488.1	8432.8	1082.3	-8363.0	8432.8	277.4	0.0	0.0	8726.4	-16.4	1.5990509	4.84	1E-10
90	17000.00	91.62	277.37	100	8485.3	8532.7	1095.1	-8462.2	8532.7	277.4	0.0	0.0	8726.4	-16.4	1.5990509	4.84	1E-10
91	17100.00	91.62	277.37	100	8482.4	8632.7	1107.9	-8561.3	8632.7	277.4	0.0	0.0	8726.4	-16.4	1.5990509	4.84	1E-10
92	17200.00	91.62	277.37	100	8479.6	8732.7	1120.7	-8660.4	8732.7	277.4	0.0	0.0	8726.4	-16.4	1.5990509	4.84	1E-10
93	17300.00	91.62	277.37	100	8476.8	8832.6	1133.6	-8759.6	8832.6	277.4	0.0	0.0	8726.4	-16.4	1.5990509	4.84	1E-10
94	17400.00	91.62	277.37	100	8474.0	8932.6	1146.4	-8858.7	8932.6	277.4	0.0	0.0	8726.4	-16.4	1.5990509	4.84	1E-10
95	17500.00	91.62	277.37	100	8471.1	9032.5	1159.2	-8957.8	9032.5	277.4	0.0	0.0	8726.4	-16.4	1.5990509	4.84	1E-10
96	17600.00	91.62	277.37	100	8468.3	9132.5	1172.1	-9057.0	9132.5	277.4	0.0	0.0	8726.4	-16.4	1.5990509	4.84	1E-10
97	17700.00	91.62	277.37	100	8465.5	9232.5	1184.9	-9156.1	9232.5	277.4	0.0	0.0	8726.4	-16.4	1.5990509	4.84	1E-10
98	17800.00	91.62	277.37	100	8462.7	9332.4	1197.7	-9255.2	9332.4	277.4	0.0	0.0	8726.4	-16.4	1.5990509	4.84	1E-10
99	17900.00	91.62	277.37	100	8459.8	9432.4	1210.5	-9354.4	9432.4	277.4	0.0	0.0	8726.4	-16.4	1.5990509	4.84	1E-10
100	18000.00	91.62	277.37	100	8457.0	9532.3	1223.4	-9453.5	9532.3	277.4	0.0	0.0	8726.4	-16.4	1.5990509	4.84	1E-10
101	18100.00	91.62	277.37	100	8454.2	9632.3	1236.2	-9552.6	9632.3	277.4	0.0	0.0	8726.4	-16.4	1.5990509	4.84	1E-10
102	18200.00	91.62	277.37	100	8451.4	9732.3	1249.0	-9651.8	9732.3	277.4	0.0	0.0	8726.4	-16.4	1.5990509	4.84	1E-10
103	18300.00	91.62	277.37	100	8448.5	9832.2	1261.9	-9750.9	9832.2	277.4	0.0	0.0	8726.4	-16.4	1.5990509	4.84	1E-10
104	18400.00	91.62	277.37	100	8445.7	9932.2	1274.7	-9850.0	9932.2	277.4	0.0	0.0	8726.4	-16.4	1.5990509	4.84	1E-10
105	18500.00	91.62	277.37	100	8442.9	10032.1	1287.5	-9949.2	10032.1	277.4	0.0	0.0	8726.4	-16.4	1.5990509	4.84	1E-10
106	18600.00	91.62	277.37	100	8440.1	10132.1	1300.3	-10048.3	10132.1	277.4	0.0	0.0	8726.4	-16.4	1.5990509	4.84	1E-10
107	18700.00	91.62	277.37	100	8437.2	10232.1	1313.2	-10147.4	10232.1	277.4	0.0	0.0	8726.4	-16.4	1.5990509	4.84	1E-10
108	18800.00	91.62	277.37	100	8434.4	10332.0	1326.0	-10246.6	10332.0	277.4	0.0	0.0	8726.4	-16.4	1.5990509	4.84	1E-10
109	18802.78	91.62	277.37	2.7841	8434.3	10334.8	1326.4	-10249.3	10334.8	277.4	0.0	0.0	8726.4	-16.4	1.5990509	4.84	1E-10
110	18802.78	91.62	277.37	0	8434.3	10334.8	1326.4	-10249.3	10334.8	277.4	#####	#####	8726.4	-16.4	1.5990509	4.84	1E-10

Mewbourne Oil Company

SURVEY CALCULATION REPORT  
Minimum Curvature Calculations

Operator: Mewbourne Oil Company  
Lease Name: Cripple Creek 35/34 Federal 716H  
KOP 8074.04  
SL: 1820 FSL & 205 FEL; Sec 35/20S/27E  
PBHL: 1980 FSL & 100 FWL; Sec 34/20S/27E

Target KBTVD: 8,647 Feet 8647.00  
Target Angle: 91.40 Degrees 91.40  
Section Plane: 271.25 Degrees  
Declination Corrected to True North: 6.63 Degrees  
Bit to Survey Offset: 44 Feet

Table with columns: Survey No., Measured Depth-ft, Drift (Deg.), Azimuth (Deg.), Course Length, TVD (Feet), Vertical Section, +N/-S (Feet), +E/-W (Feet), Closure Distance, Closure Direction, BUR, DLS, KBTVD, +Above -Below Target (RADIAN), DRIFT (RADIAN), AZIMUTH (RADIAN). Rows 1-56.



57	13600.00	91.40	271.25	100	8534.3	5197.5	113.4	-5196.3	5197.5	271.2	0.0	0.0	8661.2	-14.2	1.5951994	4.73	1E-10
58	13700.00	91.40	271.25	100	8531.9	5297.5	115.5	-5296.3	5297.5	271.2	0.0	0.0	8661.2	-14.2	1.5951994	4.73	1E-10
59	13800.00	91.40	271.25	100	8529.4	5397.5	117.7	-5396.2	5397.5	271.2	0.0	0.0	8661.2	-14.2	1.5951994	4.73	1E-10
60	13900.00	91.40	271.25	100	8527.0	5497.5	119.9	-5496.1	5497.5	271.2	0.0	0.0	8661.2	-14.2	1.5951994	4.73	1E-10
61	14000.00	91.40	271.25	100	8524.5	5597.4	122.1	-5596.1	5597.4	271.2	0.0	0.0	8661.2	-14.2	1.5951994	4.73	1E-10
62	14100.00	91.40	271.25	100	8522.1	5697.4	124.3	-5696.0	5697.4	271.2	0.0	0.0	8661.2	-14.2	1.5951994	4.73	1E-10
63	14200.00	91.40	271.25	100	8519.7	5797.4	126.4	-5796.0	5797.4	271.2	0.0	0.0	8661.2	-14.2	1.5951994	4.73	1E-10
64	14300.00	91.40	271.25	100	8517.2	5897.3	128.6	-5895.9	5897.3	271.2	0.0	0.0	8661.2	-14.2	1.5951994	4.73	1E-10
65	14400.00	91.40	271.25	100	8514.8	5997.3	130.8	-5995.9	5997.3	271.2	0.0	0.0	8661.2	-14.2	1.5951994	4.73	1E-10
66	14500.00	91.40	271.25	100	8512.3	6097.3	133.0	-6095.8	6097.3	271.2	0.0	0.0	8661.2	-14.2	1.5951994	4.73	1E-10
67	14600.00	91.40	271.25	100	8509.9	6197.2	135.2	-6195.8	6197.2	271.2	0.0	0.0	8661.2	-14.2	1.5951994	4.73	1E-10
68	14700.00	91.40	271.25	100	8507.5	6297.2	137.4	-6295.7	6297.2	271.2	0.0	0.0	8661.2	-14.2	1.5951994	4.73	1E-10
69	14800.00	91.40	271.25	100	8505.0	6397.2	139.5	-6395.7	6397.2	271.2	0.0	0.0	8661.2	-14.2	1.5951994	4.73	1E-10
70	14900.00	91.40	271.25	100	8502.6	6497.2	141.7	-6495.6	6497.2	271.2	0.0	0.0	8661.2	-14.2	1.5951994	4.73	1E-10
71	15000.00	91.40	271.25	100	8500.1	6597.1	143.9	-6595.6	6597.1	271.2	0.0	0.0	8661.2	-14.2	1.5951994	4.73	1E-10
72	15100.00	91.40	271.25	100	8497.7	6697.1	146.1	-6695.5	6697.1	271.2	0.0	0.0	8661.2	-14.2	1.5951994	4.73	1E-10
73	15200.00	91.40	271.25	100	8495.3	6797.1	148.3	-6795.4	6797.1	271.2	0.0	0.0	8661.2	-14.2	1.5951994	4.73	1E-10
74	15300.00	91.40	271.25	100	8492.8	6897.0	150.4	-6895.4	6897.0	271.2	0.0	0.0	8661.2	-14.2	1.5951994	4.73	1E-10
75	15400.00	91.40	271.25	100	8490.4	6997.0	152.6	-6995.3	6997.0	271.2	0.0	0.0	8661.2	-14.2	1.5951994	4.73	1E-10
76	15500.00	91.40	271.25	100	8487.9	7097.0	154.8	-7095.3	7097.0	271.2	0.0	0.0	8661.2	-14.2	1.5951994	4.73	1E-10
77	15600.00	91.40	271.25	100	8485.5	7196.9	157.0	-7195.2	7196.9	271.2	0.0	0.0	8661.2	-14.2	1.5951994	4.73	1E-10
78	15700.00	91.40	271.25	100	8483.1	7296.9	159.2	-7295.2	7296.9	271.2	0.0	0.0	8661.2	-14.2	1.5951994	4.73	1E-10
79	15800.00	91.40	271.25	100	8480.6	7396.9	161.3	-7395.1	7396.9	271.2	0.0	0.0	8661.2	-14.2	1.5951994	4.73	1E-10
80	15900.00	91.40	271.25	100	8478.2	7496.9	163.5	-7495.1	7496.9	271.2	0.0	0.0	8661.2	-14.2	1.5951994	4.73	1E-10
81	16000.00	91.40	271.25	100	8475.7	7596.8	165.7	-7595.0	7596.8	271.2	0.0	0.0	8661.2	-14.2	1.5951994	4.73	1E-10
82	16100.00	91.40	271.25	100	8473.3	7696.8	167.9	-7695.0	7696.8	271.2	0.0	0.0	8661.2	-14.2	1.5951994	4.73	1E-10
83	16200.00	91.40	271.25	100	8470.9	7796.8	170.1	-7794.9	7796.8	271.2	0.0	0.0	8661.2	-14.2	1.5951994	4.73	1E-10
84	16300.00	91.40	271.25	100	8468.4	7896.7	172.2	-7894.9	7896.7	271.2	0.0	0.0	8661.2	-14.2	1.5951994	4.73	1E-10
85	16400.00	91.40	271.25	100	8466.0	7996.7	174.4	-7994.8	7996.7	271.2	0.0	0.0	8661.2	-14.2	1.5951994	4.73	1E-10
86	16500.00	91.40	271.25	100	8463.5	8096.7	176.6	-8094.8	8096.7	271.2	0.0	0.0	8661.2	-14.2	1.5951994	4.73	1E-10
87	16600.00	91.40	271.25	100	8461.1	8196.6	178.8	-8194.7	8196.6	271.2	0.0	0.0	8661.2	-14.2	1.5951994	4.73	1E-10
88	16700.00	91.40	271.25	100	8458.7	8296.6	181.0	-8294.6	8296.6	271.2	0.0	0.0	8661.2	-14.2	1.5951994	4.73	1E-10
89	16800.00	91.40	271.25	100	8456.2	8396.6	183.1	-8394.6	8396.6	271.2	0.0	0.0	8661.2	-14.2	1.5951994	4.73	1E-10
90	16900.00	91.40	271.25	100	8453.8	8496.6	185.3	-8494.5	8496.6	271.2	0.0	0.0	8661.2	-14.2	1.5951994	4.73	1E-10
91	17000.00	91.40	271.25	100	8451.3	8596.5	187.5	-8594.5	8596.5	271.2	0.0	0.0	8661.2	-14.2	1.5951994	4.73	1E-10
92	17100.00	91.40	271.25	100	8448.9	8696.5	189.7	-8694.4	8696.5	271.2	0.0	0.0	8661.2	-14.2	1.5951994	4.73	1E-10
93	17200.00	91.40	271.25	100	8446.5	8796.5	191.9	-8794.4	8796.5	271.2	0.0	0.0	8661.2	-14.2	1.5951994	4.73	1E-10
94	17300.00	91.40	271.25	100	8444.0	8896.4	194.0	-8894.3	8896.4	271.2	0.0	0.0	8661.2	-14.2	1.5951994	4.73	1E-10
95	17400.00	91.40	271.25	100	8441.6	8996.4	196.2	-8994.3	8996.4	271.2	0.0	0.0	8661.2	-14.2	1.5951994	4.73	1E-10
96	17500.00	91.40	271.25	100	8439.1	9096.4	198.4	-9094.2	9096.4	271.2	0.0	0.0	8661.2	-14.2	1.5951994	4.73	1E-10
97	17600.00	91.40	271.25	100	8436.7	9196.4	200.6	-9194.2	9196.4	271.2	0.0	0.0	8661.2	-14.2	1.5951994	4.73	1E-10
98	17700.00	91.40	271.25	100	8434.3	9296.3	202.8	-9294.1	9296.3	271.2	0.0	0.0	8661.2	-14.2	1.5951994	4.73	1E-10
99	17800.00	91.40	271.25	100	8431.8	9396.3	204.9	-9394.1	9396.3	271.2	0.0	0.0	8661.2	-14.2	1.5951994	4.73	1E-10
100	17900.00	91.40	271.25	100	8429.4	9496.3	207.1	-9494.0	9496.3	271.2	0.0	0.0	8661.2	-14.2	1.5951994	4.73	1E-10
101	18000.00	91.40	271.25	100	8426.9	9596.2	209.3	-9593.9	9596.2	271.2	0.0	0.0	8661.2	-14.2	1.5951994	4.73	1E-10
102	18100.00	91.40	271.25	100	8424.5	9696.2	211.5	-9693.9	9696.2	271.2	0.0	0.0	8661.2	-14.2	1.5951994	4.73	1E-10
103	18200.00	91.40	271.25	100	8422.1	9796.2	213.7	-9793.8	9796.2	271.2	0.0	0.0	8661.2	-14.2	1.5951994	4.73	1E-10
104	18300.00	91.40	271.25	100	8419.6	9896.1	215.8	-9893.8	9896.1	271.2	0.0	0.0	8661.2	-14.2	1.5951994	4.73	1E-10
105	18400.00	91.40	271.25	100	8417.2	9996.1	218.0	-9993.7	9996.1	271.2	0.0	0.0	8661.2	-14.2	1.5951994	4.73	1E-10
106	18500.00	91.40	271.25	100	8414.7	10096.1	220.2	-10093.7	10096.1	271.2	0.0	0.0	8661.2	-14.2	1.5951994	4.73	1E-10
107	18600.00	91.40	271.25	100	8412.3	10196.1	222.4	-10193.6	10196.1	271.2	0.0	0.0	8661.2	-14.2	1.5951994	4.73	1E-10
108	18643.02	91.40	271.25	43.0223	8411.2	10239.1	223.3	-10236.6	10239.1	271.2	0.0	0.0	8661.2	-14.2	1.5951994	4.73	1E-10
109	18643.02	91.40	271.25	0	8411.2	10239.1	223.3	-10236.6	10239.1	271.2	#####	#####	8661.2	-14.2	1.5951994	4.73	1E-10

# Mewbourne Oil Company

## SURVEY CALCULATION REPORT Minimum Curvature Calculations

Operator: Mewbourne Oil Company  
 Lease Name: Cripple Creek 35/34 Federal 618H  
 KOP 7849.04  
 SL: 1800 FSL & 205 FEL; Sec 35/20S/27E  
 PBHL: 660 FSL & 100 FWL; Sec 34/20S/27E

Target KBTVD: 8,422 Feet 8422.00  
 Target Angle: 91.66 Degrees 91.66  
 Section Plane: 263.99 Degrees  
 Declination Corrected to True North: 6.63 Degrees  
 Bit to Survey Offset: 44 Feet

Survey No.	Measured Depth-ft	Drift (Deg.)	Azimuth (Deg.)	Course Length	TVD (Feet)	Vertical Section	+N/-S (Feet)	+E/-W (Feet)	Closure Distance	Closure Direction	BUR	DLS	KBTVD	+Above			
														-Below Target	DRIFT (RADIANS)	AZIMUTH (RADIANS)	
T/I	7849.04	0.00	263.99	N/A	7849.0	0.0	0.0	0.0	0.0	0.0	N/A	N/A	7849.0	573.0	1E-12	4.61	#VALUE!
1	7940.70	9.17	263.99	91.656	7940.3	7.3	-0.8	-7.3	7.3	264.0	10.0	10.0	7940.5	481.5	0.1599702	4.61	0.1599702
2	8032.35	18.33	263.99	91.656	8029.2	29.1	-3.0	-28.9	29.1	264.0	10.0	10.0	8030.1	391.9	0.3199404	4.61	0.1599702
3	8124.01	27.50	263.99	91.656	8113.6	64.7	-6.8	-64.4	64.7	264.0	10.0	10.0	8115.4	306.6	0.4799106	4.61	0.1599702
4	8215.67	36.66	263.99	91.656	8191.2	113.4	-11.9	-112.7	113.4	264.0	10.0	10.0	8194.4	227.6	0.6398808	4.61	0.1599702
5	8307.32	45.83	263.99	91.656	8260.0	173.7	-18.2	-172.8	173.7	264.0	10.0	10.0	8265.0	157.0	0.799851	4.61	0.1599702
6	8398.98	54.99	263.99	91.656	8318.3	244.3	-25.6	-242.9	244.3	264.0	10.0	10.0	8325.4	96.6	0.9598212	4.61	0.1599702
7	8490.64	64.16	263.99	91.656	8364.7	323.2	-33.8	-321.4	323.2	264.0	10.0	10.0	8374.1	47.9	1.1197915	4.61	0.1599702
8	8582.29	73.32	263.99	91.656	8397.9	408.6	-42.8	-406.3	408.6	264.0	10.0	10.0	8409.7	12.3	1.2797617	4.61	0.1599702
9	8673.95	82.49	263.99	91.656	8417.1	498.1	-52.1	-495.3	498.1	264.0	10.0	10.0	8431.5	-9.5	1.4397319	4.61	0.1599702
10	8765.60	91.66	263.99	91.656	8421.8	589.5	-61.7	-586.3	589.5	264.0	10.0	10.0	8438.8	-16.8	1.5997021	4.61	0.1599702
11	8800.00	91.66	263.99	34.396	8420.8	623.9	-65.3	-620.5	623.9	264.0	0.0	0.0	8438.8	-16.8	1.5997021	4.61	1E-10
12	8900.00	91.66	263.99	100	8417.9	723.9	-75.7	-719.9	723.9	264.0	0.0	0.0	8438.8	-16.8	1.5997021	4.61	1E-10
13	9000.00	91.66	263.99	100	8415.0	823.8	-86.2	-819.3	823.8	264.0	0.0	0.0	8438.8	-16.8	1.5997021	4.61	1E-10
14	9100.00	91.66	263.99	100	8412.1	923.8	-96.7	-918.7	923.8	264.0	0.0	0.0	8438.8	-16.8	1.5997021	4.61	1E-10
15	9200.00	91.66	263.99	100	8409.2	1023.7	-107.1	-1018.1	1023.7	264.0	0.0	0.0	8438.8	-16.8	1.5997021	4.61	1E-10
16	9300.00	91.66	263.99	100	8406.3	1123.7	-117.6	-1117.5	1123.7	264.0	0.0	0.0	8438.8	-16.8	1.5997021	4.61	1E-10
17	9400.00	91.66	263.99	100	8403.4	1223.6	-128.0	-1216.9	1223.6	264.0	0.0	0.0	8438.8	-16.8	1.5997021	4.61	1E-10
18	9500.00	91.66	263.99	100	8400.5	1323.6	-138.5	-1316.3	1323.6	264.0	0.0	0.0	8438.8	-16.8	1.5997021	4.61	1E-10
19	9600.00	91.66	263.99	100	8397.6	1423.6	-149.0	-1415.7	1423.6	264.0	0.0	0.0	8438.8	-16.8	1.5997021	4.61	1E-10
20	9700.00	91.66	263.99	100	8394.8	1523.5	-159.4	-1515.2	1523.5	264.0	0.0	0.0	8438.8	-16.8	1.5997021	4.61	1E-10
21	9800.00	91.66	263.99	100	8391.9	1623.5	-169.9	-1614.6	1623.5	264.0	0.0	0.0	8438.8	-16.8	1.5997021	4.61	1E-10
22	9900.00	91.66	263.99	100	8389.0	1723.4	-180.3	-1714.0	1723.4	264.0	0.0	0.0	8438.8	-16.8	1.5997021	4.61	1E-10
23	10000.00	91.66	263.99	100	8386.1	1823.4	-190.8	-1813.4	1823.4	264.0	0.0	0.0	8438.8	-16.8	1.5997021	4.61	1E-10
24	10100.00	91.66	263.99	100	8383.2	1923.4	-201.3	-1912.8	1923.4	264.0	0.0	0.0	8438.8	-16.8	1.5997021	4.61	1E-10
25	10200.00	91.66	263.99	100	8380.3	2023.3	-211.7	-2012.2	2023.3	264.0	0.0	0.0	8438.8	-16.8	1.5997021	4.61	1E-10
26	10300.00	91.66	263.99	100	8377.4	2123.3	-222.2	-2111.6	2123.3	264.0	0.0	0.0	8438.8	-16.8	1.5997021	4.61	1E-10
27	10400.00	91.66	263.99	100	8374.5	2223.2	-232.6	-2211.0	2223.2	264.0	0.0	0.0	8438.8	-16.8	1.5997021	4.61	1E-10
28	10500.00	91.66	263.99	100	8371.6	2323.2	-243.1	-2310.4	2323.2	264.0	0.0	0.0	8438.8	-16.8	1.5997021	4.61	1E-10
29	10600.00	91.66	263.99	100	8368.7	2423.1	-253.6	-2409.8	2423.1	264.0	0.0	0.0	8438.8	-16.8	1.5997021	4.61	1E-10
30	10700.00	91.66	263.99	100	8365.9	2523.1	-264.0	-2509.3	2523.1	264.0	0.0	0.0	8438.8	-16.8	1.5997021	4.61	1E-10
31	10800.00	91.66	263.99	100	8363.0	2623.1	-274.5	-2608.7	2623.1	264.0	0.0	0.0	8438.8	-16.8	1.5997021	4.61	1E-10
32	10900.00	91.66	263.99	100	8360.1	2723.0	-284.9	-2708.1	2723.0	264.0	0.0	0.0	8438.8	-16.8	1.5997021	4.61	1E-10
33	11000.00	91.66	263.99	100	8357.2	2823.0	-295.4	-2807.5	2823.0	264.0	0.0	0.0	8438.8	-16.8	1.5997021	4.61	1E-10
34	11100.00	91.66	263.99	100	8354.3	2922.9	-305.9	-2906.9	2922.9	264.0	0.0	0.0	8438.8	-16.8	1.5997021	4.61	1E-10
35	11200.00	91.66	263.99	100	8351.4	3022.9	-316.3	-3006.3	3022.9	264.0	0.0	0.0	8438.8	-16.8	1.5997021	4.61	1E-10
36	11300.00	91.66	263.99	100	8348.5	3122.9	-326.8	-3105.7	3122.9	264.0	0.0	0.0	8438.8	-16.8	1.5997021	4.61	1E-10
37	11400.00	91.66	263.99	100	8345.6	3222.8	-337.2	-3205.1	3222.8	264.0	0.0	0.0	8438.8	-16.8	1.5997021	4.61	1E-10
38	11500.00	91.66	263.99	100	8342.7	3322.8	-347.7	-3304.5	3322.8	264.0	0.0	0.0	8438.8	-16.8	1.5997021	4.61	1E-10
39	11600.00	91.66	263.99	100	8339.8	3422.7	-358.2	-3403.9	3422.7	264.0	0.0	0.0	8438.8	-16.8	1.5997021	4.61	1E-10
40	11700.00	91.66	263.99	100	8337.0	3522.7	-368.6	-3503.3	3522.7	264.0	0.0	0.0	8438.8	-16.8	1.5997021	4.61	1E-10
41	11800.00	91.66	263.99	100	8334.1	3622.6	-379.1	-3602.8	3622.6	264.0	0.0	0.0	8438.8	-16.8	1.5997021	4.61	1E-10
42	11900.00	91.66	263.99	100	8331.2	3722.6	-389.5	-3702.2	3722.6	264.0	0.0	0.0	8438.8	-16.8	1.5997021	4.61	1E-10
43	12000.00	91.66	263.99	100	8328.3	3822.6	-400.0	-3801.6	3822.6	264.0	0.0	0.0	8438.8	-16.8	1.5997021	4.61	1E-10
44	12100.00	91.66	263.99	100	8325.4	3922.5	-410.5	-3901.0	3922.5	264.0	0.0	0.0	8438.8	-16.8	1.5997021	4.61	1E-10
45	12200.00	91.66	263.99	100	8322.5	4022.5	-420.9	-4000.4	4022.5	264.0	0.0	0.0	8438.8	-16.8	1.5997021	4.61	1E-10
46	12300.00	91.66	263.99	100	8319.6	4122.4	-431.4	-4099.8	4122.4	264.0	0.0	0.0	8438.8	-16.8	1.5997021	4.61	1E-10
47	12400.00	91.66	263.99	100	8316.7	4222.4	-441.8	-4199.2	4222.4	264.0	0.0	0.0	8438.8	-16.8	1.5997021	4.61	1E-10
48	12500.00	91.66	263.99	100	8313.8	4322.4	-452.3	-4298.6	4322.4	264.0	0.0	0.0	8438.8	-16.8	1.5997021	4.61	1E-10
49	12600.00	91.66	263.99	100	8310.9	4422.3	-462.8	-4398.0	4422.3	264.0	0.0	0.0	8438.8	-16.8	1.5997021	4.61	1E-10
50	12700.00	91.66	263.99	100	8308.0	4522.3	-473.2	-4497.4	4522.3	264.0	0.0	0.0	8438.8	-16.8	1.5997021	4.61	1E-10
51	12800.00	91.66	263.99	100	8305.2	4622.2	-483.7	-4596.9	4622.2	264.0	0.0	0.0	8438.8	-16.8	1.5997021	4.61	1E-10
52	12900.00	91.66	263.99	100	8302.3	4722.2	-494.1	-4696.3	4722.2	264.0	0.0	0.0	8438.8	-16.8	1.5997021	4.61	1E-10
53	13000.00	91.66	263.99	100	8299.4	4822.1	-504.6	-4795.7	4822.1	264.0	0.0	0.0	8438.8	-16.8	1.5997021	4.61	1E-10
54	13100.00	91.66	263.99	100	8296.5	4922.1	-515.1	-4895.1	4922.1	264.0	0.0	0.0	8438.8	-16.8	1.5997021	4.61	1E-10
55	13200.00	91.66	263.99	100	8293.6	5022.1	-525.5	-4994.5	5022.1	264.0	0.0	0.0	8438.8	-16.8	1.5997021	4.61	1E-10
56	13300.00	91.66	263.99	100	8290.7	5122.											

57	13400.00	91.66	263.99	100	8287.8	5222.0	-546.4	-5193.3	5222.0	264.0	0.0	0.0	8438.8	-16.8	1.5997021	4.61	1E-10
58	13500.00	91.66	263.99	100	8284.9	5321.9	-556.9	-5292.7	5321.9	264.0	0.0	0.0	8438.8	-16.8	1.5997021	4.61	1E-10
59	13600.00	91.66	263.99	100	8282.0	5421.9	-567.4	-5392.1	5421.9	264.0	0.0	0.0	8438.8	-16.8	1.5997021	4.61	1E-10
60	13700.00	91.66	263.99	100	8279.1	5521.9	-577.8	-5491.5	5521.9	264.0	0.0	0.0	8438.8	-16.8	1.5997021	4.61	1E-10
61	13800.00	91.66	263.99	100	8276.3	5621.8	-588.3	-5590.9	5621.8	264.0	0.0	0.0	8438.8	-16.8	1.5997021	4.61	1E-10
62	13900.00	91.66	263.99	100	8273.4	5721.8	-598.7	-5690.4	5721.8	264.0	0.0	0.0	8438.8	-16.8	1.5997021	4.61	1E-10
63	14000.00	91.66	263.99	100	8270.5	5821.7	-609.2	-5789.8	5821.7	264.0	0.0	0.0	8438.8	-16.8	1.5997021	4.61	1E-10
64	14100.00	91.66	263.99	100	8267.6	5921.7	-619.6	-5889.2	5921.7	264.0	0.0	0.0	8438.8	-16.8	1.5997021	4.61	1E-10
65	14200.00	91.66	263.99	100	8264.7	6021.6	-630.1	-5988.6	6021.6	264.0	0.0	0.0	8438.8	-16.8	1.5997021	4.61	1E-10
66	14300.00	91.66	263.99	100	8261.8	6121.6	-640.6	-6088.0	6121.6	264.0	0.0	0.0	8438.8	-16.8	1.5997021	4.61	1E-10
67	14400.00	91.66	263.99	100	8258.9	6221.6	-651.0	-6187.4	6221.6	264.0	0.0	0.0	8438.8	-16.8	1.5997021	4.61	1E-10
68	14500.00	91.66	263.99	100	8256.0	6321.5	-661.5	-6286.8	6321.5	264.0	0.0	0.0	8438.8	-16.8	1.5997021	4.61	1E-10
69	14600.00	91.66	263.99	100	8253.1	6421.5	-671.9	-6386.2	6421.5	264.0	0.0	0.0	8438.8	-16.8	1.5997021	4.61	1E-10
70	14700.00	91.66	263.99	100	8250.2	6521.4	-682.4	-6485.6	6521.4	264.0	0.0	0.0	8438.8	-16.8	1.5997021	4.61	1E-10
71	14800.00	91.66	263.99	100	8247.4	6621.4	-692.9	-6585.0	6621.4	264.0	0.0	0.0	8438.8	-16.8	1.5997021	4.61	1E-10
72	14900.00	91.66	263.99	100	8244.5	6721.4	-703.3	-6684.5	6721.4	264.0	0.0	0.0	8438.8	-16.8	1.5997021	4.61	1E-10
73	15000.00	91.66	263.99	100	8241.6	6821.3	-713.8	-6783.9	6821.3	264.0	0.0	0.0	8438.8	-16.8	1.5997021	4.61	1E-10
74	15100.00	91.66	263.99	100	8238.7	6921.3	-724.2	-6883.3	6921.3	264.0	0.0	0.0	8438.8	-16.8	1.5997021	4.61	1E-10
75	15200.00	91.66	263.99	100	8235.8	7021.2	-734.7	-6982.7	7021.2	264.0	0.0	0.0	8438.8	-16.8	1.5997021	4.61	1E-10
76	15300.00	91.66	263.99	100	8232.9	7121.2	-745.2	-7082.1	7121.2	264.0	0.0	0.0	8438.8	-16.8	1.5997021	4.61	1E-10
77	15400.00	91.66	263.99	100	8230.0	7221.1	-755.6	-7181.5	7221.1	264.0	0.0	0.0	8438.8	-16.8	1.5997021	4.61	1E-10
78	15500.00	91.66	263.99	100	8227.1	7321.1	-766.1	-7280.9	7321.1	264.0	0.0	0.0	8438.8	-16.8	1.5997021	4.61	1E-10
79	15600.00	91.66	263.99	100	8224.2	7421.1	-776.5	-7380.3	7421.1	264.0	0.0	0.0	8438.8	-16.8	1.5997021	4.61	1E-10
80	15700.00	91.66	263.99	100	8221.3	7521.0	-787.0	-7479.7	7521.0	264.0	0.0	0.0	8438.8	-16.8	1.5997021	4.61	1E-10
81	15800.00	91.66	263.99	100	8218.5	7621.0	-797.5	-7579.1	7621.0	264.0	0.0	0.0	8438.8	-16.8	1.5997021	4.61	1E-10
82	15900.00	91.66	263.99	100	8215.6	7720.9	-807.9	-7678.5	7720.9	264.0	0.0	0.0	8438.8	-16.8	1.5997021	4.61	1E-10
83	16000.00	91.66	263.99	100	8212.7	7820.9	-818.4	-7778.0	7820.9	264.0	0.0	0.0	8438.8	-16.8	1.5997021	4.61	1E-10
84	16100.00	91.66	263.99	100	8209.8	7920.8	-828.8	-7877.4	7920.8	264.0	0.0	0.0	8438.8	-16.8	1.5997021	4.61	1E-10
85	16200.00	91.66	263.99	100	8206.9	8020.8	-839.3	-7976.8	8020.8	264.0	0.0	0.0	8438.8	-16.8	1.5997021	4.61	1E-10
86	16300.00	91.66	263.99	100	8204.0	8120.8	-849.8	-8076.2	8120.8	264.0	0.0	0.0	8438.8	-16.8	1.5997021	4.61	1E-10
87	16400.00	91.66	263.99	100	8201.1	8220.7	-860.2	-8175.6	8220.7	264.0	0.0	0.0	8438.8	-16.8	1.5997021	4.61	1E-10
88	16500.00	91.66	263.99	100	8198.2	8320.7	-870.7	-8275.0	8320.7	264.0	0.0	0.0	8438.8	-16.8	1.5997021	4.61	1E-10
89	16600.00	91.66	263.99	100	8195.3	8420.6	-881.1	-8374.4	8420.6	264.0	0.0	0.0	8438.8	-16.8	1.5997021	4.61	1E-10
90	16700.00	91.66	263.99	100	8192.4	8520.6	-891.6	-8473.8	8520.6	264.0	0.0	0.0	8438.8	-16.8	1.5997021	4.61	1E-10
91	16800.00	91.66	263.99	100	8189.6	8620.6	-902.1	-8573.2	8620.6	264.0	0.0	0.0	8438.8	-16.8	1.5997021	4.61	1E-10
92	16900.00	91.66	263.99	100	8186.7	8720.5	-912.5	-8672.6	8720.5	264.0	0.0	0.0	8438.8	-16.8	1.5997021	4.61	1E-10
93	17000.00	91.66	263.99	100	8183.8	8820.5	-923.0	-8772.0	8820.5	264.0	0.0	0.0	8438.8	-16.8	1.5997021	4.61	1E-10
94	17100.00	91.66	263.99	100	8180.9	8920.4	-933.4	-8871.5	8920.4	264.0	0.0	0.0	8438.8	-16.8	1.5997021	4.61	1E-10
95	17200.00	91.66	263.99	100	8178.0	9020.4	-943.9	-8970.9	9020.4	264.0	0.0	0.0	8438.8	-16.8	1.5997021	4.61	1E-10
96	17300.00	91.66	263.99	100	8175.1	9120.3	-954.4	-9070.3	9120.3	264.0	0.0	0.0	8438.8	-16.8	1.5997021	4.61	1E-10
97	17400.00	91.66	263.99	100	8172.2	9220.3	-964.8	-9169.7	9220.3	264.0	0.0	0.0	8438.8	-16.8	1.5997021	4.61	1E-10
98	17500.00	91.66	263.99	100	8169.3	9320.3	-975.3	-9269.1	9320.3	264.0	0.0	0.0	8438.8	-16.8	1.5997021	4.61	1E-10
99	17600.00	91.66	263.99	100	8166.4	9420.2	-985.7	-9368.5	9420.2	264.0	0.0	0.0	8438.8	-16.8	1.5997021	4.61	1E-10
100	17700.00	91.66	263.99	100	8163.5	9520.2	-996.2	-9467.9	9520.2	264.0	0.0	0.0	8438.8	-16.8	1.5997021	4.61	1E-10
101	17800.00	91.66	263.99	100	8160.7	9620.1	-1006.7	-9567.3	9620.1	264.0	0.0	0.0	8438.8	-16.8	1.5997021	4.61	1E-10
102	17900.00	91.66	263.99	100	8157.8	9720.1	-1017.1	-9666.7	9720.1	264.0	0.0	0.0	8438.8	-16.8	1.5997021	4.61	1E-10
103	18000.00	91.66	263.99	100	8154.9	9820.1	-1027.6	-9766.1	9820.1	264.0	0.0	0.0	8438.8	-16.8	1.5997021	4.61	1E-10
104	18100.00	91.66	263.99	100	8152.0	9920.0	-1038.0	-9865.6	9920.0	264.0	0.0	0.0	8438.8	-16.8	1.5997021	4.61	1E-10
105	18200.00	91.66	263.99	100	8149.1	10020.0	-1048.5	-9965.0	10020.0	264.0	0.0	0.0	8438.8	-16.8	1.5997021	4.61	1E-10
106	18300.00	91.66	263.99	100	8146.2	10119.9	-1059.0	-10064.4	10119.9	264.0	0.0	0.0	8438.8	-16.8	1.5997021	4.61	1E-10
107	18400.00	91.66	263.99	100	8143.3	10219.9	-1069.4	-10163.8	10219.9	264.0	0.0	0.0	8438.8	-16.8	1.5997021	4.61	1E-10
108	18467.59	91.66	263.99	67.586	8141.4	10287.4	-1076.5	-10231.0	10287.4	264.0	0.0	0.0	8438.8	-16.8	1.5997021	4.61	1E-10
109	18467.59	91.66	263.99	0	8141.4	10287.4	-1076.5	-10231.0	10287.4	264.0	#####	#####	8438.8	-16.8	1.5997021	4.61	1E-10

**STATE OF NEW MEXICO  
ENERGY, MINERALS AND NATURAL RESOURCES DEPARTMENT  
OIL CONSERVATION DIVISION**

**APPLICATIONS OF MEWBOURNE OIL COMPANY  
FOR COMPULSORY POOLING,  
EDDY COUNTY, NEW MEXICO**

**CASE NOS. 24174 – 24177**

**SELF-AFFIRMED STATEMENT  
OF DANA S. HARDY**

1. I am attorney in fact and authorized representative of Mewbourne Oil Company, the Applicant herein.

2. I am familiar with the Notice Letters attached as **Exhibit C-1** and caused the Notice Letters, along with the Application in this case, to be sent to the parties set out in the chart attached as **Exhibit C-2**.

3. Exhibit C-2 also provides the date each Notice Letter was sent and the date each return was received.

4. Copies of the certified mail green cards and white slips are attached as **Exhibit C-3** as supporting documentation for proof of mailing and the information provided on Exhibit C-2.

5. On February 8, 2024, I caused a notice to be published to all interested parties in the Carlsbad Current Argus. An Affidavit of Publication from the Legal Clerk of the Carlsbad Current Argus, along with a copy of the notice publication, is attached as **Exhibit C-4**.

6. I understand this Self-Affirmed Statement will be used as written testimony in the subject cases. I affirm that my testimony above is true and correct and it made under penalty of perjury under the laws of the State of New Mexico. My testimony is made as of the date handwritten next to my signature below.

/s/ Dana S. Hardy  
Dana S. Hardy

March 05, 2024  
Date

**Mewbourne Oil Company  
Case No. 24177  
Exhibit C**



hinklelawfirm.com

# HINKLE SHANOR LLP

ATTORNEYS AT LAW

P.O. BOX 2068

SANTA FE, NEW MEXICO 87504

505-982-4554 (FAX) 505-982-8623

WRITER:  
Dana S. Hardy, Partner  
dhardy@hinklelawfirm.com

February 5, 2024

**VIA CERTIFIED MAIL**  
**RETURN RECEIPT REQUESTED**

**TO ALL PARTIES ENTITLED TO NOTICE**

**Re: Case Nos. 24174, 24175, 24176, & 24177 – Applications of Mewbourne Oil Company for Compulsory Pooling, Eddy County, New Mexico.**

To whom it may concern:

This letter is to advise you that the enclosed applications were filed with the New Mexico Oil Conservation Division. The hearing will be conducted on **March 7, 2024**, beginning at 8:15 a.m.

The hearing will be conducted in a hybrid fashion, both in-person at the Energy, Minerals, Natural Resources Department, Wendell Chino Building, Pecos Hall, 1220 South St. Francis Drive, 1st Floor, Santa Fe, NM 87505 and via the WebEx virtual meeting platform. To participate virtually, see the instructions posted on the OCD Hearings website: <https://www.emnrd.nm.gov/ocd/hearing-info/>. You are not required to attend this hearing, but as an owner of an interest that may be affected by this application, you may appear and present testimony. Failure to appear at that time and become a party of record will preclude you from challenging the matter at a later date.

Pursuant to Division Rule 19.15.4.13.B, a party who intends to present evidence at the hearing shall file a pre-hearing statement and serve copies on other parties, or the attorneys of parties who are represented by counsel, at least four business days in advance of a scheduled hearing, but in no event later than 5:00 p.m. Mountain Time, on the Thursday preceding the scheduled hearing date. The statement must be submitted through the OCD E-Permitting system (<https://wwwapps.emnrd.nm.gov/ocd/ocdpermitting/>) or via e-mail to [ocd.hearings@emnrd.nm.gov](mailto:ocd.hearings@emnrd.nm.gov) and should include: the names of the parties and their attorneys, a concise statement of the case, the names of all witnesses the party will call to testify at the hearing, the approximate time the party will need to present its case, and identification of any procedural matters that are to be resolved prior to the hearing.

Please contact Ariana Rodrigues, Landman, Mewbourne Oil Company, at (432) 682-3715, or via email at [arodrigues@mewbourne.com](mailto:arodrigues@mewbourne.com), if you have questions regarding these matters.

Sincerely,

/s/ Dana S. Hardy

Dana S. Hardy

**Mewbourne Oil Company**  
**Case No. 24177**  
**Exhibit C-1**

Enclosure

PO BOX 10  
ROSWELL, NEW MEXICO 88202  
(575) 622-6510  
FAX (575) 623-9332

7601 JEFFERSON ST NE - SUITE 180  
ALBUQUERQUE, NEW MEXICO 87109  
505-858-8320  
FAX (505) 858-8321

PO BOX 2068  
SANTA FE, NEW MEXICO 87504  
(505) 982-4554  
FAX (505) 982-8623

**STATE OF NEW MEXICO  
ENERGY, MINERALS AND NATURAL RESOURCES DEPARTMENT  
OIL CONSERVATION DIVISION**

**APPLICATIONS OF MEWBOURNE OIL COMPANY  
FOR COMPULSORY POOLING,  
EDDY COUNTY, NEW MEXICO**

**CASE NOS. 24174 - 24177**

**NOTICE LETTER CHART**

<b>PARTY</b>	<b>NOTICE LETTER SENT</b>	<b>RETURN RECEIVED</b>
EOG Resources Inc. Attn: Brian Pond 5509 Champions Drive Midland, TX 79706	02/05/24	02/14/24
Marathon Oil Permian LLC Attn: Samuel Cox 990 Town and Country Blvd. Houston, TX 77024	02/05/24	02/12/24
Pacer Energy, Ltd. Attn: Dennis Ferstler 12600 Hill Country Blvd, Ste R-270 Austin, TX 78738	02/05/24	02/15/24  No signature.
Sabinal Energy Operating, LLC Attn: Nicole Reeves 1780 Hughes Landing Blvd. The Woodlands, TX 77380	02/05/24	Per USPS Tracking (Last Checked 03/04/24):  02/08/24 – Delivered to individual at the address.
Santo Legado LLC Attn: Nicole Singer 11 Greenway Plaza, Suite 535 Houston, TX 77046	02/05/24	02/21/24

**Mewbourne Oil Company  
Case No. 24177  
Exhibit C-2**

**U.S. Postal Service™**  
**CERTIFIED MAIL® RECEIPT**  
*Domestic Mail Only*

For delivery information, visit our website at [www.usps.com](http://www.usps.com)®.

OFFICIAL USE

Certified Mail Fee \$ _____	Postmark Here  
Extra Services & Fees (check box, add fee as appropriate)	
<input type="checkbox"/> Return Receipt (hardcopy) \$ _____	
<input type="checkbox"/> Return Receipt (electronic) \$ _____	
<input type="checkbox"/> Certified Mail Restricted Delivery \$ _____	
<input type="checkbox"/> Adult Signature Required \$ _____	
<input type="checkbox"/> Adult Signature Restricted Delivery \$ _____	
Postage \$ _____	
Total Postage and Fees \$ _____	
Ser: EOG Resources Inc. Attn: Brian Pond 5509 Champions Drive Midland, TX 79706 24174 - 24177 Mewbourne Cripple Creek	

PS Form 3800, January 2023 PSN 7530-02-000-9047 See Reverse for Instructions

9589 0710 5270 0725 3449 67

SENDER: COMPLETE THIS SECTION	COMPLETE THIS SECTION ON DELIVERY
<ul style="list-style-type: none"> <li>■ Complete items 1, 2, and 3.</li> <li>■ Print your name and address on the reverse so that we can return the card to you.</li> <li>■ Attach this card to the back of the mailpiece, or on the front if space permits.</li> </ul>	<p>A. Signature  <input checked="" type="checkbox"/> <i>[Signature]</i> <span style="float: right;"><input type="checkbox"/> Agent <input type="checkbox"/> Addressee</span></p> <p>B. Received by (Printed Name) <i>[Signature]</i> C. Date of Delivery <i>[Signature]</i></p> <p>D. Is delivery address different from item 1? <input type="checkbox"/> Yes          If YES, enter delivery address below: <input checked="" type="checkbox"/> No</p> <p style="text-align: center; font-size: 2em; font-weight: bold;">RECEIVED</p> <p style="text-align: center; font-size: 1.5em;">FEB 14 2024</p>
<p>1. Article Addressed to:</p> <p style="text-align: center;">EOG Resources Inc.          Attn: Brian Pond          5509 Champions Drive          Midland, TX 79706          24174 - 24177 Mewbourne Cripple Creek</p> <p style="text-align: center;">           9590 9402 8595 3244 3693 74       </p>	<p>3. Service Type</p> <p><input checked="" type="checkbox"/> Adult Signature <i>Hinkle Shanor LLC</i> <input type="checkbox"/> Priority Mail Express®</p> <p><input checked="" type="checkbox"/> Adult Signature <i>Santa Fe NM 87504</i> <input type="checkbox"/> Registered Mail™</p> <p><input type="checkbox"/> Certified Mail® <input type="checkbox"/> Registered Mail Restricted Delivery</p> <p><input type="checkbox"/> Certified Mail Restricted Delivery <input type="checkbox"/> Signature Confirmation™</p> <p><input type="checkbox"/> Collect on Delivery <input type="checkbox"/> Signature Confirmation Restricted Delivery</p> <p><input type="checkbox"/> Collect on Delivery Restricted Delivery</p> <p><input type="checkbox"/> Insured Mail</p> <p><input type="checkbox"/> Insured Mail Restricted Delivery (over \$500)</p>
<p>2. Article Number (Transfer from service label)</p> <p style="font-size: 1.5em; font-weight: bold;">9589 0710 5270 0725 3449 67</p>	
PS Form 3811, July 2020 PSN 7530-02-000-9053 <span style="float: right;">Domestic Return Receipt</span>	

**Mewbourne Oil Company**  
**Case No. 24177**  
**Exhibit C-3**

9589 0710 5270 0725 3449 74

U.S. Postal Service™  
**CERTIFIED MAIL® RECEIPT**  
Domestic Mail Only

For delivery information, visit our website at [www.usps.com](http://www.usps.com)®.

OFFICIAL USE

Certified Mail Fee	\$
Extra Services & Fees (check box, add fee as appropriate)	
<input type="checkbox"/> Return Receipt (hardcopy)	\$
<input type="checkbox"/> Return Receipt (electronic)	\$
<input type="checkbox"/> Certified Mail Restricted Delivery	\$
<input type="checkbox"/> Adult Signature Required	\$
<input type="checkbox"/> Adult Signature Restricted Delivery	\$



Postage	\$
<b>Total Postage and Fees</b>	\$

Send To  
 St Marathon Oil Permian LLC  
 Attn: Samuel Cox  
 990 Town and Country Blvd.  
 Houston, TX 77024  
 Cr 24174 - 24177 Mewbourne Cripple Creek

PS Form 3800, January 2023 PSN 7530-02-000-9047 See Reverse for Instructions

**SENDER: COMPLETE THIS SECTION**

- Complete items 1, 2, and 3.
- Print your name and address on the reverse so that we can return the card to you.
- Attach this card to the back of the mailpiece, or on the front if space permits.

1. Article Addressed to:

Marathon Oil Permian LLC  
 Attn: Samuel Cox  
 990 Town and Country Blvd.  
 Houston, TX 77024  
 24174 - 24177 Mewbourne Cripple Creek



9590 9402 8595 3244 3694 73

2. Article Number (Transfer from service label)

9589 0710 5270 0725 3449 74

PS Form 3811, July 2020 PSN 7530-02-000-9053

**COMPLETE THIS SECTION ON DELIVERY**

A. Signature  Agent  Addressee

B. Received by (Printed Name) \_\_\_\_\_ C. Date of Delivery 2/8/24

D. Is delivery address different from item 1?  Yes  No  
 If YES, enter delivery address below: \_\_\_\_\_

**RECEIVED**

FEB 12 2024

3. Service Type Hinkle Shanor LLC  Priority Mail Express®  
 Adult Signature Santa Fe NM 87501  Registered Mail™  
 Adult Signature Restricted Delivery  Registered Mail Restricted Delivery  
 Certified Mail®  Signature Confirmation™  
 Certified Mail Restricted Delivery  Signature Confirmation Restricted Delivery  
 Collect on Delivery  
 Collect on Delivery Restricted Delivery  
 Insured Mail  
 Insured Mail Restricted Delivery (over \$500)

Domestic Return Receipt



9589 0710 5270 0725 3449 36

**U.S. Postal Service™**  
**CERTIFIED MAIL® RECEIPT**  
*Domestic Mail Only*

For delivery information, visit our website at [www.usps.com](http://www.usps.com)®.

**OFFICIAL USE**

Certified Mail Fee  
 \$ \_\_\_\_\_

Extra Services & Fees (check box, add fee as appropriate)

<input type="checkbox"/> Return Receipt (hardcopy)	\$ _____
<input type="checkbox"/> Return Receipt (electronic)	\$ _____
<input type="checkbox"/> Certified Mail Restricted Delivery	\$ _____
<input type="checkbox"/> Adult Signature Required	\$ _____
<input type="checkbox"/> Adult Signature Restricted Delivery	\$ _____

Postage  
 \$ \_\_\_\_\_

Total Postage and Fees  
 \$ \_\_\_\_\_

Postmark Here

Postmark: SANTA FE NM FEB 15 2024 87501

Service Address:  
 Pacer Energy, Ltd.  
 Attn: Dennis Ferstler  
 12600 Hill Country Blvd, Ste R-270  
 Austin, TX 78738  
 24174 - 24177 Mewbourne Cripple Creek

PS Form 3800, January 2023 PSN 7530-02-000-9047 See Reverse for Instructions

SENDER: COMPLETE THIS SECTION		COMPLETE THIS SECTION ON DELIVERY															
<ul style="list-style-type: none"> <li>Complete items 1, 2, and 3.</li> <li>Print your name and address on the reverse so that we can return the card to you.</li> <li>Attach this card to the back of the mailpiece, or on the front if space permits.</li> </ul>		<p>A. Signature  <b>X</b> <input type="checkbox"/> Agent  <input type="checkbox"/> Addressee</p>															
<p>1. Article Addressed to:</p> <p>Pacer Energy, Ltd.          Attn: Dennis Ferstler          12600 Hill Country Blvd, Ste R-270          Austin, TX 78738          24174 - 24177 Mewbourne Cripple Creek</p>		<p>B. Received by (Printed Name) _____ C. Date of Delivery _____</p>															
<p>2. Article Number (Transfer from service label)  <b>9589 0710 5270 0725 3449 36</b></p>		<p>D. Is delivery address different from item 1? <input type="checkbox"/> Yes          If YES, enter delivery address below: <input type="checkbox"/> No</p> <p><b>RECEIVED</b>          FEB 15 2024</p>															
<p>3. Service Type</p> <table border="0"> <tr><td><input type="checkbox"/> Adult Signature</td><td><input type="checkbox"/> Priority Mail Express®</td></tr> <tr><td><input type="checkbox"/> Adult Signature Restricted Delivery</td><td><input type="checkbox"/> Registered Mail™</td></tr> <tr><td><input type="checkbox"/> Certified Mail®</td><td><input type="checkbox"/> Registered Mail Restricted Delivery</td></tr> <tr><td><input type="checkbox"/> Certified Mail Restricted Delivery</td><td><input type="checkbox"/> Signature Confirmation™</td></tr> <tr><td><input type="checkbox"/> Collect on Delivery</td><td><input type="checkbox"/> Signature Confirmation Restricted Delivery</td></tr> <tr><td><input type="checkbox"/> Collect on Delivery Restricted Delivery</td><td><input type="checkbox"/> Insured Mail</td></tr> <tr><td><input type="checkbox"/> Insured Mail</td><td><input type="checkbox"/> Insured Mail Restricted Delivery (over \$500)</td></tr> </table>		<input type="checkbox"/> Adult Signature	<input type="checkbox"/> Priority Mail Express®	<input type="checkbox"/> Adult Signature Restricted Delivery	<input type="checkbox"/> Registered Mail™	<input type="checkbox"/> Certified Mail®	<input type="checkbox"/> Registered Mail Restricted Delivery	<input type="checkbox"/> Certified Mail Restricted Delivery	<input type="checkbox"/> Signature Confirmation™	<input type="checkbox"/> Collect on Delivery	<input type="checkbox"/> Signature Confirmation Restricted Delivery	<input type="checkbox"/> Collect on Delivery Restricted Delivery	<input type="checkbox"/> Insured Mail	<input type="checkbox"/> Insured Mail	<input type="checkbox"/> Insured Mail Restricted Delivery (over \$500)	<p>Hinkle Shanor          Santa Fe NM 87501</p>	
<input type="checkbox"/> Adult Signature	<input type="checkbox"/> Priority Mail Express®																
<input type="checkbox"/> Adult Signature Restricted Delivery	<input type="checkbox"/> Registered Mail™																
<input type="checkbox"/> Certified Mail®	<input type="checkbox"/> Registered Mail Restricted Delivery																
<input type="checkbox"/> Certified Mail Restricted Delivery	<input type="checkbox"/> Signature Confirmation™																
<input type="checkbox"/> Collect on Delivery	<input type="checkbox"/> Signature Confirmation Restricted Delivery																
<input type="checkbox"/> Collect on Delivery Restricted Delivery	<input type="checkbox"/> Insured Mail																
<input type="checkbox"/> Insured Mail	<input type="checkbox"/> Insured Mail Restricted Delivery (over \$500)																
<p>PS Form 3811, July 2020 PSN 7530-02-000-9053</p>		<p>Domestic Return Receipt</p>															

U.S. Postal Service™  
**CERTIFIED MAIL® RECEIPT**  
Domestic Mail Only

For delivery information, visit our website at [www.usps.com](http://www.usps.com)®.

9589 0710 5270 0725 3448 06

Certified Mail Fee	
\$	
Extra Services & Fees (check box, add fee as appropriate)	
<input type="checkbox"/> Return Receipt (hardcopy)	\$
<input type="checkbox"/> Return Receipt (electronic)	\$
<input type="checkbox"/> Certified Mail Restricted Delivery	\$
<input type="checkbox"/> Adult Signature Required	\$
<input type="checkbox"/> Adult Signature Restricted Delivery	\$
Postage	
\$	
Total Postage and Fees	
\$	
Sent To: Santo Legado LLC	
Attn: Nicole Singer	
11 Greenway Plaza, Suite 535	
Houston, TX 77046	
24174 - 24177 Mewbourne Cripple Creek	

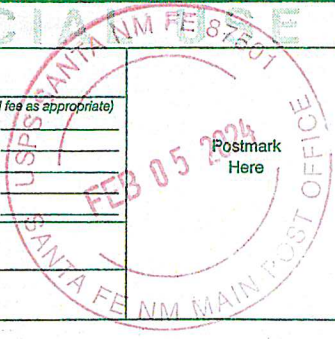

PS Form 3800, January 2023 PSN 7530-02-000-9047 See Reverse for Instructions

SENDER: COMPLETE THIS SECTION		COMPLETE THIS SECTION	
<p>Complete items 1, 2, and 3.</p> <ul style="list-style-type: none"> <li>Print your name and address on the reverse so that we can return the card to you.</li> <li>Attach this card to the back of the mailpiece, or on the front if space permits.</li> </ul>		<p>A. Signature <i>[Signature]</i></p> <p>B. Received by (Print Name) <i>Megan H</i></p> <p>C. Date of delivery FEB 21 2024</p> <p>Hinkle Shanor LLP Santa Fe NM 87504</p>	
<p>1. Article Addressed to:</p> <p>Santo Legado LLC Attn: Nicole Singer 11 Greenway Plaza, Suite 535 Houston, TX 77046 24174 - 24177 Mewbourne Cripple Creek</p>		<p>3. Service Type</p> <ul style="list-style-type: none"> <li><input type="checkbox"/> Adult Signature</li> <li><input type="checkbox"/> Adult Signature Restricted Delivery</li> <li><input type="checkbox"/> Certified Mail®</li> <li><input type="checkbox"/> Certified Mail Restricted Delivery</li> <li><input type="checkbox"/> Collect on Delivery</li> <li><input type="checkbox"/> Collect on Delivery Restricted Delivery</li> <li><input type="checkbox"/> Insured Mail</li> <li><input type="checkbox"/> Insured Mail Restricted Delivery (over \$500)</li> </ul>	
<p>2. Article Number (Transfer from service label)</p> <p>9589 0710 5270 0725 3448 06</p>		<p>PS Form 3811, July 2020 PSN 7530-02-000-9053 Do.</p>	

9589 0710 5270 0725 3449 43

**U.S. Postal Service™**  
**CERTIFIED MAIL® RECEIPT**  
Domestic Mail Only

For delivery information, visit our website at [www.usps.com](http://www.usps.com)®

**OFFICIAL USE**

Certified Mail Fee	\$
Extra Services & Fees (check box, add fee as appropriate)	
<input type="checkbox"/> Return Receipt (hardcopy)	\$
<input type="checkbox"/> Return Receipt (electronic)	\$
<input type="checkbox"/> Certified Mail Restricted Delivery	\$
<input type="checkbox"/> Adult Signature Required	\$
<input type="checkbox"/> Adult Signature Restricted Delivery	\$
Postage	\$
<b>Total Postage and Fees</b>	\$



Sent to	Sabinal Energy Operating, LLC
Street	Attn: Nicole Reeves 1780 Hughes Landing Blvd.
City	The Woodlands, TX 77380 24174 - 24177 Mowbourn Cripple Creek

PS Form 3800, January 2023 PSN 7530-02-000-9047 See Reverse for Instructions

# USPS Tracking®

FAQs >

Tracking Number:

Remove X

## 9589071052700725344943

Copy

Add to Informed Delivery (<https://informedelivery.usps.com/>)

### Latest Update

Your item was delivered to an individual at the address at 10:42 am on February 8, 2024 in SPRING, TX 77380.

Get More Out of USPS Tracking:

USPS Tracking Plus®

Feedback

#### Delivered

Delivered, Left with Individual

SPRING, TX 77380

February 8, 2024, 10:42 am

#### In Transit to Next Facility

February 7, 2024

#### Departed USPS Facility

ALBUQUERQUE, NM 87101

February 6, 2024, 8:34 am

#### Arrived at USPS Facility

ALBUQUERQUE, NM 87101

February 5, 2024, 11:26 pm

Hide Tracking History

[What Do USPS Tracking Statuses Mean? \(https://faq.usps.com/s/article/Where-is-my-package\)](https://faq.usps.com/s/article/Where-is-my-package)

**Text & Email Updates**



**USPS Tracking Plus®**



**Product Information**



**See Less**

Track Another Package

Enter tracking or barcode numbers

## Need More Help?

Contact USPS Tracking support for further assistance.

**FAQs**

# Carlsbad Current Argus.

PART OF THE USA TODAY NETWORK

## Affidavit of Publication

Ad # 0005878879

This is not an invoice

**HINKLE SHANOR, LLP**  
POBOX 2068

**SANTA FE, NM 87504**

I, a legal clerk of the **Carlsbad Current Argus**, a newspaper published daily at the City of Carlsbad, in said county of Eddy, state of New Mexico and of general paid circulation in said county; that the same is a duly qualified newspaper under the laws of the State wherein legal notices and advertisements may be published; that the printed notice attached hereto was published in the regular and entire edition of said newspaper and not in supplement thereof in editions dated as follows:

02/08/2024



Legal Clerk

Subscribed and sworn before me this February 8, 2024:



State of WI, County of Brown  
NOTARY PUBLIC

1-7-25

My commission expires

**KATHLEEN ALLEN**  
Notary Public  
State of Wisconsin

Ad # 0005878879  
PO #:  
# of Affidavits 1

This is not an invoice

This is to notify all interested parties, including EOG Resources Inc.; Marathon Oil Permian LLC; Pacer Energy, Ltd.; Sabinal Energy Operating, LLC; Santo Legado LLC; and their successors and assigns, that the New Mexico Oil Conservation Division will conduct a hearing on an application submitted by Mewbourne Oil Company (Case No. 24177). The hearing will be conducted on March 7, 2024 in a hybrid fashion, both in-person at the Energy, Minerals, Natural Resources Department, Wendell Chino Building, Pecos Hall, 1220 South St. Francis Drive, 1st Floor, Santa Fe, NM 87505 and via the WebEx virtual meeting platform. To participate virtually, see the instructions posted on the OCD Hearings website: <https://www.emnrd.nm.gov/ocd/hearing-info/>. Mewbourne Oil Company ("Applicant") applies for an order pooling all uncommitted interests in the Wolfcamp formation underlying a 320-acre, more or less, standard horizontal spacing unit comprised of the N/2 S/2 of Sections 35 and 34, Township 20 South, Range 27 East, Eddy County, New Mexico ("Unit"). The Unit will be dedicated to the proposed Cripple Creek 35/34 Fed Com #716H well ("Well"), to be drilled from a surface hole location in the NE/4 SE/4 (Unit I) of Section 35 to a bottom hole location in the NW/4 SW/4 (Unit L) of Section 34. The completed interval of the Well will be orthodox. Also to be considered will be the cost of drilling and completing the Well and the allocation of the costs, the designation of Applicant as the operator of the Well, and a 200% charge for the risk involved in drilling and completing the Well. The Well is located approximately 8 miles north of Carlsbad, New Mexico.  
#5878879, Current Argus, February 8, 2024

**Mewbourne Oil Company**  
Case No. 24177  
Exhibit C-4