

CASE NO. 24572

**APPLICATION OF MEWBOURNE OIL COMPANY
FOR COMPULSORY POOLING, EDDY COUNTY, NEW MEXICO**

EXHIBIT LIST

PART I

1. Pooling Checklist
2. Landman's Affidavit
 - 2-A: Plat and C-102
 - 2-B: Tract Maps and Ownership List
 - 2-C: Summary of Communications and Proposal Letters
 - 2-D: AFE

COMPULSORY POOLING APPLICATION CHECKLIST

ALL INFORMATION IN THE APPLICATION MUST BE SUPPORTED BY SIGNED AFFIDAVITS

Case: 24572

Date: June 27, 2024

APPLICANT'S RESPONSE

Applicant

Mewbourne Oil Company

Designated Operator & OGRID (affiliation if applicable)

14744

Applicant's Counsel:

James Bruce

Case Title:

Application of Mewbourne Oil Company for compulsory pooling, Eddy County, New Mexico

EXHIBIT 1

Entries of Appearance/Intervenors:

Well Family

Jericho Wolfcamp Wells

Formation/Pool

Formation Name(s) or Vertical Extent:

Upper Wolfcamp formation

Primary Product (Oil or Gas):

Oil

Pooling this vertical extent:

Upper Wolfcamp formation

Pool Name and Pool Code (Only if NSP is requested):

Well Location Setback Rules (Only if NSP is Requested):

Spacing Unit

Type (Horizontal/Vertical)

Horizontal

Size (Acres)

640 acres

Building Blocks:

40 acres

Orientation:

East-West

Description: TRS/County	N/2S/2 §8 and N/2S/2 §7, Township 20 South, Range 29 East, NMPM, Eddy County
Standard Horizontal Well Spacing Unit (Y/N), If No, describe <u>and is approval of non-standard unit requested in this application?</u>	Yes
Other Situations	
Depth Severance: Y/N. If yes, description	No
Proximity Tracts: If yes, description	
Proximity Defining Well: if yes, description	
Applicant's Ownership in Each Tract	Exhibit 2-B
Well(s)	
Name & API (if assigned), surface and bottom hole location, footages, completion target, orientation, completion status (standard or non-standard)	Add wells as needed
Well #1	Jericho 8/7 Fed. Com. Well No. 715H API No. 30-015-Pending

Horizontal Well First and Last Take Points	FTP: 2200 feet FSL and 100 feet FEL \$8 LTP: 2200 feet FSL and 100 feet FWL \$7
Completion Target (Formation, TVD and MD)	Upper Wolfcamp TVD 9290 feet, MVD 19425 feet
AFE Capex and Operating Costs	
Drilling Supervision/Month \$	\$8000
Production Supervision/Month \$	\$800
Justification for Supervision Costs	Exhibit 2
Requested Risk Charge	200%
Notice of Hearing	
Proposed Notice of Hearing	Exhibit 6
Proof of Mailed Notice of Hearing (20 days before hearing)	Exhibit 4
Proof of Published Notice of Hearing (10 days before hearing)	Exhibit 5

4

Ownership Determination	
Land Ownership Schematic of the Spacing Unit	Exhibit 2-B
Tract List (including lease numbers and owners)	Exhibit 2-B
If approval of Non-Standard Spacing Unit is requested, Tract List (including lease numbers and owners) of Tracts subject to notice requirements.	
Pooled Parties (including ownership type)	Exhibit 2-B/Working Interest Owners
Unlocatable Parties to be Pooled	Yes
Ownership Depth Severance (including percentage above & below)	No severance
Joinder	
Sample Copy of Proposal Letter	Exhibit 2-C
List of Interest Owners (i.e. Exhibit A of JOA)	Exhibit 2-B
Chronology of Contact with Non-Joined Working Interests	Exhibit 2-C
Overhead Rates In Proposal Letter	
Cost Estimate to Drill and Complete	Exhibit 2-D
Cost Estimate to Equip Well	Exhibit 2-D
Cost Estimate for Production Facilities	Exhibit 2-D
Geology	
Summary (including special considerations)	Exhibit 3
Spacing Unit Schematic	Exhibit 2-A

Gunbarrel/Lateral Trajectory Schematic	Exhibit 3-B
Well Orientation (with rationale)	Exhibit 3
Target Formation	Upper Wolfcamp
HSU Cross Section	Exhibit 3-B
Depth Severance Discussion	N/A
Forms, Figures and Tables	
C-102	Exhibit 2-A
Tracts	Exhibit 2-B
Summary of Interests, Unit Recapitulation (Tracts)	Exhibit 2-B
General Location Map (including basin)	Exhibit 3-A
Well Bore Location Map	Exhibit 2-A
Structure Contour Map - Subsea Depth	Exhibit 3-A
Cross Section Location Map (including wells)	Exhibit 3-B
Cross Section (including Landing Zone)	Exhibit 3-B
Additional Information	
Special Provisions/Stipulations	
CERTIFICATION: I hereby certify that the information provided in this checklist is complete and accurate.	
Printed Name (Attorney or Party Representative):	James Bruce
Signed Name (Attorney or Party Representative):	
Date:	June 20, 2024

**STATE OF NEW MEXICO
ENERGY, MINERALS AND NATURAL RESOURCES DEPARTMENT
OIL CONSERVATION DIVISION**

**IN THE MATTER OF THE HEARING CALLED
BY THE OIL CONSERVATION DIVISION FOR
THE PURPOSE OF CONSIDERING:**

**APPLICATION OF MEWBOURNE OIL COMPANY
FOR COMPULSORY POOLING, EDDY COUNTY,
NEW MEXICO.**

Case No. 24572

SELF-AFFIRMED STATEMENT OF JOSH ANDERSON

Josh Anderson, being duly sworn upon his oath, deposes and states:

1. I am a landman for Mewbourne Oil Company (“Mewbourne”), and have personal knowledge of the matters stated herein. I have been qualified by the Division as an expert petroleum landman.
2. Pursuant to Division Rules, the following information is submitted in support of this compulsory pooling application.
3. The purpose of this application is to force pool working interest owners into the Wolfcamp horizontal spacing unit described below, and in wells to be drilled in the unit.
4. In this case Mewbourne seeks an order pooling all uncommitted mineral interest owners in the Wolfcamp formation underlying a horizontal spacing unit comprised of the N/2S/2 of Section 8 and the N/2S/2 of Section 7, Township 20 South, Range 29 East, N.M.P.M., Eddy County, New Mexico (containing 320 acres). The unit will be dedicated to the Jericho 8/7 Fed. Com. Well No. 715H, with a first take point in the NE/4SE/4 of Section 8 and a last take point in the NW/4SW/4 of Section 7.
5. There is no depth severance in the Wolfcamp formation.
6. A plat and C-102 outlining the unit being pooled are submitted as Exhibit 2-A.
7. The tracts in the unit, the leases, and the parties being pooled and their interests are set forth in Exhibit 2-B. The persons noted with an asterisk are being pooled.
8. The interest owners being pooled have been contacted regarding the proposed well, but have failed or refused to voluntarily commit their interests to the well.

EXHIBIT

2

9. In order to locate the interest owners, Mewbourne examined the county and federal records, performed internet searches, checked telephone records, and searched Accurint and Whitepages. Mewbourne has made a good faith effort to locate all interest owners.

10. Exhibit 2-C contains sample copies of the proposal letters sent to the interest owners. Mewbourne has made a good faith effort to obtain the voluntary joinder of the working interest owners in the proposed well.

11. Exhibit 2-D is the Authorization for Expenditure for the proposed well. The estimated cost of the well set forth therein is fair and reasonable, and comparable to the cost of other wells of similar depth and length drilled in this area of Eddy County.

12. Mewbourne requests overhead and administrative rates of \$8000/month for a drilling well and \$800/month for a producing well. These rates are fair, and comparable to the rates charged by other operators for wells of this type in this portion of Eddy County. They are also the rates set forth in the Joint Operating Agreement for the well unit. Mewbourne requests that these rates be adjusted periodically as provided in the COPAS Accounting Procedure.

13. Mewbourne requests that the maximum cost plus 200% risk charge be assessed against a non-consenting working interest owner.

14. Mewbourne requests that it be designated operator of the well.

15. The attachments to this affidavit were prepared by me or compiled from company business records.

16. Granting this application is in the interests of conservation and the prevention of waste.

I understand that this Self-Affirmed Statement will be used as written testimony in this case. I affirm that my testimony in paragraphs 1 through 16 above is true and correct and is made under penalty of perjury under the laws of the State of New Mexico. My testimony is made as of the date handwritten next to my signature below.

Date: 5/20/24

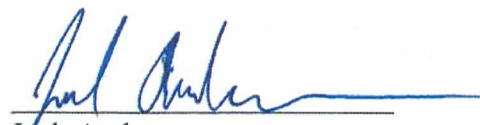
Josh Anderson

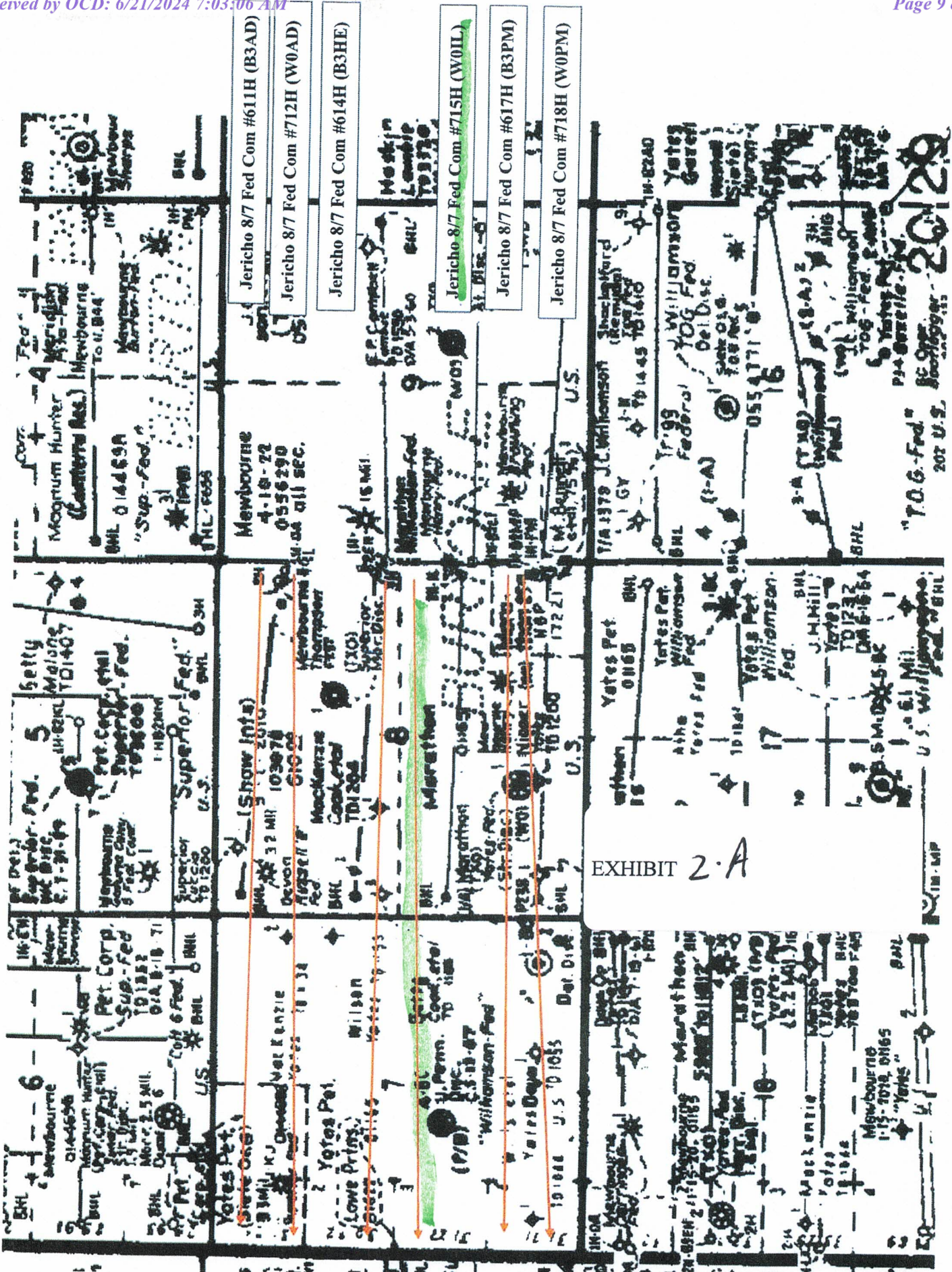

EXHIBIT 2-A

District I
1625 N. French Dr., Hobbs, NM 88240
Phone: (575) 393-6161 Fax: (575) 393-0720
District II
811 S. First St., Artesia, NM 88210
Phone: (575) 748-1283 Fax: (575) 748-9720
District III
1000 Rio Brazos Road, Aztec, NM 87410
Phone: (505) 334-6178 Fax: (505) 334-6170
District IV
1220 S. St. Francis Dr., Santa Fe, NM 87505
Phone: (505) 476-3460 Fax: (505) 476-3462

State of New Mexico
Energy, Minerals & Natural Resources Department
OIL CONSERVATION DIVISION
1220 South St. Francis Dr.
Santa Fe, NM 87505

Form C-102
Revised August 1, 2011
Submit one copy to appropriate
District Office

AMENDED REPORT

WELL LOCATION AND ACREAGE DEDICATION PLAT

1 API Number		2 Pool Code 98315		3 Pool Name Wolfcamp; Buster Flat; Upper Wolfcamp, East	
4 Property Code		5 Property Name JERICO 8/7 FED COM		6 Well Number 715H	
7 GRID NO 14744		8 Operator Name MEWBOURNE OIL COMPANY		9 Elevation 3275'	

10 Surface Location

UL or lot no.	Section	Township	Range	Lot ldn	Feet from the	North/South line	Feet From the	East/West line	County
P	8	20S	29E		1050	SOUTH	210	EAST	EDDY

11 Bottom Hole Location If Different From Surface

UL or lot no.	Section	Township	Range	Lot ldn	Feet from the	North/South line	Feet from the	East/West line	County
3	7	20S	29E		2200	SOUTH	100	WEST	EDDY

12 Dedicated Acres 320	13 Joint or Infill	14 Consolidation Code	15 Order No.
---------------------------	--------------------	-----------------------	--------------

No allowable will be assigned to this completion until all interest have been consolidated or a non-standard unit has been approved by the division.

16

CORNER DATA
NAD 83 GRID - NM EAST

A: FOUND BRASS CAP "1916" N: 575081.0 - E: 606409.4	H: FOUND BRASS CAP "1916" N: 577725.0 - E: 616710.4
B: FOUND BRASS CAP "1942" N: 577723.1 - E: 606436.7	I: FOUND BRASS CAP "1916" N: 575085.0 - E: 616714.9
C: FOUND BRASS CAP "1916" N: 580365.5 - E: 606463.1	J: FOUND BRASS CAP "1916" N: 575086.5 - E: 614071.1
D: FOUND BRASS CAP "1916" N: 580368.4 - E: 608772.1	K: FOUND BRASS CAP "1916" N: 575088.6 - E: 611425.3
E: FOUND BRASS CAP "1916" N: 580372.5 - E: 611413.2	L: FOUND BRASS CAP "1916" N: 575085.1 - E: 608784.7
F: FOUND BRASS CAP "1916" N: 580369.0 - E: 614058.1	M: FOUND BRASS CAP "1916" N: 577730.5 - E: 611419.2
G: FOUND BRASS CAP "1916" N: 580365.0 - E: 616706.0	

GEODETIC DATA
NAD 83 GRID - NM EAST

SURFACE LOCATION
N: 576134.9 - E: 616503.1
LAT: 32.5836118° N
LONG: 104.0892961° W

BOTTOM HOLE LOCATION
N: 577280.5 - E: 606532.1
LAT: 32.5868195° N
LONG: 104.1216611° W

FTP: 2200' ESL + 100' FEL

17 OPERATOR CERTIFICATION
I hereby certify that the information contained herein is true and complete to the best of my knowledge and belief, and that this organization either owns a working interest or unleased mineral interest in the land including the proposed bottom hole location or has a right to drill this well at this location pursuant to a contract with an owner of such a mineral or working interest, or to a voluntary pooling agreement or a compulsory pooling order heretofore entered by the division.

Signature _____ Date _____
Printed Name _____
E-mail Address _____

18 SURVEYOR CERTIFICATION
I hereby certify that the well location shown on this plat was plotted from field notes of actual surveys made by me or under my supervision, and that the same is true and correct to the best of my belief.

06/10/2024
Date of Survey

Signature and Seal of Professional Surveyor

ROBERT M. HOWETT
NEW MEXICO
19680
PROFESSIONAL SURVEYOR

19680
Certificate Number

Job No: LS24060508

Section Plat
Jericho 8/7 Fed Com #715H (W0IL)
N/2S/2 of Section 8 & N/2S/2 of Section 7

T20S-R29E, Eddy County, NM

Section 7	Section 8
Tract 1	Tract 2

Tract 1: Lot 3, NE/4SW/4, N/2SE/4 of Section 7 - Federal

Lease NMNM 01165

EOG Resources, Inc.
Magnum Hunter Resources, Inc.
WPX Energy Permian, LLC
Estate of Howard E. Warren
Estate of E.J. Rousuck

Tract 2: N/2S/2 of Section 8 - Federal Lease NMNM 01165

Mewbourne Oil Company
Davoil, Inc.
Great Western Drilling, Ltd.
Brooks Oil & Gas Interests, Ltd.
Hal S. Dean - Dean Family Trust

EXHIBIT 2-B

11

RECAPITULATION FOR JERICO 8/7 FED COM #715H (W01L)

Tract Number	Number of Acres Committeed	Percentage of Interst in Communitized Area
1	151.22	48.589422%
2	160	51.410578%
TOTAL	311.22	100.000000%

T20S-R29E, Eddy County, NM

Section 7

Section 8

Tract 1	Tract 2

12

TRACT OWNERSHIP
N/2S/2 of Section 8 & N/2S/2 of Section 7

Wolfcamp Formation:

Owner	% of Leasehold Interest
Mewbourne Oil Company, et al.	49.422364%
*EOG Resources, Inc. Midland Division - Land Dept. P.O. Box 2267 Midland, TX 79702	48.197405%
*WPX Energy Permian, LLC 333 W. Sheridan Ave. Oklahoma City, OK 73102	0.098901%
*Davoil, Inc. 6300 Ridglea Pl. #1208 Fort Worth, TX 76116	1.997526%
*Magnum Hunter Resources, Inc. 6001 Deauville Blvd., Suite 300N Midland, TX 79706	0.276625%
*Estate of Howard C. Warren, Deceased 161 North Clark Street, Suite 3100 Chicago, IL 60601	0.003589%
*Estate of E. J. Rousuck Address Unknown	0.003589%
TOTAL	50.577636%

Total Interest Being Pooled: 50.577636%

OWNERSHIP BY TRACT

Lot 3, NE/4SW/4, N/2SE/4 of Section 7

Owner	% of Leasehold Interest
Mewbourne Oil Company, et al	0.019164%
EOG Resources, Inc.	99.193205%
WPX Energy Permian, LLC	0.203545%
Magnum Hunter Resources, Inc.	0.569312%
Estate of Howard C. Warren, Deceased	0.007387%
Estate of E. J. Rousuck	0.007387%
TOTAL	100.000000%

N/2S/2 of Section 8

Owner	% of Leasehold Interest
Mewbourne Oil Company, et al.	96.114562%
Davoil, Inc.	3.885438%
TOTAL	100.000000%

13

Summary of Communications

**Jericho 8/7 Fed Com #611H (B3AD) N/2N/2 of Section 8-T20S-R29E,
Eddy County, NM &**

N/2N/2 of Section 7-T20S-R29E, Eddy County, NM,

**Jericho 8/7 Fed Com #614H (B3HE) S/2N/2 of Section 8-T20S-R29E,
Eddy County, NM &**

S/2N/2 of Section 7-T20S-R29E, Eddy County, NM,

**Jericho 8/7 Fed Com #617H (B3PM) S/2 of Section 8-T20S-R29E, Eddy
County, NM &**

S/2 of Section 7-T20S-R29E, Eddy County, NM,

**Jericho 8/7 Fed Com #712H (W0AD) N/2 of Section 8-T20S-R29E, Eddy
County, NM &**

N/2 of Section 7-T20S-R29E, Eddy County, NM,

**Jericho 8/7 Fed Com #715 (W0IL) N/2S/2 of Section 8-T20S-R29E, Eddy
County, NM &**

N/2S/2 of Section 7-T20S-R29E, Eddy County, NM,

& Jericho 8/7 Fed Com #718H (W0PM)

S/2S/2 of Section 8-T20S-R29E, Eddy County, NM &

S/2S/2 of Section 7-T20S-R29E, Eddy County, NM

EOG Resources, Inc.:

12/19/2022: Mailed a Working Interest Unit Jericho 8/7 Joint Operating Agreement, as well as, Jericho 8/7 Fed Com #611H (B3AD), Jericho 8/7 Fed Com #614H (B3HE), Jericho 8/7 Fed Com #617H (B3PM), Jericho 8/7 Fed Com #712H (W0AD), Jericho 8/7 Fed Com #715H (W0IL), & Jericho 8/7 Fed Com #718H (W0PM) Well Proposals to the above listed party.

12/28/2022: The above listed party received and signed for the certified mailing of the above captioned Joint Operating Agreement and Well Proposals.

8/2/2023: Correspondence with above listed party regarding Working Interest Unit and Well Proposals.

8/8/2023: Correspondence with above listed party regarding Working Interest Unit and Well Proposals.

8/16/2023: Correspondence with above listed party regarding Working Interest Unit and Well Proposals.

9/14/2023: Correspondence with above listed party regarding Working Interest Unit and Well Proposals.

1/4/2024: Correspondence with above listed party regarding Working Interest Unit and Well Proposals.

1/11/2024: Phone correspondence with above listed party regarding Working Interest Unit and Well Proposals.

1/31/2024: Phone correspondence with above listed party regarding Working Interest Unit and Well Proposals.

2/1/2024: Phone correspondence with above listed party regarding Working Interest Unit and Well Proposals.

3/8/2024: Correspondence with above listed party regarding Working Interest Unit and Well Proposals.

4/4/2024: Correspondence with above listed party regarding Working Interest Unit and Well Proposals.

4/8/2024: Correspondence with above listed party regarding Working Interest Unit and Well Proposals.

4/10/2024: Phone correspondence with above listed party regarding Working Interest Unit and Well Proposals.

4/15/2024: Phone correspondence with above listed party regarding Working Interest Unit and Well Proposals.

4/30/2024: Correspondence with above listed party regarding Working Interest Unit and Well Proposals.

EXHIBIT 2-C

14

6/4/2024: Correspondence with above listed party regarding Working Interest Unit and Well Proposals.
6/4/2024: Phone correspondence with above listed party regarding Working Interest Unit and Well Proposals.

Ongoing: Mewbourne is currently negotiating with EOG Resources, Inc. to acquire all or a portion of their interest or execute the Joint Operating Agreement.

Devon Energy Production Company, L.P.:

2/23/2023: Mailed a Working Interest Unit Jericho 8/7 Joint Operating Agreement, as well as, Jericho 8/7 Fed Com #611H (B3AD), Jericho 8/7 Fed Com #614H (B3HE), Jericho 8/7 Fed Com #617H (B3PM), Jericho 8/7 Fed Com #712H (W0AD), Jericho 8/7 Fed Com #715H (W0IL), & Jericho 8/7 Fed Com #718H (W0PM) Well Proposals to the above listed party.

2/27/2023: The above listed party received and signed for the certified mailing of the above captioned Joint Operating Agreement and Well Proposals.

3/8/2023: Correspondence with above listed party regarding Working Interest Unit and Well Proposals.

6/27/2023: Phone correspondence with above listed party regarding Working Interest Unit and Well Proposals.

2/8/2024: Correspondence with above listed party regarding Working Interest Unit and Well Proposals.

6/6/2024: Correspondence with above listed party regarding Working Interest Unit and Well Proposals.

6/10/2024: Correspondence with above listed party regarding Working Interest Unit and Well Proposals.

Ongoing: Mewbourne is currently negotiating with Devon Energy Production Company, L.P. to acquire all or a portion of their interest or execute the Joint Operating Agreement.

WPX Energy Permian, LLC:

2/23/2023: Mailed a Working Interest Unit Jericho 8/7 Joint Operating Agreement, as well as, Jericho 8/7 Fed Com #611H (B3AD), Jericho 8/7 Fed Com #614H (B3HE), Jericho 8/7 Fed Com #617H (B3PM), Jericho 8/7 Fed Com #712H (W0AD), Jericho 8/7 Fed Com #715H (W0IL), & Jericho 8/7 Fed Com #718H (W0PM) Well Proposals to the above listed party.

2/27/2023: The above listed party received and signed for the certified mailing of the above captioned Joint Operating Agreement and Well Proposals.

3/8/2023: Correspondence with above listed party regarding Working Interest Unit and Well Proposals.

6/27/2023: Phone correspondence with above listed party regarding Working Interest Unit and Well Proposals.

2/8/2024: Correspondence with above listed party regarding Working Interest Unit and Well Proposals.

6/6/2024: Correspondence with above listed party regarding Working Interest Unit and Well Proposals.

6/10/2024: Correspondence with above listed party regarding Working Interest Unit and Well Proposals.

Ongoing: Mewbourne is currently negotiating with WPX Energy Permian, LLC to acquire all or a portion of their interest or execute the Joint Operating Agreement.

Davoil, Inc.:

2/23/2023: Mailed a Working Interest Unit Jericho 8/7 Joint Operating Agreement, as well as, Jericho 8/7 Fed Com #611H (B3AD), Jericho 8/7 Fed Com #614H (B3HE), Jericho 8/7 Fed Com #617H (B3PM), Jericho 8/7 Fed Com #712H (W0AD), Jericho 8/7 Fed Com #715H (W0IL), & Jericho 8/7 Fed Com #718H (W0PM) Well Proposals to the above listed party.

2/27/2023: The above listed party received and signed for the certified mailing of the above captioned Joint Operating Agreement and Well Proposals.

3/9/2023: Phone correspondence with above listed party regarding Working Interest Unit and Well Proposals.

Ongoing: Mewbourne is currently negotiating with Davoil, Inc. to acquire all or a portion of their interest or execute the Joint Operating Agreement.

15

Magnum Hunter Resources, Inc.:

2/23/2023: Mailed a Working Interest Unit Jericho 8/7 Joint Operating Agreement, as well as, Jericho 8/7 Fed Com #611H (B3AD), Jericho 8/7 Fed Com #614H (B3HE), Jericho 8/7 Fed Com #617H (B3PM), Jericho 8/7 Fed Com #712H (W0AD), Jericho 8/7 Fed Com #715H (W0IL), & Jericho 8/7 Fed Com #718H (W0PM) Well Proposals to the above listed party's predecessor in title.

3/3/2023: The above listed party's predecessor in title's certified mailing of the above captioned Joint Operating Agreement and Well Proposals were returned.

4/11/2023: Mailed a Working Interest Unit Jericho 8/7 Joint Operating Agreement, as well as, Jericho 8/7 Fed Com #611H (B3AD), Jericho 8/7 Fed Com #614H (B3HE), Jericho 8/7 Fed Com #617H (B3PM), Jericho 8/7 Fed Com #712H (W0AD), Jericho 8/7 Fed Com #715H (W0IL), & Jericho 8/7 Fed Com #718H (W0PM) Well Proposals to the above listed party.

4/13/2023: The above listed party received and signed for the certified mailing of the above captioned Joint Operating Agreement and Well Proposals.

3/27/2024: Phone correspondence with above listed party regarding Working Interest Unit and Well Proposals.

3/28/2024: Phone correspondence with above listed party regarding Working Interest Unit and Well Proposals.

5/14/2024: Phone correspondence with above listed party regarding Working Interest Unit and Well Proposals.

Ongoing: Mewbourne is currently negotiating with Magnum Hunter Resources, Inc. to acquire all or a portion of their interest or execute the Joint Operating Agreement.

Estate of Howard C. Warren, Deceased:

2/23/2023: Mailed a Working Interest Unit Jericho 8/7 Joint Operating Agreement, as well as, Jericho 8/7 Fed Com #611H (B3AD), Jericho 8/7 Fed Com #614H (B3HE), Jericho 8/7 Fed Com #617H (B3PM), Jericho 8/7 Fed Com #712H (W0AD), Jericho 8/7 Fed Com #715H (W0IL), & Jericho 8/7 Fed Com #718H (W0PM) Well Proposals to the above listed party.

2/27/2023: The above listed party received and signed for the certified mailing of the above captioned Joint Operating Agreement and Well Proposals.

3/8/2023: Phone correspondence with above listed party regarding Working Interest Unit and Well Proposal and they indicated that they did not want to participate and would be forced pooled.

Ongoing: Mewbourne is force pooling the Estate of Howard C. Warren's interest.

Estate of E. J. Rousuck:

2/23/2023: Was never able to find an address to mail a Working Interest Unit Jericho 8/7 Joint Operating Agreement, as well as, Jericho 8/7 Fed Com #611H (B3AD), Jericho 8/7 Fed Com #614H (B3HE), Jericho 8/7 Fed Com #617H (B3PM), Jericho 8/7 Fed Com #712H (W0AD), Jericho 8/7 Fed Com #715H (W0IL), & Jericho 8/7 Fed Com #718H (W0PM) Well Proposals to the above listed party.

Ongoing: Mewbourne is currently trying to locate the Estate of E. J. Rousuck to acquire all or a portion of their interest or execute the Joint Operating Agreement.

MEWBOURNE OIL COMPANY

500 WEST TEXAS AVENUE, SUITE 1020
MIDLAND, TEXAS 79701-4279

TELEPHONE (432) 682-3715

December 19, 2022

Via Certified Mail

EOG Resources, Inc.
Midland Division - Land Dept.
P.O. Box 2267
Midland, Texas 79702
Attn: Land Manager

Re: Jericho "8/7" WOAD Fed Com No. 1H
1140' FNL & 210' FEL (SL) (Sec. 8)
1310' FNL & 100' FWL (BHL) (Sec. 7)
Section 8/7, T20S, R29E
Eddy County, New Mexico

To Whom It May Concern:

Mewbourne Oil Company ("Mewbourne") as Operator, proposes to form a 1243.88 acres Working Interest Unit ("WIU") covering all of the captioned Section 8 and the captioned Section 7 for oil and gas production. Mewbourne hereby proposes to drill the captioned well at the above referenced surface location (SL) to the referenced bottom hole location (BHL). The proposed well will be drilled to an approximate true vertical depth (TVD) of 9,284 feet subsurface to evaluate the Wolfcamp Formation. The proposed well will have a measured depth (MD) of approximately 19,281 feet. The N/2 of the captioned Section 8 and the N/2 of the captioned Section 7 will be dedicated to the well as the proration unit.

Regarding the above, enclosed for your further handling is our AFE dated December 8, 2022 for the captioned proposed well. Also, enclosed is a copy of our proposed Operating Agreement dated December 15, 2022 and an extra set of signature pages. In the event your firm elects to participate in the proposed WIU and well, please execute the enclosed AFE and extra set of signature pages and return to me within thirty (30) days.

Should you have any questions regarding the above, please email me at janderson@mewbourne.com or call me at (432) 682-3715.

Sincerely,
MEWBOURNE OIL COMPANY



Josh Anderson, RPL
Landman

17

MEWBOURNE OIL COMPANY

500 WEST TEXAS AVENUE, SUITE 1020
MIDLAND, TEXAS 79701-4279

TELEPHONE (432) 682-3715

December 19, 2022

Via Certified Mail

EOG Resources, Inc.
Midland Division - Land Dept.
P.O. Box 2267
Midland, Texas 79702
Attn: Land Manager

Re: Jericho "8/7" W0IL Fed Com No. 1H
1050' FSL & 210' FEL (SL) (Sec. 8)
2200' FSL & 100' FWL (BHL) (Sec. 7)
Section 8/7, T20S, R29E
Eddy County, New Mexico

To Whom It May Concern:

Mewbourne Oil Company ("Mewbourne") as Operator, proposes to form a 1243.88 acres Working Interest Unit ("WIU") covering all of the captioned Section 8 and the captioned Section 7 for oil and gas production. Mewbourne hereby proposes to drill the captioned well at the above referenced surface location (SL) to the referenced bottom hole location (BHL). The proposed well will be drilled to an approximate true vertical depth (TVD) of 9,290 feet subsurface to evaluate the Wolfcamp Formation. The proposed well will have a measured depth (MD) of approximately 19,425 feet. The S/2 of the captioned Section 8 and the S/2 of the captioned Section 7 will be dedicated to the well as the proration unit.

Regarding the above, enclosed for your further handling is our AFE dated December 8, 2022 for the captioned proposed well. Also, enclosed is a copy of our proposed Operating Agreement dated December 15, 2022 and an extra set of signature pages. In the event your firm elects to participate in the proposed WIU and well, please execute the enclosed AFE and extra set of signature pages and return to me within thirty (30) days.

Should you have any questions regarding the above, please email me at janderson@mewbourne.com or call me at (432) 682-3715.

Sincerely,

MEWBOURNE OIL COMPANY



Josh Anderson, RPL
Landman

18

MEWBOURNE OIL COMPANY

500 WEST TEXAS AVENUE, SUITE 1020
MIDLAND, TEXAS 79701-4279

TELEPHONE (432) 682-3715

December 19, 2022

Via Certified Mail

EOG Resources, Inc.
Midland Division - Land Dept.
P.O. Box 2267
Midland, Texas 79702
Attn: Land Manager

Re: Jericho "8/7" WOPM Fed Com No. 1H
1010' FSL & 210' FEL (SL) (Sec. 8)
440' FSL & 100' FWL (BHL) (Sec. 7)
Section 8/7, T20S, R29E
Eddy County, New Mexico

To Whom It May Concern:

Mewbourne Oil Company ("Mewbourne") as Operator, proposes to form a 1243.88 acres Working Interest Unit ("WIU") covering all of the captioned Section 8 and the captioned Section 7 for oil and gas production. Mewbourne hereby proposes to drill the captioned well at the above referenced surface location (SL) to the referenced bottom hole location (BHL). The proposed well will be drilled to an approximate true vertical depth (TVD) of 9,318 feet subsurface to evaluate the Wolfcamp Formation. The proposed well will have a measured depth (MD) of approximately 19,360 feet. The S/2 of the captioned Section 8 and the S/2 of the captioned Section 7 will be dedicated to the well as the proration unit.

Regarding the above, enclosed for your further handling is our AFE dated December 8, 2022 for the captioned proposed well. Also, enclosed is a copy of our proposed Operating Agreement dated December 15, 2022 and an extra set of signature pages. In the event your firm elects to participate in the proposed WIU and well, please execute the enclosed AFE and extra set of signature pages and return to me within thirty (30) days.

Should you have any questions regarding the above, please email me at janderson@mewbourne.com or call me at (432) 682-3715.

Sincerely,

MEWBOURNE OIL COMPANY



Josh Anderson, RPL
Landman

19

MEWBOURNE OIL COMPANY

500 WEST TEXAS AVENUE, SUITE 1020
MIDLAND, TEXAS 79701-4279

TELEPHONE (432) 682-3715

February 23, 2023

Via Certified Mail

Devon Energy Production Company, L.P.
333 W. Sheridan Ave.
Oklahoma City, Oklahoma 73102

Re: Jericho "8/7" WOAD Fed Com No. 1H
1140' FNL & 210' FEL (SL) (Sec. 8)
1310' FNL & 100' FWL (BHL) (Sec. 7)
Section 8/7, T20S, R29E
Eddy County, New Mexico

To Whom It May Concern:

Mewbourne Oil Company ("Mewbourne") as Operator, proposes to form a 1243.88 acres Working Interest Unit ("WIU") covering all of the captioned Section 8 and the captioned Section 7 for oil and gas production. Mewbourne hereby proposes to drill the captioned well at the above referenced surface location (SL) to the referenced bottom hole location (BHL). The proposed well will be drilled to an approximate true vertical depth (TVD) of 9,284 feet subsurface to evaluate the Wolfcamp Formation. The proposed well will have a measured depth (MD) of approximately 19,281 feet. The N/2 of the captioned Section 8 and the N/2 of the captioned Section 7 will be dedicated to the well as the proration unit.

Regarding the above, enclosed for your further handling is our AFE dated December 8, 2022 for the captioned proposed well. Also, enclosed is a copy of our proposed Operating Agreement dated December 15, 2022 and an extra set of signature pages. In the event your firm elects to participate in the proposed WIU and well, please execute the enclosed AFE and extra set of signature pages and return to me within thirty (30) days.

Should you have any questions regarding the above, please email me at janderson@mewbourne.com or call me at (432) 682-3715.

Sincerely,

MEWBOURNE OIL COMPANY



Josh Anderson, RPL
Landman

MEWBOURNE OIL COMPANY

500 WEST TEXAS AVENUE, SUITE 1020
MIDLAND, TEXAS 79701-4279

TELEPHONE (432) 682-3715

February 23, 2023

Via Certified Mail

Devon Energy Production Company, L.P.
333 W. Sheridan Ave.
Oklahoma City, Oklahoma 73102

Re: Jericho "8/7" W0IL Fed Com No. 1H
1050' FSL & 210' FEL (SL) (Sec. 8)
2200' FSL & 100' FWL (BHL) (Sec. 7)
Section 8/7, T20S, R29E
Eddy County, New Mexico

To Whom It May Concern:

Mewbourne Oil Company ("Mewbourne") as Operator, proposes to form a 1243.88 acres Working Interest Unit ("WIU") covering all of the captioned Section 8 and the captioned Section 7 for oil and gas production. Mewbourne hereby proposes to drill the captioned well at the above referenced surface location (SL) to the referenced bottom hole location (BHL). The proposed well will be drilled to an approximate true vertical depth (TVD) of 9,290 feet subsurface to evaluate the Wolfcamp Formation. The proposed well will have a measured depth (MD) of approximately 19,425 feet. The S/2 of the captioned Section 8 and the S/2 of the captioned Section 7 will be dedicated to the well as the proration unit.

Regarding the above, enclosed for your further handling is our AFE dated December 8, 2022 for the captioned proposed well. Also, enclosed is a copy of our proposed Operating Agreement dated December 15, 2022 and an extra set of signature pages. In the event your firm elects to participate in the proposed WIU and well, please execute the enclosed AFE and extra set of signature pages and return to me within thirty (30) days.

Should you have any questions regarding the above, please email me at janderson@mewbourne.com or call me at (432) 682-3715.

Sincerely,

MEWBOURNE OIL COMPANY



Josh Anderson, RPL
Landman

MEWBOURNE OIL COMPANY

500 WEST TEXAS AVENUE, SUITE 1020
MIDLAND, TEXAS 79701-4279

TELEPHONE (432) 682-3715

February 23, 2023

Via Certified Mail

Devon Energy Production Company, L.P.
333 W. Sheridan Ave.
Oklahoma City, Oklahoma 73102

Re: Jericho "8/7" WOPM Fed Com No. 1H
1010' FSL & 210' FEL (SL) (Sec. 8)
440' FSL & 100' FWL (BHL) (Sec. 7)
Section 8/7, T20S, R29E
Eddy County, New Mexico

To Whom It May Concern:

Mewbourne Oil Company ("Mewbourne") as Operator, proposes to form a 1243.88 acres Working Interest Unit ("WIU") covering all of the captioned Section 8 and the captioned Section 7 for oil and gas production. Mewbourne hereby proposes to drill the captioned well at the above referenced surface location (SL) to the referenced bottom hole location (BHL). The proposed well will be drilled to an approximate true vertical depth (TVD) of 9,318 feet subsurface to evaluate the Wolfcamp Formation. The proposed well will have a measured depth (MD) of approximately 19,360 feet. The S/2 of the captioned Section 8 and the S/2 of the captioned Section 7 will be dedicated to the well as the proration unit.

Regarding the above, enclosed for your further handling is our AFE dated December 8, 2022 for the captioned proposed well. Also, enclosed is a copy of our proposed Operating Agreement dated December 15, 2022 and an extra set of signature pages. In the event your firm elects to participate in the proposed WIU and well, please execute the enclosed AFE and extra set of signature pages and return to me within thirty (30) days.

Should you have any questions regarding the above, please email me at janderson@mewbourne.com or call me at (432) 682-3715.

Sincerely,

MEWBOURNE OIL COMPANY



Josh Anderson, RPL
Landman

MEWBOURNE OIL COMPANY

500 WEST TEXAS AVENUE, SUITE 1020
MIDLAND, TEXAS 79701-4279

TELEPHONE (432) 682-3715

April 11, 2023

Via Certified Mail

Magnum Hunter Resources, Inc.
600 N Marienfeld St #600
Midland, TX 79701
Attn: John Coffman

Re: Jericho "8/7" WOAD Fed Com No. 1H
1140' FNL & 210' FEL (SL) (Sec. 8)
1310' FNL & 100' FWL (BHL) (Sec. 7)
Section 8/7, T20S, R29E
Eddy County, New Mexico

To Whom It May Concern:

Mewbourne Oil Company ("Mewbourne") as Operator, proposes to form a 1243.88 acres Working Interest Unit ("WIU") covering all of the captioned Section 8 and the captioned Section 7 for oil and gas production. Mewbourne hereby proposes to drill the captioned well at the above referenced surface location (SL) to the referenced bottom hole location (BHL). The proposed well will be drilled to an approximate true vertical depth (TVD) of 9,284 feet subsurface to evaluate the Wolfcamp Formation. The proposed well will have a measured depth (MD) of approximately 19,281 feet. The N/2 of the captioned Section 8 and the N/2 of the captioned Section 7 will be dedicated to the well as the proration unit.

Regarding the above, enclosed for your further handling is our AFE dated December 8, 2022 for the captioned proposed well. Also, enclosed is a copy of our proposed Operating Agreement dated December 15, 2022 and an extra set of signature pages. In the event your firm elects to participate in the proposed WIU and well, please execute the enclosed AFE and extra set of signature pages and return to me within thirty (30) days.

Should you have any questions regarding the above, please email me at janderson@mewbourne.com or call me at (432) 682-3715.

Sincerely,

MEWBOURNE OIL COMPANY



Josh Anderson, RPL
Landman

MEWBOURNE OIL COMPANY

500 WEST TEXAS AVENUE, SUITE 1020
MIDLAND, TEXAS 79701-4279

TELEPHONE (432) 682-3715

April 11, 2023

Via Certified Mail

Magnum Hunter Resources, Inc.
600 N Marienfeld St #600
Midland, TX 79701
Attn: John Coffman

Re: Jericho "8/7" W0IL Fed Com No. 1H
1050' FSL & 210' FEL (SL) (Sec. 8)
2200' FSL & 100' FWL (BHL) (Sec. 7)
Section 8/7, T20S, R29E
Eddy County, New Mexico

To Whom It May Concern:

Mewbourne Oil Company ("Mewbourne") as Operator, proposes to form a 1243.88 acres Working Interest Unit ("WIU") covering all of the captioned Section 8 and the captioned Section 7 for oil and gas production. Mewbourne hereby proposes to drill the captioned well at the above referenced surface location (SL) to the referenced bottom hole location (BHL). The proposed well will be drilled to an approximate true vertical depth (TVD) of 9,290 feet subsurface to evaluate the Wolfcamp Formation. The proposed well will have a measured depth (MD) of approximately 19,425 feet. The S/2 of the captioned Section 8 and the S/2 of the captioned Section 7 will be dedicated to the well as the proration unit.

Regarding the above, enclosed for your further handling is our AFE dated December 8, 2022 for the captioned proposed well. Also, enclosed is a copy of our proposed Operating Agreement dated December 15, 2022 and an extra set of signature pages. In the event your firm elects to participate in the proposed WIU and well, please execute the enclosed AFE and extra set of signature pages and return to me within thirty (30) days.

Should you have any questions regarding the above, please email me at janderson@mewbourne.com or call me at (432) 682-3715.

Sincerely,
MEWBOURNE OIL COMPANY



Josh Anderson, RPL
Landman

MEWBOURNE OIL COMPANY

500 WEST TEXAS AVENUE, SUITE 1020
MIDLAND, TEXAS 79701-4279

TELEPHONE (432) 682-3715

April 11, 2023

Via Certified Mail

Magnum Hunter Resources, Inc.
600 N Marienfeld St #600
Midland, TX 79701
Attn: John Coffman

Re: Jericho "8/7" WOPM Fed Com No. 1H
1010' FSL & 210' FEL (SL) (Sec. 8)
440' FSL & 100' FWL (BHL) (Sec. 7)
Section 8/7, T20S, R29E
Eddy County, New Mexico

To Whom It May Concern:

Mewbourne Oil Company ("Mewbourne") as Operator, proposes to form a 1243.88 acres Working Interest Unit ("WIU") covering all of the captioned Section 8 and the captioned Section 7 for oil and gas production. Mewbourne hereby proposes to drill the captioned well at the above referenced surface location (SL) to the referenced bottom hole location (BHL). The proposed well will be drilled to an approximate true vertical depth (TVD) of 9,318 feet subsurface to evaluate the Wolfcamp Formation. The proposed well will have a measured depth (MD) of approximately 19,360 feet. The S/2 of the captioned Section 8 and the S/2 of the captioned Section 7 will be dedicated to the well as the proration unit.

Regarding the above, enclosed for your further handling is our AFE dated December 8, 2022 for the captioned proposed well. Also, enclosed is a copy of our proposed Operating Agreement dated December 15, 2022 and an extra set of signature pages. In the event your firm elects to participate in the proposed WIU and well, please execute the enclosed AFE and extra set of signature pages and return to me within thirty (30) days.

Should you have any questions regarding the above, please email me at janderson@mewbourne.com or call me at (432) 682-3715.

Sincerely,
MEWBOURNE OIL COMPANY



Josh Anderson, RPL
Landman

MEWBOURNE OIL COMPANY

AUTHORIZATION FOR EXPENDITURE

Well Name: JERICO 8/7 W01L FED COM #1H Prospect: HENRY/THOMPSON
 Location: SL: 1050 FSL & 210 FEL (8); BHL: 2200 FSL & 100 FWL (7) County: Eddy ST: NM
 Sec. 8 Blk: Survey: TWP: 20S RNG: 29E Prop. TVD: 9290 TMD: 19425

INTANGIBLE COSTS 0180		CODE	TCP	CODE	CC
Regulatory Permits & Surveys		0180-0100	\$20,000	0180-0200	
Location / Road / Site / Preparation		0180-0105	\$45,000	0180-0205	\$35,000
Location / Restoration		0180-0106	\$200,000	0180-0206	\$60,000
Daywork / Turnkey / Footage Drilling	23 days drlg / 3 days comp @ \$29000/d	0180-0110	\$712,400	0180-0210	\$83,300
Fuel	1700 gal/day @ \$3.9/gal	0180-0114	\$162,900	0180-0214	\$214,500
Alternate Fuels		0180-0115		0180-0215	\$97,000
Mud, Chemical & Additives		0180-0120	\$50,000	0180-0220	
Mud - Specialized		0180-0121	\$140,000	0180-0221	
Horizontal Drillout Services				0180-0222	\$200,000
Stimulation Toe Preparation				0180-0223	\$50,000
Cementing		0180-0125	\$145,000	0180-0225	\$50,000
Logging & Wireline Services		0180-0130	\$35,000	0180-0230	\$370,000
Casing / Tubing / Snubbing Services		0180-0134	\$35,000	0180-0234	\$18,000
Mud Logging		0180-0137	\$15,000		
Stimulation	51 Stg 20.2 MM gal / 25.3 MM lb			0180-0241	\$2,912,000
Stimulation Rentals & Other				0180-0242	\$275,000
Water & Other		0180-0145	\$40,000	0180-0245	\$400,000
Bits		0180-0148	\$107,500	0180-0248	
Inspection & Repair Services		0180-0150	\$50,000	0180-0250	\$5,000
Misc. Air & Pumping Services		0180-0154		0180-0254	\$10,000
Testing & Flowback Services		0180-0158	\$12,000	0180-0258	\$24,000
Completion / Workover Rig				0180-0260	\$10,500
Rig Mobilization		0180-0164	\$150,000		
Transportation		0180-0165	\$30,000	0180-0265	\$65,000
Welding, Construction & Maint. Services		0180-0168	\$4,000	0180-0268	\$15,000
Contract Services & Supervision		0180-0170	\$164,500	0180-0270	\$75,000
Directional Services	Includes Vertical Control	0180-0175	\$406,200		
Equipment Rental		0180-0180	\$160,700	0180-0280	\$25,000
Well / Lease Legal		0180-0184	\$5,000	0180-0284	
Well / Lease Insurance		0180-0185	\$5,300	0180-0285	
Intangible Supplies		0180-0188	\$7,000	0180-0288	\$1,000
Damages		0180-0190	\$10,000	0180-0290	\$10,000
Pipeline Interconnect. ROW Easements		0180-0192		0180-0292	\$5,000
Company Supervision		0180-0195	\$98,800	0180-0295	\$38,000
Overhead Fixed Rate		0180-0196	\$10,000	0180-0296	\$20,000
Contingencies	5% (TCP) 5% (CC)	0180-0199	\$141,065	0180-0299	\$253,315
TOTAL			\$2,962,365		\$5,319,615

TANGIBLE COSTS 0181		CODE	TCP	CODE	CC
Casing (19.1" - 30")	400' - 20" 94# X-56 BTC @ \$135.08/ft	0181-0793	\$36,600		
Casing (10.1" - 19.0")	1300' - 13 3/8" 64.5# J-55 ST&C @ \$76.30/ft	0181-0794	\$105,900		
Casing (8.1" - 10.0")	3150' - 9 5/8" 40# HCL80 LT&C @ \$55.54/ft	0181-0795	\$204,600		
Casing (6.1" - 8.0")	8925' - 7" 29# HPP110 BT&C @ \$59.83/ft	0181-0796	\$570,500		
Casing (4.1" - 6.0")	11460' - 4 1/2" 13.5# P-110 CDC-HTQ @ \$33.47/ft			0181-0797	\$409,600
Tubing	8750' - 2 7/8" 6.5# L-80 IPC Tbg @ \$13.60/ft			0181-0798	\$127,900
Drilling Head		0181-0860	\$50,000		
Tubing Head & Upper Section				0181-0870	\$30,000
Horizontal Completion Tools	Completion Liner Hanger			0181-0871	\$70,000
Subsurface Equip. & Artificial Lift	ESP			0181-0880	\$80,000
Pumping Unit Systems				0181-0885	
Service Pumps	(1/6) TP/CP/Circ pump			0181-0886	\$10,000
Storage Tanks	(1/6) 6 QT/5 WT/GB			0181-0890	\$120,000
Emissions Control Equipment	(1/6) VRT's/VRU/Flare/KO's			0181-0892	\$90,000
Separation / Treating Equipment	(1/6) H sep/V sep/HT			0181-0895	\$60,000
Automation Metering Equipment	Automation/fiber/meters			0181-0898	\$72,000
Line Pipe & Valves - Gathering	(1/6) 1 mile gas & water			0181-0900	\$45,000
Fittings / Valves & Accessories				0181-0906	\$235,000
Cathodic Protection				0181-0908	\$7,500
Electrical Installation				0181-0909	\$115,000
Equipment Installation				0181-0910	\$125,000
Pipeline Construction	(1/6) 1 mile gas & water			0181-0920	\$30,000
TOTAL			\$967,600		\$1,627,000
SUBTOTAL			\$3,929,965		\$6,946,615

TOTAL WELL COST \$10,876,580

Extra Expense Insurance

I elect to be covered by Operator's Extra Expense Insurance and pay my proportionate share of the premium. Operator has secured Extra Expense Insurance covering costs of well control, clean up and redrilling as estimated in Line Item 0180-0185.

I elect to purchase my own well control insurance policy.

If neither box is checked above, non-operating working interest owner elects to be covered by Operator's well control insurance.

Prepared by: Gavin Edington Date: 12/8/2022
 Company Approval: _____ Date: _____
 Joint Owner Interest: _____ Amount: _____
 Joint Owner Name: _____ Signature: _____

EXHIBIT 2-D

26