

**STATE OF NEW MEXICO
ENERGY, MINERALS AND NATURAL RESOURCES DEPARTMENT
OIL CONSERVATION DIVISION**

**APPLICATION OF AMEREDEV
OPERATING, LLC FOR
COMPULSORY POOLING,
LEA COUNTY, NEW MEXICO.**

CASE NO. 24602

NOTICE OF REVISED EXHIBITS C-3, C-5, E & F

Ameredev Operating, LLC, applicant in the above-referenced case, gives notice that it is filing the attached exhibit for acceptance into the record.

Revised Exhibit C-3 is an updated pooling exhibit showing the correct parties to be pooled.

Revised Exhibit C-5 is an updated chronology of contacts with the correct parties to be pooled and additional details regarding Ameredev's communications with those parties.

Revised Exhibit E & F is updated notice information with the correct parties to be pooled.

Respectfully submitted,

HOLLAND & HART LLP



Michael H. Feldewert
Adam G. Rankin
Paula M. Vance
Post Office Box 2208
Santa Fe, New Mexico 87504-2208
(505) 988-4421
(505) 983-6043 Facsimile
mfeldewert@hollandhart.com
agrarkin@hollandhart.com
pmvance@hollandhart.com

ATTORNEYS FOR AMEREDEV OPERATING, LLC

**BEFORE THE OIL CONSERVATION DIVISION
EXAMINER HEARING August 22, 2024**

CASE NO. 24602

PIMENTO FED COM 26 36 03 106H

LEA COUNTY, NEW MEXICO



Ameredev II, LLC

**STATE OF NEW MEXICO
ENERGY, MINERALS AND NATURAL RESOURCES DEPARTMENT
OIL CONSERVATION DIVISION**

**APPLICATIONS OF AMEREDEV
OPERATING, LLC FOR
COMPULSORY POOLING,
LEA COUNTY, NEW MEXICO.**

CASE NO. 24602

REVISED TABLE OF CONTENTS

- **Ameredev Exhibit A:** Compulsory Pooling Application Checklist
- **Ameredev Exhibit B:** Application of Ameredev Operating, LLC
- **Ameredev Exhibit C:** Affidavit of Brandon Forteza, Landman
 - Ameredev Exhibit C-1: C-102s
 - Ameredev Exhibit C-2: Land Tract Map
 - *Revised* Ameredev Exhibit C-3: Ownership Breakdown
 - Ameredev Exhibit C-4: Well Proposal Ltrs w/ AFE & Lease Offers
 - *Revised* Ameredev Exhibit C-5: Chronology of Contacts
- **Ameredev Exhibit D:** Affidavit of Parker Foy, Geologist
 - Ameredev Exhibit D-1: Locator map
 - Ameredev Exhibit D-2: Subsea structure
 - Ameredev Exhibit D-3: Cross-section map
 - Ameredev Exhibit D-4: Stratigraphic cross-section
- ***Revised* Ameredev Exhibit E:** Self-Affirmed Statement of Notice
- ***Revised* Ameredev Exhibit F:** Affidavit of Publication

COMPULSORY POOLING APPLICATION CHECKLIST**ALL INFORMATION IN THE APPLICATION MUST BE SUPPORTED BY SIGNED AFFIDAVITS**

Case: 24602	APPLICANT'S RESPONSE
Date	July 11, 2024
Applicant	Ameredev Operating, LLC
Designated Operator & OGRID (affiliation if applicable)	Ameredev Operating, LLC (OGRID No. 372224)
Applicant's Counsel:	Holland & Hart LLP
Case Title:	APPLICATION OF AMEREDEV OPERATING, LLC FOR COMPULSORY POOLING, LEA COUNTY, NEW MEXICO.
Entries of Appearance/Intervenors:	N/A
Well Family	Pimento
Formation/Pool	
Formation Name(s) or Vertical Extent:	Wolfcamp
Primary Product (Oil or Gas):	Oil
Pooling this vertical extent:	N/A
Pool Name and Pool Code (Only if NSP is requested):	N/A
Well Location Setback Rules (Only if NSP is Requested):	N/A
Spacing Unit	
Type (Horizontal/Vertical)	Horizontal
Size (Acres)	320
Building Blocks:	40 acres
Orientation:	Standup
Description: TRS/County	W/2 E/2 of Sections 3 and 10, Township 26 South, Range 36 East, NMPM, Lea County, New Mexico
Standard Horizontal Well Spacing Unit (Y/N), If No, describe and is approval of non-standard unit requested in this application?	Yes
Other Situations	
Depth Severance: Y/N. If yes, description	No BEFORE THE OIL CONSERVATION DIVISION Santa Fe, New Mexico
Proximity Tracts: If yes, description	No Exhibit No. A Submitted by: Ameredev Operating, LLC
Proximity Defining Well: if yes, description	N/A Hearing Date: August 22, 2024 Case No. 24602
Applicant's Ownership in Each Tract	Exhibit C-3
Well(s)	
Name & API (if assigned), surface and bottom hole location, footages, completion target, orientation, completion status (standard or non-standard)	Add wells as needed

SHL: 160' FNL, 2,144' FEL (Unit B) of Section 3
BHL: 50' FSL, 2,040' FEL (Unit O) of Section 10
Target: Wolfcamp
Orientation: Standup
Completion: Standard Location

Horizontal Well First and Last Take Points

Exhibit C-1

Completion Target (Formation, TVD and MD)

Exhibit C-4

AFE Capex and Operating Costs

Drilling Supervision/Month \$

\$7,000

Production Supervision/Month \$

\$700

Justification for Supervision Costs

Exhibit C

Requested Risk Charge

200%

Notice of Hearing

Proposed Notice of Hearing

Exhibit B

Proof of Mailed Notice of Hearing (20 days before hearing)

Exhibit E

Proof of Published Notice of Hearing (10 days before hearing)

Exhibit F

Ownership Determination

Land Ownership Schematic of the Spacing Unit

Exhibit C-2

Tract List (including lease numbers and owners)

Exhibit C-2

If approval of Non-Standard Spacing Unit is requested, Tract List (including lease numbers and owners) of Tracts subject to notice requirements.

N/A

Pooled Parties (including ownership type)

Exhibit C-3

Unlocatable Parties to be Pooled

6; See Exhibit C

Ownership Depth Severance (including percentage above & below)

N/A

Joinder

Sample Copy of Proposal Letter

Exhibit C-4

List of Interest Owners (ie Exhibit A of JOA)

Exhibit C-3

Chronology of Contact with Non-Joined Working Interests

Exhibit C-5

Overhead Rates In Proposal Letter

Exhibit C-4

Cost Estimate to Drill and Complete

Exhibit C-4

Cost Estimate to Equip Well

Exhibit C-4

Cost Estimate for Production Facilities

Exhibit C-4

Geology

Summary (including special considerations)

Exhibit D

Spacing Unit Schematic

Exhibit D-1

Gunbarrel/Lateral Trajectory Schematic	Exhibit D-1
Well Orientation (with rationale)	Exhibit D
Target Formation	Exhibit D, D-4
HSU Cross Section	Exhibit D-3, D-4
Depth Severance Discussion	N/A
Forms, Figures and Tables	
C-102	Exhibit C-1
Tracts	Exhibit C-2
Summary of Interests, Unit Recapitulation (Tracts)	Exhibit C-3
General Location Map (including basin)	Exhibit D-1
Well Bore Location Map	Exhibit D-1
Structure Contour Map - Subsea Depth	Exhibit D-2
Cross Section Location Map (including wells)	Exhibit D-3
Cross Section (including Landing Zone)	Exhibit D-4
Additional Information	
Special Provisions/Stipulations	N/A
CERTIFICATION: I hereby certify that the information provided in this checklist is complete and accurate.	
Printed Name (Attorney or Party Representative):	Paula M. Vance
Signed Name (Attorney or Party Representative):	
Date:	7/5/2024

STATE OF NEW MEXICO
ENERGY, MINERALS AND NATURAL RESOURCES DEPARTMENT
OIL CONSERVATION DIVISION

APPLICATION OF AMEREDEV
OPERATING, LLC FOR
COMPULSORY POOLING,
LEA COUNTY, NEW MEXICO.

CASE NO. 24602

APPLICATION

Ameredev Operating, LLC (“Ameredev” or “Applicant”) (OGRID No. 372224), through its undersigned attorneys, hereby files this application with the Oil Conservation Division pursuant to the provisions of NMSA 1978, § 70-2-17, for an order pooling all uncommitted minerals owners in a standard 320-acre, more or less, horizontal well spacing unit in the Wolfcamp formation underlying the W/2 E/2 of Sections 3 and 10, Township 26 South, Range 36 East, NMPM, Lea County, New Mexico. In support of its application, Ameredev states:

1. Ameredev is a working interest owner in the proposed horizontal spacing unit and has the right to drill thereon.
2. Ameredev seeks to initially dedicate the above-referenced spacing unit to the proposed **Pimento Fed Com 26-36-03 106H**, to be horizontally drilled from a surface location in the NW/4 NE/4 (Unit B) of Section 3, a first take point from the NW/4 NE/4 (Unit B) of Section 3, to a bottom hole location in the SW/4 SE/4 (Unit O) of Section 10.
3. Ameredev has sought and been unable to obtain voluntary agreement for the development of these lands from all working interest owners, unleased mineral interest owners and non-participating royalty interest owners in the subject spacing unit.

4. The pooling of interests will allow Applicant to obtain a just and fair share of the oil and gas underlying the subject lands, avoid the drilling of unnecessary wells, will prevent waste, and will protect correlative rights.

WHEREFORE, Applicant requests that this application be set for hearing before an Examiner of the Oil Conservation Division on July 11, 2024, and, after notice and hearing as required by law, the Division enter an order:

- A. Pooling all uncommitted mineral owners in the horizontal spacing unit;
- B. Designating Ameredev Operating, LLC operator of this spacing unit and the horizontal well to be drilled thereon;
- C. Authorizing Ameredev to recover its costs of drilling, completing, and equipping the well;
- D. Approving the actual operating charges and costs of supervision while drilling and after completion, together with a provision adjusting the rates pursuant to the COPAS accounting procedures; and
- E. Imposing a 200% charge for the risk assumed by Ameredev in drilling and completing the well against any working interest owner who does not voluntarily participate in the drilling of the well.

Respectfully submitted,

HOLLAND & HART LLP

By:  _____

Michael H. Feldewert
Adam G. Rankin
Paula M. Vance
Post Office Box 2208
Santa Fe, NM 87504
505-988-4421
505-983-6043 Facsimile
mfeldewert@hollandhart.com
agrarkin@hollandhart.com
pmvance@hollandhart.com

ATTORNEYS FOR AMEREDEV OPERATING, LLC

CASE ____: **Application of Ameredev Operating, LLC for Compulsory Pooling, Lea County, New Mexico.** Applicant in the above-styled cause seeks an order pooling all uncommitted mineral owners in a standard 320-acre, more or less, horizontal well spacing unit in the Wolfcamp formation underlying the W/2 E/2 of Sections 3 and 10, Township 26 South, Range 36 East, NMPM, Lea County, New Mexico. Ameredev seeks to initially dedicate the above-referenced spacing unit to the proposed **Pimento Fed Com 26-36-03 106H**, to be horizontally drilled from a surface location in the NW/4 NE/4 (Unit B) of Section 3, a first take point from the NW/4 NE/4 (Unit B) of Section 3, to a bottom hole location in the SW/4 SE/4 (Unit O) of Section 10. Also, to be considered will be the cost of drilling and completing the well and the allocation of the cost thereof as well as actual operating costs and charges for supervision, designation of Ameredev Operating, LLC as operator of the well, and a 200% charge for risk involved in drilling said well. Said area is located approximately 4 miles southwest of Jal, New Mexico.

**STATE OF NEW MEXICO
ENERGY, MINERALS AND NATURAL RESOURCES DEPARTMENT
OIL CONSERVATION DIVISION**

**APPLICATIONS OF AMEREDEV
OPERATING, LLC FOR
COMPULSORY POOLING,
LEA COUNTY, NEW MEXICO.**

CASE NO. 24602

SELF-AFFIRMED STATEMENT OF BRANDON FORTEZA

1. My name is Brandon Forteza. I work for Ameredev Operating, LLC (“Ameredev”) as a Senior Landman.

2. I have previously testified before the New Mexico Oil Conservation Division (“Division”) as an expert witness in petroleum land matters. My credentials as a petroleum landman have been accepted by the Division and made a matter of record.

3. I am familiar with the application filed by Ameredev in this case, and I am familiar with the status of the lands in the subject area.

4. None of the uncommitted parties in this case have indicated opposition to proceeding by self-affirmed statement and, therefore, I do not expect any opposition at the hearing.

5. In this case, Ameredev seeks an order pooling all uncommitted minerals owners in a standard 320-acre, more or less, horizontal well spacing unit in the Wolfcamp formation underlying the W/2 E/2 of Sections 3 and 10, Township 26 South, Range 36 East, NMPM, Lea County, New Mexico. Ameredev seeks to initially dedicate the above-referenced spacing unit to the proposed **Pimento Fed Com 26-36-03 106H** (API: 30-025-52799), to be horizontally drilled from a surface location in the NW/4 NE/4 (Unit B) of Section 3, a first take point from the NW/4 NE/4 (Unit B) of Section 3, to a bottom hole location in the SW/4 SE/4 (Unit O) of Section 10.

**BEFORE THE OIL CONSERVATION DIVISION
Santa Fe, New Mexico
Exhibit No. C
Submitted by: Ameredev Operating, LLC
Hearing Date: August 22, 2024
Case No. 24602**

6. **Ameredev Exhibit C-1** contains the C-102 for the proposed well. The exhibit shows that the wells will be assigned to the WC-025 G-09 S263619C, Wolfcamp [98234].

7. **Ameredev Exhibit C-2** is an exhibit prepared by me that identifies the tracts of land comprising the proposed horizontal spacing unit in this case. The proposed spacing unit includes federal and fee land.

8. **Ameredev Exhibit C-3** shows the interest owners and the percentage of their interest by tract. A unit recapitulation, showing the percentage of ownership interests in the proposed spacing unit, is also included in the exhibit. Ameredev is seeking to pool the uncommitted interest owners with an asterisk next to their name.

9. There are no depth severances in the Wolfcamp formation.

10. **Ameredev Exhibit C-4** is a sample of the well proposal letter and AFEs sent to all working interest owners, along with sample lease offer sent to the unleased mineral interest owners. The costs reflected in the AFEs are consistent with what Ameredev and other operators have incurred for drilling similar horizontal wells in the area. Additionally, Ameredev requests overhead and administrative rates of \$7,000 per month for drilling and \$700 per month for a producing well. These rates are consistent with the rates charged by Ameredev and other operators for wells of this type in this area.

11. **Ameredev Exhibit C-5** contains a general summary of the contacts with the uncommitted interest owners. As indicated in the exhibit, Ameredev has made a good faith effort to locate and has had communications with most of the parties that it seeks to pool in this case in an effort to reach voluntary joinder. Ameredev was unable to locate six of the parties; Ameredev tried multiple addresses for these unlocatable parties and was unable to make contact but has

continued efforts to try and reach them. In my opinion, Ameredev has undertaken good faith efforts to reach an agreement with the uncommitted interest owners.

12. Ameredev has provided the law firm of Holland & Hart LLP with the names and addresses of the parties that Ameredev seeks to pool and instructed that they be notified of this hearing. Ameredev has conducted a diligent search of all public records in the county where the property is located, reviewed telephone directories, and conducted computer searches to locate contact information for each interest owner.

13. Ameredev Exhibits C-1 through C-5 were either prepared by me or compiled under my direction and supervision.

14. I affirm under penalty of perjury under the laws of the State of New Mexico that the foregoing statements are true and correct. I understand that this self-affirmed statement will be used as written testimony in this case. This statement is made on the date next to my signature below.



Brandon Forteza

11/5/24

Date

District I
1625 N. French Dr., Hobbs, NM 88240
Phone: (575) 393-6161 Fax: (575) 393-0720
District II
811 S. First St., Artesia, NM 88210
Phone: (575) 748-1283 Fax: (575) 748-9720
District III
1000 Rio Brazos Road, Aztec, NM 87410
Phone: (505) 334-6178 Fax: (505) 334-6170
District IV
1220 S. St. Francis Dr., Santa Fe, NM 87505
Phone: (505) 476-3460 Fax: (505) 476-3462

State of New Mexico
Energy, Minerals & Natural Resources
Department
OIL CONSERVATION DIVISION
1220 South St. Francis Dr.
Santa Fe, NM 87505

Submitted by: Amerdev Operating, LLC
Hearing Date: August 22, 2024
Revised August 1, 2011
Case No. 24602

Submit one copy to appropriate
District Office

AMENDED REPORT

WELL LOCATION AND ACREAGE DEDICATION PLAT

¹ API Number 30-025-52799		² Pool Code 98234		³ Pool Name WC-025 G-09 S263619C; WOLFCAMP					
⁴ Property Code 325012		⁵ Property Name PIMENTO FED COM 26 36 03			⁶ Well Number 106H				
⁷ OGRID No. 37224		⁸ Operator Name AMEREDEV OPERATING, LLC.			⁹ Elevation 3001'				
¹⁰ Surface Location									
UL or lot no. B	Section 3	Township 26-S	Range 36-E	Lot Idn -	Feet from the 160'	North/South line NORTH	Feet from the 2144'	East/West line EAST	County LEA
¹¹ Bottom Hole Location If Different From Surface									
UL or lot no. 0	Section 10	Township 26-S	Range 36-E	Lot Idn -	Feet from the 50'	North/South line SOUTH	Feet from the 2040'	East/West line EAST	County LEA
¹² Dedicated Acres 320		¹³ Joint or Infill		¹⁴ Consolidation Code		¹⁵ Order No.			

No allowable will be assigned to this completion until all interests have been consolidated or a non-standard unit has been approved by the division.

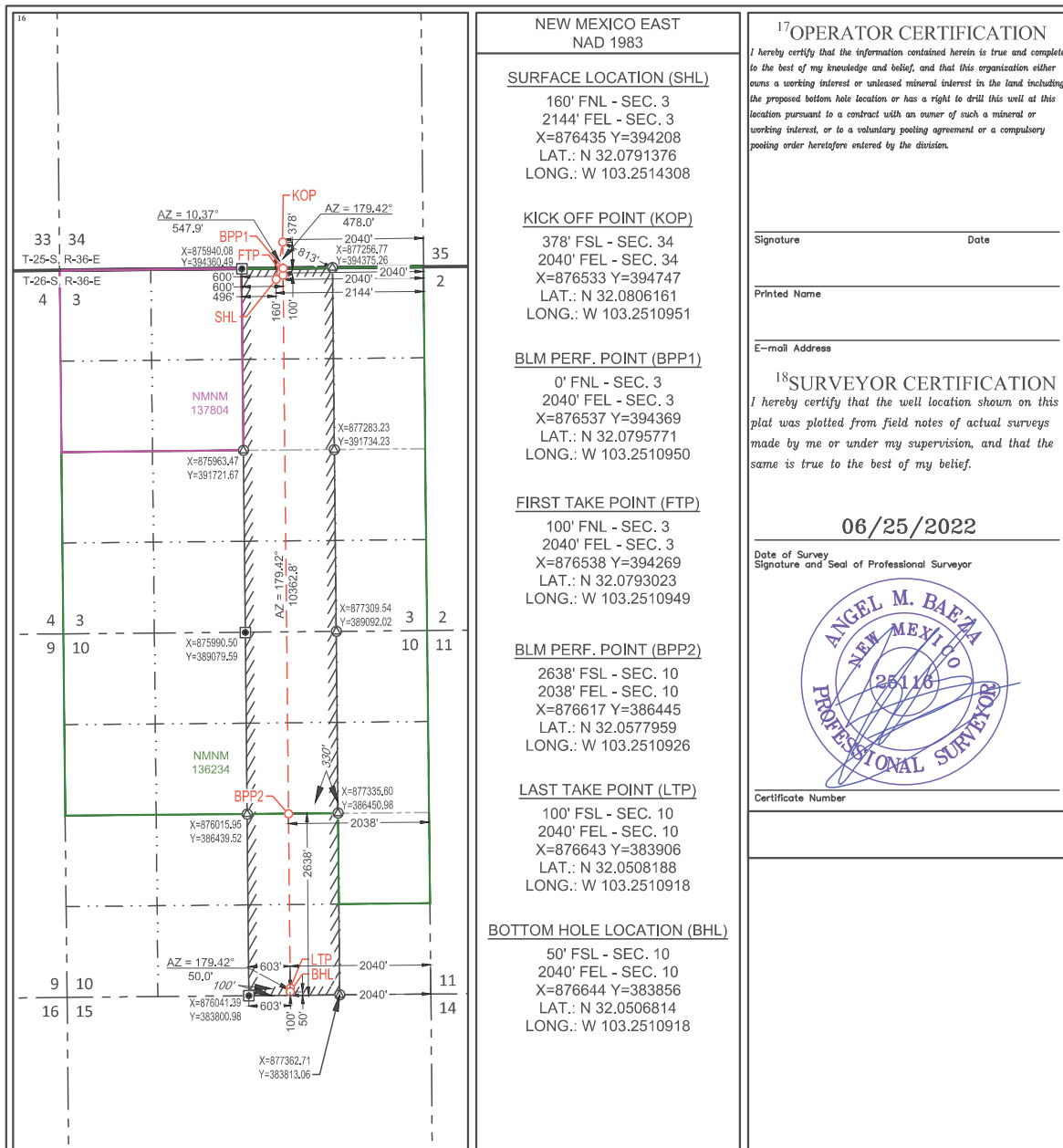

NEW MEXICO EAST
NAD 1983

SURFACE LOCATION (SHL)
160' FNL - SEC. 3
2144' FEL - SEC. 3
X=876435 Y=394208
LAT.: N 32.0791376
LONG.: W 103.2514308

KICK OFF POINT (KOP)
378' FSL - SEC. 34
2040' FEL - SEC. 34
X=876533 Y=394747
LAT.: N 32.0806161
LONG.: W 103.2510951

BLM PERF. POINT (BPP1)
0' FNL - SEC. 3
2040' FEL - SEC. 3
X=876537 Y=394369
LAT.: N 32.0795771
LONG.: W 103.2510950

FIRST TAKE POINT (FTP)
100' FNL - SEC. 3
2040' FEL - SEC. 3
X=876538 Y=394269
LAT.: N 32.0793023
LONG.: W 103.2510949

BLM PERF. POINT (BPP2)
2638' FSL - SEC. 10
2038' FEL - SEC. 10
X=876617 Y=386445
LAT.: N 32.0577959
LONG.: W 103.2510926

LAST TAKE POINT (LTP)
100' FSL - SEC. 10
2040' FEL - SEC. 10
X=876643 Y=383906
LAT.: N 32.0508188
LONG.: W 103.2510918

BOTTOM HOLE LOCATION (BHL)
50' FSL - SEC. 10
2040' FEL - SEC. 10
X=876644 Y=383856
LAT.: N 32.0506814
LONG.: W 103.2510918

¹⁷OPERATOR CERTIFICATION
I hereby certify that the information contained herein is true and complete to the best of my knowledge and belief, and that this organization either owns a working interest or unleased mineral interest in the land including the proposed bottom hole location or has a right to drill this well at this location pursuant to a contract with an owner of such a mineral or working interest, or to a voluntary pooling agreement or a compulsory pooling order heretofore entered by the division.

Signature _____ Date _____

Printed Name _____

E-mail Address _____

¹⁸SURVEYOR CERTIFICATION
I hereby certify that the well location shown on this plat was plotted from field notes of actual surveys made by me or under my supervision, and that the same is true to the best of my belief.

06/25/2022

Date of Survey
Signature and Seal of Professional Surveyor

Certificate Number _____

**PIMENTO FED COM 26-36-03 106H
T26S-R36E-SECTION 3 AND 10, W2E2
LEA COUNTY, NEW MEXICO**

SEC 3	TRACT 1 W2E2 SEC 3 W2NE4 SEC 10 240.00 ACRES NMNM 136234	
SEC 10		
	TRACT 3 NW4SE4 40.00 ACRES	
	TRACT 2 SW4SE4 40.00 ACRES	

**BEFORE THE OIL CONSERVATION DIVISION
Santa Fe, New Mexico
Exhibit No. C-2
Submitted by: Ameredev Operating, LLC
Hearing Date: August 22, 2024
Case No. 24602**

**PIMENTO FED COM 26-36-03 106H
T26S-R36E-SECTION 3 AND 10, W2E2
LEA COUNTY, NEW MEXICO**

TRACT 1: W2E2 OF SECTION 3 AND W2NE4 OF SECTION 10 26S 36E

AMEREDEV NEW MEXICO, LLC	100.0000%
TOTAL	100.0000%

TRACT 2: SW4SE4 OF SECTION 10 26S 36E

ISAACS FAMILY LIMITED PARTNERSHIP	0.5556%
QUAIL CREEK ROYALTY, LLC	0.5556%
OXY USA WTP LIMITED PARTNERSHIP	16.6667%
JOE N. GIFFORD	4.2188%
DOORNBOS MINERAL PARTNERS, LLC	2.7778%
REALEZA DEL SPEAR, LP	0.3571%
AMEREDEV NEW MEXICO, LLC	74.8686%
TOTAL	100.0000%

TRACT 3: NW4SE4 OF SECTION 10 26S 36E

JOE N. GIFFORD	4.2188%
REALEZA DEL SPEAR, LP	7.6488%
ALLIANCE LAND AND MINERALS, LLC	1.3875%
PANHANDLE PROPERTIES LLC	1.3875%
SUBTERRA RESOURCES, LLC	1.3216%
PLAYA RESOURCES, LLC	2.5293%
OLLI OPERATING, LLC	1.3917%
ELISE DELGADO	0.1302%
CANDACE DELGADO	0.0977%
SYLVIA DELGADO	0.0977%
Dan Risku	NPRI
Albert Schaefer	NPRI
Allen Vance Bickley	NPRI
Alma Schessler	NPRI
Alvin Schaefer	NPRI
Anna Marie Neerman	NPRI
Barbara June Bickley	NPRI
Byron E. Prather	NPRI
Candis Loving	NPRI
CANDLEWOOD RESOURCES LLC	NPRI
Cari Loving fka Cari Ferguson	NPRI
Cassandra Jensen	NPRI
Chris Scovill	NPRI
Christine (Winkle) Carpenter	NPRI
Clarence H. Schaefer	NPRI
Concordia Stratman	NPRI
Corine Schmitt	NPRI

BEFORE THE OIL CONSERVATION DIVISION
Santa Fe, New Mexico
Revised Exhibit No. C-3
Submitted by: Ameredev Operating, LLC
Hearing Date: August 22, 2024
Case No. 24602

CUATRO ROJOS LLC	NPRI
Dave Risku	NPRI
David Glenn Winkle	NPRI
Debra (Winkle) McMackin	NPRI
Donna (Risku) Ribich	NPRI
Dr. Herbert Senne	NPRI
Edna Schaefer	NPRI
Edwin Schaefer	NPRI
Elsie Shulties	NPRI
Erma Hoffman	NPRI
Estate of Charles Jaakola c/o Jeanne Jaakola	NPRI
Esther Krueger	NPRI
Ethel Glidewell	NPRI
Ette Frommer	NPRI
Florence Senne	NPRI
Frank Dunn	NPRI
Gertrude (Wipperman) Renken	NPRI
Gregg Gosting	NPRI
HAZEL HOGAN RIFFEL	NPRI
Heirs/assigns Susan Mowder, dec'd	NPRI
HENRY A. FELT JR.	NPRI
Hilda Frey	NPRI
Imogene Marie Dunn	NPRI
JANELLE LUNDE	NPRI
John Mowder	NPRI
JOSEPH MARK GREGORY	NPRI
JOSEPHY LEROY HAYNES AND WIFE, CAROL HAYNES	NPRI
Julie (Winkle) Howard	NPRI
Julie Kloess	NPRI
KAREN P. SAUNDERS DORSEY	NPRI
Karen Scovill McKelvey	NPRI
Kevin Loving	NPRI
Larry Dunn	NPRI
Laura Schmitt	NPRI
LINDA CAROL HAYNES	NPRI
LUCY K. SCHMITT	NPRI
MATTHEW JAKKOLA	NPRI
Nancy Dunn	NPRI
Nicholas G Kanelakos	NPRI
Pat Mowder	NPRI
PATCH ENERGY, LLC	NPRI
Paul Schaefer	NPRI
PAULINE MOWDER	NPRI
PRELLY MINERALS LLC	NPRI
Rev Arthur Senne	NPRI
Ruth McConnell	NPRI
Ruth Van Liew	NPRI

SHANNON SMITH	NPRI
STANDARD ROYATLY CORPORATION	NPRI
SUSAN MOWDER	NPRI
THOMAS JAAKOLA	NPRI
Tim Dunn	NPRI
Tim Scovill	NPRI
AMEREDEV NEW MEXICO, LLC	79.7893%
TOTAL	#REF!

**UNIT RECAPITULATION
PIMENTO FED COM 26-36-03 106H
T26S-R36E-SECTION 3 AND 10, E2W2
LEA COUNTY, NEW MEXICO**

*ISAACS FAMILY LIMITED PARTNERSHIP	0.0694%
*QUAIL CREEK ROYALTY, LLC	0.0694%
*OXY USA WTP LIMITED PARTNERSHIP	2.0833%
*JOE N. GIFFORD	1.0547%
*DOORNBOS MINERAL PARTNERS, LLC	0.3472%
*REALEZA DEL SPEAR, LP	1.0007%
*ALLIANCE LAND AND MINERALS, LLC	0.1734%
*PANHANDLE PROPERTIES LLC	0.1734%
*SUBTERRA RESOURCES, LLC	0.1652%
*PLAYA RESOURCES, LLC	0.3162%
*OLLI OPERATING, LLC	0.1740%
*ELISE DELGADO	0.0163%
*CANDACE DELGADO	0.0122%
*SYLVIA DELGADO	0.0122%
* Dan Risku	NPRI
*Albert Schaefer	NPRI
*Allen Vance Bickley	NPRI
*Alma Schessler	NPRI
*Alvin Schaefer	NPRI
*Anna Marie Neerman	NPRI
*Barbara June Bickley	NPRI
*Byron E. Prather	NPRI
*Candis Loving	NPRI
*CANDLEWOOD RESOURCES LLC	NPRI
*Cari Loving fka Cari Ferguson	NPRI
*Cassandra Jensen	NPRI
*Chris Scovill	NPRI
*Christine (Winkle) Carpenter	NPRI
*Clarence H. Schaefer	NPRI
*Concordia Stratman	NPRI
*Corine Schmitt	NPRI
*CUATRO ROJOS LLC	NPRI

*Dave Risku	NPRI
*David Glenn Winkle	NPRI
*Debra (Winkle) McMackin	NPRI
*Donna (Risku) Ribich	NPRI
*Dr. Herbert Senne	NPRI
*Edna Schaefer	NPRI
*Edwin Schaefer	NPRI
*Elsie Shulties	NPRI
*Erma Hoffman	NPRI
*Estate of Charles Jaakola c/o Jeanne Jaakola	NPRI
*Esther Krueger	NPRI
*Ethel Glidewell	NPRI
*Ette Frommer	NPRI
*Florence Senne	NPRI
*Frank Dunn	NPRI
*Gertrude (Wipperman) Renken	NPRI
*Gregg Gosting	NPRI
*HAZEL HOGAN RIFFEL	NPRI
*Heirs/assigns Susan Mowder, dec'd	NPRI
*HENRY A. FELT JR.	NPRI
*Hilda Frey	NPRI
*Imogene Marie Dunn	NPRI
*JANELLE LUNDE	NPRI
*John Mowder	NPRI
*JOSEPH MARK GREGORY	NPRI
*JOSEPHY LEROY HAYNES AND WIFE, CAROL HAYNES	NPRI
*Julie (Winkle) Howard	NPRI
*Julie Kloess	NPRI
*KAREN P. SAUNDERS DORSEY	NPRI
*Karen Scovill McKelvey	NPRI
*Kevin Loving	NPRI
*Larry Dunn	NPRI
*Laura Schmitt	NPRI
*LINDA CAROL HAYNES	NPRI
*LUCY K. SCHMITT	NPRI
*MATTHEW JAKKOLA	NPRI
*Nancy Dunn	NPRI
*Nicholas G Kanelakos	NPRI
*Pat Mowder	NPRI
*PATCH ENERGY, LLC	NPRI
*Paul Schaefer	NPRI
*PAULINE MOWDER	NPRI
*PRELLY MINERALS LLC	NPRI
*Rev Arthur Senne	NPRI
*Ruth McConnell	NPRI
*Ruth Van Liew	NPRI
*SHANNON SMITH	NPRI

*STANDARD ROYATLY CORPORATION	NPRI
*SUSAN MOWDER	NPRI
*THOMAS JAAKOLA	NPRI
*Tim Dunn	NPRI
*Tim Scovill	NPRI
AMEREDEV NEW MEXICO, LLC	94.3322%
TOTAL	100.0000%
*INTEREST SEEKING TO FORCE POOL	

Ameredev II, LLC
2901 Via Fortune, Suite 600
Austin, Texas 78746



April 12, 2024

Via Certified Return Receipt Mail

CAROLYN MICHELLE BECKHAM
425 EAGLE
LAKEWAY, TX 78734

RE: Pimento Fed Com 26-36-03 #106H and #113H Well Proposal
Sections 3 and 10
Township 26 South, Range 36 East, N.M.P.M., Lea County, New Mexico

Dear Owner:

Ameredev Operating, LLC (“Ameredev”), as Operator, hereby proposes to commence to drill and complete the following horizontal wells, testing the Wolfcamp formation at applicable lease surface locations in Section 3, T26S-36E with bottom hole locations in Section 10, T26S-R36E, Lea County, New Mexico (collectively, the “Operation”). The proposed wells will fall within two 320.00-acre spacing units all located in Sections 3 and 10 of Township 26S, Range 36E, Lea County, NM:

- E2W2 (Pimento Fed Com 26-36-03 #113H)
- W2E2 (Pimento Fed Com 26-36-03 #106H)

Proposed Wells:

- 1) Pimento Fed Com 26-36-03 #113H to be drilled to a depth sufficient to test the Wolfcamp formation at an approximate total vertical depth of 11,379 feet and a measured depth of 22,137 feet. The surface location for this well is proposed at a legal location in unit letter C of Section 3, T26S, R36-E and a bottom hole location at a legal location in unit letter N of Section 10, T26S-36E. The estimated cost to drill and complete said well is \$13,158,833.85, as shown on the attached authority for expenditure (“AFE”).
- 2) Pimento Fed Com 26-36-03 #106H to be drilled to a depth sufficient to test the Wolfcamp formation at an approximate total vertical depth of 11,150’ feet and a measured depth of 22,015’ feet. The surface location for this well is proposed at a legal location in Lot B (UL B) of Section 3, T26S, R36-E and a bottom hole location at a legal location in unit letter O of Section 10, T26S-36E. The estimated cost to drill and complete said well is \$13,158,833.85 as shown on the attached authority for expenditure (“AFE”).

Our records indicate that you own a 0.01227679 unleased mineral interest within the E2SW4, SW4SE4, NW4SE4 of Section 10, T26S-R36E, which falls within the spacing unit of the Operation. As a mineral interest owner, you have the following options:

- 1) Lease your mineral interest to Ameredev and receive revenues from the Operations as a royalty interest owner. Royalty interest owners are subject to their proportionate share of revenues pursuant to the lease’s royalty rate and are not responsible for any of the costs associated with the drilling and completing of the Operation; or
- 2) Participate in the Operations as a working interest owner. Working interest owners are responsible to pay their proportionate share of expenses with the drilling and completing of the Operation.

In the event you wish to lease your mineral interest, Ameredev hereby offers the following lease terms:

Legal Description: E2SW4, SW4SE4,NW4SE4 of Section 10, T26S-R36E, N.M.P.M Lea County, NM
Mineral Interest: 0.01227679 (1.96428571 net acres)
Bonus: \$2,000/net acres
Term: 3 years
Royalty Rate: 25%
Lease Form: Enclosed

Upon acceptance of this lease offer please execute the enclosed Oil, Gas & Mineral Lease in front of a notary public. The following documents are to be returned to the attention of the undersigned:

- 1.) Signed letter indicated acceptance of the aforementioned lease offer
- 2.) Fully executed and notarized Oil, Gas & Mineral Lease Form
- 3.) Fully executed W-9 form

The terms of this lease offer are subject to confirmation of record title ownership and may be rescinded at any time. The lease offer shall expire on **Sunday, May 12th ,2024.**

In the event you choose to participate in the Operation as a working interest owner, Ameredev proposes the Operation to be governed by the 2015 Horizontal AAPL Form 610 Operating Agreement (“OA”) with the following terms:

- Contract Area consisting of the following all in Sections 3 and 10 of Township 26 South, Range 36 East, N.M.P.M., Lea County, New Mexico, with Ameredev listed as the Operator (“Contract Area”):
 - E2W2
 - W2E2
- 100%/300%/300% non-consent risk penalties
- \$7,000/\$700 drilling and producing overhead rates

Please indicate your election on the following page and return the executed letter to the attention of the undersigned. In the interest of time, if we do not reach an agreement within thirty (30) days of the date of this letter, Ameredev will apply to the New Mexico Oil Conservation Division for compulsory pooling of your interest into a horizontal spacing unit for the proposed Operation.

Thank you for your consideration of our proposal. If you have any questions, please contact me at 737-300-4721 or bforteza@ameredev.com. Ameredev looks forward to working with you on this matter.

Sincerely,



Brandon Forteza

This portion shall be completed if you choose to LEASE your mineral interest:

The undersigned hereby accepts Ameredev's offer to lease its mineral interest per the terms of the letter dated April 12, 2024

Executed this _____ day of _____, 2024.

CAROLYN MICHELLE BECKHAM

This portion shall be completed if you choose to PARTICIPATE as a working interest owner:

Election Ballot for the Pimento Fed Com 26-36-03 #106H Well Proposal (AFE# 2024-011)

_____ CAROLYN MICHELLE BECKHAM elects to participate in the proposed Operation by paying its proportionate share of the costs outlined in the AFE 2024-011.

_____ CAROLYN MICHELLE BECKHAM elects to not participate in the proposed Operation.

Executed this _____ day of _____, 2024.

By: CAROLYN MICHELLE BECKHAM

Its:

Election Ballot for the Pimento Fed Com 26-36-03 #113H Well Proposal (AFE# 2024-012)

_____ CAROLYN MICHELLE BECKHAM elects to participate in the proposed Operation by paying its proportionate share of the costs outlined in the AFE 2024-012.

_____ CAROLYN MICHELLE BECKHAM elects to not participate in the proposed Operation.

Executed this _____ day of _____, 2024.

By: CAROLYN MICHELLE BECKHAM

Its:



Lea County, NM

Pimento Fed Com 26-36-03 106H

**2024-011
Single Well Project
4/11/2024**

Ameredev Operating, LLC
2901 Via Fortuna Suite 600, Austin, TX 78746



Amerdev II, LLC

Company Entity	Date Prepared
Amerdev Operating, LLC	April 11, 2024

AFE Type	Project	Field Name	Cost Center	AFE No.
Capital	Pimento Fed Com 26-36-03 106H	Delaware	40436	2024-011

Location	County	State	Well Type	
SHL: Sec. 3 26S-36E 160' FNL & 2144' FEL BHL: Sec. 10 26S-36E 50' FSL & 2040' FEL	Lea	NM	<i>Oil</i>	<i>Prod</i>

Estimate Type	Start Date	Completion Date	Formation	MD
<i>Original</i>	July 1, 2024	December 1, 2024	Wolfcamp XY	22,015'
				TVD
				11,150'

Project Description
 Drill ~10,000' Wolfcamp lateral. Complete with ~2200 PPF. Drill out plugs and run tubing with gas lift. Tie in to the Firethorn Central Tank Battery. This well will flow to a new satellite.

Total Cost **\$13,158,833.85**

Comments on Associated Costs
 Included costs for satellite pad if well goes through a satellite. This is split respectively on the number of wells that are going through the satellite.

Comments on AFE
 The above costs are estimates only and anticipate trouble free operations without any foreseeable change in plans. The actual costs may exceed the estimated costs without affecting the authorization for expenditure herein granted. By approval of this AFE, the working interest owner agrees to pay its proportionate share of actual legal, curative, regulatory, and well costs under term of the joint operating agreement, regulatory order, or other applicable agreement covering this well.

Well Control Insurance
 Unless otherwise indicated below, you, as a non-operating working interest owner, agree to be covered by Operator's well control insurance procured by Operator so long as Operator conducts operations hereunder and to pay your prorated share of the premiums therefore. If you elect to purchase your own well control insurance, you must provide a certificate of such insurance acceptable to Operator, as to form and limits, at the time this AFE is returned, if available, but in no event later than commencement of drilling operations. You agree that failure to provide the certificate of insurance, as provided herein, will result in your being covered by insurance procured by Operator.

I elect to purchase my own well control insurance policy.

Well control insurance procured by Operator, provides, among other terms, for \$20,000,000 (100% W.I.) of Combined Single Limit coverage for well control and related redrilling and clean-up/pollution expense covering drilling (through completion) with a \$250,000 (100% W.I.) retention.

Marketing Election

Amerdev sells its gas under arm's-length contracts with third party purchasers. Such contracts may include fees. In addition, penalties may be incurred for insufficient volumes delivered over time. Should you choose to market your share of gas with Amerdev, you will be subject to all of the terms of such contracts. Upon written request to Amerdev, we will share with you the terms and conditions pursuant to which gas will be sold.

I elect to take my gas in kind.
 I elect to market my gas with Amerdev pursuant to the terms and conditions of its contracts.

Joint Interest Approval

Company	Approved By	Date



Single Well Project

Pimento Fed Com 26-36-03 106H Delaware

Intangibles	Code	Drilling	Geology	Dry Hole Cost	Stimulation	Post Completion	Const / Facilities	Production	Workover	After Casing Point Cost	Total Cost
MISC PREPARATION COSTS	4	\$ 46,924.56	\$ -	\$ 46,924.56	\$ -	\$ -	\$ -	\$ -	\$ -	\$ -	\$ 46,924.56
EASEMENT, ROW, AND ACQUISITION	6	\$ -	\$ -	\$ -	\$ -	\$ -	\$ 55,637.57	\$ -	\$ -	\$ 55,637.57	\$ 55,638
ROAD / LOCATION PREP / RESTORATION	8	\$ -	\$ -	\$ -	\$ 32,565.88	\$ -	\$ 240,942.67	\$ -	\$ -	\$ 273,508.55	\$ 273,509
DRILLING RIG	10	\$ 893,000.00	\$ -	\$ 893,000.00	\$ -	\$ 44,400.00	\$ -	\$ -	\$ -	\$ 44,400.00	\$ 937,400
COIL TUBING	12	\$ -	\$ -	\$ -	\$ -	\$ 165,306.75	\$ -	\$ -	\$ -	\$ 165,306.75	\$ 165,307
FUEL	16	\$ 121,837.50	\$ -	\$ 121,837.50	\$ 594,792.50	\$ 21,378.42	\$ -	\$ -	\$ -	\$ 616,170.92	\$ 738,008.42
MUD FUEL	17	\$ 74,100.00	\$ -	\$ 74,100.00	\$ -	\$ -	\$ -	\$ -	\$ -	\$ -	\$ 74,100.00
TRAILER, CAMP, AND CATERING	18	\$ 54,000.00	\$ -	\$ 54,000.00	\$ 11,526.66	\$ 3,750.00	\$ -	\$ -	\$ -	\$ 15,276.66	\$ 69,277
SURFACE RENTALS	24	\$ 149,834.00	\$ -	\$ 149,834.00	\$ 55,847.33	\$ 16,892.00	\$ -	\$ -	\$ -	\$ 72,739.33	\$ 222,573.33
DRILL BITS	28	\$ 114,587.29	\$ -	\$ 114,587.29	\$ -	\$ 3,500.00	\$ -	\$ -	\$ -	\$ 3,500.00	\$ 118,087.29
DOWNHOLE RENTALS	30	\$ 28,531.76	\$ -	\$ 28,531.76	\$ -	\$ 56,000.00	\$ -	\$ -	\$ -	\$ 56,000.00	\$ 84,532
DIRECTIONAL DRILLING	32	\$ 244,921.41	\$ -	\$ 244,921.41	\$ -	\$ -	\$ -	\$ -	\$ -	\$ -	\$ 244,921
COMPOSITE PLUGS	34	\$ -	\$ -	\$ -	\$ 45,900.00	\$ -	\$ -	\$ -	\$ -	\$ 45,900.00	\$ 45,900
TUBING & BHA INSPECT & REPAIR	42	\$ 40,414.88	\$ -	\$ 40,414.88	\$ -	\$ -	\$ -	\$ -	\$ -	\$ -	\$ 40,415
RENTAL TUBING	46	\$ 46,893.18	\$ -	\$ 46,893.18	\$ -	\$ -	\$ -	\$ -	\$ -	\$ -	\$ 46,893
WELL CONTROL EQUIP / SERVICES	48	\$ 45,317.41	\$ -	\$ 45,317.41	\$ 230,166.62	\$ 25,388.34	\$ -	\$ -	\$ -	\$ 255,554.96	\$ 300,872
MUD AND ADDITIVES	60	\$ 146,221.34	\$ -	\$ 146,221.34	\$ 375,619.30	\$ 13,986.04	\$ -	\$ -	\$ -	\$ 389,605.34	\$ 535,827
FRAC PUMPING CHARGES	61	\$ -	\$ -	\$ -	\$ 2,098,976.00	\$ -	\$ -	\$ -	\$ -	\$ 2,098,976.00	\$ 2,098,976
WATER RIGHTS / TRANSFER / STORAGE	62	\$ 39,925.00	\$ -	\$ 39,925.00	\$ 511,528.44	\$ -	\$ 97,717.18	\$ -	\$ -	\$ 609,245.62	\$ 649,171
SOLIDS CONTROL EQUIP / SERVICES	66	\$ 93,009.90	\$ -	\$ 93,009.90	\$ -	\$ -	\$ -	\$ -	\$ -	\$ -	\$ 93,010
MUD / FLUIDS DISPOSAL CHARGES	68	\$ 152,370.82	\$ -	\$ 152,370.82	\$ 4,500.00	\$ 28,865.27	\$ -	\$ -	\$ -	\$ 33,365.27	\$ 185,736
CASING CREWS	70	\$ 59,226.89	\$ -	\$ 59,226.89	\$ -	\$ -	\$ -	\$ -	\$ -	\$ -	\$ 59,227
CEMENTING	72	\$ 298,276.33	\$ -	\$ 298,276.33	\$ -	\$ -	\$ -	\$ -	\$ -	\$ -	\$ 298,276
MOBILIZE & DEMOBILIZE	86	\$ 211,380.01	\$ -	\$ 211,380.01	\$ -	\$ -	\$ -	\$ -	\$ -	\$ -	\$ 211,380
SUPERVISION / COMPANY	92	\$ 10,000.00	\$ -	\$ 10,000.00	\$ -	\$ -	\$ -	\$ -	\$ -	\$ -	\$ 10,000.00
SUPERVISION / CONTRACT	94	\$ 68,400.00	\$ -	\$ 68,400.00	\$ 74,250.00	\$ 18,230.00	\$ 52,500.00	\$ -	\$ -	\$ 144,980.00	\$ 213,380
ENGINEERING / CONSULTANT	102	\$ 109,683.27	\$ -	\$ 109,683.27	\$ -	\$ -	\$ 9,000.00	\$ -	\$ -	\$ 9,000.00	\$ 118,683.27
CONTRACT ROUSTABOUT	103	\$ 16,091.15	\$ -	\$ 16,091.15	\$ -	\$ -	\$ -	\$ -	\$ -	\$ -	\$ 16,091
CONTRACT LANDWORK / SURVEY	114	\$ -	\$ -	\$ -	\$ -	\$ -	\$ 53,666.67	\$ -	\$ -	\$ 53,666.67	\$ 53,666.67
NONDESTRUCTIVE WELD TESTING	118	\$ -	\$ -	\$ -	\$ -	\$ -	\$ 6,122.67	\$ -	\$ -	\$ 6,122.67	\$ 6,122.67
CONSTRUCTION LABOR	120	\$ -	\$ -	\$ -	\$ -	\$ -	\$ 33,091.67	\$ -	\$ -	\$ 33,091.67	\$ 33,091.67
REGULTRY / ENVIRON CONSULTANT	122	\$ -	\$ -	\$ -	\$ -	\$ -	\$ 6,500.00	\$ -	\$ -	\$ 6,500.00	\$ 6,500.00
SAFETY AND EMERGENCY RESPONSE	124	\$ 3,800.00	\$ -	\$ 3,800.00	\$ 80,694.16	\$ 21,700.86	\$ -	\$ -	\$ -	\$ 102,395.01	\$ 106,195
PAINTING / INSULATION	128	\$ -	\$ -	\$ -	\$ -	\$ -	\$ 16,420.00	\$ -	\$ -	\$ 16,420.00	\$ 16,420.00
WELDING & MATERIALS	138	\$ 2,769.20	\$ -	\$ 2,769.20	\$ -	\$ -	\$ 18,985.00	\$ -	\$ -	\$ 18,985.00	\$ 21,754.20
GASLIFT / FLOW LINE CONSTRUCTION	144	\$ -	\$ -	\$ -	\$ -	\$ -	\$ 44,063.57	\$ -	\$ -	\$ 44,063.57	\$ 44,063.57
ENVIRONMENTAL / PERMITTING	172	\$ 10,500.00	\$ -	\$ 10,500.00	\$ -	\$ -	\$ -	\$ -	\$ -	\$ -	\$ 10,500.00
LEGAL / REGULATORY	182	\$ 4,960.00	\$ -	\$ 4,960.00	\$ -	\$ -	\$ -	\$ -	\$ -	\$ -	\$ 4,960.00
FLOW TESTING / EQUIP	194	\$ -	\$ -	\$ -	\$ -	\$ 66,706.46	\$ -	\$ -	\$ -	\$ 66,706.46	\$ 66,706.46
MUD LOGGING	198	\$ -	\$ 23,560.00	\$ 23,560.00	\$ -	\$ -	\$ -	\$ -	\$ -	\$ -	\$ 23,560
WIRESLINE / PERF / PUMPDOWN COSTS	200	\$ -	\$ -	\$ -	\$ 603,024.69	\$ 13,000.00	\$ -	\$ -	\$ -	\$ 616,024.69	\$ 616,025
SECONDARY CONTAINMENT	254	\$ -	\$ -	\$ -	\$ -	\$ -	\$ 7,097.14	\$ -	\$ -	\$ 7,097.14	\$ 7,097
OVERHEAD POWER	256	\$ -	\$ -	\$ -	\$ -	\$ -	\$ 53,034.00	\$ -	\$ -	\$ 53,034.00	\$ 53,034
FACILITY ELECTRIC & AUTOMATION	258	\$ -	\$ -	\$ -	\$ -	\$ -	\$ 226,199.00	\$ -	\$ -	\$ 226,199.00	\$ 226,199
ELECTRICAL	296	\$ -	\$ -	\$ -	\$ -	\$ -	\$ 61,600.00	\$ -	\$ -	\$ 61,600.00	\$ 61,600.00
TRANSPORTATION	326	\$ 97,000.00	\$ -	\$ 97,000.00	\$ -	\$ 9,630.00	\$ 5,333.33	\$ -	\$ -	\$ 14,963.33	\$ 111,963.33
VACUUM TRUCK	328	\$ 7,831.74	\$ -	\$ 7,831.74	\$ 2,000.00	\$ 25,255.19	\$ -	\$ -	\$ -	\$ 27,255.19	\$ 35,086.93
TRANSPORTATION / GATHERING EXP	378	\$ -	\$ -	\$ -	\$ -	\$ -	\$ 240.94	\$ -	\$ -	\$ 240.94	\$ 240.94
Sub Total		\$ 3,213,231.63	\$ 23,560.00	\$ 3,236,791.63	\$ 4,721,391.58	\$ 533,989.32	\$ 988,151.40	\$ -	\$ -	\$ 6,243,532.30	\$ 9,480,323.93
CONTINGENCY 3.00%		\$ 96,396.95	\$ 706.80	\$ 97,103.75	\$ 141,641.75	\$ 16,019.68	\$ 29,644.54	\$ -	\$ -	\$ 187,305.97	\$ 284,409.72
TAX 6.25%		\$ 200,826.98	\$ 1,472.50	\$ 202,299.48	\$ 295,086.97	\$ 33,374.33	\$ 61,759.46	\$ -	\$ -	\$ 390,220.77	\$ 592,520.25
Total Intangible Cost		\$ 3,510,455.55	\$ 25,739.30	\$ 3,536,194.85	\$ 5,158,120.30	\$ 583,383.34	\$ 1,079,555.41	\$ -	\$ -	\$ 6,821,059.04	\$ 10,357,253.90

Tangibles	Code	Drilling	Geology	Dry Hole Cost	Stimulation	Post Completion	Const / Facilities	Production	Workover	After Casing Point Cost	Total Cost
CASING / LINER / FLOAT EQUIPMENT	74	\$ 64,500.00	\$ -	\$ 64,500.00	\$ -	\$ -	\$ -	\$ -	\$ -	\$ -	\$ 64,500.00
SURFACE CASING	210	\$ 107,050.00	\$ -	\$ 107,050.00	\$ -	\$ -	\$ -	\$ -	\$ -	\$ -	\$ 107,050
INTERMEDIATE CASING	212	\$ 426,198.08	\$ -	\$ 426,198.08	\$ -	\$ -	\$ -	\$ -	\$ -	\$ -	\$ 426,198
PRODUCTION CASING	216	\$ 1,000,679.05	\$ -	\$ 1,000,679.05	\$ -	\$ -	\$ -	\$ -	\$ -	\$ -	\$ 1,000,679
TUBING	217	\$ -	\$ -	\$ -	\$ -	\$ 110,951.47	\$ -	\$ -	\$ -	\$ 110,951.47	\$ 110,951
WELLHEAD / TREE / CHOKES	218	\$ 105,451.12	\$ -	\$ 105,451.12	\$ -	\$ 187,605.07	\$ -	\$ -	\$ -	\$ 187,605.07	\$ 293,056.20
ISOLATION PACKER	222	\$ -	\$ -	\$ -	\$ -	\$ 13,959.09	\$ -	\$ -	\$ -	\$ 13,959.09	\$ 13,959.09
DOWNHOLE LIFT EQUIPMENT	234	\$ -	\$ -	\$ -	\$ -	\$ 12,000.00	\$ -	\$ -	\$ -	\$ 12,000.00	\$ 12,000
TANK BATT / PROCESS EQUIP / MAINT	236	\$ -	\$ -	\$ -	\$ -	\$ -	\$ 154,000.00	\$ -	\$ -	\$ 154,000.00	\$ 154,000
LINE PIPE	238	\$ -	\$ -	\$ -	\$ -	\$ -	\$ 37,503.33	\$ -	\$ -	\$ 37,503.33	\$ 37,503
FLOW LINE (PIPE WH TO FACILITY)	266	\$ -	\$ -	\$ -	\$ -	\$ -	\$ 54,966.67	\$ -	\$ -	\$ 54,966.67	\$ 54,967
PIPELINE TO SALES	270	\$ -	\$ -	\$ -	\$ -	\$ -	\$ 106,410.00	\$ -	\$ -	\$ 106,410.00	\$ 106,410
METERS AND METERING EQUIPMENT	274	\$ -	\$ -	\$ -	\$ -	\$ -	\$ 120,033.33	\$ -	\$ -	\$ 120,033.33	\$ 120,033
VALVES, FITTINGS, PROD INSTRUM	282	\$ -	\$ -	\$ -	\$ -	\$ -	\$ 63,068.02	\$ -	\$ -	\$ 63,068.02	\$ 63,068
Sub Total		\$ 1,703,878.26	\$ -	\$ 1,703,878.26	\$ -	\$ 324,515.63	\$ 535,981.35	\$ -	\$ -	\$ 860,496.98	\$ 2,564,375.24
CONTINGENCY 3.00%		\$ 51,116.35	\$ -	\$ 51,116.35	\$ -	\$ 9,735.47	\$ 16,079.44	\$ -	\$ -	\$ 25,814.91	\$ 76,931.26
TAX 6.25%		\$ 106,492.39	\$ -	\$ 106,492.39	\$ -	\$ 20,282.23	\$ 33,498.83	\$ -	\$ -	\$ 53,781.06	\$ 160,273.45
Total Tangible Cost		\$ 1,861,487.00	\$ -	\$ 1,861,487.00	\$ -	\$ 354,533.33	\$ 585,559.63	\$ -	\$ -	\$ 940,092.95	\$ 2,801,579.95
Total Cost		\$ 5,371,942.55	\$ 25,739.30	\$ 5,397,681.85	\$ 5,158,120.30	\$ 937,916.66	\$ 1,665,115.04	\$ -	\$ -	\$ 7,761,152.00	\$ 13,158,833.85

PIMENTO FED COM 26-36-03 106H Contacts

ISAACS FAMILY LIMITED PARTNERSHIP

- Has indicated will participate under force pooling order
- green card received 4/23/2024

QUAIL CREEK ROYALTY, LLC

- 4/16/2024 – mailed offer packet, did not receive a green card back
- 6/21/2024 – mailed 2nd packet to different address
- 07/1/2024 – continuing to try to locate
- – green card received 6/25/2024

OXY USA WTP LIMITED PARTNERSHIP

- 7/10/2024 – emailing with Leslie Mullin. OXY is evaluating its options
- green card received 4/18/2024

DOORNBOS MINERAL PARTNERS, LLC

- 4/16/2024 – mailed offer packet, did not receive a green card back – we did receive green card back 4/18/2024
- 6/21/2024 – mailed 2nd packet to different address
- 07/1/2024 – continuing to try to locate

REALEZA DEL SPEAR, LP

- Has indicated will participate under force pooling order– received green card back 4/24/2024

ALLIANCE LAND AND MINERALS, LLC

- Has indicated will participate under force pooling order

PANHANDLE PROPERTIES LLC

- Has indicated will participate under force pooling order

SUBTERRA RESOURCES, LLC

- Has indicated will participate under force pooling order – received green card 7/2/2024

PLAYA RESOURCES, LLC

- Has indicated will participate under force pooling order

PIMENTO FED COM 26-36-03 106H Contacts

OLLI OPERATING, LLC

- Has indicated will participate under force pooling order – received green card 4/18/2024

ELISE DELGADO

- 4/16/2024 – mailed offer packet, did not receive a green card back – Received green card 6/3/2024
- 6/21/2024 – mailed 2nd packet to different address
- 07/1/2024 – continuing to try to locate

CANDACE DELGADO

- 4/16/2024 – mailed offer packet, did not receive a green card back
- 6/21/2024 – mailed 2nd packet to different address
- 07/1/2024 – continuing to try to locate
- Still pending receipt of green card

SYLVIA DELGADO

- 4/16/2024 – mailed offer packet, did not receive a green card back
- 6/21/2024 – mailed 2nd packet to different address
- 07/1/2024 – continuing to try to locate
- Still pending receipt of green card

Owner	Notes 2nd Attempt	2nd Attempt 6/21/2024
BASCOM MITCHELL FAMILY PARTNERSHIP	LEASED	
CAROLYN MICHELLE BECKHAM	LEASED	
CARY ANTHONY	LEASED	
Doornbos Mineral Partners, LLC	RECEIVED - GREEN CARD BACK	
EARNELL BECKHAM YOUNG, INDIVIDUALLY	LEASED	
EARNELL BECKHAM YOUNG, LIFE ESTATE	LEASED	
GKT INVESTMENT PARTNERSHIP, LTD	LEASED	
ISSACS FAMILY LIMITED LIABILITY LIMITED PARTNERSHIP	PARTICIPATING	
JOE N GIFFORD AND EMILY GIFFORD	updated address 2nd attempt	7021 2720 0001 2621 5008
SITIO PERMIAN LP	LEASED	
MARK W SMITH	LEASED	
OXY USA WTP, LP	STILL DECIDING	
PEGGY DENISE BECKHAM HANNA	LEASED	
Quail Creek Royalty, LLC	updated address 2nd attempt	7021 2720 0001 2621 9594
REALEZA DEL SPEAR, LP	PARTICIPATING	
Shamrock Royalty, LP	LEASED	
THE BEVERIDGE COMPANY	LEASED	
THOMAS ANDERSON BECKHAM	LEASED	
XTO HOLDINGS, LLC	NEGOTIATING LEASE	
ZIA ROYALTY, LLC	LEASED	
BLACK RAM PROPERTIES, LLC	RETURN TO SENDER - try same address again green card from one	
CANDLEWOOD RESOURCES, LLC	updated PO box from 2024 to 2402	7021 2720 0001 2621 9556
OLLI ENERGY LLC	PARTICIPATING	
PATCH ENERGY, LLC	updated address	Atempting to locate
PLAYA RESOURCES, LLC	Try same again	Atempting to locate
SUBTERRA RESOURCES, LLC	updated address 2nd attempt	Atempting to locate
ELISE DELGADO	RECEIVED - GREEN CARD BACK	Atempting to locate
CANDACE DELGADO	Try same again	Atempting to locate
SYLVIA DELGADO	Try same again	Atempting to locate

**STATE OF NEW MEXICO
ENERGY, MINERALS AND NATURAL RESOURCES DEPARTMENT
OIL CONSERVATION DIVISION**

**APPLICATIONS OF AMEREDEV
OPERATING, LLC FOR
COMPULSORY POOLING,
LEA COUNTY, NEW MEXICO.**

CASE NO. 24602

SELF-AFFIRMED STATEMENT OF PARKER FOY

1. My name is Parker Foy. I work for Ameredev Operating, LLC (“Ameredev”) as a Geologist.
2. I have previously testified before the New Mexico Oil Conservation Division (“Division”) as an expert witness in petroleum geology matters. My credentials as a petroleum geologist have been accepted by the Division and made a matter of record.
3. I am familiar with the application filed by Ameredev in this case, and I have conducted a geologic study of the lands in the subject area.
4. **Ameredev Exhibit D-1** is a locator map that shows Ameredev’s acreage in yellow and the path of the proposed wellbore. Nearby wells that are producing in the target formation are marked with green dots. This map also shows the location of the Capitan Reef Complex.
5. **Ameredev Exhibit D-2** is a subsea structure map that I prepared for the targeted interval within the Wolfcamp formation, with a contour interval of 50 feet. The structure map shows the Wolfcamp gently dipping to the southwest. The Wolfcamp structure appears consistent across the proposed wellbore paths. I do not observe any faulting, pinchouts, or other geologic impediments to horizontally drilling the well proposed in this spacing unit.

**BEFORE THE OIL CONSERVATION DIVISION
Santa Fe, New Mexico
Exhibit No. D
Submitted by: Ameredev Operating, LLC
Hearing Date: August 22, 2024
Case No. 24602**

6. **Ameredev Exhibit D-3** shows a line of cross-section in red consisting of wells penetrating the Wolfcamp formation that I used to construct a stratigraphic cross-section from A to A'. I consider these wells to be representative of the geology in the area.

7. **Ameredev Exhibit D-4** contains the stratigraphic cross-sections that I prepared displaying open-hole logs run over the target formations from three representative wells denoted from A to A'. For each well in the cross-sections, the exhibit shows the following logs: gamma ray, resistivity, and porosity. The targeted interval is labeled and marked on the left side of the cross-sections. The logs in the cross-sections demonstrate that the interval is continuous across the entire spacing unit.

8. In my opinion, standup orientation of the proposed wells is the appropriate orientation for horizontal well development in this area because it is near perpendicular to the maximum horizontal stress of the area.

9. Based on my geologic study, the Wolfcamp formation underlying the subject area is suitable for development by horizontal wells and the acreage comprising the proposed spacing units will contribute more-or-less equally to the production from the wellbore. I have not identified any geologic impediments to drilling horizontal wells in the area of the spacing unit proposed.

10. In my opinion, horizontal drilling will be the most efficient method to develop this acreage, to prevent the drilling of unnecessary wells, and to result in the greatest ultimate recovery, and that approving Ameredev's application will be in the best interest of conservation, the prevention of waste, and protection of correlative rights.

11. **Ameredev's Exhibits D-1 through D-4** were either prepared by me or compiled under my direction and supervision.

12. I affirm under penalty of perjury under the laws of the State of New Mexico that the foregoing statements are true and correct. I understand that this self-affirmed statement will be used as written testimony in this case. This statement is made on the date next to my signature below.



PARKER FOY

7/11/24



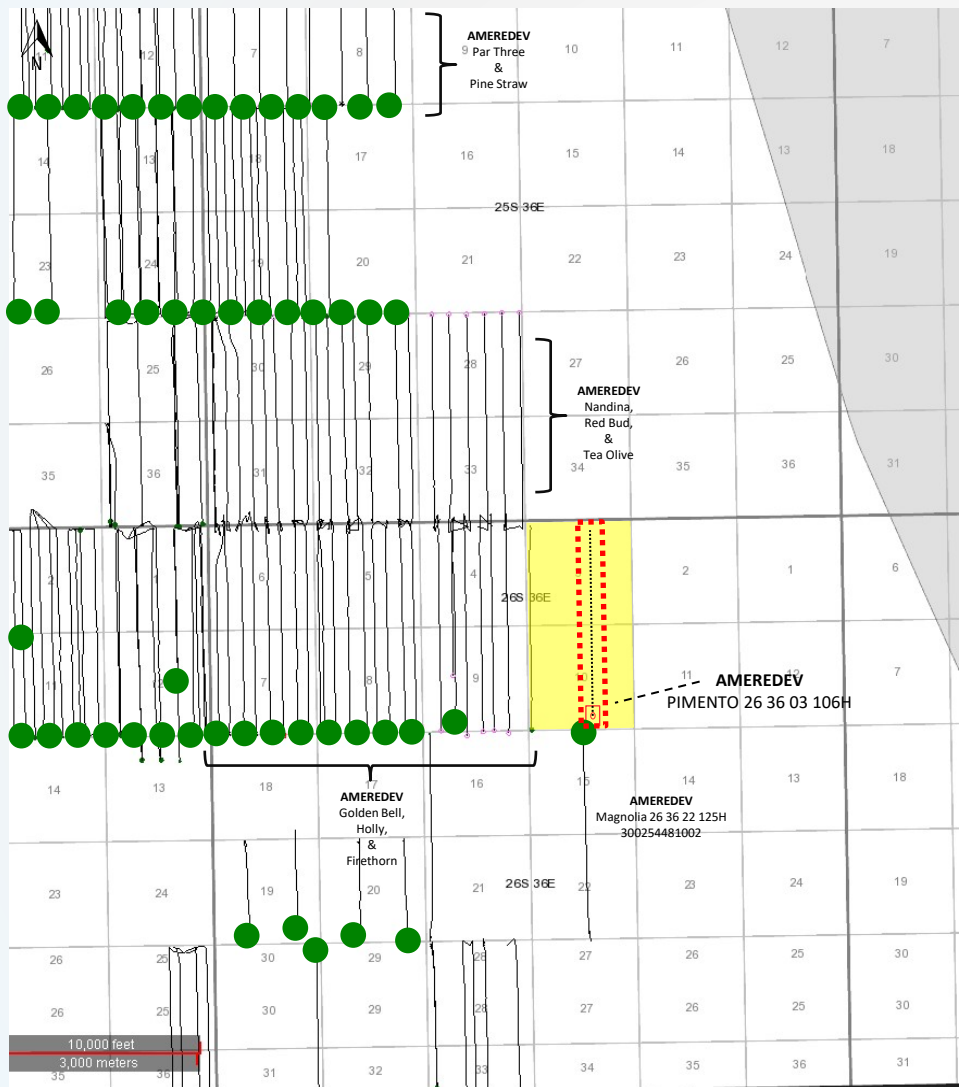

Parker Foy

Date

Wolfcamp Pool – Pimento 26 36 03 106H



Map Legend

BHL	SHL	
		AmeredeV WFMP Horizontal Locations
		Producing WFMP Wells
		AmeredeV Acreage

BEFORE THE OIL CONSERVATION DIVISION
Santa Fe, New Mexico
Exhibit No. D-1
Submitted by: AmeredeV Operating, LLC
Hearing Date: August 22, 2024
Case No. 24602

Wolfcamp Pool – Capitan Reef Complex

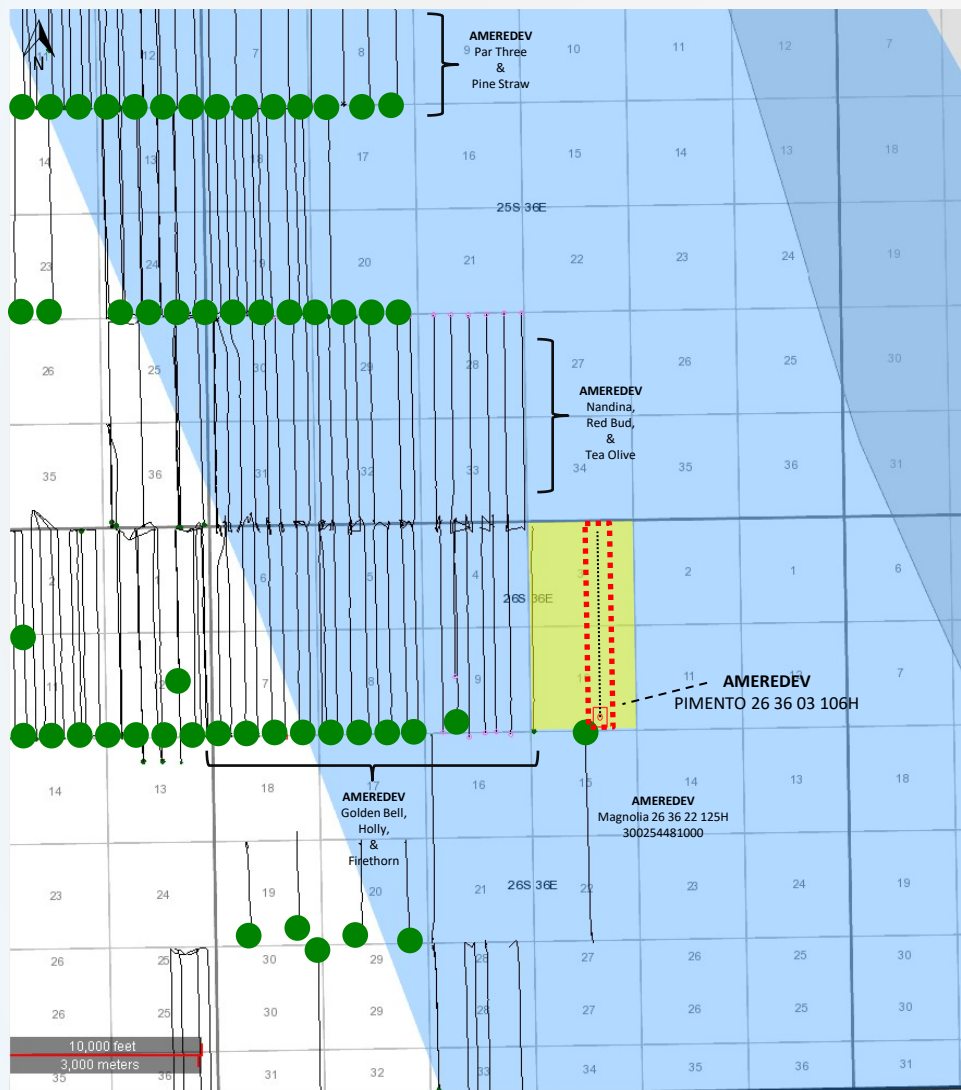





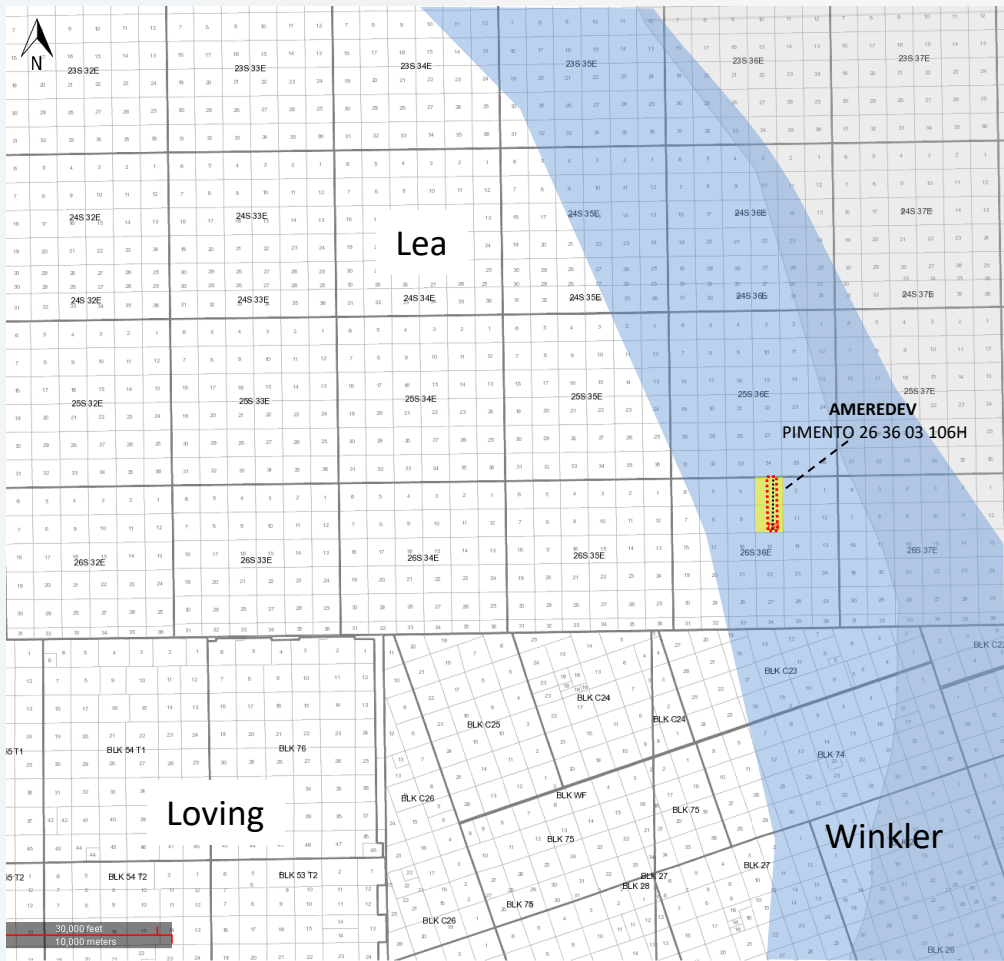

Map Legend

BHL	SHL	Description
		Amerdev WFMP Horizontal Locations
		Producing WFMP Wells
		Amerdev Acreage
		Capitan Reef Complex

Wolfcamp Pool – Capitan Reef Complex



Map Legend

BHL	SHL	
		Ameredev WFMP Horizontal Locations
		Producing WFMP Wells
		Ameredev Acreage
		Capitan Reef Complex

Wolfcamp Pool – WFMP Structure Map (Subsea Depth)

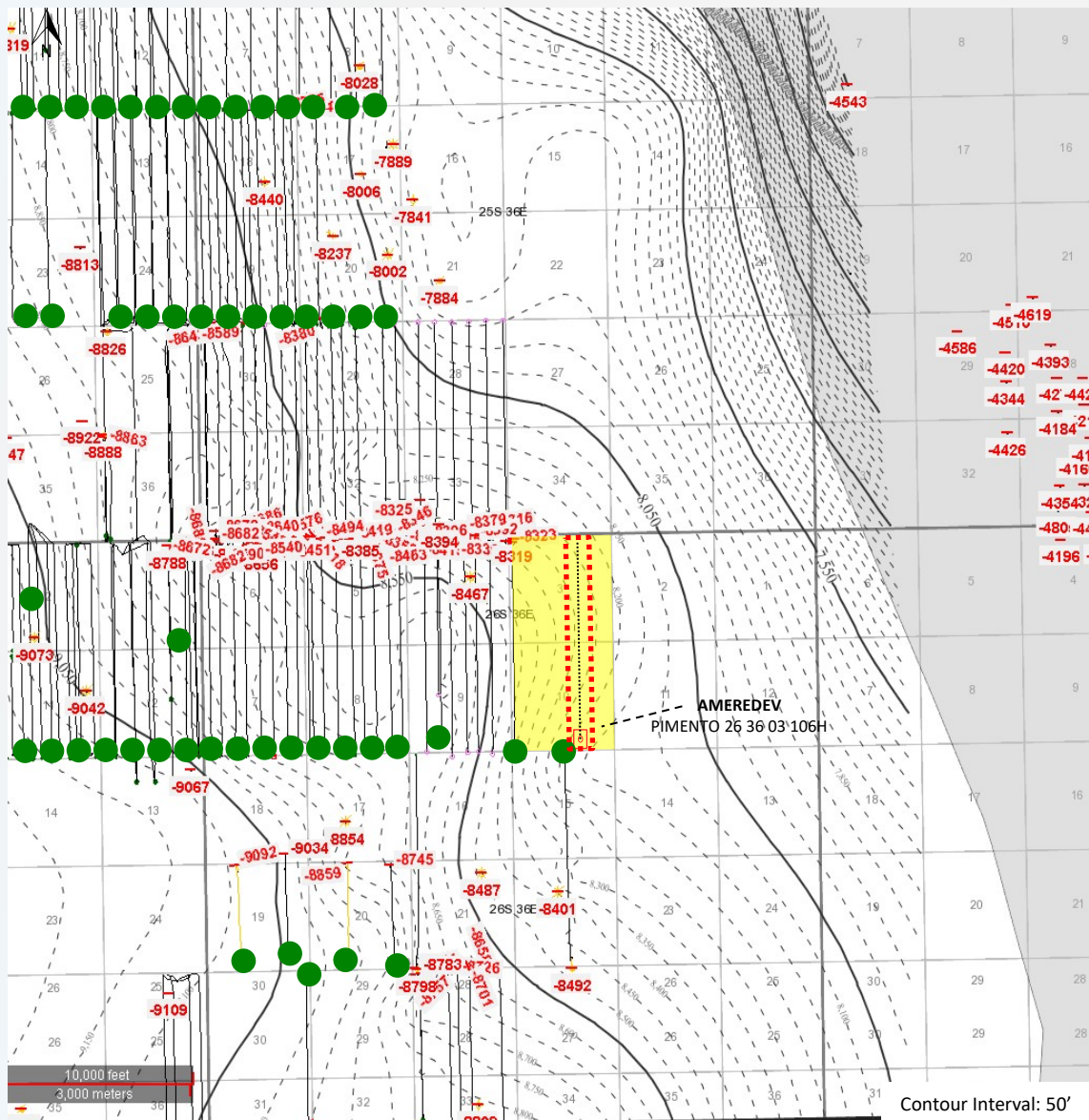

Map Legend

- BHL SHL**
- Ameredeve WFMP Horizontal Locations
- Producing WFMP Wells
- Ameredeve Acreage

BEFORE THE OIL CONSERVATION DIVISION
 Santa Fe, New Mexico
 Exhibit No. D-2
 Submitted by: Ameredeve Operating, LLC
 Hearing Date: August 22, 2024
 Case No. 24602

**STATE OF NEW MEXICO
ENERGY, MINERALS AND NATURAL RESOURCES DEPARTMENT
OIL CONSERVATION DIVISION**

**APPLICATION OF AMEREDEV
OPERATING, LLC FOR
COMPULSORY POOLING,
LEA COUNTY, NEW MEXICO.**

CASE NO. 24602

**SELF-AFFIRMED STATEMENT OF
PAULA M. VANCE**

1. I am attorney in fact and authorized representative of Ameredev Operating, LLC (“Ameredev”), the Applicant herein. I have personal knowledge of the matter addressed herein and am competent to provide this self-affirmed statement.

2. The above-referenced application and notice of the hearing on this application was sent by certified mail to the locatable affected parties on the date set forth in the letter attached hereto.

3. The spreadsheet attached hereto contains the names of the parties to whom notice was provided.

4. The spreadsheet attached hereto contains the information provided by the United States Postal Service on the status of the delivery of this notice as of August 12, 2024.

5. I caused a notice to be published to the parties subject to this compulsory pooling proceeding. The affidavit of publication from the publication’s legal clerk with a copy of the notices of publication is attached herein.

6. I affirm under penalty of perjury under the laws of the State of New Mexico that the foregoing statements are true and correct. I understand that this self-affirmed statement will be used as written testimony in this case. This statement is made on the date next to my signature below.

**BEFORE THE OIL CONSERVATION DIVISION
Santa Fe, New Mexico
Revised Exhibit No. E
Submitted by: Ameredev Operating, LLC
Hearing Date: August 22, 2024
Case No. 24602**



Paula M. Vance

8/14/2024

Date



Paula M. Vance
Associate
Phone (505) 988-4421
Email pmvance@hollandhart.com

August 2, 2024

VIA CERTIFIED MAIL
CERTIFIED RECEIPT REQUESTED

TO: ALL INTEREST OWNERS SUBJECT TO POOLING PROCEEDINGS

Re: Application of Ameredev Operating, LLC for Compulsory Pooling, Lea County, New Mexico: Pimento Fed Com 26 36 03 106H Well

Ladies & Gentlemen:

This letter is to advise you that Ameredev Operating, LLC has filed the enclosed application with the New Mexico Oil Conservation Division. A hearing has been requested before a Division Examiner on August 22, 2024, and the status of the hearing can be monitored through the Division’s website at <https://www.emnrd.nm.gov/ocd/>.

It is anticipated that hearings will be held in a hybrid format with both in-person and virtual participation options. The meeting will be held in the Pecos Hall Hearing Room at the Wendall Chino Building, 1st Floor, 1220 South St. Francis Dr., Santa Fe, New Mexico. To participate virtually in the hearing, see the instructions posted on the OCD Hearings website: <https://www.emnrd.nm.gov/ocd/hearing-info/>.

You are not required to attend this hearing, but as an owner of an interest that may be affected by this application, you may appear and present testimony. Failure to appear at that time and become a party of record will preclude you from challenging the matter at a later date. Parties appearing in cases are required to file a Pre-hearing Statement four business days in advance of a scheduled hearing that complies with the provisions of NMAC 19.15.4.13.B.

If you have any questions about this matter, please contact Brandon Forteza at (737) 300-4721 or bforteza@ameredev.com.

Sincerely,

Paula M. Vance
ATTORNEY FOR AMEREDEV OPERATING, LLC

T 505.988.4421
110 North Guadalupe, Suite 1, Santa Fe, NM 87501-1849
Mail to: P.O. Box 2208, Santa Fe, NM 87504-2208
www.hollandhart.com

Alaska	Montana	Utah
Colorado	Nevada	Washington, D.C.
Idaho	New Mexico	Wyoming

Ameredev - Pimento 106H well - Case no 24602

Postal Delivery Report

9414811898765463830489	Dan Risku	13 Saddle Ln	Hanover	MA	02339-2762	Your item was delivered to an individual at the address at 2:12 pm on August 6, 2024 in HANOVER, MA 02339.
9414811898765463830472	Albert Schaefer	621 NW 45th St	Vancouver	WA	98660-1621	This is a reminder to arrange for redelivery of your item or your item will be returned to sender.
9414811898765463830519	Allen Vance Bickley	10 Glen Brook Way Unit 201	Fitchburg	WI	53711-4958	Your package will arrive later than expected, but is still on its way. It is currently in transit to the next facility.
9414811898765463830557	Alliance Land And Minerals, LLC	PO Box 809	Artesia	NM	88211-0809	Your item was picked up at the post office at 2:45 pm on August 6, 2024 in ARTESIA, NM 88210.
9414811898765463830564	Alma Schessler	4524 Cleveland Ave	Kansas City	KS	66104-3321	This is a reminder to arrange for redelivery of your item or your item will be returned to sender.

Ameredev - Pimento 106H well - Case no 24602
Postal Delivery Report

9414811898765463830526	Alvin Schaefer	PO Box 91	Kemah	TX	77565-0091	Your item was returned to the sender on August 6, 2024 at 10:40 am in KEMAH, TX 77565 because the addressee was not known at the delivery address noted on the package.
9414811898765463830595	Anna Marie Neerman	2300 N 6th Terrace	Kansas City	KS	66100	Your package will arrive later than expected, but is still on its way. It is currently in transit to the next facility.
9414811898765463830540	Barbara June Bickley	1101 Ware Ave	Sedalia	MO	65301-6372	Your item was returned to the sender on August 7, 2024 at 8:22 am in SEDALIA, MO 65301 because the addressee was not known at the delivery address noted on the package.

Ameredev - Pimento 106H well - Case no 24602

Postal Delivery Report

9414811898765463830588	Byron E. Prather	1050 Post St	San Francisco	CA	94109-5665	Your item departed our USPS facility in ALBUQUERQUE, NM 87101 on August 11, 2024 at 11:10 pm. The item is currently in transit to the destination.
9414811898765463830533	Candace Delgado	2110 Rancho Siringo Rd Apt 6	Santa Fe	NM	87505-5517	This is a reminder to arrange for redelivery of your item or your item will be returned to sender.
9414811898765463830571	Candis Loving	14785 Soaring Eagle Ct	Fort Myers	FL	33912-1825	Your item was delivered to an individual at the address at 1:42 pm on August 7, 2024 in FORT MYERS, FL 33912.
9414811898765463838218	Cari Loving Fka Cari Ferguson	11004 Willow Grove Rd	Oklahoma City	OK	73120-5117	Your item was delivered to an individual at the address at 1:39 pm on August 10, 2024 in OKLAHOMA CITY, OK 73120.
9414811898765463838256	Cassandra Jensen	6100 N Brookline Ave Apt 27	Oklahoma City	OK	73112-4344	Your item was delivered to an individual at the address at 2:37 pm on August 10, 2024 in OKLAHOMA CITY, OK 73112.

Ameredev - Pimento 106H well - Case no 24602

Postal Delivery Report

9414811898765463838263	Chris Scovill	11616 Franklinville Rd	Upper Falls	MD	21156-1905	Your item was delivered to an individual at the address at 12:32 pm on August 6, 2024 in KINGSVILLE, MD 21087.
9414811898765463838225	Christine Winkle Carpenter	13713 E 55th Ln	Yuma	AZ	85367-8218	Your package will arrive later than expected, but is still on its way. It is currently in transit to the next facility.
9414811898765463838201	Clarence H. Schaefer	920 Mound St	Atchison	KS	66002-1732	This is a reminder to arrange for redelivery of your item or your item will be returned to sender.
9414811898765463838294	Concordia Stratman	3815 Durness Way	Houston	TX	77025-2403	This is a reminder to arrange for redelivery of your item or your item will be returned to sender.
9414811898765463838249	Corine Schmitt	1110 Unity St	Atchison	KS	66002-1357	Your package will arrive later than expected, but is still on its way. It is currently in transit to the next facility.

Ameredev - Pimento 106H well - Case no 24602
Postal Delivery Report

9414811898765463838287	Cuatro Rojos Llc	PO Box 2177	Midland	TX	79702-2177	Your item was picked up at the post office at 12:50 pm on August 8, 2024 in MIDLAND, TX 79701.
9414811898765463838270	Dave Risku	10012 Caddie St NW	Albuquerque	NM	87114-4209	Your item was delivered to an individual at the address at 5:55 pm on August 6, 2024 in ALBUQUERQUE, NM 87114.
9414811898765463838812	David Glenn Winkle	2138 W Danbury Rd	Phoenix	AZ	85023-2215	Your item was delivered to an individual at the address at 12:32 pm on August 6, 2024 in PHOENIX, AZ 85023.
9414811898765463838850	Debra Winkle McMackin	4741 NW Aspen St	Camas	WA	98607-8304	Your package will arrive later than expected, but is still on its way. It is currently in transit to the next facility.
9414811898765463838867	Donna Risku Ribich	365 Sunset Cir	Pulaski	WI	54162-9015	Your item was picked up at the post office at 8:47 am on August 10, 2024 in PULASKI, WI 54162.

Ameredev - Pimento 106H well - Case no 24602

Postal Delivery Report

9414811898765463838829	Doornbos Mineral Partners, LLC	105 1/2 SE Frank Phillips Blvd	Bartlesville	OK	74003-3519	Your item was delivered to an individual at the address at 2:38 pm on August 6, 2024 in BARTLESVILLE, OK 74003.
9414811898765463838805	Dr. Herbert Senne	1308 S Noyes Blvd	Saint Joseph	MO	64507-1742	Your package will arrive later than expected, but is still on its way. It is currently in transit to the next facility.
9414811898765463838843	Edna Schaefer	4014 SW Windsor Ct	Topeka	KS	66604-2427	Your item was returned to the sender on August 6, 2024 at 2:51 pm in TOPEKA, KS 66604 because the addressee was not known at the delivery address noted on the package.
9414811898765463838881	Edwin Schaefer	1307 Unity St	Atchison	KS	66002-1341	Your package will arrive later than expected, but is still on its way. It is currently in transit to the next facility.

Ameredev - Pimento 106H well - Case no 24602

Postal Delivery Report

9414811898765463838836	Elise Delgado	2 Paseo Galisteo	Santa Fe	NM	87508-5958	We could not access the delivery location to deliver your package at 12:56 pm on August 8, 2024 in SANTA FE, NM 87508. We will redeliver on the next delivery day. No action needed.
9414811898765463838874	Elsie Shulties	3137 SW Westover Rd	Topeka	KS	66604-2588	Your item was returned to the sender on August 6, 2024 at 5:57 pm in TOPEKA, KS 66604 because of an incomplete address.
9414811898765463838713	Erma Hoffman	64 Saratoga Street	Wisconsin Rapids	WI	54494	Your package will arrive later than expected, but is still on its way. It is currently in transit to the next facility.
9414811898765463838751	Estate Of Charles Jaakola C/O Jeanne Jaakola	990 9th Ave NW Apt 210	Saint Paul	MN	55112-2671	Your item arrived at our MINNEAPOLIS MN DISTRIBUTION CENTER destination facility on August 10, 2024 at 7:18 pm. The item is currently in transit to the destination.

Ameredev - Pimento 106H well - Case no 24602

Postal Delivery Report

9414811898765463838768	Esther Krueger	25 Mohawk Trl	Lake Zurich	IL	60047-2479	Your package will arrive later than expected, but is still on its way. It is currently in transit to the next facility.
9414811898765463838720	Ethel Glidewell	902 S Noyes Blvd	Saint Joseph	MO	64507-1736	Your package will arrive later than expected, but is still on its way. It is currently in transit to the next facility.
9414811898765463838706	Ette Frommer	437 Saratoga St S	Saint Paul	MN	55105-2544	Your package will arrive later than expected, but is still on its way. It is currently in transit to the next facility.
9414811898765463838799	Florence Senne	2026 Clay St	Saint Joseph	MO	64501	Your package will arrive later than expected, but is still on its way. It is currently in transit to the next facility.
9414811898765463838744	Frank Dunn	537 1/2 Seminary Ave	Tahlequah	OK	74464-2627	This is a reminder to arrange for redelivery of your item or your item will be returned to sender.

Ameredev - Pimento 106H well - Case no 24602

Postal Delivery Report

9414811898765463838782	Gertrude Wipperman Renken	904 E 8th St	Stuttgart	AR	72160-4520	Your item was forwarded to a different address at 5:13 pm on August 6, 2024 in STUTTGART, AR. This was because of forwarding instructions or because the address or ZIP Code on the label was incorrect.
9414811898765463838737	Gregg Gosting	4221 Deerfield Ln	Cookeville	TN	38506-7063	Your package will arrive later than expected, but is still on its way. It is currently in transit to the next facility.
9414811898765463838911	Hazel Hogan Riffel	9335 Gloxinia Dr	Garden Ridge	TX	78266-2532	Your item was returned to the sender at 1:41 pm on August 6, 2024 in SAN ANTONIO, TX 78266 because the forwarding order for this address is no longer valid.

Ameredev - Pimento 106H well - Case no 24602

Postal Delivery Report

9414811898765463838959	Heirs/Assigns Susan Mowder, DecD	PO Box 2668	New York	NY	10163-2668	Your item was returned to the sender on August 6, 2024 at 5:17 pm in NEW YORK, NY 10017 because the addressee was not known at the delivery address noted on the package.
9414811898765463838966	Henry A. Felt Jr.	252 Fairmount Ave	Glen Rock	NJ	07452-3609	Your item was delivered to an individual at the address at 11:16 am on August 10, 2024 in GLEN ROCK, NJ 07452.
9414811898765463838904	Hilda Frey	5910 E 2nd St N	Wichita	KS	67208-4403	Your item departed our USPS facility in ALBUQUERQUE, NM 87101 on August 11, 2024 at 11:10 pm. The item is currently in transit to the destination.
9414811898765463838997	Imogene Marie Dunn	2018 S Poplar Springs Church Rd	Rentz	GA	31075-3145	Your item was returned to the sender on August 6, 2024 at 1:08 pm in RENTZ, GA 31075 because it could not be delivered as addressed.

Ameredev - Pimento 106H well - Case no 24602

Postal Delivery Report

9414811898765463838942	Issacs Family Limited Liability Limited Partnership	5 Inverness Dr E	Englewood	CO	80112-5519	Your item was delivered to an individual at the address at 12:24 pm on August 5, 2024 in ENGLEWOOD, CO 80112.
9414811898765463838980	Janelle Lunde	12238 Rendova St NE	Minneapolis	MN	55449-5158	Your package will arrive later than expected, but is still on its way. It is currently in transit to the next facility.
9414811898765463838935	Joe N Gifford And Emily Gifford	PO Box 51187	Midland	TX	79710-1187	This is a reminder to pick up your item before August 20, 2024 or your item will be returned on August 21, 2024. Please pick up the item at the MIDLAND, TX 79710 Post Office.
9414811898765463838973	John Mowder	7646 Forest Park Dr	Shawnee	KS	66217-3008	Your item was delivered to an individual at the address at 2:17 pm on August 7, 2024 in SHAWNEE, KS 66217.

Ameredev - Pimento 106H well - Case no 24602

Postal Delivery Report

9414811898765463838614	Joseph Mark Gregory	8905 Random Rd	Fort Worth	TX	76179-2733	Your package will arrive later than expected, but is still on its way. It is currently in transit to the next facility.
9414811898765463838652	Josephy Leroy Haynes And Wife, Carol Haynes	423 E Warren St	Bucyrus	OH	44820	Your package will arrive later than expected, but is still on its way. It is currently in transit to the next facility.
9414811898765463838669	Julie Winkle Howard	510 Cottage Heights Loop	Cottage Grove	OR	97424	Your package will arrive later than expected, but is still on its way. It is currently in transit to the next facility.
9414811898765463838607	Julie Kloess	9407 Alpine Dr	Affton	MO	63123-4459	This is a reminder to arrange for redelivery of your item or your item will be returned to sender.
9414811898765463838690	Karen P. Saunders Dorsey	602 NE 134th Ct	Silver Springs	FL	34488-3937	Your item was returned to the sender on August 6, 2024 at 2:12 pm in SILVER SPRINGS, FL 34488 because the addressee was not known at the delivery address noted on the package.

Ameredev - Pimento 106H well - Case no 24602

Postal Delivery Report

9414811898765463838683	Karen Scovill Mckelvey	6335 Maurer Rd Apt 303	Shawnee	KS	66217-8113	Your package will arrive later than expected, but is still on its way. It is currently in transit to the next facility.
9414811898765463838638	Kevin Loving	7909 Mississippi Ln	Minneapolis	MN	55444-2218	Your item has been delivered to an agent and left with an individual at the address at 10:08 am on August 8, 2024 in MINNEAPOLIS, MN 55444.
9414811898765463838676	Larry Dunn	3717 SE 31st St	Topeka	KS	66605-2230	Your package will arrive later than expected, but is still on its way. It is currently in transit to the next facility.
9414811898765463838157	Laura Schmitt	2 Paseo Galisteo	Santa Fe	NM	87508-5958	We could not access the delivery location to deliver your package at 12:56 pm on August 8, 2024 in SANTA FE, NM 87508. We will redeliver on the next delivery day. No action needed.

Ameredev - Pimento 106H well - Case no 24602

Postal Delivery Report

9414811898765463838164	Linda Carol Haynes	5301 Byron Ave N	Minneapolis	MN	55429-3706	Your item was delivered to an individual at the address at 2:40 pm on August 8, 2024 in MINNEAPOLIS, MN 55429.
9414811898765463838126	Lucy K. Schmitt	5 Lehigh Ct	Columbia	SC	29223-8413	Your item was delivered to an individual at the address at 1:52 pm on August 6, 2024 in COLUMBIA, SC 29223.
9414811898765463838102	Matthew Jakkola	7749 Mississippi Ln	Minneapolis	MN	55444-2149	Your item has been delivered to an agent and left with an individual at the address at 10:46 am on August 6, 2024 in MINNEAPOLIS, MN 55444.
9414811898765463838195	Nancy Dunn	7909 Mississippi Ln	Minneapolis	MN	55444-2218	Your item has been delivered to an agent and left with an individual at the address at 10:49 am on August 6, 2024 in MINNEAPOLIS, MN 55444.

Ameredev - Pimento 106H well - Case no 24602

Postal Delivery Report

9414811898765463838140	Nicholas G Kanelakos	3717 SE 31st St	Topeka	KS	66605-2230	Your package will arrive later than expected, but is still on its way. It is currently in transit to the next facility.
9414811898765463838188	Olli Energy LLC	2540 King Arthur Blvd Ste 209K	Lewisville	TX	75056-5813	Your item was delivered to an individual at the address at 10:00 am on August 6, 2024 in THE COLONY, TX 75056.
9414811898765463838133	Oxy USA WTP, LP	5 Greenway Plz Ste 110	Houston	TX	77046-0521	Your package will arrive later than expected, but is still on its way. It is currently in transit to the next facility.
9414811898765463838171	Pat Mowder	2 Paseo Galisteo	Santa Fe	NM	87508-5958	We could not access the delivery location to deliver your package at 12:56 pm on August 8, 2024 in SANTA FE, NM 87508. We will redeliver on the next delivery day. No action needed.

Ameredev - Pimento 106H well - Case no 24602

Postal Delivery Report

9414811898765463838317	Paul Schaefer	620 28th Ave	East Moline	IL	61244-3144	Your package will arrive later than expected, but is still on its way. It is currently in transit to the next facility.
9414811898765463838355	Pauline Mowder	6335 Maurer Rd Apt 303	Shawnee	KS	66217-8113	Your item was returned to the sender on August 6, 2024 at 2:17 pm in SHAWNEE, KS 66217 because the addressee was not known at the delivery address noted on the package.
9414811898765463838300	Playa Resources, LLC	3213 Boyd Ave	Midland	TX	79705-8202	Your package will arrive later than expected, but is still on its way. It is currently in transit to the next facility.
9414811898765463838393	Prely Minerals LLC	PO Box 1385	Fort Worth	TX	76101-1385	Your item arrived at the FORT WORTH, TX 76102 post office at 11:37 am on August 8, 2024 and is ready for pickup.

Ameredev - Pimento 106H well - Case no 24602

Postal Delivery Report

9414811898765463838348	Quail Creek Royalty, LLC	810 Houston St	Fort Worth	TX	76102-6203	Your package will arrive later than expected, but is still on its way. It is currently in transit to the next facility.
9414811898765463838386	Realeza Del Spear, LP	PO Box 1684	Midland	TX	79702-1684	Your item was picked up at a postal facility at 11:30 am on August 9, 2024 in MIDLAND, TX 79702.
9414811898765463838010	Rev Arthur Senne	354 Putman	West Palm Beach	FL	33400	Your package will arrive later than expected, but is still on its way. It is currently in transit to the next facility.
9414811898765463838058	Ruth Mcconnell	310 Chestnut Ln	Escondido	CA	92025-5202	Your package will arrive later than expected, but is still on its way. It is currently in transit to the next facility.
9414811898765463838065	Ruth Van Liew	1120 Unity St	Atchison	KS	66002-1359	Your package will arrive later than expected, but is still on its way. It is currently in transit to the next facility.

Ameredev - Pimento 106H well - Case no 24602

Postal Delivery Report

9414811898765463838027	Shannon Smith	7909 Mississippi Ln	Minneapolis	MN	55444-2218	Your item has been delivered to an agent and left with an individual at the address at 10:08 am on August 8, 2024 in MINNEAPOLIS, MN 55444.
9414811898765463838003	Standard Royatly Corporation	5308 Julington Creek Rd	Jacksonville	FL	32258-3467	Your item was returned to the sender on August 6, 2024 at 4:35 pm in JACKSONVILLE, FL 32258 because the addressee was not known at the delivery address noted on the package.
9414811898765463838096	Subterra Resources, LLC	PO Box 53886	Midland	TX	79710-3886	This is a reminder to pick up your item before August 20, 2024 or your item will be returned on August 21, 2024. Please pick up the item at the MIDLAND, TX 79710 Post Office.
9414811898765463838041	Susan Mowder	3717 SE 31st St	Topeka	KS	66605-2230	Your item was delivered to an individual at the address at 1:40 pm on August 6, 2024 in TOPEKA, KS 66605.

Ameredev - Pimento 106H well - Case no 24602

Postal Delivery Report

9414811898765463838089	Sylvia Delgado	2 Paseo Galisteo	Santa Fe	NM	87508-5958	We could not access the delivery location to deliver your package at 12:56 pm on August 8, 2024 in SANTA FE, NM 87508. We will redeliver on the next delivery day. No action needed.
9414811898765463838034	Thomas Jaakola	5301 Byron Ave N	Minneapolis	MN	55429-3706	Your package will arrive later than expected, but is still on its way. It is currently in transit to the next facility.
9414811898765463838072	Tim Dunn	2018 S Poplar Springs Church Rd	Rentz	GA	31075-3145	Your package will arrive later than expected, but is still on its way. It is currently in transit to the next facility.
9414811898765463838454	Tim Scovill	436 S Pickard Ave	Norman	OK	73069-5511	Your item was delivered to an individual at the address at 2:42 pm on August 10, 2024 in NORMAN, OK 73069.

Affidavit of Publication

STATE OF NEW MEXICO
COUNTY OF LEA

I, Daniel Russell, Publisher of the Hobbs News-Sun, a newspaper published at Hobbs, New Mexico, solemnly swear that the clipping attached hereto was published in the regular and entire issue of said newspaper, and not a supplement thereof for a period of 1 issue(s).

Beginning with the issue dated August 06, 2024 and ending with the issue dated August 06, 2024.



Publisher

Sworn and subscribed to before me this 6th day of August 2024.



Business Manager

My commission expires January 29, 2027

(Seal) STATE OF NEW MEXICO
NOTARY PUBLIC
GUSSIE RUTH BLACK
COMMISSION # 1087526
COMMISSION EXPIRES 01/29/2027

This newspaper is duly qualified to publish legal notices or advertisements within the meaning of Section 3, Chapter 167, Laws of 1937 and payment of fees for said publication has been made.

LEGAL	LEGAL	LEGAL
LEGAL NOTICE August 6, 2024		
<p>Case No. 24602: Application of Ameredev Operating, LLC for Compulsory Pooling, Lea County, New Mexico. Notice to all affected interest owners, including all heirs, devisees and successors of: Dan Risku; Albert Schaefer; Allen Vance Bickley; ALLIANCE LAND AND MINERALS, LLC; Alma Schessler; Alvin Schaefer; Anna Marie Neerman; Barbara June Bickley; Byron E. Prather; CANDACE DELGADO; Candis Loving; Carl Loving fka Carl Ferguson; Cassandra Jensen; Chris Scovill; Christine (Winkle) Carpenter; Clarence H. Schaefer; Concordia Stratman; Corine Schmitt; CUATRO ROJOS LLC; Dave Risku; David Glenn Winkle; Debra (Winkle) McMackin; Donna (Risku) Ribich; Doornbos Mineral Partners, LLC; Dr. Herbert Senne; Edna Schaefer; Edwin Schaefer; ELISE DELGADO; Elsie Shulties; Erma Hoffman; Estate of Charles Jaakola c/o Jeanne Jaakola; Esther Krueger; Ethel Gildewell; Ette Frommer; Florence Senne; Frank Dunn; Gertrude (Wiperman) Renken; Gregg Gosting; HAZEL HOGAN RIFFEL; Heirs/assigns Susan Mowder, dec'd; HENRY A. FELT JR.; Hilda Frey; Imogene Marie Dunn; ISSACS FAMILY LIMITED LIABILITY LIMITED PARTNERSHIP; JANELLE LUNDE ; JOE N GIFFORD AND EMILY GIFFORD; John Mowder; JOSEPH MARK GREGORY; JOSEPHY LEROY HAYNES AND WIFE, CAROL HAYNES; Julie (Winkle) Howard; Julie Kloess; KAREN P. SAUNDERS DORSEY; Karen Scovill McKelvey; Kevin Loving; Larry Dunn; Laura Schmitt; LINDA CAROL HAYNES; LUCY K. SCHMITT; MATTHEW JAKKOLA; Nancy Dunn; Nicholas G Kanelakos; OLLI ENERGY LLC; OXY USA WTP, LP; Pat Mowder; Paul Schaefer; PAULINE MOWDER; PLAYA RESOURCES, LLC; PRELLY MINERALS LLC; Quail Creek Royalty, LLC; REALEZA DEL SPEAR, LP; Rev Arthur Senne; Ruth McConnell; Ruth Van Liew; SHANNON SMITH; STANDARD ROYATLY CORPORATION; SUBTERRA RESOURCES, LLC; SUSAN MOWDER; SYLVIA DELGADO; THOMAS JAAKOLA; Tim Dunn; Tim Scovill. The State of New Mexico, Energy Minerals and Natural Resources Department, Oil Conservation Division ("Division") hereby gives notice that the Division will hold public hearing 8:30 a.m. on August 22, 2024, to consider this application. The hearing will be conducted in a hybrid fashion, both in- person at the Energy, Minerals, Natural Resources Department, Wendell Chino Building, Pecos Hall, 1220 South St. Francis Drive, 1st Floor, Santa Fe, NM 87505 and via the WebEx virtual meeting platform. To participate in the hearings electronically, see the instructions posted on the docket for the hearing date: https://www.emnrd.nm.gov/ocd/hearing-info/ or contact Freya Tschantz, at Freya.Tschantz@emnrd.nm.gov. Applicant in the above-styled cause seeks an order pooling all uncommitted mineral owners in a standard 320-acre, more or less, horizontal well spacing unit in the Wolfcamp formation underlying the W/2 E/2 of Sections 3 and 10, Township 26 South, Range 36 East, NMPM, Lea County, New Mexico. Ameredev seeks to initially dedicate the above-referenced spacing unit to the proposed Pimento Fed Com 26-36-03 106H, to be horizontally drilled from a surface location in the NW/4 NE/4 (Unit B) of Section 3, a first take point from the NW/4 NE/4 (Unit B) of Section 3, to a bottom hole location in the SW/4 SE/4 (Unit O) of Section 10. Also, to be considered will be the cost of drilling and completing the well and the allocation of the cost thereof as well as actual operating costs and charges for supervision, designation of Ameredev Operating, LLC as operator of the well, and a 200% charge for risk involved in drilling said well. Said area is located approximately 4 miles southwest of Jal, New Mexico. #00293046</p>		

67100754

00293046

HOLLAND & HART LLC
110 N GUADALUPE ST., STE. 1
SANTA FE, NM 87501

BEFORE THE OIL CONSERVATION DIVISION
Santa Fe, New Mexico
Revised Exhibit No. F
Submitted by: Ameredev Operating, LLC
Hearing Date: August 22, 2024
Case No. 24602