

**STATE OF NEW MEXICO
DEPARTMENT OF ENERGY, MINERALS AND NATURAL RESOURCES
OIL CONSERVATION DIVISION**

**APPLICATION OF PERMIAN RESOURCES
OPERATING, LLC FOR COMPULSORY
POOLING, EDDY COUNTY, NEW MEXICO.**

Case No. 25063

Exhibit Index

Compulsory Pooling Checklist

Exhibit A	Self-Affirmed Statement of Ryan Curry
A-1	Application & Proposed Notice of Hearing
A-2	C-102
A-3	Plat of Tracts, Tract Ownership, Applicable Lease Numbers, Unit Recapitulation, Pooled Parties
A-4	Sample Well Proposal Letter and AFE
A-5	Chronology of Contact
Exhibit B	Self-Affirmed Statement of Christopher Cantin
B-1	Regional Locator Map
B-2	Cross-Section Location Map
B-3	Subsea Structure Map
B-4	Stratigraphic Cross-Section
Exhibit C	Self-Affirmed Statement of Dana S. Hardy
C-1	Sample of Notice Letter Sent December 16, 2024
C-2	Chart of Notice to All Interested Parties
C-3	Copies of Certified Mail Receipts and Returns
C-4	Affidavit of Publication for December 19, 2024

COMPULSORY POOLING APPLICATION CHECKLIST	
ALL INFORMATION IN THE APPLICATION MUST BE SUPPORTED BY SIGNED AFFIDAVITS	
Case: 25063	APPLICANT'S RESPONSE
Date: February 13, 2025	
Applicant	Permian Resources Operating, LLC
Designated Operator & OGRID (affiliation if applicable)	Permian Resources Operating, LLC (OGRID No. 372165)
Applicant's Counsel:	Hinkle Shanor LLP
Case Title:	Application of Permian Resources Operating, LLC for Compulsory Pooling, Eddy County, New Mexico.
Entries of Appearance/Intervenors:	EOG Resources, Inc.
Well Family	Taipan
Formation/Pool	
Formation Name(s) or Vertical Extent:	Bone Spring
Primary Product (Oil or Gas):	Oil
Pooling this vertical extent:	Bone Spring
Pool Name and Pool Code:	Avalon; Bone Spring, East (Code 3713)
Well Location Setback Rules:	Statewide
Spacing Unit	
Type (Horizontal/Vertical)	Horizontal
Size (Acres)	320 acres
Building Blocks:	quarter-quarter
Orientation:	West to East
Description: TRS/County	S/2 S/2 of Sections 21 and 22, Township 20 South, Range 28 East, Eddy County
Standard Horizontal Well Spacing Unit (Y/N), If No, describe and is approval of non-standard unit requested in this application?	Yes.
Other Situations	
Depth Severance: Y/N. If yes, description	No.
Proximity Tracts: If yes, description	No.
Proximity Defining Well: if yes, description	N/A
Applicant's Ownership in Each Tract	Exhibit A-3
Well(s)	
Name & API (if assigned), surface and bottom hole location, footages, completion target, orientation, completion status (standard or non-standard)	Add wells as needed
Well #1	Taipan 21 Fed Com 134H (API # pending) SHL: 1,438' FSL & 265' FEL (Unit I), Section 20, T20S-R28E BHL: 330' FSL & 10' FEL (Unit P), Section 22, T20S-R28E Completion Target: Bone Spring (Approx. 8,563' TVD)
AFE Capex and Operating Costs	
Drilling Supervision/Month \$	\$10,000
Production Supervision/Month \$	\$1,000
Justification for Supervision Costs	Exhibit A-4
Requested Risk Charge	200%
Notice of Hearing	
Proposed Notice of Hearing	Exhibit A-1
Proof of Mailed Notice of Hearing (20 days before hearing)	Exhibits C-1, C-2, C-3
Proof of Published Notice of Hearing (10 days before hearing)	Exhibit C-4
Ownership Determination	
Land Ownership Schematic of the Spacing Unit	Exhibit A-3
Tract List (including lease numbers and owners)	Exhibit A-3
If approval of Non-Standard Spacing Unit is requested, Tract List (including lease numbers and owners) of Tracts subject to notice requirements.	N/A

Pooled Parties (including ownership type)	Exhibit A-3
Unlocatable Parties to be Pooled	N/A
Ownership Depth Severance (including percentage above & below)	N/A
Joinder	
Sample Copy of Proposal Letter	Exhibit A-4
List of Interest Owners (ie Exhibit A of JOA)	Exhibit A-3
Chronology of Contact with Non-Joined Working Interests	Exhibit A-5
Overhead Rates In Proposal Letter	Exhibit A-4
Cost Estimate to Drill and Complete	Exhibit A-4
Cost Estimate to Equip Well	Exhibit A-4
Cost Estimate for Production Facilities	Exhibit A-4
Geology	
Summary (including special considerations)	Exhibit B
Spacing Unit Schematic	Exhibit B-1
Gunbarrel/Lateral Trajectory Schematic	N/A
Well Orientation (with rationale)	Exhibit B
Target Formation	Exhibit B
HSU Cross Section	Exhibit B-2
Depth Severance Discussion	N/A
Forms, Figures and Tables	
C-102	Exhibit A-2
Tracts	Exhibit A-3
Summary of Interests, Unit Recapitulation (Tracts)	Exhibit A-3
General Location Map (including basin)	Exhibit B-1
Well Bore Location Map	Exhibit B-2
Structure Contour Map - Subsea Depth	Exhibit B-3
Cross Section Location Map (including wells)	Exhibit B-2
Cross Section (including Landing Zone)	Exhibit B-4
Additional Information	
Special Provisions/Stipulations	N/A
CERTIFICATION: I hereby certify that the information provided in this checklist is complete and accurate.	
Printed Name (Attorney or Party Representative):	Dana S. Hardy
Signed Name (Attorney or Party Representative):	/s/ Dana S. Hardy
Date:	2/6/2025

**STATE OF NEW MEXICO
DEPARTMENT OF ENERGY, MINERALS AND NATURAL RESOURCES
OIL CONSERVATION DIVISION**

**APPLICATION OF PERMIAN RESOURCES
OPERATING, LLC FOR COMPULSORY
POOLING, EDDY COUNTY, NEW MEXICO.**

CASE NO. 25063

**SELF-AFFIRMED STATEMENT
OF RYAN CURRY**

1. I am a Senior Landman with Permian Resources Operating, LLC (“Permian Resources”). I am over 18 years of age, have personal knowledge of the matters addressed herein, and am competent to provide this Self-Affirmed Statement. I have previously testified before the New Mexico Oil Conservation Division (“Division”) and my credentials as an expert in petroleum land matters were accepted and made a matter of record.

2. Copies of Permian Resources’ application and proposed hearing notice are attached as **Exhibit A-1**.

3. None of the parties proposed to be pooled in this case indicated opposition to this matter proceeding by affidavit; therefore I do not expect any opposition at hearing.

4. Permian Resources seeks an order pooling all uncommitted interests in the Bone Spring formation underlying a 320-acre, more or less, standard horizontal spacing unit comprised of the S/2 S/2 of Sections 21 and 22, Township 20 South, Range 28 East, Eddy County, New Mexico (“Unit”).

5. The Unit will be dedicated to the **Taipan 21 Fed Com 134H** well (“Well”), which will be drilled from a surface hole location in the NE/4 SE/4 (Unit I) of Section 20 to a bottom hole location in the SE/4 SE/4 (Unit P) of Section 22.

6. The completed interval of the Well will be orthodox.

7. **Exhibit A-2** contains the C-102 for the Well.

**Permian Resources Operating, LLC
Case No. 25063
Exhibit A**

8. **Exhibit A-3** contains a plat identifying ownership by tract in the Unit. This exhibit also includes any applicable lease numbers, a unit recapitulation, and the interests Permian Resources seeks to pool highlighted in yellow.

9. Permian Resources has conducted a diligent search of all county public records, including phone directories and computer databases, as well as internet searches, to locate the interest owners it seeks to pool.

10. **Exhibit A-4** contains a sample well proposal letter and AFE sent to working interest owners for the Well. The estimated costs reflected on the AFE are fair and reasonable and comparable to the cost of other wells of similar depth and length drilled in the subject formation in the area.

11. In my opinion, Permian Resources made a good-faith effort to reach voluntary joinder of uncommitted interests in the Well as indicated by the chronology of contact described in **Exhibit A-5**.

12. Permian Resources requests overhead and administrative rates of \$10,000 per month while the Well is being drilled and \$1,000 per month while the Well is producing. These rates are fair and are comparable to the rates charged by Permian Resources and other operators in the vicinity.

13. The attached exhibits were either prepared by me or under my supervision or were compiled from company business records.

14. In my opinion, the granting of Permian Resources' application would serve the interests of conservation, the protection of correlative rights, and the prevention of waste.

15. I understand this Self-Affirmed Statement will be used as written testimony in this case. I affirm that my testimony above is true and correct and is made under penalty of perjury

under the laws of the State of New Mexico. My testimony is made as of the date next to my electronic signature below.

SR Curry
RYAN CURRY

1/28/25
Date

**STATE OF NEW MEXICO
DEPARTMENT OF ENERGY, MINERALS AND NATURAL RESOURCES
OIL CONSERVATION DIVISION**

**APPLICATION OF PERMIAN RESOURCES
OPERATING, LLC FOR COMPULSORY
POOLING, EDDY COUNTY, NEW MEXICO.**

CASE NO. 25063

APPLICATION

Pursuant to NMSA § 70-2-17, Permian Resources Operating, LLC (“Applicant”) (OGRID No. 372165) applies for an order pooling all uncommitted interests in the Bone Spring formation underlying a 320-acre, more or less, standard horizontal spacing unit comprised of the S/2 S/2 of Sections 21 and 22, Township 20 South, Range 28 East, Eddy County, New Mexico (“Unit”). In support of its application, Applicant states the following.

1. Applicant is a working interest owner in the Unit and has the right to drill wells thereon.
2. The Unit will be dedicated to the **Taipan 21 Fed Com 134H** well (“Well”), which will be drilled from a surface hole location in the NE/4 SE/4 (Unit I) of Section 20 to a bottom hole location in the SE/4 SE/4 (Unit P) of Section 22.
3. The completed interval of the Well will be orthodox.
4. Applicant has undertaken diligent, good faith efforts to obtain voluntary agreements from all interest owners to participate in the drilling of the Well but has been unable to obtain voluntary agreements from all interest owners.
5. The pooling of uncommitted interests will avoid the drilling of unnecessary wells, prevent waste, and protect correlative rights.

**Permian Resources Operating, LLC
Case No. 25063
Exhibit A-1**

6. In order to allow Applicant to obtain its just and fair share of the oil and gas underlying the subject lands, all uncommitted interests in the Unit should be pooled and Applicant should be designated the operator of the Well and the Unit.

WHEREFORE, Applicant requests that this application be set for hearing before an Examiner of the Oil Conservation Division on January 9, 2025, and, after notice and hearing as required by law, the Division enter an order:

- A. Pooling all uncommitted interests in the Unit;
- B. Approving the Well in the Unit;
- C. Designating Permian Resources Operating, LLC as operator of the Unit and the Well to be drilled thereon;
- D. Authorizing Permian Resources Operating, LLC to recover its costs of drilling, equipping, and completing the Well;
- E. Approving the actual operating charges and costs of supervision while drilling and after completion, together with a provision adjusting the rates pursuant to the COPAS accounting procedures; and
- F. Imposing a 200% charge for the risk assumed by Permian Resources Operating, LLC in drilling and completing the Well against any working interest owner who does not voluntarily participate in the drilling of the Well.

Respectfully submitted,

HINKLE SHANOR LLP

/s/ Dana S. Hardy

Dana S. Hardy

Jaclyn M. McLean

Dylan M. Villescas

P.O. Box 2068
Santa Fe, NM 87504-2068
Phone: (505) 982-4554
dhardy@hinklelawfirm.com
jmclean@hinklelawfirm.com
dvillecas@hinklelawfirm.com
*Counsel for Permian Resources Operating,
LLC*

Application of Permian Resources Operating, LLC for Compulsory Pooling, Eddy County, New Mexico. Permian Resources Operating, LLC (“Applicant”) (OGRID No. 372165) applies for an order pooling all uncommitted interests in the Bone Spring formation underlying a 320-acre, more or less, standard horizontal spacing unit comprised of the S/2 S/2 of Sections 21 and 22, Township 20 South, Range 28 East, Eddy County, New Mexico (“Unit”). The Unit will be dedicated to the **Taipan 21 Fed Com 134H** well (“Well”), which will be drilled from a surface hole location in the NE/4 SE/4 (Unit I) of Section 20 to a bottom hole location in the SE/4 SE/4 (Unit P) of Section 22. The completed interval of the Well will be orthodox. Also to be considered will be the cost of drilling and completing the Well and the allocation of the costs, the designation of Applicant as operator of the Well, and a 200% charge for the risk involved in drilling and completing the Well. The Well is located approximately 10 miles northeast of Carlsbad, New Mexico.

<p>C-102</p> <p>Submit Electronically Via OCD Permitting</p>	<p>State of New Mexico Exhibit A-2 Energy, Minerals & Natural Resources Department OIL CONSERVATION DIVISION</p>	<p>Revised July 9, 2024</p>		
		<table border="1" style="width:100%; border-collapse: collapse;"> <tr> <td style="width:15%; vertical-align: top;"> <p>Submittal Type:</p> </td> <td style="width:85%;"> <p><input type="checkbox"/> Initial Submittal</p> <p><input checked="" type="checkbox"/> Amended Report</p> <p><input type="checkbox"/> As Drilled</p> </td> </tr> </table>	<p>Submittal Type:</p>	<p><input type="checkbox"/> Initial Submittal</p> <p><input checked="" type="checkbox"/> Amended Report</p> <p><input type="checkbox"/> As Drilled</p>
<p>Submittal Type:</p>	<p><input type="checkbox"/> Initial Submittal</p> <p><input checked="" type="checkbox"/> Amended Report</p> <p><input type="checkbox"/> As Drilled</p>			

WELL LOCATION INFORMATION

API Number	Pool Code 3713	Pool Name Avalon, Bone Spring, East
Property Code	Property Name TAIPAN 21 FED COM	Well Number 134H
OGRID No. 372165	Operator Name PERMIAN RESOURCES OPERATING, LLC	Ground Level Elevation 3233.16'
Surface Owner: <input type="checkbox"/> State <input checked="" type="checkbox"/> Fee <input type="checkbox"/> Tribal <input type="checkbox"/> Federal		Mineral Owner: <input checked="" type="checkbox"/> State <input type="checkbox"/> Fee <input type="checkbox"/> Tribal <input checked="" type="checkbox"/> Federal

Surface Location

UL	Section	Township	Range	Lot	Ft. from N/S	Ft. from E/W	Latitude	Longitude	County
I	20	20-S	28-E		1438' S	265' E	32.55570	-104.19232	EDDY

Bottom Hole Location

UL	Section	Township	Range	Lot	Ft. from N/S	Ft. from E/W	Latitude	Longitude	County
P	22	20-S	28-E		330' S	10' E	32.55274	-104.15703	EDDY

Dedicated Acres 320	Infill or Defining Well Defining	Defining Well API TBD	Overlapping Spacing Unit (Y/N) N	Consolidation Code TBD
Order Numbers. TBD			Well setbacks are under Common Ownership: <input checked="" type="checkbox"/> Yes <input type="checkbox"/> No	

Kick Off Point (KOP)

UL	Section	Township	Range	Lot	Ft. from N/S	Ft. from E/W	Latitude	Longitude	County
I	20	20-S	28-E		1438' S	265' E	32.55570	-104.19232	EDDY

First Take Point (FTP)

UL	Section	Township	Range	Lot	Ft. from N/S	Ft. from E/W	Latitude	Longitude	County
M	21	20-S	28-E		330' S	100' W	32.55266	-104.19113	EDDY

Last Take Point (LTP)

UL	Section	Township	Range	Lot	Ft. from N/S	Ft. from E/W	Latitude	Longitude	County
P	22	20-S	28-E		330' S	100' E	32.55274	-104.15732	EDDY

Unitized Area or Area of Uniform Interest	Spacing Unit Type <input checked="" type="checkbox"/> Horizontal <input type="checkbox"/> Vertical	Ground Floor Elevation:
---	--	-------------------------

<p>OPERATOR CERTIFICATIONS</p> <p><i>I hereby certify that the information contained herein is true and complete to the best of my knowledge and belief, and, if the well is a vertical or directional well, that this organization either owns a working interest or unleased mineral interest in the land including the proposed bottom hole location or has a right to drill this well at this location pursuant to a contract with an owner of a working interest or unleased mineral interest, or to a voluntary pooling agreement or a compulsory pooling order heretofore entered by the division.</i></p> <p><i>If this well is a horizontal well, I further certify that this organization has received the consent of at least one lessee or owner of a working interest or unleased mineral interest in each tract (in the target pool or formation) in which any part of the well's completed interval will be located or obtained a compulsory pooling order from the division.</i></p>	<p>SURVEYOR CERTIFICATIONS</p> <p><i>I hereby certify that the well location shown on this plat was plotted from field notes of actual surveys made by me or under my supervision, and that the same is true and correct to the best of my beliefs.</i></p> <p style="text-align: center; color: red; font-weight: bold; font-size: 1.2em;">PRELIMINARY</p> <p style="text-align: center; color: red; font-weight: bold; font-size: 0.8em;">THIS DOCUMENT SHALL NOT BE RECORDED FOR ANY PURPOSE AND SHALL NOT BE USED OR VIEWED OR RELIED UPON AS A FINAL SURVEY DOCUMENT.</p>
<p>Signature Date 12/5/24</p>	<p>Signature and Seal of Professional Surveyor</p>
<p>Printed Name Cassie Evans</p> <p>Email Address Cassie.Evans@permianres.com</p>	<p>Certificate Number</p> <p>Date of Survey</p>

Note: No allowable will be assigned to this completion until all interests have been consolidated or a non-standard unit has been approved by the division.

ACREAGE DEDICATION PLATS

This grid represents a standard section. You may superimpose a non-standard section, or larger area, over this grid. Operators must outline the dedicated acreage in a red box, clearly show the well surface location and bottom hole location, if it is directionally drilled, with the dimensions from the section lines in the cardinal directions. If this is a horizontal wellbore show on this plat the location of the First Take Point and Last Take Point, and the point within the Completed interval (other than the First Take Point or Last Take Point) that is closest to any outer boundary of the tract.

Surveyors shall use the latest United States government survey or dependent resurvey. Well locations will be in reference to the New Mexico Principal Meridian. If the land is not surveyed, contact the OCD Engineering Bureau. Independent subdivision surveys will not be acceptable.

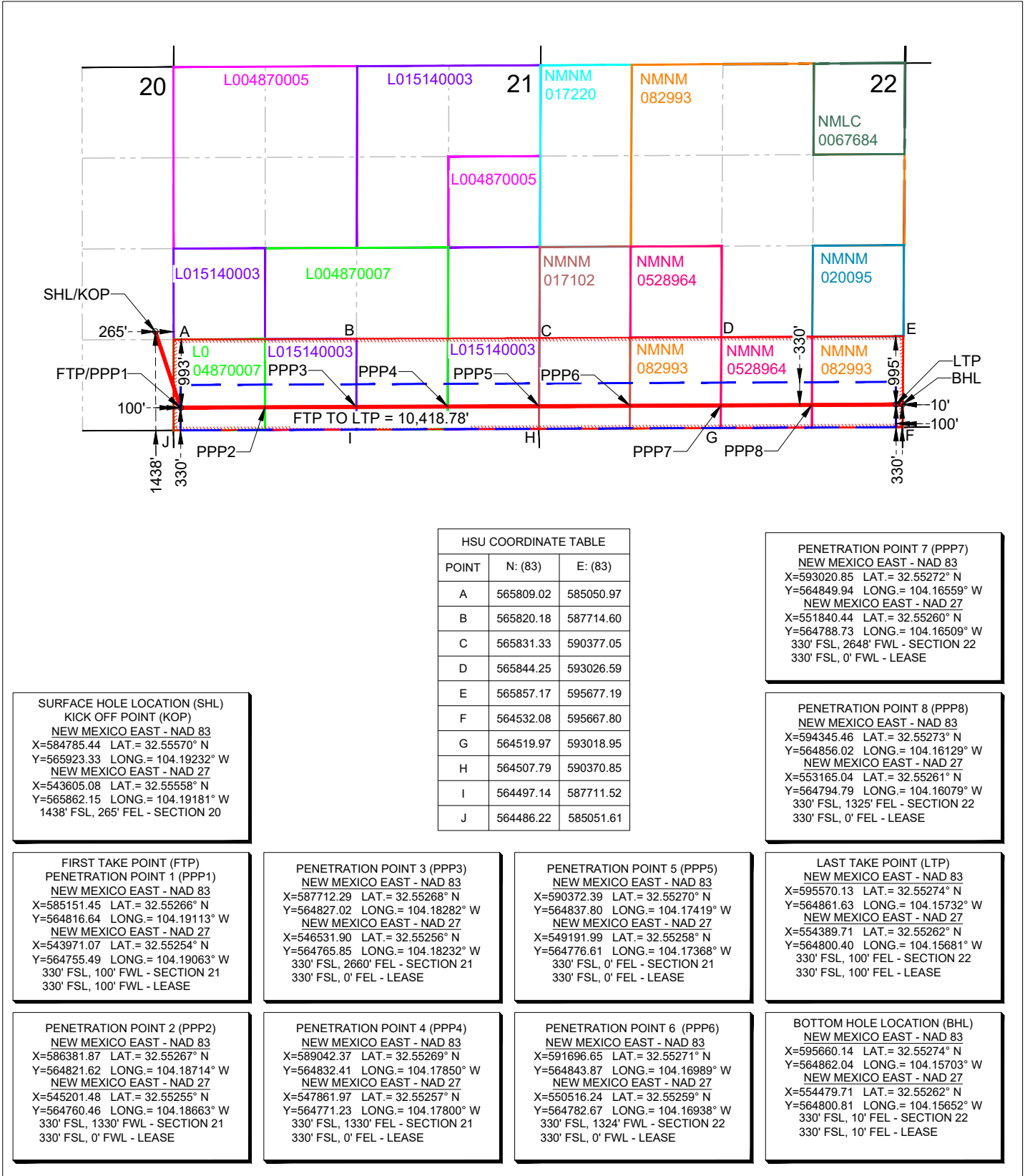

Permian Resources Operating, LLC
Taipan 21 Fed Com 134H

Township 20 South – Range 28 East, N.M.P.M.
Section 21: S/2S/2
Section 22: S/2S/2
Eddy County, New Mexico
Limited in Depth the Bone Spring Formation
320.00 Acres, more or less

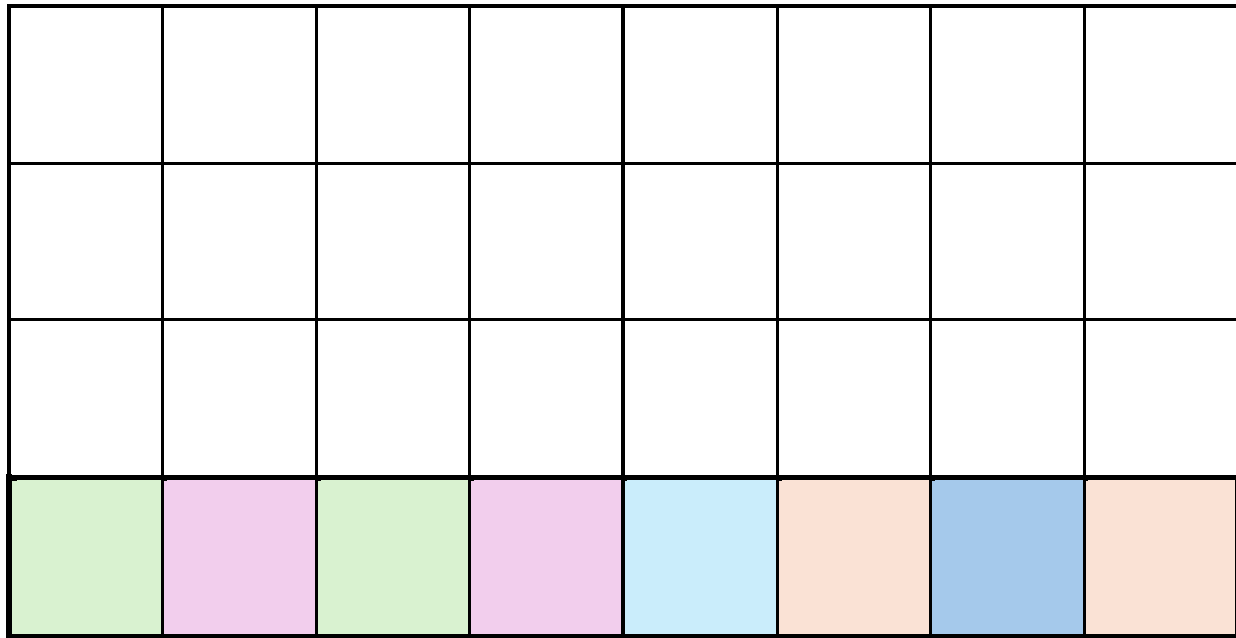

Section 21, T20S-R28E

Section 22, T20S-R28E

Tract 1: NMSLO L0-0487-0007
Tract 2: NMSLO L0-1514
Tract 3: BLM NMNM-017102
Tract 4: BLM NMNM-082993
Tract 5: BLM NMNM-0528964

Tract 1: Section 21: SW/4SW/4, SW/4SE/4 (Containing 80.00 Acres More or Less)

Permian Resources Operating, LLC	66.260000%
Claremont Corporation	3.500000%
McAnSo, LLC	15.120000%
Bursake , LLC	15.120000%
Total	100.000000%

Tract 2: Section 21: SE/4SW4, SE/4SE/4 (Containing 80.00 Acres More or Less)

Permian Resources Operating, LLC	66.260000%
Claremont Corporation	3.500000%
McAnSo, LLC	15.120000%
Bursake, LLC	15.120000%
Magnum Hunter Production, Inc.	Record Title
Total	100.000000%

Tract 3: Section 22: SW/4SW/4 (Containing 40.00 Acres More or Less)

Permian Resources Operating, LLC	96.289392%
Davoil, Inc.	1.158065%
BEXP II GW Alpha, LLC	0.896208%
BEXP II Omega Misc., LLC	1.205677%
Sabinal Energy Operating, LLC	0.450658%
Great Western Drilling Co.	Record Title
Davoil, Inc.	Record Title
Total	100.000000%

Tract 4: Section 22: SE/4SW/4, SE/4SE/4 (Containing 80.00 Acres More or Less)

Permian Resources Operating, LLC	96.289392%
Davoil, Inc.	1.158065%
BEXP II GW Alpha, LLC	0.896208%
BEXP II Omega Misc., LLC	1.205677%
Sabinal Energy Operating, LLC	0.450658%
Total	100.000000%

Tract 5: Section 22: SW/4SE/4 (Containing 40.00 Acres More or Less)

Permian Resources Operating, LLC	96.289392%
Davoil, Inc.	1.158065%
BEXP II GW Alpha, LLC	0.896208%
BEXP II Omega Misc., LLC	1.205677%
Sabinal Energy Operating, LLC	0.450658%
Total	100.000000%

Unit Working Interest

Permian Resources Operating, LLC	81.274696%
Bursake , LLC	7.560000%
McAnSo, LLC	7.560000%
Claremont Corporation	1.750000%
Davoil, Inc.	0.579033%
Sabinal Energy Operating, LLC	0.225329%
BEXP II GW Alpha, LLC	0.448104%
BEXP II Omega Misc., LLC	0.602838%
Great Western Drilling Co.	Record Title
Davoil, Inc.	Record Title
Magnum Hunter Production, Inc.	Record Title
Total	100.000000%
Total Committed to Unit	81.274696%
Total Seeking to Pool	18.725304%
Parties Seeking to Pool	

***Parties to be pooled are highlighted in yellow.**



300 N. MARIENFELD STREET, SUITE 1000
MIDLAND, TX 79701

OFFICE 432.695.4222
FAX 432.695.4063

October 22, 2024

Via Certified Mail

CLAREMONT CORPORATION
PO BOX 3226
TULSA, OK 74101

RE: Well Proposals – Taipan 21 Fed Com Wells
All of Sections 21, & 22, T20S-R28E
Eddy County, New Mexico

To Whom It May Concern:

Permian Resources Operating, LLC (“Permian”), as operator, hereby proposes the drilling and completion of the following eight (8) wells, the Taipan 21 Fed Com Wells at the following approximate locations within Township 20 South, Range 28 East, Eddy Co., NM:

1. Taipan 21 Fed Com 131H

SHL: 1,538’ FNL & 180’ FEL or a legal location in Unit Letter H of Section 20
BHL: 990’ FNL & 50’ FEL of Section 22
FTP: 990’ FNL & 100’ FWL of Section 21
LTP: 990’ FNL & 100’ FEL of Section 22
TVD: Approximately 8,549’
TMD: Approximately 18,834’
Proration Unit: N/2N/2 of Sections 21 & 22, T20S-R28E
Targeted Interval: 3rd Bone Spring
Total Cost: See attached AFE

2. Taipan 21 Fed Com 132H

SHL: 1,598’ FNL & 180’ FEL or a legal location in Unit Letter H of Section 20
BHL: 2310’ FNL & 50’ FEL of Section 22
FTP: 2310’ FNL & 100’ FWL of Section 21
LTP: 2310’ FNL & 100’ FEL of Section 22
TVD: Approximately 8,549’
TMD: Approximately 18,834’
Proration Unit: S/2N/2 of Sections 21 & 22, T20S-R28E
Targeted Interval: 3rd Bone Spring
Total Cost: See attached AFE

3. Taipan 21 Fed Com 133H

SHL: 1,438’ FSL & 266’ FEL or a legal location in Unit Letter I of Section 20
BHL: 1650’ FSL & 50’ FEL of Section 22
FTP: 1650’ FSL & 100’ FWL of Section 21
LTP: 1650’ FSL & 100’ FEL of Section 22
TVD: Approximately 8,543’
TMD: Approximately 18,828’
Proration Unit: N/2S/2 of Sections 21 & 22, T20S-R28E
Targeted Interval: 3rd Bone Spring
Total Cost: See attached AFE

Permian Resources Operating, LLC
Case No. 25063
Exhibit A-4



300 N. MARIENFELD STREET, SUITE 1000
MIDLAND, TX 79701

OFFICE 432.695.4222
FAX 432.695.4063

4. Taipan 21 Fed Com 134H

SHL: 1,438' FSL & 326' FEL or a legal location in Unit Letter I of Section 20
BHL: 330' FSL & 50' FEL of Section 22
FTP: 330' FSL & 100' FWL of Section 21
LTP: 330' FSL & 100' FEL of Section 22
TVD: Approximately 8,563'
TMD: Approximately 18,848'
Proration Unit: S/2S/2 of Sections 21 & 22, T20S-R28E
Targeted Interval: 3rd Bone Spring
Total Cost: See attached AFE

5. Taipan 21 Fed Com 201H

SHL: 1,508' FNL & 180' FEL or a legal location in Unit Letter H of Section 20
BHL: 330' FNL & 50' FEL of Section 22
FTP: 330' FNL & 100' FWL of Section 21
LTP: 330' FNL & 100' FEL of Section 22
TVD: Approximately 8,899'
TMD: Approximately 19,184'
Proration Unit: N/2N/2 of Sections 21 & 22, T20S-R28E
Targeted Interval: Wolfcamp
Total Cost: See attached AFE

6. Taipan 21 Fed Com 202H

SHL: 1,568' FNL & 180' FEL or a legal location in Unit Letter H of Section 20
BHL: 1650' FNL & 50' FEL of Section 22
FTP: 1650' FNL & 100' FWL of Section 21
LTP: 1650' FNL & 100' FEL of Section 22
TVD: Approximately 8,899'
TMD: Approximately 19,184'
Proration Unit: S/2N/2 of Sections 21 & 22, T20S-R28E
Targeted Interval: Wolfcamp
Total Cost: See attached AFE

7. Taipan 21 Fed Com 203H

SHL: 1,438' FSL & 356' FEL or a legal location in Unit Letter I of Section 20
BHL: 2310' FSL & 50' FEL of Section 22
FTP: 2310' FSL & 100' FWL of Section 21
LTP: 2310' FSL & 100' FEL of Section 22
TVD: Approximately 8,903'
TMD: Approximately 19,188'
Proration Unit: N/2S/2 of Sections 21 & 22, T20S-R28E
Targeted Interval: Wolfcamp
Total Cost: See attached AFE

8. Taipan 21 Fed Com 204H

SHL: 1,438' FSL & 296' FEL or a legal location in Unit Letter I of Section 20
BHL: 990' FSL & 50' FEL of Section 22

PERMIAN

RESOURCES

300 N. MARIENFELD STREET, SUITE 1000
MIDLAND, TX 79701

OFFICE 432.695.4222
FAX 432.695.4063

FTP: 990' FSL & 100' FWL of Section 21
LTP: 990' FSL & 100' FEL of Section 22

TVD: Approximately 8,913'
TMD: Approximately 19,198'
Proration Unit: S/2S/2 of Sections 21 & 22, T20S-R28E
Targeted Interval: Wolfcamp
Total Cost: See attached AFE

The locations, TVDs, and targets are approximate and subject to change dependent on surface or subsurface issues encountered. These surface hole locations fall within an approved potash drill island and are subject to change based on BLM approval. Permian is proposing to drill these wells under the modified terms of the 1989 AAPL Operating Agreement and a form of said Operating Agreement is available upon request. The Operating Agreement has the following general provisions:

- 100%/300%/300% non-consent provisions
- \$10,000/\$1,000 drilling and producing rates
- Permian Resources Operating, LLC named as Operator

Please indicate your election to participate in the drilling and completion of the proposed wells on the enclosed ballot. Please sign and return one copy of this letter, signed copies of the proposed AFEs, a signed copy of the enclosed insurance declaration, and your geologic well requirements.

Due to

In the interest of time, should we not reach an agreement within thirty (30) days of the date of your receipt of this letter, Permian will apply to the New Mexico Oil Conservation Division for compulsory pooling of your interest into spacing units for the proposed wells. If you do not wish to participate, Permian would be interested in acquiring your interest in the subject lands which is subject to further mutually agreeable negotiation.

Please return elections by mail and/or email to the attention of Erin Lloyd, Erin.Lloyd@permianres.com

Thank you for your time and consideration, if you have any questions at all, please don't hesitate to contact me at, Ryan.Curry@permianres.com.

Respectfully,



Ryan Curry | Senior Landman

O 432.400.0209 | ryan.curry@permianres.com
300 N. Marienfeld Street, Suite 1000 | Midland, TX 79701

Enclosures

ELECTIONS ON PAGE TO FOLLOW



300 N. MARIENFELD STREET, SUITE 1000
MIDLAND, TX 79701

OFFICE 432.695.4222
FAX 432.695.4063

Taipan 21 Fed Com Elections:

Well Elections: <i>(Please indicate your responses in the spaces below)</i>		
Well(s)	Elect to Participate	Elect to <u>NOT</u> Participate
Taipan 21 Fed Com 131H		
Taipan 21 Fed Com 132H		
Taipan 21 Fed Com 133H		
Taipan 21 Fed Com 134H		
Taipan 21 Fed Com 201H		
Taipan 21 Fed Com 202H		
Taipan 21 Fed Com 203H		
Taipan 21 Fed Com 204H		

Company Name (If Applicable):

By: _____

Printed Name: _____

Date: _____



300 N. MARIENFELD STREET, SUITE 1000
MIDLAND, TX 79701

OFFICE 432.695.4222
FAX 432.695.4063

Participate / Rejection Declaration

Please return this page to Permian Resources Operating, LLC (“Permian”) by the date specified in the letter, signed indicating your election to either participate in or reject this insurance program. If you reject the insurance coverage arranged by Permian, then, to the extent that Permian has an obligation to secure any such insurance on your behalf under any applicable agreements or otherwise, Permian will be relieved of such obligation, and Permian will assume that you maintain appropriate levels of insurance and will provide a current Certificate of Insurance upon request. If you fail to make an election within 30 days from receipt of this notice, you will be deemed a participant in the program as detailed on the attached and billed for your percentage participation as such.

- I hereby elect to participate in the insurance coverage arranged by Permian Resources Operating, LLC and understand that I will be charged for such participation.
- I hereby elect to reject the insurance coverage arranged by Permian Resources Operating, LLC.

Company Name (If Applicable):

By: _____

Printed Name: _____

Date: _____

AFE Number:		Description:	SHL LEGAL
AFE Name:	TAIPAN 21 FED COM 134H	AFE TYPE:	Drill and Complete
Well Operator:	PERMIAN RESOURCES OPERATING, LLC		
Operator AFE #:			

<u>Account</u>	<u>Description</u>	<u>Gross Est. (\$)</u>
Completion Intangible		
8025.3500	ICC - WELLSITE SUPERVISION	\$56,700.00
8025.3400	ICC - RENTAL EQUIPMENT	\$202,410.00
8025.3700	ICC - SAFETY / ENVIRONMENTAL	\$15,000.00
8025.3800	ICC - OVERHEAD	\$10,000.00
8025.1100	ICC - ROAD, LOCATIONS, PITS	\$10,500.00
8025.3000	ICC - WATER HANDLING	\$199,134.00
8025.2500	ICC - WELL STIMULATION/FRACTUR	\$2,487,131.00
8025.2000	ICC - TRUCKING	\$14,375.00
8025.3050	ICC - SOURCE WATER	\$368,398.00
8025.1500	ICC - FUEL / POWER	\$647,517.00
8025.2300	ICC - COMPLETION FLUIDS	\$10,000.00
8025.2200	ICC - ELECTRIC LOGGING / PERFORATING	\$398,624.00
8025.1600	ICC - COILED TUBING	\$226,602.00
8025.2600	ICC - CONTRACT LABOR/ROUSTABOUT	\$15,000.00
8025.1400	ICC - WIRELINE OPEN/CASED HOLE	\$40,000.00
8025.3100	ICC - WELLHEAD/FRACTREE REPAIR	\$40,000.00
8025.1800	ICC - WATER DISPOSAL/VACUUM TRUCK	\$18,113.00
8025.3600	ICC - SUPERVISION/ENGINEERING	\$5,000.00
	Sub-total	\$4,764,504.00
Drilling Intangible		
8015.3200	IDC - CONTRACT LABOR/ROUSTABOUT	\$27,000.00
8015.1900	IDC - DIRECTNL DRILL & SURVEY	\$248,760.47
8015.1310	IDC - PERMANENT EASEMENT	\$12,000.00
8015.5200	IDC - CONTINGENCY	\$116,725.85
8015.2600	IDC - MUD LOGGING	\$35,000.00
8015.1400	IDC - ROAD, LOCATIONS, PITS	\$95,625.00
8015.4600	IDC - SAFETY / ENVIRONMENTAL	\$20,150.00
8015.3000	IDC - CEMENT SERV/FLOAT EQUIP	\$143,200.00
8015.1500	IDC - RIG MOB / TRUCKING	\$127,500.00
8015.3600	IDC - SOLIDS CONTROL/ CLOSED LOOP SYSTEM	\$60,934.38
8015.3400	IDC - MATERIALS & SUPPLIES	\$5,000.00
8015.3800	IDC - WELLHEAD PREPARE/REPAIR	\$12,500.00
8015.4100	IDC - RENTAL EQUIPMENT	\$85,250.00
8015.4300	IDC - WELLSITE SUPERVISION	\$89,900.00
8015.1300	IDC - SURFACE DAMAGE / ROW	\$35,000.00
8015.1000	IDC - PERMITS,LICENSES,ETC	\$15,000.00
8015.1100	IDC - STAKING & SURVEYING	\$15,000.00
8015.2150	IDC - DRILL BIT	\$98,000.00
8015.2200	IDC - BITS, TOOLS, STABILIZERS	\$53,346.00
8015.3500	IDC - TRUCKING/VACUUM/ TRANSP	\$23,250.00

<u>Account</u>	<u>Description</u>	<u>Gross Est. (\$)</u>
8015.2500	IDC - MUD/CHEMICALS/ACIDIZING	\$186,604.40
8015.1200	IDC - LEGAL, TITLE SERVICES	\$13,000.00
8015.4200	IDC - MANCAMP	\$40,300.00
8015.2350	IDC - FUEL/MUD	\$73,570.31
8015.3700	IDC - DISPOSAL	\$153,384.00
8015.2300	IDC - FUEL / POWER	\$165,305.08
8015.5000	IDC - WELL CONTROL INSURANCE	\$8,525.00
8015.3100	IDC - CASING CREW & TOOLS	\$47,500.00
8015.2700	IDC - INSPECTION, TESTING & REPAIR	\$37,000.00
8015.1600	IDC - RIG MOB / STANDBY RATE	\$36,300.00
8015.2400	IDC - RIG WATER	\$19,375.00
8015.2000	IDC - CONDUCTOR HOLE & SERVICE	\$47,812.50
8015.1700	IDC - DAYWORK CONTRACT	\$597,815.63
	Sub-total	\$2,745,633.62
Artificial Lift Intangible		
8060.1900	IAL - INSPECTION & TESTING	\$3,000.00
8060.3410	IAL - LAYDOWN MACHINE	\$5,000.00
8060.2010	IAL - KILL TRUCK	\$5,000.00
8060.2000	IAL - TRUCKING/VACUUM/TRANSP	\$5,000.00
8060.2600	IAL - CONTRACT LABOR/ROUSTABOUT	\$15,000.00
8060.1200	IAL - WORKOVER RIG	\$17,000.00
8060.1400	IAL - WIRELINE OPEN/CASED HOLE	\$10,000.00
8060.3500	IAL - WELLSITE SUPERVISION	\$5,000.00
8060.3420	IAL - REVERSE UNIT RENTAL	\$5,000.00
8060.3400	IAL - RENTAL EQUIPMENT	\$5,000.00
8060.2300	IAL - COMPLETION FLUIDS	\$5,000.00
	Sub-total	\$80,000.00
Pipeline		
8036.2200	PLN - CONTRACT LABOR	\$35,904.00
8036.3200	PLN - VALVES FITTINGS & PIPE	\$15,000.00
8036.2800	PLN - FLOWLINE MATERIAL	\$42,240.00
8036.1310	PLN - PERMANENT EASEMENT	\$4,128.00
	Sub-total	\$97,272.00
Facilities		
8035.2200	FAC - CONTRACT LABOR / ROUSTAB	\$21,429.00
8035.1500	FAC - MATERIALS & SUPPLIES	\$2,143.00
8035.1600	FAC - TRANSPORTATION TRUCKING	\$4,286.00
8035.2100	FAC - INSPECTION & TESTING	\$714.00
8035.1900	FAC - WATER DISPOSAL / SWD	\$429.00
8035.3400	FAC - METER & LACT	\$14,500.00
8035.4400	FAC - COMPANY LABOR	\$1,429.00
8035.4500	FAC - CONTINGENCY	\$7,884.00
8035.3000	FAC - HEATER TREATER/SEPARATOR	\$110,000.00
8035.1700	FAC - RENTAL EQUIPMENT	\$7,143.00
8035.2400	FAC - SUPERVISION	\$8,571.00
8035.2500	FAC - CONSULTING SERVICES	\$714.00

<u>Account</u>	<u>Description</u>	<u>Gross Est. (\$)</u>
8035.3600	FAC - ELECTRICAL	\$10,714.00
8035.3200	FAC - VALVES FITTINGS & PIPE	\$57,143.00
8035.3700	FAC - AUTOMATION MATERIAL	\$10,714.00
8035.3100	FAC - DEHYDRATOR EQUIPMENT	\$12,857.00
	Sub-total	\$270,670.00
Artificial Lift Tangible		
8065.2300	TAL - GAS LIFT INJECTION LINE & INSTALL	\$80,000.00
8065.1100	TAL - TUBING	\$125,000.00
8065.3100	TAL - MEASUREMENT EQUIPMENT	\$30,000.00
8065.3200	TAL - COMM, TELEMETRY & AUTOMA	\$10,000.00
8065.2000	TAL - WELLHEAD EQUIPMENT	\$60,000.00
8065.2400	TAL - COMPRESSOR INSTALL & STARTUP	\$70,000.00
8065.1320	TAL - GAS LIFT EQUIPMENT/INSTALL	\$30,000.00
8065.2500	TAL - VALVES/CONNECTIONS/FTGS	\$15,000.00
	Sub-total	\$420,000.00
Flowback Intangible		
8040.4000	IFC - CHEMICALS	\$15,000.00
8040.3430	IFC - SURFACE PUMP RENTAL	\$20,000.00
8040.2900	IFC - WELL TESTING / FLOWBACK	\$125,000.00
8040.1899	IFC - FRAC WATER RECOVERY	\$215,000.00
8040.1100	IFC - ROADS LOCATIONS / PITS	\$5,000.00
8040.2000	IFC - TRUCKING/VACUUM/TRANSP	\$20,000.00
8040.3420	IFC - TANK RENTALS	\$20,000.00
8040.3500	IFC - WELLSITE SUPERVISION	\$10,000.00
	Sub-total	\$430,000.00
Completion Tangible		
8030.2000	TCC - WELLHEAD EQUIPMENT	\$47,250.00
	Sub-total	\$47,250.00
Drilling Tangible		
8020.1200	TDC - CASING - INTERMEDIATE - 1	\$102,905.25
8020.1400	TDC - CASING - PRODUCTION	\$454,891.41
8020.1500	TDC - WELLHEAD EQUIPMENT	\$63,750.00
8020.1100	TDC - CASING - SURFACE	\$20,302.25
	Sub-total	\$641,848.91
	Grand Total	\$9,497,178.53

Company Name (If Applicable):

By: _____

Printed Name: _____

Date: _____



300 N. MARIENFELD STREET, SUITE 1000
MIDLAND, TX 79701

OFFICE 432.695.4222
FAX 432.695.4063

Taipan – Chronology of Communication

October 22, 2024 – Proposals sent to all parties.

October 28, 2024 – Email correspondence with Bursake, LLC regarding working interest.

October 29, 2024 - Email correspondence with Sabinal Energy, LLC regarding working interest and request for JOA.

October 31, 2024 - Email correspondence with Karen Benbow Mcrae regarding proposal.

October 31, 2024 – Email correspondence with Claremont Corporation regarding working interest.

November 8, 2024 – Email correspondence with EOG Resources, Inc. regarding proposal.

November 8, 2024 – Phone conversation with Morris Williams regarding proposal.

November 8, 2024 – Phone conversation with William Bennet of McAnSo & Bursake regarding interest in the Unit.

November 8, 2024 – Phone conversation with Frank Medrano, on behalf of Karen Benbow McRae, regarding interest in the Unit.

November 11, 2024- Email correspondence with Claremont Corporation regarding working interest.

November 12, 2024 – Email correspondence with Claremont Corporation regarding working interest.

November 12, 2024 – Phone conversation with Claremont Corporation regarding working interest.

November 14, 2024 – Email correspondence with Sabinal Energy, LLC regarding JOA.

November 14, 2024 - Email correspondence with Karen Benbow Mcrae regarding working interest and JOA.

November 14, 2024 – Email correspondence with Claremont Corporation regarding working interest and JOA.

November 14, 2024 – Email correspondence with EOG Resources, Inc. regarding proposal.

November 15, 2024 – Email correspondence with Davoil discussing upcoming development plans inclusive of subject project.

November 18, 2024 – Email correspondence with Sabinal Energy, LLC regarding JOA.

November 19, 2024 - Email correspondence with Claremont Corporation regarding proposal.



300 N. MARIENFELD STREET, SUITE 1000
MIDLAND, TX 79701

OFFICE 432.695.4222
FAX 432.695.4063

November 21, 2024 - Email correspondence with Claremont Corporation regarding proposal and received elections.

November 22, 2024 - Email correspondence with Claremont Corporation regarding proposal.

December 5, 2024 – Email correspondence with Magnum Hunter Production regarding proposal.

December 11, 2025 – Email correspondence with BEXP regarding the project.

December 17, 2025 – Email correspondence with Sabinal regarding their interest in the project.

December 19, 2025 – Email correspondence with Karen Benbow Mcrae regarding potential acquisition

December 26, 2024 – Email correspondence with Hurt Properties.

January 7, 2025 – Email correspondence with Pat Gray on behalf of Magnum Hunter discussing voluntary joinder.

January 22, 2025 – Email correspondence with Karen Benbow Mcrae regarding potential acquisition

January 23, 2025 – Email correspondence with Karen Benbow Mcrae regarding potential acquisition

STATE OF NEW MEXICO
DEPARTMENT OF ENERGY, MINERALS AND NATURAL RESOURCES
OIL CONSERVATION DIVISION

APPLICATIONS OF PERMIAN RESOURCES
OPERATING, LLC FOR COMPULSORY
POOLING, EDDY COUNTY, NEW MEXICO.

CASE NOS. 25060, 25061
25062, 25063

SELF-AFFIRMED STATEMENT
OF CHRISTOPHER CANTIN

1. I am a geologist with Permian Resources Operating, LLC (“Permian Resources”). I am over 18 years of age, have personal knowledge of the matters addressed herein, and am competent to provide this Self-Affirmed Statement. I have previously testified before the New Mexico Oil Conservation Division (“Division”) and my credentials as an expert in petroleum geology were accepted and made a matter of record.

2. I am familiar with the geological matters that pertain to the above-referenced cases.

3. **Exhibit B-1** is a regional locator map that identifies the Taipan project area, in proximity to the Capitan Reef within the Delaware Basin, for the Bone Spring horizontal spacing units that are the subject of these applications.

4. **Exhibit B-2** is a cross-section location map for the proposed horizontal spacing units within the Bone Spring formation. The approximate wellbore paths for the proposed **Taipan 21 Fed Com 131H, Taipan 21 Fed Com 132H, Taipan 21 Fed Com 133H, and Taipan 21 Fed Com 134H** wells (“Wells”) are represented by dashed red lines. Existing producing wells in the targeted interval are represented by solid red lines. This map identifies the cross-section running from A-A’ with the cross-section wells name and a black line in proximity to the proposed Wells.

5. **Exhibit B-3** is a Subsea Structure map of the Bone Spring formation in TVD subsea with a contour interval of 100 ft. The map identifies the approximate wellbore paths for the

**Permian Resources Operating, LLC
Case No. 25063
Exhibit B**

proposed Wells with a red dashed line. It also identifies the location of the cross-section running from A-A' in proximity to the proposed Wells. The data points are indicated by red triangles. The map demonstrates the formation is gently dipping to the southeast in this area. I do not observe any faulting, pinch-outs, or geologic impediments to developing the targeted intervals with horizontal wells.

6. **Exhibit B-4** identifies two wells penetrating the targeted interval, which I used to construct a stratigraphic cross-section from A to A'. It contains gamma ray, resistivity, and porosity logs. The cross section is oriented from west to east and is flattened at the base of the Third Bone Spring Formation. The proposed landing zone for the Wells is labeled on the exhibit. The approximate well-paths for the proposed Wells are indicated by a dashed red line to be drilled from west to east across the units. This cross-section demonstrates the target interval is continuous across the Unit.

7. In my opinion, a lay down orientation for the Wells is appropriate to properly develop the subject acreage because of consistent rock properties throughout the Unit and is the preferred fracture orientation in this portion of the trend.

8. Based on my geologic study of the area, the targeted interval underlying the Unit is suitable for development by horizontal wells and the tracts comprising the Unit will contribute more or less equally to the production of the Wells.

9. In my opinion, the granting of Permian Resources' application will serve the interests of conservation, the protection of correlative rights, and the prevention of waste.

10. The exhibits attached hereto were either prepared by me or under my supervision or were compiled from company business records.

11. I understand this Self-Affirmed Statement will be used as written testimony in this case. I affirm my testimony above is true and correct and is made under penalty of perjury under the laws of the State of New Mexico. My testimony is made as of the date identified next to my signature below.

CHRISTOPHER CANTIN



Date

Regional Locator Map

Taipan 21Fed Com

Permian Resources Operating, LLC
Case No. 25063
Exhibit B-1

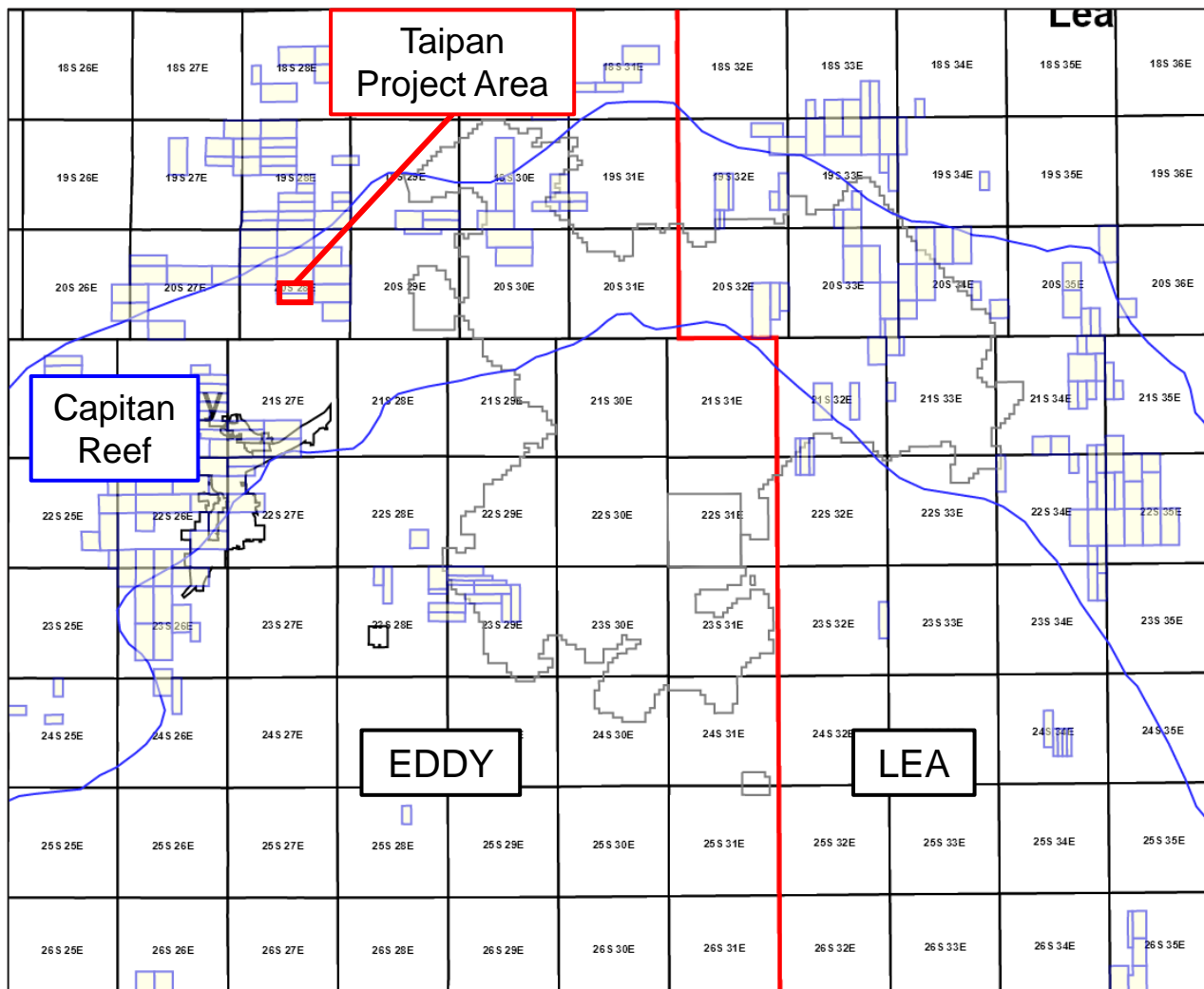
Exhibit B-1



Permian Resources



Cross-Section Locator Map

Taipan 21 Fed Com Third Bone Spring

Permian Resources Operating, LLC
Case No. 25063
Exhibit B-2

Exhibit B-2

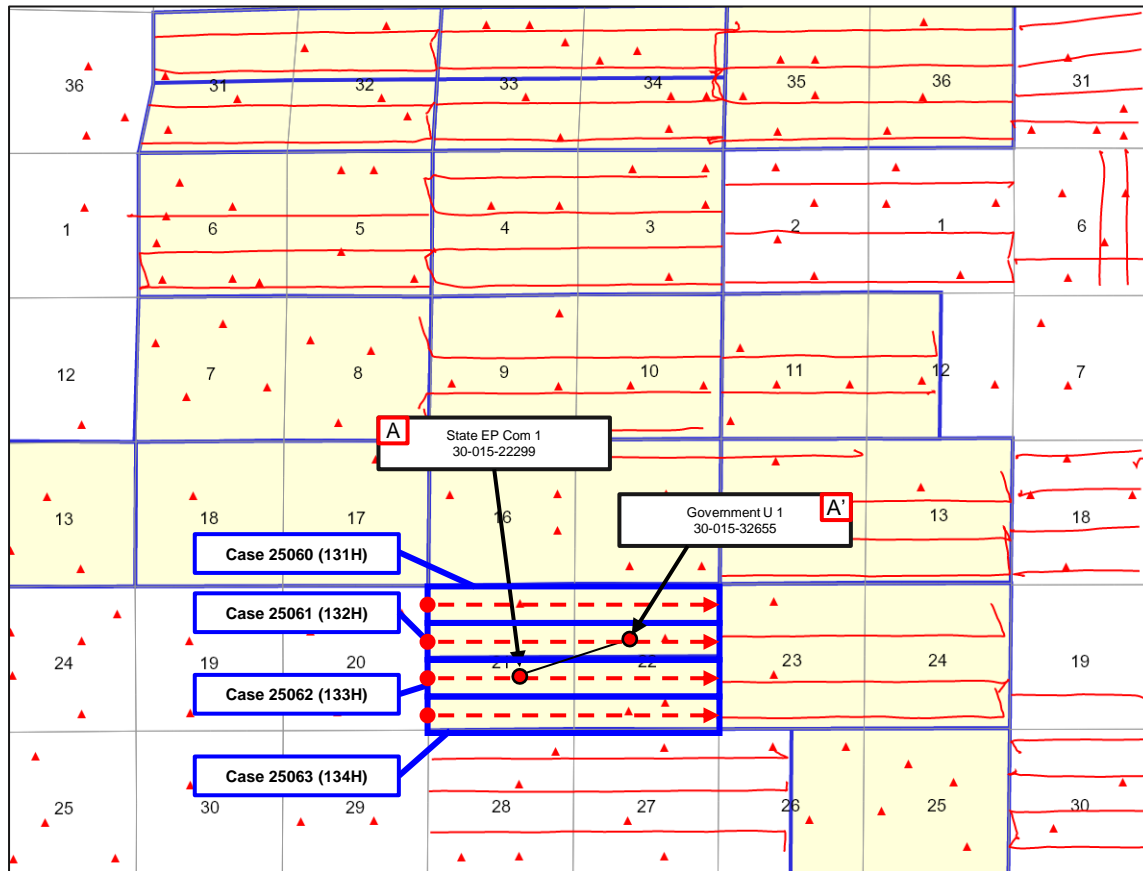

Control Point



Proposed Wells



Producing Wells

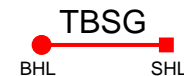

Permian Resources



Base of Third Bone Spring – Structure Map

Taipan 21 Fed Com Third Bone Spring

Case No. 25063

Exhibit B-3

Exhibit B-3

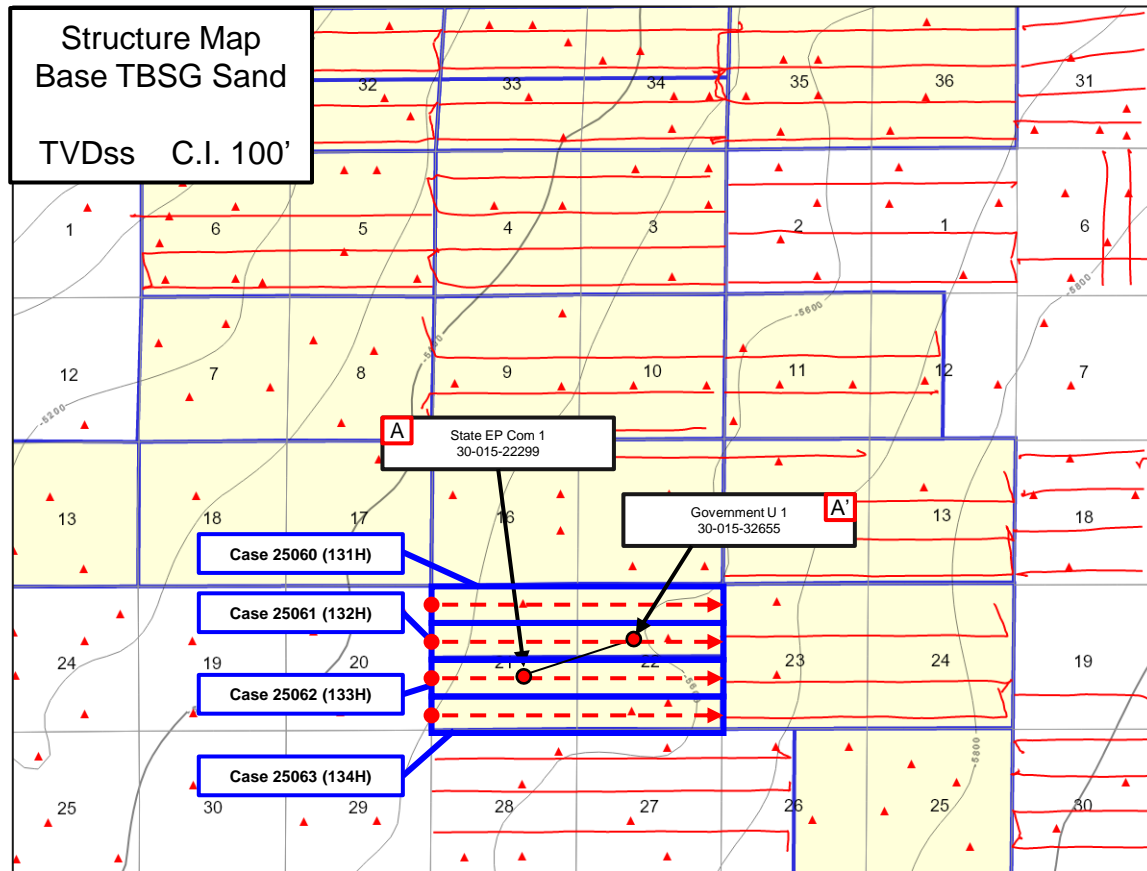

Permian Resources



Stratigraphic Cross-Section A-A'

Taipan 21 Fed Com Third Bone Spring

Permian Resources Operating, LLC
Case No. 25063
Exhibit B-4

Exhibit B-4

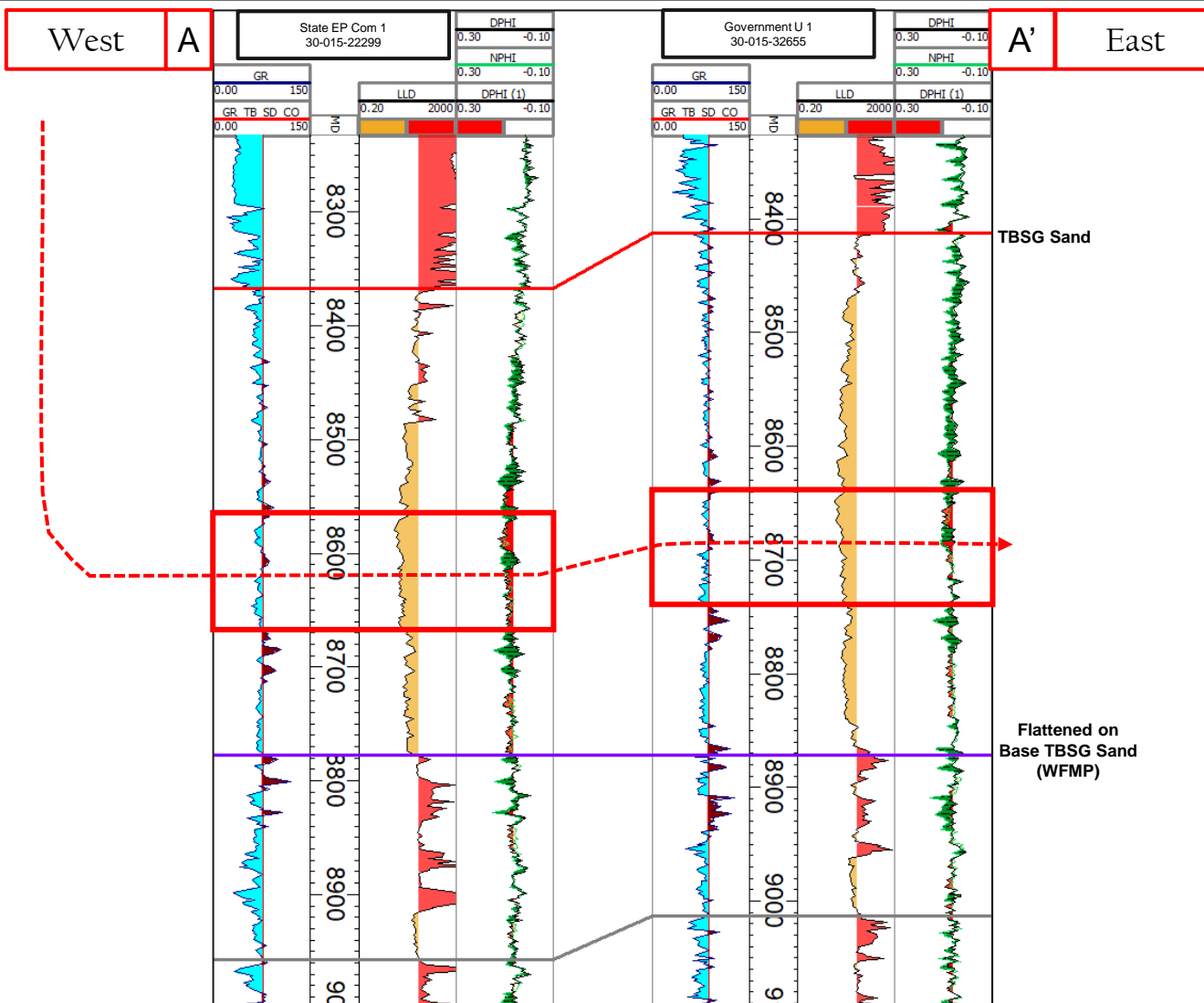

**STATE OF NEW MEXICO
DEPARTMENT OF ENERGY, MINERALS AND NATURAL RESOURCES
OIL CONSERVATION DIVISION**

**APPLICATION OF PERMIAN RESOURCES
OPERATING, LLC FOR COMPULSORY
POOLING, EDDY COUNTY, NEW MEXICO.**

CASE NO. 25063

**SELF-AFFIRMED STATEMENT
OF DANA S. HARDY**

1. I am attorney in fact and authorized representative of Permian Resources Operating, LLC the Applicant herein.

2. I am familiar with the Notice Letter attached as **Exhibit C-1**, and caused the Notice Letter, along with the Application in this case, to be sent to the parties set out in the chart attached as **Exhibit C-2**.

3. **Exhibit C-2** also provides the date each Notice Letter was sent and the date each return was received.

4. Copies of the certified mail green cards and white slips are attached as **Exhibit C-3** as supporting documentation for proof of mailing and the information provided on **Exhibit C-2**.

5. On December 19, 2024, I caused a notice to be published in the Carlsbad Current Argus. An Affidavit of Publication from the Legal Clerk of the Carlsbad Current Argus along with a copy of the notice publication, is attached as **Exhibit C-4**.

6. I understand this Self-Affirmed Statement will be used as written testimony in the subject case. I affirm that my testimony above is true and correct and is made under penalty of perjury under the laws of the State of New Mexico. My testimony is made as of the date handwritten next to my signature below.

/s/ Dana S. Hardy
Dana S. Hardy

January 21, 2025
Date

**Permian Resources Operating, LLC
Case No. 25063
Exhibit C**



hinklelawfirm.com

HINKLE SHANOR LLP

ATTORNEYS AT LAW

P.O. BOX 2068

SANTA FE, NEW MEXICO 87504

505-982-4554 (FAX) 505-982-8623

WRITER:
Dana S. Hardy, Partner
dhardy@hinklelawfirm.com

December 16, 2024

VIA CERTIFIED MAIL
RETURN RECEIPT REQUESTED

TO ALL PARTIES ENTITLED TO NOTICE

Re: Case Nos. 25060, 25061, 25062, 25063, 25064, 25065, 25066 & 25067 – Applications of Permian Resources Operating, LLC for Compulsory Pooling, Eddy County, New Mexico.

To whom it may concern:

This letter is to advise you that the enclosed applications were filed with the New Mexico Oil Conservation Division. The hearing will be conducted on **February 13, 2025**, beginning at 9:00 a.m.

The hearing will be conducted in a hybrid fashion, both virtually and in-person at the Energy, Minerals, Natural Resources Department, Wendell Chino Building, Pecos Hall, 1220 South St. Francis Drive, 1st Floor, Santa Fe, NM 87505. To participate virtually, see the instructions posted on the OCD Hearings website: <https://www.emnrd.nm.gov/ocd/hearing-info/>. You are not required to attend this hearing, but as an owner of an interest that may be affected by this application, you may appear and present testimony. Failure to appear at that time and become a party of record will preclude you from challenging the matter at a later date.

Pursuant to Division Rule 19.15.4.13.B, a party who intends to present evidence at the hearing shall file a pre-hearing statement and serve copies on other parties, or the attorneys of parties who are represented by counsel, at least four business days in advance of a scheduled hearing, but in no event later than 5:00 p.m. Mountain Time, on the Thursday preceding the scheduled hearing date. The statement must be submitted through the OCD E-Permitting system (<https://wwwapps.emnrd.nm.gov/ocd/ocdpermitting/>) or via e-mail to ocd.hearings@emnrd.nm.gov and should include: the names of the parties and their attorneys, a concise statement of the case, the names of all witnesses the party will call to testify at the hearing, the approximate time the party will need to present its case, and identification of any procedural matters that are to be resolved prior to the hearing.

If you have any questions about this application, please contact Ryan Curry, Senior Landman at Permian Resources Operating, LLC, via e-mail at ryan.curry@permianres.com

Sincerely,

/s/ Dana S. Hardy **Permian Resources Operating, LLC**
Dana S. Hardy **Case No. 25063**
Exhibit C-1

PO BOX 10
ROSWELL, NEW MEXICO 88202
(575) 622-6510
FAX (575) 623-9332

7601 JEFFERSON ST NE · SUITE 180
ALBUQUERQUE, NEW MEXICO 87109
505-858-8320
(FAX) 505-858-8321

PO BOX 2068
SANTA FE, NEW MEXICO 87504
(505) 982-4554
FAX (505) 982-8623

**STATE OF NEW MEXICO
DEPARTMENT OF ENERGY, MINERALS AND NATURAL RESOURCES
OIL CONSERVATION DIVISION**

**APPLICATION OF PERMIAN RESOURCES
OPERATING, LLC FOR COMPULSORY
POOLING, EDDY COUNTY, NEW MEXICO.**

**CASE NOS. 25060, 25061,
25062, 25063, 25064, 25065,
25066, & 25067.**

NOTICE LETTER CHART

PARTY	NOTICE LETTER SENT	RETURN RECEIVED
BEXP II GW Alpha, LLC 5914 W. Courtyard Dr. Ste. 200 Austin, TX 78730	12-16-2024 9589071052702305986949	1-2-2025
BEXP II GW WI Omega, LLC 5914 W. Courtyard Dr. Ste. 200 Austin, TX 78730	12-16-2024 9589071052702305986956	1-6-2025
BEXP II Omega MISC., LLC 5914 W. Courtyard Dr. Ste. 200 Austin, TX 78730	12-16-2024 9589071052702305986963	1-2-2025
Bursake, LLC PO Box 51407 Midland, TX 79710-0324	12-16-2024 9589071052702305986970	1-2-2025
Claremont Corporation PO Box 3226 Tulsa, OK 74101	12-16-2024 9589071052702305986987	1-2-2025
Davoil, Inc. PO Box 122269 Fort Worth, TX 76121-2269	12-16-2024 9589071052702305986994	1-2-2025
E. Cecile Martin PO Box 246 Marble Falls, TX 78654	12-16-2024 9589071052702305987007	1-3-2025 Return to Sender.
EOG Resources, Inc. 5509 Champions Dr. Midland, TX 79706	12-16-2024 9589071052702305987021	1-2-2025
Freddie Jean Wheeler 1117 S Tripp Ave Odessa, TX 79760	12-16-2024 9589071052702305987038	1-2-2025
Gilmore Resources, Inc. PO Box 577 Kimball, Nebraska 69145	12-16-2024 9589071052702305987045	1-2-2025
Great Western Drilling Ltd. PO Box 1659 Midland, TX 79702	12-16-2024 9589071052702305987052	1-6-2025
Hurt Properties, LP PO Box 1967 Abingdon, VA 24212-0000	12-16-2024 9589071052702305987069	Delivered 12-23-2025

**Permian Resources Operating, LLC
Case No. 25063
Exhibit C-2**

**STATE OF NEW MEXICO
DEPARTMENT OF ENERGY, MINERALS AND NATURAL RESOURCES
OIL CONSERVATION DIVISION**

**APPLICATION OF PERMIAN RESOURCES
OPERATING, LLC FOR COMPULSORY
POOLING, EDDY COUNTY, NEW MEXICO.**

**CASE NOS. 25060, 25061,
25062, 25063, 25064, 25065,
25066, & 25067.**

NOTICE LETTER CHART

James R. Hurt PO Box 72 Odessa, TX 79760	12-16-2024 9589071052702305987076	1-2-2025
Karen Benbow McRae PO Box 56429 Houston, TX 77256-6429	12-16-2024 9589071052702305987083	1-6-2025
Katherin Anne Gilmore Shannon and Laurence Davis Gilmore, Co- Trustees of The Katherine E. Gilmore Bypass Trust dated May 9, 2017. 505 N. Big Spring Ste. 303 Midland, TX 79701	12-16-2024 9589071052702305987106	1-2-2025
Magnum Hunter Production Inc. PO Box 972875 Dallas, TX 75397	12-16-2024 9589071052702305987113	1-2-2025
McAnSo, LLC PO Box 50530 Austin, TX 78763	12-16-2024 9589071052702305987120	Delivered 12-20-2024
Morris Allen Williams PO Box 2302 Payson, AZ 85547	12-16-2024 9589071052702305987137	1-2-2025
QRE Operating, LLC 1209 Orange St. Wilmington Newcastle, Wilmington, DE 19801	12-16-2024 9589071052702305987144	1-3-2025 Return to Sender.
Sabinal Energy Operating, LLC 1780 Hughes Landing Blvd. Ste 1200 The Woodlands, TX 77380	12-16-2024 9589071052702305987151	1-13-2025

U.S. Postal Service™
CERTIFIED MAIL® RECEIPT
Domestic Mail Only

For delivery information, visit our website at www.usps.com

OFFICIAL USE

9589 0710 5270 2305 9869 49

Certified Mail Fee \$ _____	
Extra Services & Fees (check box, add fee as appropriate)	
<input type="checkbox"/> Return Receipt (hardcopy) \$ _____	
<input type="checkbox"/> Return Receipt (electronic) \$ _____	
<input type="checkbox"/> Certified Mail Restricted Delivery \$ _____	
<input type="checkbox"/> Adult Signature Required \$ _____	
<input type="checkbox"/> Adult Signature Restricted Delivery \$ _____	
Postage \$ _____	
Total Postage and Fees \$ _____	
Sent To Street address: BEXP II GW Alpha, LLC 5914 W. Courtyard Dr. Ste. 200 City, State: Austin, TX 78730 ZIP+4: 25060-67 PRO - Taipan	

PS Form 3800, January 2023 PSN 7530-02-000-3047 See Reverse for Instructions

SENDER: COMPLETE THIS SECTION	COMPLETE THIS SECTION ON DELIVERY												
<ul style="list-style-type: none"> ■ Complete items 1, 2, and 3. ■ Print your name and address on the reverse so that we can return the card to you. ■ Attach this card to the back of the mailpiece, or on the front if space permits. 	<p>A. Signature <input checked="" type="checkbox"/> Agent <input type="checkbox"/> Addressee</p> <p>B. Received by (Printed Name) GA Costa</p> <p>C. Date of Delivery 12-19-24</p> <p>D. Is delivery address different from item 1? <input type="checkbox"/> Yes If YES, enter delivery address below: <input type="checkbox"/> No</p>												
<p>1. Article Addressed to:</p> <p style="text-align: center;">BEXP II GW Alpha, LLC 5914 W. Courtyard Dr. Ste. 200 Austin, TX 78730 <small>25060-67 PRO - Taipan</small></p> <div style="text-align: center;"> 9590 9402 9190 4225 2369 26 </div>	<div style="text-align: center; font-size: 2em; color: green; opacity: 0.5;"> RECEIVED JAN 3 2025 </div>												
<p>2. Article Number (Transfer from service label) 9589 0710 5270 2305 9869 49</p>	<p>3. Service Type <small>Hint: space</small></p> <table style="width: 100%; border: none;"> <tr> <td><input type="checkbox"/> Adult Signature</td> <td><input type="checkbox"/> Priority Mail Express®</td> </tr> <tr> <td><input type="checkbox"/> Adult Signature Restricted Delivery</td> <td><input type="checkbox"/> Registered Mail™</td> </tr> <tr> <td><input type="checkbox"/> Certified Mail®</td> <td><input type="checkbox"/> Registered Mail Restricted Delivery</td> </tr> <tr> <td><input type="checkbox"/> Certified Mail Restricted Delivery</td> <td><input type="checkbox"/> Signature Confirmation™</td> </tr> <tr> <td><input type="checkbox"/> Collect on Delivery</td> <td><input type="checkbox"/> Signature Confirmation Restricted Delivery</td> </tr> <tr> <td><input type="checkbox"/> Collect on Delivery Restricted Delivery</td> <td></td> </tr> </table>	<input type="checkbox"/> Adult Signature	<input type="checkbox"/> Priority Mail Express®	<input type="checkbox"/> Adult Signature Restricted Delivery	<input type="checkbox"/> Registered Mail™	<input type="checkbox"/> Certified Mail®	<input type="checkbox"/> Registered Mail Restricted Delivery	<input type="checkbox"/> Certified Mail Restricted Delivery	<input type="checkbox"/> Signature Confirmation™	<input type="checkbox"/> Collect on Delivery	<input type="checkbox"/> Signature Confirmation Restricted Delivery	<input type="checkbox"/> Collect on Delivery Restricted Delivery	
<input type="checkbox"/> Adult Signature	<input type="checkbox"/> Priority Mail Express®												
<input type="checkbox"/> Adult Signature Restricted Delivery	<input type="checkbox"/> Registered Mail™												
<input type="checkbox"/> Certified Mail®	<input type="checkbox"/> Registered Mail Restricted Delivery												
<input type="checkbox"/> Certified Mail Restricted Delivery	<input type="checkbox"/> Signature Confirmation™												
<input type="checkbox"/> Collect on Delivery	<input type="checkbox"/> Signature Confirmation Restricted Delivery												
<input type="checkbox"/> Collect on Delivery Restricted Delivery													
<p>PS Form 3811, July 2020 PSN 7530-02-000-9053</p>													

Permian Resources Operating, LLC
Case No. 25063
Exhibit C-3

9589 0710 5270 2305 9869 63

U.S. Postal Service™
CERTIFIED MAIL® RECEIPT
 Domestic Mail Only

For delivery information, visit our website at www.usps.com

OFFICIAL USE

Certified Mail Fee \$ _____

Extra Services & Fees (check box, add fee as appropriate)

Return Receipt (hardcopy) \$ _____

Return Receipt (electronic) \$ _____

Certified Mail Restricted Delivery \$ _____

Adult Signature Required \$ _____

Adult Signature Restricted Delivery \$ _____

Postage \$ _____

Total Postage and Fees \$ _____

Sent To

Street: BEXP II Omega MISC., LLC
 5914 W. Courtyard Dr. Ste. 200

City, St: Austin, TX 78730

25060-67 PRO - Taiwan

PS Form 3800, January 2023 PSN 7530-02-000-9047 See Reverse for Instructions



SENDER: COMPLETE THIS SECTION	COMPLETE THIS SECTION ON DELIVERY
<ul style="list-style-type: none"> Complete items 1, 2, and 3. Print your name and address on the reverse so that we can return the card to you. Attach this card to the back of the mailpiece, or on the front if space permits. 	<p>A. Signature <input checked="" type="checkbox"/> <i>[Signature]</i> <input type="checkbox"/> Agent <input type="checkbox"/> Addressee</p> <p>B. Received by (Printed Name) <i>Grason</i> C. Date of Delivery <i>12-11-24</i></p> <p>D. Is delivery address different from item 1? <input type="checkbox"/> Yes If YES, enter delivery address below: <input type="checkbox"/> No</p>
<p>1. Article Addressed to:</p> <p>BEXP II Omega MISC., LLC 5914 W. Courtyard Dr. Ste. 200 Austin, TX 78730</p> <p>25060-67 PRO - Taiwan</p>  <p>9590 9402 9190 4225 2369 02</p>	<p>RECEIVED JAN 8 2025</p>
<p>2. Article Number (Transfer from service label) 9589 0710 5270 2305 9869 63</p>	<p>3. Service Type <i>Hinkle Snator</i></p> <p><input type="checkbox"/> Adult Signature <input type="checkbox"/> Priority Mail Express®</p> <p><input type="checkbox"/> Adult Signature Restricted Delivery <input type="checkbox"/> Registered Mail™</p> <p><input type="checkbox"/> Certified Mail® <input type="checkbox"/> Registered Mail Restricted Delivery</p> <p><input type="checkbox"/> Certified Mail Restricted Delivery <input type="checkbox"/> Signature Confirmation™</p> <p><input type="checkbox"/> Collect on Delivery <input type="checkbox"/> Signature Confirmation Restricted Delivery</p> <p><input type="checkbox"/> Collect on Delivery Restricted Delivery</p>
<p>PS Form 3811, July 2020 PSN 7530-02-000-9053</p>	<p>Domestic Return Receipt</p>

U.S. Postal Service™
CERTIFIED MAIL® RECEIPT
Domestic Mail Only

For delivery information, visit our website at www.usps.com™

OFFICIAL USE

Postmark
DEC 5 2024

<p>Certified Mail Fee \$ _____</p> <p>Extra Services & Fees (check box, add fee as appropriate)</p> <p><input type="checkbox"/> Return Receipt (hardcopy) \$ _____</p> <p><input type="checkbox"/> Return Receipt (electronic) \$ _____</p> <p><input type="checkbox"/> Certified Mail Restricted Delivery \$ _____</p> <p><input type="checkbox"/> Adult Signature Required \$ _____</p> <p><input type="checkbox"/> Adult Signature Restricted Delivery \$ _____</p> <p>Postage \$ _____</p> <p>Total Postage and Fees \$ _____</p>	<p>Sent To</p> <p>Street BEXP II GW WI Omega, LLC 5914 W. Courtyard Dr. Ste. 200 City Austin, TX 78730</p> <p style="text-align: right;">25060-67 PRO - Taipan</p>
--	--

PS Form 3800, January 2023 PSN 7530-02-000-9047 See Reverse for Instructions

SENDER: COMPLETE THIS SECTION	COMPLETE THIS SECTION ON DELIVERY
<ul style="list-style-type: none"> ■ Complete items 1, 2, and 3. ■ Print your name and address on the reverse so that we can return the card to you. ■ Attach this card to the back of the mailpiece, or on the front if space permits. 	<p>A. Signature <u>EA</u> <input type="checkbox"/> Agent <input checked="" type="checkbox"/> Addressee</p> <p>B. Received by (Printed Name) <u>EA</u> C. Date of Delivery <u>12-20-24</u></p> <p>D. Is delivery address different from item 1? <input type="checkbox"/> Yes If YES, enter delivery address below: <input type="checkbox"/> No</p>
<p>1. Article Addressed to:</p> <p style="text-align: center;">BEXP II GW WI Omega, LLC 5914 W. Courtyard Dr. Ste. 200 Austin, TX 78730</p> <p style="text-align: right; font-size: 0.8em;">25060-67 PRO - Taipan</p> <div style="text-align: center;">  9590 9402 9190 4225 2369 19 </div>	<p style="text-align: center; font-size: 2em; color: green;">RECEIVED</p> <p style="text-align: center; color: red;">JAN 6 2025</p> <p>3. Service Type</p> <p><input type="checkbox"/> Adult Signature <input type="checkbox"/> Priority Mail Express®</p> <p><input type="checkbox"/> Adult Signature Restricted Delivery <input type="checkbox"/> Registered Mail™</p> <p><input type="checkbox"/> Certified Mail® <input type="checkbox"/> Registered Mail Restricted Delivery</p> <p><input type="checkbox"/> Certified Mail Restricted Delivery <input checked="" type="checkbox"/> Signature Confirmation™</p> <p><input type="checkbox"/> Collect on Delivery <input type="checkbox"/> Signature Confirmation Restricted Delivery</p> <p><input type="checkbox"/> Collect on Delivery Restricted Delivery <input type="checkbox"/> Signature Confirmation Restricted Delivery</p> <p><input type="checkbox"/> Registered Mail <input type="checkbox"/> Registered Mail Restricted Delivery</p>
<p>2. Article Number (Transfer from service label)</p> <p style="font-size: 1.5em; font-weight: bold;">9589 0710 5270 2305 9869 56</p>	<p style="text-align: center; font-size: 1.2em;">Domestic Return Receipt</p>
<p>PS Form 3811, July 2020 PSN 7530-02-000-9053</p>	

U.S. Postal Service™
CERTIFIED MAIL® RECEIPT
Domestic Mail Only

For delivery information, visit our website at www.usps.com™.

OFFICIAL USE

Certified Mail Fee \$ _____	
Extra Services & Fees (check box, add fee as appropriate)	
<input type="checkbox"/> Return Receipt (hardcopy) \$ _____	
<input type="checkbox"/> Return Receipt (electronic) \$ _____	
<input type="checkbox"/> Certified Mail Restricted Delivery \$ _____	
<input type="checkbox"/> Adult Signature Required \$ _____	
<input type="checkbox"/> Adult Signature Restricted Delivery \$ _____	
Postage \$ _____	
Total Postage and Fees \$ _____	
Sent To: _____	
Street: Bursake, LLC PO Box 51407 Midland, TX 79710-0324	
City, State, ZIP+4: _____ 25060-67 PRO - Taipan	

PS Form 3800, January 2023 PSN 7530-02-000-9047 See Reverse for Instructions

SENDER: COMPLETE THIS SECTION	COMPLETE THIS SECTION ON DELIVERY
<ul style="list-style-type: none"> ■ Complete items 1, 2, and 3. ■ Print your name and address on the reverse so that we can return the card to you. ■ Attach this card to the back of the mailpiece, or on the front if space permits. 	<p>A. Signature <input checked="" type="checkbox"/> Agent <input checked="" type="checkbox"/> Addressee</p> <p>B. Received by (Printed Name) <u>Anderson Bursake</u></p> <p>C. Date of Delivery <u>12/20/2024</u></p> <p>D. Is delivery address different from item 1? <input type="checkbox"/> Yes If YES, enter delivery address below: <input type="checkbox"/> No</p> <div style="text-align: center; font-size: 2em; font-weight: bold; margin: 10px 0;">RECEIVED</div> <div style="text-align: center; font-size: 1.2em; margin: 0 0 10px 0;">JAN 2 2025</div>
<p>1. Article Addressed to:</p> <p style="text-align: center; padding: 10px 0 0 40px;">Bursake, LLC PO Box 51407 Midland, TX 79710-0324</p> <p style="text-align: right; font-size: 0.8em;">25060-67 PRO - Taipan</p> <div style="text-align: center; margin: 10px 0 0 40px;"> <p>9590 9402 9190 4225 2368 96</p> </div>	<p>3. Service Type <input type="checkbox"/> Adult Signature <input type="checkbox"/> Adult Signature Restricted Delivery <input type="checkbox"/> Certified Mail® <input type="checkbox"/> Certified Mail Restricted Delivery <input type="checkbox"/> Collect on Delivery <input type="checkbox"/> Collect on Delivery Restricted Delivery <input type="checkbox"/> Mail <input type="checkbox"/> Mail Restricted Delivery <small>(over 3500)</small></p> <p style="text-align: right; font-size: 0.8em;">Priority Mail Express® Registered Mail™ Registered Mail Restricted Delivery Signature Confirmation™ Signature Confirmation Restricted Delivery</p>
<p>2. Article Number (Transfer from service label)</p> <p style="font-size: 1.2em; font-weight: bold;">9589 0710 5270 2305 9869 70</p>	
PS Form 3811, July 2020 PSN 7530-02-000-9053 Domestic Return Receipt	

U.S. Postal Service™
CERTIFIED MAIL® RECEIPT
Domestic Mail Only

For delivery information, visit our website at www.usps.com™.

OFFICIAL USE

Certified Mail Fee \$ _____	 <p>Postmark Here</p>
Extra Services & Fees (check box, add fee as appropriate)	
<input type="checkbox"/> Return Receipt (hardcopy) \$ _____	
<input type="checkbox"/> Return Receipt (electronic) \$ _____	
<input type="checkbox"/> Certified Mail Restricted Delivery \$ _____	
<input type="checkbox"/> Adult Signature Required \$ _____	
<input type="checkbox"/> Adult Signature Restricted Delivery \$ _____	
Postage \$ _____	
Total Postage and Fees \$ _____	
Sent To Street: Claremont Corporation PO Box 3226 City, St: Tulsa, OK 74101 25060-67 PRO - Taipan	

PS Form 3800, January 2023 PSN 7530-02-000-9047 See Reverse for Instructions

9589 0710 5270 2305 9869 87

SENDER: COMPLETE THIS SECTION	COMPLETE THIS SECTION ON DELIVERY												
<ul style="list-style-type: none"> ■ Complete items 1, 2, and 3. ■ Print your name and address on the reverse so that we can return the card to you. ■ Attach this card to the back of the mailpiece, or on the front if space permits. <p>1. Article Addressed to:</p> <p style="text-align: center;">Claremont Corporation PO Box 3226 Tulsa, OK 74101</p> <p style="text-align: right; font-size: 0.8em;">25060-67 PRO - Taipan</p> <div style="text-align: center;">  9590 9402 9190 4225 2368 89 </div> <p>2. Article Number (Transfer from service label) 9589 0710 5270 2305 9869 87</p>	<p>A. Signature <input checked="" type="checkbox"/> Wynell Miller <input type="checkbox"/> Agent <input type="checkbox"/> Addressee</p> <p>B. Received by (Printed Name) Wynell Miller</p> <p>C. Date of Delivery JAN 2 2025</p> <p>D. Is delivery address different from item 1? <input type="checkbox"/> Yes If YES, enter delivery address below: <input type="checkbox"/> No</p> <div style="text-align: center; font-size: 2em; color: green; font-weight: bold;">RECEIVED</div> <p style="text-align: center; font-size: 1.2em;">JAN 2 2025</p> <p>3. Service Type</p> <table style="width: 100%; font-size: 0.8em;"> <tr> <td><input type="checkbox"/> Adult Signature</td> <td><input type="checkbox"/> Priority Mail Express®</td> </tr> <tr> <td><input type="checkbox"/> Adult Signature Restricted Delivery</td> <td><input type="checkbox"/> Registered Mail™</td> </tr> <tr> <td><input type="checkbox"/> Certified Mail®</td> <td><input type="checkbox"/> Registered Mail Restricted Delivery</td> </tr> <tr> <td><input type="checkbox"/> Certified Mail Restricted Delivery</td> <td><input type="checkbox"/> Signature Confirmation™</td> </tr> <tr> <td><input type="checkbox"/> Collect on Delivery</td> <td><input type="checkbox"/> Signature Confirmation Restricted Delivery</td> </tr> <tr> <td><input type="checkbox"/> Collect on Delivery Restricted Delivery</td> <td></td> </tr> </table> <p style="font-size: 0.7em;">Mail Restricted Delivery</p>	<input type="checkbox"/> Adult Signature	<input type="checkbox"/> Priority Mail Express®	<input type="checkbox"/> Adult Signature Restricted Delivery	<input type="checkbox"/> Registered Mail™	<input type="checkbox"/> Certified Mail®	<input type="checkbox"/> Registered Mail Restricted Delivery	<input type="checkbox"/> Certified Mail Restricted Delivery	<input type="checkbox"/> Signature Confirmation™	<input type="checkbox"/> Collect on Delivery	<input type="checkbox"/> Signature Confirmation Restricted Delivery	<input type="checkbox"/> Collect on Delivery Restricted Delivery	
<input type="checkbox"/> Adult Signature	<input type="checkbox"/> Priority Mail Express®												
<input type="checkbox"/> Adult Signature Restricted Delivery	<input type="checkbox"/> Registered Mail™												
<input type="checkbox"/> Certified Mail®	<input type="checkbox"/> Registered Mail Restricted Delivery												
<input type="checkbox"/> Certified Mail Restricted Delivery	<input type="checkbox"/> Signature Confirmation™												
<input type="checkbox"/> Collect on Delivery	<input type="checkbox"/> Signature Confirmation Restricted Delivery												
<input type="checkbox"/> Collect on Delivery Restricted Delivery													

PS Form 3811, July 2020 PSN 7530-02-000-9053 Domestic Return Receipt

U.S. Postal Service™
CERTIFIED MAIL® RECEIPT
Domestic Mail Only

For delivery information, visit our website at www.usps.com

OFFICIAL USE

9589 0710 5270 2305 9869 94

Certified Mail Fee \$ _____	
Extra Services & Fees (check box, add fee as appropriate)	
<input type="checkbox"/> Return Receipt (hardcopy) \$ _____ <input type="checkbox"/> Return Receipt (electronic) \$ _____ <input type="checkbox"/> Certified Mail Restricted Delivery \$ _____ <input type="checkbox"/> Adult Signature Required \$ _____ <input type="checkbox"/> Adult Signature Restricted Delivery \$ _____	
Postage \$ _____	
Total Postage and Fees \$ _____	
Sent To Street: Davoil, Inc. PO Box 122269 City: Fort Worth, TX 76121-2269 25060-67 PRO - Taipan	

PS Form 3800, January 2023 PSN 7530-02-000-9047 See Reverse for Instructions

SENDER: COMPLETE THIS SECTION	COMPLETE THIS SECTION ON DELIVERY
<ul style="list-style-type: none"> ■ Complete items 1, 2, and 3. ■ Print your name and address on the reverse so that we can return the card to you. ■ Attach this card to the back of the mailpiece, or on the front if space permits. 	<p>A. Signature <input checked="" type="checkbox"/> Agent <input type="checkbox"/> Addressee</p> <p>B. Received by (Printed Name) V. Collingwood</p> <p>C. Date of Delivery 1/2-20</p> <p>D. Is delivery address different from item 1? <input type="checkbox"/> Yes If YES, enter delivery address below: <input checked="" type="checkbox"/> No</p> <div style="text-align: center; border: 1px solid black; padding: 5px; font-weight: bold; font-size: 1.5em;">RECEIVED</div> <p style="text-align: center; font-weight: bold;">JAN 2 2025</p>
<p>1. Article Addressed to:</p> <p style="text-align: center;">Davoil, Inc. PO Box 122269 Fort Worth, TX 76121-2269</p> <p style="text-align: center; font-size: 0.8em;">25060-67 PRO - Taipan</p> <div style="text-align: center;"> 9590 9402 9190 4225 2368 72 </div>	<p>3. Service Type</p> <div style="display: flex; justify-content: space-between;"> <div style="width: 60%;"> <input type="checkbox"/> Adult Signature <input type="checkbox"/> Adult Signature Restricted Delivery <input type="checkbox"/> Certified Mail® <input type="checkbox"/> Certified Mail Restricted Delivery <input type="checkbox"/> Collect on Delivery <input type="checkbox"/> Collect on Delivery Restricted Delivery </div> <div style="width: 35%;"> <input checked="" type="checkbox"/> Priority Mail Express® <input type="checkbox"/> Registered Mail™ <input type="checkbox"/> Registered Mail Restricted Delivery <input type="checkbox"/> Signature Confirmation™ <input type="checkbox"/> Signature Confirmation Restricted Delivery </div> </div> <p style="text-align: center; font-size: 0.8em;">Santa Fe NM</p>
<p>2. Article Number (Transfer from service label)</p> <p style="font-size: 1.2em; font-weight: bold;">9589 0710 5270 2305 9869 94</p>	<p>Domestic Return Receipt</p>
<p>PS Form 3811, July 2020 PSN 7530-02-000-9053</p>	

U.S. Postal Service™
CERTIFIED MAIL® RECEIPT
 Domestic Mail Only

For delivery information, visit our website at www.usps.com®.

OFFICIAL USE

Certified Mail Fee \$ _____	
Extra Services & Fees (check box, add fee as appropriate)	
<input type="checkbox"/> Return Receipt (hardcopy) \$ _____	
<input type="checkbox"/> Return Receipt (electronic) \$ _____	
<input type="checkbox"/> Certified Mail Restricted Delivery \$ _____	
<input type="checkbox"/> Adult Signature Required \$ _____	
<input type="checkbox"/> Adult Signature Restricted Delivery \$ _____	
Postage \$ _____	
Total Postage and Fees \$ _____	
Sent To Street: EOG Resources, Inc. 5509 Champions Dr. Midland, TX 79706 City, St: _____ 25060-67 PRO - Taipan	

PS Form 3800, January 2023 PSN 7530-02-000-9047 See Reverse for Instructions

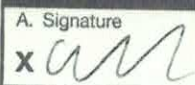
SENDER: COMPLETE THIS SECTION	COMPLETE THIS SECTION ON DELIVERY																
<ul style="list-style-type: none"> ■ Complete items 1, 2, and 3. ■ Print your name and address on the reverse so that we can return the card to you. ■ Attach this card to the back of the mailpiece, or on the front if space permits. <p>1. Article Addressed to:</p> <p style="text-align: center;">EOG Resources, Inc. 5509 Champions Dr. Midland, TX 79706 <small>25060-67 PRO - Taipan</small></p> <div style="text-align: center;">  9590 9402 9190 4225 2368 58 </div> <p>2. Article Number (Transfer from service label) 9589 0710 5270 2305 9870 21</p>	<p>A. Signature <input checked="" type="checkbox"/>  <input type="checkbox"/> Agent <input type="checkbox"/> Addressee</p> <p>B. Received by (Printed Name) C. Date of Delivery 12/19</p> <p>D. Is delivery address different from item 1? <input type="checkbox"/> Yes If YES, enter delivery address below: <input checked="" type="checkbox"/> No</p> <div style="text-align: center; font-size: 1.5em; color: green;"> RECEIVED JAN 2 2025 </div> <p>3. Service Type</p> <table style="width: 100%;"> <tr> <td><input type="checkbox"/> Adult Signature</td> <td><input type="checkbox"/> Priority Mail Express®</td> </tr> <tr> <td><input type="checkbox"/> Adult Signature Restricted Delivery</td> <td><input type="checkbox"/> Registered Mail™</td> </tr> <tr> <td><input type="checkbox"/> Certified Mail®</td> <td><input type="checkbox"/> Registered Mail Restricted Delivery</td> </tr> <tr> <td><input type="checkbox"/> Certified Mail Restricted Delivery</td> <td><input type="checkbox"/> Signature Confirmation™</td> </tr> <tr> <td><input type="checkbox"/> Collect on Delivery</td> <td><input type="checkbox"/> Signature Confirmation Restricted Delivery</td> </tr> <tr> <td><input type="checkbox"/> Collect on Delivery Restricted Delivery</td> <td></td> </tr> <tr> <td><input type="checkbox"/> Insured Mail</td> <td></td> </tr> <tr> <td><input type="checkbox"/> Mail Restricted Delivery</td> <td></td> </tr> </table>	<input type="checkbox"/> Adult Signature	<input type="checkbox"/> Priority Mail Express®	<input type="checkbox"/> Adult Signature Restricted Delivery	<input type="checkbox"/> Registered Mail™	<input type="checkbox"/> Certified Mail®	<input type="checkbox"/> Registered Mail Restricted Delivery	<input type="checkbox"/> Certified Mail Restricted Delivery	<input type="checkbox"/> Signature Confirmation™	<input type="checkbox"/> Collect on Delivery	<input type="checkbox"/> Signature Confirmation Restricted Delivery	<input type="checkbox"/> Collect on Delivery Restricted Delivery		<input type="checkbox"/> Insured Mail		<input type="checkbox"/> Mail Restricted Delivery	
<input type="checkbox"/> Adult Signature	<input type="checkbox"/> Priority Mail Express®																
<input type="checkbox"/> Adult Signature Restricted Delivery	<input type="checkbox"/> Registered Mail™																
<input type="checkbox"/> Certified Mail®	<input type="checkbox"/> Registered Mail Restricted Delivery																
<input type="checkbox"/> Certified Mail Restricted Delivery	<input type="checkbox"/> Signature Confirmation™																
<input type="checkbox"/> Collect on Delivery	<input type="checkbox"/> Signature Confirmation Restricted Delivery																
<input type="checkbox"/> Collect on Delivery Restricted Delivery																	
<input type="checkbox"/> Insured Mail																	
<input type="checkbox"/> Mail Restricted Delivery																	
PS Form 3811, July 2020 PSN 7530-02-000-9053	Domestic Return Receipt																

9589 0710 5270 2305 9870 38

U.S. Postal Service™
CERTIFIED MAIL® RECEIPT
 Domestic Mail Only

For delivery information, visit our website at www.usps.com.

OFFICIAL USE

Certified Mail Fee \$ _____

Extra Services & Fees (check box, add fee as appropriate)

Return Receipt (hardcopy) \$ _____

Return Receipt (electronic) \$ _____

Certified Mail Restricted Delivery \$ _____

Adult Signature Required \$ _____

Adult Signature Restricted Delivery \$ _____

Postage \$ _____

Total Postage and Fees \$ _____

Sent To _____

Street Freddie Jean Wheeler
 1117 S Tripp Ave

City, State Odessa, TX 79760 25060-67 PRO - Taipan

PS Form 3800, January 2023 PSN 7530-02-000-9047 See Reverse for Instructions



SENDER: COMPLETE THIS SECTION

- Complete items 1, 2, and 3.
- Print your name and address on the reverse so that we can return the card to you.
- Attach this card to the back of the mailpiece, or on the front if space permits.

1. Article Addressed to:

Freddie Jean Wheeler
 1117 S Tripp Ave
 Odessa, TX 79760
 25060-67 PRO - Taipan

2. Article Number (Transfer from service label)
 9589 0710 5270 2305 9870 38

PS Form 3811, July 2020 PSN 7530-02-000-9053

COMPLETE THIS SECTION ON DELIVERY

A. Signature
 Tanya McGehee Agent Addressee

B. Received by (Printed Name)
 Tanya McGehee

C. Date of Delivery
 JAN 2 2025

D. Is delivery address different from item 1? Yes
 If YES, enter delivery address below: No

RECEIVED

3. Service Type

Adult Signature Priority Mail Express®

Adult Signature Restricted Delivery Registered Mail™

Certified Mail® Registered Mail Restricted Delivery

Certified Mail Restricted Delivery Signature Confirmation™

Collect on Delivery Signature Confirmation Restricted Delivery

Collect on Delivery Restricted Delivery Signature Confirmation Restricted Delivery

Mail Restricted Delivery (over \$500)

Domestic Return Receipt

U.S. Postal Service™
CERTIFIED MAIL® RECEIPT
Domestic Mail Only

For delivery information, visit our website at www.usps.com®.

OFFICIAL USE

Certified Mail Fee
\$ _____

Extra Services & Fees (check box, add fee as appropriate)

Return Receipt (hardcopy) \$ _____

Return Receipt (electronic) \$ _____

Certified Mail Restricted Delivery \$ _____

Adult Signature Required \$ _____

Adult Signature Restricted Delivery \$ _____

Postage
\$ _____

Total Postage and Fees
\$ _____

Sent To

Street Gilmore Resources, Inc. _____

PO Box 577 _____

City Kimball, Nebraska 69145 _____

25060-67 PRO - Taiwan

PS Form 3800, January 2023 PSN 7530-02-000-9047 See Reverse for Instructions

9589 0710 5270 2305 9870 45



SENDER: COMPLETE THIS SECTION	COMPLETE THIS SECTION ON DELIVERY												
<ul style="list-style-type: none"> ■ Complete items 1, 2, and 3. ■ Print your name and address on the reverse so that we can return the card to you. ■ Attach this card to the back of the mailpiece, or on the front if space permits. <p>1. Article Addressed to:</p> <p style="text-align: center;">Gilmore Resources, Inc. PO Box 577 Kimball, Nebraska 69145 <small>25060-67 PRO - Taiwan</small></p> <div style="text-align: center;">  9590 9402 9190 4225 2368 34 </div> <p>2. Article Number (Transfer from service label)</p> <p style="font-size: 1.2em; font-weight: bold;">9589 0710 5270 2305 9870 45</p>	<p>A. Signature <input checked="" type="checkbox"/> <i>Sam</i> <input type="checkbox"/> Agent <input type="checkbox"/> Addressee</p> <p>B. Received by (Printed Name) <i>Sandra Ann</i></p> <p>C. Date of Delivery <i>12-27-24</i></p> <p>D. Is delivery address different from item 1? <input type="checkbox"/> Yes If YES, enter delivery address below: <input type="checkbox"/> No</p> <div style="text-align: center; border: 1px solid black; padding: 5px;"> <p style="font-size: 2em; color: green; margin: 0;">RECEIVED</p> <p style="font-size: 1.5em; margin: 0;">JAN 2 2025</p> </div> <p>3. Service Type</p> <table style="width: 100%; border: none;"> <tr> <td style="border: none;"><input type="checkbox"/> Adult Signature</td> <td style="border: none;"><input type="checkbox"/> Priority Mail Express®</td> </tr> <tr> <td style="border: none;"><input type="checkbox"/> Adult Signature Restricted Delivery</td> <td style="border: none;"><input type="checkbox"/> Registered Mail™</td> </tr> <tr> <td style="border: none;"><input type="checkbox"/> Certified Mail®</td> <td style="border: none;"><input type="checkbox"/> Registered Mail Restricted Delivery</td> </tr> <tr> <td style="border: none;"><input type="checkbox"/> Certified Mail Restricted Delivery</td> <td style="border: none;"><input type="checkbox"/> Signature Confirmation™</td> </tr> <tr> <td style="border: none;"><input type="checkbox"/> Collect on Delivery</td> <td style="border: none;"><input type="checkbox"/> Signature Confirmation Restricted Delivery</td> </tr> <tr> <td style="border: none;"><input type="checkbox"/> Collect on Delivery Restricted Delivery</td> <td style="border: none;"></td> </tr> </table>	<input type="checkbox"/> Adult Signature	<input type="checkbox"/> Priority Mail Express®	<input type="checkbox"/> Adult Signature Restricted Delivery	<input type="checkbox"/> Registered Mail™	<input type="checkbox"/> Certified Mail®	<input type="checkbox"/> Registered Mail Restricted Delivery	<input type="checkbox"/> Certified Mail Restricted Delivery	<input type="checkbox"/> Signature Confirmation™	<input type="checkbox"/> Collect on Delivery	<input type="checkbox"/> Signature Confirmation Restricted Delivery	<input type="checkbox"/> Collect on Delivery Restricted Delivery	
<input type="checkbox"/> Adult Signature	<input type="checkbox"/> Priority Mail Express®												
<input type="checkbox"/> Adult Signature Restricted Delivery	<input type="checkbox"/> Registered Mail™												
<input type="checkbox"/> Certified Mail®	<input type="checkbox"/> Registered Mail Restricted Delivery												
<input type="checkbox"/> Certified Mail Restricted Delivery	<input type="checkbox"/> Signature Confirmation™												
<input type="checkbox"/> Collect on Delivery	<input type="checkbox"/> Signature Confirmation Restricted Delivery												
<input type="checkbox"/> Collect on Delivery Restricted Delivery													
<p>PS Form 3811, July 2020 PSN 7530-02-000-9053</p>	<p>Domestic Return Receipt</p>												

U.S. Postal Service™
CERTIFIED MAIL® RECEIPT
Domestic Mail Only

For delivery information, visit our website at www.usps.com™.

OFFICIAL USE

Certified Mail Fee \$ _____ Extra Services & Fees (check box, add fee as appropriate) <input type="checkbox"/> Return Receipt (hardcopy) \$ _____ <input type="checkbox"/> Return Receipt (electronic) \$ _____ <input type="checkbox"/> Certified Mail Restricted Delivery \$ _____ <input type="checkbox"/> Adult Signature Required \$ _____ <input type="checkbox"/> Adult Signature Restricted Delivery \$ _____ Postage \$ _____ Total Postage and Fees \$ _____	
Sent to Street: Great Western Drilling Ltd. PO Box 1659 Midland, TX 79702 City: 25060-67 PRO - Taipan	

PS Form 3800, January 2023 PSN 7530-02-000-9047 See Reverse for Instructions

SENDER: COMPLETE THIS SECTION	COMPLETE THIS SECTION ON DELIVERY												
<ul style="list-style-type: none"> ■ Complete items 1, 2, and 3. ■ Print your name and address on the reverse so that we can return the card to you. ■ Attach this card to the back of the mailpiece, or on the front if space permits. 	<p>A. Signature <input checked="" type="checkbox"/> <i>[Signature]</i> <input type="checkbox"/> Agent <input type="checkbox"/> Addressee</p> <p>B. Received by (Printed Name) <i>[Signature]</i> C. Date of Delivery <i>[Signature]</i></p> <p>D. Is delivery address different from item 1? <input type="checkbox"/> Yes If YES, enter delivery address below: <input type="checkbox"/> No</p>												
<p>1. Article Addressed to:</p> <p style="text-align: center;">Great Western Drilling Ltd. PO Box 1659 Midland, TX 79702</p> <p style="text-align: center; font-size: 0.8em;">25060-67 PRO - Taipan</p>  <p style="text-align: center;">9590 9402 9190 4225 2368 27</p>	<p>3. Service Type <i>[Handwritten: Certified Mail]</i></p> <table style="width: 100%; font-size: 0.8em;"> <tr> <td><input type="checkbox"/> Adult Signature</td> <td><input type="checkbox"/> Priority Mail Express®</td> </tr> <tr> <td><input type="checkbox"/> Adult Signature Restricted Delivery</td> <td><input type="checkbox"/> Registered Mail™</td> </tr> <tr> <td><input type="checkbox"/> Certified Mail®</td> <td><input type="checkbox"/> Registered Mail Restricted Delivery</td> </tr> <tr> <td><input type="checkbox"/> Certified Mail Restricted Delivery</td> <td><input type="checkbox"/> Signature Confirmation™</td> </tr> <tr> <td><input type="checkbox"/> Collect on Delivery</td> <td><input type="checkbox"/> Signature Confirmation Restricted Delivery</td> </tr> <tr> <td><input type="checkbox"/> Collect on Delivery Restricted Delivery</td> <td></td> </tr> </table>	<input type="checkbox"/> Adult Signature	<input type="checkbox"/> Priority Mail Express®	<input type="checkbox"/> Adult Signature Restricted Delivery	<input type="checkbox"/> Registered Mail™	<input type="checkbox"/> Certified Mail®	<input type="checkbox"/> Registered Mail Restricted Delivery	<input type="checkbox"/> Certified Mail Restricted Delivery	<input type="checkbox"/> Signature Confirmation™	<input type="checkbox"/> Collect on Delivery	<input type="checkbox"/> Signature Confirmation Restricted Delivery	<input type="checkbox"/> Collect on Delivery Restricted Delivery	
<input type="checkbox"/> Adult Signature	<input type="checkbox"/> Priority Mail Express®												
<input type="checkbox"/> Adult Signature Restricted Delivery	<input type="checkbox"/> Registered Mail™												
<input type="checkbox"/> Certified Mail®	<input type="checkbox"/> Registered Mail Restricted Delivery												
<input type="checkbox"/> Certified Mail Restricted Delivery	<input type="checkbox"/> Signature Confirmation™												
<input type="checkbox"/> Collect on Delivery	<input type="checkbox"/> Signature Confirmation Restricted Delivery												
<input type="checkbox"/> Collect on Delivery Restricted Delivery													
<p>2. Article Number (Transfer from service label)</p> <p style="font-size: 1.2em; text-align: center;">9589 0710 5270 2305 9870 52</p>	<p style="text-align: center; font-size: 2em; opacity: 0.5;">RECEIVED</p> <p style="text-align: center; color: red; font-weight: bold;">DEC 31 2024</p> <p style="text-align: center; font-weight: bold;">JAN 6 2025</p>												
<p>PS Form 3811, July 2020 PSN 7530-02-000-9053 Domestic Return Receipt</p>													

U.S. Postal Service™
CERTIFIED MAIL® RECEIPT
Domestic Mail Only

For delivery information, visit our website at www.usps.com™.

OFFICIAL USE

9589 0710 5270 2305 9870 76

Certified Mail Fee \$ _____	
Extra Services & Fees (check box, add fee as appropriate)	
<input type="checkbox"/> Return Receipt (hardcopy) \$ _____ <input type="checkbox"/> Return Receipt (electronic) \$ _____ <input type="checkbox"/> Certified Mail Restricted Delivery \$ _____ <input type="checkbox"/> Adult Signature Required \$ _____ <input type="checkbox"/> Adult Signature Restricted Delivery \$ _____	
Postage \$ _____ Total Postage and Fees \$ _____	
Sent To Street and James R. Hurt PO Box 72 City, State Odessa, TX 79760 25060-67 PRO - Taipan	

PS Form 3800, January 2023 PSN 7530-02-000-9047 See Reverse for Instructions

SENDER: COMPLETE THIS SECTION	COMPLETE THIS SECTION ON DELIVERY
<ul style="list-style-type: none"> ■ Complete items 1, 2, and 3. ■ Print your name and address on the reverse so that we can return the card to you. ■ Attach this card to the back of the mailpiece, or on the front if space permits. 	A. Signature <input checked="" type="checkbox"/> <i>Mary Blain</i> <input type="checkbox"/> Agent <input type="checkbox"/> Addressee
1. Article Addressed to: James R. Hurt PO Box 72 Odessa, TX 79760 25060-67 PRO - Taipan 9590 9402 9190 4225 2368 03	B. Received by (Printed Name) MARY BLAIN C. Date of Delivery 12/19/24 D. Is delivery address different from item 1? <input type="checkbox"/> Yes If YES, enter delivery address below: <input type="checkbox"/> No
2. Article Number (Transfer from service label) 9589 0710 5270 2305 9870 76	3. Service Type <input type="checkbox"/> Adult Signature <input type="checkbox"/> Priority Mail Express® <input type="checkbox"/> Adult Signature Restricted Delivery <input type="checkbox"/> Registered Mail™ <input type="checkbox"/> Certified Mail® <input type="checkbox"/> Registered Mail Restricted Delivery <input type="checkbox"/> Certified Mail Restricted Delivery <input type="checkbox"/> Signature Confirmation™ <input type="checkbox"/> Collect on Delivery <input type="checkbox"/> Signature Confirmation Restricted Delivery <input type="checkbox"/> Collect on Delivery Restricted Delivery
PS Form 3811, July 2020 PSN 7530-02-000-9053 Domestic Form Receipt	

9589 0710 5270 2305 9870 83

U.S. Postal Service™
CERTIFIED MAIL® RECEIPT
 Domestic Mail Only

For delivery information, visit our website at www.usps.com®.

OFFICIAL USE

Certified Mail Fee
 \$ _____

Extra Services & Fees (check box, add fee as appropriate)

Return Receipt (hardcopy) \$ _____

Return Receipt (electronic) \$ _____

Certified Mail Restricted Delivery \$ _____

Adult Signature Required \$ _____

Adult Signature Restricted Delivery \$ _____



Postage
 \$ _____

Total Postage and Fees
 \$ _____

Sent To
 Street a Karen Benbow McRae
 PO Box 56429
 City, St Houston, TX 77256-6429
 25060-67 PRO - Taipan

PS Form 3800, January 2023 PSN 7530-02-000-9047 See Reverse for Instructions

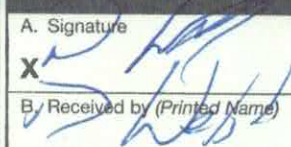
DEC 2024
 Postmark Here

SENDER: COMPLETE THIS SECTION	COMPLETE THIS SECTION ON DELIVERY
<ul style="list-style-type: none"> Complete items 1, 2, and 3. Print your name and address on the reverse so that we can return the card to you. Attach this card to the back of the mailpiece, or on the front if space permits. 	<p>A. Signature  <input type="checkbox"/> Agent <input checked="" type="checkbox"/> Addressee</p> <p>B. Received by (Printed Name) <u>Hinkle Shanon</u> C. Date of Delivery <u>1/3/24</u></p> <p>D. Is delivery address different from item 1? <input type="checkbox"/> Yes If YES, enter delivery address below: <input type="checkbox"/> No</p> <p style="text-align: center; font-size: 2em; font-weight: bold;">RECEIVED</p> <p style="text-align: center;">JAN 6 2025</p>
<p>1. Article Addressed to:</p> <p style="text-align: center;">Karen Benbow McRae PO Box 56429 Houston, TX 77256-6429</p> <p style="text-align: right; font-size: 0.8em;">25060-67 PRO - Taipan</p>  <p style="text-align: center;">9590 9402 9190 4225 2367 97</p>	<p>3. Service Type <u>Hinkle Shanon</u> <input type="checkbox"/> Priority Mail Express®</p> <p><input type="checkbox"/> Adult Signature <u>Santa Fe NM 87501</u> <input type="checkbox"/> Registered Mail™</p> <p><input type="checkbox"/> Adult Signature Restricted Delivery <input type="checkbox"/> Registered Mail Restricted Delivery</p> <p><input type="checkbox"/> Certified Mail® <input type="checkbox"/> Delivery</p> <p><input type="checkbox"/> Certified Mail Restricted Delivery <input type="checkbox"/> Signature Confirmation™</p> <p><input type="checkbox"/> Collect on Delivery <input type="checkbox"/> Signature Confirmation Restricted Delivery</p> <p><input type="checkbox"/> Collect on Delivery Restricted Delivery <input type="checkbox"/> Restricted Delivery</p>
<p>2. Article Number (Transfer from service label)</p> <p style="font-size: 1.2em; font-weight: bold;">9589 0710 5270 2305 9870 83</p>	<p>Mail Restricted Delivery (J)</p>
PS Form 3811, July 2020 PSN 7530-02-000-9053	Domestic Return Receipt

U.S. Postal Service™
CERTIFIED MAIL® RECEIPT
Domestic Mail Only

For delivery information, visit our website at www.usps.com™.

OFFICIAL USE

9589 0710 5270 2305 9871 06

Certified Mail Fee \$ _____	
Extra Services & Fees (check box, add fee as appropriate)	
<input type="checkbox"/> Return Receipt (hardcopy) \$ _____	
<input type="checkbox"/> Return Receipt (electronic) \$ _____	
<input type="checkbox"/> Certified Mail Restricted Delivery \$ _____	
<input type="checkbox"/> Adult Signature Required \$ _____	
<input type="checkbox"/> Adult Signature Restricted Delivery \$ _____	
Postage \$ _____	
Total Postage and Fees \$ _____	
Sent To Katherin Anne Gilmore Shannon and Laurence Davis Gilmore, Co-Trustees of The Katherine E. Gilmore Bypass Trust dated May 9, 2017. Street 505 N. Big Spring Ste. 303 City, St. Midland, TX 79701 ZIP+4® 25060-67 PRO - Tainan	

PS Form 3800, January 2023 PSN 7530-02-000-9047 See Reverse for Instructions

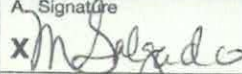
SENDER: COMPLETE THIS SECTION	COMPLETE THIS SECTION ON DELIVERY
<ul style="list-style-type: none"> ■ Complete items 1, 2, and 3. ■ Print your name and address on the reverse so that we can return the card to you. ■ Attach this card to the back of the mailpiece, or on the front if space permits. 	<p>A. Signature  <input type="checkbox"/> Agent <input type="checkbox"/> Addressee</p> <p>B. Received by (Printed Name) Maggie Salgado</p> <p>C. Date of Delivery 12/23/24</p> <p>D. Is delivery address different from item 1? <input type="checkbox"/> Yes If YES, enter delivery address below: <input type="checkbox"/> No</p>
<p>1. Article Addressed to:</p> <p>Katherin Anne Gilmore Shannon and Laurence Davis Gilmore, Co-Trustees of The Katherine E. Gilmore Bypass Trust dated May 9, 2017. 505 N. Big Spring Ste. 303 Midland, TX 79701</p> <p style="text-align: right; font-size: small;">25060-67 PRO - Tainan</p>	<div style="border: 2px solid black; padding: 10px; font-size: 2em; font-weight: bold;">RECEIVED</div> <p>JAN 2 2025</p>
<p>2. Article Number (Transfer from service label)</p> <p style="font-size: 1.5em; font-weight: bold;">9589 0710 5270 2305 9871 06</p>	
<p>3. Service Type</p> <p><input type="checkbox"/> Adult Signature Priority Mail Express®</p> <p><input type="checkbox"/> Adult Signature Restricted Delivery Registered Mail™</p> <p><input type="checkbox"/> Certified Mail® Registered Mail Restricted Delivery</p> <p><input type="checkbox"/> Certified Mail Restricted Delivery Signature Confirmation™</p> <p><input type="checkbox"/> Collect on Delivery Signature Confirmation Restricted Delivery</p> <p><input type="checkbox"/> Collect on Delivery Restricted Delivery Restricted Delivery</p>	

PS Form 3811, July 2020 PSN 7530-02-000-9053 Domestic Return Receipt

9589 0710 5270 2305 9871 13

U.S. Postal Service™
CERTIFIED MAIL® RECEIPT
Domestic Mail Only

For delivery information, visit our website at www.usps.com

OFFICIAL USE

Certified Mail Fee	\$ _____
Extra Services & Fees (check box, add fee as appropriate)	
<input type="checkbox"/> Return Receipt (hardcopy)	\$ _____
<input type="checkbox"/> Return Receipt (electronic)	\$ _____
<input type="checkbox"/> Certified Mail Restricted Delivery	\$ _____
<input type="checkbox"/> Adult Signature Required	\$ _____
<input type="checkbox"/> Adult Signature Restricted Delivery	\$ _____
Postage	\$ _____
Total Postage and Fees	\$ _____

Postmark Here **DEC 19 2024**

Send to:
 Street: Magnum Hunter Production Inc.
 PO Box 972875
 Dallas, TX 75397
 City: 25060-67 PRO - Taipan

PS Form 3800, January 2023 PSN 7530-02-000-9047 See Reverse for Instructions

SENDER: COMPLETE THIS SECTION	COMPLETE THIS SECTION ON DELIVERY																
<ul style="list-style-type: none"> Complete items 1, 2, and 3. Print your name and address on the reverse so that we can return the card to you. Attach this card to the back of the mailpiece, or on the front if space permits. <p>1. Article Addressed to:</p> <p>Magnum Hunter Production Inc. PO Box 972875 Dallas, TX 75397</p> <p>25060-67 PRO - Taipan</p>  <p>9590 9402 9190 4225 2367 73</p> <p>2. Article Number (Transfer from service label)</p> <p>9589 0710 5270 2305 9871 13</p>	<p>A. Signature DEC 19 2024</p> <p>X Gabriel Asamoah <input type="checkbox"/> Agent <input type="checkbox"/> Addressee</p> <p>B. Received by (Printed Name) C. Date of Delivery</p> <p>D. Is delivery address different from item 1? <input type="checkbox"/> Yes If YES, enter delivery address below: <input type="checkbox"/> No</p> <p>RECEIVED JAN 2 2025</p> <p>3. Service Type</p> <table border="0"> <tr> <td><input type="checkbox"/> Adult Signature</td> <td><input type="checkbox"/> Registered Mail™</td> </tr> <tr> <td><input type="checkbox"/> Adult Signature Restricted Delivery</td> <td><input type="checkbox"/> Registered Mail Restricted Delivery</td> </tr> <tr> <td><input type="checkbox"/> Certified Mail®</td> <td><input type="checkbox"/> Signature Confirmation™</td> </tr> <tr> <td><input type="checkbox"/> Certified Mail Restricted Delivery</td> <td><input type="checkbox"/> Signature Confirmation Restricted Delivery</td> </tr> <tr> <td><input type="checkbox"/> Collect on Delivery</td> <td></td> </tr> <tr> <td><input type="checkbox"/> Collect on Delivery Restricted Delivery</td> <td></td> </tr> <tr> <td><input type="checkbox"/> Insured Mail</td> <td></td> </tr> <tr> <td><input type="checkbox"/> Insured Mail Restricted Delivery</td> <td></td> </tr> </table> <p>Hinkle Shano Santa Fe NM 87504</p>	<input type="checkbox"/> Adult Signature	<input type="checkbox"/> Registered Mail™	<input type="checkbox"/> Adult Signature Restricted Delivery	<input type="checkbox"/> Registered Mail Restricted Delivery	<input type="checkbox"/> Certified Mail®	<input type="checkbox"/> Signature Confirmation™	<input type="checkbox"/> Certified Mail Restricted Delivery	<input type="checkbox"/> Signature Confirmation Restricted Delivery	<input type="checkbox"/> Collect on Delivery		<input type="checkbox"/> Collect on Delivery Restricted Delivery		<input type="checkbox"/> Insured Mail		<input type="checkbox"/> Insured Mail Restricted Delivery	
<input type="checkbox"/> Adult Signature	<input type="checkbox"/> Registered Mail™																
<input type="checkbox"/> Adult Signature Restricted Delivery	<input type="checkbox"/> Registered Mail Restricted Delivery																
<input type="checkbox"/> Certified Mail®	<input type="checkbox"/> Signature Confirmation™																
<input type="checkbox"/> Certified Mail Restricted Delivery	<input type="checkbox"/> Signature Confirmation Restricted Delivery																
<input type="checkbox"/> Collect on Delivery																	
<input type="checkbox"/> Collect on Delivery Restricted Delivery																	
<input type="checkbox"/> Insured Mail																	
<input type="checkbox"/> Insured Mail Restricted Delivery																	
PS Form 3811, July 2020 PSN 7530-02-000-9053	Domestic Return Receipt																

U.S. Postal Service™
CERTIFIED MAIL® RECEIPT
Domestic Mail Only

For delivery information, visit our website at www.usps.com™.

OFFICIAL USE

9589 0710 5270 2305 9871 37

Certified Mail Fee \$ _____ Extra Services & Fees (check box, add fee as appropriate) <input type="checkbox"/> Return Receipt (hardcopy) \$ _____ <input type="checkbox"/> Return Receipt (electronic) \$ _____ <input type="checkbox"/> Certified Mail Restricted Delivery \$ _____ <input type="checkbox"/> Adult Signature Required \$ _____ <input type="checkbox"/> Adult Signature Restricted Delivery \$ _____	
Postage \$ _____	
Total Postage and Fees \$ _____	
Sent To: Street: Morris Allen Williams PO Box 2302 City: Payson, AZ 85547 ZIP+4: 25060-67 PRO - Taiban	

PS Form 3800, January 2023 PSN 7530-02-000-9047 See Reverse for Instructions

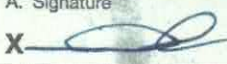
SENDER: COMPLETE THIS SECTION	COMPLETE THIS SECTION ON DELIVERY
<ul style="list-style-type: none"> ■ Complete items 1, 2, and 3. ■ Print your name and address on the reverse so that we can return the card to you. ■ Attach this card to the back of the mailpiece, or on the front if space permits. <p>1. Article Addressed to:</p> <p style="text-align: center; font-size: 1.2em;">Morris Allen Williams PO Box 2302 Payson, AZ 85547</p> <p style="text-align: center; font-size: 0.8em;">25060-67 PRO - Taiban</p>  <p style="text-align: center; font-size: 1.1em;">9590 9402 9190 4225 2367 59</p> <p>2. Article Number (Transfer from service label) 9589 0710 5270 2305 9871 37</p>	<p>A. Signature <input checked="" type="checkbox"/>  <input type="checkbox"/> Agent <input type="checkbox"/> Addressee</p> <p>B. Received by (Printed Name) <i>Morris Williams</i></p> <p>C. Date of Delivery JAN 2 2025</p> <p>D. Is delivery address different from item 1? <input type="checkbox"/> Yes If YES, enter delivery address below <input checked="" type="checkbox"/> No</p> <p style="text-align: center; font-size: 2em; font-weight: bold; color: black;">RECEIVED</p> <p style="text-align: center; font-size: 1.2em;">JAN 2 2025</p> <p>3. Service Type <input type="checkbox"/> Adult Signature <input checked="" type="checkbox"/> Santa Fe NM <input type="checkbox"/> Priority Mail Express® <input type="checkbox"/> Adult Signature Restricted Delivery <input type="checkbox"/> Registered Mail™ <input type="checkbox"/> Certified Mail® <input type="checkbox"/> Registered Mail Restricted Delivery <input type="checkbox"/> Certified Mail Restricted Delivery <input type="checkbox"/> Signature Confirmation™ <input type="checkbox"/> Collect on Delivery <input type="checkbox"/> Signature Confirmation Restricted Delivery <input type="checkbox"/> Collect on Delivery Restricted Delivery</p> <p style="font-size: 0.8em;">Mail Restricted Delivery (00)</p>
PS Form 3811, July 2020 PSN 7530-02-000-9053	Domestic Return Receipt

U.S. Postal Service™
CERTIFIED MAIL® RECEIPT
Domestic Mail Only

For delivery information, visit our website at www.usps.com

OFFICIAL USE

9589 0710 5270 2305 9871 51

Certified Mail Fee	
\$	
Extra Services & Fees (check box, add fee as appropriate)	
<input type="checkbox"/> Return Receipt (hardcopy)	\$
<input type="checkbox"/> Return Receipt (electronic)	\$
<input type="checkbox"/> Certified Mail Restricted Delivery	\$
<input type="checkbox"/> Adult Signature Required	\$
<input type="checkbox"/> Adult Signature Restricted Delivery	\$
Postage	
\$	
Total Postage and Fees	
\$	
Sent To	
Street	Sabinal Energy Operating, LLC 1780 Hughes Landing Blvd Ste 1200
City, S	The Woodlands, TX 77380 25060-67 PRO - Taiwan

PS Form 3800, January 2023 PSN 7530-02-000-9047 See Reverse for Instructions



SENDER: COMPLETE THIS SECTION	COMPLETE THIS SECTION ON DELIVERY																
<ul style="list-style-type: none"> Complete items 1, 2, and 3. Print your name and address on the reverse so that we can return the card to you. Attach this card to the back of the mailpiece, or on the front if space permits. <p>1. Article Addressed to:</p> <p>Sabinal Energy Operating, LLC 1780 Hughes Landing Blvd. 200 Woodlands, TX 77380 25060-67 PRO - Taiwan</p>  <p>9590 9402 9190 4225 2367 35</p> <p>2. Article Number (Transfer from service label)</p> <p>9589 0710 5270 2305 9871 51</p>	<p>A. Signature <input type="checkbox"/> Agent <input checked="" type="checkbox"/> Addressee</p> <p><i>Jennifer Palma</i></p> <p>B. Received by (Printed Name) C. Date of Delivery</p> <p>Jennifer Palma 12/23</p> <p>D. Is delivery address different from item 1? <input type="checkbox"/> Yes <input checked="" type="checkbox"/> No</p> <p>If YES, enter delivery address below:</p> <p style="text-align: center; font-size: 2em; color: green;">RECEIVED</p> <p style="text-align: center;">JAN 13 2025</p> <p>3. Service Type</p> <table border="0"> <tr> <td><input type="checkbox"/> Adult Signature</td> <td><input type="checkbox"/> Priority Mail Express®</td> </tr> <tr> <td><input type="checkbox"/> Adult Signature Restricted Delivery</td> <td><input type="checkbox"/> Registered Mail™</td> </tr> <tr> <td><input type="checkbox"/> Certified Mail®</td> <td><input type="checkbox"/> Registered Mail Restricted Delivery</td> </tr> <tr> <td><input type="checkbox"/> Certified Mail Restricted Delivery</td> <td><input type="checkbox"/> Signature Confirmation™</td> </tr> <tr> <td><input type="checkbox"/> Collect on Delivery</td> <td><input type="checkbox"/> Signature Confirmation Restricted Delivery</td> </tr> <tr> <td><input type="checkbox"/> Collect on Delivery Restricted Delivery</td> <td></td> </tr> <tr> <td><input type="checkbox"/> Insured Mail</td> <td></td> </tr> <tr> <td><input type="checkbox"/> Mail Restricted Delivery (00)</td> <td></td> </tr> </table>	<input type="checkbox"/> Adult Signature	<input type="checkbox"/> Priority Mail Express®	<input type="checkbox"/> Adult Signature Restricted Delivery	<input type="checkbox"/> Registered Mail™	<input type="checkbox"/> Certified Mail®	<input type="checkbox"/> Registered Mail Restricted Delivery	<input type="checkbox"/> Certified Mail Restricted Delivery	<input type="checkbox"/> Signature Confirmation™	<input type="checkbox"/> Collect on Delivery	<input type="checkbox"/> Signature Confirmation Restricted Delivery	<input type="checkbox"/> Collect on Delivery Restricted Delivery		<input type="checkbox"/> Insured Mail		<input type="checkbox"/> Mail Restricted Delivery (00)	
<input type="checkbox"/> Adult Signature	<input type="checkbox"/> Priority Mail Express®																
<input type="checkbox"/> Adult Signature Restricted Delivery	<input type="checkbox"/> Registered Mail™																
<input type="checkbox"/> Certified Mail®	<input type="checkbox"/> Registered Mail Restricted Delivery																
<input type="checkbox"/> Certified Mail Restricted Delivery	<input type="checkbox"/> Signature Confirmation™																
<input type="checkbox"/> Collect on Delivery	<input type="checkbox"/> Signature Confirmation Restricted Delivery																
<input type="checkbox"/> Collect on Delivery Restricted Delivery																	
<input type="checkbox"/> Insured Mail																	
<input type="checkbox"/> Mail Restricted Delivery (00)																	

PS Form 3811, July 2020 PSN 7530-02-000-9053 Domestic Return Receipt

U.S. Postal Service
CERTIFIED MAIL® RECEIPT
 Domestic Mail Only

For delivery information, visit our website at www.usps.com

OFFICIAL USE

Certified Mail Fee \$ _____

Extra Services & Fees (check box, add fee as appropriate)

Return Receipt (hardcopy) \$ _____

Return Receipt (electronic) \$ _____

Certified Mail Restricted Delivery \$ _____

Adult Signature Required \$ _____

Adult Signature Restricted Delivery \$ _____

Postage \$ _____

Total Postage and Fees \$ _____

Sent To:

Street: E. Cecile Martin
 PO Box 246
 Marble Falls, TX 78654

City: _____

25060-67 PRO - Tzipan

PS Form 3800, January 2023 PSN 7530-02-000-9047 See Reverse for Instructions



9589 0710 5270 2305 9870 07



FROM

HINKLE SHANOR LLP
 ATTORNEYS AT LAW

PO BOX 2068 • 218 MONTEZUMA
 SANTA FE, NEW MEXICO 87504

TO

E. Cecile Martin
 PO Box 246
 Marble Falls, TX 78654

FIRST CLASS



US POSTAGE

ZIP 87501 \$ 011.54
 02 7H
 0606057409 DEC 16 2024

vac

LN 12/19

-k-T-S- 786545097-1N 12/28/24

RETURN TO SENDER
 VACANT
 UNABLE TO FORWARD
 RETURN TO SENDER

RECEIVED

JAN 3 2025

Hinkle Shanor LLP
 Santa Fe NM 87504

U.S. Postal Service™
CERTIFIED MAIL® RECEIPT
Domestic Mail Only

For delivery information, visit our website at www.usps.com

OFFICIAL USE

Certified Mail Fee
\$ _____

Extra Services & Fees (check box, add fee as appropriate)

Return Receipt (hardcopy) \$ _____

Return Receipt (electronic) \$ _____

Certified Mail Restricted Delivery \$ _____

Adult Signature Required \$ _____

Adult Signature Restricted Delivery \$ _____

Postage
\$ _____

Total Postage and Fees
\$ _____

Sent to
Street QRE Operating, LLC
1209 Orange St. Wilmington Newcastle,
City, Wilmington, DE 19801
25060-67 PRO - Taipan

PS Form 3800, January 2023 PSN 7530-02-000-9047 See Reverse for Instructions



9589 0710 5270 2305 9871 44

SENDER: COMPLETE THIS SECTION	COMPLETE THIS SECTION ON DELIVERY
<ul style="list-style-type: none"> ■ Complete items 1, 2, and 3. ■ Print your name and address on the reverse so that we can return the card to you. ■ Attach this card to the back of the mailpiece, or on the front if space permits. <p>1. Article Addressed to:</p> <p>QRE Operating, LLC 1209 Orange St. Wilmington Newcastle, Wilmington, DE 19801 <small>25060-67 PRO - Taipan</small></p> <p style="text-align: center;">9590 9402 9190 4225 2367 42</p> <p>2. Article Number (Transfer from service label)</p> <p style="text-align: center; font-size: 1.2em;">9589 0710 5270 2305 9871 44</p> <p style="font-size: 0.8em;">PS Form 3811, July 2020 PSN 7530-02-000-9053</p>	<p>A. Signature X DEC 24 2024 <input type="checkbox"/> Agent <input type="checkbox"/> Addressee</p> <p>B. Received by (Printed Name) CT CORPORATION</p> <p>C. Date of Delivery</p> <p>D. Is delivery address different from item 1? <input type="checkbox"/> Yes if YES, enter delivery address below: <input type="checkbox"/> No</p> <div style="text-align: center; border: 1px solid black; padding: 5px; font-size: 1.5em; font-weight: bold;">RECEIVED</div> <p style="text-align: center; font-size: 1.2em;">JAN 3 2025</p> <p>3. Service Type <small>Hinkie Shenor</small></p> <p><input type="checkbox"/> Adult Signature <input type="checkbox"/> Priority Mail Express®</p> <p><input type="checkbox"/> Adult Signature Restricted Delivery <input type="checkbox"/> Registered Mail™</p> <p><input type="checkbox"/> Certified Mail® <input type="checkbox"/> Registered Mail Restricted Delivery</p> <p><input type="checkbox"/> Certified Mail Restricted Delivery <input type="checkbox"/> Signature Confirmation™</p> <p><input type="checkbox"/> Collect on Delivery <input type="checkbox"/> Signature Confirmation Restricted Delivery</p> <p><input type="checkbox"/> Collect on Delivery Restricted Delivery</p> <p>all Restricted Delivery</p> <p style="text-align: right; font-size: 0.8em;">Domestic Return Receipt</p>

Wolters Kluwer

CT Corporation
Rejection Team
1999 Bryan Street
Suite 900
Dallas, TX 75201

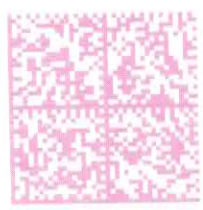

quadrant
FIRST-CLASS MAIL
AUTO - IMI
\$000.59
1506/2024 ZIP 07803
0491M32206320

US POSTAGE

JAN 3 2025



CT Corporation
Rejection Team
1999 Bryan Street
Suite 900
Dallas, TX 75201



quodient
FIRST-CLASS MAIL
AUTO - IMI
\$000.59²
12062024 ZIP 56303
043M32208326

US POSTAGE

JAN 8 2025

8056193

026 KARGAAB 07504



CT CORP-REJECT ENVL 105 (2023)

9589 0710 5270 2305 9870 69

U.S. Postal Service™	
CERTIFIED MAIL® RECEIPT	
<i>Domestic Mail Only</i>	
For delivery information, visit our website at www.usps.com ®.	
OFFICIAL USE	
Certified Mail Fee	
\$	
Extra Services & Fees (check box, add fee as appropriate)	
<input type="checkbox"/> Return Receipt (hardcopy) \$ _____	
<input type="checkbox"/> Return Receipt (electronic) \$ _____	
<input type="checkbox"/> Certified Mail Restricted Delivery \$ _____	
<input type="checkbox"/> Adult Signature Required \$ _____	
<input type="checkbox"/> Adult Signature Restricted Delivery \$ _____	
Postage	
\$	
Total Postage and Fees	
\$	
Sent To	
Street	Hurt Properties, LP PO Box 1967
City, S	Abingdon, VA 24212-0000 25060-67 PRO - Taiwan
PS Form 3800, January 2023 PSN 7530-02-000-9047 See Reverse for Instructions	

ALERT: WINTER STORMS IN THE SOUTHERN, SOUTHEAST, AND NORTHEAST AND WILDFIRE...

USPS Tracking[®]

FAQs >

Tracking Number:

Remove X

9589071052702305987069

Copy

Add to Informed Delivery (<https://informedelivery.usps.com/>)

Latest Update

Your item was picked up at the post office at 1:46 pm on December 23, 2024 in ABINGDON, VA 24210.

Get More Out of USPS Tracking:

USPS Tracking Plus[®]

Feedback

Delivered

Delivered, Individual Picked Up at Post Office

ABINGDON, VA 24210

December 23, 2024, 1:46 pm

Available for Pickup

ABINGDON

300 W MAIN ST

ABINGDON VA 24210-9998

M-F 0900-1700; SAT 1000-1200

December 21, 2024, 4:35 am

Arrived at Post Office

ABINGDON, VA 24210

December 21, 2024, 4:35 am

Arrived at USPS Regional Facility

KNOXVILLE TN DISTRIBUTION CENTER

December 20, 2024, 3:28 pm

In Transit to Next Facility

9589 0710 5270 2305 9871 20

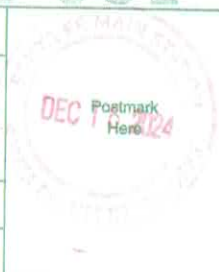
U.S. Postal Service™	
CERTIFIED MAIL® RECEIPT	
<i>Domestic Mail Only</i>	
For delivery information, visit our website at www.usps.com ®.	
OFFICIAL USE	
Certified Mail Fee	
\$	
Extra Services & Fees (check box, add fee as appropriate)	
<input type="checkbox"/> Return Receipt (hardcopy) \$	
<input type="checkbox"/> Return Receipt (electronic) \$	
<input type="checkbox"/> Certified Mail Restricted Delivery \$	
<input type="checkbox"/> Adult Signature Required \$	
<input type="checkbox"/> Adult Signature Restricted Delivery \$	
Postage	
\$	
Total Postage and Fees	
\$	
Sent To	
Street	McAnSo, LLC
	PO Box 50530
City	Austin, TX 78763
	25060-67 PRO - Taipan
PS Form 3800, January 2023 PSN 7530-02-000-9047 See Reverse for Instructions	

ALERT: WINTER STORMS IN THE SOUTHERN, SOUTHEAST, AND NORTHEAST AND WILDFIRE...

USPS Tracking[®]

FAQs >

Tracking Number:

Remove X

9589071052702305987120

Copy

Add to Informed Delivery (<https://informedelivery.usps.com/>)

Latest Update

Your item has been delivered and is available at a PO Box at 8:03 am on December 20, 2024 in AUSTIN, TX 78703.

Get More Out of USPS Tracking:

USPS Tracking Plus[®]

Feedback

Delivered

Delivered, PO Box

AUSTIN, TX 78703

December 20, 2024, 8:03 am

Arrived at Post Office

AUSTIN, TX 78703

December 20, 2024, 7:56 am

In Transit to Next Facility

December 19, 2024

Arrived at USPS Regional Facility

AUSTIN TX DISTRIBUTION CENTER

December 18, 2024, 11:21 am

Departed USPS Facility

ALBUQUERQUE, NM 87101

December 17, 2024, 8:29 am

AFFIDAVIT OF PUBLICATION

CARLSBAD CURRENT-ARGUS
PO BOX 507
HUTCHINSON, KS 67504-0507

STATE OF NEW MEXICO } SS
COUNTY OF EDDY }

Account Number: 94
Ad Number: 26190
Description: Permian Taipan 25060-25067
Ad Cost: \$217.80

Sherry Groves, being first duly sworn, says:

That she is the Agent of the the Carlsbad Current-Argus, a Weekly newspaper of general circulation, printed and published in Carlsbad, Eddy County, New Mexico; that the publication, a copy of which is attached hereto, was published in said newspaper on the following dates:

December 19, 2024

That said newspaper was regularly issued and circulated on those dates.

SIGNED:

Sherry Groves

Agent

Subscribed to and sworn to me this 19th day of December 2024.

Leanne Kaufenberg

Leanne Kaufenberg, Notary Public, Redwood County Minnesota

CARA DOUGLAS
HINKLE SHANOR, LLP
PO BOX 2068
Santa Fe, NM 87504
cdouglas@hinklelawfirm.com

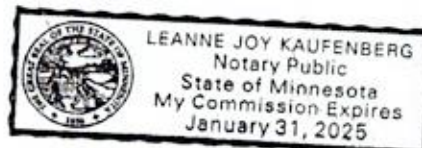

Permian Resources Operating, LLC
Case No. 25063
Exhibit C-4

PUBLIC NOTICE

This is to notify all interested parties, including BEXP II GW Alpha, LLC; BEXP II GW WI Omega, LLC; BEXP II Omega MISC., LLC; Bursake, LLC; Claremont Corporation; Davoil, Inc.; E. Cecile Martin; EOG Resources; Freddie Jean Wheeler; Gilmore Resources, Inc.; Great Western Drilling Ltd.; Hurt Properties, LP; James R. Hurt; Karen Benbow McRae; Katherine Anne Gilmore Shannon and Laurence Davis Gilmore, Co-Trustees of The Katherine E. Gilmore Bypass Trust dated May 9, 2017; Magnum Hunter Production Inc.; McAnSo, LLC; Morris Allen Williams; QRE Operating, LLC; Sabinal Energy Operating, LLC; and their successors and assigns, that the New Mexico Oil Conservation Division will conduct a hearing on the applications submitted by Permian Resources Operating, LLC (Case Nos. 25060, 25061, 25062, 25063, 25064, 25065, 25066 & 25067). The hearing will be conducted on January 9, 2025, in a hybrid fashion, both virtually and in-person at the Energy, Minerals, Natural Resources Department, Wendell Chino Building, Pecos Hall, 1220 South St. Francis Drive, 1st Floor, Santa Fe, NM 87505. To participate virtually, see the instructions posted on the OCD Hearings website: <https://www.emnrd.nm.gov/ocd/hearing-info/>. In **Case No. 25060**, Permian Resources Operating, LLC ("Applicant") applies for an order pooling all uncommitted interests in the Bone Spring formation underlying a 320-acre, more or less, standard horizontal spacing unit comprised of the N/2 N/2 of Sections 21 and 22, Township 20 South, Range 28 East, Eddy County, New Mexico. The Unit will be dedicated to the **Taipan 21 Fed Com 131H** well, which will be drilled from a surface hole location in the SE/4 NE/4 (Unit H) of Section 20 to a bottom hole location in the NE/4 NE/4 (Unit A) of Section 22. In **Case No. 25061**, Applicant applies for an order pooling all uncommitted interests in the Bone Spring formation underlying a 320-acre, more or less, standard horizontal spacing unit comprised of the S/2 N/2 of Sections 21 and 22, Township 20 South, Range 28 East, Eddy County, New Mexico. The Unit will be dedicated to the **Taipan 21 Fed Com 132H** well, which will be drilled from a surface hole location in the SE/4 NE/4 (Unit H) of Section 20 to a bottom hole location in the SE/4 NE/4 (Unit H) of Section 22. In **Case No. 25062**, Applicant applies for an order pooling all uncommitted interests in the Bone Spring formation underlying a 320-acre, more or less, standard horizontal spacing unit comprised of the N/2 S/2 of Sections 21 and 22, Township 20 South, Range 28 East, Eddy County, New Mexico. The Unit will be dedicated to the **Taipan 21 Fed Com 133H** well, which will be drilled from a surface hole location in the NE/4 SE/4 (Unit I) of Section 20 to a bottom hole location in the NE/4 SE/4 (Unit I) of Section 22. In **Case No. 25063**, Applicant applies for an order pooling all uncommitted interests in the Bone Spring formation underlying a 320-acre, more or less, standard horizontal spacing unit comprised of the S/2 S/2 of Sections 21 and 22, Township 20 South, Range 28 East, Eddy County, New Mexico. The Unit will be dedicated to the **Taipan 21 Fed Com 134H** well, which will be drilled from a surface hole location in the NE/4 SE/4 (Unit I) of Section 20 to a bottom hole location in the SE/4 SE/4 (Unit P) of Section 22. In **Case No. 25064**, Applicant applies for an order pooling all uncommitted interests in the Wolfcamp formation underlying a 320-acre, more or less, standard horizontal spacing unit comprised of the N/2 N/2 of Sections 21 and 22, Township 20 South, Range 28 East, Eddy County, New Mexico. The Unit will be dedicated to the **Taipan 21 Fed Com 201H** well, which will be drilled from a surface hole location in the SE/4 NE/4 (Unit H) of Section 20 to a bottom hole location in the NE/4 NE/4 (Unit A) of Section 22. In **Case No. 25065**, Applicant applies for an order pooling all uncommitted interests in the Wolfcamp formation underlying a 320-acre, more or less, standard horizontal spacing unit comprised of the S/2 N/2 of Sections 21 and 22, Township 20 South, Range 28 East, Eddy County, New Mexico. The Unit will be dedicated to the **Taipan 21 Fed Com 202H** well, which will be drilled from a surface hole location in the SE/4 NE/4 (Unit H) of Section 20 to a bottom hole location in the SE/4 NE/4 (Unit H) of Section 22. In **Case No. 25066**, Applicant applies for an order pooling all uncommitted interests in the Wolfcamp formation underlying a 320-acre, more or less, standard horizontal spacing unit comprised of the N/2 S/2 of Sections 21 and 22, Township 20 South, Range 28 East, Eddy County, New Mexico. The Unit will be dedicated to the **Taipan 21 Fed Com 203H** well, which will be drilled from a surface hole location in the NE/4 SE/4 (Unit I) of Section 20 to a bottom hole location in the NE/4 SE/4 (Unit I) of Section 22. In **Case No. 25067**, Applicant applies for an order pooling all uncommitted interests in the Wolfcamp formation underlying a 320-acre, more or less, standard horizontal spacing unit comprised of the S/2 S/2 of Sections 21 and 22, Township 20 South, Range 28 East, Eddy County, New Mexico. The Unit will be dedicated to the **Taipan 21 Fed Com 204H** well, which will be drilled from a surface hole location in the NE/4 SE/4 (Unit I) of Section 20 to a bottom hole location in the SE/4 SE/4 (Unit P) of Section 22. The completed intervals of the Wells will be orthodox. Also to be

considered will be the cost of drilling and completing the Wells and the allocation of the costs, the designation of Applicant as operator of the Wells, and a 200% charge for the risk involved in drilling and completing the Wells. The Wells are located approximately 10 miles northeast of Carlsbad, New Mexico.

Published in the Carlsbad Current-Argus December 19, 2024.
#26190