

District I

1625 N. French Dr., Hobbs, NM 88240

District II

811 S. First St., Artesia, NM 88210

District III

1000 Rio Brazos Road, Aztec, NM 87410

District IV

1220 S. St. Francis Dr., Santa Fe, NM 87505

State of New Mexico  
Energy Minerals and Natural ResourcesOil Conservation Division  
1220 South St. Francis Dr.  
Santa Fe, NM 87505Form C-141  
Revised August 8, 2011Submit 1 Copy to appropriate District Office in  
accordance with 19.15.29 NMAC.**2RP-2949****Release Notification and Corrective Action****OPERATOR**☐ Initial Report ☒ Final Report

Name of Company: <b>Enterprise Field Services LLC</b>	Contact: <b>Alena Miro</b>
Address: <b>PO Box 4324, Houston, TX 77252</b>	Telephone No.: <b>575-628-6802</b>
Facility Name: <b>Angel Draw: OIZ to OJ4</b>	Facility Type: <b>Gathering Pipeline</b>
Surface Owner <b>BLM</b>	Mineral Owner
API No.	

**LOCATION OF RELEASE**

Unit Letter	Section	Township	Range	Feet from the	North/South Line	Feet from the	East/West Line	County
	<b>2</b>	<b>20S</b>	<b>27E</b>					<b>Eddy</b>

Latitude: **N 32.606717** Longitude: **W -104.248667****NATURE OF RELEASE**

Type of Release: <b>Natural Gas</b>	Volume of Release: <b>130 MCF, 5 BBL PPL Liquids</b>	Volume Recovered: <b>none</b>
Source of Release: <b>Pipeline Leak</b>	Date and Hour of Occurrence: <b>Start: 02/06/2014 16:15 (MST)</b>	Date and Hour of Discovery: <b>End: 02/06/2014 17:30 (MDT)</b>
Was Immediate Notice Given? <input type="checkbox"/> Yes <input type="checkbox"/> No <input checked="" type="checkbox"/> Not Required	If YES, To Whom?	
By Whom?	Date and Hour:	
Was a Watercourse Reached? <input type="checkbox"/> Yes <input checked="" type="checkbox"/> No	If YES, Volume Impacting the Watercourse.	

If a Watercourse was Impacted, Describe Fully.\*

Describe Cause of Problem and Remedial Action Taken.\*

**CAUSE:** A small in-line leak; initially attributed to corrosion.**ACTION:** The line was blocked-in, blown down and repaired. Release volume includes blow-down for repair.

Describe Area Affected and Cleanup Action Taken.\*

**Soil remediation actions were completed as outlined in the attached document.**

I hereby certify that the information given above is true and complete to the best of my knowledge and understand that pursuant to NMOCD rules and regulations all operators are required to report and/or file certain release notifications and perform corrective actions for releases which may endanger public health or the environment. The acceptance of a C-141 report by the NMOCD marked as "Final Report" does not relieve the operator of liability should their operations have failed to adequately investigate and remediate contamination that pose a threat to ground water, surface water, human health or the environment. In addition, NMOCD acceptance of a C-141 report does not relieve the operator of responsibility for compliance with any other federal, state, or local laws and/or regulations.

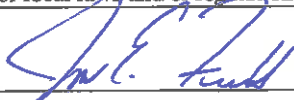
Signature: 	<b>OIL CONSERVATION DIVISION</b>	
Printed Name: Jon E. Fields	Approved by Environmental Specialist: <b>Ashley Maxwell</b>	
Title: Director – Field Environmental	Approval Date: <b>4/17/2023</b>	Expiration Date:
E-mail Address: jefields@eprod.com	Conditions of Approval:	Attached <input type="checkbox"/>
Date: <b>4/11/17</b> Phone: 713-381-6595		

\* Attach Additional Sheets If Necessary

talonlpe.com • 866.742.0742



**Closure Report**  
**Enterprise Field Services, LLC: Angel Draw**  
**[2RP-2949]**

April 12, 2017

**Prepared For:**

Ms. Alena Miro  
Enterprise Field Services, LLC  
PO Box 4342  
Houston, TX 77252

**Prepared By:**

Talon/LPE  
408 W. Texas Ave.  
Artesia, NM 88210

## Table of Contents

1.0 Introduction .....	1
1.1 Objectives and Site Background .....	1
2.0 Regulatory Framework.....	1
2.1 NMOCD Site Ranking Criteria.....	1
2.2 Remedial Action Levels for Soil.....	2
3.0 Site Area Description .....	2
3.1 Soil Description .....	2
3.2 Ground Water Depth and Wellhead Distance.....	2
3.3 Surface Water Distance .....	2
3.4 Site Ranking Conclusion.....	2
4.0 Incident Information.....	3
4.1 Incident Description.....	3
5.0 Remediation Activities .....	3
5.1 Excavation Activities .....	3
5.2 Soil Sampling.....	3
5.3 Backfill and Site Grading Activities .....	3
6.0 Conclusions and Recommendations .....	4
6.1 Conclusions .....	4
6.2 Recommendations.....	4

## 1.0 Introduction

### 1.1 Objectives and Site Background

Enterprise Field Services, LLC (Enterprise) has contracted Talon/LPE (Talon) to perform initial spill response, soil sampling and remediation services at the previously referenced location. The regulatory framework, site description, incident description, soil sampling results, remediation activities, conclusions and recommendations are submitted herein.

The Angel Draw line is located approximately fourteen (14) miles north of Carlsbad, New Mexico. The legal location for this release is Unit Letter G, Section 2, Township 20 South and Range 27 East in Eddy County, New Mexico. More specifically the latitude and longitude for the release are 32.606717 and -104.248667 West. A site plan is presented in [Appendix I](#).

## 2.0 Regulatory Framework

### 2.1 NMOCD Site Ranking Criteria

NMOCD guidance document titled: *Guidelines for Remediation of Leaks, Spills and Releases*, dated August 13, 1993. Consistent with these guidelines, general site characteristics, including the depth to groundwater, and the distance to water wells or surface water sources, will be utilized to determine the appropriate “ranking” of individual release sites and the associated remedial action requirements. The site ranking criteria and associated scoring values, based on the 1993 guidance, are summarized in the following Table.

Ranking Criteria		Ranking Score
Depth to Groundwater	<50'	20
	50-99'	10
	>100'	0
Wellhead Protection Area <1,000' from a water source, or 200' from private domestic water source.	Yes	20
	No	0
Distance to Surface Water Body	<200'	20
	200' to 1,000'	10
	>1,000'	0



## 2.2 Remedial Action Levels for Soil

From the NMOCD guidance document *Guidelines for Remediation of Leaks, Spills and Releases*, dated August 13, 1993. The total ranking score determines the degree of remediation that may be required on a site specific basis. The total ranking score is the sum of all four individual ranking criteria. The Recommended Remedial Action Level's (RRAL's) based on total site ranking are summarized in the table below.

Constituent	Site Ranking >19	Site Ranking 10	Site Ranking 0
<b>Benzene</b>	10 mg/kg	10 mg/kg	10 mg/kg
<b>Total BTEX</b>	50 mg/kg	50 mg/kg	50 mg/kg
<b>TPH</b>	100 mg/kg	1,000 mg/kg	5,000 mg/kg

Though not mentioned in the NMOCD guidance document *Guidelines for Remediation of Leaks, Spills and Releases*, dated August 13, 1993. The recommended remedial action level for Total Chloride concentration in NMOCD District 2 is 1,000 mg/kg regardless of depth to groundwater.

## 3.0 Site Area Description

### 3.1 Soil Description

According to the soil survey provided by the United States Department of Agriculture National Resources Conservation Service (NRCS), the soil in this area is made up of the Reeves-Gypsum land complex with 0 to 3 percent slopes. Drainage courses in this area are normally dry.

### 3.2 Ground Water Depth and Wellhead Distance

The New Mexico State Engineer database indicates that ground water in the project vicinity is at a depth of 79-feet below ground surface (BGS). The nearest water well to this site is well (RA-11946-POD1) is 640-feet from the site. See [Appendix III](#) for the referenced groundwater data and well data.

### 3.3 Surface Water Distance

The nearest surface water body is the Pecos River. The nearest bank of the river is approximately 5.5 miles west of the site. See [Appendix II](#) for area maps.

### 3.4 Site Ranking Conclusion

Based on the information provided in the above sections it is concluded that the ranking for this site is 20. Therefore NMOCD RRAL's for this incident should be consistent with the description in section 2.2.

## 4.0 Incident Information

### 4.1 Incident Description

On February 6, 2014, a leak was discovered in the Angel draw line between OIZ and OJ4. The line was repaired and put back into service. The leak resulted in the loss of approximately 5bbls of pipeline fluids.

## 5.0 Remediation Activities

### 5.1 Excavation Activities

A bell hole was dug to remove impacted soil utilizing visual observations, PID readings, and field chloride titrations as a guide. Once field data indicated that all of the impacted material had been successfully removed. Confirmation soil samples were taken from the bottom and sidewall samples of the excavation

### 5.2 Soil Sampling

Following excavation activities soil samples were collected from the bottom and sidewalls of the excavation. The analytical results from the soil sampling are summarized in the tables below. Laboratory Analytical Reports and Chain of Custody Documentation can be found in [Appendix V](#).

Sample ID	Depth (feet)	Benzene (mg/kg)	BTEX (mg/kg)	Chlorides (mg/kg)	TPH (mg/kg)
S-1	14	<0.050	<0.300	64	<10.0
S-2	Sidewall	<0.050	<0.300	64	<10.0
S-3	Sidewall	<0.050	<0.300	32	<10.0
S-4	Sidewall	<0.050	<0.300	<16.0	<10.0
s-5	Sidewall	<0.050	<0.300	<16.0	<10.0

### 5.3 Backfill and Site Grading Activities

Following receipt of analytical results from the soil sampling events the site was backfilled with top soil and contoured to match the surrounding terrain.

## 6.0 Conclusions and Recommendations

### 6.1 Conclusions

- The site was excavated utilizing visual observations, field chloride titrations, and PID readings to guide the extent of the excavation.
- Soil samples were taken from the bottom and sidewalls of the completed excavation and analyzed for TPH, BTEX, and total chlorides.
- Following receipt of analytical data below NMOCD RRAL's the site was backfilled with top soil and contoured to match the surrounding terrain.

### 6.2 Recommendations

Based on the analytical results from the soil sampling events we recommend that no further activities be required and that closure with regard to this release be granted.

Should you have any questions or if further information is required, please do not hesitate to contact our office at (575)-746-8768

Respectfully submitted,

TALON/LPE

  
Sheldon Hitchcock  
Project Manager

  
David J. Adkins  
District Manager

### Attachments



Appendix I Site Plan  
Appendix II Area Maps  
Appendix III Groundwater and Well Data  
Appendix IV Initial C-141  
Appendix V Laboratory Results

# APPENDIX I

## SITE PLAN

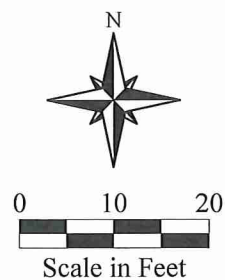
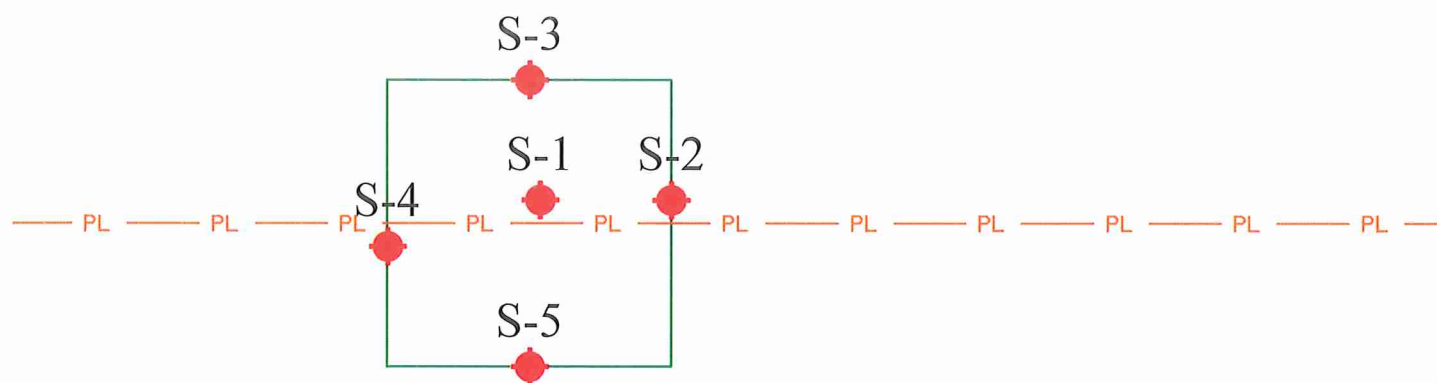



Legend	
	- Sample Location
	- Pipeline



Date: 04/16/2014

Scale: 1" = 20'

Drawn By: TJS

Angel Draw #3  
Enterprise Products Company  
Eddy County, New Mexico  
Figure 1 - Site Plan

## APPENDIX II

## AREA MAPS



Google Earth

Enterprise-Angel Draw #3





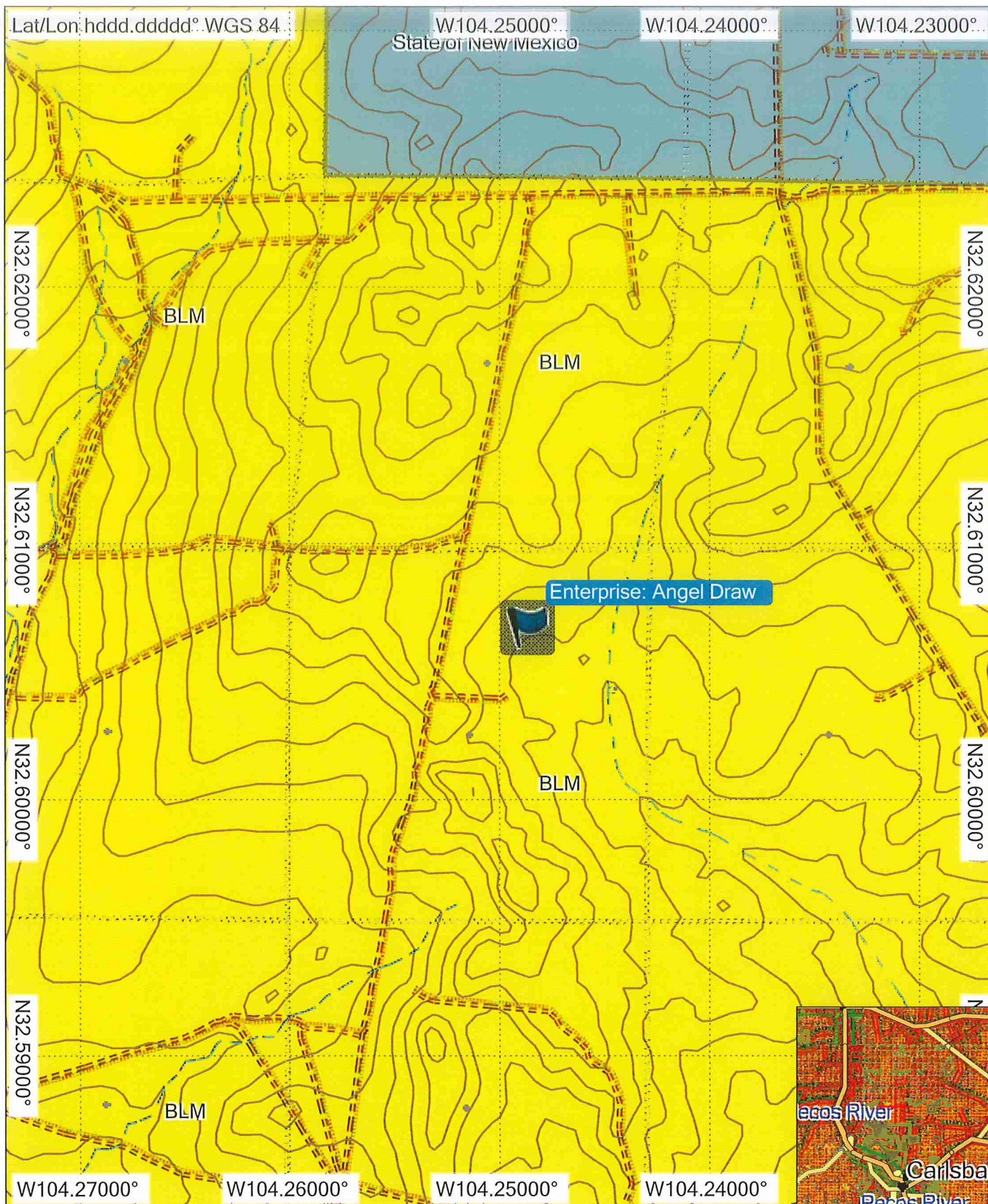

NM\_PLAT4GPS  
All rights reserved.  
gps\_mapper  
©2015 onXmaps, Inc.

10/21/2016 10:48:50 AM

0 mi 0.25 mi 0.5 mi 0.75 mi 1 mi

GARMIN.

TN MN  
8.1°  
1/1/2010

# **APPENDIX III**

## **GROUNDWATER AND WELL DATA**





# NEW MEXICO Office of the State Engineer

## Water Column/Average Depth to Water

(A CLW##### in the POD suffix indicates the POD has been replaced & no longer serves a water right file.)

(R=POD has been replaced, O=orphaned, C=the file is closed)

(quarters are 1=NW 2=NE 3=SW 4=SE)

(quarters are smallest to largest)

(NAD83 UTM in meters)

(In feet)

POD Number	POD Sub-Code	basin	County	Q 64	Q 16	Q 4	Sec	Tws	Rng	X	Y	Distance	Depth Well	Depth Water	Water Column
<a href="#">RA 11946 POD1</a>			ED	1	3	4	06	20S	26E	570307	3607894	266	160	79	81
<a href="#">RA 05552</a>			ED		2	4	02	20S	27E	570844	3607265*	566	145		
<a href="#">RA 10343</a>			ED	2	2	4	14	20S	27E	570941	3604148*	3552	128	74	54
<a href="#">RA 02385</a>			ED		1	3	27	19S	27E	568171	3610454*	3597	120		
<a href="#">RA 05410</a>			ED		2	4	14	20S	27E	570842	3604049*	3637	81	66	15

Average Depth to Water: 73 feet

Minimum Depth: 66 feet

Maximum Depth: 79 feet

Record Count: 5

Basin/County Search:

County: Eddy

UTMNAD83 Radius Search (in meters):

Easting (X): 570443

Northing (Y): 3607665

Radius: 5000

\*UTM location was derived from PLSS - see Help

The data is furnished by the NMOSE/ISC and is accepted by the recipient with the expressed understanding that the OSE/ISC make no warranties, expressed or implied, concerning the accuracy, completeness, reliability, usability, or suitability for any particular purpose of the data.

# USE WELL LOCATIONS

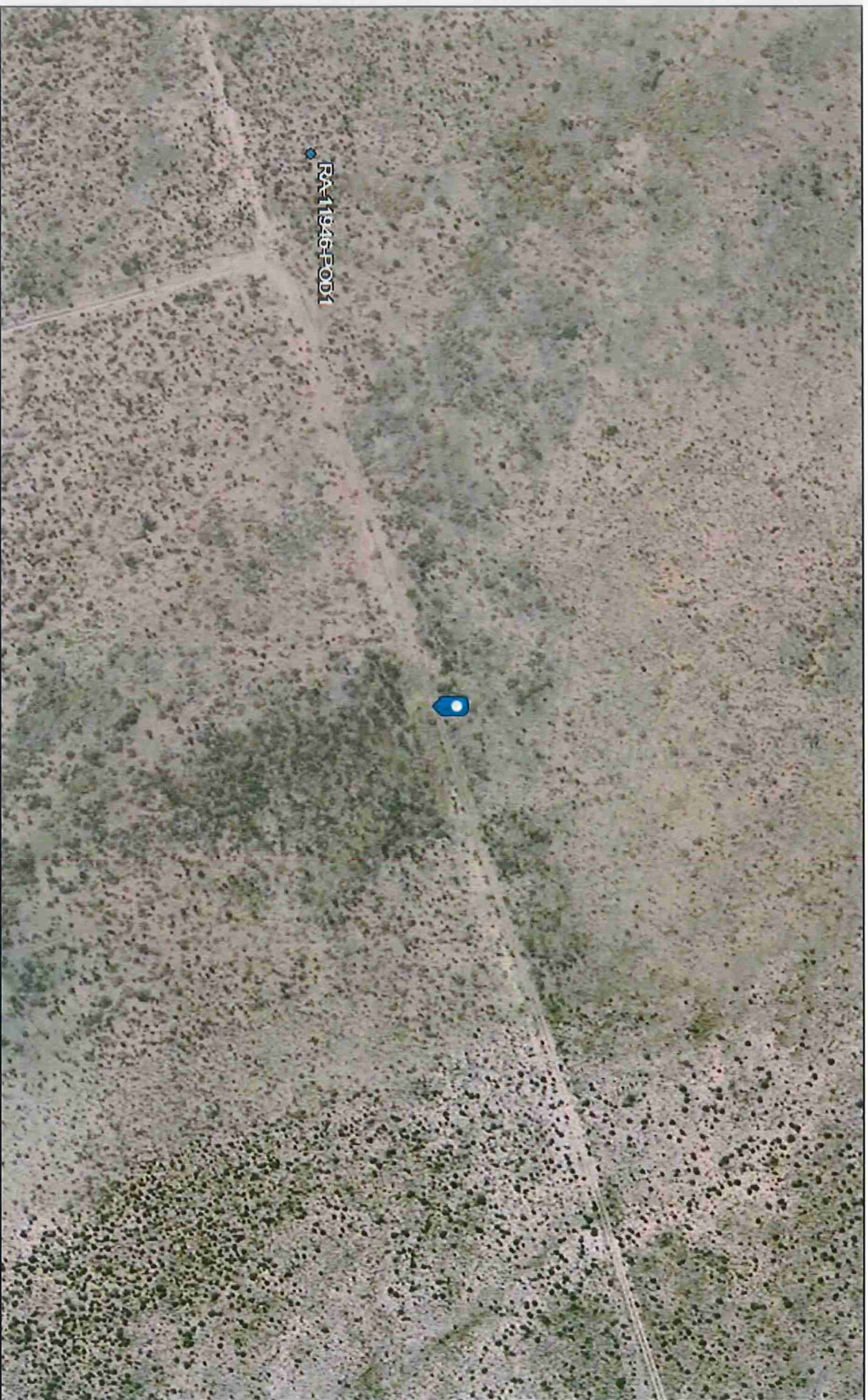

April 7, 2017

OSE Wells

● ACT

OSE District Boundary

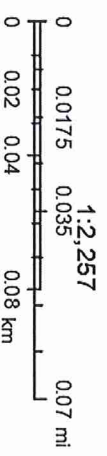

Esri, HERE, DeLorme, MapmyIndia, © OpenStreetMap contributors, and the  
Esri, HERE, DeLorme, MapmyIndia, © OpenStreetMap contributors, and the

## APPENDIX IV

## INITIAL C-141



District I  
1625 N. French Dr., Hobbs, NM 88240  
District II  
811 S. First St., Artesia, NM 88210  
District III  
1000 Rio Brazos Road, Aztec, NM 87410  
District IV  
1220 S. St. Francis Dr., Santa Fe, NM 87505

State of New Mexico  
Energy Minerals and Natural Resources

Oil Conservation Division  
1220 South St. Francis Dr.  
Santa Fe, NM 87505

Form C-141  
Revised August 8, 2011

Submit 1 Copy to appropriate District Office in  
accordance with 19.15.29 NMAC.

**FAB1510438383 Release Notification and Corrective Action**

**nAB1510438546**

**OPERATOR**

☒ Initial Report ☐ Final Report

Name of Company: <b>Enterprise Field Services LLC</b>	Contact: <b>Jim Heap</b>
Address: <b>PO Box 4324, Houston, TX 77252</b>	Telephone No.: <b>432-686-5404</b>
Facility Name: <b>Angel Draw: OIZ to OJA</b>	Facility Type: <b>Gathering Pipeline</b>
Surface Owner	Mineral Owner
API No.	

**LOCATION OF RELEASE**

Unit Letter	Section	Township	Range	Feet from the	North/South Line	Feet from the	East/West Line	County
	2	20S	27E					Eddy

Latitude: N 32.606717 Longitude: W -104.248667

**NATURE OF RELEASE**

Type of Release: <b>Natural Gas</b>	Volume of Release: <b>130 MCF, 5 BBL PPL Liquids</b>	Volume Recovered: <b>TBD</b>
Source of Release: <b>Pipeline Leak</b>	Date and Hour of Occurrence: <b>Start: 02/06/2014 16:15 (MST)</b>	Date and Hour of Discovery: <b>End: 02/06/2014 17:30 (MDT)</b>
Was Immediate Notice Given? <input type="checkbox"/> Yes <input type="checkbox"/> No <input checked="" type="checkbox"/> Not Required	If YES, To Whom?	
By Whom?	Date and Hour:	
Was a Watercourse Reached? <input type="checkbox"/> Yes <input checked="" type="checkbox"/> No	If YES, Volume Impacting the Watercourse.	

If a Watercourse was Impacted, Describe Fully.\*

Describe Cause of Problem and Remedial Action Taken.\*

**CAUSE:** A small in-line leak; initially attributed to corrosion.

**ACTION:** The line was blocked-in and blown down. Release volume includes blow-down for repair.

Describe Area Affected and Cleanup Action Taken.\*

**All gas was lost to atmosphere.**

I hereby certify that the information given above is true and complete to the best of my knowledge and understand that pursuant to NMOCD rules and regulations all operators are required to report and/or file certain release notifications and perform corrective actions for releases which may endanger public health or the environment. The acceptance of a C-141 report by the NMOCD marked as "Final Report" does not relieve the operator of liability should their operations have failed to adequately investigate and remediate contamination that pose a threat to ground water, surface water, human health or the environment. In addition, NMOCD acceptance of a C-141 report does not relieve the operator of responsibility for compliance with any other federal, state, or local laws and/or regulations.

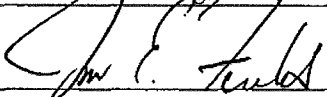
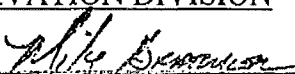
Signature: 	<b>OIL CONSERVATION DIVISION</b>	
Printed Name: Jon E. Fields	Signed By: 	
Title: Director, Field Environmental	Approved by Environmental Specialist:	
E-mail Address: jefields@eprod.com	Approval Date: <b>4/14/15</b>	Expiration Date: <b>N/A</b>
Date: <b>2-10-14</b> Phone: 713.381.6684	Conditions of Approval:	Attached <input type="checkbox"/>

**Remediation per O.C.D. Rules & Guidelines**  
**SUBMIT REMEDIATION PROPOSAL NO**  
**LATER THAN: 5/15/15**

\* Attach Additional Sheets If Necessary

**2RP-2949**

## APPENDIX V

### LABORATORY RESULTS





PHONE (575) 393-2326 ° 101 E. MARLAND ° HOBBS, NM 88240

April 02, 2014

SHELDON HITCHCOCK

TALON LPE

408 W. TEXAS AVE.

ARTESIA, NM 88210

RE: ANGEL DRAW #3

Enclosed are the results of analyses for samples received by the laboratory on 04/01/14 10:07.

Cardinal Laboratories is accredited through Texas NELAP under certificate number T104704398-13-5. Accreditation applies to drinking water, non-potable water and solid and chemical materials. All accredited analytes are denoted by an asterisk (\*). For a complete list of accredited analytes and matrices visit the TCEQ website at [www.tceq.texas.gov/field/qa/lab\\_accred\\_certif.html](http://www.tceq.texas.gov/field/qa/lab_accred_certif.html).

Cardinal Laboratories is accredited through the State of Colorado Department of Public Health and Environment for:

Method EPA 552.2	Haloacetic Acids (HAA-5)
Method EPA 524.2	Total Trihalomethanes (TTHM)
Method EPA 524.4	Regulated VOCs (V1, V2, V3)

Accreditation applies to public drinking water matrices.

This report meets NELAP requirements and is made up of a cover page, analytical results, and a copy of the original chain-of-custody. If you have any questions concerning this report, please feel free to contact me.

Sincerely,

Celey D. Keene

Lab Director/Quality Manager



PHONE (575) 393-2326 • 101 E. MARLAND • HOBBS, NM 88240

**Analytical Results For:**

TALON LPE  
 SHELDON HITCHCOCK  
 408 W. TEXAS AVE.  
 ARTESIA NM, 88210  
 Fax To: (575) 745-8905

Received: 04/01/2014  
 Reported: 04/02/2014  
 Project Name: ANGEL DRAW #3  
 Project Number: NOT GIVEN  
 Project Location: NOT GIVEN

Sampling Date: 03/31/2014  
 Sampling Type: Soil  
 Sampling Condition: Cool & Intact  
 Sample Received By: Jodi Henson

**Sample ID: S-1 14' (H400961-01)**

BTX 8021B		mg/kg		Analyzed By: MS					
Analyte	Result	Reporting Limit	Analyzed	Method Blank	BS	% Recovery	True Value QC	RPD	Qualifier
Benzene*	<0.050	0.050	04/02/2014	ND	2.60	130	2.00	9.41	
Toluene*	<0.050	0.050	04/02/2014	ND	2.46	123	2.00	9.27	
Ethylbenzene*	<0.050	0.050	04/02/2014	ND	2.40	120	2.00	9.28	
Total Xylenes*	<0.150	0.150	04/02/2014	ND	6.84	114	6.00	9.37	
Total BTX	<0.300	0.300	04/02/2014	ND					

Surrogate: 4-Bromofluorobenzene (PIE) 113 % 89.4-126

Chloride, SM4500Cl-B		mg/kg		Analyzed By: AP					
Analyte	Result	Reporting Limit	Analyzed	Method Blank	BS	% Recovery	True Value QC	RPD	Qualifier
Chloride	64.0	16.0	04/02/2014	ND	432	108	400	0.00	

TPH 8015M		mg/kg		Analyzed By: ms					
Analyte	Result	Reporting Limit	Analyzed	Method Blank	BS	% Recovery	True Value QC	RPD	Qualifier
GRO C6-C10	<10.0	10.0	04/02/2014	ND	208	104	200	5.39	
DRO >C10-C28	<10.0	10.0	04/02/2014	ND	217	109	200	2.49	

Surrogate: 1-Chlorooctane 94.6 % 65.2-140

Surrogate: 1-Chlorooctadecane 90.0 % 63.6-154

Cardinal Laboratories

\*=Accredited Analyte

PLEASE NOTE: Liability and Damages. Cardinal's liability and client's exclusive remedy for any claim arising, whether based in contract or tort, shall be limited to the amount paid by client for analyses. All claims, including those for negligence and any other cause whatsoever shall be deemed waived unless made in writing and received by Cardinal within thirty (30) days after completion of the applicable service. In no event shall Cardinal be liable for incidental or consequential damages, including, without limitation, business interruptions, loss of use, or loss of profits incurred by client, its subsidiaries, affiliates or successors arising out of or related to the performance of the services hereunder by Cardinal, regardless of whether such claim is based upon any of the above stated reasons or otherwise. Results relate only to the samples identified above. This report shall not be reproduced except in full with written approval of Cardinal Laboratories.

Celey D. Keene, Lab Director/Quality Manager



PHONE (575) 393-2326 • 101 E. MARLAND • HOBBS, NM 88240

**Analytical Results For:**

TALON LPE  
SHELDON HITCHCOCK  
408 W. TEXAS AVE.  
ARTESIA NM, 88210  
Fax To: (575) 745-8905

Received: 04/01/2014  
Reported: 04/02/2014  
Project Name: ANGEL DRAW #3  
Project Number: NOT GIVEN  
Project Location: NOT GIVEN

Sampling Date: 03/31/2014  
Sampling Type: Soil  
Sampling Condition: Cool & Intact  
Sample Received By: Jodi Henson

**Sample ID: S-2 14' (H400961-02)**

BTEx 8021B			mg/kg		Analyzed By: MS					
Analyte	Result	Reporting Limit	Analyzed	Method Blank	BS	% Recovery	True Value QC	RPD	Qualifier	
Benzene*	<0.050	0.050	04/02/2014	ND	2.60	130	2.00	9.41		
Toluene*	<0.050	0.050	04/02/2014	ND	2.46	123	2.00	9.27		
Ethylbenzene*	<0.050	0.050	04/02/2014	ND	2.40	120	2.00	9.28		
Total Xylenes*	<0.150	0.150	04/02/2014	ND	6.84	114	6.00	9.37		
Total BTEx	<0.300	0.300	04/02/2014	ND						

Surrogate: 4-Bromofluorobenzene (PIE) 112 % 89.4-126

Chloride, SM4500Cl-B			mg/kg		Analyzed By: AP					
Analyte	Result	Reporting Limit	Analyzed	Method Blank	BS	% Recovery	True Value QC	RPD	Qualifier	
Chloride	64.0	16.0	04/02/2014	ND	432	108	400	0.00		

TPH 8015M			mg/kg		Analyzed By: ms					
Analyte	Result	Reporting Limit	Analyzed	Method Blank	BS	% Recovery	True Value QC	RPD	Qualifier	
GRO C6-C10	<10.0	10.0	04/02/2014	ND	208	104	200	5.39		
DRO >C10-C28	<10.0	10.0	04/02/2014	ND	217	109	200	2.49		

Surrogate: 1-Chlorooctane 107 % 65.2-140

Surrogate: 1-Chlorooctadecane 108 % 63.6-154

Cardinal Laboratories

\*=Accredited Analyte

PLEASE NOTE: Liability and Damages. Cardinal's liability and client's exclusive remedy for any claim arising, whether based in contract or tort, shall be limited to the amount paid by client for analyses. All claims, including those for negligence and any other cause whatsoever shall be deemed waived unless made in writing and received by Cardinal within thirty (30) days after completion of the applicable service. In no event shall Cardinal be liable for incidental or consequential damages, including, without limitation, business interruptions, loss of use, or loss of profits incurred by client, its subsidiaries, affiliates or successors arising out of or related to the performance of the services hereunder by Cardinal, regardless of whether such claim is based upon any of the above stated reasons or otherwise. Results relate only to the samples identified above. This report shall not be reproduced except in full with written approval of Cardinal Laboratories.

Celey D. Keene, Lab Director/Quality Manager



PHONE (575) 393-2326 • 101 E. MARLAND • HOBBS, NM 88240

**Analytical Results For:**

TALON LPE  
 SHELDON HITCHCOCK  
 408 W. TEXAS AVE.  
 ARTESIA NM, 88210  
 Fax To: (575) 745-8905

Received: 04/01/2014  
 Reported: 04/02/2014  
 Project Name: ANGEL DRAW #3  
 Project Number: NOT GIVEN  
 Project Location: NOT GIVEN

Sampling Date: 03/31/2014  
 Sampling Type: Soil  
 Sampling Condition: Cool & Intact  
 Sample Received By: Jodi Henson

**Sample ID: S-3 14' (H400961-03)**

BTEX 8021B			mg/kg		Analyzed By: MS				
Analyte	Result	Reporting Limit	Analyzed	Method Blank	BS	% Recovery	True Value QC	RPD	Qualifier
Benzene*	<0.050	0.050	04/02/2014	ND	2.60	130	2.00	9.41	
Toluene*	<0.050	0.050	04/02/2014	ND	2.46	123	2.00	9.27	
Ethylbenzene*	<0.050	0.050	04/02/2014	ND	2.40	120	2.00	9.28	
Total Xylenes*	<0.150	0.150	04/02/2014	ND	6.84	114	6.00	9.37	
Total BTEX	<0.300	0.300	04/02/2014	ND					

Surrogate: 4-Bromofluorobenzene (PID) 111 % 89.4-126

Chloride, SM4500Cl-B		mg/kg		Analyzed By: AP					
Analyte	Result	Reporting Limit	Analyzed	Method Blank	BS	% Recovery	True Value QC	RPD	Qualifier
Chloride	32.0	16.0	04/02/2014	ND	432	108	400	0.00	

TPH 8015M		mg/kg		Analyzed By: ms					
Analyte	Result	Reporting Limit	Analyzed	Method Blank	BS	% Recovery	True Value QC	RPD	Qualifier
GRO C6-C10	<10.0	10.0	04/02/2014	ND	208	104	200	5.39	
DRO >C10-C28	<10.0	10.0	04/02/2014	ND	217	109	200	2.49	

Surrogate: 1-Chlorooctane 107 % 65.2-140

Surrogate: 1-Chlorooctadecane 103 % 63.6-154

Cardinal Laboratories

\*=Accredited Analyte

PLEASE NOTE: Liability and Damages. Cardinal's liability and client's exclusive remedy for any claim arising, whether based in contract or tort, shall be limited to the amount paid by client for analyses. All claims, including those for negligence and any other cause whatsoever shall be deemed waived unless made in writing and received by Cardinal within thirty (30) days after completion of the applicable service. In no event shall Cardinal be liable for incidental or consequential damages, including, without limitation, business interruptions, loss of use, or loss of profits incurred by client, its subsidiaries, affiliates or successors arising out of or related to the performance of the services hereunder by Cardinal, regardless of whether such claim is based upon any of the above stated reasons or otherwise. Results relate only to the samples identified above. This report shall not be reproduced except in full with written approval of Cardinal Laboratories.

Celey D. Keene, Lab Director/Quality Manager



PHONE (575) 393-2326 • 101 E. MARLAND • HOBBS, NM 88240

**Analytical Results For:**

TALON LPE  
SHELDON HITCHCOCK  
408 W. TEXAS AVE.  
ARTESIA NM, 88210  
Fax To: (575) 745-8905

Received:	04/01/2014	Sampling Date:	03/31/2014
Reported:	04/02/2014	Sampling Type:	Soil
Project Name:	ANGEL DRAW #3	Sampling Condition:	Cool & Intact
Project Number:	NOT GIVEN	Sample Received By:	Jodi Henson
Project Location:	NOT GIVEN		

**Sample ID: S-4 14' (H400961-04)**

BTEx 8021B		mg/kg		Analyzed By: MS					
Analyte	Result	Reporting Limit	Analyzed	Method Blank	BS	% Recovery	True Value QC	RPD	Qualifier
Benzene*	<0.050	0.050	04/02/2014	ND	2.60	130	2.00	9.41	
Toluene*	<0.050	0.050	04/02/2014	ND	2.46	123	2.00	9.27	
Ethylbenzene*	<0.050	0.050	04/02/2014	ND	2.40	120	2.00	9.28	
Total Xylenes*	<0.150	0.150	04/02/2014	ND	6.84	114	6.00	9.37	
Total BTEx	<0.300	0.300	04/02/2014	ND					

Surrogate: 4-Bromofluorobenzene (PID) 111 % 89.4-126

Chloride, SM4500Cl-B		mg/kg		Analyzed By: AP					
Analyte	Result	Reporting Limit	Analyzed	Method Blank	BS	% Recovery	True Value QC	RPD	Qualifier
Chloride	<16.0	16.0	04/02/2014	ND	432	108	400	0.00	

TPH 8015M		mg/kg		Analyzed By: ms					
Analyte	Result	Reporting Limit	Analyzed	Method Blank	BS	% Recovery	True Value QC	RPD	Qualifier
GRO C6-C10	<10.0	10.0	04/02/2014	ND	208	104	200	5.39	
DRO >C10-C28	<10.0	10.0	04/02/2014	ND	217	109	200	2.49	

Surrogate: 1-Chlorooctane 98.1 % 65.2-140

Surrogate: 1-Chlorooctadecane 94.6 % 63.6-154

Cardinal Laboratories

\*=Accredited Analyte

PLEASE NOTE: Liability and Damages. Cardinal's liability and client's exclusive remedy for any claim arising, whether based in contract or tort, shall be limited to the amount paid by client for analyses. All claims, including those for negligence and any other cause whatsoever shall be deemed waived unless made in writing and received by Cardinal within thirty (30) days after completion of the applicable service. In no event shall Cardinal be liable for incidental or consequential damages, including, without limitation, business interruptions, loss of use, or loss of profits incurred by client, its subsidiaries, affiliates or successors arising out of or related to the performance of the services hereunder by Cardinal, regardless of whether such claim is based upon any of the above stated reasons or otherwise. Results relate only to the samples identified above. This report shall not be reproduced except in full with written approval of Cardinal Laboratories.

*Celey D. Keene*

Celey D. Keene, Lab Director/Quality Manager





PHONE (575) 393-2326 ° 101 E. MARLAND ° HOBBS, NM 88240

**Analytical Results For:**

TALON LPE  
 SHELDON HITCHCOCK  
 408 W. TEXAS AVE.  
 ARTESIA NM, 88210  
 Fax To: (575) 745-8905

Received: 04/01/2014  
 Reported: 04/02/2014  
 Project Name: ANGEL DRAW #3  
 Project Number: NOT GIVEN  
 Project Location: NOT GIVEN

Sampling Date: 03/31/2014  
 Sampling Type: Soil  
 Sampling Condition: Cool & Intact  
 Sample Received By: Jodi Henson

**Sample ID: S-5 14' (H400961-05)**

BTEX 8021B			mg/kg		Analyzed By: MS					
Analyte	Result	Reporting Limit	Analyzed	Method Blank	BS	% Recovery	True Value QC	RPD	Qualifier	
Benzene*	<0.050	0.050	04/02/2014	ND	2.60	130	2.00	9.41		
Toluene*	<0.050	0.050	04/02/2014	ND	2.46	123	2.00	9.27		
Ethylbenzene*	<0.050	0.050	04/02/2014	ND	2.40	120	2.00	9.28		
Total Xylenes*	<0.150	0.150	04/02/2014	ND	6.84	114	6.00	9.37		
Total BTEX	<0.300	0.300	04/02/2014	ND						

Surrogate: 4-Bromofluorobenzene (PID) 111 % 89.4-126

Chloride, SM4500Cl-B		mg/kg		Analyzed By: AP						
Analyte	Result	Reporting Limit	Analyzed	Method Blank	BS	% Recovery	True Value QC	RPD	Qualifier	
Chloride	<16.0	16.0	04/02/2014	ND	432	108	400	0.00		

TPH 8015M		mg/kg		Analyzed By: ms					
Analyte	Result	Reporting Limit	Analyzed	Method Blank	BS	% Recovery	True Value QC	RPD	Qualifier
GRO C6-C10	<10.0	10.0	04/02/2014	ND	208	104	200	5.39	
DRO >C10-C28	<10.0	10.0	04/02/2014	ND	217	109	200	2.49	

Surrogate: 1-Chlorooctane 97.5 % 65.2-140

Surrogate: 1-Chlorooctadecane 101 % 63.6-154

Cardinal Laboratories

\*=Accredited Analyte

PLEASE NOTE: Liability and Damages. Cardinal's liability and client's exclusive remedy for any claim arising, whether based in contract or tort, shall be limited to the amount paid by client for analyses. All claims, including those for negligence and any other cause whatsoever shall be deemed waived unless made in writing and received by Cardinal within thirty (30) days after completion of the applicable service. In no event shall Cardinal be liable for incidental or consequential damages, including, without limitation, business interruptions, loss of use, or loss of profits incurred by client, its subsidiaries, affiliates or successors arising out of or related to the performance of the services hereunder by Cardinal, regardless of whether such claim is based upon any of the above stated reasons or otherwise. Results relate only to the samples identified above. This report shall not be reproduced except in full with written approval of Cardinal Laboratories.

Celey D. Keene, Lab Director/Quality Manager



PHONE (575) 393-2326 ° 101 E. MARLAND ° HOBBS, NM 88240

### Notes and Definitions

- ND Analyte NOT DETECTED at or above the reporting limit
- RPD Relative Percent Difference
- \*\* Samples not received at proper temperature of 6°C or below.
- \*\*\* Insufficient time to reach temperature.
- Chloride by SM4500Cl-B does not require samples be received at or below 6°C  
Samples reported on an as received basis (wet) unless otherwise noted on report

Cardinal Laboratories

\*=Accredited Analyte

PLEASE NOTE: Liability and Damages. Cardinal's liability and client's exclusive remedy for any claim arising, whether based in contract or tort, shall be limited to the amount paid by client for analyses. All claims, including those for negligence and any other cause whatsoever shall be deemed waived unless made in writing and received by Cardinal within thirty (30) days after completion of the applicable service. In no event shall Cardinal be liable for incidental or consequential damages, including, without limitation, business interruptions, loss of use, or loss of profits incurred by client, its subsidiaries, affiliates or successors arising out of or related to the performance of the services hereunder by Cardinal, regardless of whether such claim is based upon any of the above stated reasons or otherwise. Results relate only to the samples identified above. This report shall not be reproduced except in full with written approval of Cardinal Laboratories.

Celey D. Keene, Lab Director/Quality Manager

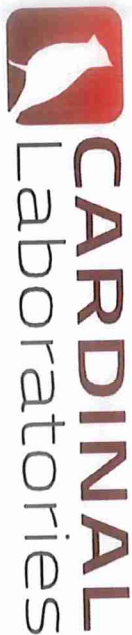

## CHAIN-OF-CUSTODY AND ANALYSIS REQUEST

**101 East Marland, Hobbs, NM 88240**  
**(575) 393-2326 FAX (575) 393-2476**

(575) 393-2326 FAX (575) 393-2476

BILL TO

ANALYSIS REQUEST

Company Name: Talon/LPE

P.O. #:

Project Manager: S. Hitchcock

Company: Talon/LPE

Address: 408 W. Texas Ave.

Attn:

City: Artesia

State: NM Zip: 88210

Phone #: 575-746-8768

Fax #: 575-746-8905

Project #:

Project Owner: Enterprise

Project Name: Angel Draw #3

City: State: Zip:

Project Location:

Phone #:

Sample Name: S. Hitchcock

Fax #:

FOR LAB USE ONLY

MATRIX

PRESERV

SAMPLING

Lab I.D. Sample I.D.

HUC0901

(G)RAB OR (C)OMP.

# CONTAINERS

GROUNDWATER

WASTEWATER

SOIL

OIL

SLUDGE

OTHER :

ACID/BASE:

ICE / COOL

OTHER :

DATE

TIME

TPH

BTEX

Chlorides

1 5-1 14'  
2 5-2 14'  
3 5-3 14'  
4 5-4 14'  
5 5-5 14'

3/31/14 2:45  
2:40  
2:50  
2:53  
3:06

PLEASE NOTE: Liability and Damages. Cardinal's liability and client's exclusive remedy for any claim arising whether based in contract or tort, shall be limited to the amount paid by the client for the analysis. All claims, including those for negligence and any other cause whatsoever shall be deemed waived unless made in writing and received by Cardinal within 30 days after completion of the applicable service. In no event shall Cardinal be liable for incidental or consequential damages, including without limitation, business interruptions, loss of use, or loss of profits incurred by client, its subsidiaries, affiliates or associates arising out of or related to the performance of services hereunder by Cardinal, regardless of whether such claim is based upon any of the above stated reasons or otherwise.

Relinquished By:

Date:

Received By:

Phone Result:

Fax Result:

Add'l Phone #:

Add'l Fax #:

REMARKS:

Relinquished By:

Date:

Received By:

Delivered By: (Circle One)

Sample Condition Cool Intact Yes No

CHECKED BY: (Initials)

Sampler - UPS - Bus - Other:

5.70

Cool Intact Yes No

CHECKED BY: (Initials)

PUSH!!

**District I**  
1625 N. French Dr., Hobbs, NM 88240  
Phone:(575) 393-6161 Fax:(575) 393-0720  
**District II**  
811 S. First St., Artesia, NM 88210  
Phone:(575) 748-1283 Fax:(575) 748-9720  
**District III**  
1000 Rio Brazos Rd., Aztec, NM 87410  
Phone:(505) 334-6178 Fax:(505) 334-6170  
**District IV**  
1220 S. St Francis Dr., Santa Fe, NM 87505  
Phone:(505) 476-3470 Fax:(505) 476-3462

State of New Mexico  
Energy, Minerals and Natural Resources  
Oil Conservation Division  
1220 S. St Francis Dr.  
Santa Fe, NM 87505

CONDITIONS  
  
Action 206681

CONDITIONS

Operator: ENTERPRISE PRODUCTS OPERATING, LLC P.O. BOX 4324 HOUSTON, TX 77210	OGRID: 374092
	Action Number: 206681
	Action Type: [IM-SD] Incident File Support Doc (ENV) (IM-BNF)

CONDITIONS

Created By	Condition	Condition Date
amaxwell	None	4/17/2023