



January 16, 2024

New Mexico Oil Conservation Division
1220 South St. Francis Drive
Santa Fe, New Mexico 87505

**Re: Closure Request
Toque State Com
Incident Number NRM2005655333
Lea County, New Mexico**

To Whom It May Concern:

Ensolum, LLC (Ensolum), on behalf of Matador Production Company (Matador), has prepared this *Closure Request* to document assessment and soil sampling activities performed at the Toque State Com (Site) in Unit K, Section 6, Township 21 South, Range 33 East, in Lea County, New Mexico (Figure 1). The purpose of the Site assessment and soil sampling activities was to assess for the presence or absence of impacts to soil resulting from the release of ignited hydrocarbons from a flare at the Site. Based on field observations, field screening activities, and laboratory analytical results, Matador is submitting this *Closure Request* and requesting closure for Incident Number NRM2005655333.

SITE DESCRIPTION AND RELEASE SUMMARY

The Site is located in Lea County, New Mexico (32.507500°, -103.61500°) and is associated with oil and gas exploration and production operations on New Mexico State Trust Land (STL) managed by the New Mexico State Land Office (NMSLO).

On February 19, 2020, Ascent Energy personnel (the previous operator of the Site) discovered the release which was the result of a flare stack fire and the ignition of ejected hydrocarbons. The fire burned a small area on-pad and consumed a nearby forklift. Ascent Energy reported the release to the New Mexico Oil Conservation Division (NMOCD) on a Release Notification Form C-141 (Form C-141) on February 21, 2020. The release was assigned Incident Number NRM2005655333. Ascent Energy completed an initial scrape of the release area and removed the northern edge of the caliche pad.

SITE CHARACTERIZATION AND CLOSURE CRITERIA

The Site was characterized to assess applicability of Table I, Closure Criteria for Soils Impacted by a Release, of Title 19, Chapter 15, Part 29 (19.15.29) of the New Mexico Administrative Code (NMAC). Results from the characterization desktop review are presented on page 3 of the Form C-141, Site Assessment/Characterization, initial Form C-141, submitted by Ascent Energy, is included and can be referenced in Appendix A. An updated Form C-141 can be referenced within the NMOCD Incident Portal. Potential Site receptors are identified on Figure 1.

According to the New Mexico Office of the State Engineer (NMOSE), the closest permitted groundwater well with depth to groundwater data is C 01884 POD1, located approximately 1.3 miles southwest of the Site. The well had a reported depth to groundwater of greater than 55 feet below ground surface (bgs) and a total depth of 55 feet bgs. There are no regional or Site-specific hydrogeological conditions, such

as shallow surface water, karst features, wetlands, or vegetation to suggest the Site is conducive to shallow groundwater. All wells used for depth to groundwater determination are presented on Figure 1. The referenced well record is included in Appendix B.

The closest continuously flowing or significant watercourse to the Site is a freshwater emergent wetland, located approximately 1.1 miles southeast of the Site. The Site is greater than 200 feet from a lakebed, sinkhole, or playa lake and greater than 300 feet from an occupied residence, school, hospital, institution, church, or wetland. The Site is greater than 1,000 feet to a freshwater well or spring and is not within a 100-year floodplain or overlying a subsurface mine. The Site is not underlain by unstable geology (low potential karst designation area). Site receptors are identified on Figure 1.

Based on the results of the Site Characterization, the following NMOCD Table I Closure Criteria (Closure Criteria) apply:

- Benzene: 10 milligrams per kilogram (mg/kg)
- Benzene, toluene, ethylbenzene, and total xylenes (BTEX): 50 mg/kg
- Total petroleum hydrocarbons (TPH): 100 mg/kg
- Chloride: 600 mg/kg

SITE ASSESSMENT ACTIVITIES

On December 12, 2023, Site assessment activities were conducted to evaluate the release extent based on information provided on the Form C-141 and visual observations. Ensolum personnel collected four delineation soil samples (SS01 through SS04) at ground surface to verify the lateral release extent. One borehole (BH01) was completed to a depth of 1-foot bgs in the vicinity of the flare stack and one borehole (BH02) was completed to a depth of 1-foot bgs inside the release area via hand auger to verify the vertical extent.

On December 21, 2023, Ensolum personnel returned to the Site to complete delineation sampling. Three additional lateral delineation samples were collected (SS01A, SS04A, and SS05). SS01A and SS04A were collected closer in proximity to the release extent and in the vicinity of the original lateral sample locations (SS01 and SS04). Soil from the delineation samples was field screened for chloride using Hach® chloride QuanTab® test strips. The release extent and delineation soil sample locations are depicted on Figure 2. Lithologic Soil Sample Logs from boreholes BH01 and BH02 are included in Appendix C. Photographs were taken during soil sampling activities and a photographic log is included in Appendix D.

All soil samples were placed directly into pre-cleaned glass jars, labeled with the location, date, time, sampler name, method of analysis, and immediately placed on ice. The soil samples were transported under strict chain-of-custody procedures to Envirotech Analytical Laboratory (Envirotech) in Farmington, New Mexico, for analysis of the following chemicals of concern (COCs): BTEX following United States Environmental Protection Agency (EPA) Method 8021B; TPH-gasoline range organics (GRO), TPH-diesel range organics (DRO), and TPH-oil range organics (ORO) following EPA Method 8015M/D; and chloride following EPA Method 300.0.

Since the release remained on pad, an assessment of cultural properties had already been completed prior to the construction of the well pad and as such, the Cultural Properties Protection Rule (CPP) has been followed. No additional cultural resource surveys were completed in connection with this release.

LABORATORY ANALYTICAL RESULTS

Laboratory analytical results for lateral delineation soil samples (SS01 through SS04), SS01A, SS04A, and SS05, collected at ground surface, and vertical delineation soil samples, collected at depths ranging from ground surface to 1-foot bgs, were all in compliance with the strictest Closure Criteria per NMOCD Table I. Laboratory analytical results are summarized in Table 1 and the complete laboratory analytical report is included as Appendix E.

CONFIRMATION SOIL SAMPLING ACTIVITIES

On December 21, 2023, Ensolum personnel conducted confirmation soil sampling activities at the Site. Six confirmation samples (FS01 through FS06) were collected at ground surface and field screened for TPH utilizing a calibrated PetroFLAG® soil analyzer system and chloride using Hach® chloride QuanTab® test strips. All soil samples were collected, handled, and analyzed following the same procedures as described above. The confirmation soil sample locations are depicted on Figure 3.

LABORATORY ANALYTICAL RESULTS

Laboratory analytical results for confirmation soil samples (FS01 through FS06), collected within the release area and at ground surface, were compliant with the strictest Closure Criteria per NMOCD Table I. Laboratory analytical results are summarized in Table 1 and the complete laboratory analytical report is included as Appendix E.

CLOSURE REQUEST

Following the delineation sampling and confirmation sampling activities completed at the Site, it was determined the release’s lateral extent was defined by delineation samples (SS01 through SS04), SS01A and SS04A and the vertical extent was defined by delineation boreholes BH01 and BH02. Based on initial response efforts, laboratory analytical results for lateral and vertical delineation soil samples (SS01 through SS04, SS01A, SS04A and BH01 through BH02), and a lack of visual evidence it has been determined COC impacts to soil are not present at the Site. In addition, waste-containing soil was not documented and as such, reclamation is not required for this release. The Reclamation Plan for this release will default to the NMSLO-approved Reclamation Plan for the well pad per 19.2.100.67 NMAC. Actions completed to-date have been protective of human health, the environment, and groundwater. As such, Matador respectfully requests closure for Incident Number NRM2005655333.

If you have any questions or comments, please contact Ms. Ashley Giovengo at (575) 988-0055 or agiovengo@ensolum.com.

Sincerely,
Ensolum, LLC

Chad Hamilton
Staff Geologist

Daniel R. Moir, PG
Senior Managing Geologist

cc: Clinton Talley, Matador
NMSLO

Appendices:

- Figure 1 Site Receptor Map
- Figure 2 Delineation Soil Sample Locations
- Figure 3 Confirmation Sample Locations
- Table 1 Soil Sample Analytical Results
- Appendix A Form C-141
- Appendix B Well Record
- Appendix C Lithologic Soil Sampling Logs
- Appendix D Photographic Log
- Appendix E Laboratory Analytical Reports & Chain-of-Custody Documentation
- Appendix F NMOCD Correspondence



FIGURES

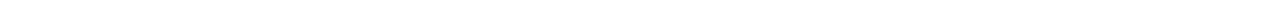

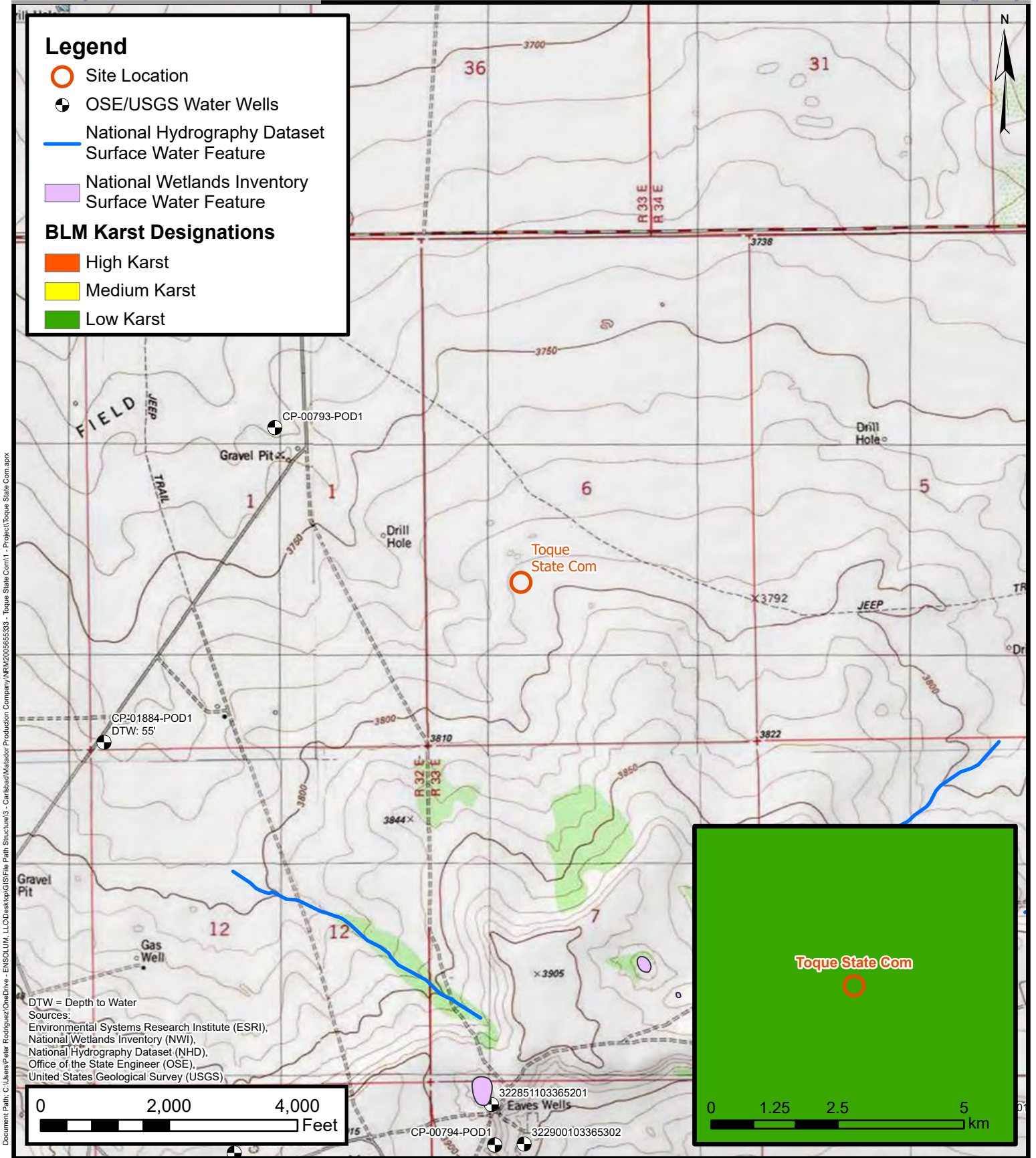

Document Path: C:\Users\Peter.Rodriguez\OneDrive - ENSOLUM, L.L.C\Desktop\GIS\File Path Structure\3 - Canbad\Matador Production Company\NRM2005655333 - Toque State Com\1 - Project\Toque State Com.aprx



Site Receptor Map

Matador Production Company
 Toque State Com
 Incident Number: NRM2005655333
 Unit K, Section 6, T 21S, R 33E
 Lea County, New Mexico

FIGURE
1

Legend

- Delineation Soil Sample
Complaint with Site
Closure Criteria
- Release Extent

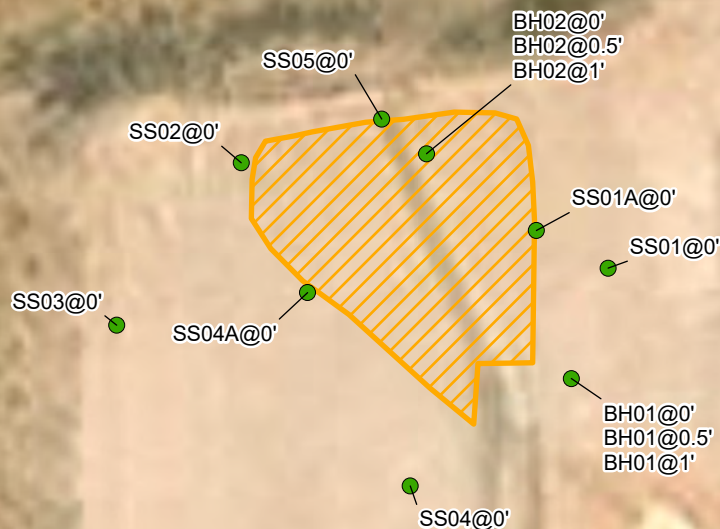

Notes:
Sample ID @ Depth Below Ground Surface

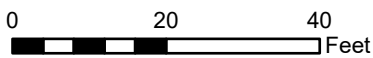

Source:
Environmental Systems Research Institute (ESRI)



Delineation Soil Sample Locations

Matador Production Company
Toque State Com
Incident Number: NRM2005655333
Unit K, Section 6, T 21S, R 33E
Lea County, New Mexico

FIGURE
2

Legend

- Confirmation Soil Sample Complaint with Site Closure Criteria
- Release Extent

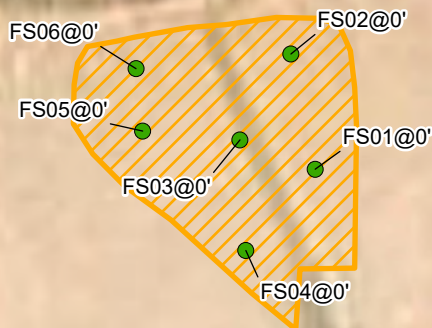

Notes:
Sample ID @ Depth Below Ground Surface

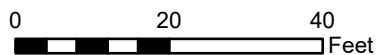

Source:
Environmental Systems Research Institute (ESRI)



Confirmation Soil Sample Locations

Matador Production Company
Toque State Com
Incident Number: NRM2005655333
Unit K, Section 6, T 21S, R 33E
Lea County, New Mexico

FIGURE
3

Document Path: C:\Users\Peter.Rodriguez\OneDrive - ENSOLUM, LLC\Desktop\GIS\File Path Structure\3 - Carlsbad\Matador Production Company\03A2270017 - Toque State Com\1 - Project\Toque State Com.aprx



TABLES



TABLE 1
SOIL SAMPLE ANALYTICAL RESULTS
 Toque State Com
 Matador Production Company
 Lea County, New Mexico

Sample Designation	Date	Depth (feet bgs)	Benzene (mg/kg)	Total BTEX (mg/kg)	TPH GRO (mg/kg)	TPH DRO (mg/kg)	TPH ORO (mg/kg)	GRO+DRO (mg/kg)	Total TPH (mg/kg)	Chloride (mg/kg)
NMOCD Table I Closure Criteria (NMAC 19.15.29)			10	50	NE	NE	NE	NE	100	600
Delineation Soil Samples										
SS01	12/12/2023	0	<0.0250	<0.0250	<20.0	<25.0	<50.0	<25.0	<25.0	<20.0
SS01A	12/21/2023	0	<0.0250	<0.0250	<20.0	<25.0	<50.0	<25.0	<25.0	520
SS02	12/12/2023	0	<0.0250	<0.0250	<20.0	<25.0	<50.0	<25.0	<25.0	<20.0
SS03	12/12/2023	0	<0.0250	<0.0250	<20.0	<25.0	<50.0	<25.0	<25.0	39.9
SS04	12/12/2023	0	<0.0250	<0.0250	<20.0	37.3	<50.0	37.3	37.3	<20.0
SS04A	12/21/2023	0	<0.0250	<0.0250	<20.0	<25.0	<50.0	<25.0	<25.0	<20.0
SS05	12/21/2023	0	<0.0250	<0.0250	<20.0	<25.0	<50.0	<25.0	<25.0	<20.0
BH01	12/12/2023	0	<0.0250	<0.0250	<20.0	<25.0	<50.0	<25.0	<25.0	205
BH01	12/12/2023	0.5	<0.0250	<0.0250	<20.0	<25.0	<50.0	<25.0	<25.0	39.6
BH01	12/12/2023	1	<0.0250	<0.0250	<20.0	<25.0	<50.0	<25.0	<25.0	<20.0
BH02	12/12/2023	0	<0.0250	<0.0250	<20.0	<25.0	<50.0	<25.0	<25.0	<20.0
BH02	12/12/2023	0.5	<0.0250	<0.0250	<20.0	<25.0	<50.0	<25.0	<25.0	<20.0
BH02	12/12/2023	1	<0.0250	<0.0250	<20.0	<25.0	<50.0	<25.0	<25.0	<20.0
Excavation Floor Soil Samples										
FS01	12/21/2023	0	<0.0250	<0.0250	<20.0	<25.0	<50.0	<25.0	<25.0	<20.0
FS02	12/21/2023	0	<0.0250	<0.0250	<20.0	<25.0	<50.0	<25.0	<25.0	77.0
FS03	12/21/2023	0	<0.0250	<0.0250	<20.0	<25.0	<50.0	<25.0	<25.0	37.6
FS04	12/21/2023	0	<0.0250	<0.0250	<20.0	<25.0	<50.0	<25.0	<25.0	42.7
FS05	12/21/2023	0	<0.0250	<0.0250	<20.0	<25.0	<50.0	<25.0	<25.0	<20.0
FS06	12/21/2023	0	<0.0250	<0.0250	<20.0	<25.0	<50.0	<25.0	<25.0	<20.0

Notes:

bgs: below ground surface

mg/kg: milligrams per kilogram

NMOCD: New Mexico Oil Conservation Division

NMAC: New Mexico Administrative Code

Grey text represents samples that have been excavated

"<": Laboratory Analytical result is less than reporting limit

Concentrations in **bold** exceed the NMOCD Table I Closure Criteria or reclamation standard where applicable.

* Indicates sample was collected in area to be reclaimed after remediation is complete; reclamation for chloride in the top 4 feet is 600 mg/kg and total TPH is 100 mg/kg.

GRO: Gasoline Range Organics

DRO: Diesel Range Organics

ORO: Oil Range Organics

TPH: Total Petroleum Hydrocarbon

BTEX: Benzene, Toluene, Ethylbenzene, and Xylenes



APPENDIX A

Form C-141

District I
1625 N. French Dr., Hobbs, NM 88240
District II
811 S. First St., Artesia, NM 88210
District III
1000 Rio Brazos Road, Aztec, NM 87410
District IV
1220 S. St. Francis Dr., Santa Fe, NM 87505

State of New Mexico
Energy Minerals and Natural
Resources Department

Oil Conservation Division
1220 South St. Francis Dr.
Santa Fe, NM 87505

Form C-141
Revised August 24, 2018
Submit to appropriate OCD District office

Incident ID	NRM2005655333
District RP	
Facility ID	
Application ID	

Release Notification

Responsible Party

Responsible Party	Ascent Energy	OGRID	325830
Contact Name	Alex Yancey	Contact Telephone	720-710-8984
Contact email	ayancey@ascentenergy.us	Incident #	(assigned by OCD)
Contact mailing address	1125 17 th Suite 410 Denver, CO 80202		

Location of Release Source

Latitude 32.507500° N Longitude -103.61500° W
(NAD 83 in decimal degrees to 5 decimal places)

Site Name	Toque State Com	Site Type	Facilities Location
Date Release Discovered	2-19-2020	API#	(if applicable)

Unit Letter	Section	Township	Range	County
K	6	21S	33E	Lea

Surface Owner: State Federal Tribal Private (Name: _____)

Nature and Volume of Release

Material(s) Released (Select all that apply and attach calculations or specific justification for the volumes provided below)

<input type="checkbox"/> Crude Oil	Volume Released (bbls)	Volume Recovered (bbls)
<input type="checkbox"/> Produced Water	Volume Released (bbls)	Volume Recovered (bbls)
	Is the concentration of dissolved chloride in the produced water >10,000 mg/l?	<input type="checkbox"/> Yes <input type="checkbox"/> No
<input type="checkbox"/> Condensate	Volume Released (bbls)	Volume Recovered (bbls)
<input type="checkbox"/> Natural Gas	Volume Released (Mcf)	Volume Recovered (Mcf)
<input checked="" type="checkbox"/> Other (describe)	Volume/Weight Released (provide units)	Volume/Weight Recovered (provide units)

Cause of Release

Ignited hydrocarbon release from flare burning caliche and nearby forklift.

State of New Mexico
Oil Conservation Division

Incident ID	NRM2005655333
District RP	
Facility ID	
Application ID	

Was this a major release as defined by 19.15.29.7(A) NMAC? <input type="checkbox"/> Yes <input checked="" type="checkbox"/> No	If YES, for what reason(s) does the responsible party consider this a major release?
If YES, was immediate notice given to the OCD? By whom? To whom? When and by what means (phone, email, etc)?	

Initial Response

The responsible party must undertake the following actions immediately unless they could create a safety hazard that would result in injury

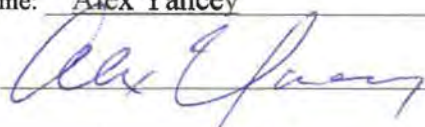
<input checked="" type="checkbox"/> The source of the release has been stopped. <input checked="" type="checkbox"/> The impacted area has been secured to protect human health and the environment. <input type="checkbox"/> Released materials have been contained via the use of berms or dikes, absorbent pads, or other containment devices. <input checked="" type="checkbox"/> All free liquids and recoverable materials have been removed and managed appropriately.
If all the actions described above have <u>not</u> been undertaken, explain why: The fire from the flare was immediately extinguished and effected area did not leave location. Berms, dikes and absorbent pad were not applicable. Forklift and burned caliche were removed from location. Additional caliche was added to pad.
Per 19.15.29.8 B. (4) NMAC the responsible party may commence remediation immediately after discovery of a release. If remediation has begun, please attach a narrative of actions to date. If remedial efforts have been successfully completed or if the release occurred within a lined containment area (see 19.15.29.11(A)(5)(a) NMAC), please attach all information needed for closure evaluation.
I hereby certify that the information given above is true and complete to the best of my knowledge and understand that pursuant to OCD rules and regulations all operators are required to report and/or file certain release notifications and perform corrective actions for releases which may endanger public health or the environment. The acceptance of a C-141 report by the OCD does not relieve the operator of liability should their operations have failed to adequately investigate and remediate contamination that pose a threat to groundwater, surface water, human health or the environment. In addition, OCD acceptance of a C-141 report does not relieve the operator of responsibility for compliance with any other federal, state, or local laws and/or regulations.
Printed Name: <u>Alex Yancey</u> Title: <u>Vice President Engineering</u> Signature:  Date: <u>2-21-2020</u> email: <u>ayancey@ascentenergy.us</u> Telephone: <u>720-710-8984</u>
OCD Only Received by: _____ Date: _____

Incident ID	NRM2005655333
District RP	
Facility ID	
Application ID	

Site Assessment/Characterization

This information must be provided to the appropriate district office no later than 90 days after the release discovery date.

What is the shallowest depth to groundwater beneath the area affected by the release?	<u>55</u> (ft bgs)
Did this release impact groundwater or surface water?	<input type="checkbox"/> Yes <input checked="" type="checkbox"/> No
Are the lateral extents of the release within 300 feet of a continuously flowing watercourse or any other significant watercourse?	<input type="checkbox"/> Yes <input checked="" type="checkbox"/> No
Are the lateral extents of the release within 200 feet of any lakebed, sinkhole, or playa lake (measured from the ordinary high-water mark)?	<input type="checkbox"/> Yes <input checked="" type="checkbox"/> No
Are the lateral extents of the release within 300 feet of an occupied permanent residence, school, hospital, institution, or church?	<input type="checkbox"/> Yes <input checked="" type="checkbox"/> No
Are the lateral extents of the release within 500 horizontal feet of a spring or a private domestic fresh water well used by less than five households for domestic or stock watering purposes?	<input type="checkbox"/> Yes <input checked="" type="checkbox"/> No
Are the lateral extents of the release within 1000 feet of any other fresh water well or spring?	<input type="checkbox"/> Yes <input checked="" type="checkbox"/> No
Are the lateral extents of the release within incorporated municipal boundaries or within a defined municipal fresh water well field?	<input type="checkbox"/> Yes <input checked="" type="checkbox"/> No
Are the lateral extents of the release within 300 feet of a wetland?	<input type="checkbox"/> Yes <input checked="" type="checkbox"/> No
Are the lateral extents of the release overlying a subsurface mine?	<input type="checkbox"/> Yes <input checked="" type="checkbox"/> No
Are the lateral extents of the release overlying an unstable area such as karst geology?	<input type="checkbox"/> Yes <input checked="" type="checkbox"/> No
Are the lateral extents of the release within a 100-year floodplain?	<input type="checkbox"/> Yes <input checked="" type="checkbox"/> No
Did the release impact areas not on an exploration, development, production, or storage site?	<input type="checkbox"/> Yes <input checked="" type="checkbox"/> No

Attach a comprehensive report (electronic submittals in .pdf format are preferred) demonstrating the lateral and vertical extents of soil contamination associated with the release have been determined. Refer to 19.15.29.11 NMAC for specifics.

Characterization Report Checklist: *Each of the following items must be included in the report.*

- Scaled site map showing impacted area, surface features, subsurface features, delineation points, and monitoring wells.
- Field data
- Data table of soil contaminant concentration data
- Depth to water determination
- Determination of water sources and significant watercourses within 1/2-mile of the lateral extents of the release
- Boring or excavation logs
- Photographs including date and GIS information
- Topographic/Aerial maps
- Laboratory data including chain of custody

If the site characterization report does not include completed efforts at remediation of the release, the report must include a proposed remediation plan. That plan must include the estimated volume of material to be remediated, the proposed remediation technique, proposed sampling plan and methods, anticipated timelines for beginning and completing the remediation. The closure criteria for a release are contained in Table 1 of 19.15.29.12 NMAC, however, use of the table is modified by site- and release-specific parameters.

State of New Mexico
Oil Conservation Division

Page 4

Incident ID	NRM2005655333
District RP	
Facility ID	
Application ID	

I hereby certify that the information given above is true and complete to the best of my knowledge and understand that pursuant to OCD rules and regulations all operators are required to report and/or file certain release notifications and perform corrective actions for releases which may endanger public health or the environment. The acceptance of a C-141 report by the OCD does not relieve the operator of liability should their operations have failed to adequately investigate and remediate contamination that pose a threat to groundwater, surface water, human health or the environment. In addition, OCD acceptance of a C-141 report does not relieve the operator of responsibility for compliance with any other federal, state, or local laws and/or regulations.

Printed Name: Clint Talley

Title: EHS Supervisor

Signature: *Clint Talley*

Date: 08/02/2023

email: Clinton.talley@matadorresources.com

Telephone: 337-319-8398

OCD Only

Received by: _____

Date: _____

Incident ID	NRM2005655333
District RP	
Facility ID	
Application ID	

Closure

The responsible party must attach information demonstrating they have complied with all applicable closure requirements and any conditions or directives of the OCD. This demonstration should be in the form of a comprehensive report (electronic submittals in .pdf format are preferred) including a scaled site map, sampling diagrams, relevant field notes, photographs of any excavation prior to backfilling, laboratory data including chain of custody documents of final sampling, and a narrative of the remedial activities. Refer to 19.15.29.12 NMAC.

Closure Report Attachment Checklist: *Each of the following items must be included in the closure report.*

- A scaled site and sampling diagram as described in 19.15.29.11 NMAC
- Photographs of the remediated site prior to backfill or photos of the liner integrity if applicable (Note: appropriate OCD District office must be notified 2 days prior to liner inspection)
- Laboratory analyses of final sampling (Note: appropriate ODC District office must be notified 2 days prior to final sampling)
- Description of remediation activities

I hereby certify that the information given above is true and complete to the best of my knowledge and understand that pursuant to OCD rules and regulations all operators are required to report and/or file certain release notifications and perform corrective actions for releases which may endanger public health or the environment. The acceptance of a C-141 report by the OCD does not relieve the operator of liability should their operations have failed to adequately investigate and remediate contamination that pose a threat to groundwater, surface water, human health or the environment. In addition, OCD acceptance of a C-141 report does not relieve the operator of responsibility for compliance with any other federal, state, or local laws and/or regulations. The responsible party acknowledges they must substantially restore, reclaim, and re-vegetate the impacted surface area to the conditions that existed prior to the release or their final land use in accordance with 19.15.29.13 NMAC including notification to the OCD when reclamation and re-vegetation are complete.

Printed Name: Clint Talley

Title: EHS Supervisor

Signature: *Clint Talley*

Date: 08/02/2023

email: Clinton.talley@matadorresources.com

Telephone: 337-319-8398

OCD Only

Received by: _____

Date: _____

Closure approval by the OCD does not relieve the responsible party of liability should their operations have failed to adequately investigate and remediate contamination that poses a threat to groundwater, surface water, human health, or the environment nor does not relieve the responsible party of compliance with any other federal, state, or local laws and/or regulations.

Closure Approved by: _____ Date: _____

Printed Name: _____

Title: _____



APPENDIX B

Referenced Wells

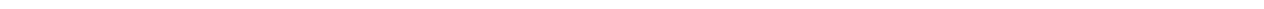



New Mexico Office of the State Engineer

Point of Diversion Summary

(quarters are 1=NW 2=NE 3=SW 4=SE)

(quarters are smallest to largest)

(NAD83 UTM in meters)

Well Tag	POD Number	Q64 Q16 Q4	Sec	Tws	Rng	X	Y
NA	CP 01884 POD1	3 3 3	01	21S	32E	628121	3596776

Driller License: 1249 **Driller Company:** ATKINS ENGINEERING ASSOC. INC.

Driller Name: ATKINS, JACKIE D.UELENER

Drill Start Date: 09/08/2021 **Drill Finish Date:** 09/08/2021 **Plug Date:** 09/15/2021

Log File Date: 09/28/2021 **PCW Rcv Date:** **Source:**

Pump Type: **Pipe Discharge Size:** **Estimated Yield:**

Casing Size: **Depth Well:** 55 feet **Depth Water:**

The data is furnished by the NMOSE/ISC and is accepted by the recipient with the expressed understanding that the OSE/ISC make no warranties, expressed or implied, concerning the accuracy, completeness, reliability, usability, or suitability for any particular purpose of the data.



APPENDIX C

Lithologic Soil Sampling Logs

					Sample Name: BH01		Date: 12/12/2023	
					Site Name: Toque State Com			
					Incident Number: NRM2005655333			
					Job Number: 03A2270017			
LITHOLOGIC / SOIL SAMPLING LOG					Logged By: Ethan Haft		Method: Hand Auger	
Coordinates: 32.5078486, -103.6151594					Hole Diameter: 3"		Total Depth: 1ft BGS	
Comments: Field screening conducted with HACH Chloride Test Strips. Chloride test performed with 1:4 dilution factor of soil to distilled water. No correction factors included.								
Moisture Content	Chloride (ppm)	TPH (ppm)	Staining	Sample ID	Sample Depth (ft bgs)	Depth (ft bgs)	USCS/Rock Symbol	Lithologic Descriptions
D	250	NA	N	BH01-0	0	0	GP	Pad caliche. Poorly sorted, limestone pebbles. Gravelly white to buff tan.
D	ND	NA	N	BH01-0.5	0.5	0.5	GP-GM	Pad caliche and dark brown clay, moderate sorting, Limestone pebbles.
M	ND	NA	N	BH01-1	1	1	SC	Dark brown clay, well sorted, moist. Some limestone gravel.
Total Depth @ 1 ft bgs.								

					Sample Name: BH02		Date: 12/12/2023	
					Site Name: Toque State Com			
					Incident Number: NRM2005655333			
					Job Number: 03A2270017			
LITHOLOGIC / SOIL SAMPLING LOG					Logged By: Ethan Haft		Method: Hand Auger	
Coordinates: 32.5079301, -103.6152191					Hole Diameter: 3"		Total Depth: 1ft BGS	
Comments: Field screening conducted with HACH Chloride Test Strips. Chloride test performed with 1:4 dilution factor of soil to distilled water. No correction factors included.								
Moisture Content	Chloride (ppm)	TPH (ppm)	Staining	Sample ID	Sample Depth (ft bgs)	Depth (ft bgs)	USCS/Rock Symbol	Lithologic Descriptions
D	ND	NA	N	BH02-0	0	0	GP	Pad caliche. Poorly sorted, limestone pebbles. Gravelly white to buff tan.
D	ND	NA	N	BH02-0.5	0.5	0.5	GP-GM	Pad caliche and dark brown clay, moderate sorting Limestone pebbles.
M	ND	NA	N	BH02-1	1	1	SC	Dark brown clay, well sorted, moist. Some limestone gravel.
Total Depth @ 1 ft bgs.								



APPENDIX D

Photographic Log

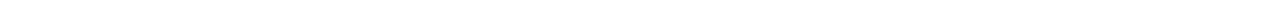



Photographic Log
Matador Production Company
Toque State Com
NRM2005655333



Photograph 1 Date: 12/21/2023
Description: Lease Signage
View: East



Photograph 2 Date: 12/01/2023
Description: Release Area
View: East



Photograph 3 Date: 12/01/2023
Description: Release Area
View: Southeast



Photograph 4 Date: 12/01/2023
Description: Release Area
View: Northeast



Photographic Log
Matador Production Company
Toque State Com
NRM2005655333

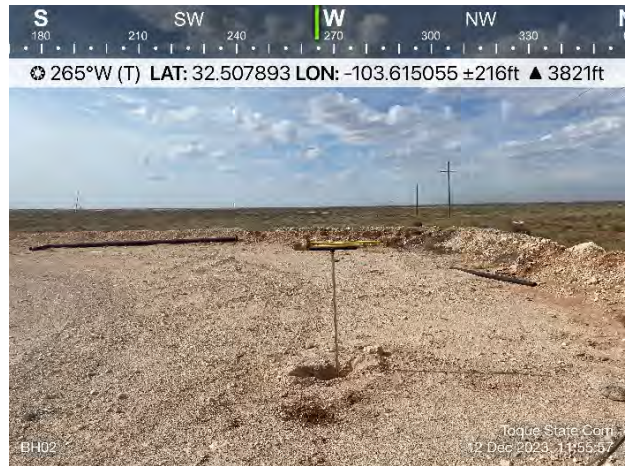

Photograph 5 Date: 12/01/2023
Description: Release Area
View: Southeast

Photograph 6 Date: 12/12/2023
Description: Vertical Delineation
View: West

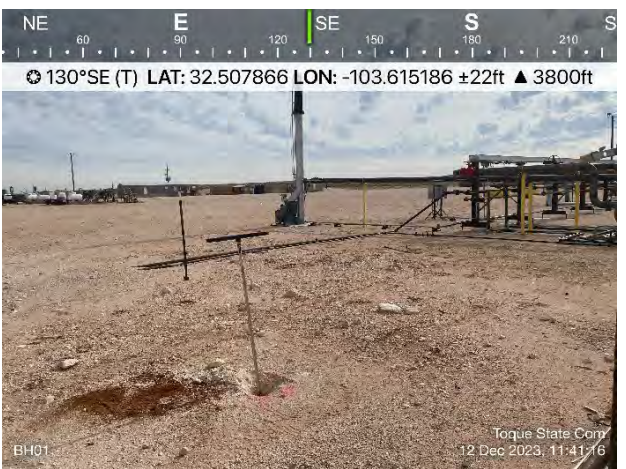
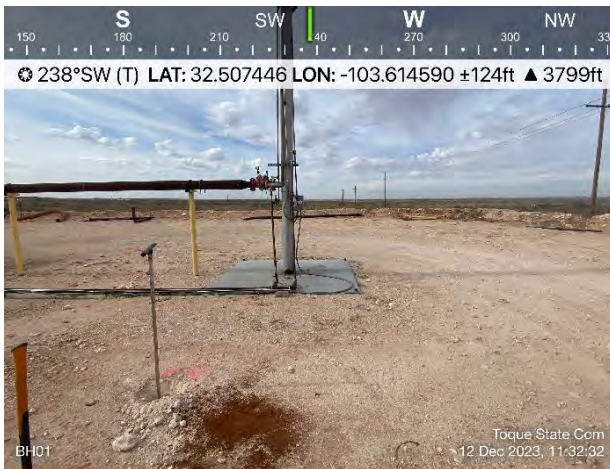

Photograph 7 Date: 12/12/2023
Description: Vertical Delineation
View: Southwest

Photograph 8 Date: 12/12/2023
Description: Vertical Delineation
View: Southeast



Photographic Log
Matador Production Company
Toque State Com
NRM2005655333

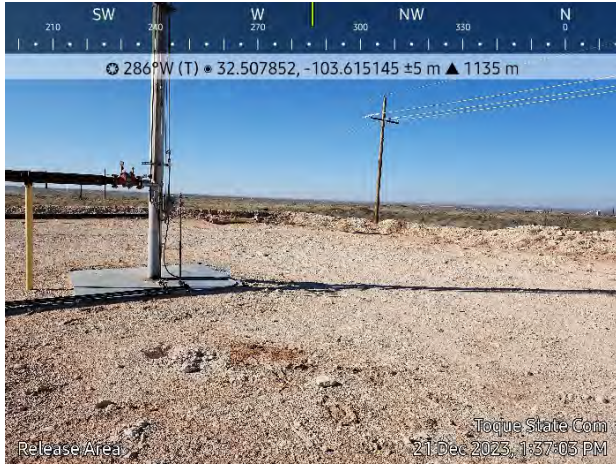

Photograph 9 Date: 12/21/2023
Description: Confirmation Sampling
View: West

Photograph 10 Date: 12/21/2023
Description: Confirmation Sampling
View: West



Photograph 11 Date: 12/21/2023
Description: Confirmation Sampling
View: Southeast

Photograph 12 Date: 12/21/2023
Description: Confirmation Sampling
View: Southeast



APPENDIX E

Laboratory Analytical Reports & Chain-of-Custody Documentation

Report to:
Ashley Giovengo

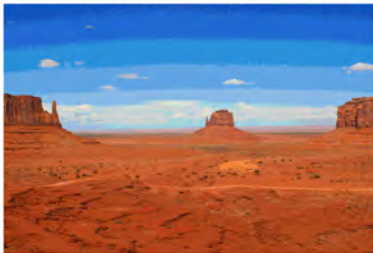

envirotech

Practical Solutions for a Better Tomorrow

Analytical Report

Matador Resources, LLC.

Project Name: Toque State Com

Work Order: E312098

Job Number: 23052-0001

Received: 12/14/2023

Revision: 1

Report Reviewed By:

Walter Hinchman
Laboratory Director
12/20/23

5796 U.S. Hwy 64
Farmington, NM 87401

Phone: (505) 632-1881
Envirotech-inc.com



Envirotech Inc. certifies the test results meet all requirements of TNI unless noted otherwise.
Statement of Data Authenticity: Envirotech Inc, attests the data reported has not been altered in any way.
Partial or incomplete reproduction of this report is prohibited, unless approved by Envirotech Inc.
Envirotech Inc, holds the Utah TNI certification NM00979 for data reported.
Envirotech Inc, holds the Texas TNI certification T104704557 for data reported.



Date Reported: 12/20/23

Ashley Giovengo
5400 LBJ Freeway, Suite 1500
Dallas, TX 75240

Project Name: Toque State Com
Workorder: E312098
Date Received: 12/14/2023 8:30:00AM

Ashley Giovengo,

Thank you for choosing Envirotech, Inc. as your analytical testing laboratory for the sample(s) received on, 12/14/2023 8:30:00AM, under the Project Name: Toque State Com.

The analytical test results summarized in this report with the Project Name: Toque State Com apply to the individual samples collected, identified and submitted bearing the project name on the enclosed chain-of-custody. Subcontracted sample analyses not conducted by Envirotech, Inc., are attached in full as issued by the subcontract laboratory.

Please review the Chain-of-Custody (COC) and Sample Receipt Checklist (SRC) for any issues regarding sample receipt temperature, containers, preservation etc. To best understand your test results, review the entire report summarizing your sample data and the associated quality control batch data.

All reported data in this analytical report were analyzed according to the referenced method(s) and are in compliance with the latest NELAC/TNI standards, unless otherwise noted. Samples or analytical quality control parameters not meeting specific QC criteria are qualified with a data flag. Data flag definitions are located in the Notes and Definitions section of this analytical report.

If you have any questions concerning this report, please feel free to contact Envirotech, Inc.

Respectfully,

Walter Hinchman
Laboratory Director
Office: 505-632-1881
Cell: 775-287-1762
whinchman@envirotech-inc.com

Raina Schwanz
Laboratory Administrator
Office: 505-632-1881
rainaschwanz@envirotech-inc.com

Alexa Michaels
Sample Custody Officer
Office: 505-632-1881
labadmin@envirotech-inc.com

Field Offices:

Southern New Mexico Area

Lynn Jarboe
Laboratory Technical Representative
Office: 505-421-LABS(5227)
Cell: 505-320-4759
ljjarboe@envirotech-inc.com

Michelle Golzales
Client Representative
Office: 505-421-LABS(5227)
Cell: 505-947-8222
mgonzales@envirotech-inc.com

Envirotech Web Address: www.envirotech-inc.com

Table of Contents

Title Page	1
Cover Page	2
Table of Contents	3
Sample Summary	4
Sample Data	5
SS01-0'	5
SS02-0'	6
SS03-0'	7
SS04-0'	8
BH01-0'	9
BH01-0.5'	10
BH01-1'	11
BH02-0'	12
BH02-0.5'	13
BH02-1'	14
QC Summary Data	15
QC - Volatile Organic Compounds by EPA 8260B	15
QC - Nonhalogenated Organics by EPA 8015D - GRO	16
QC - Nonhalogenated Organics by EPA 8015D - DRO/ORO	17
QC - Anions by EPA 300.0/9056A	18
Definitions and Notes	19
Chain of Custody etc.	20

Sample Summary

Matador Resources, LLC. 5400 LBJ Freeway, Suite 1500 Dallas TX, 75240	Project Name: Toque State Com Project Number: 23052-0001 Project Manager: Ashley Giovengo	Reported: 12/20/23 15:50
---	---	------------------------------------

Client Sample ID	Lab Sample ID	Matrix	Sampled	Received	Container
SS01-0'	E312098-01A	Soil	12/12/23	12/14/23	Glass Jar, 2 oz.
SS02-0'	E312098-02A	Soil	12/12/23	12/14/23	Glass Jar, 2 oz.
SS03-0'	E312098-03A	Soil	12/12/23	12/14/23	Glass Jar, 2 oz.
SS04-0'	E312098-04A	Soil	12/12/23	12/14/23	Glass Jar, 2 oz.
BH01-0'	E312098-05A	Soil	12/12/23	12/14/23	Glass Jar, 2 oz.
BH01-0.5'	E312098-06A	Soil	12/12/23	12/14/23	Glass Jar, 2 oz.
BH01-1'	E312098-07A	Soil	12/12/23	12/14/23	Glass Jar, 2 oz.
BH02-0'	E312098-08A	Soil	12/12/23	12/14/23	Glass Jar, 2 oz.
BH02-0.5'	E312098-09A	Soil	12/12/23	12/14/23	Glass Jar, 2 oz.
BH02-1'	E312098-10A	Soil	12/12/23	12/14/23	Glass Jar, 2 oz.



Sample Data

Matador Resources, LLC. 5400 LBJ Freeway, Suite 1500 Dallas TX, 75240	Project Name: Toque State Com Project Number: 23052-0001 Project Manager: Ashley Giovengo	Reported: 12/20/2023 3:50:39PM
---	---	--

SS01-0'

E312098-01

Analyte	Result	Reporting Limit	Dilution	Prepared	Analyzed	Notes
Volatile Organic Compounds by EPA 8260B	mg/kg	mg/kg		Analyst: RKS		Batch: 2350099
Benzene	ND	0.0250	1	12/15/23	12/16/23	
Ethylbenzene	ND	0.0250	1	12/15/23	12/16/23	
Toluene	ND	0.0250	1	12/15/23	12/16/23	
o-Xylene	ND	0.0250	1	12/15/23	12/16/23	
p,m-Xylene	ND	0.0500	1	12/15/23	12/16/23	
Total Xylenes	ND	0.0250	1	12/15/23	12/16/23	
<i>Surrogate: Bromofluorobenzene</i>		105 %	70-130	12/15/23	12/16/23	
<i>Surrogate: 1,2-Dichloroethane-d4</i>		96.8 %	70-130	12/15/23	12/16/23	
<i>Surrogate: Toluene-d8</i>		109 %	70-130	12/15/23	12/16/23	
Nonhalogenated Organics by EPA 8015D - GRO	mg/kg	mg/kg		Analyst: RKS		Batch: 2350099
Gasoline Range Organics (C6-C10)	ND	20.0	1	12/15/23	12/16/23	
<i>Surrogate: Bromofluorobenzene</i>		105 %	70-130	12/15/23	12/16/23	
<i>Surrogate: 1,2-Dichloroethane-d4</i>		96.8 %	70-130	12/15/23	12/16/23	
<i>Surrogate: Toluene-d8</i>		109 %	70-130	12/15/23	12/16/23	
Nonhalogenated Organics by EPA 8015D - DRO/ORO	mg/kg	mg/kg		Analyst: KM		Batch: 2351041
Diesel Range Organics (C10-C28)	ND	25.0	1	12/19/23	12/19/23	
Oil Range Organics (C28-C36)	ND	50.0	1	12/19/23	12/19/23	
<i>Surrogate: n-Nonane</i>		95.2 %	50-200	12/19/23	12/19/23	
Anions by EPA 300.0/9056A	mg/kg	mg/kg		Analyst: IY		Batch: 2351046
Chloride	ND	20.0	1	12/19/23	12/20/23	



Sample Data

Matador Resources, LLC. 5400 LBJ Freeway, Suite 1500 Dallas TX, 75240	Project Name: Toque State Com Project Number: 23052-0001 Project Manager: Ashley Giovengo	Reported: 12/20/2023 3:50:39PM
---	---	--

SS02-0'

E312098-02

Analyte	Result	Reporting Limit	Dilution	Prepared	Analyzed	Notes
Volatile Organic Compounds by EPA 8260B	mg/kg	mg/kg		Analyst: RKS		Batch: 2350099
Benzene	ND	0.0250	1	12/15/23	12/16/23	
Ethylbenzene	ND	0.0250	1	12/15/23	12/16/23	
Toluene	ND	0.0250	1	12/15/23	12/16/23	
o-Xylene	ND	0.0250	1	12/15/23	12/16/23	
p,m-Xylene	ND	0.0500	1	12/15/23	12/16/23	
Total Xylenes	ND	0.0250	1	12/15/23	12/16/23	
<i>Surrogate: Bromofluorobenzene</i>		105 %	70-130	12/15/23	12/16/23	
<i>Surrogate: 1,2-Dichloroethane-d4</i>		96.0 %	70-130	12/15/23	12/16/23	
<i>Surrogate: Toluene-d8</i>		108 %	70-130	12/15/23	12/16/23	
Nonhalogenated Organics by EPA 8015D - GRO	mg/kg	mg/kg		Analyst: RKS		Batch: 2350099
Gasoline Range Organics (C6-C10)	ND	20.0	1	12/15/23	12/16/23	
<i>Surrogate: Bromofluorobenzene</i>		105 %	70-130	12/15/23	12/16/23	
<i>Surrogate: 1,2-Dichloroethane-d4</i>		96.0 %	70-130	12/15/23	12/16/23	
<i>Surrogate: Toluene-d8</i>		108 %	70-130	12/15/23	12/16/23	
Nonhalogenated Organics by EPA 8015D - DRO/ORO	mg/kg	mg/kg		Analyst: KM		Batch: 2351041
Diesel Range Organics (C10-C28)	ND	25.0	1	12/19/23	12/19/23	
Oil Range Organics (C28-C36)	ND	50.0	1	12/19/23	12/19/23	
<i>Surrogate: n-Nonane</i>		103 %	50-200	12/19/23	12/19/23	
Anions by EPA 300.0/9056A	mg/kg	mg/kg		Analyst: IY		Batch: 2351046
Chloride	ND	20.0	1	12/19/23	12/20/23	



Sample Data

Matador Resources, LLC. 5400 LBJ Freeway, Suite 1500 Dallas TX, 75240	Project Name: Toque State Com Project Number: 23052-0001 Project Manager: Ashley Giovengo	Reported: 12/20/2023 3:50:39PM
---	---	--

SS03-0'

E312098-03

Analyte	Result	Reporting Limit	Dilution	Prepared	Analyzed	Notes
Volatile Organic Compounds by EPA 8260B						
	mg/kg	mg/kg		Analyst: RKS		Batch: 2350099
Benzene	ND	0.0250	1	12/15/23	12/16/23	
Ethylbenzene	ND	0.0250	1	12/15/23	12/16/23	
Toluene	ND	0.0250	1	12/15/23	12/16/23	
o-Xylene	ND	0.0250	1	12/15/23	12/16/23	
p,m-Xylene	ND	0.0500	1	12/15/23	12/16/23	
Total Xylenes	ND	0.0250	1	12/15/23	12/16/23	
<i>Surrogate: Bromofluorobenzene</i>		107 %	70-130	12/15/23	12/16/23	
<i>Surrogate: 1,2-Dichloroethane-d4</i>		94.9 %	70-130	12/15/23	12/16/23	
<i>Surrogate: Toluene-d8</i>		109 %	70-130	12/15/23	12/16/23	
Nonhalogenated Organics by EPA 8015D - GRO						
	mg/kg	mg/kg		Analyst: RKS		Batch: 2350099
Gasoline Range Organics (C6-C10)	ND	20.0	1	12/15/23	12/16/23	
<i>Surrogate: Bromofluorobenzene</i>		107 %	70-130	12/15/23	12/16/23	
<i>Surrogate: 1,2-Dichloroethane-d4</i>		94.9 %	70-130	12/15/23	12/16/23	
<i>Surrogate: Toluene-d8</i>		109 %	70-130	12/15/23	12/16/23	
Nonhalogenated Organics by EPA 8015D - DRO/ORO						
	mg/kg	mg/kg		Analyst: KM		Batch: 2351041
Diesel Range Organics (C10-C28)	ND	25.0	1	12/19/23	12/19/23	
Oil Range Organics (C28-C36)	ND	50.0	1	12/19/23	12/19/23	
<i>Surrogate: n-Nonane</i>		98.4 %	50-200	12/19/23	12/19/23	
Anions by EPA 300.0/9056A						
	mg/kg	mg/kg		Analyst: IY		Batch: 2351046
Chloride	39.9	20.0	1	12/19/23	12/20/23	



Sample Data

Matador Resources, LLC. 5400 LBJ Freeway, Suite 1500 Dallas TX, 75240	Project Name: Toque State Com Project Number: 23052-0001 Project Manager: Ashley Giovengo	Reported: 12/20/2023 3:50:39PM
---	---	--

SS04-0'

E312098-04

Analyte	Result	Reporting Limit	Dilution	Prepared	Analyzed	Notes
Volatile Organic Compounds by EPA 8260B	mg/kg	mg/kg		Analyst: RKS		Batch: 2350099
Benzene	ND	0.0250	1	12/15/23	12/16/23	
Ethylbenzene	ND	0.0250	1	12/15/23	12/16/23	
Toluene	ND	0.0250	1	12/15/23	12/16/23	
o-Xylene	ND	0.0250	1	12/15/23	12/16/23	
p,m-Xylene	ND	0.0500	1	12/15/23	12/16/23	
Total Xylenes	ND	0.0250	1	12/15/23	12/16/23	
<i>Surrogate: Bromofluorobenzene</i>		106 %	70-130	12/15/23	12/16/23	
<i>Surrogate: 1,2-Dichloroethane-d4</i>		97.5 %	70-130	12/15/23	12/16/23	
<i>Surrogate: Toluene-d8</i>		107 %	70-130	12/15/23	12/16/23	
Nonhalogenated Organics by EPA 8015D - GRO	mg/kg	mg/kg		Analyst: RKS		Batch: 2350099
Gasoline Range Organics (C6-C10)	ND	20.0	1	12/15/23	12/16/23	
<i>Surrogate: Bromofluorobenzene</i>		106 %	70-130	12/15/23	12/16/23	
<i>Surrogate: 1,2-Dichloroethane-d4</i>		97.5 %	70-130	12/15/23	12/16/23	
<i>Surrogate: Toluene-d8</i>		107 %	70-130	12/15/23	12/16/23	
Nonhalogenated Organics by EPA 8015D - DRO/ORO	mg/kg	mg/kg		Analyst: KM		Batch: 2351041
Diesel Range Organics (C10-C28)	37.3	25.0	1	12/19/23	12/20/23	
Oil Range Organics (C28-C36)	ND	50.0	1	12/19/23	12/20/23	
<i>Surrogate: n-Nonane</i>		99.2 %	50-200	12/19/23	12/20/23	
Anions by EPA 300.0/9056A	mg/kg	mg/kg		Analyst: IY		Batch: 2351046
Chloride	ND	20.0	1	12/19/23	12/20/23	



Sample Data

Matador Resources, LLC. 5400 LBJ Freeway, Suite 1500 Dallas TX, 75240	Project Name: Toque State Com Project Number: 23052-0001 Project Manager: Ashley Giovengo	Reported: 12/20/2023 3:50:39PM
---	---	--

BH01-0'
E312098-05

Analyte	Result	Reporting Limit	Dilution	Prepared	Analyzed	Notes
Volatile Organic Compounds by EPA 8260B	mg/kg	mg/kg		Analyst: RKS		Batch: 2350099
Benzene	ND	0.0250	1	12/15/23	12/16/23	
Ethylbenzene	ND	0.0250	1	12/15/23	12/16/23	
Toluene	ND	0.0250	1	12/15/23	12/16/23	
o-Xylene	ND	0.0250	1	12/15/23	12/16/23	
p,m-Xylene	ND	0.0500	1	12/15/23	12/16/23	
Total Xylenes	ND	0.0250	1	12/15/23	12/16/23	
<i>Surrogate: Bromofluorobenzene</i>		106 %	70-130	12/15/23	12/16/23	
<i>Surrogate: 1,2-Dichloroethane-d4</i>		95.5 %	70-130	12/15/23	12/16/23	
<i>Surrogate: Toluene-d8</i>		107 %	70-130	12/15/23	12/16/23	
Nonhalogenated Organics by EPA 8015D - GRO	mg/kg	mg/kg		Analyst: RKS		Batch: 2350099
Gasoline Range Organics (C6-C10)	ND	20.0	1	12/15/23	12/16/23	
<i>Surrogate: Bromofluorobenzene</i>		106 %	70-130	12/15/23	12/16/23	
<i>Surrogate: 1,2-Dichloroethane-d4</i>		95.5 %	70-130	12/15/23	12/16/23	
<i>Surrogate: Toluene-d8</i>		107 %	70-130	12/15/23	12/16/23	
Nonhalogenated Organics by EPA 8015D - DRO/ORO	mg/kg	mg/kg		Analyst: KM		Batch: 2351041
Diesel Range Organics (C10-C28)	ND	25.0	1	12/19/23	12/20/23	
Oil Range Organics (C28-C36)	ND	50.0	1	12/19/23	12/20/23	
<i>Surrogate: n-Nonane</i>		97.2 %	50-200	12/19/23	12/20/23	
Anions by EPA 300.0/9056A	mg/kg	mg/kg		Analyst: IY		Batch: 2351046
Chloride	205	20.0	1	12/19/23	12/20/23	



Sample Data

Matador Resources, LLC. 5400 LBJ Freeway, Suite 1500 Dallas TX, 75240	Project Name: Toque State Com Project Number: 23052-0001 Project Manager: Ashley Giovengo	Reported: 12/20/2023 3:50:39PM
---	---	--

BH01-0.5'

E312098-06

Analyte	Result	Reporting Limit	Dilution	Prepared	Analyzed	Notes
Volatile Organic Compounds by EPA 8260B	mg/kg	mg/kg		Analyst: RKS		Batch: 2350099
Benzene	ND	0.0250	1	12/15/23	12/16/23	
Ethylbenzene	ND	0.0250	1	12/15/23	12/16/23	
Toluene	ND	0.0250	1	12/15/23	12/16/23	
o-Xylene	ND	0.0250	1	12/15/23	12/16/23	
p,m-Xylene	ND	0.0500	1	12/15/23	12/16/23	
Total Xylenes	ND	0.0250	1	12/15/23	12/16/23	
<i>Surrogate: Bromofluorobenzene</i>		107 %	70-130	12/15/23	12/16/23	
<i>Surrogate: 1,2-Dichloroethane-d4</i>		99.7 %	70-130	12/15/23	12/16/23	
<i>Surrogate: Toluene-d8</i>		104 %	70-130	12/15/23	12/16/23	
Nonhalogenated Organics by EPA 8015D - GRO	mg/kg	mg/kg		Analyst: RKS		Batch: 2350099
Gasoline Range Organics (C6-C10)	ND	20.0	1	12/15/23	12/16/23	
<i>Surrogate: Bromofluorobenzene</i>		107 %	70-130	12/15/23	12/16/23	
<i>Surrogate: 1,2-Dichloroethane-d4</i>		99.7 %	70-130	12/15/23	12/16/23	
<i>Surrogate: Toluene-d8</i>		104 %	70-130	12/15/23	12/16/23	
Nonhalogenated Organics by EPA 8015D - DRO/ORO	mg/kg	mg/kg		Analyst: KM		Batch: 2351041
Diesel Range Organics (C10-C28)	ND	25.0	1	12/19/23	12/20/23	
Oil Range Organics (C28-C36)	ND	50.0	1	12/19/23	12/20/23	
<i>Surrogate: n-Nonane</i>		96.4 %	50-200	12/19/23	12/20/23	
Anions by EPA 300.0/9056A	mg/kg	mg/kg		Analyst: IY		Batch: 2351046
Chloride	39.6	20.0	1	12/19/23	12/20/23	



Sample Data

Matador Resources, LLC. 5400 LBJ Freeway, Suite 1500 Dallas TX, 75240	Project Name: Toque State Com Project Number: 23052-0001 Project Manager: Ashley Giovengo	Reported: 12/20/2023 3:50:39PM
---	---	--

BH01-1'
E312098-07

Analyte	Result	Reporting Limit	Dilution	Prepared	Analyzed	Notes
Volatile Organic Compounds by EPA 8260B						
	mg/kg	mg/kg		Analyst: RKS		Batch: 2350099
Benzene	ND	0.0250	1	12/15/23	12/16/23	
Ethylbenzene	ND	0.0250	1	12/15/23	12/16/23	
Toluene	ND	0.0250	1	12/15/23	12/16/23	
o-Xylene	ND	0.0250	1	12/15/23	12/16/23	
p,m-Xylene	ND	0.0500	1	12/15/23	12/16/23	
Total Xylenes	ND	0.0250	1	12/15/23	12/16/23	
<i>Surrogate: Bromofluorobenzene</i>						
		106 %	70-130	12/15/23	12/16/23	
<i>Surrogate: 1,2-Dichloroethane-d4</i>						
		98.0 %	70-130	12/15/23	12/16/23	
<i>Surrogate: Toluene-d8</i>						
		108 %	70-130	12/15/23	12/16/23	
Nonhalogenated Organics by EPA 8015D - GRO						
	mg/kg	mg/kg		Analyst: RKS		Batch: 2350099
Gasoline Range Organics (C6-C10)	ND	20.0	1	12/15/23	12/16/23	
<i>Surrogate: Bromofluorobenzene</i>						
		106 %	70-130	12/15/23	12/16/23	
<i>Surrogate: 1,2-Dichloroethane-d4</i>						
		98.0 %	70-130	12/15/23	12/16/23	
<i>Surrogate: Toluene-d8</i>						
		108 %	70-130	12/15/23	12/16/23	
Nonhalogenated Organics by EPA 8015D - DRO/ORO						
	mg/kg	mg/kg		Analyst: KM		Batch: 2351041
Diesel Range Organics (C10-C28)	ND	25.0	1	12/19/23	12/20/23	
Oil Range Organics (C28-C36)	ND	50.0	1	12/19/23	12/20/23	
<i>Surrogate: n-Nonane</i>						
		98.4 %	50-200	12/19/23	12/20/23	
Anions by EPA 300.0/9056A						
	mg/kg	mg/kg		Analyst: IY		Batch: 2351046
Chloride	ND	20.0	1	12/19/23	12/20/23	



Sample Data

Matador Resources, LLC. 5400 LBJ Freeway, Suite 1500 Dallas TX, 75240	Project Name: Toque State Com Project Number: 23052-0001 Project Manager: Ashley Giovengo	Reported: 12/20/2023 3:50:39PM
---	---	--

BH02-0'

E312098-08

Analyte	Result	Reporting Limit	Dilution	Prepared	Analyzed	Notes
Volatile Organic Compounds by EPA 8260B	mg/kg	mg/kg		Analyst: RKS		Batch: 2350099
Benzene	ND	0.0250	1	12/15/23	12/16/23	
Ethylbenzene	ND	0.0250	1	12/15/23	12/16/23	
Toluene	ND	0.0250	1	12/15/23	12/16/23	
o-Xylene	ND	0.0250	1	12/15/23	12/16/23	
p,m-Xylene	ND	0.0500	1	12/15/23	12/16/23	
Total Xylenes	ND	0.0250	1	12/15/23	12/16/23	
<i>Surrogate: Bromofluorobenzene</i>		105 %	70-130	12/15/23	12/16/23	
<i>Surrogate: 1,2-Dichloroethane-d4</i>		93.9 %	70-130	12/15/23	12/16/23	
<i>Surrogate: Toluene-d8</i>		107 %	70-130	12/15/23	12/16/23	
Nonhalogenated Organics by EPA 8015D - GRO	mg/kg	mg/kg		Analyst: RKS		Batch: 2350099
Gasoline Range Organics (C6-C10)	ND	20.0	1	12/15/23	12/16/23	
<i>Surrogate: Bromofluorobenzene</i>		105 %	70-130	12/15/23	12/16/23	
<i>Surrogate: 1,2-Dichloroethane-d4</i>		93.9 %	70-130	12/15/23	12/16/23	
<i>Surrogate: Toluene-d8</i>		107 %	70-130	12/15/23	12/16/23	
Nonhalogenated Organics by EPA 8015D - DRO/ORO	mg/kg	mg/kg		Analyst: KM		Batch: 2351041
Diesel Range Organics (C10-C28)	ND	25.0	1	12/19/23	12/20/23	
Oil Range Organics (C28-C36)	ND	50.0	1	12/19/23	12/20/23	
<i>Surrogate: n-Nonane</i>		101 %	50-200	12/19/23	12/20/23	
Anions by EPA 300.0/9056A	mg/kg	mg/kg		Analyst: IY		Batch: 2351046
Chloride	ND	20.0	1	12/19/23	12/20/23	



Sample Data

Matador Resources, LLC. 5400 LBJ Freeway, Suite 1500 Dallas TX, 75240	Project Name: Toque State Com Project Number: 23052-0001 Project Manager: Ashley Giovengo	Reported: 12/20/2023 3:50:39PM
---	---	--

BH02-0.5'

E312098-09

Analyte	Result	Reporting Limit	Dilution	Prepared	Analyzed	Notes
Volatile Organic Compounds by EPA 8260B	mg/kg	mg/kg		Analyst: RKS		Batch: 2350099
Benzene	ND	0.0250	1	12/15/23	12/16/23	
Ethylbenzene	ND	0.0250	1	12/15/23	12/16/23	
Toluene	ND	0.0250	1	12/15/23	12/16/23	
o-Xylene	ND	0.0250	1	12/15/23	12/16/23	
p,m-Xylene	ND	0.0500	1	12/15/23	12/16/23	
Total Xylenes	ND	0.0250	1	12/15/23	12/16/23	
<i>Surrogate: Bromofluorobenzene</i>		106 %	70-130	12/15/23	12/16/23	
<i>Surrogate: 1,2-Dichloroethane-d4</i>		89.5 %	70-130	12/15/23	12/16/23	
<i>Surrogate: Toluene-d8</i>		106 %	70-130	12/15/23	12/16/23	
Nonhalogenated Organics by EPA 8015D - GRO	mg/kg	mg/kg		Analyst: RKS		Batch: 2350099
Gasoline Range Organics (C6-C10)	ND	20.0	1	12/15/23	12/16/23	
<i>Surrogate: Bromofluorobenzene</i>		106 %	70-130	12/15/23	12/16/23	
<i>Surrogate: 1,2-Dichloroethane-d4</i>		89.5 %	70-130	12/15/23	12/16/23	
<i>Surrogate: Toluene-d8</i>		106 %	70-130	12/15/23	12/16/23	
Nonhalogenated Organics by EPA 8015D - DRO/ORO	mg/kg	mg/kg		Analyst: KM		Batch: 2351041
Diesel Range Organics (C10-C28)	ND	25.0	1	12/19/23	12/20/23	
Oil Range Organics (C28-C36)	ND	50.0	1	12/19/23	12/20/23	
<i>Surrogate: n-Nonane</i>		95.5 %	50-200	12/19/23	12/20/23	
Anions by EPA 300.0/9056A	mg/kg	mg/kg		Analyst: IY		Batch: 2351046
Chloride	ND	20.0	1	12/19/23	12/20/23	



Sample Data

Matador Resources, LLC. 5400 LBJ Freeway, Suite 1500 Dallas TX, 75240	Project Name: Toque State Com Project Number: 23052-0001 Project Manager: Ashley Giovengo	Reported: 12/20/2023 3:50:39PM
---	---	--

BH02-1'
E312098-10

Analyte	Result	Reporting Limit	Dilution	Prepared	Analyzed	Notes
Volatile Organic Compounds by EPA 8260B	mg/kg	mg/kg		Analyst: RKS		Batch: 2350099
Benzene	ND	0.0250	1	12/15/23	12/16/23	
Ethylbenzene	ND	0.0250	1	12/15/23	12/16/23	
Toluene	ND	0.0250	1	12/15/23	12/16/23	
o-Xylene	ND	0.0250	1	12/15/23	12/16/23	
p,m-Xylene	ND	0.0500	1	12/15/23	12/16/23	
Total Xylenes	ND	0.0250	1	12/15/23	12/16/23	
<i>Surrogate: Bromofluorobenzene</i>		105 %	70-130	12/15/23	12/16/23	
<i>Surrogate: 1,2-Dichloroethane-d4</i>		94.5 %	70-130	12/15/23	12/16/23	
<i>Surrogate: Toluene-d8</i>		107 %	70-130	12/15/23	12/16/23	
Nonhalogenated Organics by EPA 8015D - GRO	mg/kg	mg/kg		Analyst: RKS		Batch: 2350099
Gasoline Range Organics (C6-C10)	ND	20.0	1	12/15/23	12/16/23	
<i>Surrogate: Bromofluorobenzene</i>		105 %	70-130	12/15/23	12/16/23	
<i>Surrogate: 1,2-Dichloroethane-d4</i>		94.5 %	70-130	12/15/23	12/16/23	
<i>Surrogate: Toluene-d8</i>		107 %	70-130	12/15/23	12/16/23	
Nonhalogenated Organics by EPA 8015D - DRO/ORO	mg/kg	mg/kg		Analyst: KM		Batch: 2351041
Diesel Range Organics (C10-C28)	ND	25.0	1	12/19/23	12/20/23	
Oil Range Organics (C28-C36)	ND	50.0	1	12/19/23	12/20/23	
<i>Surrogate: n-Nonane</i>		91.3 %	50-200	12/19/23	12/20/23	
Anions by EPA 300.0/9056A	mg/kg	mg/kg		Analyst: IY		Batch: 2351046
Chloride	ND	20.0	1	12/19/23	12/20/23	



QC Summary Data

Matador Resources, LLC. 5400 LBJ Freeway, Suite 1500 Dallas TX, 75240	Project Name: Toque State Com Project Number: 23052-0001 Project Manager: Ashley Giovengo	Reported: 12/20/2023 3:50:39PM
---	---	--

Volatile Organic Compounds by EPA 8260B

Analyst: RKS

Analyte	Result mg/kg	Reporting Limit mg/kg	Spike Level mg/kg	Source Result mg/kg	Rec % %	Rec Limits %	RPD % %	RPD Limit %	Notes
---------	-----------------	-----------------------------	-------------------------	---------------------------	---------------	--------------------	---------------	-------------------	-------

Blank (2350099-BLK1)

Prepared: 12/15/23 Analyzed: 12/15/23

Benzene	ND	0.0250							
Ethylbenzene	ND	0.0250							
Toluene	ND	0.0250							
o-Xylene	ND	0.0250							
p,m-Xylene	ND	0.0500							
Total Xylenes	ND	0.0250							
Surrogate: Bromofluorobenzene	0.524		0.500		105		70-130		
Surrogate: 1,2-Dichloroethane-d4	0.485		0.500		96.9		70-130		
Surrogate: Toluene-d8	0.543		0.500		109		70-130		

LCS (2350099-BS1)

Prepared: 12/15/23 Analyzed: 12/15/23

Benzene	2.56	0.0250	2.50		102		70-130		
Ethylbenzene	2.64	0.0250	2.50		105		70-130		
Toluene	2.59	0.0250	2.50		104		70-130		
o-Xylene	2.58	0.0250	2.50		103		70-130		
p,m-Xylene	5.12	0.0500	5.00		102		70-130		
Total Xylenes	7.71	0.0250	7.50		103		70-130		
Surrogate: Bromofluorobenzene	0.522		0.500		104		70-130		
Surrogate: 1,2-Dichloroethane-d4	0.504		0.500		101		70-130		
Surrogate: Toluene-d8	0.523		0.500		105		70-130		

Matrix Spike (2350099-MS1)

Source: E312098-06

Prepared: 12/15/23 Analyzed: 12/16/23

Benzene	2.95	0.0250	2.50	ND	118		48-131		
Ethylbenzene	2.78	0.0250	2.50	ND	111		45-135		
Toluene	2.83	0.0250	2.50	ND	113		48-130		
o-Xylene	2.70	0.0250	2.50	ND	108		43-135		
p,m-Xylene	5.43	0.0500	5.00	ND	109		43-135		
Total Xylenes	8.13	0.0250	7.50	ND	108		43-135		
Surrogate: Bromofluorobenzene	0.530		0.500		106		70-130		
Surrogate: 1,2-Dichloroethane-d4	0.482		0.500		96.4		70-130		
Surrogate: Toluene-d8	0.525		0.500		105		70-130		

Matrix Spike Dup (2350099-MSD1)

Source: E312098-06

Prepared: 12/15/23 Analyzed: 12/16/23

Benzene	2.93	0.0250	2.50	ND	117		48-131	0.612	23
Ethylbenzene	2.77	0.0250	2.50	ND	111		45-135	0.379	27
Toluene	2.79	0.0250	2.50	ND	112		48-130	1.44	24
o-Xylene	2.72	0.0250	2.50	ND	109		43-135	0.977	27
p,m-Xylene	5.47	0.0500	5.00	ND	109		43-135	0.642	27
Total Xylenes	8.19	0.0250	7.50	ND	109		43-135	0.754	27
Surrogate: Bromofluorobenzene	0.522		0.500		104		70-130		
Surrogate: 1,2-Dichloroethane-d4	0.491		0.500		98.1		70-130		
Surrogate: Toluene-d8	0.524		0.500		105		70-130		



QC Summary Data

Matador Resources, LLC. 5400 LBJ Freeway, Suite 1500 Dallas TX, 75240	Project Name: Toque State Com Project Number: 23052-0001 Project Manager: Ashley Giovengo	Reported: 12/20/2023 3:50:39PM
---	---	--

Nonhalogenated Organics by EPA 8015D - GRO

Analyst: RKS

Analyte	Result mg/kg	Reporting Limit mg/kg	Spike Level mg/kg	Source Result mg/kg	Rec %	Rec Limits %	RPD %	RPD Limit %	Notes
---------	-----------------	-----------------------------	-------------------------	---------------------------	----------	--------------------	----------	-------------------	-------

Blank (2350099-BLK1)

Prepared: 12/15/23 Analyzed: 12/15/23

Gasoline Range Organics (C6-C10)	ND	20.0							
Surrogate: Bromofluorobenzene	0.524		0.500		105	70-130			
Surrogate: 1,2-Dichloroethane-d4	0.485		0.500		96.9	70-130			
Surrogate: Toluene-d8	0.543		0.500		109	70-130			

LCS (2350099-BS2)

Prepared: 12/15/23 Analyzed: 12/16/23

Gasoline Range Organics (C6-C10)	48.8	20.0	50.0		97.5	70-130			
Surrogate: Bromofluorobenzene	0.524		0.500		105	70-130			
Surrogate: 1,2-Dichloroethane-d4	0.486		0.500		97.1	70-130			
Surrogate: Toluene-d8	0.557		0.500		111	70-130			

Matrix Spike (2350099-MS2)

Source: E312098-06

Prepared: 12/15/23 Analyzed: 12/16/23

Gasoline Range Organics (C6-C10)	50.7	20.0	50.0	ND	101	70-130			
Surrogate: Bromofluorobenzene	0.527		0.500		105	70-130			
Surrogate: 1,2-Dichloroethane-d4	0.471		0.500		94.2	70-130			
Surrogate: Toluene-d8	0.547		0.500		109	70-130			

Matrix Spike Dup (2350099-MSD2)

Source: E312098-06

Prepared: 12/15/23 Analyzed: 12/16/23

Gasoline Range Organics (C6-C10)	48.0	20.0	50.0	ND	96.0	70-130	5.41	20	
Surrogate: Bromofluorobenzene	0.516		0.500		103	70-130			
Surrogate: 1,2-Dichloroethane-d4	0.485		0.500		97.0	70-130			
Surrogate: Toluene-d8	0.547		0.500		109	70-130			



QC Summary Data

Matador Resources, LLC. 5400 LBJ Freeway, Suite 1500 Dallas TX, 75240	Project Name: Toque State Com Project Number: 23052-0001 Project Manager: Ashley Giovengo	Reported: 12/20/2023 3:50:39PM
---	---	--

Nonhalogenated Organics by EPA 8015D - DRO/ORO

Analyst: KM

Analyte	Result mg/kg	Reporting Limit mg/kg	Spike Level mg/kg	Source Result mg/kg	Rec %	Rec Limits %	RPD %	RPD Limit %	Notes
---------	-----------------	-----------------------------	-------------------------	---------------------------	----------	--------------------	----------	-------------------	-------

Blank (2351041-BLK1)

Prepared: 12/19/23 Analyzed: 12/19/23

Diesel Range Organics (C10-C28)	ND	25.0							
Oil Range Organics (C28-C36)	ND	50.0							
Surrogate: <i>n-Nonane</i>	52.3		50.0		105	50-200			

LCS (2351041-BS1)

Prepared: 12/19/23 Analyzed: 12/19/23

Diesel Range Organics (C10-C28)	274	25.0	250		110	38-132			
Surrogate: <i>n-Nonane</i>	51.5		50.0		103	50-200			

Matrix Spike (2351041-MS1)

Source: E312127-04

Prepared: 12/19/23 Analyzed: 12/19/23

Diesel Range Organics (C10-C28)	306	25.0	250	ND	122	38-132			
Surrogate: <i>n-Nonane</i>	54.3		50.0		109	50-200			

Matrix Spike Dup (2351041-MSD1)

Source: E312127-04

Prepared: 12/19/23 Analyzed: 12/19/23

Diesel Range Organics (C10-C28)	306	25.0	250	ND	122	38-132	0.00977	20	
Surrogate: <i>n-Nonane</i>	53.9		50.0		108	50-200			



QC Summary Data

Matador Resources, LLC. 5400 LBJ Freeway, Suite 1500 Dallas TX, 75240	Project Name: Toque State Com Project Number: 23052-0001 Project Manager: Ashley Giovengo	Reported: 12/20/2023 3:50:39PM
---	---	--

Anions by EPA 300.0/9056A

Analyst: IY

Analyte	Result mg/kg	Reporting Limit mg/kg	Spike Level mg/kg	Source Result mg/kg	Rec %	Rec Limits %	RPD %	RPD Limit %	Notes
---------	-----------------	-----------------------------	-------------------------	---------------------------	----------	--------------------	----------	-------------------	-------

Blank (2351046-BLK1)

Prepared: 12/19/23 Analyzed: 12/20/23

Chloride ND 20.0

LCS (2351046-BS1)

Prepared: 12/19/23 Analyzed: 12/20/23

Chloride 246 20.0 250 98.4 90-110

Matrix Spike (2351046-MS1)

Source: E312098-04

Prepared: 12/19/23 Analyzed: 12/20/23

Chloride 248 20.0 250 ND 99.3 80-120

Matrix Spike Dup (2351046-MSD1)

Source: E312098-04

Prepared: 12/19/23 Analyzed: 12/20/23

Chloride 251 20.0 250 ND 100 80-120 1.07 20

QC Summary Report Comment:

Calculations are based off of the raw (non-rounded) data. However, for reporting purposes all QC data is rounded to three significant figures. Therefore, hand calculated values may differ slightly.



Definitions and Notes

Matador Resources, LLC. 5400 LBJ Freeway, Suite 1500 Dallas TX, 75240	Project Name: Toque State Com Project Number: 23052-0001 Project Manager: Ashley Giovengo	Reported: 12/20/23 15:50
---	---	------------------------------------

ND Analyte NOT DETECTED at or above the reporting limit

NR Not Reported

RPD Relative Percent Difference

DNI Did Not Ignite

DNR Did not react with the addition of acid or base.

Note (1): Methods marked with ** are non-accredited methods.

Note (2): Soil data is reported on an "as received" weight basis, unless reported otherwise.



Released to Imaging: 4/3/2024 8:15:39 AM

Client: Matador Production Company		Bill To		Lab Use Only		TAT			EPA Program				
Project: Toque State Com		Attention: Matador Production Company		Lab WO#	Job Number	1D	2D	3D	Standard	CWA	SDWA		
Project Manager: Ashley Giovengo		Address: on file		E312098 23052-0001					X				
Address: 3122 National Parks Hwy		City, State, Zip:		Analysis and Method									
City, State, Zip: Carlsbad NM, 88220		Phone: (337)319-8398		TPH GRO/DRO/ORO by 8015	BTEX by 8021	VOC by 8260	Metals 6010	Chloride 300.0	BGDOC NIM	GDOC TX	RCRA		
Phone: 575-988-0055		Email: clinton.talley@matadorresources.com									State		
Email: agiovengo@ensolum.com		Report due by:		NM		CO		UT		AZ		TX	

Time Sampled	Date Sampled	Matrix	No. of Containers	Sample ID	Lab Number	TPH GRO/DRO/ORO by 8015	BTEX by 8021	VOC by 8260	Metals 6010	Chloride 300.0	BGDOC NIM	GDOC TX	Remarks
11:05	12/12/2023	Soil	1	SS01 - 0'	1						X		
11:06	12/12/2023	Soil	1	SS02 - 0'	2						X		
11:08	12/12/2023	Soil	1	SS03 - 0'	3						X		
11:09	12/12/2023	Soil	1	SS04 - 0'	4						X		
11:14	12/12/2023	Soil	1	BH01 - 0'	5						X		
11:30	12/12/2023	Soil	1	BH01 - 0.5'	6						X		
11:35	12/12/2023	Soil	1	BH01 - 1'	7						X		
11:44	12/12/2023	Soil	1	BH02 - 0'	8						X		
11:55	12/12/2023	Soil	1	BH02 - 0.5'	9						X		
12:00	12/12/2023	Soil	1	BH02 - 1'	10						X		

Additional Instructions: Please CC: cburton@ensolum.com, agiovengo@ensolum.com, chamilton@ensolum.com, ehaft@ensolum.com - samples kept on ice

I, (field sampler), attest to the validity and authenticity of this sample. I am aware that tampering with or intentionally mislabelling the sample location, date or time of collection is considered fraud and may be grounds for legal action.				Samples requiring thermal preservation must be received on ice the day they are sampled or received packed in ice at an avg temp above 0 but less than 6 °C on subsequent days.			
Relinquished by: (Signature)		Date	Time	Received by: (Signature)		Date	Time
<i>[Signature]</i>		12/13/23	0700	<i>[Signature]</i>		12-13-2023	1330
Relinquished by: (Signature)		Date	Time	Received by: (Signature)		Date	Time
<i>[Signature]</i>		12-13-23	1630	<i>[Signature]</i>		12/13/23	830
Relinquished by: (Signature)		Date	Time	Received by: (Signature)		Date	Time
<i>[Signature]</i>				<i>[Signature]</i>			
Lab Use Only				Received on ice: <input checked="" type="radio"/> Y <input type="radio"/> N			
T1		T2		T3			
		4		AVG Temp °C			

Sample Matrix: S - Soil, Sd - Solid, Sg - Sludge, A - Aqueous, O - Other _____ Container Type: g - glass, p - poly/plastic, ag - amber glass, v - VOA

Note: Samples are discarded 30 days after results are reported unless other arrangements are made. Hazardous samples will be returned to client or disposed of at the client expense. The report for the analysis of the above samples is applicable only to those samples received by the laboratory with this COC. The liability of the laboratory is limited to the amount paid for on the report.

Received by: OCD: 1/22/2024 2:00:13 PM

12 fo 02 ege P

Page 46 of 77

Report to:
Ashley Giovengo



envirotech

Practical Solutions for a Better Tomorrow

Analytical Report

Matador Resources, LLC.

Project Name: Toque State Com

Work Order: E312186

Job Number: 23052-0001

Received: 12/27/2023

Revision: 1

Report Reviewed By:

Walter Hinchman
Laboratory Director
1/4/24

5796 U.S. Hwy 64
Farmington, NM 87401

Phone: (505) 632-1881
Envirotech-inc.com



Envirotech Inc. certifies the test results meet all requirements of TNI unless noted otherwise.
Statement of Data Authenticity: Envirotech Inc, attests the data reported has not been altered in any way.
Partial or incomplete reproduction of this report is prohibited, unless approved by Envirotech Inc.
Envirotech Inc, holds the Utah TNI certification NM00979 for data reported.
Envirotech Inc, holds the Texas TNI certification T104704557 for data reported.



Date Reported: 1/4/24

Ashley Giovengo
5400 LBJ Freeway, Suite 1500
Dallas, TX 75240

Project Name: Toque State Com
Workorder: E312186
Date Received: 12/27/2023 8:00:00AM

Ashley Giovengo,

Thank you for choosing Envirotech, Inc. as your analytical testing laboratory for the sample(s) received on, 12/27/2023 8:00:00AM, under the Project Name: Toque State Com.

The analytical test results summarized in this report with the Project Name: Toque State Com apply to the individual samples collected, identified and submitted bearing the project name on the enclosed chain-of-custody. Subcontracted sample analyses not conducted by Envirotech, Inc., are attached in full as issued by the subcontract laboratory.

Please review the Chain-of-Custody (COC) and Sample Receipt Checklist (SRC) for any issues regarding sample receipt temperature, containers, preservation etc. To best understand your test results, review the entire report summarizing your sample data and the associated quality control batch data.

All reported data in this analytical report were analyzed according to the referenced method(s) and are in compliance with the latest NELAC/TNI standards, unless otherwise noted. Samples or analytical quality control parameters not meeting specific QC criteria are qualified with a data flag. Data flag definitions are located in the Notes and Definitions section of this analytical report.

If you have any questions concerning this report, please feel free to contact Envirotech, Inc.

Respectfully,

Walter Hinchman
Laboratory Director
Office: 505-632-1881
Cell: 775-287-1762
whinchman@envirotech-inc.com

Raina Schwanz
Laboratory Administrator
Office: 505-632-1881
rainaschwanz@envirotech-inc.com

Alexa Michaels
Sample Custody Officer
Office: 505-632-1881
labadmin@envirotech-inc.com

Field Offices:

Southern New Mexico Area

Lynn Jarboe
Laboratory Technical Representative
Office: 505-421-LABS(5227)
Cell: 505-320-4759
ljjarboe@envirotech-inc.com

Michelle Golzales
Client Representative
Office: 505-421-LABS(5227)
Cell: 505-947-8222
mgonzales@envirotech-inc.com

Envirotech Web Address: www.envirotech-inc.com

Table of Contents

Title Page	1
Cover Page	2
Table of Contents	3
Sample Summary	4
Sample Data	5
SS04-A-0'	5
SS05-0'	6
SS01A-0'	7
FS01-0'	8
FS02-0'	9
FS03-0'	10
FS04-0'	11
FS05-0'	12
FS06-0'	13
QC Summary Data	14
QC - Volatile Organic Compounds by EPA 8260B	14
QC - Nonhalogenated Organics by EPA 8015D - GRO	15
QC - Nonhalogenated Organics by EPA 8015D - DRO/ORO	16
QC - Anions by EPA 300.0/9056A	17
Definitions and Notes	18
Chain of Custody etc.	19

Sample Summary

Matador Resources, LLC. 5400 LBJ Freeway, Suite 1500 Dallas TX, 75240	Project Name: Toque State Com Project Number: 23052-0001 Project Manager: Ashley Giovengo	Reported: 01/04/24 12:38
---	---	------------------------------------

Client Sample ID	Lab Sample ID	Matrix	Sampled	Received	Container
SS04-A-0'	E312186-01A	Soil	12/21/23	12/27/23	Glass Jar, 2 oz.
SS05-0'	E312186-02A	Soil	12/21/23	12/27/23	Glass Jar, 2 oz.
SS01A-0'	E312186-03A	Soil	12/21/23	12/27/23	Glass Jar, 2 oz.
FS01-0'	E312186-04A	Soil	12/21/23	12/27/23	Glass Jar, 2 oz.
FS02-0'	E312186-05A	Soil	12/21/23	12/27/23	Glass Jar, 2 oz.
FS03-0'	E312186-06A	Soil	12/21/23	12/27/23	Glass Jar, 2 oz.
FS04-0'	E312186-07A	Soil	12/21/23	12/27/23	Glass Jar, 2 oz.
FS05-0'	E312186-08A	Soil	12/21/23	12/27/23	Glass Jar, 2 oz.
FS06-0'	E312186-09A	Soil	12/21/23	12/27/23	Glass Jar, 2 oz.



Sample Data

Matador Resources, LLC. 5400 LBJ Freeway, Suite 1500 Dallas TX, 75240	Project Name: Toque State Com Project Number: 23052-0001 Project Manager: Ashley Giovengo	Reported: 1/4/2024 12:38:13PM
---	---	---

SS04-A-0'

E312186-01

Analyte	Result	Reporting Limit	Dilution	Prepared	Analyzed	Notes
---------	--------	-----------------	----------	----------	----------	-------

Volatile Organic Compounds by EPA 8260B	mg/kg	mg/kg	Analyst: RAS		Batch: 2352012
Benzene	ND	0.0250	1	12/27/23	01/03/24
Ethylbenzene	ND	0.0250	1	12/27/23	01/03/24
Toluene	ND	0.0250	1	12/27/23	01/03/24
o-Xylene	ND	0.0250	1	12/27/23	01/03/24
p,m-Xylene	ND	0.0500	1	12/27/23	01/03/24
Total Xylenes	ND	0.0250	1	12/27/23	01/03/24

<i>Surrogate: Bromofluorobenzene</i>	110 %	70-130		12/27/23	01/03/24
<i>Surrogate: 1,2-Dichloroethane-d4</i>	93.8 %	70-130		12/27/23	01/03/24
<i>Surrogate: Toluene-d8</i>	110 %	70-130		12/27/23	01/03/24

Nonhalogenated Organics by EPA 8015D - GRO	mg/kg	mg/kg	Analyst: RAS		Batch: 2352012
Gasoline Range Organics (C6-C10)	ND	20.0	1	12/27/23	01/03/24
<i>Surrogate: Bromofluorobenzene</i>	110 %	70-130		12/27/23	01/03/24
<i>Surrogate: 1,2-Dichloroethane-d4</i>	93.8 %	70-130		12/27/23	01/03/24
<i>Surrogate: Toluene-d8</i>	110 %	70-130		12/27/23	01/03/24

Nonhalogenated Organics by EPA 8015D - DRO/ORO	mg/kg	mg/kg	Analyst: KM		Batch: 2352022
Diesel Range Organics (C10-C28)	ND	25.0	1	12/28/23	12/29/23
Oil Range Organics (C28-C36)	ND	50.0	1	12/28/23	12/29/23
<i>Surrogate: n-Nonane</i>	92.2 %	50-200		12/28/23	12/29/23

Anions by EPA 300.0/9056A	mg/kg	mg/kg	Analyst: DT		Batch: 2352011
Chloride	ND	20.0	1	12/27/23	12/28/23



Sample Data

Matador Resources, LLC. 5400 LBJ Freeway, Suite 1500 Dallas TX, 75240	Project Name: Toque State Com Project Number: 23052-0001 Project Manager: Ashley Giovengo	Reported: 1/4/2024 12:38:13PM
---	---	---

SS05-0'

E312186-02

Analyte	Result	Reporting Limit	Dilution	Prepared	Analyzed	Notes
Volatile Organic Compounds by EPA 8260B	mg/kg	mg/kg		Analyst: RAS		Batch: 2352012
Benzene	ND	0.0250	1	12/27/23	01/03/24	
Ethylbenzene	ND	0.0250	1	12/27/23	01/03/24	
Toluene	ND	0.0250	1	12/27/23	01/03/24	
o-Xylene	ND	0.0250	1	12/27/23	01/03/24	
p,m-Xylene	ND	0.0500	1	12/27/23	01/03/24	
Total Xylenes	ND	0.0250	1	12/27/23	01/03/24	
<i>Surrogate: Bromofluorobenzene</i>		110 %	70-130	12/27/23	01/03/24	
<i>Surrogate: 1,2-Dichloroethane-d4</i>		93.7 %	70-130	12/27/23	01/03/24	
<i>Surrogate: Toluene-d8</i>		108 %	70-130	12/27/23	01/03/24	
Nonhalogenated Organics by EPA 8015D - GRO	mg/kg	mg/kg		Analyst: RAS		Batch: 2352012
Gasoline Range Organics (C6-C10)	ND	20.0	1	12/27/23	01/03/24	
<i>Surrogate: Bromofluorobenzene</i>		110 %	70-130	12/27/23	01/03/24	
<i>Surrogate: 1,2-Dichloroethane-d4</i>		93.7 %	70-130	12/27/23	01/03/24	
<i>Surrogate: Toluene-d8</i>		108 %	70-130	12/27/23	01/03/24	
Nonhalogenated Organics by EPA 8015D - DRO/ORO	mg/kg	mg/kg		Analyst: KM		Batch: 2352022
Diesel Range Organics (C10-C28)	ND	25.0	1	12/28/23	12/30/23	
Oil Range Organics (C28-C36)	ND	50.0	1	12/28/23	12/30/23	
<i>Surrogate: n-Nonane</i>		92.5 %	50-200	12/28/23	12/30/23	
Anions by EPA 300.0/9056A	mg/kg	mg/kg		Analyst: DT		Batch: 2352011
Chloride	ND	20.0	1	12/27/23	12/28/23	



Sample Data

Matador Resources, LLC. 5400 LBJ Freeway, Suite 1500 Dallas TX, 75240	Project Name: Toque State Com Project Number: 23052-0001 Project Manager: Ashley Giovengo	Reported: 1/4/2024 12:38:13PM
---	---	---

SS01A-0'
E312186-03

Analyte	Result	Reporting Limit	Dilution	Prepared	Analyzed	Notes
Volatile Organic Compounds by EPA 8260B	mg/kg	mg/kg		Analyst: RAS		Batch: 2352012
Benzene	ND	0.0250	1	12/27/23	01/03/24	
Ethylbenzene	ND	0.0250	1	12/27/23	01/03/24	
Toluene	ND	0.0250	1	12/27/23	01/03/24	
o-Xylene	ND	0.0250	1	12/27/23	01/03/24	
p,m-Xylene	ND	0.0500	1	12/27/23	01/03/24	
Total Xylenes	ND	0.0250	1	12/27/23	01/03/24	
<i>Surrogate: Bromofluorobenzene</i>		107 %	70-130	12/27/23	01/03/24	
<i>Surrogate: 1,2-Dichloroethane-d4</i>		95.1 %	70-130	12/27/23	01/03/24	
<i>Surrogate: Toluene-d8</i>		109 %	70-130	12/27/23	01/03/24	
Nonhalogenated Organics by EPA 8015D - GRO	mg/kg	mg/kg		Analyst: RAS		Batch: 2352012
Gasoline Range Organics (C6-C10)	ND	20.0	1	12/27/23	01/03/24	
<i>Surrogate: Bromofluorobenzene</i>		107 %	70-130	12/27/23	01/03/24	
<i>Surrogate: 1,2-Dichloroethane-d4</i>		95.1 %	70-130	12/27/23	01/03/24	
<i>Surrogate: Toluene-d8</i>		109 %	70-130	12/27/23	01/03/24	
Nonhalogenated Organics by EPA 8015D - DRO/ORO	mg/kg	mg/kg		Analyst: KM		Batch: 2352022
Diesel Range Organics (C10-C28)	ND	25.0	1	12/28/23	12/30/23	
Oil Range Organics (C28-C36)	ND	50.0	1	12/28/23	12/30/23	
<i>Surrogate: n-Nonane</i>		92.7 %	50-200	12/28/23	12/30/23	
Anions by EPA 300.0/9056A	mg/kg	mg/kg		Analyst: DT		Batch: 2352011
Chloride	520	20.0	1	12/27/23	12/28/23	



Sample Data

Matador Resources, LLC. 5400 LBJ Freeway, Suite 1500 Dallas TX, 75240	Project Name: Toque State Com Project Number: 23052-0001 Project Manager: Ashley Giovengo	Reported: 1/4/2024 12:38:13PM
---	---	---

FS01-0'

E312186-04

Analyte	Result	Reporting Limit	Dilution	Prepared	Analyzed	Notes
Volatile Organic Compounds by EPA 8260B	mg/kg	mg/kg		Analyst: RAS		Batch: 2352012
Benzene	ND	0.0250	1	12/27/23	01/03/24	
Ethylbenzene	ND	0.0250	1	12/27/23	01/03/24	
Toluene	ND	0.0250	1	12/27/23	01/03/24	
o-Xylene	ND	0.0250	1	12/27/23	01/03/24	
p,m-Xylene	ND	0.0500	1	12/27/23	01/03/24	
Total Xylenes	ND	0.0250	1	12/27/23	01/03/24	
<i>Surrogate: Bromofluorobenzene</i>		110 %	70-130	12/27/23	01/03/24	
<i>Surrogate: 1,2-Dichloroethane-d4</i>		94.5 %	70-130	12/27/23	01/03/24	
<i>Surrogate: Toluene-d8</i>		109 %	70-130	12/27/23	01/03/24	
Nonhalogenated Organics by EPA 8015D - GRO	mg/kg	mg/kg		Analyst: RAS		Batch: 2352012
Gasoline Range Organics (C6-C10)	ND	20.0	1	12/27/23	01/03/24	
<i>Surrogate: Bromofluorobenzene</i>		110 %	70-130	12/27/23	01/03/24	
<i>Surrogate: 1,2-Dichloroethane-d4</i>		94.5 %	70-130	12/27/23	01/03/24	
<i>Surrogate: Toluene-d8</i>		109 %	70-130	12/27/23	01/03/24	
Nonhalogenated Organics by EPA 8015D - DRO/ORO	mg/kg	mg/kg		Analyst: KM		Batch: 2352022
Diesel Range Organics (C10-C28)	ND	25.0	1	12/28/23	12/30/23	
Oil Range Organics (C28-C36)	ND	50.0	1	12/28/23	12/30/23	
<i>Surrogate: n-Nonane</i>		95.9 %	50-200	12/28/23	12/30/23	
Anions by EPA 300.0/9056A	mg/kg	mg/kg		Analyst: DT		Batch: 2352011
Chloride	77.0	20.0	1	12/27/23	12/28/23	



Sample Data

Matador Resources, LLC. 5400 LBJ Freeway, Suite 1500 Dallas TX, 75240	Project Name: Toque State Com Project Number: 23052-0001 Project Manager: Ashley Giovengo	Reported: 1/4/2024 12:38:13PM
---	---	---

FS02-0'

E312186-05

Analyte	Result	Reporting Limit	Dilution	Prepared	Analyzed	Notes
Volatile Organic Compounds by EPA 8260B	mg/kg	mg/kg		Analyst: RAS		Batch: 2352012
Benzene	ND	0.0250	1	12/27/23	01/03/24	
Ethylbenzene	ND	0.0250	1	12/27/23	01/03/24	
Toluene	ND	0.0250	1	12/27/23	01/03/24	
o-Xylene	ND	0.0250	1	12/27/23	01/03/24	
p,m-Xylene	ND	0.0500	1	12/27/23	01/03/24	
Total Xylenes	ND	0.0250	1	12/27/23	01/03/24	
<i>Surrogate: Bromofluorobenzene</i>		108 %	70-130	12/27/23	01/03/24	
<i>Surrogate: 1,2-Dichloroethane-d4</i>		95.5 %	70-130	12/27/23	01/03/24	
<i>Surrogate: Toluene-d8</i>		108 %	70-130	12/27/23	01/03/24	
Nonhalogenated Organics by EPA 8015D - GRO	mg/kg	mg/kg		Analyst: RAS		Batch: 2352012
Gasoline Range Organics (C6-C10)	ND	20.0	1	12/27/23	01/03/24	
<i>Surrogate: Bromofluorobenzene</i>		108 %	70-130	12/27/23	01/03/24	
<i>Surrogate: 1,2-Dichloroethane-d4</i>		95.5 %	70-130	12/27/23	01/03/24	
<i>Surrogate: Toluene-d8</i>		108 %	70-130	12/27/23	01/03/24	
Nonhalogenated Organics by EPA 8015D - DRO/ORO	mg/kg	mg/kg		Analyst: KM		Batch: 2352022
Diesel Range Organics (C10-C28)	ND	25.0	1	12/28/23	12/30/23	
Oil Range Organics (C28-C36)	ND	50.0	1	12/28/23	12/30/23	
<i>Surrogate: n-Nonane</i>		94.7 %	50-200	12/28/23	12/30/23	
Anions by EPA 300.0/9056A	mg/kg	mg/kg		Analyst: DT		Batch: 2352011
Chloride	37.6	20.0	1	12/27/23	12/28/23	



Sample Data

Matador Resources, LLC. 5400 LBJ Freeway, Suite 1500 Dallas TX, 75240	Project Name: Toque State Com Project Number: 23052-0001 Project Manager: Ashley Giovengo	Reported: 1/4/2024 12:38:13PM
---	---	---

FS03-0'

E312186-06

Analyte	Result	Reporting Limit	Dilution	Prepared	Analyzed	Notes
Volatile Organic Compounds by EPA 8260B	mg/kg	mg/kg		Analyst: RAS		Batch: 2352012
Benzene	ND	0.0250	1	12/27/23	01/03/24	
Ethylbenzene	ND	0.0250	1	12/27/23	01/03/24	
Toluene	ND	0.0250	1	12/27/23	01/03/24	
o-Xylene	ND	0.0250	1	12/27/23	01/03/24	
p,m-Xylene	ND	0.0500	1	12/27/23	01/03/24	
Total Xylenes	ND	0.0250	1	12/27/23	01/03/24	
<i>Surrogate: Bromofluorobenzene</i>		107 %	70-130	12/27/23	01/03/24	
<i>Surrogate: 1,2-Dichloroethane-d4</i>		95.2 %	70-130	12/27/23	01/03/24	
<i>Surrogate: Toluene-d8</i>		108 %	70-130	12/27/23	01/03/24	
Nonhalogenated Organics by EPA 8015D - GRO	mg/kg	mg/kg		Analyst: RAS		Batch: 2352012
Gasoline Range Organics (C6-C10)	ND	20.0	1	12/27/23	01/03/24	
<i>Surrogate: Bromofluorobenzene</i>		107 %	70-130	12/27/23	01/03/24	
<i>Surrogate: 1,2-Dichloroethane-d4</i>		95.2 %	70-130	12/27/23	01/03/24	
<i>Surrogate: Toluene-d8</i>		108 %	70-130	12/27/23	01/03/24	
Nonhalogenated Organics by EPA 8015D - DRO/ORO	mg/kg	mg/kg		Analyst: KM		Batch: 2352022
Diesel Range Organics (C10-C28)	ND	25.0	1	12/28/23	12/30/23	
Oil Range Organics (C28-C36)	ND	50.0	1	12/28/23	12/30/23	
<i>Surrogate: n-Nonane</i>		101 %	50-200	12/28/23	12/30/23	
Anions by EPA 300.0/9056A	mg/kg	mg/kg		Analyst: DT		Batch: 2352011
Chloride	42.7	20.0	1	12/27/23	12/28/23	



Sample Data

Matador Resources, LLC. 5400 LBJ Freeway, Suite 1500 Dallas TX, 75240	Project Name: Toque State Com Project Number: 23052-0001 Project Manager: Ashley Giovengo	Reported: 1/4/2024 12:38:13PM
---	---	---

FS04-0'

E312186-07

Analyte	Result	Reporting Limit	Dilution	Prepared	Analyzed	Notes
Volatile Organic Compounds by EPA 8260B	mg/kg	mg/kg		Analyst: RAS		Batch: 2352012
Benzene	ND	0.0250	1	12/27/23	01/03/24	
Ethylbenzene	ND	0.0250	1	12/27/23	01/03/24	
Toluene	ND	0.0250	1	12/27/23	01/03/24	
o-Xylene	ND	0.0250	1	12/27/23	01/03/24	
p,m-Xylene	ND	0.0500	1	12/27/23	01/03/24	
Total Xylenes	ND	0.0250	1	12/27/23	01/03/24	
<i>Surrogate: Bromofluorobenzene</i>		108 %	70-130	12/27/23	01/03/24	
<i>Surrogate: 1,2-Dichloroethane-d4</i>		93.5 %	70-130	12/27/23	01/03/24	
<i>Surrogate: Toluene-d8</i>		110 %	70-130	12/27/23	01/03/24	
Nonhalogenated Organics by EPA 8015D - GRO	mg/kg	mg/kg		Analyst: RAS		Batch: 2352012
Gasoline Range Organics (C6-C10)	ND	20.0	1	12/27/23	01/03/24	
<i>Surrogate: Bromofluorobenzene</i>		108 %	70-130	12/27/23	01/03/24	
<i>Surrogate: 1,2-Dichloroethane-d4</i>		93.5 %	70-130	12/27/23	01/03/24	
<i>Surrogate: Toluene-d8</i>		110 %	70-130	12/27/23	01/03/24	
Nonhalogenated Organics by EPA 8015D - DRO/ORO	mg/kg	mg/kg		Analyst: KM		Batch: 2352022
Diesel Range Organics (C10-C28)	ND	25.0	1	12/28/23	12/30/23	
Oil Range Organics (C28-C36)	ND	50.0	1	12/28/23	12/30/23	
<i>Surrogate: n-Nonane</i>		91.5 %	50-200	12/28/23	12/30/23	
Anions by EPA 300.0/9056A	mg/kg	mg/kg		Analyst: DT		Batch: 2352011
Chloride	ND	20.0	1	12/27/23	12/29/23	



Sample Data

Matador Resources, LLC. 5400 LBJ Freeway, Suite 1500 Dallas TX, 75240	Project Name: Toque State Com Project Number: 23052-0001 Project Manager: Ashley Giovengo	Reported: 1/4/2024 12:38:13PM
---	---	---

FS05-0'

E312186-08

Analyte	Result	Reporting Limit	Dilution	Prepared	Analyzed	Notes
Volatile Organic Compounds by EPA 8260B	mg/kg	mg/kg		Analyst: RAS		Batch: 2352012
Benzene	ND	0.0250	1	12/27/23	01/03/24	
Ethylbenzene	ND	0.0250	1	12/27/23	01/03/24	
Toluene	ND	0.0250	1	12/27/23	01/03/24	
o-Xylene	ND	0.0250	1	12/27/23	01/03/24	
p,m-Xylene	ND	0.0500	1	12/27/23	01/03/24	
Total Xylenes	ND	0.0250	1	12/27/23	01/03/24	
<i>Surrogate: Bromofluorobenzene</i>		109 %	70-130	12/27/23	01/03/24	
<i>Surrogate: 1,2-Dichloroethane-d4</i>		93.8 %	70-130	12/27/23	01/03/24	
<i>Surrogate: Toluene-d8</i>		109 %	70-130	12/27/23	01/03/24	
Nonhalogenated Organics by EPA 8015D - GRO	mg/kg	mg/kg		Analyst: RAS		Batch: 2352012
Gasoline Range Organics (C6-C10)	ND	20.0	1	12/27/23	01/03/24	
<i>Surrogate: Bromofluorobenzene</i>		109 %	70-130	12/27/23	01/03/24	
<i>Surrogate: 1,2-Dichloroethane-d4</i>		93.8 %	70-130	12/27/23	01/03/24	
<i>Surrogate: Toluene-d8</i>		109 %	70-130	12/27/23	01/03/24	
Nonhalogenated Organics by EPA 8015D - DRO/ORO	mg/kg	mg/kg		Analyst: KM		Batch: 2352022
Diesel Range Organics (C10-C28)	ND	25.0	1	12/28/23	12/30/23	
Oil Range Organics (C28-C36)	ND	50.0	1	12/28/23	12/30/23	
<i>Surrogate: n-Nonane</i>		94.4 %	50-200	12/28/23	12/30/23	
Anions by EPA 300.0/9056A	mg/kg	mg/kg		Analyst: DT		Batch: 2352011
Chloride	ND	20.0	1	12/27/23	12/29/23	



Sample Data

Matador Resources, LLC. 5400 LBJ Freeway, Suite 1500 Dallas TX, 75240	Project Name: Toque State Com Project Number: 23052-0001 Project Manager: Ashley Giovengo	Reported: 1/4/2024 12:38:13PM
---	---	---

FS06-0'

E312186-09

Analyte	Result	Reporting Limit	Dilution	Prepared	Analyzed	Notes
Volatile Organic Compounds by EPA 8260B	mg/kg	mg/kg		Analyst: RAS		Batch: 2352012
Benzene	ND	0.0250	1	12/27/23	01/03/24	
Ethylbenzene	ND	0.0250	1	12/27/23	01/03/24	
Toluene	ND	0.0250	1	12/27/23	01/03/24	
o-Xylene	ND	0.0250	1	12/27/23	01/03/24	
p,m-Xylene	ND	0.0500	1	12/27/23	01/03/24	
Total Xylenes	ND	0.0250	1	12/27/23	01/03/24	
<i>Surrogate: Bromofluorobenzene</i>		108 %	70-130	12/27/23	01/03/24	
<i>Surrogate: 1,2-Dichloroethane-d4</i>		95.1 %	70-130	12/27/23	01/03/24	
<i>Surrogate: Toluene-d8</i>		106 %	70-130	12/27/23	01/03/24	
Nonhalogenated Organics by EPA 8015D - GRO	mg/kg	mg/kg		Analyst: RAS		Batch: 2352012
Gasoline Range Organics (C6-C10)	ND	20.0	1	12/27/23	01/03/24	
<i>Surrogate: Bromofluorobenzene</i>		108 %	70-130	12/27/23	01/03/24	
<i>Surrogate: 1,2-Dichloroethane-d4</i>		95.1 %	70-130	12/27/23	01/03/24	
<i>Surrogate: Toluene-d8</i>		106 %	70-130	12/27/23	01/03/24	
Nonhalogenated Organics by EPA 8015D - DRO/ORO	mg/kg	mg/kg		Analyst: KM		Batch: 2352022
Diesel Range Organics (C10-C28)	ND	25.0	1	12/28/23	12/30/23	
Oil Range Organics (C28-C36)	ND	50.0	1	12/28/23	12/30/23	
<i>Surrogate: n-Nonane</i>		89.3 %	50-200	12/28/23	12/30/23	
Anions by EPA 300.0/9056A	mg/kg	mg/kg		Analyst: DT		Batch: 2352011
Chloride	ND	20.0	1	12/27/23	12/29/23	



QC Summary Data

Matador Resources, LLC. 5400 LBJ Freeway, Suite 1500 Dallas TX, 75240	Project Name: Toque State Com Project Number: 23052-0001 Project Manager: Ashley Giovengo	Reported: 1/4/2024 12:38:13PM
---	---	---

Volatile Organic Compounds by EPA 8260B

Analyst: RAS

Analyte	Result mg/kg	Reporting Limit mg/kg	Spike Level mg/kg	Source Result mg/kg	Rec %	Rec Limits %	RPD %	RPD Limit %	Notes
---------	-----------------	-----------------------------	-------------------------	---------------------------	----------	--------------------	----------	-------------------	-------

Blank (2352012-BLK1)

Prepared: 12/27/23 Analyzed: 01/03/24

Benzene	ND	0.0250							
Ethylbenzene	ND	0.0250							
Toluene	ND	0.0250							
o-Xylene	ND	0.0250							
p,m-Xylene	ND	0.0500							
Total Xylenes	ND	0.0250							
Surrogate: Bromofluorobenzene	0.543		0.500		109	70-130			
Surrogate: 1,2-Dichloroethane-d4	0.471		0.500		94.1	70-130			
Surrogate: Toluene-d8	0.546		0.500		109	70-130			

LCS (2352012-BS1)

Prepared: 12/27/23 Analyzed: 01/03/24

Benzene	2.53	0.0250	2.50		101	70-130			
Ethylbenzene	2.64	0.0250	2.50		106	70-130			
Toluene	2.59	0.0250	2.50		104	70-130			
o-Xylene	2.69	0.0250	2.50		108	70-130			
p,m-Xylene	5.43	0.0500	5.00		109	70-130			
Total Xylenes	8.12	0.0250	7.50		108	70-130			
Surrogate: Bromofluorobenzene	0.559		0.500		112	70-130			
Surrogate: 1,2-Dichloroethane-d4	0.464		0.500		92.8	70-130			
Surrogate: Toluene-d8	0.543		0.500		109	70-130			

Matrix Spike (2352012-MS1)

Source: E312186-01

Prepared: 12/27/23 Analyzed: 01/03/24

Benzene	2.66	0.0250	2.50	ND	106	48-131			
Ethylbenzene	2.74	0.0250	2.50	ND	110	45-135			
Toluene	2.68	0.0250	2.50	ND	107	48-130			
o-Xylene	2.79	0.0250	2.50	ND	112	43-135			
p,m-Xylene	5.56	0.0500	5.00	ND	111	43-135			
Total Xylenes	8.35	0.0250	7.50	ND	111	43-135			
Surrogate: Bromofluorobenzene	0.555		0.500		111	70-130			
Surrogate: 1,2-Dichloroethane-d4	0.489		0.500		97.7	70-130			
Surrogate: Toluene-d8	0.534		0.500		107	70-130			

Matrix Spike Dup (2352012-MSD1)

Source: E312186-01

Prepared: 12/27/23 Analyzed: 01/03/24

Benzene	2.61	0.0250	2.50	ND	105	48-131	1.58	23	
Ethylbenzene	2.74	0.0250	2.50	ND	110	45-135	0.164	27	
Toluene	2.67	0.0250	2.50	ND	107	48-130	0.561	24	
o-Xylene	2.78	0.0250	2.50	ND	111	43-135	0.503	27	
p,m-Xylene	5.49	0.0500	5.00	ND	110	43-135	1.35	27	
Total Xylenes	8.26	0.0250	7.50	ND	110	43-135	1.07	27	
Surrogate: Bromofluorobenzene	0.561		0.500		112	70-130			
Surrogate: 1,2-Dichloroethane-d4	0.489		0.500		97.8	70-130			
Surrogate: Toluene-d8	0.537		0.500		107	70-130			



QC Summary Data

Matador Resources, LLC. 5400 LBJ Freeway, Suite 1500 Dallas TX, 75240	Project Name: Toque State Com Project Number: 23052-0001 Project Manager: Ashley Giovengo	Reported: 1/4/2024 12:38:13PM
---	---	---

Nonhalogenated Organics by EPA 8015D - GRO

Analyst: RAS

Analyte	Result mg/kg	Reporting Limit mg/kg	Spike Level mg/kg	Source Result mg/kg	Rec %	Rec Limits %	RPD %	RPD Limit %	Notes
---------	-----------------	-----------------------------	-------------------------	---------------------------	----------	--------------------	----------	-------------------	-------

Blank (2352012-BLK1)

Prepared: 12/27/23 Analyzed: 01/03/24

Gasoline Range Organics (C6-C10)	ND	20.0							
Surrogate: Bromofluorobenzene	0.543		0.500		109	70-130			
Surrogate: 1,2-Dichloroethane-d4	0.471		0.500		94.1	70-130			
Surrogate: Toluene-d8	0.546		0.500		109	70-130			

LCS (2352012-BS2)

Prepared: 12/27/23 Analyzed: 01/03/24

Gasoline Range Organics (C6-C10)	58.8	20.0	50.0		118	70-130			
Surrogate: Bromofluorobenzene	0.554		0.500		111	70-130			
Surrogate: 1,2-Dichloroethane-d4	0.485		0.500		97.0	70-130			
Surrogate: Toluene-d8	0.549		0.500		110	70-130			

Matrix Spike (2352012-MS2)

Source: E312186-01

Prepared: 12/27/23 Analyzed: 01/03/24

Gasoline Range Organics (C6-C10)	58.0	20.0	50.0	ND	116	70-130			
Surrogate: Bromofluorobenzene	0.548		0.500		110	70-130			
Surrogate: 1,2-Dichloroethane-d4	0.456		0.500		91.1	70-130			
Surrogate: Toluene-d8	0.544		0.500		109	70-130			

Matrix Spike Dup (2352012-MSD2)

Source: E312186-01

Prepared: 12/27/23 Analyzed: 01/03/24

Gasoline Range Organics (C6-C10)	57.1	20.0	50.0	ND	114	70-130	1.59	20	
Surrogate: Bromofluorobenzene	0.543		0.500		109	70-130			
Surrogate: 1,2-Dichloroethane-d4	0.473		0.500		94.5	70-130			
Surrogate: Toluene-d8	0.550		0.500		110	70-130			



QC Summary Data

Matador Resources, LLC. 5400 LBJ Freeway, Suite 1500 Dallas TX, 75240	Project Name: Toque State Com Project Number: 23052-0001 Project Manager: Ashley Giovengo	Reported: 1/4/2024 12:38:13PM
---	---	---

Nonhalogenated Organics by EPA 8015D - DRO/ORO

Analyst: KM

Analyte	Result mg/kg	Reporting Limit mg/kg	Spike Level mg/kg	Source Result mg/kg	Rec %	Rec Limits %	RPD %	RPD Limit %	Notes
---------	-----------------	-----------------------------	-------------------------	---------------------------	----------	--------------------	----------	-------------------	-------

Blank (2352022-BLK1)

Prepared: 12/28/23 Analyzed: 12/29/23

Diesel Range Organics (C10-C28)	ND	25.0							
Oil Range Organics (C28-C36)	ND	50.0							
Surrogate: <i>n</i> -Nonane	52.3		50.0		105	50-200			

LCS (2352022-BS1)

Prepared: 12/28/23 Analyzed: 12/29/23

Diesel Range Organics (C10-C28)	270	25.0	250		108	38-132			
Surrogate: <i>n</i> -Nonane	62.2		50.0		124	50-200			

Matrix Spike (2352022-MS1)

Source: E312186-03

Prepared: 12/28/23 Analyzed: 12/29/23

Diesel Range Organics (C10-C28)	258	25.0	250	ND	103	38-132			
Surrogate: <i>n</i> -Nonane	61.9		50.0		124	50-200			

Matrix Spike Dup (2352022-MSD1)

Source: E312186-03

Prepared: 12/28/23 Analyzed: 12/29/23

Diesel Range Organics (C10-C28)	268	25.0	250	ND	107	38-132	3.72	20	
Surrogate: <i>n</i> -Nonane	63.6		50.0		127	50-200			



QC Summary Data

Matador Resources, LLC. 5400 LBJ Freeway, Suite 1500 Dallas TX, 75240	Project Name: Toque State Com Project Number: 23052-0001 Project Manager: Ashley Giovengo	Reported: 1/4/2024 12:38:13PM
---	---	---

Anions by EPA 300.0/9056A

Analyst: DT

Analyte	Result mg/kg	Reporting Limit mg/kg	Spike Level mg/kg	Source Result mg/kg	Rec %	Rec Limits %	RPD %	RPD Limit %	Notes
---------	-----------------	-----------------------------	-------------------------	---------------------------	----------	--------------------	----------	-------------------	-------

Blank (2352011-BLK1)

Prepared: 12/27/23 Analyzed: 12/28/23

Chloride	ND	20.0							
----------	----	------	--	--	--	--	--	--	--

LCS (2352011-BS1)

Prepared: 12/27/23 Analyzed: 12/28/23

Chloride	251	20.0	250		100	90-110			
----------	-----	------	-----	--	-----	--------	--	--	--

Matrix Spike (2352011-MS1)

Source: E312171-22

Prepared: 12/27/23 Analyzed: 12/28/23

Chloride	6700	200	250	6520	69.7	80-120			M4
----------	------	-----	-----	------	------	--------	--	--	----

Matrix Spike Dup (2352011-MSD1)

Source: E312171-22

Prepared: 12/27/23 Analyzed: 12/28/23

Chloride	6680	200	250	6520	63.8	80-120	0.221	20	M4
----------	------	-----	-----	------	------	--------	-------	----	----

QC Summary Report Comment:

Calculations are based off of the raw (non-rounded) data. However, for reporting purposes all QC data is rounded to three significant figures. Therefore, hand calculated values may differ slightly.



Definitions and Notes

Matador Resources, LLC. 5400 LBJ Freeway, Suite 1500 Dallas TX, 75240	Project Name: Toque State Com Project Number: 23052-0001 Project Manager: Ashley Giovengo	Reported: 01/04/24 12:38
---	---	------------------------------------

M4 Matrix spike recovery value is suspect since the analyte concentration in the sample is disproportionate to the spike level. The associated LCS spike recovery was acceptable.

ND Analyte NOT DETECTED at or above the reporting limit

NR Not Reported

RPD Relative Percent Difference

DNI Did Not Ignite

DNR Did not react with the addition of acid or base.

Note (1): Methods marked with ** are non-accredited methods.

Note (2): Soil data is reported on an "as received" weight basis, unless reported otherwise.



Client: Matador Production Company.
 Project: Toque State Com
 Project Manager: Ashley Giovengo
 Address: 3122 National Parks Hwy
 City, State, Zip: Carlsbad NM, 88220
 Phone: 575-988-0055
 Email: agiovengo@ensolum.com
 Report due by:

Bill To
 Attention: Matador Production Company
 Address: on file
 City, State, Zip:
 Phone: (337)319-8398
 Email: clinton.talley@matadorresources.com

Lab Use Only
 Lab WO# E 312186
 Job Number 23052-0001

TAT
 1D 2D 3D Standard X

EPA Program
 CWA SDWA RCRA

Time Sampled	Date Sampled	Matrix	No. of Containers	Sample ID	Lab Number	TPH GRO/DRO/ORO by 8015	BTEX by 8021	VOC by 8260	Metals 6010	Chloride 300.0	BGDOC NM	GDOC TX	Remarks
0935	12/21/23	S	1	SS01A-0' SS04A-0'	1						X		
0936	12/21/23	S	1	SS03A-0' SS05-0'	2						X		
0938	12/21/23	S	1	SS04A-0' SS01A-0'	3						X		
0942	12/21/23	S	1	FS01-0'	4						X		
0944	12/21/23	S	1	FS02-0'	5						X		
0946	12/21/23	S	1	FS03-0'	6						X		
1226	12/21/23	S	1	FS04-0'	7						X		
1240	12/21/23	S	1	FS05-0'	8						X		
0953	12/21/23	S	1	FS06-0'	9						X		

Additional Instructions: Please CC: cburton@ensolum.com, agiovengo@ensolum.com, chadhilton@ensolum.com, ehaft@ensolum.com

I, (field sampler), attest to the validity and authenticity of this sample. I am aware that tampering with or intentionally mislabelling the sample location, date or time of collection is considered fraud and may be grounds for legal action.
 Sampled by: Chad Hamilton

Samples requiring thermal preservation must be received on ice the day they are sampled or received packed in ice at an avg temp above 0 but less than 6°C on subsequent days.

Relinquished by: (Signature)	Date	Time	Received by: (Signature)	Date	Time	Lab Use Only Received on ice: Y/ N T1 T2 T3 AVG Temp °C 4
<i>[Signature]</i>	12/22/23		<i>[Signature]</i>	12-22-23	0945	
Relinquished by: (Signature)	Date	Time	Received by: (Signature)	Date	Time	
<i>[Signature]</i>	12-22-23	1445	<i>[Signature]</i>	12-22-23	1800	
Relinquished by: (Signature)	Date	Time	Received by: (Signature)	Date	Time	
<i>[Signature]</i>	12-22-23	2400	<i>[Signature]</i>	12/21/23	8:00	

Sample Matrix: S - Soil, Sd - Solid, Sg - Sludge, A - Aqueous, O - Other
 Container Type: g - glass, p - poly/plastic, ag - amber glass, v - VOA

Note: Samples are discarded 30 days after results are reported unless other arrangements are made. Hazardous samples will be returned to client or disposed of at the client expense. The report for the analysis of the above samples is applicable only to those samples received by the laboratory with this COC. The liability of the laboratory is limited to the amount paid for on the report.

Envirotech Analytical Laboratory

Printed: 12/27/2023 11:19:45AM

Sample Receipt Checklist (SRC)

Instructions: Please take note of any NO checkmarks.

If we receive no response concerning these items within 24 hours of the date of this notice, all the samples will be analyzed as requested.

Client: Matador Resources, LLC. Date Received: 12/27/23 08:00 Work Order ID: E312186
Phone: (972) 371-5200 Date Logged In: 12/27/23 09:32 Logged In By: Jordan Montano
Email: agiovnngo@ensolum.com Due Date: 01/03/24 17:00 (4 day TAT)

Chain of Custody (COC)

- 1. Does the sample ID match the COC? Yes
2. Does the number of samples per sampling site location match the COC? Yes
3. Were samples dropped off by client or carrier? Yes
4. Was the COC complete, i.e., signatures, dates/times, requested analyses? Yes
5. Were all samples received within holding time? Yes

Carrier: Courier

Note: Analysis, such as pH which should be conducted in the field, i.e, 15 minute hold time, are not included in this discussion.

Comments/Resolution

Sample Turn Around Time (TAT)

- 6. Did the COC indicate standard TAT, or Expedited TAT? Yes

Sample Cooler

- 7. Was a sample cooler received? Yes
8. If yes, was cooler received in good condition? Yes
9. Was the sample(s) received intact, i.e., not broken? Yes
10. Were custody/security seals present? No
11. If yes, were custody/security seals intact? NA
12. Was the sample received on ice? If yes, the recorded temp is 4°C, i.e., 6°±2°C? Yes

Note: Thermal preservation is not required, if samples are received w/i 15 minutes of sampling

- 13. If no visible ice, record the temperature. Actual sample temperature: 4°C

Sample Container

- 14. Are aqueous VOC samples present? No
15. Are VOC samples collected in VOA Vials? NA
16. Is the head space less than 6-8 mm (pea sized or less)? NA
17. Was a trip blank (TB) included for VOC analyses? NA
18. Are non-VOC samples collected in the correct containers? Yes
19. Is the appropriate volume/weight or number of sample containers collected? Yes

Field Label

- 20. Were field sample labels filled out with the minimum information:
Sample ID? Yes
Date/Time Collected? Yes
Collectors name? Yes

Sample Preservation

- 21. Does the COC or field labels indicate the samples were preserved? No
22. Are sample(s) correctly preserved? NA
24. Is lab filtration required and/or requested for dissolved metals? No

Multiphase Sample Matrix

- 26. Does the sample have more than one phase, i.e., multiphase? No
27. If yes, does the COC specify which phase(s) is to be analyzed? NA

Subcontract Laboratory

- 28. Are samples required to get sent to a subcontract laboratory? No
29. Was a subcontract laboratory specified by the client and if so who? NA Subcontract Lab: NA

Client Instruction

Empty box for client instruction.

Signature of client authorizing changes to the COC or sample disposition.

Date



envirotech Inc.

Envirotech Analytical Laboratory

Printed: 12/14/2023 10:34:48AM

Sample Receipt Checklist (SRC)

Instructions: Please take note of any NO checkmarks.

If we receive no response concerning these items within 24 hours of the date of this notice, all the samples will be analyzed as requested.

Client: Matador Resources, LLC.	Date Received: 12/14/23 08:30	Work Order ID: E312098
Phone: (972) 371-5200	Date Logged In: 12/14/23 09:52	Logged In By: Alexa Michaels
Email: agiovnngo@ensolum.com	Due Date: 12/21/23 17:00 (5 day TAT)	

Chain of Custody (COC)

- 1. Does the sample ID match the COC? Yes
- 2. Does the number of samples per sampling site location match the COC? Yes
- 3. Were samples dropped off by client or carrier? Yes
- 4. Was the COC complete, i.e., signatures, dates/times, requested analyses? Yes
- 5. Were all samples received within holding time? Yes

Carrier: Courier

Note: Analysis, such as pH which should be conducted in the field, i.e, 15 minute hold time, are not included in this discussion.

Comments/Resolution

Sample Turn Around Time (TAT)

- 6. Did the COC indicate standard TAT, or Expedited TAT? Yes

Sample Cooler

- 7. Was a sample cooler received? Yes
- 8. If yes, was cooler received in good condition? Yes
- 9. Was the sample(s) received intact, i.e., not broken? Yes
- 10. Were custody/security seals present? No
- 11. If yes, were custody/security seals intact? NA
- 12. Was the sample received on ice? If yes, the recorded temp is 4°C, i.e., 6°±2°C? Yes

Note: Thermal preservation is not required, if samples are received w/i 15 minutes of sampling

- 13. If no visible ice, record the temperature. Actual sample temperature: 4°C

Sample Container

- 14. Are aqueous VOC samples present? No
- 15. Are VOC samples collected in VOA Vials? NA
- 16. Is the head space less than 6-8 mm (pea sized or less)? NA
- 17. Was a trip blank (TB) included for VOC analyses? NA
- 18. Are non-VOC samples collected in the correct containers? Yes
- 19. Is the appropriate volume/weight or number of sample containers collected? Yes

Field Label

- 20. Were field sample labels filled out with the minimum information:
 - Sample ID? Yes
 - Date/Time Collected? Yes
 - Collectors name? Yes

Sample Preservation

- 21. Does the COC or field labels indicate the samples were preserved? No
- 22. Are sample(s) correctly preserved? NA
- 24. Is lab filtration required and/or requested for dissolved metals? No

Multiphase Sample Matrix

- 26. Does the sample have more than one phase, i.e., multiphase? No
- 27. If yes, does the COC specify which phase(s) is to be analyzed? NA

Subcontract Laboratory

- 28. Are samples required to get sent to a subcontract laboratory? No
- 29. Was a subcontract laboratory specified by the client and if so who? NA Subcontract Lab: NA

Client Instruction

Signature of client authorizing changes to the COC or sample disposition.

Date



envirotech Inc.



APPENDIX F

Email Correspondence

From: [Ashley Giovengo](#)
To: clinton.talley@matadorresources.com
Cc: [Cole Burton](#); [Chad Hamilton](#); [Ethan Haft](#)
Subject: 48-hour Confirmation Sampling Notification Email - Matador - Toque State Com - Incident Number NRM2005655333
Date: Thursday, December 14, 2023 3:06:43 PM
Attachments: [image001.png](#)
[image002.png](#)
[image003.png](#)
[image004.png](#)

Hello,

We intend to collect confirmation samples at Matador Production Company's Toque State Com site (Incident Number NRM2005655333) on Thursday, December 21st. Please let us know if you will be onsite to oversee the sampling process.

Thanks,

The total sampling area is 1800 sq ft.
Time to commence is 09:00 am MST.
Estimated number of samples is 9.



Ashley Giovengo

Senior Engineer

575-988-0055

Ensolum, LLC

in f 

District I
 1625 N. French Dr., Hobbs, NM 88240
 Phone:(575) 393-6161 Fax:(575) 393-0720
District II
 811 S. First St., Artesia, NM 88210
 Phone:(575) 748-1283 Fax:(575) 748-9720
District III
 1000 Rio Brazos Rd., Aztec, NM 87410
 Phone:(505) 334-6178 Fax:(505) 334-6170
District IV
 1220 S. St Francis Dr., Santa Fe, NM 87505
 Phone:(505) 476-3470 Fax:(505) 476-3462

State of New Mexico
Energy, Minerals and Natural Resources
Oil Conservation Division
1220 S. St Francis Dr.
Santa Fe, NM 87505

QUESTIONS

Action 306314

QUESTIONS

Operator: MATADOR PRODUCTION COMPANY One Lincoln Centre Dallas, TX 75240	OGRID: 228937
	Action Number: 306314
	Action Type: [C-141] Remediation Closure Request C-141 (C-141-v-Closure)

QUESTIONS

Prerequisites	
Incident ID (n#)	nRM2005655333
Incident Name	NRM2005655333 TOQUE STATE COM @ 0
Incident Type	Release Other
Incident Status	Remediation Closure Report Received

Location of Release Source

Please answer all the questions in this group.

Site Name	TOQUE STATE COM
Date Release Discovered	02/19/2020
Surface Owner	State

Incident Details

Please answer all the questions in this group.

Incident Type	Release Other
Did this release result in a fire or is the result of a fire	Yes
Did this release result in any injuries	No
Has this release reached or does it have a reasonable probability of reaching a watercourse	No
Has this release endangered or does it have a reasonable probability of endangering public health	No
Has this release substantially damaged or will it substantially damage property or the environment	No
Is this release of a volume that is or may with reasonable probability be detrimental to fresh water	No

Nature and Volume of Release

Material(s) released, please answer all that apply below. Any calculations or specific justifications for the volumes provided should be attached to the follow-up C-141 submission.

Crude Oil Released (bbls) Details	Not answered.
Produced Water Released (bbls) Details	Not answered.
Is the concentration of chloride in the produced water >10,000 mg/l	Not answered.
Condensate Released (bbls) Details	Not answered.
Natural Gas Vented (Mcf) Details	Not answered.
Natural Gas Flared (Mcf) Details	Not answered.
Other Released Details	Cause: Fire Other (Specify) Other (Specify) Released: 0 MCF (Unknown Released Amount) Recovered: 0 MCF Lost: 0 MCF.
Are there additional details for the questions above (i.e. any answer containing Other, Specify, Unknown, and/or Fire, or any negative lost amounts)	Not answered.

District I
 1625 N. French Dr., Hobbs, NM 88240
 Phone:(575) 393-6161 Fax:(575) 393-9720
District II
 811 S. First St., Artesia, NM 88210
 Phone:(575) 748-1283 Fax:(575) 748-9720
District III
 1000 Rio Brazos Rd., Aztec, NM 87410
 Phone:(505) 334-6178 Fax:(505) 334-6170
District IV
 1220 S. St Francis Dr., Santa Fe, NM 87505
 Phone:(505) 476-3470 Fax:(505) 476-3462

State of New Mexico
Energy, Minerals and Natural Resources
Oil Conservation Division
1220 S. St Francis Dr.
Santa Fe, NM 87505

QUESTIONS, Page 2

Action 306314

QUESTIONS (continued)

Operator: MATADOR PRODUCTION COMPANY One Lincoln Centre Dallas, TX 75240	OGRID: 228937
	Action Number: 306314
	Action Type: [C-141] Remediation Closure Request C-141 (C-141-v-Closure)

QUESTIONS

Nature and Volume of Release (continued)	
Is this a gas only submission (i.e. only significant Mcf values reported)	Yes, according to supplied volumes this appears to be a "gas only" report.
Was this a major release as defined by Subsection A of 19.15.29.7 NMAC	Yes
Reasons why this would be considered a submission for a notification of a major release	From paragraph A. "Major release" determine using: (2) an unauthorized release of a volume that: (a) results in a fire or is the result of a fire; (3) an unauthorized release of gases exceeding 500 MCF.
<i>With the implementation of the 19.15.27 NMAC (05/25/2021), venting and/or flaring of natural gas (i.e. gas only) are to be submitted on the C-129 form.</i>	

Initial Response

The responsible party must undertake the following actions immediately unless they could create a safety hazard that would result in injury.

The source of the release has been stopped	True
The impacted area has been secured to protect human health and the environment	True
Released materials have been contained via the use of berms or dikes, absorbent pads, or other containment devices	True
All free liquids and recoverable materials have been removed and managed appropriately	True
If all the actions described above have not been undertaken, explain why	<i>Not answered.</i>

Per Paragraph (4) of Subsection B of 19.15.29.8 NMAC the responsible party may commence remediation immediately after discovery of a release. If remediation has begun, please prepare and attach a narrative of actions to date in the follow-up C-141 submission. If remedial efforts have been successfully completed or if the release occurred within a lined containment area (see Subparagraph (a) of Paragraph (5) of Subsection A of 19.15.29.11 NMAC), please prepare and attach all information needed for closure evaluation in the follow-up C-141 submission.

I hereby certify that the information given above is true and complete to the best of my knowledge and understand that pursuant to OCD rules and regulations all operators are required to report and/or file certain release notifications and perform corrective actions for releases which may endanger public health or the environment. The acceptance of a C-141 report by the OCD does not relieve the operator of liability should their operations have failed to adequately investigate and remediate contamination that pose a threat to groundwater, surface water, human health or the environment. In addition, OCD acceptance of a C-141 report does not relieve the operator of responsibility for compliance with any other federal, state, or local laws and/or regulations.

I hereby agree and sign off to the above statement	Name: Clint Talley Title: Assistant Foreman Email: clinton.talley@matadorresources.com Date: 01/22/2024
--	--

District I
1625 N. French Dr., Hobbs, NM 88240
Phone:(575) 393-6161 Fax:(575) 393-0720

District II
811 S. First St., Artesia, NM 88210
Phone:(575) 748-1283 Fax:(575) 748-9720

District III
1000 Rio Brazos Rd., Aztec, NM 87410
Phone:(505) 334-6178 Fax:(505) 334-6170

District IV
1220 S. St Francis Dr., Santa Fe, NM 87505
Phone:(505) 476-3470 Fax:(505) 476-3462

State of New Mexico
Energy, Minerals and Natural Resources
Oil Conservation Division
1220 S. St Francis Dr.
Santa Fe, NM 87505

QUESTIONS (continued)

Operator: MATADOR PRODUCTION COMPANY One Lincoln Centre Dallas, TX 75240	OGRID: 228937
	Action Number: 306314
	Action Type: [C-141] Remediation Closure Request C-141 (C-141-v-Closure)

QUESTIONS

Site Characterization
Please answer all the questions in this group (only required when seeking remediation plan approval and beyond). This information must be provided to the appropriate district office no later than 90 days after the release discovery date.

What is the shallowest depth to groundwater beneath the area affected by the release in feet below ground surface (ft bgs)	Between 51 and 75 (ft.)
What method was used to determine the depth to ground water	NM OSE iWaters Database Search
Did this release impact groundwater or surface water	No
What is the minimum distance, between the closest lateral extents of the release and the following surface areas:	
A continuously flowing watercourse or any other significant watercourse	Between 1/2 and 1 (mi.)
Any lakebed, sinkhole, or playa lake (measured from the ordinary high-water mark)	Greater than 5 (mi.)
An occupied permanent residence, school, hospital, institution, or church	Greater than 5 (mi.)
A spring or a private domestic fresh water well used by less than five households for domestic or stock watering purposes	Greater than 5 (mi.)
Any other fresh water well or spring	Greater than 5 (mi.)
Incorporated municipal boundaries or a defined municipal fresh water well field	Greater than 5 (mi.)
A wetland	Between 1 and 5 (mi.)
A subsurface mine	Greater than 5 (mi.)
An (non-karst) unstable area	Greater than 5 (mi.)
Categorize the risk of this well / site being in a karst geology	Low
A 100-year floodplain	Greater than 5 (mi.)
Did the release impact areas not on an exploration, development, production, or storage site	No

Remediation Plan

Please answer all the questions that apply or are indicated. This information must be provided to the appropriate district office no later than 90 days after the release discovery date.

Requesting a remediation plan approval with this submission	Yes
<i>Attach a comprehensive report demonstrating the lateral and vertical extents of soil contamination associated with the release have been determined, pursuant to 19.15.29.11 NMAC and 19.15.29.13 NMAC.</i>	
Have the lateral and vertical extents of contamination been fully delineated	Yes
Was this release entirely contained within a lined containment area	No

Soil Contamination Sampling: (Provide the highest observable value for each, in milligrams per kilograms.)

Chloride (EPA 300.0 or SM4500 Cl B)	520
TPH (GRO+DRO+MRO) (EPA SW-846 Method 8015M)	37
GRO+DRO (EPA SW-846 Method 8015M)	37
BTEX (EPA SW-846 Method 8021B or 8260B)	0
Benzene (EPA SW-846 Method 8021B or 8260B)	0

Per Subsection B of 19.15.29.11 NMAC unless the site characterization report includes completed efforts at remediation, the report must include a proposed remediation plan in accordance with 19.15.29.12 NMAC, which includes the anticipated timelines for beginning and completing the remediation.

On what estimated date will the remediation commence	12/12/2023
On what date will (or did) the final sampling or liner inspection occur	12/21/2023
On what date will (or was) the remediation complete(d)	12/21/2023
What is the estimated surface area (in square feet) that will be reclaimed	0
What is the estimated volume (in cubic yards) that will be reclaimed	0
What is the estimated surface area (in square feet) that will be remediated	0
What is the estimated volume (in cubic yards) that will be remediated	0

These estimated dates and measurements are recognized to be the best guess or calculation at the time of submission and may (be) change(d) over time as more remediation efforts are completed.

The OCD recognizes that proposed remediation measures may have to be minimally adjusted in accordance with the physical realities encountered during remediation. If the responsible party has any need to significantly deviate from the remediation plan proposed, then it should consult with the division to determine if another remediation plan submission is required.

District I
 1625 N. French Dr., Hobbs, NM 88240
 Phone:(575) 393-6161 Fax:(575) 393-0720
District II
 811 S. First St., Artesia, NM 88210
 Phone:(575) 748-1283 Fax:(575) 748-9720
District III
 1000 Rio Brazos Rd., Aztec, NM 87410
 Phone:(505) 334-6178 Fax:(505) 334-6170
District IV
 1220 S. St Francis Dr., Santa Fe, NM 87505
 Phone:(505) 476-3470 Fax:(505) 476-3462

State of New Mexico
Energy, Minerals and Natural Resources
Oil Conservation Division
1220 S. St Francis Dr.
Santa Fe, NM 87505

QUESTIONS, Page 4

Action 306314

QUESTIONS (continued)

Operator: MATADOR PRODUCTION COMPANY One Lincoln Centre Dallas, TX 75240	OGRID: 228937
	Action Number: 306314
	Action Type: [C-141] Remediation Closure Request C-141 (C-141-v-Closure)

QUESTIONS

Remediation Plan (continued)

Please answer all the questions that apply or are indicated. This information must be provided to the appropriate district office no later than 90 days after the release discovery date.

This remediation will (or is expected to) utilize the following processes to remediate / reduce contaminants:

(Select all answers below that apply.)

(Ex Situ) Excavation and off-site disposal (i.e. dig and haul, hydrovac, etc.)	Yes
Which OCD approved facility will be used for off-site disposal	Not answered.
OR which OCD approved well (API) will be used for off-site disposal	Not answered.
OR is the off-site disposal site, to be used, out-of-state	Not answered.
OR is the off-site disposal site, to be used, an NMED facility	Yes
What is the name of the NMED facility	R360
(Ex Situ) Excavation and on-site remediation (i.e. On-Site Land Farms)	Not answered.
(In Situ) Soil Vapor Extraction	Not answered.
(In Situ) Chemical processing (i.e. Soil Shredding, Potassium Permanganate, etc.)	Not answered.
(In Situ) Biological processing (i.e. Microbes / Fertilizer, etc.)	Not answered.
(In Situ) Physical processing (i.e. Soil Washing, Gypsum, Disking, etc.)	Not answered.
Ground Water Abatement pursuant to 19.15.30 NMAC	Not answered.
OTHER (Non-listed remedial process)	Not answered.

Per Subsection B of 19.15.29.11 NMAC unless the site characterization report includes completed efforts at remediation, the report must include a proposed remediation plan in accordance with 19.15.29.12 NMAC, which includes the anticipated timelines for beginning and completing the remediation.

I hereby certify that the information given above is true and complete to the best of my knowledge and understand that pursuant to OCD rules and regulations all operators are required to report and/or file certain release notifications and perform corrective actions for releases which may endanger public health or the environment. The acceptance of a C-141 report by the OCD does not relieve the operator of liability should their operations have failed to adequately investigate and remediate contamination that pose a threat to groundwater, surface water, human health or the environment. In addition, OCD acceptance of a C-141 report does not relieve the operator of responsibility for compliance with any other federal, state, or local laws and/or regulations.

I hereby agree and sign off to the above statement	Name: Clint Talley Title: Assistant Foreman Email: clinton.talley@matadorresources.com Date: 01/22/2024
--	--

The OCD recognizes that proposed remediation measures may have to be minimally adjusted in accordance with the physical realities encountered during remediation. If the responsible party has any need to significantly deviate from the remediation plan proposed, then it should consult with the division to determine if another remediation plan submission is required.

District I
 1625 N. French Dr., Hobbs, NM 88240
 Phone:(575) 393-6161 Fax:(575) 393-0720

District II
 811 S. First St., Artesia, NM 88210
 Phone:(575) 748-1283 Fax:(575) 748-9720

District III
 1000 Rio Brazos Rd., Aztec, NM 87410
 Phone:(505) 334-6178 Fax:(505) 334-6170

District IV
 1220 S. St Francis Dr., Santa Fe, NM 87505
 Phone:(505) 476-3470 Fax:(505) 476-3462

State of New Mexico
Energy, Minerals and Natural Resources
Oil Conservation Division
1220 S. St Francis Dr.
Santa Fe, NM 87505

QUESTIONS, Page 5

Action 306314

QUESTIONS (continued)

Operator: MATADOR PRODUCTION COMPANY One Lincoln Centre Dallas, TX 75240	OGRID: 228937
	Action Number: 306314
	Action Type: [C-141] Remediation Closure Request C-141 (C-141-v-Closure)

QUESTIONS

Deferral Requests Only	
<i>Only answer the questions in this group if seeking a deferral upon approval this submission. Each of the following items must be confirmed as part of any request for deferral of remediation.</i>	
Requesting a deferral of the remediation closure due date with the approval of this submission	No

District I
 1625 N. French Dr., Hobbs, NM 88240
 Phone:(575) 393-6161 Fax:(575) 393-0720
District II
 811 S. First St., Artesia, NM 88210
 Phone:(575) 748-1283 Fax:(575) 748-9720
District III
 1000 Rio Brazos Rd., Aztec, NM 87410
 Phone:(505) 334-6178 Fax:(505) 334-6170
District IV
 1220 S. St Francis Dr., Santa Fe, NM 87505
 Phone:(505) 476-3470 Fax:(505) 476-3462

State of New Mexico
Energy, Minerals and Natural Resources
Oil Conservation Division
1220 S. St Francis Dr.
Santa Fe, NM 87505

QUESTIONS (continued)

Operator: MATADOR PRODUCTION COMPANY One Lincoln Centre Dallas, TX 75240	OGRID: 228937
	Action Number: 306314
	Action Type: [C-141] Remediation Closure Request C-141 (C-141-v-Closure)

QUESTIONS

Sampling Event Information	
Last sampling notification (C-141N) recorded	294931
Sampling date pursuant to Subparagraph (a) of Paragraph (1) of Subsection D of 19.15.29.12 NMAC	12/21/2023
What was the (estimated) number of samples that were to be gathered	9
What was the sampling surface area in square feet	1800

Remediation Closure Request	
<i>Only answer the questions in this group if seeking remediation closure for this release because all remediation steps have been completed.</i>	
Requesting a remediation closure approval with this submission	Yes
Have the lateral and vertical extents of contamination been fully delineated	Yes
Was this release entirely contained within a lined containment area	No
All areas reasonably needed for production or subsequent drilling operations have been stabilized, returned to the sites existing grade, and have a soil cover that prevents ponding of water, minimizing dust and erosion	Yes
What was the total surface area (in square feet) remediated	0
What was the total volume (cubic yards) remediated	0
All areas not reasonably needed for production or subsequent drilling operations have been reclaimed to contain a minimum of four feet of non-waste contain earthen material with concentrations less than 600 mg/kg chlorides, 100 mg/kg TPH, 50 mg/kg BTEX, and 10 mg/kg Benzene	Yes
What was the total surface area (in square feet) reclaimed	0
What was the total volume (in cubic yards) reclaimed	0
Summarize any additional remediation activities not included by answers (above)	Site was recently acquired from other operator. Not sure if they had any additional remediation activities.

The responsible party must attach information demonstrating they have complied with all applicable closure requirements and any conditions or directives of the OCD. This demonstration should be in the form of a comprehensive report (in .pdf format) including a scaled site map, sampling diagrams, relevant field notes, photographs of any excavation prior to backfilling, laboratory data including chain of custody documents of final sampling, and a narrative of the remedial activities. Refer to 19.15.29.12 NMAC.

I hereby certify that the information given above is true and complete to the best of my knowledge and understand that pursuant to OCD rules and regulations all operators are required to report and/or file certain release notifications and perform corrective actions for releases which may endanger public health or the environment. The acceptance of a C-141 report by the OCD does not relieve the operator of liability should their operations have failed to adequately investigate and remediate contamination that pose a threat to groundwater, surface water, human health or the environment. In addition, OCD acceptance of a C-141 report does not relieve the operator of responsibility for compliance with any other federal, state, or local laws and/or regulations. The responsible party acknowledges they must substantially restore, reclaim, and re-vegetate the impacted surface area to the conditions that existed prior to the release or their final land use in accordance with 19.15.29.13 NMAC including notification to the OCD when reclamation and re-vegetation are complete.

I hereby agree and sign off to the above statement	Name: Clint Talley Title: Assistant Foreman Email: clinton.talley@matadorresources.com Date: 01/22/2024
--	--

District I
 1625 N. French Dr., Hobbs, NM 88240
 Phone:(575) 393-6161 Fax:(575) 393-0720

District II
 811 S. First St., Artesia, NM 88210
 Phone:(575) 748-1283 Fax:(575) 748-9720

District III
 1000 Rio Brazos Rd., Aztec, NM 87410
 Phone:(505) 334-6178 Fax:(505) 334-6170

District IV
 1220 S. St Francis Dr., Santa Fe, NM 87505
 Phone:(505) 476-3470 Fax:(505) 476-3462

State of New Mexico
Energy, Minerals and Natural Resources
Oil Conservation Division
1220 S. St Francis Dr.
Santa Fe, NM 87505

QUESTIONS, Page 7

Action 306314

QUESTIONS (continued)

Operator: MATADOR PRODUCTION COMPANY One Lincoln Centre Dallas, TX 75240	OGRID: 228937
	Action Number: 306314
	Action Type: [C-141] Remediation Closure Request C-141 (C-141-v-Closure)

QUESTIONS

Reclamation Report	
<i>Only answer the questions in this group if all reclamation steps have been completed.</i>	
Requesting a reclamation approval with this submission	No

District I
 1625 N. French Dr., Hobbs, NM 88240
 Phone:(575) 393-6161 Fax:(575) 393-0720

District II
 811 S. First St., Artesia, NM 88210
 Phone:(575) 748-1283 Fax:(575) 748-9720

District III
 1000 Rio Brazos Rd., Aztec, NM 87410
 Phone:(505) 334-6178 Fax:(505) 334-6170

District IV
 1220 S. St Francis Dr., Santa Fe, NM 87505
 Phone:(505) 476-3470 Fax:(505) 476-3462

State of New Mexico
Energy, Minerals and Natural Resources
Oil Conservation Division
1220 S. St Francis Dr.
Santa Fe, NM 87505

CONDITIONS
 Action 306314

CONDITIONS

Operator: MATADOR PRODUCTION COMPANY One Lincoln Centre Dallas, TX 75240	OGRID: 228937
	Action Number: 306314
	Action Type: [C-141] Remediation Closure Request C-141 (C-141-v-Closure)

CONDITIONS

Created By	Condition	Condition Date
nvelez	None	4/5/2024