



**EOG Resources, Inc.**  
Artesia Division Office  
104 S. 4<sup>th</sup> Street  
Artesia, N. M. 88210

December 21, 2023

NMOCD District II  
1301 W Grand Ave  
Artesia, NM

Re: Scripps #4  
30-015-24880  
M-25-18S-26E  
Eddy County, NM  
nRM2030860417

EOG Resources, Inc. hereby submits the enclosed Closure Report for the above referenced incident. This report provides all site characterization and background information, as well as the remedial actions completed for the release which occurred on October 16, 2020.

If you have any questions, feel free to call me at (575) 748-1471.

Respectfully,

*Chase Settle*

Chase Settle  
Rep Safety & Environmental Sr  
EOG Resources, Inc.

Scripps #4  
Closure Report  
nRM2030860417



December 21, 2023

---

**Scripps #4**  
**Closure Report**  
**30-015-24880**  
**M-25-18S-26E**  
**Eddy County, NM**  
**December 21, 2023**  
**nRM2030860417**

Scripps #4  
Closure Report  
nRM2030860417



December 21, 2023

**Table of Contents**

I.	Introduction.....	1
II.	Background.....	1
III.	GHD Remedial Activities.....	1
IV.	Ranger Remedial Activities.....	2
V.	Vertex Remedial Activities.....	2
VI.	nAUTOFAB000640 H&S Pit.....	3
VII.	nAPP2230460513 Silverback Release October 30, 2022.....	3
VIII.	Closure Request.....	4

**Figures**

- Figure 1: Site Map
- Figure 2: Vertex Sample Map
- Figure 3: Ranger Sample Map
- Figure 4: GHD Sample Map

**Table**

- Table 1: Vertex Analytical Table
- Table 2: Ranger Analytical Table
- Table 3: GHD Analytical Table

**Appendices:**

- Appendix A: C-141 Closure
- Appendix B: Release and Excavation Photos
- Appendix C: nAPP2230460513 Release Map
- Appendix D: nAPP2230460513 Impacts Photos
- Appendix E: Laboratory Analytical Reports
- Appendix F: Agency Notifications

Scripps #4  
Closure Report  
nRM2030860417



December 21, 2023

## I. Introduction

EOG Resources, Inc. (EOG), submits this Closure Report to the New Mexico Oil Conservation Division (NMOCD) District 2 Office. This report provides documentation of the remedial activities completed in the affected area at the Scripps #4 Release Site (Site). The Site is located in Unit Letter M, Section 25 of Township 18 South, Range 26 East in Eddy County, New Mexico (Figure 1). The GPS coordinates for the release area are 33.71318 N latitude and 104.34202 W longitude. The release occurred on surface privately owned. The sample locations and other Site details are depicted on Figures 2, 3, and 4.

## II. Background

On October 16, 2020, EOG Resources, Inc. (EOG) discovered a release of 7 barrels of produced water at the Site due to a transfer pump failure which caused the 210 barrel (bbl) produced water tank to overflow. A vacuum truck was dispatched upon discovery which was able to recover 3 bbls of produced water. As indicated by the initial photographs attached in Appendix B, all released fluids were contained within the secondary berm which isolated the 210 bbl tank from the other storage/production equipment in the bulk area of the battery.

In order to allow for full assessment and necessary remedial efforts at the Site, the 210 bbl produced water tank was removed from the battery.

Initial excavation activities were conducted under the supervision of GHD Services Inc. (GHD) which involved the removal of approximately a ½ foot of visually impacted soils. GHD then conducted soil testing with samples submitted to Envirotech Inc. Results of these samples are included in Table 3 (GHD Results Table) and all analytical reports were submitted with the Remediation Plan submitted on February 11, 2021.

On June 30, 2021, NMOCD approved the Remediation Plan which called for addressment using NMAC 19.15.29.12 Table 1 Closure Criteria (51-100 feet).

## III. GHD Remedial Activities

After approval of the Remediation Plan, EOG tasked GHD with the supervision of remedial activities to be completed at the site. GHD supervised the excavation of impacted soils within the release area to a depth of 4 feet below grade surface (bgs) to meet the reclamation soil requirements of NMAC 19.15.29.13. GHD also began further excavation of the sidewalls to determine the horizontal extents of the release.

On August 2, 2021, GHD collected additional soil samples from the SW-1A and SW-4 sidewalls, as well as advancing 2 exploratory sample points (TP1-2 & TP2-2) on the other side of the battery which was not impacted by the release. Upon collection, samples were submitted to Hall Environmental Analysis Laboratory under strict chain-of-custody (COC) protocols for analyzation of BTEX (EPA Method 8021B), TPH (EPA Method 8015D) and chloride (EPA Method 300.0). The samples were collected and managed using standard QA/QC and chain-of-custody procedures.

The SW-1A sidewall analytical results indicated no further work required in this area as the most stringent closure criteria were met for NMAC 19.15.29.12 & 13. SW-4 indicated that further excavation would be required as TPH and Chloride results both remained above the required closure criteria.

GHD conducted further supervision of excavation activities in the SW-4 sidewall area, then on October 8, 2021, performed a resampling of the over-excavated sidewall. SW-4A was collected and submitted to Hall Environmental Analysis Laboratory under strict chain-of-custody (COC) protocols for analyzation of BTEX (EPA Method 8021B), TPH (EPA Method 8015D) and chloride

energy opportunity growth

Scripps #4  
Closure Report  
nRM2030860417



December 21, 2023

(EPA Method 300.0). The samples were collected and managed using standard QA/QC and chain-of-custody procedures.

The SW-4A results indicated that further TPH exceedances still existed. However, the over-excavation activities had pushed the sidewall into the previous operator's production pit. This impacted area is governed by 19.15.30 NMAC and has had previous notification to NMOCD with an Abatement Plan previously enacted, nAUTOFAB000640. Further discussion of this Abatement Plan area is conducted in the nAUTOFAB000640 section below. All results associated with GHD confirmation sampling activities are included in Table 3 with sample locations attached as Figure 4.

#### **IV. Ranger Remedial Activities**

EOG engaged Ranger Environmental Services, Inc. (Ranger) to begin the process of reopening activities and addressment of nAUTOFAB000640 after no further correspondence on the site had occurred between NMOCD and Yates Petroleum Corporation (YPC) since 2005. Due to Ranger's activities with nAUTOFAB000640, EOG tasked Ranger with collecting confirmation samples at the Scripps #4 excavation site.

On October 26, 2023, Ranger mobilized to the Site to conduct confirmation sampling of the base excavation and sidewalls. Ranger personnel collected 13 confirmation soil samples at the Site, 10 base excavation and 3 sidewall. The samples were collected from various locations along the excavated base and sidewall areas as five-part composite samples in accordance with NMAC 19.15.29.12(D), with each sample representing no more than 200 square feet. Upon collection, confirmation soil samples were submitted to Hall Environmental in Albuquerque, New Mexico for analysis of TPH, BTEX, and total chloride using the aforementioned laboratory methods. The samples were collected and managed using standard QA/QC and chain-of-custody procedures.

Review of the laboratory analytical results concluded that all base areas of the excavation were noted to have BTEX, TPH, and chloride results within the applicable Table 1 Criteria. However, all 3 sidewall results indicated remaining impacts. The north sidewall (Ranger NW-1) was above Table 1 criteria for TPH, while the south sidewall and west sidewall (Ranger SW-1 & WW-1) had chloride concentration above Table 1 criteria. Ranger sample results have been attached in Table 2 with sample locations attached as Figure 3.

#### **V. Vertex Remedial Activities**

Due to scheduling conflicts with Ranger, Vertex Resource Services, Inc. (Vertex) was retained to address the west sidewall of the excavation. As the north sidewall excavation had already encroached into the nAUTOFAB000640 impacted area which falls under the guidelines of 19.15.30 NMAC and the south sidewall was encroached upon by a release incurred by the current operator of the Site, Silverback Operating II, LLC (Silverback), on October 30, 2022, no further activities were requested of Vertex as part of the addressment of this incident. Further discussion of both nAUTOFAB000640 and nAPP2230460513 are included in below sections.

Vertex supervised the further excavation of the west sidewall on December 4, 2023, with all excavated soils being hauled to NMOCD approved facility for disposal. Based on the completed excavation and field testing completed, Vertex mobilized to the site on December 5, 2023, to collect a confirmation sample for the west sidewall.

One sidewall confirmation sample (WES23-01) was required for collection based on the requirements of 19.15.29.12.D NMAC, with the sample taken as a five-part composite sample representing no more than 200 square feet. Upon collection, the confirmation soil sample was submitted to Hall Environmental in Albuquerque, New Mexico for analysis of TPH, BTEX, and chloride using the previously discussed laboratory methods. The sample was collected and managed using standard QA/QC and chain-of-custody procedures.

Scripps #4  
Closure Report  
nRM2030860417



December 21, 2023

Review of the laboratory analytical result concluded that the sidewall was noted to have BTEX, TPH, and chloride results within the applicable Table 1 Criteria. Vertex sample results have been attached in Table 1 with sample locations attached as Figure 2.

#### **VI. nAUTOFAB000640 H&S Pit**

The Scripp Pit is a historic oil and gas production pit formerly located at the Scripp Battery, an oil and gas production facility located on private land. The Scripp Battery is currently active and is being operated by Silverback Operating II (Silverback). Based on the site history and transaction history, EOG Resources, Inc. (EOG) maintains environmental responsibility for the impacts to native media at the Site.

The Scripp Battery was historically operated by H&S Oil Company (H&S) with an unlined earthen pit formerly utilized by H&S for oil and gas fluid storage/impoundment. In 1997, Yates Petroleum Corporation (YPC) acquired the Scripp Battery and associated pit from H&S. At the time of the acquisition, the subject pit remained open and was documented to have dimensions of approximately 90 feet by 65 feet by 10 feet deep. The pit was noted to be of earthen construction with no liner present.

While operated by YPC, the pit underwent closure and assessment of the former pit location was conducted. The pit closure and assessment activities completed by YPC documented impacts to the native media. Due to the documented conditions at the Site, coordination with the New Mexico Oil and Gas Division (NMOCD) was initiated. In September 2016, EOG acquired YPC and its associated assets including the Scripp Battery which included the subject Scripp Pit. Communication and coordination between the NMOCD and YPC regarding the subject pit continued until 2005 when a Stage I & II Abatement Plan was submitted to the NMOCD. Based on available information, no response was ever received from the NMOCD regarding this plan.

During the 2005 to 2023 timeframe, a total of 14 groundwater monitoring events were conducted at the site. During May 2021, additional soil investigation activities were completed at the site. EOG has engaged Ranger to assist in the continuation of the assessment and remediation efforts at the Site as well as to re-establish communications with the NMOCD regarding the site.

In May 2023, Ranger personnel established communications with the NMOCD, and began discussion of the site and the steps needed to bring the site into compliance with the current regulatory criteria and 19.15.30 New Mexico Administrative Code (NMAC) areas at the Site.

As the H&S Pit impacts predate the nRM2030860417 incident, and fall within the regulatory obligations of 19.15.30 NMAC, the northern sidewall of the excavation will be addressed during the remediation of the nAUTOFAB000640 incident.

#### **VII. nAPP2230460513 Silverback Release October 30, 2022**

During the 2021 divestiture of the Scripps Water Transfer and Scripps Battery to Silverback, EOG retained the remedial obligations for nRM2030860417. As stated previously, this release occurred October 16, 2020, impacting the area within the secondary berm for the 210 produced water tank. Activities completed by GHD after NMOCD approval of the remediation plan left a 4 foot excavation. However, a newly constructed earthen berm on the south side of the excavation was installed in an attempt to prevent further impacts to the excavated area if a release from the remaining active equipment in the primary berm were to occur.

On October 30, 2022, Silverback discovered a release at the site due to a failed tank inlet flow line. This failure resulted in an unknown volume of produced water to be released at the site. Silverback was able to recover 150 bbls of the released product according to the C-141 available on NMOCD's Online Imagery.

Scripps #4  
Closure Report  
nRM2030860417



December 21, 2023

Based on a map of the release impact area provided to EOG by Silverback (Appendix C), impacts were sustained within the battery, on the production pad, and in pasture adjacent to the access road. Impacts within the battery are noted to have encroached upon the earthen berm installed on the south side of the nRM2030860417 excavation area, as well as along the east side of the remaining storage tank wrapping around to the south side of the production tank (GHD sample points TP1 and TP2). Photographs taken after EOG's discovery that release had occurred are attached in Appendix D. These photographs illustrate that the release impacted the southern sidewall of the excavation, as well as the other areas discussed above.

Silverback as the current owner and operator of the site therefore retains liability for any impacts created by the October 2022 release, which includes the southern sidewall of the nRM2030860417 excavation. The most recent release (2022) supersedes the historical impact liability retained by EOG as it encroached on the previously excavated area. Based on the requirements of 19.15.29.12 NMAC, Silverback is responsible for the remediation of the areas impacted by the release which occurred in 2022 after they became the owner and operator of the site. Any residual impacts of the southern sidewall of the excavation will be addressed with the Silverback remediation activities as the nAPP2230460513 release contributed to impacts along the earthen berm constructed to protect the excavation from a release event.

#### **VIII. Closure Request**

All soils excavated during the remediation activities of the Site have been transported to a NMOCD approved facility for disposal.

Based on the results of confirmation samples from the base, east, and west sidewalls of the excavation being below the most stringent Table 1 Closure Criteria, as well as the encroachment by Silverback's most recent release superseding this incident and the excavation into the nAUTOFAB000640 pit area, EOG Resources, Inc. requests closure. Due to the most recent releases of the current operator and owner of site, Silverback Operating II, LLC, superseding the EOG liability for the south sidewall of this incident and the requirements of 19.15.30 NMAC as it relates to nAUTOFAB000640 and the north sidewall, EOG believes its remediation liability for this incident has been appropriately addressed with no substantial risk remaining to human health or the environment as both remaining sidewall areas will require addressment through the remaining open remedial projects. EOG will continue with current activities addressing nAUTOFAB000640 through the guidance provided by NMOCD based on 19.15.30 NMAC, these activities will provide any further remedial actions required to address the north sidewall area of this incident. And Silverback's compliance with NMAC 19.15.29 as the current operator of the site, will provide any remedial actions required for the west sidewall during their remediation activities for nAPP2230460513 which supersedes this incident. The site will be backfilled with caliche from a local source to recreate the pad for tank re-install as well as lined with 20 ml synthetic liner as stated in the approved Remediation Plan, the areas which have been excavated beyond the original battery footprint will be backfilled with topsoil to allow for vegetation reestablishment. The current C-141 Closure Form is included as Appendix A.

Scripps #4  
Closure Report  
nRM2030860417



December 21, 2023

---

# Figures



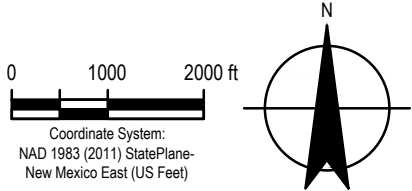
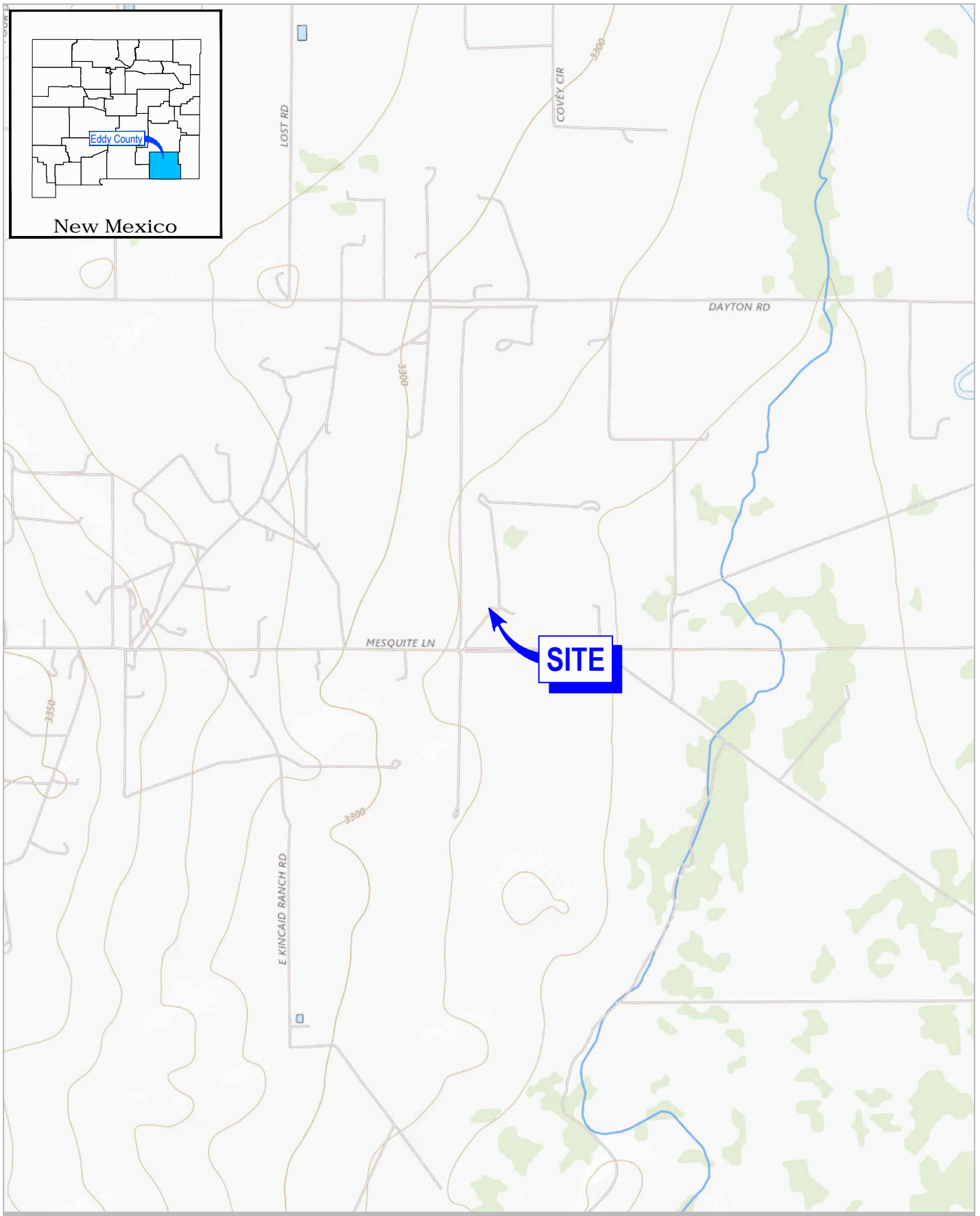

Coordinate System:  
 NAD 1983 (2011) StatePlane-  
 New Mexico East (US Feet)



**EOG RESOURCES**  
**EDDY COUNTY, NEW MEXICO**  
**SCRIPPS #4 BATTERY**

Project No. 11222059  
 Date January 2021

**SITE LOCATION MAP**

**FIGURE 1**

Document Path: C:\Users\scartan\Vertex Resource Group Ltd\Vertex US Operations - General\Environmental Services\10 - Geomatics\SPC\EOG 23E-06872 Scripps #4\Figure 1 Confirmatory Schematic 23E-06872 Req 17536 .mxd

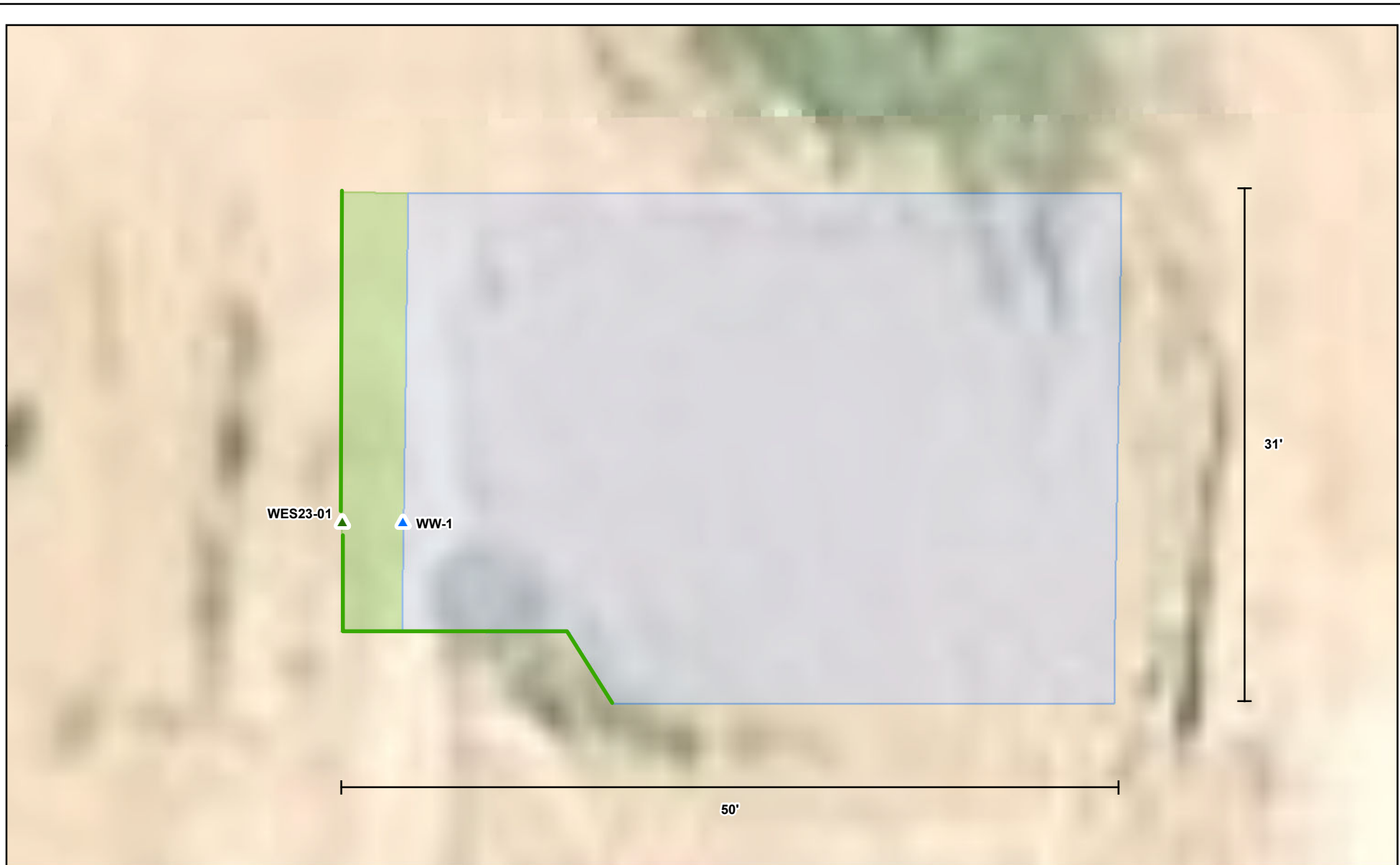

- ▲ Previous Sample
- ▲ Vertex Sample
- Previous Excavation (~1,283 sq.ft.)
- Vertex Excavation (~102 sq.ft.)

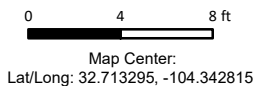

NAD 1983 UTM Zone 13N  
Date: Dec 12/23



**Vertex Confirmatory Schematic  
Scripps #4**

FIGURE:

**2**



Geospatial data presented in this figure may be derived from external sources and Vertex does not assume any liability for inaccuracies. This figure is intended for reference use only and is not certified for legal, survey, or engineering purposes.

Note: Georeferenced image from Esri, 2022. Approximate lease boundary from imagery by Vertex Professional Services Ltd. (Vertex), 2023. Site features from GPS, Vertex, 2023.

**VERSATILITY. EXPERTISE.**



**Legend**

- Excavation Sidewall Sample Area
- ⋯ Excavation Base Soil Samples

**Excavation Area**

- Light Purple Box Ramped (~0'-4' Deep)
- Light Green Box ~4' Deep

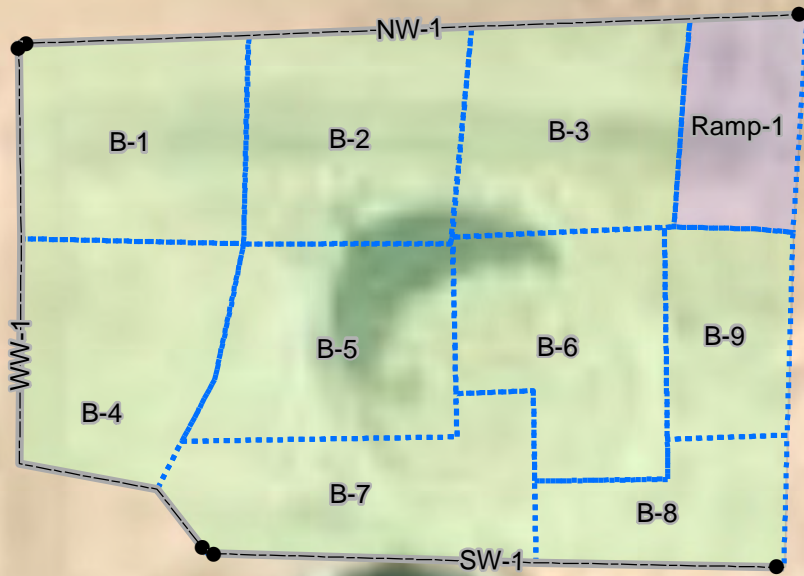

Esri, HERE, Garmin, (c) OpenStreetMap contributors, and the GIS user community  
Source: Esri, DigitalGlobe, GeoEye, Earthstar Geographics, CNES/Airbus DS, USDA, USGS, AeroGRID, IGN, and the GIS User Community

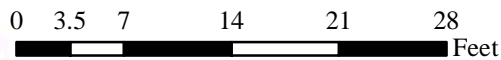

1:150

**Excavation Area and Sample Location Map**

Scripps #4  
EOG Resources, Inc.

# Scripps #4

Sample Map

## Legend

- Sidewall Samples
- Sidewall Samples
- Test Pits



50 ft

Scripps #4  
Closure Report  
nRM2030860417



December 21, 2023

---

# Tables

Client Name: EOG Resources, Inc.  
 Site Name: Scripps #4  
 NMOCD Tracking #: nRM2030860417  
 Project #: 23E-05872  
 Lab Report(sX): 2312368

Table 1. Confirmatory Sample Field Screen and Laboratory Results - Depth to Groundwater 51-100 feet bgs										
Sample Description			Petroleum Hydrocarbons						Inorganic	
Sample ID	Depth (ft)	Sample Date	Volatile		Extractable				Chloride Concentration	
			Benzene	BTEX (Total)	Gasoline Range Organics (GRO)	Diesel Range Organics (DRO)	Motor Oil Range Organics (MRO)	(GRO + DRO)		Total Petroleum Hydrocarbons (TPH)
			(mg/kg)	(mg/kg)	(mg/kg)	(mg/kg)	(mg/kg)	(mg/kg)		(mg/kg)
WES23-01	0-4	12/5/2023	ND	ND	ND	ND	ND	ND	ND	430

"ND" Not Detected at the Reporting Limit

**SOIL SAMPLE BTEX (EPA 8021), TPH (SW 8015) & CHLORIDE (EPA 300) ANALYTICAL DATA**  
**EOG RESOURCES, INC.**  
**SCRIPPS #4**

All values presented in parts per million (mg/Kg)

SAMPLE ID	DATE	DEPTH (FT)	BENZENE	TOLUENE	ETHYL-BENZENE	TOTAL XYLENES	TOTAL BTEX	TPH GRO C6-C10	TPH DRO C10-C28	TPH MRO C28-C36	TPH (GRO+DRO)	TPH (GRO+DRO+MRO)	CHLORIDE
<i>Excavation Base Soil Samples</i>													
B-1	10/26/2023	4'	<0.024	<0.049	<0.049	<0.097	<0.10	<4.9	<9.6	<48	<9.6	<48	<60
B-2	10/26/2023	4'	<0.024	<0.049	<0.049	<0.097	<0.10	<4.9	<9.8	<49	<9.8	<49	<60
B-3	10/26/2023	4'	<0.024	<0.048	<0.048	<0.097	<0.10	<4.8	<9.6	<48	<9.6	<48	<60
B-4	10/26/2023	4'	<0.024	<0.049	<0.049	<0.098	<0.10	<4.9	<9.2	<46	<9.2	<46	<60
B-5	10/26/2023	4'	<0.025	<0.049	<0.049	<0.099	<0.10	<4.9	<9.9	<50	<9.9	<50	<60
B-6	10/26/2023	4'	<0.024	<0.049	<0.049	<0.098	<0.10	<4.9	<9.4	<47	<9.4	<47	<60
B-7	10/26/2023	4'	<0.025	<0.049	<0.049	<0.098	<0.10	<4.9	<9.6	<48	<9.6	<48	<60
B-8	10/26/2023	4'	<0.024	<0.048	<0.048	<0.095	<0.10	<4.8	<9.5	<47	<9.5	<47	84
B-9	10/26/2023	4'	<0.024	<0.049	<0.049	<0.098	<0.10	<4.9	<9.2	<46	<9.2	<46	<60
Ramp-1	10/26/2023	0'-4'	<0.025	<0.050	<0.050	<0.099	<0.10	<5.0	<9.4	<47	<9.4	<47	<60
<i>Excavation Sidewall Soil Samples</i>													
NW-1	10/26/2023	0'-4'	<0.025	<0.050	<0.050	<0.10	<0.10	<5.0	380	580	380	<b>960</b>	220
SW-1	10/26/2023	0'-4'	<0.024	<0.048	<0.048	<0.097	<0.10	<4.9	<9.6	<48	<9.6	<48	<b>8,200</b>
WW-1	10/26/2023	0'-4'	<0.025	<0.049	<0.049	<0.099	<0.10	<4.9	<9.7	<48	<9.7	<48	<b>3,700</b>
<b>19.15.29.12 NMAC Table 1 Closure Criteria for Soils Impacted by a Release (GW ≤ 50')</b>			<b>10</b>	---	---	---	<b>50</b>	---	---	---	---	<b>100</b>	<b>600</b>
<b>19.15.29.13 NMAC Reclamation Criteria (0'-4' Soils Only)</b>			<b>10<sup>3</sup></b>	---	---	---	<b>50<sup>3</sup></b>	---	---	---	---	<b>100<sup>3</sup></b>	<b>600</b>
<b>Notes:</b>													
1. Results exceeding the Table 1 Closure Criteria are presented in bold type and are highlighted yellow.													
2. Results exceeding the NMAC Restoration, Reclamation and re-vegetation chloride concentration requirements are presented in bold red type.													
3. Value derived from the State of New Mexico Energy, Minerals and Natural Resources Department document Procedures for the Implementation of the Spill Rule (19.15.29 NMAC) dated September 6, 2019.													

**Table 1**  
**Summary of Soil Analytical Data**  
**Scripps #4**  
**EOG Resources**  
**Eddy County, New Mexico**

Sample ID	Sample Date	Depth (feet bgs)	Benzene (mg/Kg)	Toluene (mg/Kg)	Ethylbenzene (mg/Kg)	Xylenes (mg/Kg)	BTEX (mg/Kg)	TPH				Chloride (mg/Kg)
								GRO (C6-C10) (mg/Kg)	DRO (C10-C28) (mg/Kg)	MRO (C28-C35) (mg/Kg)	Total GRO/DRO/MRO (mg/Kg)	
								Table 1 Closure Criteria for Soils <50 feet Depth to Groundwater 19.15.29 NMAC				
			10 mg/Kg	---	---	---	50 mg/Kg	1,000 mg/Kg	---	2,500 mg/Kg	10,000 mg/Kg	
<b>Excavation Floor Samples</b>												
B-1	12/17/2020	0-0.5	<0.0250	<0.0250	<0.0250	<0.0250	<0.0250	<20.0	<25.0	<50.0	<50.0	<b>8,000</b>
B-2	12/17/2020	0-0.5	<0.0250	<0.0250	<0.0250	<0.0250	<0.0250	<20.0	<25.0	<50.0	<50.0	<b>5,290</b>
B-3	12/17/2020	0-0.5	<0.0250	<0.0250	<0.0250	<0.0250	<0.0250	<20.0	<25.0	<50.0	<50.0	<b>1,330</b>
B-4	12/17/2020	0-0.5	<0.0250	<0.0250	<0.0250	<0.0250	<0.0250	<20.0	26.2	<50.0	26.2	<b>1,620</b>
B-5	12/17/2020	0-0.5	<0.0250	<0.0250	<0.0250	<0.0250	<0.0250	<20.0	<25.0	<50.0	<50.0	<b>4,030</b>
B-6	12/17/2020	0-0.5	<0.0250	<0.0250	<0.0250	<0.0250	<0.0250	<20.0	582	496	1,078	<b>4,720</b>
<b>Test Pit Samples</b>												
TP1-2	8/2/2021	2	<0.024	<0.047	<0.047	<0.094	<0.094	<4.7	<9.6	<48	<48	<b>2,300</b>
TP2-2	8/2/2021	2	<0.024	<0.048	<0.048	<0.095	<0.095	<4.8	<9.8	<49	<49	<b>140</b>
<b>Sidewall Samples</b>												
SW-1	12/17/2020	-	<0.0250	<0.0250	<0.0250	<0.0250	<0.0250	<20.0	<25.0	<50.0	<50.0	<b>13,700</b>
SW-1A	8/2/2021	-	<0.023	<0.047	<0.047	<0.093	<0.093	<4.7	<9.5	<48	<48	<b>600</b>
SW-2	12/17/2020	-	<0.0250	<0.0250	<0.0250	<0.0250	<0.0250	<20.0	<25.0	<50.0	<50.0	<b>8,930</b>
SW-3	12/17/2020	-	<0.0250	<0.0250	<0.0250	<0.0250	<0.0250	<20.0	463	460	923	<b>5,530</b>
SW-4	8/2/2021	-	<0.024	<0.048	<0.048	<0.097	<0.097	<4.8	<b>540</b>	<b>940</b>	<b>1,480</b>	<b>800</b>

Notes:

1. Values reported in mg/kg
2. < = Value Less than Reporting Limit (RL)
3. Bold Indicates Analyte Detected
4. BTEX analyses by EPA Method SW 8021B.
5. TPH analyses by EPA Method SW 8015 Mod.
6. GRO/DRO/MRO = Gasoline/Diesel/Motor Oil
7. Yellow shaded cells indicate analytical samples that exceed the NMOC 19.15.29.12 Table 1 Closure Criteria for the site.
8. J - the target analytes was positively identified below the quantitation limit and above the detection limit.

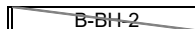
 Sample Point Excavated



Scripps #4  
Closure Report  
nRM2030860417



December 21, 2023

---

# Appendix A

## C-141 Closure

Incident ID	
District RP	nRM2030860417
Facility ID	
Application ID	

## Closure

The responsible party must attach information demonstrating they have complied with all applicable closure requirements and any conditions or directives of the OCD. This demonstration should be in the form of a comprehensive report (electronic submittals in .pdf format are preferred) including a scaled site map, sampling diagrams, relevant field notes, photographs of any excavation prior to backfilling, laboratory data including chain of custody documents of final sampling, and a narrative of the remedial activities. Refer to 19.15.29.12 NMAC.

**Closure Report Attachment Checklist:** *Each of the following items must be included in the closure report.*

- A scaled site and sampling diagram as described in 19.15.29.11 NMAC
- Photographs of the remediated site prior to backfill or photos of the liner integrity if applicable (Note: appropriate OCD District office must be notified 2 days prior to liner inspection)
- Laboratory analyses of final sampling (Note: appropriate ODC District office must be notified 2 days prior to final sampling)
- Description of remediation activities

I hereby certify that the information given above is true and complete to the best of my knowledge and understand that pursuant to OCD rules and regulations all operators are required to report and/or file certain release notifications and perform corrective actions for releases which may endanger public health or the environment. The acceptance of a C-141 report by the OCD does not relieve the operator of liability should their operations have failed to adequately investigate and remediate contamination that pose a threat to groundwater, surface water, human health or the environment. In addition, OCD acceptance of a C-141 report does not relieve the operator of responsibility for compliance with any other federal, state, or local laws and/or regulations. The responsible party acknowledges they must substantially restore, reclaim, and re-vegetate the impacted surface area to the conditions that existed prior to the release or their final land use in accordance with 19.15.29.13 NMAC including notification to the OCD when reclamation and re-vegetation are complete.

Printed Name: Chase Settle Title: Rep Safety & Environmental Sr  
 Signature: Chase Settle Date: 12/21/2023  
 email: Chase\_Settle@eogresources.com Telephone: 575-748-1471

**OCD Only**

Received by: \_\_\_\_\_ Date: \_\_\_\_\_

Closure approval by the OCD does not relieve the responsible party of liability should their operations have failed to adequately investigate and remediate contamination that poses a threat to groundwater, surface water, human health, or the environment nor does not relieve the responsible party of compliance with any other federal, state, or local laws and/or regulations.

Closure Approved by: \_\_\_\_\_ Date: \_\_\_\_\_

Printed Name: \_\_\_\_\_ Title: \_\_\_\_\_

Scripps #4  
Closure Report  
nRM2030860417



December 21, 2023

---

# Appendix B

## Release & Excavation Photos

# Initial Release Photos



# Excavation Photos



12/12/2023 7:35:02 AM (-7.0 hrs) Dir=SW Lat=32.71339 Lon=-104.34273 Alt=3300ft MSL WGS 1984



12/12/2023 7:35:10 AM (-7.0 hrs) Dir=SSW Lat=32.71338 Lon=-104.34274 Alt=3292ft MSL WGS 1984



12/12/2023 7:35:12 AM (-7.0 hrs) Dir=SW Lat=32.71338 Lon=-104.34274 Alt=3292ft MSL WGS 1984



12/12/2023 7:35:25 AM (-7.0 hrs) Dir=WSW Lat=32.71335 Lon=-104.34273 Alt=3286ft MSL WGS 1984



Scripps #4  
Closure Report  
nRM2030860417



December 21, 2023

---

# Appendix C

## nAPP2230460513 Release Map

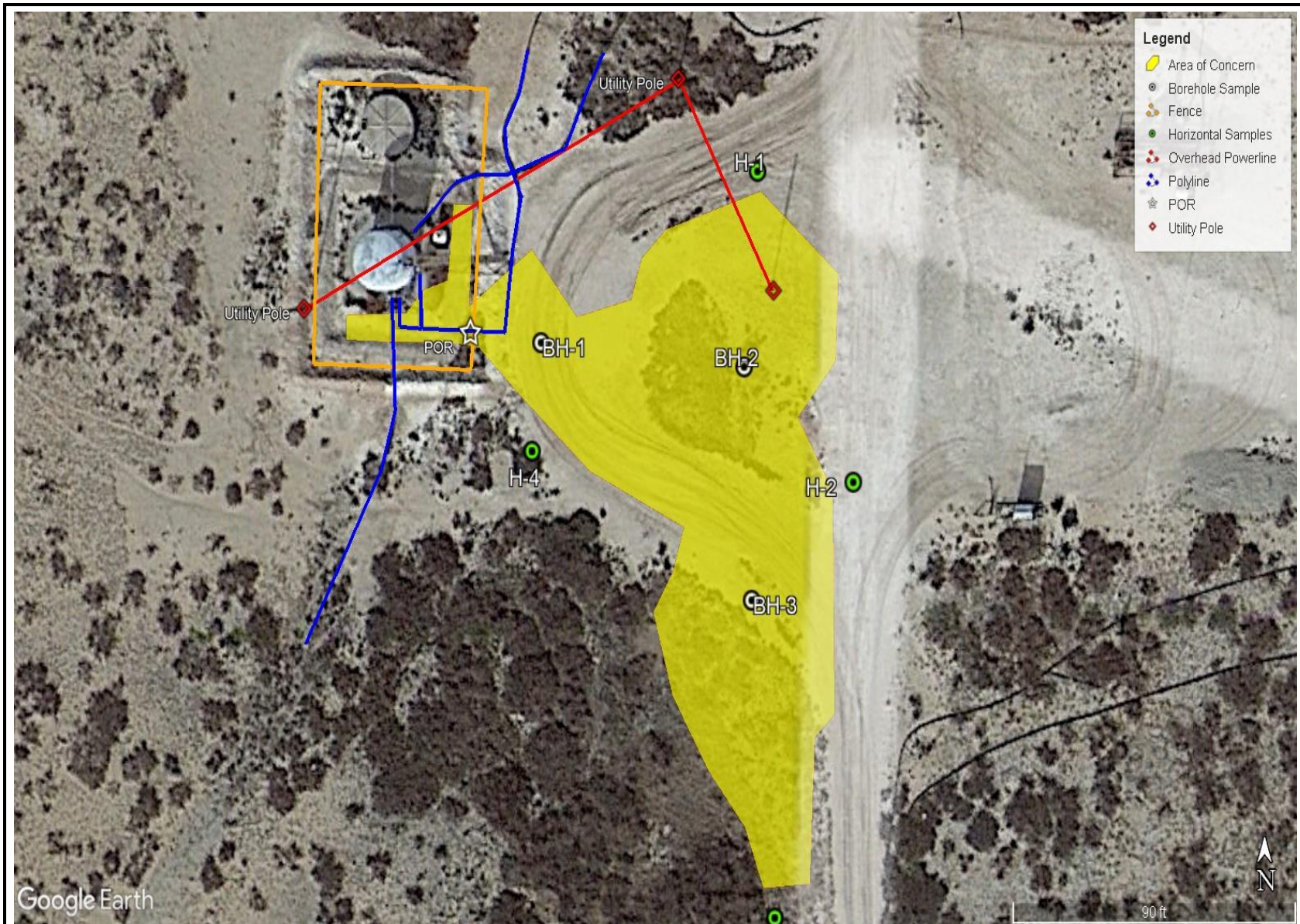

SAMPLE LOCATION MAP  
SILVERBACK OPERATING  
SCRIPPS WATER TRANSFER  
EDDY COUNTY, NEW MEXICO  
32.841718, -104.401463



FIGURE 3

Scripps #4  
Closure Report  
nRM2030860417



December 21, 2023

---

# Appendix D

## nAPP2230460513 Impacts Photos

# Silverback Release Photos



EOG Scripps #4  
Silverback Spill  
08.30.2023 09:07 AM  
32.71318, -104.34269 (±23ft)



EOG Scripps #4  
Silverback Spill  
08.30.2023 09:07 AM  
32.71326, -104.34273 (+22ft)



EOG Scripps #4  
Silverback Spill  
08:30:2023 09:08 AM  
32 71326 -104 34273 (±19ft)



EOG Scripps #4  
Silverback Spill  
08/30/2023 09:08 AM  
32.71326, -104.34274 (±23ft)



EOG Scripps #4  
Silverback Spill  
08/30/2023 09:08 AM  
32.71326 -104.34273 (±19ft)





EOG Scripps #4  
Silverback Spill  
08/30/2023 09:07 AM



EOG Scripps #4  
Silverback Spill  
08/30/2023 09:07 AM  
32.7132, -104.3427 (±18ft)



EOG Scripps #4  
Silverback Spill  
08.30.2023 09:08 AM  
32.71327 -104.34272 (±48ft)



EOG Scripps #4  
Silverback Spill  
08/30/2023 09:07 AM  
32.71319, -104.34271 (+22ft)



EOG Scripps #4  
Silverback Spill  
08.30.2023 09:04 AM  
32.71285, -104.34232 (±20ft)



EOG Scripps #4  
Silverback Spill  
08.30.2023 09:04 AM  
32.71285, -104.34235 (±23ft)



EOG Scripps #4  
Silverback Spill  
08.30.2023 09:05 AM  
32.71285 -104.34235 (±21ft)



EOG Scripps #4  
Silverback Spill  
08/30/2023 09:05 AM  
32.71296 -104.34247 (+25ft)





EOG Scripps #4  
Silverback Spill  
08/30/2023 09:05 AM  
32 71 298 -104 34248 (+20ft)



EOG Scripps #4  
Silverback Spill  
08/30/2023 09:07 AM  
32-71316-104-34273 (+24ft)



EOG Scripps #4  
Silverback Spill  
08/30/2023 09:05 AM  
32 71307 -104 34254 (±20ft)



EOG Scripps #4  
Silverback Spill  
08.30.2023 09:05 AM  
32-71307-104-34253 (±21ft)



EOG Scripps #4  
Silverback Spill  
08/30/2023 09:06 AM  
32-71307-104-34252 (+22ft)



EOG Scripps #4  
Silverback Spill  
08/30/2023 09:06 AM  
32 71307 -104 34252 (+22ft)



EOG Scripps #4  
Silverback Spill  
08.30.2023 09:06 AM  
32.71309 -104.3426 (±19ft)



EOG Scripps #4  
Silverback Spill  
08.30.2023 09:06 AM  
32 71316 -104 34273 (+24ft)





EOG Scripps #4  
Silverback Spill  
08/30/2023 09:07 AM  
32.71319 -104.34271 (±22ft)



EOG Scripps #4  
Silverback Spill  
08.30.2023 09:06 AM  
32-71304 -104 34275 (+26ft)



EOG Scripps #4  
Silverback Spill  
08/30/2023 09:06 AM  
32.71305 -104.34277 (±24ft)



EOG Scripps #4  
Silverback Spill  
08/30/2023 09:06 AM  
32.71305 -104.34277 (±25ft)



EOG Scripps #4  
Excavation  
08.28.2023 10:15 AM  
32.71308 -104.34267 (±19ft)



12/12/2023 7:36:35 AM (-7.0 hrs) Dir=SSW Lat=32.71311 Lon=-104.34279 Alt=3284ft MSL WGS 1984



12/12/2023 7:36:51 AM (-7.0 hrs) Dir=NW Lat=32.71305 Lon=-104.34279 Alt=3282ft MSL WGS 1984



12/12/2023 7:36:10 AM (-7.0 hrs) Dir=WSW Lat=32.7131 Lon=-104.34269 Alt=3280ft MSL WGS 1984





12/12/2023 7:36:17 AM (-7.0 hrs) Dir=WSW Lat=32.71308 Lon=-104.34269 Alt=3283ft MSL WGS 1984

Scripps #4  
Closure Report  
nRM2030860417



December 21, 2023

---

# Appendix E

## Laboratory Analytical Reports



Eurofins Environment Testing South  
Central, LLC  
4901 Hawkins NE  
Albuquerque, NM 87109  
TEL: 505-345-3975 FAX: 505-345-4107  
Website: [www.hallenvironmental.com](http://www.hallenvironmental.com)

December 11, 2023

Chance Dixon  
EOG  
105 South Fourth Street  
Artesia, NM 88210  
TEL:  
FAX:

RE: Scripps 4

OrderNo.: 2312368

Dear Chance Dixon:

Eurofins Environment Testing South Central, LLC received 1 sample(s) on 12/7/2023 for the analyses presented in the following report.

These were analyzed according to EPA procedures or equivalent. To access our accredited tests please go to [www.hallenvironmental.com](http://www.hallenvironmental.com) or the state specific web sites. In order to properly interpret your results, it is imperative that you review this report in its entirety. See the sample checklist and/or the Chain of Custody for information regarding the sample receipt temperature and preservation. Data qualifiers or a narrative will be provided if the sample analysis or analytical quality control parameters require a flag. When necessary, data qualifiers are provided on both the sample analysis report and the QC summary report, both sections should be reviewed. All samples are reported, as received, unless otherwise indicated. Lab measurement of analytes considered field parameters that require analysis within 15 minutes of sampling such as pH and residual chlorine are qualified as being analyzed outside of the recommended holding time.

Please do not hesitate to contact Eurofins Albuquerque for any additional information or clarifications.

ADHS Cert #AZ0682 -- NMED-DWB Cert #NM9425 -- NMED-Micro Cert #NM0901

Sincerely,

A handwritten signature in black ink, appearing to read "Andy Freeman".

Andy Freeman  
Laboratory Manager  
4901 Hawkins NE  
Albuquerque, NM 87109

**Analytical Report**

Lab Order 2312368

Date Reported: 12/11/2023

**Hall Environmental Analysis Laboratory, Inc.**

**CLIENT:** EOG

**Client Sample ID:** WES23-01

**Project:** Scripps 4

**Collection Date:** 12/5/2023 2:43:00 PM

**Lab ID:** 2312368-001

**Matrix:** MEOH (SOIL)

**Received Date:** 12/7/2023 8:05:00 AM

Analyses	Result	RL	Qual	Units	DF	Date Analyzed	Batch
<b>EPA METHOD 300.0: ANIONS</b>							Analyst: <b>SNS</b>
Chloride	430	60		mg/Kg	20	12/7/2023 12:45:45 PM	79216
<b>EPA METHOD 8015M/D: DIESEL RANGE ORGANICS</b>							Analyst: <b>DGH</b>
Diesel Range Organics (DRO)	ND	9.8		mg/Kg	1	12/7/2023 12:04:24 PM	79212
Motor Oil Range Organics (MRO)	ND	49		mg/Kg	1	12/7/2023 12:04:24 PM	79212
Surr: DNOP	89.1	69-147		%Rec	1	12/7/2023 12:04:24 PM	79212
<b>EPA METHOD 8015D: GASOLINE RANGE</b>							Analyst: <b>JJP</b>
Gasoline Range Organics (GRO)	ND	4.6		mg/Kg	1	12/7/2023 11:09:10 AM	GS10166
Surr: BFB	94.8	15-244		%Rec	1	12/7/2023 11:09:10 AM	GS10166
<b>EPA METHOD 8021B: VOLATILES</b>							Analyst: <b>JJP</b>
Benzene	ND	0.023		mg/Kg	1	12/7/2023 11:09:10 AM	BS10166
Toluene	ND	0.046		mg/Kg	1	12/7/2023 11:09:10 AM	BS10166
Ethylbenzene	ND	0.046		mg/Kg	1	12/7/2023 11:09:10 AM	BS10166
Xylenes, Total	ND	0.091		mg/Kg	1	12/7/2023 11:09:10 AM	BS10166
Surr: 4-Bromofluorobenzene	96.4	39.1-146		%Rec	1	12/7/2023 11:09:10 AM	BS10166

Refer to the QC Summary report and sample login checklist for flagged QC data and preservation information.

<b>Qualifiers:</b>	*	Value exceeds Maximum Contaminant Level.	B	Analyte detected in the associated Method Blank
	D	Sample Diluted Due to Matrix	E	Above Quantitation Range/Estimated Value
	H	Holding times for preparation or analysis exceeded	J	Analyte detected below quantitation limits
	ND	Not Detected at the Reporting Limit	P	Sample pH Not In Range
	PQL	Practical Quantitative Limit	RL	Reporting Limit
	S	% Recovery outside of standard limits. If undiluted results may be estimated.		

# QC SUMMARY REPORT

## Hall Environmental Analysis Laboratory, Inc.

WO#: 2312368

11-Dec-23

**Client:** EOG  
**Project:** Scripps 4

Sample ID: <b>LCS-79216</b>	SampType: <b>LCS</b>	TestCode: <b>EPA Method 300.0: Anions</b>								
Client ID: <b>LCSS</b>	Batch ID: <b>79216</b>	RunNo: <b>101677</b>								
Prep Date: <b>12/7/2023</b>	Analysis Date: <b>12/7/2023</b>	SeqNo: <b>3747421</b>	Units: <b>mg/Kg</b>							
Analyte	Result	PQL	SPK value	SPK Ref Val	%REC	LowLimit	HighLimit	%RPD	RPDLimit	Qual
Chloride	14	1.5	15.00	0	92.0	90	110			

Sample ID: <b>MB-79216</b>	SampType: <b>MBLK</b>	TestCode: <b>EPA Method 300.0: Anions</b>								
Client ID: <b>PBS</b>	Batch ID: <b>79216</b>	RunNo: <b>101677</b>								
Prep Date: <b>12/7/2023</b>	Analysis Date: <b>12/7/2023</b>	SeqNo: <b>3747425</b>	Units: <b>mg/Kg</b>							
Analyte	Result	PQL	SPK value	SPK Ref Val	%REC	LowLimit	HighLimit	%RPD	RPDLimit	Qual
Chloride	ND	1.5								

**Qualifiers:**

- \* Value exceeds Maximum Contaminant Level.
- D Sample Diluted Due to Matrix
- H Holding times for preparation or analysis exceeded
- ND Not Detected at the Reporting Limit
- PQL Practical Quantitative Limit
- S % Recovery outside of standard limits. If undiluted results may be estimated.
- B Analyte detected in the associated Method Blank
- E Above Quantitation Range/Estimated Value
- J Analyte detected below quantitation limits
- P Sample pH Not In Range
- RL Reporting Limit

# QC SUMMARY REPORT

## Hall Environmental Analysis Laboratory, Inc.

WO#: 2312368

11-Dec-23

**Client:** EOG  
**Project:** Scripps 4

Sample ID: <b>MB-79212</b>	SampType: <b>MBLK</b>	TestCode: <b>EPA Method 8015M/D: Diesel Range Organics</b>								
Client ID: <b>PBS</b>	Batch ID: <b>79212</b>	RunNo: <b>101680</b>								
Prep Date: <b>12/7/2023</b>	Analysis Date: <b>12/7/2023</b>	SeqNo: <b>3745389</b>	Units: <b>mg/Kg</b>							
Analyte	Result	PQL	SPK value	SPK Ref Val	%REC	LowLimit	HighLimit	%RPD	RPDLimit	Qual
Diesel Range Organics (DRO)	ND	10								
Motor Oil Range Organics (MRO)	ND	50								
Surr: DNOP	8.8		10.00		88.3	69	147			

Sample ID: <b>LCS-79212</b>	SampType: <b>LCS</b>	TestCode: <b>EPA Method 8015M/D: Diesel Range Organics</b>								
Client ID: <b>LCSS</b>	Batch ID: <b>79212</b>	RunNo: <b>101680</b>								
Prep Date: <b>12/7/2023</b>	Analysis Date: <b>12/7/2023</b>	SeqNo: <b>3745390</b>	Units: <b>mg/Kg</b>							
Analyte	Result	PQL	SPK value	SPK Ref Val	%REC	LowLimit	HighLimit	%RPD	RPDLimit	Qual
Diesel Range Organics (DRO)	51	10	50.00	0	102	61.9	130			
Surr: DNOP	4.4		5.000		88.6	69	147			

**Qualifiers:**

- \* Value exceeds Maximum Contaminant Level.
- D Sample Diluted Due to Matrix
- H Holding times for preparation or analysis exceeded
- ND Not Detected at the Reporting Limit
- PQL Practical Quantitative Limit
- S % Recovery outside of standard limits. If undiluted results may be estimated.
- B Analyte detected in the associated Method Blank
- E Above Quantitation Range/Estimated Value
- J Analyte detected below quantitation limits
- P Sample pH Not In Range
- RL Reporting Limit

# QC SUMMARY REPORT

Hall Environmental Analysis Laboratory, Inc.

WO#: 2312368

11-Dec-23

**Client:** EOG  
**Project:** Scripps 4

Sample ID: <b>2.5ug gro lcs</b>	SampType: <b>LCS</b>	TestCode: <b>EPA Method 8015D: Gasoline Range</b>								
Client ID: <b>LCSS</b>	Batch ID: <b>GS101668</b>	RunNo: <b>101668</b>								
Prep Date:	Analysis Date: <b>12/7/2023</b>	SeqNo: <b>3745008</b>			Units: <b>mg/Kg</b>					
Analyte	Result	PQL	SPK value	SPK Ref Val	%REC	LowLimit	HighLimit	%RPD	RPDLimit	Qual
Gasoline Range Organics (GRO)	23	5.0	25.00	0	92.7	70	130			
Surr: BFB	1900		1000		193	15	244			

Sample ID: <b>mb</b>	SampType: <b>MBLK</b>	TestCode: <b>EPA Method 8015D: Gasoline Range</b>								
Client ID: <b>PBS</b>	Batch ID: <b>GS101668</b>	RunNo: <b>101668</b>								
Prep Date:	Analysis Date: <b>12/7/2023</b>	SeqNo: <b>3745009</b>			Units: <b>mg/Kg</b>					
Analyte	Result	PQL	SPK value	SPK Ref Val	%REC	LowLimit	HighLimit	%RPD	RPDLimit	Qual
Gasoline Range Organics (GRO)	ND	5.0								
Surr: BFB	960		1000		95.7	15	244			

**Qualifiers:**

- \* Value exceeds Maximum Contaminant Level.
- D Sample Diluted Due to Matrix
- H Holding times for preparation or analysis exceeded
- ND Not Detected at the Reporting Limit
- PQL Practical Quantitative Limit
- S % Recovery outside of standard limits. If undiluted results may be estimated.
- B Analyte detected in the associated Method Blank
- E Above Quantitation Range/Estimated Value
- J Analyte detected below quantitation limits
- P Sample pH Not In Range
- RL Reporting Limit

# QC SUMMARY REPORT

Hall Environmental Analysis Laboratory, Inc.

WO#: 2312368

11-Dec-23

**Client:** EOG  
**Project:** Scripps 4

Sample ID: <b>100ng btex lcs</b>	SampType: <b>LCS</b>		TestCode: <b>EPA Method 8021B: Volatiles</b>							
Client ID: <b>LCSS</b>	Batch ID: <b>BS101668</b>		RunNo: <b>101668</b>							
Prep Date:	Analysis Date: <b>12/7/2023</b>		SeqNo: <b>3745016</b>		Units: <b>mg/Kg</b>					
Analyte	Result	PQL	SPK value	SPK Ref Val	%REC	LowLimit	HighLimit	%RPD	RPDLimit	Qual
Benzene	0.96	0.025	1.000	0	95.6	70	130			
Toluene	0.96	0.050	1.000	0	96.5	70	130			
Ethylbenzene	0.97	0.050	1.000	0	96.8	70	130			
Xylenes, Total	2.9	0.10	3.000	0	96.9	70	130			
Surr: 4-Bromofluorobenzene	0.97		1.000		97.2	39.1	146			

Sample ID: <b>mb</b>	SampType: <b>MBLK</b>		TestCode: <b>EPA Method 8021B: Volatiles</b>							
Client ID: <b>PBS</b>	Batch ID: <b>BS101668</b>		RunNo: <b>101668</b>							
Prep Date:	Analysis Date: <b>12/7/2023</b>		SeqNo: <b>3745017</b>		Units: <b>mg/Kg</b>					
Analyte	Result	PQL	SPK value	SPK Ref Val	%REC	LowLimit	HighLimit	%RPD	RPDLimit	Qual
Benzene	ND	0.025								
Toluene	ND	0.050								
Ethylbenzene	ND	0.050								
Xylenes, Total	ND	0.10								
Surr: 4-Bromofluorobenzene	0.98		1.000		98.0	39.1	146			

**Qualifiers:**

- \* Value exceeds Maximum Contaminant Level.
- D Sample Diluted Due to Matrix
- H Holding times for preparation or analysis exceeded
- ND Not Detected at the Reporting Limit
- PQL Practical Quantitative Limit
- S % Recovery outside of standard limits. If undiluted results may be estimated.
- B Analyte detected in the associated Method Blank
- E Above Quantitation Range/Estimated Value
- J Analyte detected below quantitation limits
- P Sample pH Not In Range
- RL Reporting Limit





# Sample Log-In Check List

Client Name: EOG Work Order Number: 2312368 RcptNo: 1

Received By: Tracy Casarrubias 12/7/2023 8:05:00 AM

Completed By: Tracy Casarrubias 12/7/2023 8:18:02 AM

Reviewed By: *[Signature]* 12-7-23

### Chain of Custody

- 1. Is Chain of Custody complete? Yes  No  Not Present
- 2. How was the sample delivered? Courier

### Log In

- 3. Was an attempt made to cool the samples? Yes  No  NA
- 4. Were all samples received at a temperature of >0° C to 6.0°C Yes  No  NA
- 5. Sample(s) in proper container(s)? Yes  No
- 6. Sufficient sample volume for indicated test(s)? Yes  No
- 7. Are samples (except VOA and ONG) properly preserved? Yes  No
- 8. Was preservative added to bottles? Yes  No  NA
- 9. Received at least 1 vial with headspace <1/4" for AQ VOA? Yes  No  NA
- 10. Were any sample containers received broken? Yes  No
- 11. Does paperwork match bottle labels? Yes  No   
(Note discrepancies on chain of custody)
- 12. Are matrices correctly identified on Chain of Custody? Yes  No
- 13. Is it clear what analyses were requested? Yes  No
- 14. Were all holding times able to be met? Yes  No   
(If no, notify customer for authorization.)

# of preserved bottles checked for pH: \_\_\_\_\_  
(<2 or >12 unless noted)  
Adjusted? \_\_\_\_\_  
Checked by: *mu 12/7/23*

### Special Handling (if applicable)

- 15. Was client notified of all discrepancies with this order? Yes  No  NA

Person Notified: \_\_\_\_\_ Date: \_\_\_\_\_  
 By Whom: \_\_\_\_\_ Via:  eMail  Phone  Fax  In Person  
 Regarding: \_\_\_\_\_  
 Client Instructions: Mailing address, phone number and Email/Fax are missing on COC- TMC 12/7/23

16. Additional remarks:

### 17. Cooler Information

Cooler No	Temp °C	Condition	Seal Intact	Seal No	Seal Date	Signed By
1	2.6	Good	Yes	Yogi		

### Chain-of-Custody Record

Client: EOG/Vortex

Mailing Address: on file

Phone #: \_\_\_\_\_

email or Fax#: \_\_\_\_\_

QA/QC Package:  Standard  Level 4 (Full Validation)

Accreditation:  Az Compliance  NELAC  Other

EDD (Type) \_\_\_\_\_

Turn-Around Time:  Standard  Rush Some day

Project Name: Scipps #4

Project #: 23E-05872

Project Manager: Chance Dixon

Sampler: Leuson

On Ice:  Yes  No log

# of Coolers: 1

Cooler Temp (including CF): 27-01 = 26 (°C)

Container Type and # 4cc

Preservative Type ice

HEAL No. 2312308

Date	Time	Matrix	Sample Name	Analysis Request
<u>12/05/23</u>	<u>14:43</u>	<u>Soil</u>	<u>WES23-01</u>	<input checked="" type="checkbox"/> (TEX) / MTBE / TMB's (8021) <input checked="" type="checkbox"/> (PH:8015D)(GRO / DRO / MRO) 8081 Pesticides/8082 PCB's EDB (Method 504.1) PAHs by 8310 or 8270SIMS RCRA 8 Metals (C) F, Br, NO <sub>3</sub> , NO <sub>2</sub> , PO <sub>4</sub> , SO <sub>4</sub> 8260 (VOA) 8270 (Semi-VOA) Total Coliform (Present/Absent)
<i>(The rest of the table is crossed out with a large blue X)</i>				

Received by: [Signature] Date: 12/13/23 Time: 9:00

Received by: Via: Cawner Date: 12/17/23 Time: 8:05

Remarks: please cc. david hill EOG. cdixon@vortex.com



Eurofins Environment Testing South  
Central, LLC  
4901 Hawkins NE  
Albuquerque, NM 87109  
TEL: 505-345-3975 FAX: 505-345-4107  
Website: [www.hallenvironmental.com](http://www.hallenvironmental.com)

November 13, 2023

Will Kierdorf  
EOG  
105 South Fourth Street  
Artesia, NM 88210  
TEL:  
FAX:

RE: Scripps 4

OrderNo.: 2310D41

Dear Will Kierdorf:

Eurofins Environment Testing South Central, LLC received 13 sample(s) on 10/28/2023 for the analyses presented in the following report.

These were analyzed according to EPA procedures or equivalent. To access our accredited tests please go to [www.hallenvironmental.com](http://www.hallenvironmental.com) or the state specific web sites. In order to properly interpret your results, it is imperative that you review this report in its entirety. See the sample checklist and/or the Chain of Custody for information regarding the sample receipt temperature and preservation. Data qualifiers or a narrative will be provided if the sample analysis or analytical quality control parameters require a flag. When necessary, data qualifiers are provided on both the sample analysis report and the QC summary report, both sections should be reviewed. All samples are reported, as received, unless otherwise indicated. Lab measurement of analytes considered field parameters that require analysis within 15 minutes of sampling such as pH and residual chlorine are qualified as being analyzed outside of the recommended holding time.

Please do not hesitate to contact Eurofins Albuquerque for any additional information or clarifications.

ADHS Cert #AZ0682 -- NMED-DWB Cert #NM9425 -- NMED-Micro Cert #NM0901

Sincerely,

A handwritten signature in black ink, appearing to read "Andy Freeman".

Andy Freeman  
Laboratory Manager  
4901 Hawkins NE  
Albuquerque, NM 87109

**Analytical Report**

Lab Order **2310D41**

Date Reported: **11/13/2023**

**Hall Environmental Analysis Laboratory, Inc.**

**CLIENT:** EOG

**Client Sample ID:** B-1

**Project:** Scripps 4

**Collection Date:** 10/26/2023 3:00:00 PM

**Lab ID:** 2310D41-001

**Matrix:** SOIL

**Received Date:** 10/28/2023 7:50:00 AM

Analyses	Result	RL	Qual	Units	DF	Date Analyzed	Batch
<b>EPA METHOD 300.0: ANIONS</b>							Analyst: <b>KCB</b>
Chloride	ND	60		mg/Kg	20	11/1/2023 10:40:14 PM	78503
<b>EPA METHOD 8015M/D: DIESEL RANGE ORGANICS</b>							Analyst: <b>PRD</b>
Diesel Range Organics (DRO)	ND	9.6		mg/Kg	1	11/1/2023 4:04:46 PM	78465
Motor Oil Range Organics (MRO)	ND	48		mg/Kg	1	11/1/2023 4:04:46 PM	78465
Surr: DNOP	102	69-147		%Rec	1	11/1/2023 4:04:46 PM	78465
<b>EPA METHOD 8015D: GASOLINE RANGE</b>							Analyst: <b>KMN</b>
Gasoline Range Organics (GRO)	ND	4.9		mg/Kg	1	11/1/2023 11:00:00 PM	78452
Surr: BFB	103	15-244		%Rec	1	11/1/2023 11:00:00 PM	78452
<b>EPA METHOD 8021B: VOLATILES</b>							Analyst: <b>KMN</b>
Benzene	ND	0.024		mg/Kg	1	11/1/2023 11:00:00 PM	78452
Toluene	ND	0.049		mg/Kg	1	11/1/2023 11:00:00 PM	78452
Ethylbenzene	ND	0.049		mg/Kg	1	11/1/2023 11:00:00 PM	78452
Xylenes, Total	ND	0.097		mg/Kg	1	11/1/2023 11:00:00 PM	78452
Surr: 4-Bromofluorobenzene	87.5	39.1-146		%Rec	1	11/1/2023 11:00:00 PM	78452

Refer to the QC Summary report and sample login checklist for flagged QC data and preservation information.

<b>Qualifiers:</b>	*	Value exceeds Maximum Contaminant Level.	B	Analyte detected in the associated Method Blank
	D	Sample Diluted Due to Matrix	E	Above Quantitation Range/Estimated Value
	H	Holding times for preparation or analysis exceeded	J	Analyte detected below quantitation limits
	ND	Not Detected at the Reporting Limit	P	Sample pH Not In Range
	PQL	Practical Quantitative Limit	RL	Reporting Limit
	S	% Recovery outside of standard limits. If undiluted results may be estimated.		

**Analytical Report**

Lab Order **2310D41**

Date Reported: **11/13/2023**

**Hall Environmental Analysis Laboratory, Inc.**

**CLIENT:** EOG

**Client Sample ID:** B-2

**Project:** Scripps 4

**Collection Date:** 10/26/2023 3:02:00 PM

**Lab ID:** 2310D41-002

**Matrix:** SOIL

**Received Date:** 10/28/2023 7:50:00 AM

Analyses	Result	RL	Qual	Units	DF	Date Analyzed	Batch
<b>EPA METHOD 300.0: ANIONS</b>							Analyst: <b>KCB</b>
Chloride	ND	60		mg/Kg	20	11/1/2023 10:52:38 PM	78503
<b>EPA METHOD 8015M/D: DIESEL RANGE ORGANICS</b>							Analyst: <b>PRD</b>
Diesel Range Organics (DRO)	ND	9.8		mg/Kg	1	11/1/2023 4:15:43 PM	78465
Motor Oil Range Organics (MRO)	ND	49		mg/Kg	1	11/1/2023 4:15:43 PM	78465
Surr: DNOP	103	69-147		%Rec	1	11/1/2023 4:15:43 PM	78465
<b>EPA METHOD 8015D: GASOLINE RANGE</b>							Analyst: <b>KMN</b>
Gasoline Range Organics (GRO)	ND	4.9		mg/Kg	1	11/2/2023 12:05:00 AM	78452
Surr: BFB	100	15-244		%Rec	1	11/2/2023 12:05:00 AM	78452
<b>EPA METHOD 8021B: VOLATILES</b>							Analyst: <b>KMN</b>
Benzene	ND	0.024		mg/Kg	1	11/2/2023 12:05:00 AM	78452
Toluene	ND	0.049		mg/Kg	1	11/2/2023 12:05:00 AM	78452
Ethylbenzene	ND	0.049		mg/Kg	1	11/2/2023 12:05:00 AM	78452
Xylenes, Total	ND	0.097		mg/Kg	1	11/2/2023 12:05:00 AM	78452
Surr: 4-Bromofluorobenzene	86.6	39.1-146		%Rec	1	11/2/2023 12:05:00 AM	78452

Refer to the QC Summary report and sample login checklist for flagged QC data and preservation information.

<b>Qualifiers:</b>	*	Value exceeds Maximum Contaminant Level.	B	Analyte detected in the associated Method Blank
	D	Sample Diluted Due to Matrix	E	Above Quantitation Range/Estimated Value
	H	Holding times for preparation or analysis exceeded	J	Analyte detected below quantitation limits
	ND	Not Detected at the Reporting Limit	P	Sample pH Not In Range
	PQL	Practical Quantitative Limit	RL	Reporting Limit
	S	% Recovery outside of standard limits. If undiluted results may be estimated.		

**Analytical Report**

Lab Order **2310D41**

Date Reported: **11/13/2023**

**Hall Environmental Analysis Laboratory, Inc.**

**CLIENT:** EOG

**Client Sample ID:** B-3

**Project:** Scripps 4

**Collection Date:** 10/26/2023 3:04:00 PM

**Lab ID:** 2310D41-003

**Matrix:** SOIL

**Received Date:** 10/28/2023 7:50:00 AM

Analyses	Result	RL	Qual	Units	DF	Date Analyzed	Batch
<b>EPA METHOD 300.0: ANIONS</b>							Analyst: <b>KCB</b>
Chloride	ND	60		mg/Kg	20	11/1/2023 11:29:52 PM	78503
<b>EPA METHOD 8015M/D: DIESEL RANGE ORGANICS</b>							Analyst: <b>PRD</b>
Diesel Range Organics (DRO)	ND	9.6		mg/Kg	1	11/1/2023 4:26:41 PM	78465
Motor Oil Range Organics (MRO)	ND	48		mg/Kg	1	11/1/2023 4:26:41 PM	78465
Surr: DNOP	98.9	69-147		%Rec	1	11/1/2023 4:26:41 PM	78465
<b>EPA METHOD 8015D: GASOLINE RANGE</b>							Analyst: <b>KMN</b>
Gasoline Range Organics (GRO)	ND	4.8		mg/Kg	1	11/2/2023 12:27:00 AM	78452
Surr: BFB	101	15-244		%Rec	1	11/2/2023 12:27:00 AM	78452
<b>EPA METHOD 8021B: VOLATILES</b>							Analyst: <b>KMN</b>
Benzene	ND	0.024		mg/Kg	1	11/2/2023 12:27:00 AM	78452
Toluene	ND	0.048		mg/Kg	1	11/2/2023 12:27:00 AM	78452
Ethylbenzene	ND	0.048		mg/Kg	1	11/2/2023 12:27:00 AM	78452
Xylenes, Total	ND	0.097		mg/Kg	1	11/2/2023 12:27:00 AM	78452
Surr: 4-Bromofluorobenzene	88.8	39.1-146		%Rec	1	11/2/2023 12:27:00 AM	78452

Refer to the QC Summary report and sample login checklist for flagged QC data and preservation information.

<b>Qualifiers:</b>	*	Value exceeds Maximum Contaminant Level.	B	Analyte detected in the associated Method Blank
	D	Sample Diluted Due to Matrix	E	Above Quantitation Range/Estimated Value
	H	Holding times for preparation or analysis exceeded	J	Analyte detected below quantitation limits
	ND	Not Detected at the Reporting Limit	P	Sample pH Not In Range
	PQL	Practical Quantitative Limit	RL	Reporting Limit
	S	% Recovery outside of standard limits. If undiluted results may be estimated.		

**Analytical Report**

Lab Order **2310D41**

Date Reported: **11/13/2023**

**Hall Environmental Analysis Laboratory, Inc.**

**CLIENT:** EOG

**Client Sample ID:** B-4

**Project:** Scripps 4

**Collection Date:** 10/26/2023 3:06:00 PM

**Lab ID:** 2310D41-004

**Matrix:** SOIL

**Received Date:** 10/28/2023 7:50:00 AM

Analyses	Result	RL	Qual	Units	DF	Date Analyzed	Batch
<b>EPA METHOD 300.0: ANIONS</b>							Analyst: <b>KCB</b>
Chloride	ND	60		mg/Kg	20	11/1/2023 11:42:17 PM	78503
<b>EPA METHOD 8015M/D: DIESEL RANGE ORGANICS</b>							Analyst: <b>PRD</b>
Diesel Range Organics (DRO)	ND	9.2		mg/Kg	1	11/1/2023 4:37:34 PM	78465
Motor Oil Range Organics (MRO)	ND	46		mg/Kg	1	11/1/2023 4:37:34 PM	78465
Surr: DNOP	95.1	69-147		%Rec	1	11/1/2023 4:37:34 PM	78465
<b>EPA METHOD 8015D: GASOLINE RANGE</b>							Analyst: <b>KMN</b>
Gasoline Range Organics (GRO)	ND	4.9		mg/Kg	1	11/2/2023 12:48:00 AM	78452
Surr: BFB	98.9	15-244		%Rec	1	11/2/2023 12:48:00 AM	78452
<b>EPA METHOD 8021B: VOLATILES</b>							Analyst: <b>KMN</b>
Benzene	ND	0.024		mg/Kg	1	11/2/2023 12:48:00 AM	78452
Toluene	ND	0.049		mg/Kg	1	11/2/2023 12:48:00 AM	78452
Ethylbenzene	ND	0.049		mg/Kg	1	11/2/2023 12:48:00 AM	78452
Xylenes, Total	ND	0.098		mg/Kg	1	11/2/2023 12:48:00 AM	78452
Surr: 4-Bromofluorobenzene	86.1	39.1-146		%Rec	1	11/2/2023 12:48:00 AM	78452

Refer to the QC Summary report and sample login checklist for flagged QC data and preservation information.

<b>Qualifiers:</b>	*	Value exceeds Maximum Contaminant Level.	B	Analyte detected in the associated Method Blank
	D	Sample Diluted Due to Matrix	E	Above Quantitation Range/Estimated Value
	H	Holding times for preparation or analysis exceeded	J	Analyte detected below quantitation limits
	ND	Not Detected at the Reporting Limit	P	Sample pH Not In Range
	PQL	Practical Quantitative Limit	RL	Reporting Limit
	S	% Recovery outside of standard limits. If undiluted results may be estimated.		

**Analytical Report**

Lab Order **2310D41**

Date Reported: **11/13/2023**

**Hall Environmental Analysis Laboratory, Inc.**

**CLIENT:** EOG

**Client Sample ID:** B-5

**Project:** Scripps 4

**Collection Date:** 10/26/2023 3:30:00 PM

**Lab ID:** 2310D41-005

**Matrix:** SOIL

**Received Date:** 10/28/2023 7:50:00 AM

Analyses	Result	RL	Qual	Units	DF	Date Analyzed	Batch
<b>EPA METHOD 300.0: ANIONS</b>							Analyst: <b>KCB</b>
Chloride	ND	60		mg/Kg	20	11/1/2023 11:54:41 PM	78503
<b>EPA METHOD 8015M/D: DIESEL RANGE ORGANICS</b>							Analyst: <b>PRD</b>
Diesel Range Organics (DRO)	ND	9.9		mg/Kg	1	11/1/2023 4:48:29 PM	78465
Motor Oil Range Organics (MRO)	ND	50		mg/Kg	1	11/1/2023 4:48:29 PM	78465
Surr: DNOP	97.2	69-147		%Rec	1	11/1/2023 4:48:29 PM	78465
<b>EPA METHOD 8015D: GASOLINE RANGE</b>							Analyst: <b>KMN</b>
Gasoline Range Organics (GRO)	ND	4.9		mg/Kg	1	11/2/2023 1:10:00 AM	78452
Surr: BFB	102	15-244		%Rec	1	11/2/2023 1:10:00 AM	78452
<b>EPA METHOD 8021B: VOLATILES</b>							Analyst: <b>KMN</b>
Benzene	ND	0.025		mg/Kg	1	11/2/2023 1:10:00 AM	78452
Toluene	ND	0.049		mg/Kg	1	11/2/2023 1:10:00 AM	78452
Ethylbenzene	ND	0.049		mg/Kg	1	11/2/2023 1:10:00 AM	78452
Xylenes, Total	ND	0.099		mg/Kg	1	11/2/2023 1:10:00 AM	78452
Surr: 4-Bromofluorobenzene	89.2	39.1-146		%Rec	1	11/2/2023 1:10:00 AM	78452

Refer to the QC Summary report and sample login checklist for flagged QC data and preservation information.

<b>Qualifiers:</b>	*	Value exceeds Maximum Contaminant Level.	B	Analyte detected in the associated Method Blank
	D	Sample Diluted Due to Matrix	E	Above Quantitation Range/Estimated Value
	H	Holding times for preparation or analysis exceeded	J	Analyte detected below quantitation limits
	ND	Not Detected at the Reporting Limit	P	Sample pH Not In Range
	PQL	Practical Quantitative Limit	RL	Reporting Limit
	S	% Recovery outside of standard limits. If undiluted results may be estimated.		



**Analytical Report**

Lab Order **2310D41**

Date Reported: **11/13/2023**

**Hall Environmental Analysis Laboratory, Inc.**

**CLIENT:** EOG

**Client Sample ID:** B-6

**Project:** Scripps 4

**Collection Date:** 10/26/2023 3:32:00 PM

**Lab ID:** 2310D41-006

**Matrix:** SOIL

**Received Date:** 10/28/2023 7:50:00 AM

Analyses	Result	RL	Qual	Units	DF	Date Analyzed	Batch
<b>EPA METHOD 300.0: ANIONS</b>							Analyst: <b>KCB</b>
Chloride	ND	60		mg/Kg	20	11/2/2023 12:07:06 AM	78503
<b>EPA METHOD 8015M/D: DIESEL RANGE ORGANICS</b>							Analyst: <b>PRD</b>
Diesel Range Organics (DRO)	ND	9.4		mg/Kg	1	11/1/2023 4:59:22 PM	78465
Motor Oil Range Organics (MRO)	ND	47		mg/Kg	1	11/1/2023 4:59:22 PM	78465
Surr: DNOP	100	69-147		%Rec	1	11/1/2023 4:59:22 PM	78465
<b>EPA METHOD 8015D: GASOLINE RANGE</b>							Analyst: <b>KMN</b>
Gasoline Range Organics (GRO)	ND	4.9		mg/Kg	1	11/2/2023 1:32:00 AM	78452
Surr: BFB	99.5	15-244		%Rec	1	11/2/2023 1:32:00 AM	78452
<b>EPA METHOD 8021B: VOLATILES</b>							Analyst: <b>KMN</b>
Benzene	ND	0.024		mg/Kg	1	11/2/2023 1:32:00 AM	78452
Toluene	ND	0.049		mg/Kg	1	11/2/2023 1:32:00 AM	78452
Ethylbenzene	ND	0.049		mg/Kg	1	11/2/2023 1:32:00 AM	78452
Xylenes, Total	ND	0.098		mg/Kg	1	11/2/2023 1:32:00 AM	78452
Surr: 4-Bromofluorobenzene	88.2	39.1-146		%Rec	1	11/2/2023 1:32:00 AM	78452

Refer to the QC Summary report and sample login checklist for flagged QC data and preservation information.

<b>Qualifiers:</b>	*	Value exceeds Maximum Contaminant Level.	B	Analyte detected in the associated Method Blank
	D	Sample Diluted Due to Matrix	E	Above Quantitation Range/Estimated Value
	H	Holding times for preparation or analysis exceeded	J	Analyte detected below quantitation limits
	ND	Not Detected at the Reporting Limit	P	Sample pH Not In Range
	PQL	Practical Quantitative Limit	RL	Reporting Limit
	S	% Recovery outside of standard limits. If undiluted results may be estimated.		

**Analytical Report**

Lab Order **2310D41**

Date Reported: **11/13/2023**

**Hall Environmental Analysis Laboratory, Inc.**

**CLIENT:** EOG

**Client Sample ID:** B-7

**Project:** Scripps 4

**Collection Date:** 10/26/2023 3:38:00 PM

**Lab ID:** 2310D41-007

**Matrix:** SOIL

**Received Date:** 10/28/2023 7:50:00 AM

Analyses	Result	RL	Qual	Units	DF	Date Analyzed	Batch
<b>EPA METHOD 300.0: ANIONS</b>							Analyst: <b>KCB</b>
Chloride	ND	60		mg/Kg	20	11/2/2023 12:19:31 AM	78503
<b>EPA METHOD 8015M/D: DIESEL RANGE ORGANICS</b>							Analyst: <b>PRD</b>
Diesel Range Organics (DRO)	ND	9.6		mg/Kg	1	11/1/2023 5:10:17 PM	78465
Motor Oil Range Organics (MRO)	ND	48		mg/Kg	1	11/1/2023 5:10:17 PM	78465
Surr: DNOP	97.1	69-147		%Rec	1	11/1/2023 5:10:17 PM	78465
<b>EPA METHOD 8015D: GASOLINE RANGE</b>							Analyst: <b>KMN</b>
Gasoline Range Organics (GRO)	ND	4.9		mg/Kg	1	11/2/2023 1:54:00 AM	78452
Surr: BFB	102	15-244		%Rec	1	11/2/2023 1:54:00 AM	78452
<b>EPA METHOD 8021B: VOLATILES</b>							Analyst: <b>KMN</b>
Benzene	ND	0.025		mg/Kg	1	11/2/2023 1:54:00 AM	78452
Toluene	ND	0.049		mg/Kg	1	11/2/2023 1:54:00 AM	78452
Ethylbenzene	ND	0.049		mg/Kg	1	11/2/2023 1:54:00 AM	78452
Xylenes, Total	ND	0.098		mg/Kg	1	11/2/2023 1:54:00 AM	78452
Surr: 4-Bromofluorobenzene	85.7	39.1-146		%Rec	1	11/2/2023 1:54:00 AM	78452

Refer to the QC Summary report and sample login checklist for flagged QC data and preservation information.

<b>Qualifiers:</b>	*	Value exceeds Maximum Contaminant Level.	B	Analyte detected in the associated Method Blank
	D	Sample Diluted Due to Matrix	E	Above Quantitation Range/Estimated Value
	H	Holding times for preparation or analysis exceeded	J	Analyte detected below quantitation limits
	ND	Not Detected at the Reporting Limit	P	Sample pH Not In Range
	PQL	Practical Quantitative Limit	RL	Reporting Limit
	S	% Recovery outside of standard limits. If undiluted results may be estimated.		

**Analytical Report**

Lab Order **2310D41**

Date Reported: **11/13/2023**

**Hall Environmental Analysis Laboratory, Inc.**

**CLIENT:** EOG

**Client Sample ID:** B-8

**Project:** Scripps 4

**Collection Date:** 10/26/2023 4:00:00 PM

**Lab ID:** 2310D41-008

**Matrix:** SOIL

**Received Date:** 10/28/2023 7:50:00 AM

Analyses	Result	RL	Qual	Units	DF	Date Analyzed	Batch
<b>EPA METHOD 300.0: ANIONS</b>							Analyst: <b>KCB</b>
Chloride	84	60		mg/Kg	20	11/2/2023 12:31:56 AM	78503
<b>EPA METHOD 8015M/D: DIESEL RANGE ORGANICS</b>							Analyst: <b>PRD</b>
Diesel Range Organics (DRO)	ND	9.5		mg/Kg	1	11/1/2023 5:21:10 PM	78465
Motor Oil Range Organics (MRO)	ND	47		mg/Kg	1	11/1/2023 5:21:10 PM	78465
Surr: DNOP	99.2	69-147		%Rec	1	11/1/2023 5:21:10 PM	78465
<b>EPA METHOD 8015D: GASOLINE RANGE</b>							Analyst: <b>KMN</b>
Gasoline Range Organics (GRO)	ND	4.8		mg/Kg	1	11/2/2023 2:15:00 AM	78452
Surr: BFB	101	15-244		%Rec	1	11/2/2023 2:15:00 AM	78452
<b>EPA METHOD 8021B: VOLATILES</b>							Analyst: <b>KMN</b>
Benzene	ND	0.024		mg/Kg	1	11/2/2023 2:15:00 AM	78452
Toluene	ND	0.048		mg/Kg	1	11/2/2023 2:15:00 AM	78452
Ethylbenzene	ND	0.048		mg/Kg	1	11/2/2023 2:15:00 AM	78452
Xylenes, Total	ND	0.095		mg/Kg	1	11/2/2023 2:15:00 AM	78452
Surr: 4-Bromofluorobenzene	87.9	39.1-146		%Rec	1	11/2/2023 2:15:00 AM	78452

Refer to the QC Summary report and sample login checklist for flagged QC data and preservation information.

<b>Qualifiers:</b>	*	Value exceeds Maximum Contaminant Level.	B	Analyte detected in the associated Method Blank
	D	Sample Diluted Due to Matrix	E	Above Quantitation Range/Estimated Value
	H	Holding times for preparation or analysis exceeded	J	Analyte detected below quantitation limits
	ND	Not Detected at the Reporting Limit	P	Sample pH Not In Range
	PQL	Practical Quantitative Limit	RL	Reporting Limit
	S	% Recovery outside of standard limits. If undiluted results may be estimated.		

**Analytical Report**

Lab Order **2310D41**

Date Reported: **11/13/2023**

**Hall Environmental Analysis Laboratory, Inc.**

**CLIENT:** EOG

**Client Sample ID:** B-9

**Project:** Scripps 4

**Collection Date:** 10/26/2023 4:02:00 PM

**Lab ID:** 2310D41-009

**Matrix:** SOIL

**Received Date:** 10/28/2023 7:50:00 AM

Analyses	Result	RL	Qual	Units	DF	Date Analyzed	Batch
<b>EPA METHOD 300.0: ANIONS</b>							Analyst: <b>KCB</b>
Chloride	ND	60		mg/Kg	20	11/2/2023 12:44:20 AM	78503
<b>EPA METHOD 8015M/D: DIESEL RANGE ORGANICS</b>							Analyst: <b>PRD</b>
Diesel Range Organics (DRO)	ND	9.2		mg/Kg	1	11/1/2023 5:32:01 PM	78465
Motor Oil Range Organics (MRO)	ND	46		mg/Kg	1	11/1/2023 5:32:01 PM	78465
Surr: DNOP	99.6	69-147		%Rec	1	11/1/2023 5:32:01 PM	78465
<b>EPA METHOD 8015D: GASOLINE RANGE</b>							Analyst: <b>KMN</b>
Gasoline Range Organics (GRO)	ND	4.9		mg/Kg	1	11/2/2023 2:37:00 AM	78452
Surr: BFB	103	15-244		%Rec	1	11/2/2023 2:37:00 AM	78452
<b>EPA METHOD 8021B: VOLATILES</b>							Analyst: <b>KMN</b>
Benzene	ND	0.024		mg/Kg	1	11/2/2023 2:37:00 AM	78452
Toluene	ND	0.049		mg/Kg	1	11/2/2023 2:37:00 AM	78452
Ethylbenzene	ND	0.049		mg/Kg	1	11/2/2023 2:37:00 AM	78452
Xylenes, Total	ND	0.098		mg/Kg	1	11/2/2023 2:37:00 AM	78452
Surr: 4-Bromofluorobenzene	88.4	39.1-146		%Rec	1	11/2/2023 2:37:00 AM	78452

Refer to the QC Summary report and sample login checklist for flagged QC data and preservation information.

<b>Qualifiers:</b>	*	Value exceeds Maximum Contaminant Level.	B	Analyte detected in the associated Method Blank
	D	Sample Diluted Due to Matrix	E	Above Quantitation Range/Estimated Value
	H	Holding times for preparation or analysis exceeded	J	Analyte detected below quantitation limits
	ND	Not Detected at the Reporting Limit	P	Sample pH Not In Range
	PQL	Practical Quantitative Limit	RL	Reporting Limit
	S	% Recovery outside of standard limits. If undiluted results may be estimated.		

**Analytical Report**

Lab Order **2310D41**

Date Reported: **11/13/2023**

**Hall Environmental Analysis Laboratory, Inc.**

**CLIENT:** EOG

**Client Sample ID:** NW-1

**Project:** Scripps 4

**Collection Date:** 10/26/2023 4:20:00 PM

**Lab ID:** 2310D41-010

**Matrix:** SOIL

**Received Date:** 10/28/2023 7:50:00 AM

Analyses	Result	RL	Qual	Units	DF	Date Analyzed	Batch
<b>EPA METHOD 300.0: ANIONS</b>							Analyst: <b>RBC</b>
Chloride	220	60		mg/Kg	20	11/2/2023 2:51:43 PM	78522
<b>EPA METHOD 8015M/D: DIESEL RANGE ORGANICS</b>							Analyst: <b>PRD</b>
Diesel Range Organics (DRO)	380	99		mg/Kg	10	11/1/2023 5:53:32 PM	78465
Motor Oil Range Organics (MRO)	580	490		mg/Kg	10	11/1/2023 5:53:32 PM	78465
Surr: DNOP	0	69-147	S	%Rec	10	11/1/2023 5:53:32 PM	78465
<b>EPA METHOD 8015D: GASOLINE RANGE</b>							Analyst: <b>KMN</b>
Gasoline Range Organics (GRO)	ND	5.0		mg/Kg	1	11/2/2023 9:52:00 AM	78452
Surr: BFB	95.6	15-244		%Rec	1	11/2/2023 9:52:00 AM	78452
<b>EPA METHOD 8021B: VOLATILES</b>							Analyst: <b>KMN</b>
Benzene	ND	0.025		mg/Kg	1	11/2/2023 9:52:00 AM	78452
Toluene	ND	0.050		mg/Kg	1	11/2/2023 9:52:00 AM	78452
Ethylbenzene	ND	0.050		mg/Kg	1	11/2/2023 9:52:00 AM	78452
Xylenes, Total	ND	0.10		mg/Kg	1	11/2/2023 9:52:00 AM	78452
Surr: 4-Bromofluorobenzene	84.1	39.1-146		%Rec	1	11/2/2023 9:52:00 AM	78452

Refer to the QC Summary report and sample login checklist for flagged QC data and preservation information.

<b>Qualifiers:</b>	*	Value exceeds Maximum Contaminant Level.	B	Analyte detected in the associated Method Blank
	D	Sample Diluted Due to Matrix	E	Above Quantitation Range/Estimated Value
	H	Holding times for preparation or analysis exceeded	J	Analyte detected below quantitation limits
	ND	Not Detected at the Reporting Limit	P	Sample pH Not In Range
	PQL	Practical Quantitative Limit	RL	Reporting Limit
	S	% Recovery outside of standard limits. If undiluted results may be estimated.		

**Analytical Report**

Lab Order **2310D41**

Date Reported: **11/13/2023**

**Hall Environmental Analysis Laboratory, Inc.**

**CLIENT:** EOG

**Client Sample ID:** WW-1

**Project:** Scripps 4

**Collection Date:** 10/26/2023 4:24:00 PM

**Lab ID:** 2310D41-011

**Matrix:** SOIL

**Received Date:** 10/28/2023 7:50:00 AM

Analyses	Result	RL	Qual	Units	DF	Date Analyzed	Batch
<b>EPA METHOD 300.0: ANIONS</b>							Analyst: <b>KCB</b>
Chloride	3700	150		mg/Kg	50	11/3/2023 10:11:29 PM	78522
<b>EPA METHOD 8015M/D: DIESEL RANGE ORGANICS</b>							Analyst: <b>PRD</b>
Diesel Range Organics (DRO)	ND	9.7		mg/Kg	1	11/1/2023 6:34:24 PM	78465
Motor Oil Range Organics (MRO)	ND	48		mg/Kg	1	11/1/2023 6:34:24 PM	78465
Surr: DNOP	100	69-147		%Rec	1	11/1/2023 6:34:24 PM	78465
<b>EPA METHOD 8015D: GASOLINE RANGE</b>							Analyst: <b>KMN</b>
Gasoline Range Organics (GRO)	ND	4.9		mg/Kg	1	11/2/2023 10:13:00 AM	78452
Surr: BFB	103	15-244		%Rec	1	11/2/2023 10:13:00 AM	78452
<b>EPA METHOD 8021B: VOLATILES</b>							Analyst: <b>KMN</b>
Benzene	ND	0.025		mg/Kg	1	11/2/2023 10:13:00 AM	78452
Toluene	ND	0.049		mg/Kg	1	11/2/2023 10:13:00 AM	78452
Ethylbenzene	ND	0.049		mg/Kg	1	11/2/2023 10:13:00 AM	78452
Xylenes, Total	ND	0.099		mg/Kg	1	11/2/2023 10:13:00 AM	78452
Surr: 4-Bromofluorobenzene	88.0	39.1-146		%Rec	1	11/2/2023 10:13:00 AM	78452

Refer to the QC Summary report and sample login checklist for flagged QC data and preservation information.

<b>Qualifiers:</b>	*	Value exceeds Maximum Contaminant Level.	B	Analyte detected in the associated Method Blank
	D	Sample Diluted Due to Matrix	E	Above Quantitation Range/Estimated Value
	H	Holding times for preparation or analysis exceeded	J	Analyte detected below quantitation limits
	ND	Not Detected at the Reporting Limit	P	Sample pH Not In Range
	PQL	Practical Quantitative Limit	RL	Reporting Limit
	S	% Recovery outside of standard limits. If undiluted results may be estimated.		

**Analytical Report**

Lab Order **2310D41**

Date Reported: **11/13/2023**

**Hall Environmental Analysis Laboratory, Inc.**

**CLIENT:** EOG

**Client Sample ID:** SW-1

**Project:** Scripps 4

**Collection Date:** 10/26/2023 4:22:00 PM

**Lab ID:** 2310D41-012

**Matrix:** SOIL

**Received Date:** 10/28/2023 7:50:00 AM

Analyses	Result	RL	Qual	Units	DF	Date Analyzed	Batch
<b>EPA METHOD 300.0: ANIONS</b>							Analyst: <b>KCB</b>
Chloride	8200	300		mg/Kg	100	11/3/2023 10:23:54 PM	78522
<b>EPA METHOD 8015M/D: DIESEL RANGE ORGANICS</b>							Analyst: <b>PRD</b>
Diesel Range Organics (DRO)	ND	9.6		mg/Kg	1	11/1/2023 6:45:11 PM	78465
Motor Oil Range Organics (MRO)	ND	48		mg/Kg	1	11/1/2023 6:45:11 PM	78465
Surr: DNOP	99.7	69-147		%Rec	1	11/1/2023 6:45:11 PM	78465
<b>EPA METHOD 8015D: GASOLINE RANGE</b>							Analyst: <b>KMN</b>
Gasoline Range Organics (GRO)	ND	4.9		mg/Kg	1	11/2/2023 10:35:00 AM	78452
Surr: BFB	104	15-244		%Rec	1	11/2/2023 10:35:00 AM	78452
<b>EPA METHOD 8021B: VOLATILES</b>							Analyst: <b>KMN</b>
Benzene	ND	0.024		mg/Kg	1	11/2/2023 10:35:00 AM	78452
Toluene	ND	0.049		mg/Kg	1	11/2/2023 10:35:00 AM	78452
Ethylbenzene	ND	0.049		mg/Kg	1	11/2/2023 10:35:00 AM	78452
Xylenes, Total	ND	0.097		mg/Kg	1	11/2/2023 10:35:00 AM	78452
Surr: 4-Bromofluorobenzene	88.6	39.1-146		%Rec	1	11/2/2023 10:35:00 AM	78452

Refer to the QC Summary report and sample login checklist for flagged QC data and preservation information.

<b>Qualifiers:</b>	*	Value exceeds Maximum Contaminant Level.	B	Analyte detected in the associated Method Blank
	D	Sample Diluted Due to Matrix	E	Above Quantitation Range/Estimated Value
	H	Holding times for preparation or analysis exceeded	J	Analyte detected below quantitation limits
	ND	Not Detected at the Reporting Limit	P	Sample pH Not In Range
	PQL	Practical Quantitative Limit	RL	Reporting Limit
	S	% Recovery outside of standard limits. If undiluted results may be estimated.		

**Analytical Report**

Lab Order **2310D41**

Date Reported: **11/13/2023**

**Hall Environmental Analysis Laboratory, Inc.**

**CLIENT:** EOG

**Client Sample ID:** Ramp-1

**Project:** Scripps 4

**Collection Date:** 10/26/2023 4:18:00 PM

**Lab ID:** 2310D41-013

**Matrix:** SOIL

**Received Date:** 10/28/2023 7:50:00 AM

Analyses	Result	RL	Qual	Units	DF	Date Analyzed	Batch
<b>EPA METHOD 300.0: ANIONS</b>							Analyst: <b>RBC</b>
Chloride	ND	60		mg/Kg	20	11/2/2023 4:42:50 PM	78522
<b>EPA METHOD 8015M/D: DIESEL RANGE ORGANICS</b>							Analyst: <b>PRD</b>
Diesel Range Organics (DRO)	ND	9.4		mg/Kg	1	11/1/2023 6:55:56 PM	78465
Motor Oil Range Organics (MRO)	ND	47		mg/Kg	1	11/1/2023 6:55:56 PM	78465
Surr: DNOP	99.0	69-147		%Rec	1	11/1/2023 6:55:56 PM	78465
<b>EPA METHOD 8015D: GASOLINE RANGE</b>							Analyst: <b>KMN</b>
Gasoline Range Organics (GRO)	ND	5.0		mg/Kg	1	11/2/2023 10:57:00 AM	78452
Surr: BFB	105	15-244		%Rec	1	11/2/2023 10:57:00 AM	78452
<b>EPA METHOD 8021B: VOLATILES</b>							Analyst: <b>KMN</b>
Benzene	ND	0.025		mg/Kg	1	11/2/2023 10:57:00 AM	78452
Toluene	ND	0.050		mg/Kg	1	11/2/2023 10:57:00 AM	78452
Ethylbenzene	ND	0.050		mg/Kg	1	11/2/2023 10:57:00 AM	78452
Xylenes, Total	ND	0.099		mg/Kg	1	11/2/2023 10:57:00 AM	78452
Surr: 4-Bromofluorobenzene	90.4	39.1-146		%Rec	1	11/2/2023 10:57:00 AM	78452

Refer to the QC Summary report and sample login checklist for flagged QC data and preservation information.

<b>Qualifiers:</b>	*	Value exceeds Maximum Contaminant Level.	B	Analyte detected in the associated Method Blank
	D	Sample Diluted Due to Matrix	E	Above Quantitation Range/Estimated Value
	H	Holding times for preparation or analysis exceeded	J	Analyte detected below quantitation limits
	ND	Not Detected at the Reporting Limit	P	Sample pH Not In Range
	PQL	Practical Quantitative Limit	RL	Reporting Limit
	S	% Recovery outside of standard limits. If undiluted results may be estimated.		



# QC SUMMARY REPORT

Hall Environmental Analysis Laboratory, Inc.

WO#: 2310D41

13-Nov-23

**Client:** EOG  
**Project:** Scripps 4

Sample ID: <b>MB-78503</b>	SampType: <b>mblk</b>	TestCode: <b>EPA Method 300.0: Anions</b>								
Client ID: <b>PBS</b>	Batch ID: <b>78503</b>	RunNo: <b>100902</b>								
Prep Date: <b>11/1/2023</b>	Analysis Date: <b>11/1/2023</b>	SeqNo: <b>3702714</b>	Units: <b>mg/Kg</b>							
Analyte	Result	PQL	SPK value	SPK Ref Val	%REC	LowLimit	HighLimit	%RPD	RPDLimit	Qual
Chloride	ND	1.5								

Sample ID: <b>LCS-78503</b>	SampType: <b>lcs</b>	TestCode: <b>EPA Method 300.0: Anions</b>								
Client ID: <b>LCSS</b>	Batch ID: <b>78503</b>	RunNo: <b>100902</b>								
Prep Date: <b>11/1/2023</b>	Analysis Date: <b>11/1/2023</b>	SeqNo: <b>3702715</b>	Units: <b>mg/Kg</b>							
Analyte	Result	PQL	SPK value	SPK Ref Val	%REC	LowLimit	HighLimit	%RPD	RPDLimit	Qual
Chloride	14	1.5	15.00	0	90.7	90	110			

Sample ID: <b>MB-78522</b>	SampType: <b>MBLK</b>	TestCode: <b>EPA Method 300.0: Anions</b>								
Client ID: <b>PBS</b>	Batch ID: <b>78522</b>	RunNo: <b>100923</b>								
Prep Date: <b>11/2/2023</b>	Analysis Date: <b>11/2/2023</b>	SeqNo: <b>3703738</b>	Units: <b>mg/Kg</b>							
Analyte	Result	PQL	SPK value	SPK Ref Val	%REC	LowLimit	HighLimit	%RPD	RPDLimit	Qual
Chloride	ND	1.5								

Sample ID: <b>LCS-78522</b>	SampType: <b>LCS</b>	TestCode: <b>EPA Method 300.0: Anions</b>								
Client ID: <b>LCSS</b>	Batch ID: <b>78522</b>	RunNo: <b>100923</b>								
Prep Date: <b>11/2/2023</b>	Analysis Date: <b>11/2/2023</b>	SeqNo: <b>3703739</b>	Units: <b>mg/Kg</b>							
Analyte	Result	PQL	SPK value	SPK Ref Val	%REC	LowLimit	HighLimit	%RPD	RPDLimit	Qual
Chloride	14	1.5	15.00	0	92.2	90	110			

**Qualifiers:**

- \* Value exceeds Maximum Contaminant Level.
- D Sample Diluted Due to Matrix
- H Holding times for preparation or analysis exceeded
- ND Not Detected at the Reporting Limit
- PQL Practical Quantitative Limit
- S % Recovery outside of standard limits. If undiluted results may be estimated.
- B Analyte detected in the associated Method Blank
- E Above Quantitation Range/Estimated Value
- J Analyte detected below quantitation limits
- P Sample pH Not In Range
- RL Reporting Limit

# QC SUMMARY REPORT

Hall Environmental Analysis Laboratory, Inc.

WO#: 2310D41

13-Nov-23

**Client:** EOG  
**Project:** Scripps 4

Sample ID: <b>LCS-78465</b>	SampType: <b>LCS</b>		TestCode: <b>EPA Method 8015M/D: Diesel Range Organics</b>							
Client ID: <b>LCSS</b>	Batch ID: <b>78465</b>		RunNo: <b>100868</b>							
Prep Date: <b>10/31/2023</b>	Analysis Date: <b>11/1/2023</b>		SeqNo: <b>3701934</b>		Units: <b>mg/Kg</b>					
Analyte	Result	PQL	SPK value	SPK Ref Val	%REC	LowLimit	HighLimit	%RPD	RPDLimit	Qual
Diesel Range Organics (DRO)	61	10	50.00	0	121	61.9	130			
Surr: DNOP	7.9		5.000		158	69	147			S

Sample ID: <b>MB-78465</b>	SampType: <b>MBLK</b>		TestCode: <b>EPA Method 8015M/D: Diesel Range Organics</b>							
Client ID: <b>PBS</b>	Batch ID: <b>78465</b>		RunNo: <b>100868</b>							
Prep Date: <b>10/31/2023</b>	Analysis Date: <b>11/1/2023</b>		SeqNo: <b>3701937</b>		Units: <b>mg/Kg</b>					
Analyte	Result	PQL	SPK value	SPK Ref Val	%REC	LowLimit	HighLimit	%RPD	RPDLimit	Qual
Diesel Range Organics (DRO)	ND	10								
Motor Oil Range Organics (MRO)	ND	50								
Surr: DNOP	9.8		10.00		97.6	69	147			

**Qualifiers:**

- \* Value exceeds Maximum Contaminant Level.
- D Sample Diluted Due to Matrix
- H Holding times for preparation or analysis exceeded
- ND Not Detected at the Reporting Limit
- PQL Practical Quantitative Limit
- S % Recovery outside of standard limits. If undiluted results may be estimated.
- B Analyte detected in the associated Method Blank
- E Above Quantitation Range/Estimated Value
- J Analyte detected below quantitation limits
- P Sample pH Not In Range
- RL Reporting Limit

# QC SUMMARY REPORT

## Hall Environmental Analysis Laboratory, Inc.

WO#: 2310D41

13-Nov-23

**Client:** EOG  
**Project:** Scripps 4

Sample ID: <b>ics-78452</b>	SampType: <b>LCS</b>	TestCode: <b>EPA Method 8015D: Gasoline Range</b>								
Client ID: <b>LCSS</b>	Batch ID: <b>78452</b>	RunNo: <b>100890</b>								
Prep Date: <b>10/30/2023</b>	Analysis Date: <b>11/1/2023</b>	SeqNo: <b>3702085</b>	Units: <b>mg/Kg</b>							
Analyte	Result	PQL	SPK value	SPK Ref Val	%REC	LowLimit	HighLimit	%RPD	RPDLimit	Qual
Gasoline Range Organics (GRO)	22	5.0	25.00	0	87.8	70	130			
Surr: BFB	2100		1000		214	15	244			

Sample ID: <b>mb-78452</b>	SampType: <b>MBLK</b>	TestCode: <b>EPA Method 8015D: Gasoline Range</b>								
Client ID: <b>PBS</b>	Batch ID: <b>78452</b>	RunNo: <b>100890</b>								
Prep Date: <b>10/30/2023</b>	Analysis Date: <b>11/1/2023</b>	SeqNo: <b>3702086</b>	Units: <b>mg/Kg</b>							
Analyte	Result	PQL	SPK value	SPK Ref Val	%REC	LowLimit	HighLimit	%RPD	RPDLimit	Qual
Gasoline Range Organics (GRO)	ND	5.0								
Surr: BFB	1100		1000		106	15	244			

**Qualifiers:**

- \* Value exceeds Maximum Contaminant Level.
- D Sample Diluted Due to Matrix
- H Holding times for preparation or analysis exceeded
- ND Not Detected at the Reporting Limit
- PQL Practical Quantitative Limit
- S % Recovery outside of standard limits. If undiluted results may be estimated.
- B Analyte detected in the associated Method Blank
- E Above Quantitation Range/Estimated Value
- J Analyte detected below quantitation limits
- P Sample pH Not In Range
- RL Reporting Limit

# QC SUMMARY REPORT

## Hall Environmental Analysis Laboratory, Inc.

WO#: 2310D41

13-Nov-23

**Client:** EOG  
**Project:** Scripps 4

Sample ID: <b>ics-78452</b>	SampType: <b>LCS</b>		TestCode: <b>EPA Method 8021B: Volatiles</b>							
Client ID: <b>LCSS</b>	Batch ID: <b>78452</b>		RunNo: <b>100890</b>							
Prep Date: <b>10/30/2023</b>	Analysis Date: <b>11/1/2023</b>		SeqNo: <b>3702063</b>		Units: <b>mg/Kg</b>					
Analyte	Result	PQL	SPK value	SPK Ref Val	%REC	LowLimit	HighLimit	%RPD	RPDLimit	Qual
Benzene	0.75	0.025	1.000	0	74.7	70	130			
Toluene	0.76	0.050	1.000	0	76.3	70	130			
Ethylbenzene	0.79	0.050	1.000	0	78.9	70	130			
Xylenes, Total	2.3	0.10	3.000	0	78.3	70	130			
Surr: 4-Bromofluorobenzene	0.86		1.000		86.5	39.1	146			

Sample ID: <b>mb-78452</b>	SampType: <b>MBLK</b>		TestCode: <b>EPA Method 8021B: Volatiles</b>							
Client ID: <b>PBS</b>	Batch ID: <b>78452</b>		RunNo: <b>100890</b>							
Prep Date: <b>10/30/2023</b>	Analysis Date: <b>11/1/2023</b>		SeqNo: <b>3702064</b>		Units: <b>mg/Kg</b>					
Analyte	Result	PQL	SPK value	SPK Ref Val	%REC	LowLimit	HighLimit	%RPD	RPDLimit	Qual
Benzene	ND	0.025								
Toluene	ND	0.050								
Ethylbenzene	ND	0.050								
Xylenes, Total	ND	0.10								
Surr: 4-Bromofluorobenzene	0.89		1.000		89.0	39.1	146			

**Qualifiers:**

- \* Value exceeds Maximum Contaminant Level.
- D Sample Diluted Due to Matrix
- H Holding times for preparation or analysis exceeded
- ND Not Detected at the Reporting Limit
- PQL Practical Quantitative Limit
- S % Recovery outside of standard limits. If undiluted results may be estimated.
- B Analyte detected in the associated Method Blank
- E Above Quantitation Range/Estimated Value
- J Analyte detected below quantitation limits
- P Sample pH Not In Range
- RL Reporting Limit



Hall Environmental Analysis Laboratory
4901 Hawkins NE
Albuquerque, NM 87109
TEL: 505-345-3975 FAX: 505-345-4107
Website: www.hallenvironmental.com

Sample Log-In Check List

Client Name: EOG Work Order Number: 2310D41 RcptNo: 1

Received By: Cheyenne Cason 10/28/2023 7:50:00 AM
Completed By: Cheyenne Cason 10/28/2023 8:43:31 AM
Reviewed By: 7/10/30/23

Chain of Custody

- 1. Is Chain of Custody complete? Yes [checked] No [ ] Not Present [ ]
2. How was the sample delivered? Courier

Log In

- 3. Was an attempt made to cool the samples? Yes [checked] No [ ] NA [ ]
4. Were all samples received at a temperature of >0° C to 6.0°C Yes [checked] No [ ] NA [ ]
5. Sample(s) in proper container(s)? Yes [checked] No [ ]
6. Sufficient sample volume for indicated test(s)? Yes [checked] No [ ]
7. Are samples (except VOA and ONG) properly preserved? Yes [checked] No [ ]
8. Was preservative added to bottles? Yes [ ] No [checked] NA [ ]
9. Received at least 1 vial with headspace <1/4" for AQ VOA? Yes [ ] No [ ] NA [checked]
10. Were any sample containers received broken? Yes [ ] No [checked]
11. Does paperwork match bottle labels? Yes [checked] No [ ]
12. Are matrices correctly identified on Chain of Custody? Yes [checked] No [ ]
13. Is it clear what analyses were requested? Yes [checked] No [ ]
14. Were all holding times able to be met? Yes [checked] No [ ]

# of preserved bottles checked for pH: (<2 or >12 unless noted)
Adjusted?
Checked by CMC 10/28/23

Special Handling (if applicable)

- 15. Was client notified of all discrepancies with this order? Yes [ ] No [ ] NA [checked]

Person Notified: Date:
By Whom: Via: [ ] eMail [ ] Phone [ ] Fax [ ] In Person
Regarding:
Client Instructions:

16. Additional remarks:

17. Cooler Information

Table with 7 columns: Cooler No, Temp °C, Condition, Seal Intact, Seal No, Seal Date, Signed By. Contains 2 rows of data.

Standard  Rush 5 DAY FAT  
Project Name: Scripts #4  
Project #: 5375

Client: EOG-Artesia / Ranger Env.  
Mailing Address: EOG - 105 S 4th St, Artesia NM, 88210  
Ranger: PO Box 201179, Austin TX 78720  
Phone #: 521-335-1785  
email or Fax#: Will@RangerEnv.com

QA/QC Package:  
 Standard  Level 4 (Full Validation)  
Accreditation:  Az Compliance  
 NELAC  Other  
 EDD (Type) Excel

Analysis Request	
BTEX (8021)	X
TPH:8015D(GRO / DRO / MRO)	X
Chloride (EPA 300)	X

Project Manager: W. Kierdorf  
Sampler: J. Martinez  
On Ice:  Yes  No Yog.  
# of Coolers: 2 0.7-0=0.7  
Cooler Temp (including Cf): 29-0=2.9  
Container Type and # | Preservative Type | HEAL No.  
1x402 Jar | ICE | 2310041  
001  
002  
003  
004  
005  
006  
007  
008  
009  
010  
012 ONI  
012

Date	Time	Matrix	Sample Name	Received by:	Via:	Date	Time
<u>10-26-23</u>	<u>1500</u>	<u>soil</u>	<u>B-1</u>	<u>W. Kierdorf</u>	<u>Hand</u>	<u>10/26/23</u>	<u>0750</u>
<u>1502</u>			<u>B-2</u>				
<u>1504</u>			<u>B-3</u>				
<u>1506</u>			<u>B-4</u>				
<u>1530</u>			<u>B-5</u>				
<u>1532</u>			<u>B-6</u>				
<u>1538</u>			<u>B-7</u>				
<u>1600</u>			<u>B-8</u>				
<u>1602</u>			<u>B-9</u>				
<u>1620</u>			<u>PW-1</u>				
<u>1624</u>			<u>NW-1</u>				
<u>1622</u>			<u>SW-1</u>				
<u>10-27-23</u>	<u>0815</u>			<u>W. Kierdorf</u>	<u>Hand</u>	<u>10/27/23</u>	<u>0815</u>
<u>10/17/23</u>	<u>1600</u>			<u>W. Kierdorf</u>	<u>Hand</u>	<u>10/17/23</u>	<u>0750</u>

Remarks: Bill to EOG Artesia

Received From: 6/25/2024 10:47:50 AM

Client: EOG-Artesia / Ranger Env.

Mailing Address: EOG - 106 S 4th St, Artesia NM, 88210

Ranger: PO Box 201179, Austin TX 78720

Phone #: 521-335-1785

email or Fax#: Will@RangerEnv.com

QA/QC Package:  Standard  Level 4 (Full Validation)

Accreditation:  Az Compliance

NELAC  Other \_\_\_\_\_

EDD (Type) Excel

Date	Time	Matrix	Sample Name	Container Type and #	Preservative Type	HEAL No.
10-26-23	1618	Soil	Ramp - 2	1x4oz Jar	ICE	2310D41 013



**HALL ENVIRONMENTAL ANALYSIS LABORATORY**  
www.hallenvironmental.com

4901 Hawkins NE - Albuquerque, NM 87109  
Tel. 505-345-3975 Fax 505-345-4107

Page 27 of 118  
2 of 2

Standard  Rush 5 DAY TAT

Project Name: SCRIPPS #4

Project #: 5375

Project Manager: W. Kierdorf

Sampler: J. Martinez

On Ice:  Yes  No Yogurt

# of Coolers: 2 0.7-0=0.7

Cooler Temp (including CF): 2, 9-0=2.9

Container Type and #  
1x4oz Jar

Preservative Type  
ICE

HEAL No.  
2310D41

Analysis Request

Analysis	Result
BTEX (8021)	X
TPH:8015D(GRO / DRO / MRO)	X X
Chloride (EPA 300)	X X

Received by: [Signature] Date: 10/27/23 Time: 815

Relinquished by: [Signature] Date: 10/27/23 Time: 1910

Via: EMS

Remarks: Bill to EOG Artesia

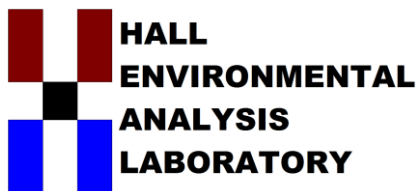

Hall Environmental Analysis Laboratory  
4901 Hawkins NE  
Albuquerque, NM 87109  
TEL: 505-345-3975 FAX: 505-345-4107  
Website: [clients.hallenvironmental.com](http://clients.hallenvironmental.com)

October 20, 2021

Tom Larson  
GHD Midland  
2135 S Loop 250 W  
Midland, TX 79703  
TEL: (432) 686-0086  
FAX

RE: Scripps 4

OrderNo.: 2110549

Dear Tom Larson:

Hall Environmental Analysis Laboratory received 1 sample(s) on 10/12/2021 for the analyses presented in the following report.

These were analyzed according to EPA procedures or equivalent. To access our accredited tests please go to [www.hallenvironmental.com](http://www.hallenvironmental.com) or the state specific web sites. In order to properly interpret your results, it is imperative that you review this report in its entirety. See the sample checklist and/or the Chain of Custody for information regarding the sample receipt temperature and preservation. Data qualifiers or a narrative will be provided if the sample analysis or analytical quality control parameters require a flag. When necessary, data qualifiers are provided on both the sample analysis report and the QC summary report, both sections should be reviewed. All samples are reported, as received, unless otherwise indicated. Lab measurement of analytes considered field parameters that require analysis within 15 minutes of sampling such as pH and residual chlorine are qualified as being analyzed outside of the recommended holding time.

Please don't hesitate to contact HEAL for any additional information or clarifications.

ADHS Cert #AZ0682 -- NMED-DWB Cert #NM9425 -- NMED-Micro Cert #NM0901

Sincerely,

A handwritten signature in black ink, appearing to read "Andy Freeman", is written over a light blue horizontal line.

Andy Freeman  
Laboratory Manager  
4901 Hawkins NE  
Albuquerque, NM 87109



**Analytical Report**

Lab Order **2110549**

Date Reported: **10/20/2021**

**Hall Environmental Analysis Laboratory, Inc.**

**CLIENT:** GHD Midland

**Client Sample ID:** SW-4A

**Project:** Scripps 4

**Collection Date:** 10/8/2021 6:40:00 AM

**Lab ID:** 2110549-001

**Matrix:** MEOH (SOIL)

**Received Date:** 10/12/2021 7:30:00 AM

Analyses	Result	RL	Qual	Units	DF	Date Analyzed	Batch
<b>EPA METHOD 300.0: ANIONS</b>							Analyst: <b>VP</b>
Chloride	170	60		mg/Kg	20	10/12/2021 8:56:42 AM	63222
<b>EPA METHOD 8015M/D: DIESEL RANGE ORGANICS</b>							Analyst: <b>JME</b>
Diesel Range Organics (DRO)	1200	190		mg/Kg	20	10/12/2021 12:13:39 PM	63221
Motor Oil Range Organics (MRO)	2000	960		mg/Kg	20	10/12/2021 12:13:39 PM	63221
Surr: DNOP	0	70-130	S	%Rec	20	10/12/2021 12:13:39 PM	63221
<b>EPA METHOD 8015D: GASOLINE RANGE</b>							Analyst: <b>NSB</b>
Gasoline Range Organics (GRO)	ND	4.3		mg/Kg	1	10/12/2021 9:15:10 AM	G81976
Surr: BFB	95.0	70-130		%Rec	1	10/12/2021 9:15:10 AM	G81976
<b>EPA METHOD 8021B: VOLATILES</b>							Analyst: <b>NSB</b>
Benzene	ND	0.021		mg/Kg	1	10/12/2021 9:15:10 AM	B81976
Toluene	ND	0.043		mg/Kg	1	10/12/2021 9:15:10 AM	B81976
Ethylbenzene	ND	0.043		mg/Kg	1	10/12/2021 9:15:10 AM	B81976
Xylenes, Total	ND	0.085		mg/Kg	1	10/12/2021 9:15:10 AM	B81976
Surr: 4-Bromofluorobenzene	83.7	70-130		%Rec	1	10/12/2021 9:15:10 AM	B81976

Refer to the QC Summary report and sample login checklist for flagged QC data and preservation information.

<b>Qualifiers:</b>	*	Value exceeds Maximum Contaminant Level.	B	Analyte detected in the associated Method Blank
	D	Sample Diluted Due to Matrix	E	Value above quantitation range
	H	Holding times for preparation or analysis exceeded	J	Analyte detected below quantitation limits
	ND	Not Detected at the Reporting Limit	P	Sample pH Not In Range
	PQL	Practical Quantitative Limit	RL	Reporting Limit
	S	% Recovery outside of range due to dilution or matrix		

# QC SUMMARY REPORT

**Hall Environmental Analysis Laboratory, Inc.**

WO#: 2110549

20-Oct-21

**Client:** GHD Midland

**Project:** Scripps 4

Sample ID: <b>MB-63222</b>	SampType: <b>MBLK</b>	TestCode: <b>EPA Method 300.0: Anions</b>								
Client ID: <b>PBS</b>	Batch ID: <b>63222</b>	RunNo: <b>81958</b>								
Prep Date: <b>10/12/2021</b>	Analysis Date: <b>10/12/2021</b>	SeqNo: <b>2903221</b>	Units: <b>mg/Kg</b>							
Analyte	Result	PQL	SPK value	SPK Ref Val	%REC	LowLimit	HighLimit	%RPD	RPDLimit	Qual
Chloride	ND	1.5								

**Qualifiers:**

- |   |   |
|---|---|
| * Value exceeds Maximum Contaminant Level.              | B Analyte detected in the associated Method Blank |
| D Sample Diluted Due to Matrix                          | E Value above quantitation range                  |
| H Holding times for preparation or analysis exceeded    | J Analyte detected below quantitation limits      |
| ND Not Detected at the Reporting Limit                  | P Sample pH Not In Range                          |
| PQL Practical Quantitative Limit                        | RL Reporting Limit                                |
| S % Recovery outside of range due to dilution or matrix |   |

# QC SUMMARY REPORT

Hall Environmental Analysis Laboratory, Inc.

WO#: 2110549

20-Oct-21

**Client:** GHD Midland

**Project:** Scripps 4

Sample ID: <b>MB-63215</b>	SampType: <b>MBLK</b>	TestCode: <b>EPA Method 8015M/D: Diesel Range Organics</b>								
Client ID: <b>PBS</b>	Batch ID: <b>63215</b>	RunNo: <b>81979</b>								
Prep Date: <b>10/11/2021</b>	Analysis Date: <b>10/12/2021</b>	SeqNo: <b>2902480</b>	Units: <b>%Rec</b>							
Analyte	Result	PQL	SPK value	SPK Ref Val	%REC	LowLimit	HighLimit	%RPD	RPDLimit	Qual
Surr: DNOP	11		10.00		112	70	130			

Sample ID: <b>MB-63221</b>	SampType: <b>MBLK</b>	TestCode: <b>EPA Method 8015M/D: Diesel Range Organics</b>								
Client ID: <b>PBS</b>	Batch ID: <b>63221</b>	RunNo: <b>81979</b>								
Prep Date: <b>10/12/2021</b>	Analysis Date: <b>10/12/2021</b>	SeqNo: <b>2902483</b>	Units: <b>mg/Kg</b>							
Analyte	Result	PQL	SPK value	SPK Ref Val	%REC	LowLimit	HighLimit	%RPD	RPDLimit	Qual
Diesel Range Organics (DRO)	ND	10								
Motor Oil Range Organics (MRO)	ND	50								
Surr: DNOP	9.7		10.00		97.2	70	130			

Sample ID: <b>LCS-63215</b>	SampType: <b>LCS</b>	TestCode: <b>EPA Method 8015M/D: Diesel Range Organics</b>								
Client ID: <b>LCSS</b>	Batch ID: <b>63215</b>	RunNo: <b>81979</b>								
Prep Date: <b>10/11/2021</b>	Analysis Date: <b>10/12/2021</b>	SeqNo: <b>2902492</b>	Units: <b>%Rec</b>							
Analyte	Result	PQL	SPK value	SPK Ref Val	%REC	LowLimit	HighLimit	%RPD	RPDLimit	Qual
Surr: DNOP	6.5		5.000		129	70	130			

Sample ID: <b>LCS-63221</b>	SampType: <b>LCS</b>	TestCode: <b>EPA Method 8015M/D: Diesel Range Organics</b>								
Client ID: <b>LCSS</b>	Batch ID: <b>63221</b>	RunNo: <b>81979</b>								
Prep Date: <b>10/12/2021</b>	Analysis Date: <b>10/12/2021</b>	SeqNo: <b>2902494</b>	Units: <b>mg/Kg</b>							
Analyte	Result	PQL	SPK value	SPK Ref Val	%REC	LowLimit	HighLimit	%RPD	RPDLimit	Qual
Diesel Range Organics (DRO)	50	10	50.00	0	99.3	68.9	135			
Surr: DNOP	5.3		5.000		106	70	130			

**Qualifiers:**

- \* Value exceeds Maximum Contaminant Level.
- D Sample Diluted Due to Matrix
- H Holding times for preparation or analysis exceeded
- ND Not Detected at the Reporting Limit
- PQL Practical Quantitative Limit
- S % Recovery outside of range due to dilution or matrix
- B Analyte detected in the associated Method Blank
- E Value above quantitation range
- J Analyte detected below quantitation limits
- P Sample pH Not In Range
- RL Reporting Limit

# QC SUMMARY REPORT

Hall Environmental Analysis Laboratory, Inc.

WO#: 2110549

20-Oct-21

**Client:** GHD Midland

**Project:** Scripps 4

Sample ID: <b>mb</b>	SampType: <b>MBLK</b>	TestCode: <b>EPA Method 8015D: Gasoline Range</b>								
Client ID: <b>PBS</b>	Batch ID: <b>G81976</b>	RunNo: <b>81976</b>								
Prep Date:	Analysis Date: <b>10/12/2021</b>	SeqNo: <b>2902810</b>	Units: <b>mg/Kg</b>							
Analyte	Result	PQL	SPK value	SPK Ref Val	%REC	LowLimit	HighLimit	%RPD	RPDLimit	Qual
Gasoline Range Organics (GRO)	ND	5.0								
Surr: BFB	990		1000		99.1	70	130			

Sample ID: <b>2.5ug gro lcs</b>	SampType: <b>LCS</b>	TestCode: <b>EPA Method 8015D: Gasoline Range</b>								
Client ID: <b>LCSS</b>	Batch ID: <b>G81976</b>	RunNo: <b>81976</b>								
Prep Date:	Analysis Date: <b>10/12/2021</b>	SeqNo: <b>2902811</b>	Units: <b>mg/Kg</b>							
Analyte	Result	PQL	SPK value	SPK Ref Val	%REC	LowLimit	HighLimit	%RPD	RPDLimit	Qual
Gasoline Range Organics (GRO)	26	5.0	25.00	0	104	78.6	131			
Surr: BFB	1100		1000		108	70	130			

Sample ID: <b>mb-63212</b>	SampType: <b>MBLK</b>	TestCode: <b>EPA Method 8015D: Gasoline Range</b>								
Client ID: <b>PBS</b>	Batch ID: <b>63212</b>	RunNo: <b>81976</b>								
Prep Date: <b>10/11/2021</b>	Analysis Date: <b>10/12/2021</b>	SeqNo: <b>2902815</b>	Units: <b>%Rec</b>							
Analyte	Result	PQL	SPK value	SPK Ref Val	%REC	LowLimit	HighLimit	%RPD	RPDLimit	Qual
Surr: BFB	940		1000		94.3	70	130			

Sample ID: <b>lcs-63212</b>	SampType: <b>LCS</b>	TestCode: <b>EPA Method 8015D: Gasoline Range</b>								
Client ID: <b>LCSS</b>	Batch ID: <b>63212</b>	RunNo: <b>81976</b>								
Prep Date: <b>10/11/2021</b>	Analysis Date: <b>10/12/2021</b>	SeqNo: <b>2902816</b>	Units: <b>%Rec</b>							
Analyte	Result	PQL	SPK value	SPK Ref Val	%REC	LowLimit	HighLimit	%RPD	RPDLimit	Qual
Surr: BFB	1100		1000		107	70	130			

**Qualifiers:**

- \* Value exceeds Maximum Contaminant Level.
- D Sample Diluted Due to Matrix
- H Holding times for preparation or analysis exceeded
- ND Not Detected at the Reporting Limit
- PQL Practical Quantitative Limit
- S % Recovery outside of range due to dilution or matrix
- B Analyte detected in the associated Method Blank
- E Value above quantitation range
- J Analyte detected below quantitation limits
- P Sample pH Not In Range
- RL Reporting Limit

# QC SUMMARY REPORT

## Hall Environmental Analysis Laboratory, Inc.

WO#: 2110549

20-Oct-21

**Client:** GHD Midland

**Project:** Scripps 4

Sample ID: <b>mb</b>	SampType: <b>MBLK</b>	TestCode: <b>EPA Method 8021B: Volatiles</b>								
Client ID: <b>PBS</b>	Batch ID: <b>B81976</b>	RunNo: <b>81976</b>								
Prep Date:	Analysis Date: <b>10/12/2021</b>	SeqNo: <b>2902857</b>	Units: <b>mg/Kg</b>							
Analyte	Result	PQL	SPK value	SPK Ref Val	%REC	LowLimit	HighLimit	%RPD	RPDLimit	Qual
Benzene	ND	0.025								
Toluene	ND	0.050								
Ethylbenzene	ND	0.050								
Xylenes, Total	ND	0.10								
Surr: 4-Bromofluorobenzene	0.87		1.000		87.1	70	130			

Sample ID: <b>100ng btex lcs</b>	SampType: <b>LCS</b>	TestCode: <b>EPA Method 8021B: Volatiles</b>								
Client ID: <b>LCSS</b>	Batch ID: <b>B81976</b>	RunNo: <b>81976</b>								
Prep Date:	Analysis Date: <b>10/12/2021</b>	SeqNo: <b>2902858</b>	Units: <b>mg/Kg</b>							
Analyte	Result	PQL	SPK value	SPK Ref Val	%REC	LowLimit	HighLimit	%RPD	RPDLimit	Qual
Benzene	0.92	0.025	1.000	0	92.1	80	120			
Toluene	0.94	0.050	1.000	0	94.4	80	120			
Ethylbenzene	0.94	0.050	1.000	0	94.4	80	120			
Xylenes, Total	2.8	0.10	3.000	0	92.8	80	120			
Surr: 4-Bromofluorobenzene	0.88		1.000		87.8	70	130			

Sample ID: <b>mb-63212</b>	SampType: <b>MBLK</b>	TestCode: <b>EPA Method 8021B: Volatiles</b>								
Client ID: <b>PBS</b>	Batch ID: <b>63212</b>	RunNo: <b>81976</b>								
Prep Date: <b>10/11/2021</b>	Analysis Date: <b>10/12/2021</b>	SeqNo: <b>2902862</b>	Units: <b>%Rec</b>							
Analyte	Result	PQL	SPK value	SPK Ref Val	%REC	LowLimit	HighLimit	%RPD	RPDLimit	Qual
Surr: 4-Bromofluorobenzene	0.85		1.000		84.5	70	130			

Sample ID: <b>LCS-63212</b>	SampType: <b>LCS</b>	TestCode: <b>EPA Method 8021B: Volatiles</b>								
Client ID: <b>LCSS</b>	Batch ID: <b>63212</b>	RunNo: <b>81976</b>								
Prep Date: <b>10/11/2021</b>	Analysis Date: <b>10/12/2021</b>	SeqNo: <b>2902863</b>	Units: <b>%Rec</b>							
Analyte	Result	PQL	SPK value	SPK Ref Val	%REC	LowLimit	HighLimit	%RPD	RPDLimit	Qual
Surr: 4-Bromofluorobenzene	0.88		1.000		88.0	70	130			

**Qualifiers:**

- \* Value exceeds Maximum Contaminant Level.
- D Sample Diluted Due to Matrix
- H Holding times for preparation or analysis exceeded
- ND Not Detected at the Reporting Limit
- PQL Practical Quantitative Limit
- S % Recovery outside of range due to dilution or matrix
- B Analyte detected in the associated Method Blank
- E Value above quantitation range
- J Analyte detected below quantitation limits
- P Sample pH Not In Range
- RL Reporting Limit

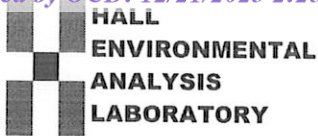

Hall Environmental Analysis Laboratory  
4901 Hawkins NE  
Albuquerque, NM 87109  
TEL: 505-345-3975 FAX: 505-345-4107  
Website: clients.hallenvironmental.com

# Sample Log-In Check List

Client Name: GHD Midland                      Work Order Number: 2110549                      RcptNo: 1

Received By: **Cheyenne Cason**                      10/12/2021 7:30:00 AM

*Cason*

Completed By: **Sean Livingston**                      10/12/2021 8:03:33 AM

*Sean Livingston*

Reviewed By: *KPA 10/12/21*

### Chain of Custody

- 1. Is Chain of Custody complete?                      Yes                       No                       Not Present
- 2. How was the sample delivered?                      Courier

### Log In

- 3. Was an attempt made to cool the samples?                      Yes                       No                       NA
- 4. Were all samples received at a temperature of >0° C to 6.0°C                      Yes                       No                       NA
- 5. Sample(s) in proper container(s)?                      Yes                       No
- 6. Sufficient sample volume for indicated test(s)?                      Yes                       No
- 7. Are samples (except VOA and ONG) properly preserved?                      Yes                       No
- 8. Was preservative added to bottles?                      Yes                       No                       NA
- 9. Received at least 1 vial with headspace <1/4" for AQ VOA?                      Yes                       No                       NA
- 10. Were any sample containers received broken?                      Yes                       No
- 11. Does paperwork match bottle labels?                      Yes                       No   
(Note discrepancies on chain of custody)
- 12. Are matrices correctly identified on Chain of Custody?                      Yes                       No
- 13. Is it clear what analyses were requested?                      Yes                       No
- 14. Were all holding times able to be met?                      Yes                       No   
(If no, notify customer for authorization.)

# of preserved bottles checked for pH: \_\_\_\_\_  
(<2 or >12 unless noted)  
Adjusted? \_\_\_\_\_  
Checked by: *JR 10/12/21*

### Special Handling (if applicable)

- 15. Was client notified of all discrepancies with this order?                      Yes                       No                       NA

Person Notified:	<input type="text"/>	Date:	<input type="text"/>
By Whom:	<input type="text"/>	Via:	<input type="checkbox"/> eMail <input type="checkbox"/> Phone <input type="checkbox"/> Fax <input type="checkbox"/> In Person
Regarding:	<input type="text"/>		
Client Instructions:	<input type="text"/>		

16. Additional remarks:

### 17. Cooler Information

Cooler No	Temp °C	Condition	Seal Intact	Seal No	Seal Date	Signed By
1	1.9	Good				

### Chain-of-Custody Record

Client: GHD

Mailing Address:  
 324 W. Main St. Suite 108, Artesia NM 88210  
 Phone #: (505)377-4218  
 email or Fax#: [Becky.Haskell@ghd.com](mailto:Becky.Haskell@ghd.com)

QA/QC Package:  
 Standard  Level 4 (Full Validation)  
 Accreditation:  AZ Compliance  
 NELAC  Other  
 EDD (Type)

Turn-Around Time: Sameday

Standard  Rush 24hr

Project Name: Stripes #4

Project #: 11222059

Project Manager:  
 Becky Haskell  
 Tom Larson

Sampler: Zach Comino

On Ice:  Yes  No

# of Coolers: 1

Cooler Temp (including CF): 1.8 + 0.1 = 1.9

Container Type and #  
Jar

Preservative Type  
HEAL No. 2110549



**HALL ENVIRONMENTAL ANALYSIS LABORATORY**  
 www.hallenvironmental.com  
 4901 Hawkins NE - Albuquerque, NM 87109  
 Tel. 505-345-3975 Fax 505-345-4107

Analysis Request	
<input checked="" type="checkbox"/> TPH:8015D(GRO / DRO / MRO)	
<input checked="" type="checkbox"/> BTEX / MTBE / TMBs (8021)	
8081 Pesticides/8082 PCB's	
EDB (Method 504.1)	
PAHs by 8310 or 8270SIMS	
RCRA 8 Metals	
Cl, F, Br, NO <sub>3</sub> , NO <sub>2</sub> , PO <sub>4</sub> , SO <sub>4</sub>	
8260 (VOA)	
8270 (Semi-VOA)	
Total Coliform (Present/Absent)	<u>Alkaline Method 300</u>

Received by: gmm Date: 10/18/21 Time: 0800

Relinquished by: Zach Comino / JAL

Date: 10/18/21 Time: 1900

Relinquished by: gmm

Via: Car Comm Date: 10/12/21 Time: 0730

Remarks: Please email: Chase\_Settle@eogresources.com; Tom.Larson@ghd.com; Zach.Comino@ghd.com; Matthew.Laughlin@ghd.com; Along with Becky Haskell listed above.

Direct Bill to EOG Chase Settle

If necessary, samples submitted to Hall Environmental may be subcontracted to other accredited laboratories. This serves as notice of this possibility. Any sub-contracted data will be clearly notated on the analytical report.

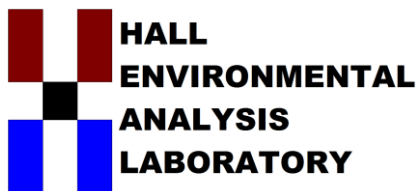

Hall Environmental Analysis Laboratory  
4901 Hawkins NE  
Albuquerque, NM 87109  
TEL: 505-345-3975 FAX: 505-345-4107  
Website: clients.hallenvironmental.com

August 12, 2021

Tom Larson  
GHD Midland  
2135 S Loop 250 W  
Midland, TX 79703  
TEL: (432) 686-0086  
FAX

RE: Scripps 4

OrderNo.: 2108131

Dear Tom Larson:

Hall Environmental Analysis Laboratory received 4 sample(s) on 8/4/2021 for the analyses presented in the following report.

These were analyzed according to EPA procedures or equivalent. To access our accredited tests please go to [www.hallenvironmental.com](http://www.hallenvironmental.com) or the state specific web sites. In order to properly interpret your results, it is imperative that you review this report in its entirety. See the sample checklist and/or the Chain of Custody for information regarding the sample receipt temperature and preservation. Data qualifiers or a narrative will be provided if the sample analysis or analytical quality control parameters require a flag. When necessary, data qualifiers are provided on both the sample analysis report and the QC summary report, both sections should be reviewed. All samples are reported, as received, unless otherwise indicated. Lab measurement of analytes considered field parameters that require analysis within 15 minutes of sampling such as pH and residual chlorine are qualified as being analyzed outside of the recommended holding time.

Please don't hesitate to contact HEAL for any additional information or clarifications.

ADHS Cert #AZ0682 -- NMED-DWB Cert #NM9425 -- NMED-Micro Cert #NM0901

Sincerely,

A handwritten signature in black ink, appearing to read 'Andy Freeman', is written over a white background.

Andy Freeman  
Laboratory Manager  
4901 Hawkins NE  
Albuquerque, NM 87109



**Analytical Report**

Lab Order **2108131**

Date Reported: **8/12/2021**

**Hall Environmental Analysis Laboratory, Inc.**

**CLIENT:** GHD Midland

**Client Sample ID:** SW-4

**Project:** Scripps 4

**Collection Date:** 8/2/2021 8:40:00 AM

**Lab ID:** 2108131-001

**Matrix:** SOIL

**Received Date:** 8/4/2021 7:50:00 AM

Analyses	Result	RL	Qual	Units	DF	Date Analyzed	Batch
<b>EPA METHOD 300.0: ANIONS</b>							Analyst: <b>VP</b>
Chloride	800	60		mg/Kg	20	8/9/2021 7:28:26 AM	61826
<b>EPA METHOD 8015M/D: DIESEL RANGE ORGANICS</b>							Analyst: <b>SB</b>
Diesel Range Organics (DRO)	540	48		mg/Kg	5	8/10/2021 2:21:45 AM	61790
Motor Oil Range Organics (MRO)	940	240		mg/Kg	5	8/10/2021 2:21:45 AM	61790
Surr: DNOP	109	70-130		%Rec	5	8/10/2021 2:21:45 AM	61790
<b>EPA METHOD 8015D: GASOLINE RANGE</b>							Analyst: <b>mb</b>
Gasoline Range Organics (GRO)	ND	4.8		mg/Kg	1	8/5/2021 11:28:00 AM	61781
Surr: BFB	109	70-130		%Rec	1	8/5/2021 11:28:00 AM	61781
<b>EPA METHOD 8021B: VOLATILES</b>							Analyst: <b>mb</b>
Benzene	ND	0.024		mg/Kg	1	8/5/2021 11:28:00 AM	61781
Toluene	ND	0.048		mg/Kg	1	8/5/2021 11:28:00 AM	61781
Ethylbenzene	ND	0.048		mg/Kg	1	8/5/2021 11:28:00 AM	61781
Xylenes, Total	ND	0.097		mg/Kg	1	8/5/2021 11:28:00 AM	61781
Surr: 4-Bromofluorobenzene	92.8	70-130		%Rec	1	8/5/2021 11:28:00 AM	61781

Refer to the QC Summary report and sample login checklist for flagged QC data and preservation information.

<b>Qualifiers:</b>	*	Value exceeds Maximum Contaminant Level.	B	Analyte detected in the associated Method Blank
	D	Sample Diluted Due to Matrix	E	Value above quantitation range
	H	Holding times for preparation or analysis exceeded	J	Analyte detected below quantitation limits
	ND	Not Detected at the Reporting Limit	P	Sample pH Not In Range
	PQL	Practical Quantitative Limit	RL	Reporting Limit
	S	% Recovery outside of range due to dilution or matrix		

**Analytical Report**

Lab Order **2108131**

Date Reported: **8/12/2021**

**Hall Environmental Analysis Laboratory, Inc.**

**CLIENT:** GHD Midland

**Client Sample ID:** SW-1A

**Project:** Scripps 4

**Collection Date:** 8/2/2021 9:20:00 AM

**Lab ID:** 2108131-002

**Matrix:** SOIL

**Received Date:** 8/4/2021 7:50:00 AM

Analyses	Result	RL	Qual	Units	DF	Date Analyzed	Batch
<b>EPA METHOD 300.0: ANIONS</b>							Analyst: <b>VP</b>
Chloride	600	60		mg/Kg	20	8/9/2021 7:40:50 AM	61826
<b>EPA METHOD 8015M/D: DIESEL RANGE ORGANICS</b>							Analyst: <b>SB</b>
Diesel Range Organics (DRO)	ND	9.5		mg/Kg	1	8/6/2021 11:22:41 AM	61790
Motor Oil Range Organics (MRO)	ND	48		mg/Kg	1	8/6/2021 11:22:41 AM	61790
Surr: DNOP	93.9	70-130		%Rec	1	8/6/2021 11:22:41 AM	61790
<b>EPA METHOD 8015D: GASOLINE RANGE</b>							Analyst: <b>mb</b>
Gasoline Range Organics (GRO)	ND	4.7		mg/Kg	1	8/5/2021 1:07:00 PM	61781
Surr: BFB	104	70-130		%Rec	1	8/5/2021 1:07:00 PM	61781
<b>EPA METHOD 8021B: VOLATILES</b>							Analyst: <b>mb</b>
Benzene	ND	0.023		mg/Kg	1	8/5/2021 1:07:00 PM	61781
Toluene	ND	0.047		mg/Kg	1	8/5/2021 1:07:00 PM	61781
Ethylbenzene	ND	0.047		mg/Kg	1	8/5/2021 1:07:00 PM	61781
Xylenes, Total	ND	0.093		mg/Kg	1	8/5/2021 1:07:00 PM	61781
Surr: 4-Bromofluorobenzene	91.8	70-130		%Rec	1	8/5/2021 1:07:00 PM	61781

Refer to the QC Summary report and sample login checklist for flagged QC data and preservation information.

<b>Qualifiers:</b>	*	Value exceeds Maximum Contaminant Level.	B	Analyte detected in the associated Method Blank
	D	Sample Diluted Due to Matrix	E	Value above quantitation range
	H	Holding times for preparation or analysis exceeded	J	Analyte detected below quantitation limits
	ND	Not Detected at the Reporting Limit	P	Sample pH Not In Range
	PQL	Practical Quantitative Limit	RL	Reporting Limit
	S	% Recovery outside of range due to dilution or matrix		

**Analytical Report**

Lab Order **2108131**

Date Reported: **8/12/2021**

**Hall Environmental Analysis Laboratory, Inc.**

**CLIENT:** GHD Midland

**Client Sample ID:** TP1-2

**Project:** Scripps 4

**Collection Date:** 8/2/2021 12:55:00 PM

**Lab ID:** 2108131-003

**Matrix:** SOIL

**Received Date:** 8/4/2021 7:50:00 AM

Analyses	Result	RL	Qual	Units	DF	Date Analyzed	Batch
<b>EPA METHOD 300.0: ANIONS</b>							Analyst: <b>VP</b>
Chloride	2300	150		mg/Kg	50	8/10/2021 4:38:34 PM	61826
<b>EPA METHOD 8015M/D: DIESEL RANGE ORGANICS</b>							Analyst: <b>SB</b>
Diesel Range Organics (DRO)	ND	9.6		mg/Kg	1	8/6/2021 11:34:56 AM	61790
Motor Oil Range Organics (MRO)	ND	48		mg/Kg	1	8/6/2021 11:34:56 AM	61790
Surr: DNOP	90.2	70-130		%Rec	1	8/6/2021 11:34:56 AM	61790
<b>EPA METHOD 8015D: GASOLINE RANGE</b>							Analyst: <b>mb</b>
Gasoline Range Organics (GRO)	ND	4.7		mg/Kg	1	8/5/2021 2:07:00 PM	61781
Surr: BFB	105	70-130		%Rec	1	8/5/2021 2:07:00 PM	61781
<b>EPA METHOD 8021B: VOLATILES</b>							Analyst: <b>mb</b>
Benzene	ND	0.024		mg/Kg	1	8/5/2021 2:07:00 PM	61781
Toluene	ND	0.047		mg/Kg	1	8/5/2021 2:07:00 PM	61781
Ethylbenzene	ND	0.047		mg/Kg	1	8/5/2021 2:07:00 PM	61781
Xylenes, Total	ND	0.094		mg/Kg	1	8/5/2021 2:07:00 PM	61781
Surr: 4-Bromofluorobenzene	91.5	70-130		%Rec	1	8/5/2021 2:07:00 PM	61781

Refer to the QC Summary report and sample login checklist for flagged QC data and preservation information.

<b>Qualifiers:</b>	*	Value exceeds Maximum Contaminant Level.	B	Analyte detected in the associated Method Blank
	D	Sample Diluted Due to Matrix	E	Value above quantitation range
	H	Holding times for preparation or analysis exceeded	J	Analyte detected below quantitation limits
	ND	Not Detected at the Reporting Limit	P	Sample pH Not In Range
	PQL	Practical Quantitative Limit	RL	Reporting Limit
	S	% Recovery outside of range due to dilution or matrix		

**Analytical Report**

Lab Order **2108131**

Date Reported: **8/12/2021**

**Hall Environmental Analysis Laboratory, Inc.**

**CLIENT:** GHD Midland

**Client Sample ID:** TP2-2

**Project:** Scripps 4

**Collection Date:** 8/2/2021 1:00:00 PM

**Lab ID:** 2108131-004

**Matrix:** SOIL

**Received Date:** 8/4/2021 7:50:00 AM

Analyses	Result	RL	Qual	Units	DF	Date Analyzed	Batch
<b>EPA METHOD 300.0: ANIONS</b>							Analyst: <b>VP</b>
Chloride	140	59		mg/Kg	20	8/9/2021 1:28:12 PM	61843
<b>EPA METHOD 8015M/D: DIESEL RANGE ORGANICS</b>							Analyst: <b>SB</b>
Diesel Range Organics (DRO)	ND	9.8		mg/Kg	1	8/6/2021 11:47:12 AM	61790
Motor Oil Range Organics (MRO)	ND	49		mg/Kg	1	8/6/2021 11:47:12 AM	61790
Surr: DNOP	89.7	70-130		%Rec	1	8/6/2021 11:47:12 AM	61790
<b>EPA METHOD 8015D: GASOLINE RANGE</b>							Analyst: <b>mb</b>
Gasoline Range Organics (GRO)	ND	4.8		mg/Kg	1	8/5/2021 2:27:00 PM	61781
Surr: BFB	109	70-130		%Rec	1	8/5/2021 2:27:00 PM	61781
<b>EPA METHOD 8021B: VOLATILES</b>							Analyst: <b>mb</b>
Benzene	ND	0.024		mg/Kg	1	8/5/2021 2:27:00 PM	61781
Toluene	ND	0.048		mg/Kg	1	8/5/2021 2:27:00 PM	61781
Ethylbenzene	ND	0.048		mg/Kg	1	8/5/2021 2:27:00 PM	61781
Xylenes, Total	ND	0.095		mg/Kg	1	8/5/2021 2:27:00 PM	61781
Surr: 4-Bromofluorobenzene	95.3	70-130		%Rec	1	8/5/2021 2:27:00 PM	61781

Refer to the QC Summary report and sample login checklist for flagged QC data and preservation information.

<b>Qualifiers:</b>	*	Value exceeds Maximum Contaminant Level.	B	Analyte detected in the associated Method Blank
	D	Sample Diluted Due to Matrix	E	Value above quantitation range
	H	Holding times for preparation or analysis exceeded	J	Analyte detected below quantitation limits
	ND	Not Detected at the Reporting Limit	P	Sample pH Not In Range
	PQL	Practical Quantitative Limit	RL	Reporting Limit
	S	% Recovery outside of range due to dilution or matrix		

# QC SUMMARY REPORT

Hall Environmental Analysis Laboratory, Inc.

WO#: 2108131

12-Aug-21

**Client:** GHD Midland

**Project:** Scripps 4

Sample ID: <b>MB-61826</b>	SampType: <b>MBLK</b>	TestCode: <b>EPA Method 300.0: Anions</b>								
Client ID: <b>PBS</b>	Batch ID: <b>61826</b>	RunNo: <b>80380</b>								
Prep Date: <b>8/6/2021</b>	Analysis Date: <b>8/7/2021</b>	SeqNo: <b>2832829</b>	Units: <b>mg/Kg</b>							
Analyte	Result	PQL	SPK value	SPK Ref Val	%REC	LowLimit	HighLimit	%RPD	RPDLimit	Qual
Chloride	ND	1.5								

Sample ID: <b>LCS-61826</b>	SampType: <b>LCS</b>	TestCode: <b>EPA Method 300.0: Anions</b>								
Client ID: <b>LCSS</b>	Batch ID: <b>61826</b>	RunNo: <b>80380</b>								
Prep Date: <b>8/6/2021</b>	Analysis Date: <b>8/7/2021</b>	SeqNo: <b>2832830</b>	Units: <b>mg/Kg</b>							
Analyte	Result	PQL	SPK value	SPK Ref Val	%REC	LowLimit	HighLimit	%RPD	RPDLimit	Qual
Chloride	14	1.5	15.00	0	93.0	90	110			

Sample ID: <b>MB-61843</b>	SampType: <b>MBLK</b>	TestCode: <b>EPA Method 300.0: Anions</b>								
Client ID: <b>PBS</b>	Batch ID: <b>61843</b>	RunNo: <b>80395</b>								
Prep Date: <b>8/9/2021</b>	Analysis Date: <b>8/9/2021</b>	SeqNo: <b>2833900</b>	Units: <b>mg/Kg</b>							
Analyte	Result	PQL	SPK value	SPK Ref Val	%REC	LowLimit	HighLimit	%RPD	RPDLimit	Qual
Chloride	ND	1.5								

Sample ID: <b>LCS-61843</b>	SampType: <b>LCS</b>	TestCode: <b>EPA Method 300.0: Anions</b>								
Client ID: <b>LCSS</b>	Batch ID: <b>61843</b>	RunNo: <b>80395</b>								
Prep Date: <b>8/9/2021</b>	Analysis Date: <b>8/9/2021</b>	SeqNo: <b>2833901</b>	Units: <b>mg/Kg</b>							
Analyte	Result	PQL	SPK value	SPK Ref Val	%REC	LowLimit	HighLimit	%RPD	RPDLimit	Qual
Chloride	14	1.5	15.00	0	93.8	90	110			

**Qualifiers:**

- \* Value exceeds Maximum Contaminant Level.
- D Sample Diluted Due to Matrix
- H Holding times for preparation or analysis exceeded
- ND Not Detected at the Reporting Limit
- PQL Practical Quantitative Limit
- S % Recovery outside of range due to dilution or matrix
- B Analyte detected in the associated Method Blank
- E Value above quantitation range
- J Analyte detected below quantitation limits
- P Sample pH Not In Range
- RL Reporting Limit

# QC SUMMARY REPORT

Hall Environmental Analysis Laboratory, Inc.

WO#: 2108131

12-Aug-21

**Client:** GHD Midland

**Project:** Scripps 4

Sample ID: <b>MB-61790</b>	SampType: <b>MBLK</b>	TestCode: <b>EPA Method 8015M/D: Diesel Range Organics</b>								
Client ID: <b>PBS</b>	Batch ID: <b>61790</b>	RunNo: <b>80370</b>								
Prep Date: <b>8/5/2021</b>	Analysis Date: <b>8/6/2021</b>	SeqNo: <b>2832252</b>	Units: <b>mg/Kg</b>							
Analyte	Result	PQL	SPK value	SPK Ref Val	%REC	LowLimit	HighLimit	%RPD	RPDLimit	Qual
Diesel Range Organics (DRO)	ND	10								
Motor Oil Range Organics (MRO)	ND	50								
Surr: DNOP	8.8		10.00		87.7	70	130			

Sample ID: <b>LCS-61790</b>	SampType: <b>LCS</b>	TestCode: <b>EPA Method 8015M/D: Diesel Range Organics</b>								
Client ID: <b>LCSS</b>	Batch ID: <b>61790</b>	RunNo: <b>80370</b>								
Prep Date: <b>8/5/2021</b>	Analysis Date: <b>8/6/2021</b>	SeqNo: <b>2832253</b>	Units: <b>mg/Kg</b>							
Analyte	Result	PQL	SPK value	SPK Ref Val	%REC	LowLimit	HighLimit	%RPD	RPDLimit	Qual
Diesel Range Organics (DRO)	44	10	50.00	0	87.4	68.9	141			
Surr: DNOP	4.2		5.000		84.6	70	130			

**Qualifiers:**

- \* Value exceeds Maximum Contaminant Level.
- D Sample Diluted Due to Matrix
- H Holding times for preparation or analysis exceeded
- ND Not Detected at the Reporting Limit
- PQL Practical Quantitative Limit
- S % Recovery outside of range due to dilution or matrix
- B Analyte detected in the associated Method Blank
- E Value above quantitation range
- J Analyte detected below quantitation limits
- P Sample pH Not In Range
- RL Reporting Limit

# QC SUMMARY REPORT

Hall Environmental Analysis Laboratory, Inc.

WO#: 2108131

12-Aug-21

**Client:** GHD Midland

**Project:** Scripps 4

Sample ID: <b>mb-61781</b>	SampType: <b>MBLK</b>	TestCode: <b>EPA Method 8015D: Gasoline Range</b>								
Client ID: <b>PBS</b>	Batch ID: <b>61781</b>	RunNo: <b>80340</b>								
Prep Date: <b>8/4/2021</b>	Analysis Date: <b>8/5/2021</b>	SeqNo: <b>2830741</b>	Units: <b>mg/Kg</b>							
Analyte	Result	PQL	SPK value	SPK Ref Val	%REC	LowLimit	HighLimit	%RPD	RPDLimit	Qual
Gasoline Range Organics (GRO)	ND	5.0								
Surr: BFB	1000		1000		102	70	130			

Sample ID: <b>ics-61781</b>	SampType: <b>LCS</b>	TestCode: <b>EPA Method 8015D: Gasoline Range</b>								
Client ID: <b>LCSS</b>	Batch ID: <b>61781</b>	RunNo: <b>80340</b>								
Prep Date: <b>8/4/2021</b>	Analysis Date: <b>8/5/2021</b>	SeqNo: <b>2830744</b>	Units: <b>mg/Kg</b>							
Analyte	Result	PQL	SPK value	SPK Ref Val	%REC	LowLimit	HighLimit	%RPD	RPDLimit	Qual
Gasoline Range Organics (GRO)	29	5.0	25.00	0	115	78.6	131			
Surr: BFB	1200		1000		119	70	130			

**Qualifiers:**

- \* Value exceeds Maximum Contaminant Level.
- D Sample Diluted Due to Matrix
- H Holding times for preparation or analysis exceeded
- ND Not Detected at the Reporting Limit
- PQL Practical Quantitative Limit
- S % Recovery outside of range due to dilution or matrix
- B Analyte detected in the associated Method Blank
- E Value above quantitation range
- J Analyte detected below quantitation limits
- P Sample pH Not In Range
- RL Reporting Limit

# QC SUMMARY REPORT

## Hall Environmental Analysis Laboratory, Inc.

WO#: 2108131

12-Aug-21

**Client:** GHD Midland

**Project:** Scripps 4

Sample ID: <b>mb-61781</b>	SampType: <b>MBLK</b>	TestCode: <b>EPA Method 8021B: Volatiles</b>								
Client ID: <b>PBS</b>	Batch ID: <b>61781</b>	RunNo: <b>80340</b>								
Prep Date: <b>8/4/2021</b>	Analysis Date: <b>8/5/2021</b>	SeqNo: <b>2830825</b>	Units: <b>mg/Kg</b>							
Analyte	Result	PQL	SPK value	SPK Ref Val	%REC	LowLimit	HighLimit	%RPD	RPDLimit	Qual
Benzene	ND	0.025								
Toluene	ND	0.050								
Ethylbenzene	ND	0.050								
Xylenes, Total	ND	0.10								
Surr: 4-Bromofluorobenzene	0.92		1.000		91.7	70	130			

Sample ID: <b>ics-61781</b>	SampType: <b>LCS</b>	TestCode: <b>EPA Method 8021B: Volatiles</b>								
Client ID: <b>LCSS</b>	Batch ID: <b>61781</b>	RunNo: <b>80340</b>								
Prep Date: <b>8/4/2021</b>	Analysis Date: <b>8/5/2021</b>	SeqNo: <b>2830826</b>	Units: <b>mg/Kg</b>							
Analyte	Result	PQL	SPK value	SPK Ref Val	%REC	LowLimit	HighLimit	%RPD	RPDLimit	Qual
Benzene	0.96	0.025	1.000	0	96.2	80	120			
Toluene	0.98	0.050	1.000	0	98.2	80	120			
Ethylbenzene	1.0	0.050	1.000	0	100	80	120			
Xylenes, Total	3.0	0.10	3.000	0	101	80	120			
Surr: 4-Bromofluorobenzene	0.95		1.000		94.8	70	130			

Sample ID: <b>2108131-001ams</b>	SampType: <b>MS</b>	TestCode: <b>EPA Method 8021B: Volatiles</b>								
Client ID: <b>SW-4</b>	Batch ID: <b>61781</b>	RunNo: <b>80340</b>								
Prep Date: <b>8/4/2021</b>	Analysis Date: <b>8/5/2021</b>	SeqNo: <b>2830827</b>	Units: <b>mg/Kg</b>							
Analyte	Result	PQL	SPK value	SPK Ref Val	%REC	LowLimit	HighLimit	%RPD	RPDLimit	Qual
Benzene	0.98	0.025	0.9872	0	99.6	80	120			
Toluene	1.0	0.049	0.9872	0	102	80	120			
Ethylbenzene	1.0	0.049	0.9872	0	105	80	120			
Xylenes, Total	3.1	0.099	2.962	0	105	80	120			
Surr: 4-Bromofluorobenzene	0.84		0.9872		85.2	70	130			

Sample ID: <b>2108131-001amsd</b>	SampType: <b>MSD</b>	TestCode: <b>EPA Method 8021B: Volatiles</b>								
Client ID: <b>SW-4</b>	Batch ID: <b>61781</b>	RunNo: <b>80340</b>								
Prep Date: <b>8/4/2021</b>	Analysis Date: <b>8/5/2021</b>	SeqNo: <b>2830828</b>	Units: <b>mg/Kg</b>							
Analyte	Result	PQL	SPK value	SPK Ref Val	%REC	LowLimit	HighLimit	%RPD	RPDLimit	Qual
Benzene	0.98	0.024	0.9569	0	103	80	120	0.103	20	
Toluene	1.0	0.048	0.9569	0	106	80	120	0.313	20	
Ethylbenzene	1.0	0.048	0.9569	0	109	80	120	0.707	20	
Xylenes, Total	3.1	0.096	2.871	0	109	80	120	0.695	20	
Surr: 4-Bromofluorobenzene	0.82		0.9569		85.6	70	130	0	0	

**Qualifiers:**

- \* Value exceeds Maximum Contaminant Level.
- D Sample Diluted Due to Matrix
- H Holding times for preparation or analysis exceeded
- ND Not Detected at the Reporting Limit
- PQL Practical Quantitative Limit
- S % Recovery outside of range due to dilution or matrix

- B Analyte detected in the associated Method Blank
- E Value above quantitation range
- J Analyte detected below quantitation limits
- P Sample pH Not In Range
- RL Reporting Limit





Hall Environmental Analysis Laboratory
4901 Hawkins NE
Albuquerque, NM 87109
TEL: 505-345-3975 FAX: 505-345-4107
Website: clients.hallenvironmental.com

Sample Log-In Check List

Client Name: GHD Midland Work Order Number: 2108131 RptNo: 1

Received By: Cheyenne Cason 8/4/2021 7:50:00 AM
Completed By: Isaiah Ortiz 8/4/2021 8:00:26 AM
Reviewed By: JR 8/4/21

Chain of Custody

- 1. Is Chain of Custody complete? Yes [checked] No [ ] Not Present [ ]
2. How was the sample delivered? Courier

Log In

- 3. Was an attempt made to cool the samples? Yes [checked] No [ ] NA [ ]
4. Were all samples received at a temperature of >0° C to 6.0°C? Yes [checked] No [ ] NA [ ]
5. Sample(s) in proper container(s)? Yes [checked] No [ ]
6. Sufficient sample volume for indicated test(s)? Yes [checked] No [ ]
7. Are samples (except VOA and ONG) properly preserved? Yes [checked] No [ ]
8. Was preservative added to bottles? Yes [ ] No [checked] NA [ ]
9. Received at least 1 vial with headspace <1/4" for AQ VOA? Yes [ ] No [ ] NA [checked]
10. Were any sample containers received broken? Yes [ ] No [checked]
11. Does paperwork match bottle labels? Yes [checked] No [ ]
12. Are matrices correctly identified on Chain of Custody? Yes [checked] No [ ]
13. Is it clear what analyses were requested? Yes [checked] No [ ]
14. Were all holding times able to be met? Yes [checked] No [ ]

# of preserved bottles checked for pH:
(<2 or >12 unless noted)
Adjusted?
Checked by: KPG 8/4/21

Special Handling (if applicable)

- 15. Was client notified of all discrepancies with this order? Yes [ ] No [ ] NA [checked]

Person Notified: [ ] Date: [ ]
By Whom: [ ] Via: [ ] eMail [ ] Phone [ ] Fax [ ] In Person [ ]
Regarding: [ ]
Client Instructions: [ ]

16. Additional remarks:

17. Cooler Information

Table with 7 columns: Cooler No, Temp °C, Condition, Seal Intact, Seal No, Seal Date, Signed By. Row 1: 1, 3.7, Good, Not Present, [ ], [ ], [ ]

### Chain-of-Custody Record

Client: GHD  
 Turn-Around Time:  Standard  Rush *SDG*  
 Project Name: *Scipps #4*  
 Project #: *11222059*

Mailing Address:  
 324 W. Main St. Suite 108, Artesia NM 88210  
 Phone #: (505)377-4218  
 email or Fax#: [Becky.Haskell@ghd.com](mailto:Becky.Haskell@ghd.com)  
 QA/QC Package:  
 Standard  Level 4 (Full Validation)  
 Accreditation:  Az Compliance  NELAC  Other  
 EDD (Type) \_\_\_\_\_

Project Manager:  
 Becky Haskell  
 Tom Larson  
 Sampler: Zach Comino  
 On Ice:  Yes  No  
 # of Coolers: *1*  
 Cooler Temp (including CF): *3.8 @ 12:37*

Date	Time	Matrix	Sample Name	Container Type and #	Preservative Type	HEAL No
<i>08/31</i>	<i>08:40</i>	<i>S</i>	<i>SQ-4</i>	<i>Jar</i>		<i>2108131</i>
<i>↓</i>	<i>09:20</i>	<i>↓</i>	<i>SQ-1A</i>			<i>001</i>
<i>↓</i>	<i>12:55</i>	<i>↓</i>	<i>TP1-2</i>			<i>002</i>
<i>↓</i>	<i>13:00</i>	<i>↓</i>	<i>TP2-2</i>			<i>003</i>
						<i>004</i>

Date: *08/31* Time: *0800* Relinquished by: *Zach Comino*  
 Date: *08/31* Time: *1900* Relinquished by: *Comino*  
 Received by: *Comino* Date: *8/31/21* Time: *800*  
 Received by: *see cover* Date: *8/4/24* Time: *0750*



HALL ENVIRONMENTAL ANALYSIS LABORATORY  
 www.hallenvironmental.com  
 4901 Hawkins NE - Albuquerque, NM 87109  
 Tel. 505-345-3975 Fax 505-345-4107

**Analysis Request**

TPH: 8015D(GRO/DRO/MRO)	<input checked="" type="checkbox"/>
8081 Pesticides/8082 PCB's	
EDB (Method 504.1)	
PAHs by 8310 or 8270SIMS	
RCRA 8 Metals	
Cl, F, Br, NO <sub>3</sub> , NO <sub>2</sub> , PO <sub>4</sub> , SO <sub>4</sub>	
8260 (VOA)	
8270 (Semi-VOA)	
Total Coliform (Present/Absent)	<i>χ Chloride M/L 300</i>

Remarks: Please email: Chase\_Settle@egresources.com;  
 Tom.Larson@ghd.com; Zach.Comino@ghd.com  
 Matthew.Laughlin@ghd.com; Along with Becky Haskell listed above.  
 Direct Bill to EOG Chase Settle

If necessary, samples submitted to Hall Environmental may be subcontracted to other accredited laboratories. This serves as notice of this possibility. Any sub-contracted data will be clearly notated on the analytical report.

Scripps #4  
Closure Report  
nRM2030860417



December 21, 2023

---

# Appendix F

## Agency Notifications

**From:** [Miriam Morales](#)  
**To:** [Artesia S&E Spill Remediation](#)  
**Cc:** [Artesia Regulatory](#)  
**Subject:** Fwd: [EXTERNAL] Scripps #4 (nrm2030860417) Sampling Notification  
**Date:** Thursday, November 30, 2023 2:29:45 PM

---

FYI

Get [Outlook for iOS](#)

---

**From:** Rodgers, Scott, EMNRD <Scott.Rodgers@emnrd.nm.gov>  
**Sent:** Thursday, November 30, 2023 2:27:32 PM  
**To:** Miriam Morales <Miriam\_Morales@eogresources.com>; Hamlet, Robert, EMNRD <Robert.Hamlet@emnrd.nm.gov>; Bratcher, Michael, EMNRD <mike.bratcher@emnrd.nm.gov>  
**Cc:** Artesia Regulatory <Artesia\_Regulatory@eogresources.com>  
**Subject:** RE: [EXTERNAL] Scripps #4 (nrm2030860417) Sampling Notification

**CAUTION:** This email originated from outside of the organization. Do not click links or open attachments unless you recognize the sender and know the content is safe.

The OCD has received your notification. Include a copy of this and all notifications in the remedial and/or closure reports to ensure the notifications are documented in the project file.

**Scott Rodgers** • Environmental Specialist  
Environmental Bureau  
EMNRD - Oil Conservation Division  
8801 Horizon Blvd. NE, Suite 260 | Albuquerque, NM 87113  
505.469.1830 | [scott.rodgers@emnrd.nm.gov](mailto:scott.rodgers@emnrd.nm.gov)  
<http://www.emnrd.nm.gov/oed>



---

**From:** Miriam Morales <Miriam\_Morales@eogresources.com>  
**Sent:** Thursday, November 30, 2023 2:00 PM  
**To:** Enviro, OCD, EMNRD <OCD.Enviro@emnrd.nm.gov>  
**Cc:** Artesia Regulatory <Artesia\_Regulatory@eogresources.com>  
**Subject:** [EXTERNAL] Scripps #4 (nrm2030860417) Sampling Notification

**CAUTION:** This email originated outside of our organization. Exercise caution prior to clicking on links or opening attachments.

Good afternoon,

EOG Resources is submitting a sampling notification 2 days prior.

Scripps #4

M-25-18S-26E

Eddy County, NM

NRM2030860417

Sampling will start at 8:00 am on December 5, 2023 continuing to December 8, 2023

Thank you,

Miriam Morales

Get [Outlook for iOS](#)

**From:** [Tina Huerta](#)  
**To:** [ocd.enviro@emnrd.nm.gov](mailto:ocd.enviro@emnrd.nm.gov)  
**Cc:** [Artesia S&E Spill Remediation](#); [Artesia Regulatory](#)  
**Subject:** Scripps 4 (nRM2030860417) Sampling Notification  
**Date:** Tuesday, October 24, 2023 1:34:35 PM  
**Attachments:** [image001.png](#)

---

Good afternoon,

EOG Resources, Inc. respectfully submits notification (2) business days prior to conducting sampling on the following location.

Scripps 4  
M-25-18S-26E  
Eddy County, NM  
nRM2030860417

Sampling will begin at 2:00 p.m. on Thursday, October 26, 2023.

Thank you,

*Tina Huerta*  
*Regulatory Specialist*  
*Direct: 575.748.4168*  
*Cell: 575.703.3121*  
*Email: [tina\\_huerta@eogresources.com](mailto:tina_huerta@eogresources.com)*



**Artesia Division**

**District I**  
 1625 N. French Dr., Hobbs, NM 88240  
 Phone:(575) 393-6161 Fax:(575) 393-0720  
**District II**  
 811 S. First St., Artesia, NM 88210  
 Phone:(575) 748-1283 Fax:(575) 748-9720  
**District III**  
 1000 Rio Brazos Rd., Aztec, NM 87410  
 Phone:(505) 334-6178 Fax:(505) 334-6170  
**District IV**  
 1220 S. St Francis Dr., Santa Fe, NM 87505  
 Phone:(505) 476-3470 Fax:(505) 476-3462

**State of New Mexico**  
**Energy, Minerals and Natural Resources**  
**Oil Conservation Division**  
**1220 S. St Francis Dr.**  
**Santa Fe, NM 87505**

QUESTIONS

Action 297089

**QUESTIONS**

Operator: EOG RESOURCES INC 5509 Champions Drive Midland, TX 79706	OGRID: 7377
	Action Number: 297089
	Action Type: [C-141] Remediation Closure Request C-141 (C-141-v-Closure)

**QUESTIONS**

<b>Prerequisites</b>	
Incident ID (n#)	nRM2030860417
Incident Name	NRM2030860417 SCRIPPS #4 @ 30-015-24880
Incident Type	Produced Water Release
Incident Status	Remediation Closure Report Received
Incident Well	[30-015-24880] SCRIPPS #004

<b>Location of Release Source</b>	
<i>Please answer all the questions in this group.</i>	
Site Name	SCRIPPS #4
Date Release Discovered	10/16/2020
Surface Owner	Private

<b>Incident Details</b>	
<i>Please answer all the questions in this group.</i>	
Incident Type	Produced Water Release
Did this release result in a fire or is the result of a fire	No
Did this release result in any injuries	No
Has this release reached or does it have a reasonable probability of reaching a watercourse	No
Has this release endangered or does it have a reasonable probability of endangering public health	No
Has this release substantially damaged or will it substantially damage property or the environment	No
Is this release of a volume that is or may with reasonable probability be detrimental to fresh water	No

<b>Nature and Volume of Release</b>	
<i>Material(s) released, please answer all that apply below. Any calculations or specific justifications for the volumes provided should be attached to the follow-up C-141 submission.</i>	
Crude Oil Released (bbls) Details	Not answered.
Produced Water Released (bbls) Details	Cause: Equipment Failure   Pump   Produced Water   Released: 7 BBL   Recovered: 3 BBL   Lost: 4 BBL.
Is the concentration of chloride in the produced water >10,000 mg/l	Yes
Condensate Released (bbls) Details	Not answered.
Natural Gas Vented (Mcf) Details	Not answered.
Natural Gas Flared (Mcf) Details	Not answered.
Other Released Details	Not answered.
Are there additional details for the questions above (i.e. any answer containing Other, Specify, Unknown, and/or Fire, or any negative lost amounts)	Not answered.

**District I**  
 1625 N. French Dr., Hobbs, NM 88240  
 Phone:(575) 393-6161 Fax:(575) 393-0720

**District II**  
 811 S. First St., Artesia, NM 88210  
 Phone:(575) 748-1283 Fax:(575) 748-9720

**District III**  
 1000 Rio Brazos Rd., Aztec, NM 87410  
 Phone:(505) 334-6178 Fax:(505) 334-6170

**District IV**  
 1220 S. St Francis Dr., Santa Fe, NM 87505  
 Phone:(505) 476-3470 Fax:(505) 476-3462

**State of New Mexico**  
**Energy, Minerals and Natural Resources**  
**Oil Conservation Division**  
**1220 S. St Francis Dr.**  
**Santa Fe, NM 87505**

QUESTIONS, Page 2

Action 297089

**QUESTIONS (continued)**

Operator: EOG RESOURCES INC 5509 Champions Drive Midland, TX 79706	OGRID: 7377
	Action Number: 297089
	Action Type: [C-141] Remediation Closure Request C-141 (C-141-v-Closure)

**QUESTIONS**

<b>Nature and Volume of Release (continued)</b>	
Is this a gas only submission (i.e. only significant Mcf values reported)	<b>No, according to supplied volumes this does not appear to be a "gas only" report.</b>
Was this a major release as defined by Subsection A of 19.15.29.7 NMAC	<b>No</b>
Reasons why this would be considered a submission for a notification of a major release	<i>Unavailable.</i>

*With the implementation of the 19.15.27 NMAC (05/25/2021), venting and/or flaring of natural gas (i.e. gas only) are to be submitted on the C-129 form.*

**Initial Response**

*The responsible party must undertake the following actions immediately unless they could create a safety hazard that would result in injury.*

The source of the release has been stopped	<b>True</b>
The impacted area has been secured to protect human health and the environment	<b>True</b>
Released materials have been contained via the use of berms or dikes, absorbent pads, or other containment devices	<b>True</b>
All free liquids and recoverable materials have been removed and managed appropriately	<b>True</b>
If all the actions described above have not been undertaken, explain why	<i>Not answered.</i>

*Per Paragraph (4) of Subsection B of 19.15.29.8 NMAC the responsible party may commence remediation immediately after discovery of a release. If remediation has begun, please prepare and attach a narrative of actions to date in the follow-up C-141 submission. If remedial efforts have been successfully completed or if the release occurred within a lined containment area (see Subparagraph (a) of Paragraph (5) of Subsection A of 19.15.29.11 NMAC), please prepare and attach all information needed for closure evaluation in the follow-up C-141 submission.*

I hereby certify that the information given above is true and complete to the best of my knowledge and understand that pursuant to OCD rules and regulations all operators are required to report and/or file certain release notifications and perform corrective actions for releases which may endanger public health or the environment. The acceptance of a C-141 report by the OCD does not relieve the operator of liability should their operations have failed to adequately investigate and remediate contamination that pose a threat to groundwater, surface water, human health or the environment. In addition, OCD acceptance of a C-141 report does not relieve the operator of responsibility for compliance with any other federal, state, or local laws and/or regulations.

I hereby agree and sign off to the above statement	Name: Tina Huerta Title: Regulatory Reporting Supervisor Email: tina_huerta@eogresources.com Date: 12/21/2023
--	--



**District I**  
1625 N. French Dr., Hobbs, NM 88240  
Phone:(575) 393-6161 Fax:(575) 393-0720

**District II**  
811 S. First St., Artesia, NM 88210  
Phone:(575) 748-1283 Fax:(575) 748-9720

**District III**  
1000 Rio Brazos Rd., Aztec, NM 87410  
Phone:(505) 334-6178 Fax:(505) 334-6170

**District IV**  
1220 S. St Francis Dr., Santa Fe, NM 87505  
Phone:(505) 476-3470 Fax:(505) 476-3462

**State of New Mexico**  
**Energy, Minerals and Natural Resources**  
**Oil Conservation Division**  
**1220 S. St Francis Dr.**  
**Santa Fe, NM 87505**

QUESTIONS, Page 3

Action 297089

**QUESTIONS (continued)**

Operator: EOG RESOURCES INC 5509 Champions Drive Midland, TX 79706	OGRID: 7377
	Action Number: 297089
	Action Type: [C-141] Remediation Closure Request C-141 (C-141-v-Closure)

**QUESTIONS**

**Site Characterization**  
*Please answer all the questions in this group (only required when seeking remediation plan approval and beyond). This information must be provided to the appropriate district office no later than 90 days after the release discovery date.*

What is the shallowest depth to groundwater beneath the area affected by the release in feet below ground surface (ft bgs)	Between 51 and 75 (ft.)
What method was used to determine the depth to ground water	Attached Document
Did this release impact groundwater or surface water	No
<b>What is the minimum distance, between the closest lateral extents of the release and the following surface areas:</b>	
A continuously flowing watercourse or any other significant watercourse	Between 1 and 5 (mi.)
Any lakebed, sinkhole, or playa lake (measured from the ordinary high-water mark)	Between 1 and 5 (mi.)
An occupied permanent residence, school, hospital, institution, or church	Between 1000 (ft.) and ½ (mi.)
A spring or a private domestic fresh water well used by less than five households for domestic or stock watering purposes	Between 1000 (ft.) and ½ (mi.)
Any other fresh water well or spring	Between 1000 (ft.) and ½ (mi.)
Incorporated municipal boundaries or a defined municipal fresh water well field	Greater than 5 (mi.)
A wetland	Between 1 and 5 (mi.)
A subsurface mine	Greater than 5 (mi.)
An (non-karst) unstable area	Between 1 and 5 (mi.)
Categorize the risk of this well / site being in a karst geology	Medium
A 100-year floodplain	Between 1 and 5 (mi.)
Did the release impact areas not on an exploration, development, production, or storage site	No

**Remediation Plan**

*Please answer all the questions that apply or are indicated. This information must be provided to the appropriate district office no later than 90 days after the release discovery date.*

Requesting a remediation plan approval with this submission	Yes
<i>Attach a comprehensive report demonstrating the lateral and vertical extents of soil contamination associated with the release have been determined, pursuant to 19.15.29.11 NMAC and 19.15.29.13 NMAC.</i>	
Have the lateral and vertical extents of contamination been fully delineated	Yes
Was this release entirely contained within a lined containment area	No

**Soil Contamination Sampling:** (Provide the highest observable value for each, in milligrams per kilograms.)

Chloride (EPA 300.0 or SM4500 Cl B)	8930
TPH (GRO+DRO+MRO) (EPA SW-846 Method 8015M)	960
GRO+DRO (EPA SW-846 Method 8015M)	380
BTEX (EPA SW-846 Method 8021B or 8260B)	0
Benzene (EPA SW-846 Method 8021B or 8260B)	0

*Per Subsection B of 19.15.29.11 NMAC unless the site characterization report includes completed efforts at remediation, the report must include a proposed remediation plan in accordance with 19.15.29.12 NMAC, which includes the anticipated timelines for beginning and completing the remediation.*

On what estimated date will the remediation commence	07/30/2021
On what date will (or did) the final sampling or liner inspection occur	12/05/2023
On what date will (or was) the remediation complete(d)	12/05/2023
What is the estimated surface area (in square feet) that will be reclaimed	2630
What is the estimated volume (in cubic yards) that will be reclaimed	390
What is the estimated surface area (in square feet) that will be remediated	2630
What is the estimated volume (in cubic yards) that will be remediated	390

*These estimated dates and measurements are recognized to be the best guess or calculation at the time of submission and may (be) change(d) over time as more remediation efforts are completed.*

*The OCD recognizes that proposed remediation measures may have to be minimally adjusted in accordance with the physical realities encountered during remediation. If the responsible party has any need to significantly deviate from the remediation plan proposed, then it should consult with the division to determine if another remediation plan submission is required.*

**District I**  
 1625 N. French Dr., Hobbs, NM 88240  
 Phone:(575) 393-6161 Fax:(575) 393-0720  
**District II**  
 811 S. First St., Artesia, NM 88210  
 Phone:(575) 748-1283 Fax:(575) 748-9720  
**District III**  
 1000 Rio Brazos Rd., Aztec, NM 87410  
 Phone:(505) 334-6178 Fax:(505) 334-6170  
**District IV**  
 1220 S. St Francis Dr., Santa Fe, NM 87505  
 Phone:(505) 476-3470 Fax:(505) 476-3462

**State of New Mexico**  
**Energy, Minerals and Natural Resources**  
**Oil Conservation Division**  
**1220 S. St Francis Dr.**  
**Santa Fe, NM 87505**

QUESTIONS, Page 4

Action 297089

**QUESTIONS (continued)**

Operator: EOG RESOURCES INC 5509 Champions Drive Midland, TX 79706	OGRID: 7377
	Action Number: 297089
	Action Type: [C-141] Remediation Closure Request C-141 (C-141-v-Closure)

**QUESTIONS**

**Remediation Plan (continued)**

Please answer all the questions that apply or are indicated. This information must be provided to the appropriate district office no later than 90 days after the release discovery date.

**This remediation will (or is expected to) utilize the following processes to remediate / reduce contaminants:**

(Select all answers below that apply.)

(Ex Situ) Excavation and <b>off-site</b> disposal (i.e. dig and haul, hydrovac, etc.)	Yes
Which OCD approved facility will be used for <b>off-site</b> disposal	LEA LAND LANDFILL [fEEM0112342028]
<b>OR</b> which OCD approved well (API) will be used for <b>off-site</b> disposal	Not answered.
<b>OR</b> is the <b>off-site</b> disposal site, to be used, out-of-state	Not answered.
<b>OR</b> is the <b>off-site</b> disposal site, to be used, an NMED facility	Not answered.
(Ex Situ) Excavation and <b>on-site</b> remediation (i.e. On-Site Land Farms)	Not answered.
(In Situ) Soil Vapor Extraction	Not answered.
(In Situ) Chemical processing (i.e. Soil Shredding, Potassium Permanganate, etc.)	Not answered.
(In Situ) Biological processing (i.e. Microbes / Fertilizer, etc.)	Not answered.
(In Situ) Physical processing (i.e. Soil Washing, Gypsum, Disking, etc.)	Not answered.
Ground Water Abatement pursuant to 19.15.30 NMAC	Not answered.
OTHER (Non-listed remedial process)	Not answered.

Per Subsection B of 19.15.29.11 NMAC unless the site characterization report includes completed efforts at remediation, the report must include a proposed remediation plan in accordance with 19.15.29.12 NMAC, which includes the anticipated timelines for beginning and completing the remediation.

I hereby certify that the information given above is true and complete to the best of my knowledge and understand that pursuant to OCD rules and regulations all operators are required to report and/or file certain release notifications and perform corrective actions for releases which may endanger public health or the environment. The acceptance of a C-141 report by the OCD does not relieve the operator of liability should their operations have failed to adequately investigate and remediate contamination that pose a threat to groundwater, surface water, human health or the environment. In addition, OCD acceptance of a C-141 report does not relieve the operator of responsibility for compliance with any other federal, state, or local laws and/or regulations.

I hereby agree and sign off to the above statement	Name: Tina Huerta Title: Regulatory Reporting Supervisor Email: tina_huerta@eogresources.com Date: 12/21/2023
--	--

The OCD recognizes that proposed remediation measures may have to be minimally adjusted in accordance with the physical realities encountered during remediation. If the responsible party has any need to significantly deviate from the remediation plan proposed, then it should consult with the division to determine if another remediation plan submission is required.

**District I**  
 1625 N. French Dr., Hobbs, NM 88240  
 Phone:(575) 393-6161 Fax:(575) 393-0720

**District II**  
 811 S. First St., Artesia, NM 88210  
 Phone:(575) 748-1283 Fax:(575) 748-9720

**District III**  
 1000 Rio Brazos Rd., Aztec, NM 87410  
 Phone:(505) 334-6178 Fax:(505) 334-6170

**District IV**  
 1220 S. St Francis Dr., Santa Fe, NM 87505  
 Phone:(505) 476-3470 Fax:(505) 476-3462

**State of New Mexico**  
**Energy, Minerals and Natural Resources**  
**Oil Conservation Division**  
**1220 S. St Francis Dr.**  
**Santa Fe, NM 87505**

QUESTIONS, Page 5

Action 297089

**QUESTIONS (continued)**

Operator: EOG RESOURCES INC 5509 Champions Drive Midland, TX 79706	OGRID: 7377
	Action Number: 297089
	Action Type: [C-141] Remediation Closure Request C-141 (C-141-v-Closure)

**QUESTIONS**

<b>Deferral Requests Only</b>	
<i>Only answer the questions in this group if seeking a deferral upon approval this submission. Each of the following items must be confirmed as part of any request for deferral of remediation.</i>	
Requesting a deferral of the remediation closure due date with the approval of this submission	No

**District I**  
 1625 N. French Dr., Hobbs, NM 88240  
 Phone:(575) 393-6161 Fax:(575) 393-0720  
**District II**  
 811 S. First St., Artesia, NM 88210  
 Phone:(575) 748-1283 Fax:(575) 748-9720  
**District III**  
 1000 Rio Brazos Rd., Aztec, NM 87410  
 Phone:(505) 334-6178 Fax:(505) 334-6170  
**District IV**  
 1220 S. St Francis Dr., Santa Fe, NM 87505  
 Phone:(505) 476-3470 Fax:(505) 476-3462

**State of New Mexico**  
**Energy, Minerals and Natural Resources**  
**Oil Conservation Division**  
**1220 S. St Francis Dr.**  
**Santa Fe, NM 87505**

QUESTIONS, Page 6

Action 297089

**QUESTIONS (continued)**

Operator: EOG RESOURCES INC 5509 Champions Drive Midland, TX 79706	OGRID: 7377
	Action Number: 297089
	Action Type: [C-141] Remediation Closure Request C-141 (C-141-v-Closure)

**QUESTIONS**

<b>Sampling Event Information</b>	
Last sampling notification (C-141N) recorded	<b>297122</b>
Sampling date pursuant to Subparagraph (a) of Paragraph (1) of Subsection D of 19.15.29.12 NMAC	<b>12/05/2023</b>
What was the (estimated) number of samples that were to be gathered	<b>1</b>
What was the sampling surface area in square feet	<b>200</b>

<b>Remediation Closure Request</b>	
<i>Only answer the questions in this group if seeking remediation closure for this release because all remediation steps have been completed.</i>	
Requesting a remediation closure approval with this submission	<b>Yes</b>
Have the lateral and vertical extents of contamination been fully delineated	<b>Yes</b>
Was this release entirely contained within a lined containment area	<b>No</b>
All areas reasonably needed for production or subsequent drilling operations have been stabilized, returned to the sites existing grade, and have a soil cover that prevents ponding of water, minimizing dust and erosion	<b>Yes</b>
What was the total surface area (in square feet) remediated	<b>2630</b>
What was the total volume (cubic yards) remediated	<b>390</b>
All areas not reasonably needed for production or subsequent drilling operations have been reclaimed to contain a minimum of four feet of non-waste contain earthen material with concentrations less than 600 mg/kg chlorides, 100 mg/kg TPH, 50 mg/kg BTEX, and 10 mg/kg Benzene	<b>Yes</b>
What was the total surface area (in square feet) reclaimed	<b>2630</b>
What was the total volume (in cubic yards) reclaimed	<b>390</b>
Summarize any additional remediation activities not included by answers (above)	<b>Please see attached report.</b>

*The responsible party must attach information demonstrating they have complied with all applicable closure requirements and any conditions or directives of the OCD. This demonstration should be in the form of a comprehensive report (in .pdf format) including a scaled site map, sampling diagrams, relevant field notes, photographs of any excavation prior to backfilling, laboratory data including chain of custody documents of final sampling, and a narrative of the remedial activities. Refer to 19.15.29.12 NMAC.*

I hereby certify that the information given above is true and complete to the best of my knowledge and understand that pursuant to OCD rules and regulations all operators are required to report and/or file certain release notifications and perform corrective actions for releases which may endanger public health or the environment. The acceptance of a C-141 report by the OCD does not relieve the operator of liability should their operations have failed to adequately investigate and remediate contamination that pose a threat to groundwater, surface water, human health or the environment. In addition, OCD acceptance of a C-141 report does not relieve the operator of responsibility for compliance with any other federal, state, or local laws and/or regulations. The responsible party acknowledges they must substantially restore, reclaim, and re-vegetate the impacted surface area to the conditions that existed prior to the release or their final land use in accordance with 19.15.29.13 NMAC including notification to the OCD when reclamation and re-vegetation are complete.

I hereby agree and sign off to the above statement	Name: Tina Huerta Title: Regulatory Reporting Supervisor Email: tina_huerta@eogresources.com Date: 12/21/2023
--	--

**District I**  
 1625 N. French Dr., Hobbs, NM 88240  
 Phone:(575) 393-6161 Fax:(575) 393-0720

**District II**  
 811 S. First St., Artesia, NM 88210  
 Phone:(575) 748-1283 Fax:(575) 748-9720

**District III**  
 1000 Rio Brazos Rd., Aztec, NM 87410  
 Phone:(505) 334-6178 Fax:(505) 334-6170

**District IV**  
 1220 S. St Francis Dr., Santa Fe, NM 87505  
 Phone:(505) 476-3470 Fax:(505) 476-3462

**State of New Mexico**  
**Energy, Minerals and Natural Resources**  
**Oil Conservation Division**  
**1220 S. St Francis Dr.**  
**Santa Fe, NM 87505**

QUESTIONS, Page 7

Action 297089

**QUESTIONS (continued)**

Operator: EOG RESOURCES INC 5509 Champions Drive Midland, TX 79706	OGRID: 7377
	Action Number: 297089
	Action Type: [C-141] Remediation Closure Request C-141 (C-141-v-Closure)

**QUESTIONS**

<b>Reclamation Report</b>	
<i>Only answer the questions in this group if all reclamation steps have been completed.</i>	
Requesting a reclamation approval with this submission	No

**District I**  
 1625 N. French Dr., Hobbs, NM 88240  
 Phone:(575) 393-6161 Fax:(575) 393-0720  
**District II**  
 811 S. First St., Artesia, NM 88210  
 Phone:(575) 748-1283 Fax:(575) 748-9720  
**District III**  
 1000 Rio Brazos Rd., Aztec, NM 87410  
 Phone:(505) 334-6178 Fax:(505) 334-6170  
**District IV**  
 1220 S. St Francis Dr., Santa Fe, NM 87505  
 Phone:(505) 476-3470 Fax:(505) 476-3462

**State of New Mexico**  
**Energy, Minerals and Natural Resources**  
**Oil Conservation Division**  
**1220 S. St Francis Dr.**  
**Santa Fe, NM 87505**

CONDITIONS

Action 297089

**CONDITIONS**

Operator: EOG RESOURCES INC 5509 Champions Drive Midland, TX 79706	OGRID: 7377
	Action Number: 297089
	Action Type: [C-141] Remediation Closure Request C-141 (C-141-v-Closure)

**CONDITIONS**

Created By	Condition	Condition Date
amaxwell	Remediation closure approved.	6/25/2024
amaxwell	A reclamation report will not be accepted until reclamation of the release area, including areas reasonably needed for production or drilling activities, is complete and meet the requirements of 19.15.29.13 NMAC. Areas not reasonably needed for production or drilling activities will still need to be reclaimed and revegetated as early as practicable.	6/25/2024
amaxwell	The reclamation report will need to include: Executive Summary of the reclamation activities; Scaled Site Map including sampling locations; Analytical results including, but not limited to, results showing that any remaining impacts meet the reclamation standards and results to prove the backfill is non-waste containing; At least one (1) representative 5-point composite sample will need to be collected from the backfill material that will be used for the reclamation of the top four feet of the excavation. OCD reserves the right to request additional sampling if needed; pictures of the backfilled areas showing that the area is back, as nearly as practical, to the original condition or the final land use and maintain those areas to control dust and minimize erosion to the extent practical; pictures of the top layer, which is either the background thickness of topsoil or one foot of suitable material to establish vegetation at the site, whichever is greater; and a revegetation plan.	6/25/2024