

P-8170

THE VERTICAL LIMITS of the Tapacito-Pictured Cliffs Gas Pool shall be the Pictured Cliffs formation.

The Tapacito-Pictured Cliffs Gas Pool, Rio Arriba County, New Mexico, was created April 18, 1956 and gas proration in this pool became effective August 1, 1958.

B. WELL ACREAGE AND LOCATION REQUIREMENTS

RULE 2(A) STANDARD GPU (GAS PRORATION UNIT) in the Tapacito-Pictured Cliffs Gas Pool shall be 160 acres.

D. ALLOCATION AND GRANTING OF ALLOWABLES

RULE 5(a)2. NON-MARGINAL GPU ALLOWABLE: The pool allowable remaining each month after deducting the total allowable assigned to marginal GPUs shall be allocated among the non-marginal GPUs entitled to an allowable in the following manner:

A) Seventy-five percent (75%) of the pool allowable remaining to be allocated to the non-marginal GPUs shall be allocated among such GPUs in the proportion that each GPU's "AD Factor" bears to the total "AD Factor" for all non-marginal GPUs in the pool.

B) Twenty-five percent (25%) of the pool allowable remaining to be allocated to non-marginal GPUs shall be allocated among such GPUs in the proportion that each GPU's acreage factor bears to the total acreage factor for all non-marginal GPUs in the pool.

RULE 8 MINIMUM ALLOWABLES: A minimum allowable of 250 MCF per month per GPU will be assigned in order to prevent premature abandonment of wells.

RULE 9(a) DELIVERABILITY TESTS: The calculated deliverability at the "deliverability pressure" shall be determined in accordance with the provisions of the current "Gas Well Testing Manual for San Juan Basin."

(General Pool Rules also apply unless in conflict with these Special Pool Rules.)

SPECIAL RULES AND REGULATIONS FOR THE
ATOKA-PENNSYLVANIAN GAS POOL

The Atoka-Pennsylvanian Gas Pool, Eddy County, New Mexico, was created May 5, 1958, and gas proration in this pool became effective July 1, 1961.

A. DEFINITIONS

THE VERTICAL LIMITS of the Atoka-Pennsylvanian Gas Pool shall be the Pennsylvanian formation.

B. WELL LOCATION AND ACREAGE REQUIREMENTS

RULE 2(a). A standard GPU in the Atoka-Pennsylvanian Gas Pool shall be 320 acres.

RULE 2(b). Each well completed or recompleted in the Atoka-Pennsylvanian Gas Pool shall be located in the northwest quarter or the southeast quarter of the section and shall be located no nearer than 990 feet to the outer boundary of the quarter section nor nearer than 330 feet to any governmental quarter-quarter section line; provided, however, that any well which was projected to or completed in said pool prior to June 5, 1959, is excepted from the requirements of this rule.

D. ALLOCATION AND GRANTING OF ALLOWABLES

RULE 5. Acreage is the only proration factor in the Atoka-Pennsylvanian Gas Pool.

SPECIAL RULES AND REGULATIONS FOR THE
BLINEBRY OIL AND GAS POOL

The Blinebry Oil and Gas Pool, Lea County, New Mexico was created February 17, 1953, and gas proration in this pool became effective January 1, 1954.

A. DEFINITIONS

THE VERTICAL LIMITS of the Blinebry Oil and Gas Pool shall extend from a point 75 feet above the "Blinebry Marker" to a point 100 feet above the "Tubb Marker." The Blinebry Marker shall be that point encountered at a depth of 5457 feet (elevation 3380, sub-sea datum -2077) and the Tubb Marker shall be that point encountered at a depth of 5921 feet (elevation 3380, sub-sea datum -2541) in the Exxon Corporation State "S" Well No. 20, SW/4 NW/4 of Section 2, Township 22 South, Range 37 East, NMPM, Lea County, New Mexico.

COUNTY EddyPOOL Atoka-Pennsylvanian GasTOWNSHIP 18 SouthRANGE 26 East

NMPM

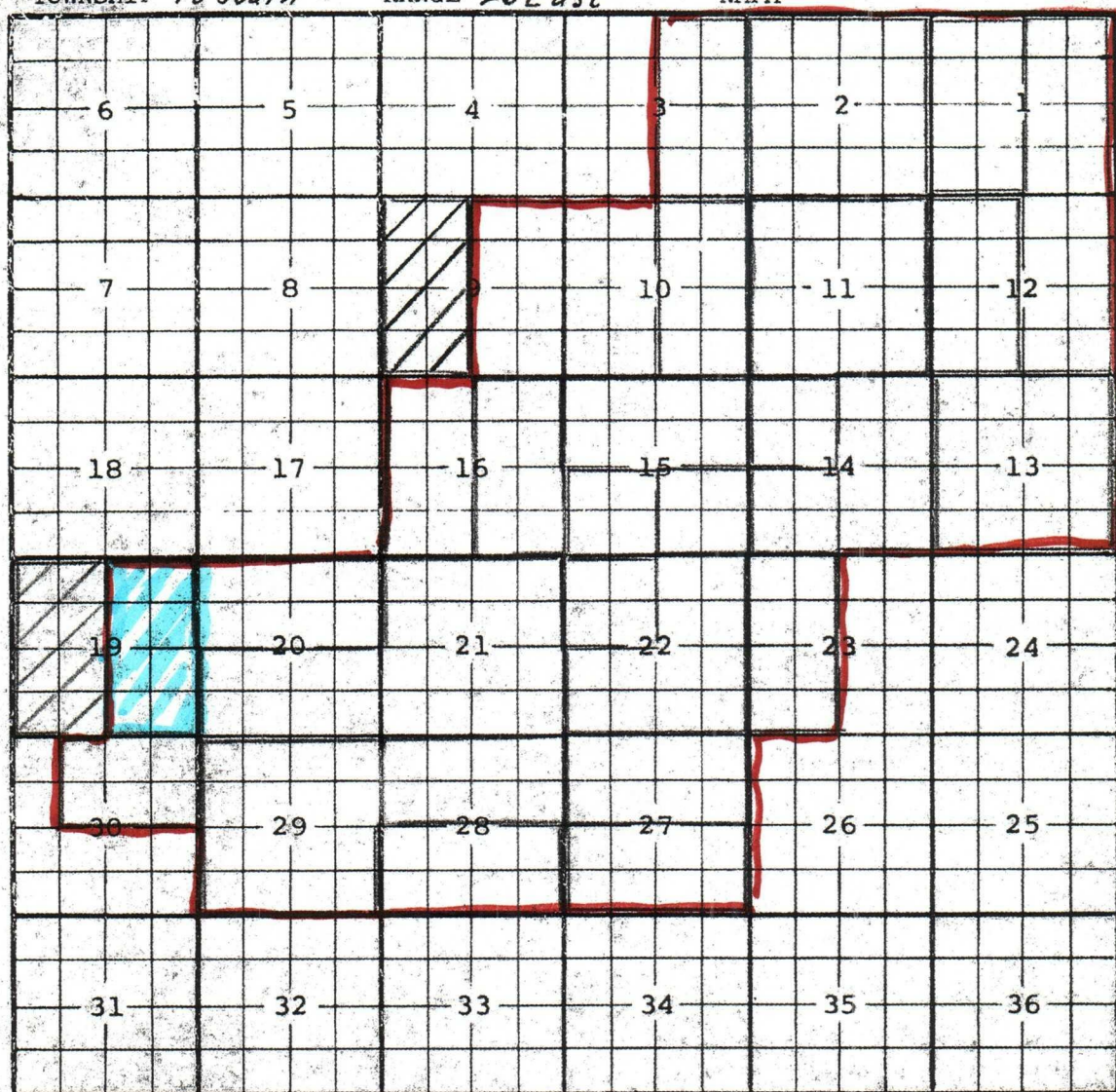
Description: SW 1/4 Sec. 14 (R-1171, 5-5-58)

Ext: SE 1/4 Sec. 15 (R-1341, 3-1-59) - NE 1/4 1/2 Sec. 22 (R-1572, 2-1-60) - N 1/2 Sec. 27 (R-1633, 4-1-60)
N 1/2 Sec. 28; All Sec. 29 (R-1417-A, 5-25-60) - W 1/2 Sec. 23 (R-1840, 1-1-61) - S 1/2 Sec. 20;
All Sec. 21 (R-1878, 3-1-61) - NW 1/4 Sec. 22 (R-2101, 1-1-61) - NW 1/4 Sec. 14; SW 1/4 Sec. 15;
S 1/2 Sec. 28 (R-2201, 4-1-62) - E 1/2 Sec. 19 (R-2241, 6-1-62) - NE 1/4 1/2 NW 1/4 Sec. 30 (R-2552, 9-1-63)
- E 1/2 Sec. 16 (R-2781, 11-1-64) - N 1/2 Sec. 15 (R-3495, 3-1-67) - N 1/2 Sec. 20 (R-3342, 12-1-67)
- W 1/2 Sec. 19 (R-4080, 1-1-71) Deletion: W 1/2 Sec. 19 (R-4162, 7-7-71)
Ext: All Sec. 11 (R-4304, 6-1-72) Ext: W 1/2 Sec. 12 (R-4782, 6-1-72)
Ext: E 1/2 Sec. 10 (R-4861, 11-1-74)
Ext: E 1/2 Sec. 1, E 1/2 Sec. 12 (R-4969, 4-1-75) Ext: All Sec. 2 (R-5015, 6-1-75)
Ext: W 1/2 Sec. 1, E 1/2 Sec. 3 (R-5124, 12-1-75) Ext: All Sec. 13 (R-5204, 5-1-76)
Ext: E 1/2 Sec. 14 (R-5316, 3-1-77) Ext: 1/2 Sec. 27 (R-6169, 11-1-79)
Ext: All Sec. 9, W 1/2 Sec. 10 (R-6526, 2-10-81) Ext: W 1/2 Sec. 16 (R-6912, 3-5-82)
CONTRACT: W 1/2 Sec. 9 (R-9133, 3-13-90)

Sec : 19 Twp : 18S Rng : 26E Section Type : NORMAL

1 38.63 Fee owned	C 40.00 Fee owned	B 40.00 Fee owned	A 40.00 Fee owned A
2 38.67 Fee owned	F 40.00 Fee owned A	G 40.00 Federal owned	H 40.00 Federal owned
3 38.73 Fee owned	K 40.00 Federal owned	J 40.00 Fee owned	I 40.00 Fee owned
4 38.77 Fee owned	N 40.00 Fee owned	O 40.00 Fee owned	P 40.00 Fee owned A

MELL S T R	JAN	FEB	MAR	APRIL	MAY	JUNE	JULY	AUG	SEPT	OCT	NOV	DEC	1992	PROD	NP	ACCU	

MATADOR OPERATING CO.																	
AARON COM	*****																
1M118S26E GAS	10887	1964	5346	4601	2995	3778	2918	2755	3341	3006	3074	3322	47987	6256127			
OIL														17510			
WAT														109			
ATOKA COM	*****																
2P1218S26E GAS	18921	3170	27363	22908	25282	23420	23127	22554	22503	22020	21364	24368	257000	1061468			
DIL	9	8	35	15	27	30	6						115	26993			
WAT					19	16							50	302			
FELMONT ATOKA	*****																
1D1218S26E GAS	670	735	878	618	750	598	640	685	617	621	533	615	7960	1337538			
DIL														5180			
JERRY NELSON COM	*****																
1C1418S26E GAS	658	791	875	736	441	624	493	196	316	675	87	489	6381	346416			
DIL														1347			
COMPANY TOTAL	9	8	35	27	30	6							115	50930			
OIL	31136	6660	34462	28863	29468	28420	27178	26190	26777	26322	25058	28794	319328	1855459			
GAS				15	19	16							50	411			
WAT																	

MEWBORNE OIL CO																	
FEDERAL B	*****																
1P 118S26E GAS	PLUGGING APPROVED 1989													3933208			
DIL														30987			
WAT														17			
SPENCER COM	*****																
1F 918S26E GAS	PLUGGING APPROVED 1992													231662			
DIL														825			
WAT														27			
COMPANY TOTAL	9	8	35	27	30	6							115	31792			
OIL	31136	6660	34462	28863	29468	28420	27178	26190	26777	26322	25058	28794	319328	4164570			
GAS				15	19	16							50	44			
WAT																	

HWJ PRODUCING COMPANY																	
MONDO LFE	*****																
1P1918S26E GAS	1263	1040	2274	132									4709	6697196			
DIL														42932			
WAT														1369			
RALPH NIX	*****																
MONDO-KELLY COM	*****																
1N2718S26E GAS	ZONE ABANDONED													2770			
PAN AMERICAN CORP	*****																
FLINT GAS COM	*****																
1J2218S26E GAS	PLUGGING APPROVED 1970													5600025			
DIL														40116			
C R MARTIN	*****																
3D2318S26E GAS	PLUGGING APPROVED 1963													152862			
DIL														1128			
COMPANY TOTAL	9	8	35	27	30	6							115	41244			
OIL	31136	6660	34462	28863	29468	28420	27178	26190	26777	26322	25058	28794	319328	5752867			
GAS				15	19	16							50				
WAT																	

PARKER & PARLEY DEVELOPMENT COMPANY																	
HIGGINS TRUST INC COM	*****																
1A1318S26E GAS	12867	14434	14254	12525	13184	10470	5717	3582	2358	4618	5257	5025	104291	547564			
DIL	5	1	4	9	12	1	2				5		42	6470			
WAT	2			5	8	6	6	2	5		1		39	3263			
LEAVITT COM	*****																
1F1318S26E GAS	10198	5541	7895	10030	5490	5806	4453	6978	5794	8154	6774	4877	81990	3689714			
DIL	25	20	16	19	6	11	3				7	8	112	19604			
WAT						6					3		12	2976			
COMPANY TOTAL	30	21	16	28	18	12	2				12	15	154	25874			
OIL	23065	19975	22149	22555	18674	16276	10170	10560	8152	12772	12031	9902	186281	9165178			
GAS	2		4	5	8	12	9	2	5		4		51	6239			
WAT																	
READ AND STEVENS, INC.	*****																
IRENE BRAINARD GAS COM	*****																
1E2018S26E GAS	1578	1502	2575	1600	1488	1646	1419	1381	1187	1411	1168	1613	18568	5512611			
DIL														21356			
WILLIAM G. ROSS	*****																
A B ROGERS COM	*****																
1P 318S26E GAS	PLUGGING APPROVED 1990													282309			
DIL														256			
WAT														14			
R.W.K. RESOURCES INC.	*****																
C R MARTIN	*****																
1J1518S26E GAS	LAST PROD. DATE 11/90													T 1295550			
DIL														86918			
WAT														576331			
PAUL TERRY ET	*****																
2M1518S26E GAS	1661	1797	1639	1877	1818	1839	1759	1573	1729	1476	1362	18530	6431808				
DIL	232	263	246	282	263	267	118	240	248	240	248	2647	21712	34766			
WAT													22729				
COMPANY TOTAL	1661	1797	1639	1877	1818	1839	1759	1573	1729	1476	1362	18530	108630				
OIL	232	263	246	282	263	267	118	240	248	240	248	2647	19387658	598760			
GAS																	
WAT																	

YATES PETROLEUM CORPORATION																	
DAYTON TOWNSITE GAS COM	*****																
1G2118S26E GAS	CONVERTED TO SWD													8120317			
DIL														40352			
BOB GUSHWA GAS COM	*****																
1J2118S26E GAS	CONVERTED TO SWD													5361591			
DIL														34766			
MARATHON AM STATE GAS COM	*****																
1P1618S26E GAS	PLUGGING APPROVED 1969													388595			
DIL														1984			
LEN MAYER GAS COM	*****																
1D2818S26E GAS	ZONE ABANDONED													6119100			
DIL														38487			
GUY W NICKSON A	*****																
1A3018S26E GAS	345	63	297	133	135	50	76	78	144	84	110	1515	217824				
DIL							1					1	199				
ETHEL V NOEL	*****																
1P2018S26E GAS		2068	18715	19126	12292	17750	15145	2258	17242	12833	15161	132590	8306580				
DIL			45	45	22	13	34	20	35	30	17	261	48560				
WAT			49	43	26	27	30	32	41	34	35	317	569				
COMPANY TOTAL	345	2131	19012	19259	12427	17800	15221	2336	17386	12917	15271	134105	28514307	164448			
OIL			45	45	22	13	35	20	35	30	17	262	589				
GAS			49	43	26	27	30	32	41	34	35	317					
WAT																	

HARVEY E. YATES CO.																	
DAYTON COM	*****																
1F1618S26E GAS	1747	1553	2277	1853	1712	1575	1472	1389	1308	1281	1218	1701	19086	361579			
DIL														570			
WAT														26			
ATOKA UPPER PENNSLYVANIAN, WEST (GAS) UP	*****																

YATES PETROLEUM CORPORATION																	
UPHAM K	*****																
1K1418S25E GAS	43		126	240	99	155	54	97	115	236	114	122	1401	178173			
DIL														573			
WAT														49			
AUSTIN MISSISSIPPIAN (GAS)	*****																

MI 13M TO 14M																	

ADOBE OIL & GAS CORP.																	
STATE 16	*****																
1M1614S36E GAS	RECOMPLETED TO LEA UND GROUP 8													209149			
DIL														1307			
WAT														6927			
PHILLIPS PETROLEUM COMPANY	*****																
AUSTIN COM	*****																
1M1714S36E GAS	PLUGGING APPROVED 1986													4149529			
DIL														58684			
SANTA FE ENERGY RESOURCES INC.	*****																
MANNAH	*****																
1M1714S36E GAS	408	394	725	386	404	13							2330	402241			
DIL														581			
WAT	62	58	62	60	62								304	7687			
PLUGGING APPROVED 1992																	

Submit 3 Copies
to Appropriate
District Office

OIL CONSERVATION DIVISION
State of New Mexico
Energy, Minerals and Natural Resources Department
RECEIVED

Form C-103
Revised 1-1-89

DISTRICT I
P.O. Box 1980, Hobbs, NM 88240

DISTRICT II
P.O. Drawer DD, Artesia, NM 88210

DISTRICT III
1000 Rio Brazos Rd., Aztec, NM 87410

'94 JAN 18 AM 10:00
OIL CONSERVATION DIVISION
Box 2088
Santa Fe, New Mexico 87504-2088

AUG 10 1992

WELL API NO.

5. Indicate Type of Lease
STATE ☐ FEE ☒

6. State Oil & Gas Lease No.

7. Lease Name or Unit Agreement Name

Hondo L F E

8. Well No.

1

9. Pool name or Wildcat

Atoka Penn

SUNDRY NOTICES AND REPORTS ON WELLS
(DO NOT USE THIS FORM FOR PROPOSALS TO DRILL OR TO DEEPEN OR PLUG BACK TO A
DIFFERENT RESERVOIR. USE "APPLICATION FOR PERMIT"
(FORM C-101) FOR SUCH PROPOSALS.)

1. Type of Well:

OIL
WELL ☐

GAS
WELL ☒

OTHER

2. Name of Operator

M W J Producing Company

3. Address of Operator

400 West Illinois Ste. 1100 Midland, Texas 79701

4. Well Location

Unit Letter P : 990 Feet From The South Line and 990 Feet From The East Line

Section 19

Township 18-S

Range 26-E

NMPM

Eddy

County

10. Elevation (Show whether DF, RKB, RT, GR, etc.)

3442' GR

11.

Check Appropriate Box to Indicate Nature of Notice, Report, or Other Data

NOTICE OF INTENTION TO:

PERFORM REMEDIAL WORK ☐

PLUG AND ABANDON ☐

TEMPORARILY ABANDON ☐

CHANGE PLANS ☐

PULL OR ALTER CASING ☐

OTHER: ☐

SUBSEQUENT REPORT OF:

REMEDIAL WORK ☐ ALTERING CASING ☐

COMMENCE DRILLING OPNS. ☐ PLUG AND ABANDONMENT ☒

CASING TEST AND CEMENT JOB ☐

OTHER: ☐

12. Describe Proposed or Completed Operations (Clearly state all pertinent details, and give pertinent dates, including estimated date of starting any proposed work) SEE RULE 1103.

- 1) Spot 50 sacks cement at 9070' w.o.c. Tag at 8326'.
- 2) Load hole with mud.
- 3) Perforate at 7250'
- 4) Set 4-1/2" cement retainer at 7199' squeeze w/ 25 sacks cement.
- 5) Cut 4-1/2" casing at 5561' Lay down.
- 6) Spot 35 sacks cement at 5611' 50' in 4-1/2" casing stub w.o.c. Tag at 5475'.
- 7) Spot 35 sacks cement at 4350'.
- 8) Spot 35 sacks cement at 2300'.
- 9) Spot 35 sacks cement at 1341' w.o.c. Tag at 1269' spot 14 sacks cement.
- 10) Spot 35 sacks cement at 350'.
- 11) Spot 10 sacks cement at surface and set up P. & A. marker.

I hereby certify that the information above is true and complete to the best of my knowledge and belief.

SIGNATURE

Sabra Fury

TITLE

Supervisor Agent

DATE

8/7/92

8-1-92

915/

TYPE OR PRINT NAME

Sabra Fury

TELEPHONE NO.

682-5216

(This space for State Use)

APPROVED BY:

[Signature]

TITLE

[Signature]

DATE

1/2/92

CONDITIONS OF APPROVAL, IF ANY:

Submit 3 Copies
to Appropriate
District Office

State of New Mexico
Energy, Minerals and Natural Resources Department

Form C-103
Revised 1-1-89

DISTRICT I
P.O. Box 1980, Hobbs, NM 88240

DISTRICT II
P.O. Drawer DD, Artesia, NM 88210

DISTRICT III
1000 Rio Brazos Rd., Aztec, NM 87410

OIL CONSERVATION DIVISION

P.O. Box 2088
Santa Fe, New Mexico 87504-2088

WELL API NO.
300-150-02110051

5. Indicate Type of Lease
STATE ☐ FEE ☒

6. State Oil & Gas Lease No.

7. Lease Name or Unit Agreement Name

Hondo LFE

8. Well No.

1

9. Pool name or Wildcat

Atoka Penn

SUNDRY NOTICES AND REPORTS ON WELLS

(DO NOT USE THIS FORM FOR PROPOSALS TO DRILL OR TO DEEPEN OR PLUG BACK TO A
DIFFERENT RESERVOIR. USE "APPLICATION FOR PERMIT"
(FORM C-101) FOR SUCH PROPOSALS.)

1. Type of Well:

OIL
WELL ☐

GAS
WELL ☒

OTHER

2. Name of Operator

MWJ Producing Company

3. Address of Operator

400 W. Illinois, Ste. 1100, Midland, TX 79701

4. Well Location

Unit Letter P : 990 Feet From The South Line and 990 Feet From The East Line

Section 19 Township 18S Range 26E NMPM Eddy County

10. Elevation (Show whether DF, RKB, RT, GR, etc.)

3442' GR

11. Check Appropriate Box to Indicate Nature of Notice, Report, or Other Data

NOTICE OF INTENTION TO:

PERFORM REMEDIAL WORK ☐

PLUG AND ABANDON ☒

TEMPORARILY ABANDON ☐

CHANGE PLANS ☐

PULL OR ALTER CASING ☐

OTHER: ☐

SUBSEQUENT REPORT OF:

REMEDIAL WORK ☐ ALTERING CASING ☐

COMMENCE DRILLING OPNS. ☐ PLUG AND ABANDONMENT ☐

CASING TEST AND CEMENT JOB ☐

OTHER: ☐

12. Describe Proposed or Completed Operations (Clearly state all pertinent details, and give pertinent dates, including estimated date of starting any proposed work) SEE RULE 1103.

Casing Record: 8-5/8" @ 1289' - TOC @ Surf, 4-1/2" @ 9124' TOC @ 8200'

Perforations: 8992-9020' & 9056-9069'

Proposed Plugging Procedure: 1) Set 50 sx @ 9070-8940' & Tag

2) Set 50 sx @ 8670-8540'

3) Set 25 sx @ 8250'

4) Set 25 sx @ 7250', Perf & Squeeze

5) Set 25 sx @ 6842', Perf & Squeeze

6) Set 35 sx @ 5600'

7) Set 35 sx @ 4350'

8) Set 35 sx @ 2300'

9) Set 35 sx @ 1250' & tag

10) Set 35 sx @ 350'

11) Set 10 sx @ surf & install dry-hole marker

Notify N.M.O.C.C. in sufficient time to witness

Plugging

I hereby certify that the information above is true and complete to the best of my knowledge and belief.

SIGNATURE

Sabra Fury

TITLE

Agent

DATE

6/10/92

915/

TYPE OR PRINT NAME

Sabra Fury

TELEPHONE NO.

682-5216

(This space for State Use)

APPROVED BY

[Signature]

TITLE

[Signature]

DATE

7/2/92

CONDITIONS OF APPROVAL, IF ANY:

NUMBER OF COPIES RECEIVED 4	
DISTRIBUTION	
SANTA FE	
FILE	
U.S.G.S.	
LAND OFFICE	
TRANSPORTER	
OIL	
GAS	
PRODUCTION OFFICE	
OPERATOR	

NEW MEXICO OIL CONSERVATION
SANTA FE, NEW MEXICO
CERTIFICATE OF COMPLIANCE AND AUTHORIZATION
TO TRANSPORT OIL AND NATURAL GAS

MISSION *Easy Post*

FORM C-110
(Rev. 7-60)

FILE THE ORIGINAL AND 4 COPIES WITH THE APPROPRIATE OFFICE

Company or Operator MWJ Producing Company				Lease Hondo LFE		Well No. 1	
Unit Letter P	Section 19	Township 18-S	Range 26-E	County Eddy			
Pool Atoka				Kind of Lease (State, Fed, Fee) Communitized Federal & Fee			
If well produces oil or condensate give location of tanks			Unit Letter P	Section 19	Township 18-S	Range 26E	
Authorized transporter of oil <input type="checkbox"/> or condensate <input checked="" type="checkbox"/> The Permian Corporation				Address (give address to which approved copy of this form is to be sent) Box 3119 Midland, Texas			
Is Gas Actually Connected? Yes <input checked="" type="checkbox"/> No <input type="checkbox"/>							
Authorized transporter of casing head gas <input type="checkbox"/> or dry gas <input type="checkbox"/> Transwestern Pipe Line Company			Date Connected 7-11-62	Address (give address to which approved copy of this form is to be sent) Box 1502, Houston, Texas			

If gas is not being sold, give reasons and also explain its present disposition:

REASON(S) FOR FILING (please check proper box)

New Well <input type="checkbox"/>	Change in Ownership <input type="checkbox"/>
Change in Transporter (check one)	Other (explain below)
Oil <input type="checkbox"/> Dry Gas <input type="checkbox"/>	Change operator name.
Casing head gas <input type="checkbox"/> Condensate <input type="checkbox"/>	

RECEIVED

OCT 13 1964

Remarks Previous operator, Martin, Williams & Judson	O. C. C. ARTERIAL
--	-----------------------------

The undersigned certifies that the Rules and Regulations of the Oil Conservation Commission have been complied with.

Executed this the **5th** day of **October**, 19 **64**.

OIL CONSERVATION COMMISSION		By <i>Edward H. Judson</i>
Approved by <i>M. L. Armistead</i>	Title Vice President	
Title OIL AND GAS INSPECTOR	Company MWJ Producing Company	
Date OCT 21 1964	Address 413 First National Bank Bldg. Midland, Texas	

COPIES RECEIVED	
DISTRIBUTION	
OFFICE	
REPORTER	
OPERATION OFFICE	
REPORTER	

NEW MEXICO OIL CONSERVATION COMMISSION
SANTA FE, NEW MEXICO
CERTIFICATE OF COMPLIANCE AND AUTHORIZATION
TO TRANSPORT OIL AND NATURAL GAS

FORM C-110
 (Rev. 7-60)

FILE THE ORIGINAL AND 4 COPIES WITH THE APPROPRIATE OFFICE

Company or Operator Martin, Williams & Judson				Lease Hondo LFE		Well No. 1	
Unit Letter P	Section 19	Township 18 S	Range 26 E		County Eddy		
Pool Atoka Pennsylvanian Gas Pool					Kind of Lease (State, Fed, Fee) Communitized Patented & Federal		
If well produces oil or condensate give location of tanks			Unit Letter P	Section 19	Township 18 S	Range 26 E	
Authorized transporter of oil <input checked="" type="checkbox"/> or condensate <input type="checkbox"/> The Permian Corporation				Address (give address to which approved copy of this form is to be sent) Box 3119 Midland, Texas			
Is Gas Actually Connected? Yes _____ No <input checked="" type="checkbox"/> _____							
Authorized transporter of casing head gas <input type="checkbox"/> or dry gas <input checked="" type="checkbox"/> Transwestern Pipe Line Co.			Date Connected	Address (give address to which approved copy of this form is to be sent) Box 1502 Houston, Texas			

If gas is not being sold, give reasons and also explain its present disposition:

Well completed as shut in gas well pending gas connection.

REASON(S) FOR FILING (please check proper box)

New Well ☐
 Change in Transporter (check one)
 Oil ☐ Dry Gas ☐
 Casing head gas . ☐ Condensate... ☐

Change in Ownership ☐
 Other (explain below)
Change in Pool Designation

RECEIVED
 MAY 31 1962
 O. C. C.
 ARTESIA, OFFICE

Remarks

The undersigned certifies that the Rules and Regulations of the Oil Conservation Commission have been complied with.

Executed this the **28th** day of **May**, 19 **62**.

OIL CONSERVATION COMMISSION

Approved by

Title

Date

By

Title

Company

Address

M. AND GAS INSPECTOR

R. Ken Williams, Partner

Martin, Williams & Judson

**413 First National Bank Bldg.
Midland, Texas**

MAY 31 1962

May 25, 1962

Martin, Williams & Judson
413 1st National Bank Bldg.
Midland, Texas

Re: Commission Order R-2241

Gentlemen:

As the result of the above referenced order your Hondo LFE well No. 1, Unit P, Section 19-18-26 has been placed in the Atoka Pennsylvanian Gas Pool.

Please file Form C-110 on the well showing the change in pool designation.

Very truly yours,

R. L. Stamets
Geologist

RLS/hb

OIL CONSERVATION COMMISSION

DRAWER DD

ARTESIA, NEW MEXICO

RECEIVED

JUL 16 1962

O. C. C.
ARTESIA, OFFICE

NOTICE OF GAS CONNECTION

DATE July 13, 1962

This is to notify the Oil Conservation Commission that connection
for the purchase of gas from the Martin, Williams & Judson, Hondo "LFE"
Operator Lease

Well #1 . 19-18S-26E . Atoka (Penn.) . Transwestern
Well Unit S.T.R. Pool Name of purchaser

was made on July 11, 1962 .

Transwestern Pipeline Company

Purchaser



Representative H. Nat Aicklen

Proration Engineer

Title

cc: To operator
Oil Conservation Commission - Santa Fe

MAR 7 1962

Revised 12-1-55

MULTI-POINT BACK PRESSURE TEST FOR GAS WELLS

Pool Atoka Penn Formation Pennsylvanian County O. C. C.
 Initial X Annual PH 1:29 Special Date of Test 2-15-62
 Company Martin, Williams & Judson Lease Hondo LFE Well No. 1
 Unit P Sec. 19 Twp. 18S Rge. 26E Purchaser None - Gas vented for test
 Casing 4 1/2 Wt. 11.60 I.D. 4.000 Set at 9124 Perf. 8990-9020 To 9036-9069
 Tubing 2 Wt. 4.7 I.D. 1.995 Set at 9072 Perf. 9026 To 9028
 Gas Pay: From 8992 To 9069 L 9026 xGmix 0.693 GL 6255 Bar. Press. 13.2
 Producing Thru: Casing Tubing X Type Well single
 Date of Completion: 2-2-62 Packer 8937 Reservoir Temp. 157° F

OBSERVED DATA

Tested Through (~~Downhole~~) (~~Stratometer~~) (Meter)Type Taps Flange

No.	Flow Data					Tubing Data		Casing Data		Duration of Flow Hr.
	(Stratometer) (Line) Size	(Stratometer) (Orifice) Size	Press. psig	Diff. h _w	Temp. °F.	Press. psig	Temp. °F.	Press. psig	Temp. °F.	
*SI						* 2685	* 80	packer	-	76 hr
1.	3	1 1/2	815	6.3	100	2594	78	packer	-	22 hr
2.	3	1-1/4	860	40.5	116	2527	78	packer	-	2 hr
3.	3	1-1/4	880	63.5	100	2451	78	packer	-	2 hr
4.	3	1 1/2	850	59.9	92	2376	78	packer	-	1 1/2 hr
5.										

FLOW CALCULATIONS

No.	Coefficient (24-Hour)	$\sqrt{h_{wPF}}$	Pressure psia	Flow Temp. Factor F _t	Gravity Factor F _g	Compress. Factor F _{pv}	Rate of Flow Q-MCFPD @ 15.025 psia
1.	14.360	73.36	828.2	0.9636	0.9608	1.061	1035
2.	9.781	188.03	873.2	0.9501	0.9608	1.063	1783
3.	9.781	238.13	893.2	0.9568	0.9608	1.066	2283
4.	14.360	214.87	863.2	0.9706	0.9608	1.078	3102
5.							

PRESSURE CALCULATIONS

Gas Liquid Hydrocarbon Ratio 64.688 cf/bbl.
 Gravity of Liquid Hydrocarbons 53 deg.
 P_c 9.936 (1-e^{-S}) 0.350

Specific Gravity Separator Gas 0.650
 Specific Gravity Flowing Fluid 0.693
 P_c 2498.2 P_c 7280.3

No.	X _r P _t (psia)	P _t ²	F _c Q	(F _c Q) ²	(F _c Q) ² (1-e ^{-S})	P _w ²	P _c ² -P _w ²	Cal. P _w	P _w P _c
1.	2607.2	6797.5	10.28	105.7	37.0	6834.3	445.8	2614.3	0.9689
2.	2540.2	6452.6	17.74	314.7	110.2	6363.8	717.5	2561.8	0.9494
3.	2464.2	6072.3	22.68	514.4	188.0	6252.3	1028.0	2500.5	0.9267
4.	2389.2	5708.3	30.82	949.9	332.5	6048.8	1239.5	2457.8	0.9109
5.									

Absolute Potential: 16.000 ✓ MCFPD; n 0.97256 ✓

COMPANY Martin, Williams & Judson
 ADDRESS 413 First National Bank Bldg., Midland, Texas
 AGENT and TITLE R. Ken Williams, Partner
 WITNESSED Jim Malcomb
 COMPANY Martin, Williams & Judson

REMARKS

On 22 hr. flow rate recovered liquid equivalent of 16 BPD. All flow rates stabilized for one hour or more. Maximum flow rate for draw down of 30% was not reached because of test equipment limitation.

RECEIVED

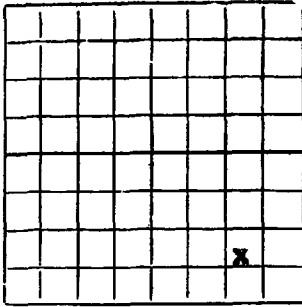

AREA 640 ACRES
LOCATE WELL CORRECTLY

NEW MEXICO OIL CONSERVATION COMMISSION

Santa Fe, New Mexico

RECEIVED

WELL RECORD

MAR 1 1962

Mail to District Office, Oil Conservation Commission, to which Form C-101 was sent not later than twenty days after completion of well. Follow instructions in Rules and Regulations of the Commission. Submit in QUINTUPLICATE. If State Land submit 6 Copies

Martin, Williams & Judson

(Company or Operator)

Hondo LFE

(Lease)

Well No. **1**, in **SE** 1/4 of **SE** 1/4, of Sec. **19**, T. **18S**, R. **24E**, NMPM.

Alpha Penn *under* Pool, **2447** County.

Well is **990** feet from **South** line and **990** feet from **East** line

of Section **19**. If State Land the Oil and Gas Lease No. is _____

Drilling Commenced **December 1**, 19**61**. Drilling was Completed **January 29**, 19**62**.

Name of Drilling Contractor **Lee Drilling Company**

Address **Tulsa, Oklahoma**

Elevation above sea level at Top of Tubing Head **3443**. The information given is to be kept confidential until _____, 19____.

OIL SANDS OR ZONES

No. 1, from **8992** to **9020** No. 4, from _____ to _____
No. 2, from **9024** to **9049** No. 5, from _____ to _____
No. 3, from _____ to _____ No. 6, from _____ to _____

IMPORTANT WATER SANDS

Include data on rate of water inflow and elevation to which water rose in hole.

San Andres, Artesian Water Sand

No. 1, from **828** to **1120** feet.
No. 2, from _____ to _____ feet.
No. 3, from _____ to _____ feet.
No. 4, from _____ to _____ feet.

CASING RECORD

SIZE	WEIGHT PER FOOT	NEW OR USED	AMOUNT	KIND OF SHOE	CUT AND PULLED FROM	PERFORATIONS	PURPOSE
8-3/8	245	new	1291	Float			Surface string
4 1/2	11.600	new	9124	Float			Oil String
8"	4.70	new	9072	Tubing			

MUDDING AND CEMENTING RECORD

SIZE OF HOLE	SIZE OF CASING	WHERE SET	NO. BAGS OF CEMENT	METHOD USED	MUD GRAVITY	AMOUNT OF MUD USED
12-1/4	8-3/8	1291	1410	Pump & Plug plus 1" pipe to bring cement to surface		
7-7/8	4 1/2	9124	300	Pump & Plug	9.00/gal when cemented	

RECORD OF PRODUCTION AND STIMULATION

(Record the Process used, No. of Qts. or Gals. used, interval treated or shot.)

Perforated casing 8992-9020; 9024-9049

Washed perfor w/250 gallons mud acid

Result of Production Stimulation _____

Depth Cleaned Out _____

X

RECORD OF DRILL-STEM AND SPECIAL TESTS

If drill-stem or other special tests or deviation surveys were made, submit report on separate sheet and attach hereto

TOOLS USED

Rotary tools were used from surface feet to 9124 ^{total depth} feet, and from _____ feet to _____ feet.
Cable tools were used from _____ feet to _____ feet, and from _____ feet to _____ feet.

PRODUCTION

Put to Producing February 2, 1962.

OIL WELL: The production during the first 24 hours was _____ barrels of liquid of which _____ % was
was oil; _____ % was emulsion; _____ % water; and _____ % was sediment. A.P.I.

Gravity _____

Flowed 3,000 MCFD on 15/64" choke. Completed as shut-in gas well.

GAS WELL: The production during the first 24 hours was _____ M.C.F. plus _____ barrels of
liquid Hydrocarbon. Shut in Pressure _____ lbs.

Length of Time Shut in _____

PLEASE INDICATE BELOW FORMATION TOPS (IN CONFORMANCE WITH GEOGRAPHICAL SECTION OF STATE):

Southeastern New Mexico

T. Anhy None
T. Salt 9 None
B. Salt None
T. Yates None
T. 7 Rivers _____
T. Queen _____
T. Grayburg _____
T. San Andres 828
T. Glorietta 2172
T. Drinkard _____
T. Tubbs _____
T. Abo 4343
T. Penn 7750
T. Miss _____

Northwestern New Mexico

T. Devonian _____
T. Silurian _____
T. Montoya _____
T. Simpson _____
T. McKee _____
T. Ellenburger _____
T. Gr. Wash _____
T. Granite _____
T. _____
T. _____
T. _____
T. _____
T. _____
T. _____
T. _____
T. _____

FORMATION RECORD

From	To	Thickness in Feet	Formation	From	To	Thickness in Feet	Formation
0	828	828	surface sand & shale	9050	9070	20	sand
828	2170	1342	dolomite	9070	9124	54	shale
2170	2240	70	sand & dolomite		TD		
2240	4340	2100	dolomite				
4340	4420	80	green shale				
4420	4450	30	shale & dolomite				
4450	5770	1120	dolomite				
5770	6550	780	lime & shale				
6550	6940	390	limy shale				
6940	6990	50	shale				
6990	7090	100	lime				
7090	7200	110	lime & shale				
7200	7320	120	shale				
7320	7650	330	limy shale				
7650	8060	410	lime				
8060	8380	320	lime & shale				
8380	8420	40	lime				
8420	8920	500	lime & shale				
8920	8930	10	sand				
8930	8990	60	shale				
8990	9020	30	sand				
9020	9050	30	shale				

ATTACH SEPARATE SHEET IF ADDITIONAL SPACE IS NEEDED

I hereby swear or affirm that the information given herewith is a complete and correct record of the well and all work done on it so far as can be determined from available records.

R. Ken Williams
February 27, 1962

Company or Operator Martin, Williams & Judson

Address 413 First Nat'l Bank Bldg., Midland, Tex.

Name _____

Position or Title R. Ken Williams, Partner

Martin, Williams & Judson
Hondo LFE No. 1
P-19-18-26
Eddy County, New Mexico
2-15-62

RECEIVED

MAR 7 1962

M. W. J.
ARTESIA, OFFICE

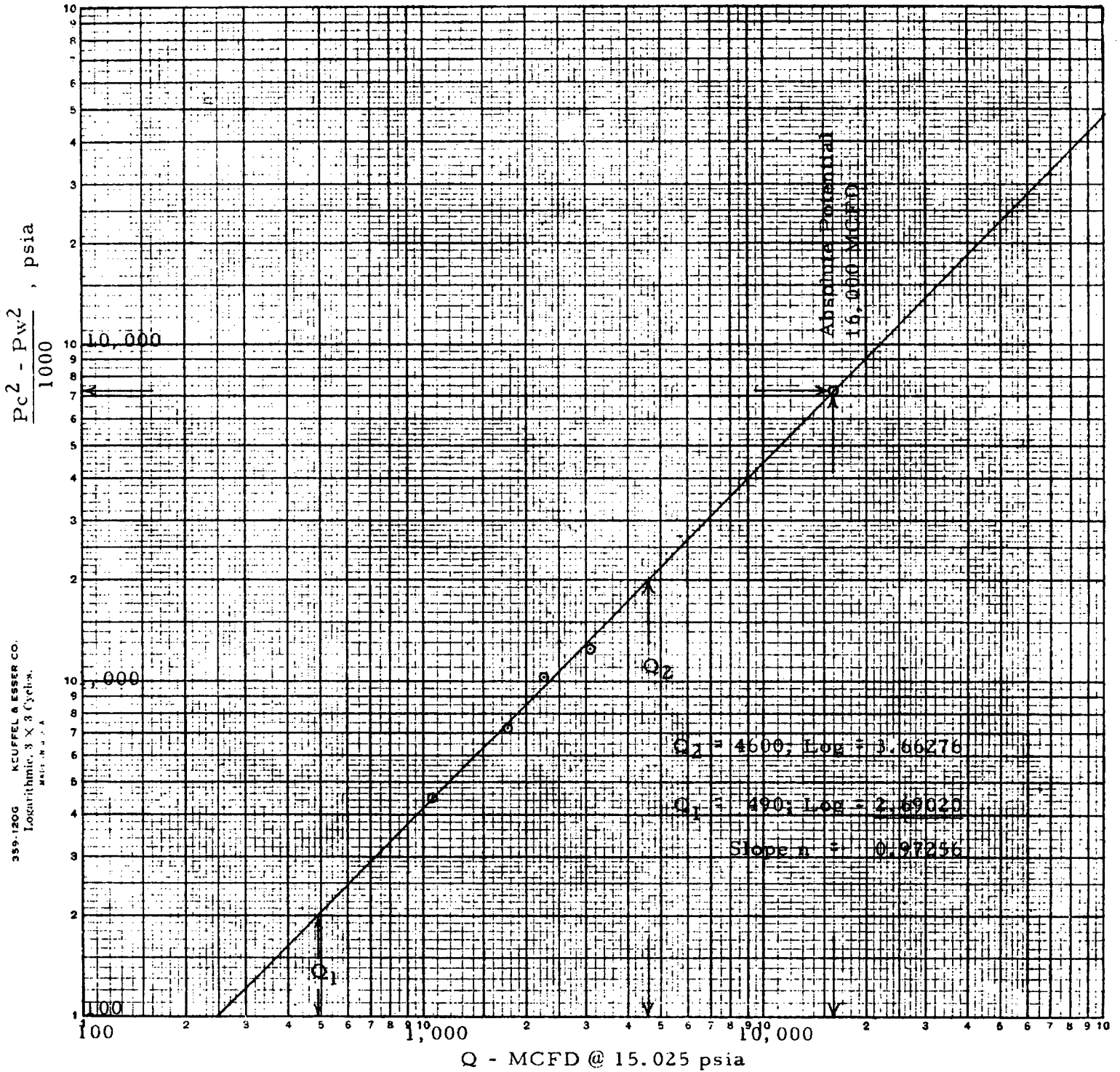

NEW MEXICO OIL CONSERVATION COMMISSION
Santa Fe, New Mexico

(Form C-104)
Revised 7/1/57

REQUEST FOR (OIL) - (GAS) ALLOWABLE

RECEIVED

New Well
Recompletion

This form shall be submitted by the operator before an initial allowable will be assigned to any completed Oil or Gas well. Form C-104 is to be submitted in QUADRUPPLICATE to the same District Office to which Form C-101 was sent. The allowable will be assigned effective 7:00 A.M. on date of completion or recompletion, provided this form is filed during calendar month of completion or recompletion. The completion date shall be that date in the case of an oil well when flow oil is delivered into the stock tanks. Gas must be reported on 15.025 psia at 60° Fahrenheit.

Midland, Texas

March 6, 1962

(Place)

(Date)

WE ARE HEREBY REQUESTING AN ALLOWABLE FOR A WELL KNOWN AS:

Martin, Williams & Judson
(Company or Operator)

Hondo LFE
(Lease)

Well No. 1, in SE 1/4, SE 1/4,

P, Sec. 19, T. 18S, R. 26E, NMPM, Atoka Penn Pool

Eddy

County. Date Spudded 12-1-61

Date Drilling Completed 1-24-62

Please indicate location:

Elevation 3457 KB Total Depth 9124 PBD 9093

Top Oil/Gas Pay 8992 Name of Prod. Form. Pennsylvanian

PRODUCING INTERVAL -

Perforations 8992-9020 & 9056-9069

Open Hole Depth Casing Shoe 9124 Depth Tubing 9072

OIL WELL TEST -

Natural Prod. Test: bbls. oil, bbls. water in hrs, min. Size Choke

Test After Acid or Fracture Treatment (after recovery of volume of oil equal to volume of load oil used): bbls. oil, bbls. water in hrs, min. Size Choke

GAS WELL TEST -

Natural Prod. Test: MCF/Day; Hours flowed Choke Size

Method of Testing (pitot, back pressure, etc.): wash 250 gal

Test After Acid or Fracture Treatment: 3102 on 4 point test MCF/Day; Hours flowed 1 1/2

Choke Size 15/64 Method of Testings: orifice meter

Acid or Fracture Treatment (Give amounts of materials used, such as acid, water, oil, and sand): wash w/250 gallons mud acid

Casing Tubing Date first new

Press. Press. oil run to tanks 2-15-62 on 4 point test

Oil Transporter The Permian Corporation

Gas Transporter Transwestern Pipe Line Company

Remarks: Well completed as shut in gas well waiting on gas connection.

4 point test - CAOF 16,000 MCFD w/GLR 64.622

I hereby certify that the information given above is true and complete to the best of my knowledge.

Approved: MAR 8 1962, 19

Martin, Williams & Judson

(Company or Operator)

OIL CONSERVATION COMMISSION

By: M. L. Armstrong

Title: OIL AND GAS INSPECTOR

By: R. Ken Williams

(Signature)

Title: R. Ken Williams, Agent Partner

Send Communications regarding well to:

Name: Martin, Williams & Judson

Address: 413 First Nat'l Bank Bldg., Midland, Texas

NEW MEXICO OIL CONSERVATION COMMISSION
SANTA FE, NEW MEXICO

Form C-110
Revised 7/1/55
RECEIVED

(File the original and 4 copies with the appropriate district office)

CERTIFICATE OF COMPLIANCE AND AUTHORIZATION
TO TRANSPORT OIL AND NATURAL GAS

ARTESIA, OFFICE

Company or Operator Martin, Williams & Judson Lease Hondo LFE
Well No. 1 Unit Letter P S 19 T 18S R 26E Pool Atoka Penn undr
County Eddy Kind of Lease (State, Fed. or Patented) Communitized Patented & Federal
If well produces oil or condensate, give location of tanks: Unit P S 19 T 18S R 26E
Authorized Transporter of Oil or Condensate The Permian Corporation
Address Box 3119, Midland, Texas
(Give address to which approved copy of this form is to be sent)
Authorized Transporter of Gas Transwestern Pipe Line Company
Address Box 1502, Houston, Texas
(Give address to which approved copy of this form is to be sent)
If Gas is not being sold, give reasons and also explain its present disposition:
Well completed as shut in gas well pending gas connection

Reasons for Filing: (Please check proper box) New Well ☒ (x)
Change in Transporter of (Check One): Oil () Dry Gas () C'head () Condensate ()
Change in Ownership () Other ()
Remarks: (Give explanation below)

The undersigned certifies that the Rules and Regulations of the Oil Conservation Commission have been complied with.

Executed this the 6th day of March 19 62

Approved MAR 6 1962 19

OIL CONSERVATION COMMISSION

By M L Armstrong

Title OIL AND GAS INSPECTOR

By R. Ken Williams

Title R. Ken Williams, Partner

Company Martin, Williams & Judson

Address 413 First Nat'l Bank Bldg.

Midland, Texas

RECEIVED

Form C-103
(Revised 3-55)

C. D. C.
ARTESIA OFFICE

NEW MEXICO OIL CONSERVATION COMMISSION
MISCELLANEOUS REPORTS ON WELLS

(Submit to appropriate District Office as per Commission Rule 1106)

COMPANY Martin, Williams & Judson, 413 First Nat'l Bank Bldg., Midland, Texas
(Address)

LEASE Hondo LFE WELL NO. 1 UNIT P S 19 T 18S R 26E

DATE WORK PERFORMED February 2, 1962 POOL Atoka Penn

This is a Report of: (Check appropriate block) ☐ Results of Test of Casing Shut-off
☐ Beginning Drilling Operations ☐ Remedial Work
☐ Plugging ☒ Other Completion

Detailed account of work done, nature and quantity of materials used and results obtained.

**Perforated casing from 8992 to 9020, 9056 to 9069 with 4 jet shots per foot.
Washed casing perforations with 250 gallons mud acid. Flowed to clean.
Gas volume measured 3,000 MCFD on 15/64" choke. Well completed as
shut-in gas well.**

FILL IN BELOW FOR REMEDIAL WORK REPORTS ONLY

Original Well Data:

DF Elev. _____ TD _____ PBD _____ Prod. Int. _____ Compl Date _____

Tbng. Dia _____ Tbng Depth _____ Oil String Dia _____ Oil String Depth _____

Perf Interval (s) _____

Open Hole Interval _____ Producing Formation (s) _____

RESULTS OF WORKOVER: BEFORE AFTER

Date of Test	_____	_____
Oil Production, bbls. per day	_____	_____
Gas Production, Mcf per day	_____	_____
Water Production, bbls. per day	_____	_____
Gas-Oil Ratio, cu. ft. per bbl.	_____	_____
Gas Well Potential, Mcf per day	_____	_____
Witnessed by _____	_____	_____

(Company)

OIL CONSERVATION COMMISSION

I hereby certify that the information given above is true and complete to the best of my knowledge.

Name M. L. Armstrong
Title _____
Date FEB 7 1962

Name R. Ken Williams
Position R. Ken Williams, Partner
Company Martin, Williams & Judson

RECEIVED

FEB 9 1962
Form C-103
(Revised 3-55)
O. C. C.
ARTESIA, OFFSH.

NEW MEXICO OIL CONSERVATION COMMISSION
MISCELLANEOUS REPORTS ON WELLS

(Submit to appropriate District Office as per Commission Rule 1106)

COMPANY Martin, Williams & Judson, 413 First Nat'l Bank Bldg., Midland, Texas
(Address)

LEASE Hondo LFE WELL NO. 1 UNIT P S 19 T 18S R 26E

DATE WORK PERFORMED January 30, 1962 POOL Atoka Penn

This is a Report of: (Check appropriate block) ☒ Results of Test of Casing Shut-off

☐ Beginning Drilling Operations

☐ Remedial Work

☐ Plugging

☐ Other

Detailed account of work done, nature and quantity of materials used and results obtained.

TD 9124. Ran 4½" new, seamless, J-55 & N-80 casing to 9124' and cemented with 300 sacks. After WOC 24 hours, tested casing to 2000 psi. Test ok.

FILL IN BELOW FOR REMEDIAL WORK REPORTS ONLY

Original Well Data:

DF Elev. _____ TD _____ PBD _____ Prod. Int. _____ Compl Date _____

Tbng. Dia _____ Tbng Depth _____ Oil String Dia _____ Oil String Depth _____

Perf Interval (s) _____

Open Hole Interval _____ Producing Formation (s) _____

RESULTS OF WORKOVER:

BEFORE

AFTER

Date of Test

Oil Production, bbls. per day

Gas Production, Mcf per day

Water Production, bbls. per day

Gas-Oil Ratio, cu. ft. per bbl.

Gas Well Potential, Mcf per day

Witnessed by _____

(Company)

OIL CONSERVATION COMMISSION

I hereby certify that the information given above is true and complete to the best of my knowledge

Name M. L. Armstrong

Name R. Ken Williams

Title JR. DISTRICT INSPECTOR

Position R. Ken Williams, Partner

Date FEB 9 1962

Company Martin, Williams & Judson

JAN 2 1962

D. C. C.
ARTESIA, OFFICEForm C-103
(Revised 3-55)NEW MEXICO OIL CONSERVATION COMMISSION
MISCELLANEOUS REPORTS ON WELLS

(Submit to appropriate District Office as per Commission Rule 1106)

COMPANY Martin, Williams & Judson
413 First National Bank Bldg., Midland, Texas
(Address)LEASE Hondo LFE WELL NO. 1 UNIT P S 19 T 185 R 24E
DATE WORK PERFORMED 12-16-61 POOL Atoka Penn
12-18-61This is a Report of: (Check appropriate block) ☒ Results of Test of Casing Shut-off☐ Beginning Drilling Operations☐ Remedial Work☐ Plugging☐ Other _____

Detailed account of work done, nature and quantity of materials used and results obtained.

Ran 3-5/8", 245, J-55, new, seamless casing to 1291 feet and cemented with 600 cu cement with 2% gel and 2% calcium chloride, followed with 150 cu cement with 2% calcium chloride. Cement did not circulate to surface. Ran temperature survey and found top of cement at 650 feet. Ran 1" pipe in annulus and cemented to surface with 600 cu cement. Cement circulated to surface. After waiting on cement 18 hours, tested casing to 1000psi for 30 minutes. Held O.K. Drilled plug and 3 feet of formation. Tested to 500 psi for 30 minutes. Held O.K.

FILL IN BELOW FOR REMEDIAL WORK REPORTS ONLY

Original Well Data:

DF Elev. _____ TD _____ PBD _____ Prod. Int. _____ Compl Date _____

Tbng. Dia _____ Tbng Depth _____ Oil String Dia _____ Oil String Depth _____

Perf Interval (s) _____

Open Hole Interval _____ Producing Formation (s) _____

RESULTS OF WORKOVER:

BEFORE

AFTER

Date of Test

Oil Production, bbls. per day

Gas Production, Mcf per day

Water Production, bbls. per day

Gas-Oil Ratio, cu. ft. per bbl.

Gas Well Potential, Mcf per day

Witnessed by _____

(Company)

OIL CONSERVATION COMMISSION

I hereby certify that the information given above is true and complete to the best of my knowledge.

Name M. L. ArmstrongName Edward H. JudsonTitle Oil and Gas InspectorPosition Edward H. Judson, PartnerDate JAN 2 1962Company Martin, Williams & Judson

NEW MEXICO OIL CONSERVATION COMMISSION
Santa Fe, New Mexico

Form C-101
Revised (12/1/55)

30-015-00211

NOTICE OF INTENTION TO DRILL

Notice must be given to the District Office of the Oil Conservation Commission and approval obtained before drilling or recompletion begins. If changes in the proposed plan are considered advisable, a copy of this notice showing such changes will be returned to the sender. Submit this notice in QUINTUPPLICATE. One copy will be returned following approval. See additional instructions in Rules and Regulations of the Commission. If State Land submit 6 Copies Attach Form C- 128 in triplicate to first 3 copies of form C-101

Midland, Texas

(Place)

December 1, 1961

(Date)

RECEIVED

OIL CONSERVATION COMMISSION
SANTA FE, NEW MEXICO

Gentlemen:

You are hereby notified that it is our intention to commence the Drilling of a well to be known as

Martin, Williams & Judson

(Company or Operator)

O. C. C.
ARTERIA, OFFICE

DEC 3 1961

Hondo LFE

(Lease)

, Well No. 1, in X P (Unit) The well is

located 990 feet from the South line and 990 feet from the East line of Section 19, T. 18S, R. 26E, NMPM.

(GIVE LOCATION FROM SECTION LINE) Atoka-Penn Gas Pool, Eddy County

D	C	B	A
E	F	G	H
L	K	X	I
M	N	O	X

If State Land the Oil and Gas Lease is No.

If patented land the owner is Joseph D Kennedy

Address FT. Worth Texas

We propose to drill well with drilling equipment as follows: Rotary tools from surface to total depth

The status of plugging bond is filed

Drilling Contractor Lee Drilling Company

We intend to complete this well in the Pennsylvanian formation at an approximate depth of 9300 feet.

CASING PROGRAM

We propose to use the following strings of Casing and to cement them as indicated:

Size of Hole	Size of Casing	Weight per Foot	New or Second Hand	Depth	Sacks Cement
11	8-5/8	24# - J	New Seamless	1200	Circulate
7-7/8	4 1/2	11.60# J&N	New Smis	9300	300 sx

If changes in the above plans become advisable we will notify you immediately.

ADDITIONAL INFORMATION (If recompletion give full details of proposed plan of work.)

Approved DEC 8 1961, 19

Except as follows:

Sincerely yours,

Martin, Williams & Judson

(Company or Operator)

By

Position R. Ken Williams, Partner

Send Communications regarding well to

Name R. Ken Williams

Address 413 First National Bank Bldg.
Midland, Texas

OIL CONSERVATION COMMISSION

By

NEW MEXICO OIL CONSERVATION COMMISSION
WELL LOCATION AND ACREAGE DEDICATION PLAT

FORM C-128
 Revised 5/1/57

SEE INSTRUCTIONS FOR COMPLETING THIS FORM ON THE REVERSE SIDE

SECTION A

Operator Martin - Williams - Judson		Lease Hondo L P E		Well No. 1
Unit Letter P	Section 19	Township 18-S	Range 26-E	County Eddy
Actual Footage Location of Well: 990 feet from the South line and 990 feet from the East line				
Ground Level Elev. 3442	Producing Formation Penn	Pool Atoka Penn.	Dedicated Acreage: 320 Acres	

- Is the Operator the only owner in the dedicated acreage outlined on the plat below? YES ☒ NO ☐ . ("Owner" means the person who has the right to drill into and to produce from any pool and to appropriate the production either for himself or for himself and another. (65-3-29 (e) NMSA 1935 Comp.)
- If the answer to question one is "no," have the interests of all the owners been consolidated by communitization agreement or otherwise? YES ☐ NO ☐ . If answer is "yes," Type of Consolidation _____
- If the answer to question two is "no," list all the owners and their respective interests below:

Owner	Land Description

SECTION B

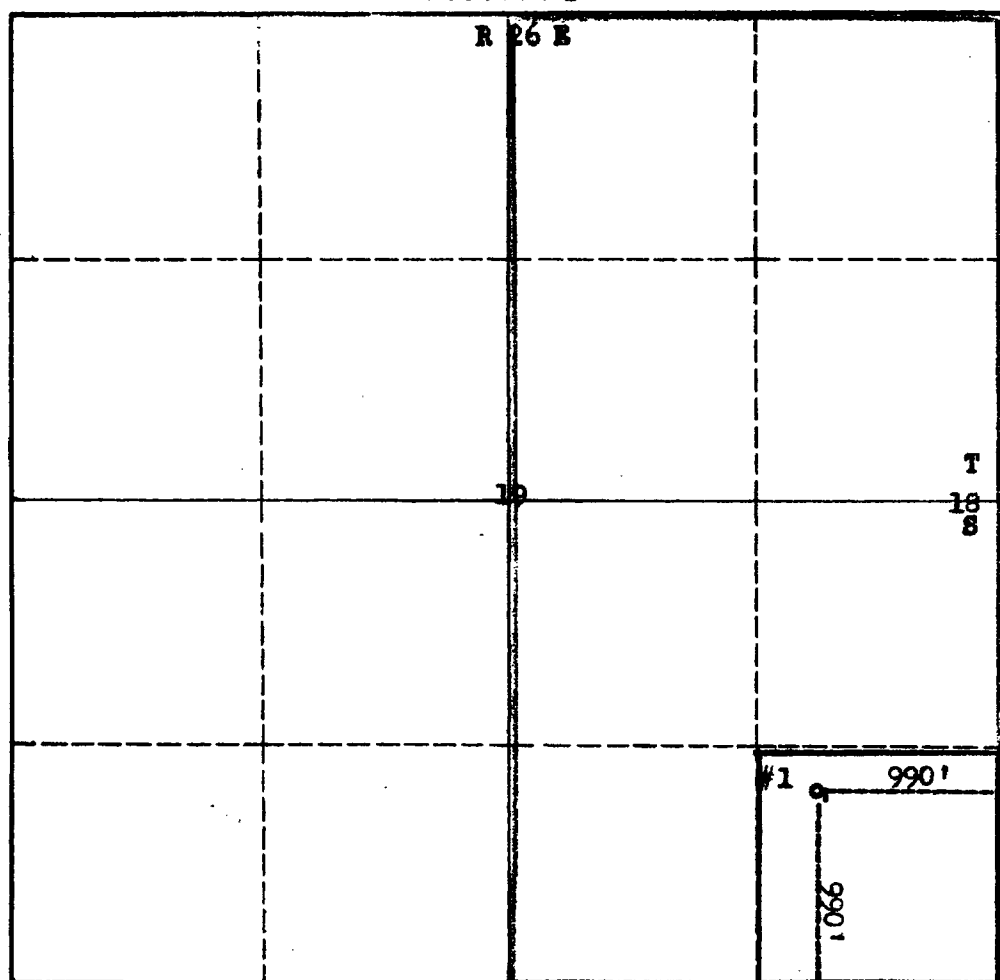

CERTIFICATION

I hereby certify that the information in SECTION A above is true and complete to the best of my knowledge and belief.

R. Ken Williams

Name
R. Ken Williams
 Position
Partner
 Company
Martin, Williams & Judson
 Date
December 1, 1961

I hereby certify that the well location shown on the plat in SECTION B was plotted from field notes of actual surveys made by me or under my supervision, and that the same is true and correct to the best of my knowledge and belief.

Date Surveyed **11 - 30 - 61**

Registered Professional Engineer and/or Land Surveyor

John H. Hewitt
 Certificate No. **3280**

0 330 660 990 1320 1650 1980 2310 2640 2000 1500 1000 500 0