

DATE IN 6-22-04	SUSPENSE 7/12	ENGINEER <i>Stagner</i>	LOGGED IN 6-23-04	TYPE NSL	APP NO. PSEM 0417535524
-----------------	---------------	-------------------------	-------------------	----------	-------------------------

ABOVE THIS LINE FOR DIVISION USE ONLY

**NEW MEXICO OIL CONSERVATION DIVISION**  
 - Engineering Bureau -  
 1220 South St. Francis Drive, Santa Fe, NM 87505



*Ulibarri Gas Com. #3N*

**ADMINISTRATIVE APPLICATION CHECKLIST**

THIS CHECKLIST IS MANDATORY FOR ALL ADMINISTRATIVE APPLICATIONS FOR EXCEPTIONS TO DIVISION RULES AND REGULATIONS WHICH REQUIRE PROCESSING AT THE DIVISION LEVEL IN SANTA FE

**Application Acronyms:**

**[NSL-Non-Standard Location] [NSP-Non-Standard Proration Unit] [SD-Simultaneous Dedication]**  
**[DHC-Downhole Commingling] [CTB-Lease Commingling] [PLC-Pool/Lease Commingling]**  
**[PC-Pool Commingling] [OLS - Off-Lease Storage] [OLM-Off-Lease Measurement]**  
**[WFX-Waterflood Expansion] [PMX-Pressure Maintenance Expansion]**  
**[SWD-Salt Water Disposal] [IPI-Injection Pressure Increase]**  
**[EOR-Qualified Enhanced Oil Recovery Certification] [PPR-Positive Production Response]**

**[1] TYPE OF APPLICATION - Check Those Which Apply for [A]**

- [A] Location - Spacing Unit - Simultaneous Dedication  
☒ NSL ☐ NSP ☐ SD

Check One Only for [B] or [C]

- [B] Commingling - Storage - Measurement  
☐ DHC ☐ CTB ☐ PLC ☐ PC ☐ OLS ☐ OLM

- [C] Injection - Disposal - Pressure Increase - Enhanced Oil Recovery  
☐ WFX ☐ PMX ☐ SWD ☐ IPI ☐ EOR ☐ PPR

- [D] Other: Specify \_\_\_\_\_

**[2] NOTIFICATION REQUIRED TO: - Check Those Which Apply, or ☒ Does Not Apply**

- [A] ☐ Working, Royalty or Overriding Royalty Interest Owners  
 [B] ☐ Offset Operators, Leaseholders or Surface Owner  
 [C] ☐ Application is One Which Requires Published Legal Notice  
 [D] ☐ Notification and/or Concurrent Approval by BLM or SLO  
U.S. Bureau of Land Management - Commissioner of Public Lands, State Land Office  
 [E] ☐ For all of the above, Proof of Notification or Publication is Attached, and/or,  
 [F] ☐ Waivers are Attached

**[3] SUBMIT ACCURATE AND COMPLETE INFORMATION REQUIRED TO PROCESS THE TYPE OF APPLICATION INDICATED ABOVE.**

**[4] CERTIFICATION:** I hereby certify that the information submitted with this application for administrative approval is **accurate** and **complete** to the best of my knowledge. I also understand that **no action** will be taken on this application until the required information and notifications are submitted to the Division.

**Note:** Statement must be completed by an individual with managerial and/or supervisory capacity.

Mary Corley  
 Print or Type Name

*Mary Corley*  
 Signature

Sr. Regulatory Analyst 06/21/2004  
 Title Date  
corleym1@bp.com  
 e-mail Address

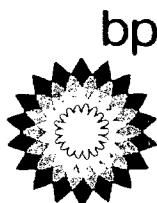

San Juan South Asset

Mary Corley  
WL1-19.171  
281-366-4491 (direct)  
281-366-0700 (FAX)  
[corleym1@bp.com](mailto:corleym1@bp.com)

P. O. Box 3092  
Houston, Texas 77253-3092  
501 Westlake Park Boulevard  
Houston, Texas 77079

May 21, 2004

Mr. Michael Stogner  
New Mexico Oil Conservation Division  
1220 South St Francis Drive  
P.O. Box 6429  
Santa Fe, NM 87505

Application for Non-Standard Well Location  
Ulibarri Gas Com Well No. 3N  
S/2 Section 35-T30N-R09W  
Basin Dakota and Blanco Mesaverde Pools  
San Juan County, New Mexico

30-045-22294  
31205

BP America Production Company respectfully requests an administrative approval for a non-standard well location for the Ulibarri Gas Com Well No. 3N which was directionally drilled from a surface location of 2230' FNL & 715' from FWL of Section 35, T30N, R09W. The original bottom hole location was 1875' FSL & 660' FWL of Section 35, T30N, R09W, however, in the process of attempting to run production casing we encountered a tight spot and the casing became stuck. Attempts to free the casing were unsuccessful and 10 drill collars and 24 joints were left down hole. A decision was made to abandon the open hole and sidetrack downhole. Upon obtaining NMOCD verbal approval (BP's Harald Jordan spoke with Charlie Perrin with NMOCD), whipstock was set at 210 azimuth off 183 degree original.

For your review and consideration attached is a C-102 Well Location Plat showing the well location (SHL, original BHL, and sidetracked BHL although not to scale), a 9-section plat showing the offset wells and operators, and a Directional Plot with both original and actual BHL.

BP operates the 320 acre unit in which the subject well is located and has a 50/50 working interest partnership with ConocoPhillips. BP has a 100% working interest in the affected offsetting 320 acre unit in the E/2 of Section <sup>34</sup>30, T31N, R09W. This information is also reflected on the 9 Section Plat.

Your attention to this matter is greatly appreciated. Should you have any questions concerning this application please do not hesitate to call me at 281-366-4491.

Sincerely,

A handwritten signature in cursive script that reads "Mary Corley".

Mary Corley

cc: Frank Chavez, Supervisor  
NMOCD District III  
1000 Rio Brazos Road  
Aztec, NM 87410



District I  
PO Box 1980, Hobbs NM 88241-1980  
District II  
PO Drawer KK, Artesia, NM 87211-0719  
District III  
1000 Rio Brazos Rd., Aztec, NM 87410  
District IV  
PO Box 2088, Santa Fe, NM 87504-2088

State of New Mexico  
Energy, Minerals & Natural Resources Department

OIL CONSERVATION DIVISION  
PO Box 2088  
Santa Fe, NM 87504-2088

Form C-102  
Revised February 21, 1994

Instructions on back  
Submit to Appropriate District Office  
State Lease - 4 Copies  
Fee Lease - 3 Copies

☐ AMENDED REPORT

WELL LOCATION AND ACREAGE DEDICATION PLAT

<sup>1</sup> API Number	<sup>2</sup> Pool Code	<sup>3</sup> Pool Name
	71599 & 72319	BASIN DAKOTA & BLANCO MESAVERDE
<sup>4</sup> Property Code	<sup>5</sup> Property Name	<sup>6</sup> Well Number
001170	ULIBARRI GAS COM	# 3N
<sup>7</sup> OGRID No.	<sup>8</sup> Operator Name	<sup>9</sup> Elevation
000778	BP AMERICA PRODUCTION COMPANY	5679

<sup>10</sup> Surface Location

UL or Lot No.	Section	Township	Range	Lot Idn	Feet from the	North/South line	Feet from the	East/West line	County
E	35	30 N	9 W		2230	NORTH	715	WEST	SAN JUAN

<sup>11</sup> Bottom Hole Location If Different From Surface

UL or lot no.	Section	Township	Range	Lot Idn	Feet from the	North/South line	Feet from the	East/West line	County
L	35	30 N	9 W		1875	SOUTH	660	WEST	SAN JUAN

<sup>12</sup> Dedicated Acres	<sup>13</sup> Joint or Infill	<sup>14</sup> Consolidation Code	<sup>15</sup> Order No.
320			

NO ALLOWABLE WILL BE ASSIGNED TO THIS COMPLETION UNTIL ALL INTERESTS HAVE BEEN CONSOLIDATED  
OR A NON-STANDARD UNIT HAS BEEN APPROVED BY THE DIVISION

<div><p>16</p><p>2637(R)</p><p>2559(R)</p><p>2230'</p><p>715'</p><p>3050' FSL + 715' FWL</p><p>Azimuth - 181°55' 998'</p><p>35</p><p>Bottom Hole Location</p><p>1875' F/SL 660' F/WL</p><p>560'</p><p>1770' FSL + 560' FWL</p><p>2630(R)</p></div>	<div><p><sup>17</sup> OPERATOR CERTIFICATION</p><p>I hereby certify that the information contained herein is true and complete to the best of my knowledge and belief.</p><p><i>Mary Corley</i></p><p>Signature</p><p>mary corley</p><p>Printed Name</p><p>Sr. Regulatory Analyst</p><p>Title</p><p>06.12.2004</p><p>Date</p></div> <div><p><sup>18</sup> SURVEYOR CERTIFICATION</p><p>I hereby certify that the well location shown on this plat was plotted from field notes of actual surveys made by me or under my supervision, and that the same is true and correct to the best of my belief.</p><p>July 2, 2002</p><p>Date of Survey</p><p>Signature and Seal of Professional Surveyor</p><p>GARY D. VANN</p><p>NEW MEXICO</p><p>REGISTERED PROFESSIONAL LAND SURVEYOR</p><p>7016</p><p>7016</p><p>Certificate Number</p></div>
--	---





WELL	FIELD	RIG
Ulibarri Gas Com 3N	San Juan County, New Mexico	AWS 54
Magnetic Parameters Model: BGGM 2002 Dip: 63.678° Mag Dec: 10.902° Date: February 07, 2003 FS: 51519.3 nT	Surface Location Lat: N36 46 7.400 Lon: W107 45 23.200 North: 2099142.53 ftUS East: 2745611.67 ftUS Grid Conv: 0.0460° Scale Fact: 0.9999	Plan#: Rev0 ST1 jok 03-Feb-03 Slot: Ulibarri Gas Com 3N (Have Lat-Long) Elev Ref: RKB(5693.00ft above MSL) Date Drawn: 01:03:54PM 02-Apr-2003

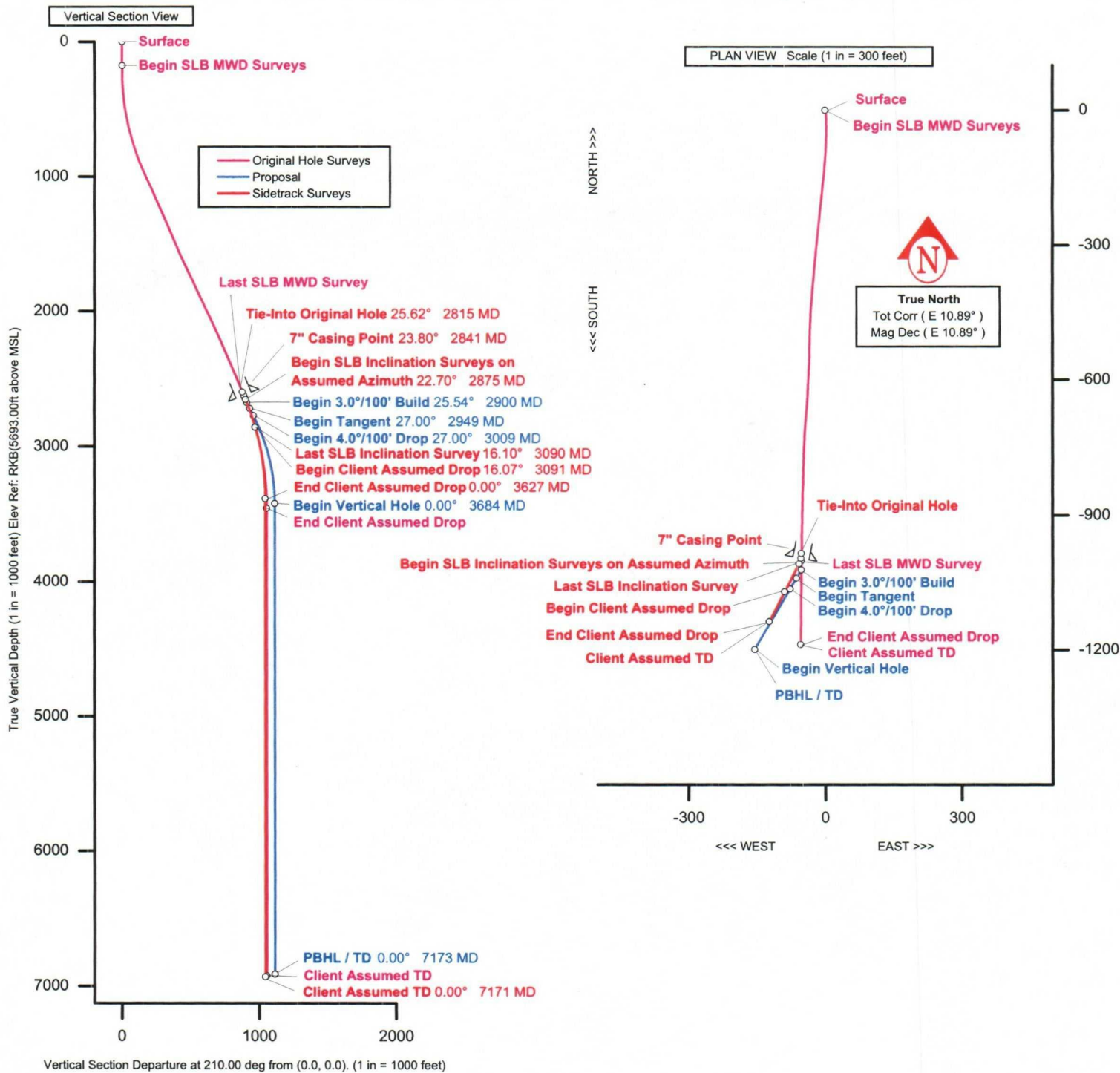

Quality Control  
Date Drawn: 02-Apr-2003  
Drawn by: James Wimberg  
Checked by: John O'Keefe  
Client OK: \_\_\_\_\_

**Stogner, Michael**

---

**From:** Corley, Mary L [corleym@bp.com]  
**Sent:** Thursday, September 02, 2004 1:38 PM  
**To:** MSTOGNER@state.nm.us  
**Subject:** NSL Application

Mr. Stogner,

Could you please advise on the status of an NSL application which was filed by BP America on May 21, 2004:

Ulibarri Gas Com Well No. 3N  
API # 30-045-31205  
S/2 Section 35-T30N-R09W

Your attention to this matter is greatly appreciated.  
Thank you,

*Mary Corley*  
*Senior Regulatory Analyst*  
*San Juan Performance Unit*  
*281-366-4491*

---

This email has been scanned by the MessageLabs Email Security System.  
For more information please visit <http://www.messagelabs.com/email>

---