

JAMES BRUCE
Attorney at Law
Post Office Box 1056
Santa Fe, New Mexico 87504
Telephone: (505) 982-2043
Fax: (505) 982-2151

FAX COVER SHEET

DELIVER TO: David Catanach
COMPANY: Oil Conservation Division
CITY: Santa Fe, New Mexico
FAX NUMBER: (505) 476-3462
NUMBER OF PAGES: 8 (Including Cover Sheet)
DATE SENT: 9/29/04
MEMO:

A. (Michael Stern)

10:45 Met w/

*Jim Beames who
informed me that the
average shown in yellow
on Exhibit "D" is 100%
J. Cleo Thompson W.I.*

DATE IN	SUBPENSE	EST	LOCATION IN	TYPE	APP NO.
---------	----------	-----	-------------	------	---------

ABOVE THIS LINE FOR DIVISION USE ONLY

NEW MEXICO OIL CONSERVATION DIVISION

- Engineering Bureau -

1220 South St. Francis Drive, Santa Fe, NM 87505

**ADMINISTRATIVE APPLICATION CHECKLIST**

THIS CHECKLIST IS MANDATORY FOR ALL ADMINISTRATIVE APPLICATIONS FOR EXCEPTIONS TO DIVISION RULES AND REGULATIONS WHICH REQUIRE PROCESSING AT THE DIVISION LEVEL IN SANTA FE

Application Acronyms:

[NSL-Non-Standard Location] [NSP-Non-Standard Proration Unit] [SD-Simultaneous Dedication]
 [DHC-Downhole Commingling] [CTB-Lease Commingling] [PLC-Pool/Lease Commingling]
 [PC-Pool Commingling] [OLS - Off-Lease Storage] [OLM-Off-Lease Measurement]
 [WFX-Waterflood Expansion] [PMX-Pressure Maintenance Expansion]
 [SWD-Salt Water Disposal] [IPI-Injection Pressure Increase]
 [EOR-Qualified Enhanced Oil Recovery Certification] [PPR-Positive Production Response]

[1] TYPE OF APPLICATION - Check Those Which Apply for [A]**[A] Location Spacing Unit - Simultaneous Dedication**☒ NSL ☐ NSP ☐ SD

Check One Only for [B] or [C]

[B] Commingling - Storage - Measurement☐ DHC ☐ CTB ☐ PLC ☐ PC ☐ OLS ☐ OLM**[C] Injection - Disposal - Pressure Increase - Enhanced Oil Recovery**☐ WFX ☐ PMX ☐ SWD ☐ IPI ☐ EOR ☐ FTR**[D] Other: Specify** _____**[2] NOTIFICATION REQUIRED TO: - Check Those Which Apply, or ☒ Does Not Apply****[A] ☐ Working, Royalty or Overriding Royalty Interest Owners****[B] ☐ Offset Operators, Leaseholders or Surface Owner****[C] ☐ Application is One Which Requires Published Legal Notice****[D] ☐ Notification and/or Concurrent Approval by BLM or SLO**
U.S. Bureau of Land Management - Commissioner of Public Lands, State Land Office**[E] ☐ For all of the above, Proof of Notification or Publication is Attached, and/or,****[F] ☐ Waivers are Attached****[3] SUBMIT ACCURATE AND COMPLETE INFORMATION REQUIRED TO PROCESS THE TYPE OF APPLICATION INDICATED ABOVE.**

[4] CERTIFICATION: I hereby certify that the information submitted with this application for administrative approval is accurate and complete to the best of my knowledge. I also understand that no action will be taken on this application until the required information and notifications are submitted to the Division.

Note: Statement must be completed by an individual with managerial and/or supervisory capacity.

James Bruce

Print or Type Name

Signature

Attorney for Applicant

Title

Date

 jamesbruce@aol.com
 e-mail Address

9/23/04

JAMES BRUCE
ATTORNEY AT LAWPOST OFFICE BOX 1056
SANTA FE, NEW MEXICO 87504369 MONTEZUMA, NO. 213
SANTA FE, NEW MEXICO 87501(505) 982-2043 (Phone)
(505) 660-6612 (Cell)
(505) 982-2151 (Fax)

jamesbruce@aol.com

September 23, 2004

Hand DeliveredMichael E. Stogner
Oil Conservation Division
1220 South St. Francis Drive
Santa Fe, New Mexico 87505

Dear Mr. Stogner:

J. Cleo Thompson and James Cleo Thompson, Jr., L.P. hereby applies for administrative approval of an unorthodox oil well location for the following well:

<u>Well:</u>	Lawrence Well No. 1
<u>Location:</u>	2531 feet FNL & 630 feet FEL
<u>Well Unit:</u>	E N W E of Section 14, Township 16 South, Range 38 East, N.M.P.M., Lea County, New Mexico

The well will be drilled to test the Devonian formation (Undesignated North Knowles-Devonian Pool). Pursuant to Division Order No. R-8497, the pool is spaced on 80 acres, with wells to be located within 150 feet of the center of a quarter-quarter section. A Form C-102 for the well is attached as Exhibit A.

The application is based on geologic reasons. Attached as Exhibit B is an isopach of the Devonian formation. Supporting seismic data is attached as Exhibit C. The proposed unorthodox location is necessary to encounter the highest part of the Devonian structure, which is necessary for a successful Devonian completion.

Attached as Exhibit D is a land plat, with applicant's acreage colored yellow. The well encroaches on the offsetting well unit (the N~~N~~W~~E~~ of Section 14) which has common royalty, overriding royalty, and working interest ownership with the SE~~N~~W~~E~~. Because the offset owners will share in production from the proposed well, they are not adversely affected, and no one has been notified of the application. As a result, applicant requests that the 20 day notice period be waived.

100% J.C. Thompson, Jr., WI

Please call me if you need any further information on this matter.

Very truly yours,



James Bruce

Attorney for J. Cleo Thompson and
James Cleo Thompson, Jr., L.P.

District I
PO Box 1980, Hobbs, NM 88241-1980

District II
511 South First, Artesia, NM 88210

District III
1000 Rio Grande Rd., Aztec, NM 87410

District IV
2040 South Pacheco, Santa Fe, NM 87505

State of New Mexico
Energy, Minerals & Natural Resources Department

OIL CONSERVATION DIVISION
2040 South Pacheco
Santa Fe, NM 87505

Form C-107

Revised October 18, 1994

Instructions on back

Submit to Appropriate District Office

State Lease - 4 Copies

Fee Lease - 3 Copies

☐ AMENDED REPORT

WELL LOCATION AND ACREAGE DEDICATION PLAT

¹ API Number	² Pool Code	³ Pool Name North Knowles-Devonian Pool
⁴ Property Code	⁵ Property Name Lawrence	⁶ Well Number 1
⁷ OGBID No.	⁸ Operator Name J. Cleo Thompson	⁹ Elevation 3702'

¹⁰ Surface Location

UL or lot no.	Section	Township	Range	Lot 10n	Feet from the	North/South line	Feet from the	East/West line	County
H	14	16-S	38-E		2531	North	630	East	Lea

¹¹ Bottom Hole Location If Different From Surface

UL or lot no.	Section	Township	Range	Lot 10n	Feet from the	North/South line	Feet from the	East/West line	County

¹² Dedicated Acres 80	¹³ Joint or Infill	¹⁴ Consolidation Code	¹⁵ Order No.
-------------------------------------	-------------------------------	----------------------------------	-------------------------

NO ALLOWABLE WILL BE ASSIGNED TO THIS COMPLETION UNTIL ALL INTERESTS HAVE BEEN CONSOLIDATED OR A NON-STANDARD UNIT HAS BEEN APPROVED BY THE DIVISION

<p>16</p>	<p>17 OPERATOR CERTIFICATION</p> <p>I hereby certify that the information contained herein is true and complete to the best of my knowledge and belief.</p> <p><i>J. E. Stevens</i> Signature JAMES E. STEVENS Printed Name OPERATIONS MANAGER Title 30T 13, 2004 Date</p>
	<p>18 SURVEYOR CERTIFICATION</p> <p>I hereby certify that the well location shown on this plat was plotted from field notes of actual surveys made by me or under my supervision, and that the same is true and correct to the best of my belief.</p> <p>August 5, 2004</p> <p>Date of Survey</p> <p>Signature and Seal of Professional Surveyor <i>Max A. Schumann, Jr.</i> Max A. Schumann, Jr. Certificate Number 1510</p>

Job No. 68,859

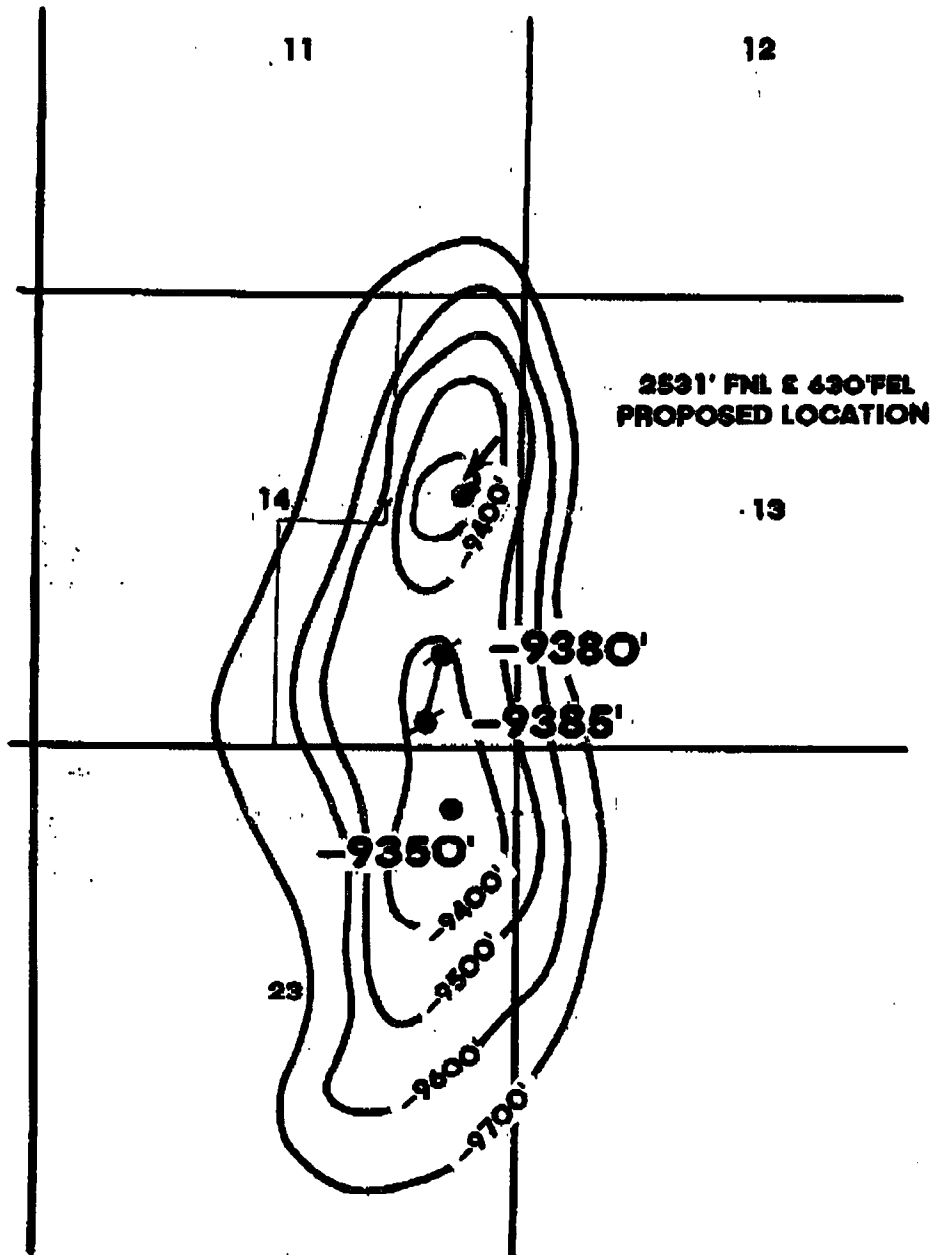

J. C. THOMPSON #1 LAWRENCE

SECTION 14-T-16-S R-38-E

**STRUCTURE MAP
T/SILURO-DEVONIAN**

ED GONZALES CL:100' SCALE 1"=2000' 9-20-04



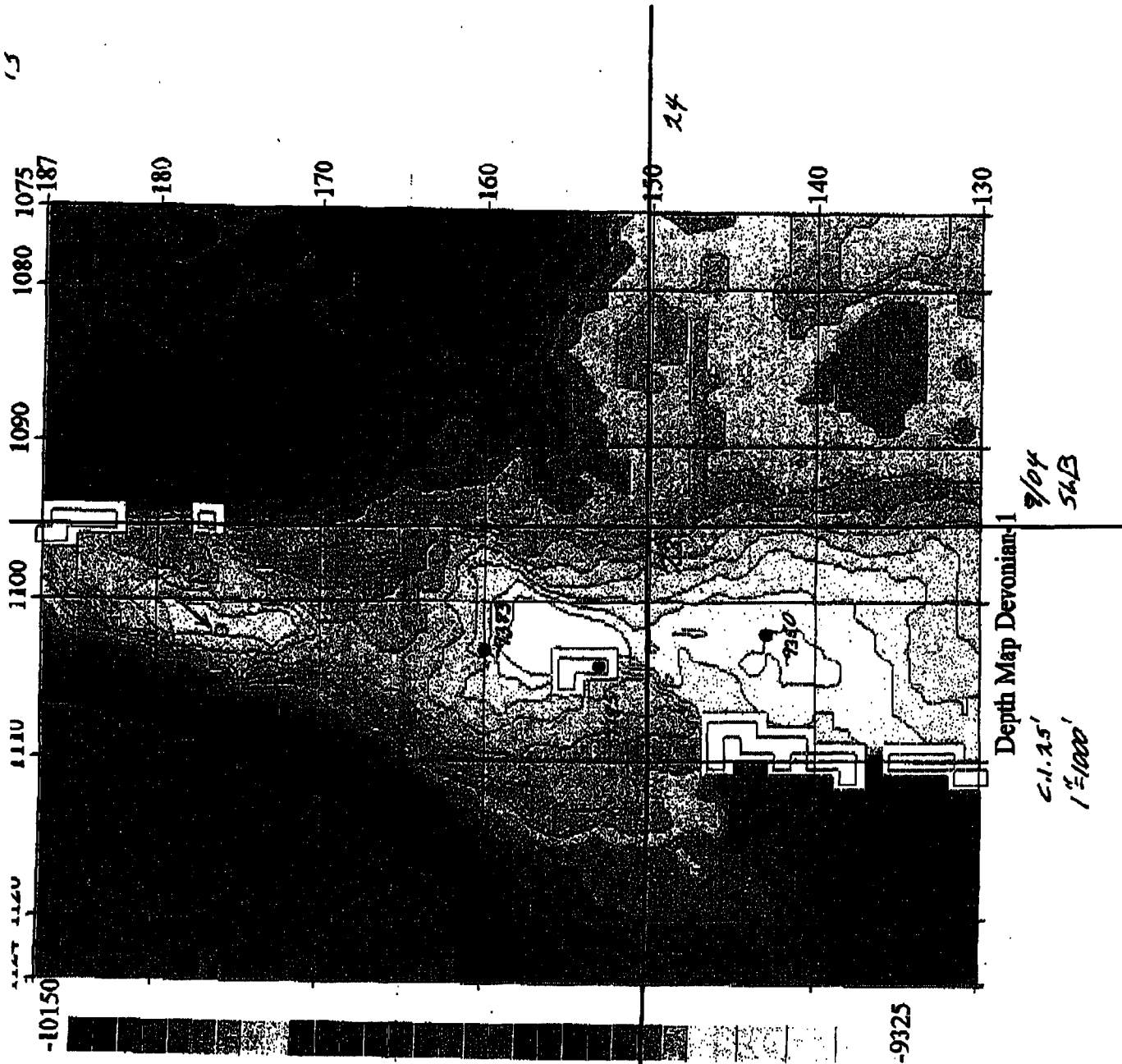

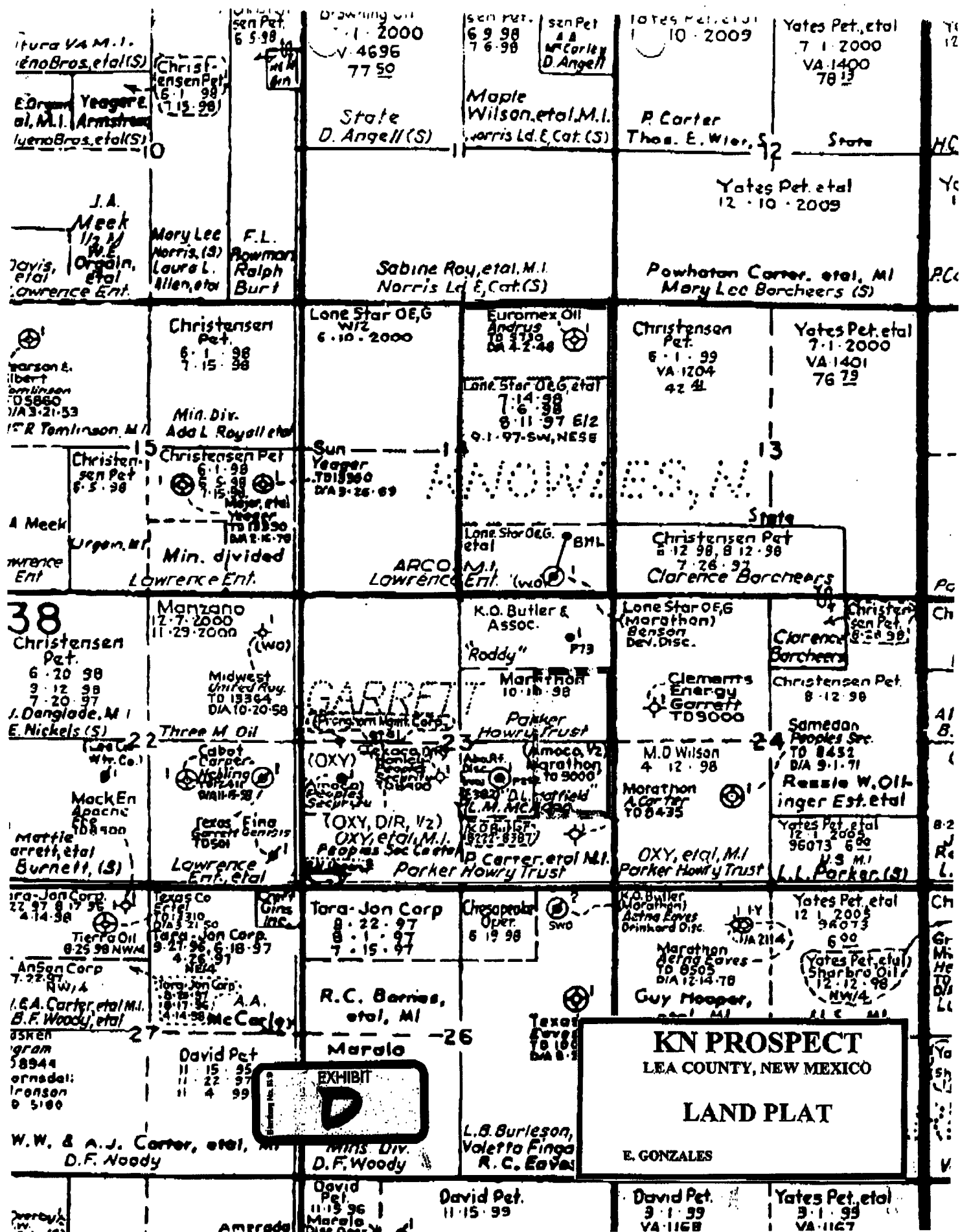

TRANSACTION REPORT

P.01

SEP-29-2004 WED 08:29 AM

FOR:

RECEIVE

DATE	START	SENDER	RX TIME	PAGES	TYPE	NOTE	M#	DP
SEP-29	08:26 AM	9822151	3' 10"	8	RECEIVE	OK		