



DEC 12 1969

CONTINENTAL OIL COMPANY

P. O. Box 460
Hobbs, New Mexico
December 10, 1969

New Mexico Oil Conservation Commission (2)
P. O. Box 2088
Santa Fe, New Mexico

Attention of Mr. A. L. Porter, Jr., Secretary Director

Gentlemen:

Subject: Application for Downhole Commingling
Lockhart B-12 Well No. 3 - C-12-21S-37E

DHC-28
Dec 1-1-70

Continental Oil Company, Box 460, Hobbs, New Mexico, as operator of the Lockhart B-12 Lease respectfully requests administrative approval under the provisions of Order No. R-3845 to commingle in the well bore production from the Drinkard and Wantz Abo Pools in its Lockhart B-12 No. 3 located in Unit C of Section 12, T21S, R37E, Lea County, New Mexico. This dual completion was authorized by administrative Order No. DC-1033. The attached plat shows the Lockhart B-12 Lease outlined in red and the No. 3 well by the red circle.

Attached hereto are forms C-116 showing the results of tests taken within the last 30 days on the two zones in this well. As shown by these tests, the combined producing rate is 13 barrels oil, 3 barrels water and 53 MCF gas per day.

On December 2, 1969, the bottom hole pressure in the Abo zone which had been flowing, was 1078 psi after shut in of about six months. The estimated bottom hole pressure after 24 hour shut in of the Drinkard zone, which is artificially lifted, is 210 psi based on the surface shut in pressure and the measured fluid level. The commingled production will be artificially lifted.

Attached hereto is a production decline curve for each zone. The future production from the Abo zone is estimated by the extension of the curve. Since the Abo has demonstrated a fairly consistent decline rate, we propose to allocate this zone's production on the curve extension and the remainder of the well's production to the Drinkard.

The quality and gravity of the two crudes is very similar, both being typical Permian high gravity crude oil. Gravities vary from month to month, but any apparent loss of revenue from commingling will be more

NMOCC
Lockhart B-12 No. 3
Page 2

than compensated by reduced shrinkage, since storage time will be reduced. The commingled stream will be handled through the Drinkard battery.

The Lockhart B-12 is a federal lease and a copy of this application is being furnished the U.S.G.S. and to all offset operators. Your further handling and approval of this application will be sincerely appreciated.

Yours very truly,



G. C. Jamieson
Assistant Division Manager

VTL-JS
CC: NMOCC-Hobbs
USGS-Hobbs (2)

RLA JJB JWK

Humble Oil & Refining Company
Elliott Producing Company
Shell Oil Company
Gulf Oil Corporation

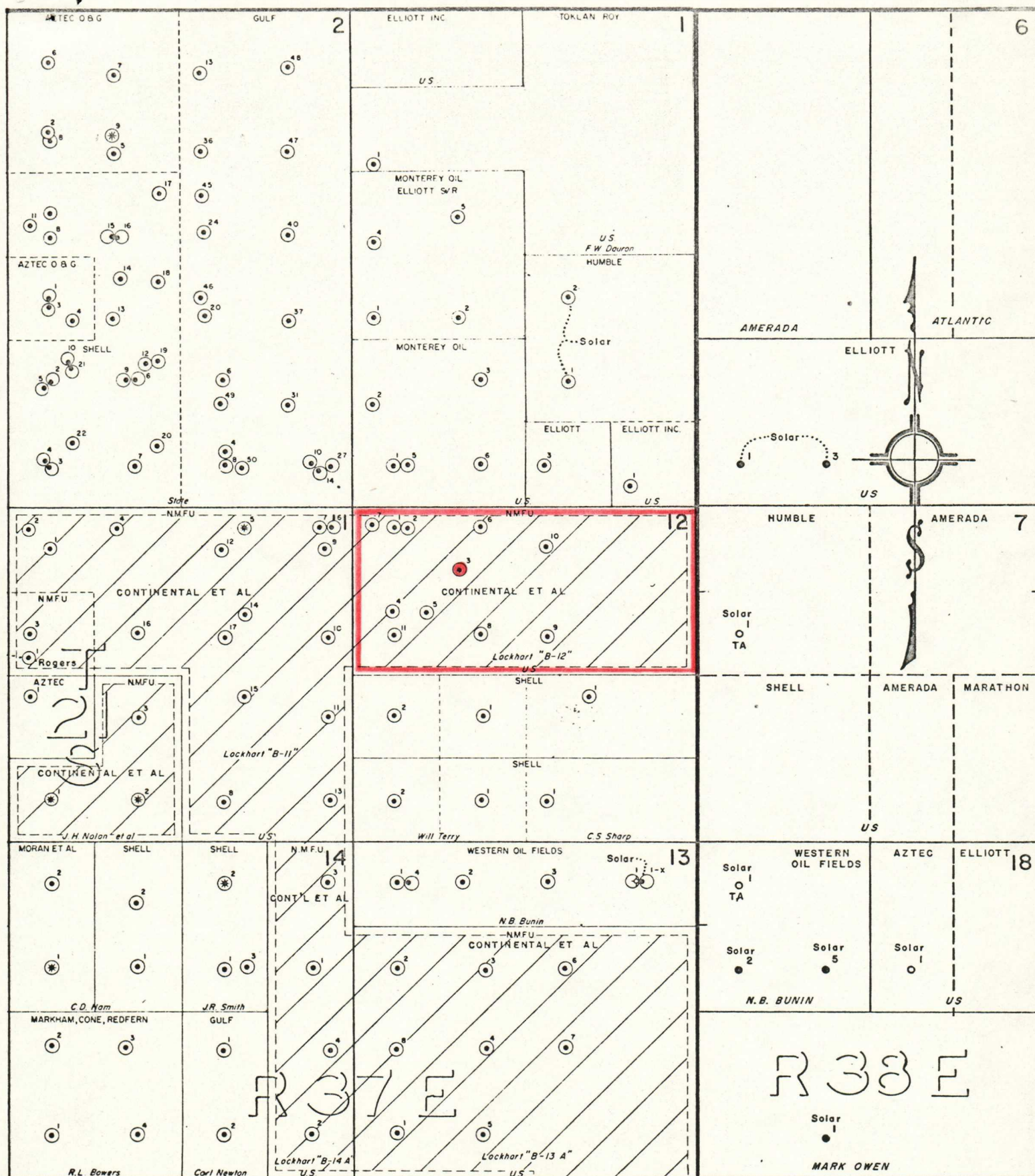

CONTINENTAL OIL COMPANY
 PRODUCTION DEPARTMENT
 HOBBS DIVISION
 LOCKHART B-12 LEASE PLAT
 LEA COUNTY, NEW MEXICO
 SCALE: 1" = 2000'

Operator		Pool		County												
Continental Oil Company		Wantz Abo		Lea												
Address		Type of Test - (X)		Completion <input type="checkbox"/> Special <input checked="" type="checkbox"/>												
Box 460, Hobbs, N. M. 88240		Scheduled <input type="checkbox"/>														
LEASE NAME	WELL NO.	LOCATION				DATE OF TEST	STATES	CHOKE SIZE	TBG. PRESS.	DAILY ALLOW-ABLE	LENGTH OF TEST HOURS	PROD. DURING TEST				GAS - OIL RATIO CU.FT./BBL.
		U	S	T	R							WATER BBLs.	GRAV. OIL BBLs.	GAS M.C.F.		
Hawk B-10	4	H	10	21	37	11-23-69	F	SCF	220	7	24	1	37	5	25	5,000
Lockhart B-11	16	F	11	20	37	Shut-in	-	tubing plugged								
Lockhart B-12	3	C	12	21	37	Shut-in	-	will not flow								

No well will be assigned an allowable greater than the amount of oil produced on the official test.

During gas-oil ratio test, each well shall be produced at a rate not exceeding the top unit allowable for the pool in which well is located by more than 25 percent. Operator is encouraged to take advantage of this 25 percent tolerance in order that well can be assigned increased allowables when authorized by the Commission.

Gas volumes must be reported in MCF measured at a pressure base of 15.025 psia and a temperature of 60° F. Specific gravity base will be 0.60.

Report casing pressure in lieu of tubing pressure for any well producing through casing.

Mail original and one copy of this report to the district office of the New Mexico Oil Conservation Commission in accordance with Rule 301 and appropriate pool rules.

I hereby certify that the above information is true and complete to the best of my knowledge and belief.

(Signature)

Administrative Section Chief

12-5-69

(Date)

Operator Continental Oil Company		Pool Drinkard		County Lea	
--	--	-------------------------	--	----------------------	--

Address Box 460, Hobbs, N. M. 88240		TYPE OF TEST - (X)		Completion <input type="checkbox"/> Special <input checked="" type="checkbox"/>	
---	--	--------------------	--	---	--

LEASE NAME	WELL NO.	LOCATION				DATE OF TEST	STATUS	CHOKE SIZE	TBG. PRESS.	DAILY ALLOW-ABLE	LENGTH OF TEST HOURS	PROD. DURING TEST				GAS - OIL RATIO CU.FT./BBL.
		U	S	T	R							WATER BBL'S.	GRAV. OIL	OIL BBL'S.	GAS M.C.F.	
Lockhart B-11	10	H	11	21	37	11-17-69P	Open	40	5	24	24	1	37	2	50	25,000
Lockhart B-11	4	C	11	21	37	Shut-in; pumping unit moved.						Last test	38	3 BOPD		
Hawk A	5	D	9	21	37	11-22-69P	Open	40	4	24	24	1	38	7	25	3,571
Hawk A	4	U	4	21	37	Shut-in - pumping unit moved.						0	37	2	33	16,500
Hawk B-3	13	X	3	21	37	11-16-69P	Open	45	2	24	24	0	37	2	33	3,200
Lockhart B-11	11	I	11	21	37	11-13-69P	Open	40	10	24	24	1	36	10	32	4,800
Lockhart B-14A	1	H	14	21	37	11-15-69P	Open	30	8	24	24	2	38	5	24	
Lockhart B-11	16	F	11	20	37	Shut-in - pumping unit moved.						3	38	13	53	4,070
Lockhart B-12	3	C	12	21	37	11-22-69P	Open	40	33	24	24					

No well will be assigned an allowable greater than the amount of oil produced on the official test.

During gas-oil ratio test, each well shall be produced at a rate not exceeding the top unit allowable for the pool in which well is located by more than 25 percent. Operator is encouraged to take advantage of this 25 percent tolerance in order that well can be assigned increased allowables when authorized by the Commission.

Gas volumes must be reported in MCF measured at a pressure base of 15.025 psia and a temperature of 60° F. Specific gravity base will be 0.60.

Report casing pressure in lieu of tubing pressure for any well producing through casing.

Mail original and one copy of this report to the district office of the New Mexico Oil Conservation Commission in accordance with Rule 301 and appropriate pool rules.

I hereby certify that the above information is true and complete to the best of my knowledge and belief.

Administrative Section Chief

NMOCC (2) FILE

12-5-69

(Date)



LOCKHART B-14-A NO. 1
DRINKARD-TERRY BLINEBRY

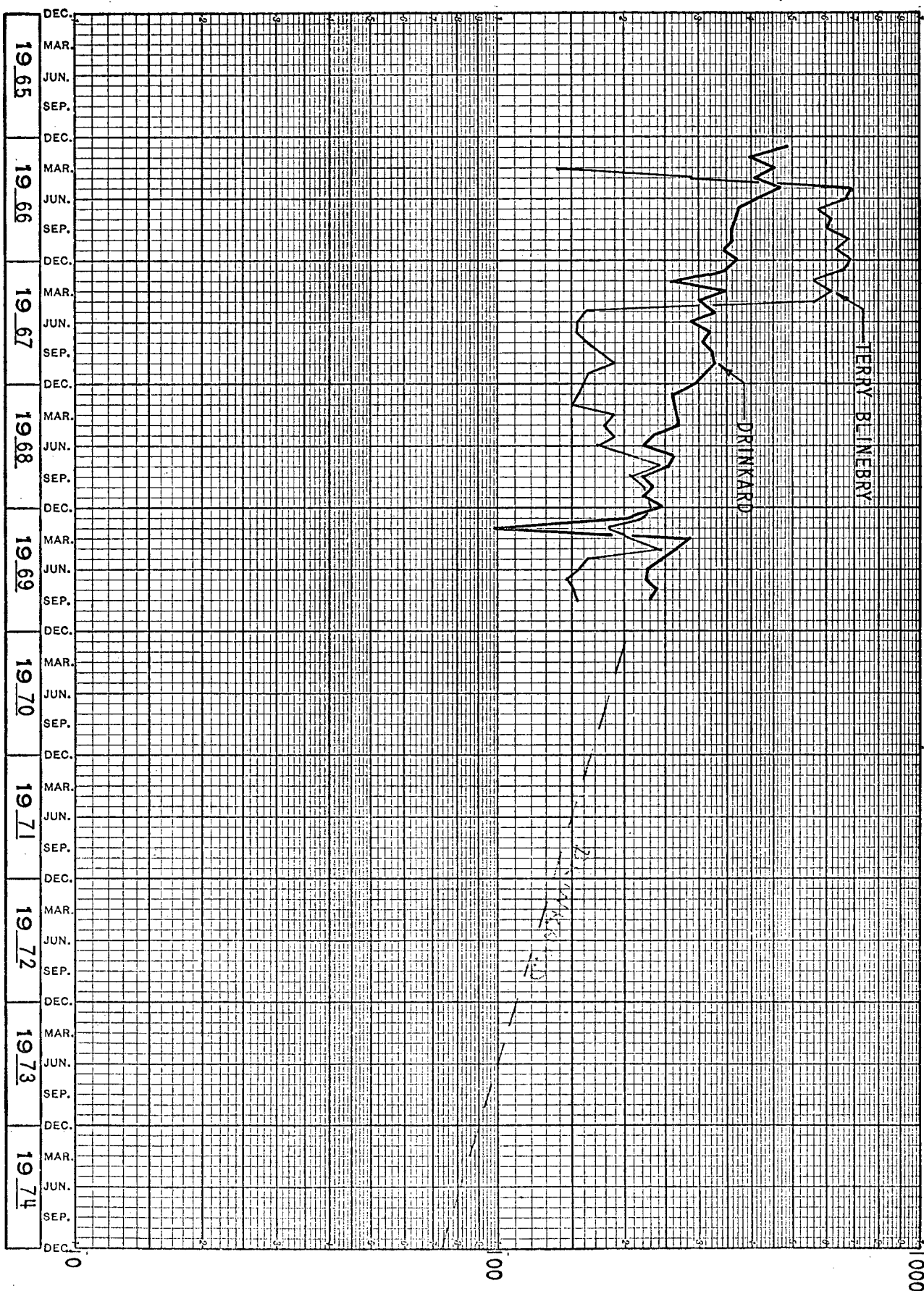

BOPM

NEW MEXICO OIL CONSERVATION COMMISSION
GAS-OIL RATIO TESTS

C-116
Revised 1-1-65

Operator Continental Oil Company		Pool Commingled Drinkard-Wantz Abo		County Lea										
Address P. O. Box 460, Hobbs, New Mexico 88240		TYPE OF TEST - (X) <input checked="" type="checkbox"/> TEST		Completion <input type="checkbox"/> Special <input checked="" type="checkbox"/>										
LEASE NAME	WELL NO.	LOCATION			DATE OF TEST	STATUS	CHOKE SIZE	TBG. PRESS.	DAILY ALLOW-ABLE	LENGTH OF TEST HOURS	PROD. DURING TEST			GAS - OIL RATIO CU. FT./BBL.
		U	S	T							R	WATER BBLs.	GRAV. OIL BBLs.	
Lockhart B-12	3	C	12	21	37	1-28-70	P	30 #	50	24	7	60	118	1967/1
Test for allowable assignment														

No well will be assigned an allowable greater than the amount of oil produced on the official test.
During gas-oil ratio test, each well shall be produced at a rate not exceeding the top unit allowable for the pool in which well is located by more than 25 percent. Operator is encouraged to take advantage of this 25 percent tolerance in order that well can be assigned increased allowables when authorized by the Commission.
Gas volumes must be reported in MCF measured at a pressure base of 15,025 psia and a temperature of 60° F. Specific gravity base will be 0.60.
Report casing pressure in lieu of tubing pressure for any well producing through casing.
Mail original and one copy of this report to the district office of the New Mexico Oil Conservation Commission in accordance with Rule 301 and appropriate pool rules.

I hereby certify that the above information is true and complete to the best of my knowledge and belief.

(Signature)

Administrative Section Chief

January 29, 1970

(Date)

NMOCC-SANTA FE (2) NMOCC-HOBBS(2) FILE

NEW MEXICO OIL CONSERVATION COMMISSION
GAS-OIL RATIO TESTS

C-116
Revised 1-1-65

Operator Continental Oil Company		Pool Commingled Drinkard-Wantz Abo		County Lea										
Address P. O. Box 460, Hobbs, New Mexico 88240		TYPE OF TEST - (X) <input checked="" type="checkbox"/> TEST		Scheduled <input type="checkbox"/> Completion <input type="checkbox"/> Special <input checked="" type="checkbox"/>										
LEASE NAME	WELL NO.	LOCATION			DATE OF TEST	STATUS	CHOKE SIZE	TBG. PRESS.	DAILY ALLOW-ABLE	LENGTH OF TEST HOURS	PROD. DURING TEST			GAS - OIL RATIO CU.FT./BBL.
		U	S	T							R	WATER BBLs.	GRAV. OIL BBLs.	
Lockhart B-12	3	C	12	21	37	1-28-70	P	30#	50	24	7	60	118	1967/1
Test for allowable assignment														

No well will be assigned an allowable greater than the amount of oil produced on the official test.

During gas-oil ratio test, each well shall be produced at a rate not exceeding the top unit allowable for the pool in which well is located by more than 25 percent. Operator is encouraged to take advantage of this 25 percent tolerance in order that well can be assigned increased allowables when authorized by the Commission.

Gas volumes must be reported in MCF measured at a pressure base of 15.025 psia and a temperature of 60° F. Specific gravity base will be 0.60.

Report casing pressure in lieu of tubing pressure for any well producing through casing.

Mail original and one copy of this report to the district office of the New Mexico Oil Conservation Commission in accordance with Rule 301 and appropriate pool rules.

I hereby certify that the above information is true and complete to the best of my knowledge and belief.

HUGH INGRAM

(Signature)

Administrative Section Chief

(Title)

January 29, 1970

(Date)

NMOCC-SANTA FE (2) NMOCC-HOBBS(2) FILE