



Union Texas Petroleum Division

ALLIED CHEMICAL CORPORATION

1300 WILCO BUILDING • MIDLAND, TEXAS 79701

915, 682-0515

DHC - 180
Due - 10/27/75

October 2, 1975



Oil Conservation Commission
The State of New Mexico
P.O. Box 2088
Santa Fe, New Mexico

Re: Application for Downhole Commingling
Union Texas Petroleum
Carlson "A" No. 4
Justis Blinebry and Justis Tubb-
Drinkard Pools; Lea County,
New Mexico

Gentlemen:

Union Texas Petroleum respectfully requests administrative approval for downhole commingling in its Carlson "A" No. 4 located 990' FSL and 990' FWL, Section 25, Township 25 South, Range 37 East, Lea County, New Mexico.

This well qualifies for administrative approval in accordance with Statewide Rule 303, Paragraph C; and in support thereof, the following facts are submitted:

1. The attached plat shows the Carlson "A" Lease outlined in red, and is described as the North half of the Southeast Quarter and the South half of the Southwest Quarter of Section 25. Well No. 4 is circled in red.
2. The well was dually completed in the Justis Blinebry and Justis Tubb-Drinkard Pools and approved by Commission Order No. DC-880 dated Jan. 18, 1960. The Tubb-Drinkard zone was temporarily abandoned on March 3, 1971 because of low productivity. We propose to remove the seal assembly in the Baker Type "FA" Packer set at 5660' and commingle downhole if this application is approved by the Commission.
3. At the time the Tubb-Drinkard was abandoned it was producing 2 BO & 1/2 BWPD. The Gas-Oil Ratio was 2000-1; Oil Gravity was 38° at 60° F. Pumping equipment was recently installed to produce the Blinebry Zone and on a test conducted September 26, 1975, production was 20 bbls. of oil plus 20 bbls. water in 24 hours, GOR is 28,300-1, Oil Gravity is 37.8° at 60° F.
4. The bottom perforations of the lower most zone is 5875'. Oil production prior to commingling does not equal 30 bbls. per day. Both zones are producing less water than the 30 bbls. per day limit.

5875' - 30 BOPD max

$$\begin{array}{rcl} \text{EL} - 20 & = & 91\% \\ \text{Dr} - \frac{2}{22} & = & 9\% \end{array}$$

5. Bottom hole pressures are low and will be produced by pumping.
6. The produced fluids are compatible and have been successfully commingled both down hole and on the surface in other operations for these two fields.
7. Value of the crude will not be decreased by the commingling and the total value of produced hydrocarbons will be increased by the value of the Tubb-Drinkard production.
8. Commingling will not jeopardize future secondary recovery operations.
9. The ownership of the zones to be commingled is common.
10. Attached is a production curve showing the monthly production of oil. Also attached is Form C-116 showing last production test of the Blinebry Zone conducted September 26, 1975.
11. It is recommended that commingled production be allocated to the Blinebry Zone, based on an extrapolation of existing Blinebry production curve, and any additional oil be allocated to the Tubb-Drinkard Zone.
12. Other wells in the two subject pools have been approved for commingling.
13. Copies of this application have been furnished to offset operators and the U.S.G.S. A list of operators notified is attached.

Yours very truly,

UNION TEXAS PETROLEUM CORPORATION

C. M. Heard

C. M. Heard
District Production Manager

JET:es
10-2-75

Union Texas Petroleum - Application for Downhole Commingling
Carlson "A" #4
990' FSL & 990' FWL, Section 25, T-25-S, R-37-E
Justis Blinebry & Tubb-Drinkard Fields, Lea County, New Mexico

Copies to:

New Mexico Oil Conservation Commission
P. O. Box 1980
Hobbs, New Mexico 88240

U. S. Geological Survey
P. O. Box 1157
Hobbs, New Mexico 88240

Atlantic Richfield Company
P. O. Box 1610
Midland, Texas 79701

Amoco Production Company
P. O. Box 367
Andrews, Texas 79714

Gulf Oil Corporation
P. O. Box 1150
Midland, Texas 79701

Terra Resources, Inc.
5416 South Yale Avenue
Tulsa, Oklahoma 74119

Skelly Oil Company
P. O. Box 730
Hobbs, New Mexico 88240

Amerada Hess
Drawer 817
Seminole, Texas 79360

Union Oil Company of California
P. O. Box 3100
Midland, Texas 79701

Westates Petroleum Company
Suite 2360, 1600 Broadway
Denver, Colorado 80202

Operator
UNION TEXAS PETROLEUM CORPORATION

Pool
Justis (Blindbry)

County

Lea

Address
1300 Wilco Building, Midland, Texas 79701

TYPE OF
TEST - (X)

Scheduled ☐

Completion ☐

Special ☒

LEASE NAME	WELL NO.	LOCATION				DATE OF TEST	STATUS	CHOKE SIZE	TBG. PRESS.	DAILY ALLOW-ABLE	LENGTH OF TEST HOURS	PROD. DURING TEST				GAS - OIL RATIO CU. FT./BBL.
		U	S	T	R							WATER DBLS.	GRAV. OIL DBLS.	OIL DBLS.	GAS M.C.F.	
Carlson "A"	4	M	25	25	37	9-26-75	P	-	-	28	24	20	37.8	20	566	28,300

No well will be assigned an allowable greater than the amount of oil produced on the official test.

During gas-oil ratio test, each well shall be produced at a rate not exceeding the top unit allowable for the pool in which well is located by more than 25 percent. Operator is encouraged to take advantage of this 25 percent tolerance in order that well can be assigned increased allowables when authorized by the Commission.

Gas volumes must be reported in MCF measured at a pressure base of 15.025 psia and a temperature of 60° F. Specific gravity base will be 0.60.

Report casing pressure in lieu of tubing pressure for any well producing through casing.

Mail original and one copy of this report to the district office of the New Mexico Oil Conservation Commission in accordance with Rule 301 and appropriate pool rules.

I hereby certify that the above information is true and complete to the best of my knowledge and belief.

(Signature)

Gas Measurement Analyst

(Title)

October 2, 1975

(Date)

OIL PRODUCTION BBLS./MO.

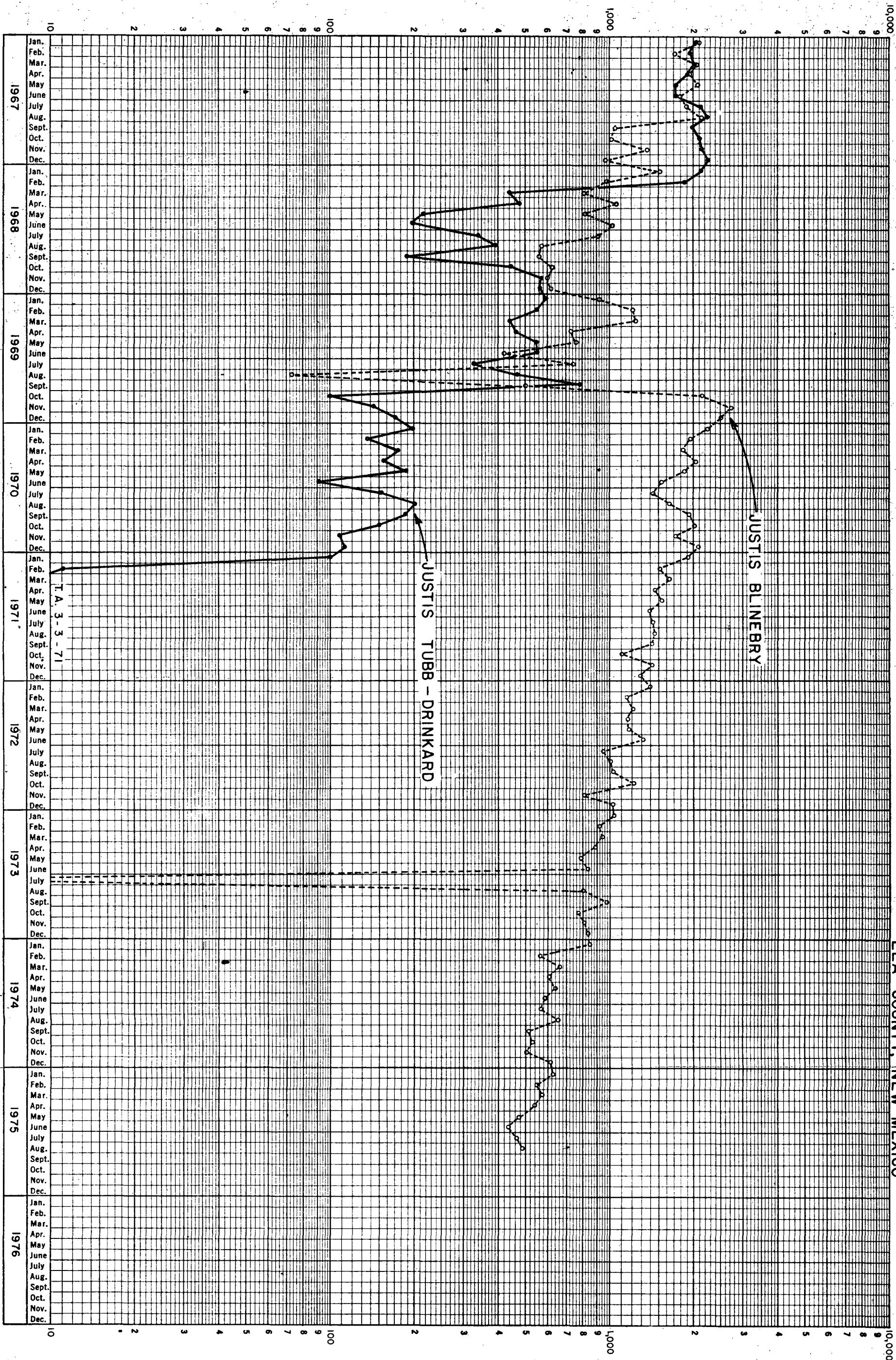

UNION TEXAS	PETROLEUM
CARLSON "A"	NO. 4
JUSTIS FIELD	
UNIT "M" SEC.	25, T-25-S, R-37-E
LEA COUNTY,	NEW MEXICO

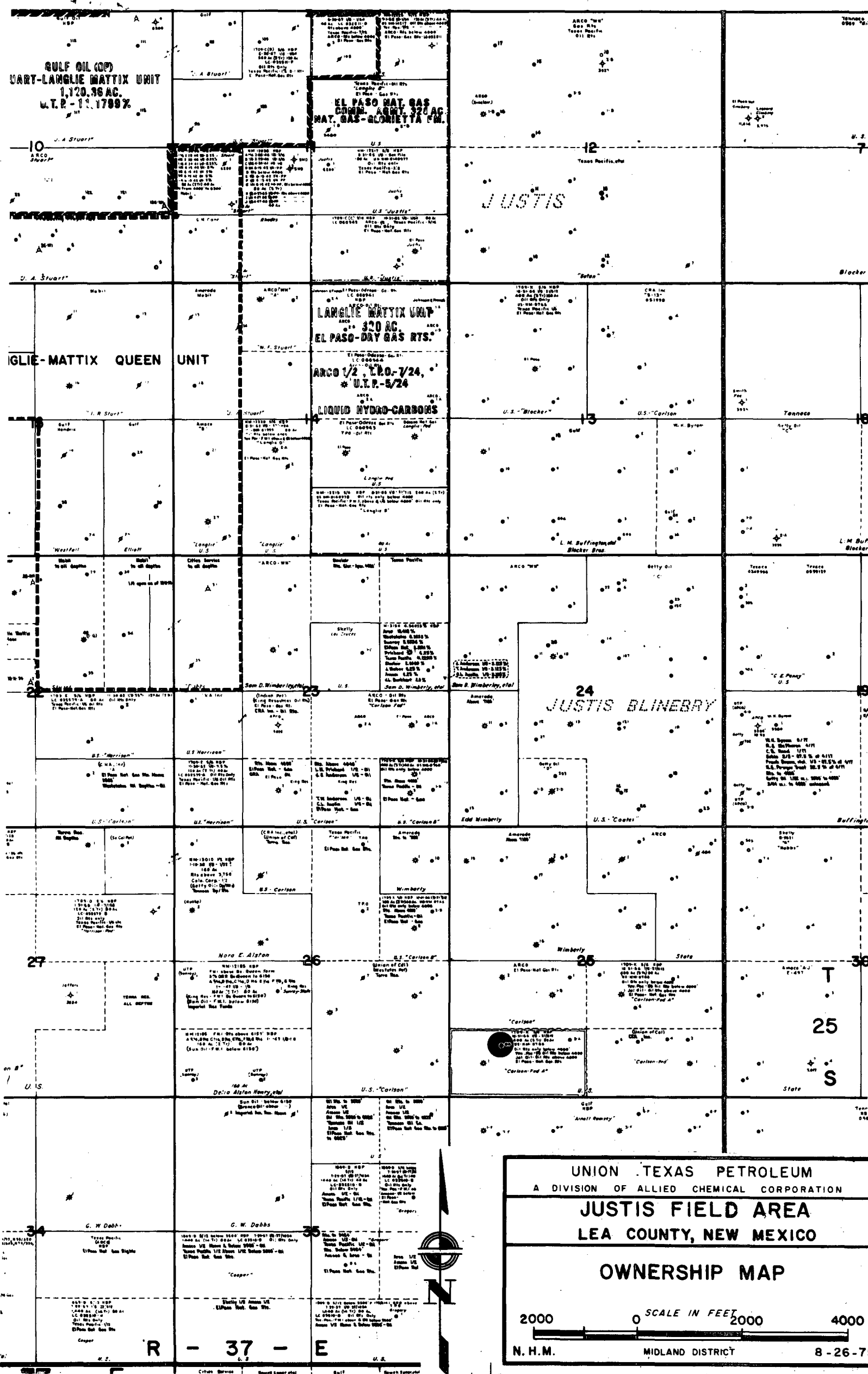

UNION TEXAS PETROLEUM

A DIVISION OF ALLIED CHEMICAL CORPORATION

JUSTIS FIELD AREA

LEA COUNTY, NEW MEXICO

OWNERSHIP MAP

20000 SCALE IN FEET20004000

N. H. M. MIDLAND DISTRICT 8-26-75

OIL CONSERVATION COMMISSION
Hobbs DISTRICT

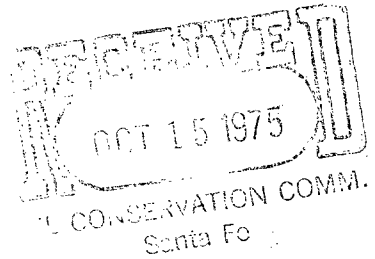

OIL CONSERVATION COMMISSION
BOX 2088
SANTA FE, NEW MEXICO

DATE Oct. 7, 1975

RE: Proposed MC _____
Proposed DHC X _____
Proposed NSL _____
Proposed SWD _____
Proposed WFX _____
Proposed PMX _____

Gentlemen:

I have examined the application dated _____
for the Union Texas Pet. Corp. Carlson A #4-M 25-25-37
Operator Lease and Well No. Unit, S-T-R

and my recommendations are as follows:

O.K.---J.W.R.

Yours very truly,

Handwritten signature of John W. Runyan in cursive script.