

11/2/04  
 9-16-04 10/15/04 9-17-04  
 DATE IN SUSPENSE ENGINEER JONES LOGGED IN TYPE SWD APP NO. PSEM0426151533

ABOVE THIS LINE FOR DIVISION USE ONLY

# NEW MEXICO OIL CONSERVATION DIVISION

- Engineering Bureau -

1220 South St. Francis Drive, Santa Fe, NM 87505



SEP 16 2004

OIL CONSERVATION  
DIVISION

## ADMINISTRATIVE APPLICATION CHECKLIST

THIS CHECKLIST IS MANDATORY FOR ALL ADMINISTRATIVE APPLICATIONS FOR EXCEPTIONS TO DIVISION RULES AND REGULATIONS WHICH REQUIRE PROCESSING AT THE DIVISION LEVEL IN SANTA FE

### Application Acronyms:

[NSL-Non-Standard Location] [NSP-Non-Standard Proration Unit] [SD-Simultaneous Dedication]  
 [DHC-Downhole Commingling] [CTB-Lease Commingling] [PLC-Pool/Lease Commingling]  
 [PC-Pool Commingling] [OLS - Off-Lease Storage] [OLM-Off-Lease Measurement]  
 [WFX-Waterflood Expansion] [PMX-Pressure Maintenance Expansion]  
 [SWD-Salt Water Disposal] [IPI-Injection Pressure Increase]  
 [EOR-Qualified Enhanced Oil Recovery Certification] [PPR-Positive Production Response]

### [1] TYPE OF APPLICATION - Check Those Which Apply for [A]

[A] Location - Spacing Unit - Simultaneous Dedication  
☐ NSL ☐ NSP ☐ SD

Check One Only for [B] or [C]

[B] Commingling - Storage - Measurement  
☐ DHC ☐ CTB ☐ PLC ☐ PC ☐ OLS ☐ OLM

[C] Injection - Disposal - Pressure Increase - Enhanced Oil Recovery  
☐ WFX ☐ PMX ☒ SWD ☐ IPI ☐ EOR ☐ PPR

[D] Other: Specify \_\_\_\_\_

### [2] NOTIFICATION REQUIRED TO: - Check Those Which Apply, or Does Not Apply

[A] ☐ Working, Royalty or Overriding Royalty Interest Owners

[B] ☒ Offset Operators, Leaseholders or Surface Owner

[C] ☒ Application is One Which Requires Published Legal Notice

[D] ☒ Notification and/or Concurrent Approval by BLM or SLO  
 U.S. Bureau of Land Management - Commissioner of Public Lands, State Land Office

[E] ☒ For all of the above, Proof of Notification or Publication is Attached, and/or,

[F] ☐ Waivers are Attached

### [3] SUBMIT ACCURATE AND COMPLETE INFORMATION REQUIRED TO PROCESS THE TYPE OF APPLICATION INDICATED ABOVE.

[4] **CERTIFICATION:** I hereby certify that the information submitted with this application for administrative approval is **accurate** and **complete** to the best of my knowledge. I also understand that **no action** will be taken on this application until the required information and notifications are submitted to the Division.

Note: Statement must be completed by an individual with managerial and/or supervisory capacity.

Eddie W. Seay

Print or Type Name

*Eddie W. Seay*  
Signature

Agent

Title

seay04@leaco.net

e-mail Address

9-3-04

Date

*See Encl for 10/12/04 APT number and more notes*

*(30-025-02405)*

**APPLICATION FOR AUTHORIZATION TO INJECT**

- I. PURPOSE: Secondary Recovery Pressure Maintenance X Disposal Storage  
Application qualifies for administrative approval? X Yes No
- II. OPERATOR: Lou Ray Oil Co., L.L.C.  
ADDRESS: Box 2081 Lovington, NM 88260  
CONTACT PARTY: Louis G. Edgett PHONE: (505) 631-3387
- III. WELL DATA: Complete the data required on the reverse side of this form for each well proposed for injection.  
Additional sheets may be attached if necessary.
- IV. Is this an expansion of an existing project? Yes X No  
If yes, give the Division order number authorizing the project: \_\_\_\_\_
- V. Attach a map that identifies all wells and leases within two miles of any proposed injection well with a one-half mile radius circle drawn around each proposed injection well. This circle identifies the well's area of review.
- VI. Attach a tabulation of data on all wells of public record within the area of review which penetrate the proposed injection zone. Such data shall include a description of each well's type, construction, date drilled, location, depth, record of completion, and a schematic of any plugged well illustrating all plugging detail.
- VII. Attach data on the proposed operation, including:
1. Proposed average and maximum daily rate and volume of fluids to be injected;
  2. Whether the system is open or closed;
  3. Proposed average and maximum injection pressure;
  4. Sources and an appropriate analysis of injection fluid and compatibility with the receiving formation if other than reinjected produced water; and,
  5. If injection is for disposal purposes into a zone not productive of oil or gas at or within one mile of the proposed well, attach a chemical analysis of the disposal zone formation water (may be measured or inferred from existing literature, studies, nearby wells, etc.).
- \*VIII. Attach appropriate geologic data on the injection zone including appropriate lithologic detail, geologic name, thickness, and depth. Give the geologic name, and depth to bottom of all underground sources of drinking water (aquifers containing waters with total dissolved solids concentrations of 10,000 mg/l or less) overlying the proposed injection zone as well as any such sources known to be immediately underlying the injection interval.
- IX. Describe the proposed stimulation program, if any.
- \*X. Attach appropriate logging and test data on the well. (If well logs have been filed with the Division, they need not be resubmitted).
- \*XI. Attach a chemical analysis of fresh water from two or more fresh water wells (if available and producing) within one mile of any injection or disposal well showing location of wells and dates samples were taken.
- XII. Applicants for disposal wells must make an affirmative statement that they have examined available geologic and engineering data and find no evidence of open faults or any other hydrologic connection between the disposal zone and any underground sources of drinking water.
- XIII. Applicants must complete the "Proof of Notice" section on the reverse side of this form.
- XIV. Certification: I hereby certify that the information submitted with this application is true and correct to the best of my knowledge and belief.
- NAME: Eddie W. Seay TITLE: Agent  
SIGNATURE: Eddie W. Seay DATE: 9-3-04
- \* If the information required under Sections VI, VII, X, and XI above has been previously submitted, it need not be resubmitted. Please show the date and circumstances of the earlier submittal: \_\_\_\_\_

DISTRIBUTION: Original and one copy to Santa Fe with one copy to the appropriate District Office

Division, they need not be resubmitted).

- \*XI. Attach a chemical analysis of fresh water from two or more fresh water wells (if available and producing) within one mile of any injection or disposal well showing location of wells and dates samples were taken.
- XII. Applicants for disposal wells must make an affirmative statement that they have examined available geologic and engineering data and find no evidence of open faults or any other hydrologic connection between the disposal zone and any underground sources of drinking water.
- XIII. Applicants must complete the "Proof of Notice" section on the reverse side of this form.
- XIV. Certification: I hereby certify that the information submitted with this application is true and correct to the best of my knowledge and belief.

NAME: Eddie W. Seay TITLE: Agent

SIGNATURE: Eddie W. Seay DATE: 9-3-04

- \* If the information required under Sections VI, VIII, X, and XI above has been previously submitted, it need not be resubmitted. Please show the date and circumstances of the earlier submittal: when drilled 1959

DISTRIBUTION: Original and one copy to Santa Fe with one copy to the appropriate District Office

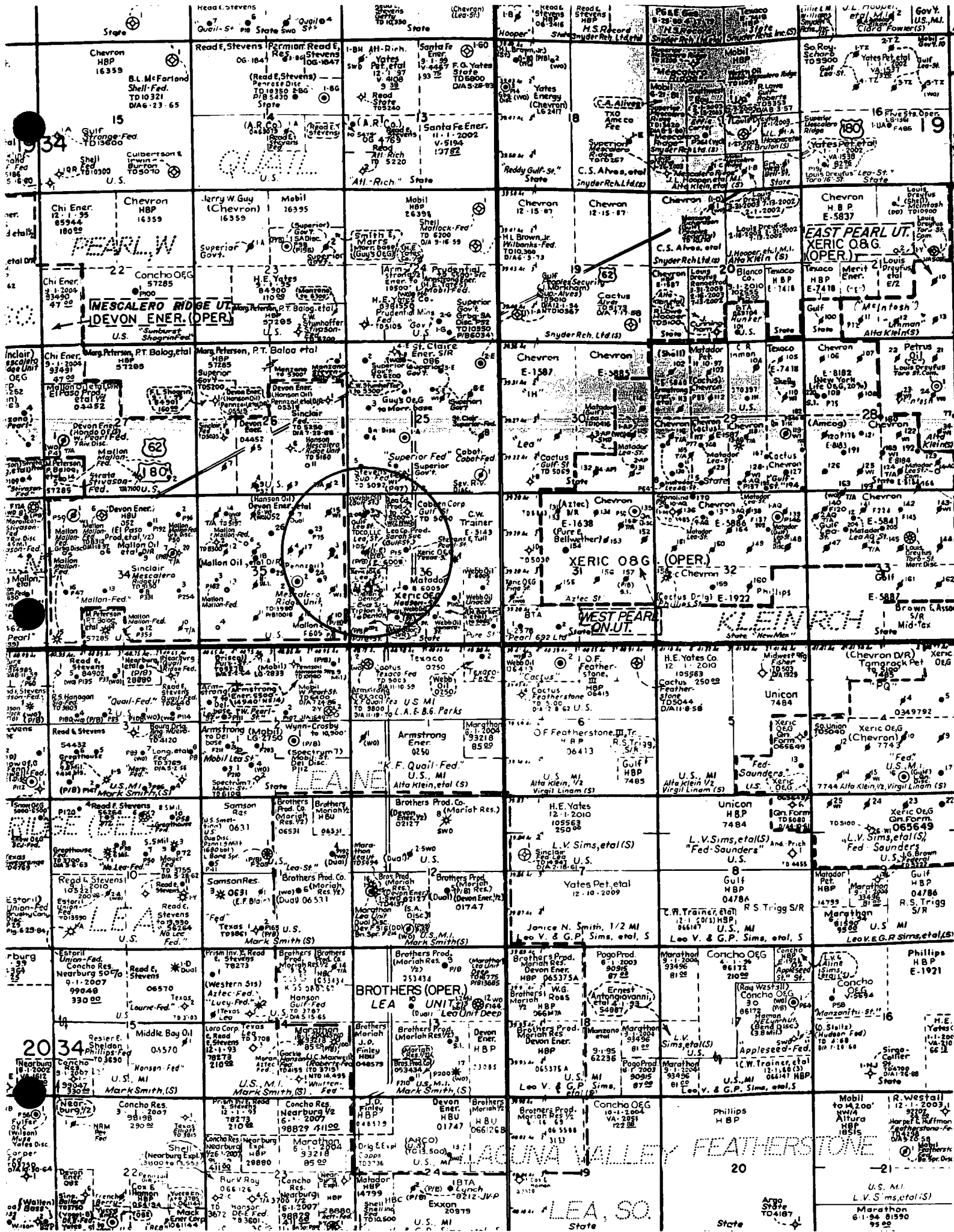

## Attachment to Application C-108

Sara Sue #1  
Unit E, Section 36, Tws. 19 S., Rng. 34 E.  
Lea Co., NM

### III. Well Data

- A.1) See injection well data sheet.
  - 2) See injection well data sheet.
  - 3) 2 7/8" plastic coated tubing.
  - 4) Baker Model "D" Packer.
- 
- B.1) Injection formation - Seven Rivers.
  - 2) Injection interval - 3953' to 3980'.
  - 3) Original purpose of the well was production.
  - 4) Tested Queen.
  - 5) Next higher zone - Yates at 3560'.  
Next lower zone - Queen at 4762'.

### IV. No.

### V. Attached.

### VI. Attached - list of wells and data.

### VII. Proposed Operations.

- 1) 1000 ~~lbs.~~ per day of produced water.
- 2) Open system.
- 3) Average pressure is 500#, whatever OCD allows.
- 4) Attached.
- 5) Normal Seven Rivers formation fluids.

### VIII. The injection zone is the Seven Rivers formation which is a calcareous limestone rock, the formation is approximately 100 ft. thick with the top of the Seven Rivers at 3900' and the base at approximately 4110' below surface.

There is no fresh water found or recorded for this area.

### IX. The only stimulation that should be required is acid as needed.

### X. Previously submitted.

OPERATOR Low Ray Oil Co. LEASE Tract 63404-00 State  
WELL NO. 1-E 1989N 660/W SECTION 36 TOWNSHIP 19 RANGE 34  
FOOTAGE LOCATION

Schematic

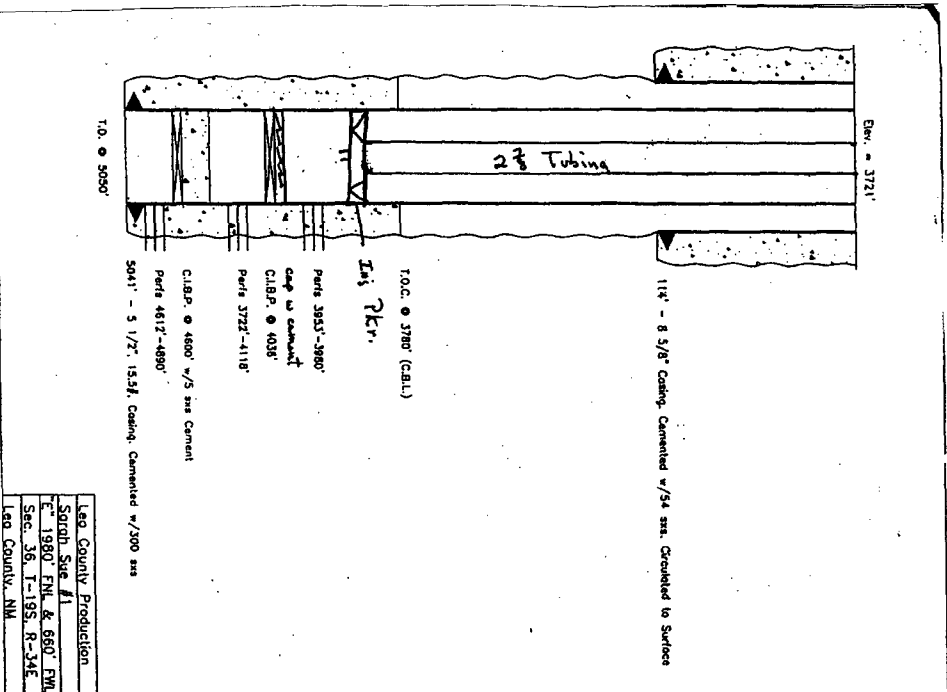

Well Construction Data

Surface Casing  
Size 8 3/4 Cemented with 54 SX.  
TOC Surface feet determined by circulation  
Hole Size 9'  
Intermediate Casing None  
Size        Cemented with        SX.  
TOC        feet determined by         
Hole Size         
Long String  
Size 5 1/2 Cemented with 300 SX.  
TOC 3780 ✓ feet determined by CRC  
Hole Size 7 7/8  
Total Depth 5050  
Injection Interval  
3953 feet to 3980 feet  
(perforated) or open-hole; indicate which)

## INJECTION WELL DATA SHEET

Tubing Size: 2 7/8 Lining Material: IPCType of Packer: Baker Model DPacker Setting Depth: 3950Other Type of Tubing/Casing Seal (if applicable): NONE

## Additional Data

1. Is this a new well drilled for injection? Yes ☒ No ☐

If no, for what purpose was the well originally drilled?

oil + gas production2. Name of the Injection Formation: Seven Rivers3. Name of Field or Pool (if applicable): Pearl Seven Rivers

4. Has the well ever been perforated in any other zone(s)? List all such perforated intervals and give plugging detail, i.e. sacks of cement or plug(s) used.

Perf. 41612-4890 = C1BP w/ 55x Cement 4500 Perf. 41118 = C1BP 4034

5. Give the name and depths of any oil or gas zones underlying or overlying the proposed injection zone in this area:

Yates is overlying at 3900Queen is underlying at 47160

2032-3350 = SALT  
3953-3980 in Zone

RECEIVED

OCT 18 2004

Area of Review

OIL CONSERVATION  
DIVISION

Lou Ray Oil, Sara Sue #1

HOLE	CASING	DEPTH	CEMENT
9"	8 5/8"	114'	54 sx
7 7/8"	5 1/2"	5041'	300 sx

circulated  
TOC 3780'

607- CBL

30-025-02405

TOCO, L.L.C., Lea DS State #1

HOLE	CASING	DEPTH	CEMENT
17"	13 3/8"	372'	420 sx
11"	8 5/8"	4021'	265 sx
7 7/8"	5 1/2"	9743'	500 sx

circulated  
TOC 3100'  
TOC 3460'

30-025-23611

Cabeen Exploration Corp., Gulf State #2  
P & A in 1961, see schematic.

30-025-02403

Lea County Production, L.L.C., Pearl Queen #3

HOLE	CASING	DEPTH	CEMENT
11"	8 5/8"	251'	125 sx
7 7/8"	4 1/2"	5157'	268 sx

circulated  
TOC 2900' calculated

30-025-21756

Gulf Oil Corp., Lea DS State #2  
P & A in 1980, see schematic.

30-025-23808

Mack Energy Corp., Hadson State #1  
P & A in 1986, see schematic.

30-025-02404

Xeric Oil & Gas Co., Lea K State #1  
P & A in 1991, see schematic.

30-025-02406

Mack Energy Corp., State 36 #2  
P & A in 2002, see schematic.

30-025-23690

Run  
CBL

3841 @ 80' f  
4170 @ 60' f



Tipton & Denton, Pure State #1

30-025-20291

<u>HOLE</u>	<u>CASING</u>	<u>DEPTH</u>	<u>CEMENT</u>	
11"	8 5/8"	226'	175 sx	circulated
7 7/8"	5 1/2"	5229'	450 sx	TOC 1400' calculated

OK

Tipton & Denton, Delaware State #1

30-025-23550

<u>HOLE</u>	<u>CASING</u>	<u>DEPTH</u>	<u>CEMENT</u>	
15"	11 3/4"	438'	450 sx	circulated
10"	8 5/6"	4050'	500 sx	TOC 2000' calculated
7 7/8"	4 1/2"	10225'	750 sx	TOC 3000' calculated

✓

Minerals Inc., Minerals State #1

30-025-21281

<u>HOLE</u>	<u>CASING</u>	<u>DEPTH</u>	<u>CEMENT</u>	
11"	8 5/8"	213'	110 sx	circulated
7 7/8"	5 1/2"	4988'	200 sx	TOC 3740'

Calc 3850 @ 80%  
4134 @ 60%

OK

Devon Energy Corp., Mescalero Ridge 26 #2

30-025-21798

<u>HOLE</u>	<u>CASING</u>	<u>DEPTH</u>	<u>CEMENT</u>	
11"	8 5/8"	211'	150 sx	circulated
7 7/8"	5 1/2"	5150'	350 sx	TOC 3250'

OK

Devon Energy Corp., Mescalero Ridge 35 #15

30-025-21483

<u>HOLE</u>	<u>CASING</u>	<u>DEPTH</u>	<u>CEMENT</u>	
11"	8 5/8"	229'	150 sx	circulated
7 7/8"	5 1/2"	5134'	350 sx	TOC 3200'

(15' 10')

Devon Energy Corp., Mescalero Ridge 35 #23

30-025-33640

<u>HOLE</u>	<u>CASING</u>	<u>DEPTH</u>	<u>CEMENT</u>	
11"	8 5/8"	1493'	700 sx	circulated
7 7/8"	5 1/2"	5215'	1600 sx	circulated

✓

30-025-33661

To Cement @ Surface

30-025-20692

**circulated  
TOC 3200'**

30-025-21859

30-025-20491

**circulated  
TOC 3200'**

30-025-23429

30-025- 20302

**circulated**

TOC 38753

30 - 025 - 21264

**circulated**

TOC 3440'

30-025-20545

**circulated**

TOC 2500'

Pennzoil Co., Mescalero Ridge #2  
P & A in 1986, see schematic.

30-025-23319

05/10/02  
AOK

Devon Energy Corp., Mescalero Ridge 35 #10  
P & A in 2000, see schematic.

30-025-21265

05/10/02  
AOK.

NO. OF COPIES RECEIVED	
DISTRIBUTION	
SANTA FE	
FILE	
U.S.G.S.	
LAND OFFICE	
OPERATOR	

# NEW MEXICO OIL CONSERVATION COMMISSION

Form C-103  
Supersedes Old  
C-102 and C-103  
Effective 1-1-65

MAY 31 2 07 PM '66

5a. Indicate Type of Lease State <input checked="" type="checkbox"/> Fee <input type="checkbox"/>
5. State Oil & Gas Lease No. E 3143
7. Unit Agreement Name
8. Farm or Lease Name GULF STATE
9. Well No. 3
10. Field and Pool, or Wildcat PEARL-QUEEN
12. County Lea

**SUNDRY NOTICES AND REPORTS ON WELLS**  
(DO NOT USE THIS FORM FOR PROPOSALS TO DRILL OR TO DEEPEN OR PLUG BACK TO A DIFFERENT RESERVOIR. USE "APPLICATION FOR PERMIT" (FORM C-101) FOR SUCH PROPOSALS.)

1. OIL WELL <input checked="" type="checkbox"/> GAS WELL <input type="checkbox"/> OTHER <input type="checkbox"/>
2. Name of Operator MINERALS, INC.
3. Address of Operator P. O. BOX 2215, HOBBS, NEW MEXICO
4. Location of Well UNIT LETTER D, 660 FEET FROM THE NORTH LINE AND 660 FEET FROM THE WEST LINE, SECTION 36 TOWNSHIP T-19-S RANGE R-34-E NMPM.
15. Elevation (Show whether DF, RT, GR, etc.) 3725 KB

16. Check Appropriate Box To Indicate Nature of Notice, Report or Other Data

NOTICE OF INTENTION TO:		SUBSEQUENT REPORT OF:	
PERFORM REMEDIAL WORK <input type="checkbox"/>	PLUG AND ABANDON <input type="checkbox"/>	REMEDIAL WORK <input type="checkbox"/>	ALTERING CASING <input type="checkbox"/>
TEMPORARILY ABANDON <input type="checkbox"/>	CHANGE PLANS <input type="checkbox"/>	COMMENCE DRILLING OPNS. <input type="checkbox"/>	PLUG AND ABANDONMENT <input type="checkbox"/>
PULL OR ALTER CASING <input type="checkbox"/>	OTHER <input type="checkbox"/>	CASING TEST AND CEMENT JOBS <input checked="" type="checkbox"/>	OTHER <input type="checkbox"/>

17. Describe Proposed or Completed Operations (Clearly state all pertinent details, and give pertinent dates, including estimated date of starting any proposed work) SEE RULE 1103.

April 20, 1966 Ran 163 Jts. 4 1/2"-11.6# Casing, sand coated 500 feet and used 10 centralizers with 40 scratchers. Pumped 180 bbls. brine water to scour and cemented with 133 sacks Class "C" 4% gel, 135 sacks 50-50 Pozmix, 2% gel, .75% CFR-2 and 10# salt/sack. WOC 48 hours. Tested to 1000# 30 min. no drop in pressure, cement job o.k.

*Questionable Cement TOP on T14LS AOR well.*

*133  
135  
268*

18. I hereby certify that the information above is true and complete to the best of my knowledge and belief.

SIGNED <u>R. A. Montgomery</u>	TITLE <u>PRESIDENT</u>	DATE <u>MAY 27, 1966</u>
APPROVED BY <u>[Signature]</u>	TITLE <u></u>	DATE <u></u>

CONDITIONS OF APPROVAL, IF ANY:

Submit 3 Copies To Appropriate District Office

District I

1625 N. French Dr., Hobbs, NM 88240

District II

811 South First, Artesia, NM 88210

District III

1000 Rio Brazos Rd., Aztec, NM 87410

District IV

2040 South Pacheco, Santa Fe, NM 87505

State of New Mexico  
Energy, Minerals and Natural Resources

OIL CONSERVATION DIVISION  
2040 South Pacheco  
Santa Fe, NM 87505

Form C-103

Revised March 25, 1999

<b>SUNDRY NOTICES AND REPORTS ON WELLS</b> (DO NOT USE THIS FORM FOR PROPOSALS TO DRILL OR TO DEEPEN OR PLUG BACK TO A DIFFERENT RESERVOIR. USE "APPLICATION FOR PERMIT" (FORM C-101) FOR SUCH PROPOSALS.)		WELL API NO. 30-025-21756
1. Type of Well: Oil Well <input checked="" type="checkbox"/> Gas Well <input type="checkbox"/> Other <input type="checkbox"/>		5. Indicate Type of Lease STATE <input checked="" type="checkbox"/> FEE <input type="checkbox"/>
2. Name of Operator LEA COUNTY PRODUCTION, LLC		6. State Oil & Gas Lease No. 63404-00
3. Address of Operator 7915 N. LLEWELYN, HOBBS, NM 88242		7. Lease Name or Unit Agreement Name: SARAH SUE
4. Well Location  Unit Letter <u>D</u> : <u>660</u> feet from the <u>NORTH</u> line and <u>660</u> feet from the <u>WEST</u> line  Section <u>36</u> Township <u>19S</u> Range <u>34E</u> NMPM LEA County		8. Well No. <u>3</u>
10. Elevation (Show whether DR, RKB, RT, GR, etc.) 3718 GR		9. Pool name or Wildcat PEARL QUEEN

11. Check Appropriate Box to Indicate Nature of Notice, Report or Other Data

NOTICE OF INTENTION TO:

PERFORM REMEDIAL WORK ☒ PLUG AND ABANDON ☐

TEMPORARILY ABANDON ☐ CHANGE PLANS ☐

PULL OR ALTER CASING ☐ MULTIPLE COMPLETION ☐

OTHER: ☐

SUBSEQUENT REPORT OF:

REMEDIAL WORK ☐ ALTERING CASING ☐

COMMENCE DRILLING OPNS. ☐ PLUG AND ABANDONMENT ☐

CASING TEST AND CEMENT JOB ☐

OTHER: ☐

12. Describe proposed or completed operations. (Clearly state all pertinent details, and give pertinent dates, including estimated date of starting any proposed work). SEE RULE 1103. For Multiple Completions: Attach wellbore diagram of proposed completion or recompletion

TD 5137, PBD 5111, PERFS 4763-4996

MIRU INSTALL BOP, POH w/TBG, RUN RBP @4700', TEST CSG, SET PKR AND SWABB LOWER QUEEN (IF SWABB DRY-ACIDIZE), SET RBP @4700', RUN CBL, PERFORATE UPPER QUEEN 4626-36, 4639-43, 4663-70 w/ 1 JSPF, SET PKR @4600', ACIDIZE PERFS 4626-4670 w/ 1000 GAL 15% NE FE, SWABB TEST FOR FLUID ENTRY.

(DEPENDING ON SWABB RESULTS WE MAY FRAC UPPER QUEEN)

GIH w/PRODUCTION EQUIPMENT AND RETURN TO PRODUCTION

WE PLAN TO START WORK AS SOON AS A PULLING UNIT IS AVAILABLE.

I hereby certify that the information above is true and complete to the best of my knowledge and belief.

SIGNATURE James Cogburn TITLE OPERATION COORDINATOR DATE 07-18-00

Type or print name JAMES COGBURN  
(This space for State use)

Telephone No. (505)392-7095

APPROVED BY \_\_\_\_\_ TITLE \_\_\_\_\_ DATE \_\_\_\_\_

Conditions of approval, if any:

OPERATOR	Cabeen Exp. Corp		DATE	PTA 1963
LEASE	West Pond Queen	WELL No.	2	LOCATION
				C - 36 - 19 - 34

105x surface plug

25' st plug at 8 $\frac{5}{8}$  shoe

8 $\frac{5}{8}$ " casing set at 129' with 90' sx of C cement

Hole size 9"

One

cut + pull csq 2150 - 25' st plug on stub.

25' st plug

Perf 3650 - 3700

5 $\frac{1}{2}$ " casing set at 5050' with 355' sx of C cement

Total Depth 5050' Hole size 7 $\frac{3}{8}$ "

## NEW MEXICO OIL CONSERVATION COMMISSION

FORM C-103  
(Rev 3-55)

## MISCELLANEOUS REPORTS ON WELLS

(Submit to appropriate District Office as per Commission Rule 1106) 3 27

Name of Company <b>Cabeen Exploration Corporation</b>		Address <b>211 N. Ervay Building, Dallas 1, Texas</b>				
Lease <b>Gulf State</b>	Well No. <b>2</b>	Unit <b>C</b>	Section <b>36</b>	Township <b>19S</b>	Range <b>34E</b>	
Date Work Performed <b>11-3-61</b>	Pool <b>West Pearl Queen Field</b>			County <b>Lea</b>		

THIS IS A REPORT OF: (Check appropriate block)

- ☐ Beginning Drilling Operations    ☐ Casing Test and Cement Job    ☐ Other (Explain):  
☒ Plugging    ☐ Remedial Work

Detailed account of work done, nature and quantity of materials used, and results obtained.

1. Tubing was run to total depth and a 25 sx. cement plug was run to cover Perforations.
2. Hole was mudded.
3. Casing was shot off at 2150' and pulled.
4. A 25 sx. cement plug was placed at the stub of the 5-1/2".
5. A 20 sx. cement plug was placed at 1950'.
6. A 20 sx. cement plug was placed in the bottom of the surface.
7. A 10 sx. top hole plug was placed and a 4" marker erected.

Witnessed by <b>Stanley Saikin</b>	Position <b>Superintendent</b>	Company <b>Lea County Casing Pullers Co.</b>
---------------------------------------	-----------------------------------	---

## FILL IN BELOW FOR REMEDIAL WORK REPORTS ONLY

## ORIGINAL WELL DATA

D F Elev.	T D	P B T D	Producing Interval	Completion Date
Tubing Diameter	Tubing Depth	Oil String Diameter	Oil String Depth	
Perforated Interval(s)				
Open Hole Interval		Producing Formation(s)		

## RESULTS OF WORKOVER

Test	Date of Test	Oil Production BPD	Gas Production MCFPD	Water Production BPD	GOR Cubic feet/Bbl	Gas Well Potential MCFPD
Before Workover						
After Workover						

## OIL CONSERVATION COMMISSION

I hereby certify that the information given above is true and complete to the best of my knowledge.

## CABEEN EXPLORATION COMPANY

Approved by <i>Leslie G. Clement</i>	Name <i>Stanley Saikin</i> (Stanley Saikin)
Title	Position <b>Superintendent</b>
Date	Company <b>Hobbs Pipe &amp; Supply Company (Agent)</b>

OPERATOR <u>Gulf Oil Corp</u>	DATE <u>PTA 1980</u>	
LEASE <u>Lea DS State</u>	WELL No. <u>2</u>	LOCATION <u>D - 36 - 19 - 34</u>

surface plug

- plug @ 270

plug at 400

$13\frac{3}{8}$ " casing set at 355' with 420 sx of C cement

Hole size  $17\frac{1}{2}$ " Cue

pull 85' at 990' cement from 1040 - 940  
 - plug 1950 - 1950  
 - plug 2160 - 2100

cut  $5\frac{1}{2}$ " @ 2327' plug from 2358 to 2210

$8\frac{5}{8}$ " casing set at 4049' with 265 sx of \_\_\_\_\_ cement

Hole size 11" Toc 3210

- plug 5400 - 5300

- CIPD w cement 9350

$5\frac{1}{2}$ " casing set at 9770' with 585 sx of C cement

Total depth 9770' Hole size  $7\frac{3}{8}$ " Toc 2360



STATE OF NEW MEXICO  
ENERGY AND MINERALS DEPARTMENT

NO. OF COPIES RECEIVED	
DISTRIBUTION	
SANTA FE	
FILE	
U.S.O.S.	
LAND OFFICE	
OPERATOR	

OIL CONSERVATION DIVISION  
P. O. BOX 208H  
SANTA FE, NEW MEXICO 87501

Form C-103  
Revised 10-1-78

5a. Indicate Type of Lease	
State <input checked="" type="checkbox"/>	Fee <input type="checkbox"/>
5. State Oil & Gas Lease No.	
E-3454	

SUNDRY NOTICES AND REPORTS ON WELLS

(DO NOT USE THIS FORM FOR PROPOSALS TO DRILL OR TO DEEPEN OR PLUG BACK TO A DIFFERENT RESERVOIR. USE "APPLICATION FOR PERMIT" (FORM C-101) FOR SUCH PROPOSALS.)

1. OIL WELL <input checked="" type="checkbox"/> GAS WELL <input type="checkbox"/> OTHER <input type="checkbox"/>	7. Unit Agreement Name
2. Name of Operator GULF OIL CORPORATION	8. Farm or Lease Name Lea "DS" State
3. Address of Operator P. O. Box 670, Hobbs, NM 88240	9. Well No. 2
4. Location of Well UNIT LETTER <u>D</u> , <u>770</u> FEET FROM THE <u>North</u> LINE AND <u>560</u> FEET FROM THE <u>West</u> LINE, SECTION <u>36</u> TOWNSHIP <u>19S</u> RANGE <u>34E</u> NMPM.	10. Field and Pool, or Wildcat Bone Springs
11. Elevation (Show whether DF, RT, GR, etc.) 3723' GL	12. County Lea

Check Appropriate Box To Indicate Nature of Notice, Report or Other Data  
NOTICE OF INTENTION TO:

PERFORM REMEDIAL WORK ☐  
TEMPORARILY ABANDON ☐  
PULL OR ALTER CASING ☐  
OTHER ☐

PLUG AND ABANDON ☐  
CHANGE PLANS ☐  
OTHER ☐

SUBSEQUENT REPORT OF:

REMEDIAL WORK ☐  
COMMENCE DRILLING OPNS. ☐  
CASING TEST AND CEMENT JOBS ☐  
OTHER ☐  
ALTERING CASING ☐  
PLUG AND ABANDONMENT ☒

17. Describe Proposed or Completed Operations (Clearly state all pertinent details, and give pertinent dates, including estimated date of starting any proposed work) SEE RULE 1103.

9770' TD Spot 10 sx cmt f/9350' up to 9300'; spot 20 sx cmt f/5400' up to 5300'; Cut 5½" csg @ 2327'. Got permission from Mr. Saxton w/OCD to pmp cmt plug f/2358' up to 2210'. Cut 8-5/8" csg @ 990'. Spot 20 sx cmt f/2160' up to 2100'. Pull up hole & spot 35 sx cmt f/1950' up to 1850'. Pull up hole & spot 70 sx cmt f/1040' up to 940'. GIH w/2-7/8" tbg, tag cmt @ 912'. Spot 80 sx cmt @ 400'. WOC 4½ hrs, tag cmt @ 367'. Spotted 55 sx cmt. Tag cmt @ 270'. Spot 10 sx cmt 30' f/surf up to surf. Install dry hole marker. Cleaned & cleared loc. P & A complete 3-27-80.

18. I hereby certify that the information above is true and complete to the best of my knowledge and belief.

SIGNED H. B. Sikes, Jr. TITLE Area Engineer DATE 3-31-80

APPROVED BY A. E. Stettin TITLE OIL & GAS INSPECTOR DATE JUN 26 1980

CONDITIONS OF APPROVAL, IF ANY:

OPERATOR <u>Mack Energy Corp</u>		DATE <u>PLA 1996</u>
LEASE <u>Hudson St</u>	WELL No. <u>1</u>	LOCATION <u>Unit 6 36-19-34</u>

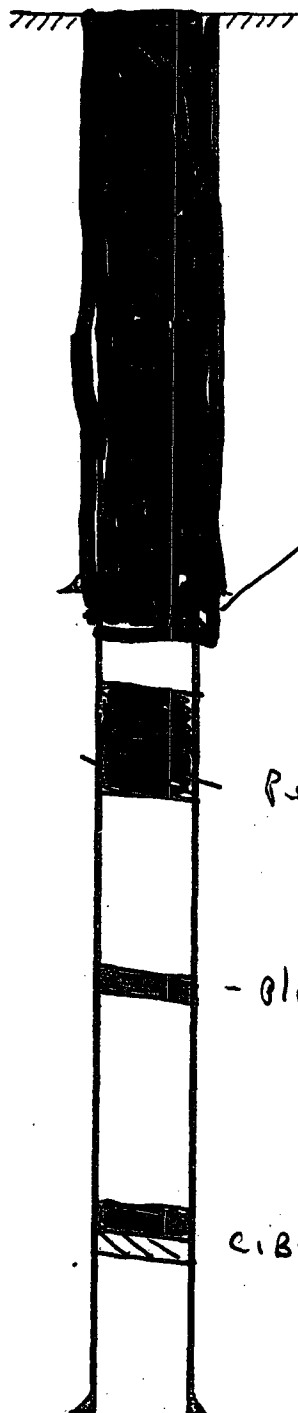

Perf. 164 circ to surface leaving 8<sup>5</sup>/<sub>8</sub> full.

8<sup>5</sup>/<sub>8</sub> " casing set at 114 ' with 100 sx of C cement

Hole size 9 " Circ

Perf 2000 pump 63 ex. plug from 2053 - 1494

- Plug 3420

cibp cap w/ 35' cement 4900

5<sup>1</sup>/<sub>2</sub> " casing set at 5060 ' with 350 sx of regular cement

Total Depth 5060 ' Hole size 7<sup>7</sup>/<sub>8</sub> " TDC 3230

Submit 3 Copies  
to Appropriate  
District Office

State of New Mexico  
Energy, Minerals and Natural Resources Department

Form C-103  
Revised 1-1-89

DISTRICT I  
P.O. Box 1980, Hobbs, NM 88240

DISTRICT II  
P.O. Drawer DD, Artesia, NM 88210

DISTRICT III  
1000 Rio Brazos Rd., Aztec, NM 87410

OIL CONSERVATION DIVISION  
P.O. Box 2088  
Santa Fe, New Mexico 87504-2088

WELL API NO.  
30-025-02404

5. Indicate Type of Lease  
STATE ☒ FEE ☐

6. State Oil & Gas Lease No.  
E-6005

7. Lease Name or Unit Agreement Name  
Hadson  
State

8. Well No.  
1

9. Pool name or Wildcat  
Pearl Queen

SUNDRY NOTICES AND REPORTS ON WELLS  
(DO NOT USE THIS FORM FOR PROPOSALS TO DRILL OR TO DEEPEN OR PLUG BACK TO A  
DIFFERENT RESERVOIR. USE "APPLICATION FOR PERMIT"  
(FORM C-101) FOR SUCH PROPOSALS.)

1. Type of Well:  
OIL WELL ☒ GAS WELL ☐ OTHER

2. Name of Operator  
Mack Energy Corporation

3. Address of Operator  
P. O. Box 960, Artesia, NM (505) 748-1288

4. Well Location  
Unit Letter K : 1980 Feet From The South Line and 1980 Feet From The West Line  
Section 36 Township 19-S Range 34-E NMPM Lea Country

10. Elevation (Show whether DF, RKB, RT, GR, etc.)

11. Check Appropriate Box to Indicate Nature of Notice, Report, or Other Data

NOTICE OF INTENTION TO:		SUBSEQUENT REPORT OF:	
FORM REMEDIAL WORK <input type="checkbox"/>	PLUG AND ABANDON <input type="checkbox"/>	REMEDIAL WORK <input type="checkbox"/>	ALTERING CASING <input type="checkbox"/>
TEMPORARILY ABANDON <input type="checkbox"/>	CHANGE PLANS <input type="checkbox"/>	COMMENCE DRILLING OPNS. <input type="checkbox"/>	PLUG AND ABANDONMENT <input checked="" type="checkbox"/>
PULL OR ALTER CASING <input type="checkbox"/>		CASING TEST AND CEMENT JOB <input type="checkbox"/>	
OTHER: <input type="checkbox"/>		OTHER: <input type="checkbox"/>	

12. Describe Proposed or Completed Operations (Clearly state all pertinent details, and give pertinent dates, including estimated date of starting any proposed work) SEE RULE 1103.

- 1) Set 5½ CIBP @ 4900' Cap with 35' cement
- 2) Load hole with mud
- 3) Spot 25 sx cement Plug @ 3420'
- 4) Perforate 5½ casing @ 2000' Hole in casing @ between 1680' - 1800' Unable to pump into formation Spot 63 sx cement @ 2053' W.O.C. Tag cement top @ 1494'
- 5) Perforate 5½ casing @ 164' 8-5/8 shoe Circulate cement to surface with 130 sacks cement Set PA marker
- 6) Job completed 2-22-96

I hereby certify that the information above is true and complete to the best of my knowledge and belief.

SIGNATURE

*Elicia Klab*

TITLE

*District Secretary*

DATE

*2/23/96*

OR PRINT NAME

TELEPHONE NO.

(This space for State Use)

APPROVED BY

*Johnny Robinson*

TITLE

DATE

CONDITIONS OF APPROVAL, IF ANY:

TCT PW

47

OPERATOR <u>Xeric Oil &amp; Gas Co</u>		DATE <u>PHA 1983</u>
LEASE <u>Lea K. State</u>	WELL No. <u>1</u>	LOCATION <u>6-36-19-34</u>

surface plug



8 5/8 " casing set at 120 ' with 90x sx of C cement

Hole size 12 1/4 " Circ

Perf + Sq 1850

c.B.P w/ cement 3850

c.B.P w/ cement 4250

5 1/2 " casing set at 4980 ' with 380 sx of 1.75 + Neat cement

Total Depth 4980 ' Hole size 7 7/8 " TOL 3300

DISTRICT I  
P.O. Box 1980, Hobbs, NM 88240

DISTRICT II  
P.O. Drawer DD, Artesia, NM 88210

DISTRICT III  
1000 Rio Brazos Rd., Aztec, NM 87410

OIL CONSERVATION DIVISION  
P.O. Box 2088  
Santa Fe, New Mexico 87504-2088

WELL API NO. 30-025-02406
5. Indicate Type of Lease STATE <input checked="" type="checkbox"/> FEE <input type="checkbox"/>
6. State Oil & Gas Lease No. E-6005-1
7. Lease Name or Unit Agreement Name Lea K State
8. Well No. 1
9. Pool name or Wildcat <i>Pearl Queen +</i> Pearl (Seven Rivers, South)

SUNDRY NOTICES AND REPORTS ON WELLS (DO NOT USE THIS FORM FOR PROPOSALS TO DRILL OR TO DEEPEN OR PLUG BACK TO A DIFFERENT RESERVOIR. USE "APPLICATION FOR PERMIT" (FORM C-101) FOR SUCH PROPOSALS.)	
1. Type of Well: OIL WELL <input type="checkbox"/> GAS WELL <input checked="" type="checkbox"/> OTHER	
2. Name of Operator Xeric Oil & Gas Co.	
3. Address of Operator P.O. Box 51311 Midland, Tx. 79710	
4. Well Location Unit Letter <u>L</u> : <u>1980</u> Feet From The <u>South</u> Line and <u>660</u> Feet From The <u>West</u> Line Section <u>36</u> Township <u>19-S</u> Range <u>34E</u> NMPM <u>Lea</u> County	
10. Elevation (Show whether DF, RKB, RT, GR, etc.) 3703 SCF	

11. Check Appropriate Box to Indicate Nature of Notice, Report, or Other Data	
NOTICE OF INTENTION TO:	SUBSEQUENT REPORT OF:
PERFORM REMEDIAL WORK <input type="checkbox"/>	REMEDIAL WORK <input type="checkbox"/>
TEMPORARILY ABANDON <input type="checkbox"/>	ALTERING CASING <input type="checkbox"/>
PULL OR ALTER CASING <input type="checkbox"/>	COMMENCE DRILLING OPNS. <input type="checkbox"/>
OTHER: <input type="checkbox"/>	PLUG AND ABANDONMENT <input checked="" type="checkbox"/>
	CASING TEST AND CEMENT JOB <input type="checkbox"/>
	OTHER: <input type="checkbox"/>

12. Describe Proposed or Completed Operations (Clearly state all pertinent details, and give pertinent dates, including estimated date of starting any proposed work) SEE RULE 1103.

10/30/91 Spot 35 sx cmt on top of CIBP @ 4250'  
10/30/91 Circ. hole w/105 BBLs. 10# brine w/1/4 sx salt gel per BBL.  
10/30/91 Set 5 1/2 CIBP @ 3850 and cap w/35 sx cmt. (TOC @ 3500')  
10/31/91 Perf @ 1850 and set 5 1/2 C.R. Sqz. w/200 sx class C cmt. Unstung and cap w/100 sx cmt. TOC @ 1050'  
10/31/91 Spot 15 sx cmt from 30' to surface.  
10/31/91 Cut off well head, weld on steel plate w/dry hole marker.

I hereby certify that the information above is true and complete to the best of my knowledge and belief.

SIGNATURE Louie French TITLE P&A Supervisor DATE 10/31/91

TYPE OR PRINT NAME Louie French TELEPHONE NO. 915 563-2805

(This space for State Use)

APPROVED BY [Signature] TITLE OIL & GAS INSPECTOR DATE NOV 09 1993

CONDITIONS OF APPROVAL, IF ANY:

OPERATOR <u>Mack Energy Corp</u>	DATE <u>PTA 2002</u>	
LEASE <u>State 36</u>	WELL No. <u>2</u>	LOCATION <u>1-36 19 34</u>

surface plug

- plug 400

1 3/4 " casing set at 463 ' with 500 sx of C cement  
Hole size 15 " circ

- plug 1930

- plug 3420

- cement plug 4060

8 5/8 " casing set at 4010 ' with 500 sx of C cement  
Hole size 11 "

CIP 4281

cement plug  
Berto 9646-9641

4 1/2 " casing set at 10250 ' with 700 sx of H cement  
Total depth 10250 ' Hole size 2 3/4 "

Submit 3 Copies  
to Appropriate  
District Office

State of New Mexico  
Energy Minerals and Natural Resources Department

L-36-19-34  
30-025-23690  
Form C-103  
Revised 1-1-89

DISTRICT I  
P.O. Box 1980, Hobbs NM 88240

DISTRICT II  
811 South First, Artesia, NM 88210

DISTRICT III  
1000 Rio Brazos Rd, Aztec, NM 87410

OIL CONSERVATION DIVISION  
2040 South Pacheco  
Santa Fe, New Mexico 87505

WELL API NO. 30-025-23690
5. Indicate Type of Lease STATE <input checked="" type="checkbox"/> FEE <input type="checkbox"/>
6. State Oil & Gas Lease No. E-6005
7. Lease Name or Unit Agreement Name State "36"
8. Well No. 2
9. Pool name or Wildcat Lea Bone Springs
10. Elevation (Show whether DF, RKB, RT, GR, etc.) 3707 GR

<b>SUNDRY NOTICES AND REPORTS ON WELLS</b> (DO NOT USE THIS FORM FOR PROPOSALS TO DRILL OR TO DEEPEN OR PLUG BACK TO A DIFFERENT RESERVOIR. USE "APPLICATION FOR PERMIT" (FORM C-101) FOR SUCH PROPOSALS).	
1. Type Of Well: OIL WELL <input type="checkbox"/> GAS WELL <input checked="" type="checkbox"/> OTHER	
2. Name of Operator Mack Energy Corporation	
3. Address of Operator P.O. Box 960, Artesia, NM 88211-0960	
4. Well Location Unit Letter <u>L</u> : <u>2130</u> Feet From The <u>South</u> Line and <u>660</u> Feet From The <u>West</u> Line Section <u>36</u> Township <u>19S</u> Range <u>34E</u> NMPM <u>Lea, NM</u> County	
10. Elevation (Show whether DF, RKB, RT, GR, etc.) 3707 GR	

11. Check Appropriate Box to Indicate Nature of Notice, Report, or Other Data	
<b>NOTICE OF INTENTION TO:</b>	<b>SUBSEQUENT REPORT OF:</b>
PERFORM REMEDIAL WORK <input type="checkbox"/>	REMEDIAL WORK <input type="checkbox"/>
TEMPORARILY ABANDON <input type="checkbox"/>	ALTERING CASING <input type="checkbox"/>
PULL OR ALTER CASING <input type="checkbox"/>	COMMENCE DRILLING OPNS. <input type="checkbox"/>
OTHER: <input type="checkbox"/>	PLUG AND ABANDONMENT <input checked="" type="checkbox"/>
	CASING TEST AND CEMENT JOB <input type="checkbox"/>
	OTHER: <input type="checkbox"/>

12. Describe Proposed or Completed Operations (Clearly state all pertinent details, and give pertinent dates, including estimated date of starting any proposed work) SEE RULE 1103.

10/23/2002 Spot 40 sx plug @ 4060'.  
10/24/2002 Tag plug @ 3928', spot 35 sx plug @ 3420', spot 35 sx. plug @ 1930', spot 35 sx plug @ 400', WOC tag @ 270', spot 10 sx surface plug @ 60.  
10/29/2002 Cut off wellhead and install dry hole marker.

I hereby certify that the information above is true and complete to the best of my knowledge and belief.

SIGNATURE Crissa D. Carter TITLE Production Analyst DATE 10/30/02

TYPE OR PRINT NAME Crissa D. Carter TELEPHONE NO. 748-1288

(This space for State Use)

APPROVED BY [Signature] TITLE [Signature] DATE 11-27-02

CONDITIONS OF APPROVAL, IF ANY:  
GWW

# General Purpose Worksheet

Subject	MESCALERO RIDGE UNIT '35' #17	Page No.	Of
File	PRESENT STATUS	By	WCH
		Date	9-16-85

— Cement from 0 - 320'

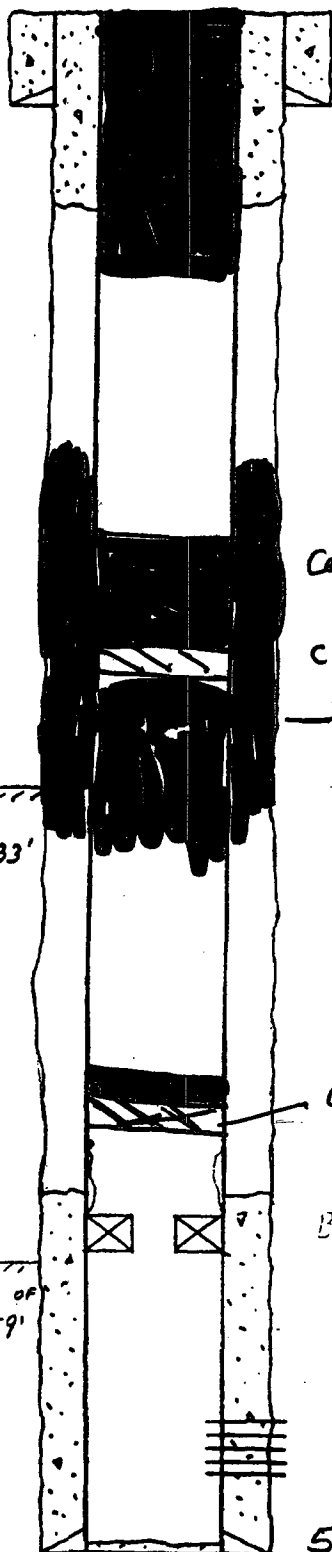

8 5/8" 32# CSG @ 227' w/200 SX. TOC @ SURF - CIRC.

HOLE IN 5 1/2" @ 490' CMTD w/200 SX - CIRC CMT TO SURF.

HOLE IN 5 1/2" @ 570' CMTD w/300 SX.

Cement - 120'

Cement Retainer

— Perf at 1795 sg 150 SX

TOP OF  
SALT 1933'

Cement Retainer at 3256 + sg 300 SX w/35' cement on top

BOTTOM OF  
SALT 3359'

BAKER AD-1 TENSION PKR - STUCK @ 3338' (UNABLE TO MOVE UP OR DOWN) - BO SAFETY COLLAR, BROKE OFF FIRST THREAD ON PIN ON PKR. BOTTOM 9 JTS OF TBL HAD FLAT SPOTS ON BODY & COLLARS. SAFETY COLLAR P/PKR WAS EGG SHAPED

SEVEN RIVERS PERFS 4009-4024' (7 HOLES)

5 1/2" 14# CSG @ 4040' w/200 SX. TOC @ 3230' - CIRC.

TD 4040' PBD 4032'



UNITED STATES  
DEPARTMENT OF THE INTERIOR  
BUREAU OF LAND MANAGEMENT

SUBMIT IN TRIP  
(Other instructions  
verse add 98240)

Form approved.  
Budget Bureau No. 1004-0135  
Expires August 31, 1985

5. LEASE DESIGNATION AND SERIAL NO.

NM 052

6. IF INDIAN, ALLOTTEE OR TRIBE NAME

7. UNIT AGREEMENT NAME

8. FARM OR LEASE NAME

Mescalero Ridge Unit 35

9. WELL NO.

17

10. FIELD AND POOL, OR WILDCAT

Pearl Seven Rivers

11. SEC., T., R., M., OR BLK. AND  
SURVEY OR AREA

Q-35-19S-34E

12. COUNTY OR PARISH

Lea

13. STATE

NM

1. OIL WELL ☐ GAS WELL ☒ OTHER SWD

2. NAME OF OPERATOR

ARCO Oil & Gas Company - Division of Atlantic Richfield Co.

3. ADDRESS OF OPERATOR

P.O. Box 1610, Midland, Texas 79702

4. LOCATION OF WELL (Report location clearly and in accordance with any State requirements.\*  
See also space 17 below.)  
At surface

1980 FNL & 1650 FEL ( Unit G)

14. PERMIT NO.

API #30-025-21859

15. ELEVATIONS (Show whether OF, BT, CR, etc.)

3713 GR

16. Check Appropriate Box To Indicate Nature of Notice, Report, or Other Data

NOTICE OF INTENTION TO:

TEST WATER SHUT-OFF ☐

FRACTURE TREAT ☐

SHOOT OR ACIDIZE ☐

REPAIR WELL ☐

(Other) ☐

PCLL OR ALTER CASING ☐

MULTIPLE COMPLETE ☐

ABANDON\* ☐

CHANGE PLANE ☐

SUBSEQUENT REPORT OF:

WATER SHUT-OFF ☐

FRACTURE TREATMENT ☐

SHOOTING OR ACIDIZING ☐

(Other) ☐

REPAIRING WELL ☐

ALTERING CASING ☐

ABANDONMENT\* ☒

(NOTE: Report results of multiple completion on Well  
Completion or Recompletion Report and Log form.)

17. DESCRIBE PROPOSED OR COMPLETED OPERATIONS (Clearly state all pertinent details, and give pertinent dates, including estimated date of starting any proposed work. If well is directionally drilled, give subsurface locations and measured and true vertical depths for all markers and zones pertinent to this work.)\*

RU PU 1-6-86. RIH w/4-3/4" bit. Tag collapsed csg @ 3347. POH. Set pkr @ 3321'. EIR 4 BPM @ 600#. Set CR @ 3256'. Sqz w/300 sx Cl "H" Neat. Dump 35' cmt on top of CR. Circ hole w/10.7# MLF. Perf'd 4 holes @ 1795'. EIR 4 bpm @ 300#. Set CR @ 1695. Sqzd w/150 sx "H" cmt. Final press 800#. Dump 120' cmt on top of CR. Spot cmt plug f/0-320 using 50 sx Cl "H" neat. Dig out celler. CO csghds. Installed P&A marker. Well P&A'd 1-10-86. FINAL REPORT.

1. 300 sx 3221-4024'. CR @ 3256' w/35 cmt on top. (Perfs 4009-4024' B-Salt)
2. 150 sx 1575-1795'. CR @ 1695' w/120' cmt on top. (T-salt).
3. 50 sx 0-320. (shoe, surface).

18. I hereby certify that the foregoing is true and correct

SIGNED Ken W. Gosnell

TITLE Engr. Tech. Spec.

DATE 1-14-86

(This space for ~~Other~~ State office use)

APPROVED BY \_\_\_\_\_  
CONDITIONS OF APPROVAL, IF ANY:

TITLE \_\_\_\_\_

DATE 8-8-86

\*See Instructions on Reverse Side

OPERATOR	Pennzoil Exp. & Prod.		DATE	May 1989
LEASE	Mescalero Ridge	WELL No.	4	LOCATION
			Unit 6	S. 35 T. 19 R. 34

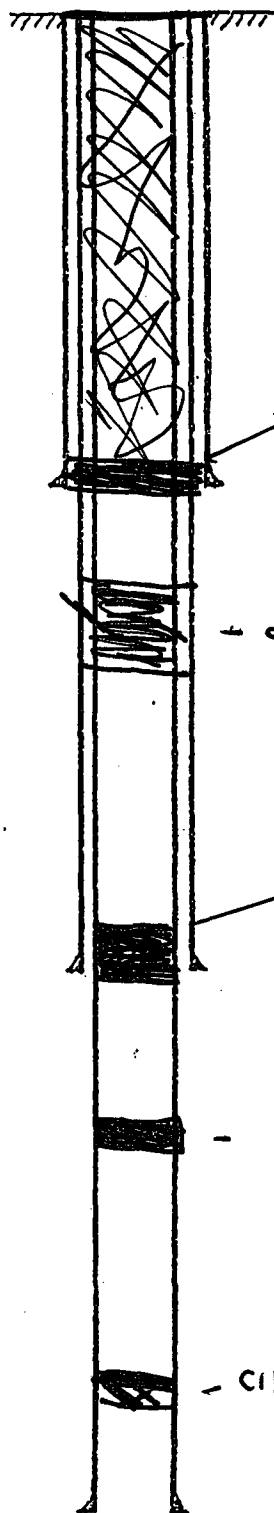

Run at 398 ppg 250 sx in & out of 88' to surface.

11  $\frac{3}{4}$  " casing set at 348 ' with 250 sx of H+C cement

Hole size 15 "

Cement Circ

- cut 4  $\frac{1}{2}$  csq 1812' - set 50sx plug 1812 to 1612

Plug from 4165 to 3965

8  $\frac{5}{8}$  " casing set at 4065 ' with 690 sx of C+H cement

Hole size 11 "

Toc 2940

- 20sx plug 5846

- CIBP 9425 w/ cement

4  $\frac{1}{2}$  " casing set at 10258 ' with 780 sx of C cement

Total depth 10258 ' Hole size 7  $\frac{7}{8}$  "

Toc 3410

UNITED STATES  
DEPARTMENT OF THE INTERIOR  
BUREAU OF LAND MANAGEMENT

SUBMIT IN TRIPPLICATE  
(Other instructions  
verat slide)

30-025-23629  
Budget Bureau No. 1004-0135  
Expires August 31, 1985

5. LEASE DESIGNATION AND SERIAL NO.

NM-052

6. IF INDIAN, ALLOTTEE OR TRIBE NAME

SUNDRY NOTICES AND REPORTS ON WELLS

(Do not use this form for proposals to drill or to deepen or plug back to a different reservoir.  
Use "APPLICATION FOR PERMIT" for such proposals.)

1. OIL WELL ☒ GAS WELL ☐ OTHER ☐  
Aug 13 10 43 AM '89

2. NAME OF OPERATOR  
PENNZOIL EXPLORATION AND PRODUCTION COMPANY

3. ADDRESS OF OPERATOR  
P. O. DRAWER 1828 - Midland, Texas 79702-1828

4. LOCATION OF WELL (Report location clearly and in accordance with any State requirements.  
See also space 17 below.)  
At surface  
unit H  
2086' FNL & 554' FEL of Sec. 35, T-19-S, R-34-E

7. UNIT AGREEMENT NAME  
Mescalero Ridge Unit

8. FARM OR LEASE NAME

9. WELL NO.  
4

10. FIELD AND POOL, OR WILDCAT  
Lea (Bone Spring)

11. SEC., T., R., M., OR BLM. AND  
SURVEY OR AREA  
Sec. 35, T-19-S, R-34-E

14. PERMIT NO.  
15. ELEVATIONS (Show whether OF, BT, OR, etc.)  
3714' GR

12. COUNTY OR PARISH  
LEA  
13. STATE  
NM

16. Check Appropriate Box To Indicate Nature of Notice, Report, or Other Data

NOTICE OF INTENTION TO:

TEST WATER SHUT-OFF ☐  
FRACTURE TREAT ☐  
SHOOT OR ACIDIZE ☐  
REPAIR WELL ☐  
(Other) ☐  
PULL OR ALTER CASING ☐  
MULTIPLE COMPLETE ☐  
ABANDON\* ☐  
CHANGE PLANS ☐

SUBSEQUENT REPORT OF:

WATER SHUT-OFF ☐  
FRACTURE TREATMENT ☐  
SHOOTING OR ACIDIZING ☐  
(Other) ☐  
REPAIRING WELL ☐  
ALTERING CASING ☐  
ABANDONMENT\* ☒

(NOTE: Report results of multiple completion on Well  
Completion or Recompletion Report and Log form.)

17. DESCRIBE PROPOSED OR COMPLETED OPERATIONS (Clearly state all pertinent details, and give pertinent dates, including estimated date of starting any proposed work. If well is directionally drilled, give subsurface locations and measured and true vertical depths for all markers and zones pertinent to this work.)

06/05/89: Unseated pump - Laid down polish rod, liner, rods and pump - Layed down tubing, tubing anchor, seating nipple, perf. sub and mud anchor.  
06/06/89: Set 4-1/2" CIBP at 9425' - Dumped 35' Class -C- cement on top of CIBP back to 9390' - Loaded casing with water & pressured to 1000# for 30" - Held O.K.  
06/07/89: Went in hole with tubing to 5846' - Set 20 sx. Class -C- cement plug from 5846' to 5646' - Pulled up to 4165' - Set 20 sx. Class -C- cement plug from 4165' to 3965'.  
06/08/89: Cut 4-1/2" casing at 1812' & layed down casing - Set 50 sx. Class -C- cement plug from 1812' to 1672'.  
06/09/89: Tagged plug at 1642' - Perf. 8-5/8" casing at 398' with 4-1" holes and at 300' with 4-1" holes - Pumped 250 sx. Class -C- cement down 8-5/8" inside and out 8-5/8" to surface - Welded on dry hole marker - P. & A. at 3:00 PM MST - Plugging witnessed and approved by Mr. D.L. Dillow, BLM, Carlsbad, NM.

18. I hereby certify that the foregoing is true and correct

SIGNED ROY R. JOHNSON TITLE Production Accountant

DATE July 18, 1989

(This space for Federal or State office use)

PETROLEUM ENGINEER

APPROVED BY (ORIG. SGN) DAVID R. GLASS

TITLE

DATE

8-25-89

CONDITIONS OF APPROVAL, IF ANY:

Approved as to plugging of the well bore,  
Liability under bond is retained until  
surface restoration is completed.

\*See Instructions on Reverse Side

OPERATOR Devon Energy Corp		DATE 3/2000	
LEASE Mescalero Ridge	WELL No. 10	LOCATION Unit P S <sub>1</sub> 35-T19 R34	

surface plug.

Perf + Circulate to surface

$8\frac{5}{8}$ " casing set at 235' with 125' sx of C cement

Hole size 11"

Circ.

Perf at 1940 sg.

- cement plug 3878

- cement plug 4280 - 4244

- circ w/ cement 4544 - 4534

Plug

$5\frac{1}{2}$ " casing set at 3740' with 350' sx of C cement

Total Depth 5180' Hole size  $2\frac{7}{8}$ " Toe 3740

UNITED STATES  
DEPARTMENT OF THE INTERIOR  
BUREAU OF LAND MANAGEMENT

N.M. Oil Cons. Division  
1625 N. French Dr.  
Hobbs, NM 88240

FORM APPROVED  
Budget Bureau No. 1004-0135  
Expires: March 31, 1993

**SUNDRY NOTICES AND REPORTS ON WELLS**

Do not use this form for proposals to drill or to deepen or reentry to a different reservoir.  
Use "APPLICATION FOR PERMIT—" for such proposals

**SUBMIT IN TRIPLICATE**

1. Type of Well

☒ Oil Well ☐ Gas Well ☐ Other

2. Name of Operator

Devon Energy Corporation

3. Address and Telephone No.

20 N. Broadway, Ste. 1500, Oklahoma City, OK 73102 (405)235-3811

4. Location of Well (Footage, Sec., T., R., M., or Survey Description)

990' FSL & 600 FEL, Unit P, Sec.35 T19S R 25E  
Lea County, NM

34E

5. Lease Designation and Serial No.

NM052

6. If Indian, Allottee or Tribe Name

NA

7. If Unit or CA, Agreement Designation

Mescalero Ridge Ut.  
891007465B

8. Well Name and No.

Mescalero Ridge 35UT#10

9. API Well No.

30-025-21265

10. Field and Pool, or Exploratory Area

Pearl (Seven Rivers)

11. County or Parish, State

Lea County, New Mexico

12. CHECK APPROPRIATE BOX(s) TO INDICATE NATURE OF NOTICE, REPORT, OR OTHER DATA

TYPE OF SUBMISSION

- ☐ Notice of Intent  
☒ Subsequent Report  
☐ Final Abandonment Notice

TYPE OF ACTION

- ☒ Abandonment  
☐ Recompletion  
☐ Plugging Back  
☐ Casing Repair  
☐ Altering Casing  
☐ Other
- ☐ Change of Plans  
☐ New Construction  
☐ Non-Routine Fracturing  
☐ Water Shut-Off  
☐ Conversion to Injection  
☐ Dispose Water

(Note: Report results of multiple completion on Well Completion or Recompletion Report and Log form.)

13. Describe Proposed or Completed Operations (Clearly state all pertinent details, and give pertinent dates, including estimated date of starting any proposed work. If well is directionally drilled, give subsurface locations and measured and true vertical depths for all markers and zones pertinent to this work.)\*

- 1) 2-15-00 NBLM Steve Caffey
- 2) 2-23-00 Circulate hole w/MLF
- 3) 2-23-00 Spot 25 sx cmt. 4280-4044' as per BLM Steve Caffey
- 4) 2-23-00 Spot 30 sx cmt. @ 3878', WOC & Tag TOC @ 3523'.
- 5) 2-24-00 Pressure up on perfs @ 1940', spot 25 sx cmt. @ 1990', COC & tag TOC @ 1819'.
- 6) 2-24-00 Circulate 80 sx cmt. down 5-1/2" csg. thru perfs @ 285' w/ cmt. circ. to Surface up 5-1/2" X 8-5/8".
- 7) Will Cut off wellhead deadmen. Install dry hole marker, backfill cellar & pit. ASAP

Approved as to plugging of the well bore.  
Liability under bond is retained until  
surface restoration is completed.

RECEIVED  
2000 MAR 13 10:48:42  
BUREAU OF LAND MGMT.  
CARLSBAD RESOURCE AREA

14. I hereby certify that the foregoing is true and correct

Signed [Signature]  
(This space for Federal or State office use)

Title Area Manager

Date 3-02-00

Approved by [Signature]  
Conditions of approval, if any:

Title

PETROLEUM ENGINEER

Date

MAR 22 2000

Title 18 U.S.C. Section 1001, makes it a crime for any person knowingly and willfully to make to any department or agency of the United States any false, fictitious or fraudulent statements or representations as to any matter within its jurisdiction.

\*See Instruction on Reverse Side

OPERATOR	Pennzoil United Inc		DATE	PLA 1986
LEASE	Mescalero Ridge	WELL No	2	LOCATION
		Unit I S. 35 T. 19 R. 34		

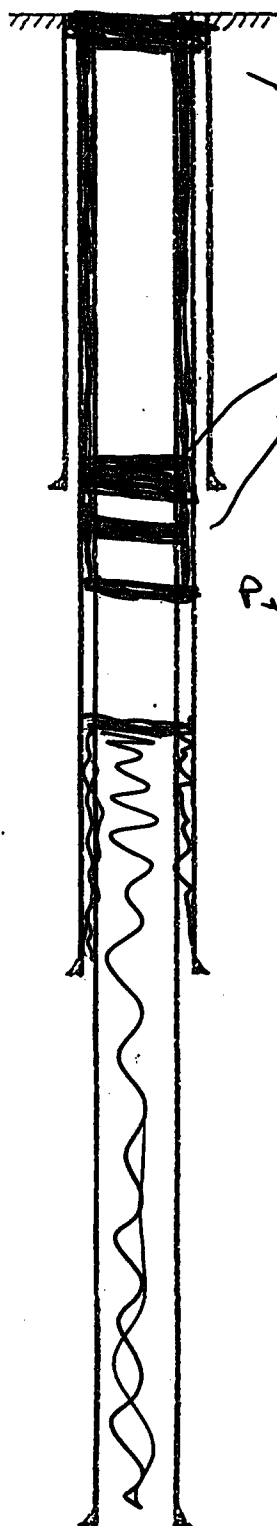

Brakehead Sq w/ 1200sx  
 10 sx plug at surface.

40 sx plug 860 to 760

40 sx plug 1930-1730

13 3/8 " casing set at 855 ' with 800 sx of C cement

Hole size 17 1/2 " are

Perf at 1982 sq. circulating and

Sq. well from 2670  
 w/ 1300sx cement.

9 5/8 " casing set at 5168 ' with 325 sx of C cement

Hole size 12 1/4 "

7 5/8 " casing set at 10293 ' with 600 sx of C cement

Total depth 13980 ' Hole size 8 3/4 "

UNITED STATES  
DEPARTMENT OF THE INTERIOR  
BUREAU OF LAND MANAGEMENT P. O. BOX 1004-0135

SUBMIT IN TRIPLI  
(Other instructions  
here)

Budget Bureau No. 1004-0135  
Expires August 31, 1985

SUNDRY NOTICES AND REPORTS ON WELLS

(Do not use this form for proposals to drill or to deepen or plug back to a different reservoir.  
Use "APPLICATION FOR PERMIT-" for such proposals.)

1. OIL WELL <input checked="" type="checkbox"/> GAS WELL <input type="checkbox"/> OTHER <input type="checkbox"/>	7. UNIT AGREEMENT NAME
2. NAME OF OPERATOR PENNZOIL COMPANY	8. FARM OR LEASE NAME Mescalero Ridge Unit
3. ADDRESS OF OPERATOR P. O. Drawer 1828, Midland, TX 79702-1828	9. WELL NO. 2
4. LOCATION OF WELL (Report location clearly and in accordance with any State requirements.* See also space 17 below.) At surface 2310' FSL & 1800' FEL of Section 35, T-19-S, R-34-E	10. FIELD AND POOL, OR WILDCAT Lea Bone Spring
14. PERMIT NO.	15. ELEVATIONS (Show whether DF, RT, CR, etc.) 3704' GL
	11. SEC., T., R., S., OR BLK. AND SUBVY OR AREA Sec. 35, T19S, R34E
	12. COUNTY OR PARISH Lea
	13. STATE NM

16. Check Appropriate Box To Indicate Nature of Notice, Report, or Other Data

NOTICE OF INTENTION TO:

TEST WATER SHUT-OFF  
FRACTURE TREAT  
SHOOT OR ACIDIZE  
REPAIR WELL  
(Other)

☐  
☐  
☐  
☐  
☐

PULL OR ALTER CASING  
MULTIPLE COMPLETION  
ABANDON\*  
CHANGE PLANS

☐  
☐  
☐  
☐  
☐

SUBSEQUENT REPORT OF:

WATER SHUT-OFF  
FRACTURE TREATMENT  
SHOOTING OR ACIDIZING  
(Other)

☐  
☐  
☐  
☐

REPAIRING WELL  
ALTERING CASING  
ABANDONMENT\*

☐  
☐  
☒  
☐

(NOTE: Report results of multiple completion on Well Completion or Recompletion Report and Log form.)

17. DESCRIBE PROPOSED OR COMPLETED OPERATIONS (Clearly state all pertinent details, and give pertinent dates, including estimated date of starting any proposed work. If well is directionally drilled, give subsurface locations and measured and true vertical depths for all markers and zones pertinent to this work.)\*

6-18-86 MIRU Plugging Unit. Cut 2-3/8" tubing at 2670'. Dowell pumped 100 sx 10-0 RFC (thicotropic) followed by 1200 sx Class "C" w/2% cc via 2-3/8" tubing on vacuum throughout job.

6-19-86 Tagged cement at 1982' w/2-3/8" tubing. Perforated 7-5/8" casing at 1980 w/5 holes. Set 7-5/8" cement retainer at 1940'. RIH w/2-3/8" tubing to same depth and circulated 275 sx Class "A" cement to surface.

6-20-86 RIH w/2-3/8" tubing to 1930' and spotted 50 sx Class "A" cement from 1930-1730'. POH to 860' and loaded hole w/10# gel. Spotted 40 sx Class "A" cement from 860-760'. POH and spotted 10 sx Class "A" cement from 50' to surface. Installed dry hole marker. WELL IS P&A.

18. I hereby certify that the foregoing is true and correct

SIGNED

*Edward P. Padry*

TITLE Adv. Engr. Tech.

DATE 6-24-86

(This space for Federal or State office use)

APPROVED BY

TITLE

DATE

9-4-86

CONDITIONS OF APPROVAL, IF ANY:

\*See Instructions on Reverse Side

UNITED STATES  
DEPARTMENT OF THE INTERIOR  
GEOLOGICAL SURVEYSUBMIT IN TRIPlicate  
(Other instructions on  
reverse side)Form approved.  
Budget Bureau No. 42-R1424.

5. LEASE DESIGNATION AND SERIAL NO.

NM 052

6. IF INDIAN, ALLOTTEE OR TRIBE NAME

7. UNIT AGREEMENT NAME

8. FARM OR LEASE NAME

Mescalero Ridge Unit

9. WELL NO.

2

10. FIELD AND POOL, OR WILDCAT

Lea Bone Spring

11. SEC., T., R., M., OR BLK. AND  
SURVEY OR AREA

Sec. 35, T-19-S, R-34-E

12. COUNTY OR PARISH 13. STATE

Lea

N. M.

## SUNDRY NOTICES AND REPORTS ON WELLS

(Do not use this form for proposals to drill or to deepen or plug back to a different reservoir.  
Use "APPLICATION FOR PERMIT" for such proposals.)1. OIL WELL ☒ GAS WELL ☐ OTHER ☐

2. NAME OF OPERATOR

Pennzoil Company

3. ADDRESS OF OPERATOR

P. O. Drawer 1828 - Midland, Texas 79701

4. LOCATION OF WELL (Report location clearly and in accordance with any State requirements.\*  
See also space 17 below.)  
At surface

2310' FSL &amp; 1800' FEL of Sec. 35, T-19-S, R-34-E

14. PERMIT NO.

15. ELEVATIONS (Show whether DF, RT, GR, etc.)

3707.4 G.L.

16. Check Appropriate Box To Indicate Nature of Notice, Report, or Other Data

## NOTICE OF INTENTION TO:

TEST WATER SHUT-OFF ☐FRACTURE TREAT ☐SHOOT OR ACIDIZE ☐REPAIR WELL ☐(Other) ☐PULL OR ALTER CASING ☐MULTIPLE COMPLETE ☐ABANDON\* ☐CHANGE PLANS ☐

## SUBSEQUENT REPORT OF:

WATER SHUT-OFF ☐FRACTURE TREATMENT ☐SHOOTING OR ACIDIZING ☐(Other) ☐REPAIRING WELL ☒ALTERING CASING ☐ABANDONMENT\* ☐(NOTE: Report results of multiple completion on Well  
Completion or Recompletion Report and Log form.)17. DESCRIBE PROPOSED OR COMPLETED OPERATIONS (Clearly state all pertinent details, and give pertinent dates, including estimated date of starting any  
proposed work. If well is directionally drilled, give subsurface locations and measured and true vertical depths for all markers and zones perti-  
nent to this work.)\*

2-11-77 Water &amp; oil started coming up in cellar between surface and intermediate casing.

2-12-77 Dug out cellar, laid line to pit to relieve pressure.

2-13-77 Performed Braden Head cement squeeze between surface &amp; intermediate casing with 400 sx of Lite cement with 5# of gilsonite &amp; 1/4# Flo-Seal per sack plus 800 sx of Class "C" cement. Squeezed to 500 psi. Shut-in 40 minutes. Pumped 1/8 bbl., pressure went to 650 psi.

Will resume pumping well on 2-16-77.

Water appears to be coming from Hanson Oil Company's Mescalero Ridge Unit No 17 S.W.D. located approximately 600' north of subject well.

18. I hereby certify that the foregoing is true and correct

SIGNED

TITLE Adv. Petroleum Engineer

DATE 2-14-77

(This space for Federal or State office use)

APPROVED BY

TITLE

CONDITIONS OF APPROVAL, IF ANY:

ACCEPTED FOR RECORD

FEB 22 1977

S. GEOLOGICAL SURVEY  
BOBBS, NEW MEXICO

\*See Instructions on Reverse Side



<u>POOL</u>	<u>LOCATION</u>	<u>CHLORIDES</u>
Dean Permo Pennsylvanian	↓ 5-16-37	44,730
Dean Devonian	↓ 35-15-36	19,525
Denton Wolfcamp	↓ 2-15-37	37,275
Denton Devonian	↓ 26-14-37	37,062
South Denton Wolfcamp	↓ 26-15-37	54,815
South Denton Devonian	↓ 36-15-37	34,080
Medicine Rock Devonian	↓ 15-15-38	39,760
Little Lucky Lake Devonian	↓ 29-15-30	23,288
Wantz Abo	↓ 26-21-37	132,770
Crosby Devonian	↓ 18-25-37	58,220
Scarborough Yates Seven Rivers	↓ 7-26-37	3,443 (Reef)
Teague Simpson	↓ 34-23-37	114,665
Teague Ellenburger	↓ 34-23-37	120,345
Rhodes Yates Seven Rivers	↓ 27-26-37	144,485
House San Andres	↓ 11-20-38	93,365
House Drinkard	↓ 12-20-38	49,700
South Leonard Queen	↓ 24-26-37	115,375
Elliott Abo	↓ 8-21-38	55,380
Scharb Bone Springs	↓ 5-19-35	30,601
EK Queen	↓ 13-18-34	41,890
East EK Queen	↓ 22-18-34	179,630
Maljamar Grayburg San Andres	↓ 22-17-32	46,079
Maljamar Paddock	↓ 27-17-32	115,375
Maljamar Devonian	↓ 22-17-32	25,418
Salt Lake Yates	↓ 7-20-33	6,781 (Reef)
Teas Yates Seven Rivers	↓ 11-20-33	22,152 (Reef?)

**New Mexico Office of the State Engineer  
Well Reports and Downloads**

Township:  Range:  Sections:

NAD27 X:  Y:  Zone:  Search Radius:

County:  Basin:  Number:  Suffix:

Owner Name: (First)  (Last)  ☐ Non-Domestic ☐ Domestic ☒ All

Well / Surface Data Report

Avg Depth to Water Report

Water Column Report

Clear Form

WATERS Menu

Help

WELL / SURFACE DATA REPORT 08/24/2004

DB File Nbr	(acre ft per annum) Use	Diversion	Owner	Well Number	(quarters : (quarters : Source
-------------	----------------------------	-----------	-------	-------------	--------------------------------------

No Records found, try again

**LOU RAY OIL CO.  
P.O. BOX 2081  
LOVINGTON, NM 88260**

September 3, 2004

RE: Sara Sue #1  
Unit E, Sect. 36, Tws. 19 S., Rng. 34 E.

Dear Sirs:

In accordance with the Rules and Regulations of the Oil Conservation Division of the State of New Mexico, you are being provided a copy of the C-108 Application for Authorization to Inject into the above captioned well.

Any questions about the permit can be directed to Eddie W. Seay, (505)392-2236. Any objections or request for hearing must be filed with the Oil Conservation division within fifteen (15) days from the date received. The OCD address is P.O. Box 6429, 1220 S. Saint Francis Drive, Santa Fe, NM 87504, (505)476-3440.

Thank you,

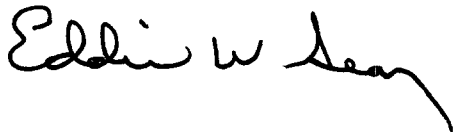
A handwritten signature in black ink that reads "Eddie W. Seay". The signature is written in a cursive, flowing style.

Eddie W. Seay, Agent  
601 W. Illinois  
Hobbs, NM 88242  
(505)392-2236

## **Lease Owners and Offsets**

State Land Office  
310 Old Santa Fe Trail  
Box 1148  
Santa Fe, NM 87504

Bureau of Land Management  
620 E. Green St.  
Carlsbad, NM 88220

TOCO, L.L.C.  
Box 888  
Hobbs, NM 88241

Lea County Production, L.L.C.  
7915 Llewelyn  
Hobbs, NM 88242

Tipton & Denton  
Box 755  
Hobbs, NM 88241

Devon Energy Corp.  
20 North Broadway, Suite 1500  
Oklahoma City, OK 73102

7004 0750 0003 4821 8337

U.S. Postal Service™  
**CERTIFIED MAIL™ RECEIPT**  
 (Domestic Mail Only; No Insurance Coverage Provided)

For delivery information visit our website at [www.usps.com](http://www.usps.com)

**OFFICIAL USE**

HOBBBS, NM 88241

Postage	1.06
Certified Fee	2.30
Return Receipt Fee (Endorsement Required)	1.75
Restricted Delivery Fee (Endorsement Required)	
<b>Total Postage &amp; Fees</b>	<b>\$ 5.11</b>

UNIT ID: 0640

Postmark  
Here

Clerk: KHGCBP

09/03/04

Sent To

Tipton & Denton

Street, Apt. No.,  
or PO Box No. Box 755

City, State, ZIP+4 Hobbs, NM 88241

PS Form 3800, June 2002

See Reverse for Instructions

7004 0750 0003 4821 8313

U.S. Postal Service™  
**CERTIFIED MAIL™ RECEIPT**  
 (Domestic Mail Only; No Insurance Coverage Provided)

For delivery information visit our website at [www.usps.com](http://www.usps.com)

**OFFICIAL USE**

HOBBBS, NM 88241

Postage	1.06
Certified Fee	2.30
Return Receipt Fee (Endorsement Required)	1.75
Restricted Delivery Fee (Endorsement Required)	
<b>Total Postage &amp; Fees</b>	<b>\$ 5.11</b>

UNIT ID: 0640

Postmark  
Here

Clerk: KHGCBP

09/03/04

Sent To

Lea County Production, L.L.C.

Street, Apt. No.,  
or PO Box No. Box 5 Llewelyn

City, State, ZIP+4 Hobbs, NM 88242

PS Form 3800, June 2002

See Reverse for Instructions

7004 0750 0003 4821 8344

U.S. Postal Service™  
**CERTIFIED MAIL™ RECEIPT**  
 (Domestic Mail Only; No Insurance Coverage Provided)

For delivery information visit our website at [www.usps.com](http://www.usps.com)

**OFFICIAL USE**

HOBBBS, NM 88241

Postage	\$ 1.06
Certified Fee	2.30
Return Receipt Fee (Endorsement Required)	1.75
Restricted Delivery Fee (Endorsement Required)	
<b>Total Postage &amp; Fees</b>	<b>\$ 5.11</b>

UNIT ID: 0640

Postmark  
Here

Clerk: KHGCBP

09/03/04

Sent To

FOCO, L.L.C.

Street, Apt. No.,  
or PO Box No. Box 888

City, State, ZIP+4 Hobbs, NM 88241

PS Form 3800, June 2002

See Reverse for Instructions

7004 0750 0003 4821 8368

U.S. Postal Service™  
**CERTIFIED MAIL™ RECEIPT**  
 (Domestic Mail Only; No Insurance Coverage Provided)

For delivery information visit our website at [www.usps.com](http://www.usps.com)

**OFFICIAL USE**

OKLAHOMA CITY, OK 73102

Postage	\$ 1.06
Certified Fee	2.30
Return Receipt Fee (Endorsement Required)	1.75
Restricted Delivery Fee (Endorsement Required)	
<b>Total Postage &amp; Fees</b>	<b>\$ 5.11</b>

UNIT ID: 0640

Postmark  
Here

Clerk: KNEYPS

09/07/04

Sent To

Devon Energy Corp.

Street, Apt. No.,  
or PO Box No. 200 North Broadway, Ste. 1500

City, State, ZIP+4 Oklahoma City, OK 73102

PS Form 3800, June 2002

See Reverse for Instructions

7004 0750 0003 4821 8320

U.S. Postal Service™  
**CERTIFIED MAIL™ RECEIPT**  
 (Domestic Mail Only; No Insurance Coverage Provided)

For delivery information visit our website at [www.usps.com](http://www.usps.com)

**OFFICIAL USE**

CARL SWANSON, NM 88220

Postage	1.06
Certified Fee	2.30
Return Receipt Fee (Endorsement Required)	1.75
Restricted Delivery Fee (Endorsement Required)	
<b>Total Postage &amp; Fees</b>	<b>\$ 5.11</b>

UNIT ID: 0640

Postmark  
Here

Clerk: KHGCBP

09/03/04

Sent To

Bureau of Land Management

Street, Apt. No.,  
or PO Box No. 20 E. Green St.

City, State, ZIP+4 Hobbs, NM 88220

PS Form 3800, June 2002

See Reverse for Instructions

7004 0750 0003 4821 8351

U.S. Postal Service™  
**CERTIFIED MAIL™ RECEIPT**  
 (Domestic Mail Only; No Insurance Coverage Provided)

For delivery information visit our website at [www.usps.com](http://www.usps.com)

**OFFICIAL USE**

SANTA FE, NM 87504

Postage	\$ 1.06
Certified Fee	2.30
Return Receipt Fee (Endorsement Required)	1.75
Restricted Delivery Fee (Endorsement Required)	
<b>Total Postage &amp; Fees</b>	<b>\$ 5.11</b>

UNIT ID: 0640

Postmark  
Here

Clerk: KHGCBP

09/03/04

Sent To

State Land Office

Street, Apt. No.,  
or PO Box No. 310 Old Santa Fe Trail

City, State, ZIP+4 Santa Fe, NM 87504

PS Form 3800, June 2002

See Reverse for Instructions

## **LEGAL NOTICE**

Pursuant to the rules and regulations of the Oil Conservation Division of the State of New Mexico, Lou Ray Oil Co., Box 2081, Lovington, NM 88260, is filing a C-108, Application for a Commercial Salt Water Disposal. The well being applied for is the Sara Sue #1, located in Unit E, Section 36, Tws. 19 S., Rng. 34 E., Lea Co., NM. The injection formation is Seven Rivers located from 3900' to 4110' below surface. Expected maximum injection rate is 1000 bpd. and the expected maximum injection pressure is 500 lbs. Any questions about the application can be directed to Eddie W. Seay, (505)392-2236, or any objections or request for hearing must be directed to the Oil Conservation Division, (505)476-3440, Box 6429, 1220 South Saint Francis Drive, Santa Fe, NM 87504, within fifteen (15) days.

# Affidavit of Publication

STATE OF NEW MEXICO )

) ss.

COUNTY OF LEA )

Joyce Clemens being first duly sworn on oath deposes and says that she is Advertising Director of **THE LOVINGTON DAILY LEADER**, a daily newspaper of general paid circulation published in the English language at Lovington, Lea County, New Mexico; that said newspaper has been so published in such county continuously and uninterruptedly for a period in excess of Twenty-six (26) consecutive weeks next prior to the first publication of the notice hereto attached as hereinafter shown; and that said newspaper is in all things duly qualified to publish legal notices within the meaning of Chapter 167 of the 1937 Session Laws of the State of New Mexico.

That the notice which is hereto attached, entitled

Legal Notice

was published in a regular and entire issue of **THE LOVINGTON DAILY LEADER** and not in any supplement thereof, for one (1) day, beginning with the issue of September 3, 2004 and ending with the issue of September 3, 2004.

And that the cost of publishing said notice is the sum of

\$ 17.74

which sum has been (Paid) as

Court Costs.

Joyce Clemens

Subscribed and sworn to before me this 13th day of  
September 2004.

Debbie Schilling  
Debbie Schilling

Notary Public, Lea County, New Mexico

My Commission Expires June 22, 2006

## LEGAL NOTICE

Pursuant to the rules and regulations of the Oil Conservation Division of the State of New Mexico, Lou Ray Oil Co., Box 2081, Lovington, NM 88260, is filing a C-108, Application for a Commercial Salt Water Disposal. The well being applied for is the Sara Sue #1, located in Unit E, Section 36, Tws. 19S., Rng. 34 E., Lea Co., NM. The injection formation is Seven Rivers located from 3900' to 4110' below surface. Expected maximum injection rate is 1000 bpd. and the expected maximum injection pressure is 500 lbs. Any questions about the application can be directed to Eddie W. Seay, (505)392-2236, or any objections or request for hearing must be directed to the Oil Conservation Division, (505)476-3440, Box 6429, 1220 South Saint Francis Drive, Santa Fe, NM 87504, within fifteen 15 days.

Published in the  
Lovington Daily Leader  
September 3, 2004.

RECEIVED

OCT 26 2004

OIL CONSERVATION  
DIVISION

Will Jones

Here are the certified notice you  
asked for, the Sara Sue SWD.  
If you need anything else  
please call.

Thanks

Eddie Lee  
392-2236



**Jones, William V**

---

**From:** Jones, William V  
**Sent:** Tuesday, October 12, 2004 3:35 PM  
**To:** 'seay04@leaco.net'  
**Cc:** Ezeanyim, Richard  
**Subject:** RE: Sara Sue #1 SWD Application

Eddie:

I am working on the AOR data and had another request.

Would you please add the API numbers to the wells in your writeup, tables, and the P&A diagrams and fax or mail this data back to me? The API numbers will speed up my check on the cement tops.

Thanks,  
Will

-----Original Message-----

**From:** Jones, William V  
**Sent:** Tuesday, October 12, 2004 2:50 PM  
**To:** 'seay04@leaco.net'  
**Subject:** Sara Sue #1 SWD Application

Hello Eddie:

I am processing this application and have a question:

According to the state database, the State Land Office is the surface owner and the following companys are "leasehold operators" within the 1/2 mile Area of Review that operate wells that have not yet been plugged:

Merit Energy Company  
Tipton & Denton  
C W Trainer  
Rodney B Webb DBA Webb Oil Company  
BEC Corporation

Looks like the following entities were notified:

State Land Office  
BLM  
TOCO, LLC  
Lea County Production, LLC  
Tipton & Denton  
Devon Energy Corp.

Let me know if there is a reason why the top group has not been notified - otherwise, send them each a copy of the application and let me know when you mailed it.

Regards,

10/12/2004

30-025-02405	SARAH SUE #001	BEC CORP	1980N	660W	E	36	19S	34E	30-025-02405	1958	5050S	O	1959-12-07	
AP	WELL NAME	OPERATOR	FTONS	NSQD	FTGFW	LEW CD	SC	TO	SEC	DIR	TYD DEPTH	LAND TYPE	WELL TYPE	STUD DATE
30-025-21683	SWD MISCALERO RIDGE UNIT #015	MERIT ENERGY CO	660N	660N	660E	660E	A	35	19S	34E	1,867	5135F	I	1965-03-04
30-025-20302	SWD MISCALERO RIDGE UNIT #351	MERIT ENERGY CO	1980S	1980S	560E	560E	I	35	19S	34E	1,797	5152F	I	1963-11-17
30-025-20692	SWD MISCALERO RIDGE UNIT #354	MERIT ENERGY CO	1980N	1980N	1980E	1980E	G	35	19S	34E	2,640	5260F	I	
30-025-20691	MISCALERO RIDGE UNIT #353	MERIT ENERGY CO	1980N	1980N	660E	660E	H	35	19S	34E	1,320	5435F	O	1964-02-01
30-025-33660	MISCALERO RIDGE UNIT #023	MERIT ENERGY CO	1300N	1300N	1300E	1300E	A	35	19S	34E	2,075	5215F	O	1996-12-20
30-025-33661	MISCALERO RIDGE UNIT #024	MERIT ENERGY CO	2620N	2620N	1300E	1300E	H	35	19S	34E	2,062	5200F	O	1997-01-04
30-025-23550	DELAWARE STATE #001	TIPTON & DENTON	990S	990S	330W	330W	M	36	19S	34E	2,333	10225S	O	1972-05-24
30-025-23611	LEA DS STATE #001	C W TRAINER	2086N	2086N	554W	554W	E	36	19S	34E	1,50	9744S	O	1987-11-24
30-025-21281	MINERALS STATE #001	RODNEY B WEBB DBA WEBB OIL CO	990S	990S	1650W	1650W	N	36	19S	34E	2,513	5327S	O	1900-01-01
30-025-23808	PRE-ONGARD WELL #002	PRE-ONGARD WELL OPERATOR	770N	770N	560W	560W	D	36	19S	34E	1,214	9770S	O	1900-01-01
30-025-23629	MISCALERO RIDGE UNIT #004	PENNZENERGY EXPLORATION AND	2086N	2086N	554E	554E	H	35	19S	34E	1,219	10258F	O	1900-01-01
30-025-02406	LEA K STATE #001	XERIC OIL & GAS CORP	1980S	1980S	660W	660W	L	36	19S	34E	1,320	4980S	O	1991-10-31
30-025-32935	PEARL STATE #001	TRILOGY OPERATING INC	1980N	1980N	1980W	1980W	F	36	19S	34E	1,320	5300S	O	1995-05-06
30-025-02403	PRE-ONGARD WELL #002	PRE-ONGARD WELL OPERATOR	660N	660N	1980W	1980W	C	36	19S	34E	1,867	5051S	O	1900-01-01
30-025-02404	HADSON STATE #001	MACK ENERGY CORP	1980S	1980S	1980W	1980W	K	36	19S	34E	1,867	5060S	O	1996-02-22
30-025-21859	MISCALERO RIDGE UNIT #017	BP AMERICA PRODUCTION COMPANY	1980N	1980N	1650E	1650E	G	35	19S	34E	2,210	4040F	S	1986-01-10
30-025-23690	STATE 36 #002	MACK ENERGY CORP	2130S	2130S	660W	660W	L	36	19S	34E	1,170	10250S	G	2002-10-29
30-025-21756	SARAH SUE #003	BEC CORP	660N	660N	660W	660W	D	36	19S	34E	1,320	5138S	O	1966-08-08
30-025-21264	MISCALERO RIDGE UNIT #359	MERIT ENERGY CO	2310S	2310S	990E	990E	I	35	19S	34E	1,924	4023F	G	1965-02-16

30-025-02405	SARAH SUE #001	WELL NAME	QUEEN/ INTENT TO P&A APPVD 5-2-02	ZONE ABAN	ACRES	NBR COMPLE	1	Formation	2004 PRODUCING POOL
30-025-21683	SWD MESCALERO RIDGE UNIT #015		QUEEN / CONVERTED TO WIW	ACTIVE				QUEEN	PEARL QUEEN
30-025-20302	SWD MESCALERO RIDGE UNIT #351		QUEEN / CONVERTED TO WIW	ACTIVE				QUEEN	PEARL QUEEN
30-025-20692	SWD MESCALERO RIDGE UNIT #354			ACTIVE				QUEEN	PEARL QUEEN
30-025-33660	MESCALERO RIDGE UNIT #353		QUEEN	ACTIVE	40.00			QUEEN	PEARL QUEEN
30-025-33661	MESCALERO RIDGE UNIT #023		QUEEN	ACTIVE	40.00			QUEEN	PEARL QUEEN
30-025-23550	MESCALERO RIDGE UNIT #024		QUEEN	ACTIVE	40.00			QUEEN	PEARL QUEEN
30-025-23550	DELAWARE STATE #001		DELAWARE	ACTIVE	40.00			1 Delaware	LEA, DELAWARE, NORTHEAST
30-025-23611	LEA DS STATE #001		BONE SPRING	ACTIVE	40.00			1 SAN ANDRES	LEA, SAN ANDRES
30-025-21281	MINERALS STATE #001			ACTIVE	40.00			1 QUEEN	PEARL QUEEN
30-025-23808	PRE-ONGARD WELL #002		GULF OIL CORP / LEA DS STATE	Abandoned					
30-025-23629	MESCALERO RIDGE UNIT #004		PENNZOIL EXPL & PROMESCALERO RIDGE	Abandoned					
30-025-02406	LEA K STATE #001		PLUGGED & ABANDONED 10-31-1991	Abandoned					
30-025-32935	PEARL STATE #001		PLUGGED & ABANDONED	Abandoned					
30-025-02403	PRE-ONGARD WELL #002		CABEN EXPLORATION / GULF C STATE	Abandoned					
30-025-02404	HADSON STATE #001		PLUGGED & ABANDONED	Abandoned					
30-025-21859	MESCALERO RIDGE UNIT #017		P&A 01-10-1986	Abandoned					
30-025-23690	STATE 36 #002		P&A 10-29-02	Abandoned					
30-025-21756	SARAH SUE #003		QUEEN	Temp Aban	40.00		1		
30-025-21264	MESCALERO RIDGE UNIT #359		SEVEN RIVERS	Temp Aban	40.00		1		

CMD :  
OG6CLOG

ONGARD  
C105-WELL COMPLETION OR RECOMP CASING LOG

10/12/04 10:12:49  
OGOWVJ -TP9X

OGRID Identifier : 14591 MERIT ENERGY CO  
Prop Identifier : 30379 MESCALERO RIDGE UNIT  
API Well Identifier : 30 25 21798 Well No : 262  
Surface Locn - UL : P Sec : 26 Twp : 19S Range : 34E Lot Idn :  
Multiple comp (S/M/C): S TVD Depth (Feet) : 5150 MVD Depth (Feet):  
Spud Date : P/A Date :  
Casing/Linear Record:

S Size (inches)	Grade Weight (lb/ft)	Depth(ft) Top-Liner	Depth(ft) Bot-Liner	Hole Size (inches)	Cement (Sacks)	TOC (feet)	Code
99.000	99.0	99999.0	99999.0	99.000	9999	99999	C

E0043: Record found; Authority denied to MODIFY/ADD

PF01 HELP	PF02	PF03 EXIT	PF04 GoTo	PF05	PF06 CONFIRM
PF07	PF08	PF09 COMMENT	PF10 TLOG	PF11	PF12

CMD :  
OG5SECT

ONGARD  
INQUIRE LAND BY SECTION

10/12/04 10:11:14  
OGOWVJ -TP9X  
PAGE NO: 1

Sec : 35 Twp : 19S Rng : 34E Section Type : NORMAL

<div>D 40.00  Federal owned U A A C</div>	<div>C 40.00  Federal owned U A C</div>	<div>B 40.00  Federal owned U A</div>	<div>A 40.00  Federal owned U A A</div>
<div>E 40.00  Federal owned U A C</div>	<div>F 40.00  Federal owned U A A C</div>	<div>G 40.00  Federal owned U A A A</div>	<div>H 40.00  Federal owned U A A A</div>

PF01 HELP  
PF07 BKWD

PF02  
PF08 FWD

PF03 EXIT  
PF09 PRINT

PF04 GoTo  
PF10 SDIV

PF05  
PF11

PF06  
PF12

CMD :  
OG5SECT

ONGARD  
INQUIRE LAND BY SECTION

10/12/04 10:11:28  
OGOWVJ -TP9X  
PAGE NO: 2

Sec : 35 Twp : 19S Rng : 34E Section Type : NORMAL

L 40.00  Federal owned U A A	K 40.00  Federal owned U A	J 40.00  Federal owned U A A A	I 40.00  Federal owned U A A
M 40.00  Federal owned U C	N 40.00  Federal owned U A	O 40.00  Federal owned U A	P 40.00  Federal owned U A A

PF01 HELP  
PF07 BKWD

PF02  
PF08 FWD

PF03 EXIT  
PF09 PRINT

PF04 GoTo  
PF10 SDIV

PF05  
PF11

PF06  
PF12

CMD :  
OG6CLOG

ONGARD  
C105-WELL COMPLETION OR RECOMP CASING LOG

10/12/04 10:09:46  
OGOWVJ -TP9X

OGRID Identifier : 210510 LOURAY OIL COMPANY, LLC  
Prop Identifier : 300793 SARAH SUE  
API Well Identifier : 30 25 2405 Well No : 001  
Surface Locn - UL : E Sec : 36 Twp : 19S Range : 34E Lot Idn :  
Multiple comp (S/M/C): S TVD Depth (Feet) : 5050 MVD Depth (Feet): 5050  
Spud Date : 12-07-1959 P/A Date :  
Casing/Linear Record:

S Size (inches)	Grade Weight (lb/ft)	Depth(ft) Top-Liner	Depth(ft) Bot-Liner	Hole Size (inches)	Cement (Sacks)	TOC (feet)	Code
8.625	28.0	0.0	114.0	9.000	54		C
5.500	15.5	0.0	5041.0	7.875	300		C

E0043: Record found; Authority denied to MODIFY/ADD

PF01 HELP	PF02	PF03 EXIT	PF04 GoTo	PF05	PF06 CONFIRM
PF07	PF08	PF09 COMMENT	PF10 TLOG	PF11	PF12

CMD :  
OG5SECT

ONGARD  
INQUIRE LAND BY SECTION

10/12/04 10:09:03  
OGOWVJ -TP9X  
PAGE NO: 2

Sec : 36 Twp : 19S Rng : 34E Section Type : NORMAL

L 40.00 CS E06005 0001 WESTERN EQUIPMENT 02/11/62 P A	K 40.00 CS E06005 0003 MAGNUM HUNTER PRO 02/11/62 A	J 40.00 CS E06005 0003 MAGNUM HUNTER PRO 02/11/62 A	<del>I 40.00 CS E06005 0003 MAGNUM HUNTER PRO 02/11/62 A</del>
M 40.00 CS E06005 0003 MAGNUM HUNTER PRO 02/11/62 A A	N 40.00 CS E06005 0003 MAGNUM HUNTER PRO 02/11/62 A	<del>O 40.00 CS E06005 0003 MAGNUM HUNTER PRO 02/11/62 A C</del>	<del>P 40.00 CS E06005 0003 MAGNUM HUNTER PRO 02/11/62 A</del>

PF01 HELP  
PF07 BKWD

PF02  
PF08 FWD

PF03 EXIT  
PF09 PRINT

PF04 GoTo  
PF10 SDIV

PF05  
PF11

PF06  
PF12



CMD :  
OG5SECT

ONGARD  
INQUIRE LAND BY SECTION

10/12/04 10:09:28  
OGOWVJ -TP9X  
PAGE NO: 1

Sec : 36 Twp : 19S Rng : 34E Section Type : NORMAL

D 40.00 CS E03143 0002 C W TRAINER 12/10/59 A A	C 40.00 CS E03143 0002 C W TRAINER 12/10/59 A	B 40.00 CS E03143 0002 C W TRAINER 12/10/59	<del>A 40.00 CS E03143 0002 C W TRAINER 12/10/59</del>
E 40.00 CS E03143 0002 C W TRAINER 12/10/59 P P	F 40.00 CS E03143 0002 C W TRAINER 12/10/59 P	G 40.00 CS E03143 0002 C W TRAINER 12/10/59 A	<del>H 40.00 CS E03143 0002 C W TRAINER 12/10/59</del>

M0002: This is the first page

PF01 HELP	PF02	PF03 EXIT	PF04 GoTo	PF05	PF06
PF07 BKWD	PF08 FWD	PF09 PRINT	PF10 SDIV	PF11	PF12

CMD :  
OG5SECT

ONGARD  
INQUIRE LAND BY SECTION

10/12/04 10:11:59  
OGOWVJ -TP9X  
PAGE NO: 2

Sec : 25 Twp : 19S Rng : 34E Section Type : NORMAL

L 40.00  Federal owned A	K 40.00  Federal owned A	J 40.00  Federal owned C	I 40.00  Federal owned A C
M 40.00  Federal owned A	N 40.00  Federal owned A A A	O 40.00  Federal owned	P 40.00  Federal owned A A

PF01 HELP  
PF07 BKWD

PF02  
PF08 FWD

PF03 EXIT  
PF09 PRINT

PF04 GoTo  
PF10 SDIV

PF05  
PF11

PF06  
PF12

CMD :  
OG6CLOG

ONGARD  
C105-WELL COMPLETION OR RECOMP CASING LOG

10/12/04 10:12:11  
OGOWVJ -TP9X

OGRID Identifier : 1092 ARMSTRONG ENERGY CORP  
Prop Identifier : 32927 SUPERIOR FEDERAL  
API Well Identifier : 30 25 21370 Well No : 005  
Surface Locn - UL : M Sec : 25 Twp : 19S Range : 34E Lot Idn :  
Multiple comp (S/M/C): S TVD Depth (Feet) : 5150 MVD Depth (Feet):  
Spud Date : P/A Date :  
Casing/Linear Record:

S Size (inches)	Grade Weight (lb/ft)	Depth(ft) Top-Liner	Depth(ft) Bot-Liner	Hole Size (inches)	Cement (Sacks)	TOC (feet)	Code
99.000	99.0	99999.0	99999.0	99.000	9999	99999	C

E0043: Record found; Authority denied to MODIFY/ADD

PF01 HELP	PF02	PF03 EXIT	PF04 GoTo	PF05	PF06 CONFIRM
PF07	PF08	PF09 COMMENT	PF10 TLOG	PF11	PF12

CMD :  
OG5SECT

ONGARD  
INQUIRE LAND BY SECTION

10/12/04 10:12:38  
OGOWVJ -TP9X  
PAGE NO: 2

Sec : 26 Twp : 19S Rng : 34E Section Type : NORMAL

L 40.00  Federal owned A	K 40.00  Federal owned U A	J 40.00  Federal owned A	I 40.00  Federal owned
M 40.00  Federal owned U A	N 40.00  Federal owned U A A	O 40.00  Federal owned U A C	P 40.00  Federal owned U A

PF01 HELP  
PF07 BKWD

PF02  
PF08 FWD

PF03 EXIT  
PF09 PRINT

PF04 GoTo  
PF10 SDIV

PF05  
PF11

PF06  
PF12