

| | | | | | |
|---------------------|---------------------|-------------------|-----------------------|-------------|---------------------------|
| 12-13-04 DATE IN | 12/2/05 SUSPENSE | JONES ENGINEER | 12-14-04 LOGGED IN | DHC TYPE | BSM 0434929822 APP NO. |
|---------------------|---------------------|-------------------|-----------------------|-------------|---------------------------|

ABOVE THIS LINE FOR DIVISION USE ONLY

NEW MEXICO OIL CONSERVATION DIVISION

- Engineering Bureau -

1220 South St. Francis Drive, Santa Fe, NM 87505



ADMINISTRATIVE APPLICATION CHECKLIST

THIS CHECKLIST IS MANDATORY FOR ALL ADMINISTRATIVE APPLICATIONS FOR EXCEPTIONS TO DIVISION RULES AND REGULATIONS WHICH REQUIRE PROCESSING AT THE DIVISION LEVEL IN SANTA FE

Application Acronyms:

[NSL-Non-Standard Location] [NSP-Non-Standard Proration Unit] [SD-Simultaneous Dedication]
[DHC-Downhole Commingling] [CTB-Lease Commingling] [PLC-Pool/Lease Commingling]
[PC-Pool Commingling] [OLS - Off-Lease Storage] [OLM-Off-Lease Measurement]
[WFX-Waterflood Expansion] [PMX-Pressure Maintenance Expansion]
[SWD-Salt Water Disposal] [IPI-Injection Pressure Increase]
[EOR-Qualified Enhanced Oil Recovery Certification] [PPR-Positive Production Response]

[1] TYPE OF APPLICATION - Check Those Which Apply for [A]

[A] Location - Spacing Unit - Simultaneous Dedication

☐ NSL ☐ NSP ☐ SD

Check One Only for [B] or [C]

[B] Commingling - Storage - Measurement

☒ DHC ☐ CTB ☐ PLC ☐ PC ☐ OLS ☐ OLM

[C] Injection - Disposal - Pressure Increase - Enhanced Oil Recovery

☐ WFX ☐ PMX ☐ SWD ☐ IPI ☐ EOR ☐ PPR

[D] Other: Specify _____

[2] NOTIFICATION REQUIRED TO: - Check Those Which Apply, or ☐ Does Not Apply

[A] ☐ Working, Royalty or Overriding Royalty Interest Owners

[B] ☐ Offset Operators, Leaseholders or Surface Owner

[C] ☐ Application is One Which Requires Published Legal Notice

[D] ☐ Notification and/or Concurrent Approval by BLM or SLO
U.S. Bureau of Land Management - Commissioner of Public Lands, State Land Office

[E] ☐ For all of the above, Proof of Notification or Publication is Attached, and/or,

[F] ☐ Waivers are Attached

[3] SUBMIT ACCURATE AND COMPLETE INFORMATION REQUIRED TO PROCESS THE TYPE OF APPLICATION INDICATED ABOVE.

[4] **CERTIFICATION:** I hereby certify that the information submitted with this application for administrative approval is **accurate and complete** to the best of my knowledge. I also understand that **no action** will be taken on this application until the required information and notifications are submitted to the Division.

Note: Statement must be completed by an individual with managerial and/or supervisory capacity.

Print or Type Name

Signature

Title

Date

e-mail Address

District I
1625 N. French Drive, Hobbs, NM 88240

District II
811 South First Street, Artesia, NM 88210

District III
1000 Rio Brazos Road, Aztec, NM 87410

District IV
1220 S. St. Francis Dr., Santa Fe, NM 87505

State of New Mexico
Energy, Minerals and Natural Resources Department

Oil Conservation Division
1220 South St. Francis Dr.
Santa Fe, New Mexico 87505

Form C-107A
Revised May 15, 2000

APPLICATION TYPE
xx Single Well
Establish Pre-Approved Pools
EXISTING WELLBORE
xxYes No

APPLICATION FOR DOWNHOLE COMMINGLING

Devon Louisiana Corporation
Operator

20 N. Broadway, Suite 1500, Oklahoma City, OK 73102
Address

Burton Flat Deep Unit 4 N-Sec 34-20S-28E Eddy
Lease Well No. Unit Letter-Section-Township-Range County

OGRID No. ~~6367~~ Property Code 23433 API No. 30-015-20835 Lease Type: xxxxFederal State Fee

2004 DEC 1

| DATA ELEMENT | UPPER ZONE | INTERMEDIATE ZONE | LOWER ZONE |
|--|--------------------------------|-------------------|--------------------------------|
| Pool Name | Burton Flat Strawn | | Burton Flat C Morrow |
| Pool Code | 73360 | | 73280 |
| Top and Bottom of Pay Section (Perforated or Open-Hole Interval) | 10216-10244 | | 10856-11114 |
| Method of Production (Flowing or Artificial Lift) | F | | F |
| Bottomhole Pressure (Note: Pressure data will not be required if the bottom perforation in the lower zone is within 150% of the depth of the top perforation in the upper zone) | | | |
| Oil Gravity or Gas BTU (Degree API or Gas BTU) | 1192 | | 1028 |
| Producing, Shut-In or New Zone | P | | P |
| Date and Oil/Gas/Water Rates of Last Production. (Note: For new zones with no production history, applicant shall be required to attach production estimates and supporting data.) | Date: 11/2/04 Rates: 0/42/0 | Date: Rates: | Date: 11/2/04 Rates: 0/11/0 |
| Fixed Allocation Percentage (Note: If allocation is based upon something other than current or past production, supporting data or explanation will be required.) | Oil 0% Gas 82 % | Oil % Gas % | Oil 0% Gas 18 % |

ADDITIONAL DATA

Are all working, royalty and overriding royalty interests identical in all commingled zones? Yes No
If not, have all working, royalty and overriding royalty interest owners been notified by certified mail? Yes No

Are all produced fluids from all commingled zones compatible with each other? Yes No

Will commingling decrease the value of production? Yes No

If this well is on, or communitized with, state or federal lands, has either the Commissioner of Public Lands
or the United States Bureau of Land Management been notified in writing of this application? Yes No

NMOCD Reference Case No. applicable to this well:

Attachments:

- C-102 for each zone to be commingled showing its spacing unit and acreage dedication.
- Production curve for each zone for at least one year. (If not available, attach explanation.)
- For zones with no production history, estimated production rates and supporting data.
- Data to support allocation method or formula.
- Notification list of working, royalty and overriding royalty interests for uncommon interest cases.
- Any additional statements, data or documents required to support commingling.

PRE-APPROVED POOLS

If application is to establish Pre-Approved Pools, the following additional information will be required:

- List of other orders approving downhole commingling within the proposed Pre-Approved Pools
- List of all operators within the proposed Pre-Approved Pools
- Proof that all operators within the proposed Pre-Approved Pools were provided notice of this application.
- Bottomhole pressure data.

I hereby certify that the information above is true and complete to the best of my knowledge and belief.

SIGNATURE TITLE DATE

TYPE OR PRINT NAME TELEPHONE NO. (405) 228-8209

WELL LOCATION AND ACREAGE DEDICATION PLAT

Form C-102
Supersedes 1
Effective 14

All distances must be from the outer boundaries of the Section.

| | | | | | |
|--|--------------------------------------|----------------------------|-------------------------------------|-------------------------------------|---------------------------|
| Operator DEVON LOUISIANA CORPORATION | | | Lease BURTON FLAT UNIT | | Well No. 4 |
| Unit Letter N | Section 34 | Township T-20-S | Range R-28-E | County EDDY | |
| Actual Footage Location of Well: | | | | | |
| 650' | | feet from the South | line end | 1980' | feet from the West |
| Ground Level Elev: 3195' | Producing Formation Morrow | | Pool BURTON FLAT - Morrow | Dedicated Acreages 320 Ac | |

1. Outline the acreage dedicated to the subject well by colored pencil or hachure marks on the plat below.
2. If more than one lease is dedicated to the well, outline each and identify the ownership thereof (both as to work interest and royalty).
3. If more than one lease of different ownership is dedicated to the well, have the interests of all owners been consolidated by ~~communitization~~ unitization, ~~forced pooling~~ unitization forced pooling or otherwise

☒ Yes ☐ No

If answer is "yes," type of consolidation

Burton Flat Deep Unit
14-08-001-12391

If answer is "no," list the owners and tract descriptions which have actually been consolidated. (Use reverse side this form if necessary.)

No allowable will be assigned to the well until all interests have been consolidated (by communitization, unitization, forced-pooling, or otherwise) or until a non-standard unit, eliminating such interests, has been approved by the Commission.

CERTIFICATION

I hereby certify that the information contained herein is true and complete to the best of my knowledge and belief.

Name

Regulatory Specialist

Position

Devon

Company

Nov. 4, 2004

Date

I hereby certify that the well location shown on this plat was plotted from field notes of actual surveys made by me under my supervision, and that the same is true and correct to the best of my knowledge and belief.

Date Surveyed

Richard B. Duniven

Registered Professional Engineer
and/or Land Surveyor

Certificate No. 4882

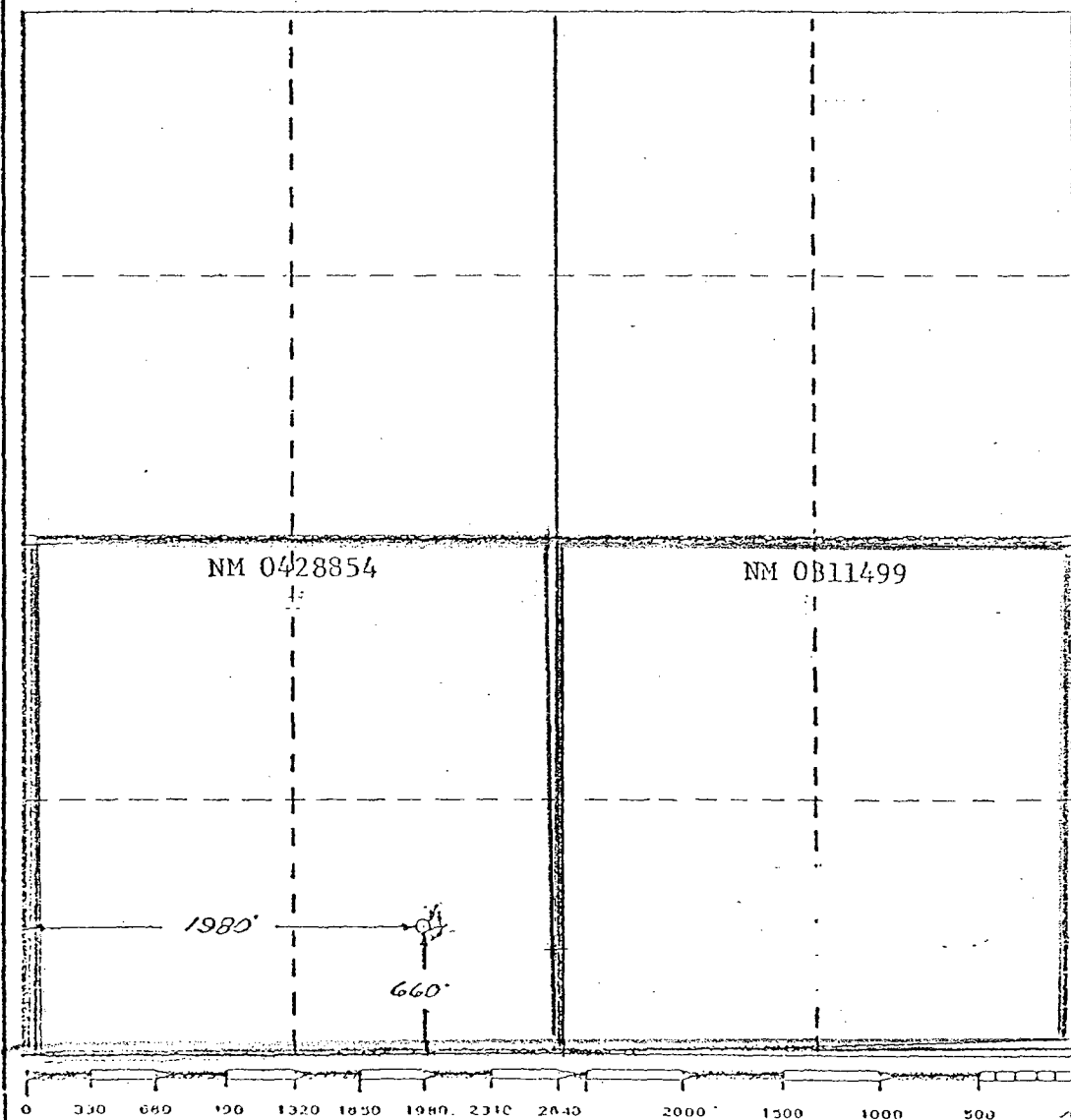

WELL LOCATION AND ACREAGE DEDICATION PLAT

Form C-102
Supersedes C
Effective 14-

All distances must be from the outer boundaries of the Section.

| | | | | | |
|---|--------------------------------------|-------------------------------------|-------------------------------------|-----------------------|----------------------|
| Operator DEVON LOUISIANA CORPORATION | | | Lease BURTON FLAT UNIT | | Well No. 4 |
| Unit Letter N | Section 34 | Township T-20-S | Range R-28-E | County EDDY | |
| Actual Footage Location of Well: 650' feet from the South line and 1980' feet from the West line | | | | | |
| Ground Level Elev: 3195' | Producing Formation STRAWN | Pool BURTON FLAT - STRAWN | Dedicated Acreage: 320 Ac | | |

1. Outline the acreage dedicated to the subject well by colored pencil or hachure marks on the plat below.
2. If more than one lease is dedicated to the well, outline each and identify the ownership thereof (both as to working interest and royalty).
3. If more than one lease of different ownership is dedicated to the well, have the interests of all owners been consolidated by ~~communitization~~ unitization, ~~forced pooling~~ /

Burton Flat Deep Unit
14-08-001-12391☒ Yes ☐ No If answer is "yes," type of consolidation

If answer is "no," list the owners and tract descriptions which have actually been consolidated. (Use reverse side this form if necessary.)

No allowable will be assigned to the well until all interests have been consolidated (by communitization, unitization, forced-pooling, or otherwise) or until a non-standard unit, eliminating such interests, has been approved by the Commission.

CERTIFICATION

I hereby certify that the information contained herein is true and complete to the best of my knowledge and belief.

Name

Regulatory Specialist

Position

Devon

Company

Nov. 4, 2004

Date

I hereby certify that the well location shown on this plat was plotted from field notes of actual surveys made by me under my supervision, and that the same is true and correct to the best of my knowledge and belief.

Date Surveyed

Richard B. Duniven

Registered Professional Engineer and/or Land Surveyor

Certificate No.

4882

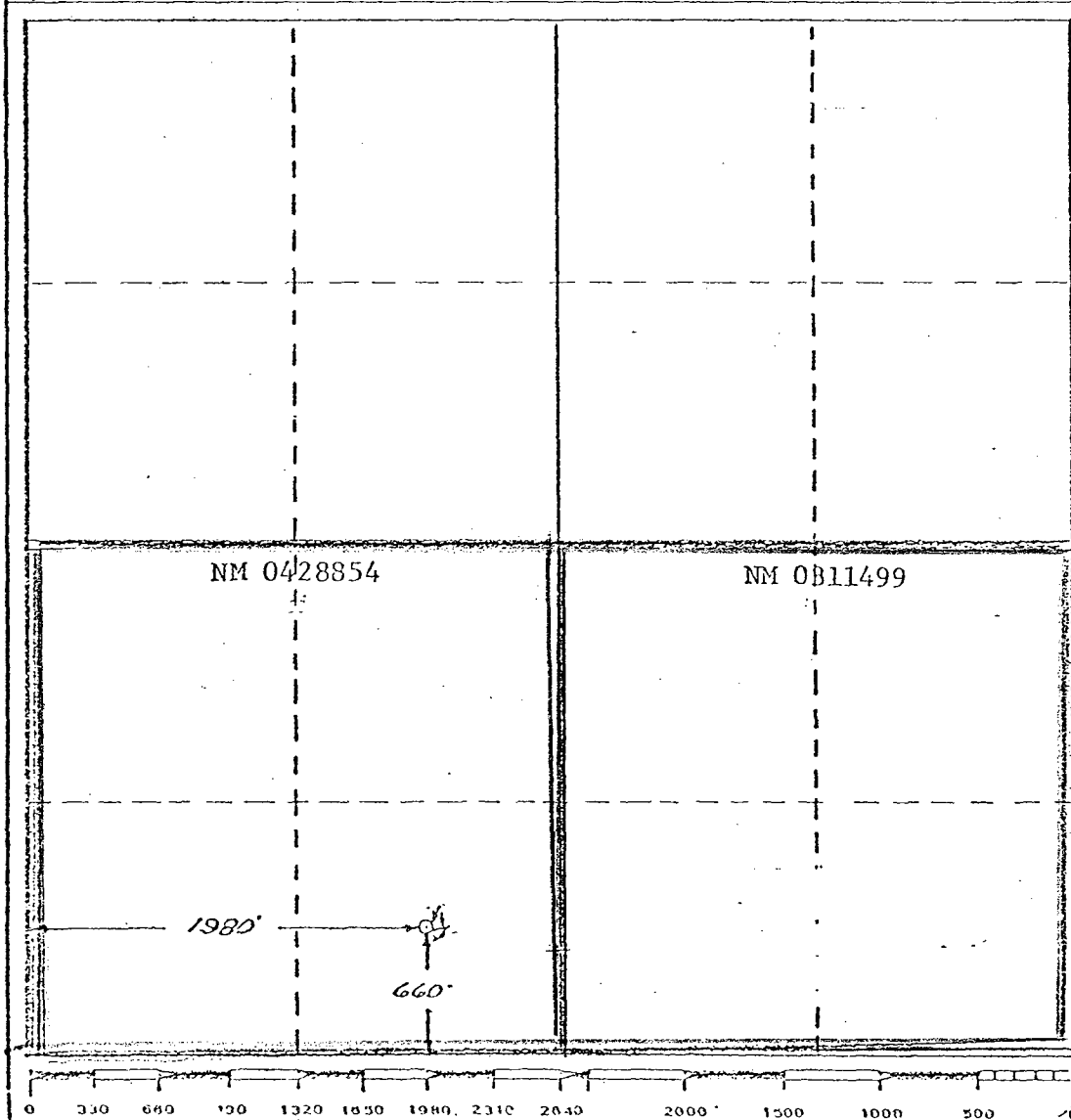

BURTON FLAT DEEP UNIT #4
BURTON FLAT FIELD
EDDY COUNTY, NM

| DATE | STRAWN RESERVOIR | | | MORROW RESERVOIR | | |
|---------|------------------|--------|------|------------------|--------|------|
| | BOPM | MCFFPM | BWPM | BOPM | MCFFPM | BWPM |
| 1/1/03 | 0 | 1349 | 0 | 0 | 248 | 0 |
| 2/1/03 | 0 | 1444 | 0 | 0 | 205 | 0 |
| 3/1/03 | 0 | 701 | 0 | 0 | 224 | 0 |
| 4/1/03 | 0 | 661 | 0 | 0 | 210 | 0 |
| 5/1/03 | 0 | 646 | 0 | 0 | 235 | 0 |
| 6/1/03 | 0 | 618 | 0 | 0 | 243 | 0 |
| 7/1/03 | 0 | 902 | 0 | 0 | 251 | 0 |
| 8/1/03 | 0 | 1261 | 0 | 0 | 254 | 0 |
| 9/1/03 | 0 | 1187 | 0 | 0 | 227 | 0 |
| 10/1/03 | 0 | 1258 | 0 | 0 | 285 | 0 |
| 11/1/03 | 0 | 1206 | 0 | 0 | 258 | 0 |
| 12/1/03 | 0 | 1268 | 0 | 0 | 254 | 0 |
| 1/1/04 | 0 | 1281 | 0 | 0 | 242 | 0 |
| 2/1/04 | 0 | 1193 | 0 | 0 | 222 | 0 |
| 3/1/04 | 0 | 1304 | 0 | 0 | 250 | 0 |
| 4/1/04 | 0 | 1275 | 0 | 0 | 242 | 0 |
| 5/1/04 | 0 | 1333 | 0 | 0 | 265 | 0 |
| 6/1/04 | 0 | 1211 | 0 | 0 | 256 | 0 |
| 7/1/04 | 0 | 1200 | 0 | 0 | 245 | 0 |
| 8/1/04 | 0 | 1181 | 0 | 0 | 250 | 0 |

Reservoir Production Average -- 2003 thru 2004

| | OIL | GAS | WATER |
|------------------|----------|-------------|----------|
| STRAWN RESERVOIR | 0 | 1124 | 0 |
| MORROW RESERVOIR | 0 | 243 | 0 |
| TOTAL | 0 | 1367 | 0 |

Reservoir Contribution Percentage -- 2003 thru 2004

| | OIL | GAS | WATER |
|------------------|-----|-------------|-------|
| STRAWN RESERVOIR | 0 | 82% | 0 |
| MORROW RESERVOIR | 0 | 18% | 0 |
| TOTAL | | 100% | |

BURTON FLAT DEEP UNIT #4
Monthly Gas Production by Reservoir

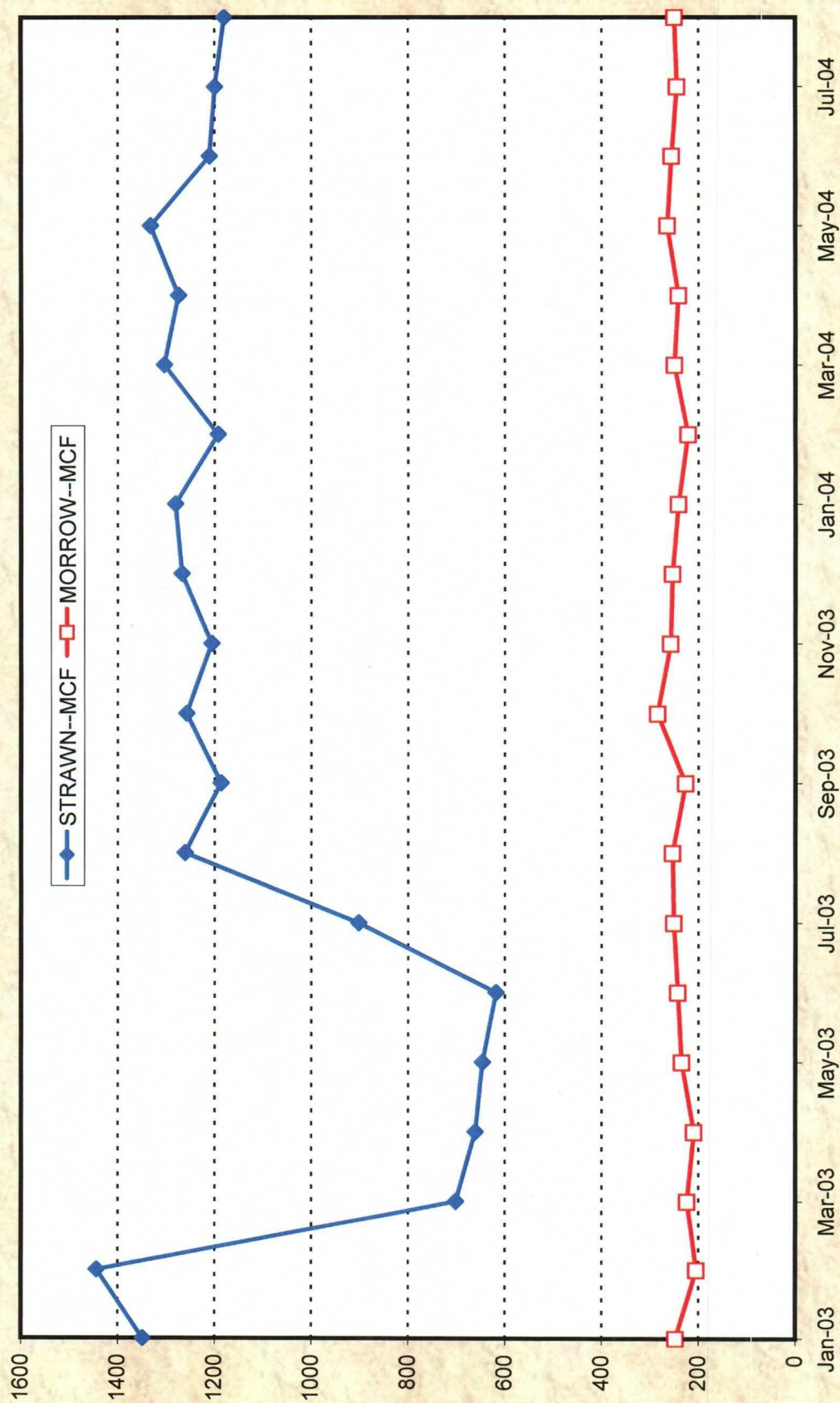

BURTON FLAT DEEP UNIT #4
Monthly Gas Production by Reservoir

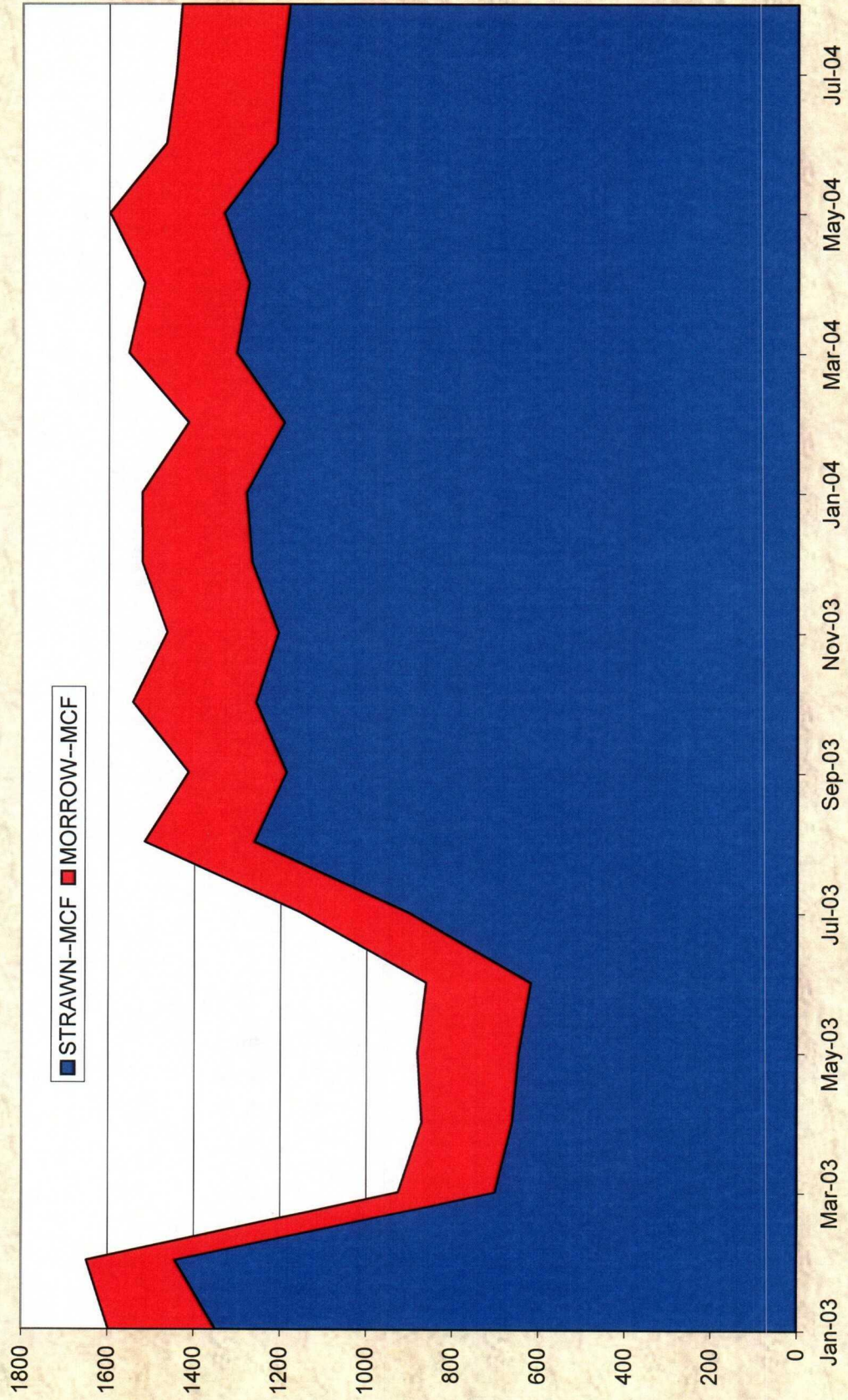

BURTON FLAT DEEP UNIT 4
Reservoir Contribution
2003 - 2004

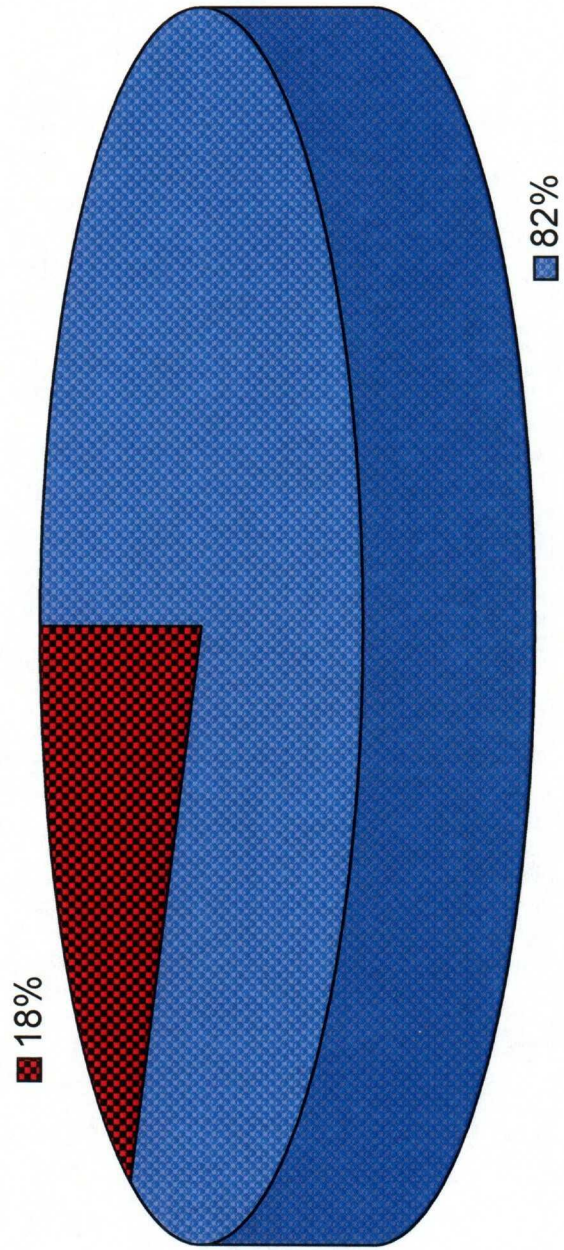

| Field Name | Wellname Prod | Current Status | Current Type | Vwm Id | Prod Date | Oil | Gas | Water | Tubing Pressure |
|-------------|---------------|----------------|------------------|----------------|-----------|-----|-----|-------|-----------------|
| BURTON FLAT | BFDU 04 (M) | Producing | Production - Gas | 065454-024-D02 | 09/30/04 | 39 | 9 | 6 | 50. |
| BURTON FLAT | BFDU 04 (M) | Producing | Production - Gas | 065454-024-D02 | 10/01/04 | 0 | 8 | 0 | 50. |
| BURTON FLAT | BFDU 04 (M) | Producing | Production - Gas | 065454-024-D02 | 10/02/04 | 0 | 8 | 0 | 50. |
| BURTON FLAT | BFDU 04 (M) | Producing | Production - Gas | 065454-024-D02 | 10/03/04 | 0 | 8 | 0 | 50. |
| BURTON FLAT | BFDU 04 (M) | Producing | Production - Gas | 065454-024-D02 | 10/04/04 | 0 | 8 | 0 | 50. |
| BURTON FLAT | BFDU 04 (M) | Producing | Production - Gas | 065454-024-D02 | 10/05/04 | 0 | 8 | 0 | 50. |
| BURTON FLAT | BFDU 04 (M) | Producing | Production - Gas | 065454-024-D02 | 10/06/04 | 0 | 8 | 0 | 50. |
| BURTON FLAT | BFDU 04 (M) | Producing | Production - Gas | 065454-024-D02 | 10/07/04 | 0 | 8 | 0 | 50. |
| BURTON FLAT | BFDU 04 (M) | Producing | Production - Gas | 065454-024-D02 | 10/08/04 | 0 | 9 | 0 | 50. |
| BURTON FLAT | BFDU 04 (M) | Producing | Production - Gas | 065454-024-D02 | 10/09/04 | 0 | 8 | 0 | 50. |
| BURTON FLAT | BFDU 04 (M) | Producing | Production - Gas | 065454-024-D02 | 10/10/04 | 0 | 8 | 0 | 50. |
| BURTON FLAT | BFDU 04 (M) | Producing | Production - Gas | 065454-024-D02 | 10/11/04 | 0 | 6 | 0 | 35. |
| BURTON FLAT | BFDU 04 (M) | Producing | Production - Gas | 065454-024-D02 | 10/12/04 | 0 | 0 | 0 | 35. |
| BURTON FLAT | BFDU 04 (M) | Producing | Production - Gas | 065454-024-D02 | 10/13/04 | 0 | 0 | 0 | 35. |
| BURTON FLAT | BFDU 04 (M) | Producing | Production - Gas | 065454-024-D02 | 10/14/04 | 0 | 22 | 0 | 35. |
| BURTON FLAT | BFDU 04 (M) | Producing | Production - Gas | 065454-024-D02 | 10/15/04 | 0 | 19 | 0 | 50. |
| BURTON FLAT | BFDU 04 (M) | Producing | Production - Gas | 065454-024-D02 | 10/16/04 | 0 | 16 | 0 | 50. |
| BURTON FLAT | BFDU 04 (M) | Producing | Production - Gas | 065454-024-D02 | 10/17/04 | 0 | 14 | 0 | 50. |
| BURTON FLAT | BFDU 04 (M) | Producing | Production - Gas | 065454-024-D02 | 10/18/04 | 0 | 13 | 0 | 50. |
| BURTON FLAT | BFDU 04 (M) | Producing | Production - Gas | 065454-024-D02 | 10/19/04 | 0 | 12 | 0 | 50. |
| BURTON FLAT | BFDU 04 (M) | Producing | Production - Gas | 065454-024-D02 | 10/20/04 | 0 | 12 | 0 | 50. |
| BURTON FLAT | BFDU 04 (M) | Producing | Production - Gas | 065454-024-D02 | 10/21/04 | 0 | 12 | 0 | 50. |
| BURTON FLAT | BFDU 04 (M) | Producing | Production - Gas | 065454-024-D02 | 10/22/04 | 0 | 11 | 0 | 50. |
| BURTON FLAT | BFDU 04 (M) | Producing | Production - Gas | 065454-024-D02 | 10/23/04 | 0 | 12 | 0 | 50. |
| BURTON FLAT | BFDU 04 (M) | Producing | Production - Gas | 065454-024-D02 | 10/24/04 | 0 | 11 | 0 | 50. |
| BURTON FLAT | BFDU 04 (M) | Producing | Production - Gas | 065454-024-D02 | 10/25/04 | 0 | 10 | 0 | 50. |
| BURTON FLAT | BFDU 04 (M) | Producing | Production - Gas | 065454-024-D02 | 10/26/04 | 0 | 10 | 0 | 50. |
| BURTON FLAT | BFDU 04 (M) | Producing | Production - Gas | 065454-024-D02 | 10/27/04 | 0 | 11 | 0 | 50. |
| BURTON FLAT | BFDU 04 (M) | Producing | Production - Gas | 065454-024-D02 | 10/28/04 | 0 | 10 | 0 | 50. |
| BURTON FLAT | BFDU 04 (M) | Producing | Production - Gas | 065454-024-D02 | 10/29/04 | 0 | 10 | 0 | 50. |
| BURTON FLAT | BFDU 04 (M) | Producing | Production - Gas | 065454-024-D02 | 10/30/04 | 0 | 10 | 0 | 50. |
| BURTON FLAT | BFDU 04 (M) | Producing | Production - Gas | 065454-024-D02 | 10/31/04 | 0 | 11 | 0 | 50. |
| BURTON FLAT | BFDU 04 (M) | Producing | Production - Gas | 065454-024-D02 | 11/01/04 | 0 | 10 | 0 | 50. |
| BURTON FLAT | BFDU 04 (M) | Producing | Production - Gas | 065454-024-D02 | 11/02/04 | 0 | 9 | 0 | 50. |
| | | | | | | | | | |
| BURTON FLAT | BFDU 04 (S) | Producing | Production - Gas | 530722-003-D01 | 09/30/04 | 0 | 39 | 0 | 50. |
| BURTON FLAT | BFDU 04 (S) | Producing | Production - Gas | 530722-003-D01 | 10/01/04 | 0 | 39 | 0 | 50. |
| BURTON FLAT | BFDU 04 (S) | Producing | Production - Gas | 530722-003-D01 | 10/02/04 | 0 | 39 | 0 | 50. |
| BURTON FLAT | BFDU 04 (S) | Producing | Production - Gas | 530722-003-D01 | 10/03/04 | 0 | 39 | 0 | 50. |
| BURTON FLAT | BFDU 04 (S) | Producing | Production - Gas | 530722-003-D01 | 10/04/04 | 0 | 39 | 0 | 50. |
| BURTON FLAT | BFDU 04 (S) | Producing | Production - Gas | 530722-003-D01 | 10/05/04 | 0 | 39 | 0 | 50. |
| BURTON FLAT | BFDU 04 (S) | Producing | Production - Gas | 530722-003-D01 | 10/06/04 | 0 | 40 | 0 | 50. |
| BURTON FLAT | BFDU 04 (S) | Producing | Production - Gas | 530722-003-D01 | 10/07/04 | 0 | 37 | 0 | 50. |
| BURTON FLAT | BFDU 04 (S) | Producing | Production - Gas | 530722-003-D01 | 10/08/04 | 0 | 39 | 0 | 50. |
| BURTON FLAT | BFDU 04 (S) | Producing | Production - Gas | 530722-003-D01 | 10/09/04 | 0 | 39 | 0 | 50. |
| BURTON FLAT | BFDU 04 (S) | Producing | Production - Gas | 530722-003-D01 | 10/10/04 | 0 | 40 | 0 | 50. |
| BURTON FLAT | BFDU 04 (S) | Producing | Production - Gas | 530722-003-D01 | 10/11/04 | 0 | 24 | 0 | 35. |
| BURTON FLAT | BFDU 04 (S) | Producing | Production - Gas | 530722-003-D01 | 10/12/04 | 0 | 32 | 0 | 50. |
| BURTON FLAT | BFDU 04 (S) | Producing | Production - Gas | 530722-003-D01 | 10/13/04 | 0 | 31 | 0 | 50. |
| BURTON FLAT | BFDU 04 (S) | Producing | Production - Gas | 530722-003-D01 | 10/14/04 | 0 | 0 | 0 | 50. |
| BURTON FLAT | BFDU 04 (S) | Producing | Production - Gas | 530722-003-D01 | 10/15/04 | 0 | 38 | 0 | 50. |
| BURTON FLAT | BFDU 04 (S) | Producing | Production - Gas | 530722-003-D01 | 10/16/04 | 0 | 60 | 0 | 50. |
| BURTON FLAT | BFDU 04 (S) | Producing | Production - Gas | 530722-003-D01 | 10/17/04 | 0 | 53 | 0 | 50. |
| BURTON FLAT | BFDU 04 (S) | Producing | Production - Gas | 530722-003-D01 | 10/18/04 | 0 | 49 | 0 | 50. |
| BURTON FLAT | BFDU 04 (S) | Producing | Production - Gas | 530722-003-D01 | 10/19/04 | 0 | 47 | 0 | 50. |
| BURTON FLAT | BFDU 04 (S) | Producing | Production - Gas | 530722-003-D01 | 10/20/04 | 0 | 45 | 0 | 50. |
| BURTON FLAT | BFDU 04 (S) | Producing | Production - Gas | 530722-003-D01 | 10/21/04 | 0 | 43 | 0 | 50. |
| BURTON FLAT | BFDU 04 (S) | Producing | Production - Gas | 530722-003-D01 | 10/22/04 | 0 | 43 | 0 | 50. |
| BURTON FLAT | BFDU 04 (S) | Producing | Production - Gas | 530722-003-D01 | 10/23/04 | 0 | 43 | 0 | 50. |
| BURTON FLAT | BFDU 04 (S) | Producing | Production - Gas | 530722-003-D01 | 10/24/04 | 0 | 41 | 0 | 50. |
| BURTON FLAT | BFDU 04 (S) | Producing | Production - Gas | 530722-003-D01 | 10/25/04 | 0 | 41 | 0 | 50. |

| Field Name | Wellname Prod | Current Status | Current Type | Vwm Id | Prod Date | Oil | Gas | Water | Tubing Pressure |
|-------------|---------------|----------------|------------------|----------------|-----------|-----|-----|-------|-----------------|
| BURTON FLAT | BFDU 04 (S) | Producing | Production - Gas | 530722-003-D01 | 10/26/04 | 0 | 41 | 0 | 50. |
| BURTON FLAT | BFDU 04 (S) | Producing | Production - Gas | 530722-003-D01 | 10/27/04 | 0 | 44 | 0 | 50. |
| BURTON FLAT | BFDU 04 (S) | Producing | Production - Gas | 530722-003-D01 | 10/28/04 | 0 | 42 | 0 | 50. |
| BURTON FLAT | BFDU 04 (S) | Producing | Production - Gas | 530722-003-D01 | 10/29/04 | 0 | 41 | 0 | 50. |
| BURTON FLAT | BFDU 04 (S) | Producing | Production - Gas | 530722-003-D01 | 10/30/04 | 0 | 41 | 0 | 50. |
| BURTON FLAT | BFDU 04 (S) | Producing | Production - Gas | 530722-003-D01 | 10/31/04 | 0 | 42 | 0 | 50. |
| BURTON FLAT | BFDU 04 (S) | Producing | Production - Gas | 530722-003-D01 | 11/01/04 | 0 | 41 | 0 | 50. |
| BURTON FLAT | BFDU 04 (S) | Producing | Production - Gas | 530722-003-D01 | 11/02/04 | 0 | 40 | 0 | 50. |

DEVON ENERGY PRODUCTION COMPANY LP

| | | | |
|------------------------------------|---------------------------|--------------------|---------------------|
| Well Name: Burton Flat Deep Unit 4 | | Field: Burton Flat | |
| Location: Sec 34, T20S-R28E | | County: Eddy | State: NM |
| Elevation: 3210' RKB | | Spud Date: 5/18/73 | Compl Date: 7/23/73 |
| API#: 30-015-20835 | Prepared by: Ronnie Slack | Date: 10/13/04 | Rev: |

CURRENT

17-1/2" hole
13-3/8", 48#, H40, ST&C, @ 600'
 Cmt'd w/ 750 sxs. Cmt to surface

12-1/4" hole
9-5/8", 36#, K55, ST&C, @ 2792'
 Cmt'd w/ 1250 sxs. Cmt to surface

Short String Production Tubing
 2-3/8", 4.7#, N80, Nuloc

Long String Production Tubing
 2-7/8", 6.5#, N80, Nulock

Otis sleeve (1.5" ID)
 Otis N Nipple (1.448" ID)

Baker Model K Double Grip Packer @ 10,041'

STRAWN
 10216' - 10244'

Blast Joints

Baker Sleeve (2.31" ID)
 Baker tubing seal receptical w/ F" Nipple (2.25" ID)
 Baker Lok-Set Packer @ 10,705'

MORROW
 10856' - 10860'
 11084' - 11102'
 11176' - 11212'
 11292' - 11296'
 11408' - 11414'

PBTD @ 11452'

8-3/4" Hole
7", 26#, S95 & CN800, LTC & BUTT @ 11500'
 Cmt'd w/ 450 sxs
 CI H w/ 3/4% cfr2 & 8# salt/sx
 TOC @ 9520'

TD @ 11,500'

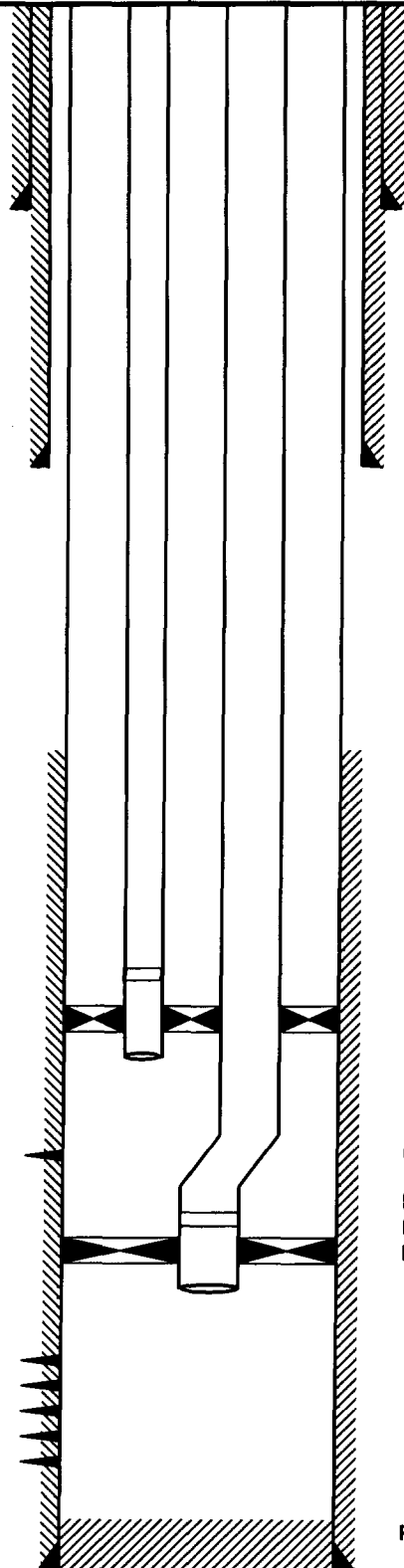



Devon Energy Corporation
20 North Broadway
Oklahoma City, Oklahoma 73102-8260
Fax 405-552-8113

December 9, 2004

Address List Attached

Re: Burton Flat Deep Unit #4
Section 34-T20S-R28E
Eddy County, New Mexico

Gentlemen:

Devon Louisiana Corporation as Operator of the referenced well intends to file the enclosed State of New Mexico Application for Downhole Commingling (Form C-107A attached hereto) for the purpose of commingling production from the Strawn and Morrow formations in the referenced well in the allocation percentages set forth on the application.

The overriding and royalty interest owners set forth on the attached address list may own an interest in either the Strawn formation or the Morrow formation or both and are entitled to notice of this Application. In accordance with New Mexico Oil Conservation Division rules you will have twenty (20) days from receipt of this notice to file an objection to the application.

Feel free to contact me at (405) 552-4633 if there are any questions or if additional information is required.

Yours very truly,

DEVON LOUISIANA CORPORATION

A handwritten signature in black ink, appearing to read "Ken Gray", written over the printed name.

Ken Gray
Senior Land Advisor

Patricia Young
P. O. Box 1639
Solana Beach, CA 92075

Edward Hudson Trust #4
Mary Hudson Trustee
222 W 4th Street Ph 5
Fort Worth, TX 76102

State of New Mexico
Commission of Public Lands
P. O. Box 1148
Santa Fe, NM 87504-1148

Swinehart 1973 Trust
John C Swinehart & Leslie Mallett
16408 N. Woodcrest Ct
Spokane, WA 99208

Edith B Myers
2717 South Lyon
Indianapolis, IN 46241

Margaret Palm
311 Grandview Place
San Antonio, TX 78209

Mary Curtiss Mayfield
P. O. Box 110915
Big Bear Lake, CA 92315

W. T. Probandt
415 W. Wall, Suite 1608
Midland, TX 79701

Thomas Mayfield III
7870 Rosemary
El Paso, TX 79915

Reva Trowbridge Estate
Ann T. Tollefson Per. Rep.
231 E 10th Street
Casper, WY 82601-3744

Betty Sumner Moran
11100 Los Lagos NE
Albuquerque, NM 87111

Mary Gene Weber Living Trust
P. O. Box 117
Elmer, OK 73539

Rosina Schutz
22 Brilliant Sky Drive
Santa Fe, NM 87508

Dorothy Sumner Corn
907 Ave. S #505
Lubbock, TX 79701

Roy Dunn
5511 North Delno
Fresno, CA 93711-3024

John Halagan
5601 Crimson Ridge Dr
Las Vegas, NM 89130-5129

Hudson New Mexico Min Trust
616 Texas Street
Fort Worth, TX 76102-4612

Southeast Royalties Inc.
P. O. Box 1658
Carlsbad, NM 88221-1658

John Gates
706 West Grand Avenue
Artesia, NM 88210

Society for Prevention of Cruelty of
Animals
8323 Baldwin Street
Oakland, CA 94621

Children's Hospital Foundation
5225 Dover Street
Oakland, CA 94609

Sol West III
P. O. Box 10120
El Paso, TX 79992

Nora Helen McCaw
210 Crossbow Rd.
Artesia, NM 88210

Thomas Laros
5711 Stanford
Dallas, TX 75209

Joe B. Schutz
P. O. Box 973
Santa Fe, NM 87501

Reva Co., A Partnership
5975 South Holly Street #253
Littleton, CO 80121

Gwendolyn Taylor Rutledge
354 Calle Colina
Santa Fe, NM 87501-0354

Agnes Dunigan Ind Exec
4024 La Adelita Drive
El Paso, TX 79922-2312

Sharon Clark
5317 Granite NE
Albuquerque, NM 87110

Suzanne Simpson
3320 12th Street NW
Albuquerque, NM 87107

William or Tina Sumner
11811 Eagle Rock Avenue NE
Albuquerque, NM 87122

George V Janzen
3488 "B" Calle Azul
Laguna Woods, CA 92653

Helen Frankot
1940 Verbania Drive
Las Vegas, NV 89134

Bureau of Land Management
2909 W. Second Street
Roswell, NM 88201-2019