

POOL Red Lake Queen-Grayburg-San Andres
RANGE 27 East NMFM

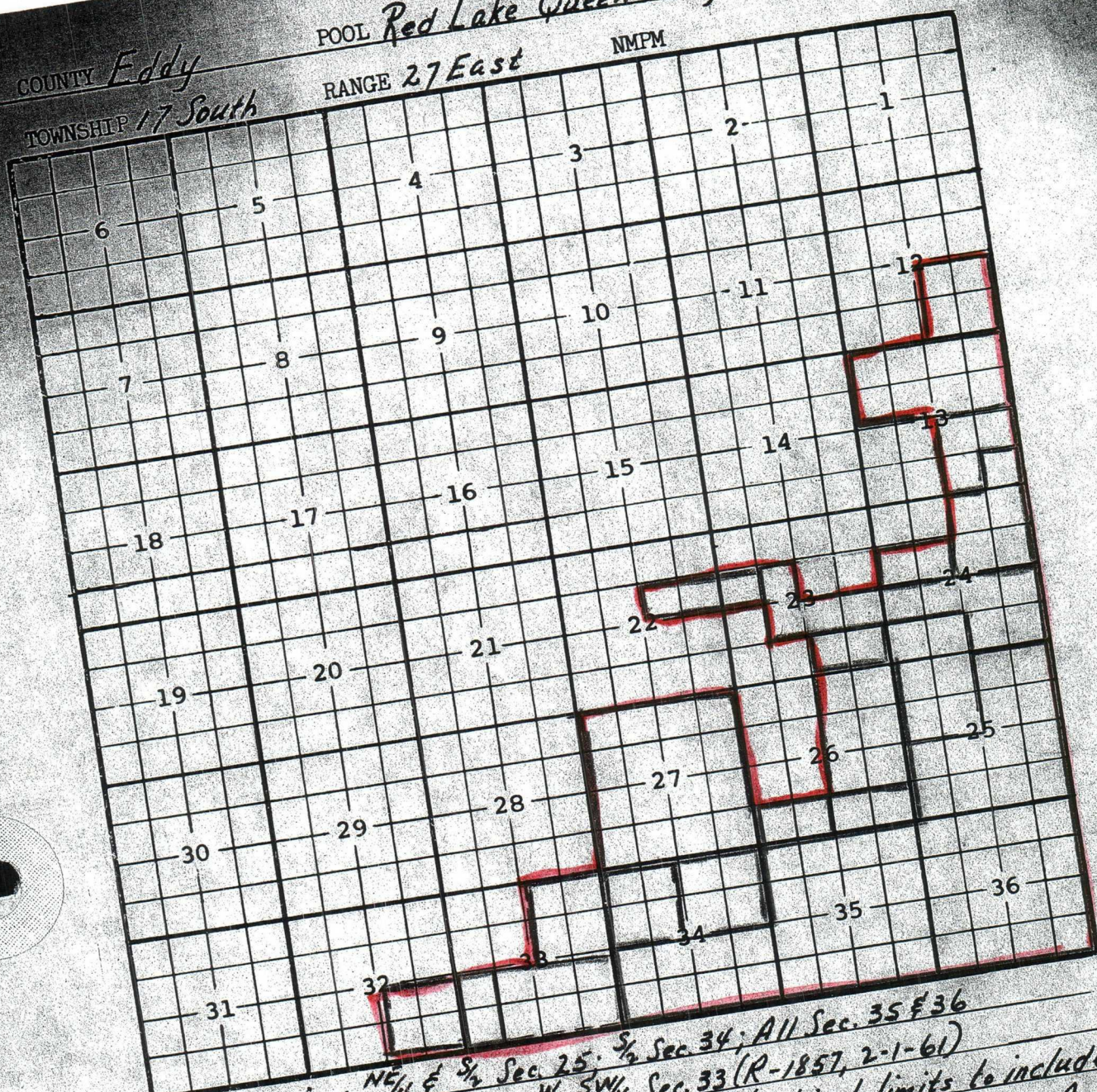

31 32

Description: NE $\frac{1}{4}$ & S $\frac{1}{2}$ Sec. 25; S $\frac{1}{2}$ Sec. 34; All Sec. 35 & 36
Ext: S $\frac{1}{2}$ SW $\frac{1}{4}$ Sec. 26 (R-157) - W $\frac{1}{2}$ SW $\frac{1}{4}$ Sec. 33 (R-1857, 2-1-61)
- S $\frac{1}{2}$ SE $\frac{1}{4}$ Sec. 26 (R-2427, 3-1-63) - Extend Vertical limits to include
Queen formation and redesignate Red Lake Queen-Grayburg-San Andres (R-3280
8-1-67)
Ext: SE $\frac{1}{4}$ NW $\frac{1}{4}$ & NE $\frac{1}{4}$ SW $\frac{1}{4}$ & N $\frac{1}{4}$ SE $\frac{1}{4}$ Sec. 23; SE $\frac{1}{4}$ & N $\frac{1}{4}$ SW $\frac{1}{4}$ Sec. 24 (R-4437, 12-1-72)
Ext: S $\frac{1}{2}$ NW $\frac{1}{4}$ Sec. 24 (R-4937, 2-1-75)
Ext: SE $\frac{1}{4}$ SE $\frac{1}{4}$ Sec. 13, NE $\frac{1}{4}$ Sec. 24 (R-5309, 11-1-76)
Ext: S $\frac{1}{2}$ NE $\frac{1}{4}$ Sec. 22, S $\frac{1}{2}$ SE $\frac{1}{4}$ & SW $\frac{1}{4}$ NW $\frac{1}{4}$ Sec. 23 (R-5417, 4-1-77)
Ext: W $\frac{1}{2}$ SE $\frac{1}{4}$ & NE $\frac{1}{4}$ SE $\frac{1}{4}$ Sec. 13 (R-5781, 9-1-78)
Ext: S $\frac{1}{2}$ SE $\frac{1}{4}$ & NE $\frac{1}{4}$ SE $\frac{1}{4}$ Sec. 12 (R-8257, 7-8-86)
Ext: N $\frac{1}{2}$ Sec. 13 (R-7555, 6-14-84) Ext: SE $\frac{1}{4}$ Sec. 12 (R-8257, 7-8-86)
Ext: SE $\frac{1}{4}$ and E $\frac{1}{2}$ SW $\frac{1}{4}$ Sec. 33, NW $\frac{1}{4}$ Sec. 34 (R-10822, 6-16-97)
Ext: NE $\frac{1}{4}$ Sec. 33, NE $\frac{1}{4}$ Sec. 34 (R-10844, 7-16-97) Ext: All Sec. 27 (R-10951, 2-4-98)
Ext: SE $\frac{1}{4}$ Sec. 32 (R-11005, 7-24-98) Ext: S $\frac{1}{2}$ SW $\frac{1}{4}$ Sec. 24, NW $\frac{1}{4}$ Sec. 25, NE $\frac{1}{4}$ and N $\frac{1}{2}$ SE $\frac{1}{4}$ Sec. 26 (R-11963, 5-13-03)

County Eddy Pool Northeast Red Lake-Glorieta-Yeso

County Eddy Pool Northeast Red Lake-Glorieta-Yeso

TOWNSHIP 17 South

TOWNSHIP 17 South Range 27 East NMPM

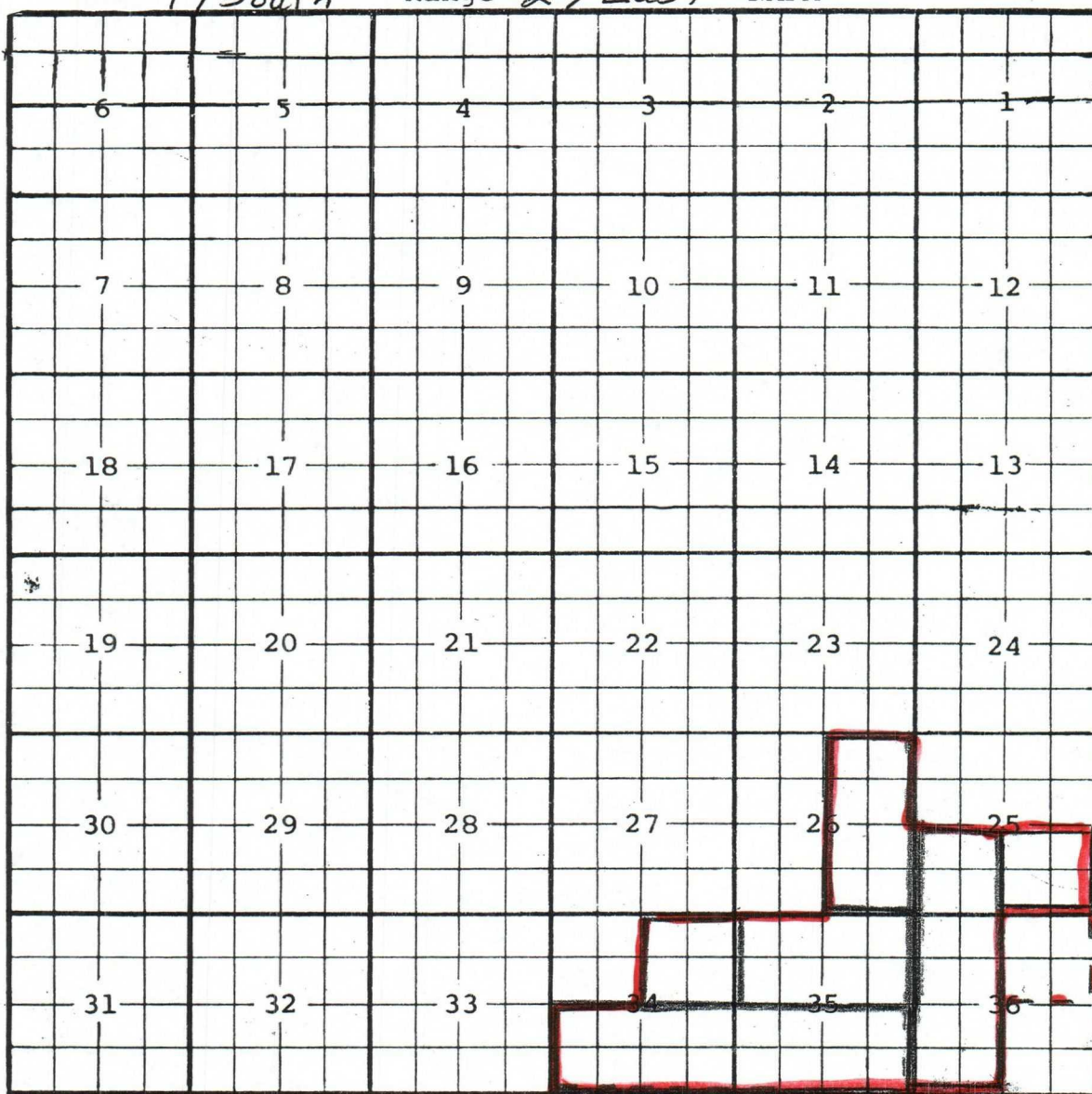

Ext. 5/2 Sec. 34, 5/2 Sec. 35 (R-11120, 4-7-99) Ext. 5/4 Sec. 25, 5/2 Sec. 36 (R-11359, 4-12-00)

Ext: ^E2 Sec. 26 (R-11470, 10-11-00) Ext: ^{SE}4 Sec. 25 (R-115443-12-00)

Ext: N/2 Sec. 35 (R-12083, 1-14-04) Ext: NE/4 Sec. 34 (R-12162, 7-2-04)

STATE OF NEW MEXICO
ENERGY, MINERALS AND NATURAL RESOURCES DEPARTMENT
OIL CONSERVATION DIVISION

IN THE MATTER OF THE HEARING
CALLED BY THE OIL CONSERVATION
DIVISION FOR THE PURPOSE OF
CONSIDERING:

CASE NO. 11966
ORDER NO. R-11162

APPLICATION OF DEVON ENERGY CORPORATION (NEVADA) FOR 23
UNORTHODOX OIL WELL LOCATIONS, EDDY COUNTY, NEW MEXICO.

ORDER OF THE DIVISION

BY THE DIVISION:

This case came on for hearing at 8:15 a.m. on April 16, 1998 at Santa Fe, New Mexico, before Examiner Michael E. Stogner.

NOW, on this 13th day of April, 1999, the Division Director, having considered the testimony, the record and the recommendations of the Examiner,

FINDS THAT:

(1) Due public notice has been given and the Division has jurisdiction of this case and its subject matter.

(2) The applicant, Devon Energy Corporation (Nevada) ["Devon"], seeks authority to drill and produce the following wells at unorthodox oil well locations in Township 17 South, Range 27 East, NMPM, Eddy County, New Mexico:

<u>Well Name and Number</u>	<u>API Number</u>	<u>Section</u>	<u>Footage Location</u>	<u>Unit</u>
Eagle "27-H" Federal No. 15	30-015-29942	27	1450' FNL & 990' FEL	H
Evarts "31" Federal No. 3	30-015-30171	31	1330' FSL & 1630' FEL	J
Eagle "33-G" Federal No. 6	30-015-29595	33	2460' FNL & 1350' FEL	G
Eagle "33-H" Federal No. 8	30-015-29596	33	2435' FNL & 531' FEL	H
Eagle "33-N" Federal No. 10	30-015-29598	33	230' FSL & 2140' FWL	N
Eagle "34-E" Federal No. 10	30-015-29632	34	2310' FNL & 1240' FWL	E
Eagle "34-F" Federal No. 12	30-015-29635	34	2310' FNL & 2420' FWL	F
Eagle "34-G" Federal No. 14	30-015-29636	34	2310' FNL & 1600' FEL	G
Eagle "34-I" Federal No. 18	30-015-29655	34	1740' FSL & 280' FEL	I
Eagle "34-L" Federal No. 24	30-015-29643	34	1740' FSL & 1065' FWL	L

In addition, Devon seeks authority to drill and produce the following wells at unorthodox oil well locations in Township 18 South, Range 27 East, NMPM, Eddy County, New Mexico:

<u>Well Name and Number</u>	<u>API Number</u>	<u>Section</u>	<u>Footage Location</u>	<u>Unit</u>
Falcon "3-N" Federal No. 18	30-015-29575	3	680' FSL & 1350' FWL	N
Carter Collier "5" Federal No. 9	30-015-29995	5	330' FNL & 2360' FEL	B
Evarts "6" Federal No. 4	30-015-30109	6	330' FNL & 1190' FEL	A
Fred "6" Federal No. 5	30-015-30155	6	1260' FNL & 990' FWL	D
Patton "6" Federal No. 6	30-015-30085	6	2460' FNL & 2310' FWL	F
Patton "6" Federal No. 4	30-015-30079	6	1593' FSL & 1469' FWL	K
Patton "6" Federal No. 3	30-015-29980	6	930' FSL & 1450' FWL	N
Hawk "9-B" Federal No. 4	30-015-29480	9	990' FNL & 1360' FEL	B
Hawk "9-J" Federal No. 16	30-015-29483	9	1630' FSL & 1650' FEL	J
Hawk "9-O" Federal No. 17	30-015-29484	9	1170' FSL & 2310' FEL	O
Hawk "17-C" Federal No. 1	30-015-29515	17	380' FNL & 1450' FWL	C
Hawk "17-C" Federal No. 2	30-015-29726	17	890' FNL & 2585' FWL	C
Kaiser No. 1	NA	18	330' FNL & 1110' FEL	A

(3) Prior to the hearing the Division issued the following Administrative Orders for four of the above-described wells:

- (a) NSL-3969 (SD), dated March 11, 1998, granted Devon approval to drill its Hawk "17-C" Federal Wells No. 1 and 2 at the above-described unorthodox oil well locations;
- (b) NSL-3982, dated March 23, 1998, granted Devon approval to drill its Carter Collier "5" Federal Well No. 9 at the above-described unorthodox oil well location; and
- (c) NSL-3983, dated March 23, 1998, granted Devon approval to drill its Evarts "6" Federal Well No. 4 at the above-described unorthodox oil well location.

Since it is unnecessary at this time to include these four wells in this application, they should be dismissed.

(4) The Red Lake (Queen-Grayburg-San Andres) Pool, as currently designated, includes the following lands in Eddy County, New Mexico:

TOWNSHIP 16 SOUTH, RANGE 28 EAST,

NMPM

Section 24: SE/4
Section 25: All
Section 26: S/2 S/2
Section 27: SE/4 SE/4
Section 34: All
Section 35: All
Section 36: All

TOWNSHIP 17 SOUTH, RANGE 27 EAST,

NMPM

Section 12: SE/4
Section 13: N/2 and SE/4
Section 22: S/2 NE/4
Section 23: S/2 NW/4, NE/4 SW/4, and SE/4
Section 24: NE/4, S/2 NW/4, N/2 SW/4, and SE/4
Section 25: NE/4 and S/2
Section 26: S/2 S/2
Section 27: All
Section 32: SE/4
Section 33: NE/4 and S/2
Section 34: All
Section 35: All
Section 36: All

TOWNSHIP 17 SOUTH, RANGE 28 EAST,

NMPM

Section 7: All
Section 8: SW/4
Section 9: NE/4 NE/4, S/2 NE/4, and SE/4
Section 10: SW/4
Section 11: S/2
Section 12: SW/4 SW/4
Section 14: W/2

TOWNSHIP 17 SOUTH, RANGE 28 EAST,

NMPM

(Continued)

Section 15: All
Section 16: NE/4 and S/2
Section 18: W/2
Section 19: S/2
Section 20: All
Section 22: All
Section 23: S/2 NW/4 and S/2
Section 25: N/2
Section 26: N/2
Section 27: N/2 N/2 and SW/4
Section 28: All
Section 29: N/2, SW/4, and N/2 SE/4
Section 30: All
Section 31: NE/4 NE/4, W/2 E/2, and W/2

TOWNSHIP 18 SOUTH, RANGE 26 EAST,

NMPM

Section 1: E/2

TOWNSHIP 18 SOUTH, RANGE 27 EAST,

NMPM

Section 1: S/2
Section 2: S/2
Section 3: All
Section 4: All
Section 5: All
Section 6: All
Section 7: All
Section 8: All
Section 9: All
Section 17: N/2
Section 18: NE/4, N/2 NW/4, and SE/4 NW/4.

(5) Currently the Red Lake (Queen-Grayburg-San Andres) Pool is governed by the Division's statewide rules, which require development on standard 40-acre spacing and proration units, each having a top unit depth bracket allowable of 80 barrels of oil per day and a limiting gas/oil ratio of 2,000 cubic feet of gas per barrel of oil, and allow infill drilling on each 40-acre unit.

(6) Within a 1236.85-acre area, more or less, comprising the following described

acreage in Eddy County, New Mexico, Devon is the operator of the West Red Lake Unit Area (approved by Division Order No. R-3453 dated July 12, 1968) in which waterflood operations are being conducted with injection into the Red Lake (Queen-Grayburg-San Andres) Pool (approved by Division Order No. R-3469, issued in Case No. 3824, dated August 13, 1968, and designated the West Red Lake Waterflood Project).

(7) The remaining 19 wells listed in Paragraph No. (2) above are either completed in or proposed to be completed in the Red Lake (Queen-Grayburg-San Andres) Pool, and each well will have a standard 40-acre, more or less, unit dedicated thereto. Eleven wells will be infill wells within existing 40-acre oil proration units while the remaining eight wells will be considered new designations.

(8) The applicant presented evidence that indicates the following:

- (a) All of the wells are located on federal land, except the Kaiser No. 1, which is located on fee land.
- (b) The subject pool is continuous across the area, trending in a northeast-southwest direction.
- (c) The original locations for all of the subject wells were orthodox, but were moved due to topographic and engineering reasons.
- (d) The subject area is near the Pecos River, with numerous draws and elevation changes of 100-200 feet. The Bureau of Land Management requested that numerous well locations be moved to prevent extreme cut and fill of slopes and prevent erosion of the highly erodible soil in this area. In addition, there are numerous gas transmission and gathering pipelines, roads, existing wells, and a gas plant. All of these factors limit well locations.
- (e) Average reserves in wells completed in the subject pool are about 50,000 barrels of oil, which equate to approximately 24 acres of drainage. The drainage radius of such a well is much less than a well that is capable of draining 40 acres. The applicant has drilled wells within 400-450 feet of older, above-average wells in the pool, and has seen no evidence of drainage from those older wells.
- (f) Directional drilling is not feasible because the small reserves in these wells do not justify the additional drilling and operating costs.

- (g) Applicant is drilling two wells per 40-acre unit to: (i) adequately drain each unit, and (ii) prepare for a possible future waterflood project. Injection in the West Red Lake Unit has shown a favorable production response. Drilling two wells per 40-acre unit could allow the Unit's waterflood project to be expanded in the future.

(9) Each of the above-described unorthodox oil well locations should be approved for one or more of the following reasons:

- (a) The location is a move toward the interior of a lease;
- (b) The location encroaches on a lease not owned or operated by the applicant, but notice was given to the offset and the Division received no objection;
- (c) The location will not drain the offset well unit due to the limited drainage areas in the subject pool;
- (d) A well will be drilled offsetting the proposed unorthodox well, or the offsetting well unit has existing wells producing from the same pool; and/or
- (e) There are no overriding royalty interest owners in the tract offsetting the subject well, or the applicant is the only overriding royalty interest owner in the offsetting tract.

(10) Approval of the proposed unorthodox oil well locations will afford the applicant the opportunity to produce its just and equitable share of oil and gas from the subject pool and will prevent waste and protect correlative rights.

IT IS THEREFORE ORDERED THAT:

(1) The applicant, Devon Energy Corporation (Nevada), is hereby authorized to drill the wells described below at unorthodox oil well locations in the Red Lake (Queen-Grayburg-San Andres) Pool in Township 17 South, Range 27 East, NMPM, Eddy County, New Mexico:

<u>Well Name and Number</u>	<u>API Number</u>	<u>Section</u>	<u>Footage Location</u>	<u>Unit</u>
Eagle "27-H" Federal No. 15	30-015-29942	27	1450' FNL & 990' FEL	H
Evarts "31" Federal No. 3	30-015-30171	31	1330' FSL & 1630' FEL	J

Eagle "33-G" Federal No. 6	30-015-29595	33	2460' FNL & 1350' FEL	G
Eagle "33-H" Federal No. 8	30-015-29596	33	2435' FNL & 531' FEL	H
Eagle "33-N" Federal No. 10	30-015-29598	33	230' FSL & 2140' FWL	N
Eagle "34-E" Federal No. 10	30-015-29632	34	2310' FNL & 1240' FWL	E
Eagle "34-F" Federal No. 12	30-015-29635	34	2310' FNL & 2420' FWL	F
Eagle "34-G" Federal No. 14	30-015-29636	34	2310' FNL & 1600' FEL	G
Eagle "34-I" Federal No. 18	30-015-29655	34	1740' FSL & 280' FEL	I
Eagle "34-L" Federal No. 24	30-015-29643	34	1740' FSL & 1065' FWL	L

And in Township 18 South, Range 27 East, NMPM, Eddy County, New Mexico:

<u>Well Name and Number</u>	<u>API Number</u>	<u>Section</u>	<u>Footage Location</u>	<u>Unit</u>
Falcon "3-N" Federal No. 18	30-015-29575	3	680' FSL & 1350' FWL	N
Fred "6" Federal. No. 5	30-015-30155	6	1260' FNL & 990' FWL	D
Patton "6" Federal No. 6	30-015-30085	6	2460' FNL & 2310' FWL	F
Patton "6" Federal No. 4	30-015-30079	6	1593' FSL & 1469' FWL	K
Patton "6" Federal No. 3	30-015-29980	6	930' FSL & 1450' FWL	N
Hawk "9-B" Federal No. 4	30-015-29480	9	990' FNL & 1360' FEL	B
Hawk "9-J" Federal No. 16	30-015-29483	9	1630' FSL & 1650' FEL	J
Hawk "9-O" Federal No. 17	30-015-29484	9	1170' FSL & 2310' FEL	O
Kaiser No. 1	NA	18	330' FNL & 1110' FEL	A

(2) Each well shall have a standard 40-acre oil spacing and proration unit dedicated thereto.

(3) Jurisdiction of this case is retained for the entry of such further orders as the Division may deem necessary.

DONE at Santa Fe, New Mexico, on the day and year hereinabove designated.

STATE OF NEW MEXICO
OIL CONSERVATION DIVISION

LORI WROTENBERY
Director

SEAL

UNITED STATES
DEPARTMENT OF THE INTERIOR
BUREAU OF LAND MANAGEMENT

SUBMIT IN TR
(Other instructions
reverse side)

DATE
ON

Form approved:
Budget Bureau No. 1004-0135
Expiration August 31, 1985

1. LEASE DESIGNATION AND SERIAL NO.

NM-0557370

2. IF INDIAN, ADOPTED OR TRIBE NAME

SUNDRY NOTICES AND REPORTS ON WELLS

(Do not use this form for proposals to drill or to deepen or plug back to a different reservoir.
Use "APPLICATION FOR PERMIT" for such proposals.)

3. WELL TYPE
OIL WELL ☐ GAS WELL ☐ OTHER PA

4. NAME OF OPERATOR

Harbob Energy Corporation ✓

5. ADDRESS OF OPERATOR

P.O. Drawer 217, Artesia, New Mexico 88211-0217

6. LOCATION OF WELL (Report location clearly and in accordance with any State requirements.
See also space 17 below.)
At surface

330 FSL 990 FWL

14. PERMIT NO.

15. ELEVATIONS (Show whether DI, RT, GR, etc.)

7. UNIT AGREEMENT NAME

8. FARM OR LEASE NAME

Hondo Federal

9. WELL NO.

1

10. FIELD AND POOL, OR WILDCAT

Red Lake On Grbg SA

11. SEC., T., R., M., OR BLM, AND
SURVEY OR AREA

Sec. 26-T17S-R27E

12. COUNTY OR PARISH 13. STATE

Eddy

N.M.

16. Check Appropriate Box To Indicate Nature of Notice, Report, or Other Data

NOTICE OF INTENTION TO:

TEST WATER SHUT-OFF

FRACTURE TREAT

SHOOT OR ACIDIZE

REPAIR WELL

(Other)

PULL OR ALTER CASING

MULTIPLE COMPLETION

ABANDON*

CHANGE PLANS

SUBSEQUENT REPORT OF:

WATER SHUT-OFF

FRACTURE TREATMENT

SHOOTING OR ACIDIZING

(Other)

REPAIRING WELL

ALTERING CASING

ABANDONMENT*

(NOTE: Report results of multiple completion on Well
Completion or Recompletion Report and Log form.)

17. DESCRIBE PROPOSED OR COMPLETED OPERATIONS (Clearly state all pertinent details, and give pertinent dates, including estimated date of starting any proposed work. If well is directionally drilled, give subsurface locations and measured and true vertical depths for all markers and zones pertinent to this work.)*

Dry hole marker has been set. Location is clean and ready for inspection.

18. I hereby certify that the foregoing is true and correct

SIGNED

Rhonda Nelson

TITLE

Production Clerk

DATE

8/30/89

(This space for Federal or State office use)

APPROVED BY

TITLE

DATE

CONDITIONS OF APPROVAL, IF ANY:

*See Instructions on Reverse Side

UNITED STATES
DEPARTMENT OF THE INTERIOR
BUREAU OF LAND MANAGEMENT

SUBMIT IN TRIP:
(Other instructions
verse side)

TE
re

Form approved.
Budget Bureau No. 1004-0135
Expires August 31, 1985

4/5F

SUNDRY NOTICES AND REPORTS ON WELLS

(Do not use this form for proposals to drill or to deepen or plug back to a different reservoir.
Use "APPLICATION FOR PERMIT—" for such proposals.)

1. OIL WELL <input checked="" type="checkbox"/> GAS WELL <input checked="" type="checkbox"/> OTHER <input checked="" type="checkbox"/> PA	5. LEASE DESIGNATION AND SERIAL NO. NM-0557370
2. NAME OF OPERATOR Marbob Energy Corporation	6. IF INDIAN, ALLOTTEE OR TRIBE NAME
3. ADDRESS OF OPERATOR P.O. Drawer 217, Artesia, N.M. 88210	7. UNIT AGREEMENT NAME
4. LOCATION OF WELL (Report location clearly and in accordance with any State requirements. See also space 17 below.) At surface 330 FSL 990 FWL	8. FARM OR LEASE NAME Hondo Federal
14. PERMIT NO.	9. WELL NO. 1
15. ELEVATIONS (Show whether DF, RT, GR, etc.) ARTESIA, OFFICE	10. FIELD AND POOL, OR WILDCAT Red Lake On Grbg SA
	11. SEC., T., R., M., OR BLK. AND SURVEY OR AREA Sec. 26-T17S-R27E
	12. COUNTY OR PARISH; 13. STATE Eddy N.M.

RECEIVED

JUL 07 '89

O. C. D.

16. Check Appropriate Box To Indicate Nature of Notice, Report, or Other Data.

NOTICE OF INTENTION TO:

TEST WATER SHUT-OFF	<input type="checkbox"/>	PULL OR ALTER CASING	<input type="checkbox"/>
FRACTURE TREAT	<input type="checkbox"/>	MULTIPLE COMPLETE	<input type="checkbox"/>
SHOOT OR ACIDIZE	<input type="checkbox"/>	ABANDON*	<input type="checkbox"/>
REPAIR WELL	<input type="checkbox"/>	CHANGE PLANS	<input type="checkbox"/>
(Other)	<input type="checkbox"/>		

SUBSEQUENT REPORT OF:

WATER SHUT-OFF	<input type="checkbox"/>	REPAIRING WELL	<input type="checkbox"/>
FRACTURE TREATMENT	<input type="checkbox"/>	ALTERING PLANS	<input type="checkbox"/>
SHOOTING OR ACIDIZING	<input type="checkbox"/>	ABANDONMENT*	<input checked="" type="checkbox"/>
(Other)	<input type="checkbox"/>		

(Note: Report results of multiple completion on Well Completion or Recompletion Report and Log (Form 3160-6))

17. DESCRIBE PROPOSED OR COMPLETED OPERATIONS (Clearly state all pertinent details, and give pertinent dates, including estimated date of starting and proposed work. If well is directionally drilled, give subsurface locations and measured and true vertical depths for all markers and names pertinent to this work.)

We plugged & abandoned well as follows:

5/15/89 Sqzd perms w/35 sx cmt; pressure tstd bottom hole plug to 750#--held okay. Tagged @ 1495'; cut tbg off @ 900'; circ cmt to surface w/70 sx cmt. Installed dry hole marker 5/17/89. Will notify upon completion of cleaning location and ready for inspection.

Post ID-2
6-30-89
PA

RECEIVED

18. I hereby certify that the foregoing is true and correct

SIGNED Rhonda Nelson

TITLE Production Clerk

DATE 6/26/89

(This space for Federal or State office use)

APPROVED BY [Signature]
CONDITIONS OF APPROVAL, IF ANY

FOR: CHIEF, MINERAL RESOURCES

DATE 6-5-89

Approved as to plug back of well bore.
Leaving well bore is retained until
surface restoration is completed.

*See Instructions on Reverse Side

UNITED STATES DEPARTMENT OF THE INTERIOR
BUREAU OF LAND MANAGEMENT

SUBMIT IN TRIP
(Other instructions
verse side)

Form approved
Budget Item # 10-1-100
Expires August 1989

NM-0557370

SUNDRY NOTICES AND REPORTS ON WELLS

(This form is to be used for proposals to drill or to deepen or plug back to a different reservoir.
See "APPLICATION FOR PERMIT" for such proposals.)

7. UNIT AGREEMENT NO.

8. FARM OR ESTATE NAME

Hondo

9. WELL NO.

1

10. FIELD AND FIRM, OR WELL NO.

Red Lake On Grbg SA

11. SEC., T., R., M., OR BLM, AND
SURVEY OR AREA

Sec. 26-T17S-R27E

12. COUNTY OR TOWNSHIP OR RANGE

Eddy

N.M.

1. WELL NO. 1000
WELL NAME 1000
WELL TYPE 1000

2. WELL IN OPERATION

Parish Energy Corporation

RECEIVED

3. ADDRESS OF OPERATOR

P.O. Drawer 217, Artesia, N.M. 88210

4. LOCATION OF WELL (Report location clearly and in accordance with any State requirements.
See also space 11 below.)

At surface

330 FSL 990 FWL

MAY 15 '89

C. C. D.

ARTESIA OFFICE

14. REMARKS

15. ELEVATIONS (Show whether SP, RT, GR, etc.)

Check Appropriate Box To Indicate Nature of Notice, Report, or Other Data

NOTICE OF INTENTION TO:

WATER SHUT-OFF

FRAC TREATMENT

SHOOTING OR ACIDIZING

REPAIR WELL

WELL OR ALTER CASING

MULTIPLE COMPLETE

ABANDON*

CHANGE PLANS

SUBSEQUENT REPORT OF:

WATER SHUT-OFF

FRAC TREATMENT

SHOOTING OR ACIDIZING

(Other)

REPAIRING WELL

ALTERING Casing

ABANDONMENT

(NOTE: Report results of multiple completion or
Completion or Recompletion Report and see form)

6. DESCRIBE OPERATIONS OR UNEXPECTED OPERATIONS (Clearly state all pertinent details, and give pertinent dates, including estimated date of completion, work. If well is directionally drilled, give subsurface locations and measured and true vertical depths for all markers from surface to the wellbore.)

We propose to plug & abandon as follows:

Set a cmt plug from TD to 1500' (tag), set cmt plug from
1330'-1200'-1000' (tag), set cmt plug from 670'-570' across
surface shoe, 50' surface plug, install dry hole marker
and clean location.

APR 14 11 05 AM '89

RECEIVED

Khonda Nelson

TITLE Production Clerk

DATE 4/13/89

(Signature for Federal or State office use)

Shamir J. Jue

FOR:

TITLE

DATE 5 12 89

*See Instructions on Reverse Side

It is a crime for any person knowingly and willfully to make to any department or agency of the United States or to any officer or employee of any such department or agency any false, fictitious or fraudulent statements or representations as to any matter within its jurisdiction.

OIL CONSERVATION DIVISION
P. O. BOX 2088
SANTA FE, NEW MEXICO 87501Form C-104
Revised 10-1-78

NO. OF TUBES DRILLED	
NO. OF TUBES CEMENTED	
SANTA FE	<input checked="" type="checkbox"/>
FILE	<input checked="" type="checkbox"/>
W.D.S.	
LAND OFFICE	
TRANSPORTER	<input checked="" type="checkbox"/>
OPERATOR	<input checked="" type="checkbox"/>
PRODUCTION OFFICE	

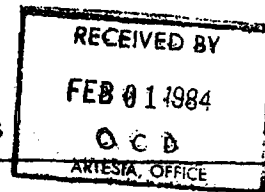
REQUEST FOR ALLOWABLE
AND
AUTHORIZATION TO TRANSPORT OIL AND NATURAL GASOperator
Marbob Energy Corporation ✓
Address
P.O. Drawer 217, Artesia, N.M. 88210

Reason(s) for filing (Check proper box)

New Well ☐ Change in Transporter oil: ☐
Recompletion ☐ Oil ☐ Dry Gas ☐
Change in Ownership ☒ Casinghead Gas ☐ Condensate ☐

Other (Please explain)

If change of ownership give name and address of previous owner: Collier & Collier, P.O. Box 798, Artesia, N.M. 88210

DESCRIPTION OF WELL AND LEASE

Lease Name Hondo	Well No. 1	Pool Name, including Formation Red Lake On Grbg SA	Kind of Lease State, Federal or Fee Fed.	Lease No. 0557370
Location Unit Letter M : 330 Feet From The South Line and 990 Feet From The West Line of Section 26 Township 17S Range 27E, NMPM, Eddy County				

DESIGNATION OF TRANSPORTER OF OIL AND NATURAL GAS

Name of Authorized Transporter of Oil <input type="checkbox"/> or Condensate <input type="checkbox"/> WELL SHUT IN	Address (Give address to which approved copy of this form is to be sent)	
Name of Authorized Transporter of Casinghead Gas <input type="checkbox"/> or Dry Gas <input type="checkbox"/>	Address (Give address to which approved copy of this form is to be sent)	
If well produces oil or liquids, give location of tanks.	Unit M	Sec. 26
	Twp. 17S	Rge. 27E
	Is gas actually connected? No	
	When	

If this production is commingled with that from any other lease or pool, give commingling order number:

COMPLETION DATA

Designate Type of Completion - (I)	Oil Well	Gas Well	New Well	Workover	Deepen	Plug Back	Same Res'v.	Dill. Res'v.
Date Spudded	Date Compl. Ready to Prod.		Total Depth		P.B.T.D.			
Elevations (DF, RKB, RT, CR, etc.)	Name of Producing Formation		Top Oil/Gas Pay		Tubing Depth			
Perforations					Depth Casing Shoe			

TUBING, CASING, AND CEMENTING RECORD

HOLE SIZE	CASING & TUBING SIZE	DEPTH SET	SACKS CEMENT

TEST DATA AND REQUEST FOR ALLOWABLE OIL WELL

(Test must be after recovery of total volume of load oil and must be equal to or exceed top allowable for this depth or be for full 24 hours)

Date First New Oil Run To Tanks	Date of Test	Producing Method (Flow, pump, gas lift, etc.) Post RD-3	
Length of Test	Tubing Pressure	Casing Pressure	Choke Size 2-12-84
Actual Prod. During Test	Oil-Bbls.	Water-Bbls.	Gas-MCF Chg. D-P

GAS WELL

Actual Prod. Test-MCF/D	Length of Test	Bbls. Condensate/MCF	Gravity of Condensate
Testing Method (prior, back pr.)	Tubing Pressure (Shut-in)	Casing Pressure (Shut-in)	Choke Size

CERTIFICATE OF COMPLIANCE

I hereby certify that the rules and regulations of the Oil Conservation Division have been complied with and that the information given above is true and complete to the best of my knowledge and belief.

Carol Orris
(Signature)

Production Clerk

(Title)

1/30/84

(Date)

OIL CONSERVATION DIVISION

APPROVED FEB 06 1984

BY Mike Williams

OIL AND GAS INSPECTOR

TITLE

This form is to be filed in compliance with RULE 1104.

If this is a request for allowable for a newly drilled or deepened well, this form must be accompanied by a tabulation of the deviation tests taken on the well in accordance with RULE 111.

All sections of this form must be filled out completely for allowable on new and recompleted wells.

Fill out only Sections I, II, III, and VI for changes of owner, well name or number, or transporter, or other such change of condition.

Separate Forms C-104 must be filed for each pool in multiple completed wells.

NO. OF COPIES RECEIVED	4
DISTRIBUTION	
SALE PRICE	1
FILE	1
U.S.O.S.	
LAND OFFICE	
TRANSPORTER	1
OIL	
GAS	
OPERATION	1
PRODUCTION OFFICE	

NEW MEXICO OIL CONSERVATION COMMISSION
REQUEST FOR ALLOWABLE
AND
AUTHORIZATION TO TRANSPORT OIL AND NATURAL GAS

Form C-101
 Supersedes Old C-101 and C-102
 Effective 1-1-65

(51)

SEP 28 1977

I. OPERATOR

Operator Collier & Collier

Address P. O. Box 798 Artesia, NM 88210

Reason(s) for filing (Check proper box)

New Well ☐ Change in Transporter of: Oil ☐ Dry Gas ☐

Recompletion ☐ Casinghead Gas ☐ Condensate ☐

Change in Ownership ☒

If change of ownership give name and address of previous owner David C. Collier Box 798 Artesia, NM

II. DESCRIPTION OF WELL AND LEASE

Lease Name	Well No.	Pool Name, including Formation	Kind of Lease	Lease No.
<u>Hondo</u>	<u>1</u>	<u>Red Lake O-G-SA</u>	<u>Federal</u>	<u>NM 055737</u>
Location				
Unit Letter	<u>M</u>	<u>330</u> Feet From The <u>South</u> Line and <u>990</u> Feet From The <u>West</u>		
Line of Section	<u>26</u>	Township <u>17S</u>	Range <u>27E</u>	County <u>Eddy</u>

III. DESIGNATION OF TRANSPORTER OF OIL AND NATURAL GAS

Name of Authorized Transporter of Oil <input type="checkbox"/> or Condensate <input type="checkbox"/>	Address (Give address to which approved copy of this form is to be sent)
<u>Navajo Rfg. Co. Pipe Line Div.</u>	<u>North Freeman Ave. Artesia, NM</u>
Name of Authorized Transporter of Casinghead Gas <input type="checkbox"/> or Dry Gas <input type="checkbox"/>	Address (Give address to which approved copy of this form is to be sent)
If well produces oil or liquids, give location of tanks.	Unit <u>M</u> Sec. <u>26</u> Twp. <u>17</u> Rge. <u>27</u> Is gas actually connected? <u>No</u> When

If this production is commingled with that from any other lease or pool, give commingling order number:

IV. COMPLETION DATA

Designate Type of Completion - (X)	Oil Well	Gas Well	New Well	Workover	Deepen	Plug Back	Stim Res'n.	Plf. Res'n.
<input checked="" type="checkbox"/>	<input type="checkbox"/>	<input type="checkbox"/>	<input type="checkbox"/>	<input type="checkbox"/>	<input type="checkbox"/>	<input type="checkbox"/>	<input type="checkbox"/>	<input type="checkbox"/>
Date Spudded	Date Compl. Ready to Prod.	Total Depth	P.B.T.D.					
Elevations (OF, RKB, RT, CR, etc.)	Name of Producing Formation	Top Oil/Gas Pay	Tubing Depth					
Perforations	Depth Casing Shoe							

TUBING, CASING, AND CEMENTING RECORD

HOLE SIZE	CASING & TUBING SIZE	DEPTH SET	SACKS CEMENT

V. TEST DATA AND REQUEST FOR ALLOWABLE OIL WELL

(Test must be after recovery of total volume of lost oil and must be equal to or exceed top all able for this depth or be for full 24 hours)

Date First New Oil Run To Tanks	Date of Test	Producing Method (Flow, pump, gas lift, etc.)	
Length of Test	Tubing Pressure	Casing Pressure	Choke Size
Actual Prod. During Test	Oil-Bbls.	Water-Bbls.	Gas-MCF

GAS WELL

Actual Prod. Test-MCF/D	Length of Test	Lbbs. Condensate/MCF	Gravity of Condensate
Testing Method (flow, back pr.)	Tubing Pressure (lbwt-in.)	Casing Pressure (lbwt-in.)	Choke Size

VI. CERTIFICATE OF COMPLIANCE

I hereby certify that the rules and regulations of the Oil Conservation Commission have been complied with and that the information given above is true and complete to the best of my knowledge and belief.

Agent

9-28-77

OIL CONSERVATION COMMISSION

APPROVED OCT 13 1977

BY W. A. Grossett

TITLE SUPERVISOR, DISTRICT II

This form is to be filed in compliance with RULE 1104.

If this is a request for allowable for a newly drilled or deep well, this form must be accompanied by a tabulation of the well tests taken on the well in accordance with RULE 111.

All sections of this form must be filled out completely for this form to be accepted.

Fill out only I, II, III, and VI for change of well name or location, or transporter, or other such change of data.

SANTA FE	
FILE	/
U.S.G.S.	/
LAND OFFICE	
TRANSPORTER	OIL /
	GAS /
OPERATOR	
PRORATION OFFICE	

NEW MEXICO OIL CONSERVATION COMMISSION
REQUEST FOR ALLOWABLE
AND
AUTHORIZATION TO TRANSPORT OIL AND NATURAL GAS

Form C-104
Supersedes Old C-104 and C-110
Effective 1-1-65

DEC 19 1975

Operator David C. Collier ✓	
Address P. O. Box 798, Artesia, NM 88210	
Reason(s) for filing (Check proper box)	
New Well <input type="checkbox"/>	Change in Transporter of:
Recompletion <input type="checkbox"/>	Oil <input type="checkbox"/>
Change in Ownership <input checked="" type="checkbox"/>	Casinghead Gas <input type="checkbox"/>
	Dry Gas <input type="checkbox"/>
	Condensate <input type="checkbox"/>
Other (Please explain)	

If change of ownership give name and address of previous owner: George A. Chase, P. O. Box 637, Artesia, NM 88210

II. DESCRIPTION OF WELL AND LEASE

Lease Name Hondo Pool	Well No. 1	Pool Name, including Formation Red Lake Queen GB SA	Kind of Lease State, Federal or FeeFed. NM	Lease No. 0557370
Location				
Unit Letter M	330	Feet From The South	Line and 990	Feet From The West
Line of Section 26	Township 17 South	Range 27 East	NMPM, Eddy	County

III. DESIGNATION OF TRANSPORTER OF OIL AND NATURAL GAS

Name of Authorized Transporter of Oil <input checked="" type="checkbox"/> or Condensate <input type="checkbox"/>	Address (Give address to which approved copy of this form is to be sent)
Navaio Refining Co. Pipeline Div.	North Freeman, Artesia, NM 88210
Name of Authorized Transporter of Casinghead Gas <input type="checkbox"/> or Dry Gas <input type="checkbox"/>	Address (Give address to which approved copy of this form is to be sent)
If well produces oil or liquids, give location of tanks.	Unit Sec. Twp. Rge. Is gas actually connected? When
M 26 17S 27E	No

If this production is commingled with that from any other lease or pool, give commingling order number:

IV. COMPLETION DATA

Designate Type of Completion - (X)	Oil Well	Gas Well	New Well	Workover	Deepen	Plug Back	Same Res'v.	Diff. Res'v.
Date Spudded	Date Compl. Ready to Prod.	Total Depth	P.B.T.D.					
Elevations (DF, RKB, RT, GR, etc.)	Name of Producing Formation	Top Oil/Gas Pay	Tubing Depth					
Perforations	Depth Casing Shoe							
TUBING, CASING, AND CEMENTING RECORD								
HOLE SIZE	CASING & TUBING SIZE	DEPTH SET	SACKS CEMENT					

V. TEST DATA AND REQUEST FOR ALLOWABLE OIL WELL

(Test must be after recovery of total volume of load oil and must be equal to or exceed top allowable for this depth or be for full 24 hours)

Date First New Oil Run To Tanks	Date of Test	Producing Method (Flow, pump, gas lift, etc.)	
Length of Test	Tubing Pressure	Casing Pressure	Choke Size
Actual Prod. During Test	Oil-Bbls.	Water-Bbls.	Gas-MCF

GAS WELL

Actual Prod. Test-MCF/D	Length of Test	Bbls. Condensate/MMCF	Gravity of Condensate
Testing Method (pilot, back pr.)	Tubing Pressure (Shut-in)	Casing Pressure (Shut-in)	Choke Size

VI. CERTIFICATE OF COMPLIANCE

I hereby certify that the rules and regulations of the Oil Conservation Commission have been complied with and that the information given above is true and complete to the best of my knowledge and belief.

Gerald C. Wilson
(Signature)
Agent
(Title)
December 17, 1975
(Date)

OIL CONSERVATION COMMISSION

DEC 19 1975

APPROVED _____, 19____
BY W. A. Grissett
TITLE SECRETARY, OIL CONSERVATION COMMISSION

This form is to be filed in compliance with RULE 1104.

If this is a request for allowable for a newly drilled or deepened well, this form must be accompanied by a tabulation of the deviation tests taken on the well in accordance with RULE 111.

All sections of this form must be filled out completely for allowable on new and recompleted wells.

Fill out only Sections I, II, III, and VI for changes of owner, well name or number, or transporter, or other such change of condition.

Separate Forms C-104 must be filed for each pool in multiply completed wells.

NO. OF COPIES RECEIVED		5
DISTRIBUTION		
SANTA FE		1
FILE		1
U.S.G.S.		
LAND OFFICE		
TRANSPORTER	OIL	1
	GAS	
OPERATOR		
PRORATION OFFICE		2

NEW MEXICO OIL CONSERVATION COMMISSION
REQUEST FOR ALLOWABLE
AND
AUTHORIZATION TO TRANSPORT OIL AND NATURAL GAS

Form C-104
Supersedes Old C-104 and C-110
Effective 1-1-65

JUN 24 1969

O.C.C.
ARTESIA, OFFICE

I. Operator
GEORGE A. CHASE

Address
P.O. Box 637 ARTESIA, NEW MEXICO

Reason(s) for filling (Check proper box)
 New Well ☐ Change in Transporter of: Oil ☒ Dry Gas ☐
 Recompletion ☐ Casinghead Gas ☐ Condensate ☐
 Change in Ownership ☐ Other (Please explain) **change from Continental Pipe line**

If change of ownership give name and address of previous owner

II. DESCRIPTION OF WELL AND LEASE

Lease Name Hondo	Well No. 1	Pool Name, including Formation Red Lake Grayburg SA	Kind of Lease State, Federal or Fee Federal
Location Unit Letter M ; 330 Feet From The South Line and 990 Feet From The West Line of Section 26 , Township 17S Range 27E , NMPM, Eddy County			

III. DESIGNATION OF TRANSPORTER OF OIL AND NATURAL GAS

Name of Authorized Transporter of Oil <input checked="" type="checkbox"/> or Condensate <input type="checkbox"/> Navajo Refinery Co. Pipeline Division	Address (Give address to which approved copy of this form is to be sent) ARTESIA, NEW MEXICO
Name of Authorized Transporter of Casinghead Gas <input type="checkbox"/> or Dry Gas <input type="checkbox"/>	Address (Give address to which approved copy of this form is to be sent)
If well produces oil or liquids, give location of tanks.	Unit Sec. Twp. Rge. Is gas actually connected? When
M 26 17S 27E	NO

If this production is commingled with that from any other lease or pool, give commingling order number:

IV. COMPLETION DATA

Designate Type of Completion - (X)		Oil Well	Gas Well	New Well	Workover	Deepen	Plug Back	Same Res'v.	Diff. Res'v.
Date Spudded	Date Compl. Ready to Prod.	Total Depth		P.B.T.D.					
Pool	Name of Producing Formation	Top Oil/Gas Pay		Tubing Depth					
Perforations		Depth Casing Shoe							
TUBING, CASING, AND CEMENTING RECORD									
HOLE SIZE	CASING & TUBING SIZE	DEPTH SET		BACKS CEMENT					

V. TEST DATA AND REQUEST FOR ALLOWABLE OIL WELL

(Test must be after recovery of total volume of load oil and must be equal to or exceed top allowable for this depth or be for full 24 hours)

Date First New Oil Run to Tanks	Date of Test	Producing Method (Flow, pump, gas lift, etc.)	
Length of Test	Tubing Pressure	Casing Pressure	Choke Size
Actual Prod. During Test	Oil - Bbls.	Water - Bbls.	Gas - MCF

GAS WELL

Actual Prod. Test-MCF/D	Length of Test	Bbls. Condensate/MMCF	Gravity of Condensate
Testing Method (pilot, back pr.)	Tubing Pressure	Casing Pressure	Choke Size

VI. CERTIFICATE OF COMPLIANCE

I hereby certify that the rules and regulations of the Oil Conservation Commission have been complied with and that the information given above is true and complete to the best of my knowledge and belief.

George A. Chase
(Signature)
Owner
(Title)
6-23-69
(Date)

OIL CONSERVATION COMMISSION

APPROVED _____, 19____
BY *W. A. Grossert*
OIL AND GAS INSPECTOR
TITLE _____

This form is to be filed in compliance with RULE 1104.
If this is a request for allowable for a newly drilled or deepened well, this form must be accompanied by a tabulation of the deviation tests taken on the well in accordance with RULE 111.
All sections of this form must be filled out completely for allowable on new and recompleted wells.
Fill out Sections I, II, III, and VI only for changes of owner, well name or number, or transporter or other such change of condition.
Separate Forms C-104 must be filed for each pool in multiply completed wells.

UNITED STATES
DEPARTMENT OF THE INTERIOR
GEOLOGICAL SURVEYSUBMIT IN T
(Other Instruc. on re-
verse side)Form approved.
Budget Bureau No. 42-R1424.

5. LEASE DESIGNATION AND SERIAL NO.

NM-0557370

6. IF INDIAN, ALLOTTEE OR TRIBE NAME

7. UNIT AGREEMENT NAME

8. FARM OR LEASE NAME

HONDO

9. WELL NO.

1

10. FIELD AND POOL, OR WILDCAT

RED LAKE

11. SEC., T., R., M., OR BLK. AND
SURVEY OR AREA

Sec 26 T17S R27E

12. COUNTY OR PARISH 13. STATE

LODY

NM

SUNDRY NOTICES AND REPORTS ON WELLS

(Do not use this form for proposals to drill or to deepen or plug back to a different reservoir.
Use "APPLICATION FOR PERMIT—" for such proposals.)1. OIL ☒ GAS ☐
WELL WELL OTHER

2. NAME OF OPERATOR

GEORGE A. CHASE

3. ADDRESS OF OPERATOR

PO Box 637 Artesia, New Mexico 88210

4. LOCATION OF WELL (Report location clearly and in accordance with any State requirements.*
See also space 17 below.)
At surface

330/5 + 990/m

14. PERMIT NO.

15. ELEVATIONS (Show whether DF, RT, GR, etc.)

16. Check Appropriate Box To Indicate Nature of Notice, Report, or Other Data

NOTICE OF INTENTION TO:

TEST WATER SHUT-OFF

FRACTURE TREAT

SHOOT OR ACIDIZE

REPAIR WELL

(Other)

PULL OR ALTER CASING

MULTIPLE COMPLETE

ABANDON*

CHANGE PLANS

SUBSEQUENT REPORT OF:

WATER SHUT-OFF

FRACTURE TREATMENT

SHOOTING OR ACIDIZING

(Other)

REPAIRING WELL

ALTERING CASING

ABANDONMENT*

(NOTE: Report results of multiple completion on Well
Completion or Recompletion Report and Log form.)17. DESCRIBE PROPOSED OR COMPLETED OPERATIONS (Clearly state all pertinent details, and give pertinent dates, including estimated date of starting any
proposed work. If well is directionally drilled, give subsurface locations and measured and true vertical depths for all markers and zones perti-
nent to this work.)*

The following work has been performed:

Run 4 1/2 casing to 1594

Cement with 150 sacks

GRAYBURG ZONE: 8/28/68

perforate 10 (.45) holes 1558 to 1568

frac zone using 20,000 gallons water, 18,000 lbs. sand, 750 gallons acid

PENROSE ZONE: 8/31/68

perforate 10 (.45) holes 1095 to 1105.

frac zone using 20,000 gallons water, 16,000 lbs. sand, 250 gallons acid.

9/3/68

clean out, run tubing and rods and put well to pumping.

RECEIVED
OCT-31-1968
U. S. GEOLOGICAL SURVEY
ARTESIA, NEW MEXICO

OCT 7 1968

D. C. C.

ARTESIA, OFFICE

18. I hereby certify that the foregoing is true and correct

SIGNED

(This space for Federal or State office use)

TITLE OWNER

DATE 9/30/68

APPROVED BY

CONDITIONS OF APPROVAL, IF ANY:

TITLE

DISTRICT ENGINEER

DATE

OCT 4 1968

*See Instructions on Reverse Side

Form approved.
Budget Bureau No. 42-R1424.

SUNDRY NOTICES AND REPORTS ON WELLS

(Do not use this form for proposals to drill or to deepen or plug back to a different reservoir.
Use "APPLICATION FOR PERMIT—" for such proposals.)

1.	OIL WELL <input checked="" type="checkbox"/> GAS WELL <input type="checkbox"/> OTHER	7. UNIT AGREEMENT NAME
2.	NAME OF OPERATOR GEORGE E. SHASE	8. FARM OR LEASE NAME HUNDA
3.	ADDRESS OF OPERATOR P. O. BOX 637, ALBUQUERQUE, NEW MEXICO 88210	9. WELL NO. 1
4.	LOCATION OF WELL (Report location clearly and in accordance with any State requirements.* See also space 17 below.) At surface Sec. 26, T. 17S., R. 27E., Sully County, New Mexico (330' N. and 990' W.)	10. FIELD AND POOL, OR WILDCAT RED LARK
		11. SEC., T., R., M., OR BLK. AND SURVEY OR AREA Sec. 26 T17S R27E
14. PERMIT NO.	15. ELEVATIONS (Show whether DF, RT, GR, etc.)	12. COUNTY OR PARISH SULLY
		13. STATE NEW MEXICO

Check Appropriate Box To Indicate Nature of Notice, Report, or Other Data

NOTICE OF INTENTION TO:		SUBSEQUENT REPORT OF:	
TEST WATER SHUT-OFF	<input type="checkbox"/>	PULL OR ALTER CASING	<input type="checkbox"/>
FRACTURE TREAT	<input type="checkbox"/>	MULTIPLE COMPLETE	<input type="checkbox"/>
SHOOT OR ACIDIZE	<input type="checkbox"/>	ABANDON*	<input type="checkbox"/>
REPAIR WELL	<input type="checkbox"/>	CHANGE PLANS	<input type="checkbox"/>
(Other)	<input type="checkbox"/>		<input type="checkbox"/>

(NOTE: Report results of multiple completion on Well Completion or Recommendation Report and Log form.)

17. DESCRIBE PROPOSED OR COMPLETED OPERATIONS (Clearly state all pertinent details, and give pertinent dates, including estimated date of starting any proposed work. If well is directionally drilled, give subsurface locations and measured and true vertical depths for all markers and zones pertinent to this work.) *

to 1020' (i. e. 1607'), 5-1/2" casing set at 1280' with 50 sacks of cement.

we intend to:

Set packer and check water in the formation at 1565', or Premier pay; if no formation water, set 4-1/2" liner 1150' - 1565' with 30 sacks of cement. Perforate Penrose, gas sand at 1100' and frac at same time; will not perforate Premier; will not perforate liner; shoe of liner at 1565'. Will commingle the Penrose and Premier zones. Set pipe on top of pay at 1560'.

To use 750 barrels water and oil at each zone and coarse sand as necessary, or as Dowell recommends, as well as approximately 200 gallons of acid - 100 per zone.

Propose to sell gas to Phillips Petroleum Company, photo of letter from that company dated 2-6-68, by William L. Ware, attached.

RECEIVED
FEB 12 1968
U. S. GEOLOGICAL SURVEY
ARTESIA, NEW MEXICO

18. I hereby certify that the foregoing is true and correct

SIGNED Long A. Chase TITLE _____

~~Wife~~

DATE 2-13-66

(This space for Federal or State office use)

APPROVED BY _____
CONDITIONS OF APPROVAL, IF ANY:

TITLED

DATE _____

(This space for Federal or
APPROVED BY
CONDITIONS OF APPROV
APPROVED

FEB 1

B. L. ELLIOTT

***See Instructions on Reverse Side**

UNITED STATES
DEPARTMENT OF THE INTERIOR
GEOLOGICAL SURVEY

SUBMIT IN TRIPPLICATE*
(Other instructions on reverse side)

Form approved.
Budget Bureau No. 42-R1424.
5. LEASE DESIGNATION AND SERIAL NO. 7

LC 050158

SUNDRY NOTICES AND REPORTS ON WELLS

(Do not use this form for proposals to drill or to deepen or plug back to a different reservoir. Use "APPLICATION FOR PERMIT" for such proposals.)

1. OIL <input checked="" type="checkbox"/> WELL GAS <input type="checkbox"/> WELL OTHER <input type="checkbox"/>		7. UNIT AGREEMENT NAME M	
2. NAME OF OPERATOR GEORGE A. CHASE		8. FARM OR LEASE NAME HONDC	
3. ADDRESS OF OPERATOR P. O. Box 637, ARTESIA, NEW MEXICO - 88210		9. WELL NO. 1	
4. LOCATION OF WELL (Report location clearly and in accordance with any State requirements. See also space 17 below.) At surface 330 feet from South line and 990 feet from a line of Section 26 SW, SW, T 17S, R 27E, Meridian N M P M, Red Lake Field, Eddy County, New Mexico		10. FIELD AND POOL, OR WILDCAT Red Lake	
11. SEC., T., R., M., OR BLK. AND SURVEY OR AREA Sec. 26, T 17S, R 27E		12. COUNTY OR PARISH Eddy	
13. STATE New Mexico		14. PERMIT NO.	
15. ELEVATIONS (Show whether DF, RT, GR, etc.)		16. COUNTY OR PARISH	

16. Check Appropriate Box To Indicate Nature of Notice, Report, or Other Data

NOTICE OF INTENTION TO:

TEST WATER SHUT-OFF

FRACTURE TREAT

SHOOT OR ACIDIZE

REPAIR WELL

(Other)

PULL OR ALTER CASING

MULTIPLE COMPLETE

ABANDON*

CHANGE PLANS

X

SUBSEQUENT REPORT OF:

WATER SHUT-OFF

FRACTURE TREATMENT

SHOOTING OR ACIDIZING

(Other)

REPAIRING WELL

ALTERING CASING

ABANDONMENT*

(NOTE: Report results of multiple completion on Well Completion or Recompletion Report and Log form.)

17. DESCRIBE PROPOSED OR COMPLETED OPERATIONS (Clearly state all pertinent details, and give pertinent dates, including estimated date of starting any proposed work. If well is directionally drilled, give subsurface locations and measured and true vertical depths for all markers and zones pertinent to this work.)*

Well placed on production June 10, 1963

RECEIVED

JAN 10 1964

O. C. C.
ARTESIA, OFFICE

RECEIVED

JAN 9 1964
U. S. GEOLOGICAL SURVEY
ARTESIA, NEW MEXICO

18. I hereby certify that the foregoing is true and correct

SIGNED George A. Chase

TITLE Owner

DATE January 7, 1964

(This space for Federal or State office use)

APPROVED BY
CONTRIBUTING OFFICE OF APPROVAL, IF ANY:

TITLE

DATE

*See Instructions on Reverse Side

APPROVED
JAN 10 1964

R. L. BEECHMAN
DISTRICT ENGINEER

COPIES RECEIVED	
DISTRIBUTION	
SANTA FE	
FILE	
U.S. OIL	
LAND OFFICE	
TRANSPORTER	OIL
	GAS
PRODUCTION OFFICE	
OPERATION	

NEW MEXICO OIL CONSERVATION COMMISSION
SANTA FE, NEW MEXICO
CERTIFICATE OF COMPLIANCE AND AUTHORIZATION
TO TRANSPORT OIL AND NATURAL GAS

FORM C-110
 (Rev. 7-60)

FILE THE ORIGINAL AND 4 COPIES WITH THE APPROPRIATE OFFICE

Company or Operator George A. Chase				Lease Hondo		Well No. 1	
Unit Letter M	Section 26	Township 17-S	Range 37 28-E	County Eddy			
Pool Red Lake				Kind of Lease (State, Fed Fee) Federal			
If well produces oil or condensate give location of tanks		Unit Letter M	Section 26	Township 17S	Range 28E		
Authorized transporter of oil <input checked="" type="checkbox"/> or condensate <input type="checkbox"/> Continental Pipe Line				Address (give address to which approved copy of this form is to be sent) Box 367, Artesia, New Mexico			
Is Gas Actually Connected? Yes _____ No <u>XX</u>							
Authorized transporter of casing head gas <input type="checkbox"/> or dry gas <input type="checkbox"/>		Date Connected	Address (give address to which approved copy of this form is to be sent)				
No Gas							

If gas is not being sold, give reasons and also explain its present disposition:

No Gas

REASON(S) FOR FILING (please check proper box)

New Well <input type="checkbox"/>	Change in Ownership <input checked="" type="checkbox"/>
Change in Transporter (check one)	Other (explain below)
Oil <input type="checkbox"/> Dry Gas <input type="checkbox"/>	
Casing head gas . <input type="checkbox"/> Condensate . <input type="checkbox"/>	

RECEIVED
JUN 13 1963
O. O. O.
ARTESIA, OFFICE

Remarks

Change operator from A. J. Smith to George A. Chase.
Change Lease & Well from Harbold #5 to Hondo Well #1

The undersigned certifies that the Rules and Regulations of the Oil Conservation Commission have been complied with.

Executed this the **10** day of **June**, 19 **63**.

OIL CONSERVATION COMMISSION		By <i>George A. Chase</i> Title Owner
Approved by <i>M. L. Christy</i> Title AN APPRAISER INSPECTOR	Company George A. Chase	
Date JUN 13 1963	Address 808 Clayton <small>Artesia, New Mexico</small>	

APPROVED

JUN 4 1963
X RONNIE E. SHOOK
ACTING DISTRICT ENGINEER

(SUBMIT IN TRIPLICATE) 04

UNITED STATES
DEPARTMENT OF THE INTERIOR
GEOLOGICAL SURVEY

Land Office _____
Lease No. **LC 050198**
Unit **M**

RECEIVED

SUNDRY NOTICES AND REPORTS ON WELLS

NOTICE OF INTENTION TO DRILL		SUBSEQUENT REPORT OF WATER SHUT-OFF	
NOTICE OF INTENTION TO CHANGE PLANS	XX	SUBSEQUENT REPORT OF SHOOTING OR ACIDIZING	
NOTICE OF INTENTION TO TEST WATER SHUT-OFF		SUBSEQUENT REPORT OF ALTERING CASING	
NOTICE OF INTENTION TO RE-DRILL OR REPAIR WELL		SUBSEQUENT REPORT OF RE-DRILLING OR REPAIR	
NOTICE OF INTENTION TO SHOOT OR ACIDIZE		SUBSEQUENT REPORT OF ABANDONMENT	
NOTICE OF INTENTION TO PULL OR ALTER CASING		SUPPLEMENTARY WELL HISTORY	
NOTICE OF INTENTION TO ABANDON WELL			

(INDICATE ABOVE BY CHECK MARK NATURE OF REPORT, NOTICE, OR OTHER DATA)

May 24, 1963

Well No. **1** is located **330** ft. from **XX** line and **990** ft. from **XX** line of sec. **26**
(formerly well #5 Harbold)
SW 1/4 (1/4 Sec. and Sec. No.) **T-17-N** (Twp.) **R-27-E** (Range) **N M P M** (Meridian)
Red Lake (Field) **Eddy** (County or Subdivision) **New Mexico** (State or Territory)

The elevation of the derrick floor above sea level is _____ ft.

DETAILS OF WORK

(State names of and expected depths to objective sands; show sizes, weights, and lengths of proposed casings; indicate mudding jobs, cementing points, and all other important proposed work)

Well designation on

Owen Haynes Well #5- Harbold will be changed to George A. Chase Well #1 Honda

Well is presently shut in. Request permission to place on pump and put back on production.

I understand that this plan of work must receive approval in writing by the Geological Survey before operations may be commenced.

Company **George A. Chase**
(Formerly Owen Haynes Operator)
Address **808 Clayton**
Artesia, New Mexico
By **George A. Chase**
Title **Owner**

SANTA FE
ARTESIA
HOBBS
OPERATOR

OIL CONSERVATION COMMISSION
STATE OF NEW MEXICO

Form C-110

CERTIFICATE of COMPLIANCE and AUTHORIZATION to TRANSPORT OIL

Company or Operator A. J. Smith Lease Harbold
Address Box 1111 Artesia, New Mexico
(Local or Field Office) (Principal Place of Business)
Unit M Wells No. 5 Sec. 26 T. 17 R. 27 Field Red Lake County Eddy
Kind of Lease Federal Location of Tanks On Lease
Transporter Artesia Pipe Line Co. Address of Transporter Artesia, New Mexico
Artesia, New Mexico (Local or Field Office)
Percent of oil to be transported 100 Other transporters author-
(Principal Place of Business) ized to transport oil from this unit are _____ %
REMARKS:

I have purchased this well, formerly known as Owen Haynes, Harbold # 5.

Date of purchase ~~April 1, 1952~~ Mar. 25, 1952

The undersigned certifies that the rules and regulations of the Oil Conservation Commission have been complied with except as noted above and that gathering agent is authorized to transport the percentages of oil produced from the above described property and that this authorization will be valid until further notice to the transporter named herein or until cancelled by the Oil Conservation Commission of New Mexico.

Executed this the 8th day of May, 1952

A. J. Smith

(Company or Operator)

By Erma G. Williams

Title Agent

State of New Mexico

County of Eddy

ss.

Before me, the undersigned authority, on this day personally appeared Erma G. Williams known to me to be the person whose name is subscribed to the above instrument, who being by me duly sworn on oath states that he is authorized to make this report and has knowledge of the facts stated herein and that said report is true and correct.

Subscribed and sworn to before me, this the 8th day of May, 1952

Notary Public in and for Eddy County, New Mexico

Approved: MAY 9 1952 1952

OIL CONSERVATION COMMISSION

By R. A. Hanson

(See Instructions on Reverse Side)

OIL CONSERVATION COMMISSION

Form 9-200

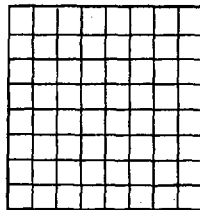

LOCATE WELL CORRECTLY

U. S. LAND OFFICE Las CrucesSERIAL NUMBER 050158

LEASE OR PERMIT TO PRODUCE

UNITED STATES
DEPARTMENT OF THE INTERIOR
GEOLOGICAL SURVEY

LOG OF OIL OR GAS WELL

Company Owen Haynes Address Box 981, Artesia, New Mexico
Lessor or Tract Harbold Field Red Lake Ext. State New Mexico
Well No. 5 Sec. 26 T. 17 R. 27 Meridian N.M.P.M. County Sday
Location 330 ft. (N) of S Line and 220 ft. (E) of W Line of 26 Elevation _____

The information given herewith is a complete and correct record of the well and all work done thereon so far as can be determined from all available records.

Date March 20, 1952 Signed Estelita D. Rodriguez
Title Agent

The summary on this page is for the condition of the well at above date.
Commenced drilling 8-10-51, 19____ Finished drilling 2-13-52, 19____

OIL OR GAS SANDS OR ZONES

(Denote gas by G)

No. 1, from 110 to 115 No. 4, from _____ to _____
No. 2, from 1002 to 1011 No. 5, from _____ to _____
No. 3, from 1571 to 1607 No. 6, from _____ to _____

IMPORTANT WATER SANDS

No. 1, from _____ to _____ No. 3, from _____ to _____
No. 2, from _____ to _____ No. 4, from _____ to _____

CASING RECORD

Size casing	Weight per foot	Threads per foot	Make	Amount	Kind of shoe	Cut and pulled from	Perforated	Purpose
8-5/8	62	15	used	621				
MISCELLANEOUS RECORD OF CEMENT								

MUDDING AND CEMENTING RECORD

Size casing	Weight per foot	Number sacks of cement	Method used	Kind of gravel	Amount of mud used
8-5/8	62	15			
7	910	25			
5-1/2	1280	50			

PLUGS AND ADAPTERS

Heaving plug—Material _____ Length _____ Depth set _____
Adapters—Material _____ Size _____

SHOOTING RECORD

Size	Shots used	Explosive used	Quantity	Date	Depth shot	Depth cleaned out
		Nitro-gly	120 qts		1571-1607	1607

TOOLS USED

Rotary tools were used from _____ feet to _____ feet, and from _____ feet to _____ feet
Cable tools were used from _____ feet to 1620 feet, and from _____ feet to _____ feet

DATES

Put to producing March 1, 1952

The production for the first 24 hours was _____ barrels of fluid of which _____ % was oil; _____ % emulsion; _____ % water; and _____ % sediment. Gravity, "B4"

If gas well, cu. ft. per 24 hours _____ Gallons gasoline per 1,000 cu. ft. of gas _____

Rock pressure, lbs. per sq. in. _____

EMPLOYEES

Driller _____, Driller _____
Driller _____, Driller _____

FORMATION RECORD

FROM-	TO-	TOTAL FEET	FORMATION
48	72		Broken anhy
72	130		red bed
130	190		anhy & red bed
190	230		anhy
230	262		red bed
262	285		broken anhy
285	365		anhy
365	370		red bed
370	395		anhy, white & hard
395	398		anhy
398	461		Brown lime
461	467		anhy
467	470		red bed
470	475		Brown lime, Show of oil
475	480		anhy
480	485		anhy
485	490		anhy
490	495		lime
495	505		clay, blue
505	575		exp. lime
575	595		brown shale
595	625		blue shale
625	630		lime
630	635		

FROM-	TO-	TOTAL FEET	FORMATION
435	440		red-bed, sandy
440	450		sandy
450	460		red sand
460	470		sandy
470	480		live shale
480	490		sandy red rock
490	505		sandy
505	513		sandy lime
513	520		lime
520	1010		sandy
1010	1025		sandy red rock
1025	1090		sandy
1090	1285		sandy, show of gas 1090-1107
1285	1299		brown lime
1299	1322		lime
1322	1345		sandy
1345	1577		lime
1577	1581		sand, sandy dolomite
1581	1592		sand
1592	1600		sandy lime
1600	1607		sand & lime
1607	1611		sand
1611	1620		lime TO Plugged back to 1607

EMPLOYEES

[illegible]

Служба поощрения и наказания	1967 по	1967 по	1967 по
Контроль за исполнением наказаний	1967 по	1967 по	1967 по

ALL INFORMATION CONTAINED HEREIN IS UNCLASSIFIED
DATE 08-19-2007 BY 60322 UCBAW/SJS

DATE 08-19-2007 BY 60322 UCBAW/SJS

ALL INFORMATION CONTAINED HEREIN IS UNCLASSIFIED
DATE 08-19-2007 BY 60322 UCBAW/SJS

DATE 08-19-2007 BY 60322 UCBAW/SJS

YIPWANG BING - YIPWANG BING

REPORT DATE: 11/11/64	REPORT TYPE: ANNUAL	REPORT PERIOD: 10/1/64 - 9/30/65	REPORTING OFFICE: FBI - NEW YORK
TITLE: [REDACTED]	CHARACTER OF CASE: [REDACTED]	SYNOPSIS: [REDACTED]	DETAILS: [REDACTED]
1. [REDACTED]	2. [REDACTED]	3. [REDACTED]	4. [REDACTED]
5. [REDACTED]	6. [REDACTED]	7. [REDACTED]	8. [REDACTED]
9. [REDACTED]	10. [REDACTED]	11. [REDACTED]	12. [REDACTED]
13. [REDACTED]	14. [REDACTED]	15. [REDACTED]	16. [REDACTED]
17. [REDACTED]	18. [REDACTED]	19. [REDACTED]	20. [REDACTED]
21. [REDACTED]	22. [REDACTED]	23. [REDACTED]	24. [REDACTED]
25. [REDACTED]	26. [REDACTED]	27. [REDACTED]	28. [REDACTED]
29. [REDACTED]	30. [REDACTED]	31. [REDACTED]	32. [REDACTED]
33. [REDACTED]	34. [REDACTED]	35. [REDACTED]	36. [REDACTED]
37. [REDACTED]	38. [REDACTED]	39. [REDACTED]	40. [REDACTED]
41. [REDACTED]	42. [REDACTED]	43. [REDACTED]	44. [REDACTED]
45. [REDACTED]	46. [REDACTED]	47. [REDACTED]	48. [REDACTED]
49. [REDACTED]	50. [REDACTED]	51. [REDACTED]	52. [REDACTED]
53. [REDACTED]	54. [REDACTED]	55. [REDACTED]	56. [REDACTED]
57. [REDACTED]	58. [REDACTED]	59. [REDACTED]	60. [REDACTED]
61. [REDACTED]	62. [REDACTED]	63. [REDACTED]	64. [REDACTED]
65. [REDACTED]	66. [REDACTED]	67. [REDACTED]	68. [REDACTED]
69. [REDACTED]	70. [REDACTED]	71. [REDACTED]	72. [REDACTED]
73. [REDACTED]	74. [REDACTED]	75. [REDACTED]	76. [REDACTED]
77. [REDACTED]	78. [REDACTED]	79. [REDACTED]	80. [REDACTED]
81. [REDACTED]	82. [REDACTED]	83. [REDACTED]	84. [REDACTED]
85. [REDACTED]	86. [REDACTED]	87. [REDACTED]	88. [REDACTED]
89. [REDACTED]	90. [REDACTED]	91. [REDACTED]	92. [REDACTED]
93. [REDACTED]	94. [REDACTED]	95. [REDACTED]	96. [REDACTED]
97. [REDACTED]	98. [REDACTED]	99. [REDACTED]	100. [REDACTED]

[illegible]

It is of the greatest importance to have a complete history of the well. Please state in detail the dates of redrilling, together with the reasons for the work and its results. If there were any changes made in the casing, state fully, and if any casing was "backtracked" or left in the well, give length and location. If the well has been dynamited, give date, size, position, and number of shots. If plugs or bridges were put in to test for water, state kind of material used, position, and results of pumping or bail-

No. 3' from		No. 4' from	
-------------	--	-------------	--

[illegible]

THE INFORMATION ON THIS CARD IS TO BE CONTAINED BY THE FBI IN THE FOLLOWING MANNER:

GEOLOGICAL SURVEY
 DEPARTMENT OF THE INTERIOR
 UNITED STATES

OIL CONSERVATION COMMISSION
Santa Fe, New Mexico

REQUEST FOR (OIL)-(GAS) ALLOWABLE

It is necessary that this form be submitted by the operator before an initial allowable will be assigned to any completed oil or gas well. Form C-110 (Certificate of Compliance and Authorization to Transport Oil) will not be approved until Form C-104 is filed with the Commission. Form C-104 is to be submitted in triplicate to the office to which Form C-101 was sent. Two copies will be retained there and the other submitted to the Proration Office, Hobbs, New Mexico. The allowable will be assigned effective 7:00 a.m. on date of completion, provided completion report is filed during month of completion. The completion date shall be that date in the case of an oil well when oil is delivered into the stock tanks. Gas must be reported on 15.025 P.B. at 60° Fahrenheit.

Artesia, New Mexico

Place

March 12, 1952

Date

WE ARE HEREBY REQUESTING AN ALLOWABLE FOR A WELL KNOWN AS:

Open Haynes Harbold Well No. 5 in SW 1/4 SW 1/4
 Company or Operator Lessee
 section 26, T. 17, R. 27, N.M.P.M. Red Lake Ext. Pool Body County

Please indicate location: Elevation _____ Spudded 8-10-51 Completed 2-19-52

Total Depth 1621 P.B. _____
 Top Oil/Gas Pay 1568 Top Water Pay _____
 Initial Production Test: Pump 52 Flow _____ (BOPD OR CU. FT.)
 Based on _____ Bbls. Oil in _____ Mins. _____
 Method of Test (Pitot, gauge, prover, meter run): _____
 Size of choke in inches _____
 Tubing (Size) 2" _____ 1589.49 Feet
 Pressures: Tubing _____ Casing 350 lbs.
 Gas/Oil Ratio _____ Gravity _____
 Casing Perforations: _____

Unit letter: M

Casing & Cementing Record

Size	Feet	Sax
<u>8-5/8"</u>	<u>623</u>	<u>15</u>
<u>7"</u>	<u>910</u>	<u>25</u>
<u>5-1/2"</u>	<u>1280</u>	<u>50</u>

Acid Record:

_____ Gals _____ to _____ S/ _____
 _____ Gals _____ to _____ S/ _____
 _____ Gals _____ to _____ S/ _____
 Shooting Record.
120 Qts 1571 to 1607 S/ _____
 _____ Qts _____ to _____ S/ _____
 _____ Qts _____ to _____ S/ _____

Show of Oil, Gas and water

Natural Production Test: _____ Pumping _____ Flowing _____
 Test after acid or shot: _____ Pumping _____ Flowing _____

Please indicate below Formation Tops (in conformance with geographical section of state):

Southeastern New Mexico

Northwestern New Mexico

T. Anhy _____	T. Devonian _____	T. Ojo Alamo _____
T. Salt _____	T. Silurian _____	T. Kirtland-Fruitland _____
B. Salt _____	T. Montoya _____	T. Farmington _____
T. Yates _____	T. Simpson _____	T. Pictured Cliffs _____
T. 7 Rivers _____	T. McKee _____	T. Cliff House _____
T. Queen _____	T. Ellenburger _____	T. Wenefee _____
T. Grayburg _____	T. Gr. Wash _____	T. Point Lookout _____
T. San Andres _____	T. Granite _____	T. Mancos _____
T. Glorieta _____	T. _____	T. Dakota _____
T. Drinkard _____	T. _____	T. Morrison _____
T. Tubbs _____	T. _____	T. Penn _____
T. Abo _____	T. _____	T. _____
T. Penn _____	T. _____	T. _____
T. Miss _____	T. _____	T. _____

Date first oil run to tanks or gas to pipe line: March 1, 1952

Pipe line taking oil or gas: Artesia Pipe Line

Remarks: We need a temporary allowable in order to empty the
tank and allow us to run a test on the well.

Owen Haynes
Company or Operator

By: Ernest B. Williams
Signature

Position: Agent

Send communications regarding well to:

Name: _____

Address: _____

APPROVED _____, 19__

OIL CONSERVATION COMMISSION

By: R. A. Johnson

Title: CHIEF ENGINEER

**OIL CONSERVATION COMMISSION
STATE OF NEW MEXICO**

CERTIFICATE of COMPLIANCE and AUTHORIZATION to TRANSPORT OIL

Company or Operator Owen Haynes Lease Harbold
 Address Box 981 Artesia, New Mexico
 (Local or Field Office) (Principal Place of Business)
 Unit M Wells No. 5 Sec. 26 T 17 R 27 Field Red Lake County Eddy
 Kind of Lease Federal Location of Tanks On Lease
 Transporter Artesia Pipe Line Co. Address of Transporter Artesia, New Mexico
 (Local or Field Office)
Artesia, New Mexico Percent of oil to be transported 100. Other transporters author-
 ized to transport oil from this unit are _____ %
 REMARKS:

New Well

The undersigned certifies that the rules and regulations of the Oil Conservation Commission have been complied with except as noted above and that gathering agent is authorized to transport the percentages of oil produced from the above described property and that this authorization will be valid until further notice to the transporter named herein or until cancelled by the Oil Conservation Commission of New Mexico.

Executed this the 12th day of March, 1952

OWEN HAYNES

(Company or Operator)

By Erma G. Williams

Title Agent

State of NEW MEXICO

County of EDDY

Before me, the undersigned authority, on this day personally appeared Erma G. Williams known to me to be the person whose name is subscribed to the above instrument, who being by me duly sworn on oath states that he is authorized to make this report and has knowledge of the facts stated herein and that said report is true and correct.

Subscribed and sworn to before me, this the 12th day of March, 1952

Notary Public in and for Eddy County, New Mexico

Approved: 1952 195

OIL CONSERVATION COMMISSION

By R. P. Benson

(See Instructions on Reverse Side)

(SUBMIT IN TRIPLICATE)

UNITED STATES
DEPARTMENT OF THE INTERIOR
GEOLOGICAL SURVEY

Land Office Las Cruces
Lease No. 05015
Unit _____

SUNDRY NOTICES AND REPORTS ON WELLS

NOTICE OF INTENTION TO DRILL		SUBSEQUENT REPORT OF WATER SHUT-OFF	
NOTICE OF INTENTION TO CHANGE PLANS		SUBSEQUENT REPORT OF SHOOTING OR ACIDIZING	
NOTICE OF INTENTION TO TEST WATER SHUT-OFF		SUBSEQUENT REPORT OF ALTERING CASING	
NOTICE OF INTENTION TO RE-DRILL OR REPAIR WELL		SUBSEQUENT REPORT OF REDRILLING OR REPAIR	
NOTICE OF INTENTION TO SHOOT OR ACIDIZE		SUBSEQUENT REPORT OF ABANDONMENT	
NOTICE OF INTENTION TO PULL OR ALTER CASING		SUPPLEMENTARY WELL HISTORY	
NOTICE OF INTENTION TO ABANDON WELL			

(INDICATE ABOVE BY CHECK MARK NATURE OF REPORT, NOTICE, OR OTHER DATA)

July 9, 1941

Well No. Harbold 55 is located 310 ft. from N line and 20 ft. from E line of sec. 26
33 13 13 26 17S 37E N.M.P.M.
(14 Sec. and Sec. No.) (Twp.) (Range) (Meridian)
Empire Ext. Alamogordo New Mexico
(Field) (County or Subdivision) (State or Territory)

The elevation of the derrick floor above sea level is _____ ft.

DETAILS OF WORK

(State names of and expected depths to objective sands; show sizes, weights, and lengths of proposed casings; indicate mudding jobs, cementing points, and all other important proposed work)

We propose to drill to approximately 1600' and will set 6" casing at approximately 300'.

I understand that this plan of work must receive approval in writing by the Geological Survey before operations may be commenced.

Company Over Hayden
Address Box 901
Artesia, New Mexico
By Emma H. Williams
Title Asst. Geol.

WELL S T R	JAN	FEB	MAR	APRIL	MAY	JUNE	JULY	AUG	SEPT	OCT	NOV	DEC	YR-PROD MP	ACCUM.
13A 718527E OIL	INJECTION WELL													29988
14H 718527E OIL	INJECTION WELL													25413
15H 718527E OIL	135	150	190	170	180	180	150	180	190	185	195	194	2099P	36205
16I 718527E OIL	199	195	253	243	331	353	313	363	323	163	171	170	3079	
17M 718527E OIL	170	225	285	255	270	270	225	270	285	277	292	291	3015	49375
18D 818527E OIL	INJECTION WELL													30149
19E 818527E OIL	51	559	1014	925	943	1047	1015	918	884	938	956	1081	10331	754
20F 818527E OIL	64	80	100	70	80	80	60	70	75	78	75	75	905P	15734
21P 818527E OIL	579	433	810	602	347	645	527	592	534	312	332	331	6264	6710
22R 818527E OIL	LAST PROD. PRIOR TO 6/73													1590
23S 818527E OIL	LAST PROD. PRIOR TO 6/73													81011
24T 818527E OIL	LAST PROD. PRIOR TO 6/73													50332
25A 818527E OIL	80	100	120	120	106	106	90	90	95	94	96	96	1193	
26I 818527E OIL	118	130	159	138	76	86	73	70	65	57	67	67	1137	
27M 418527E OIL	32	32	38	37	33	33	28	28	30	30	30	30	378	20692
28I 818527E OIL	170	200	240	210	215	205	230	200	205	200	210	209	2494P	83926
29I 818527E OIL	347	360	441	414	147	155	180	150	129	117	139	138	2717	
30N 418527E OIL	98	96	68	59	61	58	65	56	58	56	59	59	743	
31C 918527E OIL	170	200	240	210	215	205	235	200	205	200	210	209	2499P	85746
32I 818527E OIL	522	542	664	623	284	298	354	290	291	295	313	311	4787	
33I 818527E OIL	160	160	72	63	64	61	70	60	60	60	63	62	756	
34I 818527E OIL	180	220	250	250	250	240	210	210	210	210	210	210	210	96778
35I 818527E OIL	555	558	694	692	251	246	285	222	102	99	110	108	5922	
36I 818527E OIL	69	79	73	73	75	76	82	66	66	66	69	69	796	
37I 818527E OIL	160	210	230	173	75	180	180	190	196	191	201	200	2681P	36713
38I 818527E OIL	246	280	318	257	291	313	341	348	353	374	366	355	555	
39I 818527E OIL	82	89	89	67	64	64	70	74	76	74	78	78	859	
40N 418527E OIL	LAST PROD. PRIOR TO 6/73													19622
41C 918527E OIL	270	240	320	300	359	302	831	958	1249	1139	1331	1323	11090	35193
42I 818527E OIL	620	457	647	650	674	643	723	723	723	723	723	723	1305	
43I 818527E OIL	95	89	118	111	119	111	92	111	115	111	117	116	1305	
COMPANY TOTAL OIL	2887	2941	3597	3292	3284	2916	2721	2950	3004	2916	2967	2932	36407	1548659
44I 818527E OIL	1163	1349	1647	1534	1642	1390	1275	1962	2020	1945	1953	1949	19802	

B AND D OIL CO

1C3617527E OIL	175	155	160	162	162	140	150	149	139	140	140	139	1811P	91002
3A3317527E OIL	875	775	800	810	810	700	750	745	695	700	700	417	8777	
4B3517527E OIL	13	14	14	15	15	14	16	15	14	15	15	15	177P	5759
5C3517527E OIL	80	65	70	75	75	70	80	75	70	75	75	45	855	79542
6F3517527E OIL	LAST PROD. PRIOR TO 6/73													28018
7H3517527E OIL	INJECTION WELL													54742
8I3517527E OIL	INJECTION WELL													54742
9F3617527E OIL	INJECTION WELL													11588
10G3617527E OIL	INJECTION WELL													36693
11G3617527E OIL	LAST PROD. PRIOR TO 6/73													5875
12F3617527E OIL	INJECTION WELL													1406
13E3617527E OIL	22	15	16	17	15	14	16	15	14	15	15	15	189P	37975
14H3517527E OIL	110	75	80	85	85	70	80	75	70	75	75	75	75	26820
15G3517527E OIL	20	77	76	76	76	300	325	320	270	275	265	150	3859	
16H3517527E OIL	40	385	390	390	340	300	325	320	270	275	265	150	186P	73002
17K3517527E OIL	100	75	80	80	75	70	80	75	70	75	75	45	900	
18J3517527E OIL	LAST PROD. PRIOR TO 6/73													68337
19K3517527E OIL	LAST PROD. PRIOR TO 6/73													7256
20J3517527E OIL	INJECTION WELL													30154
21J3517527E OIL	INJECTION WELL													11737
22K3617527E OIL	INJECTION WELL													11737
23K3617527E OIL	INJECTION WELL													55759
24I3517527E OIL	LAST PROD. PRIOR TO 6/73													191
25I3517527E OIL	LAST PROD. PRIOR TO 6/73													38104
26I3517527E OIL	80	30	35	35	70	52	55	54	44	45	43	42	697P	85235
27I3517527E OIL	400	350	354	355	350	260	275	270	220	225	215	176	3401	
28I3517527E OIL	15	15	16	17	16	15	15	16	14	15	15	15	184P	12402
29K3517527E OIL	75	75	80	80	80	75	75	70	70	75	75	45	75	
30K3517527E OIL	12	12	10	10	10	15	15	10	10	10	10	10	174P	19596
31I3517527E OIL	30	24	25	25	24	20	22	21	18	19	19	19	844P	9574
32I3517527E OIL	150	120	125	125	120	100	110	105	90	95	95	97	1292	
33I3517527E OIL	34	135	128	140	135	150	150	140	125	130	130	130	1623	111578
34I3517527E OIL	INJECTION WELL													28002
35I3517527E OIL	INJECTION WELL													20290
36I3517527E OIL	LAST PROD. PRIOR TO 6/73													17760
37I3517527E OIL	190	150	160	160	160	140	150	140	125	130	130	130	353P	14019
38I3517527E OIL	38	30	32	32	32	28	30	28	25	26	26	26	353P	9098
39I3517527E OIL	150	150	160	160	160	140	150	140	125	130	130	130	353P	6237
40I3517527E OIL	150	110	110	110	110	125	125	125	110	115	115	115	284P	10920
41I3517527E OIL	150	110	110	110	110	125	125	125	110	115	115	115	284P	29286
42I3517527E OIL	150	110	110	110	110	125	125	125	110	115	115	115	284P	32529
43I3517527E OIL	150	110	110	110	110	125	125	125	110	115	115	115	284P	22863
44I3517527E OIL	150	110	110	110	110	125	125	125	110	115	115	115	284P	30358
45I3517527E OIL	150	110	110	110	110	125	125	125	110	115	115	115	284P	22853
46I3517527E OIL	150	110	110	110	110	125	125	125	110	115	115	115	284P	629
COMPANY TOTAL OIL	665	561	577	587	568	516	549	538	469	483	479	477	6469	1238634
47I3517527E OIL	3325	2805	2885	2935	2845	2580	2745	2690	2345	2415	2395	1431	31396	
BEATRICE BEDDINGFIELD														
ASTON AND FAIR														
1F3117528E OIL	20	22	22	72	19	19	17	16	17	16	17	14	271P	15956
2H3617527E OIL	8	9	6	7	8	25	11	7	8	10	8	15	122P	27045
3I3617527E OIL	115	126	87	138	132	83	137	73	119	72	99	100	1281P	22091
4J3617527E OIL	143	157	115	217	159	127	165	96	144	98	124	129	1674	65092
COMPANY TOTAL OIL														
COLLIER AND COLLIER														
HARBOLD														
12E3517527E OIL	58	44	43	47	50	40	47	44	42	8	5	42	470P	37759
2F3517527E OIL	8	8	9	9	10	8	8	8	8	25	25	25	68P	
3G3517527E OIL	11	11	11	11	11	11	11	11	11	11	11	11	11P	11801
4H3517527E OIL	19	16	14	18	18	17	16	17	16	6	8	14	179P	40906
5I3517527E OIL	19	16	14	18	18	17	16	17	16	6	8	14	179P	
6J3517527E OIL	28	28	29	26	31	27	18	3	3	14	30	19	256P	46838
7K3517527E OIL	116	98	114	76	56	12	12	2	2	14	30	19	256P	
8L3517527E OIL	29	28	29	26	31	27	18	3	3	14	30	19	256P	8149
9M3517527E OIL	117	99	113	76	57	13	12	2	2	14	30	19	256P	
10N3517527E OIL	21	22	20	14	23	24	13	22	15	25	16	27	242P	12957
11O3517527E OIL	91	48	12	121	72	49	71	51	71	59	60	40	718P	28223
12P3517527E OIL	90	34	64	91	53	6	22	109	28	60	51	59	667P	28663
13Q3517527E OIL	7	6	7	12	11	10	10	5	18	7	10	15	118P	6

1977

SOUTHEASTERN NEW MEXICO

I N D E X

<u>VOLUME I</u>	<u>PAGE</u>
ACTIVITY DATA BY COUNTY AND POOL	I
MONTHLY, ANNUAL AND CUMULATIVE OIL, GAS AND WATER PRODUCTION BY COUNTY	XVII
MONTHLY, ANNUAL AND CUMULATIVE OIL, GAS AND WATER BY POOL	XVII
MONTHLY, ANNUAL AND CUMULATIVE DRY GAS AND DISTILLATE BY POOL	XXXIII
MONTHLY, ANNUAL AND CUMULATIVE OIL, GAS AND WATER BY OPERATOR	1-467
MONTHLY, ANNUAL AND CUMULATIVE DRY GAS AND DISTILLATE BY OPERATOR	468-537
EXTRACTION PLANTS	538-543
BOTTOM HOLE PRESSURES	544-550
ANNUAL 72-HOUR GAS WELL SHUT-IN PRESSURES	551-584

ABBREVIATIONS IN METHOD OF PRODUCTION COLUMN

F FLOWING G GAS LIFT P PUMPING

ABBREVIATIONS IN STATUS

X	PERMANENTLY ABANDONED	I	INPUT
T	TEMPORARILY ABANDONED	U	UNREPORTED
S	SHUT-IN	D	DISCONNECTED

ALL GAS IN M. C. F.