

ABOVE THIS LINE FOR DIVISION USE ONLY

**NEW MEXICO OIL CONSERVATION DIVISION**  
- Engineering Bureau -  
1220 South St. Francis Drive, Santa Fe, NM 87505



**ADMINISTRATIVE APPLICATION CHECKLIST**

THIS CHECKLIST IS MANDATORY FOR ALL ADMINISTRATIVE APPLICATIONS FOR EXCEPTIONS TO DIVISION RULES AND REGULATIONS WHICH REQUIRE PROCESSING AT THE DIVISION LEVEL IN SANTA FE

**Application Acronyms:**

- [NSL-Non-Standard Location] [NSP-Non-Standard Proration Unit] [SD-Simultaneous Dedication]  
 [DHC-Downhole Commingling] [CTB-Lease Commingling] [PLC-Pool/Lease Commingling]  
 [PC-Pool Commingling] [OLS - Off-Lease Storage] [OLM-Off-Lease Measurement]  
 [WFX-Waterflood Expansion] [PMX-Pressure Maintenance Expansion]  
 [SWD-Salt Water Disposal] [IPI-Injection Pressure Increase]  
 [EOR-Qualified Enhanced Oil Recovery Certification] [PPR-Positive Production Response]

[1] **TYPE OF APPLICATION** - Check Those Which Apply for [A]

- [A] Location - Spacing Unit - Simultaneous Dedication  
 NSL  NSP  SD

Check One Only for [B] or [C]

- [B] Commingling - Storage - Measurement  
 DHC  CTB  PLC  PC  OLS  OLM

- [C] Injection - Disposal - Pressure Increase - Enhanced Oil Recovery  
 WFX  PMX  SWD  IPI  EOR  PPR

- [D] Other: Specify \_\_\_\_\_

- NSL  
 - Mewbourne Oil Co  
 14744  
 Pool  
 - Lea, Bone Spring  
 37570  
 WEL  
 - MARATHON ROAD  
 14 MD FEDERAL 1H  
 30-025-41215

[2] **NOTIFICATION REQUIRED TO:** - Check Those Which Apply, or  Does Not Apply

- [A]  Working, Royalty or Overriding Royalty Interest Owners  
 [B]  Offset Operators, Leaseholders or Surface Owner  
 [C]  Application is One Which Requires Published Legal Notice  
 [D]  Notification and/or Concurrent Approval by BLM or SLO  
U.S. Bureau of Land Management - Commissioner of Public Lands, State Land Office  
 [E]  For all of the above, Proof of Notification or Publication is Attached, and/or,  
 [F]  Waivers are Attached

[3] **SUBMIT ACCURATE AND COMPLETE INFORMATION REQUIRED TO PROCESS THE TYPE OF APPLICATION INDICATED ABOVE.**

[4] **CERTIFICATION:** I hereby certify that the information submitted with this application for administrative approval is **accurate** and **complete** to the best of my knowledge. I also understand that **no action** will be taken on this application until the required information and notifications are submitted to the Division.

**Note:** Statement must be completed by an individual with managerial and/or supervisory capacity.

David Catanach  
 Print or Type Name

David Catanach  
 Signature

Agent for Mewbourne Oil Company  
 Title

6/23/14  
 Date

drctanach@netscape.com  
 E-Mail Address

June 23, 2014

**Hand Delivered**

New Mexico Oil Conservation Division  
1220 S. St. Francis Drive  
Santa Fe, New Mexico 87505

Attention: Ms. Jami Bailey  
Division Director

Re: Application for Unorthodox Well Location  
Marathon Road 14 MD Federal No. 1H  
API No. (30-025-41215)  
Surface Location: 170' FNL & 810' FWL (Unit D)  
Section 23, T-20 South, R-34 East, NMPM;  
First Take Point: 330' FSL & 810' FWL (Unit M)  
BHL: 330' FNL & 500' FWL (Unit D)  
Section 14, T-20 South, R-34 East, NMPM,  
Lea County, New Mexico

Dear Ms. Bailey:

Pursuant to Division Rule 19.15.15.13, Mewbourne Oil Company ("Mewbourne") respectfully requests administrative approval of an unorthodox oil well location for its proposed Marathon Road 14 MD Federal Well No. 1H. This well will be drilled as a horizontal development oil well in the Lea-Bone Spring Pool (37570).

The Marathon Road 14 MD Federal Well No. 1H will be dedicated to a 160-acre spacing and proration unit ("project area") comprising the W/2 W/2 of Section 14. There are currently no other existing Bone Spring producing wells within the project area.

The Lea-Bone Spring Pool is currently governed by "The Special Rules and Regulations for the Lea-Bone Spring Pool" as established by Division Order No. R-1827 dated December 8, 1960. These rules require standard 80-acre spacing and proration units comprising the N/2, S/2, E/2 or W/2 of a governmental quarter section with wells to be located within 150 feet of the center of a governmental quarter-quarter section.

Pursuant to these rules, a well in the Lea-Bone Spring Pool cannot be located closer than 510 feet to a direct offset tract, and cannot be located closer than 783 feet to a diagonal offset tract.

The proposed unorthodox location is necessary in order to maximize the recovery of oil and gas reserves from the Lea-Bone Spring Pool underlying the W/2 W/2 of Section 14.

The affected offset tracts are described as follows:

Tract 1: W/2 W/2 of Section 23-20S-34E. This existing 160-acre Bone Spring horizontal project area is operated by Nearburg Producing Company. The well to which this tract is dedicated has not yet been drilled;

Tract 2: E/2 W/2 of Section 23-20S-34E. This existing 160-acre Bone Spring horizontal project area is operated by Nearburg Producing Company. The well to which this tract is dedicated is currently active;

Tract 3: W/2 W/2 of Section 11-20S-34E. This existing 160-acre Bone Spring horizontal project area is operated by COG Operating, LLC. The well to which this tract is dedicated is currently active;

Tract 4: E/2 W/2 of Section 11-20S-34E. This existing 160-acre Bone Spring horizontal project area is operated by COG Operating, LLC. The well to which this tract is dedicated has not yet been drilled;

Tract 5: S/2 SE/4 & NE/4 SE/4 of Section 10-20S-34E: This tract is currently undeveloped in the Bone Spring formation. The leasehold owner of this tract is Read & Stevens, Inc; and

Tract 6: E/2 E/2 of Section 15-20S-34E: This existing 160-acre Bone Spring horizontal project area is operated by Mewbourne Oil Company. The well to which this tract is dedicated is currently active. **(Please note that the working interest ownership between the drill tract (W/2 W/2 of Section 14) and this tract is not common. Consequently, Mewbourne is providing notice of this application to all WI owners in the E/2 E/2 of Section 15).**

Pursuant to Division rules, notice of this application is being provided to Read & Stevens, Inc., COG Operating, LLC, Nearburg Producing Company and to all working interest owners in the E/2 E/2 of Section 15 (See attached notice list).

Attached is a Form C-102 showing the proposed well and proposed project area. Also attached is a map showing the affected offset acreage, an offset leasehold notice letter and a notice list.

In summary, approval of the application will provide Mewbourne Oil Company the opportunity to recover additional oil and gas reserves from the Lea-Bone Spring Pool underlying the W/2 W/2 of Section 14 that may otherwise not be recovered, thereby preventing waste, and will not violate correlative rights.

If you should have any questions, please call me at (505) 690-9453.

*Mewbourne Oil Company  
Unorthodox Location Application  
Marathon Road 14 MD Federal Well No. 1H  
Page 3*

---

Sincerely,

A handwritten signature in black ink that reads "David Catanach". The signature is written in a cursive style with a long, sweeping underline.

David Catanach, Agent  
Mewbourne Oil Company  
500 W. Texas, Suite 1020  
Midland, Texas 79701

Xc: OCD-Hobbs

**DISTRICT I**  
 1828 N. French Dr., Hobbs, NM 88440  
 Phone (575) 598-8101 Fax (575) 588-0720

**DISTRICT II**  
 811 S. First St., Artesia, NM 88210  
 Phone (575) 748-1889 Fax (575) 748-8780

**DISTRICT III**  
 1000 Rio Brazos Rd., Aztec, NM 87410  
 Phone (505) 884-8178 Fax (505) 884-8178

**DISTRICT IV**  
 1898 S. St. Francis Dr., Santa Fe, NM 87505  
 Phone (505) 476-8660 Fax (505) 476-8660

State of New Mexico  
 Energy, Minerals and Natural Resources Department

Form C-102  
 Revised August 1, 2011

Submit one copy to appropriate  
 District Office

**OIL CONSERVATION DIVISION**  
 1220 South St. Francis Dr.  
 Santa Fe, New Mexico 87505

**WELL LOCATION AND ACREAGE DEDICATION PLAT**

AMENDED REPORT

API Number	Pool Code R-1827-A	Pool Name Lea Bone Spring
Property Code	Property Name MARATHON ROAD 14 MD FEDERAL	Well Number 1H
OGRID No. 14744	Operator Name MEWBOURNE OIL COMPANY	Elevation 3651'

Surface Location

UL or lot No.	Section	Township	Range	Lot Idn	Feet from the	North/South line	Feet from the	East/West line	County
D	23	20 S	34 E		170	NORTH	810	WEST	LEA

Bottom Hole Location If Different From Surface

UL or lot No.	Section	Township	Range	Lot Idn	Feet from the	North/South line	Feet from the	East/West line	County
D	14	20 S	34 E		330	NORTH	500	WEST	LEA

Dedicated Acres 160	Joint or Infill	Consolidation Code	Order No.
------------------------	-----------------	--------------------	-----------

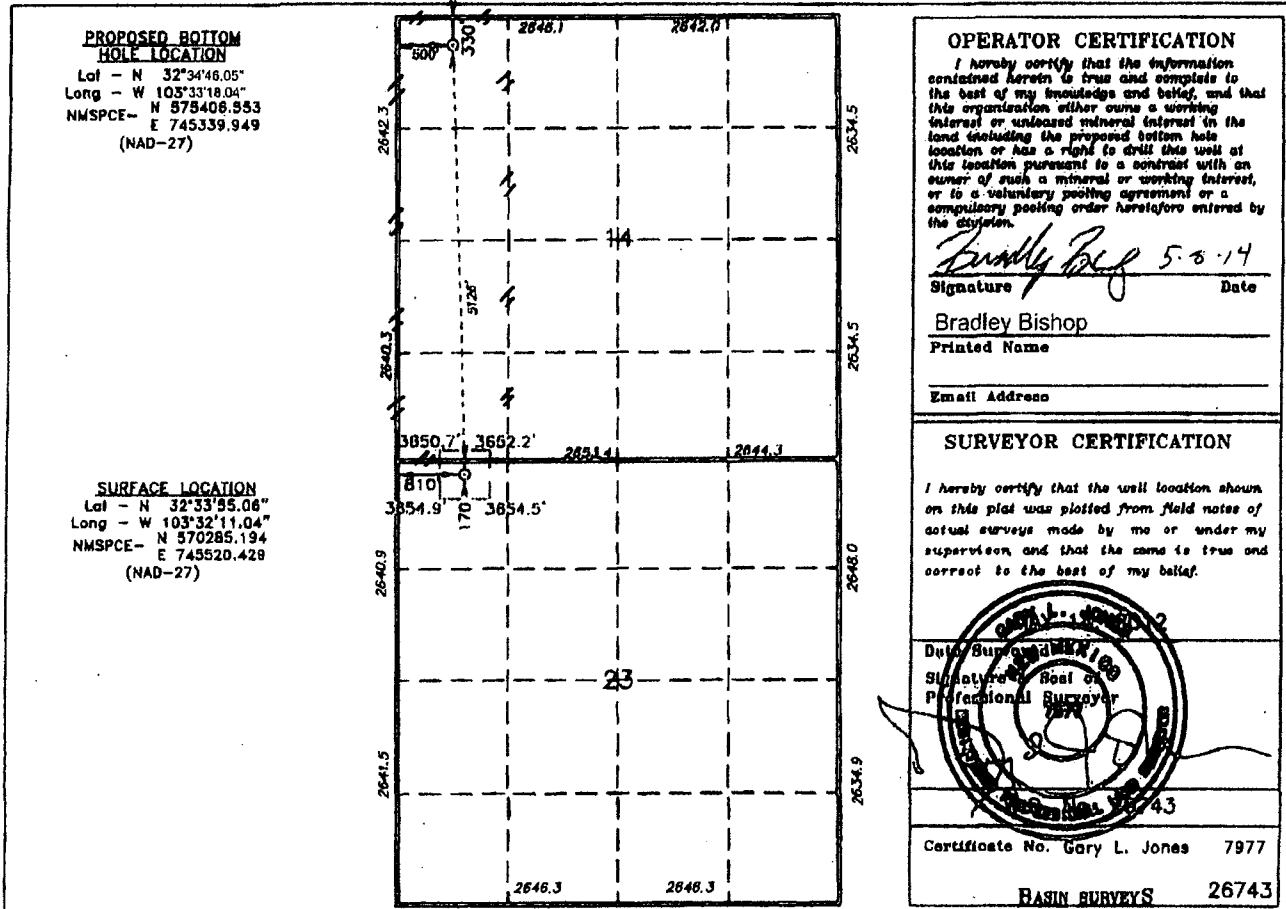

NO ALLOWABLE WILL BE ASSIGNED TO THIS COMPLETION UNTIL ALL INTERESTS HAVE BEEN CONSOLIDATED OR A NON-STANDARD UNIT HAS BEEN APPROVED BY THE DIVISION

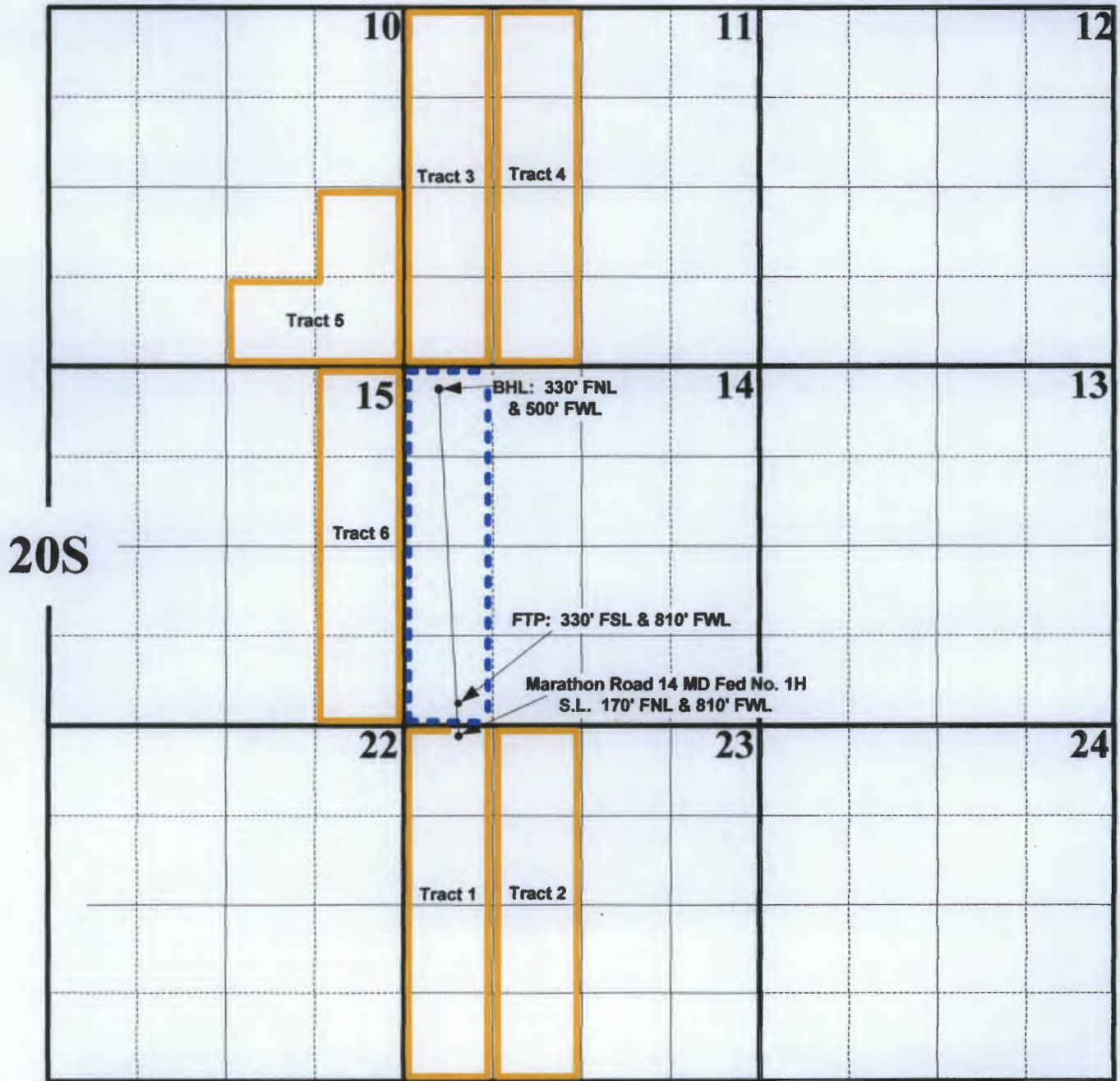

JUN 04 2014

# 34E



-  160-Acre Project Area
-  Affected Offset Acreage/Tracts

**Mewbourne Oil Company**  
**Application for Unorthodox Well Location**  
**Marathon Road 14 MD Federal No. 1H**  
**Affected Offset Acreage**

June 23, 2014

**CERTIFIED MAIL**  
**RETURN RECEIPT REQUESTED**

TO: (SEE ATTACHED NOTICE LIST)

Re: Mewbourne Oil Company  
Unorthodox Oil Well Location  
Marathon Road 14 MD Federal No. 1H (API No. 30-025-41215)  
Surface Location: 170' FNL & 810' FWL (Unit D)  
Section 23, T-20 South, R-34 East, NMPM;  
First Take Point: 330' FSL & 810' FWL (Unit M)  
Bottomhole Location: 330' FNL & 500' FWL (Unit D)  
Section 14, T-20 South, R-34 East, NMPM,  
Lea-Bone Spring Pool  
Lea County, New Mexico

Ladies and Gentlemen:

Enclosed please find a copy of the application filed by Mewbourne Oil Company ("Mewbourne") for approval of an unorthodox oil well location for its proposed Marathon Road 14 MD Federal No. 1H located at the surface, first take point and bottomhole locations described above. The well will test the Lea-Bone Spring Pool and will be dedicated to a 160-acre spacing and proration unit ("project area") comprising the W/2 W/2 of Section 14, Township 20 South, Range 34 East, NMPM. The unorthodox location is necessary in order to maximize the recovery of oil and gas reserves underlying the W/2 W/2 of Section 14.

As the owner of an interest that may be affected by the proposed unorthodox oil well location, you are being provided notice as per Division rules and regulations. Objections must be filed in writing at the Division's Santa Fe office within 20 days from the date this notice was sent to you. If no objection is received within twenty days after the filing of this application and proof of notice with the Division, the application may be approved.

If you should have any questions, please call me at (505) 690-9453.

Sincerely,



David Catanach, Agent  
Mewbourne Oil Company  
550 W. Texas, Suite 1020  
Midland, Texas 79701

Enclosure

Application for Unorthodox Well Location  
Mewbourne Oil Company-Marathon Road 14 MD Federal No. 1H  
**Notice List**

Read & Stevens, Inc.  
Post Office Box 1518  
Roswell, New Mexico 88202-1518  
Attn: Ms. Dianna Doshier

CBR Oil Properties, LLC  
Post Office Box 1518  
Roswell, New Mexico 88202-1518  
Attn: Ms. Dianna Doshier

First Century Oil, Inc.  
Post Office Box 1518  
Roswell, New Mexico 88202-1518  
Attn: Ms. Dianna Doshier

Norman L. Stevens Revocable Trust  
Post Office Box 3087  
Roswell, New Mexico 88202-3087  
Attn: Mr. Bobby D. Carroll

FISCO, Inc.  
c/o Gardere Wynne Sewell LLP  
1000 Louisiana, #3400  
Houston, Texas 77002  
Attn: Mr. N. L. Stevens, III

HHB Limited Partnership  
6823 S. Florence Avenue  
Tulsa, Oklahoma 74136  
Attn: Mr. H. H. Bass, Jr.

Western Oil Company  
1762 Queen Highway  
Carlsbad, New Mexico 88220  
Attn: Mr. Justin McClelland

Union Hill Oil & Gas Co., Inc.  
7712 Glenshannon Circle  
Dallas, Texas 75225  
Attn: Mr. Don A. Buchholz



Watson Properties, LLC  
3905 Futura  
Roswell, New Mexico 88201  
Attn: Mr. Robert H. Watson

CLM Production Company  
P. O. Box 881  
Roswell, New Mexico 88202-0881  
Attn: Mr. John C. Maxey, Jr.

Mr. Thomas M. Beall  
P. O. Box 3098  
Midland, Texas 79702-3098

Abby Corporation  
145 Ocean Pines Terrace  
Jupiter, Florida 33477-9670  
Attn: Mr. Scott A. Harris

Clark Family Limited Partnership  
21966 Windrose Point  
New Caney, Texas 77357  
Attn: Ms. Cathleen C. Perez

Bernhardt Oil Corporation  
12170 Jaycie Circle  
Midwest City, Oklahoma 73130  
Attn: Dr. William G. Bernhardt

Sisk Charitable Trust  
5319 South Lewis, #110  
Tulsa, Oklahoma 74105  
Attn: Ms. Ruth Sowards/Mr. Charles Harris

Heirs of Cavin C. Desmond  
First National Bank, Trustee  
Attn: Ms. Cynthia Green  
P. O. Box 1857  
Roswell, New Mexico 88202-1857

Non-Marital Trust u/w/o Rexell V. Desmond  
First National Bank, Trustee  
Attn: Ms. Cynthia Green  
P. O. Box 1857  
Roswell, New Mexico 88202-1857

Caza Petroleum Inc.  
10077 Grogan's Mill Road, Suite 200  
The Woodlands, Texas 77380  
Attn: Mr. Rich Albro

Wise Oil & Gas No. 6 Ltd.  
6851 NE Loop 820, #110  
North Richland Hills, Texas 76180-6611  
Attn: Mr. William Patterson

D.H.B. Partnership  
8144 Walnut Hill Lane, #982, LB51  
Dallas, Texas 75231  
Attn: Mr. John E. Goble, Jr.

Ms. Virginia B. Houston,  
Heirs of B. F. Houston  
5535 Park Lane  
Dallas, Texas 75220-2151

M.P.S. Inc.,  
Heirs of Lewis E. MacNaughton  
Post Office Box 1227  
Los Gatos, California 95031-1227  
Attn: Mr. Bruce A. MacNaughton

Ms. Susan Rawlins Weaver  
411 South Centre  
Lancaster, Texas 75146

Lincoln Oil & Gas, LLC  
701 Three Cross Drive  
Roswell, New Mexico 88201-7831  
Attn: Mr. William A. Bradshaw, III

CME Oil & Gas, Inc.  
Post Office Box 10621  
Midland, Texas 79702-0621  
Attn: Mr. James C. Brown

Turner Royalties, LLC  
3 Brass Horse Lane  
Santa Fe, New Mexico 87508-9473  
Attn: Ms. Leslie A. Turner

Sandstone Properties, L.L.C.  
40 First Plaza, #601N  
Albuquerque, New Mexico 87102-5801  
Attn: Ms. Anna Williamson

Mr. James R. Wood, III  
2221 New College Lane  
Plano, Texas 75025

Ms. Dorothy Lee Wood  
4118 Lovers Lane  
Dallas, Texas 75225

Mr. Clinton H. Wood  
6301 Westchester Drive  
Dallas, Texas 75225

Weimer, Inc.  
5080 Spectrum Drive, #902W  
Addison, Texas 75001  
Attn: Ms. Maureen F. Foley

Hillier, LLC  
4620 Livingston Avenue  
Dallas, Texas 75209-6024  
Attn: Mr. Paul W. Hillier

HM Investments, Ltd.  
Post Office Box 12248  
Austin, Texas 78711  
Attn: The Honorable Nathan L. Hecht

Estate of Carolyn L. Schlicher  
c/o Ms. Christine S. Johnson  
4024 Goodfellow Drive  
Dallas, Texas 75229

Ms. Lucinda Loveless  
Lucinda Loveless Revocable Trust  
P. O. Box 8  
Hondo, New Mexico 88336

Mr. James W. Keay, Jr.  
4123 Grassmere Lane  
Dallas, Texas 75205

Ms. Martha Keay Strauss  
401 East Street SE  
Vienna, Virginia 22180

Mr. Stuart E. Keay  
6430 Highgate Lane  
Dallas, Texas 75214-2200

The Estate of Mary Beth Desmond  
c/o Mr. Darin Boyd  
77 Van Ness Avenue, #101, PMB #1204  
San Francisco, California 94102

The Allar Company/EG3, Inc.  
Post Office Box 1567  
Graham, Texas 76450  
Attn: Mr. John C. Graham

Nearburg Exploration Company, L.L.C.  
3300 North A Street, Bldg. 2, #120  
Midland, Texas 79705  
Attn: Mr. Kenneth G. Dixon

Mr. Jerry M. Robbins  
8815 Henrietta Wyeth NE  
Albuquerque, New Mexico 87122

Ms. Mary Robbins  
1513 Oldfield  
Gautier, Mississippi 39553

Mr. David L. Robbins  
9661 Beacon Hill Court  
Littleton, Colorado 80126

Ms. Billie L. Petersen  
6811 Island Circle  
Midland, Texas 79707-1413

COG Operating, LLC  
One Concho Center  
600 W. Illinois Avenue  
Midland, Texas 79701

7012 3050 0000 6819 7230

**U.S. Postal Service™**  
**CERTIFIED MAIL™ RECEIPT**  
*(Domestic Mail Only; No Insurance Coverage Provided)*

For delivery information visit our website at [www.usps.com](http://www.usps.com)

Postage	\$	
Certified Fee		
Return Receipt Fee (Endorsement Required)		
Restricted Delivery Fee (Endorsement Required)		
Total	\$	

Postmark Here  
**JUN 24 2011**  
 CORONADO STATION  
 SANTA FE, NM 87505

Sent To: **Abby Corporation**  
**145 Ocean Pines Terrace**  
**Jupiter, Florida 33477-9670**  
**Attn: Mr. Scott A. Harris**

PS Form 3800, August 2009 See Reverse for Instructions

7012 3050 0000 6819 7242

**U.S. Postal Service™**  
**CERTIFIED MAIL™ RECEIPT**  
*(Domestic Mail Only; No Insurance Coverage Provided)*

For delivery information visit our website at [www.usps.com](http://www.usps.com)

Postage	\$	
Certified Fee		
Return Receipt Fee (Endorsement Required)		
Restricted Delivery Fee (Endorsement Required)		
Total	\$	

Postmark Here  
**JUN 24 2011**  
 CORONADO STATION  
 SANTA FE, NM 87505

Sent To: **Mr. Thomas M. Beall**  
**P. O. Box 3098**  
**Midland, Texas 79702-3098**

PS Form 3800, August 2009 See Reverse for Instructions

7012 3050 0000 6819 7254

**U.S. Postal Service™**  
**CERTIFIED MAIL™ RECEIPT**  
*(Domestic Mail Only; No Insurance Coverage Provided)*

For delivery information visit our website at [www.usps.com](http://www.usps.com)

Postage	\$	
Certified Fee		
Return Receipt Fee (Endorsement Required)		
Restricted Delivery Fee (Endorsement Required)		
Total	\$	

Postmark Here  
**JUN 24 2011**  
 CORONADO STATION  
 SANTA FE, NM 87505

Sent To: **CLM Production Company**  
**P. O. Box 881**  
**Roswell, New Mexico 88202-0881**  
**Attn: Mr. John C. Maxey, Jr.**

PS Form 3800, August 2009 See Reverse for Instructions

7012 3050 0000 6819 7262

**U.S. Postal Service™**  
**CERTIFIED MAIL™ RECEIPT**  
*(Domestic Mail Only; No Insurance Coverage Provided)*

For delivery information visit our website at [www.usps.com](http://www.usps.com)

Postage	\$	
Certified Fee		
Return Receipt Fee (Endorsement Required)		
Restricted Delivery Fee (Endorsement Required)		
Total	\$	

Postmark Here  
**JUN 24 2011**  
 CORONADO STATION  
 SANTA FE, NM 87505

Sent To: **Watson Properties, LLC**  
**3905 Futura**  
**Roswell, New Mexico 88201**  
**Attn: Mr. Robert H. Watson**

PS Form 3800, August 2009 See Reverse for Instructions

7012 3050 0000 6819 7276

**U.S. Postal Service™**  
**CERTIFIED MAIL™ RECEIPT**  
*(Domestic Mail Only; No Insurance Coverage Provided)*

For delivery information visit our website at [www.usps.com](http://www.usps.com)

Postage	\$	
Certified Fee		
Return Receipt Fee (Endorsement Required)		
Restricted Delivery Fee (Endorsement Required)		
Total	\$	

Postmark Here  
**JUN 24 2011**  
 CORONADO STATION  
 SANTA FE, NM 87505

Sent To: **Union Hill Oil & Gas Co., Inc.**  
**7712 Glenshannon Circle**  
**Dallas, Texas 75225**  
**Attn: Mr. Don A. Buchholz**

PS Form 3800, August 2009 See Reverse for Instructions

7012 3050 0000 6819 7282

**U.S. Postal Service™**  
**CERTIFIED MAIL™ RECEIPT**  
*(Domestic Mail Only; No Insurance Coverage Provided)*

For delivery information visit our website at [www.usps.com](http://www.usps.com)

Postage	\$	
Certified Fee		
Return Receipt Fee (Endorsement Required)		
Restricted Delivery Fee (Endorsement Required)		
Total	\$	

Postmark Here  
**JUN 24 2011**  
 CORONADO STATION  
 SANTA FE, NM 87505

Sent To: **Western Oil Company**  
**1762 Queen Highway**  
**Carlsbad, New Mexico 88220**  
**Attn: Mr. Justin McClelland**

PS Form 3800, August 2009 See Reverse for Instructions

7012 0470 0001 5936 2508

**U.S. Postal Service™**  
**CERTIFIED MAIL™ RECEIPT**  
*(Domestic Mail Only; No Insurance Coverage Provided)*

For delivery information visit our website at [www.usps.com](http://www.usps.com)

Postage	\$	
Certified Fee		
Return Receipt Fee (Endorsement Required)		
Restricted Delivery Fee (Endorsement Required)		
Total		

Sent To: **HHB Limited Partnership**  
**6823 S. Florence Avenue**  
**Tulsa, Oklahoma 74136**  
**Attn: Mr. H. H. Bass, Jr.**

PS Form 3800, August 2006 See reverse for instructions



7013 2630 0000 9072 4444

**U.S. Postal Service™**  
**CERTIFIED MAIL™ RECEIPT**  
*(Domestic Mail Only; No Insurance Coverage Provided)*

For delivery information visit our website at [www.usps.com](http://www.usps.com)

Postage	\$	
Certified Fee		
Return Receipt Fee (Endorsement Required)		
Restricted Delivery Fee (Endorsement Required)		
Total		

Sent To: **FISCO, Inc.**  
**c/o Gardere Wynne Sewell LLP**  
**1000 Louisiana, #3400**  
**Houston, Texas 77002**  
**Attn: Mr. N. L. Stevens, III**

PS Form 3800, August 2006 See reverse for instructions



7013 2630 0000 9072 3102

**U.S. Postal Service™**  
**CERTIFIED MAIL™ RECEIPT**  
*(Domestic Mail Only; No Insurance Coverage Provided)*

For delivery information visit our website at [www.usps.com](http://www.usps.com)

Postage	\$	
Certified Fee		
Return Receipt Fee (Endorsement Required)		
Restricted Delivery Fee (Endorsement Required)		
Total		

Sent To: **Norman L. Stevens Revocable Trust**  
**Post Office Box 3087**  
**Roswell, New Mexico 88202-3087**  
**Attn: Mr. Bobby D. Carroll**

PS Form 3800, August 2006 See reverse for instructions

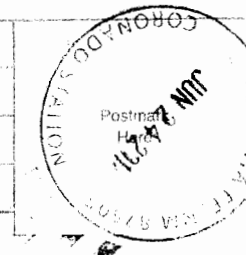

7013 2630 0000 9072 3119

**U.S. Postal Service™**  
**CERTIFIED MAIL™ RECEIPT**  
*(Domestic Mail Only; No Insurance Coverage Provided)*

For delivery information visit our website at [www.usps.com](http://www.usps.com)

Postage	\$	
Certified Fee		
Return Receipt Fee (Endorsement Required)		
Restricted Delivery Fee (Endorsement Required)		
Total		

Sent To: **First Century Oil, Inc.**  
**Post Office Box 1518**  
**Roswell, New Mexico 88202-1518**  
**Attn: Ms. Dianna Doshier**

PS Form 3800, August 2006 See reverse for instructions



7013 2630 0000 9072 3126

**U.S. Postal Service™**  
**CERTIFIED MAIL™ RECEIPT**  
*(Domestic Mail Only; No Insurance Coverage Provided)*

For delivery information visit our website at [www.usps.com](http://www.usps.com)

Postage	\$	
Certified Fee		
Return Receipt Fee (Endorsement Required)		
Restricted Delivery Fee (Endorsement Required)		
Total		

Sent To: **CBR Oil Properties, LLC**  
**Post Office Box 1518**  
**Roswell, New Mexico 88202-1518**  
**Attn: Ms. Dianna Doshier**

PS Form 3800, August 2006 See reverse for instructions



7013 2630 0000 9072 3133

**U.S. Postal Service™**  
**CERTIFIED MAIL™ RECEIPT**  
*(Domestic Mail Only; No Insurance Coverage Provided)*

For delivery information visit our website at [www.usps.com](http://www.usps.com)

Postage	\$	
Certified Fee		
Return Receipt Fee (Endorsement Required)		
Restricted Delivery Fee (Endorsement Required)		
Total		

Sent To: **Read & Stevens, Inc.**  
**Post Office Box 1518**  
**Roswell, New Mexico 88202-1518**  
**Attn: Ms. Dianna Doshier**

PS Form 3800, August 2006 See reverse for instructions

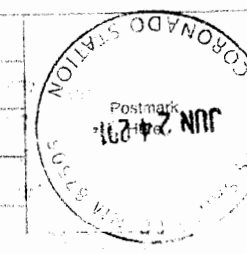

7012 3050 0000 6819 6967

**U.S. Postal Service™**  
**CERTIFIED MAIL™ RECEIPT**  
*(Domestic Mail Only; No Insurance Coverage Provided)*

For delivery information visit our website at [www.usps.com](http://www.usps.com)

Postage	\$	
Certified Fee		
Return Receipt Fee (Endorsement Required)	\$	
Restricted Delivery Fee (Endorsement Required)		
Total	\$	

Postmark Here

Sent To: **Mr. James W. Keay, Jr.**  
**4123 Grassmere Lane**  
**Dallas, Texas 75205**

PS Form 3800, August 2000 See reverse for instructions



7012 3050 0000 6819 6967

**U.S. Postal Service™**  
**CERTIFIED MAIL™ RECEIPT**  
*(Domestic Mail Only; No Insurance Coverage Provided)*

For delivery information visit our website at [www.usps.com](http://www.usps.com)

Postage	\$	
Certified Fee		
Return Receipt Fee (Endorsement Required)		
Restricted Delivery Fee (Endorsement Required)		
Total	\$	

Postmark Here

Sent To: **Ms. Martha Key Strauss**  
**401 East Street SE**  
**Vienna, Virginia 22180**

PS Form 3800, August 2000 See reverse for instructions

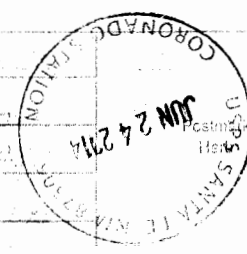

7012 3050 0000 6819 6950

**U.S. Postal Service™**  
**CERTIFIED MAIL™ RECEIPT**  
*(Domestic Mail Only; No Insurance Coverage Provided)*

For delivery information visit our website at [www.usps.com](http://www.usps.com)

Postage	\$	
Certified Fee		
Return Receipt Fee (Endorsement Required)		
Restricted Delivery Fee (Endorsement Required)		
Total	\$	

Postmark Here

Sent To: **Mr. Stuart E. Keay**  
**6430 Highgate Lane**  
**Dallas, Texas 75214-2200**

PS Form 3800, August 2000 See reverse for instructions



7012 3050 0000 6819 6943

**U.S. Postal Service™**  
**CERTIFIED MAIL™ RECEIPT**  
*(Domestic Mail Only; No Insurance Coverage Provided)*

For delivery information visit our website at [www.usps.com](http://www.usps.com)

Postage	\$	
Certified Fee		
Return Receipt Fee (Endorsement Required)		
Restricted Delivery Fee (Endorsement Required)		
Total	\$	

Postmark Here

Sent To: **The Estate of Mary Beth Desmond**  
**c/o Mr. Darin Boyd**  
**77 Van Ness Avenue, #101, PMB #1204**  
**San Francisco, California 94102**

PS Form 3800, August 2000 See reverse for instructions



7012 3050 0000 6819 6936

**U.S. Postal Service™**  
**CERTIFIED MAIL™ RECEIPT**  
*(Domestic Mail Only; No Insurance Coverage Provided)*

For delivery information visit our website at [www.usps.com](http://www.usps.com)

Postage	\$	
Certified Fee		
Return Receipt Fee (Endorsement Required)		
Restricted Delivery Fee (Endorsement Required)		
Total	\$	

Postmark Here

Sent To: **The Allar Company/EG3, Inc.**  
**Post Office Box 1567**  
**Graham, Texas 76450**  
**Attn: Mr. John C. Graham**

PS Form 3800, August 2000 See reverse for instructions

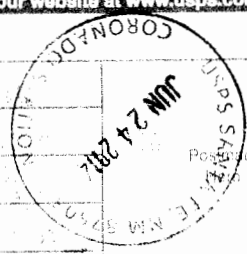

7012 3050 0000 6819 6929

**U.S. Postal Service™**  
**CERTIFIED MAIL™ RECEIPT**  
*(Domestic Mail Only; No Insurance Coverage Provided)*

For delivery information visit our website at [www.usps.com](http://www.usps.com)

Postage	\$	
Certified Fee		
Return Receipt Fee (Endorsement Required)		
Restricted Delivery Fee (Endorsement Required)		
Total	\$	

Postmark Here

Sent To: **Nearburg Exploration Company, L.L.C.**  
**3300 North A Street, Bldg. 2, #120**  
**Midland, Texas 79705**  
**Attn: Mr. Kenneth G. Dixon**

PS Form 3800, August 2000 See reverse for instructions

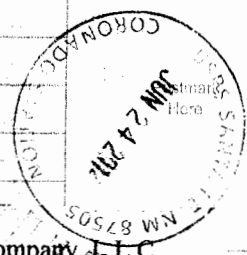

7012 3050 0000 6819 6912

U.S. Postal Service™  
**CERTIFIED MAIL™ RECEIPT**  
*(Domestic Mail Only; No Insurance Coverage Provided)*

For delivery information visit our website at [www.usps.com](http://www.usps.com)

Postage	\$	
Certified Fee		
Return Receipt Fee (Endorsement Required)		
Restricted Delivery Fee (Endorsement Required)		
Total	\$	

Postmark Here

Sent To: **Mr. Jerry M. Robbins**  
**8815 Henrietta Wyeth NE**  
**Albuquerque, New Mexico 87122**

PS Form 3800, August 2006 See Reverse for Instructions

5069 6189 0000 0506 2102

U.S. Postal Service™  
**CERTIFIED MAIL™ RECEIPT**  
*(Domestic Mail Only; No Insurance Coverage Provided)*

For delivery information visit our website at [www.usps.com](http://www.usps.com)

Postage	\$	
Certified Fee		
Return Receipt Fee (Endorsement Required)		
Restricted Delivery Fee (Endorsement Required)		
Total	\$	

Postmark Here

Sent To: **Ms. Mary Robbins**  
**1513 Oldfield**  
**Gautier, Mississippi 39553**

PS Form 3800, August 2006 See Reverse for Instructions

7012 3050 0000 6819 6899

U.S. Postal Service™  
**CERTIFIED MAIL™ RECEIPT**  
*(Domestic Mail Only; No Insurance Coverage Provided)*

For delivery information visit our website at [www.usps.com](http://www.usps.com)

Postage	\$	
Certified Fee		
Return Receipt Fee (Endorsement Required)		
Restricted Delivery Fee (Endorsement Required)		
Total	\$	

Postmark Here

Sent To: **Mr. David L. Robbins**  
**9661 Beacon Hill Court**  
**Littleton, Colorado 80126**

PS Form 3800, August 2006 See Reverse for Instructions

2989 6189 0000 0506 2102

U.S. Postal Service™  
**CERTIFIED MAIL™ RECEIPT**  
*(Domestic Mail Only; No Insurance Coverage Provided)*

For delivery information visit our website at [www.usps.com](http://www.usps.com)

Postage	\$	
Certified Fee		
Return Receipt Fee (Endorsement Required)		
Restricted Delivery Fee (Endorsement Required)		
Total	\$	

Postmark Here

Sent To: **Ms. Billie L. Petersen**  
**6811 Island Circle**  
**Midland, Texas 79707-1413**

PS Form 3800, August 2006 See Reverse for Instructions

7012 3050 0000 6819 6974

U.S. Postal Service™  
**CERTIFIED MAIL™ RECEIPT**  
*(Domestic Mail Only; No Insurance Coverage Provided)*

For delivery information visit our website at [www.usps.com](http://www.usps.com)

Postage	\$	
Certified Fee		
Return Receipt Fee (Endorsement Required)		
Restricted Delivery Fee (Endorsement Required)		
Total	\$	

Postmark Here

Sent To: **COG Operating, LLC**  
**One Concho Center**  
**600 W. Illinois Avenue**  
**Midland, Texas 79701**

PS Form 3800, August 2006 See Reverse for Instructions

7121 6189 0000 0506 2102

U.S. Postal Service™  
**CERTIFIED MAIL™ RECEIPT**  
*(Domestic Mail Only; No Insurance Coverage Provided)*

For delivery information visit our website at [www.usps.com](http://www.usps.com)

Postage	\$	
Certified Fee		
Return Receipt Fee (Endorsement Required)		
Restricted Delivery Fee (Endorsement Required)		
Total	\$	

Postmark Here

Sent To: **Ms. Virginia B. Houston,**  
**Heirs of B. F. Houston**  
**5535 Park Lane**  
**Dallas, Texas 75220-2151**

PS Form 3800, August 2006 See Reverse for Instructions



7012 3050 0000 6819 7148

**U.S. Postal Service™**  
**CERTIFIED MAIL™ RECEIPT**  
*(Domestic Mail Only; No Insurance Coverage Provided)*

For delivery information visit our website at [www.usps.com](http://www.usps.com)

Postage	\$	
Certified Fee		
Return Receipt Fee (Endorsement Required)		
Restricted Delivery Fee (Endorsement Required)		
Total P		

Sent To: **D.H.B. Partnership**  
**8144 Walnut Hill Lane, #982, LB51**  
**Dallas, Texas 75231**  
**Attn: Mr. John E. Goble, Jr**

PS Form 3800, August 2000

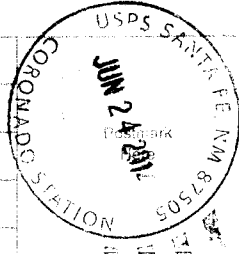

7012 3050 0000 6819 7162

**U.S. Postal Service™**  
**CERTIFIED MAIL™ RECEIPT**  
*(Domestic Mail Only; No Insurance Coverage Provided)*

For delivery information visit our website at [www.usps.com](http://www.usps.com)

Postage	\$	
Certified Fee		
Return Receipt Fee (Endorsement Required)		
Restricted Delivery Fee (Endorsement Required)		
Total P		

Sent To: **Wise Oil & Gas No. 6 Ltd.**  
**6851 NE Loop 820, #110**  
**North Richland Hills, Texas 76180-6611**  
**Attn: Mr. William Patterson**

PS Form 3800, August 2000



7012 3050 0000 6819 7172

**U.S. Postal Service™**  
**CERTIFIED MAIL™ RECEIPT**  
*(Domestic Mail Only; No Insurance Coverage Provided)*

For delivery information visit our website at [www.usps.com](http://www.usps.com)

Postage	\$	
Certified Fee		
Return Receipt Fee (Endorsement Required)		
Restricted Delivery Fee (Endorsement Required)		
Total P		

Sent To: **Caza Petroleum Inc.**  
**10077 Grogan's Mill Road, Suite 200**  
**The Woodlands, Texas 77380**  
**Attn: Mr. Rich Albro**

PS Form 3800, August 2000

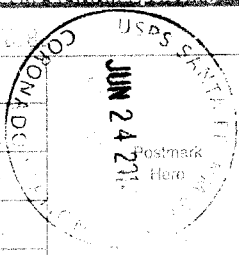

7012 3050 0000 6819 7182

**U.S. Postal Service™**  
**CERTIFIED MAIL™ RECEIPT**  
*(Domestic Mail Only; No Insurance Coverage Provided)*

For delivery information visit our website at [www.usps.com](http://www.usps.com)

Postage	\$	
Certified Fee		
Return Receipt Fee (Endorsement Required)		
Restricted Delivery Fee (Endorsement Required)		
Total P		

Sent To: **Non-Marital Trust u/w/o Rexell V. Desmond**  
**First National Bank, Trustee**  
**Attn: Ms. Cynthia Green**  
**P. O. Box 1857**  
**Roswell, New Mexico 88202-1857**

PS Form 3800, August 2000

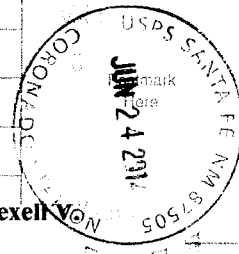

7012 3050 0000 6819 7192

**U.S. Postal Service™**  
**CERTIFIED MAIL™ RECEIPT**  
*(Domestic Mail Only; No Insurance Coverage Provided)*

For delivery information visit our website at [www.usps.com](http://www.usps.com)

Postage	\$	
Certified Fee		
Return Receipt Fee (Endorsement Required)		
Restricted Delivery Fee (Endorsement Required)		
Total P		

Sent To: **Heirs of Cavin C. Desmond**  
**First National Bank, Trustee**  
**Attn: Ms. Cynthia Green**  
**P. O. Box 1857**  
**Roswell, New Mexico 88202-1857**

PS Form 3800, August 2000

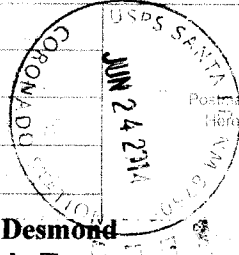

7012 3050 0000 6819 7202

**U.S. Postal Service™**  
**CERTIFIED MAIL™ RECEIPT**  
*(Domestic Mail Only; No Insurance Coverage Provided)*

For delivery information visit our website at [www.usps.com](http://www.usps.com)

Postage	\$	
Certified Fee		
Return Receipt Fee (Endorsement Required)		
Restricted Delivery Fee (Endorsement Required)		
Total P		

Sent To: **Sisk Charitable Trust**  
**5319 South Lewis, #110**  
**Tulsa, Oklahoma 74105**  
**Attn: Ms. Ruth Sowards/Mr. Charles Harris**

PS Form 3800, August 2000

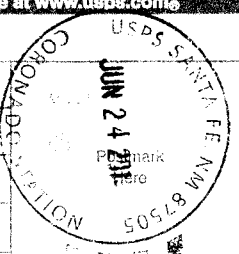

7012 3050 0000 6819 7212

**U.S. Postal Service™**  
**CERTIFIED MAIL™ RECEIPT**  
*(Domestic Mail Only; No Insurance Coverage Provided)*

For delivery information visit our website at [www.usps.com](http://www.usps.com)

Postage	\$	
Certified Fee		
Return Receipt Fee (Endorsement Required)		
Restricted Delivery Fee (Endorsement Required)		
Total		

Sent To: **Bernhardt Oil Corporation**  
**12170 Jaycie Circle**  
**Midwest City, Oklahoma 73130**  
**Attn: Dr. William G. Bernhardt**

PS Form 3800, August 2000



7012 3050 0000 6819 7212

**U.S. Postal Service™**  
**CERTIFIED MAIL™ RECEIPT**  
*(Domestic Mail Only; No Insurance Coverage Provided)*

For delivery information visit our website at [www.usps.com](http://www.usps.com)

Postage	\$	
Certified Fee		
Return Receipt Fee (Endorsement Required)		
Restricted Delivery Fee (Endorsement Required)		
Total		

Sent To: **HM Investments, Ltd.**  
**Post Office Box 12248**  
**Austin, Texas 78711**  
**Attn: Nathan L. Hecht**

PS Form 3800, August 2000

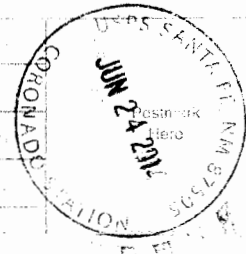

7012 3050 0000 6819 7228

**U.S. Postal Service™**  
**CERTIFIED MAIL™ RECEIPT**  
*(Domestic Mail Only; No Insurance Coverage Provided)*

For delivery information visit our website at [www.usps.com](http://www.usps.com)

Postage	\$	
Certified Fee		
Return Receipt Fee (Endorsement Required)		
Restricted Delivery Fee (Endorsement Required)		
Total		

Sent To: **Clark Family Limited Partnership**  
**21966 Windrose Point**  
**New Caney, Texas 77357**  
**Attn: Ms. Cathleen C. Perez**

PS Form 3800, August 2000



7012 3050 0000 6819 7228

**U.S. Postal Service™**  
**CERTIFIED MAIL™ RECEIPT**  
*(Domestic Mail Only; No Insurance Coverage Provided)*

For delivery information visit our website at [www.usps.com](http://www.usps.com)

Postage	\$	
Certified Fee		
Return Receipt Fee (Endorsement Required)		
Restricted Delivery Fee (Endorsement Required)		
Total		

Sent To: **Ms. Lucinda Loveless**  
**Lucinda Loveless Revocable Trust**  
**P. O. Box 8**  
**Hondo, New Mexico 88336**

PS Form 3800, August 2000



7012 3050 0000 6819 7001

**U.S. Postal Service™**  
**CERTIFIED MAIL™ RECEIPT**  
*(Domestic Mail Only; No Insurance Coverage Provided)*

For delivery information visit our website at [www.usps.com](http://www.usps.com)

Postage	\$	
Certified Fee		
Return Receipt Fee (Endorsement Required)		
Restricted Delivery Fee (Endorsement Required)		
Total		

Sent To: **Estate of Carolyn L. Schlicher**  
**c/o Ms. Christine S. Johnson**  
**4024 Goodfellow Drive**  
**Dallas, Texas 75229**

PS Form 3800, August 2000



7012 3050 0000 6819 7021

**U.S. Postal Service™**  
**CERTIFIED MAIL™ RECEIPT**  
*(Domestic Mail Only; No Insurance Coverage Provided)*

For delivery information visit our website at [www.usps.com](http://www.usps.com)

Postage	\$	
Certified Fee		
Return Receipt Fee (Endorsement Required)		
Restricted Delivery Fee (Endorsement Required)		
Total		

Sent To: **Hillier, LLC**  
**4620 Livingston Avenue**  
**Dallas, Texas 75209-6024**  
**Attn: Mr. Paul W. Hillier**

PS Form 3800, August 2000

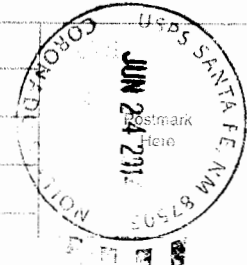

7012 3050 0000 6819 7056

**U.S. Postal Service™**  
**CERTIFIED MAIL™ RECEIPT**  
*(Domestic Mail Only; No Insurance Coverage Provided)*

For delivery information visit our website at [www.usps.com](http://www.usps.com).

Postage	\$	
Certified Fee		
Return Receipt Fee (Endorsement Required)		
Restricted Delivery Fee (Endorsement Required)		
Total		

Sent To: **Weimer, Inc.**  
**5080 Spectrum Drive, #902W**  
**Addison, Texas 75001**  
**Attn: Ms. Maureen F. Foley**

PS Form 3800, August 2009 See Reverse for Instructions



7012 3050 0000 0506 2102

**U.S. Postal Service™**  
**CERTIFIED MAIL™ RECEIPT**  
*(Domestic Mail Only; No Insurance Coverage Provided)*

For delivery information visit our website at [www.usps.com](http://www.usps.com).

Postage	\$	
Certified Fee		
Return Receipt Fee (Endorsement Required)		
Restricted Delivery Fee (Endorsement Required)		
Total Postage & Fees		

Sent To: **Mr. Clinton H. Wood**  
**6301 Westchester Drive**  
**Dallas, Texas 75225**

PS Form 3800, August 2009 See Reverse for Instructions



7012 3050 0000 6819 7056

**U.S. Postal Service™**  
**CERTIFIED MAIL™ RECEIPT**  
*(Domestic Mail Only; No Insurance Coverage Provided)*

For delivery information visit our website at [www.usps.com](http://www.usps.com).

Postage	\$	
Certified Fee		
Return Receipt Fee (Endorsement Required)		
Restricted Delivery Fee (Endorsement Required)		
Total		

Sent To: **Ms. Dorothy Lee Wood**  
**4118 Lovers Lane**  
**Dallas, Texas 75225**

PS Form 3800, August 2009 See Reverse for Instructions



7012 3050 0000 0506 2102

**U.S. Postal Service™**  
**CERTIFIED MAIL™ RECEIPT**  
*(Domestic Mail Only; No Insurance Coverage Provided)*

For delivery information visit our website at [www.usps.com](http://www.usps.com).

Postage	\$	
Certified Fee		
Return Receipt Fee (Endorsement Required)		
Restricted Delivery Fee (Endorsement Required)		
Total		

Sent To: **Mr. James R. Wood, III**  
**2221 New College Lane**  
**Plano, Texas 75025**

PS Form 3800, August 2009 See Reverse for Instructions



7012 3050 0000 6819 7056

**U.S. Postal Service™**  
**CERTIFIED MAIL™ RECEIPT**  
*(Domestic Mail Only; No Insurance Coverage Provided)*

For delivery information visit our website at [www.usps.com](http://www.usps.com).

Postage	\$	
Certified Fee		
Return Receipt Fee (Endorsement Required)		
Restricted Delivery Fee (Endorsement Required)		
Total		

Sent To: **Sandstone Properties, L.L.C.**  
**40 First Plaza, #601N**  
**Albuquerque, N.M. 87102-5801**  
**Attn: Ms. Anna Williamson**

PS Form 3800, August 2009 See Reverse for Instructions

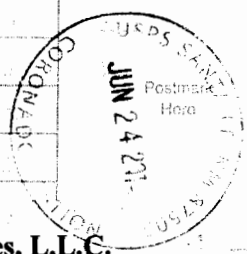

7012 3050 0000 0506 2102

**U.S. Postal Service™**  
**CERTIFIED MAIL™ RECEIPT**  
*(Domestic Mail Only; No Insurance Coverage Provided)*

For delivery information visit our website at [www.usps.com](http://www.usps.com).

Postage	\$	
Certified Fee		
Return Receipt Fee (Endorsement Required)		
Restricted Delivery Fee (Endorsement Required)		
Total P		

Sent To: **Turner Royalties, LLC**  
**3 Brass Horse Lane**  
**Santa Fe, New Mexico 87508-9473**  
**Attn: Ms. Leslie A. Turner**

PS Form 3800, August 2009 See Reverse for Instructions



7012 3050 0000 6819 7094

**U.S. Postal Service™**  
**CERTIFIED MAIL™ RECEIPT**  
*(Domestic Mail Only; No Insurance Coverage Provided)*

For delivery information visit our website at [www.usps.com](http://www.usps.com)

Postage \$  
Certified Fee  
Return Receipt Fee (Endorsement Required)  
Restricted Delivery Fee (Endorsement Required)  
Total



Sent To: **CME Oil & Gas, Inc.**  
**Post Office Box 10621**  
**Midland, Texas 79702-0621**  
**Attn: Mr. James C. Brown**

PS Form 3800, August 2009 See Reverse for Instructions

7012 3050 0000 6819 7124

**U.S. Postal Service™**  
**CERTIFIED MAIL™ RECEIPT**  
*(Domestic Mail Only; No Insurance Coverage Provided)*

For delivery information visit our website at [www.usps.com](http://www.usps.com)

Postage \$  
Certified Fee  
Return Receipt Fee (Endorsement Required)  
Restricted Delivery Fee (Endorsement Required)  
Total P



To: **M.P.S. Inc.,**  
Sent To: **Heirs of Lewis E. MacNaughton**  
**Post Office Box 1227**  
**Los Gatos, California 95031-1227**  
**Attn: Mr. Bruce A. MacNaughton**

PS Form 3800, August 2009 See Reverse for Instructions

7012 3050 0000 6819 7102

**U.S. Postal Service™**  
**CERTIFIED MAIL™ RECEIPT**  
*(Domestic Mail Only; No Insurance Coverage Provided)*

For delivery information visit our website at [www.usps.com](http://www.usps.com)

Postage \$  
Certified Fee  
Return Receipt Fee (Endorsement Required)  
Restricted Delivery Fee (Endorsement Required)  
Total

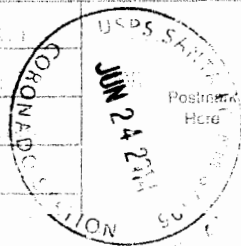

Sent To: **Lincoln Oil & Gas, LLC**  
**701 Three Cross Drive**  
**Roswell, New Mexico 88201-7831**  
**Attn: William A. Bradshaw, III**

PS Form 3800, August 2009 See Reverse for Instructions

7012 3050 0000 6819 7102

**U.S. Postal Service™**  
**CERTIFIED MAIL™ RECEIPT**  
*(Domestic Mail Only; No Insurance Coverage Provided)*

For delivery information visit our website at [www.usps.com](http://www.usps.com)

Postage \$  
Certified Fee  
Return Receipt Fee (Endorsement Required)  
Restricted Delivery Fee (Endorsement Required)  
Total P



Sent To: **Ms. Susan Rawlins Weaver**  
**411 South Centre**  
**Lancaster, Texas 75146**

PS Form 3800, August 2009 See Reverse for Instructions

UNITED STATES  
DEPARTMENT OF THE INTERIOR  
BUREAU OF LAND MANAGEMENT

FORM APPROVED  
OMB NO. 1004-0135  
Expires: July 31, 2010

**SUNDRY NOTICES AND REPORTS ON WELLS**  
*Do not use this form for proposals to drill or to re-enter an abandoned well. Use form 3160-3 (APD) for such proposals.*

**SUBMIT IN TRIPLICATE - Other instructions on reverse side.**

1. Type of Well <input checked="" type="checkbox"/> Oil Well <input type="checkbox"/> Gas Well <input type="checkbox"/> Other		5. Lease Serial No. NMNM78273
2. Name of Operator MEWBOURNE OIL COMPANY		6. If Indian, Allottee or Tribe Name
3a. Address HOBBS, NM 88241		7. If Unit or CA/Agreement, Name and/or No.
3b. Phone No. (include area code) Ph: 575-393-5905		8. Well Name and No. MARATHON ROAD 14 MD FEDERAL 1H
4. Location of Well (Footage, Sec., T., R., M., or Survey Description) Sec 23 T20S R34E NWNW 170FNL 810FWL		9. API Well No. 30-025-41215-00-X1
10. Field and Pool, or Exploratory LEA		11. County or Parish, and State LEA COUNTY, NM

**HOBBS OCD**  
**MAY 21 2014**

12. CHECK APPROPRIATE BOX(ES) TO INDICATE NATURE OF NOTICE, REPORT, OR OTHER DATA

TYPE OF SUBMISSION	TYPE OF ACTION			
<input checked="" type="checkbox"/> Notice of Intent	<input type="checkbox"/> Acidize	<input type="checkbox"/> Deepen	<input type="checkbox"/> Production (Start/Resume)	<input type="checkbox"/> Water Shut-Off
<input type="checkbox"/> Subsequent Report	<input type="checkbox"/> Alter Casing	<input type="checkbox"/> Fracture Treat	<input type="checkbox"/> Reclamation	<input type="checkbox"/> Well Integrity
<input type="checkbox"/> Final Abandonment Notice	<input type="checkbox"/> Casing Repair	<input type="checkbox"/> New Construction	<input type="checkbox"/> Recomplete	<input checked="" type="checkbox"/> Other
	<input type="checkbox"/> Change Plans	<input type="checkbox"/> Plug and Abandon	<input type="checkbox"/> Temporarily Abandon	Change to Original APD
	<input type="checkbox"/> Convert to Injection	<input type="checkbox"/> Plug Back	<input type="checkbox"/> Water Disposal	

13. Describe Proposed or Completed Operation (clearly state all pertinent details, including estimated starting date of any proposed work and approximate duration thereof. If the proposal is to deepen directionally or recomplete horizontally, give subsurface locations and measured and true vertical depths of all pertinent markers and zones. Attach the Bond under which the work will be performed or provide the Bond No. on file with BLM/BIA. Required subsequent reports shall be filed within 30 days following completion of the involved operations. If the operation results in a multiple completion or recompletion in a new interval, a Form 3160-4 shall be filed once testing has been completed. Final Abandonment Notices shall be filed only after all requirements, including reclamation, have been completed, and the operator has determined that the site is ready for final inspection.)

MOC has an approved APD for the above well. MOC would like to change the BHL from 330' FNL & 660' FWL, Sec. 14 T20S R34E to 330' FNL & 500' FWL, Sec. 14 T20S R34E. Please see attached directional plan and drilling program.

**SEE ATTACHED FOR  
CONDITIONS OF APPROVAL**

Bond on file: NM1693 nationwide & NMB000919

14. I hereby certify that the foregoing is true and correct.

**Electronic Submission #241936 verified by the BLM Well Information System  
For MEWBOURNE OIL COMPANY, sent to the Hobbs  
Committed to AFMSS for processing by JENNIFER MASON on 05/07/2014 (14JAM0051SE)**

Name (Printed/Typed) JACKIE LATHAN	Title AUTHORIZED REPRESENTATIVE
Signature (Electronic Submission)	Date 04/11/2014

**THIS SPACE FOR FEDERAL OR STATE OFFICE USE**

Approved By _____	Title _____
Conditions of approval, if any, are attached. Approval of this notice does not warrant or certify that the applicant holds legal or equitable title to those rights in the subject lease which would entitle the applicant to conduct operations thereon.	Office <i>KZ</i>

APPROVED

MAY 21 2014

BUREAU OF LAND MANAGEMENT  
CARLSBAD FIELD OFFICE

Title 18 U.S.C. Section 1001 and Title 43 U.S.C. Section 1212, make it a crime for any person knowingly and willfully to make to any department or agency of the United States any false, fictitious or fraudulent statements or representations as to any matter within its jurisdiction.

**\*\* BLM REVISED \*\* BLM REVISED \*\* BLM REVISED \*\* BLM REVISED \*\* BLM REVISED \*\***

**JUN 04 2014**