

ABOVE THIS LINE FOR DIVISION USE ONLY

## NEW MEXICO OIL CONSERVATION DIVISION

- Engineering Bureau -

1220 South St. Francis Drive, Santa Fe, NM 87505



### ADMINISTRATIVE APPLICATION CHECKLIST

THIS CHECKLIST IS MANDATORY FOR ALL ADMINISTRATIVE APPLICATIONS FOR EXCEPTIONS TO DIVISION RULES AND REGULATIONS WHICH REQUIRE PROCESSING AT THE DIVISION LEVEL IN SANTA FE

#### Application Acronyms:

[NSL-Non-Standard Location] [NSP-Non-Standard Proration Unit] [SD-Simultaneous Dedication]  
 [DHC-Downhole Commingling] [CTB-Lease Commingling] [PLC-Pool/Lease Commingling]  
 [PC-Pool Commingling] [OLS - Off-Lease Storage] [OLM-Off-Lease Measurement]  
 [WFX-Waterflood Expansion] [PMX-Pressure Maintenance Expansion]  
 [SWD-Salt Water Disposal] [IPI-Injection Pressure Increase]  
 [EOR-Qualified Enhanced Oil Recovery Certification] [PPR-Positive Production Response]

#### [1] TYPE OF APPLICATION - Check Those Which Apply for [A]

[A] Location - Spacing Unit - Simultaneous Dedication  
☐ NSL ☐ NSP ☐ SD

Check One Only for [B] or [C]

[B] Commingling - Storage - Measurement  
☐ DHC ☐ CTB ☒ PLC ☐ PC ☐ OLS ☐ OLM

[C] Injection - Disposal - Pressure Increase - Enhanced Oil Recovery  
☐ WFX ☐ PMX ☐ SWD ☐ IPI ☐ EOR ☐ PPR

[D] Other: Specify \_\_\_\_\_

#### [2] NOTIFICATION REQUIRED TO: - Check Those Which Apply, or ☐ Does Not Apply

[A] ☐ Working, Royalty or Overriding Royalty Interest Owners

[B] ☐ Offset Operators, Leaseholders or Surface Owner

[C] ☐ Application is One Which Requires Published Legal Notice

[D] ☒ Notification and/or Concurrent Approval by BLM or SLO  
 U.S. Bureau of Land Management - Commissioner of Public Lands, State Land Office

[E] ☐ For all of the above, Proof of Notification or Publication is Attached, and/or, - Tabolina

[F] ☐ Waivers are Attached

#### [3] SUBMIT ACCURATE AND COMPLETE INFORMATION REQUIRED TO PROCESS THE TYPE OF APPLICATION INDICATED ABOVE.

[4] **CERTIFICATION:** I hereby certify that the information submitted with this application for administrative approval is **accurate** and **complete** to the best of my knowledge. I also understand that **no action** will be taken on this application until the required information and notifications are submitted to the Division.

Note: Statement must be completed by an individual with managerial and/or supervisory capacity.

Erin Workman

Print or Type Name

*Erin Workman*  
 Signature

Regulatory Compliance Professional 07/22/14

Title

Date

Erin.Workman@dmn.com

E-mail Address

PLC-402

- PLC  
 - DEVON ENERGY  
 Production company  
 L.P.

6137  
 Wells

- MEAN GREEN  
 27 Federal

30-025-  
 41433

- MEAN  
 Green

26 st 14  
 Federal

30-025-  
 41246

- MEAN

Green 22 st 14

30-025-41434

Pool

- Tabolina

Delaware SW

47597

WC-025

Q-06 526 3422

PJ

Delaware

98049



Devon Energy Production Company, L.P.  
333 West Sheridan Avenue  
Oklahoma City, OK 73102-5015

Direct Dial: 405-552-6540  
Direct Fax: 405-552-1309  
Henry.Latimer@devn.com  
**HENRY W. LATIMER, SR.**

July 16, 2014

New Mexico Oil Conservation Division  
1220 South St. Francis Drive  
Santa Fe, NM 87505

RE: Application for Commingling  
Mean Green 27 Fed 1 Battery  
Sec. 27-T26S-R34E  
Lea County, New Mexico

Gentlemen:

Devon Energy Production Company, L.P. is preparing to file an Application for Commingling of the three (3) wells below at the Mean Green 27 Fed 1 Battery:

Mean Green 22 Fed 1H  
Sec. 22-T26S-R34E  
Lea County, NM  
API #: 30-025-41434  
Lease: USA NMNM 112941

Mean Green 26 Fed 1H  
Sec. 26-T26S-R34E  
Lea County, NM  
API #: 30-025-41246  
Lease: USA NMNM 100568

Mean Green 27 Fed 1  
Sec. 22-T26S-R34E  
Lea County, NM  
API #: 30-025-41433  
Lease: USA NMNM 100569

Please be advised the ownership for all three of the aforesaid wells is identical. If you have any questions or need any other information, please do not hesitate to contact me at 405-552-6540.

Sincerely

A handwritten signature in black ink, appearing to read 'Henry W. Latimer, Sr.', written in a cursive style.

Henry W. Latimer, Sr  
Senior Land Advisor

A handwritten mark or signature in black ink, consisting of a stylized 'K' or similar character with a long horizontal stroke extending to the right.



Devon Energy Corporation  
333 West Sheridan Avenue  
Oklahoma City, OK 73102-5010

405 552-7970 Phone  
Erin.workman@dvn.com

RECEIVED OOD

2014 JUL 24 PM 3:32

July 22, 2014

Mr. Richard Ezeanyim  
State of New Mexico  
Oil Conservation Division  
1220 S. St. Francis Drive  
Santa Fe, New Mexico 87505

**Re: Central Tank Battery, Pool Commingling  
Mean Green 22 Fed 1H, Mean Green 26 Fed 1H, & Mean Green 27 Fed 1H  
API # 30-025-41433, 30-025-41434, & 30-025-41246  
Sec 22, T26S, R34E & Sec 27, T26S, R34R  
Lease NMNM112941, NMNM100568, & NMNM100569  
Pools: (98049) WC 025 G-06 S263422P (96149) Livingston Ridge; Delaware, South  
Lea County, New Mexico**

Dear Mr. Ezeanyim:

Please find attached the C-103 Sundry Notice of Intent for a Central Tank Battery, Pool Commingle for the aforementioned wells.

The BLM has been notified and a copy of their approval will be provided upon receipt.

The working interest, royalty interest and overriding royalty interest owners are identical; so no further notification is necessary.

Should you have any questions or need further assistance, please do not hesitate to contact me at (405) 552-7970.

Sincerely,

  
Erin Workman  
Regulatory Compliance Professional

Enclosures

# APPLICATION FOR CENTRAL TANK BATTERY, POOL COMMINGLE

## Proposal for Mean Green Wells:

Devon Energy Production Company, LP is requesting approval for the Central Tank Battery, Pool Commingle for the following wells:

Federal Lease NMNM112941 (12.5% Royalty Rate)							
Well Name	Location	API #	Pool 98049	BOPD	Oil Gravities	MCFPD	BTU
Mean Green 22 Fed 1H	SESE, Sec. 22, T26S, R34E	30-025-41434	WC 025 G-06 S263422P; Delaware	20	32.6	No gas at this time*	
Federal Lease NMNM100569 (12.5% Royalty Rate)							
Well Name	Location	API #	Pool 98049	BOPD	Oil Gravities	MCFPD	BTU
Mean Green 27 Fed 1	SESE, Sec. 22, T26S, R34E	30-025-41433	WC 025 G-06 S263422P; Delaware	20	32.6	No gas at this time	
Federal Lease NMNM100568 (12.5% Royalty Rate)							
Well Name	Location	API #	Pool 97597	BOPD	Oil Gravities	MCFPD	BTU
Mean Green 26 Fed 1H	NENE, Sec. 26, T26S, R34E	30-025-41246	Jabaline; Delaware, SW	20	32.6	No gas at this time*	

\*These are proposed numbers

Attached is a map which displays the federal leases and well locations in Section 22, T26S, R34E.

The BLM's interest in these wells are identical.

## Oil & Gas metering:

The central tank battery is located on the Mean Green 27 Fed 1H location in Sec 22, T26S, R34E. The production from each well will flow through it's own three phase separator with a Micro Motion Coriolis Meter to meter the oil, flow meter to meter the water, and gas allocation meter to meter the gas. VRU will be allocated back to each well utilizing a percentage of each wells monthly oil production

The Mean Green 27 Fed 1 Battery will have six oil tanks that these three wells will utilize and they have a common SUG Central Delivery Point (**Number provided upon receipt**) which is on location in Sec. 14, T26S, R34E in Lea County, NM. Oil, gas, and water volumes from each well producing to this battery will be determined by using individual test separator/heater treaters for each well at the proposed facility.

The Mean Green 22 Fed 1H flows to a three phase test separator, where after separation gas is routed to the gas test meter (**number provided upon receipt**), then to the SUG CDP (**number provided upon receipt**) on location in Sec. 14, T26S, R34E. The produced water and oil are separated, the oil is then metered with a Micro Coriolis meter (**number provided upon receipt**) and water is metered using a turbine meter. The oil then flows into an oil production line where it is combined with the other wells oil and flows to one of the 500 bbl. The water from this well flows to the 500 bbl. Produced water tank, along with the water from the other wells.

The Mean Green 26 Fed 1H flows to a three phase test separator, where after separation gas is routed to the gas test meter (**number provided upon receipt**), then to the SUG CDP (**number provided upon receipt**) on location in Sec. 14, T26S, R34E. The produced water and oil are separated, the oil is then metered with a Micro Coriolis meter (**number provided upon receipt**) and water is metered using a turbine meter. The oil then flows into an oil production line where it is combined with the other wells oil and flows to one of the 500 bbl. The water from this well flows to the 500 bbl. Produced water tank, along with the water from the other wells.

The Mean Green 27 Fed 1 flows to a three phase test separator, where after separation gas is routed to the gas test meter (**number provided upon receipt**), then to the SUG CDP (**number provided upon receipt**) on location in Sec.14, T26S, R34E. The produced water and oil are separated, the oil is then metered with a Micro Coriolis meter (**number provided upon receipt**) and water is metered using a turbine meter. The oil then flows into an oil production line where it is combined with the other wells oil and flows to one of the 500 bbl. The water from this well flows to the 500 bbl. Produced water tank, along with the water from the other wells.

Oil production will be allocated on a daily basis based on the Coriolis Test meter located downstream of the separator. The Coriolis meter will be proven, as per API, NMOC, and BLM specifications, when installed, once per month for the first 3 months (to establish a consistent repeatability factor), and then quarterly thereafter, the factor obtained will be used to allocate the production volumes. Gas production will be allocated on a daily basis utilizing the gas test meter for each well. The gas production from the production equipment and the test gas meter will commingle and flow through SUG CDP sales (**number**

**provided upon receipt!)** These meters will be calibrated on a regular basis per API, NMOCD and BLM specifications. The BLM and OCD will be notified of any future changes in the facilities.

**Process and Flow Descriptions:**

The flow of produced fluids is shown in detail on the enclosed facility diagram along with a description of each vessel and map which shows the lease boundaries, location of the wells, facility, and gas sales meter. The commingling of this production is the most effective, economic means of producing the reserves and will not result in reduced royalty or improper measurement of production. The proposed commingling will reduce operating expenses as well as reduce the surface facility footprint and overall emissions.

Devon Energy Production Company, LP understands the requested approval will not constitute the granting of any right-of-way or construction rights not granted by the lease instrument. Devon will submit within 30 days, an application for right-of-way approval to the BLM and NMOCD section in your office, if we have not already done so.

Working, royalty, and overriding interest owners are identical so no further notification is necessary.

Signed:



Printed Name: Erin Workman

Title: Regulatory Compliance Professional

Date: 07.22.14

DISTRICT I  
1625 N. French Dr., Hobbs, NM 88240  
Phone: (575) 393-6161 Fax: (575) 393-6729

DISTRICT II  
811 S. First St., Artesia, NM 88210  
Phone: (575) 748-1283 Fax: (575) 748-9729

DISTRICT III  
1081 New Mexico Rd., Aztec, NM 87410  
Phone: (505) 334-6178 Fax: (505) 334-6179

DISTRICT IV  
1220 S. St. Francis Dr., Santa Fe, NM 87505  
Phone: (505) 476-3460 Fax: (505) 476-3462

HOBBS OCD

SEP 23 2013

RECEIVED

State of New Mexico  
Energy, Minerals & Natural Resources Department  
OIL CONSERVATION DIVISION  
1220 South St. Francis Dr.  
Santa Fe, New Mexico 87505

Form C-102  
Revised August 1, 2011  
Submit one copy to appropriate  
District Office  
☐ AMENDED REPORT

WELL LOCATION AND ACREAGE DEDICATION PLAT

API Number <b>30-025-41434</b>	Pool Code <b>98049</b>	Property Name <b>MEAN GREEN 22 FED</b>	Well Number <b>1H</b>
Property Code <b>40149</b>	Operator Name <b>DEVON ENERGY PRODUCTION COMPANY, LP.</b>		Elevation <b>3215.8'</b>
OGRID No. <b>6137</b>	UNDESIGNATED DELAWARE		

Surface Location

UL or lot no.	Section	Township	Range	Lot Idn	Feet from the	North/South line	Feet from the	East/West line	County
P	22	26 S	34 E		150	SOUTH	480	EAST	LEA

Bottom Hole Location If Different From Surface

UL or lot no.	Section	Township	Range	Lot Idn	Feet from the	North/South line	Feet from the	East/West line	County
A	22	26 S	34 E		330	NORTH	330	EAST	LEA

Dedicated Acres	Joint or Infill	Consolidated Code	Order No.
160			

No allowable will be assigned to this completion until all interests have been consolidated or a non-standard unit has been approved by the division.

NW COR SEC 22 NMSP-E (NAD 83) Y = 377985.0' N X = 810005.7' W LAT. = N32° 02' 10.31" LONG. = W103° 27' 58.69"	MEAN GREEN 22 FED-1H BHL NMSP-E (NAD 83) Y = 377689.4' N X = 814962.3' E LAT. = N32° 02' 06.98" LONG. = W103° 27' 01.14"	330'	<p><b>OPERATOR CERTIFICATION</b></p> <p>I hereby certify that the information contained herein is true and complete to the best of my knowledge and belief, and that this organization either owns a working interest or unleased mineral interest in the land including the proposed bottom hole location or has a right to drill this well at this location pursuant to a contract with an owner of such a mineral or working interest or to voluntary pooling agreement or a compulsory pooling order heretofore entered by the division.</p> <p><i>Barry W. Hunt</i> 10/8/12 Signature Date <b>Barry W. Hunt</b> Print Name E-mail Address</p> <p><b>SURVEYORS CERTIFICATION</b></p> <p>I hereby certify that the well location shown on this plat was plotted from field notes of actual surveys made by me or under my supervision, and that the same is true and correct to the best of my belief.</p> <p>June 10, 2012 Date of Survey Signature and Seal of Professional Surveyor <b>JAMES E. TOMPKINS</b> 14729 Job No.: WTC48540 JAMES E. TOMPKINS 14729 Certificate Number</p>
	NE COR SEC 22 NMSP-E (NAD 83) Y = 378021.6' N X = 815289.6' W LAT. = N32° 02' 10.25" LONG. = W103° 26' 57.30"	4802.9'	
	SE COR SEC 22 NMSP-E (NAD 83) Y = 372740.4' N X = 815333.7' W LAT. = N32° 01' 17.98" LONG. = W103° 26' 57.29"	N 01° 18' 42" E	
SW COR SEC 22 NMSP-E (NAD 83) Y = 372712.6' N X = 810054.3' W LAT. = N32° 01' 18.13" LONG. = W103° 27' 58.61"	MEAN GREEN 22 FED-1H SHL NMSP-E (NAD 83) Y = 372887.7' N X = 814852.4' E LAT. = N32° 01' 19.48" LONG. = W103° 27' 02.87"	150' 480'	

ELG 9-26-2013

SEP 30 2013

District I  
1625 N. French Dr., Hobbs, NM 88240  
Phone: (575) 393-6161 Fax: (575) 393-0720  
District II  
311 S. First St., Artesia, NM 88210  
Phone: (575) 748-1283 Fax: (575) 748-9720  
District III  
1000 Rio Brazos Road, Aztec, NM 87410  
Phone: (505) 334-6178 Fax: (505) 334-6170  
District IV  
1220 S. St. Francis Dr., Santa Fe, NM 87505  
Phone: (505) 476-3460 Fax: (505) 476-3462

State of New Mexico  
Energy, Minerals & Natural Resources Department  
OIL CONSERVATION DIVISION  
1220 South St. Francis Dr.  
Santa Fe, NM 87505

Form C-102  
Revised August 1, 2011  
Submit one copy to appropriate  
District Office

☐ AMENDED REPORT

RECEIVED

WELL LOCATION AND ACREAGE DEDICATION PLAT

<sup>1</sup> API Number 30-025-4240	<sup>2</sup> Pool Code 97597	<sup>3</sup> Pool Name Jaba line BRUSHY CANYON, DELAWARE, SW
<sup>4</sup> Property Code 39988	<sup>5</sup> Property Name MEAN GREEN 26 FED	<sup>6</sup> Well Number 1H
<sup>7</sup> OGRID No. 6137	<sup>8</sup> Operator Name DEVON ENERGY PRODUCTION COMPANY, L.P.	<sup>9</sup> Elevation 3222.9

<sup>10</sup> Surface Location

UL or lot no.	Section	Township	Range	Lot Idn	Feet from the	North/South line	Feet from the	East/West line	County
A	26	26 S	34 E		25	NORTH	330	EAST	LEA

<sup>11</sup> Bottom Hole Location If Different From Surface

UL or lot no.	Section	Township	Range	Lot Idn	Feet from the	North/South line	Feet from the	East/West line	County
P	26	26 S	34 E		330	SOUTH	330	EAST	LEA

<sup>12</sup> Dedicated Acres	<sup>13</sup> Joint or Infill	<sup>14</sup> Consolidation Code	<sup>15</sup> Order No.
160			

No allowable will be assigned to this completion until all interests have been consolidated or a non-standard unit has been approved by the division.

<p>N89°58'22"W 2652.59 FT</p> <p>NW CORNER SEC. 26 LAT. = 32.0215968°N LONG. = 103.4492498°W NMSP EAST (FT) N = 372739.78 E = 815333.18</p> <p>W Q CORNER SEC. 26 LAT. = 32.0144075°N LONG. = 103.4492495°W NMSP EAST (FT) N = 370101.33 E = 815354.87</p> <p>SW CORNER SEC. 26 LAT. = 32.0071541°N LONG. = 103.4492496°W NMSP EAST (FT) N = 367462.50 E = 815376.42</p>		<p>S89°24'57"W 2647.49 FT</p> <p>N Q CORNER SEC. 26 LAT. = 32.0215968°N LONG. = 103.4406931°W NMSP EAST (FT) N = 372738.52 E = 817985.37</p> <p>MEAN GREEN 26 FED 1H ELEV. = 3222.9 LAT. = 32.0215402°N (NAD83) LONG. = 103.4332172°W NMSP EAST (FT) N = 372737.13 E = 820302.58</p> <p>SE CORNER SEC. 26 LAT. = 32.0071049°N LONG. = 103.4321476°W NMSP EAST (FT) N = 367488.48 E = 820677.87</p> <p>BOTTOM OF HOLE LAT. = 32.0080148°N LONG. = 103.4332121°W NMSP EAST (FT) N = 367816.76 E = 820345.14</p> <p>S Q CORNER SEC. 26 LAT. = 32.0071287°N LONG. = 103.4407204°W NMSP EAST (FT) N = 367475.10 E = 818020.38</p>		<p>SURFACE LOCATION 330' 25'</p> <p>N00°30'22"W 2633.20 FT</p> <p>N00°28'59"W 2644.83 FT</p> <p>330'</p>	
<p>N89°43'45"E 2644.39 FT</p> <p>N89°42'42"E 2657.93 FT</p>					

**<sup>17</sup> OPERATOR CERTIFICATION**

I hereby certify that the information contained herein is true and complete to the best of my knowledge and belief, and that this organization either owns a working interest or unleased mineral interest in the land including the proposed bottom hole location or has a right to drill this well at this location pursuant to a contract with an owner of such a mineral or working interest, or to a voluntary pooling agreement or a compulsory pooling order, heretofore entered by the Division.

Signature: *[Signature]* Date: 3/25/2013

David H. Cook Regulatory Specialist

Printed Name

david.cook@dmn.com E-mail Address

**<sup>18</sup> SURVEYOR CERTIFICATION**

I hereby certify that the well location shown on this plat was plotted from field notes of actual surveys made by me or under my supervision, and that the same is true and correct to the best of my belief.

JULY 5, 2012 Date of Survey

Signature and Stamp of Professional Surveyor: *[Signature]*

Certificate Number: 2201 MON 6 JAR 100 PLS 12797 SURVEY NO. 1176

PP: 25 FNL & 330 FEL

ELG 7-2-2013

JUL 08 2013

DISTRICT I  
1625 N. French Dr., Hobbs, NM 88240  
Phone: (505) 393-6161 Fax: (505) 393-0730

DISTRICT II  
511 S. First St., Artesia, NM 88210  
Phone: (505) 748-1243 Fax: (505) 748-1244

DISTRICT III  
1000 Rio Bravos Rd., Alamogordo, NM 87410  
Phone: (505) 334-6178 Fax: (505) 334-6170

DISTRICT IV  
1220 S. St. Francis Dr., Santa Fe, NM 87505  
Phone: (505) 476-7400 Fax: (505) 476-7401

State of New Mexico  
Energy, Minerals & Natural Resources Department  
OIL CONSERVATION DIVISION  
1220 South St. Francis Dr.  
Santa Fe, New Mexico 87505

Form C-102  
Revised August 1, 2011  
Submit one copy to appropriate  
District Office  
☐ AMENDED REPORT

WELL LOCATION AND ACREAGE DEDICATION PLAT

API Number 30-025-41433	Pool Code 98049	Pool Name Delaware
Property Code 40149	Property Name MEAN GREEN 27 FED	Well Number 1
OGRID No. 6137	Operator Name DEVON ENERGY PRODUCTION COMPANY, LP.	Elevation 3215.5'

Surface Location

UL or lot no.	Section	Township	Range	Lot Idn	Feet from the	North/South line	Feet from the	East/West line	County
P	22	26 S	34 E		100	SOUTH	480	EAST	LEA

Bottom Hole Location If Different From Surface

UL or lot no.	Section	Township	Range	Lot Idn	Feet from the	North/South line	Feet from the	East/West line	County
A	27	26 S	34 E		383	NORTH	349	EAST	LEA

Dedicated Acres	Joint or Infill	Consolidated Code	Order No.
80			

No allowable will be assigned to this completion until all interests have been consolidated or a non-standard unit has been approved by the division.

<p>NW COR SEC 22 NMSP-E (NAD 83) Y = 377985.0' N X = 810005.7' W LAT. = N32° 02' 10.31" LONG. = W103° 27' 58.69"</p>	<p>22</p> <p>MEAN GREEN 27 FED-1 SHL NMSP-E (NAD 83) Y = 372837.8' N X = 814852.8' E LAT. = N32° 01' 18.99" LONG. = W103° 27' 02.87"</p> <p>100' 480'</p> <p>COMMON COR SEC 22/27 NMSP-E (NAD 83) Y = 372712.6' N X = 810054.3' W LAT. = N32° 01' 18.13" LONG. = W103° 27' 58.61"</p>	<p>NE COR SEC 22 NMSP-E (NAD 83) Y = 378021.6' N X = 815289.6' W LAT. = N32° 02' 10.25" LONG. = W103° 26' 57.30"</p> <p>COMMON COR SEC 22/27 NMSP-E (NAD 83) Y = 372740.4' N X = 815333.7' W LAT. = N32° 01' 17.98" LONG. = W103° 26' 57.29"</p>	<p><b>OPERATOR CERTIFICATION</b> I hereby certify that the information contained herein is true and complete to the best of my knowledge and belief, and that this organization either owns a working interest or unleased mineral interest in the land including the proposed bottom hole location or has a right to drill this well at this location pursuant to a contract with an owner of such a mineral or working interest, or to voluntary pooling agreement or a compulsory pooling order heretofore entered by the division.</p> <p><i>Gwyn Smith</i> 4/9/14 Signature Date Gwyn Smith - Regulatory Print Name gwyn.smith@dmv.com E-mail Address</p> <p><b>SURVEYORS CERTIFICATION</b> I hereby certify that the well location shown on this plat was plotted from field notes of actual surveys made by me or under my supervision, and that the same is true and correct to the best of my belief.</p> <p>FEBRUARY 7, 2014 Date of Survey Signature and Seal of Professional Surveyor <i>James E. Tompkins</i> Job No. WTC48540 JAMES E. TOMPKINS 14729 Certificate Number</p>
--	---	--	--

PP: 379' FNL & 358' FEL

MAY 21 2014



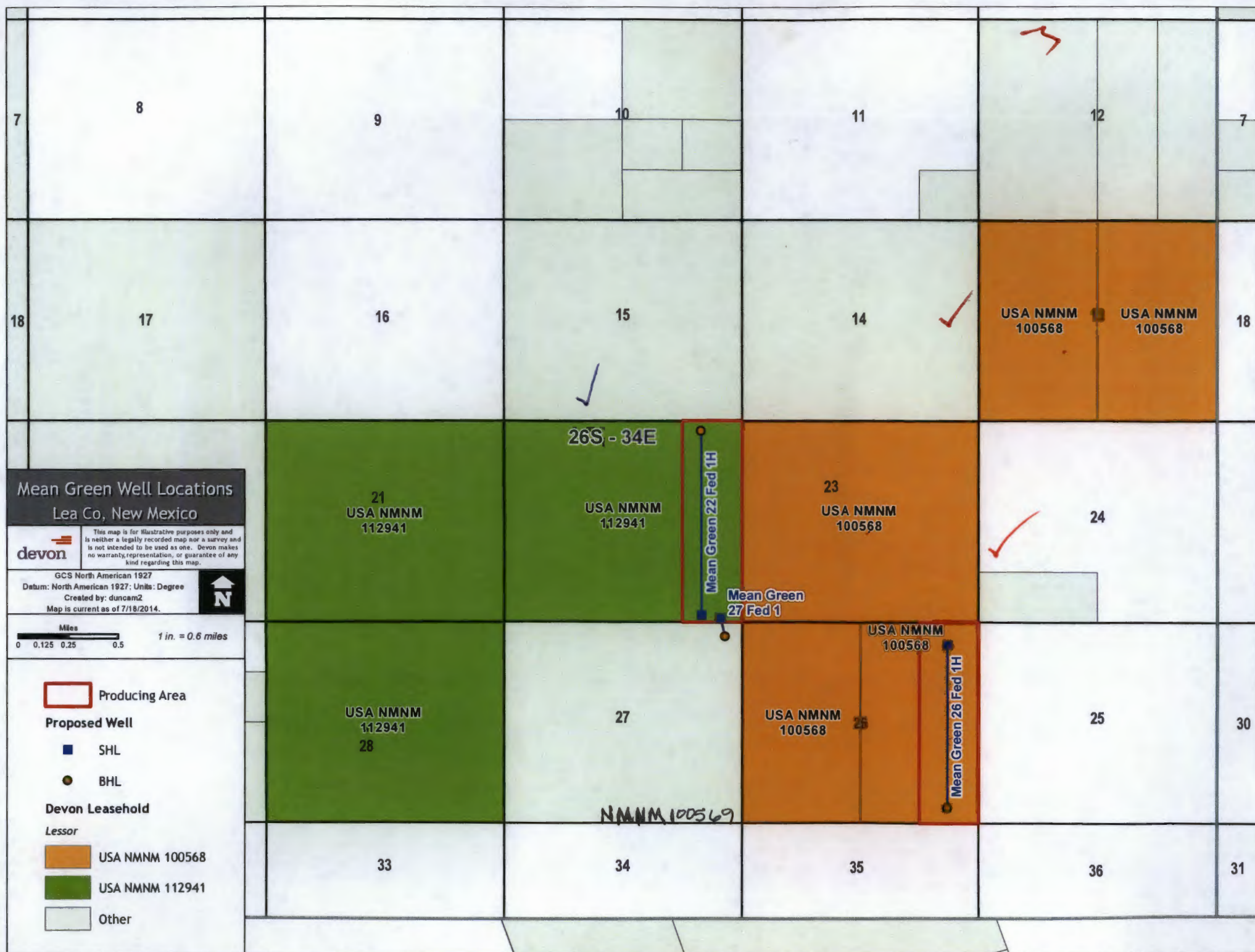



NMNM\_066927 NMNM\_066927  
NMNM\_066927 NMNM\_066927

NMNM\_100567 NMNM\_100567 NMNM\_100567  
NMNM\_100567 NMNM\_100567

NMNM\_094118 NMNM\_094118

NMNM\_094118  
NMNM\_094118

NMNM\_100568 NMNM\_100568  
NMNM\_100568 NMNM\_100568

NMNM\_112941 NMNM\_112941  
NMNM\_112941 NMNM\_112941

NMNM\_100568 NMNM\_100568  
NMNM\_100568 NMNM\_100568

NMNM\_065441 NMNM\_065441  
NMNM\_065441 NMNM\_065441

Mean Green 22 Fed 1H  
Mean Green 27 Fed 1  
**SUG CDP**  
Tank Battery

Mean Green 26 Fed 1H

NMNM\_100569 NMNM\_100569  
NMNM\_100569 NMNM\_100569

## Devon GIS Mapping



Disclaimer: This plat is for illustrative purposes only and is neither a legally recorded map nor a survey and is not intended to be used as one.

Scale: 1:18,056

Date Printed: 7/16/2014 4:43:30 PM



Mean Green 27 Fed 1H  
Sec.22, T26S, R34E  
API #30-025-41433  
100' FSL 480' FEL  
Lea County, NM

Production System: Open

All valves will be sealed 30  
minutes prior to sales

NOTE: ALL METER NUMBERS  
WILL BE ADDED WHEN  
AVAILABLE

Note:  
Devon Energy Site Security Plan  
located in the Artesia Main Office



## PROCESS FLOW DIAGRAM

