

DATE IN 8/03/2015	SUSPENSE	ENGINEER MAM	LOGGED IN 8/03/2015	TYPE PLC	APP NO. PHAM1521558596
----------------------	----------	-----------------	------------------------	-------------	---------------------------

ABOVE THIS LINE FOR DIVISION USE ONLY

Need DHC Application

NEW MEXICO OIL CONSERVATION DIVISION
- Engineering Bureau -
1220 South St. Francis Drive, Santa Fe, NM 87505



ADMINISTRATIVE APPLICATION CHECKLIST

THIS CHECKLIST IS MANDATORY FOR ALL ADMINISTRATIVE APPLICATIONS FOR EXCEPTIONS TO DIVISION RULES AND REGULATIONS WHICH REQUIRE PROCESSING AT THE DIVISION LEVEL IN SANTA FE

Application Acronyms:

[NSL-Non-Standard Location] [NSP-Non-Standard Proration Unit] [SD-Simultaneous Dedication]
[DHC-Downhole Commingling] [CTB-Lease Commingling] [PLC-Pool/Lease Commingling]
[PC-Pool Commingling] [OLS - Off-Lease Storage] [OLM-Off-Lease Measurement]
[WFX-Waterflood Expansion] [PMX-Pressure Maintenance Expansion]
[SWD-Salt Water Disposal] [IPI-Injection Pressure Increase]
[EOR-Qualified Enhanced Oil Recovery Certification] [PPR-Positive Production Response]

- [1] **TYPE OF APPLICATION** - Check Those Which Apply for [A]
[A] Location - Spacing Unit - Simultaneous Dedication
☐ NSL ☐ NSP ☐ SD
Check One Only for [B] or [C]
[B] Commingling - Storage - Measurement
☐ DHC ☐ CTB ☐ PLC ☒ PC ☐ OLS ☐ OLM
[C] Injection - Disposal - Pressure Increase - Enhanced Oil Recovery
☐ WFX ☐ PMX ☐ SWD ☐ IPI ☐ EOR ☐ PPR
[D] Other: Specify _____

*PLC
- BP America
production
company
778*

- [2] **NOTIFICATION REQUIRED TO:** - Check Those Which Apply, or ☐ Does Not Apply
[A] ☒ Working, Royalty or Overriding Royalty Interest Owners
[B] ☐ Offset Operators, Leaseholders or Surface Owner
[C] ☐ Application is One Which Requires Published Legal Notice
[D] ☒ Notification and/or Concurrent Approval by BLM or SLO
U.S. Bureau of Land Management - Commissioner of Public Lands, State Land Office
[E] ☒ For all of the above, Proof of Notification or Publication is Attached, and/or,
[F] ☐ Waivers are Attached

*Well
- FLORANCE #126
30-045-07807
- FLORANCE #126
30-045-25022
POU
- Basin Fruitland
CO #1
71624
- Basin Dakota
71544
- Otcho Chaco
82329
- Blanco Mesquite
72319*

- [3] **SUBMIT ACCURATE AND COMPLETE INFORMATION REQUIRED TO PROCESS THE TYPE OF APPLICATION INDICATED ABOVE.**

- [4] **CERTIFICATION:** I hereby certify that the information submitted with this application for administrative approval is **accurate** and **complete** to the best of my knowledge. I also understand that **no action** will be taken on this application until the required information and notifications are submitted to the Division.

Note: Statement must be completed by an individual with managerial and/or supervisory capacity.

Toya Colvin

Print or Type Name

Toya Colvin
Signature

Signature

Regulatory Analyst

Title

07/28/15

Date

Toya.Colvin@bp.com
e-mail Address

Submit 1, Copy To Appropriate District
Office
District I - (575) 393-6161
1625 N. French Dr., Hobbs, NM 88240
District II - (575) 748-1283
811 S. First St., Artesia, NM 88210
District III - (505) 334-6178
1000 Rio Brazos Rd., Aztec, NM 87410
District IV - (505) 476-3460
1220 S. St. Francis Dr., Santa Fe, NM
87505

State of New Mexico
Energy, Minerals and Natural Resources

Form C-103
Revised July 18, 2013

OIL CONSERVATION DIVISION
1220 South St. Francis Dr.
Santa Fe, NM 87505

WELL API NO. 30-045-33130, 30-045-25022, 30-045-07807
5. Indicate Type of Lease STATE <input type="checkbox"/> FEE <input type="checkbox"/>
6. State Oil & Gas Lease No. Federal Lease NMSF080000
7. Lease Name or Unit Agreement Name Florance #27S, Florance #126, Florance 27
8. Well Number
9. OGRID Number 000778
10. Pool name or Wildcat Basin Fruitland Coal-Florance 27S Otero Chacra/Basin DK- Florance 126 Blanco-Mesaverde- Florance 27

SUNDRY NOTICES AND REPORTS ON WELLS
(DO NOT USE THIS FORM FOR PROPOSALS TO DRILL OR TO DEEPEN OR PLUG BACK TO A
DIFFERENT RESERVOIR. USE "APPLICATION FOR PERMIT" (FORM C-101) FOR SUCH
PROPOSALS.)

1. Type of Well: Oil Well ☐ Gas Well ☒ Other

2. Name of Operator
BP America Production Company

3. Address of Operator
501 Westlake Park Blvd., Three Eldridge Place 12.181A
Houston, TX 77079

4. Well Location

Unit Letter **L**: **1670' (#27S) 1300' (#126), 1650' (#27)** feet from the **South** line and **990' (#27S), 1190' (#126), 990' (#27)** feet from the **West** line
Section **26** Township **29N** Range **09W** NMPM County **San Juan**

11. Elevation (Show whether DR, RKB, RT, GR, etc.)
5627'GL (#27S), 5626'GL (#126), 6525'GL (#27)

12. Check Appropriate Box to Indicate Nature of Notice, Report or Other Data

NOTICE OF INTENTION TO:

PERFORM REMEDIAL WORK ☐ PLUG AND ABANDON ☐
TEMPORARILY ABANDON ☐ CHANGE PLANS ☐
PULL OR ALTER CASING ☐ MULTIPLE COMPL ☐
DOWNHOLE COMMINGLE ☐
CLOSED-LOOP SYSTEM ☐
OTHER: **Surface Commingle** ☒

SUBSEQUENT REPORT OF:

REMEDIAL WORK ☐ ALTERING CASING ☐
COMMENCE DRILLING OPNS. ☐ P AND A ☐
CASING/CEMENT JOB ☐
OTHER: ☐

13. Describe proposed or completed operations. (Clearly state all pertinent details, and give pertinent dates, including estimated date of starting any proposed work). SEE RULE 19.15.7.14 NMAC. For Multiple Completions: Attach wellbore diagram of proposed completion or recompletion.

BP America Production Company respectfully requests permission to Surface Commingle the three subject wells, Florance 27S (Basin Fruitland Coal), Florance 126 (Basin Dakota/Otero Chacra), Florance 27 (Blanco-Mesaverde). The Florance 27S and Florance 126 currently have Surface Commingle Order PC-1181 which we would like to amend to add the Florance 27 well. The Florance 126 is an approved Non-Standard Location, Order NSL-1343, and DHC Order DHC-1017. BP would like to amend the allocation for the Florance 126 to: Basin Dakota= Oil 50%, Gas 50%, Water 50%, and Otero Chacra= Oil 50%, Gas 50%, Water 50%. Please see the attached documentation supporting our allocation for the Florance 126.

Surface commingling production from the existing Florance 27S (FC) Florance 126 (DK/CH) and Florance 27 (MV) will not reduce the economic life of the wells.

After separation, the production from each of the two wells is metered individually prior to commingling. The commingled gas will then be sent through compression prior to entering the sales meter. The difference between what is measured prior to commingling and what is sold through the sales meter is the fuel usage. The fuel usage is allocated back to each well based on the well production (see attached schematic).

The working interest, royalty and overriding royalty interest owners in the subject wells are not the same therefore notification is required and has been sent by certified mail to Conoco Phillips/Burlington Resources. Please see attached Land Letter. The proposed commingling of production is to reduce operating expenses between the 3 wells and will result in increased economic life of the wells.

Spud Date: **11/10/2005 #27S, 11/12/1981 #126,
06/30/1952 #27**

Rig Release Date:

I hereby certify that the information above is true and complete to the best of my knowledge and belief.

SIGNATURE Toya Colvin TITLE Regulatory Analyst DATE 07/28/2015

Type or print name Toya Colvin E-mail address: Toya.Colvin@bp.com PHONE: 281-366-7148

For State Use Only

APPROVED BY: _____ TITLE _____ DATE _____

Conditions of Approval (if any):

District I
1625 N. French Drive, Hobbs, NM 88240
District II
811 S. First St., Artesia, NM 88210
District III
1000 Rio Brazos Road, Aztec, NM 87410
District IV
1220 S. St Francis Dr, Santa Fe, NM
87505

State of New Mexico
Energy, Minerals and Natural Resources Department

Form C-107-B
Revised August 1, 2011

OIL CONSERVATION DIVISION
1220 S. St Francis Drive
Santa Fe, New Mexico 87505

Submit the original
application to the Santa Fe
office with one copy to the
appropriate District Office.

APPLICATION FOR SURFACE COMMINGLING (DIVERSE OWNERSHIP)

OPERATOR NAME: **BP America Production Company**

OPERATOR ADDRESS: **737 North Eldridge Parkway, Houston, TX 77079**

APPLICATION TYPE:

☒ Pool Commingling ☐ Lease Commingling ☐ Pool and Lease Commingling ☐ Off-Lease Storage and Measurement (Only if not Surface Commingled)

LEASE TYPE: ☐ Fee ☐ State ☒ Federal

Is this an Amendment to existing Order? ☒ Yes ☐ No If "Yes", please include the appropriate Order No. **PC-1181-0**
Have the Bureau of Land Management (BLM) and State Land office (SLO) been notified in writing of the proposed commingling
☒ Yes ☐ No

(A) POOL COMMINGLING

Please attach sheets with the following information

(1) Pool Names and Codes	Gravities / BTU of Non-Commingled Production	Calculated Gravities / BTU of Commingled Production		Calculated Value of Commingled Production	Volumes
Florance 027S (Basin Fruitland Coal 71629)	1108 BTU	1108 BTU		200 mcf/d	200 mcf/d
Florance 126 (Otero Chacra 82329)	1218 BTU	1218 BTU		50 mcf/d	50 mcf/d
Florance 126 (Basin Dakota 71599)	1218 BTU	1218 BTU		50 mcf/d	50 mcf/d
Florance 027 (Blanco-Mesaverde 72319)	1175 BTU	1175 BTU		100 mcf/d	100 mcf/d

- (2) Are any wells producing at top allowables? ☐ Yes ☒ No
(3) Have all interest owners been notified by certified mail of the proposed commingling? ☒ Yes ☐ No.
(4) Measurement type: ☒ Metering ☐ Other (Specify)
(5) Will commingling decrease the value of production? ☐ Yes ☒ No If "yes", describe why commingling should be approved

(B) LEASE COMMINGLING

Please attach sheets with the following information

- (1) Pool Name and Code.
(2) Is all production from same source of supply? ☐ Yes ☐ No
(3) Has all interest owners been notified by certified mail of the proposed commingling? ☐ Yes ☐ No
(4) Measurement type: ☐ Metering ☐ Other (Specify)

(C) POOL and LEASE COMMINGLING

Please attach sheets with the following information

- (1) Complete Sections A and E.

(D) OFF-LEASE STORAGE and MEASUREMENT

Please attached sheets with the following information

- (1) Is all production from same source of supply? ☐ Yes ☐ No
(2) Include proof of notice to all interest owners.

(E) ADDITIONAL INFORMATION (for all application types)

Please attach sheets with the following information

- (1) A schematic diagram of facility, including legal location.
(2) A plat with lease boundaries showing all well and facility locations. Include lease numbers if Federal or State lands are involved.
(3) Lease Names, Lease and Well Numbers, and API Numbers.

I hereby certify that the information above is true and complete to the best of my knowledge and belief.

SIGNATURE: Toya Colvin TITLE: Regulatory Analyst DATE: 07/28/2015

TYPE OR PRINT NAME Toya Colvin TELEPHONE NO.: 281-366-7148

E-MAIL ADDRESS: Toya.Colvin@bp.com

Florance 027, 027S and 126 CDP Shared Compression

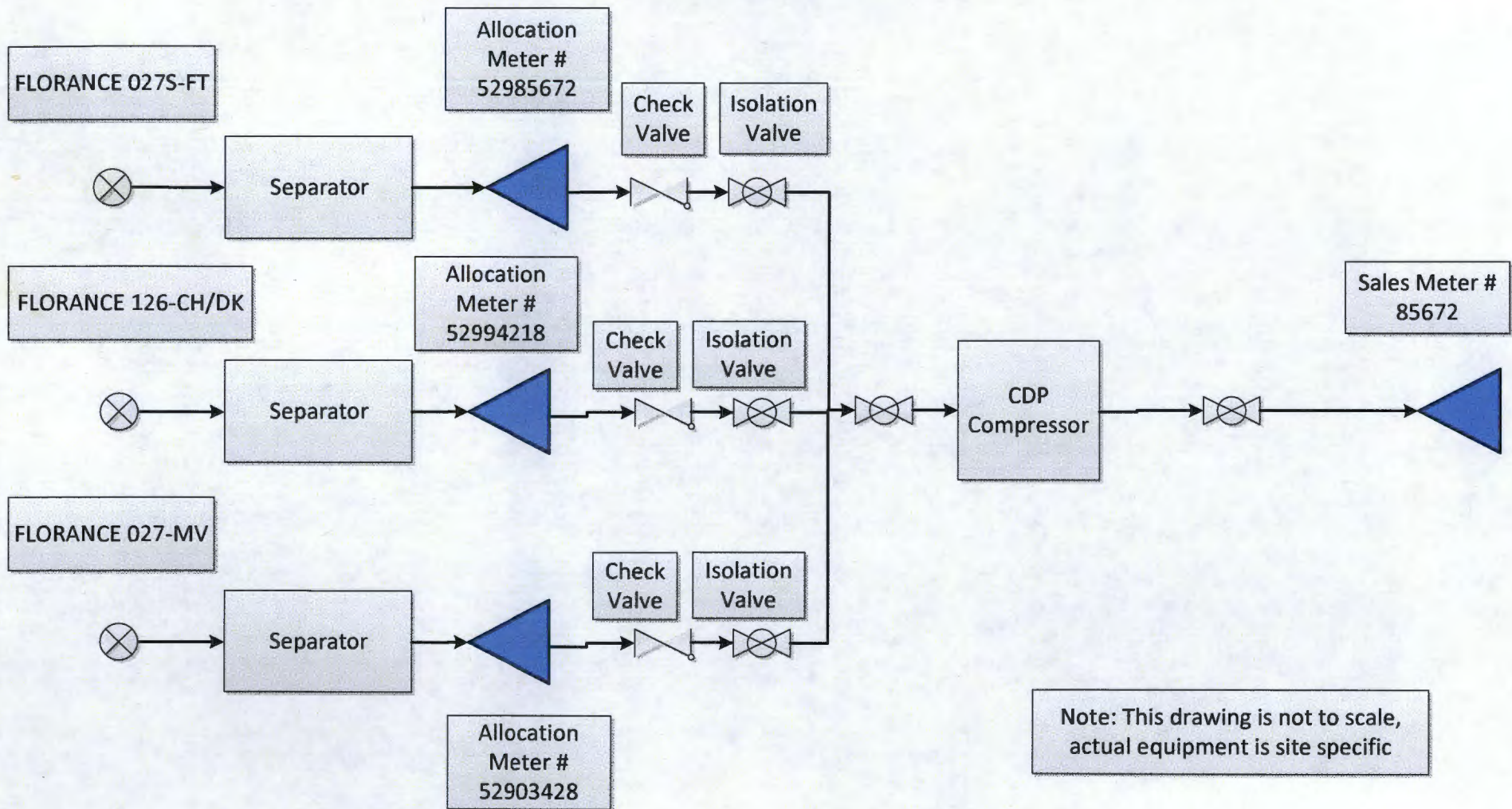

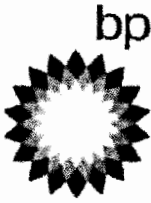

BP America Production Co.
Lower 48 Onshore

Craig T. Ferguson
craig.ferguson@bp.com
281-366-1988 (direct)

E3, 12.173B
501 Westlake Park Boulevard
Houston, Texas 77079

July 27, 2015

Ms. Toya Colvin – Regulatory Analyst
BP America Production Company
501 Westlake Park Blvd.
Houston, TX 77079

RE: Surface Commingle
API # 30-045-07807
SW/4 Section 26-T29N-R9W
San Juan County, NM, and
API #30-045-33130
SW/4 Section 26-T29N-R9W
San Juan County, NM, and
API #30-045-25022
SW/4 Section 26-T29N-R9W
San Juan County, NM

Ms. Colvin:

On behalf of BP America Production Company ("BP"), operator of the Florance 027 (MV) 320.0 acre unit defined as the W/2 and the Florance 027S (FT) 320 acre unit defined as the W/2, and the Florance 126 (CH/DK) 320 acre unit defined as the W/2, I have reviewed BP's division order records and other title records concerning the above reference wells and determined the following WI interest for both:

The Florance 027, Florance 27S, and the Florance 126 consist of one (1) Federal lease:
SF-080000, 297.13 acres, 1/8th Royalty

Florance 027 (API #3004507807)	WI
BP America Production Cos.	50.0%
ConocoPhillips	50.0%
Florance 027S (API #3004533130)	WI
BP America Production Cos.	50.0%
ConocoPhillips	50.0%

Florance 126 (API #3004525022)	WI
BP America Production Cos.	50.0%
ConocoPhillips	50.0%

Please contact me at x1988 if you have any questions concerning this topic.

Sincerely,

A handwritten signature in dark ink, appearing to read 'Craig T. Ferguson', with a stylized flourish at the end.

Craig T. Ferguson
Land Negotiator
San Juan Asset

District I
1625 N. French Dr., Hobbs, NM 88240
District II
1301 W. Grand Avenue, Artesia, NM 88210
District III
1000 Rio Brazos Rd., Aztec, NM 87410
District IV
1220 S. St. Francis Dr., Santa Fe, NM 87505

State of New Mexico
Energy, Minerals & Natural Resources Department
OIL CONSERVATION DIVISION
1220 South St. Francis Dr.
Santa Fe, NM 87505

Form C-102
Revised July 16, 2010
Submit one copy to appropriate
District Office
☐ AMENDED REPORT

WELL LOCATION AND ACREAGE DEDICATION PLAT

¹ API Number 30-045-25022	² Pool Code 71599	³ Pool Name Basin Dakota
⁴ Property Code 000518	⁵ Property Name Florance	⁶ Well Number 126
⁷ OGRID No. 000778	⁸ Operator Name BP America Production Company	⁹ Elevation 5626

¹⁰ Surface Location

UL or lot no. L	Section 26	Township 29N	Range 09W	Lot Idn	Feet from the 1300	North/South line South	Feet from the 1190	East/West line West	County San Juan
--------------------	---------------	-----------------	--------------	---------	-----------------------	---------------------------	-----------------------	------------------------	--------------------

¹¹ Bottom Hole Location If Different From Surface

UL or lot no.	Section	Township	Range	Lot Idn	Feet from the	North/South line	Feet from the	East/West line	County
¹² Dedicated Acres 295.73	¹³ Joint or Infill	¹⁴ Consolidation Code	¹⁵ Order No. R-11363, NSL 1343, DHC 1017						

No allowable will be assigned to this completion until all interests have been consolidated or a non-standard unit has been approved by the division.

¹⁶ 1190' 1300'	¹⁷ OPERATOR CERTIFICATION <i>I hereby certify that the information contained herein is true and complete to the best of my knowledge and belief, and that this organization either owns a working interest or unleased mineral interest in the land including the proposed bottom hole location or has a right to drill this well at this location pursuant to a contract with an owner of such a mineral or working interest, or to a voluntary pooling agreement or a compulsory pooling order heretofore entered by the division.</i> Signature Date 7/27/15 Tova Colvin Printed Name Tova.Colvin@bpc.com E-mail Address		
	¹⁸ SURVEYOR CERTIFICATION <i>I hereby certify that the well location shown on this plat was plotted from field notes of actual surveys made by me or under my supervision, and that the same is true and correct to the best of my belief.</i> Date of Survey Signature and Seal of Professional Surveyor: Previously Filed Certificate Number		

District I
1625 N. French Dr., Hobbs, NM 88240
District II
1301 W. Grand Avenue, Artesia, NM 88210
District III
1000 Rio Brazos Rd., Aztec, NM 87410
District IV
1220 S. St. Francis Dr., Santa Fe, NM 87505

State of New Mexico
Energy, Minerals & Natural Resources Department
OIL CONSERVATION DIVISION
1220 South St. Francis Dr.
Santa Fe, NM 87505

Form C-102
Revised July 16, 2010
Submit one copy to appropriate
District Office
☐ AMENDED REPORT

WELL LOCATION AND ACREAGE DEDICATION PLAT

¹ API Number 30-045-33130	² Pool Code 71629	³ Pool Name Basin Fruitland Coal
⁴ Property Code 000518	⁵ Property Name Florance	⁶ Well Number 27S
⁷ OGRID No. 000778	⁸ Operator Name BP America Production Company	⁹ Elevation 5627

¹⁰ Surface Location

UL or lot no. L	Section 26	Township 29N	Range 09W	Lot Idn	Feet from the 1670	North/South line South	Feet from the 990	East/West line West	County San Juan
--------------------	---------------	-----------------	--------------	---------	-----------------------	---------------------------	----------------------	------------------------	--------------------

¹¹ Bottom Hole Location If Different From Surface

UL or lot no.	Section	Township	Range	Lot Idn	Feet from the	North/South line	Feet from the	East/West line	County
¹² Dedicated Acres 295.73	¹³ Joint or Infill	¹⁴ Consolidation Code	¹⁵ Order No.						

No allowable will be assigned to this completion until all interests have been consolidated or a non-standard unit has been approved by the division.

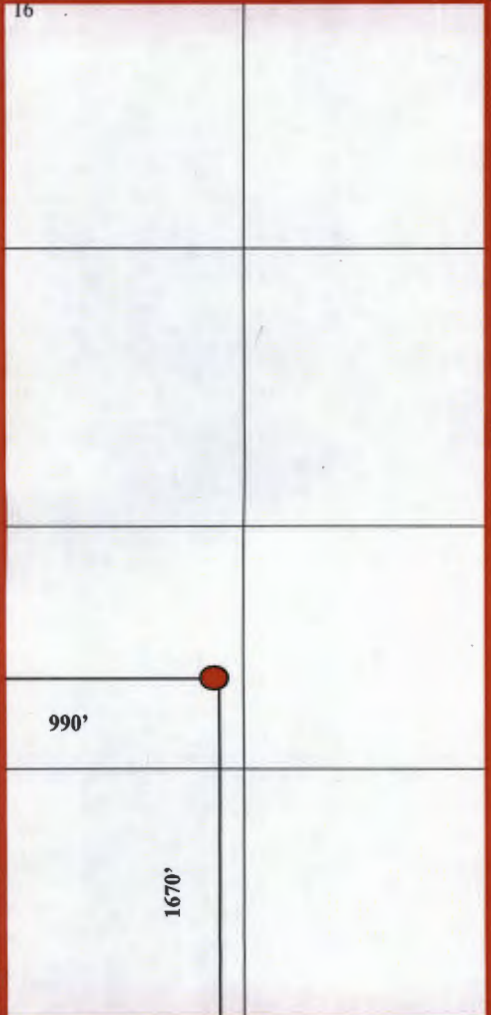
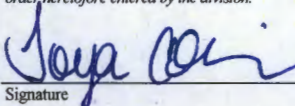
¹⁶ 	¹⁷ OPERATOR CERTIFICATION <i>I hereby certify that the information contained herein is true and complete to the best of my knowledge and belief, and that this organization either owns a working interest or unleased mineral interest in the land including the proposed bottom hole location or has a right to drill this well at this location pursuant to a contract with an owner of such a mineral or working interest, or to a voluntary pooling agreement or a compulsory pooling order, heretofore entered by the division.</i>  7/27/15 Signature Date Toya Colvin Printed Name Toya.Colvin@bp.com E-mail Address	
	¹⁸ SURVEYOR CERTIFICATION <i>I hereby certify that the well location shown on this plat was plotted from field notes of actual surveys made by me or under my supervision, and that the same is true and correct to the best of my belief.</i> Date of Survey Signature and Seal of Professional Surveyor: Previously Filed Certificate Number	

District I
1625 N. French Dr., Hobbs, NM 88240
District II
1301 W. Grand Avenue, Artesia, NM 88210
District III
1000 Rio Brazos Rd., Aztec, NM 87410
District IV
1220 S. St. Francis Dr., Santa Fe, NM 87505

State of New Mexico
Energy, Minerals & Natural Resources Department
OIL CONSERVATION DIVISION
1220 South St. Francis Dr.
Santa Fe, NM 87505

Form C-102
Revised July 16, 2010
Submit one copy to appropriate
District Office
☐ AMENDED REPORT

WELL LOCATION AND ACREAGE DEDICATION PLAT

¹ API Number 30-045-07807	² Pool Code 72319	³ Pool Name Blanco-Mesaverde
⁴ Property Code 000518	⁵ Property Name Florance	⁶ Well Number 27
⁷ OGRID No. 000778	⁸ Operator Name BP America Production Company	⁹ Elevation 6525

¹⁰ Surface Location

UL or lot no. L	Section 26	Township 29N	Range 09W	Lot Idn	Feet from the 1650	North/South line South	Feet from the 990	East/West line West	County San Juan
--------------------	---------------	-----------------	--------------	---------	-----------------------	---------------------------	----------------------	------------------------	--------------------

¹¹ Bottom Hole Location If Different From Surface

UL or lot no.	Section	Township	Range	Lot Idn	Feet from the	North/South line	Feet from the	East/West line	County
¹² Dedicated Acres 295.73	¹³ Joint or Infill	¹⁴ Consolidation Code	¹⁵ Order No.						

No allowable will be assigned to this completion until all interests have been consolidated or a non-standard unit has been approved by the division.

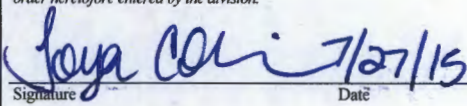
¹⁶					¹⁷ OPERATOR CERTIFICATION <i>I hereby certify that the information contained herein is true and complete to the best of my knowledge and belief, and that this organization either owns a working interest or unleased mineral interest in the land including the proposed bottom hole location or has a right to drill this well at this location pursuant to a contract with an owner of such a mineral or working interest, or to a voluntary pooling agreement or a compulsory pooling order heretofore entered by the division.</i>  Signature _____ Date 7/27/15 Toya Colvin Printed Name Toya.Colvin@bp.com E-mail Address
					¹⁸ SURVEYOR CERTIFICATION <i>I hereby certify that the well location shown on this plat was plotted from field notes of actual surveys made by me or under my supervision, and that the same is true and correct to the best of my belief.</i> Date of Survey Signature and Seal of Professional Surveyor: Previously Filed Certificate Number

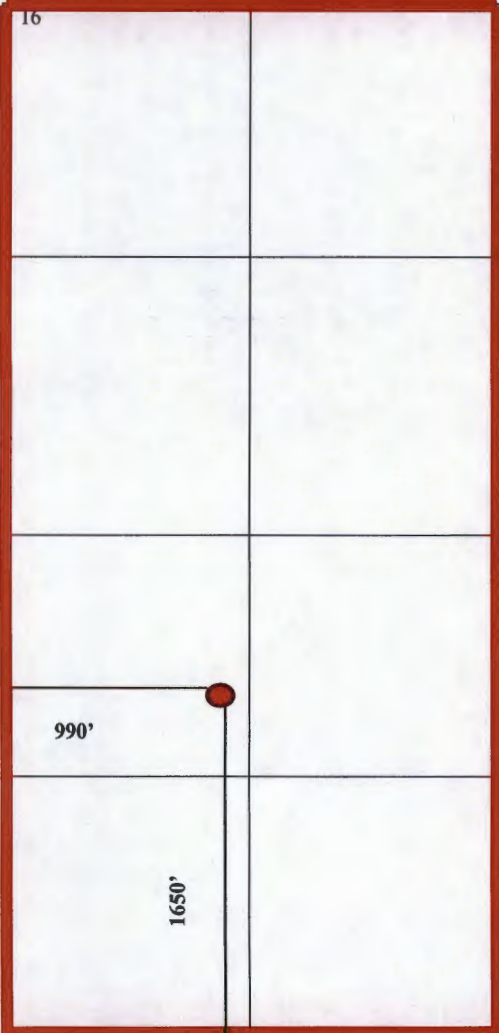

District I
1625 N. French Dr., Hobbs, NM 88240
District II
1301 W. Grand Avenue, Artesia, NM 88210
District III
1000 Rio Brazos Rd., Aztec, NM 87410
District IV
1220 S. St. Francis Dr., Santa Fe, NM 87505

State of New Mexico
Energy, Minerals & Natural Resources Department
OIL CONSERVATION DIVISION
1220 South St. Francis Dr.
Santa Fe, NM 87505

Form C-102
Revised July 16, 2010
Submit one copy to appropriate
District Office
☐ AMENDED REPORT

WELL LOCATION AND ACREAGE DEDICATION PLAT

¹ API Number 30-045-25022	² Pool Code 82329	³ Pool Name Otero Chacra
⁴ Property Code 000518	⁵ Property Name Florance	⁶ Well Number 126
⁷ OGRID No. 000778	⁸ Operator Name BP America Production Company	⁹ Elevation 5626

¹⁰ Surface Location

UL or lot no. L	Section 26	Township 29N	Range 09W	Lot Idn	Feet from the 1300	North/South line South	Feet from the 1190	East/West line West	County San Juan
---------------------------	----------------------	------------------------	---------------------	---------	------------------------------	----------------------------------	------------------------------	-------------------------------	---------------------------

¹¹ Bottom Hole Location If Different From Surface

UL or lot no.	Section	Township	Range	Lot Idn	Feet from the	North/South line	Feet from the	East/West line	County
¹² Dedicated Acres 145.33	¹³ Joint or Infill	¹⁴ Consolidation Code	¹⁵ Order No. R-11363, NSL 1343, DHC 1017						

No allowable will be assigned to this completion until all interests have been consolidated or a non-standard unit has been approved by the division.

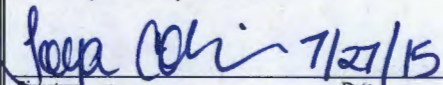
¹⁶				¹⁷ OPERATOR CERTIFICATION <i>I hereby certify that the information contained herein is true and complete to the best of my knowledge and belief, and that this organization either owns a working interest or unleased mineral interest in the land including the proposed bottom hole location or has a right to drill this well at this location pursuant to a contract with an owner of such a mineral or working interest, or to a voluntary pooling agreement or a compulsory pooling order heretofore entered by the division.</i>  Signature Date Tova Colvin Printed Name Tova.Colvin@tbp.com E-mail Address
				¹⁸ SURVEYOR CERTIFICATION <i>I hereby certify that the well location shown on this plat was plotted from field notes of actual surveys made by me or under my supervision, and that the same is true and correct to the best of my belief.</i> Date of Survey Signature and Seal of Professional Surveyor: Previously Filed Certificate Number



Proposed Allocation

Florance 126-CH/DK	Gas	Oil	Water
Chacra	50%	50%	50%
Dakota	50%	50%	50%

Gas Analysis

Florance 126-CH/DK

Date 9/11/2014
 Dry BTU 1218
 Specific Gravity 0.7088

Production Data

Florance 126-CH/DK

Compressed

Florance 117-DK

Not Compressed

Schwerdtfeger A 002E-CH

Not Compressed

Date	Gas Volume
7/5/2015	110
7/4/2015	117
7/3/2015	109
7/2/2015	114
7/1/2015	107
6/30/2015	109
6/29/2015	114
6/28/2015	110
6/27/2015	113
6/26/2015	113
6/25/2015	112
6/24/2015	116
6/23/2015	112
6/22/2015	116
6/21/2015	116
6/20/2015	116
6/19/2015	121
6/18/2015	118
6/17/2015	119
6/16/2015	122
6/15/2015	128
6/14/2015	130
6/13/2015	151
6/12/2015	108
6/11/2015	102
6/10/2015	102
6/9/2015	102
6/8/2015	102
6/7/2015	102
6/6/2015	102
6/5/2015	102
6/4/2015	102
6/3/2015	101
6/2/2015	104
6/1/2015	104
5/31/2015	103

Date	Gas Volume
7/5/2015	0
7/4/2015	0
7/3/2015	19
7/2/2015	32
7/1/2015	37
6/30/2015	39
6/29/2015	37
6/28/2015	38
6/27/2015	38
6/26/2015	36
6/25/2015	17
6/24/2015	17
6/23/2015	39
6/22/2015	37
6/21/2015	37
6/20/2015	37
6/19/2015	28
6/18/2015	15
6/17/2015	36
6/16/2015	37
6/15/2015	38
6/14/2015	34
6/13/2015	29
6/12/2015	34
6/11/2015	34
6/10/2015	36
6/9/2015	34
6/8/2015	33
6/7/2015	31
6/6/2015	34
6/5/2015	35
6/4/2015	35
6/3/2015	35
6/2/2015	36
6/1/2015	26
5/31/2015	0

Date	Gas Volume
7/5/2015	0
7/4/2015	0
7/3/2015	0
7/2/2015	0
7/1/2015	30
6/30/2015	47
6/29/2015	53
6/28/2015	57
6/27/2015	63
6/26/2015	0
6/25/2015	30
6/24/2015	44
6/23/2015	47
6/22/2015	49
6/21/2015	50
6/20/2015	50
6/19/2015	47
6/18/2015	46
6/17/2015	44
6/16/2015	53
6/15/2015	50
6/14/2015	40
6/13/2015	52
6/12/2015	51
6/11/2015	52
6/10/2015	57
6/9/2015	57
6/8/2015	64
6/7/2015	79
6/6/2015	0
6/5/2015	0
6/4/2015	27
6/3/2015	37
6/2/2015	55
6/1/2015	59
5/31/2015	4

5/30/2015	102
5/29/2015	103
5/28/2015	104
5/27/2015	104
5/26/2015	104
5/25/2015	102
5/24/2015	104
5/23/2015	103
5/22/2015	104
5/21/2015	104
5/20/2015	104
5/19/2015	104
5/18/2015	104
5/17/2015	104
5/16/2015	105
5/15/2015	105
5/14/2015	104
5/13/2015	105
5/12/2015	105
5/11/2015	107
5/10/2015	105
5/9/2015	104
5/8/2015	105
5/7/2015	106
5/6/2015	106
5/5/2015	104
5/4/2015	104
5/3/2015	105
5/2/2015	105
5/1/2015	110
4/30/2015	108
4/29/2015	106
4/28/2015	111
4/27/2015	105
4/26/2015	110
4/25/2015	110
4/24/2015	99
4/23/2015	109
4/22/2015	109
4/21/2015	108
4/20/2015	112
4/19/2015	108
4/18/2015	110
4/17/2015	108
4/16/2015	109
4/15/2015	111
4/14/2015	112
4/13/2015	112
4/12/2015	113
4/11/2015	113
4/10/2015	113
4/9/2015	113
4/8/2015	110
4/7/2015	115

5/30/2015	0
5/29/2015	30
5/28/2015	34
5/27/2015	35
5/26/2015	36
5/25/2015	35
5/24/2015	30
5/23/2015	6
5/22/2015	26
5/21/2015	32
5/20/2015	30
5/19/2015	33
5/18/2015	32
5/17/2015	34
5/16/2015	30
5/15/2015	34
5/14/2015	35
5/13/2015	31
5/12/2015	35
5/11/2015	31
5/10/2015	34
5/9/2015	35
5/8/2015	32
5/7/2015	35
5/6/2015	25
5/5/2015	30
5/4/2015	34
5/3/2015	33
5/2/2015	34
5/1/2015	36
4/30/2015	35
4/29/2015	31
4/28/2015	34
4/27/2015	34
4/26/2015	34
4/25/2015	34
4/24/2015	34
4/23/2015	33
4/22/2015	34
4/21/2015	36
4/20/2015	26
4/19/2015	27
4/18/2015	31
4/17/2015	40
4/16/2015	39
4/15/2015	36
4/14/2015	33
4/13/2015	38
4/12/2015	36
4/11/2015	36
4/10/2015	36
4/9/2015	32
4/8/2015	37
4/7/2015	38
4/6/2015	38

5/30/2015	46
5/29/2015	53
5/28/2015	38
5/27/2015	25
5/26/2015	51
5/25/2015	52
5/24/2015	12
5/23/2015	50
5/22/2015	57
5/21/2015	39
5/20/2015	10
5/19/2015	49
5/18/2015	54
5/17/2015	50
5/16/2015	12
5/15/2015	45
5/14/2015	28
5/13/2015	42
5/12/2015	45
5/11/2015	53
5/10/2015	51
5/9/2015	18
5/8/2015	48
5/7/2015	49
5/6/2015	38
5/5/2015	52
5/4/2015	62
5/3/2015	5
5/2/2015	52
5/1/2015	50
4/30/2015	30
4/29/2015	53
4/28/2015	58
4/27/2015	67
4/26/2015	81
4/25/2015	0
4/24/2015	0
4/23/2015	25
4/22/2015	43
4/21/2015	49
4/20/2015	63
4/19/2015	53
4/18/2015	0
4/17/2015	30
4/16/2015	49
4/15/2015	50
4/14/2015	51
4/13/2015	52
4/12/2015	52
4/11/2015	57
4/10/2015	64
4/9/2015	32
4/8/2015	16
4/7/2015	56
4/6/2015	59

4/5/2015	120
4/4/2015	114
4/3/2015	121
4/2/2015	121
4/1/2015	120
3/31/2015	113
3/30/2015	114
3/29/2015	118
3/28/2015	114
3/27/2015	118
3/26/2015	117
3/25/2015	118
3/24/2015	120
3/23/2015	129
3/22/2015	127
3/21/2015	124
3/20/2015	131
3/19/2015	131
3/18/2015	136
3/17/2015	127
3/16/2015	143
3/15/2015	148
3/14/2015	153
3/13/2015	157
3/12/2015	167
3/11/2015	186
3/10/2015	148
3/9/2015	0
3/8/2015	0
3/7/2015	0
3/6/2015	0
3/5/2015	0
3/4/2015	0
3/3/2015	0
3/2/2015	0
3/1/2015	0
2/28/2015	0
2/27/2015	0
2/26/2015	0
2/25/2015	0
2/24/2015	0
2/23/2015	0
2/22/2015	0
2/21/2015	0
2/20/2015	0
2/19/2015	0
2/18/2015	0
2/17/2015	0
2/16/2015	0
2/15/2015	0
2/14/2015	0
2/13/2015	0
2/12/2015	0
2/11/2015	0
2/10/2015	0

4/5/2015	37
4/4/2015	32
4/3/2015	36
4/2/2015	36
4/1/2015	37
3/31/2015	36
3/30/2015	34
3/29/2015	34
3/28/2015	36
3/27/2015	37
3/26/2015	36
3/25/2015	34
3/24/2015	37
3/23/2015	33
3/22/2015	38
3/21/2015	38
3/20/2015	38
3/19/2015	38
3/18/2015	39
3/17/2015	40
3/16/2015	34
3/15/2015	0
3/14/2015	0
3/13/2015	0
3/12/2015	9
3/11/2015	14
3/10/2015	33
3/9/2015	0
3/8/2015	0
3/7/2015	4
3/6/2015	16
3/5/2015	20
3/4/2015	22
3/3/2015	19
3/2/2015	31
3/1/2015	36
2/28/2015	37
2/27/2015	38
2/26/2015	19
2/25/2015	0
2/24/2015	5
2/23/2015	4
2/22/2015	7
2/21/2015	22
2/20/2015	32
2/19/2015	38
2/18/2015	26
2/17/2015	40
2/16/2015	37
2/15/2015	37
2/14/2015	36
2/13/2015	34
2/12/2015	38
2/11/2015	38
2/10/2015	38

4/5/2015	26
4/4/2015	19
4/3/2015	29
4/2/2015	42
4/1/2015	38
3/31/2015	52
3/30/2015	40
3/29/2015	34
3/28/2015	38
3/27/2015	43
3/26/2015	39
3/25/2015	38
3/24/2015	45
3/23/2015	36
3/22/2015	43
3/21/2015	44
3/20/2015	45
3/19/2015	46
3/18/2015	39
3/17/2015	41
3/16/2015	48
3/15/2015	39
3/14/2015	40
3/13/2015	47
3/12/2015	38
3/11/2015	39
3/10/2015	43
3/9/2015	37
3/8/2015	45
3/7/2015	35
3/6/2015	21
3/5/2015	26
3/4/2015	21
3/3/2015	18
3/2/2015	48
3/1/2015	20
2/28/2015	20
2/27/2015	20
2/26/2015	17
2/25/2015	34
2/24/2015	16
2/23/2015	16
2/22/2015	21
2/21/2015	20
2/20/2015	18
2/19/2015	21
2/18/2015	14
2/17/2015	17
2/16/2015	20
2/15/2015	17
2/14/2015	15
2/13/2015	19
2/12/2015	22
2/11/2015	18
2/10/2015	38

2/9/2015	3
2/8/2015	0
2/7/2015	0
2/6/2015	0
2/5/2015	0
2/4/2015	0
2/3/2015	0
2/2/2015	0
2/1/2015	0
1/31/2015	0
1/30/2015	0
1/29/2015	0
1/28/2015	1
1/27/2015	3
1/26/2015	4
1/25/2015	3
1/24/2015	3
1/23/2015	4
1/22/2015	5
1/21/2015	6
1/20/2015	5
1/19/2015	7
1/18/2015	7
1/17/2015	7
1/16/2015	7
1/15/2015	7
1/14/2015	2
1/13/2015	2
1/12/2015	4
1/11/2015	4
1/10/2015	3
1/9/2015	4
1/8/2015	3
1/7/2015	2

2/9/2015	38
2/8/2015	39
2/7/2015	39
2/6/2015	27
2/5/2015	0
2/4/2015	25
2/3/2015	31
2/2/2015	50
2/1/2015	40
1/31/2015	37
1/30/2015	42
1/29/2015	42
1/28/2015	39
1/27/2015	42
1/26/2015	19
1/25/2015	0
1/24/2015	0
1/23/2015	5
1/22/2015	38
1/21/2015	54
1/20/2015	44
1/19/2015	25
1/18/2015	0
1/17/2015	0
1/16/2015	0
1/15/2015	0
1/14/2015	0
1/13/2015	0
1/12/2015	0
1/11/2015	0
1/10/2015	0
1/9/2015	15
1/8/2015	0
1/7/2015	0

2/9/2015	19
2/8/2015	20
2/7/2015	20
2/6/2015	20
2/5/2015	19
2/4/2015	29
2/3/2015	20
2/2/2015	19
2/1/2015	31
1/31/2015	19
1/30/2015	19
1/29/2015	15
1/28/2015	14
1/27/2015	23
1/26/2015	22
1/25/2015	23
1/24/2015	18
1/23/2015	21
1/22/2015	22
1/21/2015	16
1/20/2015	21
1/19/2015	19
1/18/2015	42
1/17/2015	17
1/16/2015	17
1/15/2015	17
1/14/2015	19
1/13/2015	19
1/12/2015	22
1/11/2015	19
1/10/2015	20
1/9/2015	21
1/8/2015	27
1/7/2015	23

Production Data

Fiorance 128-CN/DK	Fiorance 117-DK	Schwerdtfeger A 002E-CH
Compressed	Not Compressed	Not Compressed

June Production	112		33		45
May Production	105		32		40
April Production	112		34		45
March Production	140		25		38
Feb Production			29		19
Jan Production			32		21

Offset Comparison

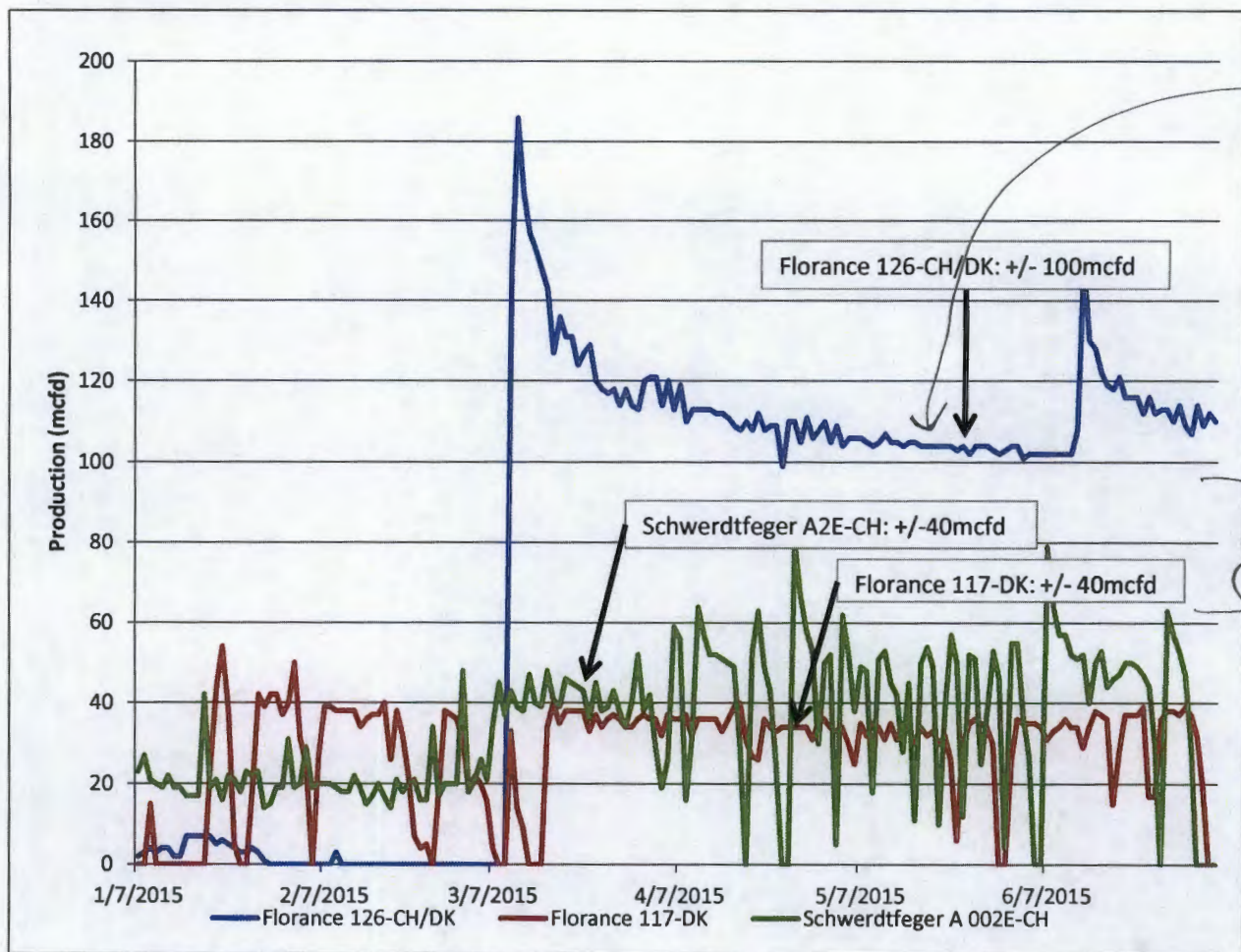

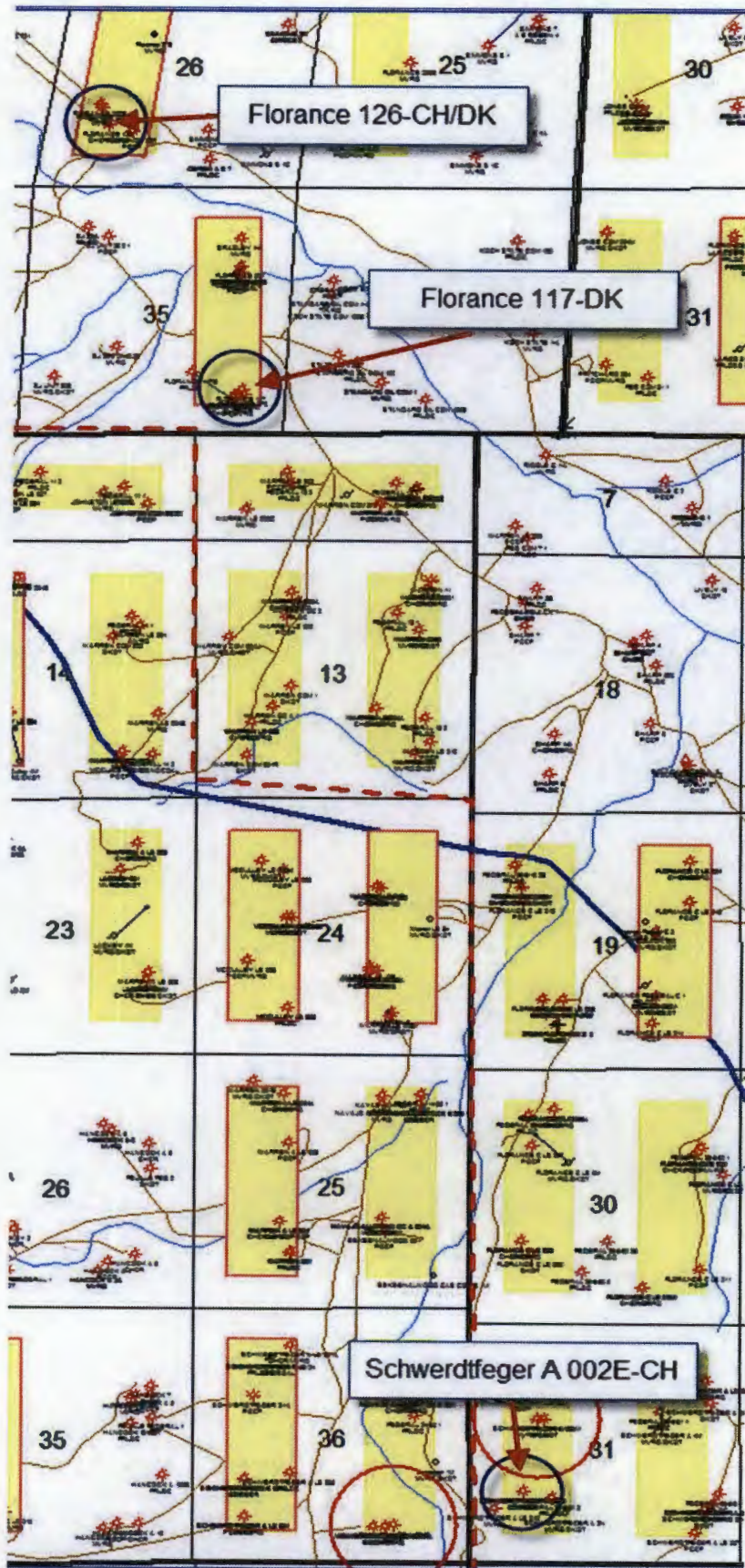

SENDER: COMPLETE THIS SECTION		COMPLETE THIS SECTION ON DELIVERY	
<ul style="list-style-type: none"> ■ Complete items 1, 2, and 3. Also complete item 4 if Restricted Delivery is desired. ■ Print your name and address on the reverse so that we can return the card to you. ■ Attach this card to the back of the mailpiece, or on the front if space permits. 		A. Signature X <div style="text-align: right;"> <input type="checkbox"/> Agent <input type="checkbox"/> Addressee </div>	
1. Article Addressed to: Conoco Phillips/Burlington Resources Attn: Land Dept. PO Box 4289 Farmington, NM 87499-4289		B. Received by (Printed Name)	C. Date of Delivery
2. Art (772) 7014 1820 0000 2635 5547		D. Is delivery address different from item 1? <input type="checkbox"/> Yes If YES, enter delivery address below: <input type="checkbox"/> No	
		3. Service Type <input checked="" type="checkbox"/> Certified Mail® <input type="checkbox"/> Priority Mail Express™ <input type="checkbox"/> Registered <input checked="" type="checkbox"/> Return Receipt for Merchandise <input type="checkbox"/> Insured Mail <input type="checkbox"/> Collect on Delivery	
		4. Restricted Delivery? (Extra Fee) <input type="checkbox"/> Yes	

PS Form 3811, July 2013 Domestic Return Receipt

PLACE STICKER AT TOP OF ENVELOPE TO THE RIGHT OF THE RETURN ADDRESS, FOLD AT DOTTED LINE
CERTIFIED MAIL®



7014 1820 0000 2635 5547

7014 1820 0000 2635 5547

U.S. Postal Service™
CERTIFIED MAIL® RECEIPT
Domestic Mail Only

For delivery information, visit our website at www.usps.com®.

OFFICIAL USE

Postage	\$	Postmark Here
Certified Fee		
Return Receipt Fee (Endorsement Required)		
Restricted Delivery Fee (Endorsement Required)		
Total Postage & Fees	\$	

Sent To: Conoco Phillips/Burlington Resources

Street & Apt. No. or PO Box No.: PO BOX 4289

City, State, ZIP+4: Farmington, NM 87499-4289

PS Form 3800, July 2014 See Reverse for Instructions

SENDER: COMPLETE THIS SECTION		COMPLETE THIS SECTION ON DELIVERY	
<ul style="list-style-type: none"> ■ Complete items 1, 2, and 3. Also complete item 4 if Restricted Delivery is desired. ■ Print your name and address on the reverse so that we can return the card to you. ■ Attach this card to the back of the mailpiece, or on the front if space permits. 		A. Signature X <input type="checkbox"/> Agent <input type="checkbox"/> Addressee	
1. Article Addressed to: Bureau of Land Management 6251 College Blvd. Suite A Farmington, NM 87402		B. Received by (Printed Name) C. Date of Delivery D. Is delivery address different from item 1? <input type="checkbox"/> Yes If YES, enter delivery address below: <input type="checkbox"/> No	
		3. Service Type <input checked="" type="checkbox"/> Certified Mail® <input type="checkbox"/> Priority Mail Express™ <input type="checkbox"/> Registered <input checked="" type="checkbox"/> Return Receipt for Merchandise <input type="checkbox"/> Insured Mail <input type="checkbox"/> Collect on Delivery	
		4. Restricted Delivery? (Extra Fee) <input type="checkbox"/> Yes	
2. Art (Tr) 7014 1820 0000 2635 5523			
PS Form 3811, July 2013		Domestic Return Receipt	

U.S. Postal Service™ CERTIFIED MAIL® RECEIPT Domestic Mail Only	
For delivery information, visit our website at www.usps.com ®.	
OFFICIAL USE	
Postage \$	Postmark Here
Certified Fee	
Return Receipt Fee (Endorsement Required)	
Restricted Delivery Fee (Endorsement Required)	
Total Postage & Fees \$	
Sent To <u>Bureau Land Management</u> Street & Apt. No., or PO Box No. <u>6251 College Blvd., Suite A</u> City, State, ZIP+4 <u>Farmington, NM 87402</u>	
PS Form 3800, July 2014 See Reverse for Instructions	

SENDER: COMPLETE THIS SECTION		COMPLETE THIS SECTION ON DELIVERY	
<ul style="list-style-type: none"> Complete items 1, 2, and 3. Also complete item 4 if Restricted Delivery is desired. Print your name and address on the reverse so that we can return the card to you. Attach this card to the back of the mailpiece, or on the front if space permits. 		A. Signature X <div style="text-align: right;"> <input type="checkbox"/> Agent <input type="checkbox"/> Addressee </div>	
1. Article Addressed to: <div style="border: 1px solid black; padding: 5px; margin-top: 10px;"> Bureau of Land Management 6251 College Blvd. Suite A Farmington, NM 87402 </div>		B. Received by (Printed Name)	C. Date of Delivery
		D. Is delivery address different from item 1? <input type="checkbox"/> Yes If YES, enter delivery address below: <input type="checkbox"/> No	
		3. Service Type <input checked="" type="checkbox"/> Certified Mail® <input type="checkbox"/> Priority Mail Express™ <input type="checkbox"/> Registered <input checked="" type="checkbox"/> Return Receipt for Merchandise <input type="checkbox"/> Insured Mail <input type="checkbox"/> Collect on Delivery	
		4. Restricted Delivery? (Extra Fee) <input type="checkbox"/> Yes	
2. At (ii) <u>7008 1140 0001 9414 9368</u>			

PS Form 3811, July 2013 Domestic Return Receipt

PS Form 3800, August 2006
See Reverse for Instructions

Sent To
Bureau Land Management
Street, Apt. No., or PO Box No.
6251 College Blvd. Suite A
City, State, ZIP+4
Farmington, NM 87402

Postage	Certified Fee	Return Receipt Fee (Endorsement Required)	Restricted Delivery Fee (Endorsement Required)	Total Postage & Fees
\$				\$

Postmark Here

OFFICIAL USE

For delivery information visit our website at www.usps.com

U.S. Postal Service™

CERTIFIED MAIL™ RECEIPT

(Domestic Mail Only; No Insurance Coverage Provided)

7008 1140 0001 9414 9368
7008 1140 0001 9414 9368
7008 1140 0001 9414 9368



CERTIFIED MAIL™

PLACE STICKER AT TOP OF ENVELOPE TO THE RIGHT OF THE RETURN ADDRESS. FOLD AT DOTTED LINE



NEW MEXICO ENERGY, MINERALS and NATURAL RESOURCES DEPARTMENT

BILL RICHARDSON

Governor

Joanna Prukop

Cabinet Secretary

Mark E. Fesmire, P.E.

Director

Oil Conservation Division

COMMINGLING ORDER PC-1181

BP America Production Company
501 Westlake Park Blvd
PO Box 3092
WL1-19.132
Houston, TX 77079

Attention: Cherry Hlava

The above-named company is hereby authorized to commingle gas production from the Basin-Dakota Prorated Gas (71599) Pool, the Basin-Fruitland Coal Gas (71629) Pool, and the Otero-Chacra Gas (79680) Pool from the following diverse ownership wells located on the same lease located in San Juan County, New Mexico.

Florance Well No. 27S (API 30-045-33130)
Lot 12 (Unit L), Section 26, Township 29 North, Range 9 West, NMPM
Basin-Fruitland Coal Gas Pool, E/2 (295.73 Acres) Sec 26 Dedication

Florance Well No. 126 (API 30-045-25022)
Lot 12 (Unit L), Section 26, Township 29 North, Range 9 West, NMPM
Otero-Chacra Gas Pool, SW/4 (145.33 Acres) Sec 26 Dedication, DHC-1017az with the
Basin-Dakota Prorated Gas Pool, E/2 (295.73 Acres) Sec 26 Dedication

Each of these wells shall be equipped with its own separator and allocation meter that will continuously meter production prior to commingling for sales. Gas production from each of the subject wells shall be determined by ratio utilizing allocation meter volumes and sales meter volumes. Oil shall not be commingled.

It is the responsibility of the producer to notify the transporter of this commingling authority. The operator shall notify the Aztec district office of the Division upon commencement of commingling operations.

Done, at Santa Fe, New Mexico on November 24, 2006.

MARK E. FESMIRE, P.E.,
Division Director

MEF/wvj

cc: Oil Conservation Division – Aztec
Bureau of Land Management-Farmington