

FEB 12 2018

Revised March 23, 2017

RECEIVED: 2/12/18	REVIEWER: LRL	TYPE: NSL	APP NO: PLEL1804635411
-------------------	---------------	-----------	------------------------

ABOVE THIS TABLE FOR OCD DIVISION USE ONLY

NEW MEXICO OIL CONSERVATION DIVISION

- Geological & Engineering Bureau -

1220 South St. Francis Drive, Santa Fe, NM 87505



ADMINISTRATIVE APPLICATION CHECKLIST

THIS CHECKLIST IS MANDATORY FOR ALL ADMINISTRATIVE APPLICATIONS FOR EXCEPTIONS TO DIVISION RULES AND REGULATIONS WHICH REQUIRE PROCESSING AT THE DIVISION LEVEL IN SANTA FE

Applicant: COG Operating LLC

OGRID Number: 229137

Well Name: Zeppo 5 Federal Com #17H

API: 30-025-

Pool: Maljamar; Yeso, West

Pool Code: 44500

SUBMIT ACCURATE AND COMPLETE INFORMATION REQUIRED TO PROCESS THE TYPE OF APPLICATION INDICATED BELOW

NSL-7635

1) **TYPE OF APPLICATION:** Check those which apply for [A]

A. Location - Spacing Unit - Simultaneous Dedication

☒ NSL☐ NSP (PROJECT AREA)☐ NSP (PRORATION UNIT)☐ SD

B. Check one only for [I] or [II]

[I] Commingling - Storage - Measurement

☐ DHC☐ CTB☐ PLC☐ PC☐ OLS☐ OLM

[II] Injection - Disposal - Pressure Increase - Enhanced Oil Recovery

☐ WFX☐ PMX☐ SWD☐ IPI☐ EOR☐ PPR

FEB 12 2018 AM 11:25

2) **NOTIFICATION REQUIRED TO:** Check those which apply.A. ☒ Offset operators or lease holdersB. ☐ Royalty, overriding royalty owners, revenue ownersC. ☐ Application requires published noticeD. ☐ Notification and/or concurrent approval by SLOE. ☐ Notification and/or concurrent approval by BLMF. ☐ Surface ownerG. ☒ For all of the above, proof of notification or publication is attached, and/or,H. ☐ No notice required**FOR OCD ONLY**

Notice Complete

Application
Content
Complete

3) **CERTIFICATION:** I hereby certify that the information submitted with this application for administrative approval is **accurate** and **complete** to the best of my knowledge. I also understand that **no action** will be taken on this application until the required information and notifications are submitted to the Division.

Note: Statement must be completed by an individual with managerial and/or supervisory capacity.

Robyn Russell

Print or Type Name

Signature

02/09/2018

Date

(432) 685-4385

Phone Number

Russell@concho.com

e-mail Address

District I
1625 N. French Dr., Hobbs, NM 88240
Phone: (575) 393-6161 Fax: (575) 393-0720
District II
811 S. First St., Artesia, NM 88210
Phone: (575) 748-1283 Fax: (575) 748-9720
District III
1000 Rio Brazos Road, Aztec, NM 87410
Phone: (505) 334-6178 Fax: (505) 334-6170
District IV
1220 S. St. Francis Dr., Santa Fe, NM 87505
Phone: (505) 476-3460 Fax: (505) 476-3462

State of New Mexico
Energy, Minerals & Natural Resources Department
OIL CONSERVATION DIVISION
1220 South St. Francis Dr.
Santa Fe, NM 87505

Form C-102
Revised August 1, 2011
Submit one copy to appropriate
District Office

☐ AMENDED REPORT

WELL LOCATION AND ACREAGE DEDICATION PLAT

1 API Number 30-025-		2 Pool Code 44500		3 Pool Name Maljamar; Yeso, West					
4 Property Code 319782		5 Property Name ZEPP0 5 FEDERAL COM						6 Well Number 17H	
7 OGRID NO. 229137		8 Operator Name COG OPERATING, LLC						9 Elevation 4107'	
10 Surface Location									
UL or lot no. G	Section 5	Township 17S	Range 32E	Lot Idn	Feet from the 2490	North/South line NORTH	Feet From the 1375	East/West line EAST	County LEA
11 Bottom Hole Location If Different From Surface									
UL or lot no. P	Section 8	Township 17S	Range 32E	Lot Idn	Feet from the 10	North/South line SOUTH	Feet from the 990	East/West line EAST	County LEA
12 Dedicated Acres 200		13 Joint or Infill		14 Consolidation Code		15 Order No.			

No allowable will be assigned to this completion until all interest have been consolidated or a non-standard unit has been approved by the division.

	<p>17 OPERATOR CERTIFICATION I hereby certify that the information contained herein is true and complete to the best of my knowledge and belief, and that this organization either owns a working interest or unleased mineral interest in the land including the proposed bottom hole location or has a right to drill this well at this location pursuant to a contract with an owner of such a mineral or working interest, or to a voluntary pooling agreement or a compulsory pooling order heretofore entered by the division.</p> <p>Signature: <i>[Signature]</i> Date: 11/29/17 Printed Name: Robyn M. Russell E-mail Address: Russell@concho.com</p>
	<p>18 SURVEYOR CERTIFICATION I hereby certify that the well location shown on this plat was plotted from field notes of actual surveys made by me or under my supervision, and that the same is true and correct to the best of my belief.</p> <p>10-31-2016 Date of Survey Signature and Seal of Professional Surveyor: <i>[Signature]</i> 19680 Certificate Number Rev: 10-17-17 BH</p>
	<p>19 CALCULATED POINTS 1: N 678377.5 - E 709899.8 2: N 670459.5 - E 709948.0</p>
	<p>20 CORNER DATA NAD 83 GRID - NW EAST A: FOUND BRASS CAP "1913" N: 670449.0 - E: 705989.7 B: FOUND BRASS CAP "1913" N: 673083.7 - E: 705979.1 C: FOUND 1-1/2" IRON PIPE N: 675723.3 - E: 705965.0 D: FOUND BRASS CAP "1913" N: 678363.7 - E: 705942.4 E: FOUND BRASS CAP "1913" N: 681002.8 - E: 705922.6 F: FOUND BRASS CAP "1913" N: 681021.0 - E: 711201.1 G: FOUND BRASS CAP "1913" N: 678382.0 - E: 711216.6 H: FOUND PK NAIL N: 675742.1 - E: 711243.8 I: FOUND BRASS CAP "1913" N: 673102.5 - E: 711246.5 J: FOUND BRASS CAP "1912" N: 670464.8 - E: 711264.7 K: FOUND BRASS CAP "1912" N: 670454.6 - E: 708627.4</p>

RRC - Job No.:

LS1608269D



Memorandum

To: Leonard Lowe
Engineering Bureau
New Mexico Oil Conservation Division

From: Bryan Montgomery
Reservoir Engineering Supervisor, NM Shelf Team
COG Operating LLC

Date: February 09, 2018

Subject: Zeppo 5 Federal Com #17H NSL Engineer Statement

COG Operating LLC (COG) is requesting a non-standard location exception (NSL) for this horizontal well to be able to access and drain Yeso reserves that would otherwise be left in the reservoir, thereby preventing waste of an economic resource. The Yeso is a very low permeability reservoir that does not sufficiently drain a great distance from wellbores and their hydraulic fractures. In addition, it would not be economical to try to access these reserves with a vertical well.

Zeppo 5 Federal Com #17H Land Plat

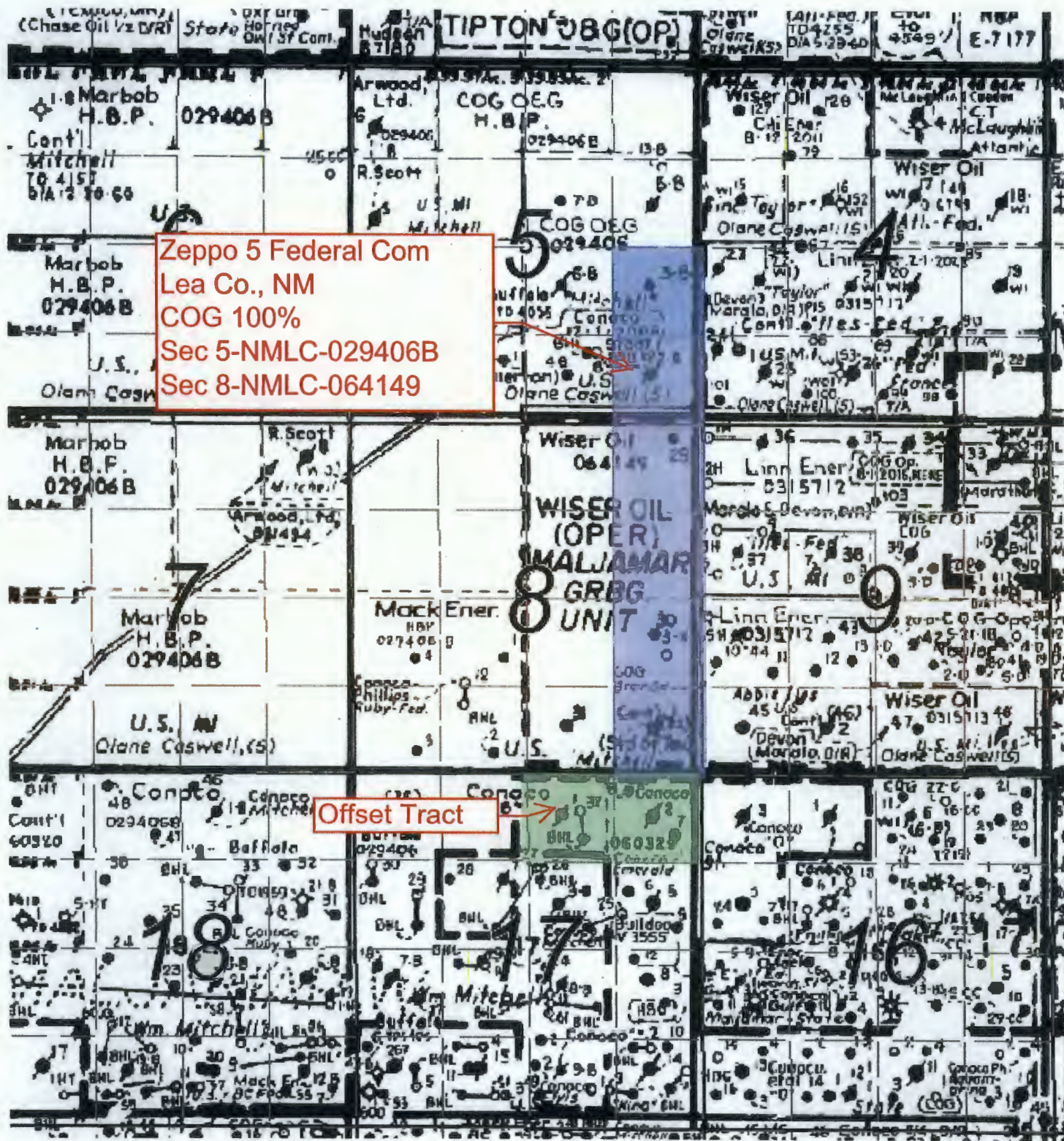



Sent Certified Mail
Receipt #: 91-7199-9991-7038-1610-8099

January 25, 2018

ConocoPhillips
600 North Dairy Ashford Rd., 2WL-15058
Houston, TX 77079

RE: Designation of Non-Standard Location by COG Operating LLC
Lea County, New Mexico

To Whom It May Concern,

This letter is to advise you that COG Operating LLC has filed the enclosed Well Dedication and Acreage Plats (C-102) with the New Mexico Oil Conservation Division seeking to designate non-standard location in Sections 5 & 8, T17S, R32E, Lea County, New Mexico.

Should your company have any objection, it must be filed in writing within twenty (20) days from the date of this notice. Non response within the 20 day notice shall constitute an approval/waiver of protest to COG's non-standard location.

Please contact me should you have any questions.

Sincerely,

A handwritten signature in black ink, appearing to read "Robyn Russell", written in a cursive style.

Robyn Russell
Regulatory Analyst
COG Operating, LLC
(432) 685-4385
Russell@concho.com

SENDER: COMPLETE THIS SECTION

- Complete items 1, 2, and 3.
- Print your name and address on the reverse so that we can return the card to you.
- Attach this card to the back of the mailpiece, or on the front if space permits.

1. A

ConocoPhillips
600 North Dairy Ashford Rd.,
2WL-1505
Houston, Texas 77079
Re: NSL-Zeppo 5 Fed Com #17H



9590 9402 2420 6249 0703 94

2 Article Number (Transfer from service label)

91 7199 9991 7038 1610 8099

PS Form 3811, July 2015 PSN 7530-02-000-9053

COMPLETE THIS SECTION ON DELIVERY

A. Signature

X

☐ Agent☐ Addressee

B. Received by (Printed Name)

C. Date of Delivery

D. Is delivery address different from item 1? ☐ Yes
If YES, enter delivery address below: ☐ No

3. Service Type

- | | |
|--|---|
| <input type="checkbox"/> Adult Signature | <input type="checkbox"/> Priority Mail Express® |
| <input type="checkbox"/> Adult Signature Restricted Delivery | <input type="checkbox"/> Registered Mail™ |
| <input checked="" type="checkbox"/> Certified Mail® | <input type="checkbox"/> Registered Mail Restricted Delivery |
| <input type="checkbox"/> Certified Mail Restricted Delivery | <input checked="" type="checkbox"/> Return Receipt for Merchandise |
| <input type="checkbox"/> Collect on Delivery | <input type="checkbox"/> Signature Confirmation™ |
| <input type="checkbox"/> Collect on Delivery Restricted Delivery | <input type="checkbox"/> Signature Confirmation Restricted Delivery |
| <input type="checkbox"/> Insured Mail | |

Restricted Delivery

Domestic Return Receipt

SENDER: COMPLETE THIS SECTION

- Complete items 1, 2, and 3.
- Print your name and address on the reverse so that we can return the card to you.
- Attach this card to the back of the mailpiece, or on the front if space permits.

1. A

ConocoPhillips
600 North Dairy Ashford Rd.,
2WL-1505
Houston, Texas 77079
Re: NSL-Zeppo 5 Fed Com #17H



9590 9402 2420 6249 0703 94

2 Article Number (Transfer from service label)

91 7199 9991 7038 1610 8099

PS Form 3811, July 2015 PSN 7530-02-000-9053

COMPLETE THIS SECTION ON DELIVERY

A. Signature

X

☐ Agent☐ Addressee

B. Received by (Printed Name)

C. Date of Delivery

D. Is delivery address different from item 1? ☐ Yes
If YES, enter delivery address below: ☐ No

FEB 02 2018

3. Service Type

- | | |
|--|---|
| <input type="checkbox"/> Adult Signature | <input type="checkbox"/> Priority Mail Express® |
| <input type="checkbox"/> Adult Signature Restricted Delivery | <input type="checkbox"/> Registered Mail™ |
| <input checked="" type="checkbox"/> Certified Mail® | <input type="checkbox"/> Registered Mail Restricted Delivery |
| <input type="checkbox"/> Certified Mail Restricted Delivery | <input checked="" type="checkbox"/> Return Receipt for Merchandise |
| <input type="checkbox"/> Collect on Delivery | <input type="checkbox"/> Signature Confirmation™ |
| <input type="checkbox"/> Collect on Delivery Restricted Delivery | <input type="checkbox"/> Signature Confirmation Restricted Delivery |
| <input type="checkbox"/> Insured Mail | |

Restricted Delivery

Domestic Return Receipt



CONOCO PHILLIPS

ONE CONCHO CENTER
600 W. ILLINOIS AVENUE
MIDLAND, TX 79701

91 7199 9991 7038 1610 8099



ConocoPhillips
600 North Dairy Ashford Rd.,
2WL-1505
Houston, Texas 77079

From: [Lowe, Leonard, EMNRD](#)
To: ["Robyn Russell"](#)
Cc: [Brown, Maxey G, EMNRD](#); [Kautz, Paul, EMNRD](#); [Jones, William V, EMNRD](#); [McMillan, Michael, EMNRD](#); [Goetze, Phillip, EMNRD](#); ["lisa@rwbyram.com"](#); ["jglover@blm.gov"](#); ["scaffey@blm.gov"](#); ["jstovall@blm.gov"](#)
Subject: APPROVED NSL-7635_COG Operating, LLC_Zeppo 5 Federal Com Well No. 17H_SEC 5 17S 32E
Date: Monday, March 12, 2018 9:13:00 AM
Importance: High

Robyn Russell,

The following Administrative Order has been issued:

ORDER: NSL-7635
OPERATOR: COG Operating, LLC
WELL: Zeppo 5 Federal Com Well No. 17H
API NO: 30-025-PENDING

The Order will soon be available on the Division's web site:

<http://ocdimage.emnrd.state.nm.us/Imaging/Default.aspx>

Enjoy your Monday!

Leonard Lowe

Engineering Bureau

Oil Conservation Division

Energy Minerals and Natural Resources Department

1220 South St. Frances

Santa Fe, New Mexico 87004

Office: 505-476-3492

Cell: 505-930-6717

Fax: 505-476-3462

E-mail: leonard.lowe@state.nm.us

Website: <http://www.emnrd.state.nm.us/ocd/>