

RECEIVED: 2/13/2018	REVIEWER: M Am	TYPE: WFX	APP NO: PMA1804459113
---------------------	----------------	-----------	-----------------------

ABOVE THIS TABLE FOR OCD DIVISION USE ONLY

NEW MEXICO OIL CONSERVATION DIVISION
 - Geological & Engineering Bureau -
 1220 South St. Francis Drive, Santa Fe, NM 87505



ADMINISTRATIVE APPLICATION CHECKLIST

THIS CHECKLIST IS MANDATORY FOR ALL ADMINISTRATIVE APPLICATIONS FOR EXCEPTIONS TO DIVISION RULES AND REGULATIONS WHICH REQUIRE PROCESSING AT THE DIVISION LEVEL IN SANTA FE

Applicant: Apache Corporation **OGRID Number:** 873
Well Name: East Blinbry Drinkard Unit 25 **API:** 30-025-06531
Pool: Eunice; BLI-TU-DR, North **Pool Code:** 22900

SUBMIT ACCURATE AND COMPLETE INFORMATION REQUIRED TO PROCESS THE TYPE OF APPLICATION INDICATED BELOW

WFX-978

- 1) **TYPE OF APPLICATION:** Check those which apply for [A]
 A. Location - Spacing Unit - Simultaneous Dedication
 NSL NSP (PROJECT AREA) NSP (PRORATION UNIT) SD
 B. Check one only for [I] or [II]
 [I] Commingling - Storage - Measurement
 DHC CTB PLC PC OLS OLM
 [II] Injection - Disposal - Pressure Increase - Enhanced Oil Recovery
 WFX PMX SWD IPI EOR PPR

FEB 13 2018 PM 04:29

- 2) **NOTIFICATION REQUIRED TO:** Check those which apply.
 A. Offset operators or lease holders
 B. Royalty, overriding royalty owners, revenue owners
 C. Application requires published notice
 D. Notification and/or concurrent approval by SLO
 E. Notification and/or concurrent approval by BLM
 F. Surface owner
 G. For all of the above, proof of notification or publication is attached, and/or,
 H. No notice required

FOR OCD ONLY	
<input type="checkbox"/>	Notice Complete
<input type="checkbox"/>	Application Content Complete

3) **CERTIFICATION:** I hereby certify that the information submitted with this application for administrative approval is **accurate** and **complete** to the best of my knowledge. I also understand that **no action** will be taken on this application until the required information and notifications are submitted to the Division.

Note: Statement must be completed by an individual with managerial and/or supervisory capacity.

Brian Wood

Print or Type Name

Signature

2-12-18
Date

505 466-8120
Phone Number

brian@permitswest.com
e-mail Address

APPLICATION FOR AUTHORIZATION TO INJECT

I. PURPOSE: XXX Secondary Recovery _____ Pressure Maintenance _____ Disposal _____ Storage _____
Application qualifies for administrative approval? XXX Yes _____ No

II. OPERATOR: APACHE CORPORATION

ADDRESS: 303 VETERANS AIRPARK LANE, SUITE 3000, MIDLAND, TX 79705

CONTACT PARTY: BRIAN WOOD (PERMITS WEST, INC.) PHONE: 505 466-8120

III. WELL DATA: Complete the data required on the reverse side of this form for each well proposed for injection.
Additional sheets may be attached if necessary.

IV. Is this an expansion of an existing project? _____ Yes XXX No
If yes, give the Division order number authorizing the project: R-12981

V. Attach a map that identifies all wells and leases within two miles of any proposed injection well with a one-half mile radius circle drawn around each proposed injection well. This circle identifies the well's area of review.

VI. Attach a tabulation of data on all wells of public record within the area of review which penetrate the proposed injection zone. Such data shall include a description of each well's type, construction, date drilled, location, depth, record of completion, and a schematic of any plugged well illustrating all plugging detail.

EAST BLINEBRY DRINKARD UNIT 25

VII. Attach data on the proposed operation, including: **30-025-06531**

1. Proposed average and maximum daily rate and volume of fluids to be injected;
2. Whether the system is open or closed;
3. Proposed average and maximum injection pressure;
4. Sources and an appropriate analysis of injection fluid and compatibility with the receiving formation if other than reinjected produced water; and,
5. If injection is for disposal purposes into a zone not productive of oil or gas at or within one mile of the proposed well, attach a chemical analysis of the disposal zone formation water (may be measured or inferred from existing literature, studies, nearby wells, etc.).

*VIII. Attach appropriate geologic data on the injection zone including appropriate lithologic detail, geologic name, thickness, and depth. Give the geologic name, and depth to bottom of all underground sources of drinking water (aquifers containing waters with total dissolved solids concentrations of 10,000 mg/l or less) overlying the proposed injection zone as well as any such sources known to be immediately underlying the injection interval.

IX. Describe the proposed stimulation program, if any.

*X. Attach appropriate logging and test data on the well. (If well logs have been filed with the Division, they need not be resubmitted).

*XI. Attach a chemical analysis of fresh water from two or more fresh water wells (if available and producing) within one mile of any injection or disposal well showing location of wells and dates samples were taken.

XII. Applicants for disposal wells must make an affirmative statement that they have examined available geologic and engineering data and find no evidence of open faults or any other hydrologic connection between the disposal zone and any underground sources of drinking water.

XIII. Applicants must complete the "Proof of Notice" section on the reverse side of this form.

XIV. Certification: I hereby certify that the information submitted with this application is true and correct to the best of my knowledge and belief.

NAME: BRIAN WOOD  TITLE: CONSULTANT

SIGNATURE: _____ DATE: JAN. 29, 2018

E-MAIL ADDRESS: brian@permitswest.com

* If the information required under Sections VI, VIII, X, and XI above has been previously submitted, it need not be resubmitted. Please show the date and circumstances of the earlier submittal: _____

III. WELL DATA

A. The following well data must be submitted for each injection well covered by this application. The data must be both in tabular and schematic form and shall include:

- (1) Lease name; Well No.; Location by Section, Township and Range; and footage location within the section.
- (2) Each casing string used with its size, setting depth, sacks of cement used, hole size, top of cement, and how such top was determined.
- (3) A description of the tubing to be used including its size, lining material, and setting depth.
- (4) The name, model, and setting depth of the packer used or a description of any other seal system or assembly used.

Division District Offices have supplies of Well Data Sheets which may be used or which may be used as models for this purpose. Applicants for several identical wells may submit a "typical data sheet" rather than submitting the data for each well.

B. The following must be submitted for each injection well covered by this application. All items must be addressed for the initial well. Responses for additional wells need be shown only when different. Information shown on schematics need not be repeated.

- (1) The name of the injection formation and, if applicable, the field or pool name.
- (2) The injection interval and whether it is perforated or open-hole.
- (3) State if the well was drilled for injection or, if not, the original purpose of the well.
- (4) Give the depths of any other perforated intervals and detail on the sacks of cement or bridge plugs used to seal off such perforations.
- (5) Give the depth to and the name of the next higher and next lower oil or gas zone in the area of the well, if any.

XIV. PROOF OF NOTICE

All applicants must furnish proof that a copy of the application has been furnished, by certified or registered mail, to the owner of the surface of the land on which the well is to be located and to each leasehold operator within one-half mile of the well location.

Where an application is subject to administrative approval, a proof of publication must be submitted. Such proof shall consist of a copy of the legal advertisement which was published in the county in which the well is located. The contents of such advertisement must include:

- (1) The name, address, phone number, and contact party for the applicant;
- (2) The intended purpose of the injection well; with the exact location of single wells or the Section, Township, and Range location of multiple wells;
- (3) The formation name and depth with expected maximum injection rates and pressures; and,
- (4) A notation that interested parties must file objections or requests for hearing with the Oil Conservation Division, 1220 South St. Francis Dr., Santa Fe, New Mexico 87505, within 15 days.

NO ACTION WILL BE TAKEN ON THE APPLICATION UNTIL PROPER PROOF OF NOTICE HAS BEEN SUBMITTED.

NOTICE: Surface owners or offset operators must file any objections or requests for hearing of administrative applications within 15 days from the date this application was mailed to them.

INJECTION WELL DATA SHEET

OPERATOR: APACHE CORPORATION

WELL NAME & NUMBER: EAST BLINEBRY DRINKARD UNIT 25

WELL LOCATION: 1980' FNL & 1980' FWL

UNIT LETTER: F SECTION: 11 TOWNSHIP: 21 S RANGE: 37 E

FOOTAGE LOCATION

SECTION: 11 TOWNSHIP: 21 S RANGE: 37 E

WELLBORE SCHEMATIC

WELL CONSTRUCTION DATA

" AS IS"

(not to scale)

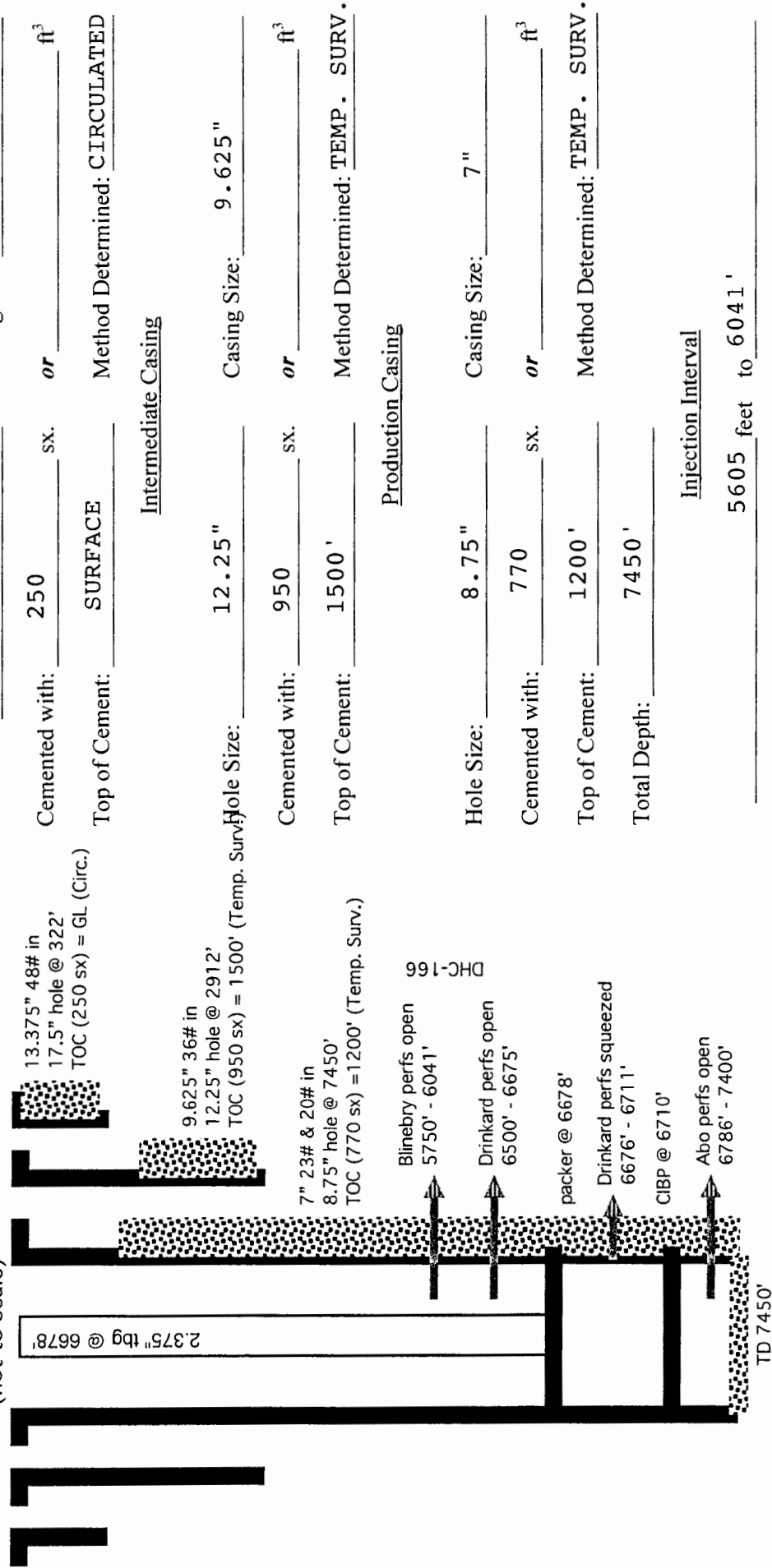

(Perforated or Open Hole; indicate which)

INJECTION WELL DATA SHEET

OPERATOR: APACHE CORPORATION

WELL NAME & NUMBER: EAST BLINEBRY DRINKARD UNIT 25

WELL LOCATION: 1980' FNL & 1980' FWL

UNIT LETTER: F

SECTION: 11

TOWNSHIP: 21 S

37 E

FOOTAGE LOCATION

RANGE

WELLBORE SCHEMATIC

WELL CONSTRUCTION DATA
Surface Casing

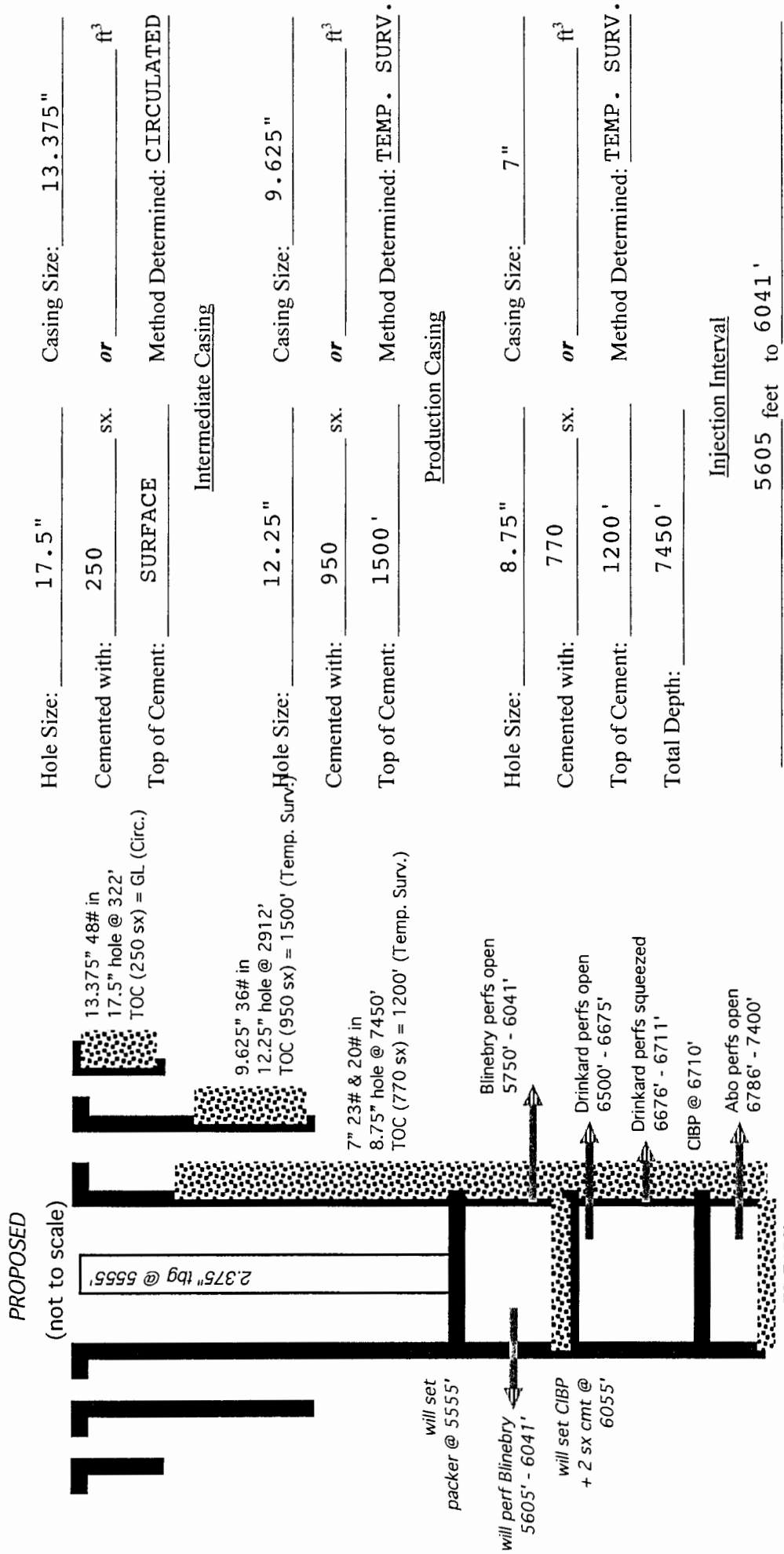

(Perforated or Open Hole; indicate which)

INJECTION WELL DATA SHEET

Tubing Size: 2-3/8" J-55 4.7# Lining Material: INTERNAL PLASTIC COAT

Type of Packer: LOCK SET INJECTION

Packer Setting Depth: ≈5555'

Other Type of Tubing/Casing Seal (if applicable): _____

Additional Data

1. Is this a new well drilled for injection? Yes XXX No _____
 If no, for what purpose was the well originally drilled? DRINKARD & ABO OIL WELL

2. Name of the Injection Formation: BLINEBRY

3. Name of Field or Pool (if applicable): EUNICE; BLI-TU-DR, NORTH (POOL CODE 22900)

4. Has the well ever been perforated in any other zone(s)? List all such perforated intervals and give plugging detail, i.e. sacks of cement or plug(s) used. _____
NO

5. Give the name and depths of any oil or gas zones underlying or overlying the proposed injection zone in this area: _____
OVER: 7 RIVERS (2852'), QUEEN (3408'), GRAYBURG (3750'),
SAN ANDRES (3964')
UNDER: TUBB (6152'), DRINKARD (6487'), ABO (6745')

I. Goal is to convert a 7450' deep oil well to a water injection well to increase oil recovery. The well will inject (5605' - 6041') into the Blinebry, which is part of the Eunice; Blinebry-Tubb-Drinkard, North Pool (aka, Eunice; BLI-TU-DR, North and pool code = 22900).

Well and zone are in the East Blinebry Drinkard Unit (Case Numbers 13503 and 13504, Order Numbers R-12394 and R-12395) that was established in 2005 by Apache. There have been 6 subsequent WFX approvals (WFX-819, -842, -904, -909, -963, & -969). This is an active water flood. Twenty-four water injectors are in the Unit. Injection increase to 2100 psi was authorized (IPI-292) in 2008.

II. Operator: Apache Corporation (OGRID #873)
Operator phone number: (432) 818-1167
Operator address: 303 Veterans Airpark Lane, Suite 3000
Midland, TX 79705
Contact for Application: Brian Wood (Permits West, Inc.)
Phone: (505) 466-8120

III. A. (1) Lease: BLM (NMNM-125057)
Lease Size: 1200 acres (see Exhibit A for maps and C-102)
Closest Lease Line: 660'
Lease Area: E2 & NW4 Section 11, T. 21 S., R. 37 E. et al
Unit Size: 2080 acres BLM Unit #: NMNM-112723X
Closest Unit Line: 660'
Unit Area: T. 21 S., R. 37 E.
Section 1: Lots 11-15, W2SE4, & SW4
Section 11: E2 & NW4
Sections 12: W2 & W2E2
Section 13: W2, W2NW4, & NWSE
Section 14: NE4 & E2SE4

A. (2) Surface casing (13.375", 48#, H-40) is set at 322' in a 17.5" hole and cemented to GL (circulated) with 250 sacks.

Intermediate casing (9.625", 36#, H-40) is set at 2912' in a 12.25" hole and cemented to 1500' (temperature survey) with 950 sacks.

Production casing (7", 23# & 20#, J-55) is set at 7450' in an 8.75" hole and cemented to 1200' (temperature survey) with 770 sacks.

A CIBP will be set at $\approx 6055'$ and topped with 2 sacks cement. Mechanical integrity of the casing will be assured by hydraulically pressure testing to 500 psi for 30 minutes.

- A. (3) Tubing will be 2-3/8" J-55 (4.7# IPC or 5.3# fiber lined). Setting depth will be $\approx 5555'$. (Disposal interval will be 5605' - 6041'.)
- A. (4) A lock set injection packer will be set at $\approx 5555'$ ($\approx 50'$ above the highest proposed perforation of 5605').
- B. (1) Injection zone will be the Blinebry carbonate. It is part of the Eunice; Blinebry-Tubb-Drinkard, North Pool. Fracture gradient is ≈ 0.56 psi/ft.
- B. (2) Injection interval will be from 5605' to 6041' in a cased hole. Well has been perforated in the Blinebry (5750' - 6041'), Drinkard (6500' - 6711'), and Abo (6786' - 7400').
- B. (3) Well was drilled in 1961 as a Drinkard and Abo oil well. Blinebry was added in 1964.
- B. (4) Well will be perforated from 5605' to 6041' with 2 shots per foot. Shot diameter = 0.40". Perforation and isolation history follows:

Depth	Zone	Action
5605' - 6041'	<i>Blinebry</i>	<i>proposed injection interval</i>
5750' - 6041'	Blinebry	open perms
6055'	<i>Blinebry</i>	<i>proposed CIBP + 2 sx cm:</i>
6500' - 6675'	Drinkard	open perms
6676' - 6711'	Drinkard	squeezed perms
6710'	Drinkard	CIBP
6786' - 7400'	Abo	open perms

B. (5) Next higher oil or gas zone in the area of review is the Grayburg. Its bottom is at 3963'. Injection will occur in the Blinebry. Highest perforation will be 5605'.

Next lower oil or gas zone in the area of review is the Tubb, part of the same Eunice; Blinebry-Tubb-Drinkard, North Pool. Tubb top is at 6152'. Deepest perforation will be 6041'.

IV. This is not a horizontal or vertical expansion of an existing injection project. Case files 13503 and 13504 describe the water flood.

V. Exhibit B shows and tabulates all 33 existing wells (28 oil wells + 5 injectors) within a half-mile radius, regardless of depth. No P&A wells are within a half-mile. Exhibit C shows all 682 existing wells (463 oil or gas wells + 124 injection or disposal wells + 62 P&A wells + 32 water supply wells + 1 brine well) within a two-mile radius.

Exhibit D shows all leases (BLM, fee) within a half-mile radius. Exhibit E shows all lessors (BLM, fee, and state) within a two-mile radius. Leases within a half-mile are:

Aliquot Parts in Area of Review (T21S, R37E)	Lessor	Lease	Lessee(s) of Record	Blinebry, Tubb, or Drinkard operator
S2SW4 Sec. 2	NMSLO	B0-9745-0004	Occidental Permian	Apache
SWSE Sec. 2	NMSLO	B0-1732-0001	Chevron USA	Apache
NENE Sec. 10	fee	Dauron	Apache	Apache
SENE Sec. 10	BLM	NMNM-002512	Apache & Chevron USA	Apache
NESE Sec. 10	NMSLO	B0-0935-0000	ExxonMobil	Apache
N2, N2SE4, & SWSE Sec. 11	BLM	NMNM-125057	Apache, BP, & Chevron USA	Apache
E2SW4 & SWSW Sec. 11	fee	J H Nolan	Apache	Apache
NWSW Sec. 11	fee	Gutman	Apache	Apache

VI. Thirty-three existing wells are within a half-mile. All 33 wells penetrated the Blinebry. The penetrators include 28 oil wells and 5 injectors. All 33 wells are active. A table abstracting the well construction details and histories of the penetrators is in Exhibit F.

- VII. 1. Average injection rate will be \approx 400 bwpd.
 Maximum injection rate will be 500 bwpd.
2. System is closed. Well will be tied into the existing unit pipeline system.
3. Average injection pressure will be \approx 2000 psi. Maximum injection pressure will be 2100 psi (IPI-292).
4. Water source will be water pumped from an existing San Andres water supply well. A comparison of nearby analyses and San Andres follows. No compatibility problems have reported from the 16,926,128 barrels that have been injected in the Unit to date.

	<u>NEDU Injection Pump Discharge</u>	<u>San Andres 919-S</u>
Anion/Cation Ratio	1.0	N/A
Barium	0.1 mg/l	0.38 mg/l
Bicarbonate	671.0 mg/l	562.0 mg/l
Calcium	1,099.0 mg/l	608.0 mg/l
Carbon Dioxide	80.0 ppm	80.0 ppm
Chloride	10,086.0 mg/l	6,200.0 mg/l
Hydrogen Sulfide	90.0 ppm	408.0 ppm
Iron	0.3 mg/l	0.0 mg/l
Magnesium	439.0 mg/l	244.0 mg/l
Manganese	N/A	0.01 mg/l
pH	7.5	6.49
Potassium	115.0 mg/l	N/A
Sodium	5,799.5 mg/l	3,909.0 mg/l
Strontium	28.0 mg/l	19.0 mg/l
Sulfate	2,465.0 mg/l	1,750.0 mg/l
Total Dissolved Solids	20,702.9 mg/l	13,273.0 mg/l

5. The Unit has 91 oil wells. Project goal is to increase production.

VIII. The Unit is on the north end of a north-northwest to south-southeast trending anticline. It is part of the Penrose Skelly trend and parallels the west edge of the Central Basin Platform. Dips are 1° to 2°. The injection interval is Leonardian in age, 435' thick, and consists of tan to dark gray shallow marine carbonates, many of which have been dolomitized. Core filling and replacement anhydrite is common in the limestone. Nodular anhydrite is common in the dolomite. Five per cent porosity cut off is used to determine pay zones. Impermeable shale and carbonates vertically confine the interval.

There are 105 Blinebry injection wells in New Mexico. The East Blinebry Drinkard Unit shares its west border with Apache's Northeast Drinkard Unit. Three other similar water floods (West Blinebry Drinkard Unit, Northeast Drinkard Unit, and Warren Blinebry Unit) are within a mile of the East Blinebry Drinkard Unit. The slightly more distant (2 miles) Central Drinkard Unit has been under water flood since the 1960s.

Formation depths are:

Quaternary = 0'
Rustler = 1314'
Salado = 1400'
Tansill = 2452'
Seven Rivers = 2852'
Queen = 3408'
Penrose = 3570'
Grayburg = 3750'
San Andres = 3964'
Glorieta = 5219'
Paddock = 5324'
Blinebry = 5605'
injection interval = 5605' - 6041'
Blinebry marker = 5673'
Tubb = 6152'
Drinkard = 6487'
Abo = 6745'
TD = 7450'

According to Office of the State Engineer records (Exhibit G), one fresh water well (CP 00286), 70' deep, is within a mile radius. That 52-year old well could not be found during an August 18, 2017 field inspection. However, four water wells within 5900' to 10,500' were found and sampled.

The same records show the deepest water well within 2 miles is 8015'. However, it is not a fresh water well. It is a now P&A oil well (30-025-06606) that was converted to a water supply well for unit water floods. Water source was the San Andres (4016' - 4941'). Otherwise, deepest water well within 2-miles is 136'.

There will be >4,000' of vertical separation and hundreds of feet of salt and anhydrite between the bottom of the only likely underground fresh water source (Quaternary redbeds) and the top of the injection interval. Well is a 4/5 mile southwest of the Ogallala aquifer.

There are 213 active or new injection wells and 8 active disposal wells in either the Blinebry-Tubb-Drinkard, San Andres, Grayburg, Queen, Seven Rivers, or Yates in T. 21 S., R. 37 E.

- IX. The well will be stimulated with acid to clean out scale or fill.
- X. GRN, acoustic velocity, induction electric, and caliper logs are on file with NMOCD.
- XI. No water well was found within a mile. Analyses from four fresh water wells within 1.1 miles to 2 miles away are in Exhibit G.
- XII. Apache (Exhibit H) is not aware of any geologic or engineering data that may indicate the injection interval is in hydrologic connection with any underground sources of water. Closest Quaternary faults are \approx 110 miles southwest (Exhibit H). There are 105 Blinebry injection wells in New Mexico. Previously approved water flood expansions in the Unit include WFX-819, -842, -904, -909, -963, and -969.
- XIII. A legal ad (see Exhibit I) was published on January 18, 2018. Notice (this application) has been sent (Exhibit J) to the surface owner (W F M Ranch), government lessors (BLM, NMSLO), lessees (BP, Chevron USA, ExxonMobil, Occidental Permian), operating rights holders (Chevron USA, ConocoPhillips, Devon, Energen, Kerr-McGee, Petro Strategies, St. Croix, Tanos) within a half-mile. Apache operates all wells within a half-mile regardless of depth.

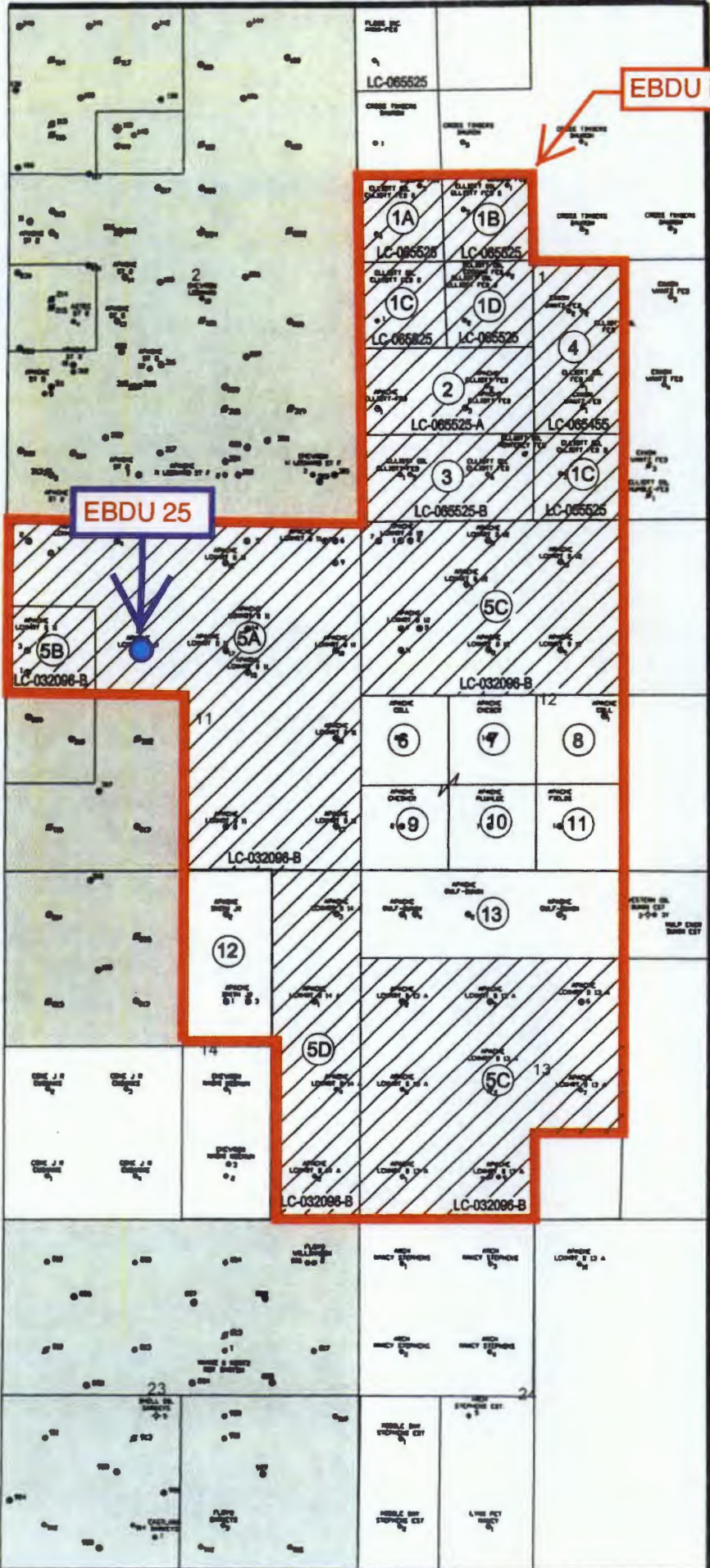

EBDU boundary

EAST BLINEBRY DRINKARD UNIT
LEA COUNTY, NEW MEXICO

EBDU 25

LEGEND

① UNIT TRACT NUMBER

	ACREAGE	PERCENTAGE
FEDERAL LANDS	1640.00	78.85
PATENTED (FEE) LANDS	440.00	21.15
TOTALS	2080.00	100%



103.15000° W

103.13333° W

WGS84 103.11667° W

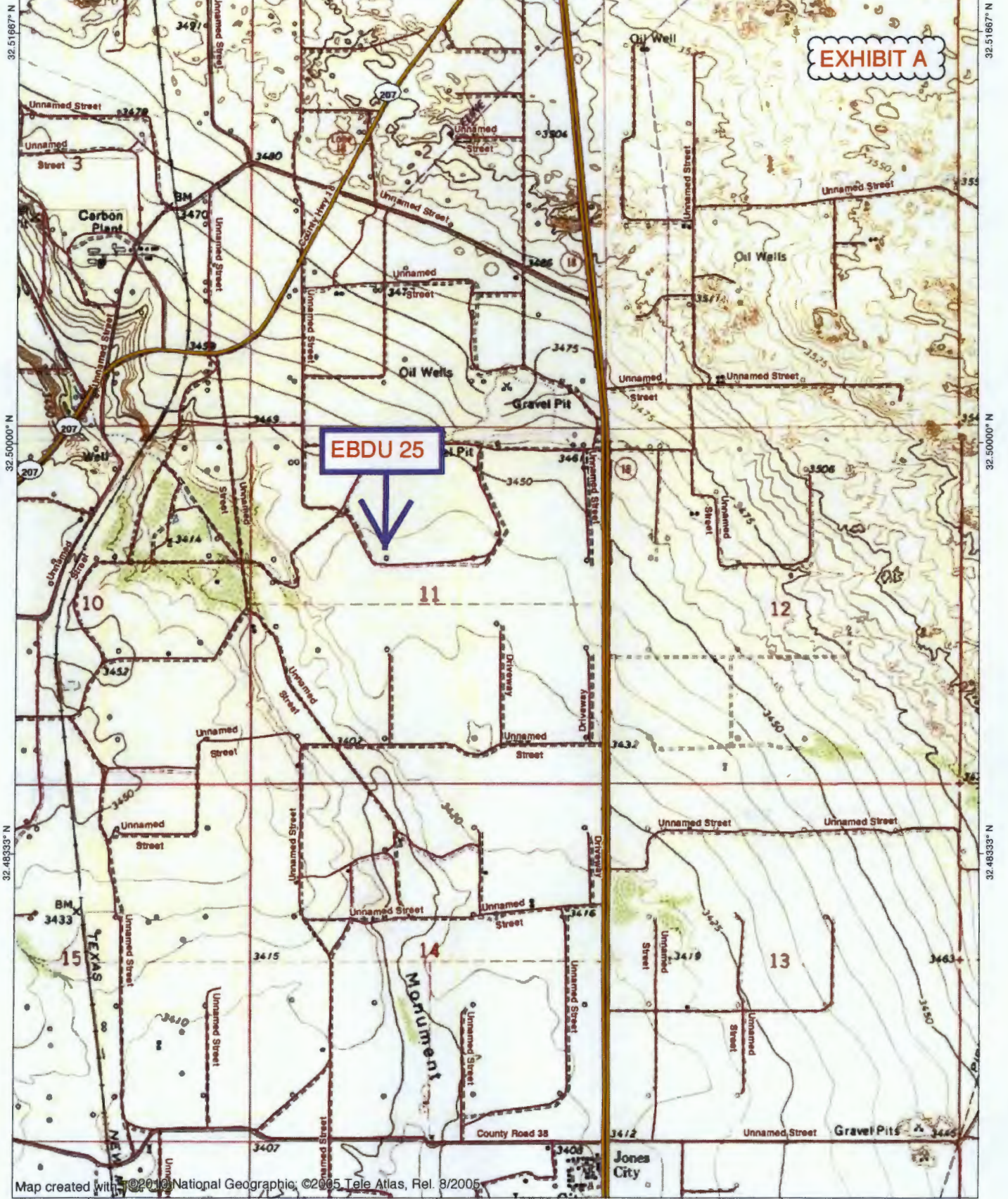
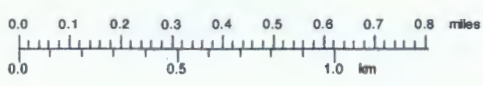

EXHIBIT A

EBDU 25



Map created with ©2016 National Geographic, ©2005 Tale Atlas, Rel. 8/2005



TN 41MN
6.5°
01/05/18

NEW MEXICO OIL CONSERVATION COMMISSION
WELL LOCATION AND ACREAGE DEDICATION PLAT

FORM C-128
Revised 5/1/57

SEE INSTRUCTIONS FOR COMPLETING THIS FORM ON THE REVERSE SIDE

SECTION A

Operator Continental Oil Company		Lease Lockhart B 11		Well No. 16
Unit Letter F	Section 11	Township 21 South	Range 37 East	County Lea
Actual Footage Location of Well: 1980 feet from the North line and 1980 feet from the West line				
Ground Level Elev. 3435.3	Producing Formation Drinkard & Abo	Pool Drinkard & Warts Abo	Dedicated Acreage: 40/well Acres	

1. Is the Operator the only owner in the dedicated acreage outlined on the plat below? YES NO _____ ("Owner" means the person who has the right to drill into and to produce from any pool and to appropriate the production either for himself or for himself and another. (65-3-29 (e) NMSA 1935 Comp.)
2. If the answer to question one is "no," have the interests of all the owners been consolidated by communitization agreement or otherwise? YES _____ NO _____. If answer is "yes," Type of Consolidation _____
3. If the answer to question two is "no," list all the owners and their respective interests below:

Owner	Land Description

SECTION B

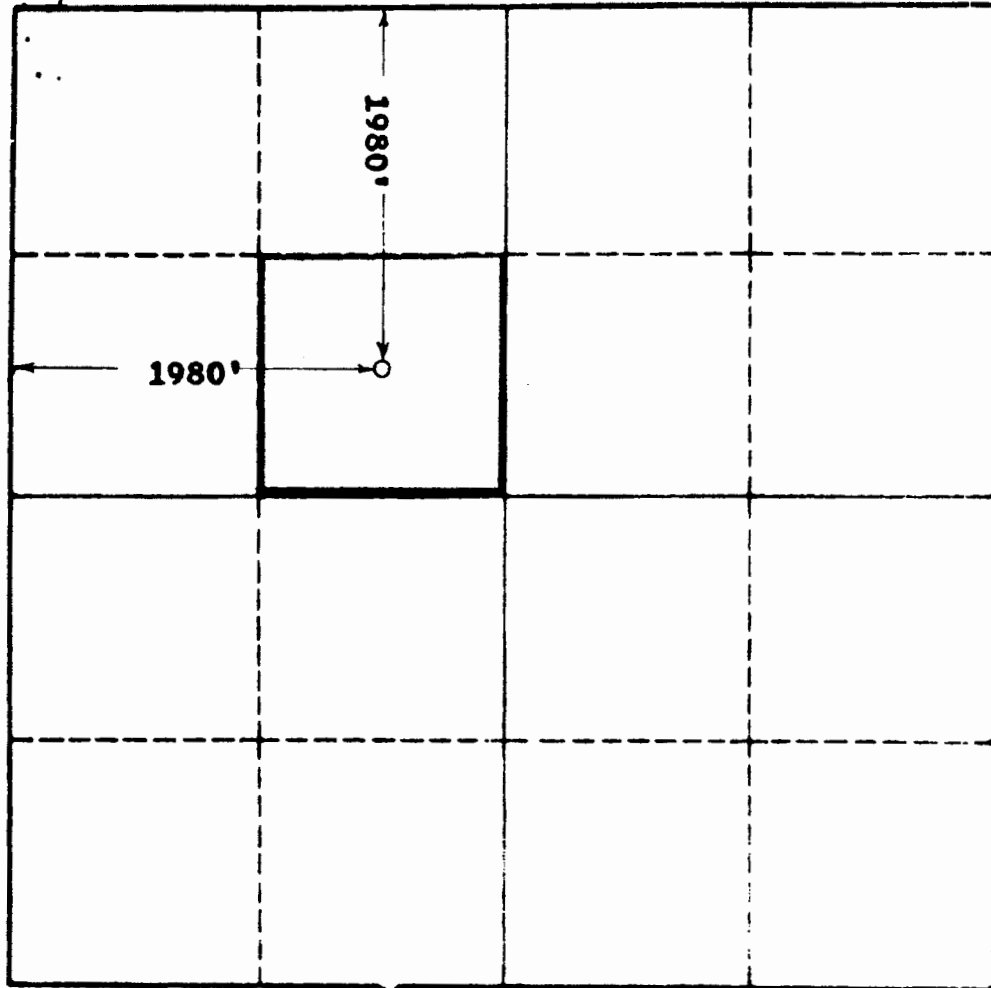

CERTIFICATION

I hereby certify that the information in SECTION A above is true and complete to the best of my knowledge and belief.

J. R. Parker
Name
J. R. Parker
Position
District Superintendent
Company
Continental Oil Company
Date
December 14, 1961

I hereby certify that the well location shown on the plat in SECTION B was plotted from field notes of actual surveys made by me or under my supervision, and that the same is true and correct to the best of my knowledge and belief.

Date Surveyed
12-11-1961
Registered Professional Engineer and/or Land Surveyor, **JOHN W. WEST**
John W. West
Certificate No.
N. M. - P. E. & L. S. NO. 678

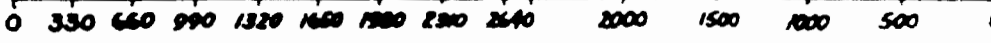
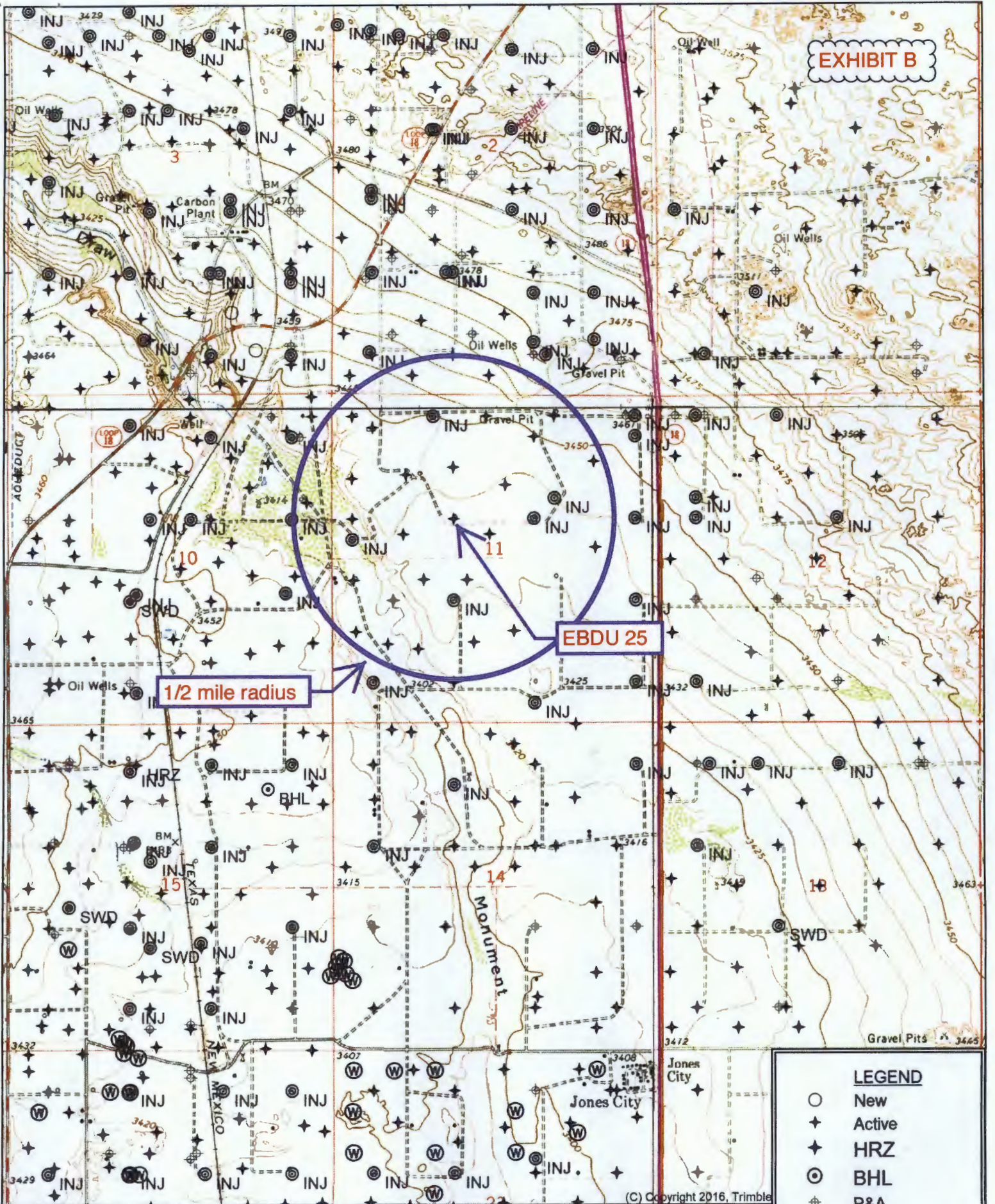

EXHIBIT B



1/2 mile radius

EBDU 25

LEGEND

- New
- ✦ Active
- ✦ HRZ
- ⊙ BHL
- ⊕ P&A
- ⊙ INJ
- ⊙ SWD
- ⊙ Water

Quad: EUNICE
Scale: 1 inch = 2,000 ft.



(C) Copyright 2016, Trimble

SORTED BY DISTANCE FROM EBDU 25

API	WHO	WELL	TYPE	T21S-R37E UNIT- SECTION	TVD	ZONE	FEET FROM EBDU 25
3002539865	Apache	EBDU 099	O	C-11	7204	Eunice; Bli-Tu-Dr, N	641
3002539380	Apache	EBDU 073	O	G-11	6978	Eunice; Bli-Tu-Dr, N	720
3002539644	Apache	EBDU 086	O	F-11	7112	Eunice; Bli-Tu-Dr, N	730
3002539678	Apache	EBDU 101	O	E-11	7211	Eunice; Bli-Tu-Dr, N	950
3002538301	Apache	EBDU 064	O	D-11	6975	Eunice; Bli-Tu-Dr, N	951
3002537728	Apache	NEDU 424	O	K-11	6955	Eunice; Bli-Tu-Dr, N	965
3002537729	Apache	NEDU 530	O	K-11	6900	Eunice; Bli-Tu-Dr, N	1070
3002506536	Apache	EBDU 026	I	G-11	7500	Eunice; Bli-Tu-Dr, N	1295
3002506534	Apache	NEDU 512	I	K-11	7492	Eunice; Bli-Tu-Dr, N	1321
3002538760	Apache	EBDU 065	O	C-11	6950	Eunice; Bli-Tu-Dr, N	1551
3002520218	Apache	NEDU 510	O	L-11	7200	Eunice; Bli-Tu-Dr, N	1653
3002506525	Apache	Lockhart B 11 003	O	E-11	7659	Penrose Skelly; Grayburg	1658
3002506529	Apache	EBDU 023	I	G-11	5925	Eunice; Bli-Tu-Dr, N	1659
3002506476	Apache	EBDU 013	I	C-11	7811	Eunice; Bli-Tu-Dr, N	1683
3002506535	Apache	EBDU 027	I	E-11	6635	Eunice; Bli-Tu-Dr, N	1691
3002539461	Apache	EBDU 100	O	E-11	6900	Eunice; Bli-Tu-Dr, N	1737
3002506523	Apache	EBDU 021	O	B-11	5932	Eunice; Bli-Tu-Dr, N	1849
3002506530	Apache	EBDU 024	O	J-11	6760	Eunice; Bli-Tu-Dr, N	1850
3002506537	Apache	NEDU 509	O	L-11	7576	Eunice; Bli-Tu-Dr, N	1918
3002538234	Apache	EBDU 063	O	J-11	6968	Eunice; Bli-Tu-Dr, N	1951

SORTED BY DISTANCE FROM EBDU 25

3002537673	Apache	NEDU 528	O	N-11	6900	Eunice; Bli-Tu-Dr, N	1969
3002506524	Apache	Lockhart B 11 001	O	D-11	7751	Wantz; Abo	1980
3002534885	Apache	NEDU 517	O	N-11	6860	Eunice; Bli-Tu-Dr, N	2180
3002538761	Apache	EBDU 066	O	A-11	7000	Eunice; Bli-Tu-Dr, N	2197
3002538771	Apache	EBDU 067	O	H-11	6960	Eunice; Bli-Tu-Dr, N	2224
3002537677	Apache	NEDU 339	O	M-2	6975	Eunice; Bli-Tu-Dr, N	2229
3002541157	Apache	NEDU 567	O	M-11	6956	Eunice; Bli-Tu-Dr, N	2258
3002506482	Apache	EBDU 014	O	B-11	7831	Eunice; Bli-Tu-Dr, N	2317
3002506477	Apache	EBDU 012	O	D-11	6818	Eunice; Bli-Tu-Dr, N	2340
3002536808	Apache	NEDU 336	O	N-2	7000	Eunice; Bli-Tu-Dr, N	2387
3002538532	Apache	NEDU 532	O	L-11	6875	Eunice; Bli-Tu-Dr, N	2397
3002506475	Apache	Hawk B 10 001	O	H-10	6625	Penrose Skelly; Grayburg	2415
3002506373	Apache	State Section 2 007	O	N-2	7854	Wantz; Abo	2640
3002506533	Apache	NEDU 513	O	N-11	6711	Eunice; Bli-Tu-Dr, N	2641

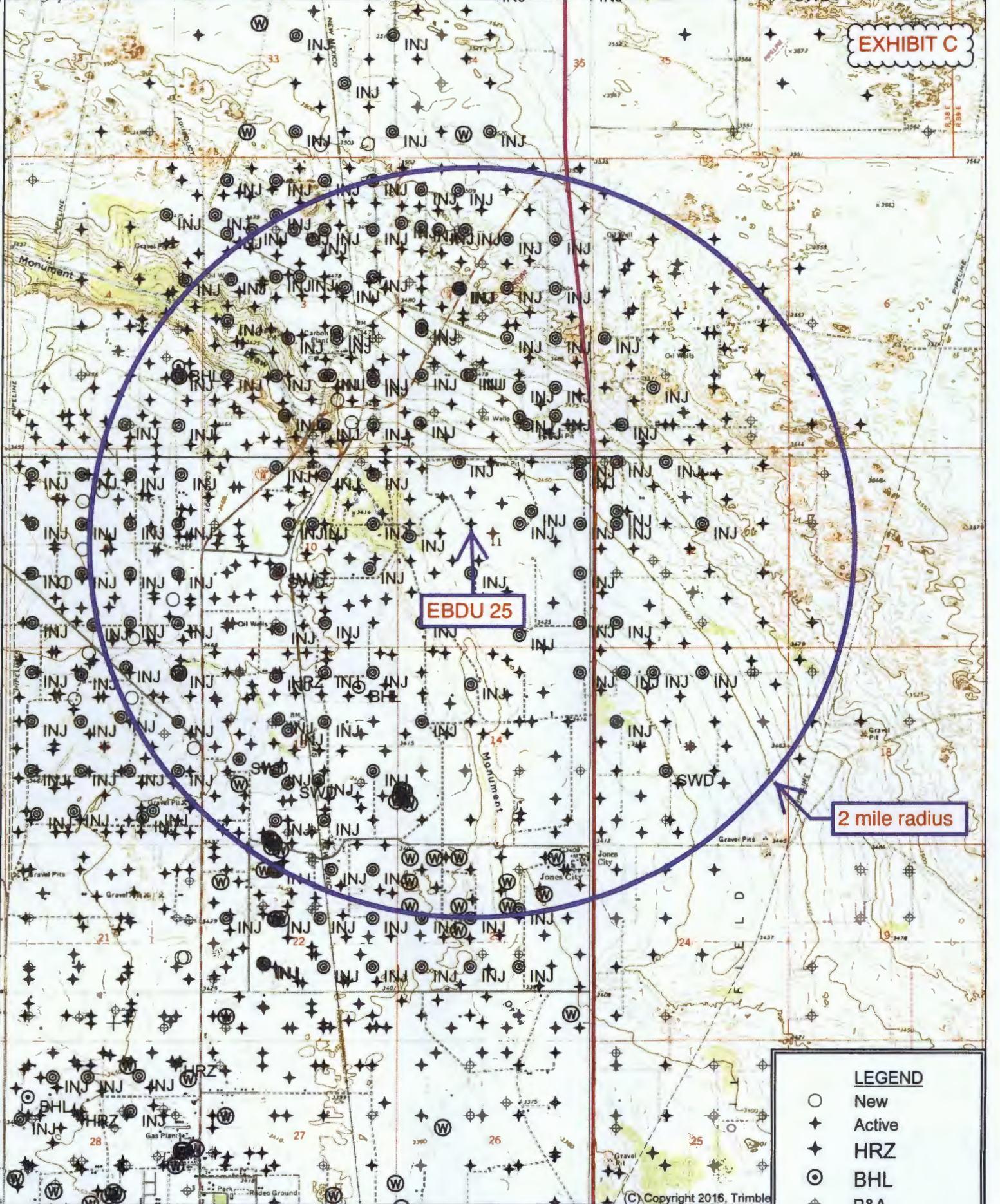

EBDU 25

2 mile radius

LEGEND	
○	New
+	Active
+	HRZ
⊙	BHL
+	P&A
⊙	INJ
⊙	SWD
⊙	Water

Quad: JAL
 Scale: 1 inch = 3,333 ft.



Oil, Gas, and Minerals Leases and Wells

- Override 1
- Villages
- Smaller Towns
- Larger Towns
- Cities
- State Boundary
- Continental Divide
- County Boundaries
- Townships
- Sections
- Subdivisions
- Carbon Dioxide
- Gas
- Injection
- Oil
- Salt Water Disposal
- Water Storage
- Miscellaneous
- Plugged / Dry / Abandoned
- Cancelled / Not Drilled
- Highway Mileposts
- Detailed Roads
- Unit Agreement Boundaries
- Participating Areas in Units
- Commercial Leases
- Minerals Leases
- Oil and Gas Leases
- Agricultural Leases
- Energy Leases
- Potash District
- All Minerals
- Coal Only
- Oil and Gas Only
- Oil, Gas and Coal Only
- Other Minerals

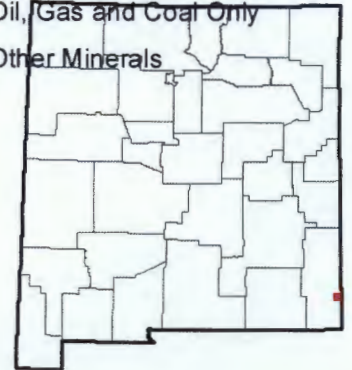
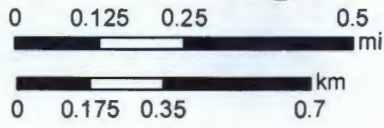
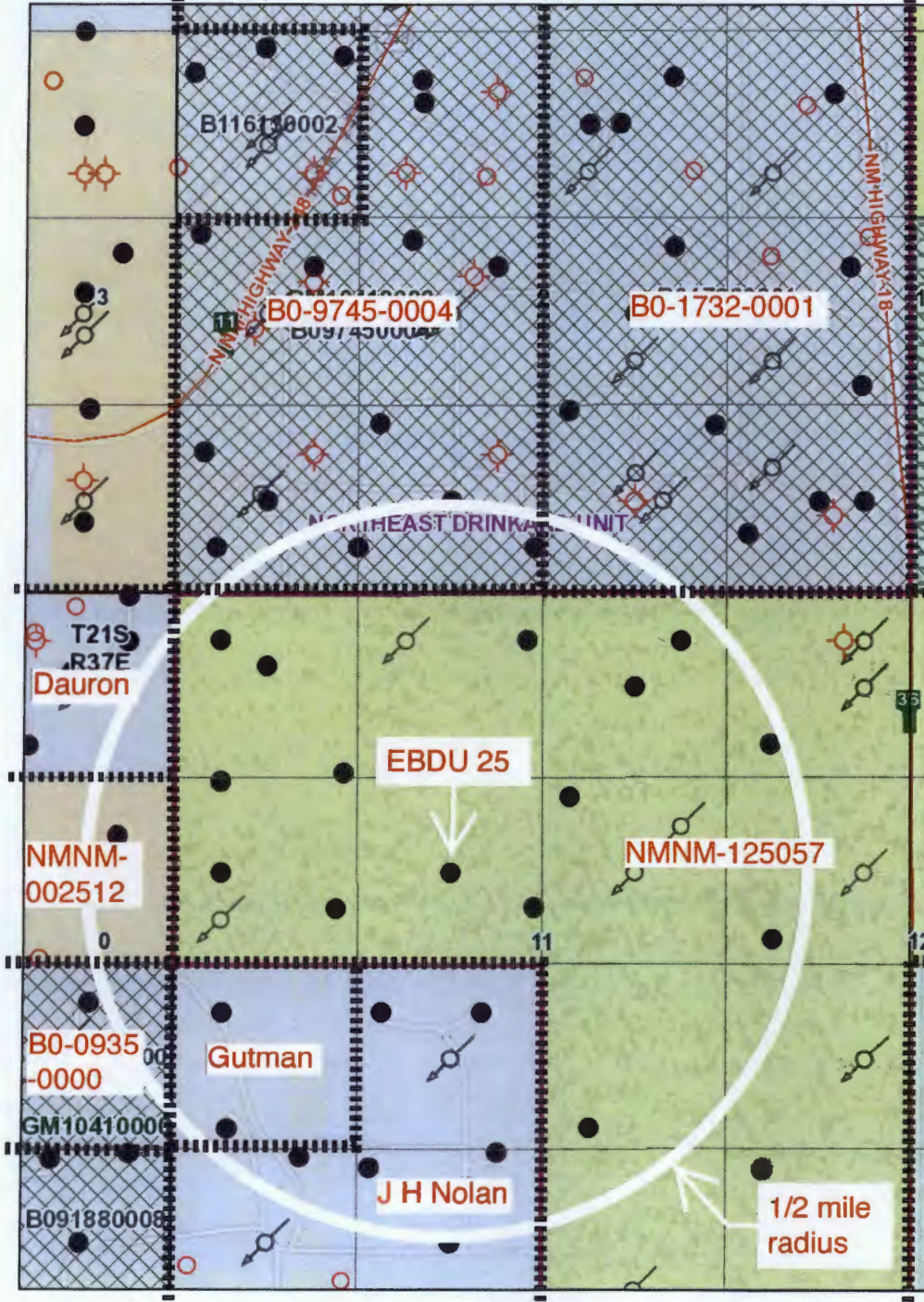

Disclaimer:
 The New Mexico State Land Office assumes no responsibility or liability for, or in connection with the accuracy, reliability or use of the information provided herein with respect to State Land Office data or data from other sources.

Data pertaining to New Mexico State Trust Lands are provisional and subject to revision, and do not constitute an official record of title. Official records may be reviewed at the New Mexico State Land Office in Santa Fe, New Mexico.

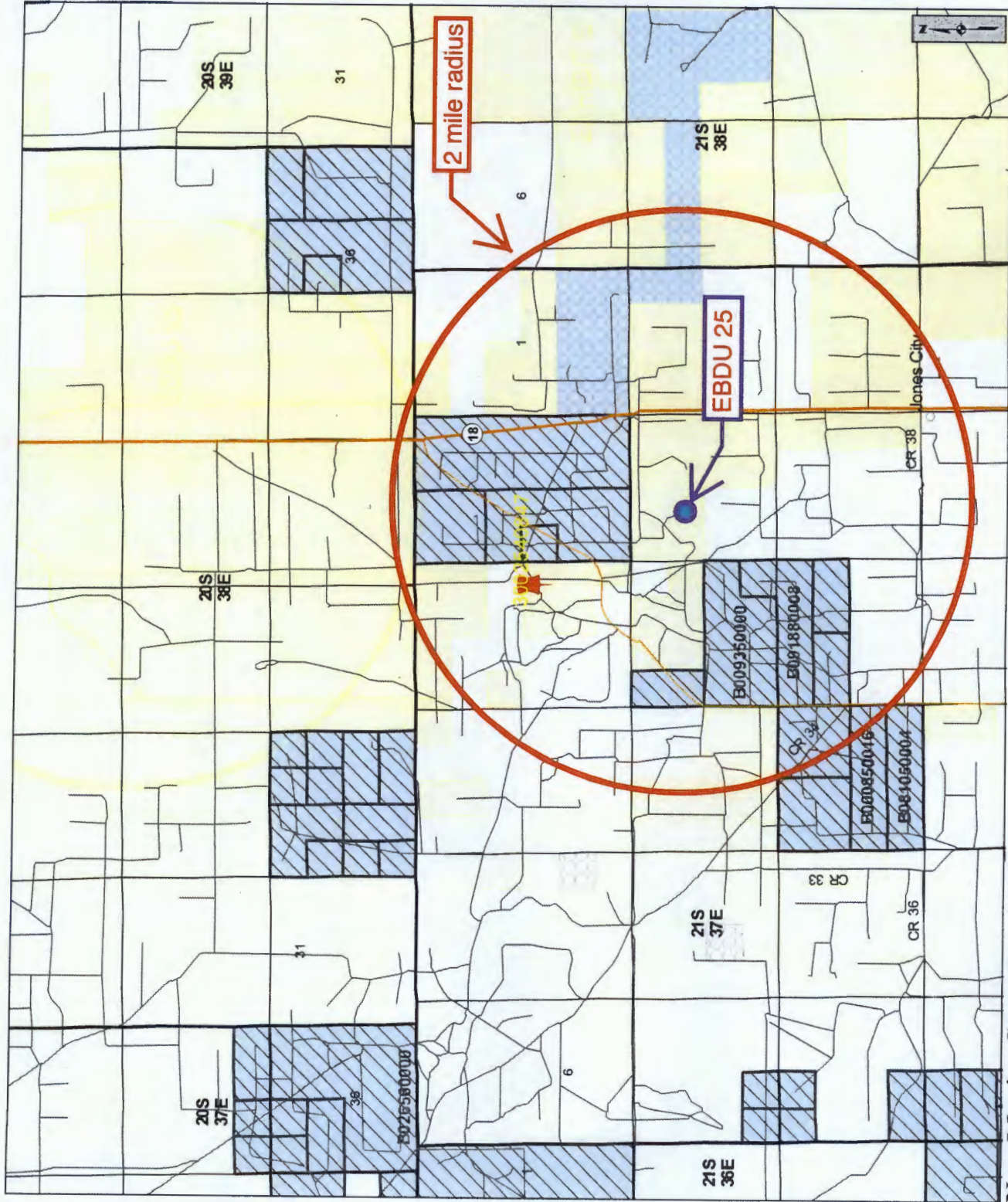

New Mexico State Land Office
Oil, Gas, and Minerals

0 0.2 0.4 0.8 1.2 1.6
 Miles
 Universal Transverse Mercator Projection, Zone 13
 1983 North American Datum

The New Mexico State Land Office assumes no responsibility or liability for, or in connection with, the accuracy, reliability or use of the information provided here, in State Land Office data layers or any other data layer.

Land Office Geographic Information Center
 logic@sls.state.nm.us

EXHIBIT E

Created On: 3/11/2013 1:48:40 PM

- Point Locations**
- County Seat
 - ▲ SLO District Offices
 - City, Town or Village
 - ★ Volcanic Vents
 - Highway Mileposts
- NMOC Oil and Gas Wells**
- Oil
 - Injection
 - ★ Carbon Dioxide
 - Miscellaneous
 - ☆ Gas
 - ◆ Water
 - ◇ DA or PA
 - △ Salt Water Disposal
- Federal Minerals**
- All Minerals
 - Coal Only
 - Oil and Gas Only
 - Oil, Gas and Coal Only
 - Other Minerals
- State Trust Lands**
- Surface Estate
 - Subsurface Estate
 - Both Estates
- NMSLO Leasing**
- Option Agreement
 - Commercial Lease
 - Minerals Lease
 - Oil and Gas Lease
 - Agricultural Lease
 - Not Available for Oil and Gas Leasing
 - Restriction Influences Oil and Gas Leasing
- Other Boundaries**
- Continental Divide
 - State Boundary
 - County Boundaries
 - Oil and Gas Unit Boundary
 - Participating Areas in Units
 - Geologic Regions
 - Pekah Enclave (NMOC R-111-P)

For detailed legend of the Geologic Map of New Mexico, please see <http://geoinfo.nmi.edu>

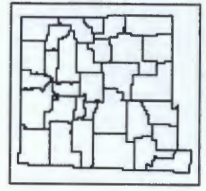

www.nmstatelands.org

Sorted by distance from Apache EBDU 25

WELL	SPUD	TD	POOL	WELL TYPE	HOLE O.D.	CASING O.D.	SET @	CEMENT	TOC	HOW TOC DETERMINED
EBDU 099	10/6/10	7204	Eunice; Bli-Tu-Dr, N	O	12.25	8.625	1378	700 sx	Surface	Circ 189 sx
30-025-39865					7.875	5.5	7204	1425 sx	100	CBL
C-11-21S-37E										
EBDU 073	9/18/09	6978	Eunice; Bli-Tu-Dr, N	O	12.25	8.625	1430	850 sx	Surface	Circ
30-025-39380					7.875	5.5	6978	1150 sx	Surface	Circ
G-11-21S-37E										
EBDU 086	6/27/10	7112	Eunice; Bli-Tu-Dr, N	O	12.25	8.625	1370	750 sx	Surface	Circ
30-025-39644					7.875	5.5	7112	1400 sx	340	CBL
F-11-21S-37E										
EBDU 101	6/29/10	7211	Eunice; Bli-Tu-Dr, N	O	12.25	8.625	1340	700 sx	Surface	Circ
30-025-39678					7.875	5.5	7051	1400 sx	94	CBL
E-11-21S-37E										

Sorted by distance from Apache EBDU 25

EBDU 064	6/6/07	6975	Eunice; Bli-Tu-Dr, N	O	12.25	8.625	1320	600 sx	Surface	Circ
30-025-38301					7.875	5.5	6975	1150 sx	90	CBL
D-11-21S-37E										
NEDU 424	8/7/06	6955	Eunice; Bli-Tu-Dr, N	O	12.25	8.625	1239	550 sx	Surface	Circ 146 sx
30-025-37728					7.875	5.5	6955	1325 sx	140	CBL
K-11-21S-37E										
NEDU 530	4/24/06	6900	Eunice; Bli-Tu-Dr, N	O	12.25	8.625	1218	500 sx	Surface	Circ 107 sx
30-025-37729					7.875	5.5	6900	1225 sx	186	CBL
K-11-21S-37E										
EBDU 026	4/10/62	7500	Eunice; Bli-Tu-Dr, N	I	17.5	13.375	368	300 sx	Surface	Circ
30-025-06536					12.25	9.625	3094	1150 sx	1600	Temp Survey
G-11-21S-37E					8.75	7	7499	650 sx	3600	Temp Survey
NEDU 512	11/21/37	7492	Eunice; Bli-Tu-Dr, N	I	15	13.375	350	250 sx	Surface	Circ
30-025-06534					11.75	9.625	3093	1200 sx	1500	Temp Survey
K-11-21S-37E					8.75	7	7492	625 sx	3800	Temp Survey

Sorted by distance from: Apache EBDU 25

EBDU 065	3/30/08	6950	Eunice; Bli-Tu-Dr, N	O	12.25	8.625	1396	650 sx	Surface	Circ
30-025-38760					7.875	5.5	6950	1300 sx	150	CBL
C-11-21S-37E										
NEDU 510	11/27/63	7200	Eunice; Bli-Tu-Dr. N	O	17.5	13.375	336	330 sx	Surface	Circ
30-025-20218					12.25	9.625	3008	900 sx	Surface	Circ
L-11-21S-37E					8.75	7	6000	No report	3400	Temp Survey
					7.875	4.5	7200	930 sx	0	TOL
Lockhart B 11 003	8/20/63	7659	Penrose Skelly, Grayburg	O	15	10.75	262	250 sx	Surface	Circ
30-025-06525					9.875	7.625	3099	1680 sx	Surface	Circ
E-11-21S-37E					6.75	5.5	7658	546 sx	880	CBL
EBDU 023	7/16/57	5925	Eunice; Bli-Tu-Dr, N	I	No report	10.75	275	250 sx	Surface	Circ
30-025-06529					No report	7.625	3124	420 sx	1575	Calc
G-11-21S-37E					6.75	5.5	5924	400 sx	3175	Calc

Sorted by distance from Apache EBDU 25

EBDU 013	11/21/51	7811	Eunice; Bli-Tu-Dr, N	I	15	10.75	272	250 sx	Surface	Circ
30-025-06476					9.5	7.625	3149	1200 sx	340	No report
C-11-21S-37E					6.75	5.5	7805	835 sx	Surface	Circ
EBDU 027	2/9/53	6635	Eunice; Bli-Tu-Dr, N	I	15.75	13.375	174	200 sx	Surface	No report
30-025-06535					12.25	8.625	3043	900 sx	745	Calc
E-11-21S-37E					7.75	5.5	6464	250 sx	5299	Calc
EBDU 100	8/8/09	6900	Eunice; Bli-Tu-Dr, N	O	12.25	8.625	1325	650 sx	Surface	Circ 173 sx
30-025-39461					7.875	5.5	6900	1050 sx	Surface	Circ
E-11-21S-37E										
EBDU 021	4/29/56	5932	Eunice; Bli-Tu-Dr. N	O	10.625	8.625	1396	700 sx	No report	No report
30-025-06523					7.875	5.5	5924	1626 sx	Surface	No report
B-11-21S-37E										
EBDU 024	1/12/60	6760	Eunice; Bli-Tu-Dr, N	O	17.5	13.375	307	260 sx	Surface	Circ
30-025-06530					12.25	9.625	2995	1150 sx	2000	Calc
J-11-21S-37E					8.75	7	6760	500 sx	3000	Calc

EXHIBIT F

Sorted by distance from Apache EBDU 25

NEDU 509	2/14/52	7576	Eunice; Bli-Tu-Dr, N	O	17.5	13.375	233	275 sx	Surface	Circ
30-025-06537					11	8.625	3010	2450 sx	Surface	Circ
L-11-21S-37E					7.875	5.5	7490	500 sx	4310	Temp survey
EBDU 063	5/26/07	6968	Eunice; Bli-Tu-Dr, N	O	12.25	8.625	1321	600 sx	Surface	Circ
30-025-38234					7.875	5.5	6968	1050 sx	70	CBL
J-11-21S-37E										
NEDU 528	2/24/06	6900	Eunice; Bli-Tu-Dr. N	O	12.25	8.625	1230	525 sx	Surface	Circ 104 sx
30-025-37673					7.875	5.5	6900	1325 sx	190	CBL
N-11-21S-37E										
Lockhart B 11 001	10/21/50	7751	Wantz; Abo	O	No report	10.75	248	250 sx	Surface	Circ
30-025-06524					No report	7.625	3049	1050 sx	686	Temp survey
D-11-21S-37E					7.875	5.5	7750	7750 sx	3030	Temp survey
NEDU 517	5/17/00	6860	Eunice; Bli-Tu-Dr. N	O	12.25	8.625	1341	460 sx	Surface	Circ 96 sx
30-025-34885					7.875	5.5	6860	1340 sx	Surface	Circ 125 sx
N-11-21S-37E										

Sorted by distance from Apache EBDU 25

EBDU 066	4/12/08	7000	Eunice; Bli-Tu-Dr, N	O	12.25	8.625	1413	680 sx	Surface	Circ
30-025-38761					7.875	5.5	7000	1300 sx	125	CBL
A-11-21S-37E										
EBDU 067	4/25/08	6960	Eunice; Bli-Tu-Dr, N	O	12.25	8.625	1366	680 sx	Surface	Circ
30-025-38771					7.875	5.5	6960	1550 sx	1013	CBL
H-11-21S-37E										
NEDU 339	3/24/06	6975	Eunice; Bli-Tu-Dr, N	O	12.25	8.625	1274	550 sx	Surface	Circ 157 sx
30-025-37677					7.875	5.5	6975	1200 sx	107	CBL
M-2-21S-37E										
NEDU 567	6/25/13	6956	Eunice; Bli-Tu-Dr, N	O	11	8.625	1301	475 sx	Surface	Circ 48 sx
30-025-41157					7.875	5.5	6956	1900 sx	Surface	Circ 449 sx
M-11-21S-37E										
EBDU 014	3/8/52	7831	Eunice; Bli-Tu-Dr, N	O	12.25	10.75	255	250 sx	Surface	Circ
30-025-06482					8.75	7.625	3149	1600 sx	750	Temp Survey
B-11-21S-37E					6.75	5.5	7830	583 sx	3150	Temp Survey

Sorted by distance from Apache EBDU 25

EBDU 012	7/16/51	6818	Eunice; Bli-Tu-Dr, N	O	13	10.75	266	250 sx	Surface	Circ
30-025-06477					8.75	7.625	3049	1392 sx	1360	Temp Survey
D-11-21S-37E					6.75	5.5	6817	375 sx	Surface	Circ
NEDU 336	12/27/04	7000	Eunice; Bli-Tu-Dr, N	O	12.25	8.625	1262	575 sx	Surface	Circ 54 sx
30-025-36808					7.875	5.5	7000	1200 sx	65	No report
N-2-21S-37E										
NEDU 532	10/31/07	6875	Eunice; Bli-Tu-Dr, N	O	12.25	8.625	1267	650 sx	Surface	Circ
30-025-38532					7.875	5.5	6875	1150 sx	85	CBL
L-11-21S-37E										
Hawk B 10 001	5/9/53	6625	Penrose Skelly; Grayburg	O	13.75	10.75	180	150 sx	Surface	Circ
30-025-06475					8.75	7.625	3005	900 sx	1415	Temp Survey
H-10-21S-37E					6.75	5.5	6453	315 sx	3580	CBL
State Section 2 007	7/13/51	7854	Wantz; Abo	O	17.25	13.375	225	250 sx	Surface	Circ
30-025-06373					11	8.625	3152	1950 sx	Surface	Circ 146 sx
N-2-21S-37E					7.875	5.5	7852	900 sx	Surface	Circ

EXHIBIT F

Sorted by distance from Apache EBDU 25

NEDU 513	5/12/55	6711	Eunice; Bll-Tu-Dr. N	0	13.75	10.75	254	250 sx	Surface	Circ
30-025-06533					9.875	7.625	3049	484 sx	700	No report
N-11-21S-37E					7.625	5.5	6479	1280 sx	Surface	Circ



New Mexico Office of the State Engineer

Water Column/Average Depth to Water

(A CLW##### in the POD suffix indicates the POD has been replaced & no longer serves a water right file.)

(R=POD has been replaced,
O=orphaned,
C=the file is closed)

(quarters are 1=NW 2=NE 3=SW 4=SE)
(quarters are smallest to largest) (NAD83 UTM in meters)

(In feet)

POD Number	Code	POD Sub-basin	County	Q 64	Q 16	Q 4	Sec	Tws	Rng	X	Y	Distance	DepthWell	DepthWater	Water Column
<u>CP 00286 POD1</u>		CP	LE	2	1	2	10	21S	37E	674019	3597338*	1213	70		
<u>CP 00137 POD1</u>	1 mile =	CP	LE	2	2	1	13	21S	37E	676862	3595783*	2035	65		
<u>CP 01185 POD1</u>	1610 m	CP	LE		1	3	14	21S	37E	674598	3594689*	2234	70		
<u>CP 01185 POD2</u>		CP	LE		1	3	14	21S	37E	674623	3594674*	2243	70		
<u>CP 01110 POD1</u>		CP	LE		1	3	14	21S	37E	674586	3594648*	2277	70		
<u>CP 01110 POD2</u>		CP	LE		1	3	14	21S	37E	674586	3594648*	2277	70		
<u>CP 01110 POD3</u>		CP	LE		1	3	14	21S	37E	674586	3594648*	2277	70		
<u>CP 01110 POD4</u>		CP	LE		1	3	14	21S	37E	674586	3594648*	2277	20		
<u>CP 01110 POD5</u>		CP	LE		1	3	14	21S	37E	674586	3594648*	2277	20		
<u>CP 00197</u>	O	CP	LE	1	4	1	01	21S	37E	676611	3598599*	2282	85		
<u>CP 00197 POD1</u>		CP	LE	1	4	1	01	21S	37E	676611	3598599*	2282	85		
<u>CP 01185 POD3</u>		CP	LE		1	3	14	21S	37E	674592	3594620*	2303	70		
<u>CP 01185 POD4</u>		CP	LE		1	3	14	21S	37E	674633	3594610*	2303	70		
<u>CP 01574 POD2</u>		CP	LE	1	3	3	14	21S	37E	674666	3594578*	2327	68	57	11
<u>CP 01574 POD1</u>		CP	LE	2	4	4	15	21S	37E	674559	3594598*	2332	68	57	11
<u>CP 00554</u>		CP	LE		2	2	16	21S	37E	672744	3595610*	2696	80	70	10
<u>CP 00552</u>		CP	LE		2	4	04	21S	37E	672700	3598022*	2697	90	75	15
<u>CP 00553</u>		CP	LE		2	4	04	21S	37E	672700	3598022*	2697	90	75	15
<u>CP 00235 POD2</u>		CP	LE	1	2	1	23	21S	37E	675083	3594144*	2715	96	65	31
<u>CP 00235 POD1</u>		CP	LE	2	2	1	23	21S	37E	675283	3594144*	2719	81		
<u>CP 00239 POD1</u>		CP	LE	1	1	2	23	21S	37E	675485	3594152*	2729	89	61	28
<u>CP 00235 POD6</u>		CP	LE	2	1	1	23	21S	37E	674881	3594137*	2733	85	65	20
<u>CP 00235 POD3</u>		CP	LE	1	1	1	23	21S	37E	674681	3594137*	2759	90	61	29
<u>CP 00562</u>		CP	LE	1	2	2	23	21S	37E	675887	3594159*	2803	136	65	71
<u>CP 00729 POD1</u>		CP	LE	4	1	3	15	21S	37E	673259	3594711*	2851	8015		
<u>CP 00240 POD1</u>		CP	LE	4	2	1	23	21S	37E	675283	3593944*	2918			
<u>CP 00241 POD1</u>		CP	LE	4	2	1	23	21S	37E	675283	3593944*	2918	79		
<u>CP 00235 POD8</u>		CP	LE	3	1	2	23	21S	37E	675485	3593952*	2928	94	58	36
<u>CP 00236 POD1</u>		CP	LE	3	1	2	23	21S	37E	675485	3593952*	2928	83		
<u>CP 00134 POD1</u>		CP	LE	1	1	1	24	21S	37E	676289	3594166*	2930	85		

EXHIBIT G

<u>CP 00235 POD7</u>	CP	LE	3	1	1	23	21S	37E	674681	3593937*	2956	85	65	20	
<u>CP 01141 POD3</u>	CP	LE				15	21S	37E	673520	3594272	3048	40			
<u>CP 01141 POD2</u>	CP	LE				15	21S	37E	673543	3594250	3055	40			
<u>CP 01141 POD4</u>	CP	LE				15	21S	37E	673556	3594239	3058	45			
<u>CP 01575 POD2</u>	CP	LE	2	2	1	22	21S	37E	673615	3594181	3078	35	35	0	
<u>CP 00700</u>	CP	LE				2	23	21S	37E	675794	3593851*	3079	75	65	10
<u>CP 01575 POD1</u>	CP	LE	1	2	1	22	21S	37E	673544	3594204	3093	40	35	5	
<u>CP 00235 POD5</u>	CP	LE	1	4	1	23	21S	37E	675090	3593742*	3117	90	70	20	
<u>CP 00235 POD10</u>	CP	LE	1	3	2	23	21S	37E	675492	3593749*	3130	92	60	32	
<u>CP 00235 POD11</u>	CP	LE	1	3	2	23	21S	37E	675492	3593749*	3130	97	60	37	
<u>CP 00237 POD1</u>	CP	LE	1	3	2	23	21S	37E	675492	3593749*	3130	84			
<u>CP 00235 POD4</u>	CP	LE	1	3	1	23	21S	37E	674688	3593735*	3155	100	80	20	
<u>L 13546 POD1</u>	L	LE	4	4	3	34	20S	38E	675011	3600037	3180	88			

Average Depth to Water: **62 feet**

Minimum Depth: **35 feet**

Maximum Depth: **80 feet**

Record Count: 43

UTMNAD83 Radius Search (in meters):

Easting (X): 675134

Northing (Y): 3596859

Radius: 3220

***UTM location was derived from PLSS - see Help**

The data is furnished by the NMOSE/ISC and is accepted by the recipient with the expressed understanding that the OSE/ISC make no warranties, expressed or implied, concerning the accuracy, completeness, reliability, usability, or suitability for any particular purpose of the data.

1/29/18 8:46 AM

WATER COLUMN/ AVERAGE DEPTH TO WATER

EXHIBIT G

Hall Environmental Analysis Laboratory, Inc.

Analytical Report

Lab Order 1708C75

Date Reported: 9/11/2017

CLIENT: Permits West

Client Sample ID: Section 12 Tank

Project: Apache EBDU 24 et al

Collection Date: 8/18/2017 10:28:00 AM

Lab ID: 1708C75-001

Matrix: AQUEOUS

Received Date: 8/22/2017 2:00:00 PM

Analyses	Result	PQL	Qual	Units	DF	Date Analyzed
EPA METHOD 300.0: ANIONS						Analyst: MRA
Chloride	670	25	*	mg/L	50	8/31/2017 6:31:12 PM
EPA METHOD 1664B						Analyst: MAB
N-Hexane Extractable Material	ND	10.7		mg/L	1	9/1/2017
SM2540C MOD: TOTAL DISSOLVED SOLIDS						Analyst: SRM
Total Dissolved Solids	1770	20.0	*	mg/L	1	8/25/2017 5:04:00 PM

EXHIBIT G

Refer to the QC Summary report and sample login checklist for flagged QC data and preservation information.

Qualifiers:	* Value exceeds Maximum Contaminant Level.	B Analyte detected in the associated Method Blank
	D Sample Diluted Due to Matrix	E Value above quantitation range
	H Holding times for preparation or analysis exceeded	J Analyte detected below quantitation limits
	ND Not Detected at the Reporting Limit	P Sample pH Not In Range
	PQL Practical Quantitative Limit	RL Reporting Detection Limit
	S % Recovery outside of range due to dilution or matrix	W Sample container temperature is out of limit as specified

Hall Environmental Analysis Laboratory, Inc.

CLIENT: Permits West

Client Sample ID: Section 13 WM

Project: Apache EBDU 24 et al

Collection Date: 8/18/2017 11:19:00 AM

Lab ID: 1708C75-002

Matrix: AQUEOUS

Received Date: 8/22/2017 2:00:00 PM

Analyses	Result	PQL	Qual	Units	DF	Date Analyzed
EPA METHOD 300.0: ANIONS						Analyst: MRA
Chloride	280	10	*	mg/L	20	8/25/2017 12:24:29 AM
EPA METHOD 1664B						Analyst: MAB
N-Hexane Extractable Material	ND	9.95		mg/L	1	9/1/2017
SM2540C MOD: TOTAL DISSOLVED SOLIDS						Analyst: SRM
Total Dissolved Solids	930	20.0	*	mg/L	1	8/25/2017 5:04:00 PM

EXHIBIT G

Refer to the QC Summary report and sample login checklist for flagged QC data and preservation information.

Qualifiers:	*	Value exceeds Maximum Contaminant Level.	B	Analyte detected in the associated Method Blank
	D	Sample Diluted Due to Matrix	E	Value above quantitation range
	H	Holding times for preparation or analysis exceeded	J	Analyte detected below quantitation limits
	ND	Not Detected at the Reporting Limit	P	Sample pH Not In Range
	PQL	Practical Quantitative Limit	RL	Reporting Detection Limit
	S	% Recovery outside of range due to dilution or matrix	W	Sample container temperature is out of limit as specified

Hall Environmental Analysis Laboratory, Inc.

Analytical Report

Lab Order 1708C75

Date Reported: 9/11/2017

CLIENT: Permits West

Client Sample ID: Decky Pond

Project: Apache EBDU 24 et al

Collection Date: 8/18/2017 2:20:00 PM

Lab ID: 1708C75-003

Matrix: AQUEOUS

Received Date: 8/22/2017 2:00:00 PM

Analyses	Result	PQL	Qual	Units	DF	Date Analyzed
EPA METHOD 300.0: ANIONS Analyst: MRA						
Chloride	360	10	*	mg/L	20	8/25/2017 12:49:18 AM
EPA METHOD 1664B Analyst: MAB						
N-Hexane Extractable Material	ND	9.93		mg/L	1	9/1/2017
SM2540C MOD: TOTAL DISSOLVED SOLIDS Analyst: SRM						
Total Dissolved Solids	1040	20.0	*	mg/L	1	8/25/2017 5:04:00 PM

EXHIBIT G

Refer to the QC Summary report and sample login checklist for flagged QC data and preservation information.

Qualifiers:	* Value exceeds Maximum Contaminant Level.	B Analyte detected in the associated Method Blank
	D Sample Diluted Due to Matrix	E Value above quantitation range
	H Holding times for preparation or analysis exceeded	J Analyte detected below quantitation limits
	ND Not Detected at the Reporting Limit	P Sample pH Not In Range
	PQL Practical Quantitative Limit	RL Reporting Detection Limit
	S % Recovery outside of range due to dilution or matrix	W Sample container temperature is out of limit as specified

Hall Environmental Analysis Laboratory, Inc.

Analytical Report
 Lab Order 1708C75
 Date Reported: 9/11/2017

CLIENT: Permits West

Client Sample ID: Section 15 Tank

Project: Apache EBDU 24 et al

Collection Date: 8/18/2017 5:17:00 PM

Lab ID: 1708C75-004

Matrix: AQUEOUS

Received Date: 8/22/2017 2:00:00 PM

Analyses	Result	PQL	Qual	Units	DF	Date Analyzed
EPA METHOD 300.0: ANIONS Analyst: MRA						
Chloride	660	25	*	mg/L	50	9/5/2017 6:57:19 PM
EPA METHOD 1664B Analyst: MAB						
N-Hexane Extractable Material	ND	10.1		mg/L	1	9/1/2017
SM2540C MOD: TOTAL DISSOLVED SOLIDS Analyst: SRM						
Total Dissolved Solids	1730	40.0	*D	mg/L	1	8/25/2017 5:04:00 PM

EXHIBIT G

Refer to the QC Summary report and sample login checklist for flagged QC data and preservation information.

Qualifiers:	* Value exceeds Maximum Contaminant Level.	B Analyte detected in the associated Method Blank
	D Sample Diluted Due to Matrix	E Value above quantitation range
	H Holding times for preparation or analysis exceeded	J Analyte detected below quantitation limits
	ND Not Detected at the Reporting Limit	P Sample pH Not In Range
	PQL Practical Quantitative Limit	RL Reporting Detection Limit
	S % Recovery outside of range due to dilution or matrix	W Sample container temperature is out of limit as specified

QC SUMMARY REPORT

Hall Environmental Analysis Laboratory, Inc.

WO#: 1708C75
11-Sep-17

Client: Permits West
Project: Apache EBDU 24 et al

Sample ID	MB-33659	SampType:	MBLK	TestCode:	EPA Method 1664B					
Client ID:	PBW	Batch ID:	33659	RunNo:	45373					
Prep Date:	9/1/2017	Analysis Date:	9/1/2017	SeqNo:	1437730	Units:	mg/L			
Analyte	Result	PQL	SPK value	SPK Ref Val	%REC	LowLimit	HighLimit	%RPD	RPDLimit	Qual
N-Hexane Extractable Material	ND	10.0								

Sample ID	LCS-33659	SampType:	LCS	TestCode:	EPA Method 1664B					
Client ID:	LCSW	Batch ID:	33659	RunNo:	45373					
Prep Date:	9/1/2017	Analysis Date:	9/1/2017	SeqNo:	1437731	Units:	mg/L			
Analyte	Result	PQL	SPK value	SPK Ref Val	%REC	LowLimit	HighLimit	%RPD	RPDLimit	Qual
N-Hexane Extractable Material	33.8	10.0	40.00	0	84.5	78	114			

Qualifiers:

- * Value exceeds Maximum Contaminant Level.
- D Sample Diluted Due to Matrix
- H Holding times for preparation or analysis exceeded
- ND Not Detected at the Reporting Limit
- PQL Practical Quantitative Limit
- S % Recovery outside of range due to dilution or matrix
- B Analyte detected in the associated Method Blank
- E Value above quantitation range
- J Analyte detected below quantitation limits
- P Sample pH Not In Range
- RL Reporting Detection Limit
- W Sample container temperature is out of limit as specified



QC SUMMARY REPORT

Hall Environmental Analysis Laboratory, Inc.

WO#: 1708C75

11-Sep-17

Client: Permits West
Project: Apache EBDU 24 et al

Sample ID	MB	SampType:	mblk	TestCode:	EPA Method 300.0: Anions					
Client ID:	PBW	Batch ID:	R45189	RunNo:	45189					
Prep Date:		Analysis Date:	8/24/2017	SeqNo:	1432143	Units:	mg/L			
Analyte	Result	PQL	SPK value	SPK Ref Val	%REC	LowLimit	HighLimit	%RPD	RPDLimit	Qual
Chloride	ND	0.50								

Sample ID	LCS	SampType:	ics	TestCode:	EPA Method 300.0: Anions					
Client ID:	LCSW	Batch ID:	R45189	RunNo:	45189					
Prep Date:		Analysis Date:	8/24/2017	SeqNo:	1432144	Units:	mg/L			
Analyte	Result	PQL	SPK value	SPK Ref Val	%REC	LowLimit	HighLimit	%RPD	RPDLimit	Qual
Chloride	5.0	0.50	5.000	0	100	90	110			

Sample ID	MB	SampType:	mblk	TestCode:	EPA Method 300.0: Anions					
Client ID:	PBW	Batch ID:	R45380	RunNo:	45380					
Prep Date:		Analysis Date:	8/31/2017	SeqNo:	1437942	Units:	mg/L			
Analyte	Result	PQL	SPK value	SPK Ref Val	%REC	LowLimit	HighLimit	%RPD	RPDLimit	Qual
Chloride	ND	0.50								

Sample ID	LCS	SampType:	ics	TestCode:	EPA Method 300.0: Anions					
Client ID:	LCSW	Batch ID:	R45380	RunNo:	45380					
Prep Date:		Analysis Date:	8/31/2017	SeqNo:	1437943	Units:	mg/L			
Analyte	Result	PQL	SPK value	SPK Ref Val	%REC	LowLimit	HighLimit	%RPD	RPDLimit	Qual
Chloride	4.6	0.50	5.000	0	92.8	90	110			

Sample ID	MB	SampType:	mblk	TestCode:	EPA Method 300.0: Anions					
Client ID:	PBW	Batch ID:	A45445	RunNo:	45445					
Prep Date:		Analysis Date:	9/5/2017	SeqNo:	1439920	Units:	mg/L			
Analyte	Result	PQL	SPK value	SPK Ref Val	%REC	LowLimit	HighLimit	%RPD	RPDLimit	Qual
Chloride	ND	0.50								

Sample ID	LCS-b	SampType:	ics	TestCode:	EPA Method 300.0: Anions					
Client ID:	LCSW	Batch ID:	A45445	RunNo:	45445					
Prep Date:		Analysis Date:	9/5/2017	SeqNo:	1439922	Units:	mg/L			
Analyte	Result	PQL	SPK value	SPK Ref Val	%REC	LowLimit	HighLimit	%RPD	RPDLimit	Qual
Chloride	4.6	0.50	5.000	0	91.9	90	110			

Qualifiers:

- * Value exceeds Maximum Contaminant Level.
- D Sample Diluted Due to Matrix
- H Holding times for preparation or analysis exceeded
- ND Not Detected at the Reporting Limit
- PQL Practical Quantitative Limit
- S % Recovery outside of range due to dilution or matrix
- B Analyte detected in the associated Method Blank
- E Value above quantitation range
- J Analyte detected below quantitation limits
- P Sample pH Not In Range
- RL Reporting Detection Limit
- W Sample container temperature is out of limit as specified

QC SUMMARY REPORT

Hall Environmental Analysis Laboratory, Inc.

WO#: 1708C75

11-Sep-17

Client: Permits West
Project: Apache EBDU 24 et al

Sample ID	MB-33526	SampType:	MBLK	TestCode:	SM2540C MOD: Total Dissolved Solids					
Client ID:	PBW	Batch ID:	33526	RunNo:	45227					
Prep Date:	8/23/2017	Analysis Date:	8/25/2017	SeqNo:	1432473	Units:	mg/L			
Analyte	Result	PQL	SPK value	SPK Ref Val	%REC	LowLimit	HighLimit	%RPD	RPDLimit	Qual
Total Dissolved Solids	ND	20.0								

Sample ID	LCS-33526	SampType:	LCS	TestCode:	SM2540C MOD: Total Dissolved Solids					
Client ID:	LCSW	Batch ID:	33526	RunNo:	45227					
Prep Date:	8/23/2017	Analysis Date:	8/25/2017	SeqNo:	1432474	Units:	mg/L			
Analyte	Result	PQL	SPK value	SPK Ref Val	%REC	LowLimit	HighLimit	%RPD	RPDLimit	Qual
Total Dissolved Solids	1030	20.0	1000	0	103	80	120			

Sample ID	1708C75-004AMS	SampType:	MS	TestCode:	SM2540C MOD: Total Dissolved Solids					
Client ID:	Section 15 Tank	Batch ID:	33526	RunNo:	45227					
Prep Date:	8/23/2017	Analysis Date:	8/25/2017	SeqNo:	1432494	Units:	mg/L			
Analyte	Result	PQL	SPK value	SPK Ref Val	%REC	LowLimit	HighLimit	%RPD	RPDLimit	Qual
Total Dissolved Solids	3830	40.0	2000	1728	105	80	120			D

Sample ID	1708C75-004AMSD	SampType:	MSD	TestCode:	SM2540C MOD: Total Dissolved Solids					
Client ID:	Section 15 Tank	Batch ID:	33526	RunNo:	45227					
Prep Date:	8/23/2017	Analysis Date:	8/25/2017	SeqNo:	1432495	Units:	mg/L			
Analyte	Result	PQL	SPK value	SPK Ref Val	%REC	LowLimit	HighLimit	%RPD	RPDLimit	Qual
Total Dissolved Solids	3850	40.0	2000	1728	106	80	120	0.625	5	D

Qualifiers:

- * Value exceeds Maximum Contaminant Level.
- D Sample Diluted Due to Matrix
- H Holding times for preparation or analysis exceeded
- ND Not Detected at the Reporting Limit
- PQL Practical Quantitative Limit
- S % Recovery outside of range due to dilution or matrix
- B Analyte detected in the associated Method Blank
- E Value above quantitation range
- J Analyte detected below quantitation limits
- P Sample pH Not In Range
- RL Reporting Detection Limit
- W Sample container temperature is out of limit as specified



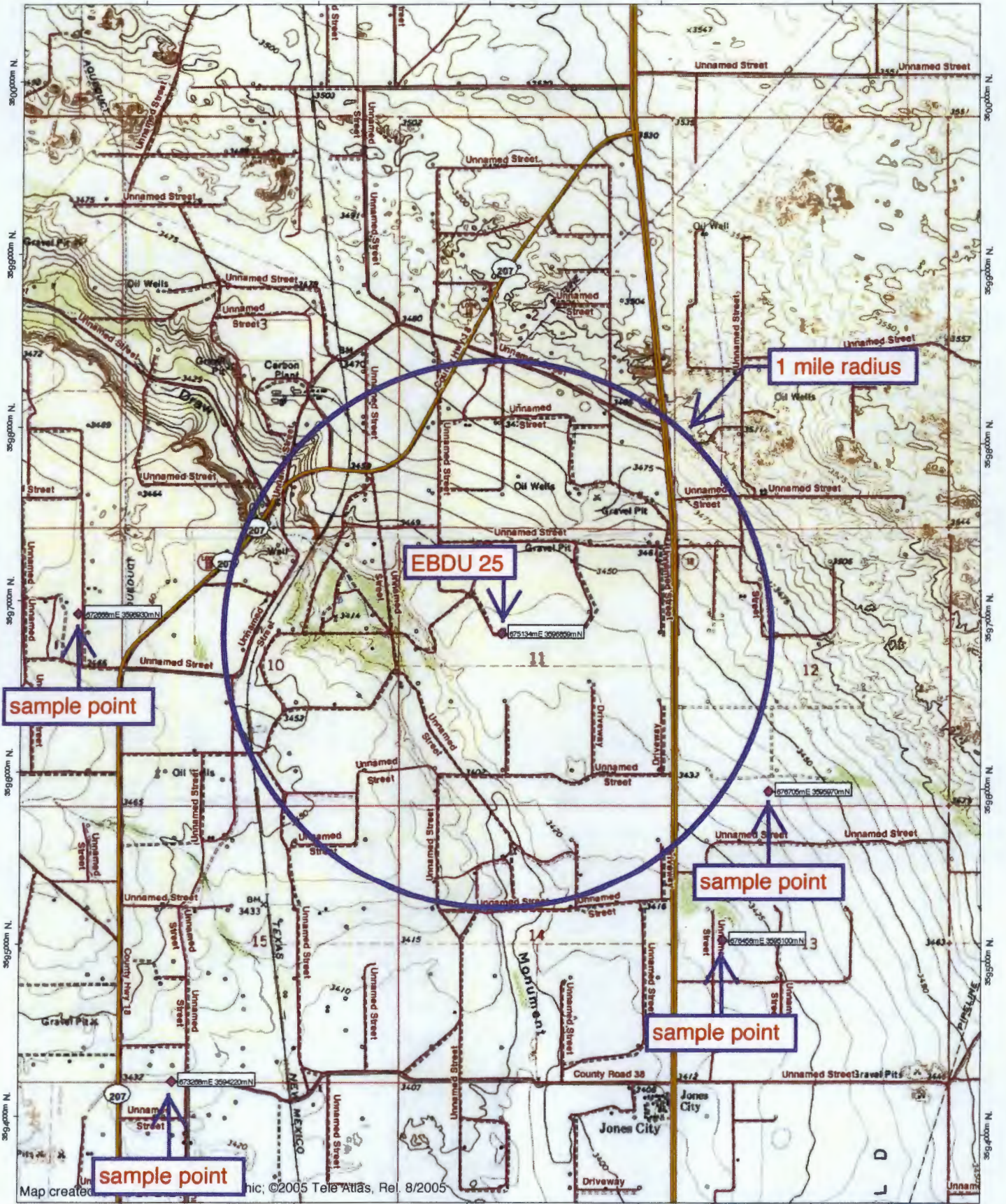

sample point

EBDU 25

1 mile radius

sample point

sample point

sample point

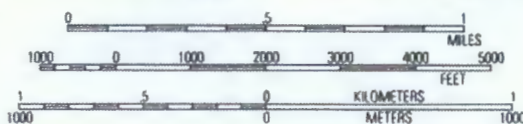
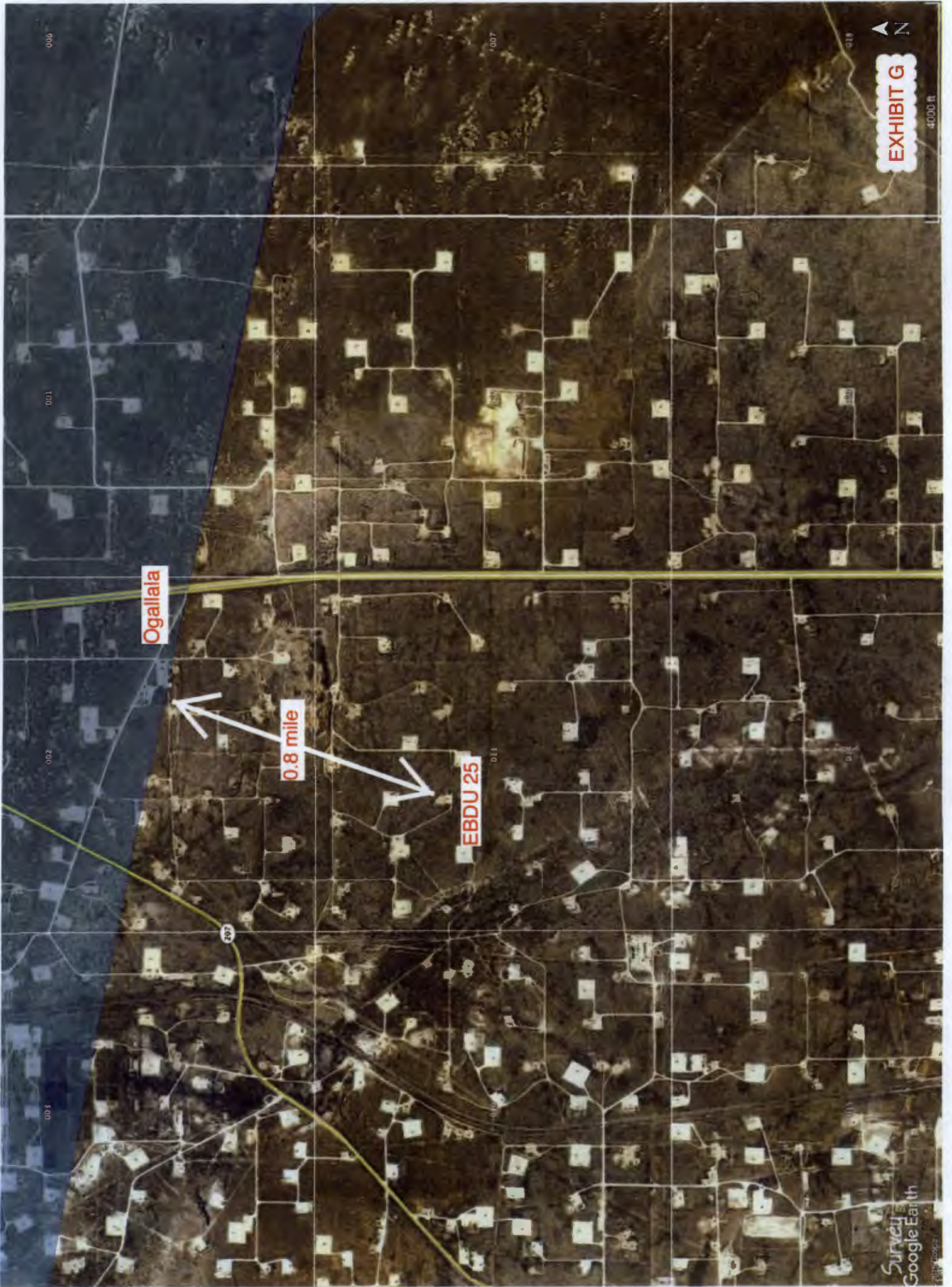

EXHIBIT G

TN 41MN
6.5°
01/29/18



006

007

018

001

002

003

Ogallala

0.8 mile

EBDU 25

207

EXHIBIT G

4000 ft

Survey Google Earth



90.0m



EBDU 25

32.49512, -103.13591

110 miles

Quaternary faults

Form C-108
Affirmative Statement
Apache Corporation
East Blinebry Drinkard Unit
Section 11, T-21-S, R-37-E
Lea County, New Mexico

The extractions from the seismic data show no evidence of faulting at (or above) the Glorieta in this area and surface mapping from the USGS confirms that no faults are known at the surface. In addition, we have no empirical evidence that our injection operations at EBDU are affected by faulting at the Glorieta level, the evaporites, or the surface. Available geologic and engineering data has been examined and no evidence of open faults or hydrological connection between the injection zone and any underground sources of drinking water has been found.

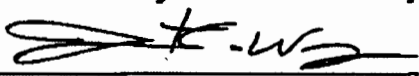

Justin Wagner
Geologist I

8/14/2017

Date

Affidavit of Publication

EXHIBIT I

STATE OF NEW MEXICO
COUNTY OF LEA

I, Daniel Russell, Publisher of the Hobbs News-Sun, a newspaper published at Hobbs, New Mexico, solemnly swear that the clipping attached hereto was published in the regular and entire issue of said newspaper, and not a supplement thereof for a period of 1 issue(s).

Beginning with the issue dated
January 18, 2018
and ending with the issue dated
January 18, 2018.

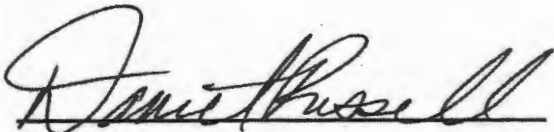
Publisher

Sworn and subscribed to before me this
18th day of January 2018.

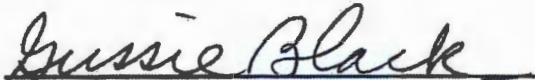
Business Manager

My commission expires
January 29, 2019

(Seal)  OFFICIAL SEAL
GUSSIE BLACK
Notary Public
State of New Mexico
My Commission Expires 1-29-19

LEGAL NOTICE
January 18, 2018

Apache Corporation is applying to convert the East Blinbery Drinkard Unit 25 oil well to a water injection well. The well is at 1980 FNL & 1980 FWL, Sec. 11, T. 21 S., R. 37 E., Lea County, NM. This is 4 miles northeast of Eunice, NM. It will inject water into the Blinbery (maximum injection pressure = 2,100 psi) from 5,605' to 6,041'. Injection will be at a maximum rate of 500 bwpd. Interested parties must file objections or requests for hearing with the NM Oil Conservation Division, 1220 South Saint Francis Dr., Santa Fe, NM 87505 within 15 days. Additional information can be obtained by contacting: Brian Wood, Permits West, Inc., 37 Verano Loop, Santa Fe, NM 87508. Phone number is (505) 466-8120. #32422

02108485

00205654

This newspaper is duly qualified to publish legal notices or advertisements within the meaning of Section 3, Chapter 167, Laws of 1937 and payment of fees for said

BRIAN WOOD
PERMITS WEST
37 VERANO LOOP
SANTA FE, NM 87508

January 29, 2018

W F M Ranch Ltd et al
PO Box 21116
Billings MT 59104

TYPICAL LETTER

Apache Corporation is applying (see attached application) to convert its East Blinebry Drinkard Unit 25 oil well to a water injection well. As required by NM Oil Conservation Division (NMOCD) Rules, I am notifying you of the following proposed water injection well. This letter is a notice only. No action is needed unless you have questions or objections.

Well Name: East Blinebry Drinkard Unit 25 (BLM lease) TD = 7,450'

Proposed Injection Zone: Blinebry from 5,605' to 6,041'

Where: 1980' FNL & 1980' FWL Sec. 11, T. 21 S., R. 37 E., Lea County, NM

Approximate Location: 4 air miles NE of Eunice, NM

Applicant Name: Apache Corporation (432) 818-1062

Applicant's Address: 303 Veterans Airpark Lane, #3000, Midland, TX 79705

Submittal Information: Application for a water injection well will be filed with the NMOCD. If you have an objection, or wish to request a hearing, then it must be filed with the NMOCD within 15 days of receipt of this letter. The New Mexico Oil Conservation Division address is 1220 South St. Francis Dr. Santa Fe, NM 87505. Their phone number is (505) 476-3440.

Please call me if you have any questions.

Sincerely,

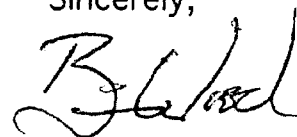

Brian Wood

**U.S. Postal Service™
CERTIFIED MAIL® RECEIPT**
Domestic Mail Only

For delivery information, visit our website at www.usps.com®.

Certified Mail Fee
\$

Extra Services & Fees (check box, add fee as appropriate)

<input type="checkbox"/> Return Receipt (hardcopy)	\$
<input type="checkbox"/> Return Receipt (electronic)	\$
<input type="checkbox"/> Certified Mail Restricted Delivery	\$
<input type="checkbox"/> Adult Signature Required	\$
<input type="checkbox"/> Adult Signature Restricted Delivery	\$

Postage
\$

Total Postage and Fees
\$

Sent To
**BP American Production Co
737 North Eldridge Parkway
Houston TX 77079
Apache E. Blinebry 25**

Street and Apt. No., or PO Box No.
City, State, ZIP+4®

PS Form 3800, April 2015 PSN 7530-02-000-9047 See Reverse for Instructions

**U.S. Postal Service™
CERTIFIED MAIL® RECEIPT**
Domestic Mail Only

For delivery information, visit our website at www.usps.com®.

Certified Mail Fee
\$

Extra Services & Fees (check box, add fee as appropriate)

<input type="checkbox"/> Return Receipt (hardcopy)	\$
<input type="checkbox"/> Return Receipt (electronic)	\$
<input type="checkbox"/> Certified Mail Restricted Delivery	\$
<input type="checkbox"/> Adult Signature Required	\$
<input type="checkbox"/> Adult Signature Restricted Delivery	\$

Postage
\$

Total Postage and Fees
\$

Sent To
**Conoco Phillips Co
PO Box 7500
Bartlesville OK 74005-7500
Apache E. Blinebry 25**

Street and Apt. No., or PO Box No.
City, State, ZIP+4®

PS Form 3800, April 2015 PSN 7530-02-000-9047 See Reverse for Instructions

**U.S. Postal Service™
CERTIFIED MAIL® RECEIPT**
Domestic Mail Only

For delivery information, visit our website at www.usps.com®.

Certified Mail Fee
\$

Extra Services & Fees (check box, add fee as appropriate)

<input type="checkbox"/> Return Receipt (hardcopy)	\$
<input type="checkbox"/> Return Receipt (electronic)	\$
<input type="checkbox"/> Certified Mail Restricted Delivery	\$
<input type="checkbox"/> Adult Signature Required	\$
<input type="checkbox"/> Adult Signature Restricted Delivery	\$

Postage
\$

Total Postage and Fees
\$

Sent To
**Energex Resources Co.
605 Richard Arrington Jr. Blvd.
Birmingham AL 35203
Apache E. Blinebry 25**

Street and Apt. No., or PO Box No.
City, State, ZIP+4®

PS Form 3800, April 2015 PSN 7530-02-000-9047 See Reverse for Instructions

**U.S. Postal Service™
CERTIFIED MAIL® RECEIPT** EXHIBIT J
Domestic Mail Only

For delivery information, visit our website at www.usps.com®.

Certified Mail Fee
\$

Extra Services & Fees (check box, add fee as appropriate)

<input type="checkbox"/> Return Receipt (hardcopy)	\$
<input type="checkbox"/> Return Receipt (electronic)	\$
<input type="checkbox"/> Certified Mail Restricted Delivery	\$
<input type="checkbox"/> Adult Signature Required	\$
<input type="checkbox"/> Adult Signature Restricted Delivery	\$

Postage
\$

Total Postage and Fees
\$

Sent To
**BLM
620 E. Greene
Carlsbad NM 88220
Apache E. Blinebry 25**

Street and Apt. No., or PO Box No.
City, State, ZIP+4®

PS Form 3800, April 2015 PSN 7530-02-000-9047 See Reverse for Instructions

**U.S. Postal Service™
CERTIFIED MAIL® RECEIPT**
Domestic Mail Only

For delivery information, visit our website at www.usps.com®.

Certified Mail Fee
\$

Extra Services & Fees (check box, add fee as appropriate)

<input type="checkbox"/> Return Receipt (hardcopy)	\$
<input type="checkbox"/> Return Receipt (electronic)	\$
<input type="checkbox"/> Certified Mail Restricted Delivery	\$
<input type="checkbox"/> Adult Signature Required	\$
<input type="checkbox"/> Adult Signature Restricted Delivery	\$

Postage
\$

Total Postage and Fees
\$

Sent To
**Chevron USA
6301 Deauville
Midland TX 79706-2964
Apache E. Blinebry 25**

Street and Apt. No., or PO Box No.
City, State, ZIP+4®

PS Form 3800, April 2015 PSN 7530-02-000-9047 See Reverse for Instructions

**U.S. Postal Service™
CERTIFIED MAIL® RECEIPT**
Domestic Mail Only

For delivery information, visit our website at www.usps.com®.

Certified Mail Fee
\$

Extra Services & Fees (check box, add fee as appropriate)

<input type="checkbox"/> Return Receipt (hardcopy)	\$
<input type="checkbox"/> Return Receipt (electronic)	\$
<input type="checkbox"/> Certified Mail Restricted Delivery	\$
<input type="checkbox"/> Adult Signature Required	\$
<input type="checkbox"/> Adult Signature Restricted Delivery	\$

Postage
\$

Total Postage and Fees
\$

Sent To
**Devon Energy Prod Co LP
333 W. Sheridan Ave.
Oklahoma City OK 73102
Apache E. Blinebry 25**

Street and Apt. No., or PO Box No.
City, State, ZIP+4®

PS Form 3800, April 2015 PSN 7530-02-000-9047 See Reverse for Instructions

7017 1000 0001 0526 1388

**U.S. Postal Service™
CERTIFIED MAIL® RECEIPT**
Domestic Mail Only

For delivery information, visit our website at www.usps.com™.

OFFICIAL USE

Certified Mail Fee	\$
Extra Services & Fees (check box, add fee as appropriate)	
<input type="checkbox"/> Return Receipt (hardcopy)	\$
<input type="checkbox"/> Return Receipt (electronic)	\$
<input type="checkbox"/> Certified Mail Restricted Delivery	\$
<input type="checkbox"/> Adult Signature Required	\$
<input type="checkbox"/> Adult Signature Restricted Delivery	\$



Postage	\$
Total Postage and Fees	\$
Sent To	Kerr-McGee OG c/o Anadarko 1201 Lake Robbins Dr. The Woodlands TX 77380 Apache E. Blinebry 25

Street and Apt. No., or PO Box No.
City, State, ZIP+4®

PS Form 3800, April 2015 PSN 7530-02-000-9047 See Reverse for Instructions

7017 1000 0001 0526 1340

**U.S. Postal Service™
CERTIFIED MAIL® RECEIPT**
Domestic Mail Only

EXHIBIT J

For delivery information, visit our website at www.usps.com™.

OFFICIAL USE

Certified Mail Fee	\$
Extra Services & Fees (check box, add fee as appropriate)	
<input type="checkbox"/> Return Receipt (hardcopy)	\$
<input type="checkbox"/> Return Receipt (electronic)	\$
<input type="checkbox"/> Certified Mail Restricted Delivery	\$
<input type="checkbox"/> Adult Signature Required	\$
<input type="checkbox"/> Adult Signature Restricted Delivery	\$

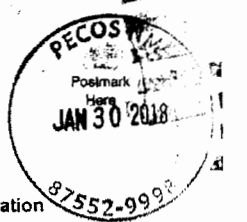

Postage	\$
Total Postage and Fees	\$
Sent To	ExxonMobil Corporation PO Box 4358 Houston TX 77210 Apache E. Blinebry 25

Street and Apt. No., or PO Box No.
City, State, ZIP+4®

PS Form 3800, April 2015 PSN 7530-02-000-9047 See Reverse for Instructions

7017 1000 0001 0526 1357

**U.S. Postal Service™
CERTIFIED MAIL® RECEIPT**
Domestic Mail Only

For delivery information, visit our website at www.usps.com™.

OFFICIAL USE

Certified Mail Fee	\$
Extra Services & Fees (check box, add fee as appropriate)	
<input type="checkbox"/> Return Receipt (hardcopy)	\$
<input type="checkbox"/> Return Receipt (electronic)	\$
<input type="checkbox"/> Certified Mail Restricted Delivery	\$
<input type="checkbox"/> Adult Signature Required	\$
<input type="checkbox"/> Adult Signature Restricted Delivery	\$



Postage	\$
Total Postage and Fees	\$
Sent To	Occidental Permian Ltd. PO Box 4284 Houston TX 77210 Apache E. Blinebry 25

Street and Apt. No., or PO Box No.
City, State, ZIP+4®

PS Form 3800, April 2015 PSN 7530-02-000-9047 See Reverse for Instructions

7017 1000 0001 0526 1333

**U.S. Postal Service™
CERTIFIED MAIL® RECEIPT**
Domestic Mail Only

For delivery information, visit our website at www.usps.com™.

OFFICIAL USE

Certified Mail Fee	\$
Extra Services & Fees (check box, add fee as appropriate)	
<input type="checkbox"/> Return Receipt (hardcopy)	\$
<input type="checkbox"/> Return Receipt (electronic)	\$
<input type="checkbox"/> Certified Mail Restricted Delivery	\$
<input type="checkbox"/> Adult Signature Required	\$
<input type="checkbox"/> Adult Signature Restricted Delivery	\$



Postage	\$
Total Postage and Fees	\$
Sent To	NM State Land Office PO Box 1148 Santa Fe NM 87504 Apache E. Blinebry 25

Street and Apt. No., or PO Box No.
City, State, ZIP+4®

PS Form 3800, April 2015 PSN 7530-02-000-9047 See Reverse for Instructions

7017 1000 0001 0526 1401

**U.S. Postal Service™
CERTIFIED MAIL® RECEIPT**
Domestic Mail Only

For delivery information, visit our website at www.usps.com™.

OFFICIAL USE

Certified Mail Fee	\$
Extra Services & Fees (check box, add fee as appropriate)	
<input type="checkbox"/> Return Receipt (hardcopy)	\$
<input type="checkbox"/> Return Receipt (electronic)	\$
<input type="checkbox"/> Certified Mail Restricted Delivery	\$
<input type="checkbox"/> Adult Signature Required	\$
<input type="checkbox"/> Adult Signature Restricted Delivery	\$



Postage	\$
Total Postage and Fees	\$
Sent To	St. Croix Corp. 13601 Preston, #406E Dallas TX 75240 Apache E. Blinebry 25

Street and Apt. No., or PO Box No.
City, State, ZIP+4®

PS Form 3800, April 2015 PSN 7530-02-000-9047 See Reverse for Instructions

7017 1000 0001 0526 1395

**U.S. Postal Service™
CERTIFIED MAIL® RECEIPT**
Domestic Mail Only

For delivery information, visit our website at www.usps.com™.

OFFICIAL USE

Certified Mail Fee	\$
Extra Services & Fees (check box, add fee as appropriate)	
<input type="checkbox"/> Return Receipt (hardcopy)	\$
<input type="checkbox"/> Return Receipt (electronic)	\$
<input type="checkbox"/> Certified Mail Restricted Delivery	\$
<input type="checkbox"/> Adult Signature Required	\$
<input type="checkbox"/> Adult Signature Restricted Delivery	\$



Postage	\$
Total Postage and Fees	\$
Sent To	Petro Strategies Inc. PO Box 5562 Midland TX 79704 Apache E. Blinebry 25

Street and Apt. No., or PO Box No.
City, State, ZIP+4®

PS Form 3800, April 2015 PSN 7530-02-000-9047 See Reverse for Instructions

7017 1000 0001 0526 1418

U.S. Postal Service™
CERTIFIED MAIL® RECEIPT

Domestic Mail Only

For delivery information, visit our website at www.usps.com™.

OFFICIAL USE

Certified Mail Fee

\$

Extra Services & Fees (check box, add fee as appropriate)

- Return Receipt (hardcopy) \$ _____
- Return Receipt (electronic) \$ _____
- Certified Mail Restricted Delivery \$ _____
- Adult Signature Required \$ _____
- Adult Signature Restricted Delivery \$ _____

Postage

\$

Total Postage and Fees

Tanos Energy Holdings

821 E. Southeast Loop 323

Sent To

Tyler TX 75701

Street and Apt. No., or PO Box No.

Apache E. Blinebry 25

City, State, ZIP+4®

PS Form 3800, April 2015 PSN 7530-02-000-9047

See Reverse for Instructions

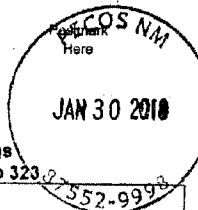

7017 1000 0001 0526 1326

U.S. Postal Service™
CERTIFIED MAIL® REC

EXHIBIT J

Domestic Mail Only

For delivery information, visit our website at www.usps.com™.

OFFICIAL USE

Certified Mail Fee

\$

Extra Services & Fees (check box, add fee as appropriate)

- Return Receipt (hardcopy) \$ _____
- Return Receipt (electronic) \$ _____
- Certified Mail Restricted Delivery \$ _____
- Adult Signature Required \$ _____
- Adult Signature Restricted Delivery \$ _____

Postage

\$

Total Postage and Fees

W F M Ranch

PO Box 21116

Sent To

Billings MT 59104

Street and Apt. No., or PO Box No.

Apache E. Blinebry 25

City, State, ZIP+4®

PS Form 3800, April 2015 PSN 7530-02-000-9047

See Reverse for Instructions

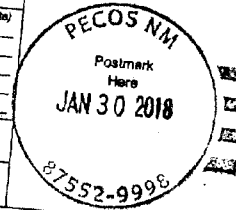

SENDER: COMPLETE THIS SECTION

- Complete items 1, 2, and 3.
- Print your name and address on the reverse so that we can return the card to you.
- Attach this card to the back of the mailpiece, or on the front if space permits.

1. Article Addressed to:

BLM
620 E. Greene
Carlsbad NM 88220

Apache E Blinebry 25



9590 9402 2894 7094 3440 99

2. Article Number (Transfer from service label)

7017 1000 0001 0526 1319

PS Form 3811, July 2015 PSN 7530-02-000-9053

COMPLETE THIS SECTION ON DELIVERY

A. Signature
X *[Signature]* Agent Addressee

B. Received by (Printed Name) C. Date of Delivery

D. Is delivery address different from item 1? Yes
If YES, enter delivery address below: No

3. Service Type

<input type="checkbox"/> Adult Signature	<input type="checkbox"/> Priority Mail Express®
<input type="checkbox"/> Adult Signature Restricted Delivery	<input type="checkbox"/> Registered Mail™
<input type="checkbox"/> Certified Mail®	<input type="checkbox"/> Registered Mail Restricted Delivery
<input type="checkbox"/> Certified Mail Restricted Delivery	<input type="checkbox"/> Return Receipt for Merchandise
<input type="checkbox"/> Collect on Delivery	<input type="checkbox"/> Signature Confirmation™
<input type="checkbox"/> Collect on Delivery Restricted Delivery	<input type="checkbox"/> Signature Confirmation Restricted Delivery
<input type="checkbox"/> Insured Mail	
<input type="checkbox"/> Mail Restricted Delivery (0)	

Domestic Return Receipt

SENDER: COMPLETE THIS SECTION

- Complete items 1, 2, and 3.
- Print your name and address on the reverse so that we can return the card to you.
- Attach this card to the back of the mailpiece, or on the front if space permits.

1. Article Addressed to:

Chevron USA
6301 Deauville
Midland TX 79706-2964

Apache E Blinebry 25



9590 9402 2894 7094 3442 11

2. Article Number (Transfer from service label)

7017 1000 0001 0526 1296

PS Form 3811, July 2015 PSN 7530-02-000-9053

COMPLETE THIS SECTION ON DELIVERY

A. Signature
X *[Signature]* Agent Addressee

B. Received by (Printed Name) C. Date of Delivery

D. Is delivery address different from item 1? Yes
If YES, enter delivery address below: No

3. Service Type

<input type="checkbox"/> Adult Signature	<input type="checkbox"/> Priority Mail Express®
<input type="checkbox"/> Adult Signature Restricted Delivery	<input type="checkbox"/> Registered Mail™
<input type="checkbox"/> Certified Mail®	<input type="checkbox"/> Registered Mail Restricted Delivery
<input type="checkbox"/> Certified Mail Restricted Delivery	<input type="checkbox"/> Return Receipt for Merchandise
<input type="checkbox"/> Collect on Delivery	<input type="checkbox"/> Signature Confirmation™
<input type="checkbox"/> Collect on Delivery Restricted Delivery	<input type="checkbox"/> Signature Confirmation Restricted Delivery
<input type="checkbox"/> Insured Mail	
<input type="checkbox"/> Mail Restricted Delivery (0)	

Domestic Return Receipt

SENDER: COMPLETE THIS SECTION

- Complete items 1, 2, and 3.
- Print your name and address on the reverse so that we can return the card to you.
- Attach this card to the back of the mailpiece, or on the front if space permits.

1. Article Addressed to:

Conoco Phillips Co
PO Box 7500
Bartlesville OK 74005-7500

Apache E Blinebry 25



9590 9402 2894 7094 3442 28

2. Article Number (Transfer from service label)

7017 1000 0001 0526 1302

PS Form 3811, July 2015 PSN 7530-02-000-9053

COMPLETE THIS SECTION ON DELIVERY

A. Signature
X *[Signature]* Agent Addressee

B. Received by (Printed Name) C. Date of Delivery

[Signature] FEB 02 2018

D. Is delivery address different from item 1? Yes
If YES, enter delivery address below: No

FEB 02 2018

3. Service Type

<input type="checkbox"/> Adult Signature	<input type="checkbox"/> Priority Mail Express®
<input type="checkbox"/> Adult Signature Restricted Delivery	<input type="checkbox"/> Registered Mail™
<input type="checkbox"/> Certified Mail®	<input type="checkbox"/> Registered Mail Restricted Delivery
<input type="checkbox"/> Certified Mail Restricted Delivery	<input type="checkbox"/> Return Receipt for Merchandise
<input type="checkbox"/> Collect on Delivery	<input type="checkbox"/> Signature Confirmation™
<input type="checkbox"/> Collect on Delivery Restricted Delivery	<input type="checkbox"/> Signature Confirmation Restricted Delivery
<input type="checkbox"/> Insured Mail	
<input type="checkbox"/> Mail Restricted Delivery (0)	

Domestic Return Receipt

SENDER: COMPLETE THIS SECTION

- Complete items 1, 2, and 3.
- Print your name and address on the reverse so that we can return the card to you.
- Attach this card to the back of the mailpiece, or on the front if space permits.

1. Article Addressed to:

Devon Energy Prod Co LP
333 W. Sheridan Ave.
Oklahoma City OK 73102

Apache E Blinebry 25



9590 9402 2894 7094 3441 43

2. Article Number (Transfer from service label)

7017 1000 0001 0526 1364

PS Form 3811, July 2015 PSN 7530-02-000-9053

COMPLETE THIS SECTION ON DELIVERY

A. Signature
David Carrillo Agent Addressee
 B. Received by (Printed Name) C. Date of Delivery

D. Is delivery address different from item 1? Yes No
If YES, enter delivery address below:

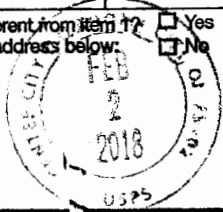

3. Service Type
- | | |
|--|---|
| <input type="checkbox"/> Adult Signature | <input type="checkbox"/> Priority Mail Express® |
| <input type="checkbox"/> Adult Signature Restricted Delivery | <input type="checkbox"/> Registered Mail™ |
| <input type="checkbox"/> Certified Mail® | <input type="checkbox"/> Registered Mail Restricted Delivery |
| <input type="checkbox"/> Certified Mail Restricted Delivery | <input type="checkbox"/> Return Receipt for Merchandise |
| <input type="checkbox"/> Collect on Delivery | <input type="checkbox"/> Signature Confirmation™ |
| <input type="checkbox"/> Collect on Delivery Restricted Delivery | <input type="checkbox"/> Signature Confirmation Restricted Delivery |
| <input type="checkbox"/> Insured Mail | |
| <input type="checkbox"/> Insured Mail Restricted Delivery | |

Domestic Return Receipt

SENDER: COMPLETE THIS SECTION

- Complete items 1, 2, and 3.
- Print your name and address on the reverse so that we can return the card to you.
- Attach this card to the back of the mailpiece, or on the front if space permits.

1. Article Addressed to:

Energen Resources Co.
605 Richard Arrington Jr. Blvd.
Birmingham AL 35203

Apache E Blinebry 25



9590 9402 2894 7094 3441 50

2. Article Number (Transfer from service label)

7017 1000 0001 0526 1371

PS Form 3811, July 2015 PSN 7530-02-000-9053

COMPLETE THIS SECTION ON DELIVERY

A. Signature
Brenda Amptons Agent Addressee
 B. Received by (Printed Name) C. Date of Delivery
Brenda Amptons

D. Is delivery address different from item 1? Yes No
If YES, enter delivery address below:

3. Service Type
- | | |
|--|---|
| <input type="checkbox"/> Adult Signature | <input type="checkbox"/> Priority Mail Express® |
| <input type="checkbox"/> Adult Signature Restricted Delivery | <input type="checkbox"/> Registered Mail™ |
| <input type="checkbox"/> Certified Mail® | <input type="checkbox"/> Registered Mail Restricted Delivery |
| <input type="checkbox"/> Certified Mail Restricted Delivery | <input type="checkbox"/> Return Receipt for Merchandise |
| <input type="checkbox"/> Collect on Delivery | <input type="checkbox"/> Signature Confirmation™ |
| <input type="checkbox"/> Collect on Delivery Restricted Delivery | <input type="checkbox"/> Signature Confirmation Restricted Delivery |
| <input type="checkbox"/> Insured Mail | |
| <input type="checkbox"/> Insured Mail Restricted Delivery | |

Domestic Return Receipt

SENDER: COMPLETE THIS SECTION

- Complete items 1, 2, and 3.
- Print your name and address on the reverse so that we can return the card to you.
- Attach this card to the back of the mailpiece, or on the front if space permits.

1. Article Addressed to:

Kerr-McGee OG c/o Anadarko
1201 Lake Robbins Dr.
The Woodlands TX

2. Article Number

7017 1000 0001 0526 1388

PS Form 3811, July 2015 PSN 7530-02-000-9053

COMPLETE THIS SECTION ON DELIVERY

A. Signature
 X Agent Addressee
 B. Received by (Printed Name) C. Date of Delivery

D. Is delivery address different from item 1? Yes No
If YES, enter delivery address below:

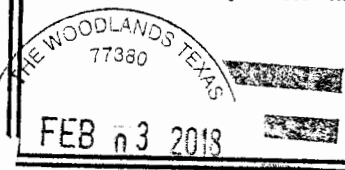

3. Service Type
- | | |
|--|---|
| <input type="checkbox"/> Adult Signature | <input type="checkbox"/> Priority Mail Express® |
| <input type="checkbox"/> Adult Signature Restricted Delivery | <input type="checkbox"/> Registered Mail™ |
| <input type="checkbox"/> Certified Mail® | <input type="checkbox"/> Registered Mail Restricted Delivery |
| <input type="checkbox"/> Certified Mail Restricted Delivery | <input type="checkbox"/> Return Receipt for Merchandise |
| <input type="checkbox"/> Collect on Delivery | <input type="checkbox"/> Signature Confirmation™ |
| <input type="checkbox"/> Collect on Delivery Restricted Delivery | <input type="checkbox"/> Signature Confirmation Restricted Delivery |
| <input type="checkbox"/> Insured Mail | |
| <input type="checkbox"/> Insured Mail Restricted Delivery | |

Domestic Return Receipt

SENDER: COMPLETE THIS SECTION

- Complete items 1, 2, and 3.
- Print your name and address on the reverse so that we can return the card to you.
- Attach this card to the back of the mailpiece, or on the front if space permits.

1. Article Addressed to:

NM State Land Office
PO Box 1148
Santa Fe NM 87504

Apache E Blinebry 25



9590 9402 2894 7094 3441 12

2. Article Number (Transfer from service label)

7017 1000 0001 0526 1333

PS Form 3811, July 2015 PSN 7530-02-000-9053

COMPLETE THIS SECTION ON DELIVERY

A. Signature Agent Addressee
 X *[Signature]*

B. Received by (Printed Name) _____ C. Date of Delivery _____

D. Is delivery address different from item 1? Yes No
 If YES, enter delivery address below: _____

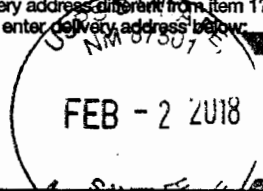

3. Service Type

<input type="checkbox"/> Adult Signature	<input type="checkbox"/> Priority Mail Express®
<input type="checkbox"/> Adult Signature Restricted Delivery	<input type="checkbox"/> Registered Mail™
<input type="checkbox"/> Certified Mail®	<input type="checkbox"/> Registered Mail Restricted Delivery
<input type="checkbox"/> Certified Mail Restricted Delivery	<input type="checkbox"/> Return Receipt for Merchandise
<input type="checkbox"/> Collect on Delivery	<input type="checkbox"/> Signature Confirmation™
<input type="checkbox"/> Collect on Delivery Restricted Delivery	<input type="checkbox"/> Signature Confirmation Restricted Delivery
<input type="checkbox"/> Insured Mail	

Restricted Delivery

SENDER: COMPLETE THIS SECTION

- Complete items 1, 2, and 3.
- Print your name and address on the reverse so that we can return the card to you.
- Attach this card to the back of the mailpiece, or on the front if space permits.

1. Article Addressed to:

Occidental Permian Ltd.
PO Box 4294
Houston TX 77210

Apache E Blinebry 25



9590 9402 2894 7094 3441 36

2. Article Number (Transfer from service label)

7017 1000 0001 0526 1357

PS Form 3811, July 2015 PSN 7530-02-000-9053

COMPLETE THIS SECTION ON DELIVERY

A. Signature Agent Addressee
 X *[Signature]*

B. Received by (Printed Name) _____ C. Date of Delivery _____

D. Is delivery address different from item 1? Yes No
 If YES, enter delivery address below: _____

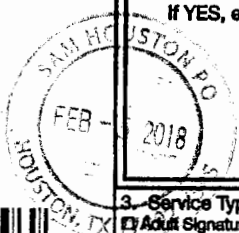

3. Service Type

<input type="checkbox"/> Adult Signature	<input type="checkbox"/> Priority Mail Express®
<input type="checkbox"/> Adult Signature Restricted Delivery	<input type="checkbox"/> Registered Mail™
<input type="checkbox"/> Certified Mail®	<input type="checkbox"/> Registered Mail Restricted Delivery
<input type="checkbox"/> Certified Mail Restricted Delivery	<input type="checkbox"/> Return Receipt for Merchandise
<input type="checkbox"/> Collect on Delivery	<input type="checkbox"/> Signature Confirmation™
<input type="checkbox"/> Collect on Delivery Restricted Delivery	<input type="checkbox"/> Signature Confirmation Restricted Delivery
<input type="checkbox"/> Insured Mail	

Restricted Delivery

SENDER: COMPLETE THIS SECTION

- Complete items 1, 2, and 3.
- Print your name and address on the reverse so that we can return the card to you.
- Attach this card to the back of the mailpiece, or on the front if space permits.

1. Article Addressed to:

Petro Strategies Inc.
PO Box 5562
Midland TX 79704

Apache E Blinebry 25



9590 9402 2894 7094 3441 74

2. Article Number (Transfer from service label)

7017 1000 0001 0526 1395

PS Form 3811, July 2015 PSN 7530-02-000-9053

COMPLETE THIS SECTION ON DELIVERY

A. Signature Agent Addressee
 X *[Signature]*

B. Received by (Printed Name) _____ C. Date of Delivery _____

D. Is delivery address different from item 1? Yes No
 If YES, enter delivery address below: _____



3. Service Type

<input type="checkbox"/> Adult Signature	<input type="checkbox"/> Priority Mail Express®
<input type="checkbox"/> Adult Signature Restricted Delivery	<input type="checkbox"/> Registered Mail™
<input type="checkbox"/> Certified Mail®	<input type="checkbox"/> Registered Mail Restricted Delivery
<input type="checkbox"/> Certified Mail Restricted Delivery	<input type="checkbox"/> Return Receipt for Merchandise
<input type="checkbox"/> Collect on Delivery	<input type="checkbox"/> Signature Confirmation™
<input type="checkbox"/> Collect on Delivery Restricted Delivery	<input type="checkbox"/> Signature Confirmation Restricted Delivery
<input type="checkbox"/> Insured Mail	

Restricted Delivery

SENDER: COMPLETE THIS SECTION

- Complete items 1, 2, and 3.
- Print your name and address on the reverse so that we can return the card to you.
- Attach this card to the back of the mailpiece, or on the front if space permits.

1. Article Addressed to:

Tanos Energy Holdings
821 E. Southeast Loop 323
Tyler TX 75701

Apache E Blinebry 25



9590 9402 2894 7094 3441 98

2. Article Number (Transfer from service label)

7017 1000 0001 0526 1418

PS Form 3811, July 2015 PSN 7530-02-000-9053

COMPLETE THIS SECTION ON DELIVERY

A. Signature

J. Tucker

- Agent
 Addressee

B. Received by (Printed Name)

Seannette Tucker

C. Date of Delivery

2-2-18

- D. Is delivery address different from item 1? Yes
If YES, enter delivery address below: No

3. Service Type

- | | |
|--|---|
| <input type="checkbox"/> Adult Signature | <input type="checkbox"/> Priority Mail Express® |
| <input type="checkbox"/> Adult Signature Restricted Delivery | <input type="checkbox"/> Registered Mail™ |
| <input type="checkbox"/> Certified Mail® | <input type="checkbox"/> Registered Mail Restricted Delivery |
| <input type="checkbox"/> Certified Mail Restricted Delivery | <input type="checkbox"/> Return Receipt for Merchandise |
| <input type="checkbox"/> Collect on Delivery | <input type="checkbox"/> Signature Confirmation™ |
| <input type="checkbox"/> Collect on Delivery Restricted Delivery | <input type="checkbox"/> Signature Confirmation Restricted Delivery |
| <input type="checkbox"/> Insured Mail | |
| <input type="checkbox"/> Insured Mail Restricted Delivery | |

Domestic Return Receipt

SENDER: COMPLETE THIS SECTION

- Complete items 1, 2, and 3.
- Print your name and address on the reverse so that we can return the card to you.
- Attach this card to the back of the mailpiece, or on the front if space permits.

1. Article Addressed to:

W F M Ranch
PO Box 21116
Billings MT 59104

Apache E Blinebry 25



9590 9402 2894 7094 3441 05

2. Article Number (Transfer from service label)

7017 1000 0001 0526 1326

PS Form 3811, July 2015 PSN 7530-02-000-9053

COMPLETE THIS SECTION ON DELIVERY

A. Signature

John McNeil

- Agent
 Addressee

B. Received by (Printed Name)

John McNeil

C. Date of Delivery

2-6-18

- D. Is delivery address different from item 1? Yes
If YES, enter delivery address below: No

3. Service Type

- | | |
|--|---|
| <input type="checkbox"/> Adult Signature | <input type="checkbox"/> Priority Mail Express® |
| <input type="checkbox"/> Adult Signature Restricted Delivery | <input type="checkbox"/> Registered Mail™ |
| <input type="checkbox"/> Certified Mail® | <input type="checkbox"/> Registered Mail Restricted Delivery |
| <input type="checkbox"/> Certified Mail Restricted Delivery | <input type="checkbox"/> Return Receipt for Merchandise |
| <input type="checkbox"/> Collect on Delivery | <input type="checkbox"/> Signature Confirmation™ |
| <input type="checkbox"/> Collect on Delivery Restricted Delivery | <input type="checkbox"/> Signature Confirmation Restricted Delivery |
| <input type="checkbox"/> Insured Mail | |
| <input type="checkbox"/> Insured Mail Restricted Delivery | |

Domestic Return Receipt



FORM C-108 Technical Review Summary [Prepared by reviewer and included with application; V16.2]

DATE RECORD: First Rec: 2/13/2018 Admin Complete: or Suspended: Add. Request/Reply:
ORDER TYPE: WFX / PMX / SWD Number: Order Date: Legacy Permits/Orders: 13503 FPI-292

Well No. 25 Well Name(s): EBD4
API: 30-0 25-06531 Spud Date: 2/13/2018 New or Old (EPA): (UIC Class II Primacy 03/07/1982)
Footages: 1480 FNL 1480 FWL Lot or Unit F Sec 11 Tsp 215 Rge 37E County Leg
General Location: 2 miles N/Eunice Pool: Pool No.:
BLM 100K Map: JAI Operator: Apache Corp OGRID: 873 Contact: Brian Wood, Agent

COMPLIANCE RULE 5.9: Total Wells: Inactive: Fincl Assur: Compl. Order? IS 5.9 OK? Date:
WELL FILE REVIEWED Current Status: Active
WELL DIAGRAMS: NEW: Proposed or RE-ENTER: Before Conv. After Conv. Logs in Imaging: X
Planned Rehab Work to Well:

Table with columns: Well Construction Details, Sizes (in) Borehole / Pipe, Setting Depths (ft), Cement Sx or Cf, Cement Top and Determination Method. Rows include Surface, Interm/Prod, Prod/Liner, and OH / PERF.

Table with columns: Injection Lithostratigraphic Units, Depths (ft), Injection or Confining Units, Tops. Includes rows for Adjacent Unit, Proposed Inj Interval, and Confining Unit.

Completion/Operation Details: Drilled TD 7501 PBSD, NEW TD, NEW Open Hole, Tubing Size 2 7/8 in, Proposed Packer Depth 555 ft, Min. Packer Depth, Proposed Max. Surface Press, Admin. Inj. Press.
AOR: Hydrologic and Geologic Information
POTASH: R-111-P Noticed? BLM Sec Ord WIPP Noticed? Salt/Salado T: B: NW: Cliff House fm
FRESH WATER: Aquifer G4C ternary Max Depth 60' HYDRO AFFIRM STATEMENT By Qualified Person
NMOSE Basin: Capitan CAPITAN REEF: thru adj NA No. GW Wells in 1-Mile Radius? 1 FW Analysis? X
Disposal Fluid: Formation Source(s) Produced H2O Analysis? X On Lease Operator Only or Commercial
Disposal Interval: Inject Rate (Avg/Max BWPD): 400/500 Protectable Waters? Source: System: Closed or Open
HC Potential: Producing Interval? X Formerly Producing? Method: Logs/DST/P&A/Other 2-Mi Radius Pool Map
AOR Wells: 1/2-M Radius Map and Well List? X No. Penetrating Wells: 33 [AOR Horizontals: AOR SWDs:]
Penetrating Wells: No. Active Wells 33 Num Repairs? on which well(s)? Diagrams?
Penetrating Wells: No. P&A Wells Num Repairs? on which well(s)? Diagrams?

NOTICE: Newspaper Date 1-18-2018 Mineral Owner: Bumpus SW Surface Owner: WFM Ranch N. Date:
RULE 26.7(A): Identified Tracts? X Affected Persons: Bumpus, WFM Ranch, N. Date: 3-0-2018

Order Conditions: Issues:
Additional COAs: