

RECEIVED: 2/20/2018	REVIEWER: MAN	TYPE: CTB	APP NO: PMAM1805260092
-------------------------------	-------------------------	---------------------	----------------------------------

ABOVE THIS TABLE FOR OCD DIVISION USE ONLY

NEW MEXICO OIL CONSERVATION DIVISION
 - Geological & Engineering Bureau -
 1220 South St. Francis Drive, Santa Fe, NM 87505



FEB 20 2018 PM 03:41

ADMINISTRATIVE APPLICATION CHECKLIST

THIS CHECKLIST IS MANDATORY FOR ALL ADMINISTRATIVE APPLICATIONS FOR EXCEPTIONS TO DIVISION RULES AND REGULATIONS WHICH REQUIRE PROCESSING AT THE DIVISION LEVEL IN SANTA FE

Applicant: Chisholm Energy Operating, LLC OGRID Number: 372137
 Well Name: Cottonwood 28-33 Fed Com WCA 3H & 4H API: 30-015-43689 & 30-015-43690
 Pool: Purple Sage; Wolfcamp Pool Code: 98220

SUBMIT ACCURATE AND COMPLETE INFORMATION REQUIRED TO PROCESS THE TYPE OF APPLICATION INDICATED BELOW

CTB - 850

- 1) **TYPE OF APPLICATION:** Check those which apply for (A)
- A. Location - Spacing Unit - Simultaneous Dedication
☐ NSL ☐ NSP (PROJECT AREA) ☐ NSP (PRORATION UNIT) ☐ SD
- B. Check one only for (I) or (II)
- (I) Commingling - Storage - Measurement
☐ DHC ☒ CTB ☐ PLC ☐ PC ☐ OLS ☐ OLM
- (II) Injection - Disposal - Pressure Increase - Enhanced Oil Recovery
☐ WFX ☐ PMX ☐ SWD ☐ IPI ☐ EOR ☐ PPR

2) **NOTIFICATION REQUIRED TO:** Check those which apply.

- A. ☐ Offset operators or lease holders
 B. ☒ Royalty, overriding royalty owners, revenue owners
 C. ☐ Application requires published notice
 D. ☐ Notification and/or concurrent approval by SLO
 E. ☐ Notification and/or concurrent approval by BLM
 F. ☐ Surface owner
 G. ☐ For all of the above, proof of notification or publication is attached, and/or,
 H. ☐ No notice required

FOR OCD ONLY

- ☐ Notice Complete
☐ Application Content Complete

- 3) **CERTIFICATION:** I hereby certify that the information submitted with this application for administrative approval is **accurate** and **complete** to the best of my knowledge. I also understand that **no action** will be taken on this application until the required information and notifications are submitted to the Division.

Note: Statement must be completed by an individual with managerial and/or supervisory capacity.

Bettie Watson

Print or Type Name

Bettie Watson

Signature

2/14/2018
Date

817-864-1104
Phone Number

bwatson@chisholmenergy.com
e-mail Address



February 14, 2018

VIA Certified Mail, Return Receipt

New Mexico Oil Conservation Division
1220 S. St. Francis Dr.
Santa Fe, New Mexico 87505

Attn: Mr. Michael McMillan

RE: Commingle Application of Diverse Ownership
Cottonwood 28-33 Fed Com WCA 3H & 4H
API 30-015-43687 & API 30-015-43690
S22, T26S, R26E
Eddy County, New Mexico

Mr. McMillan,

Pursuant to Division Rule 19.15.12.10, Chisholm Energy Operating, LLC respectfully requests administrative approval to Surface Commingle Diverse Interest and store in a common storage facility production from Cottonwood 28-33 Fed Com WCA 3H & 4H wells located in Eddy County, New Mexico. Each well is metered individually. This action will prevent waste, promote conservation, and protect correlative rights. Due to topographic issues the battery is in Sec 21.

A Communitization Agreement proposal has been submitted by Chisholm Energy Operating, LLC for the East half of sections 28 & 33. At this time, it has not been approved. To provide for production from these wells the Commingle Application of Diverse Ownership is attached.

The Cottonwood 28-33 Fed Com WCA 3H & 4H are operated by Chisholm Energy Operating, LLC. These wells are on the same leases. The interest owners have diverse interest percentages. Pursuant Division Rule 19.15.12.10 the Interest owners that are to be notified are listed on Exhibit A and are being sent a copy of this application by certified mail, return receipt.

Also, attached:

- 1) Topographic map which shows all the lease boundaries, facility, wellheads with API #'s, and path of production.
- 2) Facility Diagram
- 3) Copy of the notice letter to interest owners and copy of certified mail, return receipt request.
- 4) Plats for each well – Form C-102 and associated plats

For future addition of wells, leases, and pools to this commingling operation, notice shall only be given to those interest owners in the wells, leases or pools to be added, in accordance with the Division Rule 19.15.12.10 C (4)(g) NMAC.

If you should have any questions, please call me at (972)979-0132 or Jennifer Elrod at (817) 953-3728.

Sincerely,

Bettie Watson,
Regulatory Consultant



CHISHOLM ENERGY PRODUCING, LLC

EXHIBIT "A"

Application of Chisholm Energy Operating, LLC
for approval of Lease Surface Commingle
WELLS: Cottonwood 28-33 Fed Com WCA 3H & 4H
Section 21, T26S, R26E - Eddy County, New Mexico

Owners to be Served Notice of this Filing

Nearburg Producing Company F/B/O
The Nearburg Producing Company Employee Fund
Attn: Kathie Craft
P. O. Box 823085
Dallas, Texas 75382

Nearburg Producing Company
Attn: Kathie Craft
P.O. Box 823085
Dallas, Texas 75382

Oxy Y-1 Company
2095 East Bender Blvd.
Hobbs, NM 88240

EOG A Resources, Inc.
105 S. 4th Street
Artesia, NM 88210

EOG M Resources, Inc.
105 S. 4th Street
Artesia, NM 88210

EOG Y Resources, Inc.
105 S. 4th Street
Artesia, NM 88210

District I
1625 N. French Drive, Hobbs, NM 88240
District II
811 S. First St., Artesia, NM 88210
District III
1000 Rio Brazos Road, Aztec, NM 87410
District IV
1220 S. St Francis Dr, Santa Fe, NM
87505

State of New Mexico
Energy, Minerals and Natural Resources Department

Form C-107-B
Revised August 1, 2011

OIL CONSERVATION DIVISION
1220 S. St Francis Drive
Santa Fe, New Mexico 87505

Submit the original
application to the Santa Fe
office with one copy to the
appropriate District Office.

APPLICATION FOR SURFACE COMMINGLING (DIVERSE OWNERSHIP)

OPERATOR NAME: Chisholm Energy Operating, LLC
OPERATOR ADDRESS: 800 Cherry Street - Suite 1200-Unit 20 - Fort Worth, TX 76102
APPLICATION TYPE:

☐ Pool Commingling ☒ Lease Commingling ☐ Pool and Lease Commingling ☐ Off-Lease Storage and Measurement (Only if not Surface Commingling)

LEASE TYPE: ☐ Fee ☐ State ☒ Federal

Is this an Amendment to existing Order? ☐ Yes ☒ No If "Yes", please include the appropriate Order No. _____
Have the Bureau of Land Management (BLM) and State Land office (SLO) been notified in writing of the proposed commingling
☒ Yes ☐ No

(A) POOL COMMINGLING

Please attach sheets with the following information

(1) Pool Names and Codes	Gravities / BTU of Non-Commingled Production	Calculated Gravities / BTU of Commingled Production		Calculated Value of Commingled Production	Volumes

- (2) Are any wells producing at top allowables? ☐ Yes ☐ No
(3) Has all interest owners been notified by certified mail of the proposed commingling? ☐ Yes ☐ No.
(4) Measurement type: ☐ Metering ☐ Other (Specify)
(5) Will commingling decrease the value of production? ☐ Yes ☐ No If "yes", describe why commingling should be approved

(B) LEASE COMMINGLING

Please attach sheets with the following information

- (1) Pool Name and Code. Purple Sage; Wolfcamp Gas Pool - Code #98220
(2) Is all production from same source of supply? ☒ Yes ☐ No
(3) Has all interest owners been notified by certified mail of the proposed commingling? ☒ Yes ☐ No
(4) Measurement type: ☒ Metering ☐ Other (Specify)

(C) POOL and LEASE COMMINGLING

Please attach sheets with the following information

- (1) Complete Sections A and E.

(D) OFF-LEASE STORAGE and MEASUREMENT

Please attached sheets with the following information

- (1) Is all production from same source of supply? ☐ Yes ☐ No
(2) Include proof of notice to all interest owners.

(E) ADDITIONAL INFORMATION (for all application types)

Please attach sheets with the following information

- (1) A schematic diagram of facility, including legal location.
(2) A plat with lease boundaries showing all well and facility locations. Include lease numbers if Federal or State lands are involved.
(3) Lease Names, Lease and Well Numbers, and API Numbers.

I hereby certify that the information above is true and complete to the best of my knowledge and belief.

SIGNATURE: Bettie Watson TITLE: Regulatory Consultant DATE: 2/14/2018

TYPE OR PRINT NAME Bettie Watson TELEPHONE NO.: 972-979-0132

E-MAIL ADDRESS: bwatson@chisholmenergy.com



SUMMARY DETAIL

APPLICATION FOR COMMINGLE PERMIT AT A CENTRAL TANK BATTERY, LEASE COMMINGLE & STORAGE Commingle Proposal for Cottonwood 28-33 Fed Com WCA 3H & 4H

Chisholm Energy Operating, LLC is requesting approval for a Central Tank Battery, Lease Commingle & Storage of the following wells:

Well Names _____ Location - Eddy Co. _____ API # _____ Pool _____

BLM Leases: Tract 1 BLM NMNM113944

Cottonwood 28-33 Fed Com WCA 3H SESE, 21, T26S, R26E 30-015-43687 Purple Sage; Wolfcamp/98220

BLM Leases: Tract 1 BLM NMNM113944 & Tract 2 BLM NMNM121472

Cottonwood 28-33 Fed Com WCA 4H SESE, 21, T26S, R26E 30-015-43690 Purple Sage; Wolfcamp/98220

Each tract has diverse ownership. The BLM's interest in both leases is a flat royalty rate of 12.5%.

Economic Justification Worksheet¹

Individual Wells	Current BOPD-est	Oil Gravity	Value/ BBL	Current MCFPD-est	DRY BTU	Value/ MCF
Cottonwood 28-33 Fed Com WCA 3H	600	48.0	\$58.00	2,200		\$3.00
Cottonwood 28-33 Fed Com WCA 4H	400	48.0	\$58.00	1,800		\$3.00
Economic combined production	BOPD	Oil Gravity	Value/ BBL	MCFPD	DRY BTU	Value/ MCF
	1000	48.0	\$58.00	4,000		\$3.00

¹This form is used to indicate that no production and commodity value will be lost by the commingling.

The commingling of production is in the interest of conservation and waste and will result in the most effective, economic means of producing the reserves in place from the affected wells and will not result in reduced royalty or improper measurement of production.

A Communitization Agreement proposal has been submitted but has not been approved for the East half of sections 28 & 33 at this time.

A copy of this application will be submitted to the NMOCD and interest owners by certified mail.

Attached: Topographic map which shows all the lease boundaries, facility, wellheads with API #'s, and path of production.

NMOCD Form C-102 Well Plats

A Facility Diagram

A copy of the notice letter to interest owners and copy of certified mail, return receipt request.

Process and Flow Description:

The flow of produced fluids is shown on the enclosed facility diagram. The surface location of the wells and battery are in Lot P of Sec 21, T26S, R26E. The wells are producing from the East half of Sections 28 & 33 in T26S, R26E. Each well will be metered individually. The fluid/gas enters the production unit where it is separated into the three components, gas, water and oil. The gas flows through a check meter on the production skid and then to the pipeline sales meter. The oil exits the vessel and flows through a turbine meter and then to the oil production tank. The water exits the vessel and flows through a turbine meter and then to the water production tank.

Sign & date

Betty Watson 2-14-2018

S:\Chisholm Wellfiles\Operated\Cottonwood 28-33 Fed Com WCA 3H\Regulatory\COMMINGLE>Cottonwood 28-33 Fed Com WCA 3H, 4H Eco and measurement detail.docx

801 Cherry Street, Suite 1200-Unit 20 | Fort Worth, Texas 76102 | Phone: 817-953-6063 | Fax: 817-601-7551

Cottonwood 28-33 Fed Com WCA Battery in Lot P of Sec 21 T26S R26E
NM OCD OIL AND GAS MAP New Mexico Oil Conservation Division TC

NM OCD OIL AND GAS MAP

New Mexico Oil Conservation Division

TOPO

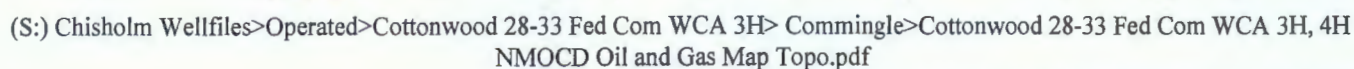

CHISHOLM ENERGY OPERATING, LLC
Cottonwood 28-33 Fed Com WCA East Pad Battery Diagram
SWSE Lot P in Sec 21, T26S, R26E

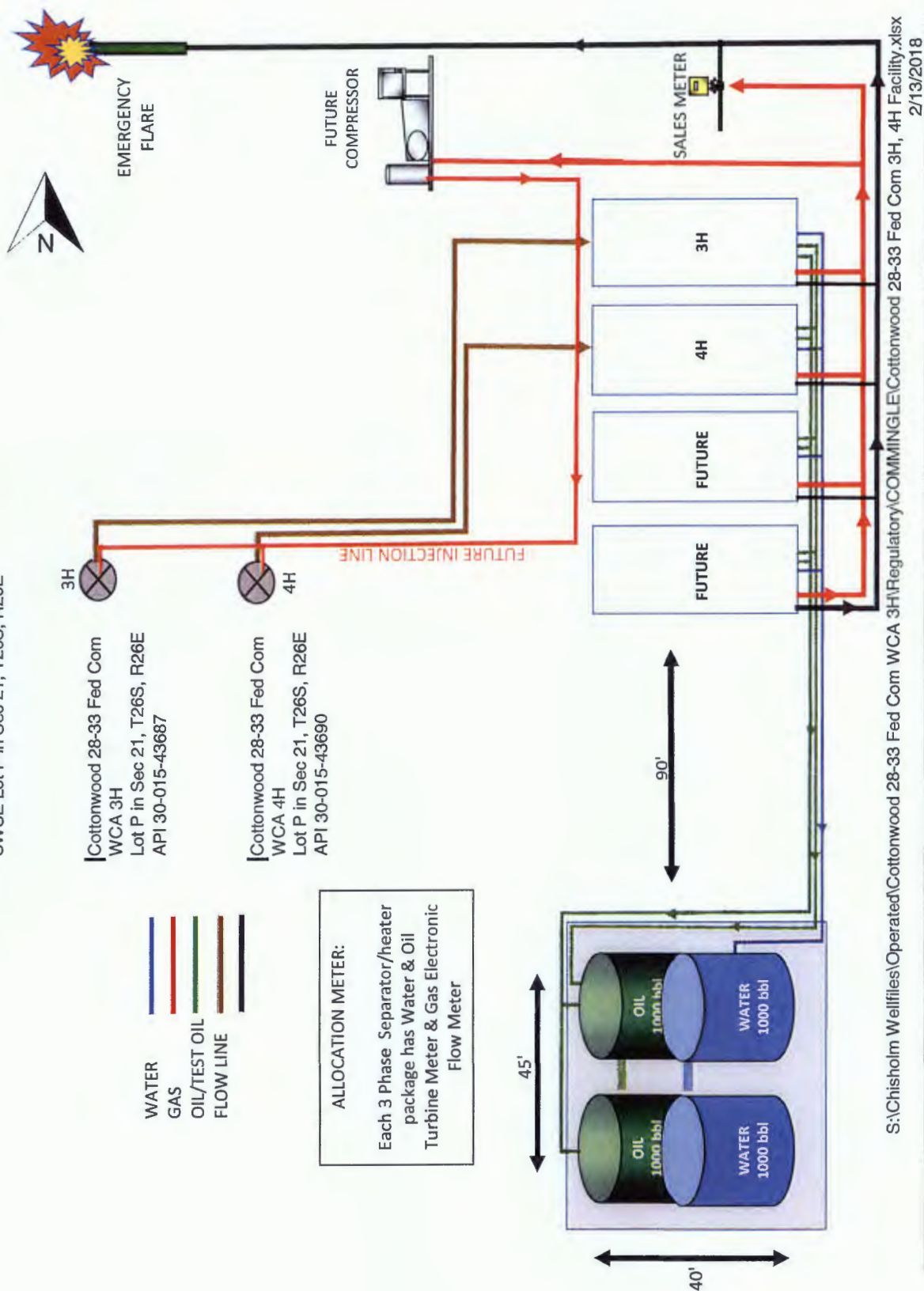

District I
1625 N. French Dr., Hobbs, NM 88240
Phone: (575) 393-6161 Fax: (575) 393-0720
District II
811 S. First St., Artesia, NM 88210
Phone: (575) 748-1283 Fax: (575) 748-9720
District III
1000 Rio Brazos Road, Aztec, NM 87410
Phone: (505) 334-6178 Fax: (505) 334-6170
District IV
1220 S. St. Francis Dr., Santa Fe, NM 87505
Phone: (505) 476-3460 Fax: (505) 476-3462

State of New Mexico
Energy, Minerals & Natural Resources Department
OIL CONSERVATION DIVISION
1220 South St. Francis Dr.
Santa Fe, NM 87505

Form C-102
Revised August 1, 2011
Submit one copy to appropriate
District Office
☒ AMENDED REPORT

WELL LOCATION AND ACREAGE DEDICATION PLAT

¹ API Number 30-015-43690	² Pool Code 98220	⁵ Property Name PURPLE SAGE WOLF CAMP
⁴ Property Code	⁵ Property Name COTTONWOOD 28-33 FED COM WCA	⁶ Well Number 4H
⁷ OGRID No. 372137	⁸ Operator Name CHISHOLM ENERGY OPERATING, LLC	⁹ Elevation 3384

¹⁰ Surface Location

UL or lot no. P	Section 21	Township 26S	Range 26E	Lot Idn	Feet from the 200	North/South line FSL	Feet from the 970	East/West line FEL	County EDDY
--------------------	---------------	-----------------	--------------	---------	----------------------	-------------------------	----------------------	-----------------------	----------------

¹¹ Bottom Hole Location If Different From Surface

UL or lot no. LOT 1	Section 33	Township 26S	Range 26E	Lot Idn	Feet from the 340	North/South line FSL	Feet from the 565	East/West line FEL	County EDDY
------------------------	---------------	-----------------	--------------	---------	----------------------	-------------------------	----------------------	-----------------------	----------------

¹² Dedicated Acres 447.94	¹³ Joint or Infill	¹⁴ Consolidation Code	¹⁵ Order No.
---	-------------------------------	----------------------------------	-------------------------

No allowable will be assigned to this completion until all interests have been consolidated or a non-standard unit has been approved by the division.

¹⁷ OPERATOR CERTIFICATION

I hereby certify that the information contained herein is true and complete to the best of my knowledge and belief, and that this organization either owns a working interest or unleased mineral interest in the land including the proposed bottom hole location or has a right to drill this well at this location pursuant to a contract with an owner of such a mineral or working interest, or to a voluntary pooling agreement or a compulsory pooling order heretofore entered by the division.

Jennifer Elrod 1/4/18
Signature Date

Jennifer Elrod
Printed Name

jelrod@chisholmenergy.com
E-mail Address

¹⁸ SURVEYOR CERTIFICATION

I hereby certify that the well location shown on this plat was plotted from field notes of actual surveys made by me or under my supervision, and that the same is true and correct to the best of my belief.

Date of Survey
Signature and Seal of Professional Surveyor:

Certificate Number

District I
1625 N. French Dr., Hobbs, NM 88240
Phone: (575) 393-6161 Fax: (575) 393-0720
District II
811 S. First St., Artesia, NM 88210
Phone: (575) 748-1283 Fax: (575) 748-9720
District III
1000 Rio Brazos Road, Aztec, NM 87410
Phone: (505) 334-6178 Fax: (505) 334-6170
District IV
1220 S. St. Francis Dr., Santa Fe, NM 87505
Phone: (505) 476-3460 Fax: (505) 476-3462

State of New Mexico
Energy, Minerals & Natural Resources Department
OIL CONSERVATION DIVISION
1220 South St. Francis Dr.
Santa Fe, NM 87505

Form C-102
Revised August 1, 2011
Submit one copy to appropriate
District Office
☒ AMENDED REPORT

WELL LOCATION AND ACREAGE DEDICATION PLAT

¹ API Number 30-015-43687	² Pool Code 98220	³ Property Name PURPLE SAGE; WOLFCAMP
⁴ Property Code	⁵ Property Name COTTONWOOD 28-33 FED COM WCA	⁶ Well Number 3H
⁷ OGRID No. 372137	⁸ Operator Name CHISHOLM ENERGY OPERATING, LLC	⁹ Elevation 3382

¹⁰ Surface Location									
UL or lot no. P	Section 21	Township 26S	Range 26E	Lot Idn	Feet from the 200	North/South line FSL	Feet from the 1030	East/West line FEL	County EDDY

¹¹ Bottom Hole Location If Different From Surface									
UL or lot no. LOT 2	Section 33	Township 26S	Range 26E	Lot Idn	Feet from the 338	North/South line FSL	Feet from the 1600	East/West line FEL	County EDDY
¹² Dedicated Acres 447.94	¹³ Joint or Infill	¹⁴ Consolidation Code	¹⁵ Order No.						

No allowable will be assigned to this completion until all interests have been consolidated or a non-standard unit has been approved by the division.

	<p>¹⁷ OPERATOR CERTIFICATION</p> <p>I hereby certify that the information contained herein is true and complete to the best of my knowledge and belief, and that this organization either owns a working interest or unleased mineral interest in the land including the proposed bottom hole location or has a right to drill this well at this location pursuant to a contract with an owner of such a mineral or working interest, or to a voluntary pooling agreement or a compulsory pooling order heretofore entered by the division.</p> <p><i>Jennifer Elrod</i> 01/05/18 Signature Date</p> <p>Jennifer Elrod Printed Name jelrod@chisholmenergy.com E-mail Address</p>
	<p>¹⁸ SURVEYOR CERTIFICATION</p> <p>I hereby certify that the well location shown on this plat was plotted from field notes of actual surveys made by me or under my supervision, and that the same is true and correct to the best of my belief.</p> <p>Date of Survey Signature and Seal of Professional Surveyor</p> <p>Certificate Number</p>



CHISHOLM ENERGY PRODUCING, LLC

CERTIFIED MAIL RETURN RECEIPT REQUESTED

February 14, 2018

TO: See Exhibit "A"

RE: Request for Lease Surface Commingle of Diverse Ownership
Cottonwood 28-33 Fed Com WCA 3H & 4H
API 30-015-43689 & API 30-015-43690
Purple Sage; Wolfcamp/98220
Eddy County, New Mexico

Gentlemen:

This is to advise you that Chisholm Energy Operating, LLC, is filing an application with the Bureau of Land Management (BLM) and New Mexico Oil Conservation Division (NMOCD) seeking approval for Surface Commingle permit at a central Tank Battery for the above-mentioned wells. Our application as submitted to the BLM and NMOCD is attached. Each well is individually metered. Due to topographic issues the battery is in Sec 21.

In accordance with Paragraph (4)(c) of Subsection C of 19.15.12.10 NMAC prescribes that the applicant shall notify the interest owners. The Applicant shall submit a statement attesting that the applicant, on or before the date the applicant submitted the application to the division, notified each of the interest owners by sending them a copy of the application and the attachments to the application by certified mail, return receipt requested, and advising them that they must file an objection in writing with the division's Santa Fe office within 20 days from the date the division received the application. The division may approve the application administratively, without hearing, upon receipt of written waiver from the interest owner, or if no interest owner has filed an objection within the 20-day period. If the division receives an objection, it shall set the application for hearing. The division shall notify the applicant, who shall give formal notice of hearing to each party who has filed an objection and to such other persons as the division directs.

For future addition of wells, leases, and pools to this commingling operation, notice shall only be given to those interest owners in the wells, leases or pools to be added, in accordance with the Division Rule 19.15.12.10 C (4)(g) NMAC.

To expedite the approval process, I have provided a waiver statement below for your convenience. Please sign and return to my e-mail bwatson@chisholmenergy.com. Also, for your convenience, is a self-addressed stamped return envelope. If you have any questions, please call me at 974.979.0132.

Sincerely,

Bettie Watson, Regulatory Consultant

I have received a copy of the referenced commingle filing. I agree to waive the 20-day protest period required by the regulations as stated above for the referenced commingle filing.

Print Name: _____ Date: _____

Signature: _____ Title: _____

Company Name: _____ Date: _____

801 Cherry Street, Suite 1200, Unit 20 – Fort Worth, Texas 76102

U.S. Postal Service™
CERTIFIED MAIL® RECEIPT
Domestic Mail Only

For delivery information, visit our website at www.usps.com™.

OFFICIAL USE

Certified Mail Fee
\$

Extra Services & Fees (check box, add fee as appropriate)
☐ Return Receipt (hardcopy) \$
☐ Return Receipt (electronic) \$
☐ Certified Mail Restricted Delivery \$
☐ Adult Signature Required \$
☐ Adult Signature Restricted Delivery \$

Postage
\$

Total Postage and Fees
\$

Sent To
Street and Apt. No.,
City, State, ZIP+4®

EOG A Resources Inc
105 South Fourth Street
Artesia, NM 88210-2177

PS Form 3800, April 2015 PSN 7530-02-000-9047 See Reverse for Instructions

U.S. Postal Service™
CERTIFIED MAIL® RECEIPT
Domestic Mail Only

For delivery information, visit our website at www.usps.com™.

OFFICIAL USE

Certified Mail Fee
\$

Extra Services & Fees (check box, add fee as appropriate)
☐ Return Receipt (hardcopy) \$
☐ Return Receipt (electronic) \$
☐ Certified Mail Restricted Delivery \$
☐ Adult Signature Required \$
☐ Adult Signature Restricted Delivery \$

Postage
\$

Total Postage and Fees
\$

Sent To
Street and Apt. No.,
City, State, ZIP+4®

Nearburg Producing Company F/B/O
The Nearburg Producing Company
Employee Fund
Attn: Kathie Craft
P.O. Box 823085
Dallas, TX 75382

PS Form 3800, April 2015 PSN 7530-02-000-9047 See Reverse for Instructions

U.S. Postal Service™
CERTIFIED MAIL® RECEIPT
Domestic Mail Only

For delivery information, visit our website at www.usps.com™.

OFFICIAL USE

Certified Mail Fee
\$

Extra Services & Fees (check box, add fee as appropriate)
☐ Return Receipt (hardcopy) \$
☐ Return Receipt (electronic) \$
☐ Certified Mail Restricted Delivery \$
☐ Adult Signature Required \$
☐ Adult Signature Restricted Delivery \$

Postage
\$

Total Postage and Fees
\$

Sent To
Street and Apt. No.,
City, State, ZIP+4®

Oxy Y-1 Company
2095 East Bender Blvd
Hobbs, NM 88240

PS Form 3800, April 2015 PSN 7530-02-000-9047 See Reverse for Instructions

U.S. Postal Service™
CERTIFIED MAIL® RECEIPT
Domestic Mail Only

For delivery information, visit our website at www.usps.com™.

OFFICIAL USE

Certified Mail Fee
\$

Extra Services & Fees (check box, add fee as appropriate)
☐ Return Receipt (hardcopy) \$
☐ Return Receipt (electronic) \$
☐ Certified Mail Restricted Delivery \$
☐ Adult Signature Required \$
☐ Adult Signature Restricted Delivery \$

Postage
\$

Total Postage and Fees
\$

Sent To
Street and Apt. No.,
City, State, ZIP+4®

Nearburg Producing Company
Attn: Kathie Craft
P.O. Box 823085
Dallas, TX 75382

PS Form 3800, April 2015 PSN 7530-02-000-9047 See Reverse for Instructions

7017 0530 0000 7868 9683 7017 0530 0000 7868 9690 7017 0530 0000 7868 971

For delivery information, visit our website at www.usps.com™.

OFFICIAL USE

Certified Mail Fee
\$

Extra Services & Fees (check box, add fee as appropriate)
☐ Return Receipt (hardcopy) \$
☐ Return Receipt (electronic) \$
☐ Certified Mail Restricted Delivery \$
☐ Adult Signature Required \$
☐ Adult Signature Restricted Delivery \$

Postage
\$

Total Postage and Fees
\$

Sent To
Street and Apt. No.,
City, State, ZIP+4®

EOG M Resources Inc
105 South Fourth Street
Artesia, NM 88210-2177

PS Form 3800, April 2015 PSN 7530-02-000-9047 See Reverse for Instructions

U.S. Postal Service™
CERTIFIED MAIL® RECEIPT
Domestic Mail Only

For delivery information, visit our website at www.usps.com™.

OFFICIAL USE

Certified Mail Fee
\$

Extra Services & Fees (check box, add fee as appropriate)
☐ Return Receipt (hardcopy) \$
☐ Return Receipt (electronic) \$
☐ Certified Mail Restricted Delivery \$
☐ Adult Signature Required \$
☐ Adult Signature Restricted Delivery \$

Postage
\$

Total Postage and Fees
\$

Sent To
Street and Apt. No.,
City, State, ZIP+4®

New Mexico Oil & Gas
Oil Conservation Division
Attn: Michael McMillian
1220 South St. Francis Drive
Santa Fe, NM 87505

PS Form 3800, April 2015 PSN 7530-02-000-9047 See Reverse for Instructions

U.S. Postal Service™
CERTIFIED MAIL® RECEIPT
Domestic Mail Only

For delivery information, visit our website at www.usps.com™.

OFFICIAL USE

Certified Mail Fee
\$

Extra Services & Fees (check box, add fee as appropriate)
☐ Return Receipt (hardcopy) \$
☐ Return Receipt (electronic) \$
☐ Certified Mail Restricted Delivery \$
☐ Adult Signature Required \$
☐ Adult Signature Restricted Delivery \$

Postage
\$

Total Postage and Fees
\$

Sent To
Street and Apt. No.,
City, State, ZIP+4®

EOG Y Resources Inc
105 South Fourth Street
Artesia, NM 88210-2177

PS Form 3800, April 2015 PSN 7530-02-000-9047 See Reverse for Instructions