

RECEIVED: <b>3/23/2018</b>	REVIEWER: <b>MAM</b>	TYPE:	APP NO: <b>PMAm190824737</b>
-------------------------------	-------------------------	-------	---------------------------------

ABOVE THIS TABLE FOR OCD DIVISION USE ONLY

**NEW MEXICO OIL CONSERVATION DIVISION**  
 - Geological & Engineering Bureau -  
 1220 South St. Francis Drive, Santa Fe, NM 87505



**ADMINISTRATIVE APPLICATION CHECKLIST**

THIS CHECKLIST IS MANDATORY FOR ALL ADMINISTRATIVE APPLICATIONS FOR EXCEPTIONS TO DIVISION RULES AND REGULATIONS WHICH REQUIRE PROCESSING AT THE DIVISION LEVEL IN SANTA FE

**Applicant:** Matador Production Company **OGRID Number:** 228937  
**Well Name:** Garrett State Com 121H, 201H, 215H & 221H **API:** 30-015-44751, 30-015-44418, 30-015-44458 & 30-015-44256  
**Pool:** Pierce Crossing; Bone Spring East Pool and the Purple Sage; Wolfcamp (Gas) Pool **Pool Code:** 96473 & 98220

**SUBMIT ACCURATE AND COMPLETE INFORMATION REQUIRED TO PROCESS THE TYPE OF APPLICATION INDICATED BELOW**

- 1) **TYPE OF APPLICATION:** Check those which apply for [A]  
 A. Location - Spacing Unit - Simultaneous Dedication  
☐ NSL ☐ NSP (PROJECT AREA) ☐ NSP (PRORATION UNIT) ☐ SD

B. Check one only for [I] or [II]

[I] Commingling - Storage - Measurement

☐ DHC ☒ CTB ☒ PLC ☒ PC ☒ OLS ☒ OLM

[II] Injection - Disposal - Pressure Increase - Enhanced Oil Recovery

☐ WFX ☐ PMX ☐ SWD ☐ IPI ☐ EOR ☐ PPR

- 2) **NOTIFICATION REQUIRED TO:** Check those which apply.

- A. ☐ Offset operators or lease holders  
 B. ☒ Royalty, overriding royalty owners, revenue owners  
 C. ☐ Application requires published notice  
 D. ☒ Notification and/or concurrent approval by SLO  
 E. ☐ Notification and/or concurrent approval by BLM  
 F. ☐ Surface owner  
 G. ☒ For all of the above, proof of notification or publication is attached, and/or,  
 H. ☐ No notice required

**FOR OCD ONLY**

- ☐ Notice Complete  
☐ Application Content Complete

- 3) **CERTIFICATION:** I hereby certify that the information submitted with this application for administrative approval is **accurate** and **complete** to the best of my knowledge. I also understand that **no action** will be taken on this application until the required information and notifications are submitted to the Division.

**Note: Statement must be completed by an individual with managerial and/or supervisory capacity.**

Michael H. Feldewert

Print or Type Name

Signature

March 23, 2018

Date

505-988-4421

Phone Number

mfeldewert@hollandhart.com

e-mail Address



March 23, 2018

**VIA HAND DELIVERY**

MAR 23 2018 AM 11:47

Heather Riley  
Oil Conservation Division  
New Mexico Department of Energy,  
Minerals and Natural Resources  
1220 South Saint Francis Drive  
Santa Fe, New Mexico 87505

**Re: Application of Matador Production Company to authorize pool commingling, off-lease storage and off-lease marketing at the Garrett Tank Battery located in the NW/4 NW/4 (Unit D) of Section 32, Township 24 South, Range 29 East, NMPM, Eddy County, New Mexico.**

Dear Ms. Riley:

Under NMAC 19.15.12.7, individual spacing and proration units are considered separate “leases” for surface commingling purposes. Accordingly, Matador Production Company (OGRID No. 228937) seeks administrative approval for pool commingling, off-lease storage and off-lease marketing at the Garrett Tank Battery of production from the Pierce Crossing; Bone Spring East Pool (96473) and the Purple Sage; Wolfcamp (Gas) Pool (98220) produced from *all existing and future wells* drilled in the following “leases:”

- (a) The 160.74-acre spacing and proration unit comprised of the N/2 N/2 of Section 32, which is currently dedicated to the Garrett State Com 121H (API No. 30-015-44751);
- (b) The 321.42-acre spacing and proration unit comprised of the N/2 Section 32, which is currently dedicated to the Garrett State Com 201H (API No. 30-015-44418), the Garrett State Com 215H (API No. 30-015-44458), and the Garrett State Com 221H (API No. 30-015-44256); and
- (c) Pursuant to NMAC 19.15.12.10.C(4)(g), *future spacing and proration units connected to this central tank battery* with notice provided only to the interest owners within these future “leases.”

Oil and gas production from these “leases” will be commingled and sold at the Garrett State Com Tank Battery located in the NW/4 NW/4 (Unit D) of Section 32. Prior to commingling, gas production from each “lease” will be separately metered using individual test separators with



calibrated orifice meters that are manufactured to AGA specifications. Oil production from each "lease" will also be separately metered using turbine meters.

**Exhibit 1** is a land plat showing Matador's current development plan, the central tank batter ("production facility") and the gathering line in the subject area;

**Exhibit 2** contains the C-102s for each well currently planned or drilled for the subject leases. There are no available six-month production reports for these wells.

**Exhibit 3** contains a completed Application for Surface Commingling (Diverse Ownership) Form C-107-B that includes a statement from Benjamin D. Peterson, P.E. identifying the facilities and the measurement devices to be utilized, a detailed schematic of the surface facilities (attachment A to the statement) and a referenced gas sample (attachment B to the statement).

**Exhibit 4** is a list of all mineral owners (including owners of royalty and overriding royalty interests) affected by this application, a copy of the letters sent by certified mail advising them that if they have an objection it must file it in writing with the division within 20 days from the date the Division receives this application, and proof of mailing.

Since state lands are involved, a copy of this application has been provided to the New Mexico State Land Office.

Thank you for your attention to this matter and please feel free to call if you have any questions and require additional information.

Sincerely,

Michael H. Feldewert

**ATTORNEY FOR MATADOR PRODUCTION  
COMPANY**

District I  
1625 N French Drive, Hobbs, NM 88240  
District II  
811 S First St., Artesia, NM 88210  
District III  
1000 Rio Brazos Road, Aztec, NM 87410  
District IV  
1220 S St Francis Dr, Santa Fe, NM  
87505

State of New Mexico  
Energy, Minerals and Natural Resources Department

Form C-107-B  
Revised August 1, 2011

**OIL CONSERVATION DIVISION**  
1220 S. St Francis Drive  
Santa Fe, New Mexico 87505

Submit the original  
application to the Santa Fe  
office with one copy to the  
appropriate District Office.

**APPLICATION FOR SURFACE COMMINGLING (DIVERSE OWNERSHIP)**

OPERATOR NAME: Matador Production Company

OPERATOR ADDRESS: 5400 LBJ Freeway, STE 1500, Dallas, TX 75240

APPLICATION TYPE:

☒ Pool Commingling ☐ Lease Commingling ☐ Pool and Lease Commingling ☐ Off-Lease Storage and Measurement (Only if not Surface Commingled)

LEASE TYPE: ☒ Fee ☒ State ☐ Federal

Is this an Amendment to existing Order? ☐ Yes ☒ No If "Yes", please include the appropriate Order No.

Have the Bureau of Land Management (BLM) and State Land office (SLO) been notified in writing of the proposed commingling

☒ Yes ☐ No

**(A) POOL COMMINGLING**

Please attach sheets with the following information

(1) Pool Names and Codes	Gravities / BTU of Non-Commingled Production	Calculated Gravities / BTU of Commingled Production	Calculated Value of Commingled Production	Volumes
Willow Lake; Bone Spring (50391)	1,242 BTU/scf	1,222 BTU/scf	\$2.55/mcf (Feb 2018 pricing)	10,050 mcf/d
	46.5°			
Purple Sage; Wolfcamp (Gas) (98220)	1,220 BTU/scf	46.8°	\$61.72/bbl (Feb 2018 pricing - deemed sweet/40°)	2,500 bopd
	46.9°			

(2) Are any wells producing at top allowables? ☐ Yes ☒ No

(3) Has all interest owners been notified by certified mail of the proposed commingling? ☒ Yes ☐ No

(4) Measurement type: ☒ Metering ☐ Other (Specify)

(5) Will commingling decrease the value of production? ☐ Yes ☒ No If "yes", describe why commingling should be approved

**(B) LEASE COMMINGLING**

Please attach sheets with the following information

(1) Pool Name and Code - See Above

(2) Is all production from same source of supply? ☐ Yes ☒ No

(3) Has all interest owners been notified by certified mail of the proposed commingling? ☒ Yes ☐ No

(4) Measurement type: ☒ Metering ☐ Other (Specify)

**(C) POOL and LEASE COMMINGLING**

Please attach sheets with the following information

(1) Complete Sections A and E.

**(D) OFF-LEASE STORAGE and MEASUREMENT**

Please attach sheets with the following information

(1) Is all production from same source of supply? ☐ Yes ☒ No

(2) Include proof of notice to all interest owners.

**(E) ADDITIONAL INFORMATION (for all application types)**

Please attach sheets with the following information

(1) A schematic diagram of facility, including legal location.

(2) A plat with lease boundaries showing all well and facility locations. Include lease numbers if Federal or State lands are involved.

(3) Lease Names, Lease and Well Numbers, and API Numbers.

I hereby certify that the information above is true and complete to the best of my knowledge and belief.

SIGNATURE: 

TITLE: Area Production Manager

DATE: 3/14/18

TYPE OR PRINT NAME: John Romano

TELEPHONE NO.: 972-371-5245

E-MAIL ADDRESS: jromano@matadorresources.com

EXHIBIT

3

# Matador Production Company

One Lincoln Centre • 5400 LBJ Freeway • Suite 1500 • Dallas, Texas 75240

Voice 972.371.5427 • Fax 972.371.5201

[bpeterson@matadorresources.com](mailto:bpeterson@matadorresources.com)

---

**John Romano**  
Area Production Manager

March 14, 2018

New Mexico Oil Conservation Division  
1220 South St. Francis Drive  
Santa Fe, NM 87505

**Re: Application of Matador Production Company for the spacing units comprised of the N/2 of Section 32, Township 24 South, Range 29 East, NMPM, Eddy County, New Mexico (the "Lands")**

To Whom This May Concern,

Matador Production Company ("Matador"), OGRID: 228937, requests to commingle current oil and gas production from four (4) distinct wells located on the Lands and future production from the Lands as described herein. All wells will be metered through individual test separators with an oil turbine meter and gas orifice meter. The gas commingling will occur after individual measurement at each well. Gas exiting each well test flows into one gathering line, as depicted on **Exhibit A**, the Longwood Gathering line. Each well on the Lands will have its own test separator with an orifice meter manufactured and assembled in accordance with American Gas Association (AGA) specifications. All primary and secondary Electronic Flow Measurement (EFM) equipment is tested and calibrated by a reputable third party measurement company in accordance with industry specifications.

The orifice meter is the preferred measurement device utilized by midstream and E&P companies in natural gas measurement. The gas samples are obtained at the time of the meter testing/calibration and the composition and heating value are determined by a laboratory in accordance with American Petroleum Institute (API) specifications to ensure accurate volume and Energy (MMBTU) determinations. See example from Fesco Laboratory attached as **Exhibit B** hereto.

The flow stream from each wellhead is demonstrated in the Process Flow Diagram (PFD) attached as **Exhibit A** hereto. The PFD shows that the water, oil, and gas leave the wellbore and flow into a wellhead test separator which separates the oil, gas, and water. The oil is measured via turbine meter which is calibrated periodically in accordance with industry specifications by a third party measurement company for accuracy. The gas is measured on a volume and MMBTU basis by an orifice meter and supporting EFM equipment in accordance with American Petroleum Association (API) Chapter 21.1. The gas is then sent into a gathering line where it is commingled with each of

the other wells' metered gas. The gathering line gas is then metered by another orifice meter at the tank battery check to show the total volume of gas leaving the Tank Battery. This meter is tested and calibrated in accordance with industry specifications and volume and energy are determined on an hourly, daily, and monthly basis. Once the gas exits this final tank battery sales check it travels directly into a third party sales connect meter. Longwood Gathering has its own orifice meter that measures the gas for custody transfer. These meters are also calibrated periodically to ensure the measurement accuracy.

In conclusion, all the oil and gas produced on the Lands is and will be metered at each wellhead and allocated correctly using the same measurement equipment as the pipeline sales measurement specifications accepted by API as industry standard.

Very truly yours,

MATADOR PRODUCTION COMPANY

A handwritten signature in black ink, appearing to read 'John Romano', with a stylized, flowing script.

John Romano  
Area Production Manager

# Garrett State Com Land Plat

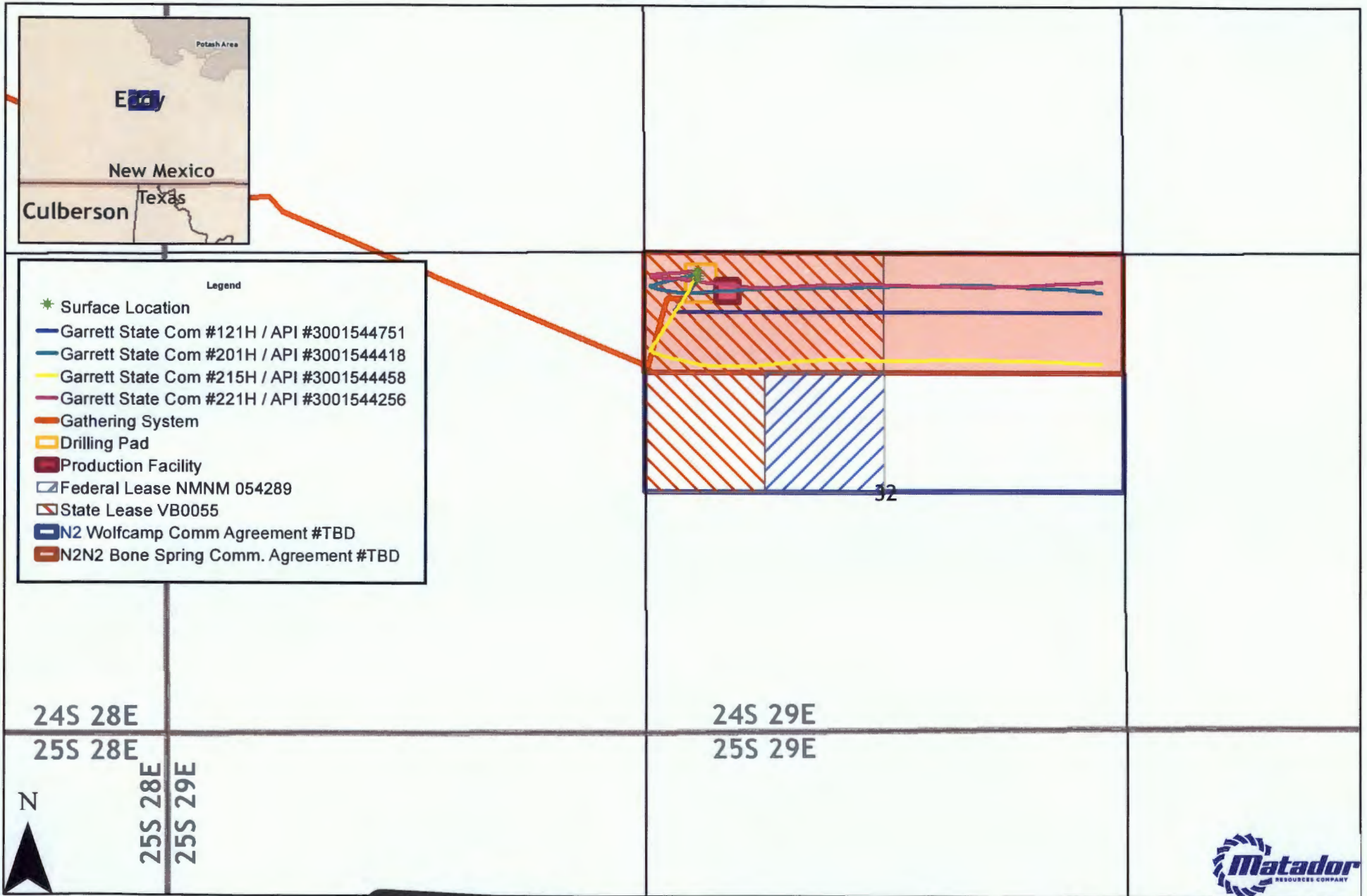

0 750 1,500 3,000 Feet

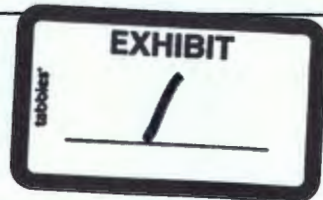

Southeast New Mexico

Date: March 14, 2018  
 Filename: ComminglingLandPlat\_GarrettSlot1  
 Projection: NAD27 State Plane New Mexico East FIPS 3001  
 Sources: IHS; ESRI;



District I  
1625 N. French Dr., Hobbs, NM 88240  
Phone: (575) 393-6161 Fax: (575) 393-0720  
District II  
811 S First St., Artesia, NM 88210  
Phone: (575) 748-1283 Fax: (575) 748-9720  
District III  
1000 Rio Brazos Road, Aztec, NM 87410  
Phone: (505) 334-6178 Fax: (505) 134-6170  
District IV  
1220 S. St. Francis Dr., Santa Fe, NM 87505  
Phone: (505) 476-3460 Fax: (505) 476-3462

State of New Mexico  
Energy, Minerals & Natural Resources  
Department  
OIL CONSERVATION DIVISION  
1220 South St. Francis Dr.  
Santa Fe, NM 87505

FORM C-102  
Revised August 1, 2011  
Submit one copy to appropriate  
District Office

☒ AMENDED REPORT

WELL LOCATION AND ACREAGE DEDICATION PLAT

<sup>1</sup> API Number 30-015-44418		<sup>2</sup> Pool Code 98820		<sup>3</sup> Pool Name Purple Sage; Wolfcamp (Gas)	
<sup>4</sup> Property Code 319473		<sup>5</sup> Property Name GARRETT STATE COM			<sup>6</sup> Well Number #201H
<sup>7</sup> GRID No. 228937		<sup>8</sup> Operator Name MATADOR PRODUCTION COMPANY			<sup>9</sup> Elevation 2938'
<sup>10</sup> Surface Location					
UL or lot no. D	Section 32	Township 24-S	Range 29-E	Lot Idn -	Feet from the 250'
					North/South line NORTH
					Feet from the 570'
					East/West line WEST
					County EDDY
UL or lot no. A	Section 32	Township 24-S	Range 29-E	Lot Idn -	Feet from the 330'
					North/South line NORTH
					Feet from the 240'
					East/West line EAST
					County EDDY
<sup>11</sup> Dedicated Acres 321.42		<sup>13</sup> Joint or Infill		<sup>14</sup> Consolidation Code	
				<sup>15</sup> Order No.	

No allowable will be assigned to this completion until all interests have been consolidated or a non-standard unit has been approved by the division.

570'

**FIRST PERFORMANCE POINT**  
NEW MEXICO EAST  
NAD 1927  
X=598928  
Y=429391  
LAT.: N 32.1801077  
LONG.: W 104.0135780  
NAD 1983  
X=640113  
Y=429449  
LAT.: N 32.1802307  
LONG.: W 104.0140684

**LAST PERFORMANCE POINT**  
NEW MEXICO EAST  
NAD 1927  
X=603543  
Y=429378  
LAT.: N 32.1800339  
LONG.: W 103.9986820  
NAD 1983  
X=644728  
Y=429436  
LAT.: N 32.1801571  
LONG.: W 103.9991498

**BOTTOM HOLE LOCATION**  
NEW MEXICO EAST  
NAD 1927  
X=603633  
Y=429378  
LAT.: N 32.1800324  
LONG.: W 103.9983711  
NAD 1983  
X=644818  
Y=429436  
LAT.: N 32.1801557  
LONG.: W 103.9988589

**SURFACE LOCATION**  
NEW MEXICO EAST  
NAD 1927  
X=598168  
Y=429470  
LAT.: N 32.1803234  
LONG.: W 104.0128025  
NAD 1983  
X=640352  
Y=429528  
LAT.: N 32.1804464  
LONG.: W 104.0132908

**17 OPERATOR CERTIFICATION**  
I hereby certify that the information contained herein is true and complete to the best of my knowledge and belief, and that this organization either owns a working interest or undivided mineral interest in the land including the proposed bottom hole location or has a right to drill this well at this location pursuant to a contract with an owner of such a mineral or working interest, or to a unitary pooling agreement or a compulsory pooling order heretofore entered by the division.  
Signature: *Chris Carleton* Date: 3/2/18  
Printed Name: Chris Carleton  
E-mail Address: carleton@matadorresources.com

**18 SURVEYOR CERTIFICATION**  
I hereby certify that the well location shown on this plat was plotted from field notes of actual surveys made by me or under my supervision, and that the same is true to the best of my belief.  
08/15/2017  
Date of Survey  
Signature and Seal of Surveyor: *Michael B. Brown*  
MICHAEL B. BROWN  
NEW MEXICO  
18328  
CERTIFICATED SURVEYOR  
Certificate Number

District I  
1625 N French Dr., Hobbs, NM 88240  
Phone: (575) 393-6161 Fax: (575) 393-0720  
District II  
811 S First St., Artesia, NM 88210  
Phone: (575) 748-1283 Fax: (575) 748-9720  
District III  
1000 Rio Brazos Road, Aztec, NM 87410  
Phone: (505) 334-6178 Fax: (505) 334-6170  
District IV  
1220 S St. Francis Dr., Santa Fe, NM 87505  
Phone: (505) 476-3460 Fax: (505) 476-3462

State of New Mexico  
Energy, Minerals & Natural Resources  
Department  
OIL CONSERVATION DIVISION  
1220 South St. Francis Dr.  
Santa Fe, NM 87505

FORM C-102  
Revised August 1, 2011  
Submit one copy to appropriate  
District Office

☒ AMENDED REPORT

WELL LOCATION AND ACREAGE DEDICATION PLAT

<sup>1</sup> API Number 30-015-44751	<sup>2</sup> Pool Code 96473	<sup>3</sup> Pool Name PIERCE CROSSING; BONE SPRING, EAST
<sup>4</sup> Property Code 319473	<sup>5</sup> Property Name GARRETT STATE COM	<sup>6</sup> Well Number #121H
<sup>7</sup> GRID No. 228937	<sup>8</sup> Operator Name MATADOR PRODUCTION COMPANY	<sup>9</sup> Elevation 2938'

<sup>10</sup>Surface Location

UL or lot no.	Section	Township	Range	Lot Idn	Feet from the	North/South line	Feet from the	East/West line	County
D	32	24-S	29-E	-	310'	NORTH	570'	WEST	EDDY

UL or lot no.	Section	Township	Range	Lot Idn	Feet from the	North/South line	Feet from the	East/West line	County
A	32	24-S	29-E	-	660'	NORTH	240'	EAST	EDDY

<sup>11</sup> Dedicated Acres 160.74	<sup>12</sup> Joint or Infill	<sup>13</sup> Consolidation Code	<sup>14</sup> Order No.
---	-------------------------------	----------------------------------	-------------------------

No allowable will be assigned to this completion until all interests have been consolidated or a non-standard unit has been approved by the division.

				<p><sup>17</sup>OPERATOR CERTIFICATION</p> <p>I hereby certify that the information contained herein is true and correct to the best of my knowledge and belief, and that this organization either owns a working interest or undivided mineral interest in the land including the proposed bottom hole location or has a right to drill this well at this location pursuant to a contract with an owner of such mineral or working interest, or to a voluntary pooling agreement or a compulsory pooling order heretofore entered by the division.</p> <p><i>Chris Carleton</i> 3/2/18 Signature Date</p> <p>Chris Carleton Printed Name</p> <p>ccarleton@matadorresources.com E-mail Address</p>
<p>FIRST PERFORATION POINT NEW MEXICO EAST NAD 1927 X=598930 Y=429061 LAT.: N 32.1792011 LONG.: W 104.0135753 NAD 1983 X=640114 Y=429119 LAT.: N 32.1793241 LONG.: W 104.0140637</p>	<p>SURFACE LOCATION NEW MEXICO EAST NAD 1927 X=599168 Y=429410 LAT.: N 32.1801584 LONG.: W 104.0126021 NAD 1983 X=640353 Y=429468 LAT.: N 32.1802815 LONG.: W 104.0132904</p>	<p>LAST PERFORATION POINT NEW MEXICO EAST NAD 1927 X=603545 Y=429048 LAT.: N 32.1791273 LONG.: W 103.9986616 NAD 1983 X=644729 Y=429107 LAT.: N 32.1792506 LONG.: W 103.9991493</p>	<p>BOTTOM HOLE LOCATION NEW MEXICO EAST NAD 1927 X=603635 Y=429048 LAT.: N 32.1791259 LONG.: W 103.9983707 NAD 1983 X=644819 Y=429106 LAT.: N 32.1792491 LONG.: W 103.9985584</p>	
<p><sup>18</sup>SURVEYOR CERTIFICATION</p> <p>I hereby certify that the well location shown on this plat was plotted from field notes of actual surveys made by me or under my supervision, and that the same is true to the best of my belief.</p> <p>01 MARCH 2018 Date of Survey Signature and Seal MICHAEL BROWN NEW MEXICO 18329 PROFESSIONAL SURVEYOR Certificate Number</p>				

3 SURVEY-MATADOR-RESOURCES-GARRETT FED COM 1211FFINAL PRODUCTS-LO GARRETT FED COM 1211H DWS 11/7/2018 1:24:10 PM bgregory

EXHIBIT

2

District I  
1625 N. French Dr., Hobbs, NM 88240  
Phone: (575) 393-6161 Fax: (575) 393-0720  
District II  
811 S. First St., Artesia, NM 88210  
Phone: (575) 748-1283 Fax: (575) 748-9720  
District III  
1000 Rio Bruzos Road, Aztec, NM 87410  
Phone: (505) 334-6178 Fax: (505) 334-6170  
District IV  
1220 S. St. Francis Dr., Santa Fe, NM 87505  
Phone: (505) 476-3460 Fax: (505) 476-3462

State of New Mexico  
Energy, Minerals & Natural Resources  
Department  
OIL CONSERVATION DIVISION  
1220 South St. Francis Dr.  
Santa Fe, NM 87505

FORM C-102  
Revised August 1, 2011  
Submit one copy to appropriate  
District Office

☒ AMENDED REPORT

WELL LOCATION AND ACREAGE DEDICATION PLAT

<sup>1</sup> API Number 30-015-44458		<sup>2</sup> Pool Code 98220	<sup>3</sup> Pool Name PURPLE SAGE; WOLFCAMP (GAS)
<sup>4</sup> Property Code 319473	<sup>5</sup> Property Name GARRETT STATE COM		<sup>6</sup> Well Number #215H
<sup>7</sup> GRID No. 228937	<sup>8</sup> Operator Name MATADOR PRODUCTION COMPANY		<sup>9</sup> Elevation 2939'

<sup>10</sup>Surface Location

UL or lot no.	Section	Township	Range	Lot Idn	Feet from the	North/South line	Feet from the	East/West line	County
D	32	24-S	29-E	-	280'	NORTH	570'	WEST	EDDY

UL or lot no.	Section	Township	Range	Lot Idn	Feet from the	North/South line	Feet from the	East/West line	County
A	32	24-S	29-E	-	1220'	NORTH	240'	EAST	EDDY

<sup>11</sup> Dedicated Acres 321.42	<sup>12</sup> Joint or Infill	<sup>13</sup> Consolidation Code	<sup>14</sup> Order No.
---	-------------------------------	----------------------------------	-------------------------

No allowable will be assigned to this completion until all interests have been consolidated or a non-standard unit has been approved by the division.

				<p><b><sup>17</sup>OPERATOR CERTIFICATION</b></p> <p>I hereby certify that the information contained herein is true and complete to the best of my knowledge and belief, and that this organization either owns a working interest or undivided mineral interest in the land underlying the proposed bottom hole location or has a right to drill this well at this location pursuant to a contract with an owner of such a mineral or working interest, or to a voluntary pooling agreement or a compulsory pooling order heretofore entered by the division.</p> <p>Signature: <i>Chris Carleton</i> Date: 3/2/18</p> <p>Chris Carleton</p> <p>ccarleton@matadorresources.com</p>
<p><b>FIRST PERFORATION POINT</b> NEW MEXICO EAST NAD 1927 X=598933 Y=428501 LAT.: N 32.1776817 LONG.: W 104.0135708 NAD 1983 X=640117 Y=428559 LAT.: N 32.1777848 LONG.: W 104.0140591</p>	<p><b>SURFACE LOCATION</b> NEW MEXICO EAST NAD 1927 X=599188 Y=429440 LAT.: N 32.1802409 LONG.: W 104.0128023 NAD 1983 X=640352 Y=429498 LAT.: N 32.1803839 LONG.: W 104.0132906</p>	<p><b>LAST PERFORATION POINT</b> NEW MEXICO EAST NAD 1927 X=603546 Y=428488 LAT.: N 32.1775880 LONG.: W 103.9986608 NAD 1983 X=644731 Y=428547 LAT.: N 32.1777112 LONG.: W 103.9991485</p>	<p><b>BOTTOM HOLE LOCATION</b> NEW MEXICO EAST NAD 1927 X=603637 Y=428488 LAT.: N 32.1775865 LONG.: W 103.9983699 NAD 1983 X=644821 Y=428546 LAT.: N 32.1777098 LONG.: W 103.9988576</p>	
<p><b><sup>18</sup>SURVEYOR CERTIFICATION</b></p> <p>I hereby certify that the well location shown on this plat was plotted from field notes of actual surveys made by me or under my supervision, and that the same is true to the best of my belief.</p> <p>Date of Survey: 03/20/2017 Signature: <i>Michael Brown</i> MICHAEL BROWN NEW MEXICO 18329 PROFESSIONAL SURVEYOR Certificate Number</p>				

District I  
1625 N French Dr., Hobbs, NM 88240  
Phone (575) 393-6161 Fax (575) 393-0720  
District II  
811 S First St., Artesia, NM 88210  
Phone (575) 748-1283 Fax (575) 748-9720  
District III  
1000 Rio Brazos Road, Aztec, NM 87410  
Phone (505) 334-6178 Fax (505) 334-6170  
District IV  
1220 S. St. Francis Dr., Santa Fe, NM 87505  
Phone (505) 476-3460 Fax (505) 476-3462

State of New Mexico  
Energy, Minerals & Natural Resources  
Department  
OIL CONSERVATION DIVISION  
1220 South St. Francis Dr.  
Santa Fe, NM 87505

FORM C-102  
Revised August 1, 2011  
Submit one copy to appropriate  
District Office

☒ AMENDED REPORT

WELL LOCATION AND ACREAGE DEDICATION PLAT

<sup>1</sup> API Number 30-015-44256	<sup>2</sup> Pool Code 98220	<sup>3</sup> Pool Name PURPLE SAGE; WOLFCAMP (GAS)
<sup>4</sup> Property Code	<sup>5</sup> Property Name GARRETT STATE COM	<sup>6</sup> Well Number #221H
<sup>7</sup> GRID No. 228937	<sup>8</sup> Operator Name MATADOR PRODUCTION COMPANY	<sup>9</sup> Elevation 2938'

<sup>10</sup>Surface Location

UL or lot no.	Section	Township	Range	Lot Idn	Feet from the	North/South line	Feet from the	East/West line	County
D	32	24-S	29-E	-	220'	NORTH	570'	WEST	EDDY

UL or lot no.	Section	Township	Range	Lot Idn	Feet from the	North/South line	Feet from the	East/West line	County
A	32	24-S	29-E	-	330'	NORTH	240'	EAST	EDDY

<sup>11</sup> Dedicated Acres 320	<sup>12</sup> Joint or Infill	<sup>13</sup> Consolidation Code	<sup>14</sup> Order No.
--------------------------------------	-------------------------------	----------------------------------	-------------------------

No allowable will be assigned to this completion until all interests have been consolidated or a non-standard unit has been approved by the division.

570'

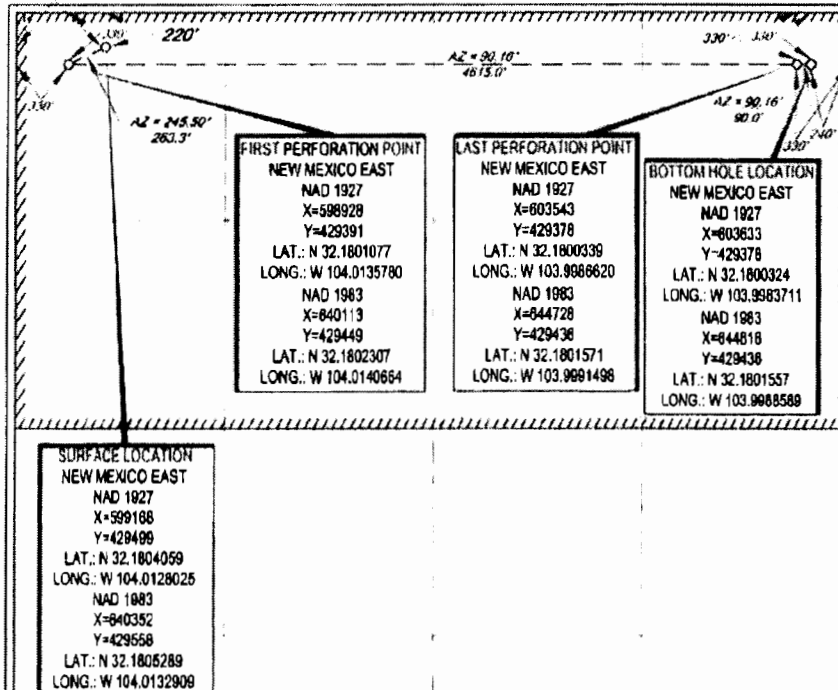

<sup>17</sup>OPERATOR CERTIFICATION

I hereby certify that the information contained herein is true and complete to the best of my knowledge and belief, and that this information reflects a working interest or undivided mineral interest in the land underlying the proposed bottom hole location or has a right to drill this well at this location pursuant to a contract with an owner of such a mineral or working interest, or to a voluntary pooling agreement or a compulsory pooling order heretofore entered by the division.

*Chris Carleton* 3/2/18  
Signature Date

Chris Carleton

Printed Name

ccarleton@matadorresources.com

E-mail Address

<sup>18</sup>SURVEYOR CERTIFICATION

I hereby certify that the well location shown on this plat was plotted from field notes of actual surveys made by me or under my supervision, and that the same is true to the best of my belief.

03/02/2017  
Date of Survey  
Signature  
MICHAEL J. BRUN  
NEW MEXICO  
18329  
PROFESSIONAL SURVEYOR  
Certificate Number

**FESCO, Ltd.**  
**1100 Fesco Ave. - Alice, Texas 78332**

**For:** Matador Production Company  
 One Lincoln Centre  
 5400 LBJ Freeway, Suite 1500  
 Dallas, Texas 75240

**Sample:** Garrett Com No. 201H  
 First Stage Separator  
 Spot Gas Sample @ 557 psig & 124 °F

Date Sampled: 02/08/2018

Job Number: 81463.001

**CHROMATOGRAPH EXTENDED ANALYSIS - GPA 2286**

COMPONENT	MOL%	GPM
Hydrogen Sulfide*	< 0.001	
Nitrogen	0.993	
Carbon Dioxide	0.092	
Methane	78.353	
Ethane	12.371	3.301
Propane	5.258	1.445
Isobutane	0.599	0.196
n-Butane	1.323	0.416
2-2 Dimethylpropane	0.010	0.004
Isopentane	0.240	0.088
n-Pentane	0.277	0.100
Hexanes	0.200	0.082
Heptanes Plus	<u>0.284</u>	<u>0.122</u>
Totals	100.000	5.755

**Computed Real Characteristics Of Heptanes Plus:**

Specific Gravity ----- 3.544 (Air=1)  
 Molecular Weight ----- 102.27  
 Gross Heating Value ----- 5321 BTU/CF

**Computed Real Characteristics Of Total Sample:**

Specific Gravity ----- 0.724 (Air=1)  
 Compressibility (Z) ----- 0.9964  
 Molecular Weight ----- 20.88  
 Gross Heating Value  
   Dry Basis ----- 1252 BTU/CF  
   Saturated Basis ----- 1231 BTU/CF

\*Hydrogen Sulfide tested on location b; Stain Tube Method (GPA 2377)

Results: <0.013 Gr/100 CF, <0.2 PPMV or <0.001 Mol %

Base Conditions: 14.650 PSI & 60 Deg F



Sampled By: (08) McCollum  
 Analyst: NG  
 Processor: NG  
 Cylinder ID: X-0287

Certified: FESCO, Ltd. - Alice, Texas

David Dannhaus 361-661-7015

**CHROMATOGRAPH EXTENDED ANALYSIS - GPA 2286**  
**TOTAL REPORT**

COMPONENT	MOL %	GPM	WT %
Hydrogen Sulfide*	< 0.001		< 0.001
Nitrogen	0.993		1.332
Carbon Dioxide	0.092		0.194
Methane	78.353		60.189
Ethane	12.371	3.301	17.813
Propane	5.258	1.445	11.103
Isobutane	0.599	0.196	1.667
n-Butane	1.323	0.416	3.682
2,2 Dimethylpropane	0.010	0.004	0.035
Isopentane	0.240	0.088	0.829
n-Pentane	0.277	0.100	0.957
2,2 Dimethylbutane	0.004	0.002	0.017
Cyclopentane	0.024	0.010	0.081
2,3 Dimethylbutane	0.000	0.000	0.000
2 Methylpentane	0.060	0.025	0.248
3 Methylpentane	0.032	0.013	0.132
n-Hexane	0.080	0.033	0.330
Methylcyclopentane	0.034	0.012	0.137
Benzene	0.005	0.001	0.019
Cyclohexane	0.037	0.013	0.149
2-Methylhexane	0.010	0.005	0.048
3-Methylhexane	0.011	0.005	0.053
2,2,4 Trimethylpentane	0.000	0.000	0.000
Other C7's	0.029	0.013	0.138
n-Heptane	0.025	0.012	0.120
Methylcyclohexane	0.034	0.014	0.160
Toluene	0.007	0.002	0.031
Other C8's	0.033	0.015	0.174
n-Octane	0.011	0.006	0.060
Ethylbenzene	0.001	0.000	0.005
M & P Xylenes	0.005	0.002	0.025
O-Xylene	0.001	0.000	0.005
Other C9's	0.015	0.008	0.091
n-Nonane	0.005	0.003	0.031
Other C10's	0.009	0.005	0.061
n-Decane	0.005	0.003	0.034
Undecanes (11)	<u>0.007</u>	<u>0.004</u>	<u>0.050</u>
Totals	100.000	5.755	100.000

Computed Real Characteristics of Total Sample

Specific Gravity -----	0.724	(Air=1)
Compressibility (Z) -----	0.9964	
Molecular Weight -----	20.88	
Gross Heating Value		
Dry Basis -----	1252	BTU/CF
Saturated Basis -----	1231	BTU/CF

**FESCO, Ltd.**  
**1100 Fesco Ave. - Alice, Texas 78332**

**Sample:** Garrett Com No. 201H  
 First Stage Separator  
 Spot Gas Sample @ 557 psig & 124 °F

Date Sampled: 02/08/2018

Job Number: 81463.001

**GLYCALC FORMAT**

<b>COMPONENT</b>	<b>MOL%</b>	<b>GPM</b>	<b>Wt %</b>
Carbon Dioxide	0.092		0.194
Hydrogen Sulfide	< 0.001		< 0.001
Nitrogen	0.993		1.332
Methane	78.353		60.189
Ethane	12.371	3.301	17.813
Propane	5.258	1.445	11.103
Isobutane	0.599	0.196	1.667
n-Butane	1.333	0.420	3.717
Isopentane	0.240	0.088	0.829
n-Pentane	0.277	0.100	0.957
Cyclopentane	0.024	0.010	0.081
n-Hexane	0.080	0.033	0.330
Cyclohexane	0.037	0.013	0.149
Other C6's	0.096	0.040	0.397
Heptanes	0.109	0.045	0.496
Methylcyclohexane	0.034	0.014	0.160
2,2,4 Trimethylpentane	0.000	0.000	0.000
Benzene	0.005	0.001	0.019
Toluene	0.007	0.002	0.031
Ethylbenzene	0.001	0.000	0.005
Xylenes	0.006	0.002	0.030
Octanes Plus	<u>0.085</u>	<u>0.044</u>	<u>0.501</u>
Totals	100.000	5.755	100.000

**Real Characteristics Of Octanes Plus:**

Specific Gravity ----- 4.267 (Air=1)  
 Molecular Weight ----- 123.16  
 Gross Heating Value ----- 6424 BTU/CF

**Real Characteristics Of Total Sample:**

Specific Gravity ----- 0.724 (Air=1)  
 Compressibility (Z) ----- 0.9964  
 Molecular Weight ----- 20.88  
 Gross Heating Value  
   Dry Basis ----- 1252 BTU/CF  
   Saturated Basis ----- 1231 BTU/CF

Garrett State Com 121H, et al.

Interested Parties

Company	Address	City	State	Zip
Chisholm Energy Operating, LLC	801 Cherry Street, Suite 1200 – Unit 20	Fort Worth	TX	76102
CML Exploration, LLC	P.O. Box 890	Snyder	TX	79550
Patterson Petroleum LLC c/o CML Exploration, LLC	P.O. Box 890	Snyder	TX	79550
JKS Resources, LLC	1200 W. 4th Street	Roswell	NM	88201
Fred M. Nelson Farms	3755 E. Grand Plains Rd.	Roswell	NM	88203
Exxon Mobil Corporation	810 Houston Street	Fort Worth	TX	76102
Nearburg Producing Company	P.O. Box 823085	Dallas	TX	75382
Nearburg Exploration Company, LLC	P.O. Box 823085	Dallas	TX	75382
Ross Duncan Properties LLC	PO Box 647	Artesia	NM	88211
Big Three Energy Group, LLC	PO Box 429	Roswell	NM	88202
XPLOR Resources, LLC	1104 N. Shore	Carlsbad	NM	88220
American Indian Youth-Running Strong	8815 Telegraph Road	Lorton	VA	22079
Bettis Brothers, LP	500 W. Texas Avenue, Suite 830	Midland	TX	79701
Eau Rouge LLC	801 Cherry Street, Suite 1200 – Unit 20	Fort Worth	TX	76102
EOG Resources Inc.	P.O. Box 2267	Midland	TX	79702
L.E. Oppermann and wife, Nicolette A. Oppermann	1505 Neely	Midland	TX	79705
Morris E. Schertz	P.O. Drawer 2588	Roswell	NM	88201
Rolla R. Hinkle III	P.O. Box 2292	Roswell	NM	88202
Madison M. Hinkle	P.O. Box 2292	Roswell	NM	88202
Thomas R. Smith	1505 S. County Road 1130	Midland	TX	79701
Wells Fargo Bank, NA, Trustee of the John Saleh Charitable Foundation	P.O. Box 1959	Midland	TX	79702





## Shipment Confirmation Acceptance Notice

### A. Mailer Action

**Note to Mailer:** The labels and volume associated to this form online, **must** match the labeled packages being presented to the USPS® employee with this form.

Garrett State Com 121H 201H  
215H 221H - Interested  
Parties MRC Permian  
83379.0001

Shipment Date: 03/21/2018

Shipped From:

Name: HOLLAND & HART LLP

Address: 110 N GUADALUPE ST # 1

City: SANTA FE

State: NM ZIP+4® 87501

Type of Mail	Volume
Priority Mail Express®	
Priority Mail®	0
First-Class Package Service®	
Returns	
International*	
Other	21
Total	21

\*Start time for products with service guarantees will begin when mail arrives at the local Post Office™ and items receive individual processing and acceptance scans.

### B. USPS Action

Note to RSS Clerk:

1. Home screen > Mailing/Shipping > More
2. Select Shipment Confirm
3. Scan or enter the barcode/label number from PS Form 5630
4. Confirm the volume count message by selecting Yes or No
5. Select Pay and End Visit to complete transaction

USPS EMPLOYEE: Please scan upon pickup or receipt of mail.  
Leave form with customer or in customer's mail receptacle.

USPS SCAN AT ACCEPTANCE



9275 0901 1935 6200 0007 6729 19



Firm Mailing Book For Accountable Mail

Name and Address of Sender Holland & Hart LLP 110 N Guadalupe St # 1 Santa Fe NM 87501		Check type of mail or service <input type="checkbox"/> Adult Signature Required <input type="checkbox"/> Adult Signature Restricted Delivery <input checked="" type="checkbox"/> Certified Mail <input type="checkbox"/> Certified Mail Restricted Delivery <input type="checkbox"/> Collect on Delivery (COD) <input type="checkbox"/> Insured Mail <input type="checkbox"/> Priority Mail <input type="checkbox"/> Priority Mail Express <input type="checkbox"/> Registered Mail <input type="checkbox"/> Return Receipt for Merchandise <input type="checkbox"/> Signature Confirmation <input type="checkbox"/> Signature Confirmation Restricted Delivery	
USPS Tracking/Article Number		Addressee (Name, Street, City, State, & ZIP Code™)	
1.	9214 8901 9403 8305 0764 43	Chisholm Energy Operating LLC 801 Cherry Street Suite 1200 ? Unit 20 Fort Worth TX 76102	
2.	9214 8901 9403 8305 0764 50	CML Exploration LLC PO BOX 880 Snyder TX 79550	
3.	9214 8901 9403 8305 0764 67	Patterson Petroleum LLC c/o CML Exploration LLC PO BOX 880 Snyder TX 79550	
4.	9214 8901 9403 8305 0764 74	JKS Resources LLC 1200 W 4th Street Roswell NM 88201	
5.	9214 8901 9403 8305 0764 81	Fred M Nelson Farms 3755 E Grand Plains Rd Roswell NM 88203	
6.	9214 8901 9403 8305 0764 98	Exxon Mobil Corporation 810 Houston Street Fort Worth TX 76102	
7.	9214 8901 9403 8305 0765 04	Nearburg Producing Company PO BOX 823085 Dallas TX 75382	
8.	9214 8901 9403 8305 0765 11	Nearburg Exploration Company LLC PO BOX 823085 Dallas TX 75382	
Total Number of Pieces Listed by Sender 21		Postmaster, Per (Name of receiving employee)	



Firm Mailing Book For Accountable Mail

Name and Address of Sender		Check type of mail or service		Affix Stamp Here (if issued as an international certificate of mailing or for additional copies of this receipt). Postmark with Date of Receipt.												
USPS Tracking/Article Number		Addressee (Name, Street, City, State, & ZIP Code™)		Postage	(Extra Service) Fee	Handling Charge	Actual Value if Registered	Insured Value	Due Sender if COD	ASR Fee	ASRD Fee	RD Fee	RR Fee	SC Fee	SCRD Fee	SH Fee
9.	9214 8901 9403 8305 0765 28	Ros Duncan Properties LLC PO BOX 647 Artesia NM 88211		1.63	3.45								1.50			
10.	9214 8901 9403 8305 0765 35	Big Three Energy Group LLC PO BOX 425 Roswell NM 88202		1.63	3.45								1.50			
11.	9214 8901 9403 8305 0765 42	XPLOR Resources LLC 1104 N Shore Carlsbad NM 88220		1.63	3.45								1.50			
12.	9214 8901 9403 8305 0765 59	American Indian Youth-Running Strong 8815 Telegraph Road Lorton VA 22079		1.63	3.45								1.50			
13.	9214 8901 9403 8305 0765 66	Bettis Brothers LP 500 W Texas Avenue Suite 530 Midland TX 79701		1.63	3.45								1.50			
14.	9214 8901 9403 8305 0765 73	Eau Rouge LLC 801 Cherry Street Suite 1200 7 Unit 20 Fort Worth TX 76102		1.63	3.45								1.50			
15.	9214 8901 9403 8305 0765 80	EOG Resources Inc PO BOX 2267 Midland TX 79702		1.63	3.45								1.50			
16.	9214 8901 9403 8305 0765 97	L E Oppermann and wife Nicolette A Oppermann 1505 Neely Midland TX 79705		1.63	3.45								1.50			
Total Number of Pieces Listed by Sender 21		Total Number of Pieces Received at Post Office		Postmaster, Per (Name of receiving employee)												



Firm Mailing Book For Accountable Mail

Name and Address of Sender Holland & Hart LLP 110 N Guadalupe St # 1 Santa Fe NM 87501		Check type of mail or service <input type="checkbox"/> Adult Signature Required <input type="checkbox"/> Adult Signature Restricted Delivery <input checked="" type="checkbox"/> Certified Mail <input type="checkbox"/> Certified Mail Restricted Delivery <input type="checkbox"/> Collect on Delivery (COD) <input type="checkbox"/> Insured Mail <input type="checkbox"/> Priority Mail <input type="checkbox"/> Priority Mail Express <input type="checkbox"/> Registered Mail <input type="checkbox"/> Return Receipt for Merchandise <input type="checkbox"/> Signature Confirmation <input type="checkbox"/> Signature Confirmation Restricted Delivery		Affix Stamp Here (if issued as an international certificate of mailing or for additional copies of this receipt). Postmark with Date of Receipt.												
USPS Tracking/Article Number		Addressee (Name, Street, City, State, & ZIP Code™)		Postage	(Extra Service) Fee	Handling Charge	Actual Value if Registered	Insured Value	Due Sender if COD	ASR Fee	ASRD Fee	RD Fee	RR Fee	SC Fee	SCRD Fee	SH Fee
17. 9214 8901 9403 8305 0766 03		Morris E Schertz P O Drawer 2588 Roswell NM 86201		1.63	3.45								1.50			
18. 9214 8901 9403 8305 0766 10		Rolla R Hinkle III PO BOX 2292 Roswell NM 86202		1.63	3.45								1.50			
19. 9214 8901 9403 8305 0766 27		Madison M Hinkle PO BOX 2292 Roswell NM 86202		1.63	3.45								1.50			
20. 9214 8901 9403 8305 0766 34		Thomas R Smith 1505 S County Road 1130 Midland TX 79701		1.63	3.45								1.50			
21. 9214 8901 9403 8305 0766 41		Wells Fargo Bank NA Trustee of the John Saleh Charitable Foundation PO BOX 1959 Midland TX 79702		1.63	3.45								1.50			
Total Number of Pieces Listed by Sender 21		Postmaster, Per (Name of receiving employee)														

HOLLAND & HART<sup>LLP</sup>



**Michael H. Feldewert**  
Recognized Specialist in the  
Area of Natural Resources - Oil  
and Gas Law - New Mexico  
Board of Legal Specialization  
mfeldewert@hollandhart.com

March 23, 2018

**CERTIFIED MAIL**  
**RETURN RECEIPT REQUESTED**

**TO: ALL AFFECTED PARTIES**

**Re: Application of Matador Production Company to authorize pool commingling, off-lease storage and off-lease marketing at the Garrett Tank Battery located in the NW/4 NW/4 (Unit D) of Section 32, Township 24 South, Range 29 East, NMPM, Eddy County, New Mexico.**

Ladies and Gentlemen:

Enclosed is a copy of the above-referenced application which was filed with the New Mexico Oil Conservation Division on this date. Any objection to this application must be filed in writing within twenty days from this date at the Division's Santa Fe office located at 1220 South St. Francis Drive, Santa Fe, New Mexico, 87505. If no objection is received within this twenty-day period, this application may be approved administratively by the Division.

If you have any questions about this application, please contact the following:

Sherri Gore  
Matador Production Company  
972-371-5467  
SGore@matadorresources.com

Sincerely,

Michael H. Feldewert  
ATTORNEY FOR  
MATADOR PRODUCTION COMPANY

**Holland & Hart<sup>LLP</sup>**

Phone [505] 988-4421 Fax [505] 983-6043 [www.hollandhart.com](http://www.hollandhart.com)

110 North Guadalupe Suite 1 Santa Fe, New Mexico 87501 Mailing Address P.O. Box 2208 Santa Fe, NM 87504-2208

Aspen Boulder Carson City Colorado Springs Denver Denver Tech Center Billings Boise Cheyenne Jackson Hole Las Vegas Reno Salt Lake City Santa Fe Washington, D.C. ☏

HOLLAND & HART<sup>LLP</sup>



**Michael H. Feldewert**  
Recognized Specialist in the  
Area of Natural Resources - Oil  
and Gas Law - New Mexico  
Board of Legal Specialization  
mfeldewert@hollandhart.com

March 23, 2018

Marilyn Gruebel  
New Mexico State Land Office  
P.O. Box 1148  
Santa Fe, NM 87504-1148

**Re: Application of Matador Production Company to authorize pool commingling, off-lease storage and off-lease marketing at the Garrett Tank Battery located in the NW/4 NW/4 (Unit D) of Section 32, Township 24 South, Range 29 East, NMPM, Eddy County, New Mexico.**

Dear Ms. Gruebel:

Enclosed is a copy of the above-referenced administrative application which was filed with the New Mexico Oil Conservation Division on this date. Any objection to this application must be filed in writing within twenty days from this date at the Division's Santa Fe office located at 1220 South St. Francis Drive, Santa Fe, New Mexico, 87505. If no objection is received within this twenty-day period, this application may be approved administratively by the Division.

Also enclosed is a fully completed and signed Application for Commingling and Off-Lease Storage for state trust lands along with a check from my office for the \$150 filing fee.

If you have any questions about this application, please contact the following:

Sherri Gore  
Matador Production Company  
972-371-5467  
SGore@matadorresources.com

Sincerely,

Michael H. Feldewert  
**ATTORNEY FOR**  
**MATADOR PRODUCTION COMPANY**

**Holland & Hart<sup>LLP</sup>**

Phone [505] 988-4421 Fax [505] 983-6043 [www.hollandhart.com](http://www.hollandhart.com)

110 North Guadalupe Suite 1 Santa Fe, New Mexico 87501 Mailing Address P.O. Box 2208 Santa Fe, NM 87504-2208

Aspen Boulder Carson City Colorado Springs Denver Denver Tech Center Billings Boise Cheyenne Jackson Hole Las Vegas Reno Salt Lake City Santa Fe Washington, D.C. ☺

**NEW MEXICO  
STATE  
LAND OFFICE**

**APPLICATION FOR  
COMMINGLING AND OFF-LEASE STORAGE  
ON STATE TRUST LANDS**



This application form is required for all commingling applications requiring approval by the Commissioner of Public Lands.

**Applicant:** Matador Production Company **OGRID #:** 228937  
**Well Name:** GARRETT STATE COM #221H, #215H, #201H, #121H **API #:** See Attached  
**Pool:** Purple Sage; Wolfcamp (GAS) & Willow Lake; Bone Spring

**OPERATOR NAME:** Matador Production Company  
**OPERATOR ADDRESS:** 5400 LBJ Freeway, STE 1500, Dallas, TX 75240

**APPLICATION REQUIREMENTS – SUBMIT:**

1. New Mexico Oil Conservation Division (NMOCD) application packet (or equivalent information if no application is required by NMOCD),
2. Commingling application fee of \$150.

**CERTIFICATION:** To the best of my knowledge,

- All business leases and rights-of-way necessary for conducting the proposed operation on State Trust lands have been applied for or obtained,
- The information submitted with this application is **accurate** and **complete**, and
- No loss will accrue to the state of New Mexico as a result of the proposed operation.

I also understand that **no action** will be taken on this application until the required information and fee are submitted to the State Land Office.

**Note: Statement must be completed by an individual with managerial and/or supervisory capacity.**

Sherri Gore

Print or Type Name

Sherri Gore  
Signature

3/15/18  
Date

972-371-5467  
Phone Number

sgore@matadorresources.com  
e-mail Address

**Submit application to:**  
Commissioner of Public Lands  
Attn: Commingling Manager  
PO Box 1148  
Santa Fe, NM 87504-1148

Questions?  
Contact the Commingling Manager:  
505.827.5791

Upon approval, the requesting organization will receive an acknowledgment letter from the Commissioner of Public Lands.