

RECEIVED: 07/24/2018	REVIEWER: MAM	TYPE: CTB	APP NO: PMAM1818353917
-------------------------	------------------	--------------	---------------------------

ABOVE THIS TABLE FOR OCD DIVISION USE ONLY

NEW MEXICO OIL CONSERVATION DIVISION
 - Geological & Engineering Bureau -
 1220 South St. Francis Drive, Santa Fe, NM 87505

**ADMINISTRATIVE APPLICATION CHECKLIST**

THIS CHECKLIST IS MANDATORY FOR ALL ADMINISTRATIVE APPLICATIONS FOR EXCEPTIONS TO DIVISION RULES AND
 REGULATIONS WHICH REQUIRE PROCESSING AT THE DIVISION LEVEL IN SANTA FE

Applicant: Mack Energy Corporation **OGRID Number:** 013837
Well Name: Multiple **API:** Multiple
Pool: Round Tank; San Andres **Pool Code:** 52770

**SUBMIT ACCURATE AND COMPLETE INFORMATION REQUIRED TO PROCESS THE TYPE OF APPLICATION
 INDICATED BELOW**

1) TYPE OF APPLICATION: Check those which apply for [A]

A. Location - Spacing Unit - Simultaneous Dedication

☐ NSL ☐ NSP(PROJECT AREA) ☐ NSP(PORATION UNIT) ☐ SD

B. Check one only for [I] or [II]

[I] Commingling - Storage - Measurement

☐ DHC ☒ CTB ☐ PLC ☐ PC ☐ OLS ☐ OLM

[II] Injection - Disposal - Pressure Increase - Enhanced Oil Recovery

☐ WFX ☐ PMX ☐ SWD ☐ IFI ☐ EOR ☐ PPR

2) NOTIFICATION REQUIRED TO: Check those which apply.

- A. ☐ Offset operators or lease holders
 B. ☒ Royalty, overriding royalty owners, revenue owners
 C. ☐ Application requires published notice
 D. ☒ Notification and/or concurrent approval by SLO
 E. ☒ Notification and/or concurrent approval by BLM
 F. ☐ Surface owner
 G. ☒ For all of the above, proof of notification or publication is attached, and/or,
 H. ☐ No notice required

FOR OCD ONLY

- ☐ Notice Complete
☐ Application
 Content
 Complete

3) CERTIFICATION: I hereby certify that the information submitted with this application for administrative approval is **accurate and complete** to the best of my knowledge. I also understand that **no action** will be taken on this application until the required information and notifications are submitted to the Division.

Note: Statement must be completed by an individual with managerial and/or supervisory capacity.

Jerry W. Sherrell
 Print or Type Name

Jerry W. Sherrell
 Signature

6/25/2018
 Date

575-748-1288
 Phone Number

jerrys@mec.com
 e-mail Address



P.O. Box 960
Artesia, NM 88211-0960
Office (575) 748-1288
Fax (575) 746-9539

June 25, 2018

*Oil Conservation Division
Attn: Michael A. McMillan
1220 S. St. Francis Drive
Santa Fe, NM 87505*

Re: Application of Mack Energy Corporation for administrative approval for Central Tank Battery and Off Lease Measurement of oil and gas production at a CTB Facility located in Section 35, Township 15S Range 28E, NMPM, Chaves County, New Mexico.

Dear Sir:

Mack Energy Corporation (OGRID 013837) seeks administrative approval for a Central Tank Battery/Off Lease Measurement Facility to surface commingle oil and gas production from the Round Tank; San Andres Pool (Pool Code 52770) for the attached list of existing and future wells and leases drilled within the mentioned areas of diverse ownership in Sections 25, 26 and 36 T15S R28E.

Pursuant to NMAC 19.15.12.7, approved spacing units with diverse ownership are considered separate leases for surface commingling purposes. Mack Energy is requesting approval to surface commingle production according to the provisions of NMAC 19.15.12.10.C from all existing and future wells in these separate areas of diverse ownership at the Ajax CTB in Unit A, Sec. 35 T15S R28E. Pursuant to 19.15.12.10(C)(4)(g), Mack Energy requests authority to produce future leases with notice provided to only the interest owners of the future wells on these leases. Each well will be tested through a test production train, located at this facility. Oil and Gas production will be measured using test meters and 7 day test cycles.

The gas production will be measured at this CTB, and then transported by pipeline to the central sales point located off lease in Unit O, Section 4-T16S-R29E, Chaves County.

Oil produced from the Ajax State Com 1H Red Deer Federal Com 2H will be measured and sold from the Ajax CTB located in Unit A, Sec 35 T15S R28E.

Exhibit 1 is a land map showing Mack's current and proposed development in the subject area.

Exhibit 2 is a completed Application for Surface Commingling(Diverse Ownership) and Off-Lease Measurement Form C107B.

Exhibit 3 is a list of all lands associated with this commingling application.

Exhibit 4 is a C-102 for each well both existing and proposed within the project area.

Exhibit 5 is a facility diagram for this CTB.

Exhibit 6 is a list of the interests affected by this request for approval of a CTB Facility. A copy of this application with all attachments has been sent by certified mail to all affected parties advising them that if they have an objection they must file it in writing with the division within 20 of the date the division receives Mack's application.

Your attention to this matter is greatly appreciated.

Sincerely,

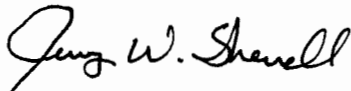
A handwritten signature in cursive script that reads "Jerry W. Sherrell".

Jerry W. Sherrell
Production Clerk
jerrys@mec.com







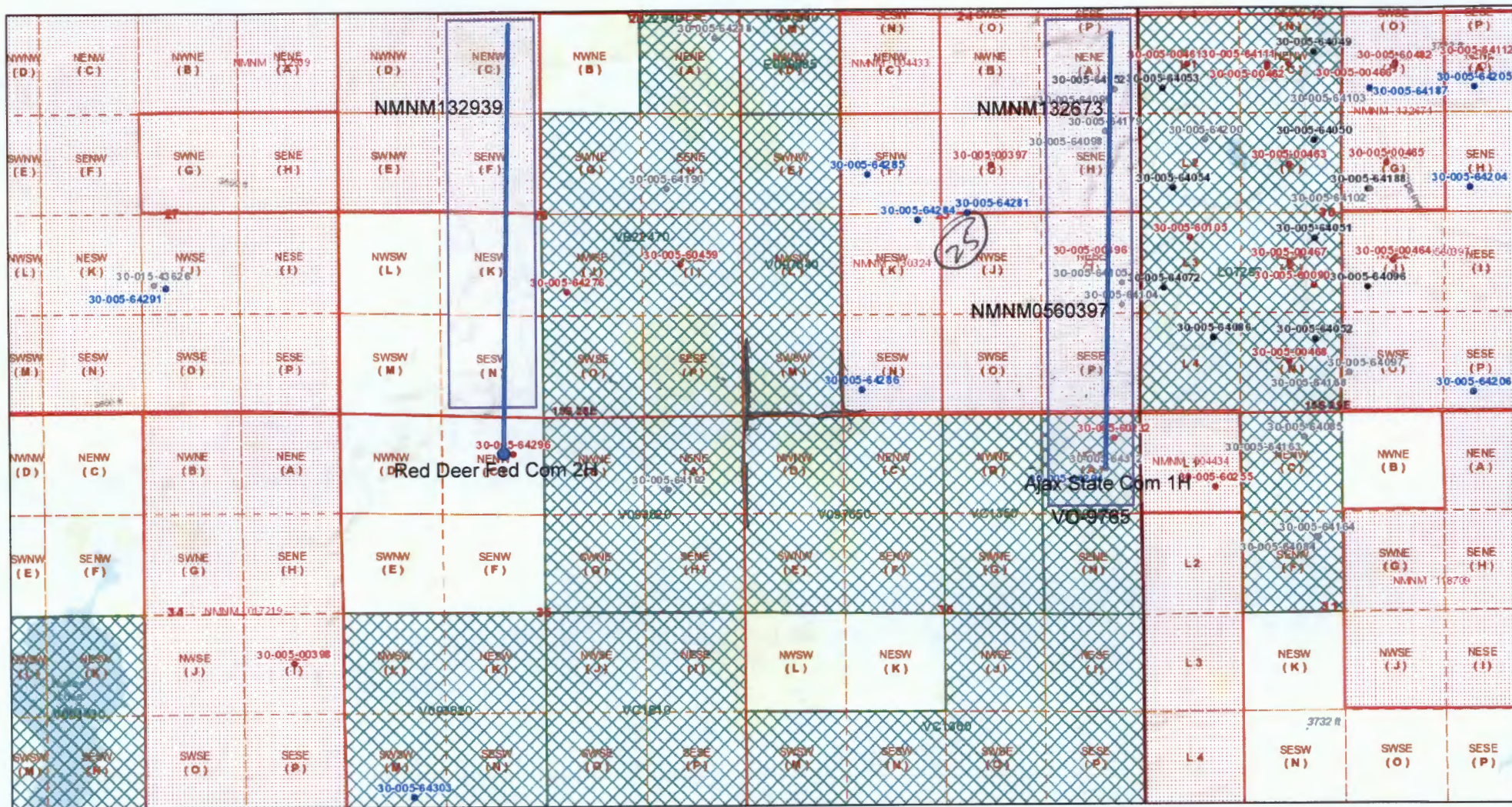



JWS/

Enclosures

OCD Well Locations



6/12/2018 12:42:56 PM

-  Override 1
 Plugged
Areas
 Override 1
 Cancelled
 Override 2
 Temporarily Abandoned
Well Locations - Small Scale
 Active
 New
Well Locations - Large Scale
 Miscellaneous
 CO2 Active

1:18,056

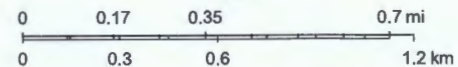

Texas Parks & Wildlife, Esri, HERE, Garmin, INCREMENT P, USGS, METI/NASA, EPA, USDA, OCD, BLM

NM OCD Oil and Gas Map. <http://nm-emnrd.maps.arcgis.com/apps/webappviewer/>

District I
1625 N. French Drive, Hobbs, NM 88240
District II
811 S. First St., Artesia, NM 88210
District III
1000 Rio Brazos Road, Aztec, NM 87410
District IV
1220 S. St Francis Dr, Santa Fe, NM
87505

State of New Mexico
Energy, Minerals and Natural Resources Department

Form C-107-B
Revised August 1, 2011

OIL CONSERVATION DIVISION
1220 S. St Francis Drive
Santa Fe, New Mexico 87505

Submit the original
application to the Santa Fe
office with one copy to the
appropriate District Office.

APPLICATION FOR SURFACE COMMINGLING (DIVERSE OWNERSHIP)

OPERATOR NAME: MACK ENERGY CORPORATION
OPERATOR ADDRESS: PO BOX 960 ARTESIA, NM 88211-0960
APPLICATION TYPE:

☐ Pool Commingling ☒ Lease Commingling ☐ Pool and Lease Commingling ☐ Off-Lease Storage and Measurement (Only if not Surface Commingled)

LEASE TYPE: ☐ Fee ☒ State ☒ Federal

Is this an Amendment to existing Order? ☐ Yes ☒ No If "Yes", please include the appropriate Order No. _____
Have the Bureau of Land Management (BLM) and State Land office (SLO) been notified in writing of the proposed commingling
X Yes ☐ No

(A) POOL COMMINGLING

Please attach sheets with the following information

(1) Pool Names and Codes	Gravities / BTU of Non-Commingled Production	Calculated Gravities / BTU of Commingled Production		Calculated Value of Commingled Production	Volumes

- (2) Are any wells producing at top allowables? ☐ Yes ☐ No
(3) Has all interest owners been notified by certified mail of the proposed commingling? ☐ Yes ☐ No.
(4) Measurement type: ☐ Metering ☐ Other (Specify)
(5) Will commingling decrease the value of production? ☐ Yes ☐ No If "yes", describe why commingling should be approved

(B) LEASE COMMINGLING

Please attach sheets with the following information

- (1) Pool Name and Code. ROUND TANK; SAN ANDRES (52770)
(2) Is all production from same source of supply? ☒ Yes ☐ No
(3) Has all interest owners been notified by certified mail of the proposed commingling? ☒ Yes ☐ No
(4) Measurement type: ☐ Metering ☒ Other (Specify) 7 day test intervals, using test equipment.

(C) POOL and LEASE COMMINGLING

Please attach sheets with the following information

- (1) Complete Sections A and E.

(D) OFF-LEASE STORAGE and MEASUREMENT

Please attached sheets with the following information

- (1) Is all production from same source of supply? ☐ Yes ☐ No
(2) Include proof of notice to all interest owners.

(E) ADDITIONAL INFORMATION (for all application types)

Please attach sheets with the following information

- (1) A schematic diagram of facility, including legal location.
(2) A plat with lease boundaries showing all well and facility locations. Include lease numbers if Federal or State lands are involved.
(3) Lease Names, Lease and Well Numbers, and API Numbers.

I hereby certify that the information above is true and complete to the best of my knowledge and belief.

SIGNATURE: Jerry W. Sherrell

TITLE: PRODUCTION CLERK

DATE: 6/25/2012

TYPE OR PRINT NAME Jerry W. Sherrell

TELEPHONE NO.: 575-748-1288

E-MAIL ADDRESS: jerrys@mec.com

Lands for Ajax CTB

T15S R28E

Sec. 36 N/2 Leases: VO-9785, VO-1350

Sec. 25 All but NWNW Leases: NMNM0560397, NMNM132673, NMNM130324, NMNM004433,
VO-9764

Sec. 26 W/2 Leases: Fee Lease, NMNM132939

District I
1625 N. French Dr., Hobbs, NM 88240
Phone (575) 393-6161 Fax (575) 393-0720
District II
811 S. East St., Artesia, NM 88210
Phone (575) 748-1253 Fax (575) 748-4720
District III
1000 Rio Brazos Road, Aztec, NM 87410
Phone (505) 334-6178 Fax (505) 334-6170
District IV
1220 S. St. Francis Dr., Santa Fe, NM 87505
Phone (505) 476-3460 Fax (505) 476-3462

State of New Mexico
Energy, Minerals & Natural Resources Department
OIL CONSERVATION DIVISION
1220 South St. Francis Dr.
Santa Fe, NM 87505

Form C-102
Revised August 1, 2011
Submit one copy to appropriate
District Office

☐ AMENDED REPORT

WELL LOCATION AND ACREAGE DEDICATION PLAT

¹ API Number 30-005-64294	² Pool Code 52770	³ Pool Name Round Tank; San Andres
⁴ Property Code 321286	⁵ Property Name AJAX STATE COM	
⁶ OGRID No. 13837	⁷ Operator Name MACK ENERGY CORPORATION	
		⁸ Well Number 1H
		⁹ Elevation 3649.8

" Surface Location

UL or lot no.	Section	Township	Range	Lot Idn	Feet from the	North/South line	Feet from the	East/West line	County
A	36	15 S	28 E		736	NORTH	464	EAST	CHAVES

" Bottom Hole Location If Different From Surface

UL or lot no.	Section	Township	Range	Lot Idn	Feet from the	North/South line	Feet from the	East/ West line	County
A	25	15 S	28 E		5	NORTH	355	EAST	CHAVES

¹² Dedicated Acres	¹³ Joint or Infill	¹⁴ Consolidation Code	¹⁵ Order No.
200			

No allowable will be assigned to this completion until all interests have been consolidated or a non-standard unit has been approved by the division.

<p>NW CORNER SEC. 25 LAT. = 32.9942570N LONG. = 104.0938829W NWSP EAST (FT) N = 725530.56 E = 614752.22</p> <p>W O CORNER SEC. 25 LAT. = 32.9863876N LONG. = 104.0938863W NWSP EAST (FT) N = 722865.75 E = 614763.15</p> <p>NW CORNER SEC. 36 LAT. = 32.9797168N LONG. = 104.0938364W NWSP EAST (FT) N = 720240.47 E = 614777.92</p> <p>W O CORNER SEC. 36 LAT. = 32.9725723N LONG. = 104.0938200W NWSP EAST (FT) N = 717641.13 E = 614769.47</p> <p>SW CORNER SEC. 36 LAT. = 32.9654174N LONG. = 104.0937949W NWSP EAST (FT) N = 715038.00 E = 614603.13</p>		<p>589 33'59"E 2637.60 FT</p> <p>589 33'59"E 2637.60 FT</p> <p>LAST TAKE POINT 100' PNL 358' FEL LAT. = 32.9938481N LONG. = 104.0778458W NWSP EAST (FT) N = 725393.34 E = 612669.53</p> <p>BOTTOM OF HOLE LAT. = 32.99410911N LONG. = 104.0778400W NWSP EAST (FT) N = 725488.33 E = 619571.18</p> <p>NOTE: LATITUDE AND LONGITUDE COORDINATES ARE SHOWN USING THE NORTH AMERICAN DATUM OF 1983 (NAD83) LISTED NEW MEXICO STATE PLANE EAST COORDINATES ARE GRID (UNADJ.) BASIS OF BEARINGS AND DISTANCES USED ARE NEW MEXICO STATE PLANE EAST COORDINATES MODIFIED TO THE SURFACE. VERTICAL DATUM HAVORS</p> <p>589 44'34"E 2628.21 FT</p> <p>N O CORNER SEC. 36 LAT. = 32.9797375N LONG. = 104.0852699W NWSP EAST (FT) N = 720252.26 E = 617405.42</p> <p>FIRST TAKE POINT 89' PNL 447' FEL LAT. = 32.9785103N LONG. = 104.0781531W NWSP EAST (FT) N = 720176.65 E = 619287.67</p> <p>W O CORNER SEC. 36 LAT. = 32.9654152N LONG. = 104.0851896W NWSP EAST (FT) N = 715043.31 E = 617442.53</p> <p>589 53'06"W 2640.18 FT</p> <p>589 50'28"W 2646.03 FT</p>		<p>N00 53'44"E 95.00 FT</p> <p>NE CORNER SEC. 25 LAT. = 32.9941131N LONG. = 104.0766827W NWSP EAST (FT) N = 725490.64 E = 620025.90</p> <p>E O CORNER SEC. 25 LAT. = 32.9869217N LONG. = 104.0765398W NWSP EAST (FT) N = 722892.47 E = 620063.79</p> <p>NE CORNER SEC. 36 LAT. = 32.9797298N LONG. = 104.0766964W NWSP EAST (FT) N = 720257.54 E = 620034.47</p> <p>N00 53'44"E 655.73 FT</p> <p>UNF</p> <p>SE CORNER SEC. 36 LAT. = 32.9653776N LONG. = 104.0765635W NWSP EAST (FT) N = 715035.98 E = 620087.96</p>		<p>" OPERATOR CERTIFICATION</p> <p>I hereby certify that the information contained herein is true and complete to the best of my knowledge and belief, and that this organization either owns a working interest or undivided mineral interest in the land including the proposed bottom hole location or has a right to drill this well at this location pursuant to a contract with an owner of such a mineral or working interest, or to a voluntary pooling agreement or a compulsory pooling order heretofore entered by the division.</p> <p><i>Deana Weaver</i> 4.26.18 Signature Date</p> <p>Deana Weaver Printed Name</p> <p>dweaver@mec.com E-mail Address</p> <p>"SURVEYOR CERTIFICATION</p> <p>I hereby certify that the well location shown on this plat was plotted from field notes of actual surveys made by me or under my supervision, and that the same is true and correct to the best of my belief.</p> <p>APRIL 6, 2018 Date of Survey</p> <p><i>F. Jaramillo</i> Signature of Licensed Professional Surveyor</p> <p>Certificate Number: 12797 SURVEY NO. 4782C</p>
---	--	---	--	--	--	--

District I
1625 N. French Dr., Hobbs, NM 88240
Phone (575) 393-6161 Fax (575) 393-0720
District II
811 S. First St., Artesia, NM 88210
Phone (575) 748-1283 Fax (575) 748-9720
District III
1000 Ray Braggs Road, Aztec, NM 87410
Phone (505) 334-6178 Fax (505) 334-6170
District IV
1220 S. St. Francis Dr., Santa Fe, NM 87505
Phone (505) 476-3460 Fax (505) 476-3462

State of New Mexico
Energy, Minerals & Natural Resources Department
OIL CONSERVATION DIVISION
1220 South St. Francis Dr.
Santa Fe, NM 87505

Form C-102
Revised August 1, 2011
Submit one copy to appropriate
District Office

☐ AMENDED REPORT

WELL LOCATION AND ACREAGE DEDICATION PLAT

1 API Number		2 Pool Code 52770		3 Pool Name Round Tank; San Andres	
4 Property Code		5 Property Name RED DEER FEDERAL COM			6 Well Number 2H
7 OGRID No. 13837		8 Operator Name MACK ENERGY CORPORATION			9 Elevation 3577.7

10 Surface Location

11 U. or lot no.	Section	Township	Range	Lot Idn	Feet from the	North/South line	Feet from the	East/West line	County
C	35	15 S	28 E		500	NORTH	2265	WEST	CHAVES

12 Bottom Hole Location If Different From Surface

11 U. or lot no.	Section	Township	Range	Lot Idn	Feet from the	North/South line	Feet from the	East/ West line	County
C	26	15 S	28 E		5	NORTH	2285	WEST	CHAVES

13 Dedicated Acres 160	14 Joint or Infill	15 Consolidation Code	16 Order No.
---------------------------	--------------------	-----------------------	--------------

No allowable will be assigned to this completion until all interests have been consolidated or a non-standard unit has been approved by the division.

<p>17 OPERATOR CERTIFICATION I hereby certify that the information contained herein is true and complete to the best of my knowledge and belief, and that this organization either owns a working interest or undivided mineral interest in the land including the proposed bottom hole location or has a right to drill this well at this location pursuant to a contract with an owner of such a mineral or working interest, or to a voluntary pooling agreement or a compulsory pooling order heretofore entered by the division.</p> <p>Signature: <u>Deana Weaver</u> Date: <u>5.15.18</u></p> <p>Printed Name: <u>Deana Weaver</u></p> <p>E-mail Address: <u>dweaver@mec.com</u></p>		<p>18 SURVEYOR CERTIFICATION I hereby certify that the well location shown on this plat was plotted from field notes of actual surveys made by me or under my supervision, and that the same is true and correct to the best of my belief.</p> <p>APR 18 2018</p> <p>Date of Survey: <u>APR 18 2018</u></p> <p>Signature and Seal of Professional Surveyor: <u>[Signature]</u></p> <p>Certificate Number: <u>HEIMON E. JARAMILLO, PLS 12797</u></p> <p>SURVEY NO. <u>5878A</u></p>	
--	--	---	--

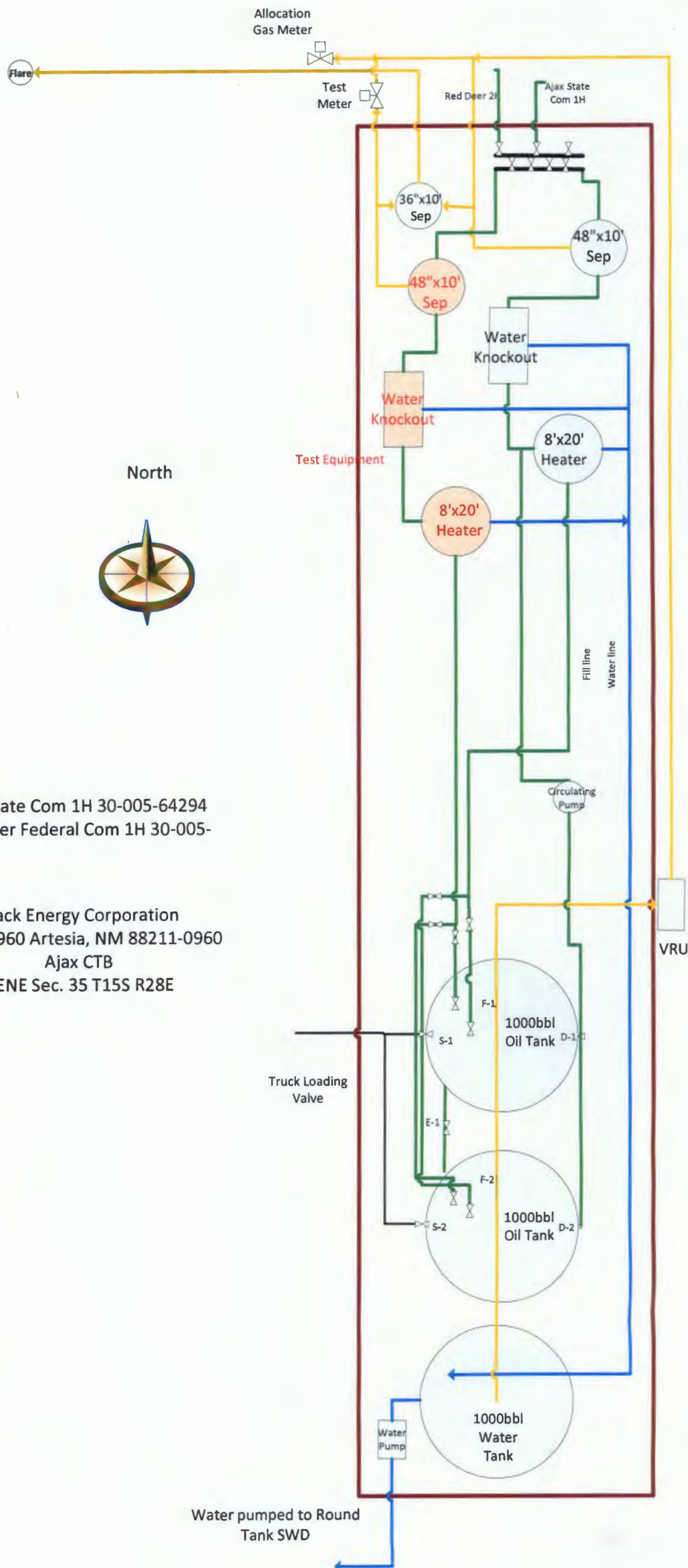

Ajax State Com 1H 30-005-64294
 Red Deer Federal Com 1H 30-005-

Mack Energy Corporation
 PO Box 960 Artesia, NM 88211-0960
 Ajax CTB
 NENE Sec. 35 T15S R28E

Sales Phase

Tank 1	Tank 2
F-1 Closed	F-1 Open
F-2 Open	F-2 Closed
E-1 Closed	E-1 Closed
D-1 Closed	D-1 Open
D-2 Open	D-2 Closed
S-1 Open	S-1 Closed
S-2 Closed	S-2 Open

Production Phase

Tank 1	Tank 2
F-1 Open	F-1 Closed
F-2 Closed	F-2 Open
E-1 Open	E-1 Open
D-1 Open	D-1 Closed
D-2 Closed	D-2 Open
S-1 Closed	S-1 Closed
S-2 Closed	S-2 Closed

Re: Application of Mack Energy Corporation for administrative approval for Central Tank Battery and Off Lease Measurement of oil and gas production at a CTB Facility located in Section 35, Township 15S Range 28E, NMPM, Chaves County, New Mexico.

List of Affected Parties

Sendero Energy LLC

Katz Resources LLC

M Squared Energy LLC

Chase Oil Corp

Robert C Chase

Broken Arrow Royalties LLC

Ventana Minerals LLC

DiaKan Minerals LLC

Bureau of Land Management

New Mexico State Land Office

Armstrong Energy Corporation

Slash Exploration LP

Chimney Rock Oil & Gas, LLC

Mossman-Midwest Co.

Bogle Ltd. Co.

Trustees of Dartmouth College

SIGNATURE PAGE

Re: Application of Mack Energy Corporation for administrative approval for Central Tank Battery and Off Lease Measurement of oil and gas production at a CTB Facility located in Section 35, Township 15S Range 28E, NMPM, Chaves County, New Mexico.

SENDERO ENERGY LLC

By: 
Matt Brewer, Managing Member

Date: 6/26/18

KATZ RESOURCES LLC

By: 
Charles Sadler, Managing Member

Date: 6/26/18

M SQUARED ENERGY LLC

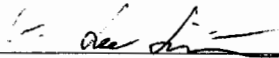
By: 
W. Lee Livingston, Managing Member

Date: 6/25/2018



P.O. Box 960
Artesia, NM 88211-0960
Office (575) 748-1288
Fax (575) 746-9539

June 25, 2018

VIA CERTIFIED MAIL 7015 0640 0006 7024 4172

Armstrong Energy Corporation
PO Box 1973
Roswell, NM 88202

Dear Sir:

Mack Energy Corporation is requesting administrative approval from the NMOCD for approval of CTB/Surface Commingling of Oil and Gas production at a CTB Facility located in the NENE, Sec. 35 T15S R28E. Lands and wells associated with this application include N/2 Sec. 36 T15S R28E, Sec. 25 T15S R28E all but NWNW, W/2 Sec. 26 T15S R28E. Production from these lands will be measured, stored and sold from the CTB location. Gas production will be transported through an approved pipeline to a sales point on DCP's gathering system in Unit N, Sec. 19 T15S R29E, governed under CTB-855.

Enclosed is a copy of this application which was filed with the New Mexico Oil Conservation Division on this date. Any objection to this application must be filed in writing within twenty days from this date at the Division's Santa Fe office located at 1220 South St. Francis Drive, Santa Fe, New Mexico, 87505. If no objection has been made within the 20 days period, this application may be approved administratively by the Division.

Should you have any questions please contact me @ 575-748-1288.

Sincerely,

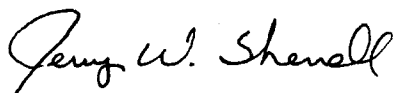
Jerry W. Sherrell
Production Clerk
jerrys@mec.com

JWS/

Enclosures



P.O. Box 960
Artesia, NM 88211-0960
Office (575) 748-1288
Fax (575) 746-9539

June 25, 2018

VIA CERTIFIED MAIL 7015 0640 0006 7024 4134

*Bogle Ltd. Company
PO Box 460
Dexter, NM 88230*

Dear Sir:

Mack Energy Corporation is requesting administrative approval from the NMOCD for approval of CTB/Surface Commingling of Oil and Gas production at a CTB Facility located in the NENE, Sec. 35 T15S R28E. Lands and wells associated with this application include N/2 Sec. 36 T15S R28E, Sec. 25 T15S R28E all but NWNW, W/2 Sec. 26 T15S R28E. Production from these lands will be measured, stored and sold from the CTB location. Gas production will be transported through an approved pipeline to a sales point on DCP's gathering system in Unit N, Sec. 19 T15S R29E, governed under CTB-855.

Enclosed is a copy of this application which was filed with the New Mexico Oil Conservation Division on this date. Any objection to this application must be filed in writing within twenty days from this date at the Division's Santa Fe office located at 1220 South St. Francis Drive, Santa Fe, New Mexico, 87505. If no objection has been made within the 20 days period, this application may be approved administratively by the Division.

Should you have any questions please contact me @ 575-748-1288.

Sincerely,

Jerry W. Sherrell
Production Clerk
jerrys@mec.com

JWS/

Enclosures



P.O. Box 960
Artesia, NM 88211-0960
Office (575) 748-1288
Fax (575) 746-9539

June 25, 2018

VIA CERTIFIED MAIL 7015 0640 0006 7024 4196

*Bureau of Land Management
2909 West 2nd Street
Roswell, NM 88202-2909*

Dear Sir:

Mack Energy Corporation is requesting administrative approval from the NMOCD for approval of CTB/Surface Commingling of Oil and Gas production at a CTB Facility located in the NENE, Sec. 35 T15S R28E. Lands and wells associated with this application include N/2 Sec. 36 T15S R28E, Sec. 25 T15S R28E all but NWNW, W/2 Sec. 26 T15S R28E. Production from these lands will be measured, stored and sold from the CTB location. Gas production will be transported through an approved pipeline to a sales point on DCP's gathering system in Unit N, Sec. 19 T15S R29E, governed under CTB-855.

Enclosed is a copy of this application which was filed with the New Mexico Oil Conservation Division on this date. Any objection to this application must be filed in writing within twenty days from this date at the Division's Santa Fe office located at 1220 South St. Francis Drive, Santa Fe, New Mexico, 87505. If no objection has been made within the 20 days period, this application may be approved administratively by the Division.

Should you have any questions please contact me @ 575-748-1288.

Sincerely,

Jerry W. Sherrell
Production Clerk
jerrys@mec.com

JWS/

Enclosures



P.O. Box 960
Artesia, NM 88211-0960
Office (575) 748-1288
Fax (575) 746-9550

June 25, 2018

VIA CERTIFIED MAIL 7015 0640 0006 7024 4165

Chimney Rock Oil & Gas, LLC
PO Box 1973
Roswell, NM 88202

Dear Sir:

Mack Energy Corporation is requesting administrative approval from the NMOCD for approval of CTB/Surface Commingling of Oil and Gas production at a CTB Facility located in the NENE, Sec. 35 T15S R28E. Lands and wells associated with this application include N/2 Sec. 36 T15S R28E, Sec. 25 T15S R28E all but NWNW, W/2 Sec. 26 T15S R28E. Production from these lands will be measured, stored and sold from the CTB location. Gas production will be transported through an approved pipeline to a sales point on DCP's gathering system in Unit N, Sec. 19 T15S R29E, governed under CTB-855.

Enclosed is a copy of this application which was filed with the New Mexico Oil Conservation Division on this date. Any objection to this application must be filed in writing within twenty days from this date at the Division's Santa Fe office located at 1220 South St. Francis Drive, Santa Fe, New Mexico, 87505. If no objection has been made within the 20 days period, this application may be approved administratively by the Division.

Should you have any questions please contact me @ 575-748-1288.

Sincerely,

Jerry W. Sherrell
Production Clerk
jerrys@mec.com

JWS/

Enclosures



P.O. Box 960
Artesia, NM 88211-0960
Office (575) 748-1288
Fax (575) 746-9539

June 25, 2018

VIA CERTIFIED MAIL 7015 0640 0006 7024 4189

*Commissioner of Public Lands
PO Box 1148
Santa Fe, NM 87504-1148*

Dear Sir:

Mack Energy Corporation is requesting administrative approval from the NMOCD for approval of CTB/Surface Commingling of Oil and Gas production at a CTB Facility located in the NENE, Sec. 35 T15S R28E. Lands and wells associated with this application include N/2 Sec. 36 T15S R28E, Sec. 25 T15S R28E all but NWNW, W/2 Sec. 26 T15S R28E. Production from these lands will be measured, stored and sold from the CTB location. Gas production will be transported through an approved pipeline to a sales point on DCP's gathering system in Unit N, Sec. 19 T15S R29E, governed under CTB-855.

Enclosed is a copy of this application which was filed with the New Mexico Oil Conservation Division on this date. Any objection to this application must be filed in writing within twenty days from this date at the Division's Santa Fe office located at 1220 South St. Francis Drive, Santa Fe, New Mexico, 87505. If no objection has been made within the 20 days period, this application may be approved administratively by the Division.

Should you have any questions please contact me @ 575-748-1288.

Sincerely,

Jerry W. Sherrell
Production Clerk
jerrys@mec.com

JWS/

Enclosures



P.O. Box 960
Artesia, NM 88211-0960
Office (575) 748-1288
Fax (575) 746-9539

June 25, 2018

VIA CERTIFIED MAIL 7015 0640 0006 7024 4158

Mossman-Midwest Company
PO Box 597
Roswell, NM 88202

Dear Sir:

Mack Energy Corporation is requesting administrative approval from the NMOCD for approval of CTB/Surface Commingling of Oil and Gas production at a CTB Facility located in the NENE, Sec. 35 T15S R28E. Lands and wells associated with this application include N/2 Sec. 36 T15S R28E, Sec. 25 T15S R28Eall but NWNW, W/2 Sec. 26 T15S R28E. Production from these lands will be measured, stored and sold from the CTB location. Gas production will be transported through an approved pipeline to a sales point on DCP's gathering system in Unit N, Sec. 19 T15S R29E, governed under CTB-855.

Enclosed is a copy of this application which was filed with the New Mexico Oil Conservation Division on this date. Any objection to this application must be filed in writing within twenty days from this date at the Division's Santa Fe office located at 1220 South St. Francis Drive, Santa Fe, New Mexico, 87505. If no objection has been made within the 20 days period, this application may be approved administratively by the Division.

Should you have any questions please contact me @ 575-748-1288.

Sincerely,

Jerry W. Sherrell
Production Clerk
jerrys@mec.com

JWS/

Enclosures



P.O. Box 960
Artesia, NM 88211-0960
Office (575) 748-1288
Fax (575) 740-9559

June 25, 2018

VIA CERTIFIED MAIL 7015 0640 0006 7024 4202

Slash Exploration LP
PO Box 1973
Roswell, NM 88202

Dear Sir:

Mack Energy Corporation is requesting administrative approval from the NMOCD for approval of CTB/Surface Commingling of Oil and Gas production at a CTB Facility located in the NENE, Sec. 35 T15S R28E. Lands and wells associated with this application include N/2 Sec. 36 T15S R28E, Sec. 25 T15S R28Eall but NWNW, W/2 Sec. 26 T15S R28E. Production from these lands will be measured, stored and sold from the CTB location. Gas production will be transported through an approved pipeline to a sales point on DCP's gathering system in Unit N, Sec. 19 T15S R29E, governed under CTB-855.

Enclosed is a copy of this application which was filed with the New Mexico Oil Conservation Division on this date. Any objection to this application must be filed in writing within twenty days from this date at the Division's Santa Fe office located at 1220 South St. Francis Drive, Santa Fe, New Mexico, 87505. If no objection has been made within the 20 days period, this application may be approved administratively by the Division.

Should you have any questions please contact me @ 575-748-1288.

Sincerely,

Jerry W. Sherrell
Production Clerk
jerrys@mec.com

JWS/

Enclosures



P.O. Box 960
Artesia, NM 88211-0960
Office (575) 748-1288
Fax (575) 746-9539

June 25, 2018

VIA CERTIFIED MAIL 7015 0640 0006 7024 4141

*Trustees of Dartmouth College
7 Lebanon Street, Ste. 302
Hanover, NH 03755*

Dear Sir:

Mack Energy Corporation is requesting administrative approval from the NMOCD for approval of CTB/Surface Commingling of Oil and Gas production at a CTB Facility located in the NENE, Sec. 35 T15S R28E. Lands and wells associated with this application include N/2 Sec. 36 T15S R28E, Sec. 25 T15S R28E all but NWNW, W/2 Sec. 26 T15S R28E. Production from these lands will be measured, stored and sold from the CTB location. Gas production will be transported through an approved pipeline to a sales point on DCP's gathering system in Unit N, Sec. 19 T15S R29E, governed under CTB-855.

Enclosed is a copy of this application which was filed with the New Mexico Oil Conservation Division on this date. Any objection to this application must be filed in writing within twenty days from this date at the Division's Santa Fe office located at 1220 South St. Francis Drive, Santa Fe, New Mexico, 87505. If no objection has been made within the 20 days period, this application may be approved administratively by the Division.

Should you have any questions please contact me @ 575-748-1288.

Sincerely,

Jerry W. Sherrell
Production Clerk
jerrys@mec.com

JWS/

Enclosures



PO Box 1000
Alamogordo, NM 88401-1000
Office 505-761-1515
Fax 505-761-1514

August 1, 2016

Mr. Michael McMillan
Oil Conservation Division
1220 South St. Francis Dr.
Santa Fe, New Mexico 87505

RE: **Mack Energy Corporation & Chase Affiliates**

Dear Mr. McMillan:

Mack Energy Corporation is a Chase Family owned entity. The following Chase individuals or companies are all affiliates of Mack Energy Corporation and usually own an interest in wells drilled and/or operated by Mack Energy Corporation.

- Mack C. Chase Trust
- Robert C. Chase
- Richard L. Chase or Ventana Minerals LLC
- Gerene Dianne Chase Ferguson or DiaKan Minerals LLC
- Broken Arrow Royalties LLC
- Chase Oil Corporation

All of these family members and companies all office in the same building so notifications can be hand delivered; therefore we request that the certified mail process be waived when these parties are involved.

If you have any questions or need additional information please do not hesitate to contact me. Your assistance is greatly appreciated.

Sincerely,
Mack Energy Corporation

A handwritten signature in cursive script that reads "Staci Sanders".

Staci Sanders
Land Manager

/ss

McMillan, Michael, EMNRD

From: Jerry Sherrell <jerrys@mec.com>
Sent: Wednesday, July 11, 2018 8:30 AM
To: McMillan, Michael, EMNRD
Subject: Ajax CTB

Good Morning Mike,

Please use the letter showing Mack Energy's affiliates for this project. Thank You.

Jerry W. Sherrell
Mack Energy Corporation
PO Box 960
Artesia, NM 88210
Office 575-748-1288
Cell 575-703-7382
jerrys@mec.com

State of New Mexico
Energy, Minerals and Natural Resources Department

Susana Martinez
Governor

Ken McQueen
Cabinet Secretary

Matthias Sayer
Deputy Cabinet Secretary

Heather Riley, Division Director
Oil Conservation Division



May 8, 2018

ADMINISTRATIVE CENTRAL TANK BATTERY ORDER

Administrative Order CTB-855

Mack Energy Corporation
Attn: Mr. Jerry Sherrell

Mack Energy Corporation (OGRID 13837) is hereby authorized to surface commingle gas production from diversely owned leases and wells identified in Attachment A, and made part of this order. These wells and leases produce from Round Tank; San Andres (Pool code 52770) and are located on Federal and State leases in Township 15 South, Range 28 and 29 East, Chaves County, New Mexico.

Production from the subject wells shall be determined as follows:

The gas production from wells in Attachment A shall be sold at the Facility Measurement Point (FMP) located in Unit O, Section 4, Township 16 South, Range 29 East, NMPM, Eddy County New Mexico.

The oil and gas production from each of the diversely-owned leases shall be measured with a combination of metering and well testing. Each of the wells shall be tested a minimum of seven days per cycle. The oil production from each well shall be measured and sold at each surface facility listed in Attachment A, which will be the subject of future administrative orders.

The operator shall notify the transporter of this commingling authority.

For future additions of wells and leases to this commingling operation, notice shall only be given to those interest owners in the wells and leases to be added, in accordance with Division Rule 19.15.12.10 C (4) (g) NMAC.

Subsequent wells within leases approved by this order may be added to this administrative surface commingle application with a Sundry notice to the Engineering Bureau.

This administrative order supersedes any previous administrative order for gas measurement only for wells listed in Attachment A.

The operator shall notify the Artesia district office of the Division upon commencement of commingling operations.

Administrative Order CTB-855
Mack Energy Corporation
May 8, 2018
Page 2 of 2

This approval is subject to like approval from the **Bureau of Land Management** and **New Mexico State Land Office** before commencement of the commingling operations.

HEATHER RILEY
Director

HR/mam

cc: Oil Conservation Division District Office – Artesia
United States Bureau of Land Management - Carlsbad
New Mexico State Land Office – Oil, Gas, and Minerals

Attachment A: Mack Energy wells Chaves					
Surface Facility/Well Name	API	Surface location	Project Area/Unit		
Blue Bomber Federal TB	Chaves	J-7-15S-29E			
Blue Bomber Federal #1	30-005-64059	J-15S-29E	NW4 SE/4, Section 7, T 15S R29E		
Calgary Federal TB	Chaves	A-25-15S-29E			
Calgary Federal #1	30-005-64198	P-24-15S-28E	SE/4 SE/4 Section 24, T 15S R28E		
Calgary Federal #2	30-005-64199	I-24-15S-28E	NE/4 NE/4 Section 24, T 15S R28E		
Calgary Federal #5	30-005-64193	H-24-15S-28E	SE/4 NE/4 Section 24, T 15S R28E		
Calgary Federal #6	30-005-64194	G-24-15S-28E	SW/4 NE/4 Section 24, T 15S R28E		
Calgary Federal #7	30-005-64195	F-24-15S-28E	SE/4 NW/4 Section 24, T 15S R28E		
Eskimo State TB	Chaves	N-19-15S-29E			
Eskimo State #1	30-005-64027	N-19-15S-29E	SE/4 SW/4 Section 19, T 15S R29E		
Eskimo State #2	30-005-64026	K-19-15S-29E	NE/4 SW/4 Section 19, T 15S R29E		
Eskimo State #3	30-005-64049	C-30-15S-29E	NE/4 NW/4 Section 19, T 15S R29E		
Eskimo State #4	30-005-64050	F-30-15S-29E	SE/4 NW/4 Section 30, T 15S R29E		
Eskimo State #5	30-005-64051	K-30-15S-29E	NE/4 SW/4 Section 30, T 15S R29E		
Eskimo State #6	30-005-64052	N-30-15S-29E	SE/4 SW/4 Section 30, T 15S R29E		
Eskimo State #7	30-005-64053	Lot 1/ D-30-15S-29E	NW/4 NW/4 Section 30, T 15S R29E		
Eskimo State #8	30-005-64054	Lot 2/E-30-15S-29E	SW/4 NW/4 Section 30, T 15S R29E		
Eskimo State #9	30-005-64072	Lot 3/L-30-15S-29E	NW/4 SW/4 Section 30, T 15S R29E		
Eskimo State #10	30-005-64086	Lot 4/M-30-15S-29E	SW/4 SW/4 Section 30, T 15S R29E		
Klondike CTB	Chaves	O-23-15S-28E			
Klondike State Com	30-005-64295	O-23-15S-28E	SW/4 SE/4 Section 23, T 15S R28E		
Medicine Hat State Com #1H	30-005-64303	M-23-15S-28E	W/2 W/2 of section 35, T 15S R28E		
Medicine Hat State Com #2H	30-005-64296	C-23-15S-28E	E/2 W/2 of section 35, T 15S R28E, T 15S R28E		
Markham State Com #1H	30-005-64191	P-23-15S-28E	SE/4 SE/4 of Section 23, E/2 E/2 of section 26, and E/2 NE/4 of section 35, T 15S R28E		
Packers Federal TB		H-29-15S-29E			
Packers Federal #1	30-005-64032	H-19-15S-29E	SE/4 NE/4 of Section 29, T 15S R29E		
Prince Rupert Federal TB		L-20-15S-29E			
Prince Rupert Federal #1	30-005-64222	L-20-15S-29E	NW/4 SW/4, Section 20, T 15S R29E		
Prince Rupert Federal #2	30-005-64223	K-20-15S-29E	NE/4 SW/4 Section 20, T 15S R29E		
Prince Rupert Federal #3H	30-005-64241	O-20-15S-29E	W/2 E/2 of Section 20, T 15S R29E		