

RECEIVED: 10/31/18	REVIEWER: LRL	TYPE: NSL	APP NO: pLEL1831057887
--------------------	---------------	-----------	------------------------

ABOVE THIS TABLE FOR OCD DIVISION USE ONLY

NEW MEXICO OIL CONSERVATION DIVISION
 - Geological & Engineering Bureau -
 1220 South St. Francis Drive, Santa Fe, NM 87505

**ADMINISTRATIVE APPLICATION CHECKLIST**

THIS CHECKLIST IS MANDATORY FOR ALL ADMINISTRATIVE APPLICATIONS FOR EXCEPTIONS TO DIVISION RULES AND
 REGULATIONS WHICH REQUIRE PROCESSING AT THE DIVISION LEVEL IN SANTA FE

Applicant: COG Operating LLC **OGRID Number:** 229137
Well Name: Baseball Cap Federal Com 702H **API:** _____
Pool: WC-025 G-09 S263402N; Wolfcamp **Pool Code:** 98116

**SUBMIT ACCURATE AND COMPLETE INFORMATION REQUIRED TO PROCESS THE TYPE OF APPLICATION
 INDICATED BELOW**

1) TYPE OF APPLICATION: Check those which apply for [A]

A. Location – Spacing Unit – Simultaneous Dedication

☒ NSL☐ NSP (PROJECT AREA)☐ NSP (PRORATION UNIT)☐ SD

B. Check one only for [I] or [II]

[I] Commingling – Storage – Measurement

☐ DHC☐ CTB☐ PLC☐ PC☐ OLS☐ OLM

[II] Injection – Disposal – Pressure Increase – Enhanced Oil Recovery

☐ WFX☐ PMX☐ SWD☐ IPI☐ EOR☐ PPR**2) NOTIFICATION REQUIRED TO:** Check those which apply.A. ☒ Offset operators or lease holdersB. ☒ Royalty, overriding royalty owners, revenue ownersC. ☐ Application requires published noticeD. ☐ Notification and/or concurrent approval by SLOE. ☐ Notification and/or concurrent approval by BLMF. ☐ Surface ownerG. ☒ For all of the above, proof of notification or publication is attached, and/or,H. ☐ No notice required**FOR OCD ONLY**

☐ Notice Complete
☐ Application
 Content
 Complete

3) CERTIFICATION: I hereby certify that the information submitted with this application for administrative approval is **accurate** and **complete** to the best of my knowledge. I also understand that **no action** will be taken on this application until the required information and notifications are submitted to the Division.

Note: Statement must be completed by an individual with managerial and/or supervisory capacity.

Debora L. Wilbourn

Print or Type Name

Debora L. Wilbourn
 Signature

10/29/2018

Date

575-513-1282

Phone Number

dwilbourn@concho.com

e-mail Address



October 30, 2018

Oil Conservation Division
Attention: Mr. Leonard Lowe
1220 South Saint Francis Drive
Santa Fe, New Mexico 87505

Re: Application for Unorthodox Well Location
Baseball Cap Federal Com 702H
SHL: 430' FSL 1140' FEL (Unit P), Sec. 25-T24S-R34E
Proposed FTP: 330' FSL 1420' FEL, Sec. 25-T24S-R34E
BHL: 200' FNL 1420' FEL (Unit B), Sec. 24-T24S-R34E
Proposed LTP: 330' FNL 1420' FEL, Sec. 24-T24S-R34E
Lea County, NM

Dear Mr. Lowe:

COG Operating LLC (COG) respectfully requests administrative approval of a Non-standard Wellbore Location for its Baseball Cap Federal Com 702H well. The completed interval of this well will not meet the requirement for being 330' from the outer boundary of the spacing unit. Attached is Form C-102 showing the Horizontal Spacing Unit for this well.

COG is seeking approval of the Non-standard Location in order to maximize recovery of reserves. The New Mexico Oil Conservation Division's approval of the non-standard completed interval for the Baseball Cap Federal Com 702H well will allow for efficient recovery of reserves, thereby preventing waste and improving well performance. (Please see attached Engineering Statement for more detailed information.)

The affected offset tract is the E/2E/2 of Sec. 24 and E/2E/2 of Sec. 25-T24S-R34E. COG Operating LLC is the operator of the offsetting acreage, therefore the working interest owners under COG's acreage have been notified by Certified Mail of the proposed Non-standard Location. The notice letter advises said working interest owners that in the event they have an objection to COG's application, they must file a written letter with the Division within twenty (20) days from the date the Division receives this application.

Thank you for your consideration of this application. Should you have questions or require further information, please contact me at 575-748-6958 or by email at dwilbourn@concho.com.

Sincerely,

A handwritten signature in blue ink that reads "Debora L. Wilbourn".

Debora L. Wilbourn
Regulatory Analyst

Enclosure

cc: OCD Hobbs

CORPORATE ADDRESS

ONE CONCHO CENTER | 600 WEST ILLINOIS AVENUE | MIDLAND, TEXAS 79701
P 432.683.7443 | F 432.683.7441

ARTESIA WEST OFFICE

2208 MAIN STREET | ARTESIA, NEW MEXICO 88210
P 575.748.6940 | F 575.746.2096

Form C-102
Revised August 1, 2011
Submit one copy to appropriate
District Office

DISTRICT II
811 S. FIRST ST., ARTESIA, NM 88210
Phone: (575) 748-1283 Fax: (575) 748-9720

DISTRICT III
1000 RIO BRAZOS RD., AZTEC, NM 87410
Phone: (505) 334-6176 Fax: (505) 334-6170

DISTRICT IV
1220 S. ST. FRANCIS DR., SANTA FE, NM 87505
Phone: (505) 478-3460 Fax: (505) 478-3462

☐ AMENDED REPORT

WELL LOCATION AND ACREAGE DEDICATION PLAT

API Number	Pool Code	Pool Name
	98116	WC-025 G-09 S263402N; Wolfcamp
Property Code	Property Name	Well Number
	BASEBALL CAP FEDERAL COM	702H
OGRID No.	Operator Name	Elevation
229137	COG OPERATING, LLC	3377.2'

Surface Location

UL or lot No.	Section	Township	Range	Lot Idn	Feet from the	North/South line	Feet from the	East/West line	County
P	25	24-S	34-E		430'	SOUTH	1140'	EAST	LEA

Bottom Hole Location If Different From Surface

UL or lot No.	Section	Township	Range	Lot Idn	Feet from the	North/South line	Feet from the	East/West line	County
B	24	24-S	34-E		200'	NORTH	1420'	EAST	LEA

Dedicated Acres	Joint or Infill	Consolidation Code	Order No.
320			

NO ALLOWABLE WILL BE ASSIGNED TO THIS COMPLETION UNTIL ALL INTERESTS HAVE BEEN CONSOLIDATED
OR A NON-STANDARD UNIT HAS BEEN APPROVED BY THE DIVISION

NAD 83 NME PROPOSED BOTTOM HOLE LOCATION
Y=441231.0 N
X=823895.1 E
LAT.=32.209720° N
LONG.=103.419754° W

LTP
330' FNL & 1420' FEL
Y=441101.0 N
X=823896.1 E
LAT.=32.209362° N
LONG.=103.419754° W

SECTION 24

SECTION 25

PROJECT AREA PRODUCING AREA

B.H.

LEASE X-ING
LAT.=32.203008° N
LONG.=103.419760° W

GRID AZ. - 359.33.25"
HORIZ. DIST. - 10094.7'

LEASE X-ING
LAT.=32.195749° N
LONG.=103.419766° W

FIP
330' FSL & 1420' FEL
Y=431136.6 N
X=823973.1 E
LAT.=32.181973° N
LONG.=103.419778° W
GRID AZ. TO FIP
250°45'23"

NAD 83 NME SURFACE LOCATION
Y=431234.2 N
X=824252.8 E
LAT.=32.182235° N
LONG.=103.418872° W

LEASE X-ING
LAT.=32.182066° N
LONG.=103.419454° W

S.L.

Y=430805.7 N
X=824075.4 E

1140'

430'

Baseball Cap/Jacinto Federal Com Wells

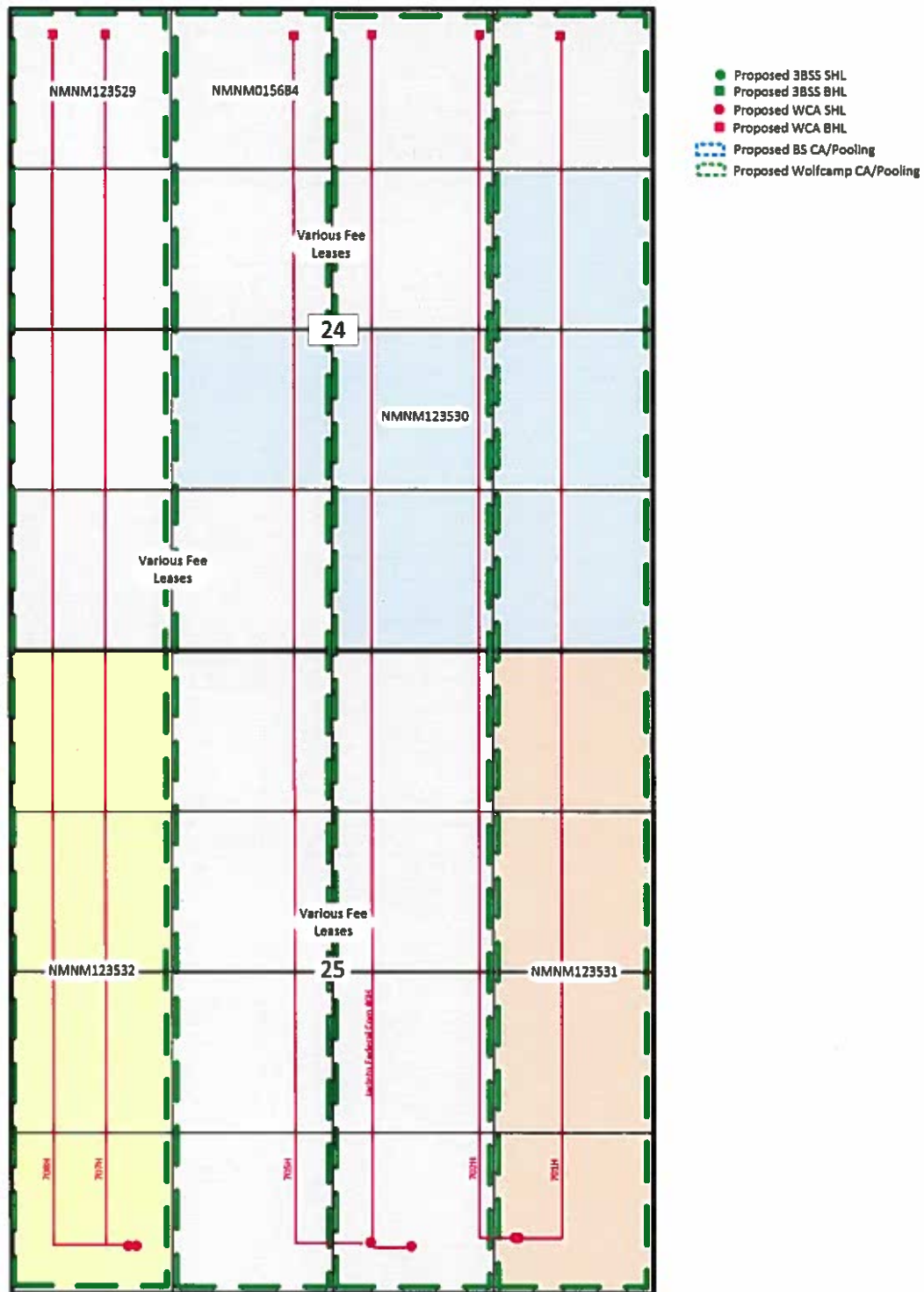

Sec. 24, 25, 36-T24S-R34E
Lea County, NM



CONCHO

Baseball Cap Federal 702H

Secs. 24,15-T24S-R34E
Lea County, NM

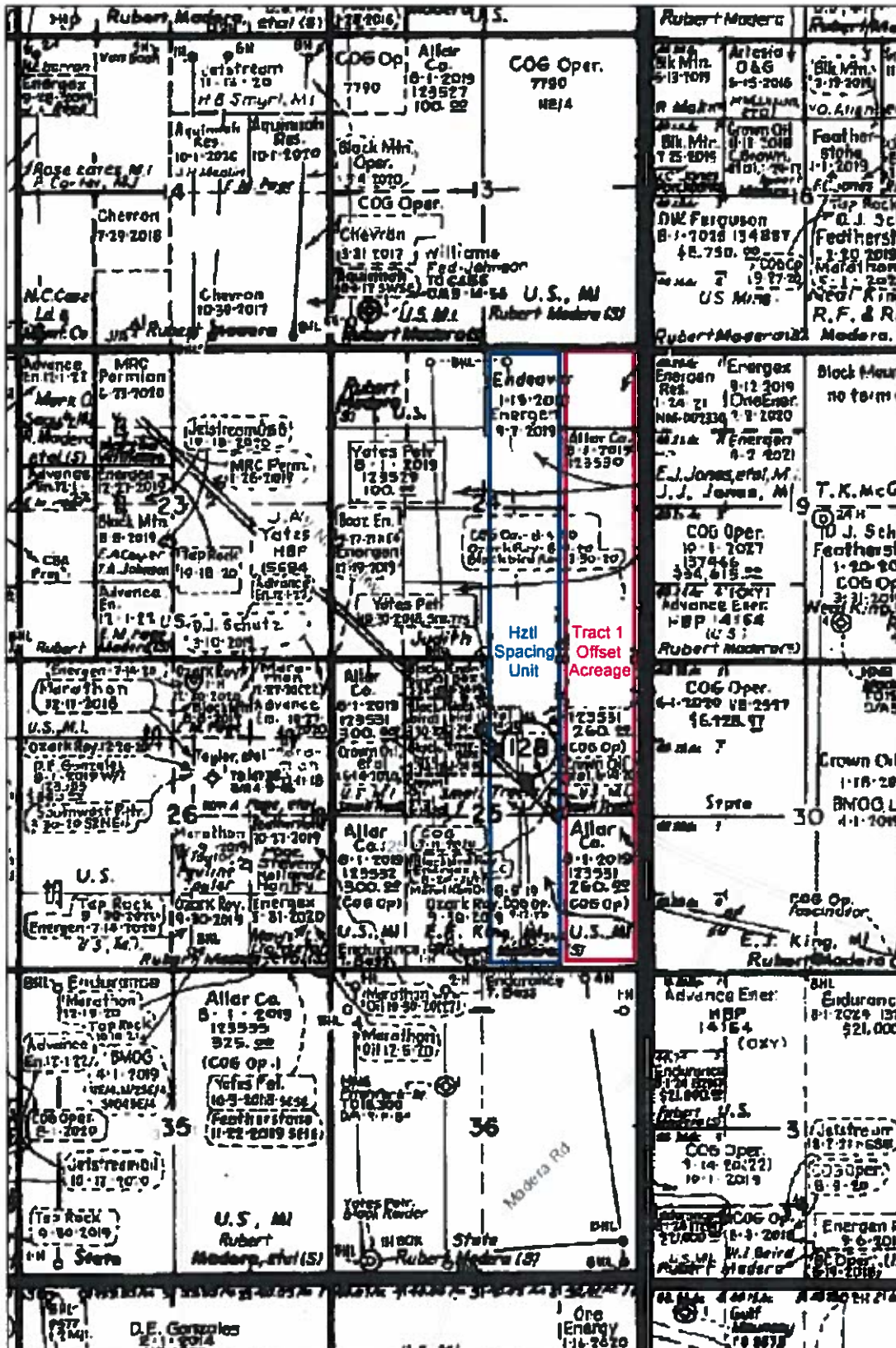

Legend

Lea_NE_1_11_2014

Red: Band_1

Green: Band_2

Blue: Band_3

Lea_NE_2_11_2014

Red: Band_1

Green: Band_2

Blue: Band_3

Lea_NW_1_11_2014

Red: Band_1

Green: Band_2

Blue: Band_3

Lea_NW_2_11_2014

Red: Band_1

Green: Band_2

Blue: Band_3

SE Lea 06_2018

High: 255

Low: 0

SW Lea 06_2018

High: 255

Low: 0

0.48 0 0.48 0.96 Miles

WGS_1984_Web_Mercator_Auxiliary_Sphere

Map Scale 1:36,111



**Baseball Cap Federal 702H
Owner Notification List**

Tracts	Working Interest Owners	Certified Receipt No.	Received
1	Commerce First Operating 14241 Dallas Parkway, Ste 600 Dallas, TX 75254	7017 3040 0000 2540 3761	
1	Energen Resources Corporation 605 Richard Arrington, Jr. Blvd. North Birmingham, AL 35203	7017 3040 0000 2540 3747	
1	MECO IV, LLC 1200 17th St., Ste 975 Denver, CO 80202	7017 3040 0000 2540 3754	
1	Bradley S. Bates 101 Blackberry Court Midland, TX 79705	7017 3040 0000 2540 3723	

Baseball Cap Federal 702H – NSL Applications Engineering Statement

The Baseball Cap Federal 702H well is part of a development project in which COG Operating LLC (COG) will test reduced spacing in the Wolfcamp Shale interval. There are a total of six Wolfcamp Shale wells in Sections 24, 25-T24S-R34E, that will be testing this reduced spacing.

Approval of NSL for the Baseball Cap Federal 702H well will provide adequate spacing for the planned spacing test and will allow economic recovery along with the co-development of the other wells in the section. By testing the viability of simultaneous development on reduced spacing within a single interval, COG is attempting to maximize recoverable resources from the interval and minimize waste created should we not simultaneously develop these targets.



October 30, 2018

Certified Mail – Return Receipt Request
7017 3040 0000 2540 3730

Bureau of Land Management
620 E. Greene St.
Carlsbad 88220

Re: Application for Unorthodox Well Location
Baseball Cap Federal Com 702H
SHL: 430' FSL 1140' FEL (Unit P), Sec. 25-T24S-R34E
Proposed FTP: 330' FSL 1420' FEL, Sec. 25-T24S-R34E
BHL: 200' FNL 1420' FEL (Unit B), Sec. 24-T24S-R34E
Proposed LTP: 330' FNL 1420' FEL, Sec. 24-T24S-R34E
Lea County, NM

Gentlemen:

Attached is a copy of COG Operating LLC (COG)'s Application for a Non-standard Location for the Baseball Cap Federal Com 702H well, the SHL of which is located in Sec. 25-T24S-R34E, Lea County, New Mexico. You are being provided a copy of this Application per OCD's requirement to notify the operators/working interest owners of the affected offset acreage. If you have any objection to this Application, notification should be given to OCD within 20 days of receipt of this letter.

COG is seeking approval of the non-standard unit in order to allow for the efficient recovery of reserves, thereby preventing waste.

If you have any questions regarding this application, please contact Matt Solomon at (432) 685-4352 or Sean Johnson at (432) 818-2230 or by email at msolomon@concho.com or sjohnson@concho.com.

Sincerely,

A handwritten signature in blue ink that reads "Debora L. Wilbourn".

Debora L. Wilbourn
Regulatory Analyst

Enclosures

CORPORATE ADDRESS

ONE CONCHO CENTER | 600 WEST ILLINOIS AVENUE | MIDLAND, TEXAS 79701
P 432.683.7443 | F 432.683.7441

ARTESIA WEST OFFICE

2208 MAIN STREET | ARTESIA, NEW MEXICO 88210
P 575.748.6940 | F 575.746.2096



October 30, 2018

Certified Mail – Return Receipt Request
7017 3040 0000 2540 3761

Commerce First Operating
14241 Dallas Parkway, Ste 600
Dallas 75254

Re: Application for Unorthodox Well Location
Baseball Cap Federal Com 702H
SHL: 430' FSL 1140' FEL (Unit P), Sec. 25-T24S-R34E
Proposed FTP: 330' FSL 1420' FEL, Sec. 25-T24S-R34E
BHL: 200' FNL 1420' FEL (Unit B), Sec. 24-T24S-R34E
Proposed LTP: 330' FNL 1420' FEL, Sec. 24-T24S-R34E
Lea County, NM

Gentlemen:

Attached is a copy of COG Operating LLC (COG)'s Application for a Non-standard Location for the Baseball Cap Federal Com 702H well, the SHL of which is located in Sec. 25-T24S-R34E, Lea County, New Mexico. You are being provided a copy of this Application per OCD's requirement to notify the operators/working interest owners of the affected offset acreage. If you have any objection to this Application, notification should be given to OCD within 20 days of receipt of this letter.

COG is seeking approval of the non-standard unit in order to allow for the efficient recovery of reserves, thereby preventing waste.

If you have any questions regarding this application, please contact Matt Solomon at (432) 685-4352 or Sean Johnson at (432) 818-2230 or by email at msolomon@concho.com or sjohnson@concho.com.

Sincerely,

A handwritten signature in blue ink that reads "Debora L. Wilbourn".

Debora L. Wilbourn
Regulatory Analyst

Enclosures



October 30, 2018

Certified Mail – Return Receipt Request
7017 3040 0000 2540 3747

Energen Resources Corporation
605 Richard Arrington, Jr. Blvd. North
Birmingham 35203

Re: Application for Unorthodox Well Location
Baseball Cap Federal Com 702H
SHL: 430' FSL 1140' FEL (Unit P), Sec. 25-T24S-R34E
Proposed FTP: 330' FSL 1420' FEL, Sec. 25-T24S-R34E
BHL: 200' FNL 1420' FEL (Unit B), Sec. 24-T24S-R34E
Proposed LTP: 330' FNL 1420' FEL, Sec. 24-T24S-R34E
Lea County, NM

Gentlemen:

Attached is a copy of COG Operating LLC (COG)'s Application for a Non-standard Location for the Baseball Cap Federal Com 702H well, the SHL of which is located in Sec. 25-T24S-R34E, Lea County, New Mexico. You are being provided a copy of this Application per OCD's requirement to notify the operators/working interest owners of the affected offset acreage. If you have any objection to this Application, notification should be given to OCD within 20 days of receipt of this letter.

COG is seeking approval of the non-standard unit in order to allow for the efficient recovery of reserves, thereby preventing waste.

If you have any questions regarding this application, please contact Matt Solomon at (432) 685-4352 or Sean Johnson at (432) 818-2230 or by email at msolomon@concho.com or sjohnson@concho.com.

Sincerely,

A handwritten signature in blue ink that reads "Debora L. Wilbourn".

Debora L. Wilbourn
Regulatory Analyst

Enclosures



October 30, 2018

Certified Mail – Return Receipt Request
7017 3040 0000 2540 3754

MECO IV, LLC
1200 17th St., Ste 975
Denver 80202

Re: Application for Unorthodox Well Location
Baseball Cap Federal Com 702H
SHL: 430' FSL 1140' FEL (Unit P), Sec. 25-T24S-R34E
Proposed FTP: 330' FSL 1420' FEL, Sec. 25-T24S-R34E
BHL: 200' FNL 1420' FEL (Unit B), Sec. 24-T24S-R34E
Proposed LTP: 330' FNL 1420' FEL, Sec. 24-T24S-R34E
Lea County, NM

Gentlemen:

Attached is a copy of COG Operating LLC (COG)'s Application for a Non-standard Location for the Baseball Cap Federal Com 702H well, the SHL of which is located in Sec. 25-T24S-R34E, Lea County, New Mexico. You are being provided a copy of this Application per OCD's requirement to notify the operators/working interest owners of the affected offset acreage. If you have any objection to this Application, notification should be given to OCD within 20 days of receipt of this letter.

COG is seeking approval of the non-standard unit in order to allow for the efficient recovery of reserves, thereby preventing waste.

If you have any questions regarding this application, please contact Matt Solomon at (432) 685-4352 or Sean Johnson at (432) 818-2230 or by email at msolomon@concho.com or sjohnson@concho.com.

Sincerely,

A handwritten signature in blue ink that reads "Debora L. Wilbourn".

Debora L. Wilbourn
Regulatory Analyst

Enclosures



October 30, 2018

Certified Mail – Return Receipt Request
7017 3040 0000 2540 37323

Bradley S. Bates
101 Blackberry Court
Midland 79705

Re: Application for Unorthodox Well Location
Baseball Cap Federal Com 702H
SHL: 430' FSL 1140' FEL (Unit P), Sec. 25-T24S-R34E
Proposed FTP: 330' FSL 1420' FEL, Sec. 25-T24S-R34E
BHL: 200' FNL 1420' FEL (Unit B), Sec. 24-T24S-R34E
Proposed LTP: 330' FNL 1420' FEL, Sec. 24-T24S-R34E
Lea County, NM

Dear Mr. Bates:

Attached is a copy of COG Operating LLC (COG)'s Application for a Non-standard Location for the Baseball Cap Federal Com 702H well, the SHL of which is located in Sec. 25-T24S-R34E, Lea County, New Mexico. You are being provided a copy of this Application per OCD's requirement to notify the operators/working interest owners of the affected offset acreage. If you have any objection to this Application, notification should be given to OCD within 20 days of receipt of this letter.

COG is seeking approval of the non-standard unit in order to allow for the efficient recovery of reserves, thereby preventing waste.

If you have any questions regarding this application, please contact Matt Solomon at (432) 685-4352 or Sean Johnson at (432) 818-2230 or by email at msolomon@concho.com or sjohnson@concho.com.

Sincerely,

Debora L. Wilbourn
Regulatory Analyst

Enclosures

Lowe, Leonard, EMNRD

From: Debora Wilbourn <DWilbourn@concho.com>
Sent: Wednesday, October 31, 2018 2:48 PM
To: Lowe, Leonard, EMNRD
Cc: Jones, William V, EMNRD; Matt Solomon; Debora Wilbourn
Subject: [EXT] Baseball Cap Fed Com 702H NSL Application
Attachments: Baseball Cap Fed Com 702H NSL Application.pdf

Follow Up Flag: Follow up
Flag Status: Flagged

Mr. Lowe,

Please find attached COG's NSL application for the Baseball Cap Fed Com 702H. If you have any questions, please let me know.

Debora Wilbourn

Production Compliance Lead
North Delaware Basin Asset Team
dwilbourn@concho.com

575.748.6958

Concho West | 2208 W Main St | Artesia, NM | 88210-3720 | 575.748.6940



NOTICE: The information in this email may be confidential and/or privileged. If you are not the intended recipient or an authorized representative of the intended recipient, you are hereby notified that any review, dissemination or copying of this email and its attachments, if any, or the information contained herein, is prohibited. If you have received this email in error, please immediately notify the sender by return email and delete this email from your system. Further, any contract terms proposed or purportedly accepted in this email are not binding and are subject to management's final approval as memorialized in a separate written instrument, excluding electronic correspondence, executed by an authorized representative of COG Operating LLC or its affiliates.

Lowe, Leonard, EMNRD

From: Lowe, Leonard, EMNRD
Sent: Tuesday, November 20, 2018 12:24 PM
To: 'Jordan L. Kessler'
Cc: Brown, Maxey G, EMNRD; Kautz, Paul, EMNRD; 'lisa@rwbyram.com'; Jones, William V, EMNRD; McMillan, Michael, EMNRD; Dawson, Scott, EMNRD; Goetze, Phillip, EMNRD; Martin, Ed; Holm, Anchor E.
Subject: APPROVED NSL-7784_Ameredev Operating LLC_Red Bud 25 36 32 State Com Well No. 107H_SEC 32 25S 36E
Importance: High

Ms. Jordan L. Kessler,

The following administrative order has been issued and will soon be available on the Division's web site:
<http://ocdimage.emnrd.state.nm.us/Imaging/Default.aspx>

NSL-7784

Ameredev Operating LLC

API #: 30-025-45036

WELL: Red Bud 25 36 32 State Com Well No. 107H

Leonard Lowe

Engineering Bureau

Oil Conservation **D**ivision

Energy **M**inerals and **N**atural **R**esources **D**epartment

1220 South St. Frances

Santa Fe, New Mexico 87004

Office: 505-476-3492

Cell: 505-930-6717

Fax: 505-476-3462

E-mail: leonard.lowe@state.nm.us

Website: <http://www.emnrd.state.nm.us/ocd/>