

RECEIVED: 01/08/19	REVIEWER: LRL	TYPE: NSL	APP NO: pLEL1900933361
--------------------	---------------	-----------	------------------------

ABOVE THIS TABLE FOR OCD DIVISION USE ONLY

NEW MEXICO OIL CONSERVATION DIVISION
 - Geological & Engineering Bureau -
 1220 South St. Francis Drive, Santa Fe, NM 87505

**ADMINISTRATIVE APPLICATION CHECKLIST**

THIS CHECKLIST IS MANDATORY FOR ALL ADMINISTRATIVE APPLICATIONS FOR EXCEPTIONS TO DIVISION RULES AND
 REGULATIONS WHICH REQUIRE PROCESSING AT THE DIVISION LEVEL IN SANTA FE

Applicant: <u>Devon Energy Production Company, L.P.</u>	OGRID Number: <u>6137</u>
Well Name: <u>Spud Muffin 31-30 Fed Com 621H</u>	API: <u>30-015-45460-00-X1</u>
Pool: <u>Purple Sage-Wolfcamp Gas Pool</u>	Pool Code: <u>98220</u>

**SUBMIT ACCURATE AND COMPLETE INFORMATION REQUIRED TO PROCESS THE TYPE OF APPLICATION
 INDICATED BELOW**

1) TYPE OF APPLICATION: Check those which apply for [A]

A. Location – Spacing Unit – Simultaneous Dedication

☒ NSL☐ NSP (PROJECT AREA)☐ NSP (PRORATION UNIT)☐ SD

B. Check one only for [I] or [II]

[I] Commingling – Storage – Measurement

☐ DHC☐ CTB☐ PLC☐ PC☐ OLS☐ OLM

[II] Injection – Disposal – Pressure Increase – Enhanced Oil Recovery

☐ WFX☐ PMX☐ SWD☐ IPI☐ EOR☐ PPR**2) NOTIFICATION REQUIRED TO:** Check those which apply.A. ☒ Offset operators or lease holdersB. ☐ Royalty, overriding royalty owners, revenue ownersC. ☐ Application requires published noticeD. ☐ Notification and/or concurrent approval by SLOE. ☒ Notification and/or concurrent approval by BLMF. ☐ Surface ownerG. ☐ For all of the above, proof of notification or publication is attached, and/or,H. ☐ No notice required**FOR OCD ONLY**☐

Notice Complete

☐Application
Content
Complete

3) CERTIFICATION: I hereby certify that the information submitted with this application for administrative approval is **accurate** and **complete** to the best of my knowledge. I also understand that **no action** will be taken on this application until the required information and notifications are submitted to the Division.

Note: Statement must be completed by an individual with managerial and/or supervisory capacity.

Joe Hammond

Print or Type Name

Joe Hammond
 Signature

1-4-19
Date405-552-8102

Phone Number

joe.hammond@dvnm.com

e-mail Address

HOLLAND & HART L.P.



Adam G. Rankin
Associate
Phone (505) 954-7286
Fax (505) 983-6043
AGR Rankin@hollandhart.com

January 8, 2019

VIA CERTIFIED MAIL
RETURN RECEIPT REQUESTED

TO AFFECTED PARTIES

Re: Application of Devon Energy Production Company, L.P. for administrative approval of an unorthodox well location.

Ladies and Gentlemen:

Enclosed is a copy of the above-referenced application which was filed with the New Mexico Oil Conservation Division on this date. Any objection to this application must be filed in writing within twenty days from this date with the applicant and the New Mexico Oil Conservation Division, 1220 South St. Francis Drive, Santa Fe, New Mexico, 87505. If no objection is received within this twenty-day period, this application may be approved administratively by the Division.

If you have any questions about this application, please contact the following:

Joe Hammond
Devon Energy
(405) 552-8102
joe.hammond@dvn.com

Sincerely,

Adam G. Rankin
**ATTORNEY FOR DEVON ENERGY PRODUCTION
COMPANY, L.P.**



Devon Energy Production Company, L.P.
333 West Sheridan Avenue
Oklahoma City, OK 73102-5015

January 3, 2019

Mr. Leonard Lowe
New Mexico Oil Conservation Division
1220 South Francis Drive
Santa Fe, New Mexico 87505

RE: Application for Nonstandard Locations
Engineering Statement
Devon Energy Production Company, L.P.
Spud Muffin 31-30 623H, 624H, 735H, 736H, 738H Wells
Spud Muffin 31-30 Com 622H, 734H Wells
Spud Muffin 31-30 Fed Com 621H Well
Eddy County, New Mexico

Dear Mr. Lowe:

Devon Energy Production Company, L.P. respectfully requests administrative approval of a non-standard location for each of the Spud Muffin Wells referenced above by decreasing the first and last take points from 330 feet to 100 feet from the horizontal plane outer boundary. The wells are located in the Purple Sage-Wolfcamp Gas Pool (Pool Code 98220). It is Devon's responsibility as a prudent operator to maximize lateral length and to minimize reserves left in the ground. Decreasing the first and last take point will increase the wells effective lateral length by 460 feet thereby increasing ultimate recovery of reserves and thereby preventing waste of natural resources.

Sincerely,

A handwritten signature in blue ink, appearing to read "K. Sprague", written over the printed name.

Karsan Sprague
Reservoir Engineer

District I
1625 N French Dr., Hobbs, NM 88240
Phone: (575) 393-6161 Fax: (575) 393-0720
District II
811 S First St., Artesia, NM 88210
Phone: (575) 748-1283 Fax: (575) 748-9720
District III
1000 Rio Brazos Road, Aztec, NM 87410
Phone: (505) 334-6178 Fax: (505) 334-6170
District IV
1220 S St Francis Dr., Santa Fe, NM 87505
Phone: (505) 476-7460 Fax: (505) 476-3462

State of New Mexico
Energy, Minerals & Natural Resources Department
OIL CONSERVATION DIVISION
1220 South St. Francis Dr.
Santa Fe, NM 87505

Form C-102
Revised August 1, 2011
Submit one copy to appropriate
District Office
☐ AMENDED REPORT

WELL LOCATION AND ACREAGE DEDICATION PLAT

¹ API Number		² Pool Code		³ Pool Name	
⁴ Property Code		⁵ Property Name SPUD MUFFIN 30-31 FED COM			⁶ Well Number 621H
⁷ OGRID No. 6137		⁸ Operator Name DEVON ENERGY PRODUCTION COMPANY, L.P.			⁹ Elevation 2959.7
¹⁰ Surface Location					
UL or lot no. 4	Section 31	Township 23 S	Range 29 E	Lot Idn	Feet from the 270
				North/South line SOUTH	Feet from the 1245
				East/West line WEST	County EDDY
¹¹ Bottom Hole Location If Different From Surface					
UL or lot no. 1	Section 30	Township 23 S	Range 29 E	Lot Idn	Feet from the 20
				North/South line NORTH	Feet from the 330
				East/West line WEST	County EDDY
¹² Dedicated Acres		¹³ Joint or Infill		¹⁴ Consolidation Code	
				¹⁵ Order No.	

No allowable will be assigned to this completion until all interests have been consolidated or a non-standard unit has been approved by the division.

<p>17 OPERATOR CERTIFICATION I hereby certify that the information contained herein is true and complete to the best of my knowledge and belief, and that this organization either owns a working interest or unleased mineral interest in the land including the proposed bottom hole location or has a right to drill this well at this location pursuant to a contract with an owner of such a mineral or working interest, or to a voluntary pooling agreement or a compulsory pooling order heretofore entered by the division.</p> <p>Signature _____ Date _____</p> <p>Printed Name _____</p> <p>E-mail Address _____</p>	
<p>18 SURVEYOR CERTIFICATION I hereby certify that the well location shown on this plat was plotted from field notes of actual surveys made by me or under my supervision, and that the same is true and correct to the best of my belief.</p> <p>DECEMBER 19, 2018</p> <p>Date of Survey _____</p> <p>Signature and Seal of Professional Surveyor FILIMON F. JARAMILLO, PLS 12797 Certificate Number FILIMON F. JARAMILLO, PLS 12797 SURVEY NO. 6035D</p>	

Intent ☐ As Drilled ☐

API #

Operator Name: DEVON ENERGY PRODUCTION COMPANY, L.P.	Property Name: SPUD MUFFIN 31-30 FED COM	Well Number 621H
--	--	----------------------------

Kick Off Point (KOP)

UL	Section	Township	Range	Lot	Feet	From N/S	Feet	From E/W	County
Latitude					Longitude				NAD

First Take Point (FTP)

UL M	Section 31	Township 23S	Range 29E	Lot 4	Feet 100	From N/S SOUTH	Feet 330	From E/W WEST	County EDDY
Latitude 32.2545875					Longitude 104.0312813				NAD 83

Last Take Point (LTP)

UL D	Section 30	Township 23S	Range 29E	Lot 1	Feet 100	From N/S NORTH	Feet 330	From E/W WEST	County EDDY
Latitude 32.2833028					Longitude 104.0311796				NAD 83

Is this well the defining well for the Horizontal Spacing Unit? ☐

Is this well an infill well? ☐

If infill is yes please provide API if available, Operator Name and well number for Defining well for Horizontal Spacing Unit.

API #

Operator Name:	Property Name:	Well Number
----------------	----------------	-------------

KZ 06/29/2018

Unorthodox Location Notice Plat

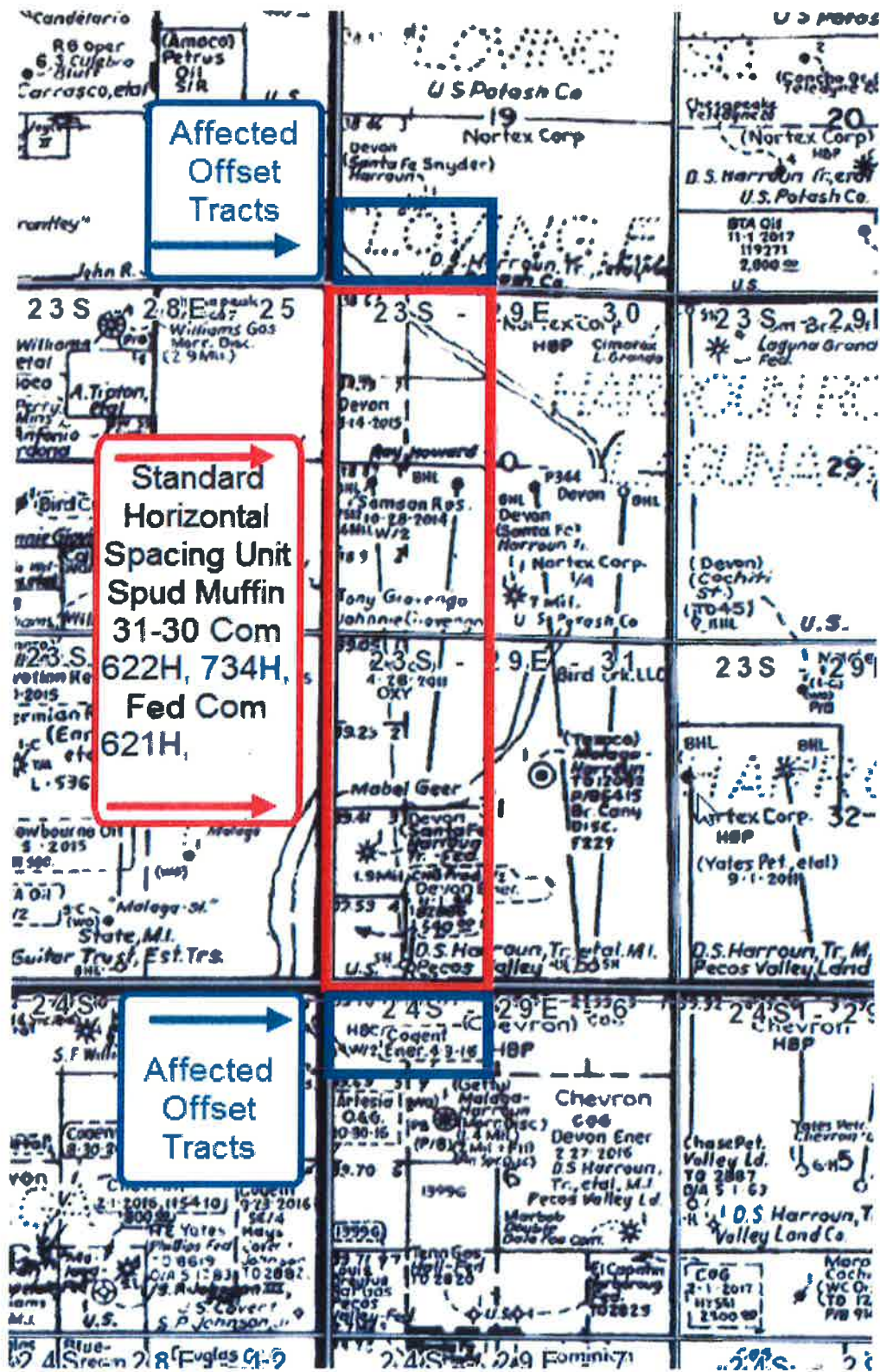



Devon Energy Production Company, L.P.
333 West Sheridan Avenue
Oklahoma City, OK 73102-5015

Application Non-Standard Location - Address List
Devon Energy Production Company, L.P.
Spud Muffin 31-30 Com 622H
Spud Muffin 31-30 Com 734H
Spud Muffin 31-30 Fed Com 621H

T23S-R29E
Section 19 - Unit M, N
Eddy County, NM

Kaiser-Francis Oil Company
6733 South Yale Avenue
Tulsa, OK 74136

T24S-R29E
Section 6 - Unit D, C
Eddy County, NM

OXY USA, Inc.
5 Greenway Plaza, Suite 110
Houston, TX 77046

Additional Addresses:
New Mexico Oil Conservation Division
1220 South St. Francis Dr.
Santa Fe, NM 87505

Bureau of Land Management
620 E. Greene Street
Carlsbad, NM 88220-6292



Shipment Confirmation Acceptance Notice

A. Mailer Action

Note to Mailer: The labels and volume associated to this form online, **must** match the labeled packages being presented to the USPS® employee with this form.

Devon Energy - 8 NSL Applications
CM# 41132.0002 20190108
notice List

Shipment Date: 01/07/2019

Shipped From:

Name: HOLLAND & HART LLP

Address: 110 N GUADALUPE ST # 1

City: SANTA FE

State: NM ZIP+4® 87501

Type of Mail	Volume
Priority Mail Express®	
Priority Mail®	0
First-Class Package Service®	
Returns	
International*	
Other	3
Total	3

*Start time for products with service guarantees will begin when mail arrives at the local Post Office™ and items receive individual processing and acceptance scans.

B. USPS Action

Note to RSS Clerk:

1. Home screen > Mailing/Shipping > More
2. Select Shipment Confirm
3. Scan or enter the barcode/label number from PS Form 5630
4. Confirm the volume count message by selecting Yes or No
5. Select Pay and End Visit to complete transaction

USPS EMPLOYEE: Please scan upon pickup or receipt of mail.
Leave form with customer or in customer's mail receptacle.

USPS SCAN AT ACCEPTANCE



9275 0901 1935 6200 0012 0540 83



Firm Mailing Book For Accountable Mail

[illegible]

Lowe, Leonard, EMNRD

From: Hammond, Joe <Joe.Hammond@dvn.com>
Sent: Thursday, January 10, 2019 3:44 PM
To: Lowe, Leonard, EMNRD
Subject: [EXT] RE: [EXTERNAL] FW: Devon - NSL applications

Hello Mr. Lowe, so sorry for the confusion on the Spud Muffin NSL requests.

If I understand correctly, the information you are requesting from your email below is:

Well: Spud Muffin 31-30 736H
HSU Location: E/2 Sections 31 and 30, T23S-R29E
Dedicated Acres: 640
First Take Point: 100' FSL, 1254' FEL, Unit P, Sec 31
Last Take Point: 100'FNL, 1254' FEL, Unit A, Sec 30

Well: Spud Muffin 31-30 722H
HSU Location: W/2 Sections 31 and 30, T23S-R29E
Dedicated Acres: 632.38
First Take Point: 100' FSL, 1870' FWL, Unit N, Sec 31
Last Take Point: 100'FNL, 1870' FWL, Unit C, Sec 30

Well: Spud Muffin 31-30 621H
HSU Location: W/2 Sections 31 and 30, T23S-R29E
Dedicated Acres: 632.38
First Take Point: 100' FSL, 330' FWL, Unit M, Sec 31
Last Take Point: 100'FNL, 330' FWL, Unit D, Sec 30

Well: Spud Muffin 31-30 623H
HSU Location: W/2 Sections 31 and 30, T23S-R29E
Dedicated Acres: 632.38
First Take Point: 100' FSL, 2178' FWL, Unit N, Sec 31
Last Take Point: 100'FNL, 2178' FWL, Unit C, Sec 30

Well: Spud Muffin 31-30 623H
HSU Location: E/2 Sections 31 and 30, T23S-R29E
Dedicated Acres: 640
First Take Point: 100' FSL, 1870' FEL, Unit O, Sec 31
Last Take Point: 100'FNL, 1870' FEL, Unit B, Sec 30

Well: Spud Muffin 31-30 624H
HSU Location: E/2 Sections 31 and 30, T23S-R29E
Dedicated Acres: 640
First Take Point: 100' FSL, 380' FEL, Unit P, Sec 31
Last Take Point: 100'FNL, 380' FEL, Unit A, Sec 30

Well: Spud Muffin 31-30 735H
HSU Location: E/2 Sections 31 and 30, T23S-R29E
Dedicated Acres: 640

First Take Point: 100' FSL, 2178' FEL, Unit O, Sec 31

Last Take Point: 100'FNL, 2178' FEL, Unit B, Sec 30

Well: Spud Muffin 31-30 738H

HSU Location: E/2 Sections 31 and 30, T23S-R29E

Dedicated Acres: 640

First Take Point: 100' FSL, 330' FEL, Unit P, Sec 31

Last Take Point: 100'FNL, 330' FEL, Unit A, Sec 30

If I have inadvertently left something off again, please advise accordingly.

I haven't done a whole lot of NSL's requests.

Thank you.

Joe Hammond

Land Advisor

Devon Energy

333 West Sheridan Avenue

Oklahoma City, OK 73102-5010

(405) 552-8102 Direct

(405) 823-4791 Cell



Devon - Internal

From: Lowe, Leonard, EMNRD [mailto:Leonard.Lowe@state.nm.us]

Sent: Wednesday, January 09, 2019 1:08 PM

To: Hammond, Joe <Joe.Hammond@devon.com>

Subject: [EXTERNAL] FW: Devon - NSL applications

Importance: High

Mr. Joe Hammond,

Please provide for all submitted NSLs to my attention. You may e-mail them.

Leonard Lowe

Engineering Bureau

Oil Conservation Division

Energy Minerals and Natural Resources Department

1220 South St. Frances

Santa Fe, New Mexico 87004

Office: 505-476-3492

Cell: 505-930-6717

Fax: 505-476-3462

E-mail: leonard.lowe@state.nm.us

Website: <http://www.emnrd.state.nm.us/ocd/>

From: Lowe, Leonard, EMNRD
Sent: Wednesday, January 9, 2019 9:53 AM
To: 'Adam Rankin' <AGRankin@hollandhart.com>; McMillan, Michael, EMNRD <Michael.McMillan@state.nm.us>
Subject: RE: Devon - NSL applications

Mr. Adam Rankin,

What are the FTP & LTP? The C-102 is not as clear.

What is the location subject Horizontal Spacing Unit? What is the acreage?

This pertains to all of the submitted NSL applications. Please submit a letter identifying these and all information pertaining to the NSL request for all the submitted Administrative Applications.

Leonard Lowe

Engineering Bureau
Oil Conservation Division
Energy Minerals and Natural Resources Department
1220 South St. Frances
Santa Fe, New Mexico 87004
Office: 505-476-3492
Cell: 505-930-6717
Fax: 505-476-3462
E-mail: leonard.lowe@state.nm.us
Website: <http://www.emnrd.state.nm.us/ocd/>

From: Adam Rankin <AGRankin@hollandhart.com>
Sent: Tuesday, January 8, 2019 12:05 PM
To: McMillan, Michael, EMNRD <Michael.McMillan@state.nm.us>; Lowe, Leonard, EMNRD <Leonard.Lowe@state.nm.us>
Subject: [EXT] Devon - NSL applications

Mike and Leonard,

We hand-delivered the attached NSL applications on behalf of Devon this morning. These are all Purple Sage-WC pool NSLs seeking approval to be 100 feet from the toe and heel. Please let us know if you have any questions.

Very best,
Adam

Adam G. Rankin
Holland & Hart LLP
110 North Guadalupe Suite 1
P.O. Box 2208
Santa Fe, NM 87504
Office: (505) 988-4421
Direct: (505) 954-7294
Cell: (505) 570-0377
Fax (505) 983-6043
E-mail: agrarkin@hollandhart.com
[Download vCard](#)

Lowe, Leonard, EMNRD

From: Lowe, Leonard, EMNRD
Sent: Thursday, February 7, 2019 8:30 AM
To: 'Hammond, Joe'
Cc: Mike Bratcher (mike.bratcher@state.nm.us); Cordero, Gilbert, EMNRD; 'lisa@rwbyram.com'; Jones, William V, EMNRD; Dawson, Scott, EMNRD; Murphy, Kathleen A, EMNRD; McMillan, Michael, EMNRD; Goetze, Phillip, EMNRD; 'jglover@blm.gov'
Subject: APPROVED 8 NSLs_Devon Energy Production Company, L.P._8 - Spud Muffin Wells_SEC 31 30 23S 29E

Importance: High

Mr. Joe Hammon,

The following administrative orders have been issued and will soon be available on the Division's web site:
<http://ocdimage.emnrd.state.nm.us/Imaging/Default.aspx>

DEVON ENERGY PRODUCTION COMPANY, L.P. [6137] POOL: Purple Sage; Wolfcamp [# 98220]

WELL NAME	API Number
Spud Muffin 31 30 Well No. 738H	30-015-44757
Spud Muffin 31 30 Well No. 736H	30-015-44755
Spud Muffin 31 30 Well No. 735H	30-015-44754
Spud Muffin 31 30 Com Well No. 734H	30-015-44753
Spud Muffin 31 30 Well No. 624H	30-015-45268
Spud Muffin 31 30 Well No. 623H	30-015-45267
Spud Muffin 31 30 Com Well No. 622H	30-015-45266
Spud Muffin 31 30 Federal Com Well No. 621H	30-015-45460

Leonard Lowe

Engineering Bureau
Oil Conservation Division
Energy Minerals and Natural Resources Department
1220 South St. Frances
Santa Fe, New Mexico 87004
Office: 505-476-3492
Cell: 505-930-6717
Fax: 505-476-3462
E-mail: leonard.lowe@state.nm.us
Website: <http://www.emnrd.state.nm.us/ocd/>