

RECEIVED: 01/08/19	REVIEWER: LRL	TYPE: NSL	APP NO: pLEL1900948935
---------------------------	----------------------	------------------	-------------------------------

ABOVE THIS TABLE FOR OCD DIVISION USE ONLY

NEW MEXICO OIL CONSERVATION DIVISION
 - Geological & Engineering Bureau -
 1220 South St. Francis Drive, Santa Fe, NM 87505

**ADMINISTRATIVE APPLICATION CHECKLIST**

THIS CHECKLIST IS MANDATORY FOR ALL ADMINISTRATIVE APPLICATIONS FOR EXCEPTIONS TO DIVISION RULES AND
 REGULATIONS WHICH REQUIRE PROCESSING AT THE DIVISION LEVEL IN SANTA FE

Applicant: Devon Energy Production Company, L.P. **OGRID Number:** 6137
Well Name: Spud Muffin 31-30 738H **API:** 30-015-44757
Pool: Purple Sage-Wolfcamp Gas Pool **Pool Code:** 98220

**SUBMIT ACCURATE AND COMPLETE INFORMATION REQUIRED TO PROCESS THE TYPE OF APPLICATION
 INDICATED BELOW**

- 1) **TYPE OF APPLICATION:** Check those which apply for [A]
 A. Location - Spacing Unit - Simultaneous Dedication
☒ NSL ☐ NSP (PROJECT AREA) ☐ NSP (PRORATION UNIT) ☐ SD

B. Check one only for [I] or [II]

[I] Commingling - Storage - Measurement

☐ DHC ☐ CTB ☐ PLC ☐ PC ☐ OLS ☐ OLM

[II] Injection - Disposal - Pressure Increase - Enhanced Oil Recovery

☐ WFX ☐ PMX ☐ SWD ☐ IPI ☐ EOR ☐ PPR

- 2) **NOTIFICATION REQUIRED TO:** Check those which apply.

- A. ☒ Offset operators or lease holders
 B. ☐ Royalty, overriding royalty owners, revenue owners
 C. ☐ Application requires published notice
 D. ☐ Notification and/or concurrent approval by SLO
 E. ☒ Notification and/or concurrent approval by BLM
 F. ☐ Surface owner
 G. ☐ For all of the above, proof of notification or publication is attached, and/or,
 H. ☐ No notice required

FOR OCD ONLY

- ☐ Notice Complete
☐ Application
 Content
 Complete

- 3) **CERTIFICATION:** I hereby certify that the information submitted with this application for administrative approval is **accurate** and **complete** to the best of my knowledge. I also understand that **no action** will be taken on this application until the required information and notifications are submitted to the Division.

Note: Statement must be completed by an individual with managerial and/or supervisory capacity.

Joe Hammond

Print or Type Name

Joe Hammond
 Signature

1-4-19
 Date

405-552-8102

Phone Number

joe.hammond@dvn.com

e-mail Address

HOLLAND & HART LLP



Adam G. Rankin
Associate
Phone (505) 954-7286
Fax (505) 983-6043
AGRankin@hollandhart.com

January 8, 2019

VIA CERTIFIED MAIL
RETURN RECEIPT REQUESTED

TO AFFECTED PARTIES

Re: Application of Devon Energy Production Company, L.P. for administrative approval of an unorthodox well location.

Ladies and Gentlemen:

Enclosed is a copy of the above-referenced application which was filed with the New Mexico Oil Conservation Division on this date. Any objection to this application must be filed in writing within twenty days from this date with the applicant and the New Mexico Oil Conservation Division, 1220 South St. Francis Drive, Santa Fe, New Mexico, 87505. If no objection is received within this twenty-day period, this application may be approved administratively by the Division.

If you have any questions about this application, please contact the following:

Joe Hammond
Devon Energy
(405) 552-8102
joe.hammond@devon.com

Sincerely,

Adam G. Rankin
**ATTORNEY FOR DEVON ENERGY PRODUCTION
COMPANY, L.P.**



Devon Energy Production Company, L.P.
333 West Sheridan Avenue
Oklahoma City, OK 73102-5015

January 3, 2019

Mr. Leonard Lowe
New Mexico Oil Conservation Division
1220 South Francis Drive
Santa Fe, New Mexico 87505

RE: Application for Nonstandard Locations
Engineering Statement
Devon Energy Production Company, L.P.
Spud Muffin 31-30 623H, 624H, 735H, 736H, 738H Wells
Spud Muffin 31-30 Com 622H, 734H Wells
Spud Muffin 31-30 Fed Com 621H Well
Eddy County, New Mexico

Dear Mr. Lowe:

Devon Energy Production Company, L.P. respectfully requests administrative approval of a non-standard location for each of the Spud Muffin Wells referenced above by decreasing the first and last take points from 330 feet to 100 feet from the horizontal plane outer boundary. The wells are located in the Purple Sage-Wolfcamp Gas Pool (Pool Code 98220). It is Devon's responsibility as a prudent operator to maximize lateral length and to minimize reserves left in the ground. Decreasing the first and last take point will increase the wells effective lateral length by 460 feet thereby increasing ultimate recovery of reserves and thereby preventing waste of natural resources.

Sincerely,



Karsan Sprague
Reservoir Engineer

District I
1625 N. French Dr., Hobbs, NM 88240
Phone: (575) 393-6161 Fax: (575) 393-0720
District II
311 S. First St., Artesia, NM 88210
Phone: (575) 748-1283 Fax: (575) 748-9720
District III
1000 Rio Brazos Road, Aztec, NM 87410
Phone: (505) 334-6178 Fax: (505) 334-6170
District IV
1220 S. St. Francis Dr., Santa Fe, NM 87505
Phone: (505) 476-3460 Fax: (505) 476-3462

State of New Mexico
Energy, Minerals & Natural Resources Department
OIL CONSERVATION DIVISION
1220 South St. Francis Dr.
Santa Fe, NM 87505

Form C-102
Revised August 1, 2011
Submit one copy to appropriate
District Office
☐ AMENDED REPORT

WELL LOCATION AND ACREAGE DEDICATION PLAT

¹ API Number	² Pool Code	³ Pool Name
⁴ Property Code	⁵ Property Name SPUD MUFFIN 31-30	⁶ Well Number 738H
⁷ OGRID No. 6137	⁸ Operator Name DEVON ENERGY PRODUCTION COMPANY, L.P.	⁹ Elevation 2960.3

¹⁰ Surface Location

UL or lot no. P	Section 31	Township 23 S	Range 29 E	Lot Idn	Feet from the 335	North/South line SOUTH	Feet from the 455	East/West line EAST	County EDDY
--------------------	---------------	------------------	---------------	---------	----------------------	---------------------------	----------------------	------------------------	----------------

¹¹ Bottom Hole Location If Different From Surface

UL or lot no. A	Section 30	Township 23 S	Range 29 E	Lot Idn	Feet from the 20	North/South line NORTH	Feet from the 330	East/West line EAST	County EDDY
--------------------	---------------	------------------	---------------	---------	---------------------	---------------------------	----------------------	------------------------	----------------

¹² Dedicated Acres	¹³ Joint or Infill	¹⁴ Consolidation Code	¹⁵ Order No.
-------------------------------	-------------------------------	----------------------------------	-------------------------

No allowable will be assigned to this completion until all interests have been consolidated or a non-standard unit has been approved by the division.

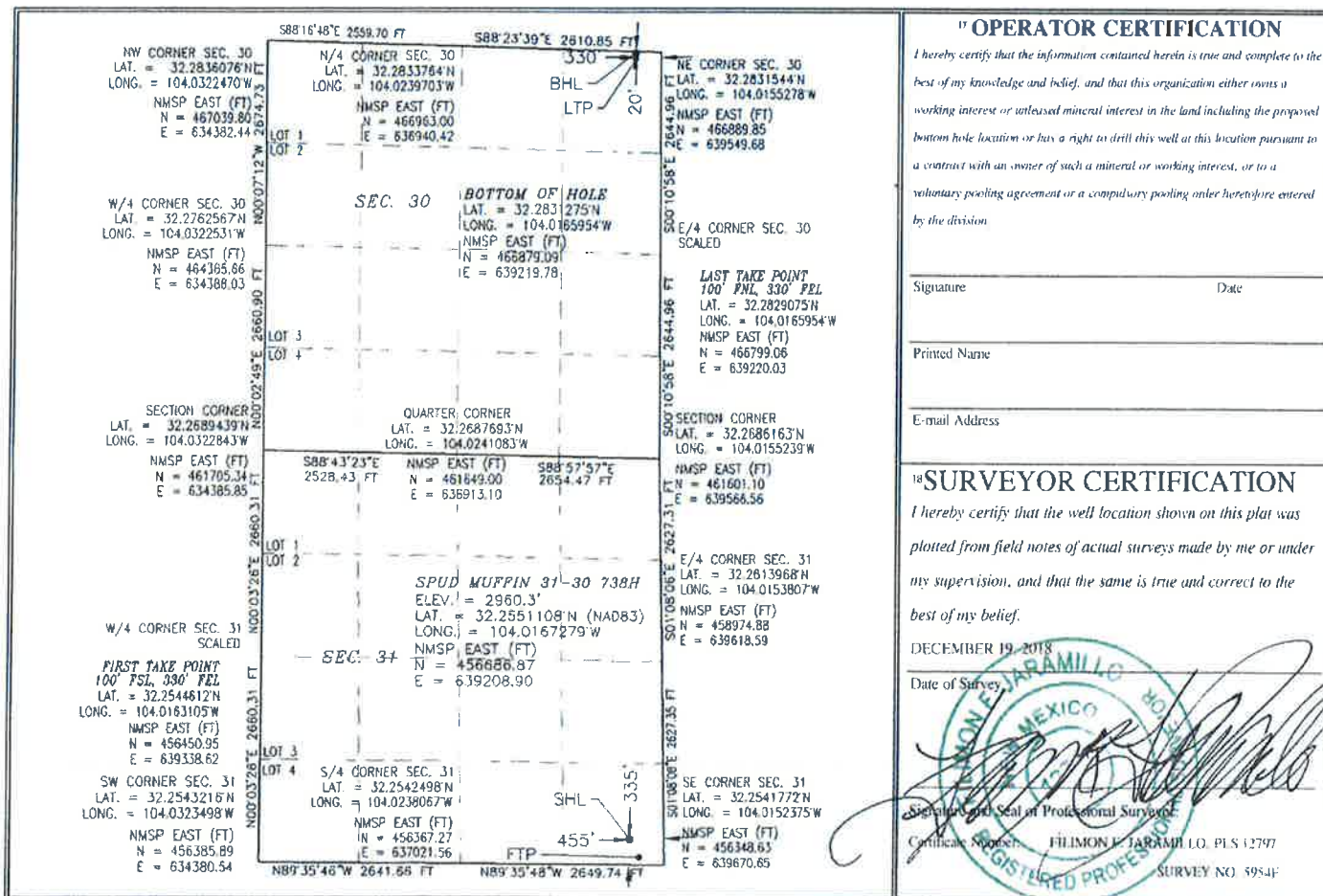

Intent ☐ As Drilled ☐

API #

Operator Name:

DEVON ENERGY PRODUCTION CO., L.P.

Property Name:

SPUD MUFFIN 31-30

Well Number

738H

Kick Off Point (KOP)

UL	Section	Township	Range	Lot	Feet	From N/S	Feet	From E/W	County
Latitude					Longitude			NAD	

First Take Point (FTP)

UL	Section	Township	Range	Lot	Feet	From N/S	Feet	From E/W	County
P	31	23S	29E		100	SOUTH	330	EAST	EDDY
Latitude					Longitude			NAD	
32.2544612					104.0163105			83	

Last Take Point (LTP)

UL	Section	Township	Range	Lot	Feet	From N/S	Feet	From E/W	County
A	30	23S	29E		100	NORTH	330	EAST	EDDY
Latitude					Longitude			NAD	
32.2829075					104.0165954			83	

Is this well the defining well for the Horizontal Spacing Unit?

☐

Is this well an infill well?

☐

If infill is yes please provide API if available, Operator Name and well number for Defining well for Horizontal Spacing Unit.

API #

Operator Name:

Property Name:

Well Number

KZ 06/29/2018

Devon Energy Production Company, L.P.

Unorthodox Location Notice Plat

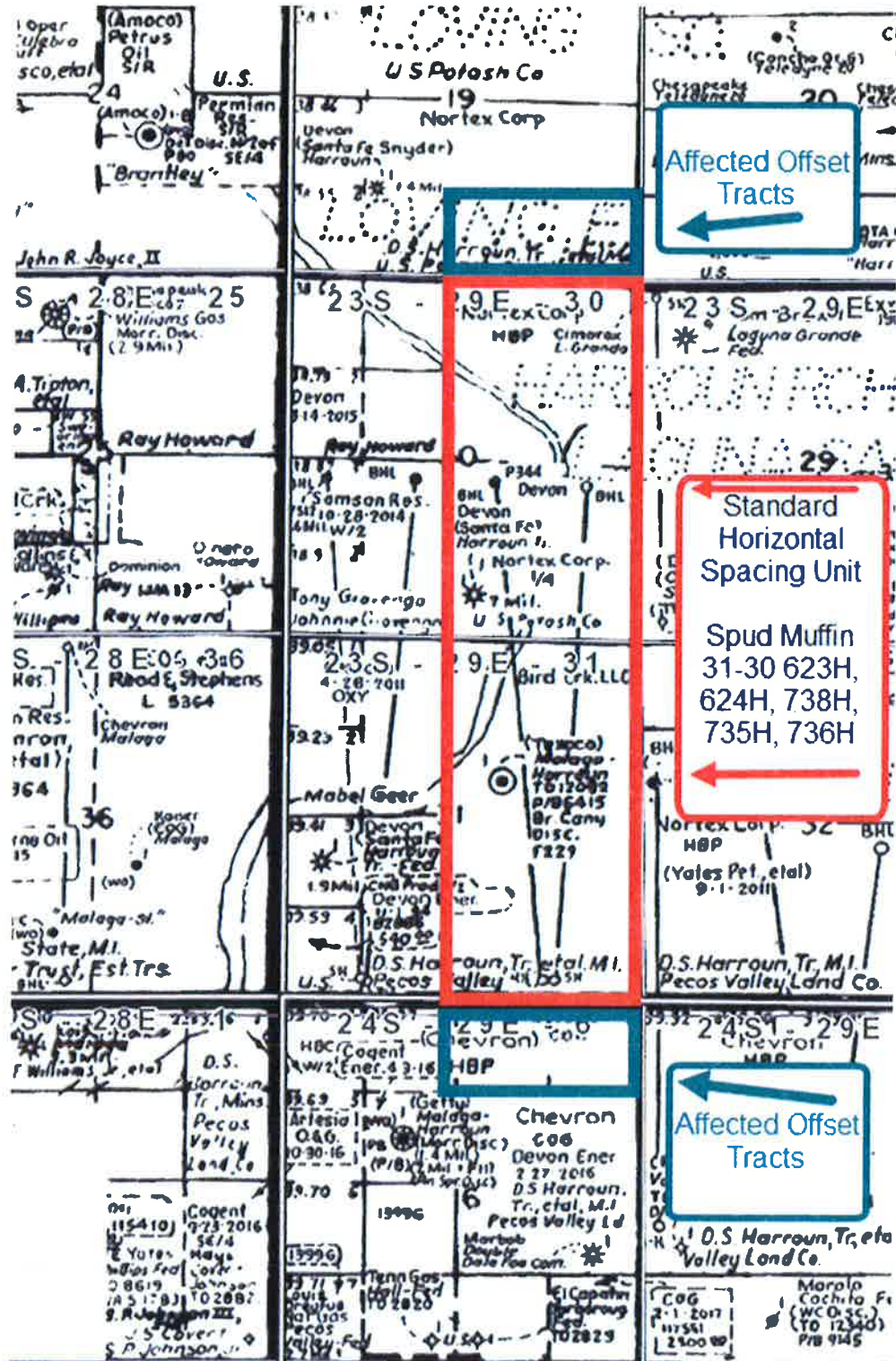



Devon Energy Production Company, L.P.
333 West Sheridan Avenue
Oklahoma City, OK 73102-5015

Application Non-Standard Location - Address List

Devon Energy Production Company, L.P.

Spud Muffin 31-30 623H

Spud Muffin 31-30 624H

Spud Muffin 31-30 735H

Spud Muffin 31-30 736H

Spud Muffin 31-30 738H

T23S-R29E

Section 19 - Units O, P

Eddy County, NM

Kaiser-Francis Oil Company

6733 South Yale Avenue

Tulsa, OK 74136

T24S-R29E

Section 6 - Units B, A

Eddy County, NM

OXY USA, Inc.

5 Greenway Plaza, Suite 110

Houston, TX 77046

Additional Addresses:

New Mexico Oil Conservation Division

1220 South St. Francis Dr.

Santa Fe, NM 87505

Bureau of Land Management

620 E. Greene Street

Carlsbad, NM 88220-6292



Shipment Confirmation Acceptance Notice

A. Mailer Action

Note to Mailer: The labels and volume associated to this form online, **must** match the labeled packages being presented to the USPS® employee with this form.

Devon Energy - 8 NSL Applications
CM# 41132.0002 20190108
notice List

Shipment Date: 01/07/2019

Shipped From:

Name: HOLLAND & HART LLP

Address: 110 N GUADALUPE ST # 1

City: SANTA FE

State: NM ZIP+4® 87501

Type of Mail	Volume
Priority Mail Express®	
Priority Mail®	0
First-Class Package Service®	
Returns	
International*	
Other	3
Total	3

*Start time for products with service guarantees will begin when mail arrives at the local Post Office™ and items receive individual processing and acceptance scans.

B. USPS Action

Note to RSS Clerk:

1. Home screen > Mailing/Shipping > More
2. Select Shipment Confirm
3. Scan or enter the barcode/label number from PS Form 5630
4. Confirm the volume count message by selecting Yes or No
5. Select Pay and End Visit to complete transaction

USPS EMPLOYEE: Please scan upon pickup or receipt of mail.
Leave form with customer or in customer's mail receptacle.

USPS SCAN AT ACCEPTANCE



9275 0901 1935 6200 0012 0540 83



Firm Mailing Book For Accountable Mail

Name and Address of Sender Holland & Hart LLP 110 N Guadalupe St # 1 Santa Fe NM 87501		Check type of mail or service <input type="checkbox"/> Adult Signature Required <input type="checkbox"/> Adult Signature Restricted Delivery <input checked="" type="checkbox"/> Certified Mail <input type="checkbox"/> Certified Mail Restricted Delivery <input type="checkbox"/> Collect on Delivery (COD) <input type="checkbox"/> Insured Mail <input type="checkbox"/> Priority Mail		Priority Mail Express <input type="checkbox"/> Registered Mail <input type="checkbox"/> Return Receipt for Merchandise <input type="checkbox"/> Signature Confirmation <input type="checkbox"/> Signature Confirmation Restricted Delivery		Affix Stamp Here (if issued as an international certificate of mailing or for additional copies of this receipt). Postmark with Date of Receipt.									
USPS Tracking/Article Number	Addressee (Name, Street, City, State, & ZIP Code™)	Postage	(Extra Service) Fee	Handling Charge	Actual Value if Registered	Insured Value	Due Sender if COD	ASR Fee	ASRD Fee	RD Fee	RR Fee	SC Fee	SCRD Fee	SH Fee	
1. 9214 8901 9403 8377 0825 26	BUREAU OF LAND MANAGEMENT CARLSBAD DISTRICT OFFICES 620 E GREENE STREET CARLSBAD NM 88220	3.52	3.45	Handling Charge - if Registered and over \$50,000 in value							1.50				
2. 9214 8901 9403 8377 0825 57	KAISER-FRANCIS OIL COMPANY 6733 S YALE AVE TULSA OK 74136-3302	3.52	3.45									1.50			
3. 9214 8901 9403 8377 0826 18	OXY USA INC 5 GREENWAY PLZ STE 110 HOUSTON TX 77046-0521	3.52	3.45									1.50			
													Signature Confirmation Restricted Delivery		
												Return Receipt			
												Signature Confirmation			
												Restricted Delivery			
												Adult Signature Required			
												Adult Signature Restricted Delivery			
												Special Handling			

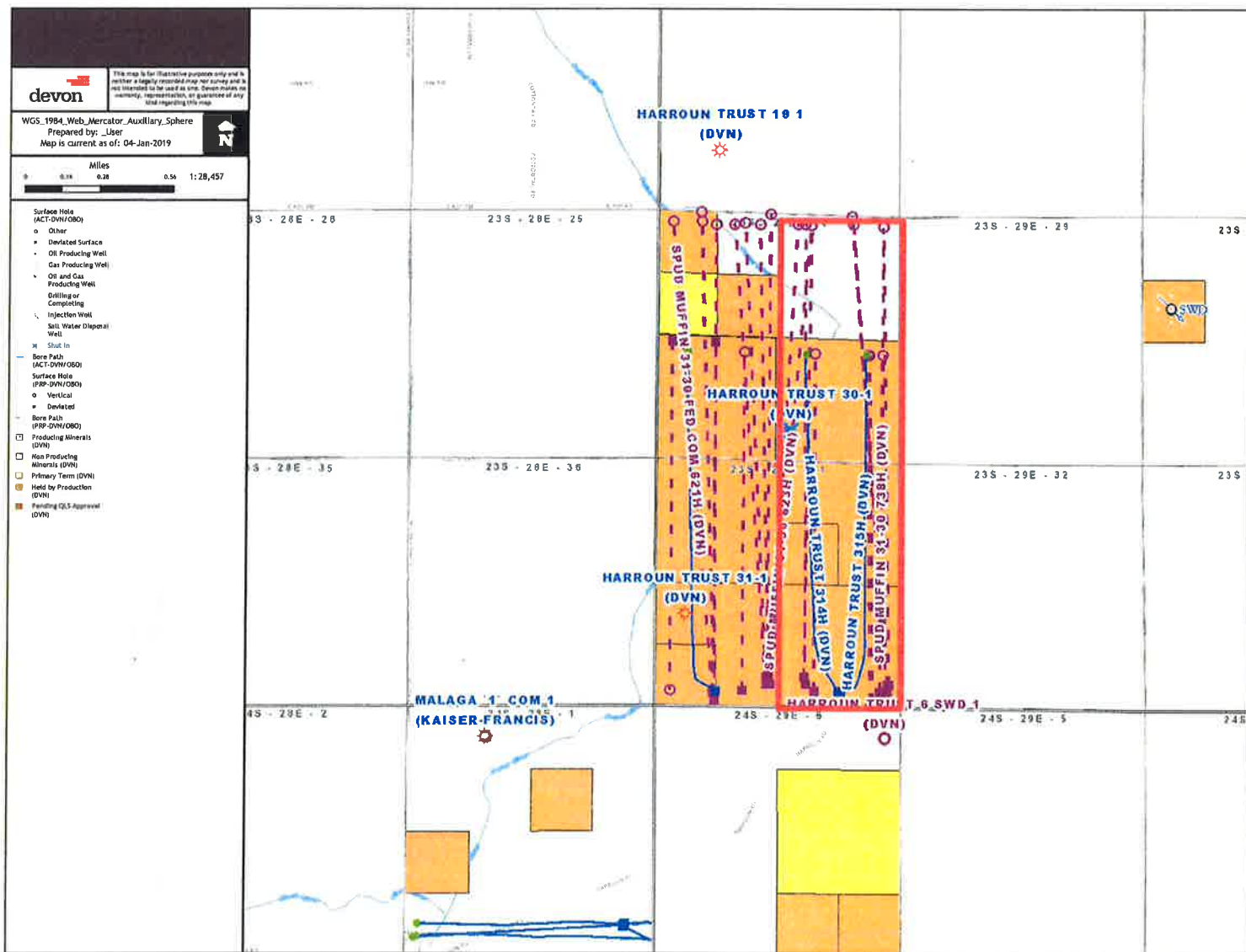

Lowe, Leonard, EMNRD

From: Adam Rankin <AGRankin@hollandhart.com>
Sent: Tuesday, January 8, 2019 12:05 PM
To: McMillan, Michael, EMNRD; Lowe, Leonard, EMNRD
Subject: [EXT] Devon - NSL applications
Attachments: NSL DEVON 736H_001.pdf; NSL DEVON SPUD 622H_001.pdf; NSL DEVON SPUD 621H_001.pdf; NSL DEVON SPUD 734H_001.pdf; NSL DEVON SPUD 623H_001.pdf; NSL DEVON SPUD 624H_001.pdf; NSL DEVON SPUD 735H_001.pdf; NSL DEVON SPUD 738H_001.pdf

Follow Up Flag: Follow up
Flag Status: Flagged

Mike and Leonard,

We hand-delivered the attached NSL applications on behalf of Devon this morning. These are all Purple Sage-WC pool NSLs seeking approval to be 100 feet from the toe and heel. Please let us know if you have any questions.

Very best,
Adam

Adam G. Rankin
Holland & Hart LLP
110 North Guadalupe Suite 1
P.O. Box 2208
Santa Fe, NM 87504
Office: (505) 988-4421
Direct: (505) 954-7294
Cell: (505) 570-0377
Fax (505) 983-6043
E-mail: agrankin@hollandhart.com
[Download vCard](#)
[Web Bio](#)



CONFIDENTIALITY NOTICE: This message is confidential and may be privileged. If you believe that this email has been sent to you in error, please reply to the sender that you received the message in error; then please delete this e-mail. Thank you.

Lowe, Leonard, EMNRD

From: Hammond, Joe <Joe.Hammond@dvn.com>
Sent: Thursday, January 10, 2019 3:44 PM
To: Lowe, Leonard, EMNRD
Subject: [EXT] RE: [EXTERNAL] FW: Devon - NSL applications

Hello Mr. Lowe, so sorry for the confusion on the Spud Muffin NSL requests.

If I understand correctly, the information you are requesting from your email below is:

Well: Spud Muffin 31-30 736H
HSU Location: E/2 Sections 31 and 30, T23S-R29E
Dedicated Acres: 640
First Take Point: 100' FSL, 1254' FEL, Unit P, Sec 31
Last Take Point: 100'FNL, 1254' FEL, Unit A, Sec 30

Well: Spud Muffin 31-30 722H
HSU Location: W/2 Sections 31 and 30, T23S-R29E
Dedicated Acres: 632.38
First Take Point: 100' FSL, 1870' FWL, Unit N, Sec 31
Last Take Point: 100'FNL, 1870' FWL, Unit C, Sec 30

Well: Spud Muffin 31-30 621H
HSU Location: W/2 Sections 31 and 30, T23S-R29E
Dedicated Acres: 632.38
First Take Point: 100' FSL, 330' FWL, Unit M, Sec 31
Last Take Point: 100'FNL, 330' FWL, Unit D, Sec 30

Well: Spud Muffin 31-30 623H
HSU Location: W/2 Sections 31 and 30, T23S-R29E
Dedicated Acres: 632.38
First Take Point: 100' FSL, 2178' FWL, Unit N, Sec 31
Last Take Point: 100'FNL, 2178' FWL, Unit C, Sec 30

Well: Spud Muffin 31-30 623H
HSU Location: E/2 Sections 31 and 30, T23S-R29E
Dedicated Acres: 640
First Take Point: 100' FSL, 1870' FEL, Unit O, Sec 31
Last Take Point: 100'FNL, 1870' FEL, Unit B, Sec 30

Well: Spud Muffin 31-30 624H
HSU Location: E/2 Sections 31 and 30, T23S-R29E
Dedicated Acres: 640
First Take Point: 100' FSL, 380' FEL, Unit P, Sec 31
Last Take Point: 100'FNL, 380' FEL, Unit A, Sec 30

Well: Spud Muffin 31-30 735H
HSU Location: E/2 Sections 31 and 30, T23S-R29E
Dedicated Acres: 640

First Take Point: 100' FSL, 2178' FEL, Unit O, Sec 31

Last Take Point: 100'FNL, 2178' FEL, Unit B, Sec 30

Well: Spud Muffin 31-30 738H

HSU Location: E/2 Sections 31 and 30, T23S-R29E

Dedicated Acres: 640

First Take Point: 100' FSL, 330' FEL, Unit P, Sec 31

Last Take Point: 100'FNL, 330' FEL, Unit A, Sec 30

If I have inadvertently left something off again, please advise accordingly.

I haven't done a whole lot of NSL's requests.

Thank you.

Joe Hammond

Land Advisor

Devon Energy

333 West Sheridan Avenue

Oklahoma City, OK 73102-5010

(405) 552-8102 Direct

(405) 823-4791 Cell



Devon - Internal

From: Lowe, Leonard, EMNRD [mailto:Leonard.Lowe@state.nm.us]

Sent: Wednesday, January 09, 2019 1:08 PM

To: Hammond, Joe <Joe.Hammond@devon.com>

Subject: [EXTERNAL] FW: Devon - NSL applications

Importance: High

Mr. Joe Hammond,

Please provide for all submitted NSLs to my attention. You may e-mail them.

Leonard Lowe

Engineering Bureau

Oil Conservation Division

Energy Minerals and Natural Resources Department

1220 South St. Frances

Santa Fe, New Mexico 87004

Office: 505-476-3492

Cell: 505-930-6717

Fax: 505-476-3462

E-mail: leonard.lowe@state.nm.us

Website: <http://www.emnrd.state.nm.us/ocd/>

From: Lowe, Leonard, EMNRD
Sent: Wednesday, January 9, 2019 9:53 AM
To: 'Adam Rankin' <AGRankin@hollandhart.com>; McMillan, Michael, EMNRD <Michael.McMillan@state.nm.us>
Subject: RE: Devon - NSL applications

Mr. Adam Rankin,

What are the FTP & LTP? The C-102 is not as clear.

What is the location subject Horizontal Spacing Unit? What is the acreage?

This pertains to all of the submitted NSL applications. Please submit a letter identifying these and all information pertaining to the NSL request for all the submitted Administrative Applications.

Leonard Lowe

Engineering Bureau
Oil Conservation Division
Energy Minerals and Natural Resources Department
1220 South St. Frances
Santa Fe, New Mexico 87004
Office: 505-476-3492
Cell: 505-930-6717
Fax: 505-476-3462
E-mail: leonard.lowe@state.nm.us
Website: <http://www.emnrd.state.nm.us/ocd/>

From: Adam Rankin <AGRankin@hollandhart.com>
Sent: Tuesday, January 8, 2019 12:05 PM
To: McMillan, Michael, EMNRD <Michael.McMillan@state.nm.us>; Lowe, Leonard, EMNRD <Leonard.Lowe@state.nm.us>
Subject: [EXT] Devon - NSL applications

Mike and Leonard,

We hand-delivered the attached NSL applications on behalf of Devon this morning. These are all Purple Sage-WC pool NSLs seeking approval to be 100 feet from the toe and heel. Please let us know if you have any questions.

Very best,
Adam

Adam G. Rankin
Holland & Hart LLP
110 North Guadalupe Suite 1
P.O. Box 2208
Santa Fe, NM 87504
Office: (505) 988-4421
Direct: (505) 954-7294
Cell: (505) 570-0377
Fax (505) 983-6043
E-mail: agrarkin@hollandhart.com
[Download vCard](#)

Lowe, Leonard, EMNRD

From: Lowe, Leonard, EMNRD
Sent: Thursday, February 7, 2019 8:30 AM
To: 'Hammond, Joe'
Cc: Mike Bratcher (mike.bratcher@state.nm.us); Cordero, Gilbert, EMNRD; 'lisa@rwbyram.com'; Jones, William V, EMNRD; Dawson, Scott, EMNRD; Murphy, Kathleen A, EMNRD; McMillan, Michael, EMNRD; Goetze, Phillip, EMNRD; 'jglover@blm.gov'
Subject: APPROVED 8 NSLs_Devon Energy Production Company, L.P._8 - Spud Muffin Wells_SEC 31 30 23S 29E

Importance: High

Mr. Joe Hammon,

The following administrative orders have been issued and will soon be available on the Division's web site:
<http://ocdimage.emnrd.state.nm.us/Imaging/Default.aspx>

DEVON ENERGY PRODUCTION COMPANY, L.P. [6137] POOL: Purple Sage; Wolfcamp [# 98220]

WELL NAME	API Number
Spud Muffin 31 30 Well No. 738H	30-015-44757
Spud Muffin 31 30 Well No. 736H	30-015-44755
Spud Muffin 31 30 Well No. 735H	30-015-44754
Spud Muffin 31 30 Com Well No. 734H	30-015-44753
Spud Muffin 31 30 Well No. 624H	30-015-45268
Spud Muffin 31 30 Well No. 623H	30-015-45267
Spud Muffin 31 30 Com Well No. 622H	30-015-45266
Spud Muffin 31 30 Federal Com Well No. 621H	30-015-45460

Leonard Lowe

Engineering Bureau
Oil Conservation Division
Energy Minerals and Natural Resources Department
1220 South St. Frances
Santa Fe, New Mexico 87004
Office: 505-476-3492
Cell: 505-930-6717
Fax: 505-476-3462
E-mail: leonard.lowe@state.nm.us
Website: <http://www.emnrd.state.nm.us/ocd/>