

Initial Application Part I

Received: 06/14/2019

This application is placed in file for record. It MAY or MAY NOT have been reviewed to be determined Administratively Complete

RECEIVED: 06/14/2019	REVIEWER:	TYPE: SWD	APP NO: pMAM1916549246
-------------------------	-----------	-----------	---------------------------

ABOVE THIS TABLE FOR OCD DIVISION USE ONLY

NEW MEXICO OIL CONSERVATION DIVISION
 - Geological & Engineering Bureau -
 1220 South St. Francis Drive, Santa Fe, NM 87505

**ADMINISTRATIVE APPLICATION CHECKLIST**

THIS CHECKLIST IS MANDATORY FOR ALL ADMINISTRATIVE APPLICATIONS FOR EXCEPTIONS TO DIVISION RULES AND
 REGULATIONS WHICH REQUIRE PROCESSING AT THE DIVISION LEVEL IN SANTA FE

Applicant: Mewbourne Oil Company	OGRID Number: 14744
Well Name: Hopi 32 SWD #1	API: 30-015-pending
Pool: SWD: DEVONIAN	Pool Code: 96101

**SUBMIT ACCURATE AND COMPLETE INFORMATION REQUIRED TO PROCESS THE TYPE OF APPLICATION
 INDICATED BELOW**

- 1) **TYPE OF APPLICATION:** Check those which apply for [A]
 A. Location – Spacing Unit – Simultaneous Dedication
☐ NSL ☐ NSP (PROJECT AREA) ☐ NSP (PRORATION UNIT) ☐ SD **SWD-2155**

B. Check one only for [I] or [II]

[I] Commingling – Storage – Measurement

☐ DHC ☐ CTB ☐ PLC ☐ PC ☐ OLS ☐ OLM

[II] Injection – Disposal – Pressure Increase – Enhanced Oil Recovery

☐ WFX ☐ PMX ☒ SWD ☐ IPI ☐ EOR ☐ PPR

- 2) **NOTIFICATION REQUIRED TO:** Check those which apply.

- A. ☒ Offset operators or lease holders
 B. ☐ Royalty, overriding royalty owners, revenue owners
 C. ☒ Application requires published notice
 D. ☐ Notification and/or concurrent approval by SLO
 E. ☐ Notification and/or concurrent approval by BLM
 F. ☒ Surface owner
 G. ☒ For all of the above, proof of notification or publication is attached, and/or,
 H. ☐ No notice required

FOR OCD ONLY

- ☐ Notice Complete
☐ Application
 Content
 Complete

- 3) **CERTIFICATION:** I hereby certify that the information submitted with this application for administrative approval is **accurate** and **complete** to the best of my knowledge. I also understand that **no action** will be taken on this application until the required information and notifications are submitted to the Division.

Note: Statement must be completed by an individual with managerial and/or supervisory capacity.

Timothy R. Harrington

Print or Type Name

Signature

May 10, 2019

Date

903-534-7647

Phone Number

tharrington@mewbourne.com

e-mail Address

McMillan, Michael, EMNRD

From: Tim Harrington <tharrington@mewbourne.com>
Sent: Wednesday, June 19, 2019 2:55 PM
To: McMillan, Michael, EMNRD
Subject: [EXT] FW: HOPI 32 SWD RETURN RECEIPTS
Attachments: Hopi 32 SWD State & Fed Minerals.pdf

FYI.

Tim Harrington
Reservoir Engineer
Mewbourne Oil Company
3620 Old Bullard Road
PO Box 7698
Tyler, TX 75701

W- 903-561-2900 (Ext 7647)
C – 832-217-6852
tharrington@mewbourne.com

From: Tim Harrington
Sent: Friday, June 14, 2019 3:37 PM
To: McMillan, Michael, EMNRD <Michael.McMillan@state.nm.us>
Subject: RE: HOPI 32 SWD RETURN RECEIPTS

There are no Federal or State Minerals within 1 mile radius of our proposed well. Attached is a map and an updated Offset Operator Map with a dot at the well location. Thanks.

Tim Harrington
Reservoir Engineer
Mewbourne Oil Company
3620 Old Bullard Road
PO Box 7698
Tyler, TX 75701

W- 903-561-2900 (Ext 7647)
C – 832-217-6852
tharrington@mewbourne.com

From: McMillan, Michael, EMNRD <Michael.McMillan@state.nm.us>
Sent: Friday, June 14, 2019 1:21 PM
To: Tim Harrington <tharrington@mewbourne.com>
Subject: RE: HOPI 32 SWD RETURN RECEIPTS

Your tract map was not clear that showed affected parties

Mike

Michael McMillan
1220 South St. Francis
Santa Fe, New Mexico
505-476-3448
Michael.mcmillan@state.nm.us

From: Tim Harrington <tharrington@mewbourne.com>
Sent: Friday, June 14, 2019 12:19 PM
To: McMillan, Michael, EMNRD <Michael.McMillan@state.nm.us>
Subject: [EXT] HOPI 32 SWD RETURN RECEIPTS

Mike:

Here they are. Have a good weekend. Thanks.

Tim Harrington
Reservoir Engineer
Mewbourne Oil Company
3620 Old Bullard Road
PO Box 7698
Tyler, TX 75701

W- 903-561-2900 (Ext 7647)
C – 832-217-6852
tharrington@mewbourne.com

MEWBOURNE OIL COMPANY
HOPI 32 SWD #1
SWD PERMIT APPLICATION

LIST OF ATTACHMENTS:

Administrative Checklist

Form C-108

Hopi 32 SWD #1 well schematic

Hopi 32 SWD #1 survey plat

Well Plat

Tabulation of wells within 1 mile radius (NOTE: no wells currently penetrate the Devonian)

Surface Ownership Map

Fresh Water well map

Tabulation of nearby fresh water wells – (Source: NM Office of the State Engineer)

Fresh Water Well Water Analysis

Producing Well Water Analysis – Wolfcamp, & Bone Spring

Offset Operator Map

Listing of Notified Persons

Affidavit of Publication – Carlsbad Current-Argus

Hydrologic Affirmation

Seismicity Statement

Historical Seismicity, Fault Map and Devonian SWD Offset Map

Distance to Offsetting Devonian SWD Wells

Geological Cross Section

Plugging Assessment

APPLICATION FOR AUTHORIZATION TO INJECT

- I. PURPOSE: Secondary Recovery Pressure Maintenance X Disposal Storage
Application qualifies for administrative approval? X Yes No
- II. OPERATOR: **Mewbourne Oil Company**
ADDRESS: **3620 Old Bullard Road**
Tyler, TX 79701
CONTACT PARTY: **Tim Harrington** PHONE: **903-534-7647**
- III. WELL DATA: Complete the data required on the reverse side of this form for each well proposed for injection.
Additional sheets may be attached if necessary.
- IV. Is this an expansion of an existing project? Yes X No
If yes, give the Division order number authorizing the project: _____
- V. Attach a map that identifies all wells and leases within two miles of any proposed injection well with a one-half mile radius circle drawn around each proposed injection well. This circle identifies the well's area of review.
- VI. Attach a tabulation of data on all wells of public record within the area of review which penetrate the proposed injection zone. Such data shall include a description of each well's type, construction, date drilled, location, depth, record of completion, and a schematic of any plugged well illustrating all plugging detail.
- VII. Attach data on the proposed operation, including:
1. Proposed average and maximum daily rate and volume of fluids to be injected;
 2. Whether the system is open or closed;
 3. Proposed average and maximum injection pressure;
 4. Sources and an appropriate analysis of injection fluid and compatibility with the receiving formation if other than reinjected produced water; and,
 5. If injection is for disposal purposes into a zone not productive of oil or gas at or within one mile of the proposed well, attach a chemical analysis of the disposal zone formation water (may be measured or inferred from existing literature, studies, nearby wells, etc.).
- *VIII. Attach appropriate geologic data on the injection zone including appropriate lithologic detail, geologic name, thickness, and depth. Give the geologic name, and depth to bottom of all underground sources of drinking water (aquifers containing waters with total dissolved solids concentrations of 10,000 mg/l or less) overlying the proposed injection zone as well as any such sources known to be immediately underlying the injection interval.
- IX. Describe the proposed stimulation program, if any.
- *X. Attach appropriate logging and test data on the well. (If well logs have been filed with the Division, they need not be resubmitted).
- *XI. Attach a chemical analysis of fresh water from two or more fresh water wells (if available and producing) within one mile of any injection or disposal well showing location of wells and dates samples were taken.
- XII. Applicants for disposal wells must make an affirmative statement that they have examined available geologic and engineering data and find no evidence of open faults or any other hydrologic connection between the disposal zone and any underground sources of drinking water.
- XIII. Applicants must complete the "Proof of Notice" section on the reverse side of this form.
- XIV. Certification: I hereby certify that the information submitted with this application is true and correct to the best of my knowledge and belief.
- NAME: **Tim Harrington** TITLE: **Reservoir Engineer**
SIGNATURE:  DATE: 5/10/2019
E-MAIL ADDRESS: **tharrington@mewbourne.com**
- * If the information required under Sections VI, VIII, X, and XI above has been previously submitted, it need not be resubmitted. Please show the date and circumstances of the earlier submittal: _____

III. WELL DATA

- A. The following well data must be submitted for each injection well covered by this application. The data must be both in tabular and schematic form and shall include:

- (1) Lease name; Well No.; Location by Section, Township and Range; and footage location within the section.
- (2) Each casing string used with its size, setting depth, sacks of cement used, hole size, top of cement, and how such top was determined.
- (3) A description of the tubing to be used including its size, lining material, and setting depth.
- (4) The name, model, and setting depth of the packer used or a description of any other seal system or assembly used.

Division District Offices have supplies of Well Data Sheets which may be used or which may be used as models for this purpose. Applicants for several identical wells may submit a "typical data sheet" rather than submitting the data for each well.

- B. The following must be submitted for each injection well covered by this application. All items must be addressed for the initial well. Responses for additional wells need be shown only when different. Information shown on schematics need not be repeated.

- (1) The name of the injection formation and, if applicable, the field or pool name.
- (2) The injection interval and whether it is perforated or open-hole.
- (3) State if the well was drilled for injection or, if not, the original purpose of the well.
- (4) Give the depths of any other perforated intervals and detail on the sacks of cement or bridge plugs used to seal off such perforations.
- (5) Give the depth to and the name of the next higher and next lower oil or gas zone in the area of the well, if any.

XIV. PROOF OF NOTICE

All applicants must furnish proof that a copy of the application has been furnished, by certified or registered mail, to the owner of the surface of the land on which the well is to be located and to each leasehold operator within one-half mile of the well location.

Where an application is subject to administrative approval, a proof of publication must be submitted. Such proof shall consist of a copy of the legal advertisement which was published in the county in which the well is located. The contents of such advertisement must include:

- (1) The name, address, phone number, and contact party for the applicant;
- (2) The intended purpose of the injection well; with the exact location of single wells or the Section, Township, and Range location of multiple wells;
- (3) The formation name and depth with expected maximum injection rates and pressures; and,
- (4) A notation that interested parties must file objections or requests for hearing with the Oil Conservation Division, 1220 South St. Francis Dr., Santa Fe, New Mexico 87505, within 15 days.

NO ACTION WILL BE TAKEN ON THE APPLICATION UNTIL PROPER PROOF OF NOTICE HAS BEEN SUBMITTED.

NOTICE: Surface owners or offset operators must file any objections or requests for hearing of administrative applications within 15 days from the date this application was mailed to them.

INJECTION WELL DATA SHEET

OPERATOR: **Mewbourne Oil Company**WELL NAME & NUMBER: **Hopi 32 SWD #1**

WELL LOCATION:	<u>2411' FNL & 2188' FWL</u>	<u>F</u>	<u>32</u>	<u>22S</u>	<u>27E</u>
	FOOTAGE LOCATION	UNIT LETTER	SECTION	TOWNSHIP	RANGE

WELLBORE SCHEMATIC (See Attached)WELL CONSTRUCTION DATASurface CasingHole Size: **26"** Casing Size: **20" (94 #) @ 350'**Cement with: **575 sx (100% excess)** Top of Cement: **Surface**Intermediate CasingHole Size: **17 1/2"** Casing Size: **13 3/8" (54.5#) @ 1,975'**Stage 1: **950 sx (25% excess)** Top of Cement: **Surface (Calculated)**Production CasingHole Size: **12 1/4"** Casing Size: **9 5/8" (40 & 43.5#) @ 8,850'**Stage 1: **1440 sx** Top of Cement: **Surface (Calculated)**Stage 2: **490 sx** **DV Tool @ 2,025'**
Top of Cement: **Surface (Calculated)**Production LinerHole Size: **8 1/2"** Casing Size: **7 5/8" (39#)**
Top @ 8,650'
Bottom @ 12,750'Cement with: **285 sx (25% excess)** Top of Cement: **8,650'**
(Proposed: circulated to liner top)**TD @ 13,775'**Permitted Injection Interval 12,750'-13,775'

INJECTION WELL DATA SHEET

Tubing Size: 7" x 5 ½" Lining Material: **Duoline**
7", P110 UFJ GB to approximately 8,600'
5 1/2", P110 UFJ GB to 12,670'

Type of Packer: 3 ½" x 7 5/8" **Model R Packer (Inconel)**

Packer Setting Depth: +/- 12,670'

Other Type of Tubing/Casing Seal (if applicable): N/A

Additional Data

1. Is this a new well drilled for injection? **Yes**

If no, for what purpose was the well originally drilled? **NA**

2. Name of the Injection Formation: **Devonian - Open Hole Completion**

3. Name of Field or Pool (if applicable): **96101 SWD; Devonian**

4. Has the well ever been perforated in any other zone(s)? **No.**

5. Give the name and depths of any oil or gas zones underlying or overlying the proposed injection zone in this area:

Overlying potentially productive zone tops – **Delaware (2,050'), Bone Spring (5,350'), Wolfcamp (8,800'), & Morrow (10,050')**

Underlying producing zone – **N/A**

HOP1 32 SWD #1
Additional Details

VI. There are no wells penetrating the disposal formation within the area of review.

VII. 1. Proposed average rate of 20,000 bwpd and maximum rate of 35,000 bwpd.

2. Non-commercial SWD (closed system).

3. Proposed average injection pressure is unknown and the maximum injection pressure is approximately 2,550 psi (0.2 psi/ft x 12,750 ft).

4. This well is being permitted as a private SWD, therefore all the injected fluid will be formation water from Mewbourne Oil Company operated wells currently producing or planned in the area. Representative water samples from the Wolfcamp and Bone Spring formations are attached.

5. We will be injecting into the Devonian formation. Devonian formation water is known to be compatible with the formation water of the Bone Spring and Wolfcamp. No Devonian water analysis are available within the immediate area. The following data is the closest produced water analysis that is available on the USGS

IDUSGS	IDORIG	IDDB	SOURCE	LATITUDE	LONGITUDE	API	COUNTY	FIELD	WELLNAME	TOWNRANGE	
35292	30000310	USGSBREIT	Pan American Petroleum Corporation	32.183	-103.7766	30015108590000	Eddy	Poker Lake South	Poker Lake Unit #36	S 24 E 31 28	
DATESAMPLE	METHOD	FORMATION	DEPTHUPPER	DEPTHLOWER	SG	SPGRAV	RESIS	RESIST	PH	TDSUSGS	TDS
1967-04-06	Separator	Devonian	16578	16660	1.086	1.086	0.067	77	6.6	120326	120326

VIII. 1. The proposed injection interval is within the Devonian formation which is a porous dolomitic limestone from 12,750' to 13,775'. It is estimated that the base of the injection interval should be approximately 625' above the top of the Ellenburger.

Other Projected Formation Tops:

Mississippian	12,300'
Woodford	12,700'
Devonian	12,750'
EST TOTAL DEPTH	13,775'
Montoya	13,800'
Simpson	14,100'
Ellenburger	14,400'

2. The underground fresh water aquifers (unnamed) are present at shallow depths (per review of well records, within 2 miles of the proposed SWD, on the NM Office of the State Engineers website) with the deepest water being encountered at a depth of 200', the shallowest water at a depth of 31' and the average water depth at 97'. There are no known fresh water intervals underlying the injecting formation.

IX. The proposed stimulation is an open-hole acid treatment of 30,000 gallons of 15% HCL.

- IX.** A gamma-ray / neutron log will be run from TD to surface upon the drilling and completion of proposed well.
- X.** There were numerous fresh water wells on record with the NM State Engineers Office that are within 2 miles of the proposed SWD and a tabulation of these wells is attached. A fresh water sample was taken from a well owned and operated by the Hopi 32 SWD surface owner, and a copy of the analysis is attached.
- XI.** Mewbourne Oil Company has examined geologic and engineering data and has found that there is no evidence of faulting between the proposed disposal zone and any underground sources of drinking water. A signed affidavit is attached.
- XII.** See attached Proof of Notice

Mewbourne Oil Company

Well Name: Hopi 32 SWD #1
Spud: 2019

Last Updated by T. Harrington: 6/3/2019

20" 94# J-55 BTC
Set @ 350'
Cmt w/ 575 sx

13 3/8" 54.5# J55 & HCL80 STC
Set @ 1975'
Cmt w/ 950 sx

ECP/DV Tool @ 2025'
Cmt 2nd stg w/ 490 sx

9 5/8" 40# & 43.5 HCL80 LTC
Set @ 8850'
Cmt 1st stg w/ 1440 sx

7 5/8" 39# P-110 UFJ Liner
Set from 8650'-12,750'
Cmt w/ 285 sx

6 1/8" Open Hole
TD @ 13,775'

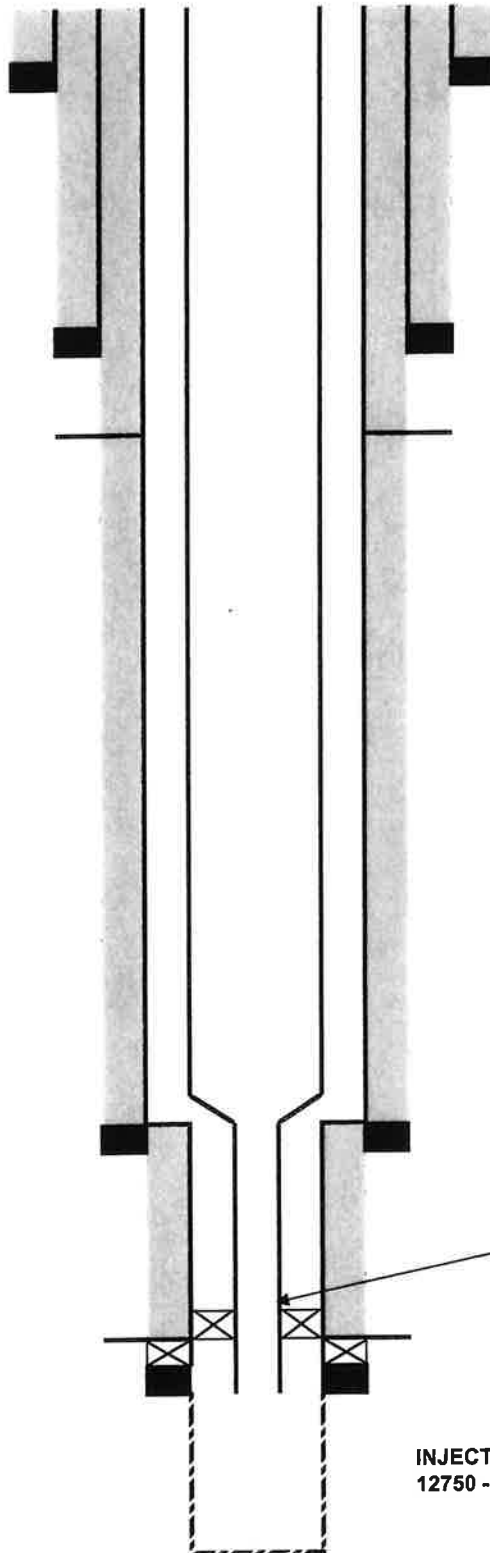

Injection String
7" P110 UFJ GB & 5 1/2" P110 UFJ GB
Nickel-Plated Pkr Set @ 12,670'

DV Tool @ 12,680'
External Csg Pkr Set @ 12,720'

INJECTION ZONE: DEVONIAN
12750 - 13775'

District I
1625 N. French Dr., Hobbs, NM 88240
Phone: (575) 393-6161 Fax: (575) 393-0720
District II
811 S. First St., Artesia, NM 88210
Phone: (575) 748-1283 Fax: (575) 748-9720
District III
1000 Rio Brazos Road, Aztec, NM 87410
Phone: (505) 334-6178 Fax: (505) 334-6170
District IV
1220 S. St. Francis Dr., Santa Fe, NM 87505
Phone: (505) 476-3460 Fax: (505) 476-3462

State of New Mexico
Energy, Minerals & Natural Resources Department
OIL CONSERVATION DIVISION
1220 South St. Francis Dr.
Santa Fe, NM 87505

Form C-102
Revised August 1, 2011
Submit one copy to appropriate
District Office

☐ AMENDED REPORT

WELL LOCATION AND ACREAGE DEDICATION PLAT

1 API Number		2 Pool Code		3 Pool Name	
4 Property Code		5 Property Name HOPI 32 SWD			6 Well Number 1
7 GRID NO.		8 Operator Name MEWBOURNE OIL COMPANY			9 Elevation 3158'

10 Surface Location									
UL or lot no.	Section	Township	Range	Lot Idn	Feet from the	North/South line	Feet From the	East/West line	County
F	32	22S	27E		2411	NORTH	2188	WEST	EDDY

11 Bottom Hole Location If Different From Surface									
UL or lot no.	Section	Township	Range	Lot Idn	Feet from the	North/South line	Feet from the	East/West line	County
12 Dedicated Acres		13 Joint or Infill		14 Consolidation Code		15 Order No.			

No allowable will be assigned to this completion until all interest have been consolidated or a non-standard unit has been approved by the division.

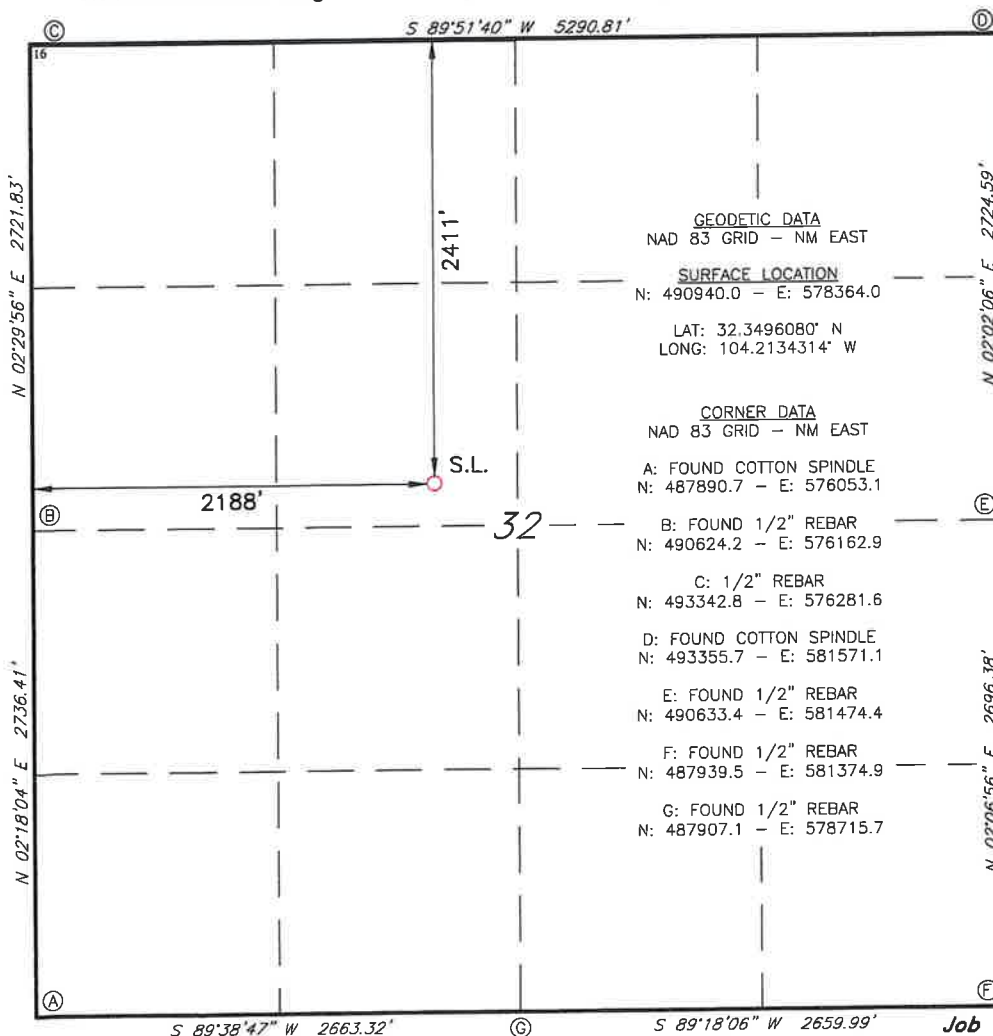

17 OPERATOR CERTIFICATION	
I hereby certify that the information contained herein is true and complete to the best of my knowledge and belief, and that this organization either owns a working interest or unleased mineral interest in the land including the proposed bottom hole location or has a right to drill this well at this location pursuant to a contract with an owner of such a mineral or working interest, or to a voluntary pooling agreement or a compulsory pooling order heretofore entered by the division.	
Signature	Date
Printed Name	
E-mail Address	
18 SURVEYOR CERTIFICATION	
I hereby certify that the well location shown on this plat was plotted from field notes of actual surveys made by me or under my supervision, and that the same is true and correct to the best of my belief.	
5-17-19	
Date of Survey	
Signature and Seal of Professional Surveyor	
19680	
Certificate Number	

Job No.: LS19050591

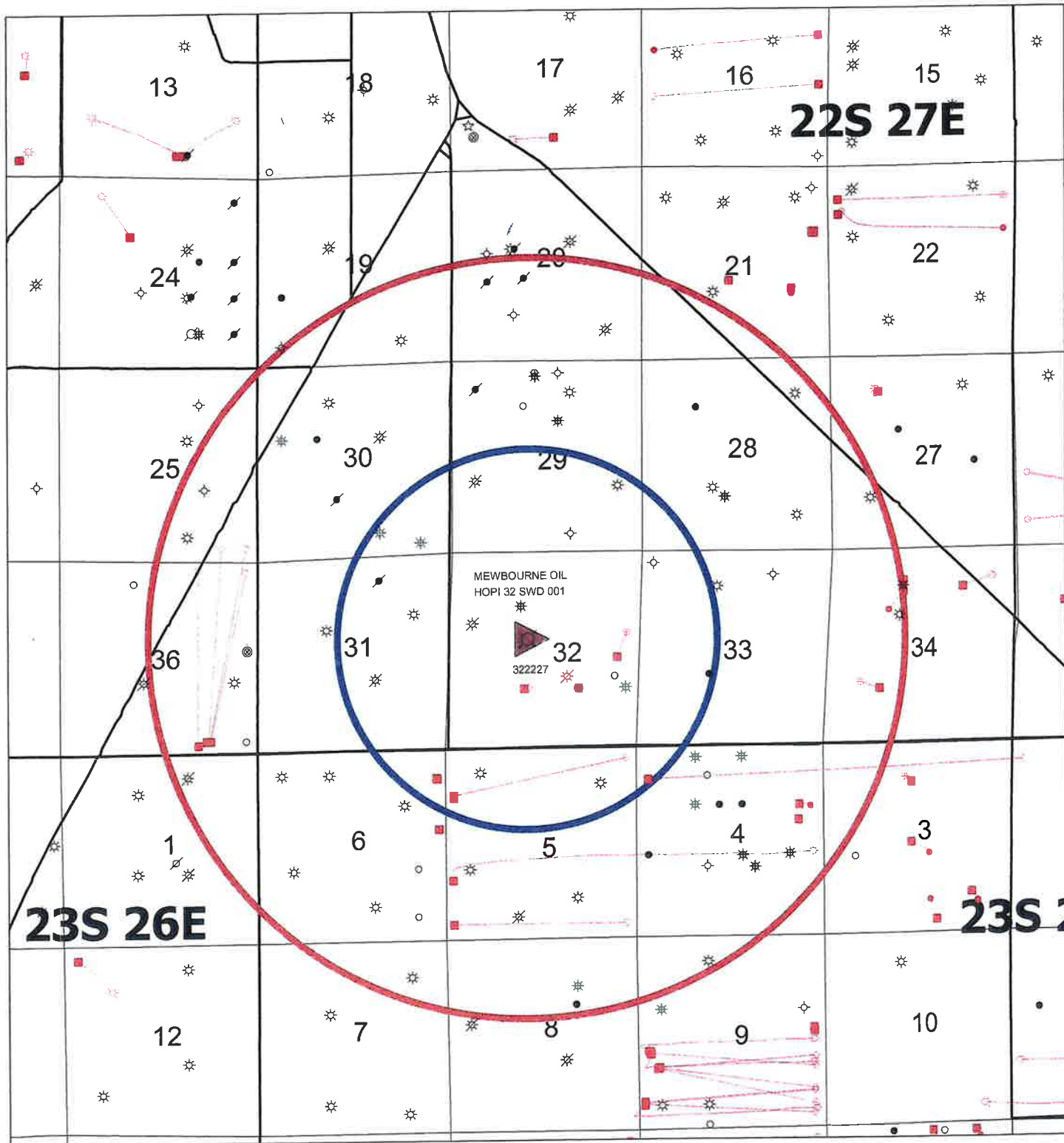

MEWBOURNE OIL
HOPI 32 SWD 001



1 MILE AOR



2 MILE AOR

 Mewbourne Oil Company		
HOPI 32 SWD #1 Sec. 32-22S-27E 2411' FNL & 2188' FWL EDDY, NEW MEXICO		
Tech:		Date:
ed		20 May, 2019
Scale:		
1" = 4000'		

**Mewbourne Oil Company
Hopi 32 SWD #1 Application
Surface Ownership Map
Section 32, Twp 22S, Rge 27E**

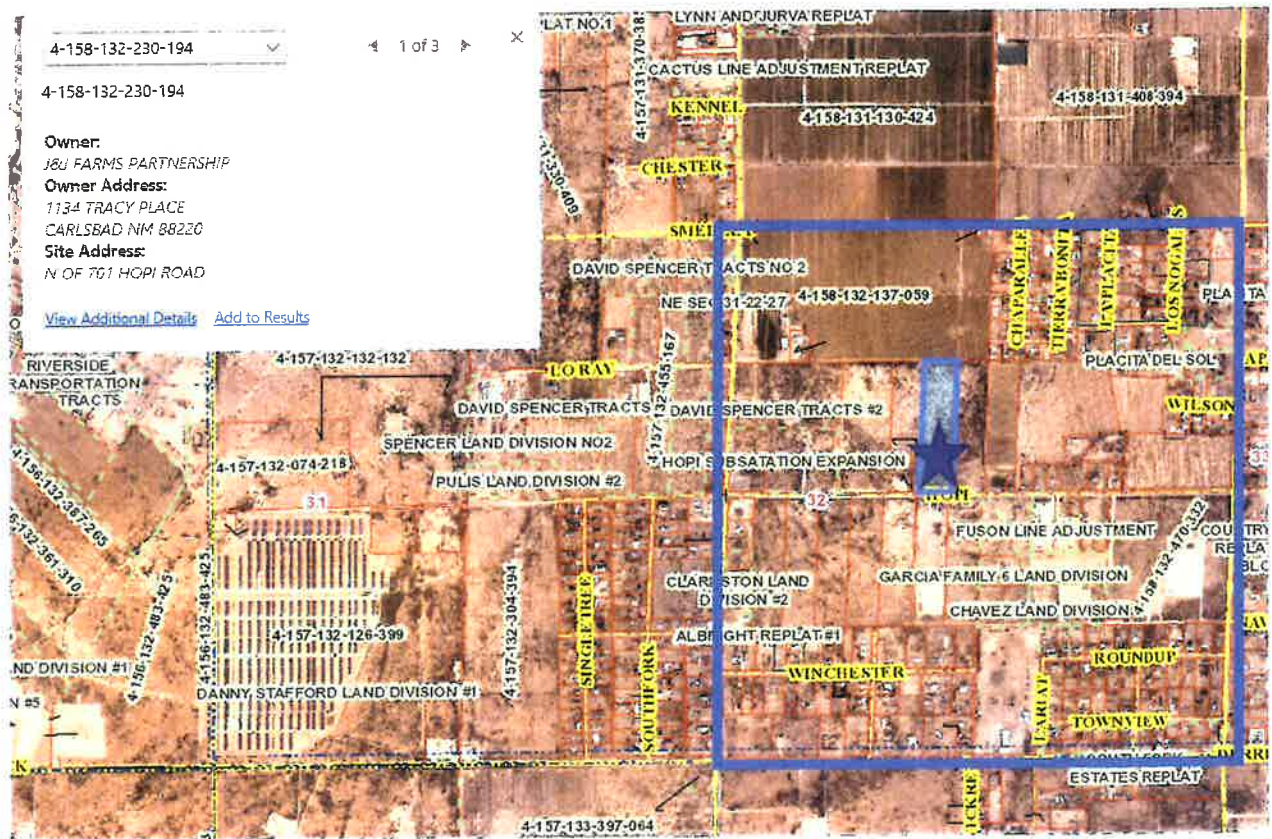

NOTE: Source of data – Eddy County Appraisal District

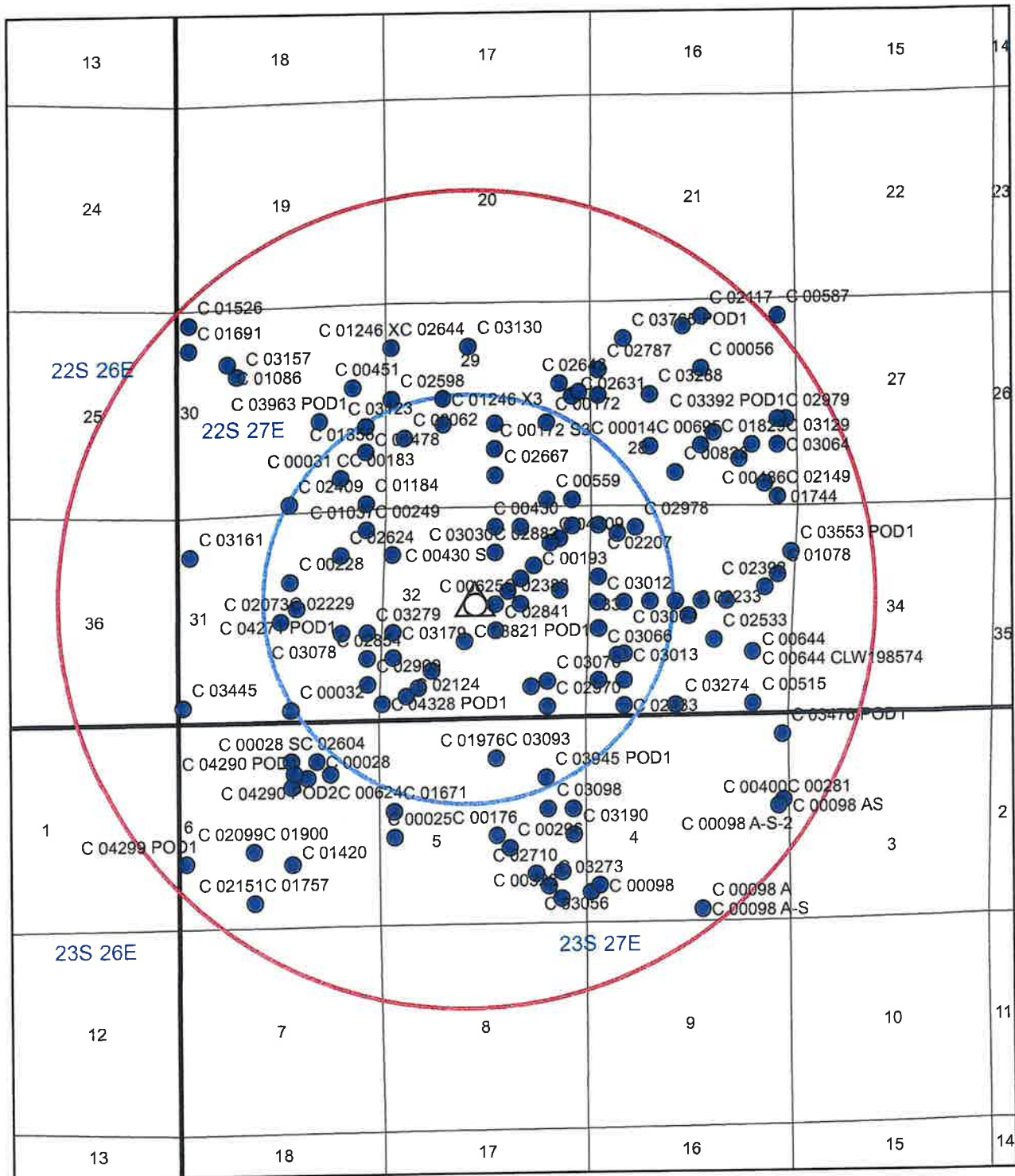

HOPI SWD #1



WATER SOURCE



1 MILE AOR



2 MILE AOR

 Mewbourne Oil Company		
HOPI 32 SWD #1 Sec. 32-22S-27E 2411' FNL & 2188' FWL EDDY, NEW MEXICO		
Tech:		Date:
Steve Daugherty		21 May, 2019
Scale:		
1" = 4000'		

Water Sample information provided by
the N.M Office of the State Engineer

HOPI 32 SWD #1
S-32, T-22S, R-27E

State and Federal Minerals Map

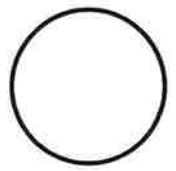

One Mile
Radius

NOTE: Source of Data
New Mexico State Land
Office GIS Map



NMSLO



FEDERAL

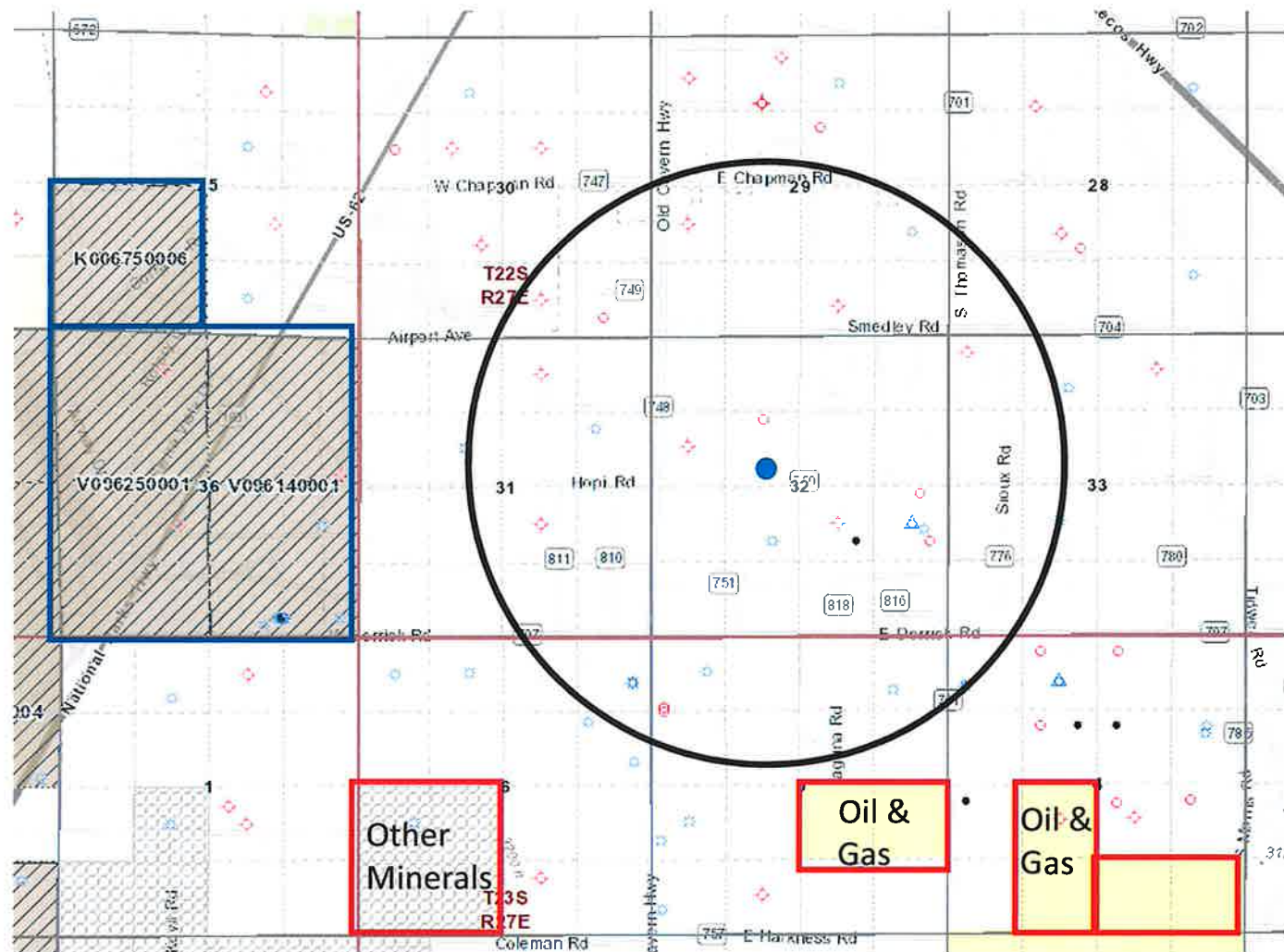

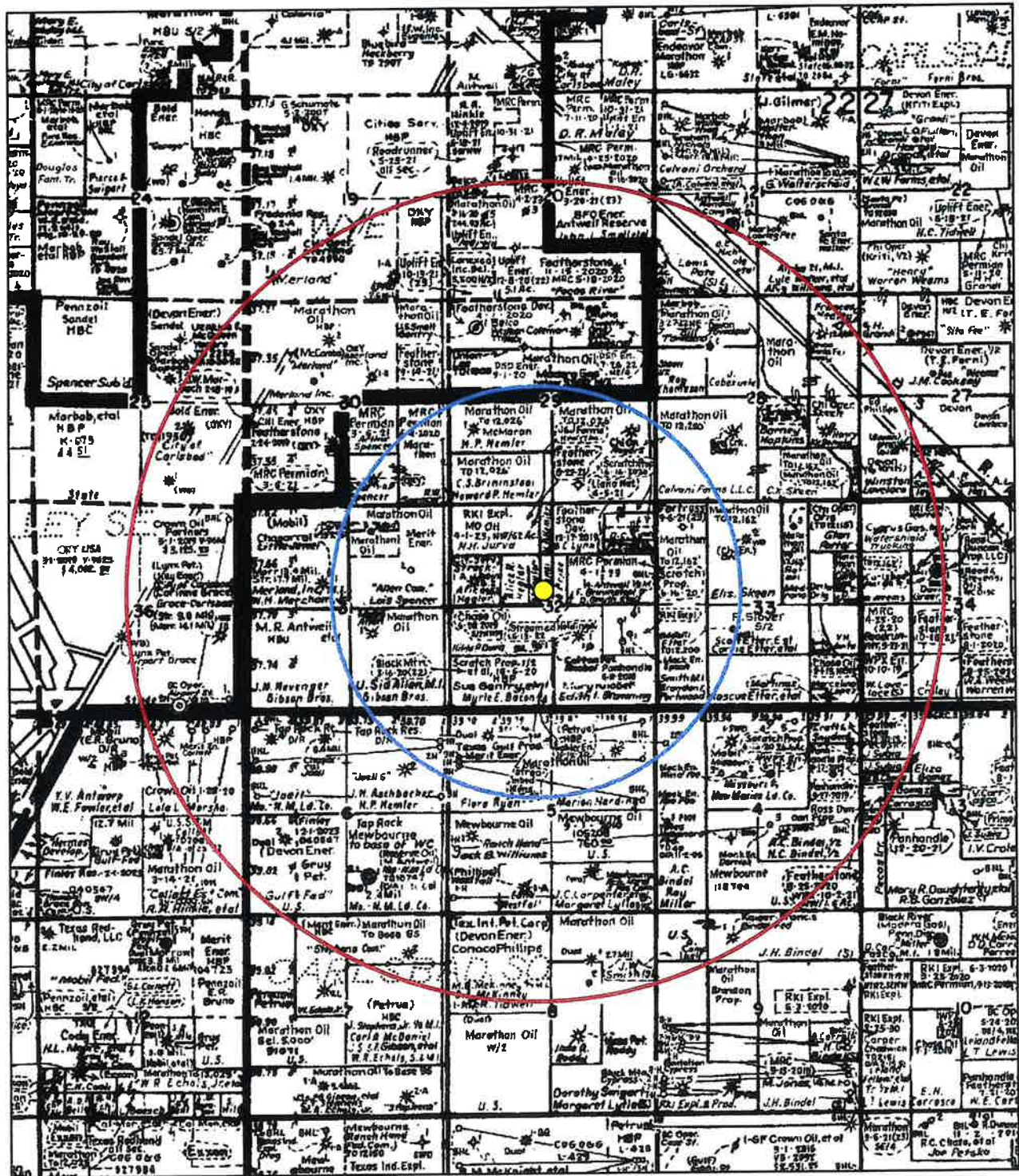

HOPI SWD #1



1 MILE AOR



2 MILE AOR



Mewbourne Oil Company

HOPI 32 SWD #1

Sec. 32-21S-27E

2411' FNL & 2188' FWL

EDDY, NEW MEXICO

Date:

21 May, 2019

Tech:
Steve Daughtry

Scale:
1" = 4000'

MEWBOURNE OIL COMPANY - HOPI 32 SWD #1 – OFFSET OPERATOR MAP

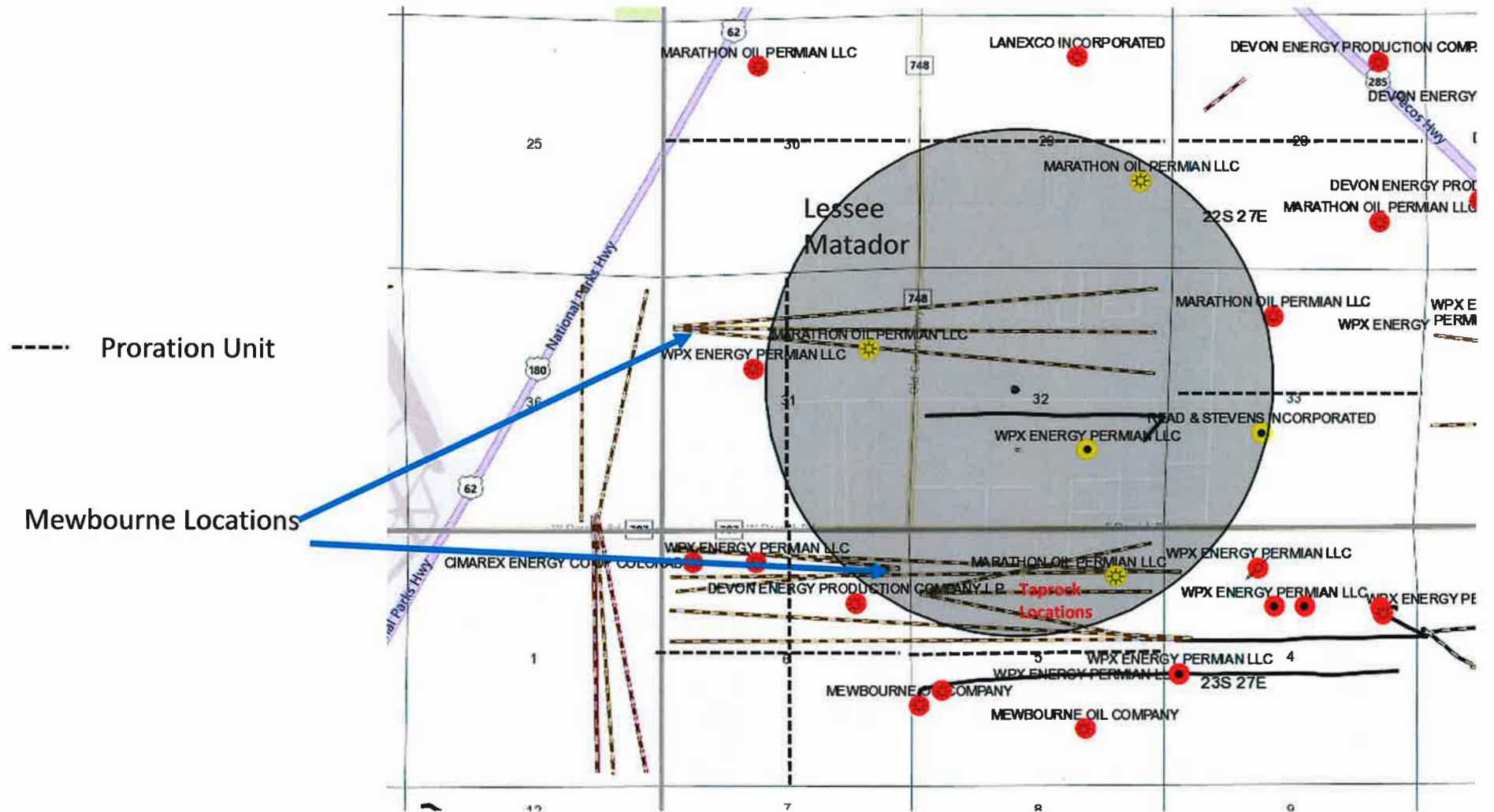

HOPI 32 SWD #1
S-32, T-22S, R-27E

State and Federal Minerals Map

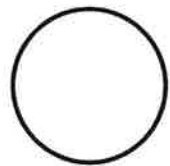

One Mile
Radius

NOTE: Source of Data
New Mexico State Land
Office GIS Map



NMSLO



FEDERAL

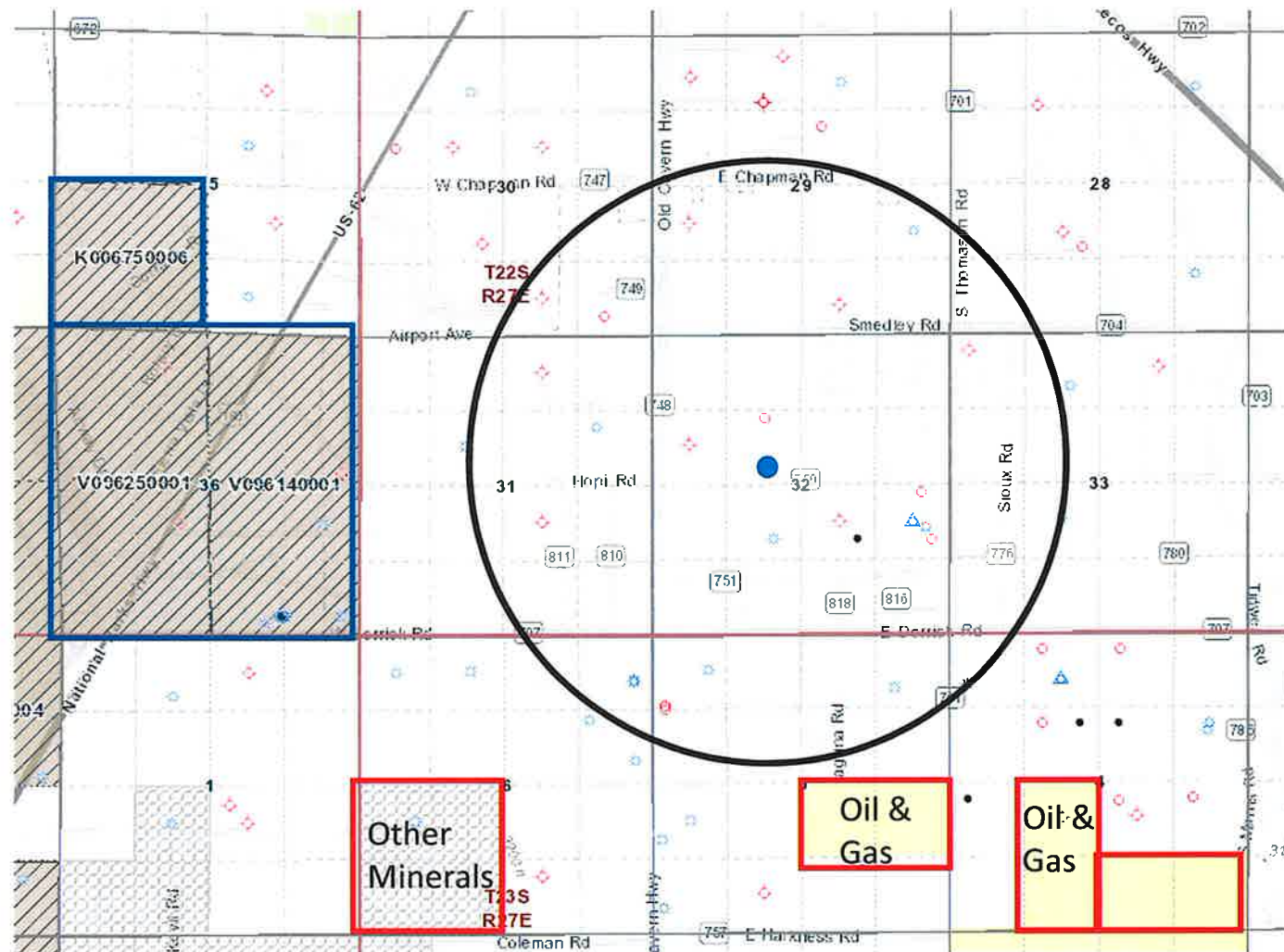

Imperative Water Analysis Report

IMPERATIVE
CHEMICAL PARTNERS

SYSTEM IDENTIFICATION

Company: Mewbourne Oil NM
Location: Hopi SWD
Sample Point: Wellhead
Account Rep: Kyle Carrasco

NW/4, NW/4
32-22N-27E

Fresh Water Sample

Sample ID#: W-9842

Sample Date: 06-07-2019
Report Date: 06-10-2019

WATER CHEMISTRY

CATIONS

Calcium(as Ca)	888.60
Magnesium(as Mg)	745.60
Barium(as Ba)	0.00
Strontium(as Sr)	11.50
Sodium(as Na)	867.58
Potassium(as K)	33.64
Iron(as Fe)	0.321
Manganese(as Mn)	0.0180

ANIONS

Chloride(as Cl)	3700
Sulfate(as SO ₄)	1679
Dissolved CO ₂ (as CO ₂)	20.00
Bicarbonate(as HCO ₃)	305.30
H ₂ S (as H ₂ S)	17.10
Boron(as B)	6.04

PARAMETERS

Temperature(°F)	77.00
Sample pH	7.14
Conductivity	9486
T.D.S.	8310
Resistivity	105.41
Sp.Gr.(g/mL)	1.00

SCALE AND CORROSION POTENTIAL

Temp. (°F)	Press. (atm)	Calcite CaCO ₃		Anhydrite CaSO ₄		Gypsum CaSO ₄ *2H ₂ O		Barite BaSO ₄		Celestite SrSO ₄		Siderite FeCO ₃		Mackawenite FeS		CO ₂ (mpy)	pCO ₂ (atm)
70.00	1.00	2.70	0.138	0.398	-356.18	0.678	-146.87	0.00	-0.00827	0.513	-7.78	1.67	0.0507	7.86	0.0447	0.0186	0.0332
81.82	1.36	2.93	0.142	0.396	-348.37	0.637	-168.26	0.00	-0.0112	0.499	-8.21	1.98	0.0641	6.76	0.0435	0.0187	0.0393
93.64	1.73	3.16	0.144	0.406	-327.27	0.604	-184.66	0.00	-0.0147	0.493	-8.38	2.32	0.0758	5.92	0.0423	0.0127	0.0453
105.45	2.09	3.40	0.146	0.427	-295.46	0.590	-188.75	0.00	-0.0188	0.493	-8.37	2.69	0.0857	5.26	0.0410	0.0759	0.0514
117.27	2.45	3.62	0.147	0.460	-255.77	0.629	-157.99	0.00	-0.0236	0.493	-8.38	3.09	0.0939	4.69	0.0396	0.0733	0.0574
129.09	2.82	3.84	0.147	0.507	-210.83	0.666	-131.82	0.00	-0.0296	0.490	-8.44	3.51	0.101	4.17	0.0380	0.0675	0.0635
140.91	3.18	4.04	0.146	0.571	-163.08	0.702	-109.57	0.00	-0.0369	0.487	-8.56	3.95	0.106	3.70	0.0361	0.0592	0.0695
152.73	3.55	4.22	0.144	0.655	-114.69	0.736	-90.72	0.00	-0.0458	0.481	-8.73	4.39	0.111	3.27	0.0340	0.0646	0.0755
164.55	3.91	4.39	0.142	0.764	-67.35	0.768	-74.68	0.00	-0.0565	0.474	-8.94	4.83	0.114	2.88	0.0316	0.0699	0.0816
176.36	4.27	4.52	0.139	0.907	-22.64	0.798	-61.14	0.00	-0.0694	0.467	-9.21	5.27	0.116	2.53	0.0288	0.0739	0.0876
188.18	4.64	4.65	0.136	1.09	18.49	0.827	-49.64	0.00	-0.0848	0.458	-9.50	5.69	0.117	2.22	0.0257	0.0186	0.0937
200.00	5.00	4.75	0.133	1.33	55.29	0.854	-39.85	0.00	-0.103	0.449	-9.83	6.10	0.118	1.94	0.0222	0.0232	0.0997
			Lbs per		Lbs per		Lbs per		Lbs per		Lbs per		Lbs per		Lbs per		
		xSAT	1000	xSAT	1000	xSAT	1000	xSAT	1000	xSAT	1000	xSAT	1000	xSAT	1000		
			Barrels		Barrels		Barrels		Barrels		Barrels		Barrels		Barrels		

Saturation Levels (xSAT) are the ratio of ion activity to solubility, e.g. {Ca}{CO₃}/K_{sp}. pCO₂ (atm) is the partial pressure of CO₂ in the gas phase.
Lbs/1000 Barrels scale is the quantity of precipitation (or dissolution) required to instantaneously bring the water to equilibrium.

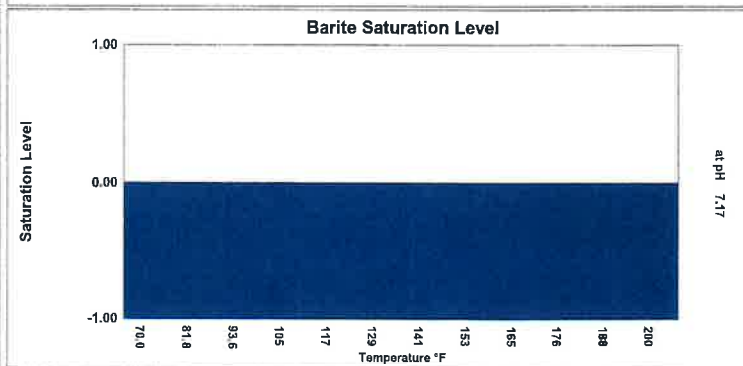
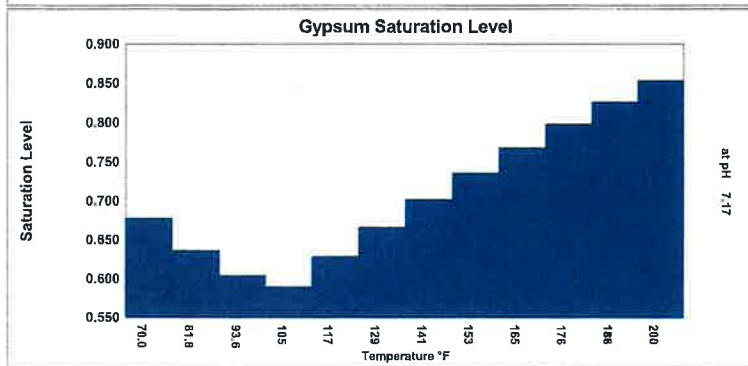
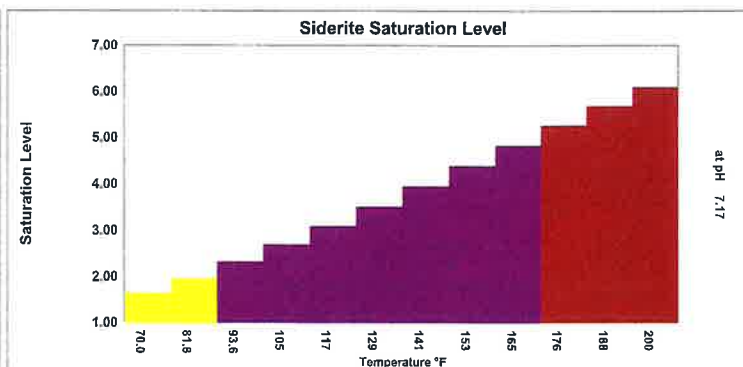
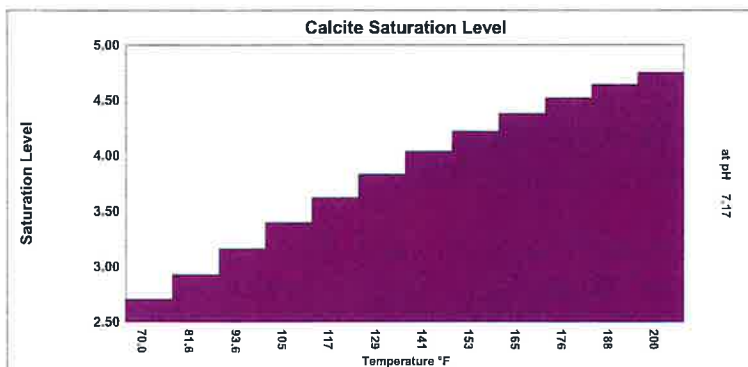

MEWBOURNE OIL COMPANY

HOP1 32 SWD #1 PERMIT APPLICATION

TABULATION OF PRODUCED WATER ANALYSIS

3rd Bone Spring Formation

Formation:	Roscoe 6 B3AD Fed Com #1H
Section	Bone Spring
Township	6
Range	21S
	27E
Sample #	W-6358
Date Caught	3/14/2019
Process Date	3/15/2019
Analysis	
pH	5.8
Temp	118.1
Specific Gravity	1.1
CO2	700.0
Calcium	4,909.0
Magnesium	799.1
Sodium	47,178.0
Barium	1.69
Manganese	0.78
Strontium	536.6
Potassium	1,401
Bicarbonate	61
Sulfate	259
Chlorides	86,000
Iron	22.6
TDS	138,049

Wolfcamp Formation

Date	Company	Well	Well Type	Flow Date	Sample Date	Flow Rate	pH	Temp	Calcium	Lab TDS	Lab TDS	Lab TDS	Lab TDS
W-1472	Mewbourne Oil NM	Styx 17 W2PA Fee Com	1H	3/31/2017	4/11/2018	376	6.01	8	62,669	25.29	104,530	6.01	1.073
W-3755	Mewbourne Oil NM	Styx 17 W2PA Fee Com	1H	3/31/2017	9/7/2018	525	5.16	17.1	61,267	247.46	101,474	5.16	1.071
W-3786	Mewbourne Oil NM	Loving Townsite 21 W2PA Fee	2H	5/15/2017	9/7/2018	480	7.16	17.1	68,675	11.22	112,445	7.16	1.076
W-3787	Mewbourne Oil NM	Slider 18 W2DM Fed Com	1H	7/6/2017	9/7/2018	428	6.59	8.55	67,574	2.71	110,832	6.59	1.077
W-4599	Mewbourne Oil NM	Viper 29 32 W2DM Fed Com	1H	2/20/2016	11/9/2018	993	6.58	0.34	80,000	25.61	128,781	6.58	1.09
W-4600	Mewbourne Oil NM	White Snake 20/21 W2BC Fee	2H	6/13/2018	11/9/2018	149	6.59	0.34	81,000	12.25	130,470	6.59	1.09
W-4601	Mewbourne Oil NM	White Snake 20/21 W2BC Fee	1H	6/13/2018	11/9/2018	149	6.34	0.34	69,000	57.84	111,964	6.34	1.08
W-4618	Mewbourne Oil NM	Speedwagon 27 W2DM	1H	3/11/2016	11/12/2018	976	6.13	1.71	70,000	13.94	113,697	6.13	1.08
W-4619	Mewbourne Oil NM	Loving Townsite 21 W2PA Fee	1H	5/15/2017	11/12/2018	546	6.69	3.42	69,000	72.99	111,798	6.69	1.08
W-4621	Mewbourne Oil NM	Speedwagon 27 W2PA	1H	1/24/2018	11/12/2018	292	6.45	1.71	71,000	101.5	115,051	6.13	1.08
W-4622	Mewbourne Oil NM	Speedwagon 27 W2PA	2H	1/24/2018	11/12/2018	292	6.78	1.71	77,000	39.9	124,062	5.57	1.09

ALL SAMPLES FROM MEWBOURNE OPERATED WELLS IN TOWNSHIP 23S, RANGE 27E & 23S, RANGE 28E

Listing of Notified Persons

Hopi 32 SWD #1 Application
2188' FWL & 2411' FNL, Unit F
Section 32, T22S, R27E, Eddy County, NM

Surface Owner

J&J Farms Partnership
1134 Tracy Place
Carlsbad, NM 88220

Offsetting Operators Or Leasehold Owners Within 1 Mile

Sections 4 & 6, 23S, 27E, 31 & 32, 22S, 27E

WPX Energy Permian LLC
3500 One Williams Center
Tulsa, OK 74172

N/2, Section 5, 22S, 27E

Tap Rock Operating, LLC
602 Park Point Drive, Suite 200
Golden, CO 80401

Section 5, 23S, 27E, Sections 28, 29, 30, 31 & 33, 22S, 27E

Marathon Oil Permian, LLC
5555 San Felipe Street
Houston, TX 77056

Section 6, 23S, 27E

Devon Energy Production Company, LP
333 West Sheridan Avenue
Oklahoma City, OK 73102

N/2, Section 29, 22S, 27E

Lanexco Inc. DBA Lanexco New Mexico
107 Main Street
Sealy, TX 77474

Section 30, 22S, 27E

Matador Production Company
5400 LBJ Freeway, Suite 1500
Dallas, TX 75240

S/2, Section 33, 22S, 27E

Read and Stephens Inc.
400 Penn Plaza, Suite 1000
Roswell, NM 88201

CARLSBAD
CURRENT-ARGUS

AFFIDAVIT OF PUBLICATION

Ad No.
0001287875

MEWBOURNE OIL COMPANY
3901 S BROADWAY AVE

TYLER TX 75701

I, a legal clerk of the **Carlsbad Current-Argus**,
a newspaper published daily at the City of
Carlsbad, in said county of Eddy, state of New
Mexico and of general paid circulation in said
county; that the same is a duly qualified
newspaper under the laws of the State wherein
legal notices and advertisements may be
published; that the printed notice attached
hereto was published in the regular and entire
edition of said newspaper and not in supplement
thereof on the date as follows, to wit:

06/05/19



Legal Clerk

Subscribed and sworn before me this
6th of June 2019.

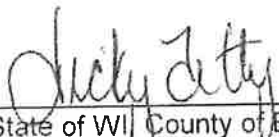

State of WI County of Brown
NOTARY PUBLIC

9-19-21

My Commission Expires

NOTICE

Mewbourne Oil Company has filed a form C-108 (Application for Authorization to Inject) with the New Mexico Oil Conservation Division seeking administrative approval to drill and complete the Hopi 32 SWD #1 as a salt water disposal well.

The Hopi 32 SWD #1 is located 2411' FNL and 2188' FWL, Unit Letter F, Section 32, Township 22 South, Range 27 East, NMPM, Eddy County, New Mexico. The well will dispose of water produced from nearby operated oil and gas wells into the Devonian formation into an open-hole interval from a depth of 12,750 feet to 13,775 feet. Expected maximum injection rates are 35,000 BWPD at a maximum injection pressure of 2,550 psi.

Interested parties must file objections or requests for hearing with the Oil Conservation Division, 1220 South St. Francis Drive, Santa Fe, New Mexico 87505, within 15 days. The name and address of the contact party for the applicant is Tim Harrington, Mewbourne Oil Company, 3620 Old Bullard Road, Tyler, Texas 75701, (903)-534-7647. The well is located approximately 4.9 miles south of Carlsbad, New Mexico.

June 5, 2019





June 10, 2019

Engineering and Geological Services Bureau, Oil Conservation Division
1220 South St. Francis Drive
Santa Fe, NM 87505
Attn: Mr. Phillip Goetze

Re: Hopi 32 SWD #1
Sec 32, Twp 22S, Rge 27E
Eddy County, NM

Mr. Goetze,

In accordance with item XII on Mewbourne Oil Company's C-108 filed for the captioned salt water disposal well, Mewbourne Oil Company has examined geologic and engineering data and has found that there is no evidence of faulting or any other hydrologic connection between the proposed disposal zone and any underground sources of drinking water.

Should you have any questions, please email me at tharrington@mewbourne.com or call me at (903) 534-7647.

Sincerely yours,

MEWBOURNE OIL COMPANY

A handwritten signature in black ink, appearing to read 'Tim R. Harrington', with a long horizontal flourish extending to the right.

Tim Harrington
Reservoir Engineer
tharrington@mewbourne.com

Mewbourne Oil Company
Hopi 32 SWD #1
C-108 Attachment
May 10, 2019

STATEMENTS REGARDING SEISMICITY AND WELL SPACING

Historically, the area nearby our proposed Hopi 32 SWD #1 has not seen a significant amount of seismic activity. There has been one seismic event (per USGS database) in this area in 1974 (magnitude 3.9) that was located 4.9 miles southeast of our proposed SWD.

Mewbourne Oil Company does not own 2D or 3D seismic data near our proposed SWD therefore our fault interpretation is based on subsurface mapping and data obtained from public technical sources. Our publicly sourced faults data is from a 2005 paper by Ruppel et al. (map attached). Based off our subsurface mapping of the deep formations, Mewbourne has not interpreted any faults in the immediate area. The closest known mapped "deep" fault, that is documented in public data, is approximately 7.0 miles southwest of our proposed SWD.

A very recent technical paper written by Snee and Zoback, "State of Stress in the Permian, Basin, Texas and New Mexico: Implications for induced seismicity", that was published in the February 2018 edition of The Leading Edge, evaluates the strike-slip probability, using probabilistic FSP analysis, of known Permian Basin faults. This study predicts that the Precambrian fault located on our map has less than a 10% probability of being critically stressed so as to create an induced seismicity event. The main reason for this low probability is due to the relationship of the strike of this fault to the regional Shmax orientation in study area 3 (see Figure #2) is approximately N 35 deg in this area.

The Hopi 32 SWD #1 is located greater than 1.5 miles away from any active, permitted or pending Devonian SWD application (see map), to meet current OCD and industry recommended practices.

Operator	Well Name	Status	Distance from Hopi 32 SWD (miles)
NGL	Quintana SWD #1	Pending Application	1.81
Overflow Energy	Rita SWD #1	Public Notice	2.08
Solaris	Maley SWD #7	Pending Application	2.58

Timothy R. Harrington



Reservoir Engineer
tharrington@mewbourne.com
903-534-7647

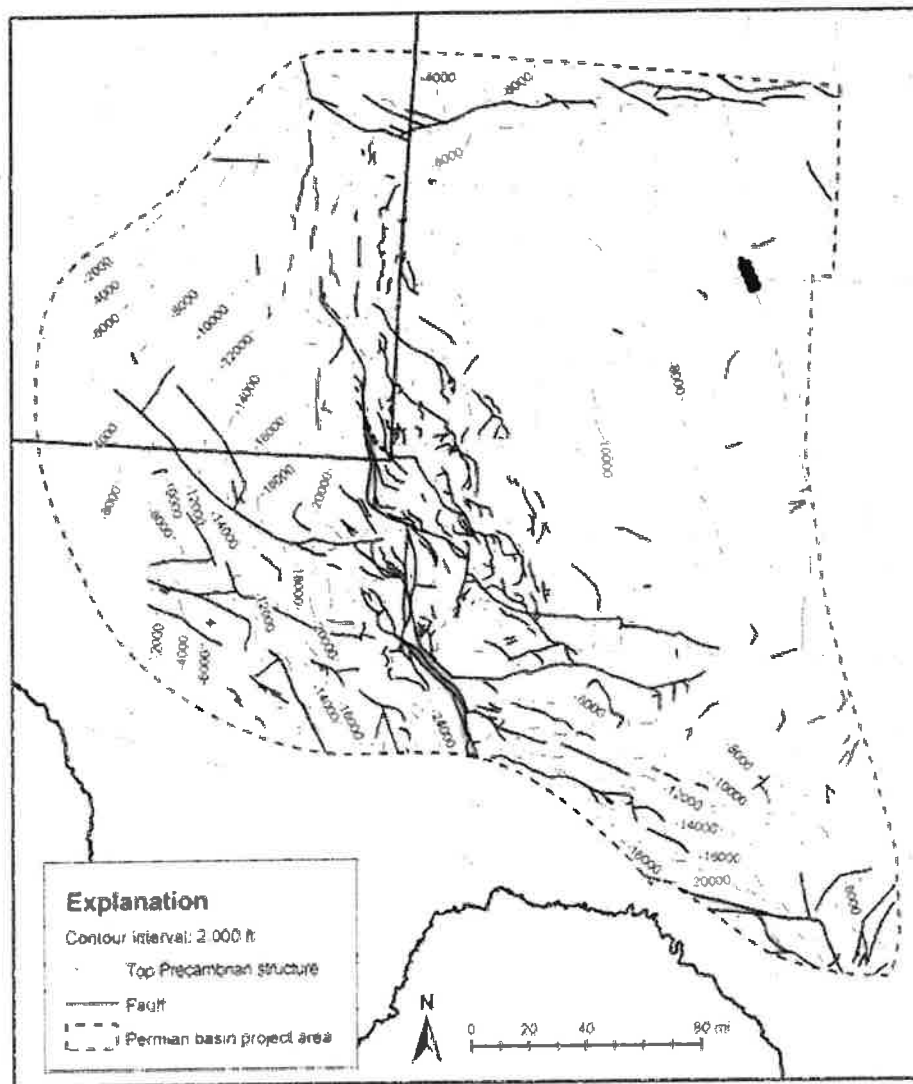

Precambrian Structure Map In the Permian Basin (Ruppel et al.)

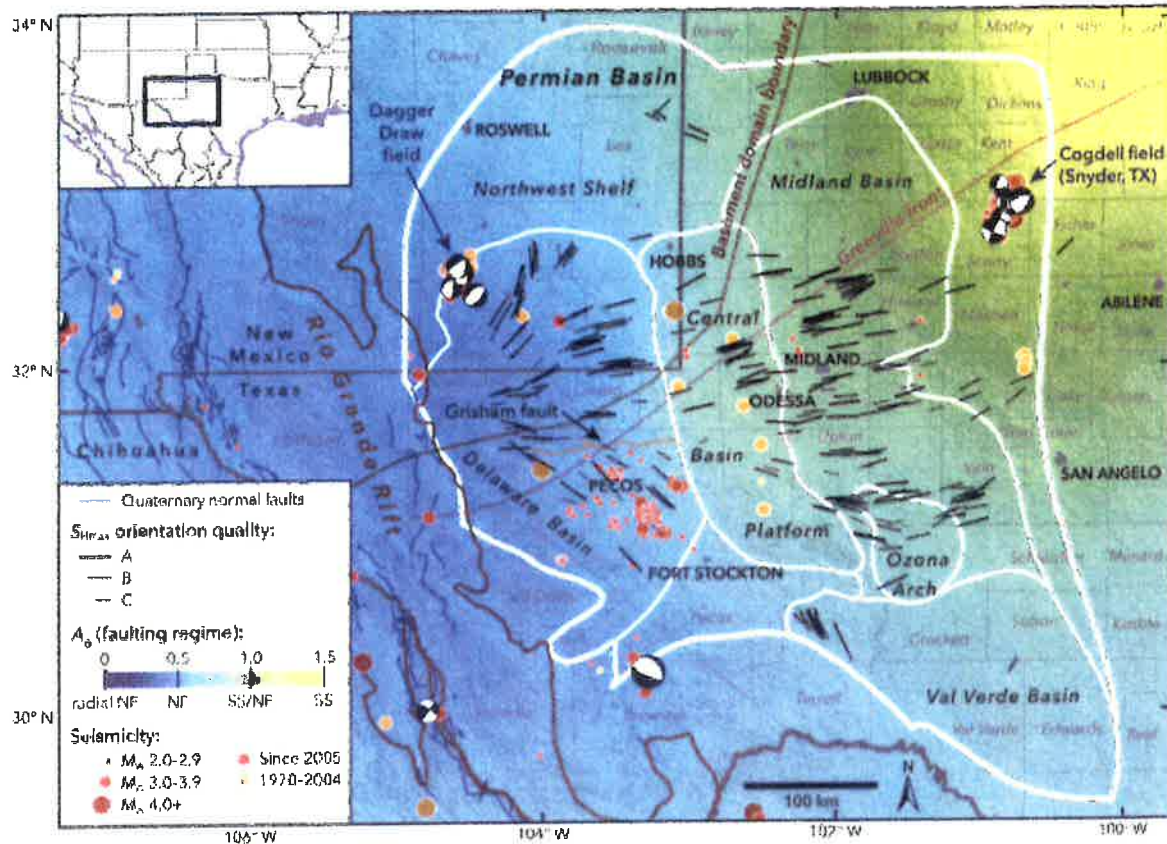

Figure 1. State of stress in the Permian Basin, Texas and New Mexico. Black lines are the measured orientations of S_{Hmax} , with line length scaled by data quality. The colored background is an interpolation of measured relative principal stress magnitudes (faulting regime) expressed using the A_0 parameter (see text for details) of Simpson (1997). Blue lines are fault traces known to have experienced normal-sense offset within the past 1.5 Ma, from the USGS Quaternary Faults and Folds Database (Crone and Wheeler, 2000). The boundary between the Shawnee and Mazatzal basement domains is from Lund et al. (2015), and the Precambrian Grenville Front is from Thomas (2006). The Permian Basin boundary is from the U.S. Energy Information Administration, and the subbasin boundaries are from the Texas Bureau of Economic Geology Permian Basin Geological Synthesis Project. Earthquakes are from the USGS National Earthquake Information Center, the TexNet Seismic Monitoring Program, and Gan and Frohlich (2013). Focal mechanisms are from Saint Louis University (Herrmann et al., 2011).

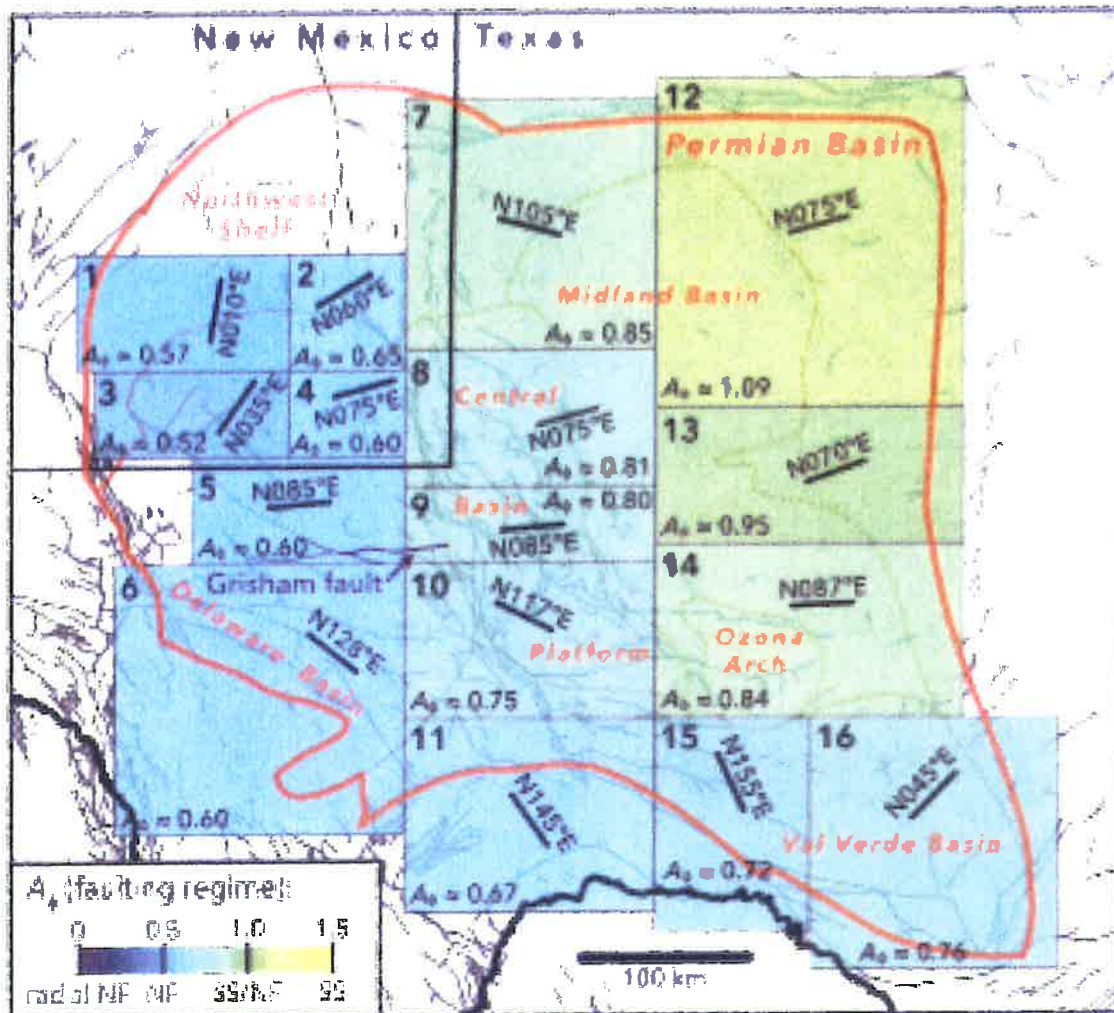

Figure 2. Map of study areas chosen for FSP analysis on the basis of broadly similar stress conditions. Text annotations indicate representative S_{1max} orientation and relative principal stress magnitudes (A_1 parameter) for each study area based on the data presented in Figure 1. Gray lines in the background indicate fault traces compiled from Ewing et al. (1990), Green and Jones (1997), Ruppel et al. (2005), and the USGS Quaternary Faults and Folds Database (Crone and Wheeler, 2000), to which we apply FSP analysis.

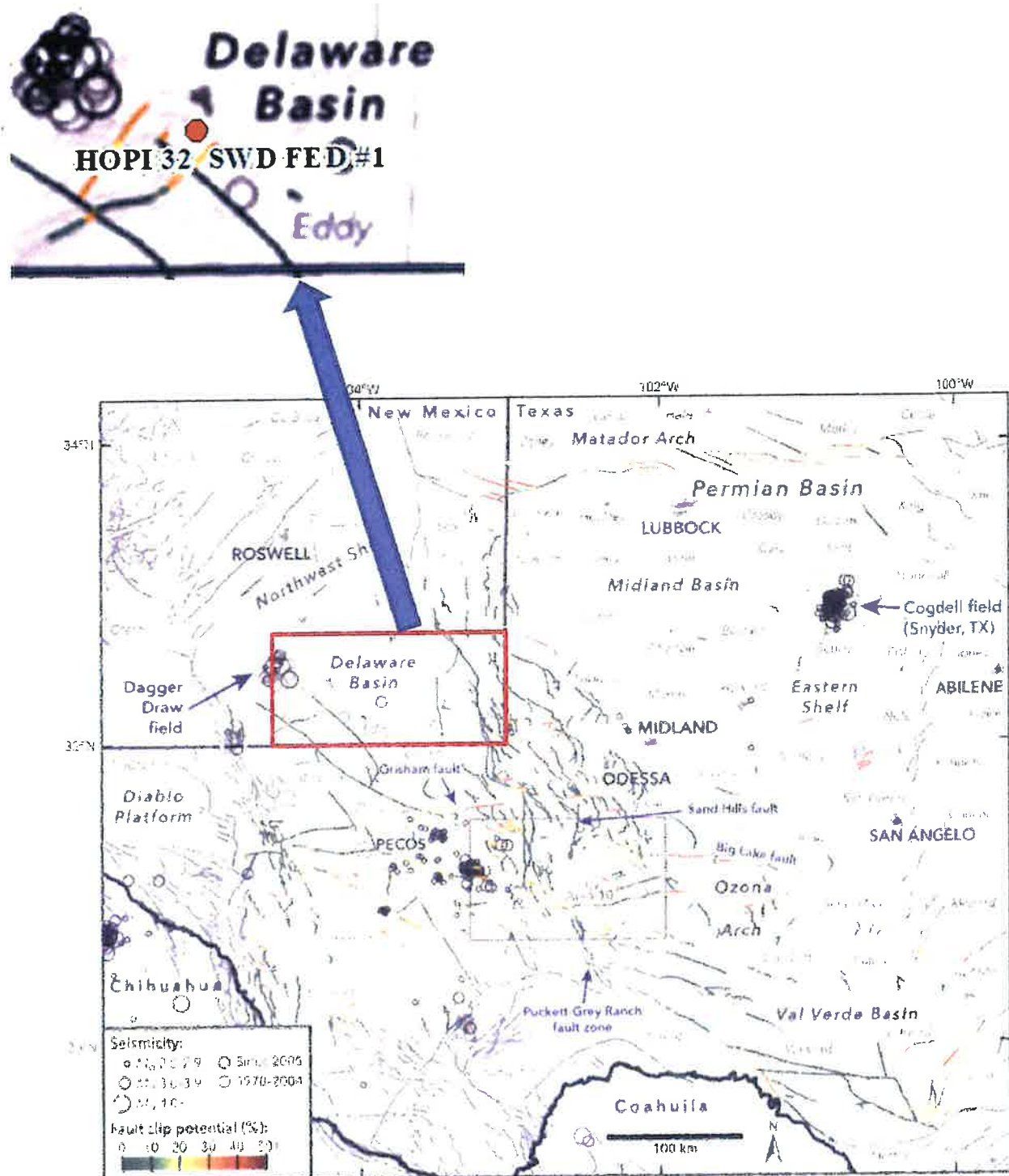

Figure 3. Results of our probabilistic FSP analysis across the Permian Basin. Data sources are as in Figures 1 and 2.

Mewbourne Oil Company
Hopi 32 SWD #1
C-108 Attachment
May 10, 2019

References

- Ewing, T.E., R.T. Budnik, J.T. Ames, and D.M. Ridner, 1990, Tectonic Map of Texas: Bureau of Economic Geology, University of Texas at Austin.
- Green, G.N., and G.E. Jones, 1997, The digital geologic map of New Mexico in ARC/INFO format: U.S. Geological Survey Open-File Report.
- Jens-Erik Lund Snee and Mark D. Zoback, 2018, State of stress in the Permian Basin, Texas and New Mexico: Implications for induced seismicity: The Leading Edge, February 2018.
- Ruppel, S.C., R.H. Jones, C.L. Breton, and J.A. Kane, 2005 Preparation of maps depicting geothermal gradient and Precambrian structure in the Permian Basin: Bureau of Economic Geology, Jackson School of Geosciences, The University of Texas at Austin, Austin, TX.

CARLSBAD
CURRENT-ARGUS

AFFIDAVIT OF PUBLICATION

Ad No.
0001287875

MEWBOURNE OIL COMPANY
3901 S BROADWAY AVE

TYLER TX 75701

NOTICE

Mewbourne Oil Company has filed a form C-108 (Application for Authorization to Inject) with the New Mexico Oil Conservation Division seeking administrative approval to drill and complete the Hopi 32 SWD #1 as a salt water disposal well.

The Hopi 32 SWD #1 is located 2411' FNL and 2188' FWL, Unit Letter F, Section 32, Township 22 South, Range 27 East, NMPM, Eddy County, New Mexico. The well will dispose of water produced from nearby operated oil and gas wells into the Devonian formation into an open-hole interval from a depth of 12,750 feet to 13,775 feet. Expected maximum injection rates are 35,000 BWPd at a maximum injection pressure of 2,550 psi.

Interested parties must file objections or requests for hearing with the Oil Conservation Division, 1220 South St. Francis Drive, Santa Fe, New Mexico 87505, within 15 days. The name and address of the contact party for the applicant is Tim Harrington, Mewbourne Oil Company, 3620 Old Bullard Road, Tyler, Texas 75701, (903)-534-7647. The well is located approximately 4.9 miles south of Carlsbad, New Mexico.

June 5, 2019

I, a legal clerk of the **Carlsbad Current-Argus**, a newspaper published daily at the City of Carlsbad, in said county of Eddy, state of New Mexico and of general paid circulation in said county; that the same is a duly qualified newspaper under the laws of the State wherein legal notices and advertisements may be published; that the printed notice attached hereto was published in the regular and entire edition of said newspaper and not in supplement thereof on the date as follows, to wit:

06/05/19



Legal Clerk

Subscribed and sworn before me this
5th of June 2019.



State of WI, County of Brown
NOTARY PUBLIC



My Commission Expires



MEWBOURNE OIL COMPANY
Hopi 32 SWD #1

PLUGGING RISK ASSESSMENT

5 ½" Flush Joint Injection Tubing Inside of 7 ⅝" Casing

Specs

5 ½" 17# P110 Flush Joint Tubing	OD (in)	ID (in)	Drift (in)	LINED ID (in)	FLARE DRIFT (in)
Coupling	N/A	N/A	N/A	N/A	N/A
Body	5.500	4.892	4.767	4.520	4.275
7 ⅝" 39# P110 Casing	OD (in)	ID (in)	Drift (in)	Wall Thickness (in)	5 ½" Flush Jt. Clearance (in)
	7.625	6.625	6.500	0.500	0.562

*All fishing procedures are subject to well conditions. Determinations are made onsite on a case by case scenario.

Overshot Fishing Procedure

A 6.625" O.D. Bowen Series 150 overshot (Assembly 8625) with a spiral grapple will be utilized to perform this overshot operation. *NOTE: (The 6.625" O.D. will be turned down to 6.500" O.D. prior to commencing operation). Details on the overshot are noted below.



Tools are listed in order of maximum catch size.

The following table shows only a partial listing of available NOV Dowhole Bowen® overshots.

NOTE: Nitralloy Grapples are available upon request.

Bowen Series 150 Releasing and Circulation Overshots
 Maximum Catch Size 4½" to 5½" inclusive

Maximum Catch Size (Spiral)	4½"	4½"	4½"	4½"	5"	5"	5½"
Maximum Catch Size (Basket)	3¾"	4½"	4½"	4½"	4½"	4½"	4½"
Overshot O.D.	5½"	5½"	5½"	5½"	5½"	5½"	5½"
Type	F.S.	S.H.	S.H.	S.F.S.	S.H.	F.S.	S.H.
Complete Assembly	Part No.	5698	5698	C-5188	8875	C-5171	C-4825
(Dressed Spiral Parts)	Weight	130	130	132	138	140	192
Replacement Parts							
Top Sub	Part No.	5697	5699	A-5189	8876	A-5172	B-4826
Bowl	Part No.	5698	5700	B-5170	8877	B-5173	B-4827
Packer	Part No.	109	1140	B-2199	8114	L-5090	L-4904
Spiral Grapple	Part No.	185	1135	B-2201	8112	B-4389	M-1071
Spiral Grapple Control	Part No.	186	1137	B-2202	8113	B-4370	M-1072
Standard Guide	Part No.	187	1143	B-2203	8121	B-4371	L-1074
Basket Parts							
Basket Grapple	Part No.	185	1135	B-2201	8112	B-4389	M-1071
Basket Grapple Control	Part No.	186	1137	B-2202	8113	B-4370	M-1072
Mini Control Packer	Part No.	109-R	1140-R	B-2199-R	8114-R	L-5090-R	M-4905

In the Event of a Connection Break

1. If dressing is needed, trip in hole with a mill and mill connection to allow for (above listed) turned-down overshot to be latched onto the body of the tubing. If no milling is required, trip in hole with (above listed) turned-down overshot and latch onto fish.
2. Once latched onto fish, pick up string weight and straight pull to release Model R packer.
3. Once packer is released, trip out of hole with fish.

In the Event of a Body Break

1. If dressing is needed, trip in hole with a mill and mill tubing to allow for (above listed) turned-down overshot to be latched onto the body of the tubing. If no milling is required, trip in hole with (above listed) turned-down overshot and latch onto fish.
2. Once latched onto fish, pick up string weight and straight pull to release Model R packer.
3. Once packer is released, trip out of hole with fish.

*NOTE: (Wash pipe with a mill may be substituted for dressing off a break instead of a standard mill to ensure pipe stabilization and to ensure that the casing is not damaged due to milling.)

In the Event a Mill Cannot be Used

If an inadequate fishing neck is looking up and a mill cannot be used to dress the fish, a cutting tool may be utilized to cut off the damaged portion of tubing and a spear used to retrieve the cut-off piece. Once the cut-off piece is retrieved, the (above listed) turned-down overshot may be utilized to retrieve the fish and release the packer.

Spear Fishing Procedure

In the event the (above listed) turned-down overshot cannot be used or the fishing neck is inadequate, a spear may be used to spear into the fish. In the case of insert lined pipe, a smaller spear will be utilized to go inside the insert liner and pull out the lining. Once the lining has been removed, trip out of hole with insert liner. Pick up the proper sized spear for the pipe ID. Trip in hole with tubing spear, spear the fish, pick up string weight and straight pull to release the packer. Trip out of hole with fish and packer assembly.

7" Flush Joint Injection Tubing Inside of 9 5/8" Casing

Specs

7" 26# HCP110 Flush Joint Tubing	OD (in)	ID (in)	Drift (in)	LINED ID (in)	FLARE DRIFT (in)
Coupling	N/A	N/A	N/A	N/A	N/A
Body	7.000	6.276	6.151	6.080	5.815
9 5/8" 43.5# HCL80 Casing	OD (in)	ID (in)	Drift (in)	Wall Thickness (in)	7" Flush Jt. Clearance (in)
	9.625	8.755	8.599	0.435	0.877

*All fishing procedures are subject to well conditions. Determinations are made onsite on a case by case scenario.

Overshot Fishing Procedure

A Bowen Series 150 overshot (Assembly 9217) with a spiral grapple will be utilized to perform this overshot operation. Details on the overshot are noted below.

Bowen Series 150 Releasing and Circulation Overshots

Maximum Catch Size 6 3/4" to 7 1/4" inclusive

Maximum Catch Size (Spiral)		5 1/2"	6 1/4"	7"	7 1/4"
Maximum Catch Size (Basket)		5 3/4"	6 1/4"	6 3/4"	6 5/8"
Overshot O.D.		8 1/4"	7 3/4"	8 1/4"	8 1/4"
Type		F.S.	S.H.	S.H.	S.H.
Complete Assembly	Part No.	C-3032	C-5222	9217	C-5354
(Dressed Spiral Parts)	Weight	260	243	251	260

Replacement Parts

Top Sub	Part No.	A-3033	A-5223	9216	A-5355
Bowl	Part No.	B-3034	B-5224	9210	B-5356
Packer	Part No.	A-1814	B-5225	9224	B-5357
Spiral Grapple	Part No.	N-84	B-5227	9222	B-5359
Spiral Grapple Control	Part No.	M-89	A-5226	9223	B-5360
Standard Guide	Part No.	A-1816	A-5229	9229	A-5361

Basket Parts

Basket Grapple	Part No.	N-84	B-5227	9222	B-5359
Basket Grapple Control	Part No.	M-89	A-5226	9223	B-5360
Mill Control Packer	Part No.	A-1814-R	B-5225-R	9224-R	B-5357-R

In the Event of a Connection Break

1. If dressing is needed, trip in hole with a mill and mill connection to allow for (above listed) overshot to be latched onto the body of the tubing. If no milling is required, trip in hole with (above listed) overshot and latch onto fish.
2. Once latched onto fish, pick up string weight and straight pull to release Model R packer.
3. Once packer is released, trip out of hole with fish.

In the Event of a Body Break

1. If dressing is needed, trip in hole with a mill and mill tubing to allow for (above listed) overshot to be latched onto the body of the tubing. If no milling is required, trip in hole with (above listed) overshot and latch onto fish.
2. Once latched onto fish, pick up string weight and straight pull to release Model R packer.
3. Once packer is released, trip out of hole with fish.

*NOTE: (Wash pipe with a mill may be substituted for dressing off a break instead of a standard mill to ensure pipe stabilization and to ensure that the casing is not damaged due to milling.)

In the Event a Mill Cannot be Used

If an inadequate fishing neck is looking up and a mill cannot be used to dress the fish, a cutting tool may be utilized to cut off the damaged portion of tubing and a spear used to retrieve the cut-off piece. Once the cut-off piece is retrieved, the (above listed) overshot may be utilized to retrieve the fish and release the packer.

Spear Fishing Procedure

In the event the (above listed) overshot cannot be used or the fishing neck is inadequate, a spear may be used to spear into the fish. In the case of insert lined pipe, a smaller spear will be utilized to go inside the insert liner and pull out the lining. Once the lining has been removed, trip out of hole with insert liner. Pick up the proper sized spear for the pipe ID. Trip in hole with tubing spear, spear the fish, pick up string weight and straight pull to release the packer. Trip out of hole with fish and packer assembly.

Abandonment Procedure in-the-Event that Injection Tubing Cannot be Fished

The operator will need to ensure that geological formations are properly isolated to prevent future fluid communication. The operator will first insure that the injection tubing I.D. is open and clear. Once injection tubing I.D. is confirmed to be open and clear, run in hole with a wireline set profile plug and set plug inside of the packer assembly. This plug would allow for cement to fill both the I.D. of the injection tubing and the tubing-to-casing annulus to provide isolation between the different geological formations. Next, run in hole with wireline conveyed perforating guns and shoot perforations at the deepest depth that the injection tubing is still in the wellbore. Trip in hole with a workstring and latch onto the injection tubing with an overshot, spear, cement retainer or any other tool that would ensure a work string-to-injection tubing seal and allow the operator to pump cement down the remaining injection tubing. Rig up cement truck and cement the annulus between the injection tubing and casing to surface.

In the Event of a Connection Break

1. If dressing is needed, trip in hole with a mill and mill connection to allow for (above listed) overshot to be latched onto the body of the tubing. If no milling is required, trip in hole with (above listed) overshot and latch onto fish.
2. Once latched onto fish, pick up string weight and straight pull to release Model R packer.
3. Once packer is released, trip out of hole with fish.

In the Event of a Body Break

1. If dressing is needed, trip in hole with a mill and mill tubing to allow for (above listed) overshot to be latched onto the body of the tubing. If no milling is required, trip in hole with (above listed) overshot and latch onto fish.
2. Once latched onto fish, pick up string weight and straight pull to release Model R packer.
3. Once packer is released, trip out of hole with fish.

*NOTE: (Wash pipe with a mill may be substituted for dressing off a break instead of a standard mill to ensure pipe stabilization and to ensure that the casing is not damaged due to milling.)

In the Event a Mill Cannot be Used

If an inadequate fishing neck is looking up and a mill cannot be used to dress the fish, a cutting tool may be utilized to cut off the damaged portion of tubing and a spear used to retrieve the cut-off piece. Once the cut-off piece is retrieved, the (above listed) overshot may be utilized to retrieve the fish and release the packer.

Spear Fishing Procedure

In the event the (above listed) overshot cannot be used or the fishing neck is inadequate, a spear may be used to spear into the fish. In the case of insert lined pipe, a smaller spear will be utilized to go inside the insert liner and pull out the lining. Once the lining has been removed, trip out of hole with insert liner. Pick up the proper sized spear for the pipe ID. Trip in hole with tubing spear, spear the fish, pick up string weight and straight pull to release the packer. Trip out of hole with fish and packer assembly.

Abandonment Procedure in-the-Event that Injection Tubing Cannot be Fished

The operator will need to ensure that geological formations are properly isolated to prevent future fluid communication. The operator will first insure that the injection tubing I.D. is open and clear. Once injection tubing I.D. is confirmed to be open and clear, run in hole with a wireline set profile plug and set plug inside of the packer assembly. This plug would allow for cement to fill both the I.D. of the injection tubing and the tubing-to-casing annulus to provide isolation between the different geological formations. Next, run in hole with wireline conveyed perforating guns and shoot perforations at the deepest depth that the injection tubing is still in the wellbore. Trip in hole with a workstring and latch onto the injection tubing with an overshot, spear, cement retainer or any other tool that would ensure a work string-to-injection tubing seal and allow the operator to pump cement down the remaining injection tubing. Rig up cement truck and cement the annulus between the injection tubing and casing to surface.

Mewbourne Oil Company
Hopi 32 SWD #1
Tabulation of Wells Within 1 Mile Radius
5/31/2019

NOTE: ESTIMATED TOP OF DEVONIAN FORMATION = 12,750' TVD

DIR	API	Lease Name	Well Num	Original Operator Name	Current or Final Operator Name	Sec	Twp	Rge	Footage	Status	IP Form Name	Driller Td	TVD (ft)		Proposed Prod Form Name	Proj Depth	Proj Form	Permit Date	Spud Date	Comp Date	Aband Date
													8890	11915							
HZ	30015449980000	PLINY ELDER THE 23527E0605	201	TAP ROCK OPERATING LLC	TAP ROCK OPERATING LLC	4	23S	27E	870 FNL 330 FWL	PERMIT				8890		18500	WOLFCAMP	1/22/2019			
HZ	30015455580000	PLINY ELDER THE FEE	215H	TAP ROCK OPERATING LLC	TAP ROCK OPERATING LLC	4	23S	27E	895 FNL 330 FWL	PROD?		19426		8950		19000	WOLFCAMP	12/18/2018	12/29/2018	2019-01-20	
V	30015207380000	RYAN	1	SUPERIOR OIL COMPANY THE	TAP ROCK OPERATING LLC	5	23S	27E	660 FNL 990 FWL	SHUT-IN	MORROW	11915	11915	MORROW				1972-08-22	1972-09-01	1972-12-30	
HZ	30015449090000	EAGLE POWER 23-27-5 WA FEE	001H	MARATHON OIL PERMIAN LLC	MARATHON OIL PERMIAN LLC	5	23S	27E	1316 FNL 259 FWL	CANC PERMIT					13748	WOLFCAMP	2018-04-27				
HZ	30015449100000	EAGLE POWER 23-27-5 WXY FEE	005H	MARATHON OIL PERMIAN LLC	MARATHON OIL PERMIAN LLC	5	23S	27E	1346 FNL 258 FWL	CANC PERMIT				9000	13746	WOLFCAMP	2018-04-27				
HZ	30015449110000	EAGLE POWER 23-27-5 WXY FEE	009H	MARATHON OIL PERMIAN LLC	MARATHON OIL PERMIAN LLC	5	23S	27E	1286 FNL 259 FWL	CANC PERMIT				9000	13744	WOLFCAMP	2018-04-27				
V	30015325820000	RYAN	2	CHI OPERATING INCORPORATED	MARATHON OIL PERMIAN LLC	5	23S	27E	990 FNL 990 FEL	ACT - GAS	L MORROW	12100	12100		12000	MORROW LOWE	2003-01-29	2003-05-30	2003-03-18		
HZ	30015449940000	STINGER 6 WOAD FEE	001H	MEWBOURNE OIL COMPANY	MEWBOURNE OIL COMPANY	6	23S	27E	780 FNL 240 FEL	PERMIT					13380	WOLFCAMP	2018-05-31				
HZ	30015449950000	STINGER 6 WOAD FEE	002H	MEWBOURNE OIL COMPANY	MEWBOURNE OIL COMPANY	6	23S	27E	810 FNL 240 FEL	PERMIT					13380	WOLFCAMP	2018-05-31				
V	30015332920000	JOELL 6	2	DEVON ENERGY PRODUCTION CO	DEVON ENERGY PRODUCTION CO	6	23S	27E	1530 FNL 1130 FEL	ACT - GAS	MORROW	11960	11960	MORROW		12000	MORROW	2004-05-10	2004-08-13	2004-06-08	
V	30015207890000	HOWARD-HEMLER COM	1	BRUNSON & MCKNIGHT	BRUNSON & MCKNIGHT	29	22S	27E	1980 FSL 660 FWL	P&A - GAS	MORROW	11815	11815	MORROW			UNKNOWN	1972-12-18	1972-12-28	1973-03-06	5/9/1975
V	30015238060000	CALVANI	1	HUSKY OIL COMPANY	HUSKY OIL COMPANY	29	22S	27E	500 FSL 1980 FEL	P&A - TESTED		11869	11869		12000	MORROW	1981-08-02	1981-08-12	1983-03-23	4/29/1983	
V	30015336700000	ROGERS	1	CHI OPERATING INCORPORATED	MARATHON OIL PERMIAN LLC	29	22S	27E	1820 FSL 660 FEL	ACT - GAS	L MORROW	11926	11926	L MORROW	12100	MORROW	2004-10-12	2004-10-23	2005-05-30		
V	30015204010000	SPENCER A	1	CITIES SERVICE OIL COMPANY	OXY USA INC	30	22S	27E	660 FSL 1980 FEL	P&A - GAS	MORROW	11820	11820	MORROW			UNKNOWN	1971-03-20	1971-03-30	1971-06-11	10/28/2005
V	30015290070000	HAGERMAN	1	OXY USA INC	CHI OPERATING INCORPORATED	30	22S	27E	1650 FSL 2200 FWL	P&A - TESTED	STRAWN TESTED	11840	11840		11900	MORROW	1996-06-23	1996-07-03	1996-12-18		
V	30015290070001	HAGERMAN	1	CHI OPERATING INCORPORATED	CHI OPERATING INCORPORATED	30	22S	27E	1650 FSL 2200 FWL	P&A - OIL	DELAWARE	11840	11840	DELAWARE	3407	DELAWARE	2004-02-20	2004-03-01	2005-11-09	8/29/2013	
V	30015203680000	LITTLE JEWEL COM	1	ANTWEIL MORRIS R	WPX ENERGY PERMIAN LLC	31	22S	27E	1980 FNL 1900 FWL	ACT - GAS	MORROW	11820	11820	STRAWN / MORROW			UNKNOWN	1971-01-06	1971-01-16	1971-04-20	
V	30015202880000	ALLEN	1	ANTWEIL MORRIS R	SABRE OPERATING INCORPORATED	31	22S	27E	1980 FSL 1980 FEL	P&A - GAS	STRAWN	11825	11825	STRAWN			UNKNOWN	1970-02-22	1970-03-04	1970-10-03	4/23/1997
V	30015327950000	ALLEN COM	2	CHI OPERATING INCORPORATED	MARATHON OIL PERMIAN LLC	31	22S	27E	1650 FNL 990 FEL	ACT - GAS	MORROW	11891	11891	MORROW	12000	MORROW	2003-05-11	2003-05-29	2003-10-01		
V	30015337880000	ALLEN	3	CHI OPERATING INCORPORATED	CHI OPERATING INCORPORATED	31	22S	27E	660 FNL 1980 FEL	P&A - OIL	DELAWARE SD	5393	5393	DELAWARE SD	5400	DELAWARE	2005-01-03	2005-02-28	2005-05-31	8/22/2013	
HZ	30015459040000	SUNDOWN 31 32 WODA FEE	001H	MEWBOURNE OIL COMPANY	MEWBOURNE OIL COMPANY	31	22S	27E	1030 FNL 250 FWL	PERMIT					19049	WOLFCAMP	2019-04-24				
HZ	30015459050000	SUNDOWN 31 32 WOEH FEE	002H	MEWBOURNE OIL COMPANY	MEWBOURNE OIL COMPANY	31	22S	27E	1060 FNL 250 FWL	PERMIT					18997	WOLFCAMP	2019-04-24				
V	30015203360000	STRACKBEIN A	1	CITIES SERVICE OIL COMPANY	OXY USA WTP LP	32	22S	27E	1980 FNL 660 FWL	P&A - GAS	MORROW	11840	11840	MORROW			UNKNOWN	1970-09-27	1970-10-07	1970-12-17	1/29/2003
V	30015215510000	KNOBEL MARY K	1	COTTON PETROLEUM	PACIFIC ENTERPRISES OIL CO USA	32	22S	27E	1980 FSL 1980 FEL	P&A - GAS	MORROW	12003		MORROW	12000	MORROW	1975-05-29	1975-06-08	1975-11-10		
V	30015215510001	KNOBEL MARY K	1	PACIFIC ENTERPRISES OIL COMPANY	PACIFIC ENTERPRISES OIL CO USA	32	22S	27E	1980 FSL 1980 FEL	P&A - GAS	STRAWN	12003		STRAWN	11253		1990-06-08	1990-06-18	1990-08-21	12/6/1991	
V	30015423200000	CASCADE FEE	001	RKI EXPLORATION & PRODUCTION LLC	WPX ENERGY PERMIAN LLC	32	22S	27E	1650 FSL 1650 FEL	ACT - OIL	BONE SPRING	9620	9618	BONE SPRING	9600	BONE SPRING	2014-04-16	2014-08-09	2017-05-21		
DIR	30015423550000	OLD CAVERN FEE	1	RKI EXPLORATION & PRODUCTION LLC	RKI EXPLORATION & PRODUCTION	32	22S	27E	1650 FSL 2160 FWL	SI		9160	9160		9250	BONE SPRING	2014-05-01	2014-06-26	2017-09-13		
HZ	30015454460000	BOXER 32-22-27 FEE	401H	WPX ENERGY PERMIAN LLC	WPX ENERGY PERMIAN LLC	32	22S	27E	1833 FSL 489 FEL	PROD?		13747	8881		13491	WOLFCAMP	2018-11-16	2018-12-15			
V	30015011710000	LENAU	1	GETTY OIL COMPANY	GETTY OIL COMPANY	33	22S	27E	330 FNL 330 FWL	P&A - OIL		3137	3137				1927-05-24	1927-06-03	1927-10-11	1927?	
V	30015210960000	ETTER COM	1	MOBIL OIL CORPORATION	READ & STEVENS INCORPORATED	33	22S	27E	1980 FSL 1980 FWL	P&A		12200	12200		12500	MORROW	1974-02-04	1974-02-14	1974-07-11		
V	30015210960001	ETTER COM	1	READ & STEVENS INCORPORATED	READ & STEVENS INCORPORATED	33	22S	27E	1980 FSL 1980 FWL	ACT - GAS	STRAWN	12200	12200	STRAWN	11650	STRAWN	1989-10-21	1989-10-31	1989-11-29		
V	30015248100000	OTIS '33'	2	READ & STEVENS INCORPORATED	MARATHON OIL PERMIAN LLC	33	22S	27E	990 FNL 2130 FWL	P&A - GAS	MORROW	12070	12200	MORROW	12000	MORROW	1984-03-19	1984-03-29	1984-07-31		
V	30015248100002	OTIS 33	2	CHI OPERATING INCORPORATED	MARATHON OIL PERMIAN LLC	33	22S	27E	990 FNL 2130 FWL	ACT - GAS	WOLFCAMP	12070	12070	WOLFCAMP	12070		2004-10-01	2004-10-02	2004-11-29		

NOTE: NO WELLS PENETRATE THE DEVONIAN FORMATION WITHIN 1 MILE RADIUS

MEWBOURNE OIL COMPANY

HOP1 32 SWD #1 APPLICATION

TABULATION OF NEARBY WATER WELLS - SOURCE NEW MEXICO OFFICE OF THE STATE ENGINEER

POD Number	Source	q64	q16	q4	Sec	Tws	Rtg	Start Date	Finish_Dat	Depth_Well	Depth_Wate	Driller	LAT	LONG	
C 00400	Shallow	SE	SE	NE	4	23S	27E	1951-10-31	1951-10-02	145		HEMLER, HOWARD	32.33488408	-104.1875725	
C 03056	Shallow	NW	SW	NW	4	23S	27E	2004-07-01	2004-07-01	60	31		32.32938684	-104.2025812	
C 03798 POD1	Shallow	NW	SW	SW	4	23S	27E	2014-11-24	2014-11-25	200	51	SIRMAN, JOHN	32.3288639	-104.2033293	
C 00098	Shallow	NW	SW	SW	4	23S	27E						32.3293969	-104.2025918	
C 00098 A		SW	SW	SE	4	23S	27E						32.32761841	-104.1940121	
C 00098 A-S	Shallow	SE	SE	NE	4	23S	27E						32.32761841	-104.1940121	
C 00098 A-S-2		SE	SE	NE	4	23S	27E						32.33488408	-104.1875725	
C 00098 AS	Shallow	SW	SW	SE	4	23S	27E						32.3353053	-104.1871437	
C 00098 AS	Shallow	NW	SW	NW	4	23S	27E						32.32213507	-104.059914	
C 00109	Shallow	NW	SW	SW	4	23S	27E						32.32938684	-104.2025812	
C 00281	Shallow	SE	SE	NE	4	23S	27E						32.33488408	-104.1875725	
C 03476 POD1		NE	NE	NE	4	23S	27E					SIDES, BOYO	32.33994255	-104.1872191	
C 01670		SE	SE	NE	5	23S	27E	1976-05-27	1976-06-05	385		HALL, TONY	32.3348437	-104.2047543	
C 01671		SW	SW	NW	5	23S	27E	1976-05-03	1976-05-21	350			32.33477123	-104.2197152	
C 01976		SW	NW	NW	5	23S	27E	1981-09-07	1981-09-12	250			32.3384437	-104.2111618	
C 02710	Shallow			SE	5	23S	27E	2000-06-01	2000-06-09	200	72		32.33025025	-104.2078967	
C 02711	Shallow			SE	5	23S	27E	2000-06-01	2000-06-28	170	75		32.32846888	-104.2087873	
C 03020	Shallow	NE	SE	SE	5	23S	27E	2004-08-26	2004-08-31	176	135		32.32846888	-104.2057873	
C 03853 POD1	Shallow	NE	SE	SE	5	23S	27E	2014-07-14	2014-07-16	220	180	CURRY, CALEB	32.33035369	-104.2056964	
C 00025		NW	NW	SW	5	23S	27E						32.33293974	-104.2196778	
C 00176		NW	NW	SE	5	23S	27E						32.33297676	-104.2111242	
C 00296		NW	SE	SE	5	23S	27E						32.33207702	-104.2100589	
C 03023		SE	SE	SE	5	23S	27E						32.32846888	-104.2057873	
C 03093		SW	NW	NE	5	23S	27E						32.3384437	-104.2111618	
C 03098		SW	SE	NE	5	23S	27E						32.33482651	-104.2068793	
C 03190		NE	NE	SE	5	23S	27E						32.33299073	-104.2047278	
C 03273		NW	SE	SE	5	23S	27E						32.32936865	-104.2088525	
C 03945 POD1		NW	SE	NE	5	23S	27E						32.33703762	-104.2070194	
C 00028 CLW204125	Shallow	SE	NW	NE	6	23S	27E	1950-05-24	1950-06-15	210		HEMLER, HOWARD	32.33838327	-104.226166	
C 00028 S	Shallow	SW	NW	NE	6	23S	27E	1953-04-20	1953-04-30	231	190	HEMLER, HOWARD	32.33838628	-104.228291	
C 00624				NE	6	23S	27E						32.33760169	-104.187536	
C 02099	Shallow			NE	SW	6	23S	27E	1948-08-05	200		A.M. BRINNINSTOOL	32.3568047	-104.187536	
C 02151	Shallow			SE	SE	SE	SE	1948-07-15	1948-08-05	200		A.M. BRINNINSTOOL	32.36136747	-104.1928732	
C 04290 POD1	Shallow	SE	SE	SE	28	22S	27E	1954-05-31	1954-06-01	146		HOWARD HEMLER	32.3568047	-104.187536	
C 04298 POD1	Shallow	NE	NE	NE	28	22S	27E	1954-08-27	1954-09-04	130	84	DAVID SPENCER	32.36961406	-104.1874852	
C 01144	Shallow	SE	SE	SE	SE	SE	SE	1977-06-02	1977-06-09	140	100	JIM TOMBLIN	32.35772254	-104.1885769	
C 02149	Shallow	SE	SE	SE	SE	SE	SE	2005-04-04	2005-04-07	119	62		32.3568047	-104.187536	
C 02149 CLW488826	Shallow			SE	SE	SE	SE	1987-06-14	1987-06-22	125	70		32.35949544	-104.1907323	
C 02787	Shallow	NW	SW	NW	28	22S	27E	2001-11-10	2001-11-26	143	54	TAYLOR, CLINTON E.	32.36590313	-104.2025052	
C 03064	Shallow	SE	NE	SE	SE	SE	SE	2004-10-20	2004-10-21	125		MALEY, JASON R.	32.36046712	-104.1875245	
C 03392 POD1	Shallow	NE	NE	SE	SE	SE	SE	2008-12-24	2008-12-29	140	70	CLINTON E. TAYLOR	32.36230276	-104.1868066	
C 03763 POD1	Shallow	NW	NE	NE	SE	28	22S	27E	2014-07-23	240	55	CALEB CURRY	32.36884361	-104.1954738	
C 00014	Shallow	SW	NE	SW	28	22S	27E						32.36044648	-104.198238	
C 00014 CLW244969	Shallow	SW	SW	NW	28	22S	27E						32.36409904	-104.2025211	
C 00014 CLW244972	Shallow	SW	SW	NW	28	22S	27E						32.36409904	-104.2025211	
C 00014 S	Shallow	SW	SW	NW	28	22S	27E						32.36409904	-104.2025211	
C 00056	Shallow	NW	SW	NE	28	22S	27E						32.36593879	-104.1939273	
C 00695		SW	NW	SE	28	22S	27E						32.36046328	-104.1939547	
C 00828		NE	SE	SW	SE	SE	SE						32.3585736	-104.1961077	
C 01829	Shallow	SW	NE	SE	28	22S	27E						32.36048079	-104.18965	
C 02117		NW	NW	NE	SE	28	22S	27E					32.36961016	-104.1939054	
C 02979		NE	NE	SE	SE	SE	SE						32.3622712	-104.1875083	
C 03129		SE	NE	SE	SE	SE	SE						32.36046712	-104.1875245	
C 03288		SW	SE	NW	SE	28	22S	27E					32.36411692	-104.1982269	
C 03765 POD1		SE	NW	NW	28	22S	27E						32.36809105	-104.200424	
C 00597	Shallow	NW	NE	SW	29	22S	27E	1954-07-30	1954-08-05	140	90	DONOWHO, JOE	32.36214129	-104.2154307	
C 02831	Shallow	SE	SE	NE	29	22S	27E	1999-06-20	1999-07-12	96	69		32.36404966	-104.2047004	
C 02848	Shallow	SE	NE	NE	29	22S	27E	1999-04-28	1999-05-08	200	66	FELKINS, CLIFTON L.	32.36496735	-104.2057446	
C 02867	Shallow	NW	SW	SE	SE	29	22S	27E	1999-10-10	1999-10-19	128	81		32.35880606	-104.2111258
C 03434 POD1	Shallow	SE	SE	NE	29	22S	27E	2009-09-30	2009-10-05	99	75	CLINTON TAYLOR	32.3643528	-104.2041344	
C 00062	Shallow	NW	SW	SW	29	22S	27E						32.3612142	-104.2186698	
C 00172		NW	NE	SE	SE	29	22S	27E					32.3622047	-104.206821	
C 00172 S		SE	SE	SE	29	22S	27E						32.35672474	-104.2047114	
C 00172 S2	Shallow	SW	NW	SE	29	22S	27E						32.36037349	-104.2111415	
C 00172 S3		SW	NW	SE	29	22S	27E						32.36037349	-104.2111415	
C 00172 S4	Shallow	NW	NW	SE	29	22S	27E						32.36217758	-104.2111258	
C 00173		SE	SE	SE	29	22S	27E						32.35672474	-104.2047114	
C 00559		SW	SE	SE	29	22S	27E						32.35673612	-104.2068369	
C 01246 X	Shallow	SW	NW	NW	29	22S	27E						32.3639997	-104.2154466	
C 01246 X-3	Shallow	SW	SE	NW	29	22S	27E						32.36397228	-104.2197515	
C 01246 X3		SW	SE	NW	29	22S	27E						32.36763479	-104.2197519	
C 02598		SW	NW	NW	29	22S	27E						32.3639997	-104.2154466	
C 02644		SW	NW	NW	29	22S	27E						32.36397228	-104.2197515	
C 03130	Shallow	SE	NE	NW	29	22S	27E						32.36765791	-104.2133104	
C 00031 C	Shallow	NW	SE	SE	30	22S	27E	1953-12-31	1953-12-31	204	172	SPENCER DAVID A	32.36842367	-104.2240185	
C 01086	Shallow			NW	SE	30	22S	27E	1962-07-15	200	140	BARRON, EMMETT	32.36858185	-104.2333981	
C 01184	Shallow	SE	SE	SE	SE	30	22S	27E	1954-04-25	1954-05-03	144	131	SPENCER, DAVID A.	32.35660648	-104.2219084
C 01356	Shallow	SE	NE	SE	SE	30	22S	27E	1967-08-01	1967-12-31	210	130	ROBERTS, GRADY	32.36026999	-104.2219089
C 01478	Shallow	NE	NE	SE	SE	30	22S	27E	1972-07-02	1972-07-10	172	149	BARRON, EMMETT	32.36207308	-104.2218935
C 01691	Shallow	SW	NW	NW	30	22S	27E	1976-12-19	1976-12-29	210	68	BOYD SIDES	32.36755768	-104.2366317	
C 02409	Shallow	SW	SW	SE	SE	30	22S	27E	1984-12-02	1984-12-07	191	90	HAMMOND, J.O.	32.36660075	-104.2283171
C 03123	Shallow	NE	NE	SE	SE	30	22S	27E	2006-08-07	2006-09-09	159	97		32.36207308	-104.218935
C 03157	Shallow	NW	SE	NW	SE	30	22S	27E	2006-02-05	2006-02-08	173	100		32.36570201	-104.2376083
C 00183		NW	SE	SE	SE	30	22S	27E					32.35842367	-104.2240185	
C 00225 D	Shallow	SE	SE	SE	SE	30	22S	27E					32.35660648	-104.2219084	
C 00451	Shallow	SE	NE	SE	SE	30	22S	27E					32.36484911	-104.2226645	
C 01526		NW	NW	NW	30	22S	27E						32.36936178	-104.2366166	
C 03963 POD1		NE	NW	SE	SE	30	22S	27E					32.36249392	-104.22578	
C 00228 S	Shallow	NE	NE	NE	SE	31	22S	27E	1957-11-03	1957-12-20	225	145	SPENCER, DAVID A.	32.35475709	-104.2218924
C 01037	Shallow	NE	NE	NE	SE	31	22S	27E	1962-07-20	1962-08-03	141	109	SPENCER, DAVID A.	32.35475709	-104.2218924
C 02624	Shallow	SW	NE	NE	SE	31	22S	27E	1999-04-29	1999-05-15	220	75		32.35296609	-104.2240332
C 03078	Shallow	NW	NE	SE	SE	31	22S	27E	2005-06-06	2005-06-13	130	60	WAYNE BRAZEAL	32.34747222	-104.2240163
C 03161		SW	NW	NW	31	22S	27E	2006-01-31	2006-02-03	200			32.35293462	-104.2366164	
C 03445	Shallow	SW	SW	SW	SE	31	22S	27E					32.34226689	-104.2372905	
C 00032		SW	SW												

C.01749	Shallow			SW	32 22S	27E	1987-01-30	1987-02-05	156	126	MAGBY, EDGAR	32 3447/1049	-104.2165057
C.01833	Shallow			SW	32 22S	27E	1978-12-26	1979-01-09	180	155	JIM TOMBLIN	32 3447/1049	-104.2165057
C.02124	Shallow		SW	SW	32 22S	27E	1986-02-04	1986-02-20	195	60	GEORGE WEST	32 3429/1062	-104.2186571
C.02262	Shallow		SE	NE	32 22S	27E	1992-10-07	1992-10-07	128	60	COLLIS, ROBERT E. (LD)	32 3503/1763	-104.2057877
C.02502	Shallow		NE	NE	32 22S	27E	1998-02-16	1998-02-19	98	64		32 3639/8	-104.2057663
C.02590	Shallow	NE	NW	NE	32 22S	27E	1998-08-29	1998-08-29	87	45		32 3548/3934	-104.2090709
C.02590 POD2	Shallow	NE	NW	NE	32 22S	27E	1999-03-09	1999-03-16	300	114	TAYLOR, CLINTON E.	32 3548/3934	-104.2090709
C.02970	Shallow	SW	SE	SE	32 22S	27E	2003-06-12	2003-06-13	138	71	TAYLOR, CLINTON E.	32 3420/7943	-104.2068904
C.03028	Shallow	NW	NW	NE	32 22S	27E	2005-12-29	2006-07-26	217	89	VLOSICH, JOSEPH M., JR.	32 3548/5265	-104.2111363
C.03030	Shallow	SW	NW	NE	32 22S	27E	2005-09-24	2005-12-21	100	53	VLOSICH, JOSEPH M., JR.	32 3530/4856	-104.211152
C.03085	Shallow	NE	NE	NE	32 22S	27E	2005-05-08	2005-05-09	155	82		32 3530/4856	-104.211152
C.03821 POD1	Shallow	NE	SW	SE	32 22S	27E	2012-07-15	2012-07-19	105	90	HAMMOND, MARK (LD)	32 3435/2216	-104.2082274
C.03821	Shallow	NE	NE	SW	32 22S	27E	2014-12-12	2014-12-13	200	120	JUSTIN MULLINS	32 3467/7702	-104.2137249
C.00031 CLW205964	Shallow	SW	NW	SW	32 22S	27E						32 3456/687	-104.2197386
C.00193 & C-343-S			SW	NE	32 22S	27E						32 3502/9047	-104.2100813
C.00193 COMB-S-2				NE	32 22S	27E						32 3502/9019	-104.2079295
C.00193 COMBS			SW	NE	32 22S	27E						32 3502/9047	-104.2100813
C.00204			NE	SW	NE	32 22S	27E					32 3511/769	-104.2090215
C.00204 COMBS2			SW	SW	NE	32 22S	27E					32 3493/8612	-104.2111625
C.00204 CLW194896	Shallow	SW	SW	SW	NE	32 22S	27E					32 3493/8612	-104.2111625
C.00343 CLW242762	Shallow	SW	SW	NE	32 22S	27E						32 3548/5265	-104.2111363
C.00430	Shallow	NW	NW	NE	32 22S	27E						32 3530/4856	-104.211152
C.00430 S	Shallow	SW	NW	NE	32 22S	27E						32 3493/8612	-104.2111625
C.00619		SW	SW	NE	32 22S	27E						32 3493/8612	-104.2111625
C.00625		SW	SW	NE	32 22S	27E						32 3493/8612	-104.2111625
C.02383		SW	SW	NE	32 22S	27E						32 3493/8612	-104.2111625
C.02841		NW	NSW	SE	32 22S	27E						32 3493/8612	-104.2111625
C.02882		SW	NSW	NE	32 22S	27E						32 3493/8612	-104.2111625
C.03070		NW	SE	SE	32 22S	27E						32 3475/2771	-104.2111467
C.03179		NW	NW	SW	32 22S	27E						32 3530/4856	-104.211152
C.03409		NE	SW	SW	32 22S	27E						32 3438/352	-104.2068747
C.03900 POD1		SW	NE	NE	32 22S	27E						32 3474/728	-104.2197231
C.04328 POD1		SW	SW	SW	32 22S	27E						32 3435/0873	-104.2176425
C.00191	Shallow	SW	SW	NE	33 22S	27E	1950-04-10	1950-04-10	200		A.M. BRINNISTOOL	32 3423/9998	-104.2065553
C.00215	Shallow	SE	SW	NE	33 22S	27E	1947-04-16	1952-03-11	180	150	JOE BOND & FRED A.	32 3494/6892	-104.1939778
C.00514	Shallow	SW	SE	SE	33 22S	27E	1954-05-20	1946-12-31	180	80	FRED BOND	32 3494/5332	-104.1918525
C.00644	Shallow	SW	NE	SE	33 22S	27E	1965-07-08	1965-07-10	190		BARRON, EMMETT	32 3421/5051	-104.1866859
C.02230	Shallow				33 22S	27E	1991-07-20	1991-09-02	260	90	MARK HAMMOND	32 3458/13	-104.1866852
C.02392	Shallow		SE	NE	33 22S	27E	1995-01-24	1995-01-25	150	48	OSBOLJRN, FLOYD	32 3484/0943	-104.1950711
C.02412	Shallow	NE	SW	SW	33 22S	27E	1994-12-15	1995-01-30	251	65	TAYLOR, W.H. SR.	32 3503/8861	-104.1865823
C.02433	Shallow	SE	SW	SW	33 22S	27E	1995-01-30	1995-02-21	96	64	TAYLOR, W.H. SR.	32 3439/9719	-104.2004668
C.02449	Shallow				33 22S	27E	1995-12-28	1996-01-03	300	70		32 3420/931	-104.2004827
C.02696	Shallow	NW	SW	SW	33 22S	27E	2000-09-22	2000-09-30	124	71		32 3484/0943	-104.1950711
C.03013	Shallow	NW	NW	NW	33 22S	27E	2003-10-11	2003-12-31	120	62	VLOSICH, JOSEPH M., JR.	32 3439/1064	-104.202592
C.03066	Shallow	SE	NW	SW	33 22S	27E	2004-02-28	2004-05-21	118	63	VLOSICH, JOSEPH M., JR.	32 3549/0683	-104.202538
C.03074	Shallow	NW	NW	SW	33 22S	27E	2004-10-09	2004-10-13	240	85		32 3457/6449	-104.200461
C.03274	Shallow	SE	SW	NW	33 22S	27E	2004-09-03	2004-09-03	115			32 3475/8203	-104.2025704
C.03553 POD1	Shallow	SE	SE	SW	33 22S	27E	2006-07-27	2006-07-31	130	81		32 3494/2692	-104.200045
C.00191 CLW208156	Shallow	SE	NE	NE	33 22S	27E	2012-10-22	2012-10-23	200	75	KEY, GARY (LD)	32 3421/1086	-104.1961789
C.00191 S		SE	SE	NW	33 22S	27E						32 3528/7329	-104.1864021
C.00193 S		SE	SE	NW	33 22S	27E						32 3494/582	-104.1962712
C.00193 S	Shallow	NW	SW	NW	33 22S	27E						32 3494/4467	-104.1961459
C.00515 CLW197977	Shallow	NW	SW	NW	33 22S	27E						32 3512/4446	-104.2025595
C.00644 CLW198574	Shallow	SW	SE	SE	33 22S	27E						32 3512/4446	-104.2025595
C.01078	Shallow	SW	NE	SE	33 22S	27E						32 3421/5051	-104.1866859
C.02207		NE	SE	NE	33 22S	27E						32 3458/13	-104.1866852
C.02233		NW	NW	NW	33 22S	27E						32 3512/7486	-104.1875323
C.02533					33 22S	27E						32 3549/0683	-104.202538
C.02978		NW	SE	SE	33 22S	27E						32 3484/0943	-104.1950711
C.03012		NE	NW	NW	33 22S	27E						32 3467/0869	-104.1929077
C.03435 POD1		SW	SW	NW	33 22S	27E						32 3547/1585	-104.199447
C.04128 POD1		NE	NW	NW	33 22S	27E						32 3494/4038	-104.2025753
		SW	NW	SW	33 22S	27E						32 3543/0139	-104.2009492
												32 3456/687	-104.2010038
AVERAGE										179	97		



Shipment Receipt

June 12, 2019

1ZF698E80191618443

Where

Ship From

Mewbourne Oil Company, Kimberly Ripka
3901 South Broadway, Tyler, TX 75701
rmcdaniel@mewbourne.com, 903-561-2900

Ship To

New Mexico Oil Conservation Div., Phillip
Goetze-Engineernig Bureau
1220 South St. Francis Drive, SANTA FE, NM
87505
(505) 476-3440

What

Package 1 - 1ZF698E80191618443

Weight

0 lbs

Dimensions

UPS Letter

Service Details - UPS Next Day Air

Estimated Delivery Thursday June 13, 2019 , 10:30 AM

Payment

Bill Shipping Charges To: Shipper - F698E8

Shipping Total

Shipping Fees

Package 1

UPS Next Day Air

\$39.53

Fuel Surcharge

\$2.96

Subtotals

Shipping Fees

\$42.49

Combined Charges

\$42.49

Contract Rate

\$27.61

Transportation Charges: for services listed as guaranteed, refunds apply to transportation charges only. See Terms and Conditions in the Service Guide for details. Certain commodities and high value shipments may require additional transit time for customs clearance.

Rate includes a fuel Surcharge, but excludes taxes, duties and other charges that may apply to the shipment.

Your invoice may vary from the displayed reference rates

Note: This document is not an invoice.

All shipments are subject to the UPS Tariff/Terms and Conditions of Service ("UPS terms") in effect on the date of shipment, which are available at www.ups.com/terms. Pursuant to the UPS Terms, UPS's maximum liability for loss or damage to each domestic package or international shipment is limited to \$100, unless the shipper declares a greater value in the declared value field of the UPS shipping system used and pays the applicable charge (in which case UPS's maximum liability is the declared value). Special terms apply to some services and articles. Please review the UPS Terms for liability limits, exclusions from liability, maximum declared values, prohibited items, and other important terms of service. The shipper agrees that in the absence of a greater declared value, \$100 value is a reasonable limitation under the circumstances of the transportation. Claims not timely made (generally noticed within sixty days and filed within nine months, but filed within sixty days for international shipments) are deemed waived and will not be paid. See the UPS Terms for details. Under no circumstances will UPS be liable for any special, incidental, or consequential damages.

Proof of Delivery

Dear Customer,

This notice serves as proof of delivery for the shipment listed below.

Tracking Number

1ZF698E80191618443

Weight

0.00 LBS

Service

UPS Next Day Air®

Shipped / Billed On

06/12/2019

Delivered On

06/13/2019 9:55 A.M.

Delivered To

SANTA FE, NM, US

Received By

ROYBAL

Left At

Receiver

Thank you for giving us this opportunity to serve you. Details are only available for shipments delivered within the last 120 days. Please print for your records if you require this information after 120 days.

Sincerely,

UPS

Tracking results provided by UPS: 06/13/2019 4:03 P.M. EST



Shipment Receipt

June 12, 2019

1ZF698E80193233426

Where

Ship From

Mewbourne Oil Company, Kimberly Ripka
3901 South Broadway, Tyler, TX 75701
rmcdaniel@mewbourne.com, 903-561-2900

Ship To

J&J Farms Partnership
1134 Tracy Place, CARLSBAD, NM 88220
Residential

What

Package 1 - 1ZF698E80193233426

Weight
0 lbs

Dimensions
UPS Letter

Service Details - UPS Next Day Air

Estimated Delivery Thursday June 13, 2019 , End of Day

Payment

Bill Shipping Charges To: Shipper - F698E8

Shipping Total

Shipping Fees

Residential Address Surcharge	\$4.55
Package 1	
UPS Next Day Air	\$37.45
Delivery Area Surcharge	\$4.35
Fuel Surcharge	\$3.48

Transportation Charges: for services listed as guaranteed, refunds apply to transportation charges only. See Terms and Conditions in the Service Guide for details. Certain commodities and high value shipments may require additional transit time for customs clearance.

Note: This document is not an invoice.

All shipments are subject to the UPS Tariff/Terms and Conditions of Service ("UPS terms") in effect on the date of shipment, which are available at www.ups.com/terms. Pursuant to the UPS Terms, UPS's maximum liability for loss or damage to each domestic package or international shipment is limited to \$100, unless the shipper declares a greater value in the declared value field of the UPS shipping system used and pays the applicable charge (in which case UPS's maximum liability is the declared value). Special terms apply to some services and articles. Please review the UPS Terms for liability limits, exclusions from liability, maximum declared values, prohibited items, and other important terms of service. The shipper agrees that in the absence of a greater declared value, \$100 value is a reasonable limitation under the circumstances of the transportation. Claims not timely made (generally noticed within sixty days and filed within nine months, but filed within sixty days for international shipments) are deemed waived and will not be paid. See the UPS Terms for details. Under no circumstances will UPS be liable for any special, incidental, or consequential damages.

Subtotals

Shipping Fees	\$49.83
Combined Charges	\$49.83
Contract Rate	\$35.74

Rate includes a fuel Surcharge, but excludes taxes, duties and other charges that may apply to the shipment.
Your invoice may vary from the displayed reference rates

Proof of Delivery

Dear Customer,

This notice serves as proof of delivery for the shipment listed below.

Tracking Number

1ZF698E80193233426

Weight

0.00 LBS

Service

UPS Next Day Air®

Shipped / Billed On

06/12/2019

Delivered On

06/13/2019 1:17 P.M.

Delivered To

CARLSBAD, NM, US

Left At

Front Door

Thank you for giving us this opportunity to serve you. Details are only available for shipments delivered within the last 120 days. Please print for your records if you require this information after 120 days.

Sincerely,

UPS

Tracking results provided by UPS: 06/13/2019 4:04 P.M. EST



Shipment Receipt

June 12, 2019

1ZF698E80194690396

Where

Ship From

Mewbourne Oil Company, Kimberly Ripka
3901 South Broadway, Tyler, TX 75701
rmcdaniel@mewbourne.com, 903-561-2900

Ship To

Marathon Oil Permian, LLC
5555 San Felipe St, HOUSTON, TX 77056

What

Package 1 - 1ZF698E80194690396

Weight
0 lbs

Dimensions
UPS Letter

Service Details - UPS Next Day Air

Estimated Delivery Thursday June 13, 2019 , 10:30 AM

Payment

Bill Shipping Charges To: Shipper - F698E8

Shipping Total

Shipping Fees

Package 1	
UPS Next Day Air	\$29.35
Fuel Surcharge	\$2.20

Subtotals

Shipping Fees	\$31.55
Combined Charges	\$31.55
Contract Rate	\$20.51

Transportation Charges: for services listed as guaranteed, refunds apply to transportation charges only. See Terms and Conditions in the Service Guide for details. Certain commodities and high value shipments may require additional transit time for customs clearance.

Rate includes a fuel Surcharge, but excludes taxes, duties and other charges that may apply to the shipment.
Your invoice may vary from the displayed reference rates

Note: This document is not an invoice.

All shipments are subject to the UPS Tariff/Terms and Conditions of Service ("UPS terms") in effect on the date of shipment, which are available at www.ups.com/terms. Pursuant to the UPS Terms, UPS's maximum liability for loss or damage to each domestic package or international shipment is limited to \$100, unless the shipper declares a greater value in the declared value field of the UPS shipping system used and pays the applicable charge (in which case UPS's maximum liability is the declared value). Special terms apply to some services and articles. Please review the UPS Terms for liability limits, exclusions from liability, maximum declared values, prohibited items, and other important terms of service. The shipper agrees that in the absence of a greater declared value, \$100 value is a reasonable limitation under the circumstances of the transportation. Claims not timely made (generally noticed within sixty days and filed within nine months, but filed within sixty days for international shipments) are deemed waived and will not be paid. See the UPS Terms for details. Under no circumstances will UPS be liable for any special, incidental, or consequential damages.

Proof of Delivery

Dear Customer,

This notice serves as proof of delivery for the shipment listed below.

Tracking Number

1ZF698E80194690396

Weight

0.00 LBS

Service

UPS Next Day Air®

Shipped / Billed On

06/12/2019

Delivered On

06/13/2019 10:29 A.M.

Delivered To

HOUSTON, TX, US

Received By

RICHARD

Left At

Front Desk

Thank you for giving us this opportunity to serve you. Details are only available for shipments delivered within the last 120 days. Please print for your records if you require this information after 120 days.

Sincerely,

UPS

Tracking results provided by UPS: 06/13/2019 4:06 P.M. EST



Shipment Receipt

June 12, 2019

1ZF698E80199483995

Where

Ship From

Mewbourne Oil Company, Kimberly Ripka
3901 South Broadway, Tyler, TX 75701
rmcdaniel@mewbourne.com, 903-561-2900

Ship To

Read and Stephens, Inc.
400 Penn Plaza, Suite 1000, ROSWELL, NM
88201

What

Package 1 - 1ZF698E80199483995

Weight
0 lbs

Dimensions
UPS Letter

Service Details - UPS Next Day Air

Estimated Delivery Thursday June 13, 2019 , 12:00 PM

Payment

Bill Shipping Charges To: Shipper - F698E8

Shipping Total

Shipping Fees

Package 1	
UPS Next Day Air	\$37.45
Fuel Surcharge	\$2.81

Subtotals

Shipping Fees	\$40.26
Combined Charges	\$40.26
Contract Rate	\$26.17

Transportation Charges: for services listed as guaranteed, refunds apply to transportation charges only. See Terms and Conditions in the Service Guide for details. Certain commodities and high value shipments may require additional transit time for customs clearance.

Rate includes a fuel Surcharge, but excludes taxes, duties and other charges that may apply to the shipment.
Your invoice may vary from the displayed reference rates

Note: This document is not an invoice.

All shipments are subject to the UPS Tariff/Terms and Conditions of Service ("UPS terms") in effect on the date of shipment, which are available at www.ups.com/terms. Pursuant to the UPS Terms, UPS's maximum liability for loss or damage to each domestic package or international shipment is limited to \$100, unless the shipper declares a greater value in the declared value field of the UPS shipping system used and pays the applicable charge (in which case UPS's maximum liability is the declared value). Special terms apply to some services and articles. Please review the UPS Terms for liability limits, exclusions from liability, maximum declared values, prohibited items, and other important terms of service. The shipper agrees that in the absence of a greater declared value, \$100 value is a reasonable limitation under the circumstances of the transportation. Claims not timely made (generally noticed within sixty days and filed within nine months, but filed within sixty days for international shipments) are deemed waived and will not be paid. See the UPS Terms for details. Under no circumstances will UPS be liable for any special, incidental, or consequential damages.

Proof of Delivery

Dear Customer,

This notice serves as proof of delivery for the shipment listed below.

Tracking Number

1ZF698E80199483995

Weight

0.00 LBS

Service

UPS Next Day Air®

Shipped / Billed On

06/12/2019

Delivered On

06/14/2019 10:55 A.M.

Delivered To

ROSWELL, NM, US

Received By

TURLEY

Left At

Office

Thank you for giving us this opportunity to serve you. Details are only available for shipments delivered within the last 120 days. Please print for your records if you require this information after 120 days.

Sincerely,

UPS

Tracking results provided by UPS: 06/14/2019 2:09 P.M. EST



Shipment Receipt

June 13, 2019

1ZF698E80193725850

Where

Ship From

Mewbourne Oil Company, Kimberly Ripka
3901 South Broadway, Tyler, TX 75701
mcdaniel@mewbourne.com, 903-561-2900

Ship To

Devon Energy Production Company, LP
333 West Sherican Avenue, OKLAHOMA CITY,
OK 73102

What

Package 1 - 1ZF698E80193725850

Weight
0 lbs

Dimensions
UPS Letter

Service Details - UPS Next Day Air

Estimated Delivery Friday June 14, 2019 , 10:30 AM

Payment

Bill Shipping Charges To: Shipper - F698E8

Shipping Total

Shipping Fees

Package 1	
UPS Next Day Air	\$29.35
Fuel Surcharge	\$2.20

Subtotals

Shipping Fees	\$31.55
Combined Charges	\$31.55
Contract Rate	\$20.51

Transportation Charges: for services listed as guaranteed, refunds apply to transportation charges only. See Terms and Conditions in the Service Guide for details. Certain commodities and high value shipments may require additional transit time for customs clearance.

Rate includes a fuel Surcharge, but excludes taxes, duties and other charges that may apply to the shipment.
Your invoice may vary from the displayed reference rates

Note: This document is not an invoice.

All shipments are subject to the UPS Tariff/Terms and Conditions of Service ("UPS terms") in effect on the date of shipment, which are available at www.ups.com/terms. Pursuant to the UPS Terms, UPS's maximum liability for loss or damage to each domestic package or international shipment is limited to \$100, unless the shipper declares a greater value in the declared value field of the UPS shipping system used and pays the applicable charge (in which case UPS's maximum liability is the declared value). Special terms apply to some services and articles. Please review the UPS Terms for liability limits, exclusions from liability, maximum declared values, prohibited items, and other important terms of service. The shipper agrees that in the absence of a greater declared value, \$100 value is a reasonable limitation under the circumstances of the transportation. Claims not timely made (generally noticed within sixty days and filed within nine months, but filed within sixty days for international shipments) are deemed waived and will not be paid. See the UPS Terms for details. Under no circumstances will UPS be liable for any special, incidental, or consequential damages.

Proof of Delivery

Dear Customer,

This notice serves as proof of delivery for the shipment listed below.

Tracking Number

1ZF698E80193725850

Weight

0.00 LBS

Service

UPS Next Day Air®

Shipped / Billed On

06/13/2019

Delivered On

06/14/2019 10:16 A.M.

Delivered To

OKLAHOMA CITY, OK, US

Received By

WELLS

Left At

Receiver

Thank you for giving us this opportunity to serve you. Details are only available for shipments delivered within the last 120 days. Please print for your records if you require this information after 120 days.

Sincerely,

UPS

Tracking results provided by UPS: 06/14/2019 2:11 P.M. EST



Shipment Receipt

June 12, 2019

1ZF698E80192239637

Where

Ship From

Mewbourne Oil Company, Kimberly Ripka
3901 South Broadway, Tyler, TX 75701
rmcdaniel@mewbourne.com, 903-561-2900

Ship To

Tap Rock Operating, LLC
602 Park Point Drive, Suite 200, GOLDEN, CO
80401

What

Package 1 - 1ZF698E80192239637

Weight
0 lbs

Dimensions
UPS Letter

Service Details - UPS Next Day Air

Estimated Delivery Thursday June 13, 2019 , 10:30 AM

Payment

Bill Shipping Charges To: Shipper - F698E8

Shipping Total

Shipping Fees

Package 1	
UPS Next Day Air	\$39.53
Fuel Surcharge	\$2.96

Subtotals

Shipping Fees	\$42.49
Combined Charges	\$42.49
Contract Rate	\$27.61

Transportation Charges: for services listed as guaranteed, refunds apply to transportation charges only. See Terms and Conditions in the Service Guide for details. Certain commodities and high value shipments may require additional transit time for customs clearance.

Rate includes a fuel Surcharge, but excludes taxes, duties and other charges that may apply to the shipment.
Your invoice may vary from the displayed reference rates

Note: This document is not an invoice.

All shipments are subject to the UPS Tariff/Terms and Conditions of Service ("UPS terms") in effect on the date of shipment, which are available at www.ups.com/terms. Pursuant to the UPS Terms, UPS's maximum liability for loss or damage to each domestic package or international shipment is limited to \$100, unless the shipper declares a greater value in the declared value field of the UPS shipping system used and pays the applicable charge (in which case UPS's maximum liability is the declared value). Special terms apply to some services and articles. Please review the UPS Terms for liability limits, exclusions from liability, maximum declared values, prohibited items, and other important terms of service. The shipper agrees that in the absence of a greater declared value, \$100 value is a reasonable limitation under the circumstances of the transportation. Claims not timely made (generally noticed within sixty days and filed within nine months, but filed within sixty days for international shipments) are deemed waived and will not be paid. See the UPS Terms for details. Under no circumstances will UPS be liable for any special, incidental, or consequential damages.

Proof of Delivery

Dear Customer,

This notice serves as proof of delivery for the shipment listed below.

Tracking Number

1ZF698E80192239637

Weight

0.00 LBS

Service

UPS Next Day Air®

Shipped / Billed On

06/12/2019

Delivered On

06/13/2019 10:20 A.M.

Delivered To

GOLDEN, CO, US

Received By

KASA

Left At

Office

Thank you for giving us this opportunity to serve you. Details are only available for shipments delivered within the last 120 days. Please print for your records if you require this information after 120 days.

Sincerely,

UPS

Tracking results provided by UPS: 06/13/2019 4:03 P.M. EST



Shipment Receipt

June 12, 2019

1ZF698E80196670985

Where

Ship From

Mewbourne Oil Company, Kimberly Ripka
3901 South Broadway, Tyler, TX 75701
rmcdaniel@mewbourne.com, 903-561-2900

Ship To

Lanexco New Mexico
107 Main Street, SEALY, TX 77474

What

Package 1 - 1ZF698E80196670985

Weight

0 lbs

Dimensions

UPS Letter

Service Details - UPS Next Day Air

Estimated Delivery Thursday June 13, 2019 , 12:00 PM

Payment

Bill Shipping Charges To: Shipper - F698E8

Shipping Total

Shipping Fees

Package 1	
UPS Next Day Air	\$29.35
Delivery Area Surcharge – Extended	\$2.95
Fuel Surcharge	\$2.42

Subtotals

Shipping Fees	\$34.72
Combined Charges	\$34.72
Contract Rate	\$23.68

Transportation Charges: for services listed as guaranteed, refunds apply to transportation charges only. See Terms and Conditions in the Service Guide for details. Certain commodities and high value shipments may require additional transit time for customs clearance.

Rate includes a fuel Surcharge, but excludes taxes, duties and other charges that may apply to the shipment.
Your invoice may vary from the displayed reference rates

Note: This document is not an invoice.

All shipments are subject to the UPS Tariff/Terms and Conditions of Service ("UPS terms") in effect on the date of shipment, which are available at www.ups.com/terms. Pursuant to the UPS Terms, UPS's maximum liability for loss or damage to each domestic package or international shipment is limited to \$100, unless the shipper declares a greater value in the declared value field of the UPS shipping system used and pays the applicable charge (in which case UPS's maximum liability is the declared value). Special terms apply to some services and articles. Please review the UPS Terms for liability limits, exclusions from liability, maximum declared values, prohibited items, and other important terms of service. The shipper agrees that in the absence of a greater declared value, \$100 value is a reasonable limitation under the circumstances of the transportation. Claims not timely made (generally noticed within sixty days and filed within nine months, but filed within sixty days for international shipments) are deemed waived and will not be paid. See the UPS Terms for details. Under no circumstances will UPS be liable for any special, incidental, or consequential damages.

Proof of Delivery

Dear Customer,

This notice serves as proof of delivery for the shipment listed below.

Tracking Number

1ZF698E80196670985

Weight

0.00 LBS

Service

UPS Next Day Air®

Shipped / Billed On

06/12/2019

Delivered On

06/13/2019 11:26 A.M.

Delivered To

SEALY, TX, US

Left At

Front Door

Thank you for giving us this opportunity to serve you. Details are only available for shipments delivered within the last 120 days. Please print for your records if you require this information after 120 days.

Sincerely,

UPS

Tracking results provided by UPS: 06/13/2019 4:04 P.M. EST



Shipment Receipt

June 12, 2019

1ZF698E80193003817

Where

Ship From

Mewbourne Oil Company, Kimberly Ripka
3901 South Broadway, Tyler, TX 75701
rmcdaniel@mewbourne.com, 903-561-2900

Ship To

WPX Energy Permian LLC
3500 One Williams Center, TULSA, OK 74172

What

Package 1 - 1ZF698E80193003817

Weight
0 lbs

Dimensions
UPS Letter

Service Details - UPS Next Day Air

Estimated Delivery Thursday June 13, 2019 , 10:30 AM

Payment

Bill Shipping Charges To: Shipper - F698E8

Shipping Total

Shipping Fees

Package 1	
UPS Next Day Air	\$29.35
Fuel Surcharge	\$2.20

Subtotals

Shipping Fees	\$31.55
Combined Charges	\$31.55
Contract Rate	\$20.51

Transportation Charges: for services listed as guaranteed, refunds apply to transportation charges only. See Terms and Conditions in the Service Guide for details. Certain commodities and high value shipments may require additional transit time for customs clearance.

Rate includes a fuel Surcharge, but excludes taxes, duties and other charges that may apply to the shipment.
Your invoice may vary from the displayed reference rates

Note: This document is not an invoice.

All shipments are subject to the UPS Tariff/Terms and Conditions of Service ("UPS terms") in effect on the date of shipment, which are available at www.ups.com/terms. Pursuant to the UPS Terms, UPS's maximum liability for loss or damage to each domestic package or international shipment is limited to \$100, unless the shipper declares a greater value in the declared value field of the UPS shipping system used and pays the applicable charge (in which case UPS's maximum liability is the declared value). Special terms apply to some services and articles. Please review the UPS Terms for liability limits, exclusions from liability, maximum declared values, prohibited items, and other important terms of service. The shipper agrees that in the absence of a greater declared value, \$100 value is a reasonable limitation under the circumstances of the transportation. Claims not timely made (generally noticed within sixty days and filed within nine months, but filed within sixty days for international shipments) are deemed waived and will not be paid. See the UPS Terms for details. Under no circumstances will UPS be liable for any special, incidental, or consequential damages.

Proof of Delivery

Dear Customer,

This notice serves as proof of delivery for the shipment listed below.

Tracking Number

1ZF698E80193003817

Weight

0.00 LBS

Service

UPS Next Day Air®

Shipped / Billed On

06/12/2019

Delivered On

06/13/2019 10:14 A.M.

Delivered To

TULSA, OK, US

Received By

NOLAN

Left At

Other - released

Thank you for giving us this opportunity to serve you. Details are only available for shipments delivered within the last 120 days. Please print for your records if you require this information after 120 days.

Sincerely,

UPS

Tracking results provided by UPS: 06/13/2019 4:05 P.M. EST



Shipment Receipt

June 12, 2019

1ZF698E80191114808

Where

Ship From

Mewbourne Oil Company, Kimberly Ripka
3901 South Broadway, Tyler, TX 75701
rmcdaniel@mewbourne.com, 903-561-2900

Ship To

Matador Production Company
One Lincoln Center, 5400 LBJ Freeway, Suite
1500, DALLAS, TX 75240

What

Package 1 - 1ZF698E80191114808

Weight
0 lbs

Dimensions
UPS Letter

Service Details - UPS Next Day Air

Estimated Delivery Thursday June 13, 2019 , 10:30 AM

Payment

Bill Shipping Charges To: Shipper - F698E8

Shipping Total

Shipping Fees

Package 1	
UPS Next Day Air	\$24.64
Fuel Surcharge	\$1.85

Subtotals

Shipping Fees	\$26.49
Combined Charges	\$26.49
Contract Rate	\$17.22

Transportation Charges: for services listed as guaranteed, refunds apply to transportation charges only. See Terms and Conditions in the Service Guide for details. Certain commodities and high value shipments may require additional transit time for customs clearance.

Rate includes a fuel Surcharge, but excludes taxes, duties and other charges that may apply to the shipment.
Your invoice may vary from the displayed reference rates

Note: This document is not an invoice.

All shipments are subject to the UPS Tariff/Terms and Conditions of Service ("UPS terms") in effect on the date of shipment, which are available at www.ups.com/terms. Pursuant to the UPS Terms, UPS's maximum liability for loss or damage to each domestic package or international shipment is limited to \$100, unless the shipper declares a greater value in the declared value field of the UPS shipping system used and pays the applicable charge (in which case UPS's maximum liability is the declared value). Special terms apply to some services and articles. Please review the UPS Terms for liability limits, exclusions from liability, maximum declared values, prohibited items, and other important terms of service. The shipper agrees that in the absence of a greater declared value, \$100 value is a reasonable limitation under the circumstances of the transportation. Claims not timely made (generally noticed within sixty days and filed within nine months, but filed within sixty days for international shipments) are deemed waived and will not be paid. See the UPS Terms for details. Under no circumstances will UPS be liable for any special, incidental, or consequential damages.

Proof of Delivery

Dear Customer,

This notice serves as proof of delivery for the shipment listed below.

Tracking Number

1ZF698E80191114808

Weight

0.00 LBS

Service

UPS Next Day Air®

Shipped / Billed On

06/12/2019

Delivered On

06/13/2019 9:37 A.M.

Delivered To

DALLAS, TX, US

Received By

BROWN

Left At

Front Desk

Thank you for giving us this opportunity to serve you. Details are only available for shipments delivered within the last 120 days. Please print for your records if you require this information after 120 days.

Sincerely,

UPS

Tracking results provided by UPS: 06/13/2019 4:05 P.M. EST

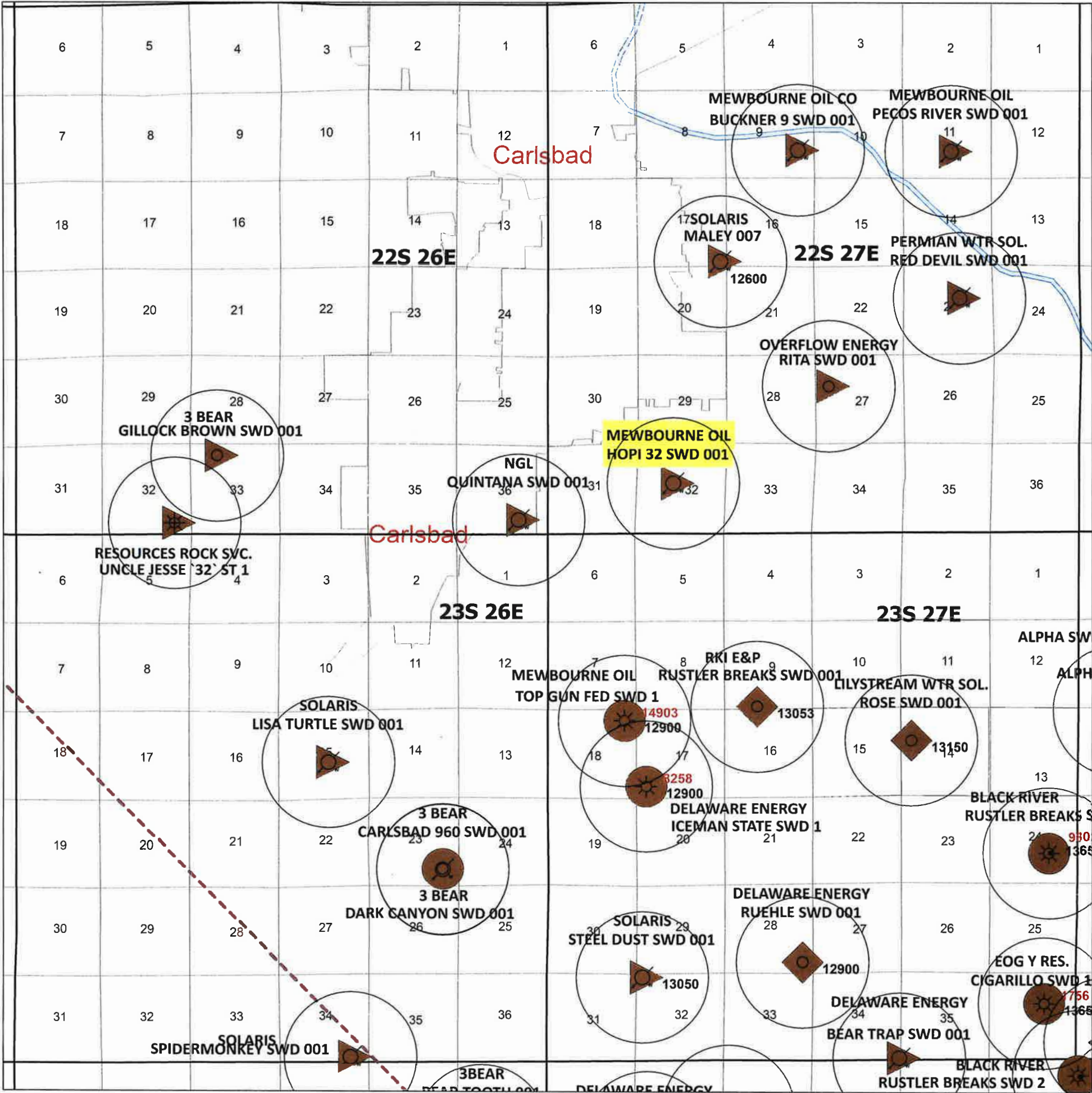





PERMITTED DISPOSAL WELL



ACTIVE DISPOSAL WELL



PLUGGED DISPOSAL WELLS



TEMPORARILY ABANDON



SHUT - IN



SWD WELLS IN APPLICATION PROCESS

DEVONIAN SWD WELLS



2018 AVG RATE
TOP INTERVAL



.75 MILE RADIUS

ORDOVICIAN SWD WELLS



2018 AVG RATE
TOP INTERVAL

FAULT

(UNIVERSITY OF TEXAS BUREAU OF
ECONOMIC GEOLOGY)

<div><div>MOC</div><div>Mewbourne Oil Company</div></div>		
HOPI 32 SWD #001 Sec. 32-22S-27E 2411' FNL & 2811' FWL EDDY, NEW MEXICO		
		Date: 4 June, 2019
Tech: Steve Daughtry	Scale: 1" = 4000'	Hopi 32 SWD #001 ¼ Mile Circle.gmp

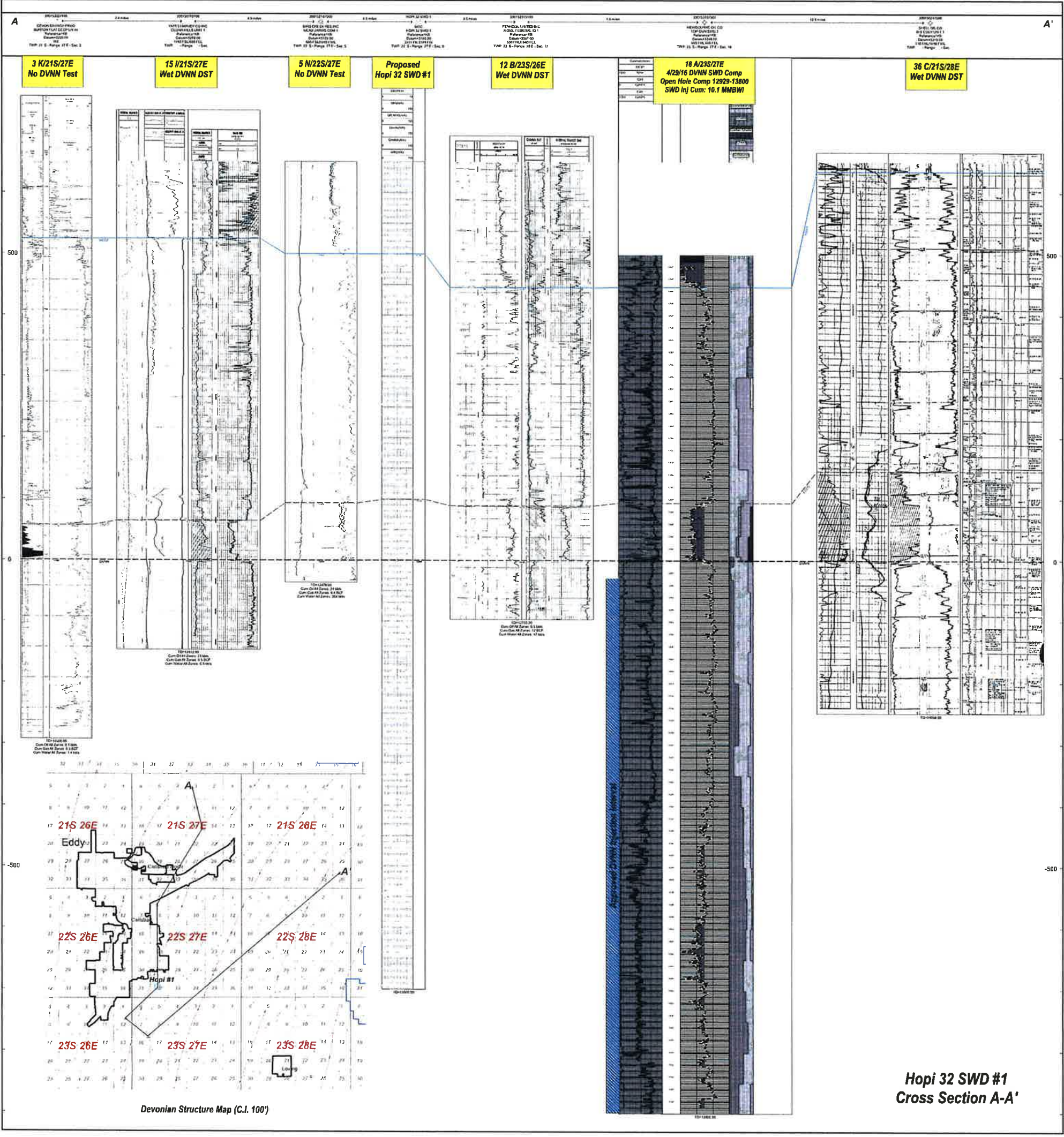

Hopi 32 SWD #1
Cross Section A-A'