

| | | | |
|----------------------------------|-----------|--------------|-----------------------------|
| RECEIVED: <i>mm</i> 4/24/2019 | REVIEWER: | TYPE: SWD | APP NO: DMAm 19116 29979 |
|----------------------------------|-----------|--------------|-----------------------------|

ABOVE THIS TABLE FOR OCD DIVISION USE ONLY

NEW MEXICO OIL CONSERVATION DIVISION
 - Geological & Engineering Bureau -
 1220 South St. Francis Drive, Santa Fe, NM 87505



ADMINISTRATIVE APPLICATION CHECKLIST

THIS CHECKLIST IS MANDATORY FOR ALL ADMINISTRATIVE APPLICATIONS FOR EXCEPTIONS TO DIVISION RULES AND REGULATIONS WHICH REQUIRE PROCESSING AT THE DIVISION LEVEL IN SANTA FE

| | |
|--------------------------------------------------|-----------------------------|
| Applicant: Delaware Energy | OGRID Number: 371195 |
| Well Name: Tasmanian Devil SWD Well No. 1 | API: 30-015-Pending |
| Pool: swd; Devonian | Pool Code: 96101 |

SUBMIT ACCURATE AND COMPLETE INFORMATION REQUIRED TO PROCESS THE TYPE OF APPLICATION INDICATED BELOW

- 1) **TYPE OF APPLICATION:** Check those which apply for [A]
- A. Location – Spacing Unit – Simultaneous Dedication
 NSL NSP (PROJECT AREA) NSP (PRORATION UNIT) SD
- B. Check one only for [I] or [II]
- [I] Commingling – Storage – Measurement
 DHC CTB PLC PC OLS OLM
- [II] Injection – Disposal – Pressure Increase – Enhanced Oil Recovery
 WFX PMX SWD IPI EOR PPR

- 2) **NOTIFICATION REQUIRED TO:** Check those which apply.
- A. Offset operators or lease holders
 B. Royalty, overriding royalty owners, revenue owners
 C. Application requires published notice
 D. Notification and/or concurrent approval by SLO
 E. Notification and/or concurrent approval by BLM
 F. Surface owner
 G. For all of the above, proof of notification or publication is attached, and/or,
 H. No notice required

| FOR OCD ONLY | |
|--------------------------|------------------------------|
| <input type="checkbox"/> | Notice Complete |
| <input type="checkbox"/> | Application Content Complete |

3) **CERTIFICATION:** I hereby certify that the information submitted with this application for administrative approval is **accurate** and **complete** to the best of my knowledge. I also understand that **no action** will be taken on this application until the required information and notifications are submitted to the Division.

Note: Statement must be completed by an individual with managerial and/or supervisory capacity.

Sarah Presley
 Print or Type Name

April 26, 2019
 Date

432-685-7008
 Phone Number

see Application
 Signature

S.Presley@delawareenergy.com
 e-mail Address

McMillan, Michael, EMNRD

From: Charles Moran <Charles_Moran@eogresources.com>
Sent: Thursday, April 25, 2019 5:22 PM
To: McMillan, Michael, EMNRD; Dawson, Scott, EMNRD; Goetze, Phillip, EMNRD; Lowe, Leonard, EMNRD
Cc: Erin Lloyd; Stephanie Williams; Sarah Presley
Subject: [EXT] Protests SWD Proposal - Tasmanian Devil SWD #1/ Delaware Energy, LLC Unit M Sec. 10-T25S-R27E, Eddy County, New Mexico.

Messer: McMillan, Dawson, Goetze and Lowe:

EOG Resources, Inc. protests the SWD application of Delaware Energy, LLC's Tasmanian Devil SWD #1 at the proposed location of 306' FSL & 695' FWL, Unit Letter M, Sec. 10-T25S-R27E, Eddy County, New Mexico. We request this matter be set for hearing if it proceeds.

Chuck Moran

EOG Resources, Inc. – Midland Division

432-686-3684

Delaware Energy, L.L.C.
405 N. Marienfeld, Suite 200
Midland, TX 79701
Office: (432) 685-7005

April 15, 2019

Surface Owner / Offset Operators

Re: Notification of Application for Authorization to Inject
Tasmanian Devil SWD #1 Well

Ladies and Gentlemen:

Delaware Energy, LLC is seeking administrative approval to utilize the proposed Tasmanian Devil SWD #1 as a commercial Salt Water Disposal well. As required by the New Mexico Oil Conservation Division Rules, we are notifying you of the following proposed salt water disposal well. This letter is a notice only. No action is required unless you have questions or objections.

| | |
|--------------------------------|-----------------------------------------------------------------|
| <u>Well:</u> | Tasmanian Devil SWD #1 |
| <u>Proposed Disposal Zone:</u> | Devonian Formation (from 13,397' - 14,397') |
| <u>Location:</u> | 306' FSL & 695' FWL, UL M, Sec. 10, T25S, R27E, Eddy Co., NM |
| <u>Applicants Name:</u> | Delaware Energy, L.L.C. |
| <u>Applicants Address:</u> | 405 N. Marienfeld, Suite 200, Midland, TX 79701 |

This application for water disposal well will be filed with the New Mexico Oil Conservation Division. If they determine the application complies with the applicable regulations, then it will be approved. The New Mexico Conservation Division address is 1220 South St. Francis Dr., Santa Fe, NM 87505. And their phone number is 505-476-3460.

Please call Sarah Presley with Delaware Energy, LLC if you have any questions at 432-685-7005.

Sincerely,

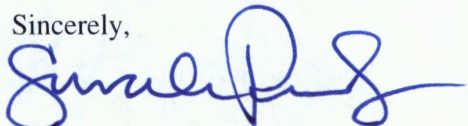

Sarah Presley

DISTRIBUTION LIST

Surface Owner:

State of New Mexico
310 Old Santa Fe Trail
Santa Fe NM 87501

Offset Operators/Leasehold Owners:

COG Operating, LLC
600 W. Illinois
Midland, TX 79701

EOG Resources, Inc
5509 Champions Dr.
Midland, TX 79706

Chevron USA Inc.
6301 Deauville Blvd.
Midland, TX 79706

State of New Mexico Oil Conservation Division
District II
811 S. First St.
Artesia, NM 88210

State of New Mexico Oil Conservation Division
1220 South St. Francis Dr.
Santa Fe, NM 87505

APPLICATION FOR AUTHORIZATION TO INJECT

APR 24 2019 AM 11:47

- I. PURPOSE: _____ Secondary Recovery _____ Pressure Maintenance XXX Disposal _____ Storage
Application qualifies for administrative approval? XX Yes _____ No
- II. OPERATOR: Delaware Energy, LLC
ADDRESS: 405 North Marienfeld, Suite 250, Midland TX 79701
CONTACT PARTY: Mike McCurdy PHONE: 432-312-5251
- III. WELL DATA: Complete the data required on the reverse side of this form for each well proposed for injection.
Additional sheets may be attached if necessary.
- IV. Is this an expansion of an existing project? _____ Yes XXXX No
If yes, give the Division order number authorizing the project: _____
- V. Attach a map that identifies all wells and leases within two miles of any proposed injection well with a one-half mile radius circle drawn around each proposed injection well. This circle identifies the well's area of review.
- VI. Attach a tabulation of data on all wells of public record within the area of review which penetrate the proposed injection zone. Such data shall include a description of each well's type, construction, date drilled, location, depth, record of completion, and a schematic of any plugged well illustrating all plugging detail.
- VII. Attach data on the proposed operation, including:
1. Proposed average and maximum daily rate and volume of fluids to be injected;
 2. Whether the system is open or closed;
 3. Proposed average and maximum injection pressure;
 4. Sources and an appropriate analysis of injection fluid and compatibility with the receiving formation if other than reinjected produced water; and,
 5. If injection is for disposal purposes into a zone not productive of oil or gas at or within one mile of the proposed well, attach a chemical analysis of the disposal zone formation water (may be measured or inferred from existing literature, studies, nearby wells, etc.).
- *VIII. Attach appropriate geologic data on the injection zone including appropriate lithologic detail, geologic name, thickness, and depth. Give the geologic name, and depth to bottom of all underground sources of drinking water (aquifers containing waters with total dissolved solids concentrations of 10,000 mg/l or less) overlying the proposed injection zone as well as any such sources known to be immediately underlying the injection interval.
- IX. Describe the proposed stimulation program, if any.
- *X. Attach appropriate logging and test data on the well. (If well logs have been filed with the Division, they need not be resubmitted).
- *XI. Attach a chemical analysis of fresh water from two or more fresh water wells (if available and producing) within one mile of any injection or disposal well showing location of wells and dates samples were taken.
- XII. Applicants for disposal wells must make an affirmative statement that they have examined available geologic and engineering data and find no evidence of open faults or any other hydrologic connection between the disposal zone and any underground sources of drinking water.
- XIII. Applicants must complete the "Proof of Notice" section on the reverse side of this form.
- XIV. Certification: I hereby certify that the information submitted with this application is true and correct to the best of my knowledge and belief.

NAME: Mike McCurdy TITLE: Vice-President

SIGNATURE:  DATE: 4/15/2019

E-MAIL ADDRESS: m.mccurdy@delawareenergy.com

- * If the information required under Sections VI, VIII, X, and XI above has been previously submitted, it need not be resubmitted. Please show the date and circumstances of the earlier submittal: _____

III. WELL DATA

A. The following well data must be submitted for each injection well covered by this application. The data must be both in tabular and schematic form and shall include:

- (1) Lease name; Well No.; Location by Section, Township and Range; and footage location within the section.
- (2) Each casing string used with its size, setting depth, sacks of cement used, hole size, top of cement, and how such top was determined.
- (3) A description of the tubing to be used including its size, lining material, and setting depth.
- (4) The name, model, and setting depth of the packer used or a description of any other seal system or assembly used.

Division District Offices have supplies of Well Data Sheets which may be used or which may be used as models for this purpose. Applicants for several identical wells may submit a "typical data sheet" rather than submitting the data for each well.

B. The following must be submitted for each injection well covered by this application. All items must be addressed for the initial well. Responses for additional wells need be shown only when different. Information shown on schematics need not be repeated.

- (1) The name of the injection formation and, if applicable, the field or pool name.
- (2) The injection interval and whether it is perforated or open-hole.
- (3) State if the well was drilled for injection or, if not, the original purpose of the well.
- (4) Give the depths of any other perforated intervals and detail on the sacks of cement or bridge plugs used to seal off such perforations.
- (5) Give the depth to and the name of the next higher and next lower oil or gas zone in the area of the well, if any.

XIV. PROOF OF NOTICE

All applicants must furnish proof that a copy of the application has been furnished, by certified or registered mail, to the owner of the surface of the land on which the well is to be located and to each leasehold operator within one-half mile of the well location.

Where an application is subject to administrative approval, a proof of publication must be submitted. Such proof shall consist of a copy of the legal advertisement which was published in the county in which the well is located. The contents of such advertisement must include:

- (1) The name, address, phone number, and contact party for the applicant;
- (2) The intended purpose of the injection well; with the exact location of single wells or the Section, Township, and Range location of multiple wells;
- (3) The formation name and depth with expected maximum injection rates and pressures; and,
- (4) A notation that interested parties must file objections or requests for hearing with the Oil Conservation Division, 1220 South St. Francis Dr., Santa Fe, New Mexico 87505, within 15 days.

NO ACTION WILL BE TAKEN ON THE APPLICATION UNTIL PROPER PROOF OF NOTICE HAS BEEN SUBMITTED.

NOTICE: Surface owners or offset operators must file any objections or requests for hearing of administrative applications within 15 days from the date this application was mailed to them.

INJECTION WELL DATA SHEET

OPERATOR: Delaware Energy, LLC

WELL NAME & NUMBER: Tasmanian Devil SWD # 1

WELL LOCATION: 306' FSL & 695' FWL M 10 SECTION 25S TOWNSHIP 27E RANGE
FOOTAGE LOCATION UNIT LETTER SECTION TOWNSHIP RANGE

WELLBORE SCHEMATIC see attached wellbore sketch

WELL CONSTRUCTION DATA

Surface Casing

Hole Size: 17-1/2" Casing Size: 13-3/8", 54.5#
Cemented with: 500 sx. or ft³

Top of Cement: surface Method Determined: Plan to Circulate

Intermediate Casing

Hole Size: 12-1/4" Casing Size: 9-5/8", 47#, L-80
Cemented with: 2,500' sx. or ft³

Top of Cement: surface Method Determined: Plan to Circulate

Production Casing

Hole Size: 8-1/2" Casing Size: 7-5/8", 39#, P-110
Cemented with: 650 sx. or ft³

Top of Cement: Top of Liner Method Determined: Plan to Circulate to liner top

Total Depth: 13,397'

Injection Interval

13,397' feet to 14,397'
(OPEN HOLE)

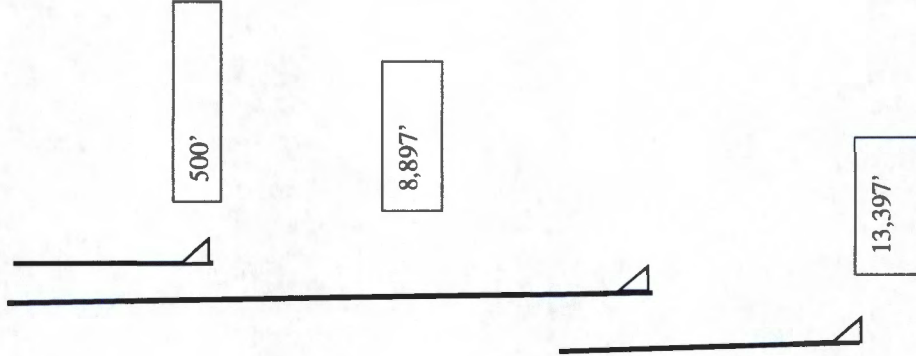

INJECTION WELL DATA SHEET

Tubing Size: 5.5" BTC x 5.5" Flush Joint Lining Material: Fiber Glass

Type of Packer: Weatherford Arrow Set IX

Packer Setting Depth: 13,347'

Other Type of Tubing/Casing Seal (if applicable): none

Additional Data

1. Is this a new well drilled for injection? XXXXX Yes No
If no, for what purpose was the well originally drilled? N/A

2. Name of the Injection Formation: Devonian

3. Name of Field or Pool (if applicable): SWD; Devonian

4. Has the well ever been perforated in any other zone(s)? List all such perforated intervals and give plugging detail, i.e. sacks of cement or plug(s) used. N/A

5. Give the name and depths of any oil or gas zones underlying or overlying the proposed injection zone in this area: _____

Below: none

Next Higher: Delaware 2,247' - 5,597'; Bone Springs 5,597' - 8,897'; Wolfcamp 8,897' - 10,847'; Strawn 10,847' - 10,997'; Atoka 10,997' - 11,797'; Morrow 11,797' - 12,997'

VII.

1. Proposed average and maximum daily rate and volume of fluids to be injected;

Average 15,000-20,000 BWP/D, Max 25,000 BWP/D

2. Whether the system is open or closed;

Open System, Commercial SWD

3. Proposed average and maximum injection pressure;

Average 1,500-2,500 PSI, Max 2,679 PSI

4. Sources and an appropriate analysis of injection fluid and compatibility with the receiving formation if other than reinjected produced water; and,

Bone Spring, Delaware, and Wolfcamp produced water. No known incompatibility exists with these produced water types and the Devonian. Devonian formation is used as a disposal interval throughout the Delaware Basin for Wolfcamp, Bone Springs, and Delaware produced water. See attached water analysis from Bone Spring, Wolfcamp, and Delaware produced water.

5. If injection is for disposal purposes into a zone not productive of oil or gas at or within one mile of the proposed well, attach a chemical analysis of the disposal zone formation water (may be measured or inferred from existing literature, studies, nearby wells, etc.).

Disposal zone produces water and no hydrocarbons, nearby Devonian test wells have only tested water in DST's. Nearby Top Gun SWD tested Sulphur water.

***VIII. Attach appropriate geologic data on the injection zone including appropriate lithologic detail, geologic name, thickness, and depth. Give the geologic name, and depth to bottom of all underground sources of drinking water (aquifers containing waters with total dissolved solids concentrations of 10,000 mg/l or less) overlying the proposed injection zone as well as any such sources known to be immediately underlying the injection interval.**

The proposed disposal interval is in the Devonian formation 13,397'-14,397'. Devonian is an impermeable organic Shale at the very top (13,297 ft, Woodford Shale) 100ft thick followed by permeable lime, dolomite, and small amount of shale 1000ft thick. There are no fresh water zones underlying the proposed injection zone. Usable water depth is from surface to +/- 100', the water source is older alluvium (Quaternary). All the fresh water wells in the area have an average depth to water of 100ft per State Engineer.

IX. Describe the proposed stimulation program, if any.

60,000 gallons 20% HCL acid job with packer

X. Attach appropriate logging and test data on the well

Mud log will be filed after the well has been drilled. All cased hole and open hole Logs will be filed following drilling operations.

XI. Attach a chemical analysis of fresh water from two or more fresh water wells (if available and producing) within one mile of any injection or disposal well showing location of wells and dates samples were taken.

Attached is a water sample

XII. Applicants for disposal wells must make an affirmative statement that they have examined available geologic and engineering data and find no evidence of open faults or any other hydrologic connection between the disposal zone and any underground sources of drinking water.

Delaware Energy, L.L.C. has reviewed and examined available geologic and engineering data in the area of interest for the Tasmanian Devil SWD #1 and have found no evidence of faults or other hydrologic connections between Devonian disposal zone and the underground sources of drinking water.

Furthermore, there exist many impermeable intervals between the injection interval and the fresh ground water from the top of the Devonian Carbonate and the base of the ground water.

Mike McCurdy _____ **Vice President** _____ **4/15/2019**
 _____ **Title** _____ **Date** _____

III. WELL DATA

(1) Lease name; Well No.; Location by Section, Township and Range; and footage location within the section.

Tasmanian Devil SWD #1, Sec. 10-T25S-R27E, 306' FSL & 695' FWL, UL M, Eddy County, New Mexico

(2) Each casing string used with its size, setting depth, sacks of cement used, hole size, top of cement, and how such top was determined.

| Casing Size | Setting Depth | Sacks of Cement | Hole Size | Top of Cement | Determined |
|-------------|----------------|-----------------|-----------|---------------|------------|
| 13-3/8" | 500' | 500 | 17-1/2" | Surface | CIRC |
| 9-5/8" | 8,897' | 2500 | 12-1/4" | Surface | CIRC |
| 7-5/8" | 8,697'-13,397' | 650 | 8-1/2" | Liner Top | CIRC & CBL |

(3) A description of the tubing to be used including its size, lining material, and setting depth.

5-1/2" BTC X 5-1/2" Flush Joint, Internally Fiber Glass Coated Tubing set 50 to 100ft above open hole

(4) The name, model, and setting depth of the packer used or a description of any other seal system or assembly used.

Weatherford Arrow Set 1X injection packer, nickel plated with on/off tool

B. The following must be submitted for each injection well covered by this application. All items must be addressed for the initial well. Responses for additional wells need be shown only when different. Information shown on schematics need not be repeated.

(1) The name of the injection formation and, if applicable, the field or pool name.

Devonian Formation
 Pool Name: SWD (Devonian)

(2) The injection interval and whether it is perforated or open-hole.

13,397' to 14,397' (Open hole)

(3) State if the well was drilled for injection or, if not, the original purpose of the well.

Well is a planned new drill for SWD

(4) Give the depths of any other perforated intervals and detail on the sacks of cement or bridge plugs used to seal off such perforations.

None, well is a planned new drill

(5) Give the depth to and the name of the next higher and next lower oil or gas zone in the area of the well, if any.

Next Higher: Delaware 2,247' - 5,597'; Bone Springs 5,597' - 8,897'; Wolfcamp 8,897' - 10,847'; Strawn 10,847' - 10,997', Atoka 10,997' - 11,797'; Morrow 11,797' - 12,997'

Next Lower: None

DISTRICT I
1625 N. French Dr., Hobbs, NM 88240
Phone (575) 393-8161 Fax: (575) 393-0720

DISTRICT II
811 S. First St., Artesia, NM 88210
Phone (575) 748-1283 Fax: (575) 748-9720

DISTRICT III
1000 Rio Brazos Rd., Aztec, NM 87410
Phone (505) 334-8178 Fax: (505) 334-8170

DISTRICT IV
1220 S. St. Francis Dr., Santa Fe, NM 87505
Phone (505) 476-3480 Fax: (505) 476-3488

State of New Mexico
Energy, Minerals and Natural Resources Department

Form C-102
Revised August 1, 2011
Submit one copy to appropriate
District Office

OIL CONSERVATION DIVISION
1220 South St. Francis Dr.
Santa Fe, New Mexico 87505

AMENDED REPORT

WELL LOCATION AND ACREAGE DEDICATION PLAT

| | | |
|---------------------|--------------------------------------|----------------------------|
| API Number | Pool Code 96101 | Pool Name SWD; DEVONIAN |
| Property Code | Property Name TASMANIAN DEVIL SWD | Well Number 1 |
| OGRID No. 371195 | Operator Name DELAWARE ENERGY | Elevation 3197' |

Surface Location

| UL or lot No. | Section | Township | Range | Lot Idn | Feet from the | North/South line | Feet from the | East/West line | County |
|---------------|---------|----------|-------|---------|---------------|------------------|---------------|----------------|--------|
| M | 10 | 25 S | 27 E | | 306 | SOUTH | 695 | WEST | EDDY |

Bottom Hole Location If Different From Surface

| UL or lot No. | Section | Township | Range | Lot Idn | Feet from the | North/South line | Feet from the | East/West line | County |
|---------------|---------|----------|-------|---------|---------------|------------------|---------------|----------------|--------|
| | | | | | | | | | |

| Dedicated Acres | Joint or Infill | Consolidation Code | Order No. |
|-----------------|-----------------|--------------------|-----------|
| | | | |

NO ALLOWABLE WILL BE ASSIGNED TO THIS COMPLETION UNTIL ALL INTERESTS HAVE BEEN CONSOLIDATED OR A NON-STANDARD UNIT HAS BEEN APPROVED BY THE DIVISION

N: 419014.8
E: 586685.8
(NAD83)

N: 419009.8
E: 591993.8
(NAD83)

N: 416370.5
E: 586703.7
(NAD83)

N: 416355.3
E: 592011.5
(NAD83)

N: 413700.7
E: 592028.6
(NAD83)

N: 413698.4
E: 589375.9
(NAD83)

N: 413729.4
E: 586723.8
(NAD83)

OPERATOR CERTIFICATION

I hereby certify that the information contained herein is true and complete to the best of my knowledge and belief, and that this organization either owns a working interest or unleased mineral interest in the land including the proposed bottom hole location or has a right to drill this well at this location pursuant to a contract with an owner of such a mineral or working interest, or to a voluntary pooling agreement or a compulsory pooling order heretofore entered by the division.

Sarah Presley 4.13.19
Signature Date

Sarah Presley
Printed Name
s.presley@delawareenergy.com
Email Address

SURVEYOR CERTIFICATION

I hereby certify that the well location shown on this plat was plotted from field notes of actual surveys made by me or under my supervision, and that the same is true and correct to the best of my belief.

FEBRUARY 25 2019
Date Surveyed

[Signature]
Signature & Seal of Professional Surveyor

Certificate No. GARY L. JONES 7977
BASIN SURVEYS

0' 1000' 2000' 3000' 4000'
SCALE: 1" = 2000'
WO Num.: 34332

SURFACE LOCATION
Lat - N 32.138261°
Long - W 104.184531°
NMSPC- N 414027.4
E 587416.6
(NAD-83)

**SECTION 10, TOWNSHIP 25 SOUTH, RANGE 27 EAST, N.M.P.M.,
EDDY COUNTY, NEW MEXICO.**

TASMANIAN DEVIL SWD #1
ELEV. - 3197'
 Lat - N 32.138261°
 Long - W 104.184531°
 NMSPE- N 414027.4
 E 587416.6
 (NAD-83)

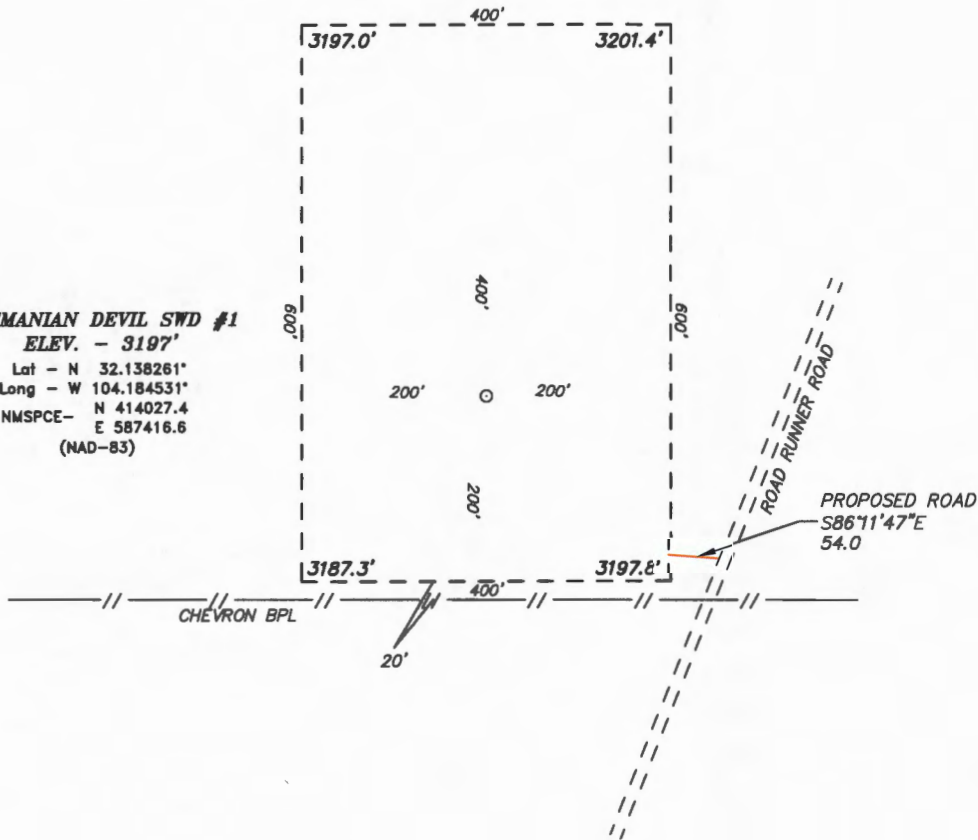

MALAGA, NM IS ±8 MILES TO THE NORTHEAST OF LOCATION.

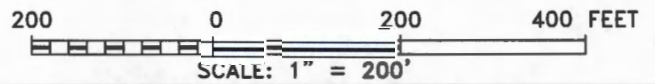

DELAWARE ENERGY

REF: TASMANIAN DEVIL SWD #1 / WELL PAD TOPO

THE TASMANIAN DEVIL SWD #1 LOCATED 306' FROM
 THE SOUTH LINE AND 695' FROM THE WEST LINE OF
 SECTION 10, TOWNSHIP 25 SOUTH, RANGE 27 EAST.

N.M.P.M., EDDY COUNTY, NEW MEXICO.



focused on excellence in the oilfield
 P.O. Box 1786 (575) 393-7316 - Office
 1120 N. West County Rd. (575) 392-2206 - Fax
 Hobbs, New Mexico 88241 basin-surveys.com

**SECTION 10, TOWNSHIP 25 SOUTH, RANGE 27 EAST, N.M.P.M.,
EDDY COUNTY, NEW MEXICO.**

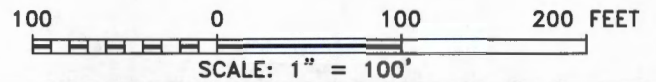
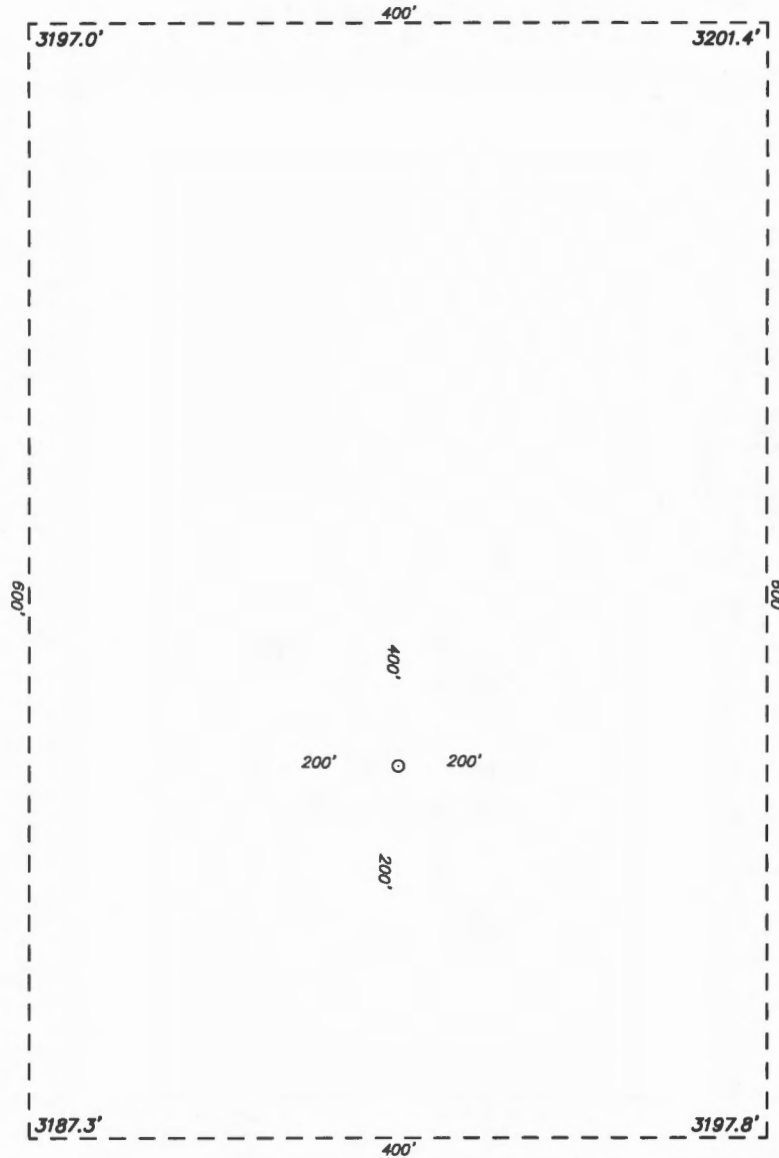

DELAWARE ENERGY

REF: TASMANIAN DEVIL SWD #1 / WELL PAD TOPO

THE TASMANIAN DEVIL SWD #1 LOCATED 306' FROM
THE SOUTH LINE AND 695' FROM THE WEST LINE OF
SECTION 10, TOWNSHIP 25 SOUTH, RANGE 27 EAST.

N.M.P.M., EDDY COUNTY, NEW MEXICO.



P.O. Box 1786 (575) 393-7316 - Office
1120 N. West County Rd. (575) 392-2208 - Fax
Hobbs, New Mexico 88241 basinsurveys.com

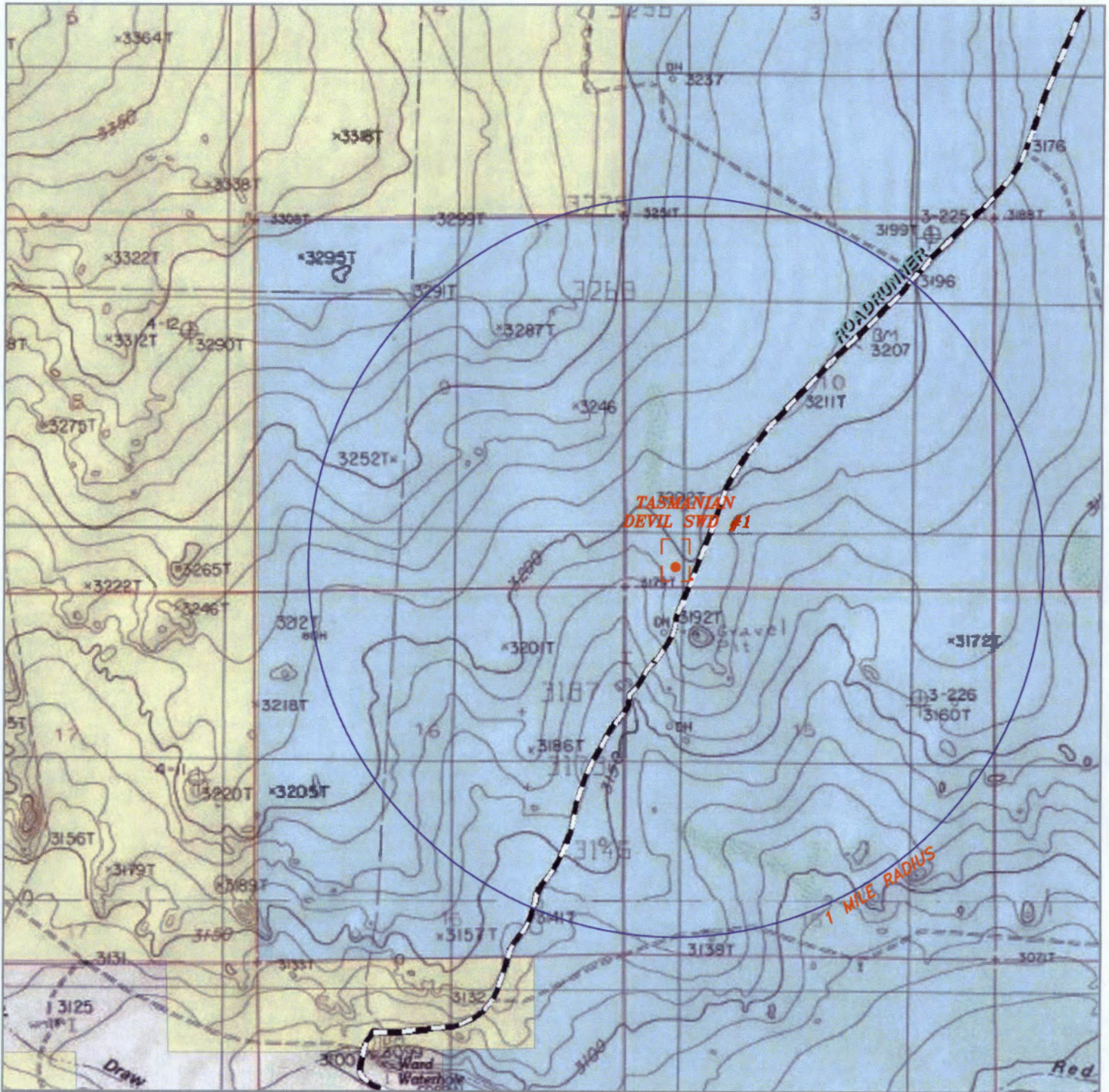

TASMANIAN DEVIL SWD #1

Located 306' FSL and 695' FWL
 Section 10, Township 25 South, Range 27 East,
 N.M.P.M., Eddy County, New Mexico.



P.O. Box 1786
 1120 N. West County Rd.
 Hobbs, New Mexico 88241
 (575) 393-7316 - Office
 (575) 392-2206 - Fax
 basinsurveys.com

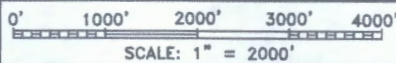

W.O. Number: JG 34332

Survey Date: 2-25-2019

YELLOW TINT - USA LAND
 BLUE TINT - STATE LAND
 NATURAL COLOR - FEE LAND



DELAWARE ENERGY



TASMANIAN DEVIL SWD #1

Located 306' FSL and 695' FWL
 Section 10, Township 25 South, Range 27 East,
 N.M.P.M., Eddy County, New Mexico.



P.O. Box 1786
 1120 N. West County Rd.
 Hobbs, New Mexico 88241
 (575) 393-7316 - Office
 (575) 392-2206 - Fax
 basinsurveys.com

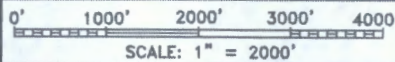

W.O. Number: JG 34332

Survey Date: 2-25-2019

YELLOW TINT - USA LAND
 BLUE TINT - STATE LAND
 NATURAL COLOR - FEE LAND



**DELAWARE
 ENERGY**

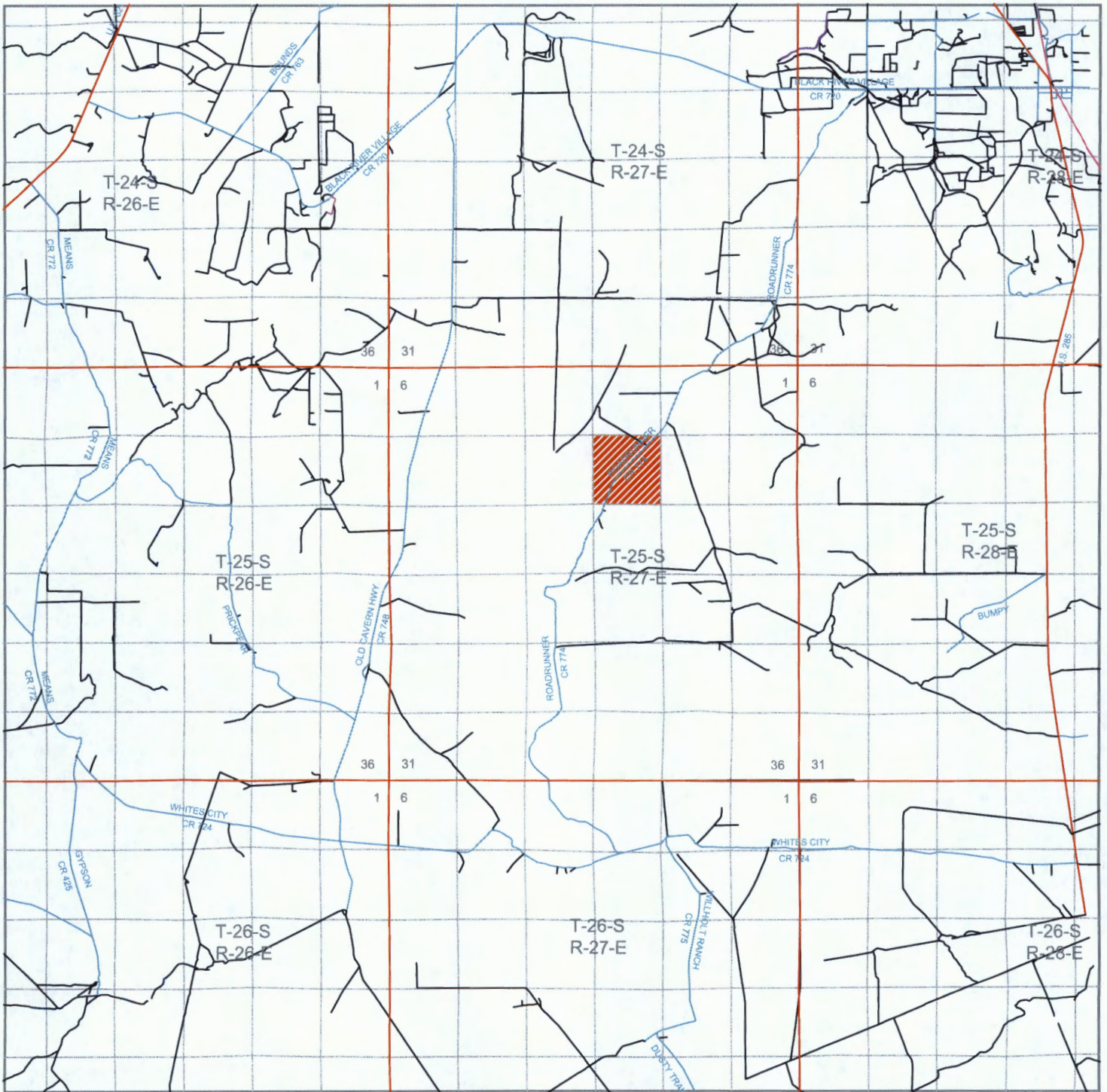

TASMANIAN DEVIL SWD #1

Located 306' FSL and 695' FWL
 Section 10, Township 25 South, Range 27 East,
 N.M.P.M., Eddy County, New Mexico.

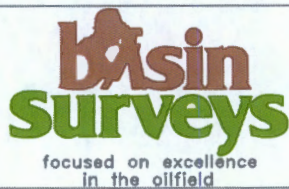

P.O. Box 1786
 1120 N. West County Rd.
 Hobbs, New Mexico 88241
 (575) 393-7316 - Office
 (575) 392-2206 - Fax
 basinsurveys.com

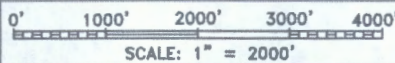

W.O. Number: JG 34332

Survey Date: 2-25-2019

YELLOW TINT - USA LAND
 BLUE TINT - STATE LAND
 NATURAL COLOR - FEE LAND



DELTA ENERGY

**SECTION 10, TOWNSHIP 25 SOUTH, RANGE 27 EAST, N.M.P.M.,
EDDY COUNTY, NEW MEXICO.**

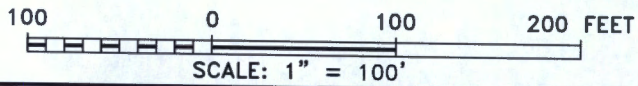
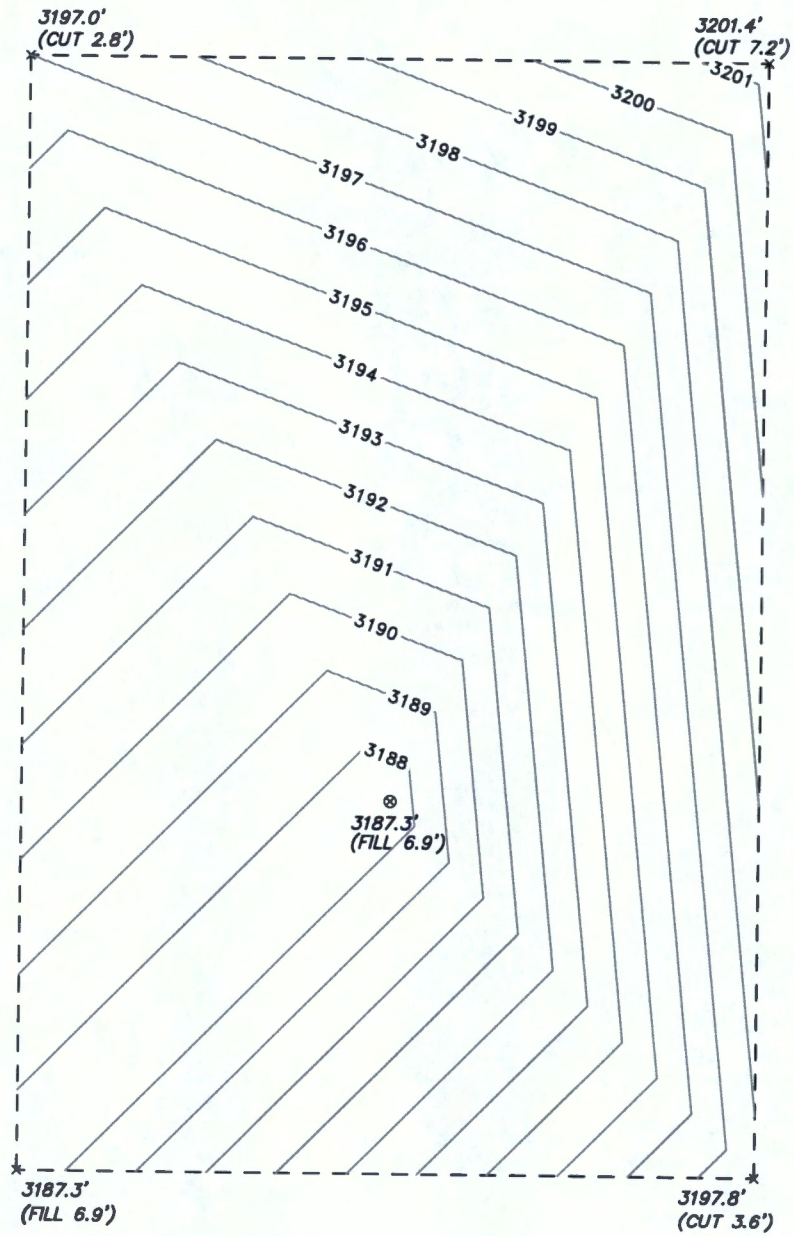

DELAWARE ENERGY

REF: TASMANIAN DEVIL SWD #1 / CUT & FILL

THE TASMANIAN DEVIL SWD #1 LOCATED 306' FROM
THE SOUTH LINE AND 695' FROM THE WEST LINE OF
SECTION 10, TOWNSHIP 25 SOUTH, RANGE 27 EAST.
N.M.P.M., EDDY COUNTY, NEW MEXICO.



P.O. Box 1786 (575) 393-7316 - Office
1120 N. West County Rd. (575) 392-2206 - Fax
Hobbs, New Mexico 88241 basin-surveys.com

Sec 22, T25S, R28E

North Permian Basin Region

P.O. Box 740

Sundown, TX 79372-0740

(806) 229-8121

Lab Team Leader - Sheila Hernandez

(432) 495-7240

Bone Spring

Water Analysis Report by Baker Petrolite

| | | | |
|---------------------|--------------------------|------------------|-------------------------------|
| Company: | PERMIAN BASIN | Sales RDT: | 33514.1 |
| Region: | ARTESIA, NM | Account Manager: | TONY HERNANDEZ (575) 910-7135 |
| Area: | PINOCHLE 'BPN' STATE COM | Sample #: | 534665 |
| Lease/Platform: | 2 H | Analysis ID #: | 106795 |
| Entity (or well #): | UNKNOWN | Analysis Cost: | \$90.00 |
| Formation: | WELLHEAD | | |
| Sample Point: | | | |

| Summary | | Analysis of Sample 534665 @ 75 F | | | | | | | |
|----------------------------|--------------|----------------------------------|----------|---------|------------|---------|---------|------|-------|
| Sampling Date: | 03/10/11 | Anions | | mg/l | meq/l | Cations | | mg/l | meq/l |
| Analysis Date: | 03/18/11 | Chloride: | 109618.0 | 3091.92 | Sodium: | 70275.7 | 3056.82 | | |
| Analyst: | SANDRA GOMEZ | Bicarbonate: | 2135.0 | 34.99 | Magnesium: | 195.0 | 16.04 | | |
| TDS (mg/l or g/m3): | 184911.1 | Carbonate: | 0.0 | 0. | Calcium: | 844.0 | 42.12 | | |
| Density (g/cm3, tonne/m3): | 1.113 | Sulfate: | 747.0 | 15.55 | Strontium: | 220.0 | 5.02 | | |
| Anion/Cation Ratio: | 1 | Phosphate: | | | Berium: | 0.8 | 0.01 | | |
| Carbon Dioxide: | 0.50 PPM | Borate: | | | Iron: | 6.5 | 0.23 | | |
| Oxygen: | | Silicate: | | | Potassium: | 869.0 | 22.22 | | |
| Comments: | | Hydrogen Sulfide: | | 0 PPM | Aluminum: | | | | |
| | | pH at time of sampling: | | 7 | Chromium: | | | | |
| | | pH at time of analysis: | | | Copper: | | | | |
| | | pH used in Calculation: | | 7 | Lead: | | | | |
| | | | | | Manganese: | 0.100 | 0. | | |
| | | | | | Nickel: | | | | |

| Conditions | | Values Calculated at the Given Conditions - Amounts of Scale in lb/1000 bbl | | | | | | | | | | |
|------------|--------------|-----------------------------------------------------------------------------|--------|---------------------------------------------|--------|-----------------------------|--------|-----------------------------|--------|--------------------------|--------|-----------------------|
| Temp | Gauge Press. | Calcite CaCO ₃ | | Gypsum CaSO ₄ ·2H ₂ O | | Anhydrite CaSO ₄ | | Celestite SrSO ₄ | | Barite BaSO ₄ | | CO ₂ Press |
| | | Index | Amount | Index | Amount | Index | Amount | Index | Amount | Index | Amount | |
| 80 | 0 | 1.08 | 188.52 | -1.20 | 0.00 | -1.18 | 0.00 | -0.11 | 0.00 | 0.58 | 0.29 | 1.72 |
| 100 | 0 | 1.10 | 206.05 | -1.29 | 0.00 | -1.20 | 0.00 | -0.15 | 0.00 | 0.35 | 0.29 | 2.35 |
| 120 | 0 | 1.12 | 224.17 | -1.36 | 0.00 | -1.19 | 0.00 | -0.17 | 0.00 | 0.16 | 0.00 | 3.17 |
| 140 | 0 | 1.13 | 243.17 | -1.42 | 0.00 | -1.18 | 0.00 | -0.18 | 0.00 | 0.00 | 0.00 | 4.21 |

Note 1: When assessing the severity of the scale problem, both the saturation index (SI) and amount of scale must be considered.
 Note 2: Precipitation of each scale is considered separately. Total scale will be less than the sum of the amounts of the five scales.
 Note 3: The reported CO₂ pressure is actually the calculated CO₂ fugacity. It is usually nearly the same as the CO₂ partial pressure.

Scale Predictions from Baker Petrolite

Analysis of Sample 534665 @ 75 °F for

03/18/11

Calcite - CaCO₃

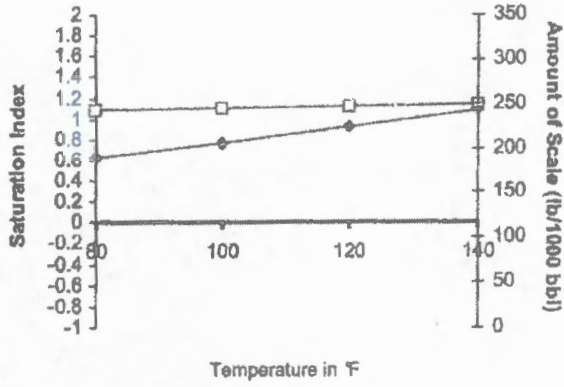

Barite - BaSO₄

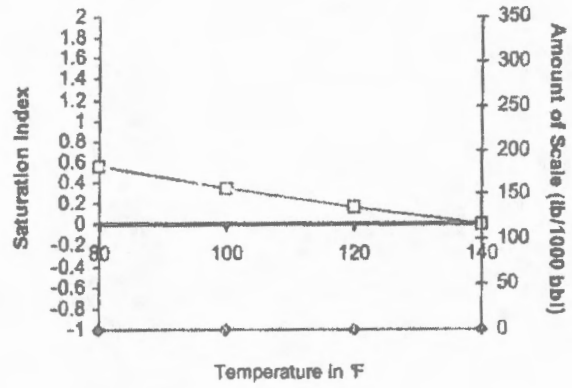

Gypsum - CaSO₄·2H₂O

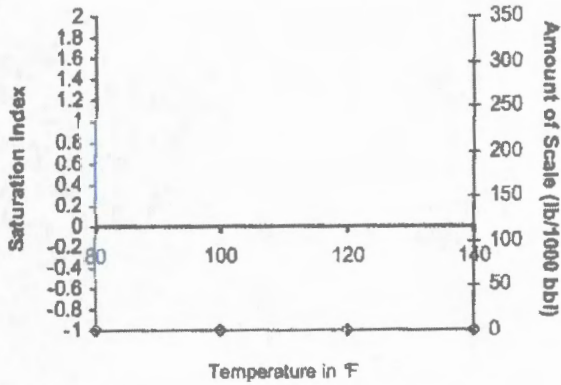

Anhydrite - CaSO₄

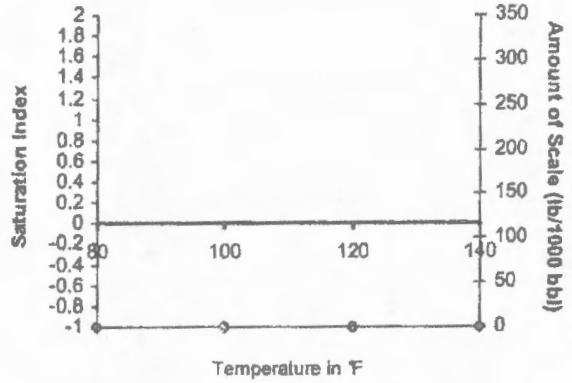

Carbon Dioxide Partial Pressure

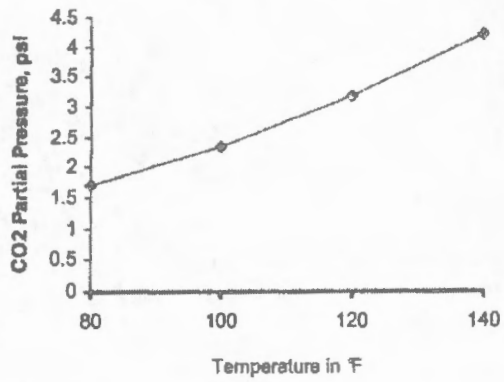

Celestite - SrSO₄

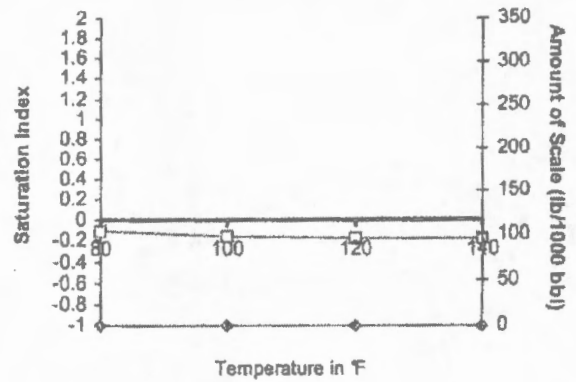

Wolfcamp



Water Analysis

Date: 23-Aug-11

2708 West County Road, Hobbs NM 88240
Phone (575) 392-5556 Fax (575) 392-7307

Analyzed For

Brush Draw L#1

| Company | Well Name | County | State |
|---------|-----------|--------|------------|
| | BD | Lea | New Mexico |

Sample Source Swab Sample Sample # *Eddy* *1-265-295*
1

Formation Depth

| | | | |
|------------------|-------|-----------------|--------|
| Specific Gravity | 1.170 | SG @ 60 °F | 1.172 |
| pH | 6.30 | Sulfides | Absent |
| Temperature (°F) | 70 | Reducing Agents | |

Cations

| | | | | |
|--------------------|---------|--------|--------|--------|
| Sodium (Calc) | in Mg/L | 77,962 | in PPM | 66,520 |
| Calcium | in Mg/L | 4,000 | in PPM | 3,413 |
| Magnesium | in Mg/L | 1,200 | in PPM | 1,024 |
| Soluble Iron (FE2) | in Mg/L | 10.0 | in PPM | 9 |

Anions

| | | | | |
|-------------------------------|---------|---------|--------|---------|
| Chlorides | in Mg/L | 130,000 | in PPM | 110,922 |
| Sulfates | in Mg/L | 250 | in PPM | 213 |
| Bicarbonates | in Mg/L | 127 | in PPM | 108 |
| Total Hardness (as CaCO3) | in Mg/L | 15,000 | in PPM | 12,799 |
| Total Dissolved Solids (Calc) | in Mg/L | 213,549 | in PPM | 182,209 |
| Equivalent NaCl Concentration | in Mg/L | 182,868 | in PPM | 156,031 |

Scaling Tendencies

*Calcium Carbonate Index 507,520

Below 500,000 Remote / 500,000 - 1,000,000 Possible / Above 1,000,000 Probable

*Calcium Sulfate (Gyp) Index 1,000,000

Below 500,000 Remote / 500,000 - 10,000,000 Possible / Above 10,000,000 Probable

*This Calculation is only an approximation and is only valid before treatment of a well or several weeks after treatment.

Remarks RW=.048@70F

Report # 3188

Sec 16, T23S R 28E



PRODUCTION DEPARTMENT

MILLER CHEMICALS, INC.

Post Office Box 298
 Artesia, N.M. 88211-0298
 (505) 746-1919 Artesia Office
 (505) 392-2893 Hobbs Office
 (505) 746-1918 Fax
 mci@plateautel.net

Delaware Brushy Canyon

WATER ANALYSIS REPORT

Company :
 Address :
 Lease : LOVING "AIB"
 Well : #15
 Sample Pt. : WELLHEAD
 Date : MARCH 17, 2008
 Date Sampled : MARCH 17, 2008
 Analysis No. :

| ANALYSIS | mg/L | | * meq/L | |
|---------------------------------------|-------|----------|---------|--------|
| 1. pH | 6.0 | | | |
| 2. H2S | 0 | | | |
| 3. Specific Gravity | 1.070 | | | |
| 4. Total Dissolved Solids | | 304684.9 | | |
| 5. Suspended Solids | | NR | | |
| 6. Dissolved Oxygen | | NR | | |
| 7. Dissolved CO2 | | NR | | |
| 8. Oil In Water | | NR | | |
| 9. Phenolphthalein Alkalinity (CaCO3) | | | | |
| 10. Methyl Orange Alkalinity (CaCO3) | | | | |
| 11. Bicarbonate | HCO3 | 927.0 | HCO3 | 15.2 |
| 12. Chloride | Cl | 187440.0 | Cl | 5287.4 |
| 13. Sulfate | SO4 | 500.0 | SO4 | 10.4 |
| 14. Calcium | Ca | 37200.0 | Ca | 1856.3 |
| 15. Magnesium | Mg | 996.3 | Mg | 82.0 |
| 16. Sodium (calculated) | Na | 77586.6 | Na | 3374.8 |
| 17. Iron | Fe | 35.0 | | |
| 18. Barium | Ba | NR | | |
| 19. Strontium | Sr | NR | | |
| 20. Total Hardness (CaCO3) | | 97000.0 | | |

PROBABLE MINERAL COMPOSITION

| *milli equivalents per Liter | Compound | Equiv wt X meq/L | = mg/L |
|------------------------------------|-----------|------------------|--------|
| 1856 *Ca <----- *HCO3 15 | Ca(HCO3)2 | 81.0 | 1231 |
| /-----> | CaSO4 | 68.1 | 709 |
| 82 *Mg -----> *SO4 10 | CaCl2 | 55.5 | 1830.7 |
| <-----/ | Mg(HCO3)2 | 73.2 | |
| 3375 *Na -----> *Cl 5287 | MgSO4 | 60.2 | |
| /-----> | MgCl2 | 47.6 | 3902 |
| Saturation Values Dist. Water 20 C | NaHCO3 | 84.0 | |
| CaCO3 13 mg/L | Na2SO4 | 71.0 | |
| CaSO4 * 2H2O 2090 mg/L | NaCl | 58.4 | 197223 |
| BaSO4 2.4 mg/L | | | |

REMARKS:



P.O. Box 3394, Midland, Texas 79702
 Phone (432) 684-4233 Fax (432) 684-4277

Water Analysis

| | | | |
|--------------------------------|------------------|-------------------------------|------------|
| Code | 209056 | Sample Information | |
| Client Information | | Lease/Well: Tasmanian Devil/1 | |
| Delaware Energy County: | Eddy | Sample Point: | |
| Rep: | Lanston Cottrell | Date Sampled: | 08/22/2018 |
| | | Date Reported: | 08/24/2018 |

Results

Cations

| Ion | Concentration(mg/L) |
|-------------------|---------------------|
| Barium (as Ba) | 0 |
| Calcium (as Ca) | 602 |
| Iron (as Fe) | 0 |
| Sodium (as Na) | 1633 |
| Magnesium (as Mg) | 663 |

Other Measurements

| Measurement | Value |
|------------------------|----------|
| pH | 8.38 |
| SG | 1.007 |
| Turbidity | 11 |
| CO ₂ | |
| Total Dissolved Solids | 5432.000 |

Anions

| Ion | Concentration(mg/L) |
|-------------------------------------------|---------------------|
| Chlorides (as Cl) | 1466 |
| Sulfate (as SO ₄) | 848 |
| Carbonate (as CO ₃) | 0 |
| Bicarbonates (as HCO ₃) | 220 |
| Sulfide (as S ₂ ⁻) | 0 |

Scaling Indices

| Temp(F) | CaCO ₃ | CaSO ₄ *2H ₂ O | CaSO ₄ | BaSO ₄ |
|---------|-------------------|--------------------------------------|-------------------|-------------------|
| 80 | 1.5905 | 0.0000 | 0.0000 | -28.2893 |
| 120 | 1.9896 | 0.0000 | 0.0000 | -28.5085 |
| 160 | 2.4865 | 0.0000 | 0.0000 | -28.6532 |
| 200 | 2.9415 | 0.0000 | 0.0000 | -28.7273 |
| 250 | 3.3465 | 0.0000 | 0.0000 | -28.6876 |

Low = < 0.200, Moderate = 0.200-0.999, High = > 1.00

Comments

Tasmanian Devil SWD # 1

API # PENDING
306' FSL & 695' FWL, Sec. 10, T25S, R27E, UL "M"
EDDY COUNTY, NEW MEXICO

ELEVATION:
GL: 3,197'

PROPOSED WELLBORE

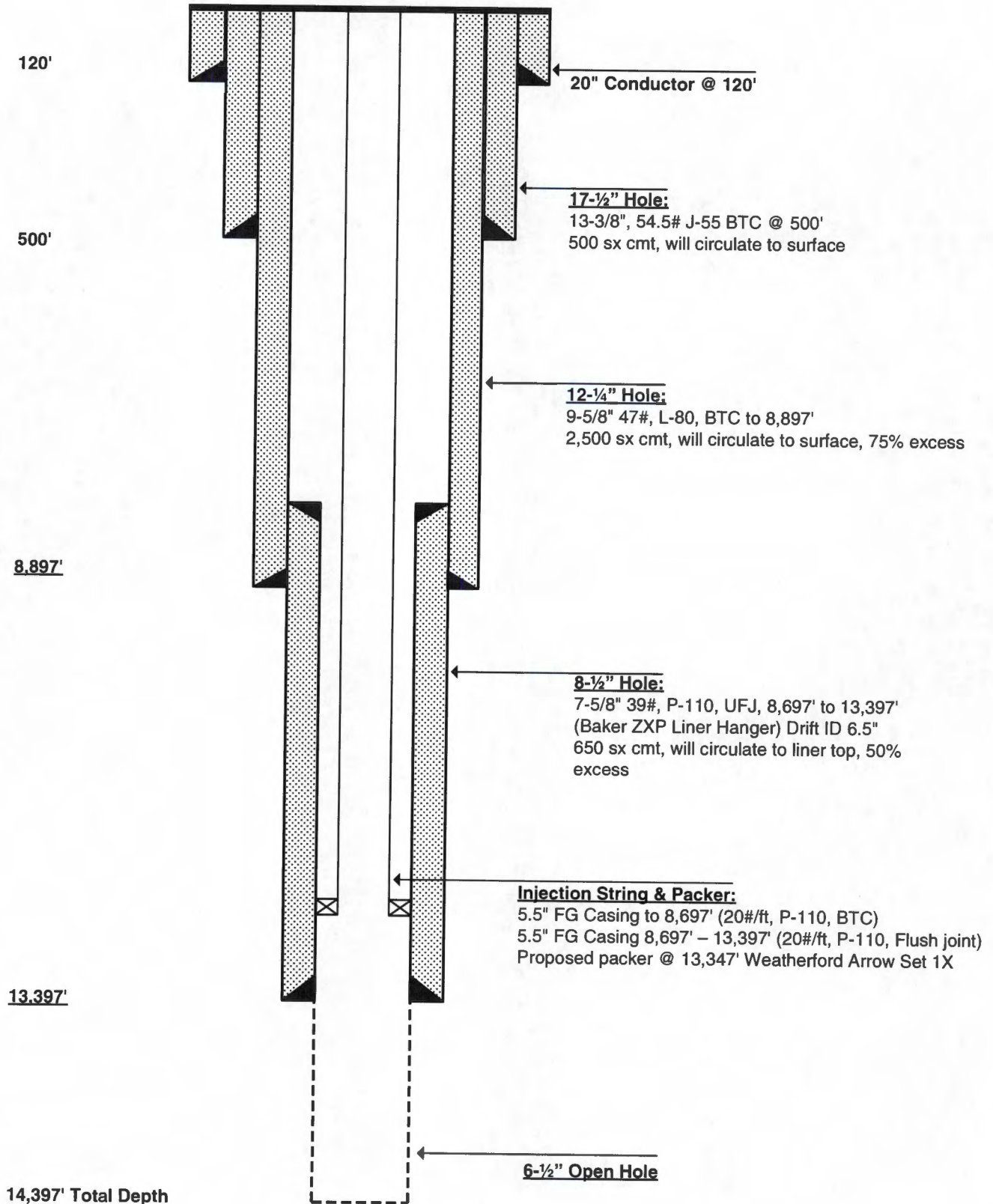

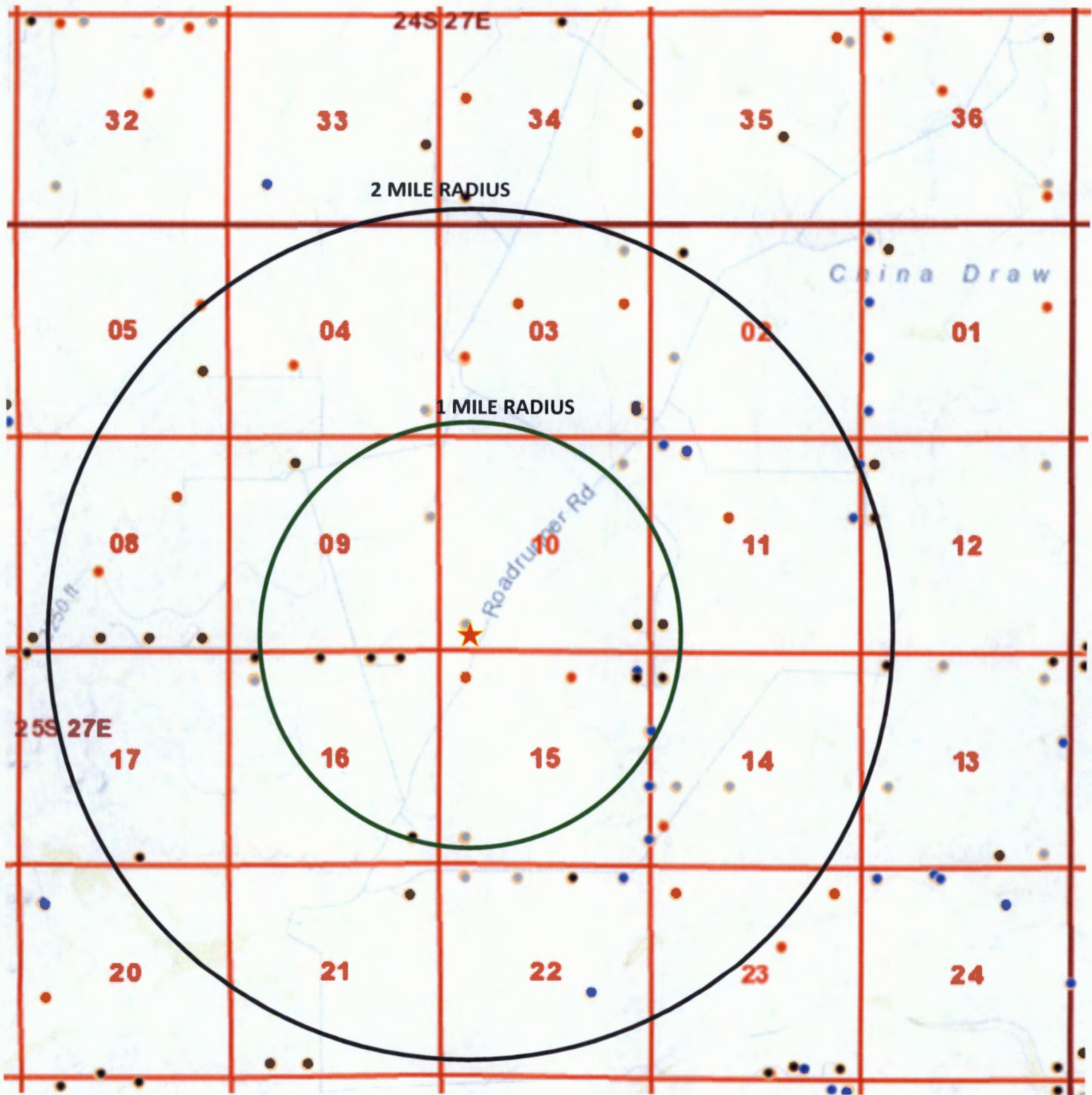

WELLS – ONE MILE RADIUS

NO WELLS PENETRATE THE DEVONIAN FORMATION IN THE AOR

SECTION 10-T25S-R27E

★ Tasmanian Devil SWD #1
 (Proposed Location)
 Delaware Energy, LLC

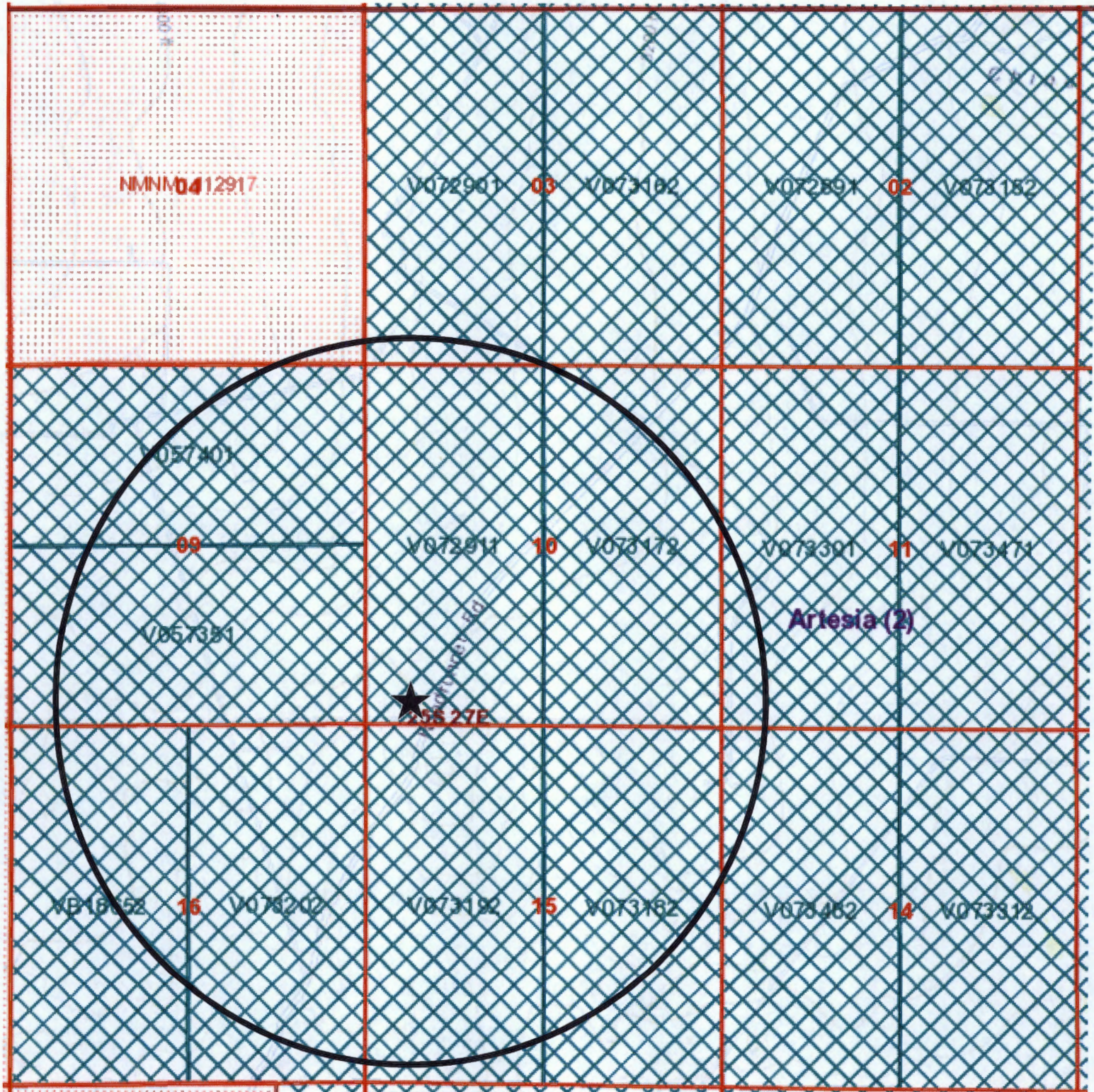

LEASES – ONE MILE RADIUS

★ **Tasmanian Devil SWD #1**
Sec. 10-T25S-R27E
Eddy Co. NM

Tasmanian Devil SWD #1

LEASES – ONE MILE RADIUS

Section 3, T25S-R27E

State Leases (V072901 & V073162)

- **EOG Resources, Inc**
5509 Champions Drive
Midland, TX 79706

Section 4, T25S-R27E

Federal Lease (NMNM 112917)

- **COG Operating, LLC (Lessee)**
600 W. Illinois
Midland, TX 79701

- **Concho Oil & Gas, LLC (Lessee)**
600 W. Illinois
Midland, TX 79701

Section 9, T25S-R27E

State Leases (V057401 & V057351)

- **EOG Resources, Inc and (Lessee)**
5509 Champions Drive
Midland, TX 79706

Section 10, T25S-R27E

State Lease (V072911)

- **EOG Resources, Inc and (Lessee)**
5509 Champions Drive
Midland, TX 79706

State Lease (V073172)

- **COG Operating, LLC (Lessee)**
600 W. Illinois
Midland, TX 79701

Section 11, T25S-R27E

State Lease (V073301)

- **EOG Resources, Inc and (Lessee)**
5509 Champions Dr.
Midland, TX 79706

Section 14, T25S-R27E

- **EOG Resources, Inc**
5509 Champions Dr.
Midland, TX 79706

State Lease (V073482)

- **COG Operating, LLC (Lessee)**
600 W. Illinois
Midland, TX 79701
- **Concho Oil & Gas, LLC (Lessee)**
600 W. Illinois
Midland, TX 79701

Section 15, T25S-R27E

- **EOG Resources, Inc**
5509 Champions Dr.
Midland, TX 79706
- **COG Operating, LLC (Lessee)**
600 W. Illinois
Midland, TX 79701

Section 16, T25S-R27E

- **Chevron USA Inc.**
6301 Deauville Blvd.
Midland, TX 79706

Tasmanian Devil SWD #1
Location: 306' FSL & 695' FWL
Sec. 10, T-25-S, R-27-E

Estimated Pre-Drill Formation Tops

| | |
|------------------------|---------|
| Top of Salt | 497' |
| Base Salt | 1,997' |
| Lamar | 2,197' |
| Delaware – Bell Canyon | 2,247' |
| Cherry Canyon | 3,147' |
| Brushy Canyon | 4,197' |
| Bone Spring | 5,597' |
| Dean | 8,547' |
| Wolfcamp | 8,897' |
| Strawn | 10,847' |
| Atoka | 10,997' |
| Morrow | 11,797' |
| Mississippian | 12,997' |
| Woodford | 13,297' |
| Devonian | 13,397' |

Statement Regarding Seismicity and Well Location (Tasmanian Devil SWD #1)

Historically, the area near the proposed Tasmanian Devil SWD #1 has not seen any major seismic activity. There has been one seismic event (as per public data available on the USGS database) which is 12.6 miles NNE of the proposed SWD location which measured 3.9 on November 24, 1978.

Delaware Energy does not own 2D or 3D seismic data near the proposed SWD location therefore the fault interpretations are based on data obtained from the USGS New Mexico Faults Database (2005) and other published data. Based on these sources the closest faults would be approximately 2.1 miles northeast and 9.8 miles northwest of the location. A recent technical paper written by Snee and Zoback, "State of Stress in the Permian Basin, Texas and New Mexico: Implications for induced seismicity", was published in the February 2018 edition of The Leading Edge. The study evaluates the strike-slip probability of known faults using FSP analysis. The study predicts that the NW-SE trending fault NE and closest to the location (green) should have a very low probability of being critically stressed resulting in an induced seismicity event. No documented seismicity associated with this fault has been found in the public domain. The SW-NE trending fault NW and furthest from the location (orange) would have a higher probability of being critically stressed, resulting in potential slip, due to the relationship of the strike of the fault and the regional S_{hmax} orientation (approx. N 35 deg E) in the area. The exact position of this fault relative to the proposed location, and depth of the target formation, is unknown. Risk of contact with this fault should be reduced due to the distance of the proposed SWD well from the fault (9.8 miles).

The proposed Tasmanian Devil SWD #1 is located well away from the nearest active Devonian or Delaware SWD well (see map below). The well should meet current OCD and Industry recommended practices.

Kevin J. Schepel
Petrophysical Advisor
kevin.schepel@att.net
214-212-6540

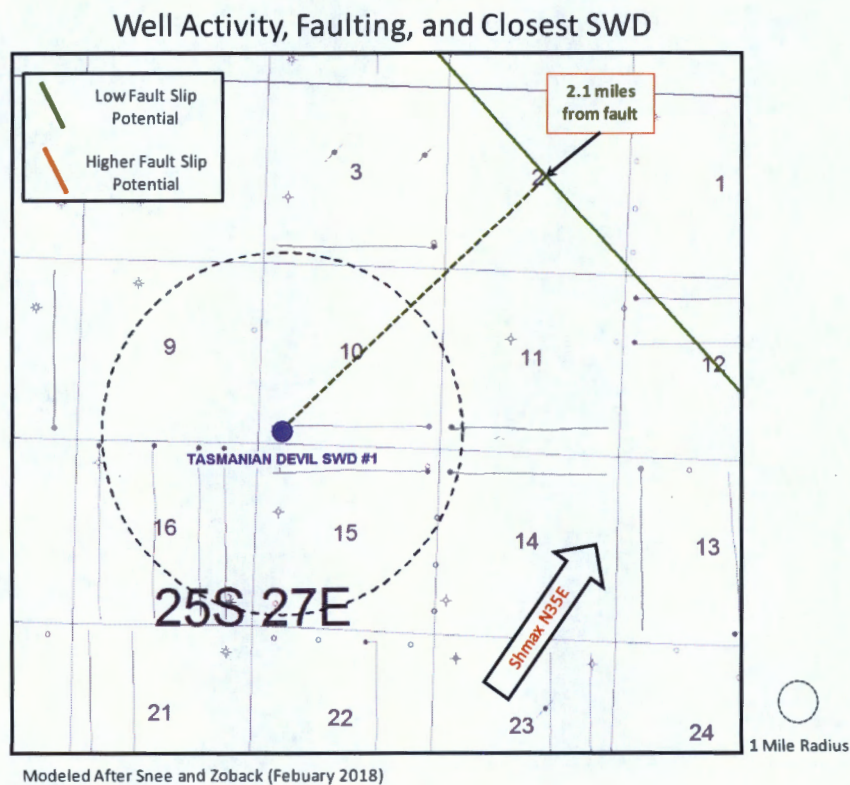

Proximity to Historic Earthquake Activity and Faults

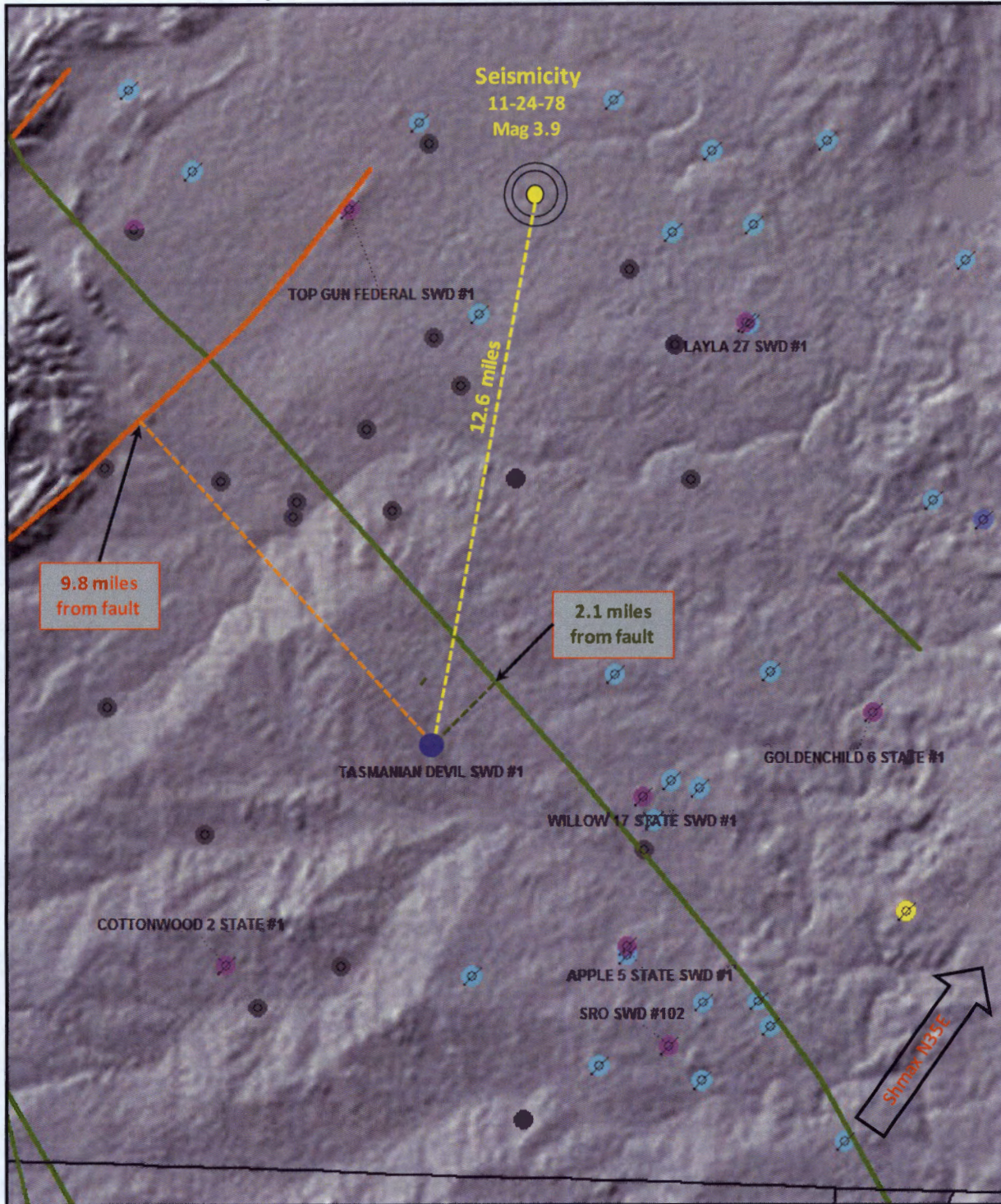

Modeled After Snee and Zoback (February 2018)

- Devonian SWD
- Delaware SWD
- Mississippian SWD
- Morrow SWD
- Proposed Location
- DVNN Permits
- USGS Earthquake
- Low Fault Slip Potential
- Higher Fault Slip Potential

Data and Interpretation Disclosure - Although care has been taken to ensure that these data are up to date and accurate, this information and data is being providing as is. The data are what is believed to be the best public data available based on published documents, reports, and information available through the USGS. The user assumes all responsibility and risk for use of the data and interpretations. Users of the data agree not to misuse, add to without permission, or misrepresent the data provided in any way. In no event will the provider of this document be liable to any party for any direct, indirect, incidental, consequential, special or exemplary damages, or lost profit resulting from any use or misuse of this data. Additionally, provider is not liable for any inaccurate data. No person, entity, or user shall use the information in a manner that is in violation of any federal, state, or local law or regulation.

CARLSBAD
CURRENT-ARGUS

AFFIDAVIT OF PUBLICATION

Ad No.
0001280162

DELAWARE ENERGY, L.L.C.
405 N. MARIENFELD
SUITE 250
MIDLAND TX 79701

I, a legal clerk of the **Carlsbad Current-Argus**, a newspaper published daily at the City of Carlsbad, in said county of Eddy, state of New Mexico and of general paid circulation in said county; that the same is a duly qualified newspaper under the laws of the State wherein legal notices and advertisements may be published; that the printed notice attached hereto was published in the regular and entire edition of said newspaper and not in supplement thereof on the date as follows, to wit:

03/15/19

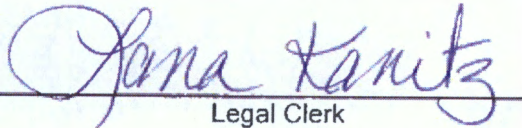
Legal Clerk

Subscribed and sworn before me this
15th of March 2019.

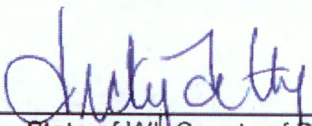
State of WI, County of Brown
NOTARY PUBLIC

9-19-21
My Commission Expires

LEGAL NOTICE

Delaware Energy, L.L.C., 405 N. Marienfeld St. Suite 200, Midland, TX 79701, has filed a form C-108 (Application for Authorization to Inject) with the Oil Conservation Division seeking administrative approval to drill the Tasmanian Devil SWD #1 as a Commercial Salt Water Disposal well.

The Tasmanian Devil SWD #1 is located at 306' FSL and 695' FWL, Unit Letter M, Section 10, Township 25 South, Range 27 East, Eddy County, New Mexico. The well will dispose of water produced from oil and gas wells into the Devonian Formation from 13,397' to 14,397' at a maximum rate of 25,000 barrels of water per day at a maximum pressure of 2,679 psi.

Interested parties must file objections or requests for hearing with the Oil Conservation Division, 1220 South St. Francis Dr., Santa Fe, New Mexico 87505, within 15 days.

Additional information can be obtained by contacting Delaware Energy, L.L.C., at (432) 685-7005.

Pub: March 15, 2019 #1280162

Ad#: 0001280162
P O : 1279967
of Affidavits : 0.00



0905 0580 0000 0680 0107

U.S. Postal Service™
CERTIFIED MAIL® RECEIPT
Domestic Mail Only

For delivery information, visit our website at www.usps.com®.

MIDLAND, TX 79701
OFFICIAL USE

| | |
|-----------------------------------------------------------|--------|
| Certified Mail Fee | \$3.50 |
| Extra Services & Fees (check box, add fee as appropriate) | \$2.80 |
| Postage | \$1.75 |
| Total Postage and Fees | \$8.05 |

Tasmanian Devil
SWD #1
APR 16 2019
MIDLAND, TX
04/16/2019

Sent To
COG Operating, LLC
Street and Apt. No., or PO Box No.
600 W. Illinois
City, State, ZIP+4®
Midland, TX 79701
PS Form 3800, April 2015 PSN 7530-02-000-9047 See Reverse for Instructions

0905 0580 0000 0680 0107

U.S. Postal Service™
CERTIFIED MAIL® RECEIPT
Domestic Mail Only

For delivery information, visit our website at www.usps.com®.

MIDLAND, TX 79706
OFFICIAL USE

| | |
|-----------------------------------------------------------|--------|
| Certified Mail Fee | \$3.50 |
| Extra Services & Fees (check box, add fee as appropriate) | \$2.80 |
| Postage | \$1.75 |
| Total Postage and Fees | \$8.05 |

Tasmanian Devil
SWD #1
APR 16 2019
MIDLAND, TX
04/16/2019

Sent To
Chevron USA Inc.
Street and Apt. No., or PO Box No.
6301 Deauville Blvd.
City, State, ZIP+4®
Midland, TX 79706
PS Form 3800, April 2015 PSN 7530-02-000-9047 See Reverse for Instructions

0905 0580 0000 0680 0107

U.S. Postal Service™
CERTIFIED MAIL® RECEIPT
Domestic Mail Only

For delivery information, visit our website at www.usps.com®.

SANTA FE, NM 87501
OFFICIAL USE

| | |
|-----------------------------------------------------------|--------|
| Certified Mail Fee | \$3.50 |
| Extra Services & Fees (check box, add fee as appropriate) | \$2.80 |
| Postage | \$1.75 |
| Total Postage and Fees | \$8.05 |

Tasmanian Devil
SWD #1
APR 16 2019
MIDLAND, TX
04/16/2019

Sent To
New Mexico State Land Office
Street and Apt. No., or PO Box No.
810 Old Santa Fe Trail
City, State, ZIP+4®
Santa Fe, NM 87501
PS Form 3800, April 2015 PSN 7530-02-000-9047 See Reverse for Instructions

0905 0580 0000 0680 0107

U.S. Postal Service™
CERTIFIED MAIL® RECEIPT
Domestic Mail Only

For delivery information, visit our website at www.usps.com®.

MIDLAND, TX 79706
OFFICIAL USE

| | |
|-----------------------------------------------------------|--------|
| Certified Mail Fee | \$3.50 |
| Extra Services & Fees (check box, add fee as appropriate) | \$2.80 |
| Postage | \$1.75 |
| Total Postage and Fees | \$8.05 |

Tasmanian Devil
SWD #1
APR 16 2019
MIDLAND, TX
04/16/2019

Sent To
COG Resources, Inc.
Street and Apt. No., or PO Box No.
5509 Champions Dr.
City, State, ZIP+4®
Midland, TX 79706
PS Form 3800, April 2015 PSN 7530-02-000-9047 See Reverse for Instructions

0905 0580 0000 0680 0107

U.S. Postal Service™
CERTIFIED MAIL® RECEIPT
Domestic Mail Only

For delivery information, visit our website at www.usps.com®.

ARTESIA, NM 88210
OFFICIAL USE

| | |
|-----------------------------------------------------------|--------|
| Certified Mail Fee | \$3.50 |
| Extra Services & Fees (check box, add fee as appropriate) | \$2.80 |
| Postage | \$1.75 |
| Total Postage and Fees | \$8.05 |

Tasmanian Devil
SWD #1
APR 16 2019
MIDLAND, TX
04/16/2019

Sent To
State of New Mexico OCO District II
Street and Apt. No., or PO Box No.
811 S. First Street
City, State, ZIP+4®
Artesia, NM 88210
PS Form 3800, April 2015 PSN 7530-02-000-9047 See Reverse for Instructions

McMillan, Michael, EMNRD

From: Sarah Presley <s.presley@delawareenergy.com>
Sent: Friday, April 26, 2019 8:32 AM
To: McMillan, Michael, EMNRD
Subject: [EXT] RE: Tasmanian Devil SWD Well No. 1

Thanks Mike!! I'll get the BLM notification out and send you the certified receipt. I have a call today with Chuck Moran to discuss the Tasmanian Devil.

Thanks,

SP

Regards,

Sarah Presley | Operations Manager
405 N. Marienfeld, Suite 200
Midland, TX 79701
O: (432) 685-7005
C: (432) 269-3789



From: McMillan, Michael, EMNRD <Michael.McMillan@state.nm.us>
Sent: Friday, April 26, 2019 9:25 AM
To: Sarah Presley <s.presley@delawareenergy.com>
Subject: Tasmanian Devil SWD Well No. 1

Sarah:
Per our conversation on April 24, 2019 your application is suspended, because you did not notify BLM
Your application is suspended until you provide notice to them.

Further, this location is protested by EOG, and you will received formal notice shortly.

Mike

Michael McMillan
1220 South St. Francis
Santa Fe, New Mexico
505-476-3448
Michael.mcmillan@state.nm.us

McMillan, Michael, EMNRD

From: Sarah Presley <s.presley@delawareenergy.com>
Sent: Monday, April 29, 2019 2:52 PM
To: McMillan, Michael, EMNRD
Subject: [EXT] RE: Tasmanian Devil SWD Well No. 1
Attachments: tasmanian swd.pdf

Hey Mike,

Here is the certified receipt for the BLM.

Thanks,

SP

Regards,

Sarah Presley | Operations Manager
405 N. Marienfeld, Suite 200
Midland, TX 79701
O: (432) 685-7005
C: (432) 269-3789



From: McMillan, Michael, EMNRD <Michael.McMillan@state.nm.us>
Sent: Friday, April 26, 2019 9:40 AM
To: Sarah Presley <s.presley@delawareenergy.com>
Subject: RE: Tasmanian Devil SWD Well No. 1

I sent the last e-mail as a joke

I have known Chuck for years-his job at Yates was to argue with state and federal agencies he is a good guy, and he but he is level headed and easy to communicate with

Mike

From: Sarah Presley <s.presley@delawareenergy.com>
Sent: Friday, April 26, 2019 8:37 AM
To: McMillan, Michael, EMNRD <Michael.McMillan@state.nm.us>
Subject: [EXT] RE: Tasmanian Devil SWD Well No. 1

Thanks!! That is exactly the advise I need.

Thanks,

SP

Regards,

Sarah Presley | Operations Manager
405 N. Marienfeld, Suite 200
Midland, TX 79701
O: (432) 685-7005
C: (432) 269-3789

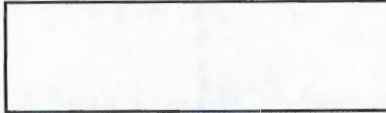

From: McMillan, Michael, EMNRD <Michael.McMillan@state.nm.us>
Sent: Friday, April 26, 2019 9:34 AM
To: Sarah Presley <s.presley@delawareenergy.com>
Subject: RE: Tasmanian Devil SWD Well No. 1

Be nice to Chuck- he is very sensitive, and hates confrontation

Mike

From: Sarah Presley <s.presley@delawareenergy.com>
Sent: Friday, April 26, 2019 8:32 AM
To: McMillan, Michael, EMNRD <Michael.McMillan@state.nm.us>
Subject: [EXT] RE: Tasmanian Devil SWD Well No. 1

Thanks Mike!! I'll get the BLM notification out and send you the certified receipt. I have a call today with Chuck Moran to discuss the Tasmanian Devil.

Thanks,

SP

Regards,

Sarah Presley | Operations Manager
405 N. Marienfeld, Suite 200
Midland, TX 79701
O: (432) 685-7005
C: (432) 269-3789

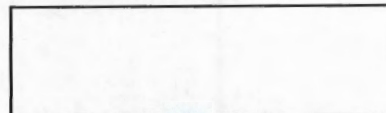

From: McMillan, Michael, EMNRD <Michael.McMillan@state.nm.us>
Sent: Friday, April 26, 2019 9:25 AM
To: Sarah Presley <s.presley@delawareenergy.com>
Subject: Tasmanian Devil SWD Well No. 1

Sarah:

Per our conversation on April 24, 2019 your application is suspended, because you did not notify BLM
Your application is suspended until you provide notice to them.

Further, this location is protested by EOG, and you will received formal notice shortly.

Mike

Michael McMillan
1220 South St. Francis
Santa Fe, New Mexico
505-476-3448
Michael.mcmillan@state.nm.us

U.S. Postal Service™
CERTIFIED MAIL® RECEIPT
 Domestic Mail Only

For delivery information, visit our website at www.usps.com.

OFFICIAL USE

Certified Mail Fee \$3.50
 Extra Services & Fees (check box, add fee) \$2.80
 Return Receipt (hardcopy) \$0.00
 Return Receipt (electronic) \$0.00
 Certified Mail Restricted Delivery \$0.00
 Adult Signature Required \$0.00
 Adult Signature Restricted Delivery \$0.00
 Postage \$1.90
 Total Postage and Fees \$8.20

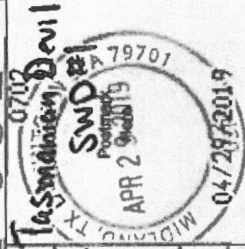

Sent to
Bureau of Land Management
 Street and Apt. No., or PO Box No.
1020 E Greene Street
 City, State, ZIP+4®
Carlsbad, NM 88220

7028 0680 0000 0890 8702