

ABOVE THIS LINE FOR DIVISION USE ONLY

NEW MEXICO OIL CONSERVATION DIVISION

- Engineering Bureau -

1220 South St. Francis Drive, Santa Fe, NM 87505



A/7/85/3/E

ADMINISTRATIVE APPLICATION CHECKLIST

THIS CHECKLIST IS MANDATORY FOR ALL ADMINISTRATIVE APPLICATIONS FOR EXCEPTIONS TO DIVISION RULES AND REGULATIONS WHICH REQUIRE PROCESSING AT THE DIVISION LEVEL IN SANTA FE

Application Acronyms:

[NSL-Non-Standard Location] [NSP-Non-Standard Proration Unit] [SD-Simultaneous Dedication]
[DHC-Downhole Commingling] [CTB-Lease Commingling] [PLC-Pool/Lease Commingling]
[PC-Pool Commingling] [OLS - Off-Lease Storage] [OLM-Off-Lease Measurement]
[WFX-Waterflood Expansion] [PMX-Pressure Maintenance Expansion]
[SWD-Salt Water Disposal] [IPI-Injection Pressure Increase]
[EOR-Qualified Enhanced Oil Recovery Certification] [PPR-Positive Production Response]

[1] TYPE OF APPLICATION - Check Those Which Apply for [A]

[A] Location - Spacing Unit - Simultaneous Dedication
☐ NSL ☐ NSP ☐ SD

Check One Only for [B] or [C]

[B] Commingling - Storage - Measurement
☐ DHC ☐ CTB ☐ PLC ☐ PC ☐ OLS ☐ OLM

[C] Injection - Disposal - Pressure Increase - Enhanced Oil Recovery
☐ WFX ☐ PMX ☒ SWD ☐ IPI ☐ EOR ☐ PPR

[D] Other: Specify _____

[2] NOTIFICATION REQUIRED TO: - Check Those Which Apply, or ☐ Does Not Apply

[A] ☐ Working, Royalty or Overriding Royalty Interest Owners

[B] ☐ Offset Operators, Leaseholders or Surface Owner

[C] ☐ Application is One Which Requires Published Legal Notice

[D] ☐ Notification and/or Concurrent Approval by BLM or SLO
U.S. Bureau of Land Management - Commissioner of Public Lands, State Land Office.

[E] ☐ For all of the above, Proof of Notification or Publication is Attached, and/or,

[F] ☐ Waivers are Attached

[3] SUBMIT ACCURATE AND COMPLETE INFORMATION REQUIRED TO PROCESS THE TYPE OF APPLICATION INDICATED ABOVE.

[4] CERTIFICATION: I hereby certify that the information submitted with this application for administrative approval is accurate and complete to the best of my knowledge. I also understand that no action will be taken on this application until the required information and notifications are submitted to the Division.

Note: Statement must be completed by an individual with managerial and/or supervisory capacity.

Print or Type Name

Signature

Title

Date

e-mail Address

JUN 20 2005

APPLICATION FOR AUTHORIZATION TO INJECT

- PURPOSE:** ☐ Secondary Recovery ☒ Pressure Maintenance ☒ Disposal ☐ Storage
Application qualifies for administrative approval? ☒ Yes ☐ No

II. OPERATOR: John R. STEARNS
ADDRESS: HC 65 Box 988, CROSSROADS, N.M. 88114
CONTACT PARTY: John R. STEARNS ⁵⁰⁵ **PHONE:** 675-2356

III. WELL DATA: Complete the data required on the reverse side of this form for each well proposed for injection.
Additional sheets may be attached if necessary.

IV. Is this an expansion of an existing project? ☐ Yes ☒ No
If yes, give the Division order number authorizing the project: _____

V. Attach a map that identifies all wells and leases within two miles of any proposed injection well with a one-half mile radius circle drawn around each proposed injection well. This circle identifies the well's area of review.

VI. Attach a tabulation of data on all wells of public record within the area of review which penetrate the proposed injection zone. Such data shall include a description of each well's type, construction, date drilled, location, depth, record of completion, and a schematic of any plugged well illustrating all plugging detail.

VII. Attach data on the proposed operation, including:

 1. Proposed average and maximum daily rate and volume of fluids to be injected;
 2. Whether the system is open or closed;
 3. Proposed average and maximum injection pressure;
 4. Sources and an appropriate analysis of injection fluid and compatibility with the receiving formation if other than reinjected produced water; and,
 5. If injection is for disposal purposes into a zone not productive of oil or gas at or within one mile of the proposed well, attach a chemical analysis of the disposal zone formation water (may be measured or inferred from existing literature, studies, nearby wells, etc.).

***VIII.** Attach appropriate geologic data on the injection zone including appropriate lithologic detail, geologic name, thickness, and depth. Give the geologic name, and depth to bottom of all underground sources of drinking water (aquifers containing waters with total dissolved solids concentrations of 10,000 mg/l or less) overlying the proposed injection zone as well as any such sources known to be immediately underlying the injection interval.

IX. Describe the proposed stimulation program, if any.

***X.** Attach appropriate logging and test data on the well. (If well logs have been filed with the Division, they need not be resubmitted).

***XI.** Attach a chemical analysis of fresh water from two or more fresh water wells (if available and producing) within one mile of any injection or disposal well showing location of wells and dates samples were taken.

XII. Applicants for disposal wells must make an affirmative statement that they have examined available geologic and engineering data and find no evidence of open faults or any other hydrologic connection between the disposal zone and any underground sources of drinking water.

XIII. Applicants must complete the "Proof of Notice" section on the reverse side of this form.

XIV. Certification: I hereby certify that the information submitted with this application is true and correct to the best of my knowledge and belief.

NAME: John R. Stearns / TITLE: OWNER

SIGNATURE: John P. [Signature] DATE: June 1, 2005

E-MAIL ADDRESS: ISTEARN@YUCCA.NET

- * If the information required under Sections VI, VIII, X, and XI above has been previously submitted, it need not be resubmitted. Please show the date and circumstances of the earlier submittal:

DISTRIBUTION: Original and one copy to Santa Fe with one copy to the appropriate District Office

III. WELL DATA

A. The following well data must be submitted for each injection well covered by this application. The data must be both in tabular and schematic form and shall include:

- (1) Lease name; Well No.; Location by Section, Township and Range; and footage location within the section.
- (2) Each casing string used with its size, setting depth, sacks of cement used, hole size, top of cement, and how such top was determined.
- (3) A description of the tubing to be used including its size, lining material, and setting depth.
- (4) The name, model, and setting depth of the packer used or a description of any other seal system or assembly used.

Division District Offices have supplies of Well Data Sheets which may be used or which may be used as models for this purpose. Applicants for several identical wells may submit a "typical data sheet" rather than submitting the data for each well.

B. The following must be submitted for each injection well covered by this application. All items must be addressed for the initial well. Responses for additional wells need be shown only when different. Information shown on schematics need not be repeated.

- (1) The name of the injection formation and, if applicable, the field or pool name.
- (2) The injection interval and whether it is perforated or open-hole.
- (3) State if the well was drilled for injection or, if not, the original purpose of the well.
- (4) Give the depths of any other perforated intervals and detail on the sacks of cement or bridge plugs used to seal off such perforations.
- (5) Give the depth to and the name of the next higher and next lower oil or gas zone in the area of the well, if any.

XIV. PROOF OF NOTICE

All applicants must furnish proof that a copy of the application has been furnished, by certified or registered mail, to the owner of the surface of the land on which the well is to be located and to each leasehold operator within one-half mile of the well location.

Where an application is subject to administrative approval, a proof of publication must be submitted. Such proof shall consist of a copy of the legal advertisement which was published in the county in which the well is located. The contents of such advertisement must include:

- (1) The name, address, phone number, and contact party for the applicant;
- (2) The intended purpose of the injection well; with the exact location of single wells or the Section, Township, and Range location of multiple wells;
- (3) The formation name and depth with expected maximum injection rates and pressures; and,
- (4) A notation that interested parties must file objections or requests for hearing with the Oil Conservation Division, 1220 South St. Francis Dr., Santa Fe, New Mexico 87505, within 15 days.

NO ACTION WILL BE TAKEN ON THE APPLICATION UNTIL PROPER PROOF OF NOTICE HAS BEEN SUBMITTED.

NOTICE: Surface owners or offset operators must file any objections or requests for hearing of administrative applications within 15 days from the date this application was mailed to them.

INJECTION WELL DATA SHEET

OPERATOR: John R. StearnsWELL NAME & NUMBER: Wattam Federal # 6WELL LOCATION: 643' ENL - 782' FEL

FOOTAGE LOCATION

UNIT LETTER

SECTION

TOWNSHIP

RANGE

WELLBORE SCHEMATICWELL CONSTRUCTION DATA
Surface CasingSurfaceHole Size: 12 1/4"Casing Size: 8 5/8"Cemented with: 850 SX.or 0" ft³Top of Cement: SURFACEMethod Determined: Calculated8 5/8" casing 1221' cement circ.Intermediate Casing

Hole Size:

Casing Size:

Cemented with:

or 0" ft³

Top of Cement:

Method Determined:

Production CasingHole Size: 7 7/8"Casing Size: 5 1/2"Cemented with: 1450 SX.or 0" ft³

Top of Cement:

Method Determined:

Total Depth: 3900'Injection Intervalfeet to 3720' TD at 1900'Kick off @ 3470'TVD 5301'Top of Plug 3695'
TD 3900'AD-1 PACKER @ 3400'1931' ± Horizontal Hole

(Perforated or Open Hole; indicate which)

2 7/8" IRC Coated tubing5 1/2" casing1775' = 8 5/8" hole
to 1900'Quarry to 1900' 2475'SA TOP ~ 2915' 3475'1 1/4" 400'

INJECTION WELL DATA SHEETTubing Size: 2 7/8" Lining Material: IPeType of Packer: AD-1 ~~X~~Packer Setting Depth: 3400'Other Type of Tubing/Casing Seal (if applicable): NONEAdditional Data

1. Is this a new well drilled for injection? Yes X No

If no, for what purpose was the well originally drilled? Oil2. Name of the Injection Formation: SAN ANDRES3. Name of Field or Pool (if applicable): CATO4. Has the well ever been perforated in any other zone(s)? List all such perforated intervals and give plugging detail, i.e. sacks of cement or plug(s) used. NO5. Give the name and depths of any oil or gas zones underlying or overlying the proposed injection zone in this area: NONE

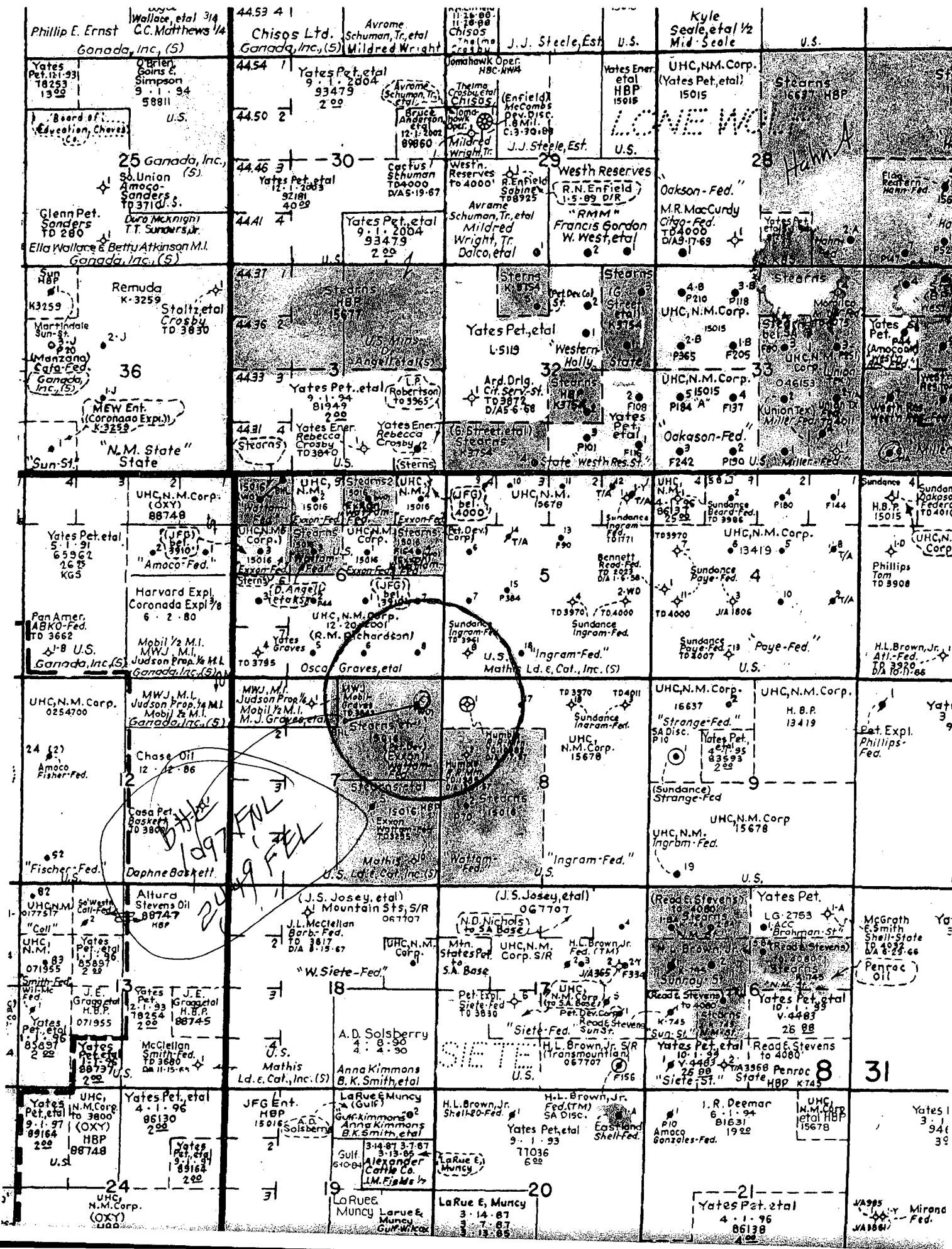

Company: UHC New Mexico Corp.

Lease: GRAVES #6

Sec. 6 T 8 S R 31 E

Footage: 660' FSL 1980' FEL

County: Chaves

Date Drilled: 3/77

Total Depth: 3870'

Perfs: NA

Stimulation: NA

8 5/8" 20# CASING @ 262' and cement circulated

4 1/2" CASING @ 3870' cemented with 275 SX

NO. OF COPIES RECEIVED	
DISTRIBUTION	
SANTA FE	
FILE	
U.S.G.S.	
LAND OFFICE	
OPERATOR	

NEW MEXICO OIL CONSERVATION COMMISSION

Form C-103
Supersedes Old
C-102 and C-103
Effective 1-1-65

5a. Indicate Type of Lease	
State <input type="checkbox"/>	Fee <input checked="" type="checkbox"/>

5. State Oil & Gas Lease No.
Fee

SUNDRY NOTICES AND REPORTS ON WELLS

FOR PROPOSALS TO DRILL OR TO DEEPEN OR PLUG BACK TO A DIFFERENT RESERVOIR.
(APPLICATION FOR PERMIT TO DRILL OR TO DEEPEN OR PLUG BACK TO A DIFFERENT RESERVOIR.)

XX

Harvey E. Yates Company, Inc.

Suite 1000 Security National Bank Bldg., Roswell, N.M. 88201

0 660 South 1980

East 6 8S 31E

Graves

6

Cato-San Andres

4212.1 GL

Chaves

Check Appropriate Box To Indicate Nature of Notice, Report or Other Data

NOTICE OF INTENTION TO:

SUBSEQUENT REPORT OF:

REMEDIAL WORK ☐

PLUG AND ABANDON ☐

REMEDIAL WORK ☐

REPAIR OR ABANDON ☐

COMMENCE DRILLING OPERATIONS ☐

REPAIR OR ALTER CASING ☐

CHANGE PLANS ☐

CASING TEST AND CEMENT JOBS ☐

OTHER ☐

OTHER Spud and run 8 5/8" casing XX

For Notices of Proposed or Completed Operations (Clearly state all pertinent details, and give pertinent dates, including estimated date of starting any proposed work) SEE RULE 1103.

3-3-77 Spudded 11" hole @ 10:30 AM.

3-3-77 Ran 6 Joints (262') 8 5/8" 20#, Range 3, 8 rd casing. Set in cement @ 274' with 125 Sx Class C cement, 2% Calcium Chloride. Plugged down 2:15 PM 3-3-77. Circulated 15 Sx.

WOC 12 Hours. Pressure tested casing @ 600# for 30 minutes. OK

I hereby certify that the information above is true and complete to the best of my knowledge and belief.

Vice President

March 7, 1977

11/18/77

NEW MEXICO OIL CONSERVATION COMMISSION

SUNDRY NOTICES AND REPORTS ON WELLS <small>DO NOT USE THIS FORM FOR PROPOSALS TO DRILL OR TO DEEPEN OR PLUG BACK TO A DIFFERENT RESERVOIR. SEE "APPLICATION FOR PERMIT" (FORM C-101) FOR SUCH PROPOSALS.</small>		Fee
1. Type of Well: <input checked="" type="checkbox"/> OIL WELL <input type="checkbox"/> GAS WELL <input type="checkbox"/> OTHER		7. Unit Agreement Name
2. Name of Operator: Harvey E. Yates Company, Inc.		8. Field and Well, or Wildcat
3. Address of Operator: Suite 1000 Security National Bank Bldg., Roswell, N.M. 88201		Graves
4. Location of Well: NE1/4 CORNER <u>0</u> <u>660</u> FEET FROM THE <u>South</u> LINE AND <u>1980</u> FEET FROM <u>East</u> LINE, SECTION <u>6</u> TOWNSHIP <u>8S</u> RANGE <u>31E</u> N.M.P.M.		#6
5. Elevation (Show whether DF, RT, CR, etc.) 4212.1 GL		12. County
		Chaves

Check Appropriate Box To Indicate Nature of Notice, Report or Other Data

NOTICE OF INTENTION TO:		SUBSEQUENT REPORT OF:	
<input type="checkbox"/> REMEDIAL WORK	<input type="checkbox"/> PLUG AND ABANDON	<input type="checkbox"/> REMEDIAL WORK	<input type="checkbox"/> ALTERING CASING
<input type="checkbox"/> REPAIR OR ABANDON	<input type="checkbox"/> CHANGE PLANS	<input type="checkbox"/> COMMENCE DRILLING OPNS.	<input type="checkbox"/> PLUG AND ABANDONMENT
<input type="checkbox"/> ALTER CASING	<input type="checkbox"/> OTHER	<input type="checkbox"/> CASING TEST AND CEMENT JOBS	<input checked="" type="checkbox"/> OTHER <u>Run production casing and Deviation Survey</u>

6. Description of Work (Clearly state all pertinent details, and give pertinent dates, including estimated date of starting any proposed work. SEE RULE 115.)

3-10-77 Ran 97 Joints (3870') 4 1/2", 9.5#, R-2 & 3, 8rd. casing. Set in cement at 3850' with 275 Sx Class C 50-50 POZ, 2% gel, 6# salt. Plugged down @ 3:00 AM 3-11-77.

WOC 36 hrs

Pressured up to 1800# for 30 minutes. OK.

I hereby certify that the information above is true and complete to the best of my knowledge and belief.

SIGNED [Signature] TITLE Vice President DATE March 14, 1977

APPROVED BY [Signature] TITLE DATE
 CONDITIONS OF APPROVAL, IF ANY:

Company: UHC New Mexico Corp.

Lease: GRAVES #7

Sec. 6 T 8 S R 31 E

Footage: 1980' FSL 660' FEL

County: CHAVES

Date Drilled: 10/77

Total Depth: 3874'

Perfs: 3662' - 3779'

Stimulation: NA

8⁵/₈" CASING @ 259' with cement circulated

CIRC CMT

7" CASING @ 1278' with 350 SX cement

6¹/₄" Hole

4¹/₂" CASING @ 3874' with 125 SX cement

NO. OF COPIES RECEIVED	
DISTRIBUTION	
SANTA FE	
FILE	
U.S.G.S.	
LAND OFFICE	
OPERATOR	

NEW MEXICO OIL CONSERVATION COMMISSION

Form C-103
Supersedes Old
C-102 and C-101
Effective 1-1-65

SUNDRY NOTICES AND REPORTS ON WELLS

(DO NOT USE THIS FORM FOR OPERATIONS TO RELATE TO A WELL OR PLUG BACK TO A DIFFERENT RESERVOIR.
USE APPLICATION FOR PERMIT TO DRILL OR RE-DRILL FOR A DIFFERENT RESERVOIR.)

1. <input checked="" type="checkbox"/> OIL WELL <input type="checkbox"/> GAS WELL <input type="checkbox"/> OTHER	5a. Indicate Type of Lease State <input type="checkbox"/> Fee <input checked="" type="checkbox"/>
2. Name of Operator Harvey E. Yates Co., Inc.	5. State Oil & Gas Lease No.
3. Address of Operator P. O. Box 1933, Roswell, N. M. 88201	7. Unit Agreement Date
4. Location of Well UNIT LETTER <u>I</u> <u>1980</u> FEET FROM THE <u>South</u> LINE AND <u>660</u> FEET FROM THE <u>East</u> LINE, SECTION <u>6</u> TOWNSHIP <u>8S</u> RANGE <u>31E</u> N.M.P.M.	8. Farm or Lease Name Graves
	9. Well No. 7
	10. Field and Pool, or Wildcat Cato-San Andres
15. Elevation (Show whether DF, RT, GR, etc.) 4202.' GL	12. County Chaves

16. Check Appropriate Box To Indicate Nature of Notice, Report or Other Data

NOTICE OF INTENTION TO:

SUBSEQUENT REPORT OF:

PERFORM REMEDIAL WORK <input type="checkbox"/>	PLUG AND ABANDON <input type="checkbox"/>	REMEDIAL WORK <input checked="" type="checkbox"/>	ALTERING CASING <input type="checkbox"/>
TEMPORARILY ABANDON <input type="checkbox"/>	CHANGE PLANS <input type="checkbox"/>	COMMENCE DRILLING OPNS. <input type="checkbox"/>	PLUG AND ABANDONMENT <input type="checkbox"/>
PULL OR ALTER CASING <input type="checkbox"/>	OTHER <input type="checkbox"/>	CASING TEST AND CEMENT JOBS <input type="checkbox"/>	
		OTHER <u>Run casing, cement, test etc.</u> <input checked="" type="checkbox"/>	

17. Describe Proposed or Completed Operations (Clearly state all pertinent details, and give pertinent dates, including estimated date of starting any proposed work) SEE RULE 1103.

- 10-20-77 Begin cleaning out hole lost on 10-6-77.
- 10-26-77 Cleaned out to 1280'. Ran 34 Jts. (1278.25') 7" OD, 20# Casing set and cemented at 1286' with 350 Sx C1 C Lodense and 100 Sx C1 C 2% CaCl. Circulated estimated 10 Sx. Rigged down cable tools and moved off location. WOC.
- 10-30-77 WEK Drilling Co., Inc. Rig #1 moved on location. Tested 7" casing to 1000# for 30 minutes. OK.

18. I hereby certify that the information above is true and complete to the best of my knowledge and belief.

SIGNED Paul J. Hardee

TITLE Engineer

DATE 11-7-77

APPROVED BY _____

TITLE _____

CONDITIONS OF APPROVAL, IF ANY:

NOV 1 1977

NO. OF COPIES RECEIVED	
DISTRIBUTION	
SANTA FE	
FILE	
U.S.G.S.	
LAND OFFICE	
OPERATOR	

NEW MEXICO OIL CONSERVATION COMMISSION

Form C-103
Supersedes Old
C-102 and C-103
Effective 1-1-65

SUNDARY NOTICES AND REPORTS ON WELLS

DO NOT USE THIS FORM FOR INFORMATION TO BE USED IN CONNECTION WITH A DIFFERENT RESERVOIR.
(SEE APPLICATION FOR PERMIT TO PRODUCE OIL OR GAS FROM A DIFFERENT RESERVOIR.)

1. <input checked="" type="checkbox"/> OIL WELL <input type="checkbox"/> GAS WELL <input type="checkbox"/> OTHER	5a. Indicate Type of Lease State <input type="checkbox"/> Fee <input checked="" type="checkbox"/>
2. Name of Operator Harvey E. Yates Company, Inc.	5. State Oil & Gas Lease No.
3. Address of Operator P. O. Box 1933, Roswell, New Mexico 88201	7. Unit Agreement Name
4. Location of Well UNIT LETTER <u>I</u> 1980 FEET FROM THE <u>South</u> LINE AND <u>660</u> FEET FROM THE <u>East</u> LINE, SECTION <u>6</u> TOWNSHIP <u>8S</u> RANGE <u>31E</u> NMPM.	8. Form of Lease Name Graves
	9. Well No. 7
	10. Field and Pool, or Wildcat Cato-San Andres
15. Elevation (Show whether DF, RT, GR, etc.) 4202.0' GL	12. County Chaves

16. Check Appropriate Box To Indicate Nature of Notice, Report or Other Data

NOTICE OF INTENTION TO:

SUBSEQUENT REPORT OF:

PERFORM REMEDIAL WORK <input type="checkbox"/>	PLUG AND ABANDON <input type="checkbox"/>	REMEDIAL WORK <input type="checkbox"/>	ALTERING CASING <input type="checkbox"/>
TEMPORARILY ABANDON <input type="checkbox"/>	CHANGE PLANS <input type="checkbox"/>	COMMENCE DRILLING OPHS. <input type="checkbox"/>	PLUG AND ABANDONMENT <input type="checkbox"/>
PULL OR ALTER CASING <input type="checkbox"/>	OTHER <input type="checkbox"/>	CASING TEST AND CEMENT JOB <input type="checkbox"/>	
		OTHER <u>Surface casing, cement job & test</u> <input checked="" type="checkbox"/>	

17. Describe Proposed or Completed Operations (Clearly state all pertinent details, and give pertinent dates, including estimated date of starting any proposed work) SEE RULE 1503.

10-2-77 Spudded 11" hole at 1:00 PM

Ran 6 Joints (259') 8 5/8", 20#, R-3, 8rd casing. Set and cemented at 271' with 125 Sx C1 C 2% CaCl. Circulated 20 Sx.

WOC 12 hours

M. W. S. / B. W. S.

Pressure tested casing to 600# for 30 minutes. OK

18. I hereby certify that the information above is true and complete to the best of my knowledge and belief.

SIGNED Paul J. Linder TITLE Engineer DATE 10-4-77

APPROVED BY Paul J. Linder TITLE Engineer DATE 10-10-77

CONDITIONS OF APPROVAL, IF ANY:

NO. OF COPIES RECEIVED	
DISTRIBUTION	
SALE AREA	
FILE	
U.S.G.S.	
LAND OFFICE	
TRANSPORTER	OIL GAS
OPERATOR	
REGISTRATION OFFICE	

NEW MEXICO OIL CONSERVATION COMMISSION
REQUEST FOR ALLOWABLE
AND
AUTHORIZATION TO TRANSPORT OIL AND NATURAL GAS

Form O-104
 Superseding Old O-101 and O-1
 Effective 1-1-65

Harvey E. Yates Company

P. O. Box 1933, Roswell, N. M. 88201

Reason(s) for filing (Check proper box)		Other (Please explain)	
New Well <input checked="" type="checkbox"/>	Change in Transporter of Oil <input type="checkbox"/>	CASE HEAD GAS MUST NOT BE PLATED AFTER 211173 UNDER AN EXCEPTION TO R-4070 IS OBTAINED.	
Recompletion <input type="checkbox"/>	Oil <input type="checkbox"/> Dry Gas <input type="checkbox"/>		
Change in Ownership <input type="checkbox"/>	Casinghead Gas <input type="checkbox"/> Condensate <input type="checkbox"/>		

Change of ownership give name
 and address of previous owner

DESCRIPTION OF WELL AND LEASE

Lease Name Graves	Well No. 7	Pool Name, including Formation Cato-San Andres	Kind of Lease State, Federal or Fee Fee	Lease No.
Location				
Unit Letter I : 1980 Feet From The South Line and 660 Feet From The East				
Line of Section 6 Township 8S Range 31E , N.M.P.M. Chaves County				

DESIGNATION OF TRANSPORTER OF OIL AND NATURAL GAS

Name of Authorized Transporter of Oil <input checked="" type="checkbox"/> or Condensate <input type="checkbox"/>	Address (Give address to which approved copy of this form is to be sent)
Navajo Crude Oil Purchasing Company	N Freeman Avenue Artesia, N. M. 88210
Name of Authorized Transporter of Casinghead Gas <input type="checkbox"/> or Dry Gas <input type="checkbox"/>	Address (Give address to which approved copy of this form is to be sent)

Well produces oil or liquids, give location of tanks.	Unit J	Sec. 6	Twp. 8S	Rge. 31E	Is gas actually connected? <input type="checkbox"/>	When
--	------------------	------------------	-------------------	--------------------	---	------

this production is commingled with that from any other lease or pool, give commingling order number:

COMPLETION DATA

Designate Type of Completion - (X)	Oil Well <input checked="" type="checkbox"/>	Gas well <input type="checkbox"/>	Flow Well <input type="checkbox"/>	Workover <input type="checkbox"/>	Deepen <input type="checkbox"/>	Plug Back <input type="checkbox"/>	Same Test <input type="checkbox"/>	Diff. Test <input type="checkbox"/>
Date Spudded 10-2-77	Date Compl. Ready to Prod. 11-23-77	Total Depth 3873' KB		P.U.T.D. 3843' KB				
Perforations (DF, RKB, RT, GR, etc.) 4202' GL	Name of Producing Formation San Andres	Top Oil/Gas Pay 3652' - 3789'		Tubing Depth 3828' KB				
Perforations 3652', 60', 66', 75' - 4 Shots; 3706', 13', 14', 16', 19', 27', 32', 35', 37 - 9 Shots; 3779', 83', 86 1/2', 89' - 4 Shots				Depth Casing Shoe				

TUBING, CASING, AND CEMENTING RECORD

HOLE SIZE	CASING & TUBING SIZE	DEPTH SET	SACKS CEMENT
11"	8 5/8"	271'	125 Sx Cl C w/2% CaCl
8"	7"	1278' KB	350 Sx Cl C w/2% CaCl
6 1/2"	4 1/2"	3874' KB	125 Sx Cl C 50/50 Poz 2%
	2 3/8"	3828' KB	cel w/6# salt/sx

TEST DATA AND REQUEST FOR ALLOWABLE

(Test must be after recovery of total volume of load oil and must be equal to or exceed top allowable for this depth or be for full 24 hours)

First New Oil Run To Tanks 12-1-77	Date of Test 12-2-77	Producing Method (Flow, pump, gas lift, etc.) Pumping	
Length of Test 24 Hours	Tubing Pressure	Casing Pressure	Choke Size
Actual Prod. During Test 95 BBLs	Oil-Bbls. 85	Water-Bbls. 10	Gas-MCF TSTM

GAS WELL

Actual Prod. Test-MCF/D	Length of Test	Bbls. Condensate/MCF	Gravity of Condensate
Testing Method (prior, back pr.)	Tubing Pressure (Shut-In)	Casing Pressure (Shut-In)	Choke Size

CERTIFICATE OF COMPLIANCE

I hereby certify that the rules and regulations of the Oil Conservation Commission have been complied with and that the information given above is true and complete to the best of my knowledge and belief.

Paul J. Sandoz
 (Signature)

Engineer
 (Title)

December 7, 1977
 (Date)

OIL CONSERVATION COMMISSION

APPROVED *[Signature]*, 19
 BY *[Signature]*
 TITLE *[Signature]*

This form is to be filed in compliance with N.M.R. 1104.

If this is a request for allowable for a newly drilled or deepened well, this form must be accompanied by a telephoto of the bottom tests taken on the well in accordance with N.M.R. 111.

All sections of this form must be filled out completely for allowable on new and recompleted wells.

Fill out only Sections I, II, III, and VI for change of owner, well name or number, or transportation other such change of conditions.

Company: UHC New Mexico Corp.

Lease: DRAVES #8

Sec. 6 T 8 S R 31 E

Footage: 660' FSL 660' FEL

County: Chaves

Date Drilled: 3/78

Total Depth: 3907'

Perfs: 3686' - 3804'

Stimulation: NA

8 5/8" casing @ 1328' with cement circulated

7 7/8" Hole

4 1/2" casing @ 3907' with 2755x cement.

NO. OF COPIES RECEIVED	
DISTRIBUTION	
SANTA FE	
FILE	
U.S.G.S.	
LAND OFFICE	
TRANSPORTER	OIL GAS
OPERATOR	
PRODUCTION OFFICE	
Operator	

MEXICO OIL CONSERVATION COMMISSION

REQUEST FOR ALLOWABLE AND

AUTHORIZATION TO TRANSPORT OIL AND NATURAL GAS

Form C-101
Superseding Old C-101 and C-1
Effective 1-1-65

Harvey E. Yates Company	
Address P. O. Box 1933, Roswell, New Mexico 88201	
Reason(s) for filing (Check proper box)	Other (Please explain)
New Well <input checked="" type="checkbox"/>	CANNED GAS MUST NOT BE FURNISHED ATTEM 2/1/78 UNLESS AN EXCEPTION TO R-4076 IS OBTAINED.
Recompletion <input type="checkbox"/>	
Change in Ownership <input type="checkbox"/>	
Change in Transporter of	
Oil <input type="checkbox"/>	
Casinghead Gas <input type="checkbox"/>	
Dry Gas <input type="checkbox"/>	
Condensate <input type="checkbox"/>	

If change of ownership give name
and address of previous owner

DESCRIPTION OF WELL AND LEASE

Lease Name Graves	Well No. 8	Pool Name, including Formation Cato-San Andres	Kind of Lease State, Federal or Fee Fee	Lease No.
Location				
Unit Letter P	660	Feet From The South	Line and 660	Feet From The East
Line of Section 6	Township 8S	Range 31E	NMPM, Chaves	County

DESIGNATION OF TRANSPORTER OF OIL AND NATURAL GAS

Name of Authorized Transporter of Oil <input checked="" type="checkbox"/> or Condensate <input type="checkbox"/>	Address (Give address to which approved copy of this form is to be sent)
Navajo Crude Oil Purchasing Company	N. Freeman Ave., Artesia, N. M. 88210
Name of Authorized Transporter of Casinghead Gas <input type="checkbox"/> or Dry Gas <input type="checkbox"/>	Address (Give address to which approved copy of this form is to be sent)
If well produces oil or liquids, give location of tanks.	Unit J
	Sec. 6
	Twp. 8S
	Rge. 31E
Is gas actually connected?	When

If this production is commingled with that from any other lease or pool, give commingling order number:

COMPLETION DATA

Designate Type of Completion - (X)	Oil Well <input checked="" type="checkbox"/>	Gas Well <input type="checkbox"/>	Flow Well <input type="checkbox"/>	Workover <input type="checkbox"/>	Deepen <input type="checkbox"/>	Plug Back <input type="checkbox"/>	Same as Test <input type="checkbox"/>	Test, Re-test
Date Spudded 3-24-78	Date Compl. Ready to Prod. 4-21-78	Total Depth 3907' KB	P.B.T.D.					
Elevations (DF, RNB, RT, GR, etc.) 4215' GL	Name of Producing Formation San Andres	Top Oil/Gas Pay 3686'	Tubing Depth 3866' KB					
Perforations 3686', 91', 99', 3700' - 4 holes 65', 66', 77' - 8 holes		3740', 48', 49', 50', 63', 3804', 13', 17', 18', 19', 20', 21', 22' 8 holes						

TUBING, CASING, AND CEMENTING RECORD

HOLE SIZE	CASING & TUBING SIZE	DEPTH SET	SACKS CEMENT
11"	8 5/8"	1340' KB	475 Sx
7 7/8"	4 1/2"	3907' KB	275 Sx
	2 3/8"	3866' KB	

TEST DATA AND REQUEST FOR ALLOWABLE OIL WELL

(Test must be after recovery of total volume of load oil and must be equal to or exceed top oil
able for this depth or be for full 24 hours)

Date First New Oil Run To Tanks 4-28-78	Date of Test 4-29-78	Producing Method (Flow, pump, gas lift, etc.) Pumping
Length of Test 24 Hours	Tubing Pressure -	Casing Pressure 50
Actual Prod. During Test 35	Oil-Bble. 35	Water-Bble. 15
		Gas-MCF TSTM

GAS WELL

Actual Prod. Test-MCF/D	Length of Test	Bble. Condensate/MCF	Gravity of Condensate
Testing Method (pilot, back pr.)	Tubing Pressure (Shut-in)	Casing Pressure (Shut-in)	Choke Size

CERTIFICATE OF COMPLIANCE

I hereby certify that the rules and regulations of the Oil Conservation Commission have been complied with and that the information given above is true and complete to the best of my knowledge and belief.

Park Harder
(Signature)

Engineer

(Title)

April 28, 1978

(Date)

OIL CONSERVATION COMMISSION

MAY 8 1978

APPROVED _____, 19

BY

James A. Smith
SUPERVISOR DISTRICT I

TITLE

This form is to be filed in compliance with RULE 1104.

If this is a request for allowable for a newly drilled or deepened well, this form must be accompanied by a tabulation of the fluid tests taken on the well in accordance with RULE 111.

All sections of this form must be filled out completely for saleable and non-saleable completed wells.

Fill out only Sections I, II, III, and VI for revision of well name or number, or transporter, or other such change of condition.

NO. OF COPIES RECEIVED	
DISTRIBUTION	
DATE	
TIME	
NO. OF COPIES	
NO. OF COPIES	
NO. OF COPIES	

NEW MEXICO OIL CONSERVATION COMMISSION

Form C-103
Supersedes Old
C-102 and C-103
Effective 1-1-65

SUNDARY NOTICES AND REPORTS ON WELLS (DO NOT USE THIS FORM FOR OPERATIONS TO BE PERFORMED ON A DIFFERENT RESERVOIR. USE APPLICATION FOR PERMIT TO DRILL OR RE-DRILL FOR A DIFFERENT RESERVOIR.)

OIL WELL ☒ GAS WELL ☐ OTHER ☐

Name of Operator
Harvey E. Yates Company

Address of Operator
P. O. Box 1933, Roswell, N. M. 88201

Location of Well
UNIT LETTER **P** **660** FEET FROM THE **South** LINE AND **660** FEET FROM
THE **East** LINE, SECTION **6**, TOWNSHIP **8S**, RANGE **31E**, N.M.P.M.

5a. Indicate Type of Lease State <input type="checkbox"/> Fee <input checked="" type="checkbox"/>
5. State Oil & Gas Lease No.
7. Unit Agreement Name
8. Term of Lease Name Graves
9. Well No. 8
10. Field and Pool, or Wellhead Cato-San Andres
12. County Chaves

11. Elevation (Show whether DF, RT, GR, etc.)
4215.1' GL

Check Appropriate Box To Indicate Nature of Notice, Report or Other Data
NOTICE OF INTENTION TO: SUBSEQUENT REPORT OF:

GRM REMEDIAL WORK <input type="checkbox"/>	PLUG AND ABANDON <input type="checkbox"/>	REMEDIAL WORK <input type="checkbox"/>	ALTERING CASING <input type="checkbox"/>
GRABILI ABANDON <input type="checkbox"/>	CHANGE PLANS <input type="checkbox"/>	COMMENCE DRILLING OPNS. <input type="checkbox"/>	PLUG AND ABANDONMENT <input type="checkbox"/>
OR ALTER CASING <input type="checkbox"/>	OTHER <input type="checkbox"/>	CASING TEST AND CEMENT JOBS <input type="checkbox"/>	
		OTHER Spud, run casing, cement & test <input checked="" type="checkbox"/>	

Describe Proposed or Completed Operations (Clearly state all pertinent details, and give pertinent dates, including estimated date of starting any proposed work.) SEE RULE 1103.

3-24-78 Spudded 11" hole at 1:15 pm.

3-25-78 Ran 1328' (33joints) 8 5/8" OD 23# 8RD R-3 ST&C L. B. Foster casing. Set and cemented at 1340' KB with 375 Sx Lite w/6# Salt/Sx and 100 Sx Cl C w/2% CaCl. Plug down at 1:00 pm. Circulated 25 Sx.

WOC 18 Hours.

3-26-78 Tested casing to 1500 psi for 30 minutes. OK.

I hereby certify that the information above is true and complete to the best of my knowledge and belief.

DATE **March 31, 1978**
TITLE **Engineer**
DATE **APR 3 1978**
OVER BY **Paul J. Sander**
TITLES OF APPROVAL, IF ANY:

NO. OF COPIES RECEIVED	
DISTRIBUTION	
AREA FE	
FILE	
S.G.S.	
AND OFFICE	
RELATOR	

NEW MEXICO OIL CONSERVATION COMMISSION

Form C-103
Supersedes Old
C-102 and C-103
Effective 1-1-65

SUNDRY NOTICES AND REPORTS ON WELLS
(DO NOT USE THIS FORM FOR PROPOSALS TO DRILL OR TO RE-ENTER OR RE-LOCATE TO A DIFFERENT RESERVOIR. USE APPLICATION FOR PERMIT TO DRILL (C-101) FOR SUCH PROPOSALS.)

OIL WELL ☒ GAS WELL ☐ OTHER ☐

Name of Operator
Harvey E. Yates Company

Address of Operator
P. O. Box 1933, Roswell, N. M. 88201

Location of Well
UNIT LETTER P 660 FEET FROM THE South LINE AND 660 FEET FROM
THE East LINE, SECTION 6 TOWNSHIP 8S RANGE 31E NMPLS.

15. Elevation (Show whether DF, RT, GR, etc.)
4215.' GL

5a. Indicate Type of Lease
State ☐ Fee ☒

3. State Oil & Gas Lease No.

7. Unit Agreement Name

8. Farm or Lease Name
Graves

9. Well No.
8

10. Field and Pool, or Wildcat
Cato-San Andres

12. County
Chaves

Check Appropriate Box To Indicate Nature of Notice, Report or Other Data

NOTICE OF INTENTION TO:		SUBSEQUENT REPORT OF:	
PERFORM REMEDIAL WORK <input type="checkbox"/>	PLUG AND ABANDON <input type="checkbox"/>	REMEDIAL WORK <input type="checkbox"/>	ALTERING CASING <input type="checkbox"/>
PERMANENTLY ABANDON <input type="checkbox"/>	CHANGE PLANS <input type="checkbox"/>	COMMENCE DRILLING OPS. <input type="checkbox"/>	PLUG AND ABANDONMENT <input type="checkbox"/>
RELOCATE OR ALTER CASING <input type="checkbox"/>	OTHER <input type="checkbox"/>	CASING TEST AND CEMENT JOBS <input type="checkbox"/>	OTHER <u>Run production casing, cement</u> <input checked="" type="checkbox"/>

Describe Proposed or Completed Operations (Clearly state all pertinent details, and give pertinent dates, including estimated date of starting any proposed work) SEE RULE 1103.

3-31-78 Ran 99 Joints (3928') 4 1/2" OD 9.5# 8Rd R-2 & R-3 ST&C casing set and cemented at 3907' with 275 Sxs Cl C 50-50 POS, 6# salt, 2% gel. Plug down 11:00 am.

WOC

Will pressure test casing when completion unit comes on location.

I hereby certify that the information above is true and complete to the best of my knowledge and belief.

By Pert Harder TITLE Engineer DATE April 11, 1978

COPIES BY Jerry Sexton TITLE Dist. Supv. DATE APR 21 1978

EDITIONS OF APPROVAL, IN

Company: Humble Oil & Refining

Lease: Railroad Mountain UN #2

Sec. 8 T 8 S R 31 E

Footage: 1980' FNL 660' FWL

County: Chaves

Date Drilled: 1/1958

Total Depth: 1985'

Perfs: NA

Stimulation: NA

8 5/8" casing @ 308' with cement circ.

40 SX plug 250' - 300'

Put casing @ 640' and pulled.

80 SX plug 540' - 740'

Too shallow

5 1/2 casing with 150 SX cement @ 1985'

5 SX plug

(SUBMIT IN TRIPLICATE)

LAND OFFICE LC-064421LEASE NO. 224813UNIT 77 E

FEB 27 1958

UNITED STATES
DEPARTMENT OF THE INTERIOR
GEOLOGICAL SURVEY

SUNDRY NOTICES AND REPORTS ON WELLS

NOTICE OF INTENTION TO DRILL	SUBSEQUENT REPORT OF WATER SHUT-OFF	
NOTICE OF INTENTION TO CHANGE PLANS	SUBSEQUENT REPORT OF SHOOTING OR ACIDIZING	
NOTICE OF INTENTION TO TEST WATER SHUT-OFF	SUBSEQUENT REPORT OF ALTERING CASING	
NOTICE OF INTENTION TO RE-DRILL OR REPAIR WELL	SUBSEQUENT REPORT OF RE-DRILLING OR REPAIR	
NOTICE OF INTENTION TO SHOOT OR ACIDIZE	SUBSEQUENT REPORT OF ABANDONMENT	X
NOTICE OF INTENTION TO PULL OR ALTER CASING	SUPPLEMENTARY WELL HISTORY	
NOTICE OF INTENTION TO ABANDON WELL	Subsequent Report Plug	X

(INDICATE ABOVE BY CHECK MARK NATURE OF REPORT, NOTICE, OR OTHER DATA)

RAILROAD MOUNT. IN UNIT

January 31, 19 58

WELL NO. 2 IS LOCATED 1980 FT. FROM {N} LINE AND 660 FT. FROM {W} LINE OF SEC. 8

NW/4 Sec

T-8-S

31

(1/4 SEC. AND SEC. NO.)

(TWP.)

(RANGE)

(MERIDIAN)

Wildcat

Chaves

New Mexico

(FIELD)

(COUNTY OR SUBDIVISION)

(STATE OR TERRITORY)

THE ELEVATION OF THE DERRICK FLOOR ABOVE SEA LEVEL IS 4215 FT.

DETAILS OF WORK

(STATE NAMES OF AND EXPECTED DEPTHS TO OBJECTIVE SANDS; SHOW SIZES, WEIGHTS, AND LENGTHS OF PROPOSED CASINGS; INDICATE MUDDING JOBS, CEMENTING POINTS, AND ALL OTHER IMPORTANT PROPOSED WORK.)

Cut 5½" csg. at 640' and pulled casing. Filled 5½" csg with heavy mud laden fluid.
 Set cmt plug from 740 to 540' with 80 sacks reg cmt 2% calcium chloride.
 Set cmt plug from 360 to 250' with 40 sacks reg cement 2% calcium chloride.
 Set cmt plug from 10 to 0 with 5 sacks reg cement.
 Placed marker over well as required by NMOCC.
 Location cleaned and leveled.

I UNDERSTAND THAT THIS PLAN OF WORK MUST RECEIVE APPROVAL IN WRITING BY THE GEOLOGICAL SURVEY BEFORE OPERATIONS MAY BE COMMENCED.

COMPANY Humble Oil & Refining CompanyADDRESS Box 2347, Hobbs, New MexicoBY R. B. JohnsonTITLE Agent

U. S. GOVERNMENT PRINTING OFFICE 16-5497-5

Orig & 2cc: USGS, Roswell, N.M., lcc: NMOCC, Artesia, NM, lcc: Mr. Bybee, Midland,
 lcc: Mr. L. H. Thompson, Houston, lcc: Midland, lcc: Dist File, lcc: NM State Land Office,
 Attn: Mr. Ted Bilberry, Unit Section, Santa Fe, N.M.

Company: HARVEY E. YATES

Lease: RAILROAD MOUNTAIN #1

Sec. 8 T 8 S R 31 E

Footage: 660' FNL 660' FWL

County: CHAVES

Date Drilled: 10/76

Total Depth: 9933'

Perfs: 9210' - 9860'

Stimulation: 4400 gal ACID

13 3/8 casing @ 330' with cement circulated

35 SX plug @ 1914'

35 SX plug @ 3426'

9 5/8" casing @ 3990' with cement circulated

35 SX plug @ 5001'

35 SX plug @ 7013'

20 SX plug @ 8560'

20 SX plug @ 9127' - 8857'

CIBP @ 9650 with 15 SX cement.

4 1/2" casing @ 9933' with 600 SX cement.

10 SX plug

Form 9-331
(May 1965)UNITED STATES
DEPARTMENT OF THE INTERIOR
GEOLOGICAL SURVEYSUBMIT IN TRIPLICATION*
(Other instructions on re-
verse side)Form approved,
Budget Bureau No. 42-R1424.

5. LEASE DESIGNATION AND SERIAL NO.

15678

6. IF INDIAN, ALLOTTEE OR TRIBE NAME

SUNDRY NOTICES AND REPORTS ON WELLS

(Do not use this form for proposals to drill or to deepen or plug back to a different reservoir.
Use "APPLICATION FOR PERMIT-" for such proposals.)

7. UNIT AGREEMENT NAME

8. FARM OR LEASE NAME

Railroad Mountain

9. WELL NO.

#1

10. FIELD AND POOL, OR WILDCAT

Undesignated

11. SEC. T., R., M., OR B.L. AND
SURVEY OR AREA

Sec. 8, T-8S, R-31E

12. COUNTY OR PARISH

Chaves

13. STATE

N.M.

1. OIL ☐ GAS ☒ WELL ☒ OTHER ☐

2. NAME OF OPERATOR

Harvey E. Yates Company, Inc.

3. ADDRESS OF OPERATOR

Suite 1000 Security National Bank Bldg., Roswell, N.M. 88201

4. LOCATION OF WELL (Report location clearly and in accordance with any State requirements.*
See also space 17 below.)At surface
660 FNL & FWL

14. PERMIT NO.

15. ELEVATIONS (Show whether DF, RT, GR, etc.)

4225' DF

16.

Check Appropriate Box To Indicate Nature of Notice, Report, or Other Data

NOTICE OF INTENTION TO:

TEST WATER SHUT-OFF ☐FRACTURE TREAT ☐SHOOT OR ACIDIZE ☐REPAIR WELL ☐(Other) ☐PULL OR ALTER CASING ☐MULTIPLE COMPLETE ☐ABANDON* ☐CHANGE PLANS ☐

SUBSEQUENT REPORT OF:

WATER SHUT-OFF ☐FRACTURE TREATMENT ☐SHOOTING OR ACIDIZING ☐(Other) ☐REPAIRING WELL ☐ALTERING CASING ☐ABANDONMENT* ☒(Note: Report results of multiple completion on Well
Completion or Recompletion Report and Log form.)17. DESCRIBE PROPOSED OR COMPLETED OPERATIONS (Clearly state all pertinent details, and give pertinent dates, including estimated date of starting any
proposed work. If well is directionally drilled, give subsurface locations and measured and true vertical depths for all markers and zones perti-
nent to this work.)*

2-02-77 Plugged and abandoned in the following manner:

Plug #1 - 15 Sx Class H cement spotted on top CIBP from 9650' - 9550'
 Plug #2 - 20 Sx Class H cement spotted from 9127' - 8857'
 Plug #3 - 20 Sx Cement @ 8560'
 Plug #4 - 35 Sx Cement @ 7013'
 Plug #5 - 35 Sx Cement @ 5001'
 Plug #6 - 35 Sx Cement @ 3426'
 Plug #7 - 35 Sx Cement @ 1914'
 Plug #8 - 10 Sx @ Surface

Dry Hole Marker at Top

RECEIVED
 FEB 16 1977
 U.S. GEOLOGICAL SURVEY
 ALBUQUERQUE, NEW MEXICO

18. I hereby certify that the foregoing is true and correct

SIGNED

TITLE Vice President

DATE February 14, 1977

(This space for Federal or State office use)

APPROVED BY

TITLE

NOT ENGINEER

DATE

FEB 28 1980

CONDITIONS OF APPROVAL, IF ANY:

*See Instructions on Reverse Side

UNITED STATES
DEPARTMENT OF THE INTERIOR
GEOLOGICAL SURVEY

SUBMIT IN DUPLICATE

See other in
specimens or
enclose sideForm approved
Bureau of ReclamationLEASE DESIGNATION AND SERIAL NO.
15678

B. H. INDIAN, COTTEL, TELLO, ...

UNIT AGREEMENT NAME

FARM OR LEASE NAME

Railroad Mountain

WELL NO.

1

FIELD AND POOL OR WILDCAT

Undesignated

11. SECTION, T., R., MD. OR BLOCK AND SURFACE
OF AREA

Sec. 8, T-8S, R-31E

12. COUNTY OR
PARISH

Chaves

N.M.

13. ELEVATION (DEF. RISE, RT
GR. ETC.)

ROTARY TOOLS

0' - 10150'

25. WAS DIRECTOR
SURVEY MADE

No

No

WELL COMPLETION OR RECOMPLETION REPORT AND LOG *

1a. TYPE OF WELL: OIL WELL ☐ GAS WELL ☒ DRY ☐ Other Re-Entry

b. TYPE OF COMPLETION:

NEW WELL ☐ WORK OVER ☐ DEEP EN ☐ PLUG BACK ☐ DIFF. RESER. ☐ Other P & A

2. NAME OF OPERATOR

Harvey E. Yates Company, Inc.

3. ADDRESS OF OPERATOR

Suite 1000 Security National Bank Bldg., Roswell, N.M.

4. LOCATION OF WELL (Report location clearly and in accordance with any State requirements)*

At surface 660 FNL & FWL

At top prod. interval reported below

At total depth

Same

14. PERMIT NO.

DATE ISSUED

15. DATE STUDD

10-19-76

16. DATE T.D. REACHED

11-04-76

17. DATE COMPLETION (Report to prod.)

11-04-76

18. ELEVATION (DEF. RISE, RT

4225' DF

20. TOTAL DEPTH, MD & TVD

10,150'

21. PLUG BACK T.D., MD & TVD

9956'

22. IF MULTIPLE COMPLETIONS, HOW MANY?

1

24. PRODUCING INTERVAL(S) OF THIS COMPLETION (Report bottom name (MD AND TVD)*)

RECEIVED
FEB 17 1977
U.S. GEOLOGICAL SURVEY
ARTESIA, NEW MEXICO

26. TYPE OF LOG AND OTHER LOGS RUN

Gamma Ray Neutron and Cement Bond

28. CASING RECORD (Report all strings set in well)

CASING SIZE	WEIGHT, LB./FT.	DEPTH SET (MD)	HOLE SIZE	CEMENTING RECORD	AMOUNT SET (MD)
13 3/8"	48#	330'	17 1/2"	Circulated	
9 5/8"		3390'	12 1/4"	Circulated	
4 1/2"	11.6#	9933'		600 Sx Class H	

29. LINER RECORD

SIZE	TOP (MD)	BOTTOM (MD)	BACKS CEMENT*	SCREEN (MD)	SIZE	DEPTH SET (MD)	AMOUNT SET (MD)

31. PERFORATION RECORD (Interval, size and number)

9860-62 - 3 Holes, 9854-58 - 5 Holes, 9736-42 - 6 Holes.

9210-12, 9257-59, 9310-13, 9315-19, 9323-27, 9330-36, 9340-43- 48 Shots.

32. ACID, SHOT, FRACTURE, CEMENT SQUEEZE, ETC.

DEPTH INTERVAL (MD)	AMOUNT AND KIND OF MATERIAL
9736 - 9860	4400 Gals Acid
9210 - 9343	6000 Gals Acid w/120 Ball sealers

33. PRODUCTION

DATE FIRST PRODUCTION PRODUCTION METHOD (Flowing, gas lift, pumping- size and type of pump)

WELL STATUS (Producing or shut in)

DATE OF TEST	HOURS TESTED	CHOKE SIZE	PROD'N. FOR TEST PERIOD	OIL - BBL.	GAS - MCF	WATER - BBL.	GAS - GRAVITY ADJ. COR.
FLOW, TUBING PRESS.	CASING PRESSURE	CALCULATED 24-HOUR RATE	OIL - BBL.	GAS - MCF.	WATER - BBL.	OIL GRAVITY ADJ. COR.	

34. DISPOSITION OF GAS (Sold, used for fuel, vented, etc.)

TEST WITNESSED BY

35. LIST OF ATTACHMENTS

36. I hereby certify that the foregoing and attached information is complete and correct as determined from all available records

SIGNED

TITLE Vice President

DATE 2-15-77

*(See Instructions and Spaces for Additional Data on Reverse Side)

Company: Murphy Operating Corp.

Lease: INGRAM Fed. #8

Sec. 5 T 8 S R 31 E

Footage: 660' FSL 660' FWL

County: Chaves

Date Drilled: 8/78

Total Depth: 3961

Perfs: NA

Stimulation: NA

8 5/8" casing @ 1305' with 3005x cement.

35sx plug



1355' - 35 sx plug



1750' - 35 sx plug



3000' - 35 sx plug



3660' - 35 sx plug

← TD 3961' NO CASING RUN - well Plugged

UNITED STATES
DEPARTMENT OF THE INTERIOR
GEOLOGICAL SURVEY

SUBMIT IN TRIPLICATE*
(Other instructions on re-
verse side)

Form approved.
Budget Bureau No. 42-R1424.

5. USE DESIGNATION AND SERIAL NO.

NM-15678

6. IF INDIAN, ALLOTTEE OR TRIBE NAME

7. UNIT AGREEMENT NAME

8. FARM OR LEASE NAME

Ingram Federal

9. WELL NO.

8

10. FIELD AND POOL, OR WILDCAT

Cato, San Andres

11. SEC., T., R., M., OR BLK. AND
SURVEY OR AREA

Section 5, T.8S., R.31E.

12. COUNTY OR PARISH 13. STATE

Chaves

New Mexico

1. OIL WELL ☐ GAS WELL ☐ OTHER ☒ DRY HOLE

2. NAME OF OPERATOR

SUNDANCE OIL COMPANY

3. ADDRESS OF OPERATOR

Suite 510, 1776 Lincoln St., Denver, CO 80203

4. LOCATION OF WELL (Report location clearly and in accordance with any State requirements.*
See also space 17 below.)
At surface

660' FSL, 660' FWL

Unit M

14. PERMIT NO.

15. ELEVATIONS (Show whether DF, RT, OR, etc.)

4220' GL

16. Check Appropriate Box To Indicate Nature of Notice, Report, or Other Data

NOTICE OF INTENTION TO:

TEST WATER SHUT-OFF ☐

FRACTURE TREAT ☐

SHOOT OR ACIDIZE ☐

REPAIR WELL ☐

(Other) ☐

PULL OR ALTER CASING ☐

MULTIPLE COMPLETE ☐

ABANDON* ☒

CHANGE PLANS ☐

SUBSEQUENT REPORT OF:

WATER SHUT-OFF ☐

FRACTURE TREATMENT ☐

SHOOTING OR ACIDIZING ☐

(Other) ☐

REPAIRING WELL ☐

ALTERING CASING ☐

ABANDONMENT* ☐

(NOTE: Report results of multiple completion on Well
Completion or Recompletion Report and Log form.)

17. DESCRIBE PROPOSED OR COMPLETED OPERATIONS (Clearly state all pertinent details, and give pertinent dates, including estimated date of starting any proposed work. If well is directionally drilled, give subsurface locations and measured and true vertical depths for all markers and zones pertinent to this work.)*

After receiving permission to plug, will set plugs as follows:

35 sx cement at 3650'
35 sx cement at 3000'
35 sx cement at 1750'
35 sx cement at 1355'
35 sx cement at surface

18. I hereby certify that the foregoing is true and correct

SIGNED

Richard O. Dimit

TITLE Vice President, Production

DATE 9/26/78

(This space for Federal or State office use)

APPROVED BY

Lee J. Lars

TITLE ACTING DISTRICT ENGINEER

DATE SEP 29 1978

CONDITIONS OF APPROVAL, IF ANY:

*See Instructions on Reverse Side

SUPPLEMENTAL DATA

Form C-108

- VII. 1. Proposed average daily rate is 800 B/D. ✓
 2. The injection system will be open. ✓
 3. Injection pressure at the well head will be no more than 1500 psi.
 4. Source of the injection fluid will be from the San Andres formation. ✓
 5. The injection fluid will be injected into the same formation of the producing wells within 1 mile. ✓
- VIII. 1. The San Andres zone consists highly permeable cycle-based siltstone and sandstone beds that are continuous over large areas. The gross zone is normally 40-60 feet thick and at the depth of 3850-4000 feet.
 2. Fresh water zones are almost non-existent in this area. A few wells of low capacity have been found at the depth of 90-200 feet.
- IX. 1. No stimulation of the well is planned except for acid to be pumped down the tubing.
- X. 1. Well logs are on file with the OCD. Last production on the well was April of 2002.
- XI. 1. There are no fresh water wells within the described area.

XI

There are no fresh water wells within the one mile radius of the proposed injection well.

XII
AFFIRMATIVE STATEMENT

As required by item XII of form C-108, John R. Stearns dba Stearns, has examined available geologic and engineering data and found no evidence of open faults or other hydrologic connection between the disposal zone and any other underground source of drinking water.

7002 2410 0005 8142 8587

U.S. Postal Service™
CERTIFIED MAIL™ RECEIPT
 (Domestic Mail Only; No Insurance Coverage Provided)

For delivery information visit our website at www.usps.com®

OFFICIAL USE

Postage	\$ 1.52
Certified Fee	2.30
Return Receipt Fee (Endorsement Required)	1.75
Restricted Delivery Fee (Endorsement Required)	
Total Postage & Fees	\$ 5.57



Sent To O.H.C.
 Street, Apt. No., or PO Box No. PO Box 1956
 City, State, ZIP+4 Cleburne, TX 76033

PS Form 3800, June 2002

See Reverse for Instructions

7002 2410 0005 8142 8594

U.S. Postal Service™
CERTIFIED MAIL™ RECEIPT
 (Domestic Mail Only; No Insurance Coverage Provided)

For delivery information visit our website at www.usps.com®

OFFICIAL USE

Postage	\$ 1.52
Certified Fee	2.30
Return Receipt Fee (Endorsement Required)	1.75
Restricted Delivery Fee (Endorsement Required)	
Total Postage & Fees	\$ 5.57



Sent To M. W. S. Producing Co.
 Street, Apt. No., or PO Box No. 400 W Illinois Suite 1100
 City, State, ZIP+4 Midland TX 79701

PS Form 3800, June 2002

See Reverse for Instructions

7002 2410 0005 8142 8600

U.S. Postal Service™
CERTIFIED MAIL™ RECEIPT
 (Domestic Mail Only; No Insurance Coverage Provided)

For delivery information visit our website at www.usps.com®

OFFICIAL USE

Postage	\$ 2.67
Certified Fee	2.30
Return Receipt Fee (Endorsement Required)	1.75
Restricted Delivery Fee (Endorsement Required)	
Total Postage & Fees	\$ 6.72

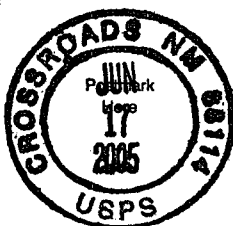

Sent To Oil Conservation Division
 Street, Apt. No., or PO Box No. 1220 So. St. Francis Dr
 City, State, ZIP+4 Santa Fe, NM 87505

PS Form 3800, June 2002

See Reverse for Instructions

7002 2410 0005 8142 8570

U.S. Postal Service™
CERTIFIED MAIL™ RECEIPT
 (Domestic Mail Only; No Insurance Coverage Provided)

For delivery information visit our website at www.usps.com®

OFFICIAL USE

Postage	\$ 1.52
Certified Fee	2.30
Return Receipt Fee (Endorsement Required)	1.75
Restricted Delivery Fee (Endorsement Required)	
Total Postage & Fees	\$ 5.57

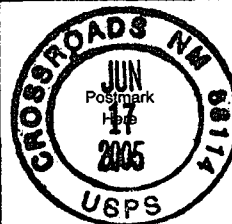

Sent To Bureau of Land Management
 Street, Apt. No., or PO Box No. 2909 W Second
 City, State, ZIP+4 Roswell, NM 88201

PS Form 3800, June 2002

See Reverse for Instructions

7002 2410 0005 8142 8563

U.S. Postal Service™
CERTIFIED MAIL™ RECEIPT
 (Domestic Mail Only; No Insurance Coverage Provided)

For delivery information visit our website at www.usps.com®

OFFICIAL USE

Postage	\$ 1.52
Certified Fee	2.30
Return Receipt Fee (Endorsement Required)	1.75
Restricted Delivery Fee (Endorsement Required)	
Total Postage & Fees	\$ 5.57



Sent To Oil Conservation Division
 Street, Apt. No., or PO Box No. 1625 N French Dr.

AFFIDAVIT OF PUBLICATION

COUNTY OF CHAVES
STATE OF NEW MEXICO

I, Fran Saunders,
Legals Clerk

Of the Roswell Daily Record, a daily newspaper published at Roswell, New Mexico, do solemnly swear that the clipping hereto attached was published in the regular and entire issue of said paper and not in a supplement thereof for a period of:

one time

beginning with the issue dated

June 6th 2005

and ending with the issue dated

June 6th 2005

Fran Saunders
Clerk

Sworn and subscribed to before me

This 7th Day of June 2005

Marilyn S. Skipper
Notary Public

My Commission expires
July 25, 2006

(SEAL)



Published June 6, 2005

Legal Notice

John R. Stearns dba Stearns, HC 65, Box 988, Crossroads, NM 88114, (505) 675-2356, is making an application to the State of New Mexico, Oil Conservation Division, for a permit to dispose of produced water into the Wattam Federal #6. The well is located 643' FNL, and 781' FEL, Sec. 7-T8S-R31E, Chaves County, New Mexico. Injection will be into the San Andres formation at the depth of 3720', anticipated rate 800 b/d @ 1500# psi.

Interested parties may file objections or request a hearing within 15 days to the Oil Conservation Division, 1220 South St. Francis Dr., Santa Fe, New Mexico 87505

Published in the Roswell Daily Record

John R. Stearns SWD Application													
30-005-20814	WATTAM FEDERAL #006	STEARNS	643N	782E	A	708S	31E	30-005-20814	3900A	F	O		
API	WELL NAME	OPERATOR	FIG NS	NS CD	FIG EW	EW CD	UL2	Sec	Lsp	Rgt	DIH	TYD DEPTH	OGD UL AND TVAL (F)
30-005-00526	PRE-ONGARD WELL #001	OK	PRE-ONGARD WELL OPERATOR	PEA	660N	660W	D	808S	31E	1,442	10382D		O
30-005-20580	GRAVES #006	OK	UHC NEW MEXICO CORPORATION	660S	1980E	O	O	608S	31E	1,770	3850O		O
30-005-20607	GRAVES #007	OK	UHC NEW MEXICO CORPORATION	1980S	660E	I	I	608S	31E	2,626	3873I		O
30-005-20621	GRAVES #008	OK	UHC NEW MEXICO CORPORATION	660S	660E	P	P	608S	31E	1,309	3907P		O
30-005-20629	PRE-ONGARD WELL #001	OK	PRE-ONGARD WELL OPERATOR	PEA	660N	2180W	C	708S	31E	2,450	3841C		O
30-005-20638	INGRAM FEDERAL #008	OK	MURPHY OPERATING CORP	660S	660W	M	M	508S	31E	1,943	3961M		O
30-005-20824	PRE-ONGARD WELL #005	OK	PRE-ONGARD WELL OPERATOR	PEA	1980S	1980E	J	708S	31E	2,915	3912J		O
30-005-20852	PRE-ONGARD WELL #010	OK	PRE-ONGARD WELL OPERATOR	PEA	660S	660E	P	708S	31E	3,979	3925P		O

John R. Stearns SWD Application					
30-005-20814	WATTAM FEDERAL #006			SAN ANDRES	ACTIVE
API	WELL NAME	SPUD DATE	PLUG DATE	FORMATION AND NOTES	STATUS
30-005-00526	PRE-ONGARD WELL #001	1900-01-01	1900-01-01	HARVEY E YATES CO /RAILROAD MOUNTAIN	PLUGGED
30-005-20580	GRAVES #006	1977-03-03		SAN ANDRES	ACTIVE
30-005-20607	GRAVES #007	1977-10-02		SAN ANDRES	ACTIVE
30-005-20621	GRAVES #008	1978-03-24		SAN ANDRES	ACTIVE
30-005-20629	PRE-ONGARD WELL #001	1900-01-01	1900-01-01	MWJ PRODUCING CO /MOBIL GRAVES	PLUGGED
30-005-20638	INGRAM FEDERAL #008	1900-01-01	1900-01-01	MURPHY OPERATING CO/INGRAM FEDERAL	PLUGGED
30-005-20824	PRE-ONGARD WELL #005	1900-01-01	1900-01-01	EXXON CORP /WATTAM FEDERAL	PLUGGED
30-005-20852	PRE-ONGARD WELL #010	1900-01-01	1900-01-01	EXXON CORP /WATTAM FEDERAL	PLUGGED

UNITED STATES
DEPARTMENT OF THE INTERIOR
BUREAU OF LAND MANAGEMENT

N. M. OIL CONS. COMMISSION
P. O. BOX 1980
HOBBS, NEW MEXICO 88240

FORM APPROVED
Budget Bureau No. 1004-0135
Expires: March 31, 1993

SUNDRY NOTICES AND REPORTS ON WELLS

Do not use this form for proposals to drill or to deepen or reentry to a different reservoir.
Use "APPLICATION FOR PERMIT—" for such proposals

SUBMIT IN TRIPLICATE

1. Type of Well

☒ Oil Well ☐ Gas Well ☐ Other

2. Name of Operator

Petroleum Development Corporation

3. Address and Telephone No.

9720-B Candelaria NE, Albuquerque, NM 87112

4. Location of Well (Footage, Sec., T., R., M., or Survey Description)

643' FNL, 782' FEL
Section 7, T8S, R31E

5. Lease Designation and Serial No.

NM-15016

6. If Indian, Allottee or Tribe Name

7. If Unit or CA, Agreement Designation

8. Well Name and No.

Wattam Federal

9. API Well No.

6

10. Field and Pool, or Exploratory Area

Cato

11. County or Parish, State

Chaves County, New Mex

12. CHECK APPROPRIATE BOX(s) TO INDICATE NATURE OF NOTICE, REPORT, OR OTHER DATA

TYPE OF SUBMISSION

☐ Notice of Intent
☒ Subsequent Report
☐ Final Abandonment Notice

TYPE OF ACTION

☐ Abandonment
☒ Recompletion
☐ Plugging Back
☐ Casing Repair
☐ Altering Casing
☐ Other Horizontal
☐ Change of Plans
☐ New Construction
☐ Non-Routine Fracturing
☐ Water Shut-Off
☐ Conversion to Injection
☐ Dispose Water

(Note: Report results of multiple completion on Well Completion or Recompletion Report and Log form.)

13. Describe Proposed or Completed Operations (Clearly state all pertinent details, and give pertinent dates, including estimated date of starting any proposed work. If well is directionally drilled give subsurface locations and measured and true vertical depths for all markers and zones pertinent to this work.)

- 1) MIRUPU and Drilling Equipment.
- 2) Drill cement plugs: surface to 410', 1231'-1370', 3500'-3546' & CIBP @ 3546'.
- 3) Set cement retainer @ 3695'. Perforations 3708'-3794' & 3642'-3682', communicated. Set packer @ 3369'. Cement squeeze perforations w/250 sx. cement.
- 4) Drill cement 3450' to 3695'.
- 5) Mill casing from 3470' 3544'.
- 6) Spot 45 sx. cement plug. Reverse out @ 3356'.
- 7) Drill cement 3440'-3520'.
- 8) Drill horizontal Arc 3520' to 3840'. TVD 3720'.
- 9) Drilled horizontal lateral to 5371'. TVD-3711.3'. 1096.6' FNL, 2448.8' FEL
- 10) Acidized w/15,000 gal. 15% NEFE acid.
- 11) Put well on pump.

14. I hereby certify that the foregoing is true and correct

Signed

J. C. Johnson

Title

President

(This space for Federal or State office use)

Approved by

Conditions of approval, if any:

Title

ACCEPTED FOR RECORD
PETER W. CHESTER

Date

9/14/95

SEP 22 1995

Date

BUREAU OF LAND MANAGEMENT
ROSWELL RESOURCE AREA

Title 18 U.S.C. Section 1001, makes it a crime for any person knowingly and wilfully to make to any department or agency of the United States any false, fictitious or fraudulent statement or representations as to any matter within its jurisdiction.

*See Instruction on Reverse Side

INSTRUCTIONS

General: This form is designed for submitting a complete and correct well completion report and log on all types of lands and leases to either a Federal agency or a State agency, or both, pursuant to applicable Federal and/or State laws and regulations. Any necessary special instructions concerning the use of this form and the number of copies to be submitted, particularly with regard to local, area, or regional procedures and practices, either are shown below or will be issued by, or may be obtained from, the local Federal and/or State office. See instructions on Items 22 and 24, and 33, below regarding separate reports for separate completions.

If not filed prior to the time this summary record is submitted, copies of all currently available logs (drillers, geologists, sample and core analysis, all types electric, etc.), formation and pressure tests, and directional surveys, should be attached hereto, to the extent required by applicable Federal and/or State laws and regulations. All attachments should be listed on this form, see item 35.

Item 4: If there are no applicable State requirements, locations on Federal or Indian land should be described in accordance with Federal requirements. (Consult local State or Federal office for specific instructions.)

Item 18: Indicate which elevation is used as reference (where not otherwise shown) for depth measurements given in other spaces on this form and in any attachments.

Items 22 and 24: If this well is completed for separate production from more than one interval zone (multiple completion), so state in item 22, and in item 24 show the producing interval, or intervals, top(s), bottom(s) and name(s) (if any) for only the interval reported in item 33. Submit a separate report (page) on this form, adequately identified, for each additional interval to be separately produced, showing the additional data pertinent to such interval.

Item 29: "Stacks (cement)": Attached supplemental records for this well should show the details of any multiple stage cementing and the location of the cementing tool.

Item 33: Submit a separate completion report on this form for each interval to be separately produced. (See instruction for items 22 and 24 above.)

37. SUMMARY OF FORMER ZONES:			38. GEOLOGIC MARKERS	
SHOW ALL IMPORTANT ZONES OF POROSITY AND CONTENTS THEREOF: CORED INTERVALS; AND ALL DRILL-STEM TESTS, INCLUDING DEPTH INTERVAL TESTED, CUSHION USED, TIME TOOL OPEN, FLOWING, AND SHUT-IN PRESSURES, AND RECOVERIES				
FORMATION	TOP	BOTTOM	NAME	MEAS. DEPTH
Anhy	1243	1780		
Yates	1780	1948		
7 Rivers	1948	2470		
Queen	2470	2950		
San Andres	2950	4265		
Clarieta	4265	4318		
Yeso	4318	5808		
Tubb	5808	6664		
Abo	6664	7550		
Hueco	7550	8222		
Cisco	8222	8407		
Canyon	8407	8862		
Bond	8862	9960		
Miss	9960	TD		

N. M. OIL CONS. COMMISSION
UNITED STATES P. O. BOX 1980
DEPARTMENT OF THE INTERIOR
BUREAU OF LAND MANAGEMENT
HOBBS, NEW MEXICO 88240FORM APPROVED
OMB NO. 1004-0137
Expires: February 28, 1995

1. PAGE DESIGNATION AND SERIAL NO.

NM-15016

2. IF INDIAN, ALLOTTEE OR TRIBE NAME

3. UNIT ACCESSION NAME

4. FARM OR LEASE NAME, WELL NO.

Wattam Federal

5. API WELL NO.

6

6. FIELD AND POOL OR WILDCAT

Cato

7. SEC., T., R., M., OR BLOCK AND SURVEY OR AREA

Section 7, T8S, R31E

8. COUNTY OR
PARISH
Chaves9. STATE
NM

WELL COMPLETION OR RECOMPLETION REPORT AND LOG *

10. TYPE OF WELL: OIL ☒ GAS ☐ DRY ☐ Other11. TYPE OF COMPLETION: NEW WELL ☐ WORK OVER ☐ REPAIR ☒ PLUG BACK ☐ DIFF. GRAVE ☐ Other Horizontal

12. NAME OF OPERATOR

Petroleum Development Corporation

13. ADDRESS AND TELEPHONE NO.

9720-B Candelaria NE, Albuquerque, NM 87112

14. LOCATION OF WELL (Report location clearly and in accordance with any State requirements):

At surface 643' FNL, 782' FEL

At top prod. interval reported below 699.6' FNL, 902.6' FEL

At total depth 1096.6' FNL, 2448.8' FEL

15. PERMIT NO.

DATE ISSUED

16. DATE RECORDED 3/20/94 17. DATE T.D. REACHED 3/24/94 18. DATE COMPL. (Ready to prod.) 5/20/94 19. ELEVATIONS (OF, RKB, BT, GS, ETC.) 4208' GR 20. ELEV. CASINGHEAD 4209'

21. TOTAL DEPTH, MD & TVD 5371'-3721.1' 22. PLUG BACK T.D. MD & TVD 23. IF MULTIPLE COMPL., HOW MANY 24. INTERVALS DRILLED BY 25. ROTARY TOOLS ALL 26. CABLE TOOLS

27. PRODUCING INTERVAL(S), OF THIS COMPLETION—TOP, BOTTOM, NAME (MD AND TVD)*

MD 3773'-5371'. TVD 3708.9' - 3721.1'

28. WAS DIRECTIONAL SURVEY MADE

Yes

29. TYPE ELECTRIC AND OTHER LOGS RUN

30. WAS WELL COBED
No

31. CASING RECORD				32. CEMENTING RECORD	
CASING SIZE/GRADE	WEIGHT, LB./FT.	DEPTH SET (MD)	HOLES IN CASING	AMOUNT OF CEMENT, CEMENTING RECORD	AMOUNT PULLED
Existing Casing					

33. LINER RECORD				34. TUBING RECORD		
SIZE	TOP (MD)	BOTTOM (MD)	SACKS CEMENT*	SCREEN (MD)	SIZE	DEPTH SET (MD) (PACKER SET (MD))
					2-7/8"	3500'

35. PERFORATION RECORD (Interval, size and number)

Open Hole - MD 3773'-5371'
TVD 3708.9'-3721.1'

36. ACID, SHOT, FRACTURE, CEMENT SQUEEZE, ETC.

37. DEPTH INTERVAL (MD) 3773'-5371' 38. AMOUNT AND KIND OF MATERIAL USED 15,000 gal. 15% NEFE acid

39. PRODUCTION							
DATE FIRST PRODUCTION		PRODUCTION METHOD (Flowing, gas lift, pumping—size and type of pump)				WELL STATUS (Producing or shut-in)	
5/10/94		Pumping				Producing	
DATE OF TEST	HOURS TESTED	CHOKER SIZE	PROD. FOR TEST PERIOD	OIL—BBL	GAS—MCF	WATER—BBL	GAS-OIL RATIO
6/5/94	24			20	20	400	1000
FLOW, TUBING PRESS.	CASING PRESSURE	CALCULATED 24-HOUR RATE	OIL—BBL	GAS—MCF	WATER—BBL	OIL GRAVITY—API (CORR.)	
			20	20	400	23.8	

40. DISPOSITION OF GAS (Sold, used for fuel, vented, etc.)

Vent

41. LIST OF ATTACHMENTS

Directional Surveys

42. I hereby certify that the foregoing and attached information is complete and correct as determined from all available records

SIGNED J. E. Johnson

TITLE

President

ACCEPTED FOR RECORD
PETER W. CHESTER
SEP 22 1995

JOHNSON

DATE 9/14/95

*(See Instructions and Spaces for Additional Data on Reverse Side)

Title 16 U.S.C. Section 1001, makes it a crime for any person knowingly and willfully to make to any department or agency of the United States any false, fictitious or fraudulent statements or representations as to any matter within its jurisdiction.

UNITED STATES
DEPARTMENT OF THE INTERIOR
BUREAU OF LAND MANAGEMENT

SUBMIT IN TRIPPLICATE
N. M. ONE-CONV. COMMISSION
P.O. BOX 1980
HOBBS, NEW MEXICO 88240

Form approved.
Budget Bureau No. 1004-0136
Expires December 31, 1988

APPLICATION FOR PERMIT TO DRILL, DEEPEN, OR PLUG BACK

1a. TYPE OF WORK

DRILL ☒ Re-entry DEEPEN ☐ PLUG BACK ☐

b. TYPE OF WELL Horizontal lateral from milled section in 5 1/2" casing
OIL WELL ☒ GAS WELL ☐ OTHER ☐
SINGLE ZONE ☒ MULTIPLE ZONE ☐

2. NAME OF OPERATOR

Petroleum Development Corporation

3. ADDRESS OF OPERATOR

9720-B Candelaria NE, Albuquerque, NM 87112

4. LOCATION OF WELL Report location clearly and in accordance with any State requirements.

At surface 660' FNL & 660' FEL, Section 7, T8S, R31E
At proposed prod. zone 292' Unit A

14. DISTANCE IN MILES AND DIRECTION FROM NEAREST TOWN OR POST OFFICE

15. DISTANCE FROM PROPOSED

LOCATION TO NEAREST
PROPERTY OR LEASE LINE, FT.
(Also to nearest drlg. unit line, if any)

660'

660'

18. DISTANCE FROM PROPOSED LOCATION
TO NEAREST WELL, DRILLING, COMPLETED,
OR APPLIED FOR, ON THIS LEASE, FT.

2952'

16. NO. OF ACRES IN LEASE

2280.9

19. PROPOSED DEPTH

3752'

17. NO. OF ACRES ASSIGNED
TO THIS WELL

40

20. ROTARY OR CABLE TOOLS

Horizontal Articulated Down
Hole Motor

21. ELEVATIONS (Show whether DF, RT, GR, etc.)

4208' GR

22. APPROX. DATE WORK WILL START

9/15/93

PROPOSED CASING AND CEMENTING PROGRAM

SIZE OF HOLE	SIZE OF CASING	WEIGHT PER FOOT	SETTING DEPTH	QUANTITY OF CEMENT
Existing Casing				

ALL OPERATIONS WILL BE CONDUCTED USING COMPLETION RIG.

1. Drill cement plugs @ surface to 400', 1178' to 1371', 3500' to 3546'. Drill the cast iron bridge plug @ 3546'.

2. Cement squeeze perforations at 3642' to 3794'.

3. Drill out cement to 3696'.

4. Mill casing from 3620' to 3670'.

5. Drill horizontal hole through the vertical depth 3708' to 3752' in a direction of our choice, however, the end of the lateral will be maintained 100' from the lease line.

A 24' x 60' x 6' working pit will be built & lined w/plastic on the original reserve pit site w/1/2 pit volume below actual ground level.

IN ABOVE SPACE DESCRIBE PROPOSED PROGRAM: If proposal is to deepen or plug back, give data on present productive zone and proposed new productive zone. If proposal is to drill or deepen directionally, give pertinent data on subsurface locations and measured and true vertical depths. Give blowout preventer program, if any.

SIGNED

J. C. Johnson

TITLE

President

DATE

8/18/93

(This space for Federal or State office use)

PERMIT NO.

APPROVAL DATE

APPROVED BY

David Stout

Asst. Area Manager

DATE

9/28/93

APPROVAL OF THIS APPLICATION DOES NOT WARRANT OR CERTIFY THAT THE APPLICANT HOLDS LEGAL OR EQUITABLE TITLE TO THOSE RIGHTS IN THE SUBJECT LEASE WHICH WOULD ENTITLE THE APPLICANT TO CONDUCT OPERATIONS THEREON.

PLEASE BE ADVISED THAT THERE WILL BE NO EXCAVATION OF FEDERALLY OWNED MINERAL MATERIAL FOR CONSTRUCTION OF THE ACCESS ROAD OR PAD WITHOUT PAYMENT IN ADVANCE.

United States any false, fictitious or fraudulent statements or representations as to any matter within its jurisdiction.

BECHFIELD

DRILLING SERVICES

PETROLEUM DEVELOPMENT
VAITEM FEDERAL NO. 6
CHAVES COUNTY, NEW MEXICO

8000 1st Avenue SW, P.O. Box 524-183
Albuquerque, NM 87103 Phone (505) 262-4700

P.O. Box 524-183
Albuquerque, NM 87103 Phone (505) 262-4700

Date: 3/16/94

Drawn By: DBG

HORIZONTAL PROJECTION



The Surface Location
is shown as a reference
by the dashed line to
the North arrow.

Surface Area: 100' x 100'

Horizontal Projection
The Surface Location
is shown as a reference
by the dashed line to
the North arrow.
The Surface Area is 100' x 100'.

Horizontal Projection
The Surface Location
is shown as a reference
by the dashed line to
the North arrow.
The Surface Area is 100' x 100'.

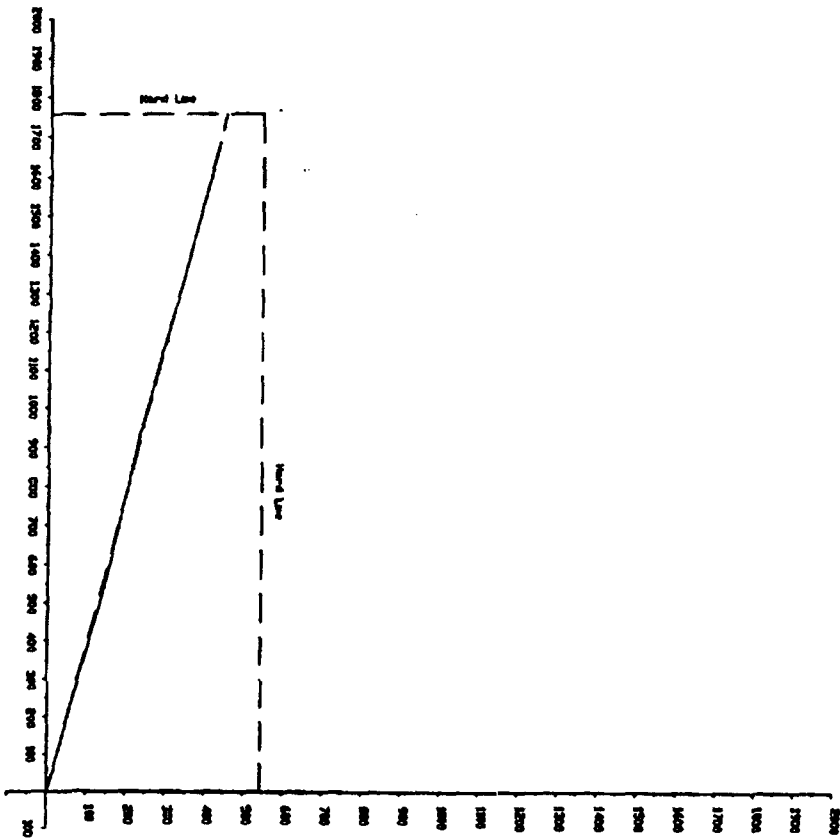
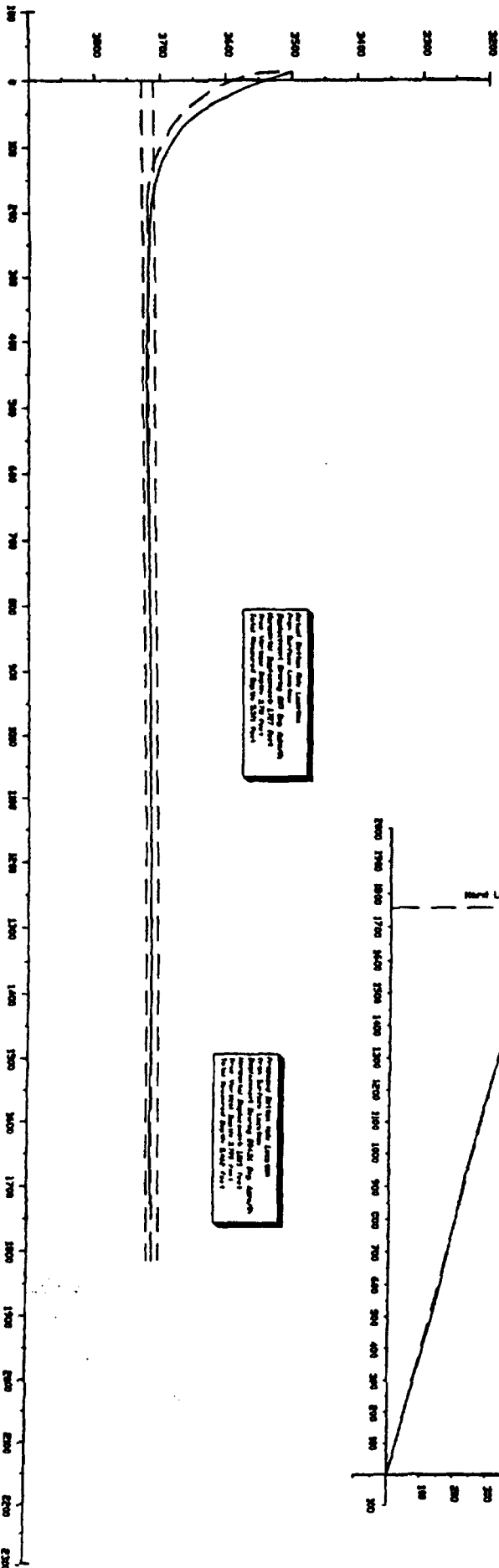

ip
B

STATE OF NEW MEXICO
ENERGY, MINERALS, AND NATURAL RESOURCES DEPARTMENT
OIL CONSERVATION DIVISION

IN THE MATTER OF THE HEARING
CALLED BY THE OIL CONSERVATION
DIVISION FOR THE PURPOSE OF
CONSIDERING:

CASE NO. 10821
Order No. R-9972

APPLICATION OF PETROLEUM DEVELOPMENT COMPANY FOR A SHORT
RADIUS HORIZONTAL DIRECTIONAL DRILLING PROJECT AREA AND
SPECIAL OPERATING RULES THEREFOR, CHAVES COUNTY, NEW MEXICO.

ORDER OF THE DIVISION

BY THE DIVISION:

This cause came on for hearing at 8:15 a.m. on September 9, 1993, at Santa Fe, New Mexico, before Examiner David R. Catanach.

NOW, on this 22nd day of September, 1993, the Division Director, having considered the testimony, the record, and the recommendations of the Examiner, and being fully advised in the premises,

FINDS THAT:

- (1) Due public notice having been given as required by law, the Division has jurisdiction of this cause and the subject matter thereof.
- (2) Division Case Nos. 10818, 10819, 10820 and 10821 were consolidated at the time of the hearing for the purpose of testimony.
- (3) The applicant, Petroleum Development Company, seeks authority to institute a short radius horizontal directional drilling project in the Tom Tom-San Andres Pool on a portion of its Wattam Federal Lease comprising Lots 2, 3 and 4, the E/2, SE/4 NW/4, and the E/2 SW/4 of Section 7 and the S/2 NW/4 and SW/4 of Section 8, Township 8 South, Range 31 East, NMPM, Chaves County, New Mexico, hereinafter referred to as the "project area".
- (4) At the time of the hearing the applicant requested that the proposed project area be contracted to include only the NE/4 of Section 7 and the S/2 NW/4 and N/2 SW/4 of Section 8, Township 8 South, Range 31 East, NMPM.
- (5) Within the project area the applicant seeks authority to:

- a) horizontally drill the existing Wattam Federal Well No. 2 located 1980 feet from the South line and 660 feet from the West line (Unit L) of Section 8, and the plugged and abandoned Exxon Corporation Wattam Federal Well No. 6 located 643 feet from the North line and 782 feet from the East line (Unit A) of Section 7, in a direction and lateral distance to be determined by the applicant;
- b) traverse quarter and quarter-quarter section lines within the project area by either of its proposed horizontal wellbores;
- c) drill the proposed horizontal wellbores to within 100 feet of the outer boundary of the project area; and,
- d) administratively receive an adjustable project allowable based upon the number of standard 40-acre proration units within the project area which are developed or traversed by a horizontal wellbore.

(6) The applicant further seeks the promulgation of special operating rules and procedures within the project area including provisions for administrative authorization of further horizontal wellbores, the formation of non-standard or irregular sized spacing units, and the assignment of special oil allowables.

(7) At the time of the hearing, the applicant requested that its proposal for the establishment of administrative authorization procedures within the project area be dismissed.

(8) The proposed project area is located within the Tom Tom-San Andres Pool which is currently governed by Statewide Rules and Regulations which require standard 40-acre spacing and proration units with wells to be located no closer than 330 feet from the outer boundary of the spacing unit, a standard oil allowable of 80 barrels of oil per day, and a limiting gas-oil ratio of 2,000 cubic feet of gas per barrel of oil.

(9) Testimony by the applicant indicates that it has successfully horizontally drilled wells in various San Andres Pools in this area.

(10) Division records indicate that the two subject wells are the only wells which have previously developed the Tom Tom-San Andres Pool within the project area.

(11) The applicant now seeks approval to develop the proposed project area with horizontal drilling technology by initially horizontally drilling its Wattam Federal Well Nos. 2 and 6, as described above.

(12) The procedures proposed by the applicant are more flexible and lenient than previously approved by the Division.

(13) According to applicant's testimony, it has tentatively determined that the Wattam Federal Well Nos. 2 and 6 will be drilled in a northeast and southwest direction, respectively, however, the applicant seeks the flexibility to alter the proposed direction of either wellbore in the project area when technological or geological data warrant such alteration.

(14) The applicant further seeks the flexibility to traverse quarter or quarter-quarter section lines within the project area with either of its proposed horizontal wellbores in order to remove unnecessary restrictions on lateral wellbore distances which may restrict applicant's ability to test the limits of horizontal drilling technology.

(15) Horizontal drilling within the project area should result in the recovery of a significant volume of oil and gas which was not recovered by the existing conventional vertical wellbores, thereby preventing waste.

(16) The NE/4 of Section 7 and the S/2 NW/4 and N/2 SW/4 of Section 8 is a single Federal lease which is commonly owned throughout. Approval of the subject application as proposed should not result in the violation of the correlative rights of any interest owner within the project area.

(17) According to applicant's testimony, the proposed 100 foot setback will allow for additional drilling flexibility, however, applicant further testified that it will attempt to maintain a reasonable distance from the outer boundary of the project area within its proposed horizontal wellbores.

(18) Murphy Operating Corporation, Yates Energy Corporation and Yates Petroleum Corporation, the only offset operators to the proposed project, were notified of the application in this case but did not appear in protest.

(19) No other offset operator and/or interest owner appeared at the hearing in opposition to the application.

(20) In the interest of conservation and prevention of waste, the application of Petroleum Development Company for a short radius horizontal directional drilling project within the NE/4 of Section 7 and the S/2 NW/4 and N/2 SW/4 of Section 8 should be approved.

(21) The allowable assigned to the project area should be assigned by the supervisor of the Hobbs district office of the Division and should be based upon the number of standard 40-acre proration units within the project area which are developed or traversed by a horizontal wellbore.

(22) The applicant should be authorized to produce the project allowable from any of the wells within the project area in any proportion.

(23) The applicant should be required to determine the actual location of the kick-off points within each well prior to commencing directional drilling operations. Also, the applicant should be required to conduct a directional survey on the lateral portion of each wellbore during or after completion of drilling operations.

(24) The applicant should notify the supervisor of the Hobbs district office of the Division of the date and time of conductance of any directional surveys in order that the same may be witnessed.

(25) The applicant should be required to submit copies of all directional surveys conducted on the subject well to both the Santa Fe and Hobbs offices of the Division.

IT IS THEREFORE ORDERED THAT:

(1) The applicant, Petroleum Development Company, is hereby authorized to institute a short radius horizontal directional drilling project in the Tom Tom-San Andres Pool on a portion of its Wattam Federal Lease comprising the NE/4 of Section 7 and the S/2 NW/4 and N/2 SW/4 of Section 8, Township 8 South, Range 31 East, NMPM, Chaves County, New Mexico, hereinafter referred to as the "project area".

(2) Within the project area, the applicant is further authorized to horizontally drill the existing Wattam Federal Well No. 2 located 1980 feet from the South line and 660 feet from the West line (Unit L) of Section 8, and the plugged and abandoned Exxon Corporation Wattam Federal Well No. 6 located 643 feet from the North line and 782 feet from the East line (Unit A) of Section 7, in a direction and lateral distance to be determined by the applicant.

(3) The horizontal wellbores may traverse quarter and quarter-quarter section lines within the project area provided that the horizontal or producing portion of each wellbore shall be located no closer than 100 feet from the outer boundary of the project area.

(4) The applicant shall determine the actual location of the kick-off points in each well prior to commencing directional drilling operations. Also, the applicant shall conduct a directional survey on the lateral portion of each wellbore during or after completion of drilling operations.

(5) The applicant shall notify the supervisor of the Hobbs district office of the Division of the date and time of conductance of any directional surveys in order that the same may be witnessed.

(6) The applicant shall submit copies of all directional surveys conducted on the subject well to both the Santa Fe and Hobbs offices of the Division.

(7) The allowable assigned to the project area in the Tom Tom-San Andres Pool shall be assigned by the supervisor of the Division's Hobbs district office and shall be equal to 80 BOPD X the number of standard 40-acre proration units within the project area which are developed or traversed by a horizontal wellbore.

(8) The portion of the application requesting the establishment of administrative authorization procedures within the project area is hereby dismissed.

(9) Jurisdiction is hereby retained for the entry of such further orders as the Division may deem necessary.

DONE at Santa Fe, New Mexico, on the day and year hereinabove designated.

STATE OF NEW MEXICO
OIL CONSERVATION DIVISION

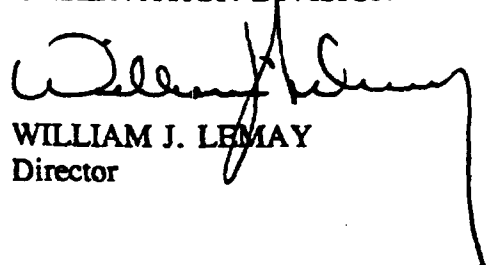
WILLIAM J. LEMAY
Director

S E A L