

CMD :  
OG5SECT

ONGARD  
INQUIRE LAND BY SECTION

Sec : 24 Twp : 22S Rng : 30E Section Type : NORMAL

07/20/05 16:14:36  
OGOMES -TQOM  
PAGE NO: 1

D 40.00 Federal owned U R	C 40.00 Federal owned R	B 40.00 Federal owned R	A 40.00 Federal owned R C C A A
E 40.00 Fee owned U R A	F 40.00 Federal owned R	G 40.00 Federal owned R	H 40.00 Federal owned R C A
L 40.00 Federal owned R	K 40.00 Federal owned R	J 40.00 Federal owned R	I 40.00 Federal owned R C A A
M 40.00 Federal owned R	N 40.00 Federal owned R	O 40.00 Federal owned R	P 40.00 Federal owned R C A A

county Eddy Pool Southeast Quabada Ridge-Delaware

TOWNSHIP 22 South Range 30 East NMPM

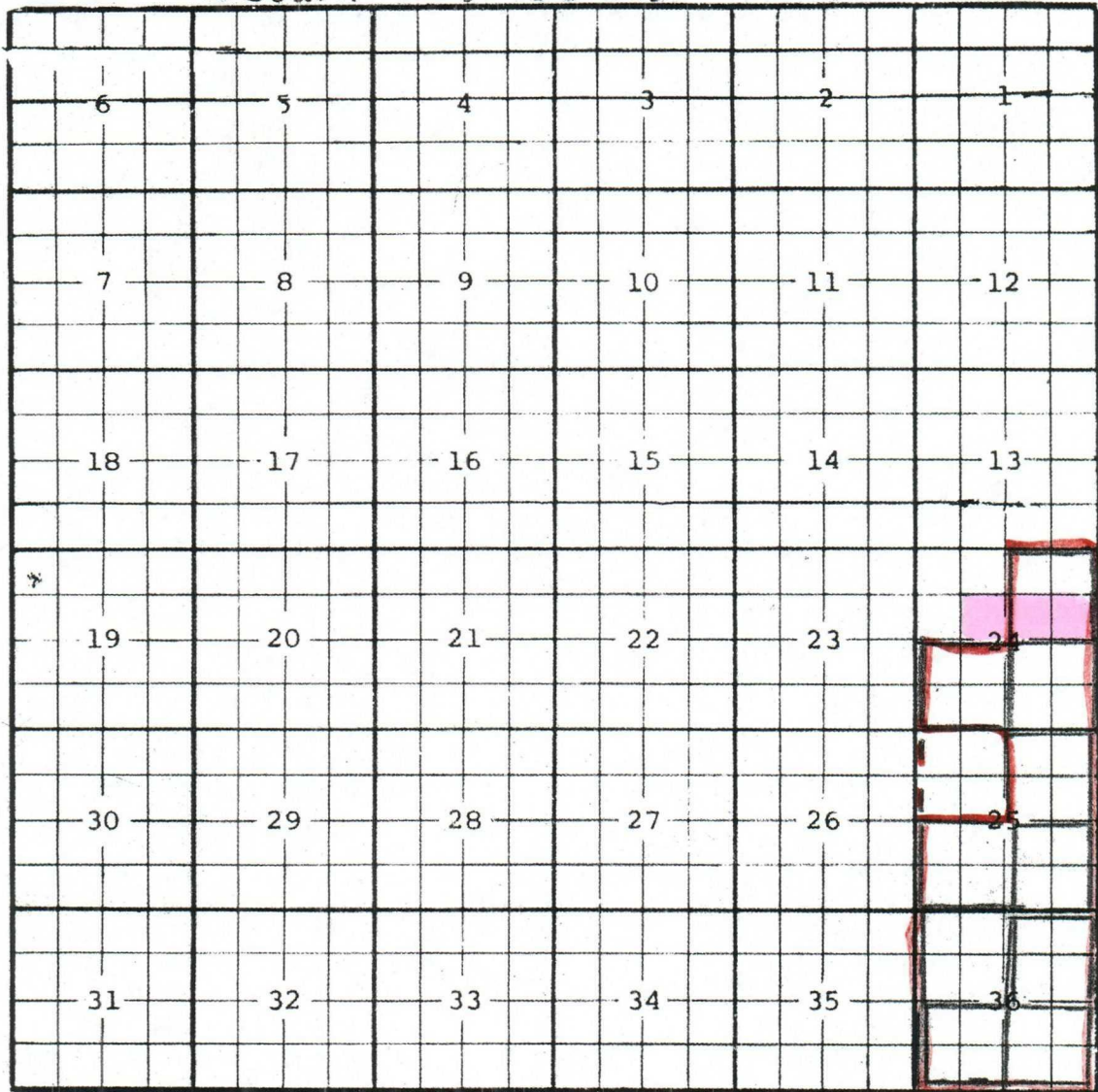

Description:  $\frac{SE}{4}$  Sec. 36 (R-9938, 8-17-93) Ext:  $\frac{SW}{4}$  Sec. 36 (R-10124, 5-31-94)

Ext:  $\frac{NE}{4}$  Sec. 36 (R-10591, 5-8-96) Ext:  $\frac{SE}{4}$  Sec. 25 (R-11005, 7-24-98)

Ext:  $\frac{NW}{4}$  Sec. 25 (R-12066, 12-9-03) Ext:  $\frac{SE}{4}$  Sec. 24 (R-12102, 2-10-04)

Ext:  $\frac{NE}{4}$  Sec. 24 (R-12125, 3-30-04) Ext:  $\frac{SW}{4}$  Sec. 25 (R-12153, 6-7-04)

Ext:  $\frac{NW}{4}$  Sec. 36 (R-12288, 2-23-05) Ext:  $\frac{SW}{4}$  Sec. 24 (R-12357, 5-25-05)





