

CMD :  
OG5SECT

ONGARD  
INQUIRE LAND BY SECTION

07/19/05 10:59:19  
OGOMES -TPOC  
PAGE NO: 1

Sec : 31 Twp : 05S Rng : 22E Section Type : NORMAL

1 39.95 Federal owned	C 40.00 Federal owned	B 40.00 Federal owned	A 40.00 Federal owned
2 39.96 Federal owned	F 40.00 Federal owned	G 40.00 Federal owned	H 40.00 Federal owned
3 39.98 Federal owned	K 40.00 Federal owned	J 40.00 Federal owned	I 40.00 Federal owned
4 39.99 Federal owned	N 40.00 Federal owned	O 40.00 Federal owned	P 40.00 Federal owned
			A

COUNTY Chaves POOL West Pecos Slope-Abo Gas

82740

TOWNSHIP 5 South RANGE 22 East NMPM

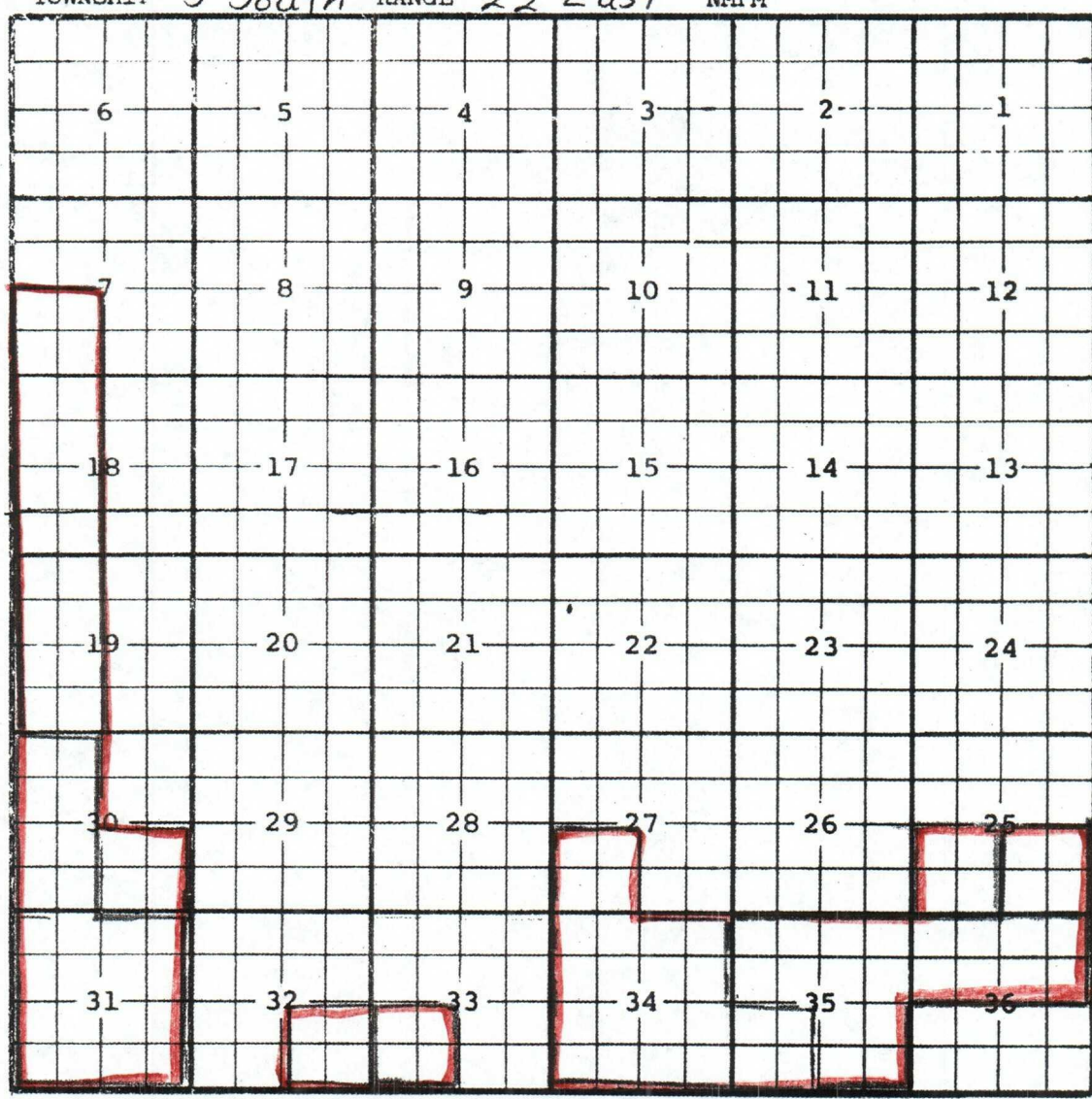

DESCRIPTION: SW/4 SEC 27, SEC 34 (ALL), SW/4 SEC 35 (R-8522, 10/1/87)

EXT: W/2 SEC 30, ALL SEC 31, SW/4 SEC 33 (R-8562 12/4/87) EXT: SE/4 SEC 32 (R-8627, 1/1/88)

EXT: SE/4 sec. 30 (R-8665 6/9/88) EXT: SE/4 sec. 25, NW/4 & E/2 sec. 35.

N/2 sec. 36 (R-8945, 5-31-89) Ext. <sup>5W</sup>/4 sec. 7, <sup>W</sup>/2 sec. 18, <sup>W</sup>/2 sec. 19 (R-10664, 9-16-96)

[illegible]

UNITED STATES  
DEPARTMENT OF THE INTERIOR  
BUREAU OF LAND MANAGEMENT  
Artesia, NM 88210

SUBMIT IN TRIPLICATE

Other Inquiries  
NM Oil Records

Form approved.  
Mission Budget Bureau No. 1004-0136  
Expires August 31, 1985  
LEASE ASSIGNMENT AND CESSID NO.

20-285-63823  
NM-88084  
6. IF INDIAN, ALLOTTEE OR TRIBE NAME  
7. UNIT AGREEMENT NAME  
8. FARM OR LEASE NAME  
Samantha Federal  
9. WELL NO.  
1  
10. FIELD AND POOL, OR WILDCAT  
W. Pecos Slope Abo  
11. SEC., T., R., M., OR BLK.  
AND SURVEY OR AREA  
Sec. 31, T-5S, R-22E  
12. COUNTY OR PARISH  
Chaves  
13. STATE  
NM  
22. APPROX. DATE WORK WILL START  
3-9-92

APPLICATION FOR PERMIT TO DRILL, DEEPEN, OR PLUG BACK

1a. TYPE OF WORK  
DRILL ☒ DEEPEN ☐ PLUG BACK ☐

b. TYPE OF WELL  
OIL WELL ☐ GAS WELL ☒ OTHER ☐  
SINGLE ZONE ☒ MULTIPLE ZONE ☐

2. NAME OF OPERATOR  
McKay Oil Corporation ✓

3. ADDRESS OF OPERATOR  
P.O. Box 2014, Roswell, NM 88202

4. LOCATION OF WELL (Report location clearly and in accordance with any State requirements)  
At surface  
660' FSL - 660' FEL  
At proposed prod. zone  
660' FSL - 660' FEL  
MAR 25 1992  
O.C.D.  
ARTEZIA OFFICE

14. DISTANCE IN MILES AND DIRECTION FROM NEAREST TOWN OR POST OFFICE  
Approximately 26 north of Roswell, NM

15. DISTANCE FROM PROPOSED LOCATION TO NEAREST PROPERTY OR LEASE LINE, FT.  
660'  
(Also to nearest drig. unit line, if any)

16. NO. OF ACRES IN LEASE  
640.0

17. NO. OF ACRES ASSIGNED TO THIS WELL  
160.0

18. DISTANCE FROM PROPOSED LOCATION TO NEAREST WELL, DRILLING, COMPLETED, OR APPLIED FOR, ON THIS LEASE, FT.  
0'

19. PROPOSED DEPTH  
3,400'

20. ROTARY OR CABLE TOOLS  
rotary

21. ELEVATIONS (Show whether DF, RT, GR, etc.)  
4205' GL

23. PROPOSED CASING AND CEMENTING PROGRAM

SIZE OF HOLE	SIZE OF CASING	WEIGHT PER FOOT	SETTING DEPTH	QUANTITY OF CEMENT
12 1/4"	8 5/8"	24 J-55	900+	850 cf cement circulated
7 7/8"	4 1/2"	10.5 J-55	TD	1200 cf cement including
				480 cf to tie in 4 1/2 to 8 5/8" from 1500' to 800'

We propose to drill and test the Abo Formation. Approximately 900' of surface casing will be set and cemented to surface. If commercial, 4 1/2 production casing will be run and cemented with adequate cover, perforated and stimulated as needed for production.

MUD PROGRAM: See Supplemental Drilling Data which is attached.

BOP PROGRAM: BOP will be installed on 8 5/8" casing and tested daily.

Gas is not dedicated.

Post ID-1  
3-37-92  
New line + API

IN ABOVE SPACE DESCRIBE PROPOSED PROGRAM: If proposal is to deepen or plug back, give data on present productive zone and proposed new productive zone. If proposal is to drill or deepen directionally, give pertinent data on subsurface locations and measured and true vertical depths. Give blowout preventer program, if any.

24. SIGNED Sam I. Self TITLE Agent DATE 3-3-92

(This space for Federal or State office use)

PERMIT NO. David Stout APPROVAL DATE 3-24-92

APPROVED BY David Stout TITLE Asst Area Manager DATE 3-24-92

CONDITIONS OF APPROVAL, IF ANY:

PLEASE BE ADVISED THAT THERE WILL BE NO EXCAVATION OF FEDERALLY OWNED MINERAL MATERIAL FOR CONSTRUCTION OF THE ACCESS ROAD OR PAD WITHOUT PAYMENT IN ADVANCE.

APPROVAL OF THIS APPLICATION DOES NOT WARRANT OR CERTIFY THAT THE APPLICANT HOLDS LEGAL OR EQUITABLE TITLE TO THOSE RIGHTS IN THE SUBJECT LEASE WHICH WOULD ENTITLE THE APPLICANT TO CONDUCT OPERATIONS THEREON

Section 1001, makes it a crime for any person knowingly and willfully to make to any department or agency of the United States any false, fictitious or fraudulent statements or representations as to any matter within its jurisdiction.

Submit to Appropriate  
District Office  
State Lease - 4 copies  
Fee Lease - 3 copies

State of New Mexico  
Energy, Minerals and Natural Resources Department

Form C-102  
Revised 1-1-89

OIL CONSERVATION DIVISION

P.O. Box 2088  
Santa Fe, New Mexico 87504-2088

DISTRICT I  
P.O. Box 1980, Hobbs, NM 88240

DISTRICT II  
P.O. Drawer DD, Artesia, NM 88210

DISTRICT III  
1000 Rio Brazos Rd., Aztec, NM 87410

WELL LOCATION AND ACREAGE DEDICATION PLAT

All Distances must be from the outer boundaries of the section

Operator <b>MCKAY OIL CORPORATION</b>			Lease <b>SAMANTHA FEDERAL</b>		Well No. <b>#1</b>
Initial Letter <b>P</b>	Section <b>31</b>	Township <b>5S.</b>	Range <b>22E.</b>	County <b>NMPM</b>	<b>CHAVES</b>
Actual Footage Location of Well: <b>660</b> feet from the <b>SOUTH</b> line and <b>660</b> feet from the <b>EAST</b> line					
Ground level Elev. <b>4205</b>	Producing Formation <b>ABO</b>		Foot <b>W. Pecos Slope Abo</b>		Dedicated Acreage: <b>160.0</b> Acres

- Outline the acreage dedicated to the subject well by colored pencil or hatchure marks on the plat below.
- If more than one lease is dedicated to the well, outline each and identify the ownership thereof (both as to working interest and royalty).
- If more than one lease of different ownership is dedicated to the well, have the interest of all owners been consolidated by communitization, unitization, force pooling, etc.?  
☐ Yes ☐ No If answer is "yes" type of consolidation \_\_\_\_\_  
If answer is "no" list the owners and tract descriptions which have actually been consolidated. (Use reverse side of this form if necessary).  
No allowable will be assigned to the well until all interests have been consolidated (by communitization, unitization, forced-pooling, or otherwise) or until a non-standard unit, eliminating such interest, has been approved by the Division.

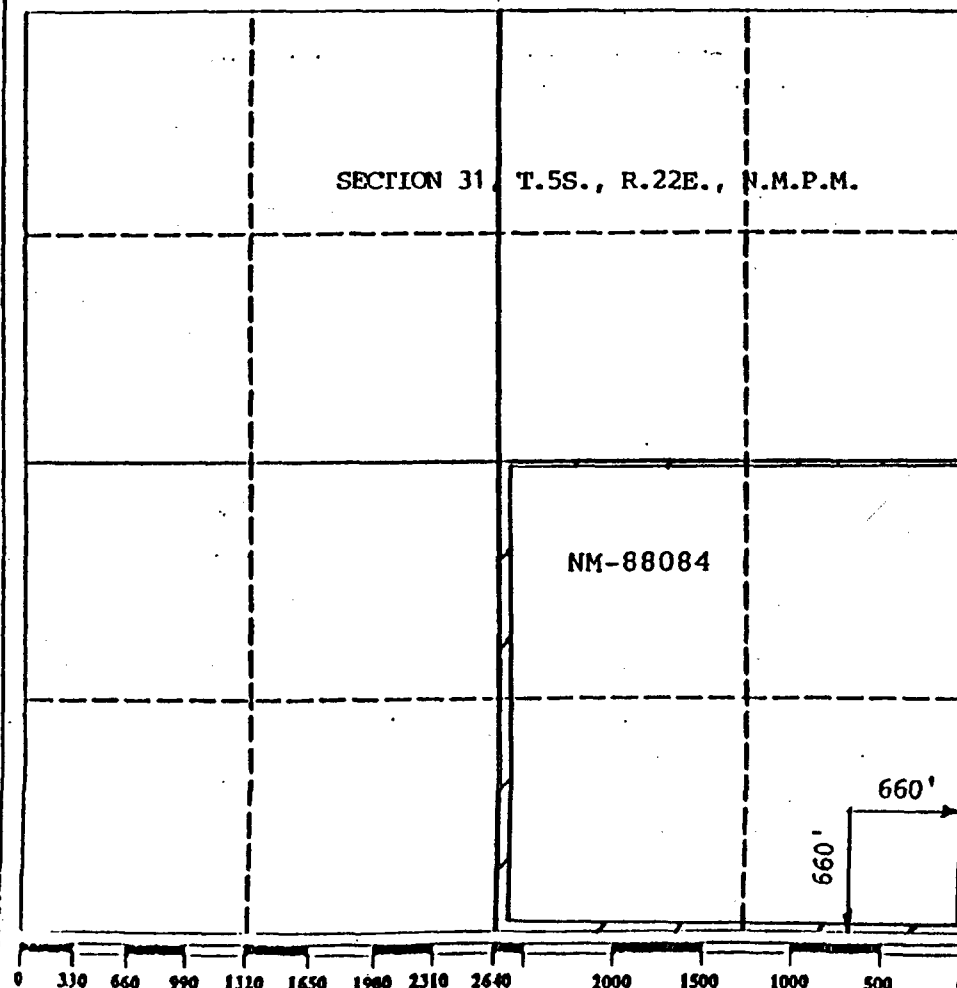

OPERATOR CERTIFICATION

I hereby certify that the information contained herein is true and complete to the best of my knowledge and belief.

Signature  
*Sam L. Shackelford*  
Printed Name  
**Sam L. Shackelford**  
Position  
**Representative**  
Company  
**McKay Oil Corp.**  
Date  
**2-16-92**

SURVEYOR CERTIFICATION

I hereby certify that the well location shown on this plat was plotted from field notes of actual surveys made by me or under my supervision, and that the same is true and correct to the best of my knowledge and belief.

Date Surveyed  
**2/10/92**  
Signature & Seal of  
Professional Surveyor

*John H. Hagan*  
Certificate No.  
**6290**

BK. 62, PG. 59

NM Oil Cons. Commission

Drawer DD

Artesia, NM 88210

UNITED STATES

DEPARTMENT OF THE INTERIOR

BUREAU OF LAND MANAGEMENT

Form 3160-5  
(June 1990)

FORM APPROVED  
Budget Bureau No. 1004-0135  
Expires: March 31, 1993

**SUNDRY NOTICES AND REPORTS ON WELLS**

Do not use this form for proposals to drill or to deepen or reentry to a different reservoir.  
Use "APPLICATION FOR PERMIT—" for such proposals.

**SUBMIT IN TRIPLICATE**

1. Type of Well

☐ Oil Well ☒ Gas Well ☐ Other

2. Name of Operator

McKay Oil Corporation

3. Address and Telephone No.

Post Office Box 2014, Roswell, NM 88201

4. Location of Well (Footage, Sec., T., R., M., or Survey Description)

660' FSL & 660' FEL

RECEIVED

SEP 04 1992

O. C. D.

5. Lease Designation and Serial No.

NM-88084

6. If Indian, Allottee or Tribe Name

7. If Unit or CA, Agreement Designation

8. Well Name and No.

Samantha Federal #1

9. API Well No.

30-005-62893

10. Field and Pool, or Exploratory Area

W. Pecos Slope Abo

11. County or Parish, State

Sec. 31-5S-22E

12. CHECK APPROPRIATE BOX(S) TO INDICATE NATURE OF NOTICE, REPORT, OR OTHER DATA

TYPE OF SUBMISSION

☐ Notice of Intent  
☒ Subsequent Report  
☐ Final Abandonment Notice

TYPE OF ACTION

☐ Abandonment  
☐ Recompletion  
☐ Plugging Back  
☐ Casing Repair  
☐ Altering Casing  
☐ Other Spud & surface csg.  
☐ Change of Plans  
☐ New Construction  
☐ Non-Routine Fracturing  
☐ Water Shut-Off  
☐ Conversion to Injection  
☐ Dispose Water

(Note: Report results of multiple completion on Well Completion or Recompletion Report and Log form.)

13. Describe Proposed or Completed Operations (Clearly state all pertinent details, and give pertinent dates, including estimated date of starting any proposed work. If well is directionally drilled, give subsurface locations and measured and true vertical depths for all markers and zones pertinent to this work.)\*

Spudded well @ 12:35 p.m. on 3-31-92

RIH w/24 jts. 8 5/8" csg., landed csg. @ 1022', shoe jt. 42.83 w/insert float guide shoe, 1 centralizer. RU Halliburton, mix & pump 150 sxs Halliburton Lite w/4% CaCl @ 12.7#/gal 1/2# Celoflakes, tail in w/100 sxs Pre plus w/2% CaCl @ 14.8#/gal, drop plug @ 5:10 p.m. displace w/H2O, landed plug @ 5:28 p.m. Job completed @ 5:29 p.m. WOC 4 hrs. TIH w/1" tbg, tag cmt @ 827'. (see attached)

RIH w/96 jts. 4 1/2", 10.5# used csg., set @ 3122 w/marker jts set @ 2800'. Mix & pump 500 gal mud flush ahead, 250 sxs Premium Plus POZ 65/35, 2.5 salt, 4/10 Halad 322, 1/2 FS, 2% gel 14.2#/gal. Shut down drop plug, displace H2O, landed plug, release PSI-float held. Job completed @ 7:54 p.m. WOC 4 hrs.

14. I hereby certify that the foregoing is true and correct

Signed Theresa Rodriguez

Title Production Analyst

Date 5-13-92

(This space for Federal or State office use)

Approved by

Conditions of approval, if any:

Title

ACCEPTED FOR RECORD  
PETER W. CHESTER  
Date

SEP 1 1992

Title 18 U.S.C. Section 1001, makes it a crime for any person knowingly and willfully to make to any department or agency of the United States any false, fictitious or fraudulent statements or representations as to any matter within its jurisdiction.

\*See Instruction on Reverse Side

OPERATOR : MCKAY OIL CORPORATION  
WELL NAME: SAMANTHA FEDERAL #1  
PROSPECT : Pecos Slope Abo  
ID# : NM-88084  
LOCATION : Sec. 31-5S-22E

PROPOSED TD : 3400'  
PBDT :  
ELEVATION : 4205' g1  
SPUD DATE : 3-30-92  
CONFIDENTIAL:

3-25-92 Valley Const. started work.  
3-26-92 Work on location.  
3-27-92 Work on location.  
3-28-92 Work on location.  
3-29-92 Work on location.  
3-30-92 Depth 21'. Made 21' in 3 hrs., 18" hole, drilling w/air & mist, 80-85 RPM, WOB all, RIH w/1 jt. 13 3/8" csg. RU 4 hrs. Spudded well @ 12:35 p.m. WOC. SION  
3-31-92 Depth 214'. Made 193' in 15 1/4 hrs, drilling w/air & mist, 80-85 RPM, WOB all. Bit 12 1/2 Varrel, F27. Received from Hondo Pipe 26 jts. 1116.30 ft new 8 5/8", 24# csg.  
4-1-92 Depth 814'. Made 600' in 23.5 hrs., drilling w/air & mist, 80-85 RPM, WOB 30000, service rig 1/2 hr. 86 sxs. fresh wtr. gel, 1 sx. caustic, 3 sxs lime. 38 1/2 hrs on bit #1.  
4-2-92 Depth 1039'. Made 225' in 5 3/4 hrs. Drilled w/air & mist, 80-85 RPM, WOB 30,000, TD @ p.m. Circ hole w/250 bbls FWG, Visc. 40, wt 9.8 for 1/2 hr., TOH, RU csg crew & ran 24 jts. 8 5/8" csg landed @ 1022', shoe jt. 42.83 w/insert float guide shoe, 1 centralizer. RU Halliburton, mix & pump 150 sxs Halliburton Lite w/4% CC @ 12.7# gal. 1/2# Celo-flaxes, tail in w/100 sxs Prem + 2% CC @ 14.8# gal. Drop plug @ 5:10 p.m., displace w/H2O, land plug @ 5:28 p.m. Release PSI - float held. Job completed @ 5:29 p.m. WOC 4 hrs., TIH w/1" tbg, tag cmt @ 827'. RU Halliburton to 1" tbg. 1st plug 10:59 p.m. 30 sxs + 4% CC 15.8# /gal, no gain TOC 827', 2nd plug 1:05 a.m. 30 sxs + 4% CC 14.8#/gal 100 gal SF NG TOC 827'. GIH w/5 yds per gravel, no gain. 3rd plug 3:01 a.m. 40 sxs + 4% CC 16#/gal 100 gal SF, gain 49', TOC 778'. 4th plug 3:50 a.m. 30 sxs + 4% CC 16#/gal, 100 gal SF, no gain TOC 778'. RIH w/3 yds pee gravel, gain 15', 5th plug 5:15 a.m. 30 sxs + 4% CC 16#/gal, 100 gal SF, gain 59', TOC 719'. 6th plug 6:07

ACCEPTED FOR RECORD  
PETER W. CHESTER

SEP 1 1992

BUREAU OF LAND MANAGEMENT  
ROSWELL RESOURCE AREA



OPERATOR : MCKAY OIL CORPORATION  
WELL NAME: SAMANTHA FEDERAL #1.  
PROSPECT : Pecos Slope Abo  
ID# : NM-88084  
LOCATION : Sec. 31-55-22E

PROPOSED TD : 3400'  
PBTD :  
ELEVATION : 4205' g1  
SPUD DATE : 3-30-92  
CONFIDENTIAL:

a.m. 30 sxs + 4% CC 16#/gal, no gain, TOC 719'. RIH w/2 yds pee gravel, gain 15'.

4-3-92

7th plug 7:35 a.m. 30 sxs + 4% CC 16#/gal, 100 gal SF, gain 73', TOC 646', 8th plug 8:31 a.m. 30 sxs + 4% CC 16#/gal 100 gal SF, gain 83', TOC 563', 9th plug 9:36 a.m. 30 sxs + 4% CC 16#/gal, 100 gal SF, gain 43', TOC 520'. RIH w/2 yds Pee gravel, gain 15', 10th plug 10:44 a.m. 30 sxs + 4% CC 16#/gal, 100 gal SF, gain 22', TOC 498', RIH w/1.5 yds pee gravel, gain 15', 11th plug 11:59 a.m. 30 sxs + 4% CC 16#/gal 100 gal SF, gain 100', TOC 398', 12th plug 12:58 p.m. 30 sxs + 4% CC 16#/gal, gain 50', TOC 348', 13th plug 12:58 p.m. 30 sxs + 4% CC 16#/gal, gain 57', TOC 291', 14th plug 2:56 p.m. 30 sxs + 4% CC 16#/gal, gain 101', TOC 190', 15th plug 3:53 p.m. 30 sxs + 4% CC 16#/gal, gain 23', TOC 167', GIH w/1.5 yds Pee gravel, gain 15', 16th plug 4:57 p.m. 30 sxs + 4% CC 16#/gal, gain 37', TOC 130', 17th plug 5:47 p.m. 30 sxs + 4% CC 16#/gal, 100 gal SF, 18th plug 30 sxs + 2% CC 16#/gal, circ. cmt. to surface 6 sxs to pit. Job complete @ 6 p.m. Nipple up BOP, test blind rams and manifold, choke 1200# 30 min., OK, TIH w/7 7/8" bit WM, type 52 F, 3-13 jets, drill collars, DP, test pipe rams 1200#, 30 min. OK, drill cmt & insert 2.5 hrs, drilled formation 5 hrs, made 300' 60-65 RPM, WOB 30,000, PP 600#, LS 5 1/2, SPH 58, fresh wtr. depth 1339'.

4-4-92

Depth 2629', made 1290' in 23 3/4 hrs., 60-65 RPM, WOB 30,000, 600 press., liner 5 1/2, strokes 58, native mud, DS 1/2 degree @ 1514, 3/4 degree @ 2015', 1 degree @ 2513'.

4-5-92

Depth 3150', made 521' in 16 hrs., 60-65 RPM, WOB 35,000, press 800, liner 5 1/2, strokes 60, MW 10, VIC. 38, WL 10, PH 10, mix 410 sxs SWG, 140 sxs starch, 6 sxs caustic, 1 sx lime. TD'd @ 11:30 p.m. DS 1 1/4 degree @ 3026', 1 1/4 degree @ 3150', circ 1 hr., short trip, circ 1 1/2hr. TOH, rig up Dresser Atlas to log.

Depth 3150' Dresser Atlas ran CNDL, DLL, Caliper, 6 hrs logging. Rig down Dresser Atlas. TIH w/DP. TOH, lay down DP. RU Csg. crew. Ran 96 jts. 4 1/2" 10.5# used

ACCEPTED FOR RECORD  
PETER W. CHESTER

SEP 1 1992

BUREAU OF LAND MANAGEMENT  
KOSWELL RESOURCE AREA

UNITED STATES  
DEPARTMENT OF THE INTERIOR  
BUREAU OF LAND MANAGEMENT  
Artesia, NM 88210SUBMIT IN DUPLICATE  
NM Oil Conservation Commission  
DDFOR APPROVED  
OMB NO. 1004-0137  
Expires: December 31, 1991

LEASE DESIGNATION AND SERIAL NO.

NM-88084

6. IF INDIAN, ALLOTTEE OR TRIBE NAME

7. UNIT AGREEMENT NAME

8. FARM OR LEASE NAME, WELL NO.

Samantha Federal #1

9. API WELL NO.

30-005-62893

10. FIELD AND POOL, OR WILDCAT

W. Pecos Slope Abo

11. SEC., T., R. M., OR BLOCK AND SURVEY OR AREA

Sec. 31-5S-22E

12. COUNTY OR PARISH

Chaves

13. STATE

NM

## WELL COMPLETION OR RECOMPLETION REPORT AND LOG \*

1a. TYPE OF WELL: OIL WELL ☐ GAS WELL ☒ DRY ☐ Other ☐ RECEIVED

b. TYPE OF COMPLETION:

NEW WELL ☒ WORK OVER ☐ DEEP-EN ☐ PLUG BACK ☐ DIFF. GENVR. ☐ Other ☐ SEP 04 1992

2. NAME OF OPERATOR

McKay Oil Corporation

3. ADDRESS AND TELEPHONE NO.

4. LOCATION OF WELL (Report location clearly and in accordance with any State requirements)\*

At surface

At top prod. interval reported below

At total depth

14. PERMIT NO.

DATE ISSUED

15. DATE SPUDDED 16. DATE T.D. REACHED 17. DATE COMPL. (Ready to prod.) 18. ELEVATIONS (OF, RKB, AT, GS, ETC.)\* 19. ELEV. CASINGHEAD

3/31/92

4/5/92

4/21/92

20. TOTAL DEPTH, MD &amp; TVD 21. PLUG BACK T.D., MD &amp; TVD 22. IF MULTIPLE COMPL., HOW MANY\* 23. INTERVALS DRILLED BY 24. ROTARY TOOLS 25. CABLE TOOLS

3150'

3096'

X

26. PRODUCING INTERVAL(S), OF THIS COMPLETION—TOP, BOTTOM, NAME (MD AND TVD)\*

2908 - 2919

25. WAS DIRECTIONAL SURVEY MADE

Yes

26. TYPE ELECTRIC AND OTHER LOGS RUN

DLL; CND: Perforating Depth Control

27. WAS WELL CORED

No

28. CASING RECORD (Report all strings set in well)

CASING SIZE/GRADE	WEIGHT, LB./FT.	DEPTH SET (MD)	HOLE SIZE	TOP OF CEMENT, CEMENTING RECORD	AMOUNT PULLED
8 5/8"	24"	1022'	18"	150 sx. + 100 sx.	
4 1/2"	10.5#	3122'	7 7/8"	250 sx.	

29. LINER RECORD

SIZE	TOP (MD)	BOTTOM (MD)	BACKS CEMENT*	SCREEN (MD)

30. TUBING RECORD

SIZE	DEPTH SET (MD)	PACKER SET (MD)
2 3/8"	2920'	

31. PERFORATION RECORD (Interval, size and number)

2908 - 2919 (11 2SPF, .375)

32. ACID, SHOT, FRACTURE, CEMENT SQUEEZE, ETC.

DEPTH INTERVAL (MD)	AMOUNT AND KIND OF MATERIAL USED
2908-2919	1500 gals 7 1/2% acid & 44 BS
	35000 gal thix str 30 cont.
	74000# 20/40 frac sd., 15000
	gal thix wtr 30 pad, 2000 gal

33.\* PRODUCTION thix wtr.,

DATE FIRST PRODUCTION		PRODUCTION METHOD (Flowing, gas lift, pumping—size and type of pump)				WELL STATUS (Producing or shut-in)	
5/19/92		Flowing				Producing	
DATE OF TEST	HOURS TESTED	CHOKE SIZE	PROD'N. FOR TEST PERIOD	OIL—BSL.	GAS—MCF.	WATER—BSL.	GAS-OIL RATIO
5/19/92	Flow tst	12/64	→		74		
FLOW, TUBING PRESS.	CASING PRESSURE	CALCULATED 24-HOUR RATE	OIL—BSL.	GAS—MCF.	WATER—BSL.	OIL GRAVITY-API (CORR.)	
18	87	→				ACCEPTED FOR RECORD PETER	

34. DISPOSITION OF GAS (Sold, used for fuel, vented, etc.)

Sold

35. LIST OF ATTACHMENTS

Set of logs listed above; Deviation Survey

36. I hereby certify that the foregoing and attached information is complete and correct as determined from all available records

SIGNED

Theresa Rodriguez

TITLE

Production Analyst

8-13-92

\*(See Instructions and Spaces for Additional Data on Reverse Side)

Title 18 U.S.C. Section 1001, makes it a crime for any person knowingly and willfully to make to any department or agency of the United States any false, fictitious or fraudulent statements or representations as to any matter within its jurisdiction.



7. SUMMARY OF POROUS ZONES: (Show all important zones of porosity and contents thereof; cored intervals; and all drill-stem, tests, including depth interval tested, cushion used, flowing and shut-in pressures, and recoveries):

38. GEOLOGIC MARKERS

FORMATION	TOP	BOTTOM	DESCRIPTION, CONTENTS, ETC.	NAME	TOP	
					MEAS. DEPTH	TRUE VERT. DEPTH
				Abo	2722	

WELL NAME AND NUMBER Samantha Federal No. 1  
LOCATION 660' FSL & 66' FEL, Section 31, T5S, R22E, Chaves County, NM  
OPERATOR Ruffin Exploration Corporation  
DRILLING CONTRACTOR United Drilling, Inc.

The undersigned hereby certifies that he is an authorized representative of the drilling contractor who drilled the above described well and had conducted deviation tests and obtained the following results:

<u>Degrees @ Depth</u>	<u>Degrees @ Depth</u>	<u>Degrees @ Depth</u>
<u>1/4° 514'</u>	<u>                    </u>	<u>                    </u>
<u>1/2° 1039'</u>	<u>                    </u>	<u>                    </u>
<u>1/2° 1514'</u>	<u>                    </u>	<u>                    </u>
<u>3/4° 2015'</u>	<u>                    </u>	<u>                    </u>
<u>1° 2513'</u>	<u>                    </u>	<u>                    </u>
<u>1-1/4° 3026</u>	<u>                    </u>	<u>                    </u>
<u>1-1/4° 3150'</u>	<u>                    </u>	<u>                    </u>
<u>                    </u>	<u>                    </u>	<u>                    </u>

Drilling Contractor United Drilling, Inc.

By: W. M. Gibbs

Title: Business Manager

Subscribed and sworn to before me this 7<sup>th</sup> day of April,  
1992.

Harmon T. [Signature]  
Notary Public

My Commission Expires: 9-25-95 Chaves N.M.  
County State

Submit: 5 Copies  
Appropriate District Office  
DISTRICT I  
P.O. Box 1980, Hobbs, NM 88240

State of New Mexico  
Energy, Minerals and Natural Resources Department

Form C-104  
Revised 1-1-89  
See Instructions  
at Bottom of Page

OIL CONSERVATION DIVISION

P.O. Box 2088  
Santa Fe, New Mexico 87504-2088

NOV 17 1993

DISTRICT II  
P.O. Drawer DD, Artesia, NM 88210

DISTRICT III  
1000 Rio Brazos Rd., Aztec, NM 87410

REQUEST FOR ALLOWABLE AND AUTHORIZATION  
TO TRANSPORT OIL AND NATURAL GAS

Operator McKay Oil Corporation		Well API No. 30-005-62893
Address Post Office Box 2014, Roswell, NM 88201		
Reason(s) for Filing (Check proper box) <input type="checkbox"/> Other (Please explain)		
New Well <input checked="" type="checkbox"/>	Change in Transporter of:	
Recompletion <input type="checkbox"/>	Oil <input type="checkbox"/>	Dry Gas <input type="checkbox"/>
Change in Operator <input type="checkbox"/>	Casinghead Gas <input type="checkbox"/>	Condensate <input type="checkbox"/>
If change of operator give name and address of previous operator		

II. DESCRIPTION OF WELL AND LEASE

Lease Name Samantha Fed	Well No. #1	Pool Name, including Formation W. Pecos Slope Abo	Kind of Lease State, Federal or Fee	Lease No. NM-88084
Location Unit Letter <u>P</u> : <u>660</u> Feet From The <u>South</u> Line and <u>660</u> Feet From The <u>East</u> Line Section <u>31</u> Township <u>5S</u> Range <u>22E</u> , <u>NMPM</u> , Chaves County				

III. DESIGNATION OF TRANSPORTER OF OIL AND NATURAL GAS

Name of Authorized Transporter of Oil <input type="checkbox"/> or Condensate <input type="checkbox"/>	Address (Give address to which approved copy of this form is to be sent)	
Name of Authorized Transporter of Casinghead Gas <input type="checkbox"/> or Dry Gas <input checked="" type="checkbox"/>	Address (Give address to which approved copy of this form is to be sent)	
New Mexico Gas Marketing, Inc.	Post Office Box 2014, Roswell, NM 88201	
If well produces oil or liquids, give location of tanks.	Unit	Sec.
	Twp.	Rge.
	Is gas actually connected?	When ?
	Yes	5-19-92

If this production is commingled with that from any other lease or pool, give commingling order number:

IV. COMPLETION DATA

Designate Type of Completion - (X)	Oil Well	Gas Well	New Well	Workover	Deepen	Plug Back	Same Res'v	Diff Res'v
		X	X					
Date Spudded 3-31-93	Date Compl. Ready to Prod. 4-21-92		Total Depth 3150'		F.B.T.D. 3096'			
Elevations (DF, RKB, RT, GR, etc.)	Name of Producing Formation Abo		Top Oil/Gas Pay		Tubing Depth 2920			
Perforations 2908 - 2919					Depth Casing Shoe			

TUBING, CASING AND CEMENTING RECORD

HOLE SIZE	CASING & TUBING SIZE	DEPTH SET	SACKS CEMENT
18"	8 5/8"	1022'	250 SXS.
7 7/8"	4 1/2"	3122'	250 SXS.

V. TEST DATA AND REQUEST FOR ALLOWABLE

OIL WELL (Test must be after recovery of total volume of load oil and must be equal to or exceed top allowable for this depth or be for full 24 hours.)

Date First New Oil Run To Tank	Date of Test	Producing Method (Flow, pump, gas lift, etc.)	
Length of Test	Tubing Pressure	Casing Pressure	Choke Size
Actual Prod. During Test	Oil - Bbls.	Water - Bbls.	Gas - MCF

GAS WELL

Actual Prod. Test - MCF/D 74	Length of Test flow test	Bbls. Condensate/MMCF	Gravity of Condensate
Testing Method (pilot, back pr.) flow test	Tubing Pressure (Shut-in)	Casing Pressure (Shut-in)	Choke Size

VI. OPERATOR CERTIFICATE OF COMPLIANCE

I hereby certify that the rules and regulations of the Oil Conservation Division have been complied with and that the information given above is true and complete to the best of my knowledge and belief.

Signature Theresa Rodriguez  
Theresa Rodriguez, Production Analyst  
Printed Name  
Date November 4, 1993 Telephone No. 505-623-4735

OIL CONSERVATION DIVISION

Date Approved NOV 30 1993

By ORIGINAL SIGNED BY

DUNE WILLIAMS  
Title SUPERVISOR, DISTRICT II

INSTRUCTIONS: This form is to be filed in compliance with Rule 1104

- 1) Request for allowable for newly drilled or deepened well must be accompanied by tabulation of deviation tests taken in accordance with Rule 111.
- 2) All sections of this form must be filled out for allowable on new and recompleted wells.
- 3) Fill out only Sections I, II, III, and VI for changes of operator, well name or number, transporter, or other such changes.
- 4) Separate Form C-104 must be filed for each pool in multiply completed wells.

PO Box 1960, Hobbs, NM 88241-1960  
District II  
PO Drawer DD, Artesia, NM 88211-9719  
District III  
1000 Rio Bruma Rd., Aztec, NM 87410  
District IV  
PO Box 2088, Santa Fe, NM 87504-2088

Energy, Minerals & Natural Resources Department

OIL CONSERVATION DIVISION  
PO Box 2088  
Santa Fe, NM 87504-2088

Revised February 10, 1994  
Instructions on back  
Submit to Appropriate District Office  
5 Copies

☐ AMENDED REPORT

REQUEST FOR ALLOWABLE AND AUTHORIZATION TO TRANSPORT

Operator name and Address MCKAY OIL CORPORATION Post Office Box 2014 Roswell, NM 88201		OGRID Number 014424
Reason for Filing Code Change in gas transporter Name		
API Number 30 - 005-62893	Pool Name PECOS SLOPE ABO, WEST	Pool Code 82740
Property Code 006709	Property Name SAMANTHA FED	Well Number 1

II. Surface Location

UL or lot no.	Section	Township	Range	Lot Idn	Feet from the	North/South Line	Feet from the	East/West line	County
P	31	56S	22E		660	South	660	East	Chaves

Bottom Hole Location

UL or lot no.	Section	Township	Range	Lot Idn	Feet from the	North/South line	Feet from the	East/West line	County
Lea Code F	Producing Method Code F	Gas Connection Date 5-19-92	C-129 Permit Number	C-129 Effective Date	C-129 Expiration Date				

III. Oil and Gas Transporters

Transporter OGRID	Transporter Name and Address	POD	O/G	POD ULSTR Location and Description
015834	ABO GAS GATHERING Post Office Box 2918 Roswell, NM 88201	1295430	G	

RECEIVED

MAR 31 1995

OIL CON. DIV.  
DIST. 2

IV. Produced Water

POD	POD ULSTR Location and Description

V. Well Completion Data

Spud Date	Ready Date	TD	FBTD	Perforations

VI. Well Test Data

Date New Oil	Gas Delivery Date	Test Date	Test Length	Tbg. Pressure	Csg. Pressure
Choke Size	Oil	Water	Gas	AOF	Test Method

I hereby certify that the rules of the Oil Conservation Division have been complied with and that the information given above is true and complete to the best of my knowledge and belief.

Signature: *Theresa Rodriguez*  
Printed name: Theresa Rodriguez  
Title: Production Analyst  
Date: 3/28/95 Phone: 505-623-4735

OIL CONSERVATION DIVISION  
ORIGINAL SIGNED BY TIM W. GUM  
DISTRICT II SUPERVISOR

Approved by:

Title:

Approval Date:

APR 8 1995

If this is a change of operator fill in the OGRID number and name of the previous operator

Previous Operator Signature	Printed Name	Title	Date

UNITED STATES  
DEPARTMENT OF THE INTERIOR  
BUREAU OF LAND MANAGEMENT

N.M. Oil Cons. Division  
811 S. 1st Str.  
Artesia, NM 88210-2834

FORM APPROVED  
OMB No. 1004-0135  
Expires July 31, 1996

C1517

**SUNDRY NOTICES AND REPORTS ON WELLS**

*Do not use this form for proposals to drill or to re-enter an abandoned well. Use Form 3160-3 (APD) for such proposals.*

**SUBMIT IN TRIPLICATE - Other instructions on reverse side**

1. Type of Well  
☐ Oil Well ☒ Gas Well ☐ Other

2. Name of Operator  
McKay Oil Corporation

3a. Address  
P.O. Box 2014, Roswell, NM 88201

3b. Phone No. (include area code)  
505-623-4735

4. Location of Well (Footage, Sec., T., R., M., or Survey Description)  
660' FSL & 660' FEL SEC.31, T5S, R22E

5. Lease Serial No.  
NM-88084

6. If Indian, Allottee or Tribe Name

7. If Unit or CA/Agreement, Name and/or No.

8. Well Name and No.  
SAMANTHA FED #1

9. API Well No.  
30-005-62893

10. Field and Pool, or Exploratory Area  
W. Pecos Slope Abo

11. County or Parish, State  
Chaves County, New Mexico

**12. CHECK APPROPRIATE BOX(ES) TO INDICATE NATURE OF NOTICE, REPORT, OR OTHER DATA**

TYPE OF SUBMISSION	TYPE OF ACTION			
<input checked="" type="checkbox"/> Notice of Intent	<input type="checkbox"/> Acidize	<input type="checkbox"/> Deepen	<input checked="" type="checkbox"/> Production (Start/Resume)	<input type="checkbox"/> Water Shut-Off
<input type="checkbox"/> Subsequent Report	<input type="checkbox"/> Alter Casing	<input type="checkbox"/> Fracture Treat	<input type="checkbox"/> Reclamation	<input type="checkbox"/> Well Integrity
<input type="checkbox"/> Final Abandonment Notice	<input type="checkbox"/> Casing Repair	<input type="checkbox"/> New Construction	<input type="checkbox"/> Recomplete	<input type="checkbox"/> Other
	<input type="checkbox"/> Change Plans	<input type="checkbox"/> Plug and Abandon	<input type="checkbox"/> Temporarily Abandon	
	<input type="checkbox"/> Convert to Injection	<input type="checkbox"/> Plug Back	<input type="checkbox"/> Water Disposal	

13. Describe Proposed or Completed Operation (clearly state all pertinent details, including estimated starting date of any proposed work and approximate duration thereof. If the proposal is to deepen directionally or recompleate horizontally, give subsurface locations and measured and true vertical depths of all pertinent markers and zones. Attach the Bond under which the work will be performed or provide the Bond No. on file with BLM/BIA. Required subsequent reports shall be filed within 30 days following completion of the involved operations. If the operation results in a multiple completion or recompleation in a new interval, a Form 3160-4 shall be filed once testing has been completed. Final Abandonment Notices shall be filed only after all requirements, including reclamation, have been completed, and the operator has determined that the site is ready for final inspection.)

McKay Oil Corporation plans to replace stolen well equipment and place this well in a producing status.  
McKay Oil Corporation anticipates having this well on line on or before September 15, 1999.

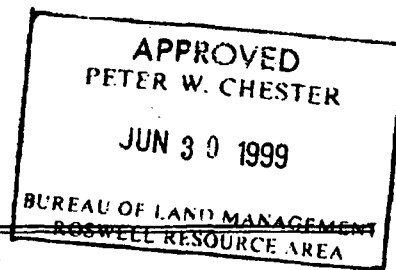
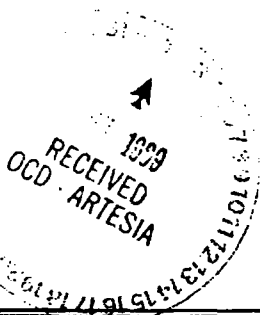

14. I hereby certify that the foregoing is true and correct

Name (Printed/Typed)

Donna L. James

Signature

*Donna L. James*

Title

Production Manager

Date

6-17-99

**THIS SPACE FOR FEDERAL OR STATE OFFICE USE**

Approved by

Title

Date

Conditions of approval, if any, are attached. Approval of this notice does not warrant or certify that the applicant holds legal or equitable title to those rights in the subject lease which would entitle the applicant to conduct operations thereon.

Office

Title 18 U.S.C. Section 1001, makes it a crime for any person knowingly and willfully to make to any department or agency of the United States any false, fictitious or fraudulent statements or representations as to any matter within its jurisdiction.

(Instructions on reverse)