

PARTIAL Print
of work plan

Bratcher, Mike, EMNRD

From: Tavarez, Ike <Ike.Tavarez@tetrattech.com>
Sent: Wednesday, May 01, 2013 9:45 AM
To: Bratcher, Mike, EMNRD; James_Amos@blm.gov
Cc: Robert Grubbs; Joshua Russo; Pat Ellis; Michelle Mullins (MMullins@concho.com)
Subject: COG - Dryland Shiner Federal Tank Battery - Work Plan Approval Request
Attachments: COG - Dryland Federal - Work Plan.pdf

Mike and James,

Please find the enclosed Work Plan for the above reference spill site located in Eddy County, New Mexico. The work plan includes the soil assessment and remedial recommendations for the spill. I will mail you a hard copy of the work plan for your files. Once approved, Tetra Tech will schedule the soil remediation and notify you prior to implementing the work plan. Please let me know if you need additional information or call me if you have any questions

Ike Tavarez, PG | Senior Project Manager

Main: 432.682.4559 | Fax: 432.682.3946 | Cell: 432.425.3878

Ike.Tavarez@tetrattech.com

Tetra Tech | Complex World, Clear Solutions™

1910 North Big Spring | Midland, TX 79705 | www.tetrattech.com

PLEASE NOTE: This message, including any attachments, may include privileged, confidential and/or inside information. Any distribution or use of this communication by anyone other than the intended recipient is strictly prohibited and may be unlawful. If you are not the intended recipient, please notify the sender by replying to this message and then delete it from your system.

SITE INFORMATION

Report Type: Work Plan

General Site Information:

Site:	Dryland Shiner Federal Tank Battery				
Company:	COG Operating LLC				
Section, Township and Range	Unit 1	Sec 3	T21S	R25E	
Lease Number:	API-30-015-32815				
County:	Eddy County				
GPS:	32.51975° N			104.37667° W	
Surface Owner:	Federal				
Mineral Owner:					
Directions:	From Carlsbad at the intersection of Hwy 285 and the George Shoup Relief Route, travel north on Hwy 285 for 6.6 miles. Turn right onto Capitan Reef (CR 30) and travel 0.2 miles, stay right and travel 0.2 miles, turn left and travel 0.1 miles to site.				

Release Data:

Date Released:	7/18/2012
Type Release:	Produced Water
Source of Contamination:	Oil Tanks
Fluid Released:	500 bbls
Fluids Recovered:	480 bbls

Official Communication:

Name:	Pat Ellis	Ike Tavarez
Company:	COG Operating, LLC	Tetra Tech
Address:	One Concho Center 600 W. Illinois Ave.	1910 N. Big Spring
City:	Midland Texas, 79701	Midland, Texas
Phone number:	(432) 686-3023	(432) 682-4559
Fax:	(432) 684-7137	
Email:	pellis@conchoresources.com	ike.tavarez@tetratech.com

Ranking Criteria

Depth to Groundwater:	Ranking Score	Site Data
<50 ft	20	20
50-99 ft	10	
>100 ft.	0	
WellHead Protection:	Ranking Score	Site Data
Water Source <1,000 ft., Private <200 ft.	20	
Water Source >1,000 ft., Private >200 ft.	0	0
Surface Body of Water:	Ranking Score	Site Data
<200 ft.	20	
200 ft - 1,000 ft.	10	
>1,000 ft.	0	0
Total Ranking Score:		20

Acceptable Soil RRAL (mg/kg)		
Benzene	Total BTEX	TPH
10	50	100

Table 1
COG Operating
Dryland Shiner Federal Tank Battery
Eddy County, New Mexico

Sample ID	Sample Date	Sample Depth (ft)	Soil Status		TPH (mg/kg)			Benzene (mg/kg)	Toluene (mg/kg)	Ethlybenzene (mg/kg)	Xylene (mg/kg)	Total BTEX (mg/kg)	Chloride (mg/kg)
			In-Situ	Removed	GRO	DRO	Total						
SB-1	1/16/2013	0-1	X		3,620	135	3,755	<0.200	2.31	<0.200	22.0	24.3	247
	"	2-3	X		2,750	123	2,873	-	-	-	-	-	294
	"	4-5	X		35.8	<50.0	35.8	-	-	-	-	-	168
	"	6-7	X		-	-	-	-	-	-	-	-	32.7
	"	9-10	X		-	-	-	-	-	-	-	-	88.7
SB-2	1/16/2013	0-1	X		<4.00	<50.0	<50.0	<0.0200	<0.0200	<0.0200	<0.0200	<0.0200	1,330
	"	2	X		-	-	-	-	-	-	-	-	462
	"	3	X		-	-	-	-	-	-	-	-	303
	"	4-5	X		-	-	-	-	-	-	-	-	182
	"	6-7	X		-	-	-	-	-	-	-	-	244
SB-3	1/16/2013	0-1	X		<4.00	<50.0	<50.0	<0.0200	<0.0200	<0.0200	<0.0200	<0.0200	315
	"	2	X		-	-	-	-	-	-	-	-	404
	"	3	X		-	-	-	-	-	-	-	-	498
	"	4-5	X		-	-	-	-	-	-	-	-	89.2
	"	6-7	X		-	-	-	-	-	-	-	-	103

(-) Not Analyzed



Proposed Excavated Depths



Surface Scape

* Due to a dense formation, soil borings were installed in place of the trenches (T-1 and T-3)

*T-1 was replaced with SB-1

*T-3 was replaced with SB-2

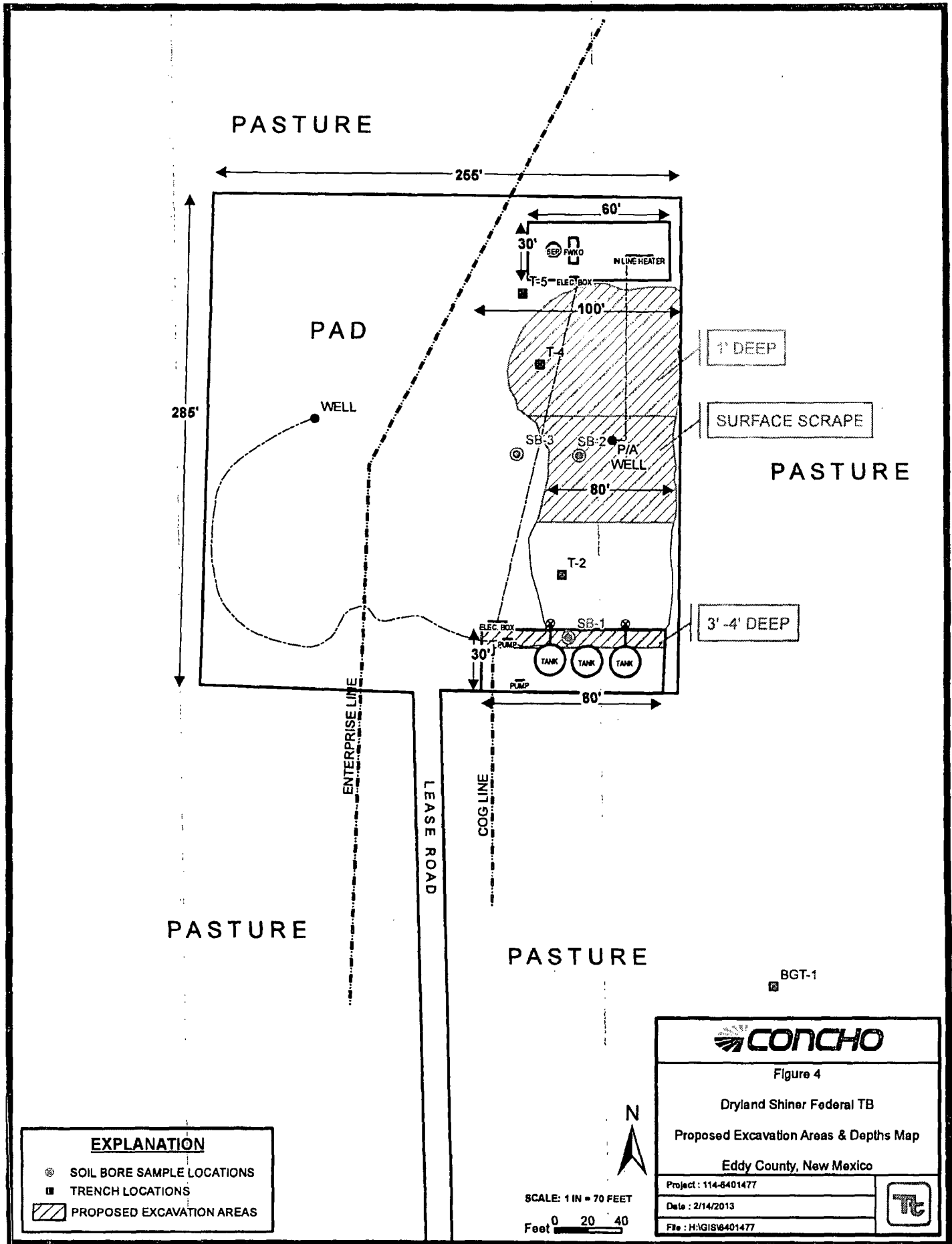

PASTURE

PASTURE

PASTURE

BGT-1



Figure 4

Dryland Shiner Federal TB

Proposed Excavation Areas & Depths Map

Eddy County, New Mexico

Project : 114-8401477

Date : 2/14/2013

File : H:\GIS\8401477



EXPLANATION

- ⊙ SOIL BORE SAMPLE LOCATIONS
- TRENCH LOCATIONS
- ▨ PROPOSED EXCAVATION AREAS

SCALE: 1 IN = 70 FEET

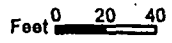

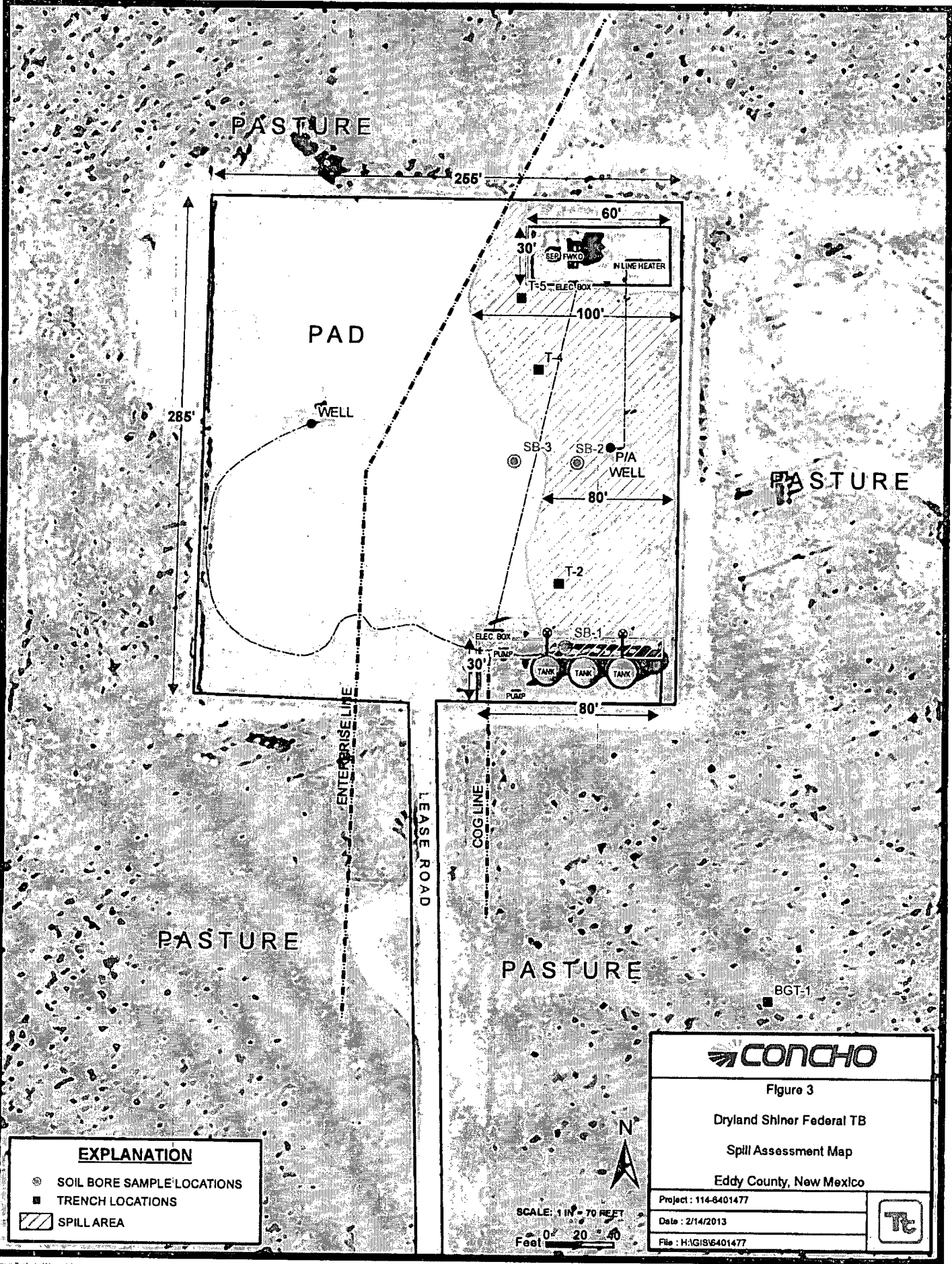

EXPLANATION	
	SOIL BORE SAMPLE LOCATIONS
	TRENCH LOCATIONS
	SPILL AREA

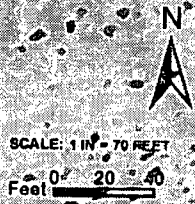

Figure 3	
Dryland Shiner Federal TB	
Spill Assessment Map	
Eddy County, New Mexico	
Project : 114-8401477	
Date : 2/14/2013	
File : HAGIS6401477	

Drawn By: Isabel Marmolejo