

Well Selection Criteria Quick Print

(WH_SEC = 30 and WH_TWPN = 31 and WH_RNGN = 9)

API Well #	Well Name and No.	Operator Name	Typ	Stat	County	Surf	UL	Sec	Twp	Rng	Ft N/S	Ft E/W	UICPrmt	Lst Insp Dt
30-045-26833-00-00	JACQUEZ COM	BP AMERICA PRODUCTION COM	G	A	San Juan	P	A	30	31 N	9	1085 N	790 E		4/26/2005
30-045-10372-00-00	RIDDLE C LS	BP AMERICA PRODUCTION COM	G	A	San Juan	P	A	30	31 N	9	990 N	990 E		4/26/2005
30-045-26853-00-00	BARRETT COM	BP AMERICA PRODUCTION COM	G	A	San Juan	F	C	30	31 N	9	130 N	820 W		4/26/2005
30-045-31037-00-00	BARRETT LS	BP AMERICA PRODUCTION COM	G	A	San Juan	F	C	30	31 N	9	190 N	810 W		4/26/2005
30-045-29773-00-00	BARRETT LS	BP AMERICA PRODUCTION COM	G	A	San Juan	F	F	30	31 N	9	1820 N	840 W		4/26/2005
30-045-31078-00-00	RIDDLE C LS	BP AMERICA PRODUCTION COM	G	A	San Juan	F	G	30	31 N	9	2390 N	1715 E		9/29/2003
30-045-27754-00-00	RIDDLE GAS COM B	BP AMERICA PRODUCTION COM	G	A	San Juan	F	G	30	31 N	9	2380 N	1370 E		9/29/2003
30-045-22451-00-00	RIDDLE C LS	BP AMERICA PRODUCTION COM	G	A	San Juan	F	I	30	31 N	9	1600 S	885 E		9/15/2005
30-045-33336-00-00	RIDDLE C LS	BP AMERICA PRODUCTION COM	G	N	San Juan	F	K	30	31 N	9	2110 S	925 W		
30-045-10279-00-00	RIDDLE C LS	BP AMERICA PRODUCTION COM	G	A	San Juan	F	K	30	31 N	9	1650 S	500 W		
30-045-27790-00-00	PRE-ONGARD WELL	PRE-ONGARD WELL OPERATOR	G	C	San Juan	F	K	30	31 N	9	2120 S	890 W		
30-045-28614-00-00	PRE-ONGARD WELL	PRE-ONGARD WELL OPERATOR	G	C	San Juan	F	K	30	31 N	9	2120 S	890 W		
30-045-26839-00-00	RIDDLE C	BP AMERICA PRODUCTION COM	G	A	San Juan	F	P	30	31 N	9	1175 S	890 E		9/15/2005
30-045-27119-00-00	PRE-ONGARD WELL	PRE-ONGARD WELL OPERATOR	G	C	San Juan	F	P	30	31 N	9	1060 S	900 E		

BEFORE THE OIL CONSERVATION COMMISSION
OF THE STATE OF NEW MEXICO

IN THE MATTER OF THE APPLICATION OF
DELHI OIL CORPORATION, DALLAS, TEXAS
FOR AN ORDER PERMITTING THE COMMUNITIZ-
ING OF SHORT OR NARROW QUARTER-SECTIONS
ON A NORTH-SOUTH BASIS AS THEY MAY LIE
ALONG THE WEST SIDE OF TOWNSHIPS 30 AND
31 NORTH, RANGE 9 WEST, FOR THE PURPOSE
OF CREATING DRILLING UNITS AND ALLOWABLES
APPROXIMATELY CORRESPONDING TO THE
SPACING AND ALLOWABLE REQUIREMENTS OF
ORDER NO. 799 RELATING TO THE BLANCO-
MESAVERDE GAS POOL IN SAN JUAN COUNTY,
NEW MEXICO.

CASE NO. 236
ORDER NO. R-35

ORDER OF THE COMMISSION

BY THE COMMISSION:

This cause came on for hearing at Santa Fe, New Mexico, at 10:00 o'clock A. M., October 24, 1950, before the Oil Conservation Commission of New Mexico, hereinafter referred to as the "Commission".

NOW, on this 1st day of December, 1950, the Commission having before it for consideration the testimony adduced at the hearing of said case and being fully advised in the premises,

FINDS:

A. The extreme western quarter sections of sections 6, 7, 18, 19, 30 and 31 of Townships 30 and 31 north, Range 8 west, NMPM, San Juan County, New Mexico are "narrow" quarter sections comprising approximately 100 acres each.

B. That the sections in question are within or near the areal limits of the Blanco-Mesaverde Pool.

C. That wells drilled upon "narrow" half sections would be entitled to only approximately 200/320 of the allowable assigned to a full 320 acre drilling unit.

D. That waste would result from unnecessary drilling on 200-acre units.

IT IS THEREFORE ORDERED:

1. The following "narrow" quarter sections are hereby unitized as shown below by threes, each three unitized quarter sections of approximately 300 acres each to be a drilling unit for the Mesaverde formation underlying:

W/2 Sec. 6 and NW/4 Sec. 7
SW/4 Sec. 7 and W/2 Sec. 18
W/2 Sec. 19 and NW/4 Sec. 30
SW/4 Sec. 30 and W/2 Sec. 31
W/2 Sec. 19 and NW/4 Sec. 30
SW/4 Sec. 30 and W/2 Sec. 31

for both Townships 30 and 31 north, Range 9 west.

2. (a) Wells which may be located upon these eight unitized drilling units will be located as follows:

All to be not closer than 660 ft. to the outer boundary nor closer to the center than 330 ft. of the quarter section ("narrow") upon which it is located:

SW/4 Sec. 6	for both Townships 30 and 31 North
SW/4 Sec. 18	Range 9 west.
SW/4 Sec. 19	
SW/4 Sec. 30	

(b) All wells upon the east half of the narrow sections to be located in the northeast quarter of the section not closer than 660 feet to the outer boundary nor closer than 330 feet to the center of the quarter section upon which they are located.

3. That no well shall be drilled or completed and no Notice of Intention nor drilling permit shall be approved unless one of the above designated 300 acre units is assigned to the well for allowable and proration purposes.

4. That the allowable for any unit shall in direct proportion of the acreage in the unit to 320, i. e., a 300-acre unit will receive $300/320$ or $15/16$ or 93.75% of a normal unit allowable for 320 acres in Mesaverde pools spaced one well to each half section.

DONE at Santa Fe, New Mexico, on this 1st day of December, 1950.

**STATE OF NEW MEXICO
OIL CONSERVATION COMMISSION**

Signed by: Thomas J. Mabry, Chairman; Guy Shepard, Member; R.R. Spurrier, Secy.

STATE OF NEW MEXICO
ENERGY, MINERALS AND NATURAL RESOURCES DEPARTMENT
OIL CONSERVATION DIVISION

IN THE MATTER OF THE HEARING
CALLED BY THE OIL CONSERVATION
DIVISION FOR THE PURPOSE OF
CONSIDERING:

CASE NO. 10072
ORDER NO. R-9308

*APPLICATION OF AMOCO PRODUCTION
COMPANY FOR A NON-STANDARD GAS
PRORATION UNIT AND AN UNORTHODOX
COAL GAS WELL LOCATION, SAN JUAN
COUNTY, NEW MEXICO*

ORDER OF THE DIVISION

BY THE DIVISION:

This cause came on for hearing at 8:15 a.m. on September 5, 1990, at Santa Fe, New Mexico, before Examiner Michael E. Stogner.

NOW, on this 27th day of September, 1990, the Division Director, having considered the testimony, the record and the recommendations of the Examiner, and being fully advised in the premises,

FINDS THAT:

- (1) Due public notice having been given as required by law, the Division has jurisdiction of this cause and the subject matter thereof.
- (2) At the time of the hearing this case was consolidated with Case Nos. 10070, 10071, 10073 and 10074 for purposes of testimony.
- (3) The applicant, Amoco Production Company, seeks approval of a 309.09-acre non-standard gas spacing and proration unit comprising Lots 7, 8, 9, 10, 15, 16, 17 and 18 (W/2 equivalent) of Section 19 and Lots 6 through 9 (NW/4 equivalent) of Section 30, both in Township 31 North, Range 9 West, NMPM, Basin-Fruitland Coal Gas Pool, San Juan County, New Mexico, to be dedicated to its Barrett Gas Com "A" Well No. 1 to be drilled 1810 feet from the South line and 925 feet from the West line (Unit K) of said Section 19.

(4) At the time of the hearing, it was discovered that the proposed location is standard for said pool and that the unorthodox coal gas well location portion of this application was in error; therefore, the unorthodox location request should be dismissed.

(5) The Basin-Fruitland Coal Gas Pool is spaced on 320 acres pursuant to the Special Rules and Regulations as promulgated by Division Order No. R-8768.

(6) The proposed non-standard gas proration unit is necessitated by a variation in the legal subdivision of the United States Public Land Survey.

(7) The proposed non-standard gas proration unit has previously been approved by Division Order No. R-35 for use in developing gas reserves in the Blanco-Mesaverde Pool, which is also spaced on 320-acre units and has proven to be effective in promoting orderly development in this area.

(8) The entire non-standard proration unit may reasonably be presumed productive of gas from the Basin-Fruitland Coal Gas Pool and the entire non-standard gas proration unit can be efficiently and economically drained and developed by the aforesaid well.

(9) No offset operator or interested party objected to the proposed non-standard gas proration unit.

(10) Approval of the subject application will afford the applicant the opportunity to produce its just and equitable share of the gas in the affected pools, will prevent the economic loss caused by the drilling of unnecessary wells, avoid the augmentation of risk arising from the drilling of an excessive number of wells and will otherwise prevent waste and protect correlative rights.

IT IS THEREFORE ORDERED THAT:

(1) The application of Amoco Production Company for a 309.09-acre non-standard gas spacing and proration unit comprising Lots 7, 8, 9, 10, 15, 16, 17 and 18 (W/2 equivalent) of Section 19 and Lots 6 through 9 (NW/4 equivalent) of Section 30, both in Township 31 North, Range 9 West, NMPM, Basin-Fruitland Coal Gas Pool, San Juan County, New Mexico, is hereby approved.

(2) Said unit shall be dedicated to its Barrett Gas Com "A" Well No. 1 to be drilled at a standard coal gas well location 1810 feet from the South line and 925 feet from the West line (Unit K) of said Section 19.

Case No. 10072
Order No. R-9308
Page No. 3

(3) The unorthodox location portion of this application is hereby dismissed.

(4) Jurisdiction of this cause is retained for the entry of such further orders as the Division may deem necessary.

DONE at Santa Fe, New Mexico, on the day and year hereinabove designated.

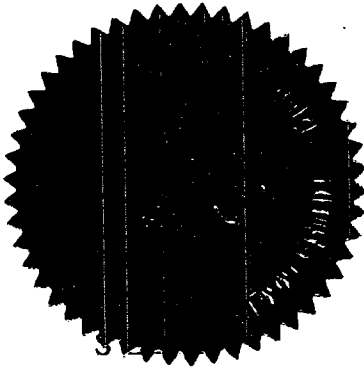

STATE OF NEW MEXICO
OIL CONSERVATION DIVISION

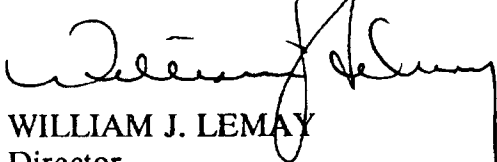
WILLIAM J. LEMAY
Director

UNITED STATES
DEPARTMENT OF THE INTERIOR
BUREAU OF LAND MANAGEMENT

APPLICATION FOR PERMIT TO DRILL, DEEPEN, OR PLUG BACK

1A. TYPE OF WORK

DRILL ☒

DEEPEN ☐

PLUG BACK ☐

B. TYPE OF WELL

OIL
WELL ☐

GAS
WELL ☒

OTHER Coal Seam

SINGLE
ZONE ☒

MULTIPLE
ZONE ☐

2. NAME OF OPERATOR

Amoco Production Company

ATTN: J. L. Hampton

3. ADDRESS OF OPERATOR

P. O. Box 800 Denver, Colorado 80201

4. LOCATION OF WELL (Report location clearly and in accordance with any State requirements.)*

At surface

925' FWL, 1840' FSL NE/SW

At proposed prod. zone

14. DISTANCE IN MILES AND DIRECTION FROM NEAREST TOWN OR POST OFFICE*

12 miles from Aztec, NM

10. DISTANCE FROM PROPOSED*

LOCATION TO NEAREST
PROPERTY OR LEASE LINE, FT.
(Also to nearest drlg. unit line, if any)

925'

16. NO. OF ACRES IN LEASE

2065.97
1160.05

18. DISTANCE FROM PROPOSED LOCATION*

TO NEAREST WELL, DRILLING, COMPLETED,
OR APPLIED FOR, ON THIS LEASE, FT.

19. PROPOSED DEPTH

3468' TD

21. ELEVATIONS (Show whether DF, RT, GR, etc.)

6676' GR

23.

PROPOSED CASING AND CEMENTING PROGRAM DRILLING OPERATIONS AUTHORIZED ARE

SIZE OF HOLE	SIZE OF CASING	WEIGHT PER FOOT	SETTING DEPTH	QUANTITY OF CEMENT
12 1/4"	9 5/8"	36#	250'	200 cf Class B (cement to surface)
8 3/4"	7"	20#	3223'	902 cf Class B (cement to surface)
6 1/4"	5 1/2"	23#	3468' (TD)	None

Notice of Staking was Submitted: 3/13/90

Lease Description:

T31N,R9W:

Sec. 19: Lots 5-20

Sec. 20: Lots 1-16

Sec. 29: Lots 1,2,3,5-12

Sec. 30: Lots 5,6,8-19

RECEIVED
MAY 24 1990
OIL CON. DIV.
DIST. 3

IN ABOVE SPACE DESCRIBE PROPOSED PROGRAM: If proposal is to deepen or plug back, give data on present productive zone and proposed new productive zone. If proposal is to drill or deepen directionally, give pertinent data on subsurface locations and measured and true vertical depths. Give blowout preventer program, if any.

24.

SIGNED

J. L. Hampton/CLB

TITLE Sr. Staff Admin. Supervisor

DATE

3/28/90

(This space for Federal or State office use)

PERMIT NO.

APPROVAL DATE

APPROVED BY

TITLE

DATE

CONDITIONS OF APPROVAL, IF ANY:

Held C-104 FOR USC & NSP
(P) NMOC

*See Instructions On Reverse Side

APPROVED
AS AMENDED
MAY 28 1990
for Shell
AREA MANAGER

UNITED STATES
DEPARTMENT OF THE INTERIOR
BUREAU OF LAND MANAGEMENT

SUBMIT IN DUPLICATE*

(See other In-
structions on
Reverse Side)

Form approved,
Budget Bureau No. 1004-0137
Expires August 31, 1985

WELL COMPLETION OR RECOMPLETION REPORT AND LOG*

1a. TYPE OF WELL:		OIL WELL <input type="checkbox"/>	GAS WELL <input checked="" type="checkbox"/>	DRY <input type="checkbox"/>	Other <u>Coal Seam</u>		
b. TYPE OF COMPLETION:		NEW WELL <input checked="" type="checkbox"/>	WORK OVER <input type="checkbox"/>	DEEP-EN <input type="checkbox"/>	PLUG BACK <input type="checkbox"/>	DIFF. RESER. <input type="checkbox"/>	Other _____
2. NAME OF OPERATOR						7. UNIT AGREEMENT NAME	
Amoco Production Company Attn: John Hampton						Barrett Gas Com "A"	
3. ADDRESS OF OPERATOR						9. WELL NO.	
P.O. Box 800, Denver, Colorado 80201						#1	
4. LOCATION OF WELL (Report location clearly and in accordance with any State requirements)*						10. FIELD AND POOL, OR WILDCAT	
At surface 1810' FSL, 925' FWL, NE/SW						Basin Fruitland Coal Gas	
At top prod. interval reported below						11. SEC. T., R., M., OR BLOCK AND SURVEY OR AREA	
At total depth						Sec 19, T31N R9W	
14. PERMIT NO.				DATE ISSUED			
30-045-27838				5/22/90			
15. DATE SPUDDED		16. DATE T.D. REACHED		17. DATE COMPL. (Ready to prod.)		18. ELEVATIONS (OF, HKB, RT, GR, ETC.)*	
7/10/90		7/13/90		11/14/90		6676' GR	
20. TOTAL DEPTH, MD & TVD		21. PLUG BACK T.D., MD & TVD		22. IF MULTIPLE COMPL., HOW MANY*		23. INTERVALS DRILLED BY	
3660'		3597'				ROTARY TOOLS yes	
24. PRODUCING INTERVAL(S), OF THIS COMPLETION—TOP, BOTTOM, NAME (MD AND TVD)*						25. WAS DIRECTIONAL SURVEY MADE	
3256'-3444' Fruitland Coal						no	
26. TYPE ELECTRIC AND OTHER LOGS RUN						27. WAS WELL CORED	
Mirco density, formation density, Caliper, Microlog						no	
28. CASING RECORD (Report all strings set in well)							
CASING SIZE		WEIGHT, LB./FT.		DEPTH SET (MD)		HOLE SIZE	
9 5/8"		36#		270		12 1/4"	
7"		23#		3219'		8 3/4"	
						65/35 poz, tail w/100sx Cl B howco ideal	
						W/2% CACL2	
29. LINER RECORD				30. TUBING RECORD			
SIZE		TOP (MD)		BOTTOM (MD)		SIZE	
4 1/2"		2877'		3586'		2 3/8"	
				175sx Cl B		3240'	
31. PERFORATION RECORD (Interval, size, and number)				32. ACID, SHOT, FRACTURE, CEMENT SQUEEZE, ETC.			
See Attached				DEPTH INTERVAL (MD)			
				AMOUNT AND KIND OF MATERIAL USED			
				See Attached			
33.* PRODUCTION							
DATE FIRST PRODUCTION		PRODUCTION METHOD (Flowing, gas lift, pumping—size and type of pump)				WELL STATUS (Producing or shut-in)	
10/31/90		Flowing				SI/WO/Pipeline	
DATE OF TEST		HOURS TESTED		CHOKE SIZE		PROD'N. FOR TEST PERIOD	
11/14/90		24		1"		OIL—BBL. 0	
						GAS—MCF. 11	
						WATER—BBL. 0	
						GAS-OIL RATIO	
FLOW, TUBING PRESS.		CASING PRESSURE		CALCULATED 24-HOUR RATE		OIL GRAVITY, API (CORR.)	
60		400		0		11	
34. DISPOSITION OF GAS (Sold, used for fuel, vented, etc.)							
To Be sold							
35. LIST OF ATTACHMENTS							
Perf and Frac info.							
FARMINGTON RESOURCE AREA							
36. I hereby certify that the foregoing and attached information is complete and correct as determined from all available records							
SIGNED		John Hampton		TITLE Sr. Staff Admin. Supv.		DATE 12/4/90	

* (See Instructions and Space for Additional Data on Reverse Side)

37. SUMMARY OF POROUS ZONES: (Show all important zones of porosity and contents thereof; cored intervals; and all drill-stem, tests, including depth interval tested, cushion used, time tool open, flowing and shut-in pressures, and recoveries):					38. GEOLOGIC MARKERS		
FORMATION	TOP	BOTTOM	DESCRIPTION, CONTENTS, ETC.		NAME	MEAS. DEPTH	TRUE VERT. DEPTH
					Fruitland Pictured Cliffs	3206' 3464'	

Perf: 10/17/90

3344'-3355', W/4 JSPPF, .46" diam., 44 shots open.

3381'-3385', W/4 JSPPF, .46" diam., 16 shots open.

3422'-3444', W/4 JSPPF, .46" diam., 44 shots open.

Frac: 10/20/90

Frac down casing with 65500 gal slick water pad, 9100# 40/70 sn,
82900# 20/40 sn, AIR 60 BPM, AIP 1100psi.

Perf: 10/21/90

3256'-3263', W/4 JSPPF, .46" diam., 28 shots open.

3269'-3273', W/4 JSPPF, .46" diam., 16 shots open.

3282'-3285', W/4 JSPPF, .46" diam., 12 shots open.

3290'-3309', W/4 JSPPF, .46" diam., 76 shots open.

Frac: 10/22/90 Start frac, blew main hydraulic hose on pad with 28000# 20/40 sn
in formation! Overflush with 100BW.

Frac: 10/23/90

Frac down casing with 83200 gal slick water pad, 11500# 40/70 brady sn,
25500# 20/40 brady sn in 26400 gal slick water, AIR 65.5BPM, AIP 2200psi.

UNITED STATES
DEPARTMENT OF THE INTERIOR
BUREAU OF LAND MANAGEMENT

FORM APPROVED
Budget Bureau No. 1004-1135
Expires September 30, 1990

SUNDRY NOTICES AND REPORTS ON WELLS

Do not use this form for proposals to drill or to deepen or reentry to a different reservoir.
Use "APPLICATION FOR PERMIT—" for such proposals

SUBMIT IN TRIPLICATE

1. Type of Well
☐ Oil Well ☒ Gas Well ☐ Other Coal Seam

2. Name of Operator
Amoco Production Company Attn: John Hampton

3. Address and Telephone No.
P.O. Box 800, Denver, Colorado 80201

4. Location of Well (Footage, Sec., T., R., M., or Survey Description)
1810' FSL, 925' FWL, NE/SW, Sec 19, T21N-R9W

5. Lease Designation and Serial No.
SF-078336B

6. If Indian, Allottee or Tribe Name

7. If Unit or C.A. Agreement Designation

8. Well Name and No.
Barrett Gas Com "A" 1

9. AM Well No.
30 045 27838

10. Field and Pool or Exploratory Area
Basin Fruitland Coal

11. County or Parish, State
San Juan, New Mexico

12. CHECK APPROPRIATE BOX(S) TO INDICATE NATURE OF NOTICE, REPORT, OR OTHER DATA

TYPE OF SUBMISSION

☐ Notice of Intent

☒ Subsequent Report

☐ Final Abandonment Notice

TYPE OF ACTION

☐ Abandonment

☐ Recompletion

☐ Plugging Back

☐ Casing Repair

☐ Altering Casing

☒ Other

☐ Change of Plans

☐ New Construction

☐ Non-Routine Fracturing

☐ Water Shut-Off

☐ Conversion to Injection

Perf and Frac

(Note: Report results of multiple completion on Well Completion or Recompletion Report and Log form.)

13. Describe Proposed or Completed Operations (Clearly state all pertinent details, and give pertinent dates, including estimated date of starting any proposed work. If well is directionally drilled, give subsurface locations and measured and true vertical depths for all markers and zones pertinent to this work.)

Perf: 10/17/90

3344'-3355', W/4 JSPF, .46" diam., 44 shots open.

3381'-3385', W/4 JSPF, .46" diam., 16 shots open.

3422'-3444', W/4 JSPF, .46" diam., 44 shots open.

Frac: 10/20/90

Frac down casing with 65500 gal slick water pad, 9100# 40/70 sn, 82900# 20/40 sn, AIR 60 BPM, AIP 1100psi.

Perf: 10/21/90

3256'-3263', W/4 JSPF, .46" diam., 28 shots open.

3269'-3273', W/4 JSPF, .46" diam., 16 shots open.

3282'-3285', W/4 JSPF, .46" diam., 12 shots open.

3290'-3309', W/4 JSPF, .46" diam., 76 shots open.

Frac: 10/22/90. Start frac, blew main hydraulic hose on pad with 28000# 20/40 sn in formation. Overflush with 100BW.

Frac: 10/23/90

Frac down casing with 83200 gal slick water pad, 11500# 40/70 brady sn, 25500# 20/40 brady sn in 26400 gal slick water, AIR 65.5BPM, AIP 2200psi.

14. I hereby certify that the foregoing is true and correct

Signed

John Hampton

Title Sr. Staff Admin Supv

(This space for Federal or State office use)

ACCEPTED FOR RECORD

JAN 09 1991

Approved by

Conditions of approval, if any:

Title

FARMINGTON RESOURCE AREA

BY

TABULATION OF DEVIATION TESTS

* * AMOCO PRODUCTION COMPANY * *

DEPTH	DEVIATION
155'	.25°
246'	.50°
745'	1.26°
1278'	1.26°
1776'	.76°
2278'	1.00°
2814'	1.00°
3192'	1.50°

RECEIVED
SEP 17 1990
OIL CON. DIV.
DIST. 3

AFFIDAVIT

THIS IS TO CERTIFY that to the best of my knowledge, the above tabulation details the deviation tests taken on AMOCO PRODUCTION COMPANY'S

Barrett Doe Com A#1
1810' FSL, 925' FWL NE/SW
Sec. 19, T31N-R9W
San Juan, N.M.

Signed *Julie A. Victor*
Title *Asst. Staff Asst.*

THE STATE OF COLORADO)
COUNTY OF DENVER) SS.

BEFORE ME, the undersigned authority, on this day personally appeared *Julie A. Victor* known to me to be *Asst. Staff Asst.* for Amoco Production Company and to be the person whose name is subscribed to the above statement, who, being by me duly sworn on oath, states that he has knowledge of the facts stated herein and that said statement is true and correct.

SUBSCRIBED AND SWORN to before me, a Notary Public in and for said County and State this 12 day of September, 19 90.

Julie A. Victor
Notary Public

My Commission Expires: 4-7-94

UNITED STATES
DEPARTMENT OF THE INTERIOR
BUREAU OF LAND MANAGEMENT

SUBMIT IN TRIPLICATE*
(Other instructions on re-
verse side)

Form approved.
Budget Bureau No. 1004-0135
Expires August 31, 1985

5. LEASE DESIGNATION AND SERIAL NO.

SF-078336B

6. IF INDIAN, ALLOTTEE OR TRIBE NAME

7. UNIT AGREEMENT NAME

8. FARM OR LEASE NAME

Barnett Bros. Co. A

9. WELL NO.

1

10. FIELD AND POOL, OR WILDCAT

Basin Foothills & G. L. S. Co.

11. SEC., T., R., M., OR BLK. AND
SURVEY OR AREA

Sec. 17, T31N-R9W

12. COUNTY OR PARISH

San Juan

13. STATE

N.M.

1.

OIL WELL ☐ GAS WELL ☒ OTHER

Coal seam

2. NAME OF OPERATOR

Amoco Production Company ATTN: J.L. HAMPTON

3. ADDRESS OF OPERATOR

P. O. Box 800 Denver, Colorado 80201

4. LOCATION OF WELL (Report location clearly and in accordance with any State requirements.
See also space 17 below.)

At surface

1810' FSL, 925' FWL NE/SW

14. PERMIT NO.

30 045 27838

15. ELEVATIONS (Show whether OF, BT, OR, etc.)

6676' GR

16.

Check Appropriate Box To Indicate Nature of Notice, Report, or Other Data

NOTICE OF INTENTION TO:

TEST WATER SHUT-OFF

FRACURE TREAT

SHOOT OR ACIDIZING

REPAIR WELL

(Other)

REEL OR ALTER CASING

MULTIPLE COMPLETION

ABANDON*

CHANGE PLANS

SUBSEQUENT REPORT OF:

WATER SHUT-OFF

FRACURE TREATMENT

SHOOTING OR ACIDIZING

(Other)

REPAIRING WELL

ALTERING CASING

ABANDONMENT*

(Note: Report results of multiple completion on Well Completion or Recompletion Report and Log form.)

17. DESCRIBE PROPOSED OR COMPLETED OPERATIONS (Clearly state all pertinent details, and give pertinent dates, including estimated date of starting any proposed work. If directionally drilled, give subsurface locations and measured and true vertical depths for all markers and zones pertinent to this work.)

Spud a 12 1/4" surface hole on 7-10-90 at 11:30 hrs. Drilled to 272'.

Set 9 5/8" 36" K-55 LTC surface casing at 270'. Cemented with 180sx class B. Circulated 7.5 BBLs to the surface. Pressure tested casing to 2000 psi. Drilled a 8 3/4" hole to a TD of 3223' on 7-13-90. Set 7" 23" K55 production casing at 3219'. Cemented with 548sx class B, 100sx class B tail. Circulated 3 BBLs good cement to the surface.

Rig Released at 3:15 hrs. on 7-13-90.

Set a 4 1/2" 11.6# K55 liner from 2877' - 3586'. Cement with 175 sx Class B

18. I hereby certify that the foregoing is true and correct

SIGNED

J. L. Hampton/CB

TITLE Sr. Staff Admin. Supv.

DATE

9/12/90

(This space for Federal or State office use)

ACCEPTED FOR RECORD

APPROVED BY

CONDITIONS OF APPROVAL, IF ANY:

TITLE

SEP 26 1990

FARMINGTON RESOURCE AREA

BY

JPT

*See Instructions on Reverse Side

STATE OF NEW MEXICO
ENERGY AND MINERALS DEPARTMENT

OIL CONSERVATION DIVISION
P. O. BOX 2088
SANTA FE, NEW MEXICO 87501

Form C-102
Revised 10-1-78

All distances must be from the outer boundaries of the Section.

Operator Amoco Production Company			Lease Barrett Gas Com /A/		Well No. #1
Unit Letter K	Section 19	Township 31N	Range 9W	County San Juan	
Actual Location of Well: 1810' feet from the South line and 925' feet from the West line					
Ground Level Elev. 5676'	Producing Formation Fruitland Coal	Pool Basin Fruitland Coal Gas		Dedicated Acres: w/2 Sec. 19 NW/4 Sec 30 309.09 Acres	

1. Outline the acreage dedicated to the subject well by colored pencil or hatchure marks on the plat below.
2. If more than one lease is dedicated to the well, outline each and identify the ownership thereof (both as to working interest and royalty).
3. If more than one lease of different ownership is dedicated to the well, have the interests of all owners been consolidated by communitization, unitization, force-pooling, etc?

☐ Yes ☐ No If answer is "yes," type of consolidation _____

If answer is "no," list the owners and tract descriptions which have actually been consolidated. (Use reverse side of this form if necessary.) _____

No allowable will be assigned to the well until all interests have been consolidated (by communitization, unitization, forced-pooling, or otherwise) or until a non-standard unit, eliminating such interests, has been approved by the Division.

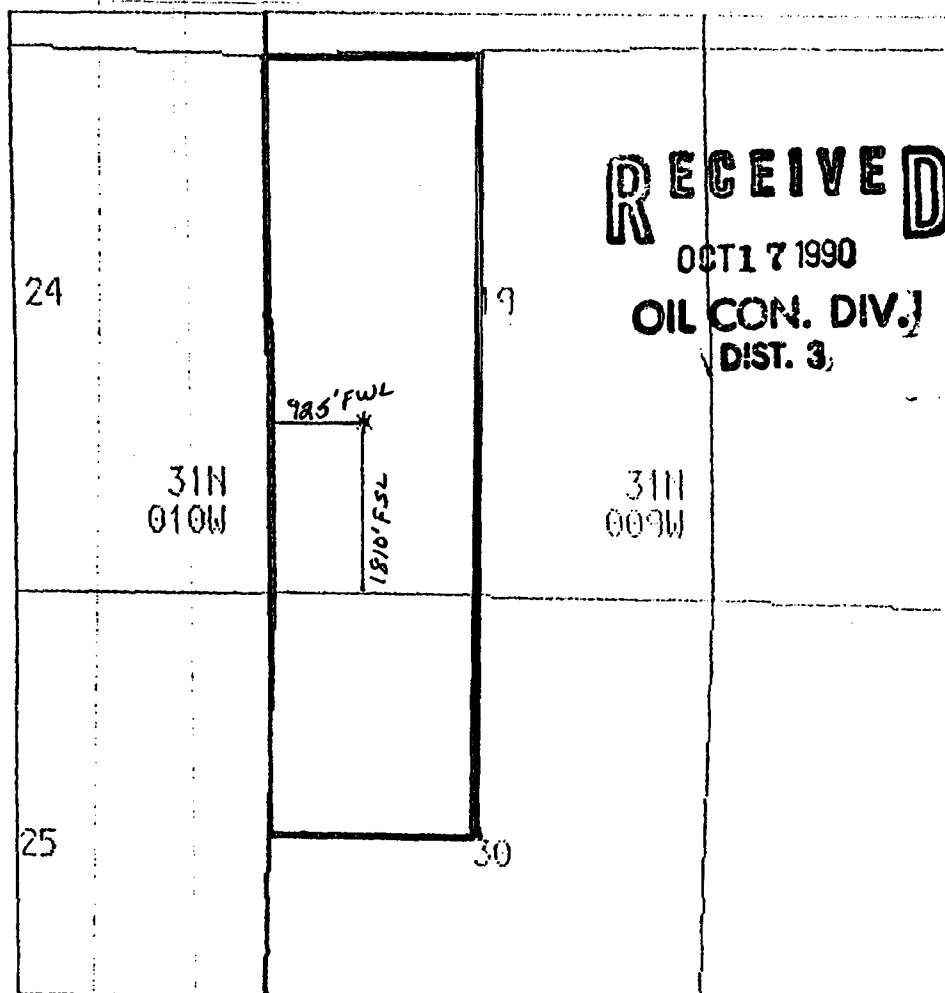

CERTIFICATION

I hereby certify that the information contained herein is true and complete to the best of my knowledge and belief.

John Hampton
Name
John Hampton

Position
Sr. Staff Admin. Supv.

Company
Amoco Production Company

Date
9/26/90

I hereby certify that the well location shown on this plat was plotted from field notes of actual surveys made by me or under my supervision, and that the same is true and correct to the best of my knowledge and belief.

Date Surveyed
"on file"

Registered Professional Engineer
and/or Land Surveyor

Certificate No. *500*

OIL CONSERVATION DIVISION

P.O. Box 2088
Santa Fe, New Mexico 87504-2088

DISTRICT II
P.O. Drawer DD, Artesia, NM 88210

DISTRICT III
1000 Rio Brazos Rd., Aztec, NM 87410

REQUEST FOR ALLOWABLE AND AUTHORIZATION
TO TRANSPORT OIL AND NATURAL GAS

Operator Amoco Production Co.		Well API No. 30-045-27838
Address P. O. Box 800, Denver, CO 80201		
Reason(s) for Filing (Check proper box) <input type="checkbox"/> Other (Please explain)		
New Well <input checked="" type="checkbox"/>	Change in Transporter of:	
Recompletion <input type="checkbox"/>	Oil <input type="checkbox"/>	Dry Gas <input type="checkbox"/>
Change in Operator <input type="checkbox"/>	Casinghead Gas <input type="checkbox"/>	Condensate <input type="checkbox"/>
If change of operator give name and address of previous operator		

II. DESCRIPTION OF WELL AND LEASE

Lease Name Barrett Gas Com A	Well No. 1	Pool Name, Including Formation Basin Fruitland Coal Gas	Kind of Lease State, Federal <input checked="" type="checkbox"/> Other	Lease No. SF-0783368
Location				
Unit Letter K	: 1810'	Feet From The 5 Line and 925'	Feet From The W Line	
Section 19	Township 31N	Range 9W	NMIM, San Juan	County

III. DESIGNATION OF TRANSPORTER OF OIL AND NATURAL GAS

Name of Authorized Transporter of Oil <input type="checkbox"/> or Condensate <input type="checkbox"/>	Address (Give address to which approved copy of this form is to be sent)	
Name of Authorized Transporter of Casinghead Gas <input type="checkbox"/> or Dry Gas <input checked="" type="checkbox"/>	Address (Give address to which approved copy of this form is to be sent)	
Amoco Production Co.	P. O. Box 800, Denver, CO 80201	
If well produces oil or liquids, give location of tanks.	Unit	Sec.
	Twp.	Rge.
Is gas actually connected?	When?	

If this production is commingled with that from any other lease or pool, give commingling order number:

IV. COMPLETION DATA

Designate Type of Completion - (X)	Oil Well <input type="checkbox"/>	Gas Well <input checked="" type="checkbox"/>	New Well <input checked="" type="checkbox"/>	Workover <input type="checkbox"/>	Deepen <input type="checkbox"/>	Plug Back <input type="checkbox"/>	Same Res'v <input type="checkbox"/>	Diff Res'v <input type="checkbox"/>
Date Spudded 7/10/90	Date Compl. Ready to Prod. 11/14/90		Total Depth 3660'		P.B.T.D. 3597'			
Elevations (DF, RKB, RT, GR, etc.) 6676' GR	Name of Producing Formation Fruitland Coal		Top Oil/Gas Pay 3256'		Tubing Depth 3240'			
Perforations See attached						Depth Casing Shoe		
TUBING, CASING AND CEMENTING RECORD								
HOLE SIZE 12-1/4"	CASING & TUBING SIZE 9-5/8"		DEPTH SET 270		SACKS CEMENT 180 SX C1 B Ashgrove			
8-3/4"	7"		3219'		548 SX C1 B			
	2-3/8"		3240'		100 SX C1 B, 65/35 Poz. Tail			

V. TEST DATA AND REQUEST FOR ALLOWABLE

OIL WELL (Test must be after recovery of total volume of load oil and must be equal to or exceed 10% of total volume of load oil in 24 hours.)		
Date First New Oil Run To Tank	Date of Test	Producing Method (Pump, gas lift, etc.)
Length of Test	Tubing Pressure	Casing Pressure
Actual Prod. During Test	Oil - bbls.	Water - bbls.

GAS WELL

Actual Prod. Test - MCF/D 11	Length of Test 24	bbls. Condensate/MCF 0	Gravity of Condensate 0
Testing Method (pitot, back pr.) Flowing	Tubing Pressure (Shut-in) 60	Casing Pressure (Shut-in) 400	Choke Size 1"

VI. OPERATOR CERTIFICATE OF COMPLIANCE

I hereby certify that the rules and regulations of the Oil Conservation Division have been complied with and that the information given above is true and complete to the best of my knowledge and belief.

Signature
D. W. Whaley, Staff Admin. Supervisor
Printed Name
1-31-91
Date
(303) 830-4280
Telephone No.

OIL CONSERVATION DIVISION

Date Approved **MAR 22 1991**

By **Original Signed by FRANK T. CHAVEZ**

Title **SUPERVISOR DISTRICT # 3**

INSTRUCTIONS: This form is to be filed in compliance with Rule 1104

- 1) Request for allowable for newly drilled or deepened well must be accompanied by tabulation of deviation tests taken in accordance with Rule 111.
- 2) All sections of this form must be filled out for allowable on new and recompleted wells.
- 3) Fill out only Sections I, II, III, and VI for changes of operator, well name, number, transporter, or other such changes.
- 4) Separate Form C-104 must be filed for each pool in multiply completed wells.

Barrett Gas
Com A

Perf: 10/17/90

3344'-3355', W/4 JSPPF, .46" diam., 44 shots open.

3381'-3385', W/4 JSPPF, .46" diam., 16 shots open.

3422'-3444', W/4 JSPPF, .46" diam., 44 shots open.

Frac: 10/20/90

Frac down casing with 65500 gal slick water pad, 9100# 40/70 sn,
82900# 20/40 sn, AIR 60 BPM, AIP 1100psi.

Perf: 10/21/90

3256'-3263', W/4 JSPPF, .46" diam., 28 shots open.

3269'-3273', W/4 JSPPF, .46" diam., 16 shots open.

3282'-3285', W/4 JSPPF, .46" diam., 12 shots open.

3290'-3309', W/4 JSPPF, .46" diam., 76 shots open.

Frac: 10/22/90 Start frac, blew main hydraulic hose on pad with 28000# 20/40 sn
in formation! Overflush with 100BW.

Frac: 10/23/90

Frac down casing with 83200 gal slick water pad, 11500# 40/70 brady sn,
25500# 20/40 brady sn in 26400 gal slick water, AIR 65.5BPM, AIP 2200psi.

District I
1625 N. French Dr., Hobbs, NM 88240
District II
1301 W. Grand Avenue, Artesia, NM 88210
District III
1000 Rio Brazos Road, Aztec, NM 87410
District IV
1220 S. St. Francis Dr., Santa Fe, NM 87505

State of New Mexico
Energy Minerals and Natural Resources

Form C-104B
March 19, 2001

Oil Conservation Division
1220 South St. Francis Dr.
Santa Fe, NM 87505

Submit 1 copy of the final affected
wells list along with 1 copy of this form
per number of wells on that list to
appropriate District Office

Change of Operator Name

OGRID: 000778
Effective Date: 12/31/2001

Previous Operator Name and Information:

Name: Amoco Production Company
Address: P.O. Box 3092
Address: _____
City, State, Zip: Houston, Texas 77253

New Operator Name and Information:

New Name: BP America Production Company
Address: P.O. Box 3092
Address: _____
City, State, Zip: Houston, Texas 77253

I hereby certify that the rules of the Oil Conservation Division have been complied with and that the information given on this form and the attached list of wells is true and complete to the best of my knowledge and belief.

Signature: Mary Corley

Printed
name: Mary Corley

Title: Senior Regulatory Specialist

Date: 12/10/2001 Phone: 281-366-4491

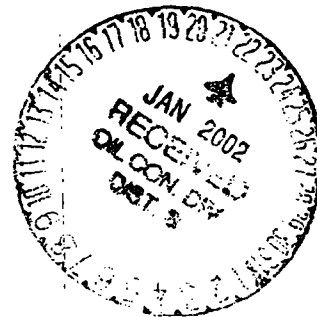

NMOCD Approval

Signature: [Signature]

Printed Name: SUPERVISOR DISTRICT #3

District: JAN 22 2002

Date: _____