

AMEND DHC 6/3/99

2000 POST OAK BOULEVARD / SUITE 100 / HOUSTON, TEXAS 77056-4400

CORPORATION

[713] 296-6000

May 11, 1999

Mr. David Catanach
State of New Mexico
Oil Conservation Division
2040 S. Pacheco
Santa Fe, NM 87505-6429

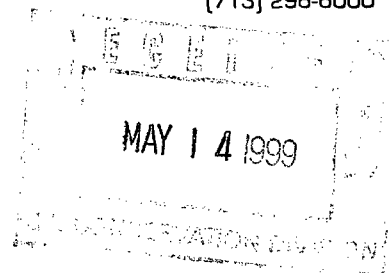

RE: Application to Amend Downhole Commingle Permits
State "C" Tract 12 Well Nos. #3, #4, and #7
State "C" Tract 13 Well No. #5
State "CK" Well No. #3
Eunice Area
Lea County, New Mexico

Dear Sir:

Apache Corporation is proposing to amend the downhole commingling permits on the above five wells. We are requesting to commingle these zones based on the results from our State "C" Tract 13 #6Y. By performing a workover on the existing perfs and adding the Blinbry perfs in our State "C" Tract 12 #6Y, production increased by 50%. Apache expects to have the same response on the above referenced wells. Commingling production will enhance the economic operations of these wells.

Previous studies show that the produced fluids from these zones should be compatible and commingling these fluids should not result in precipitation, which might damage the reservoir. All zones to be commingled in the above referenced wells have common ownership. Apache is basing its allocation percentages on past, current, and anticipated production volumes by using test performed on your State "C" Tract 12 leases, which has test from each zone we asking to commingle (See Attached Allocation Table).

To support our application we have attached the following:

- 1) Forms 107A for each well
- 2) Allocation Percentage Table
- 3) Well Test Reports
- 4) Forms C-102 for each well
- 5) Yearly production and curve for each well
- 6) Map with half-mile radius for each well
- 7) Copy of Letter & Certified notice sent to each Surface owner and Offset Operator.

Should you have any questions about this application, please contact Frances Byers at (713) 296-6361.

Sincerely,
Apache Corporation

Frances M. Byers
Sr. Engineer Tech

Attachments

ALLOCATION PERCENTAGE TABLE

<u>Well Name</u>	<u>Test</u>	<u>Oil %</u>	<u>Gas%</u>
State C Tract 12 #3			
Skelly Penrose	10 BOPD x 3 BWPD x 20 MCFD	36%	26%
Blinebry	1 BOPD x 1 BWPD x 15 MCFD	4%	19%
Tubb	2 BOPD x 1 BWPD x 41 MCFD	7%	53%
Drinkard	15 <u>BOPD x 1 BWPD x 10 MCFD</u>	53%	2%
TOTAL	28 BOPD x 6 BWPD x 78 MCFD		
State C Tract 12 #4			
Paddock	25 BOPD x 87 BWPD x 9 MCFD	35%	27%
Blinebry	11 BOPD x 3 BWPD x 90 MCFD	15%	38%
Tubb	26 BOPD x 3 BWPD x 90 MCFD	37%	38%
Drinkard	9 <u>BOPD x 22 BWPD x 50 MCFD</u>	13%	21%
TOTAL	13 BOPD x 6 BWPD x 151 MCFD		
State C Tract 13 #5			
Blinebry	1 BOPD x 1 BWPD x 78 MCFD	50%	50% 49
Tubb	0 BOPD x 0 BWPD x 44 MCFD	0%	28%
Drinkard	1 <u>BOPD x 2 BWPD x 36 MCFD</u>	50%	22%
TOTAL	2 BOPD x 3 BWPD x 158 MCFD		23
State C Tract 12 #7			
Blinebry	1 BOPD x 1 BWPD x 44 MCFD	14%	42%
Tubb	5 BOPD x 3 BWPD x 40 MCFD	72%	28%
Drinkard	1 <u>BOPD x 1 BWPD x 20 MCFD</u>	14%	20%
TOTAL	7 BOPD x 5 BWPD x 104 MCFD		
State "CK" #3			
Paddock	25 BOPD x 80 BWPD x 9 MCFD	96%	4%
Blinebry	0 BOPD x 0 BWPD x 70 MCFD	0%	35%
Tubb	0 BOPD x 0 BWPD x 53 MCFD	0%	22%
Drinkard	1 <u>BOPD x 2 BWPD x 30 MCFD</u>	4%	39%
TOTAL	26 BOPD x 82 BWPD x 201 MCFD		

DISTRICT I

P.O. Box 1980, Hobbs, NM 88240

DISTRICT II

P.O. Drawer DD, Artesia, NM 88210

DISTRICT III

1000 Rio Brazos Rd., Aztec, NM 87410

State of New Mexico
Energy, Minerals and Natural Resources Department
OIL CONSERVATION DIVISION
2040 S. Pacheco
Santa Fe, New Mexico 87505-6429

Form C-107A
New 3-12-96

APPROVAL PROCESS:☐ Administrative☐ Hearing**EXISTING WELLBORE**☐ Yes ☐ No**APPLICATION FOR DOWNHOLE COMMINGLE****APACHE CORPORATION**

Operator

2000 POST OAK BLVD. STE 100 - RM 358A

Address

HOUSTON, TX 77056-4400**STATE -C- TRACT 13**

Lease

5

Well No.

E - Sec. 36, T21S, R37E

Unit Ltr.-Sec-Twp-Rgn

LEA

County

Spacing Unit Lease Types: (one or more)

☐ Federal☒ State☐ FeeOGRID NO. **000873**Property Code **023114**

API No.

30-025-07051

The following facts are submitted in support of downhole commingling:	Upper Zone	Intermediate Zones	Lower Zone
1. Pool Name and Pool Code	BLINEBRY	TUBB/86440	DRINKARD/60240
2. Top and Bottom of Pay Section (Perforations)	5566' - 5888'		
3. Type of production (Oil or Gas)	GAS & OIL	GAS	GAS & OIL
4. Method of Production (Flowing or Artificial Lift)	AL	AL	FL
5. Bottomhole Pressure	a. (Current) 200	a. 600	a. 600
Oil Zones - Artificial Lift: Estimated Current			
Gas & Oil - Flowing: Measured Current	b. (Original) 200-500	b. 500-600	500-600
All Gas Zones: Estimated or Measured Original			
6. Oil Gravity ("API) or Gas BTU Content	37.7	36.6	37
7. Producing or Shut-In?	PRODUCING	PRODUCING	SI
Production Marginal? (Yes or No)	Y	Y	Y
° If Shut-In, give date and oil/gas/ water rates of last production	Date: 02/02/99 Rates: 1BOPD, 1BWPD, 78 MCFPD	Date: 02/02/99 Rates: 0 BOPD, 0 BWPD, 44 MCFPD	Date: 4/28/99 Rates: (ANTICIPATED BY ST C #7 TEST) 1BOPD, 2 BWPD, 36 MCFPD
Note: For new zones with no production history, applicant shall be required to attach production estimates and supporting data			
° If Producing, give date and oil/gas/ water rates of recent test (within 80 days)	Date: Rates:	Date: Rates:	Date: 07/93 LAST TEST PRIOR ABDN Rates: 9 BOPD, 22 BWPD, 50 MCFPD (DRINK)
8. Fixed Percentage Allocation Formula - % for each zone	Oil: 50% Gas: 50%	Oil: 0% Gas: 28%	Oil: 50% Gas: 22%

9. If allocation formula is based upon something other than current or past production, or is based upon some other method, submit attachments with supporting data and / or explaining method and providing rate projections or other required data.

10. Are all working, overriding and royalty interests identical in all commingled zones?

☒ Yes ☐ No

If not, have all working, overriding and royalty interests been notified by certified mail?

☒ Yes ☐ No

Have all offset operators been given written notice of the proposed downhole commingling?

☒ Yes ☐ No

11. Will cross-flow occur? ☒ Yes ☐ No

If yes, are fluids compatible, will the formations be undamaged, will any cross-flow production be recovered and will the allocation formula be reliable.

☒ Yes ☐ No

(If No, attach explanation)

12. Are all produced fluids from all commingled zones compatible with each other?

☒ Yes ☐ No

13. Will the value of production be decreased by commingling? ☐ Yes ☒ No

(If Yes, attach explanation)

14. If this well is on or communitized with state or federal lands, either the Commissioner of Public Lands or the United States

Bureau of Land Management has been notified in writing of this application.

☒ Yes ☐ No

15. NMOCD Reference Cases for Rule 303(C) Exceptions:

Order No.s **DHC #434****16. ATTACHMENTS:**

- ° C-102 for each zone to be commingled showing its spacing unit and acreage dedication.
- ° Production curve for each zone for at least one year. (If not available, attach explanation.)
- ° For zones with no production history, estimated production rates and supporting data.
- ° Data to support allocation method or formula.
- ° Notification list of all offset operators.
- ° Notification list of working, overriding, and royalty interests for uncommon interest cases.
- ° Any additional statements, data, or documents required to support commingling.

I hereby certify that the information above is true and complete to the best of my knowledge and belief.

SIGNATURE

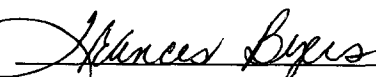
TITLE **Sr. Engineering Tech**DATE **4/28/99**

TYPE OR PRINT NAME

Frances M. Byers

TELEPHONE NO.

(713) 296-6361

Submit to Appropriate
District Office
State Lease - 4 copies
Fee Lease - 3 copies

State of New Mexico
Energy, Minerals and Natural Resources Department

Form C-102
Revised 1-1-89

OIL CONSERVATION DIVISION

P.O. Box 2088
Santa Fe, New Mexico 87504-2088

DISTRICT I
P.O. Box 1980, Hobbs, NM 88240

DISTRICT II
P.O. Drawer DD, Artesia, NM 88210

DISTRICT III
1000 Rio Brazos Rd., Aztec, NM 87410

WELL LOCATION AND ACREAGE DEDICATION PLAT

All Distances must be from the outer boundaries of the section

Operator APACHE CORPORATION		Lease STATE "C" TRACT L@		Well No. 5
Unit Letter E	Section 16	Township 21S	Range 37E	County LEA
Actual Footage Location of Well: 1980' N 660' W				
feet from the line and		feet from the line		
Ground level Elev. 3371 DF	Producing Formation DRINKARD	Pool DRINKARD 60240	Dedicated Acreage: 40 Acres	

1. Outline the acreage dedicated to the subject well by colored pencil or hatchure marks on the plat below.
2. If more than one lease is dedicated to the well, outline each and identify the ownership thereof (both as to working interest and royalty).
3. If more than one lease of different ownership is dedicated to the well, have the interest of all owners been consolidated by communitization, unitization, force-pooling, etc.?
☐ Yes ☐ No If answer is "yes" type of consolidation _____
If answer is "no" list the owners and tract descriptions which have actually been consolidated. (Use reverse side of this form if necessary). _____
No allowable will be assigned to the well until all interests have been consolidated (by communitization, unitization, forced-pooling, or otherwise) or until a non-standard unit, eliminating such interest, has been approved by the Division.

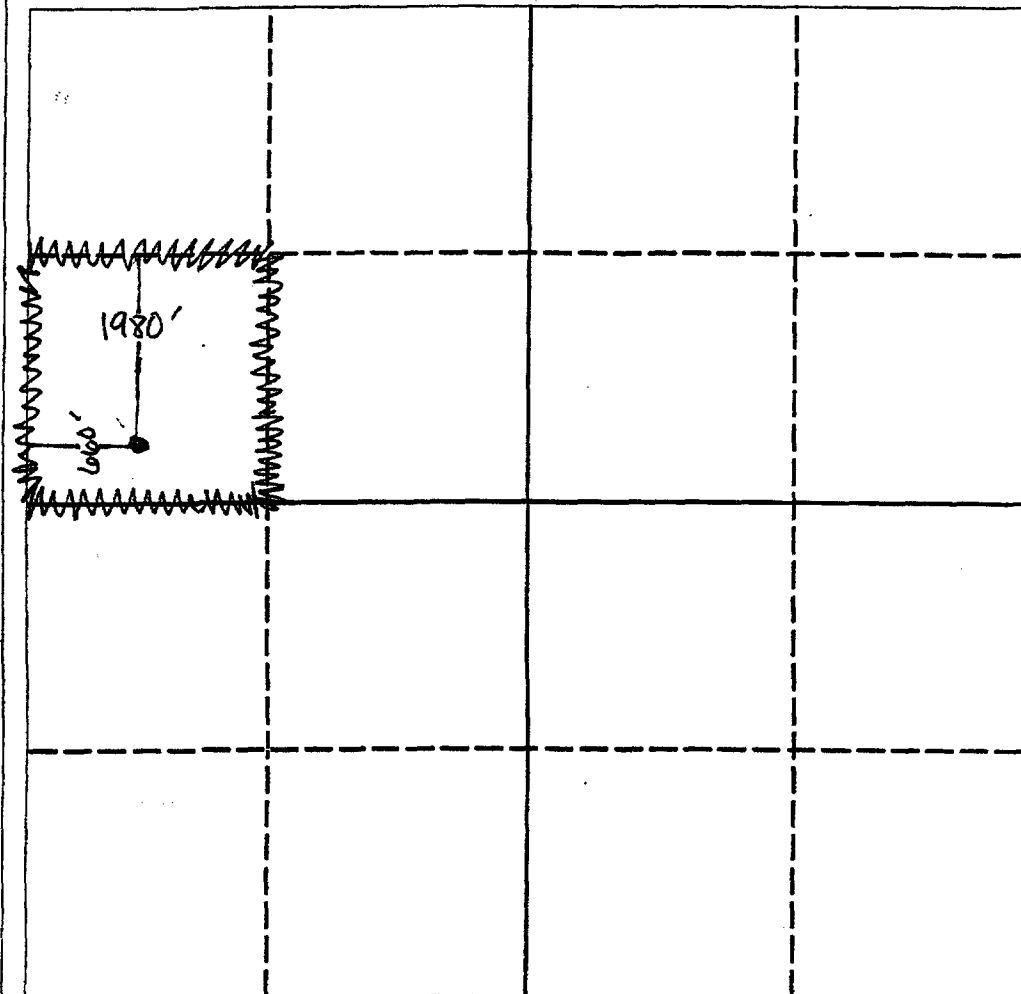

OPERATOR CERTIFICATION

I hereby certify that the information contained herein is true and complete to the best of my knowledge and belief.

Signature *Frances M. Byers*

Printed Name
FRANCES M. BYERS

Position
ENGINEERING TECH

Company

Date

SURVEYOR CERTIFICATION

I hereby certify that the well location shown on this plat was plotted from field notes of actual surveys made by me or under my supervision, and that the same is true and correct to the best of my knowledge and belief.

Date Surveyed

Signature & Seal of
Professional Surveyor

Certificate No.

0 330 660 990 1320 1650 1980 2310 2640 2000 1500 1000 500 0

Submit to Appropriate
District Office
State Lease - 4 copies
Fee Lease - 3 copies

State of New Mexico
Energy, Minerals and Natural Resources Department

Form C-102
Revised 1-1-89

OIL CONSERVATION DIVISION

P.O. Box 2088
Santa Fe, New Mexico 87504-2088

DISTRICT I
P.O. Box 1980, Hobbs, NM 88240

DISTRICT II
P.O. Drawer DD, Artesia, NM 88210

DISTRICT III
1000 Rio Brazos Rd., Aztec, NM 87410

WELL LOCATION AND ACREAGE DEDICATION PLAT

All Distances must be from the outer boundaries of the section

Operator APACHE CORPORATION		Lease STATE "C" TRACT L@		Well No. 5
Unit Letter E	Section 16	Township 21S	Range 37E	County LEA
Actual Footage Location of Well: 1980' N 660' W				
Ground level Elev. 3371 DF		Producing Formation TUBB	Pool TUBB 86440	Dedicated Acreage: 40 Acres

1. Outline the acreage dedicated to the subject well by colored pencil or hatchure marks on the plat below.
2. If more than one lease is dedicated to the well, outline each and identify the ownership thereof (both as to working interest and royalty).
3. If more than one lease of different ownership is dedicated to the well, have the interest of all owners been consolidated by communitization, unitization, force-pooling, etc?
☐ Yes ☐ No If answer is "yes" type of consolidation _____
If answer is "no" list the owners and tract descriptions which have actually been consolidated. (Use reverse side of this form if necessary.)
No allowable will be assigned to the well until all interests have been consolidated (by communitization, unitization, forced-pooling, or otherwise) or until a non-standard unit, eliminating such interest, has been approved by the Division.

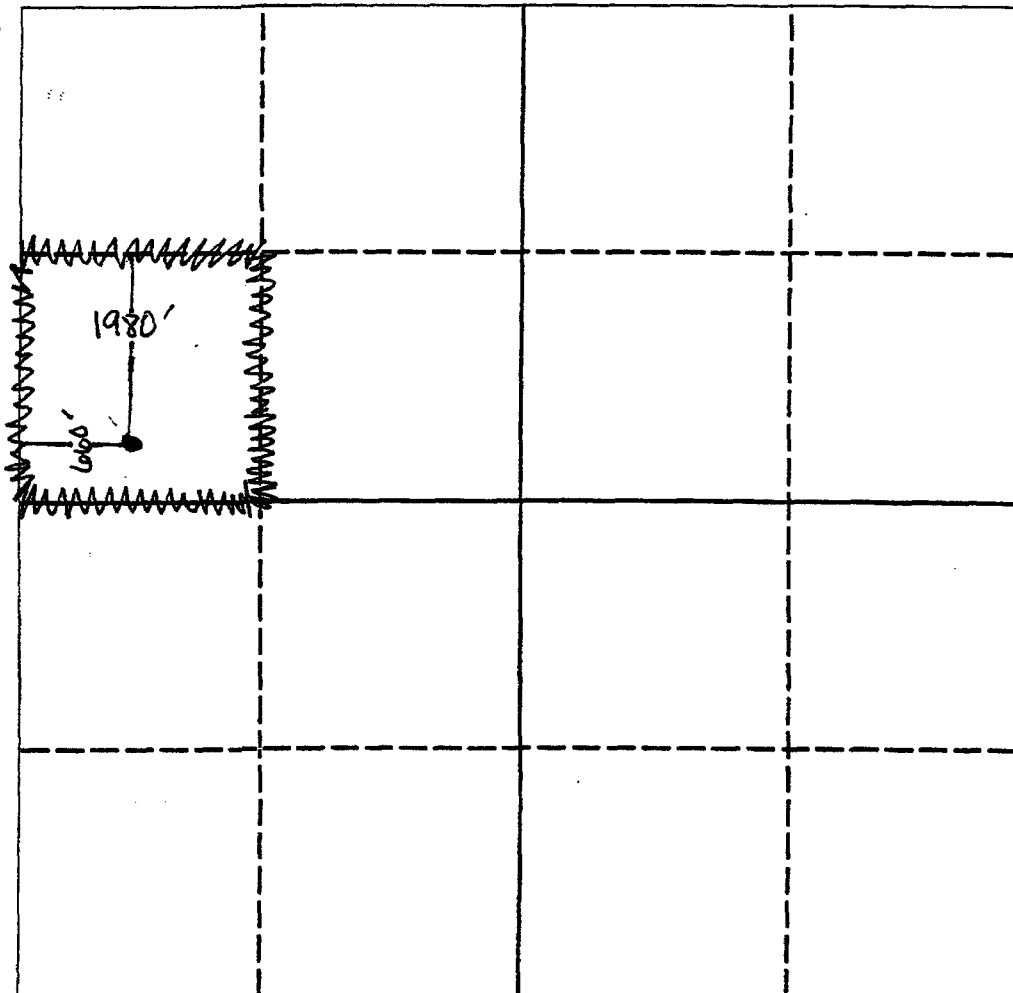

OPERATOR CERTIFICATION

I hereby certify that the information contained herein is true and complete to the best of my knowledge and belief.

Signature
FRANCES N. BYERS

Printed Name
ENGINEERING TECH

Position

Company

Date

SURVEYOR CERTIFICATION

I hereby certify that the well location shown on this plat was plotted from field notes of actual surveys made by me or under my supervision, and that the same is true and correct to the best of my knowledge and belief.

Date Surveyed

Signature & Seal of
Professional Surveyor

Certificate No.

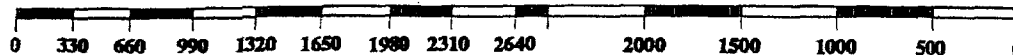

Submit to Appropriate
District Office
State Lease - 4 copies
Fee Lease - 3 copies

State of New Mexico
Energy, Minerals and Natural Resources Department

Form C-102
Revised 1-1-89

OIL CONSERVATION DIVISION

P.O. Box 2088
Santa Fe, New Mexico 87504-2088

DISTRICT I
P.O. Box 1980, Hobbs, NM 88240

DISTRICT II
P.O. Drawer DD, Artesia, NM 88210

DISTRICT III
1000 Rio Brazos Rd., Aztec, NM 87410

WELL LOCATION AND ACREAGE DEDICATION PLAT

All Distances must be from the outer boundaries of the section

Operator APACHE CORPORATION		Lease STATE "C" TRACT L@		Well No. 5
Unit Letter E	Section 16	Township 21S	Range 37E	County LEA
Actual Footage Location of Well: 1980' N 660' W				
feet from the line and		feet from the line		
Ground level Elev. 3371 DF	Producing Formation BLINEBRY	Pool BLINEBRY OIL & GAS	Dedicated Acreage: 40 Acres	

1. Outline the acreage dedicated to the subject well by colored pencil or hatchure marks on the plat below.

2. If more than one lease is dedicated to the well, outline each and identify the ownership thereof (both as to working interest and royalty).

3. If more than one lease of different ownership is dedicated to the well, have the interest of all owners been consolidated by communitization, unitization, force-pooling, etc.?

☐ Yes ☐ No If answer is "yes" type of consolidation

If answer is "no" list the owners and tract descriptions which have actually been consolidated. (Use reverse side of this form if necessary.)

No allowable will be assigned to the well until all interests have been consolidated (by communitization, unitization, forced-pooling, or otherwise) or until a non-standard unit, eliminating such interest, has been approved by the Division.

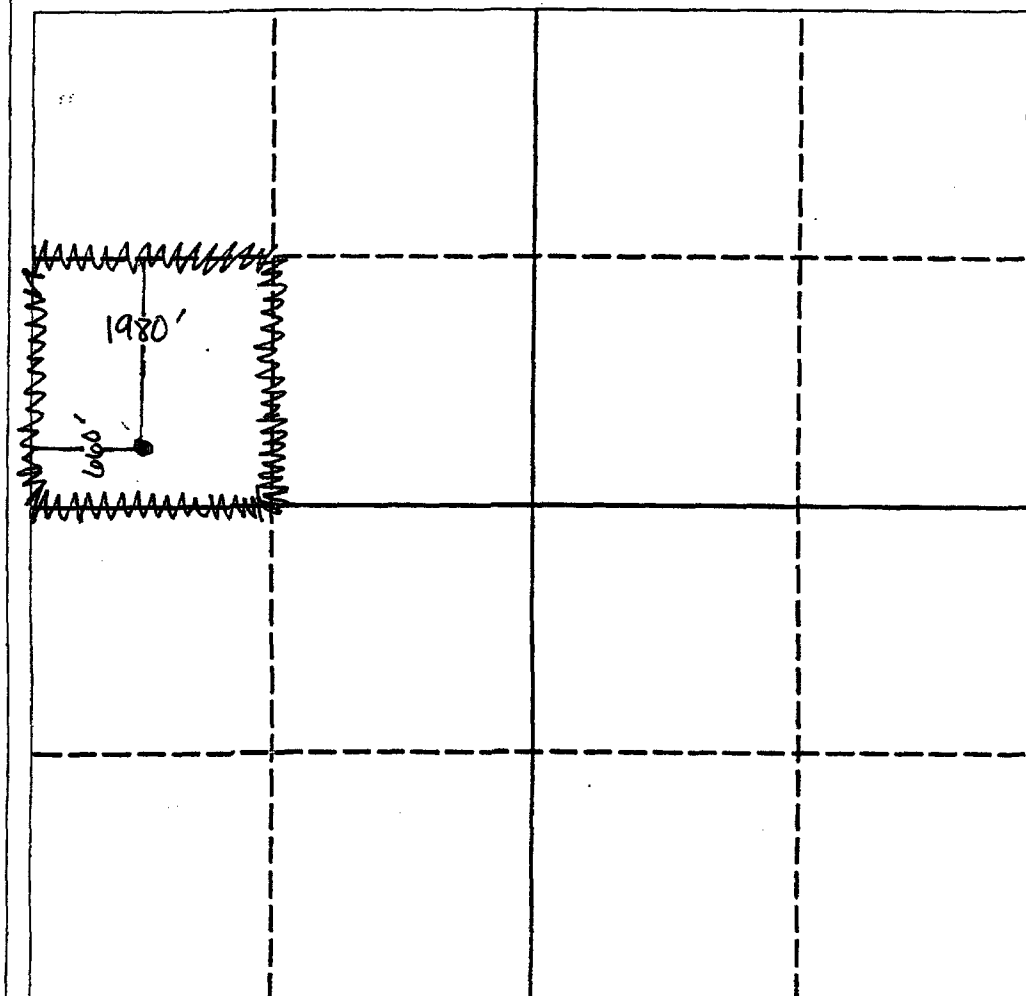

OPERATOR CERTIFICATION

I hereby certify that the information contained herein is true and complete to the best of my knowledge and belief.

Signature
Frances M. Byers

Printed Name
FRANCES M. BYERS

Position
ENGINEERING TECH

Position

Company

Date

SURVEYOR CERTIFICATION

I hereby certify that the well location shown on this plat was plotted from field notes of actual surveys made by me or under my supervision, and that the same is true and correct to the best of my knowledge and belief.

Date Surveyed

Signature & Seal of
Professional Surveyor

Certificate No.

0 330 660 990 1320 1650 1980 2310 2640 2000 1500 1000 500 0

21S 37E

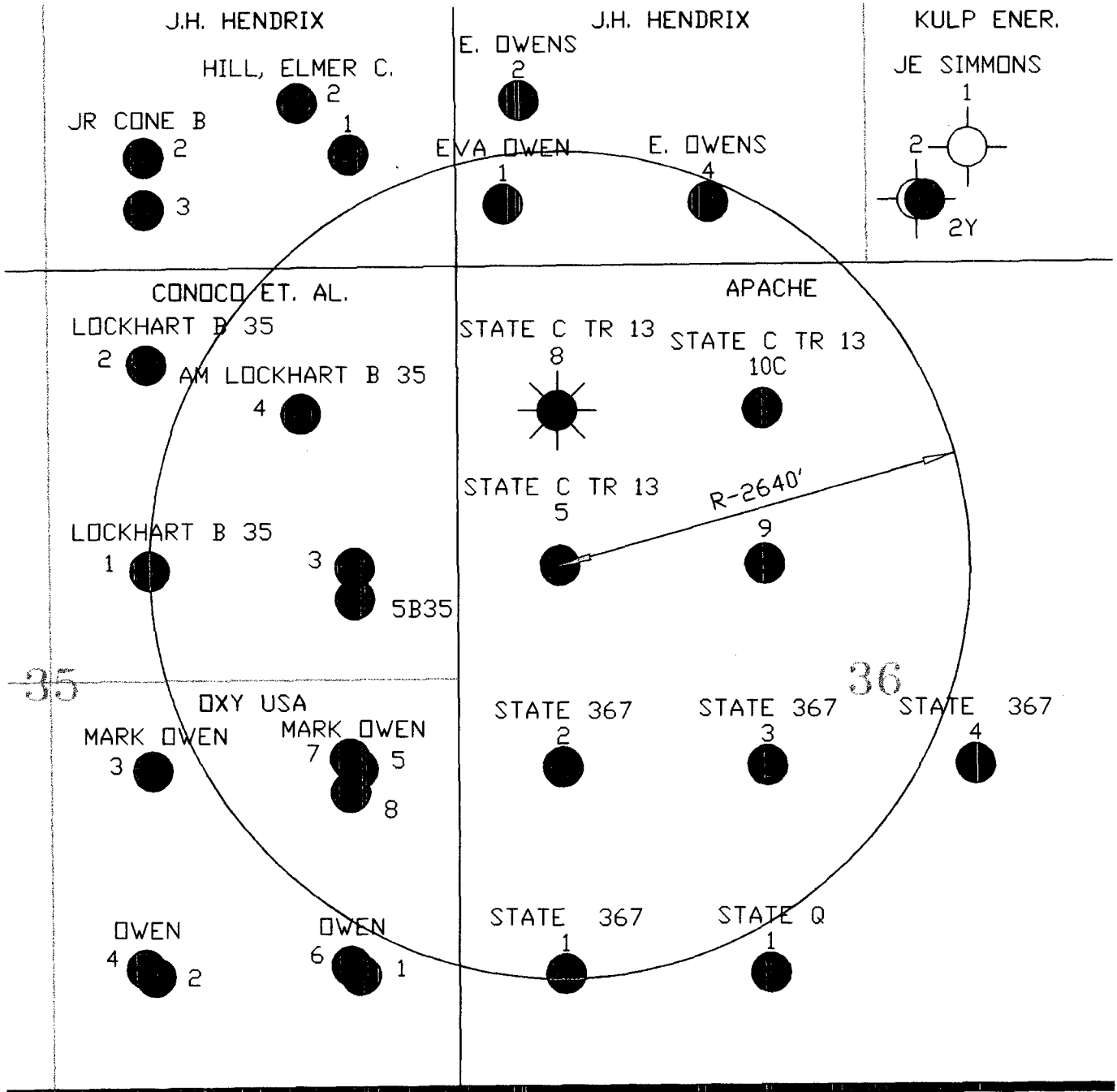

Dwight's Energydata Inc.
TX - NM Permian
New Mexico Gas

Run Date: 5/13/99
Published 3/99
(#250,025,21S37E36E00BL)

Operator:	APACHE CORP	
Well/Lease Name:	STATE C TR 13	
Well #:	5	Last Production Date: 10/98
Location:	36E 21S 37E	Cum. Thru L. P. Date Oil: 42,611
State:	NM	
District:	002	Cum. Thru L. P. Date Gas: 7,028,254
County:	LEA	
Regulatory #:		
API #:	30-025-0705100	
Field:	BLINEBRY (BLINEBRY) BL	
Reservoir:	BLINEBRY	
Basin:	PERMIAN BASIN	
Gas Gatherer:	WARRE	
Liquid Gatherer:	DOROC	
Status Date:		
Status:	ACT	

Year	Oil Prod BBLs	Gas Prod MCF	Water BBLs	# of Wells	Days On	Allowables
1970	237	257,862		1		
1971	124	115,147		1		
1972	380	291,243		1		
1973	478	281,711		1		
1974	179	450,640	299	1		
1975	232	472,269	236	1		
1976	202	420,155	265	1		
1977	434	398,599	286	1		
1978	848	335,966	426	1		
1979	618	299,450	348	1		
1980	65	231,650	330	1		
1981	71	206,777	364	1		
1982	83	107,592	139	1	197	
1983	189	110,127	221	1	231	
1984	298	100,327	329	1	210	
1985	128	71,781	95	1	115	
1986	172	96,698	161	1	246	
1987	124	120,095	299	1	313	
1988	84	108,514	254	1	342	
1989	34	75,631	221	1	350	
1990	2	80,139		1	321	
1991		70,325		1	356	
1992	4	64,522	22	1	366	
1993	14	57,884	9	1	361	
1994		48,100	303	1	358	
1995	54	26,143		1	219	
1996	139	45,187			176	
1997	66	7,658		1	30	
1998	137	19,651		1	270	

Date MO/YR	Oil Prod BBLs	BBLs /Day	Cum. Oil Prod. BBLs	Gas Prod MCF	Cum. Gas MCF	YIELD BBLs/MMCF	Water	% Water	# of Wells	Days On	Allowables
01/95	0	0	42,215	0	6,929,615				0	0	
02/95	0	0	42,215	0	6,929,615				0	0	
03/95	19	0	42,234	1,878	6,931,493	10.12			1	30	
04/95	0	0	42,234	2,463	6,933,956	0.00			1	30	
05/95	0	0	42,234	4,120	6,938,076	0.00			1	31	
06/95	0	0	42,234	3,696	6,941,772	0.00			1	29	
07/95	0	0	42,234	3,700	6,945,472	0.00			1	31	
08/95	0	0	42,234	2,708	6,948,180	0.00			1	0	
09/95	0	0	42,234	0	6,948,180				0	0	
10/95	0	0	42,234	3,477	6,951,657	0.00			1	31	
11/95	29	1	42,263	3,316	6,954,973	8.75			1	29	
12/95	6	0	42,269	785	6,955,758	7.64			1	8	
Totals	54			26,143						219	
01/96	23	0	42,292	3,272	6,959,030	7.03			1	24	
02/96	26	0	42,318	3,463	6,962,493	7.51			1	29	
03/96	22	0	42,340	4,450	6,966,943	4.94			1	31	
04/96	22	0	42,362	3,335	6,970,278	6.60			1	30	
05/96	28	0	42,390	4,348	6,974,626	6.44			1	31	
06/96	0	0	42,390	4,269	6,978,895	0.00			0	0	
07/96	0	0	42,390	4,223	6,983,118	0.00			0	0	
08/96	0	0	42,390	4,261	6,987,379	0.00			0	0	
09/96	0	0	42,390	3,792	6,991,171	0.00			0	0	
10/96	18	0	42,408	3,770	6,994,941	4.77			1	31	
11/96	0	0	42,408	3,058	6,997,999	0.00			0	0	
12/96	0	0	42,408	2,946	7,000,945	0.00			0	0	
Totals	139			45,187						176	
01/97	0	0	42,408	2,884	7,003,829	0.00			0	0	
02/97	0	0	42,408	2,476	7,006,305	0.00			0	0	
03/97	0	0	42,408	0	7,006,305				0	0	
04/97	0	0	42,408	0	7,006,305				0	0	
05/97	0	0	42,408	0	7,006,305				0	0	
06/97	66	2	42,474	2,298	7,008,603	28.72			1	30	
07/97	0	0	42,474	0	7,008,603				0	0	
08/97	0	0	42,474	0	7,008,603				0	0	
09/97	0	0	42,474	0	7,008,603				0	0	
10/97	0	0	42,474	0	7,008,603				0	0	
11/97	0	0	42,474	0	7,008,603				0	0	
12/97	0	0	42,474	0	7,008,603				0	0	
Totals	66			7,658						30	
01/98	0	0	42,474	0	7,008,603				0	0	
02/98	4	0	42,478	2,152	7,010,755	1.86			1	28	
03/98	28	0	42,506	2,321	7,013,076	12.06			1	31	
04/98	28	0	42,534	2,193	7,015,269	12.77			1	30	
05/98	21	0	42,555	2,264	7,017,533	9.28			1	31	
06/98	11	0	42,566	2,125	7,019,658	5.18			1	30	
07/98	11	0	42,577	2,235	7,021,893	4.92			1	30	
08/98	10	0	42,587	2,224	7,024,117	4.50			1	29	
09/98	15	0	42,602	2,111	7,026,228	7.11			1	30	
10/98	9	0	42,611	2,026	7,028,254	4.44			1	31	
11/98	0	0	42,611	0	7,028,254				0	0	
12/98	0	0	42,611	0	7,028,254				0	0	
Totals	137			19,651						270	

Dwights

Lease: STATE C TR 13 (5)

05/13/99

Retrieval Code: 250,025,21S37E36E00BL

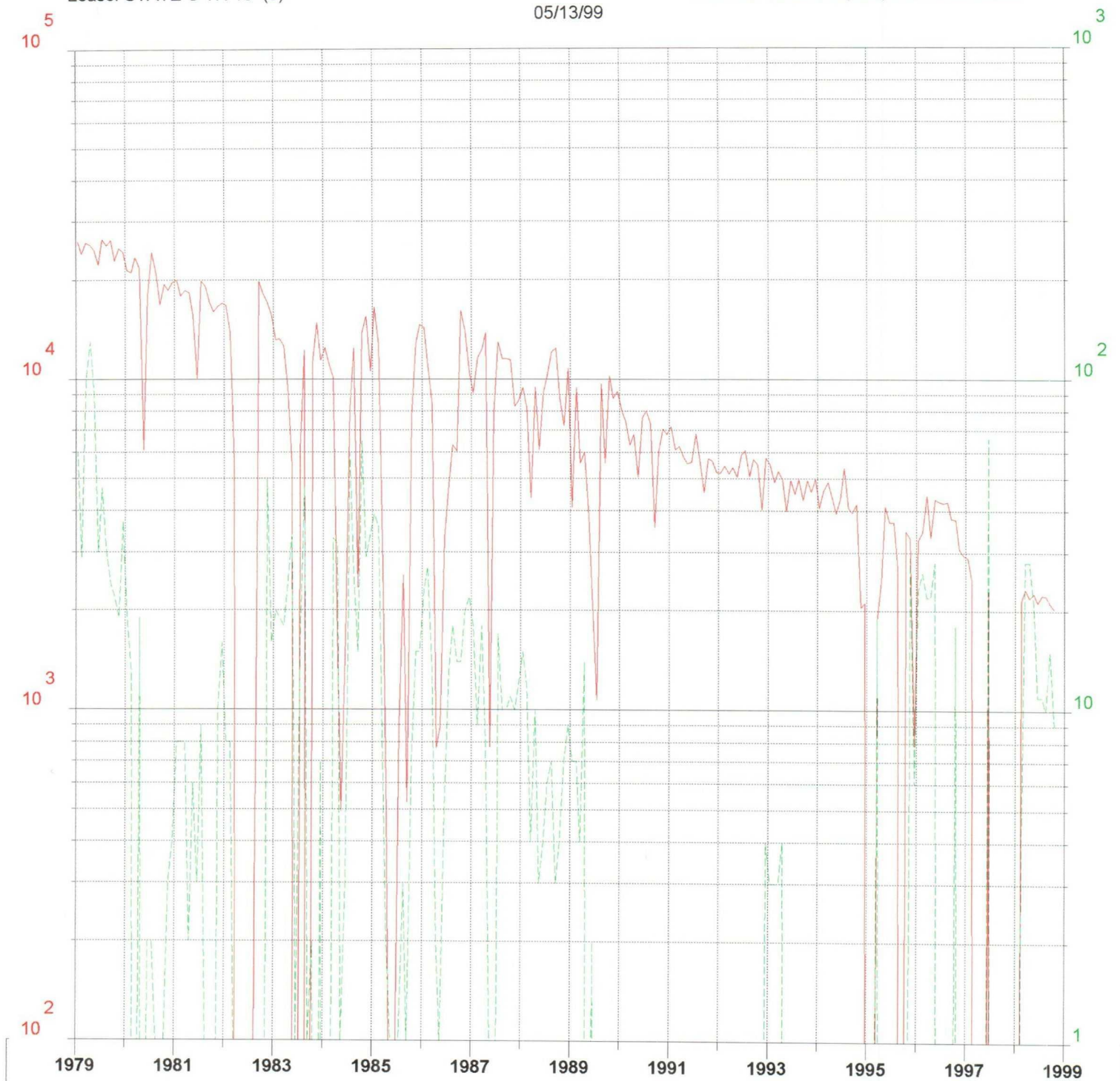

Gas (mcf/mo)

County: LEA

F.P. Date: N/A

Oil (bbl/mo)

Field: BLINEBRY (BLINEBRY) BL

Oil Cum: 42.61 mbbl

Reservoir: BLINEBRY

Gas Cum: 7028 mmcf

Operator: APACHE CORP

Location: 36E 21S 37E

May 7, 1999

(SEE ATTACHED LIST)

RE: Application to Amend Downhole Commingle Permits

State "C" Tract 12 Well Nos. #3, #4, and #7

State "C" Tract 13 Well No. #5

State "CK" Well No. #3

Eunice Area

Lea County, New Mexico

Dear Sir:

Apache Corporation, as operator of the subject wells, is proposing to amend the downhole commingling permits on the above five wells. Commingling production will enhance the economic operations of these wells. We are requesting to add one or more zones to the existing permits as indicated below:

State C Tract 12 #3	DHC #16 Blinebry & Drinkard	Adding Tubb & Skelly Penrose
State C Tract 12 #4	DHC #434 Tubb & Drinkard	Adding Blinebry & Paddock
State C Tract 13 #5	Applying For DHC	Blinebry, Tubb & Drinkard
State C Tract 12 #7	DHC #17 Blinebry & Drinkard	Adding Tubb
State CK #3	DHC #845 Blinebry & Paddock	Adding Tubb & Drinkard

Should you have in questions concerning this application, please contact Frances Byers at (713) 296-6361.

Sincerely,

APACHE CORPORATION



Frances M. Byers
Sr. Engineering Tech

Attachments

SURFACE OWNER & OFFSET OPERATORS LIST FOR:

State C Tract 12 #3, #4, #5, & #7

Surface Owner

Tim Walters
C/O Nations Bank
P. O. Box 270
Midland, TX 79702

Offset Operators

John Hendrix
P. O. Box 3040
Midland, TX 79702-3040

Mr. Craig Wright
Chevron USA
P. O. Box 1150
Midland, TX 79702

Mr. Ed
Collins & Ware
508 W. Wall Ave
Suite 1200
Midland, TX 79701-5076

Mr. J. Miller
Conoco
10 Desta Dr.
Suite 100W
Midland, TX 79705-4500

Oxy
P. O. Box 4662
Midland, TX 79702

SURFACE OWNER & OFFSET OPERATORS LIST FOR:

State CK #3

Surface Owner

Tim Walters
C/O Nations Bank
P. O. Box 270
Midland, TX 79702

Offset Operators

Mr. Craig Wright
Chevron USA
P. O. Box 1150
Midland, TX 79702

BC Oil et al
P. O. Box 20820
Midland, TX 79710-0820

Parker & Parsley
P. O. Box 3178
Midland, TX 79702-3178

Campbell & Hedrick
2003 Country Club Dr.
Midland, TX 79701-5718

Texaco
205 E. Bender Blvd.
Hobbs, NM 88240

**SUPPORT FOR BLINEBRY-TUBB-DRINKARD
ZONES**

Z 11b 152 482

US Postal Service

Receipt for Certified Mail

No Insurance Coverage Provided.

Do not use for International Mail (See reverse)

Mr. Craig Wright
Chevron USA
P. O. Box 1150
Midland, TX 79702

PS Form 3800, April 1995

Certified Fee	
Special Delivery Fee	
Restricted Delivery Fee	
Return Receipt Showing to Whom & Date Delivered	
Return Receipt Showing to Whom, Date, & Addressee's Address	
TOTAL Postage & Fees	\$
Postmark or Date	

Z 11b 152 485

US Postal Service

Receipt for Certified Mail

No Insurance Coverage Provided.

Do not use for International Mail (See reverse)

Mr. J. Miller
Conoco
10 Desta Dr.
Suite 100W
Midland, TX 79705-4500

PS Form 3800, April 1995

Certified Fee	
Special Delivery Fee	
Restricted Delivery Fee	
Return Receipt Showing to Whom & Date Delivered	
Return Receipt Showing to Whom, Date, & Addressee's Address	
TOTAL Postage & Fees	\$
Postmark or Date	

Z 11b 150 836

US Postal Service

Receipt for Certified Mail

No Insurance Coverage Provided.

Mr. Ron Westbrook
John Hendrix
P. O. Box 3040
Midland, TX 79702-3040

PS Form 3800, April 1995

Certified Fee	
Special Delivery Fee	
Restricted Delivery Fee	
Return Receipt Showing to Whom & Date Delivered	
Return Receipt Showing to Whom, Date, & Addressee's Address	
TOTAL Postage & Fees	\$
Postmark or Date	

Z 11b 152 484

US Postal Service

Receipt for Certified Mail

No Insurance Coverage Provided.

Do not use for International Mail (See reverse)

OXY
P. O. Box 4662
Midland, TX 79702

PS Form 3800, April 1995

Certified Fee	
Special Delivery Fee	
Restricted Delivery Fee	
Return Receipt Showing to Whom & Date Delivered	
Return Receipt Showing to Whom, Date, & Addressee's Address	
TOTAL Postage & Fees	\$
Postmark or Date	

Z 11b 150 835

US Postal Service

Receipt for Certified Mail

No Insurance Coverage Provided.

Do not use for International Mail (See reverse)

Tim Walters
C/O Nations Bank
P. O. Box 270
Midland, TX 79702

PS Form 3800, April 1995

Certified Fee	
Special Delivery Fee	
Restricted Delivery Fee	
Return Receipt Showing to Whom & Date Delivered	
Return Receipt Showing to Whom, Date, & Addressee's Address	
TOTAL Postage & Fees	\$
Postmark or Date	

Z 11b 152 483

US Postal Service

Receipt for Certified Mail

No Insurance Coverage Provided.

Do not use for International Mail (See reverse)

Mr. Erick Nelson
Collins & Ware
508 W. Wall Ave
Suite 1200
Midland, TX 79701-5076

PS Form 3800, April 1995

Certified Fee	
Special Delivery Fee	
Restricted Delivery Fee	
Return Receipt Showing to Whom & Date Delivered	
Return Receipt Showing to Whom, Date, & Addressee's Address	
TOTAL Postage & Fees	\$
Postmark or Date	

Z 11b 152 487

US Postal Service
Receipt for Certified Mail
No Insurance Coverage Provided.
Do not use for International Mail (See reverse)

Parker & Parsley
P. O. Box 3178
Midland, TX 79702-3178

PS Form 3800, April 1995

Certified Fee	
Special Delivery Fee	
Restricted Delivery Fee	
Return Receipt Showing to Whom & Date Delivered	
Return Receipt Showing to Whom, Date, & Addressee's Address	
TOTAL Postage & Fees	\$
Postmark or Date	

Z 11b 151 077

US Postal Service
Receipt for Certified Mail
No Insurance Coverage Provided.
Do not use for International Mail (See reverse)

Texaco
205 E. Bender Blvd.
Hobbs, NM 88240

3800, April 1995

Certified Fee	
Special Delivery Fee	
Restricted Delivery Fee	
Return Receipt Showing to Whom & Date Delivered	
Return Receipt Showing to Whom, Date, & Addressee's Address	
TOTAL Postage & Fees	\$
Postmark or Date	

Z 11b 152 486

US Postal Service
Receipt for Certified Mail
No Insurance Coverage Provided.
Do not use for International Mail (See reverse)

BC Oil et al
P. O. Box 20820
Midland, TX 79710-0820

PS Form 3800, April 1995

Certified Fee	
Special Delivery Fee	
Restricted Delivery Fee	
Return Receipt Showing to Whom & Date Delivered	
Return Receipt Showing to Whom, Date, & Addressee's Address	
TOTAL Postage & Fees	\$
Postmark or Date	

Z 11b 151 076

US Postal Service
Receipt for Certified Mail
No Insurance Coverage Provided.
Do not use for International Mail (See reverse)

Campbell & Hedrick
2003 Country Club Dr.
Midland, TX 79701-5718

3800, April 1995

Certified Fee	
Special Delivery Fee	
Restricted Delivery Fee	
Return Receipt Showing to Whom & Date Delivered	
Return Receipt Showing to Whom, Date, & Addressee's Address	
TOTAL Postage & Fees	\$
Postmark or Date	

Friday, February 10, 1995 Through Monday, May 10, 1999

Pressure Base	: None
Units	: A.P.I.

: None
: A.P.I.

Page No : 1
Print Date : 5/10/99, 9:56

Rounded (Y/n) : No

Report Number : R 013

Dates		Completion Name	Meas Mthd Type Hrs	24 Hour Volumes				Ratios				PPM		Obsr
Test	Eff			Oil	Gas	Water	Lift	Emul	GOR	WOR	GFR	Chl	Iron	
11/01/97	11/01/97	STATE C TR 13 #05:BLINEBRY	24.00	.20	75.00	1.00	.00	.00	375,000.000	5.000	62,500.000			.00
03/01/98	03/01/98	STATE C TR 13 #05:BLINEBRY	24.00	1.00	80.00	.00	.00	.00	80,000.000	0.000	80,000.000			.00
02/02/99	02/02/99	STATE C TR 13 #05:BLINEBRY	24.00	1.00	78.00	3.00	.00	.00	78,000.000	3.000	19,500.000			.00
Avgs-- STATE C TR 13 #05:BLINEBRY				.73	77.67	1.33	.00							
11/01/97	11/01/97	STATE C TR 13 #05:TUBB	24.00	.00	49.00	.00	.00	.00	0.000	0.000	0.000			.00
03/01/98	03/01/98	STATE C TR 13 #05:TUBB	24.00	.00	48.00	.00	.00	.00	0.000	0.000	0.000			.00
02/02/99	02/02/99	STATE C TR 13 #05:TUBB	24.00	.00	36.00	.00	.00	.00	0.000	0.000	0.000			.00
Avgs-- STATE C TR 13 #05:TUBB				.00	44.33	.00	.00							

Friday, February 10, 1995 Through Monday, May 10, 1999

Well Test History (OGW)

Select By : Completions

Pressure Base : None
Units : A.P.I.
Page No : 1
Print Date : 5/10/99, 9:5

Sort By : None selected in Report Options.

Rounded (v/n) : No
Report Number : R 013

Dates		Completion Name	Meas Mthd Type Hrs	24 Hour Volumes				Ratios				PPM		Obs
Test	Eff			Oil	Gas	Water	Lift	Emul	GOR	WOR	GFR	Chl	Iron	
11/01/97	11/01/97	STATE C TR 12 #7;BLINEBRY	24.00	1.50	48.00	1.00	.00	.00	32,000.000	0.667	19,200.000			.00
03/01/98	03/01/98	STATE C TR 12 #7;BLINEBRY	24.00	1.00	40.00	.00	.00	.00	40,000.000	0.000	40,000.000			.00
AVGS-		STATE C TR 12 #7;BLINEBRY		1.25	44.00	.50	.00							
11/01/97	11/01/97	STATE C TR 12 #7;DRINKARD	24.00	.70	20.60	.10	.00	.00	29,428.571	0.143	25,750.000			.00

WellTest History (OGW)

Select By : Completions

Pressure Base : None
Units : A.P.L.

Page No : 1
Print Date : 5/10/99, 9:41

Sort By : None selected in Report Options.

Rounded (y/n) : No

Report Number : R 013

Dates	Test Eff	Completion Name	Methd Type	Meas					Emul	Ratios			PPM		Obsl
				Hrs	Oil	Gas	Water	Lift		GOR	WOR	GFR	Chi	Iron	Grv
02/02/99		STATE /CK/ #3:BLINEBRY		24.00	.00	69.40	.00	.00	.00	0.000	0.000	0.000			.00
02/02/99		STATE /CK/ #3:PADDOCK		24.00	25.00	8.60	80.00	.00	.00	344.000	3.200	81.905			.00
03/16/99		STATE /CK/ #3:PADDOCK		24.00	24.00	8.60	93.00	.00	.00	358.333	3.875	73.504			.00
Avgs-- STATE /CK/ #3:PADDOCK					24.50	8.60	86.50	.00							

WellTest History (OGW)

Friday, February 10, 1995 Through Monday, May 10, 1999

Select By : Completions

Pressure Base

: None

Page No

: 1

Units

: A.P.I.

Print Date

: 5/10/99, 9:58:

Sort By : None selected in Report Options.

Rounded (v/n) : No

Report Number : R 013

Dates	Test Eff	Completion Name	Meas Mthd Type Hrs	24 Hour Volumes				Ratios				PPM		Obsrv
				Oil	Gas	Water	Lift	Emul	GOR	WOR	GFR	Chl	Iron	
03/01/99	03/01/99	STATE C TR 12 #6Y:BLI	24.00	.00	.00	.00	.00	.00	0.000	0.000	0.000			.00
03/16/99	03/16/99		24.00	16.00	374.00	14.00	.00	.00	23,375.000	0.875	12,466.667			.00
Avgs-- 03/1999				8.00	187.00	7.00	.00	.00	11,687.500	0.438	6,233.333			.00
04/01/99	04/01/99	STATE C TR 12 #6Y:BLI	24.00	11.00	355.50	9.87	.00	.00	32,318.182	0.897	17,034.020			.00
Avgs-- STATE C TR 12 #6Y:BLI				9.00	243.17	7.96	.00	.00						
11/01/97	11/01/97	STATE C TR 12 #6Y:DRINKARD	24.00	.50	1.00	.00	.00	.00	2,000.000	0.000	2,000.000			.00
03/01/98	03/01/98	STATE C TR 12 #6Y:DRINKARD	24.00	.00	250.00	1.00	.00	.00	0.000	0.000	250,000.000			.00
10/09/98	10/09/98	STATE C TR 12 #6Y:DRINKARD	15.00	.00	23.52	24.80	.00	.00	0.000	0.000	948.387			.00
10/10/98	10/10/98		24.00	1.00	20.70	16.00	.00	.00	20,700.000	16.000	1,217.647			.00
10/11/98	10/11/98		24.00	4.50	20.70	22.50	.00	.00	4,600.000	5.000	766.667			.00
10/12/98	10/12/98		24.00	7.00	21.60	25.00	.00	.00	3,085.714	3.571	675.000			.00
10/13/98	10/13/98		24.00	4.50	21.20	22.50	.00	.00	4,711.111	5.000	785.185			.00
10/14/98	10/14/98		24.00	2.00	21.60	20.00	.00	.00	10,800.000	10.000	981.818			.00
10/15/98	10/15/98		24.00	2.50	23.00	23.50	.00	.00	9,200.000	9.400	884.615			.00
10/16/98	10/16/98		24.00	4.00	24.00	20.00	.00	.00	6,000.000	5.000	1,000.000			.00
10/17/98	10/17/98		24.00	.50	25.85	11.00	.00	.00	51,700.000	22.000	2,247.826			.00
10/18/98	10/18/98		24.00	.50	26.30	7.50	.00	.00	52,600.000	15.000	3,287.500			.00
10/19/98	10/19/98		24.00	.50	28.20	6.50	.00	.00	56,400.000	13.000	4,028.571			.00
10/23/98	10/23/98		24.00	.50	28.20	7.50	.00	.00	56,400.000	15.000	3,525.000			.00
10/24/98	10/24/98		24.00	.50	30.60	7.50	.00	.00	61,200.000	15.000	3,825.000			.00
10/25/98	10/25/98		24.00	.50	31.50	7.50	.00	.00	63,000.000	15.000	3,937.500			.00
10/26/98	10/26/98		24.00	2.00	32.00	7.50	.00	.00	16,000.000	3.750	3,368.421			.00
10/27/98	10/27/98		24.00	1.00	32.40	5.00	.00	.00	32,400.000	5.000	5,400.000			.00
10/28/98	10/28/98		24.00	1.00	32.40	3.50	.00	.00	32,400.000	3.500	7,200.000			.00
10/29/98	10/29/98		24.00	1.00	33.40	3.50	.00	.00	33,400.000	3.500	7,422.222			.00
10/30/98	10/30/98		24.00	1.00	32.00	5.00	.00	.00	32,000.000	5.000	5,333.333			.00
10/31/98	10/31/98		24.00	.50	34.80	6.50	.00	.00	69,600.000	13.000	4,971.429			.00
Avgs-- 10/1998				1.75	27.20	12.64	.00	.00	30,809.841	9.136	3,090.306			.00
11/01/98	11/01/98	STATE C TR 12 #6Y:DRINKARD	24.00	.50	34.80	3.00	.00	.00	69,600.000	6.000	9,942.857			.00
11/02/98	11/02/98		24.00	.50	35.30	1.50	.00	.00	70,600.000	3.000	17,650.000			.00
11/03/98	11/03/98		24.00	.50	35.70	1.50	.00	.00	71,400.000	3.000	17,850.000			.00
11/04/98	11/04/98		24.00	.50	35.30	2.00	.00	.00	70,600.000	4.000	14,120.000			.00
11/05/98	11/05/98		24.00	.50	36.20	1.50	.00	.00	72,400.000	3.000	18,100.000			.00
11/06/98	11/06/98		24.00	.50	36.20	1.50	.00	.00	72,400.000	3.000	18,100.000			.00
11/07/98	11/07/98		24.00	.50	36.20	1.50	.00	.00	72,400.000	3.000	18,100.000			.00
11/08/98	11/08/98		24.00	.50	36.70	1.50	.00	.00	73,400.000	3.000	18,350.000			.00
11/09/98	11/09/98		24.00	35.00	36.70	1.50	.00	.00	1,048.571	0.043	1,005.479			.00
11/10/98	11/10/98		24.00	.50	37.10	1.50	.00	.00	74,200.000	3.000	18,550.000			.00

WellTest History (OGW)

Friday, February 10, 1995 Through Monday, May 10, 1999

Select By : Completions

Pressure Base : None

Units : A.P.L.

Page No : 2

Rounded (v/v) : No

Print Date : 5/10/99, 9:58

Sort By : None selected in Report Options.

Report Number : R 013

Dates	Test Eff	Completion Name	Methd Type	Hrs	24 Hour Volumes				Ratios				PPM		Obsr
					Oil	Gas	Water	Lift	Emul	GOR	WOR	GFR	Chl	Iron	
11/11/98	11/11/98	STATE C TR 12 #6Y:DRINKARD	24.00		.50	37.10	1.50	.00	.00	74,200.000	3.000	18,550.000			.00
11/12/98	11/12/98		24.00		.50	36.20	1.50	.00	.00	72,400.000	3.000	18,100.000			.00
Avgs-- 11/1998															
					3.38	36.13	1.67	.00	.00	66,220.714	3.087	15,701.528			.00
Avgs-- 1998															
02/02/99	02/02/99	STATE C TR 12 #6Y:DRINKARD	24.00		.50	47.00	.50	.00	.00	94,000.000	1.000	47,000.000			.00
03/01/99	03/01/99	STATE C TR 12 #6Y:DRINKARD	24.00		.00	.00	.00	.00	.00	0.000	0.000	0.000			.00
03/13/99	03/13/99		24.00		9.00	388.00	144.00	.00	.00	43,111.111	16.000	2,535.948			.00
03/15/99	03/15/99		24.00		15.00	467.00	40.00	.00	.00	31,133.333	2.667	8,490.909			.00
03/16/99	03/16/99		24.00		.50	47.00	.50	.00	.00	94,000.000	1.000	47,000.000			.00
03/17/99	03/17/99		24.00		16.00	473.00	6.00	.00	.00	29,562.500	0.375	21,500.000			.00
03/18/99	03/18/99		24.00		14.00	455.00	21.00	.00	.00	32,500.000	1.500	13,000.000			.00
03/19/99	03/19/99		24.00		16.00	459.00	12.00	.00	.00	28,687.500	0.750	16,392.857			.00
03/20/99	03/20/99		24.00		14.00	441.00	12.00	.00	.00	31,500.000	0.857	16,961.538			.00
03/21/99	03/21/99		24.00		13.00	468.00	15.00	.00	.00	36,000.000	1.154	16,714.286			.00
03/22/99	03/22/99		24.00		11.00	468.00	6.00	.00	.00	42,545.455	0.545	27,529.412			.00
03/23/99	03/23/99		24.00		15.00	468.00	16.00	.00	.00	31,200.000	1.067	15,096.774			.00
03/24/99	03/24/99		24.00		11.00	465.00	12.00	.00	.00	42,272.727	1.091	20,217.391			.00
03/25/99	03/25/99		24.00		10.00	463.00	13.00	.00	.00	46,300.000	1.300	20,130.435			.00
03/26/99	03/26/99		24.00		13.00	462.00	19.00	.00	.00	35,538.462	1.462	14,437.500			.00
03/27/99	03/27/99		24.00		10.00	457.00	8.00	.00	.00	45,700.000	0.800	25,388.889			.00
03/28/99	03/28/99		24.00		16.00	453.00	15.00	.00	.00	28,312.500	0.938	14,612.903			.00
03/29/99	03/29/99		24.00		10.00	453.00	8.00	.00	.00	45,300.000	0.800	25,166.667			.00
03/30/99	03/30/99		24.00		10.00	451.00	11.00	.00	.00	45,100.000	1.100	21,476.190			.00
03/31/99	03/31/99		24.00		13.00	450.00	11.00	.00	.00	34,615.385	0.846	18,750.000			.00
Avgs-- 03/1999															
04/01/99	04/01/99	STATE C TR 12 #6Y:DRINKARD	24.00		11.39	409.89	19.45	.00	.00	38,072.577	1.803	18,179.037			.00
04/02/99	04/02/99		24.00		1.00	49.50	.31	.00	.00	49,500.000	0.310	37,786.260			.00
04/03/99	04/03/99		24.00		5.00	210.10	5.50	.00	.00	42,020.000	1.100	20,009.554			.00
04/04/99	04/04/99		24.00		10.00	446.00	7.00	.00	.00	44,600.000	0.700	26,235.294			.00
04/05/99	04/05/99		24.00		10.00	443.00	11.00	.00	.00	44,300.000	1.100	21,095.238			.00
04/07/99	04/07/99		24.00		6.00	441.00	5.00	.00	.00	73,500.000	0.833	40,090.909			.00
04/08/99	04/08/99		24.00		3.00	440.00	10.00	.00	.00	146,666.667	3.333	33,846.154			.00
Avgs-- 04/1999															
					10.00	442.00	11.00	.00	.00	44,200.000	1.100	21,047.619			.00
Avgs-- 1999															
					6.43	353.09	7.12	.00	.00	63,540.952	1.211	28,587.285			.00
Avgs-- STATE C TR 12 #6Y:DRINKARD															
11/01/97	11/01/97	STATE C TR 12 #6Y:TUBB	24.00		.50	1.00	.00	.00	.00	2,000.000	0.000	2,000.000			.00
10/09/98	10/09/98	STATE C TR 12 #6Y:TUBB	15.00		.00	26.40	24.80	.00	.00	0.000	0.000	1,064.516			.00
10/10/98	10/10/98		24.00		1.00	23.30	16.00	.00	.00	23,300.000	16.000	1,370.588			.00

Well Test History (OGW)

Friday, February 10, 1995 Through Monday, May 10, 1999

Select By : Completions

Pressure Base

: None

Units

: A.P.I.

Page No

: 3

Print Date

: 5/10/99, 9:58:

Sort By : None selected in Report Options.

Rounded (V/n) : No

Report Number : R 013

Dates	Completion Name	Meas Mthd Type Hrs	24 Hour Volumes				Ratios				PPM		Obsrv
			Oil	Gas	Water	Lift	Emul	GOR	WOR	GFR	Chl	Iron	
10/11/98	10/11/98 STATE C TR 12 #6Y:TUBB	24.00	4.50	23.30	22.50	.00	.00	5,177.778	5.000	862.963			.00
10/12/98	10/12/98	24.00	7.00	24.40	25.00	.00	.00	3,485.714	3.571	762.500			.00
10/13/98	10/13/98	24.00	4.50	23.80	22.50	.00	.00	5,288.889	5.000	881.481			.00
10/14/98	10/14/98	24.00	2.00	24.40	20.00	.00	.00	12,200.000	10.000	1,109.091			.00
10/15/98	10/15/98	24.00	2.50	56.00	23.50	.00	.00	22,400.000	9.400	2,153.846			.00
10/16/98	10/16/98	24.00	4.00	27.00	20.00	.00	.00	6,750.000	5.000	1,125.000			.00
10/17/98	10/17/98	24.00	.50	29.15	11.00	.00	.00	58,300.000	22.000	2,534.783			.00
10/18/98	10/18/98	24.00	.50	29.70	7.50	.00	.00	59,400.000	15.000	3,712.500			.00
10/19/98	10/19/98	24.00	.50	31.80	6.50	.00	.00	63,600.000	13.000	4,542.857			.00
10/23/98	10/23/98	24.00	.50	31.80	7.50	.00	.00	63,600.000	15.000	3,975.000			.00
10/24/98	10/24/98	24.00	.50	34.40	7.50	.00	.00	68,800.000	15.000	4,300.000			.00
10/25/98	10/25/98	24.00	.50	35.50	7.50	.00	.00	71,000.000	15.000	4,437.500			.00
10/26/98	10/26/98	24.00	2.00	36.00	7.50	.00	.00	18,000.000	3.750	3,789.474			.00
10/27/98	10/27/98	24.00	1.00	36.60	5.00	.00	.00	36,600.000	5.000	6,100.000			.00
10/28/98	10/28/98	24.00	1.00	36.60	3.50	.00	.00	36,600.000	3.500	8,133.333			.00
10/29/98	10/29/98	24.00	1.00	37.60	3.50	.00	.00	37,600.000	3.500	8,355.556			.00
10/30/98	10/30/98	24.00	1.00	36.00	5.00	.00	.00	36,000.000	5.000	6,000.000			.00
10/31/98	10/31/98	24.00	.50	39.20	6.50	.00	.00	78,400.000	13.000	5,600.000			.00
Avg-- 10/1998			1.75	32.15	12.64	.00	.00	35,325.119	9.136	3,540.549			.00
11/01/98	11/01/98 STATE C TR 12 #6Y:TUBB	24.00	.50	39.20	3.00	.00	.00	78,400.000	6.000	11,200.000			.00
11/02/98	11/02/98	24.00	.50	39.70	1.50	.00	.00	79,400.000	3.000	19,850.000			.00
11/03/98	11/03/98	24.00	.50	40.30	1.50	.00	.00	80,600.000	3.000	20,150.000			.00
11/04/98	11/04/98	24.00	.50	39.70	2.00	.00	.00	79,400.000	4.000	15,880.000			.00
11/05/98	11/05/98	24.00	.50	40.80	1.50	.00	.00	81,600.000	3.000	20,400.000			.00
11/06/98	11/06/98	24.00	.50	40.80	1.50	.00	.00	81,600.000	3.000	20,400.000			.00
11/07/98	11/07/98	24.00	.50	40.80	1.50	.00	.00	81,600.000	3.000	20,400.000			.00
11/08/98	11/08/98	24.00	.50	41.30	1.50	.00	.00	82,600.000	3.000	20,650.000			.00
11/09/98	11/09/98	24.00	.50	41.30	1.50	.00	.00	82,600.000	3.000	20,650.000			.00
11/10/98	11/10/98	24.00	.50	41.90	1.50	.00	.00	83,800.000	3.000	20,950.000			.00
11/11/98	11/11/98	24.00	.50	41.90	1.50	.00	.00	83,800.000	3.000	20,950.000			.00
11/12/98	11/12/98	24.00	.50	40.80	1.50	.00	.00	81,600.000	3.000	20,400.000			.00
Avg-- 11/1998			.50	40.71	1.67	.00	.00	81,416.667	3.333	19,323.333			.00
Avg-- 1998			1.28	35.36	8.53	.00	.00	106,000.000	11.000	8,833.333			.00
02/02/99	02/02/99 STATE C TR 12 #6Y:TUBB	24.00	.50	53.00	5.50	.00	.00	106,000.000	1.000	53,000.000			.00
03/16/99	03/16/99 STATE C TR 12 #6Y:TUBB	24.00	.50	53.00	.50	.00	.00	0.000	0.000	0.000			.00
03/31/99	03/31/99	24.00	.00	.00	.00	.00	.00	53,000.000	0.500	26,500.000			.00
Avg-- 03/1999			.25	26.50	.25	.00	.00	45,000.000	0.320	34,090.909			.00
04/01/99	04/01/99 STATE C TR 12 #6Y:TUBB	24.00	1.00	45.00	.32	.00	.00	47,380.000	1.100	22,561.905			.00
04/02/99	04/02/99	24.00	5.00	226.90	5.50	.00	.00						.00