

ABOVE THIS LINE FOR DIVISION USE ONLY

NEW MEXICO OIL CONSERVATION DIVISION

- Engineering Bureau -

ADMINISTRATIVE APPLICATION COVERSHEET

THIS COVERSHEET IS MANDATORY FOR ALL ADMINISTRATIVE APPLICATIONS FOR EXCEPTIONS TO DIVISION RULES AND REGULATIONS

Application Acronyms:

[NSP-Non-Standard Proration Unit] [NSL-Non-Standard Location]
 [DD-Directional Drilling] [SD-Simultaneous Dedication]
 [DHC-Downhole Commingling] [CTB-Lease Commingling] [PLC-Pool/Lease Commingling]
 [PC-Pool Commingling] [OLS - Off-Lease Storage] [OLM-Off-Lease Measurement]
 [WFX-Waterflood Expansion] [PMX-Pressure Maintenance Expansion]
 [SWD-Salt Water Disposal] [IPI-Injection Pressure Increase]
 [EOR-Qualified Enhanced Oil Recovery Certification] [PPR-Positive Production Response]

[1] TYPE OF APPLICATION - Check Those Which Apply for [A]

[A] Location - Spacing Unit - Directional Drilling

☒ NSL ☐ NSP ☐ DD ☐ SD

Check One Only for [B] or [C]

[B] Commingling - Storage - Measurement

☐ DHC ☐ CTB ☐ PLC ☐ PC ☐ OLS ☐ OLM

[C] Injection - Disposal - Pressure Increase - Enhanced Oil Recovery

☐ WFX ☐ PMX ☐ SWD ☐ IPI ☐ EOR ☐ PPR

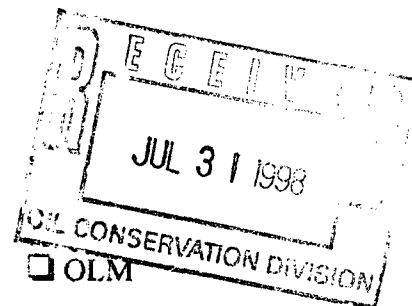

[2] NOTIFICATION REQUIRED TO: - Check Those Which Apply, or ☒ Does Not Apply

[A] ☐ Working, Royalty or Overriding Royalty Interest Owners

[B] ☐ Offset Operators, Leaseholders or Surface Owner

[C] ☐ Application is One Which Requires Published Legal Notice

[D] ☐ Notification and/or Concurrent Approval by BLM or SLO

U.S. Bureau of Land Management - Commissioner of Public Lands, State Land Office

[E] ☐ For all of the above, Proof of Notification or Publication is Attached, and/or,

[F] ☐ Waivers are Attached

[3] INFORMATION / DATA SUBMITTED IS COMPLETE - Statement of Understanding

I hereby certify that I, or personnel under my supervision, have read and complied with all applicable Rules and Regulations of the Oil Conservation Division. Further, I assert that the attached application for administrative approval is accurate and complete to the best of my knowledge and where applicable, verify that all interest (WI, RI, ORRI) is common. I further verify that all applicable API Numbers are included. I understand that any omission of data, information or notification is cause to have the application package returned with no action taken.

JAMES BRUCE
 P.O. BOX 1056
 SANTA FE, NM 87504

Note: Statement must be completed by an individual with supervisory capacity.

James Bruce
 Signature

Harvey Tor
 Title
Applicant

Date

Print or Type Name

JAMES BRUCE
ATTORNEY AT LAW

POST OFFICE BOX 1056
SANTA FE, NEW MEXICO 87504

SUITE B
612 OLD SANTA FE TRAIL
SANTA FE, NEW MEXICO 87501

(505) 982-2043
(505) 982-2151 (FAX)

July 31, 1998

Hand Delivered

Michael E. Stogner
Oil Conservation Division
2040 South Pacheco Street
Santa Fe, New Mexico 87505

Dear Mr. Stogner:

Pursuant to Division Rule 104.F.(2), Pogo Producing Company ("Pogo") applies for administrative approval of unorthodox oil well locations for the following wells:

Lost Tank "3" Fed. Well No. 4
1330 feet FNL & 330 feet FWL
SW $\frac{1}{4}$ NW $\frac{1}{4}$ (Unit E) S3

Lost Tank "4" Fed. Well No. 7
1330 feet FNL & 660 feet FEL
SE $\frac{1}{4}$ NE $\frac{1}{4}$ (Unit H) S4

*No. 1 & 2
No. 2
Vet*

All in Township 22 South, Range 31 East, NMPM, Eddy County, New Mexico.

The wells will be drilled to test the Delaware formation (West Lost Tank-Delaware Pool). The pool is governed by statewide rules, with 40 acre spacing and wells to be located no closer than 330 feet to a quarter-quarter section line.

The subject acreage is in the oil-potash area of southeast New Mexico, and the proposed locations are non-standard due to potash reasons.

The original location for the Lost Tank "3" Fed. Well No. 4 was orthodox, 1650 feet FNL and 660 feet FWL. **Exhibit A.** However, the Bureau of Land Management ("BLM") denied that location based on potash concerns. **Exhibit B.** Negotiations with the BLM resulted in an alternate location described above. Copies of the APD (Form 3160-3) and Form C-102 submitted to the BLM for the unorthodox

location are attached as Exhibit C.

The original location for the Lost Tank "4" Fed. Well No. 7 was also orthodox, 1650 feet FNL and 430 feet FEL. **Exhibit D.** The BLM denied that location due to potash concerns. **Exhibit E.** Discussions with the BLM resulted in the proposed unorthodox location described above. Copies of the APD and Form C-102 submitted to the BLM for this location are attached hereto as Exhibit F.

Submitted as Exhibit G is a land plat of the subject area. All of Section 3 and all of Section 4 except the NW $\frac{1}{4}$ NW $\frac{1}{4}$ is comprised of federal lease NM 0417696, which is owned 50-50 by Pogo and Phillips Petroleum Company. Pogo operates the lease. In addition, royalty and overriding royalty ownership is common throughout the lease. Thus, no interest owner is adversely affected by the unorthodox locations, and notice is not required to be given to anyone.

This application is submitted in duplicate. Please call me if you need anything further on this matter.

Very truly yours,

A handwritten signature in cursive script, appearing to read "James Bruce".

James Bruce

Attorney for Pogo Producing Company

OPERATOR'S COPY

Form 3160-J
(July 1992)

SUBMIT IN TRIPLICATE*

FORM APPROVED
OMB NO. 1004-0136
Expires: February 28, 1995UNITED STATES
DEPARTMENT OF THE INTERIOR
BUREAU OF LAND MANAGEMENT

RECEIVED

APPLICATION FOR PERMIT TO DRILL OR DEEPEN

1. TYPE OF WORK

DRILL ☒DEEPEN ☐

ROOSEVELT, NM

2. TYPE OF WELL

OIL WELL ☒GAS WELL ☐

OTHER

SINGLE ZONE ☒MULTIPLE ZONE ☐

3. NAME OF OPERATOR

POGO PRODUCING CO

(RICHARD WRIGHT)

4. ADDRESS AND TELEPHONE

P.O. Box 10340 MIDLAND, TX 79702 Phone (915) 682-6822

5. LOCATION OF WELL (Report location clearly and in accordance with any State requirements.)

1650' FNL & 660' FWL SEC. 3 T22S-R31E EDDY CO. NM
At proposed prod. zone
Same

6. DISTANCE IN MILES AND DIRECTION FROM NEAREST TOWN OR POST OFFICE*

APPROXIMATELY 30 MILES EAST OF CARLSBAD, N.M.

7. DISTANCE FROM PROPOSED*

LOCATION TO NEAREST
PROPERTY OR LEASE LING. FT.
(Also to nearest rig, unit line, if any)

460

8. NO. OF ACRES IN LEASE

320

9. NO. OF ACRES ASSIGNED

TO THIS WELL 40

10. DISTANCE FROM PROPOSED LOCATION*
TO NEAREST WELL, DRILLING, COMPLETED,
OR APPLIED FOR, ON THIS LEASE, FT.

990'

11. PROPOSED DEPTH

8150'

12. ROTARY OR CABLE TOOL

ROTARY

13. ELEVATIONS (Show whether DV, RT, GR, etc.)

3470' GR.

14. APPROX. DATE WORK WILL START*

AS SOON AS APPROVED

15.

PROPOSED CASING AND CEMENTING PROGRAM

SIZE OF HOLE	GRADE SIZE OF CASING	WEIGHT PER FOOT	SETTING DEPTH	QUANTITY OF CEMENT
25"	20" Conductor	NA	40'	Cement to surface w/Redi-Mix
14-3/4"	H-40 10-3/4"	32.7	550'	400 sx Circulate to surface
9-7/8"	J-55 7-5/8"	26.4	4000'	1000 sx " " "
6-3/4"	J-55 4-1/2"	11.6	8150'	1500 sx " " "

1. Drill 25" hole to 40'. Set 40' of 20" conductor pipe. Cement to surface with Redi-Mix.
2. Drill 14-3/4" hole to 550'. Run & set 550' of 10-3/4" H-40 32.7# ST&C casing. Cement with 250 sx of 35/65 Class "C" POZ light + 2% CaCl, tail in with 150 sx Class "C" + 2% CaCl. Circulate cement to surface.
3. Drill 9-7/8" hole to 4000'. Run & set 4000' of 7-5/8" J-55 26.4 ST&C casing. Cement with 800 sx 35/65 Class "C" POZ + 5# Salt/sx. Tail in with 200 sx Class "C" + 2% CaCl. Circulate cement to surface.
4. Drill 6-3/4" hole to 8150'. Run & set 8150' of 4 1/2" J-55 11.6# ST&C casing. Cement in three stages: 1st stage: 500 sx Class "H" + 5% Micro Bond. 2nd stage: 400 sx Class "C" 12# Gilsontite/sx. 3rd stage: 500 sx Class "C" Halo light, tail in with 100 sx Class "C" neat. Circulate cement to surface.

IN ABOVE SPACE DESCRIBE PROPOSED PROGRAM: If proposal is to deepen, give data on present productive zone and proposed new productive zone. If proposal is to drill or deepen directionally, give prominent data on subsurface locations and measured and true vertical depths. Give blowout prevention program, if any.

SIGNED

Robert J. Davis

TITLE

AGENT

DATE 07/29/97

(This space for Federal or State office use)

PERMIT NO.

APPROVAL DATE

Application approval does not warrant or certify that the applicant holds legal or equitable title to those rights in the subject lease which would entitle the applicant to conduct operations thereon.

CONDITIONS OF APPROVAL, IF ANY:

APPROVED BY

TITLE

*See Instructions On Reverse Side

Title 18 U.S.C. Section 1001, makes it a crime for any person knowingly and willfully to make to United States any false, fictitious or fraudulent statements or representations as to any matter within

EXHIBIT

A

DISTRICT I

P.O. Box 1000, Hobbs, NM 88241-1000

State of New Mexico

Energy, Minerals and Natural Resources Department

Form C-102

Revised February 10, 1984

Submit to Appropriate District Office

State Lease - 4 Copies

Fee Lease - 3 Copies

DISTRICT II

P.O. Box 22, Aracoma, NM 88211-0022

DISTRICT III

1000 Rio Grande Rd., Artes, NM 87410

OIL CONSERVATION DIVISION

P.O. Box 2088

Santa Fe, New Mexico 87504-2088

DISTRICT IV

P.O. Box 2000, Santa Fe, NM 87504-2000

☐ AMENDED REPORT

WELL LOCATION AND ACREAGE DEDICATION PLAT

API Number	Pool Code	Pool Name
	96582	TRIPLE "P" DELAWARE
Property Code	Property Name	Well Number
20943	LOST TANK "3" FEDERAL	4
OGREI No.	Operator Name	Elevation
17891	POGO PRODUCING COMPANY	3470

Surface Location

UL or lot No.	Section	Township	Range	Lot Idn	Feet from the	North/South line	Feet from the	East/West line	County
E	3	22 S	31 E		1650	NORTH	660	WEST	EDDY

Bottom Hole Location If Different From Surface

UL or lot No.	Section	Township	Range	Lot Idn	Feet from the	North/South line	Feet from the	East/West line	County

Dedicated Acres	Joint or Infill	Consolidation Code	Order No.
40			

NO ALLOWABLE WILL BE ASSIGNED TO THIS COMPLETION UNTIL ALL INTERESTS HAVE BEEN CONSOLIDATED
OR A NON-STANDARD UNIT HAS BEEN APPROVED BY THE DIVISION

	<p>OPERATOR CERTIFICATION</p> <p>I hereby certify that the information contained herein is true and complete to the best of my knowledge and belief.</p> <p><i>Joe T. Janica</i> Signature Joe T. Janica Printed Name Agent 07/29/97 Date</p> <p>SURVEYOR CERTIFICATION</p> <p>I hereby certify that the well location shown on this plat was plotted from field notes of actual surveys made by me or under my supervision and that the same is true and correct to the best of my belief.</p> <p>APRIL 9, 1997</p> <p>Date Surveyed Signed and sealed Professional Surveyor NEW MEXICO 4/6/97 P.O. Box 97-160543 Certificate No. 3238 WEST, EDDY, NEW MEXICO, 87504-2088 C. EIDSON, 12841</p>
--	---

EXHIBIT "A"



United States Department of the Interior

BUREAU OF LAND MANAGEMENT

New Mexico State Office
1474 Rodeo Road
P. O. Box 27115
Santa Fe, New Mexico 87502-0115

RECEIVED

MAR 19 1998

MIDLAND

IN REPLY REFER TO:
3160(06200)
NM-0417696

MAR 6 1998

CERTIFIED--RETURN RECEIPT REQUESTED
P 382 821 519

Pogo Producing Company
Attention: Richard Wright
P. O. Box 10340
Midland, TX 79702

RE: Lost Tank "3" Federal #4
NM-0417696
1650' FNL & 660' FWL, Sec. 3, T22S, R31E
Eddy County, New Mexico

Dear Mr. Wright:

Your proposed oil and gas well is located in the Secretary of the Interior's Potash Area as described by 1986 Secretarial Order. In accordance with the order, we have designated areas within the Potash Area as a Potash Enclave. The enclave contains measured potassium mineral resources of sufficient quality and quantity to be technologically and economically minable using standard mining practices.

Regrettably, your proposed well must be denied. Drilling at the proposed location would likely interfere with future potash mining and result in undue waste of known enclave reserves. In the future, it could also prove hazardous to the health and safety of potash miners.

Your copies of the application are being returned. Any party adversely affected by this decision may appeal to the Interior Board of Land Appeals in accordance with 43 CFR 3165.4 and Form 1842-1 (enclosed).

Please contact our Carlsbad Resource Area Office Solid Minerals Staff at (505) 887-6544 should you have questions regarding alternative locations or need other assistance on matters involving potash mining.

Sincerely,

for Gilbert J. Lucero
Acting State Director

2 Enclosures

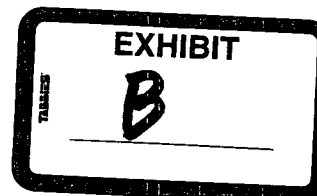

Form 3150-3
(July 1992)SUBMIT IN TRIPPLICATE
(Other instructions on
reverse side)FORM APPROVED
OMB NO. 1004-0136
Expires: February 28, 1995UNITED STATES
DEPARTMENT OF THE INTERIOR
BUREAU OF LAND MANAGEMENT

APPLICATION FOR PERMIT TO DRILL OR DEEPEN

1. TYPE OF WORK DRILL <input checked="" type="checkbox"/> DEEPEN <input type="checkbox"/>		2. LEASE DESIGNATION AND SERIAL NO. NM-0417696	
3. TYPE OF WELL OIL WELL <input checked="" type="checkbox"/> GAS WELL <input type="checkbox"/> OTHER <input type="checkbox"/>		3. IF INDIAN, ALLOTTEE OR TRIBE NAME ---	
4. NAME OF OPERATOR POGO PRODUCING CO (RICHARD WRIGHT)		4. UNIT ACCESSION NAME ---	
5. ADDRESS AND TELEPHONE NO. P.O. Box 10340 MIDLAND, TX 79702 Phone (915) 682-6822		5. FARM OR LEASE NAME WELL NO. LOST TANK "3" FEDERAL # 4	
6. LOCATION OF WELL (Report location clearly and in accordance with any State requirements.) At surface 1330' FNL & 330' FWL SEC. 3 T22S-R31E EDDY CO. NM At proposed prod. zone: Same		6. SURVEY NO. ---	
7. DISTANCE IN MILES AND DIRECTION FROM NEAREST TOWN OR POST OFFICE APPROXIMATELY 30 MILES EAST OF CARLSBAD, N.M.		7. FIELD AND POOL OR WILDCAT LOST TANK DELAWARE WEST	
8. DISTANCE FROM PROPOSED LOCATION TO NEAREST PROPERTY OR LEASE LINE, FT. (Also in nearest 616. Unit (lbs. if any.) 330'		8. SEC. T. R. M. OR BLC. AND SURVEY OR AREA SEC 3 T22S R31E	
9. DISTANCE FROM PROPOSED LOCATION TO NEAREST WELL, DRILLING, COMPLETED, OR APPLIED FOR, ON THIS LEASE, FT. 990'		9. COUNTY OR PARISH EDDY CO	
10. NO. OF ACRES IN LEASE 320		10. STATE N.M.	
11. PROPOSED DEPTH 8150'		11. NO. OF ACRES ASSIGNED TO THIS WELL 40	
12. ROTARY OR CASEL TOOLS ROTARY		12. APPROX. DATE WORK WILL START AS SOON AS APPROVED	
13. ELEVATIONS (Show whether OF, AT, OR, etc.) 3474' GR.			

PROPOSED CASING AND CEMENTING PROGRAM

SIZE OF HOLE	GRADE SIZE OF CASING	WEIGHT PER FOOT	SETTING DEPTH	QUANTITY OF CEMENT
25"	20" Conductor	NA	40'	Cement to surface w/Redi-Mix
14-3/4"	H-40 10-3/4"	32.7	550'	400 sx Circulate to surface
9-7/8"	J-55 7-5/8"	26.4	4000'	1000 sx " " "
6-3/4"	J-55 4-1/2"	11.6	8150'	1500 sx " " "

1. Drill 25" hole to 40'. Set 40' of 20" conductor pipe. Cement to surface with Redi-Mix.
2. Drill 14-3/4" hole to 550'. Run & set 550' of 10-3/4" H-40 32.7# ST&C casing. Cement with 250 sx of 35/65 Class "C" POZ light + 2% CaCl. Tail in with 150 sx Class "C" + 2% CaCl. Circulate cement to surface.
3. Drill 9-7/8" hole to 4000'. Run & set 4000' of 7-5/8" J-55 26.4 ST&C casing. Cement with 800 sx 35/65 Class "C" POZ + 5% Salt/sx. Tail in with 200 sx Class "C" + 2% CaCl. Circulate cement to surface.
4. Drill 6-3/4" hole to 8150'. Run & set 8150' of 4 1/2" J-55 11.6# ST&C casing. Cement in three stages: 1st stage: 500 sx Class "H" + 5% Micro Bond. 2nd stage: 400 sx Class "C" 12# Gilsontite/sx. 3rd stage: 500 sx Class "C" Halco light, tail in with 100 sx Class "C" neat. Circulate cement to surface.

IN ABOVE SPACE DESCRIBE PROPOSED PROGRAM: If proposal is to develop, give data on present productive zone and proposed new productive zone. If proposal is to drill or deepen directionally, give pertinent data on subsurface locations and measures and their vertical depths. Give blowout prevention program, if any.

SIGNED

TITLE

AGENT

DATE

06/25/98

(This space for Federal or State office use)

PERMIT NO.

APPROVAL DATE

Application approval does not warrant or certify that the applicant holds legal or equitable title to those rights in the subject lease which would entitle the applicant to conduct operations thereon.

CONVENTIONS OF APPROVAL, IF ANY:

APPROVED BY

TITLE

*See Instructions On Reverse Side

File 18 U.S.C. Section 1001, makes it a crime for any person knowingly and willfully to make in a titled States any false, fictitious or fraudulent statements or representations as to any matter with

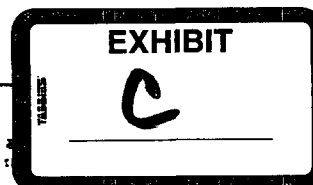

DISTRICT I

P.O. Box 1002, Santa Fe, NM 87504-1002

State of New Mexico

Energy, Minerals and Natural Resources Department

DISTRICT II

P.O. Box 200, Santa Fe, NM 87501-0200

DISTRICT III

1000 El Estero Rd., Santa Fe, NM 87410

DISTRICT IV

P.O. Box 2000, Santa Fe, NM 87504-2000

OIL CONSERVATION DIVISION

P.O. Box 2088

Santa Fe, New Mexico 87504-2088

Form C-102
 Revised February 10, 1996
 Submit to Appropriate District Office
 State Lease - 4 Copies
 Fee Lease - 3 Copies

☐ AMENDED REPORT

WELL LOCATION AND ACREAGE DEDICATION PLAT

API Number	Pool Code 96532	Pool Name
Property Code	Property Name	Well Number
20943	LOST TANK "J" FEDERAL	4
OSRD No.	Operator Name	Elevation
17891	POGO PRODUCING COMPANY	3474

Surface Location

UL or lot No.	Section	Township	Range	Lot Idn	Feet from the	North/South Line	Feet from the	East/West Line	County
E	3	22 S	31 E		1330	NORTH	330	WEST	EDDY

Bottom Hole Location If Different From Surface

UL or lot No.	Section	Township	Range	Lot Idn	Feet from the	North/South Line	Feet from the	East/West Line	County

Dedicated acre	Joint or Infill	Consolidation Code	Order No.
40			

NO ALLOWABLE WILL BE ASSIGNED TO THIS COMPLETION UNTIL ALL INTERESTS HAVE BEEN CONSOLIDATED
 OR A NON-STANDARD UNIT HAS BEEN APPROVED BY THE DIVISION

LOT 4 39.65 AC.	LOT 3 39.78 AC.	LOT 2 39.92 AC.	LOT 1 40.05 AC.
-----------------	-----------------	-----------------	-----------------

OPERATOR CERTIFICATION

I hereby certify that the information contained herein is true and complete to the best of my knowledge and belief.

Joe T. Janica
 Signature
 Joe T. Janica
 Printed Name
 Agent
 Title
 Date 06/25/98

SURVEYOR CERTIFICATION

I hereby certify that the well location shown on this plat was plotted from field notes of actual surveys made by me or under my supervision and that the same is true and correct to the best of my belief.

JUNE 15, 1998

Date Surveyed JLP

Signature of State of Professional Surveyor
Ronald E. Bullock
 R.E.B. 98-750907

Certificate No. 3239
 CARL G. EIDSON
 PROFESSIONAL SURVEYOR 12:08

EXHIBIT "A"

Form 3160-3
(July 1992)

N. M. Oil Cons. Division

DUPLICATE

FORM APPROVED
OMB NO. 1004-0134
Expires: February 28, 1995UNITED STATES
DEPARTMENT OF THE INTERIOR
BUREAU OF LAND MANAGEMENT

ARTESIA, NM RECEIVED

4-22-98 MAY 15 1998

APPLICATION FOR PERMIT TO DRILL OR DEEPEN

1. TYPE OF WORK

DRILL ☒DEEPEN ☐

MIDLAND

2. TYPE OF WELL

OIL
WELL ☒GAS
WELL ☐

OTHER

SINGLE
ZONE ☒MULTIPLE
ZONE ☐

3. NAME OF OPERATOR

POGO PRODUCING CO

(RICHARD WRIGHT)

4. ADDRESS AND TELEPHONE NO.

P.O. Box 10340 MIDLAND, TX 79702 Phone (915) 682-6822

5. LOCATION OF WELL (Report location clearly and in accordance with 43 CFR State requirements.)

At surface
1650' FNL & 430' FEL SEC. 4 T22S-R31E EDDY CO
At proposed prod. zone
Same

6. DISTANCE IN MILES AND DIRECTION FROM NEAREST TOWN OR POST OFFICE

APPROXIMATELY 30 MILES EAST OF CARLSBAD, N.M.

7. DISTANCE FROM PROPOSED

LOCATION TO NEAREST
PROPERTY OR LEASE LINE, FT.
(Also to nearest drig. unit line, if any)

430'

8. DISTANCE FROM PROPOSED LOCATION

TO NEAREST WELL, DRILLING, COMPLETED,
OR APPLIED FOR, ON THIS LEASE, FT.

1220'

9. ELEVATIONS (Show whether DP, RT, GR, etc.)

3463' GR.

10.

PROPOSED CASING AND CEMENTING PROGRAM

SIZE OF HOLE	GRADE SIZE OF CASING	WEIGHT PER FOOT	SETTING DEPTH	QUANTITY OF CEMENT
25"	20" Conductor	NA	40'	Cement to surface w/Redi-Mix
14-3/4"	H-40 10-3/4"	32.7	550'	400 sx Circulate to surface
9-7/8"	J-55 7-5/8"	26.4	4000'	1000 sx " " "
6-3/4"	J-55 4-1/2"	11.6	8150'	1500 sx " " "

1. Drill 25" hole to 40'. Set 40' of 20" conductor pipe. Cement to surface with Redi-Mix.
2. Drill 14-3/4" hole to 550'. Run & set 550' of 10-3/4" H-40 32.7# ST&C casing. Cement with 250 sx of 35/65 Class "C" POZ light + 2% CaCl, tail in with 150 sx Class "C" + 2% CaCl. Circulate cement to surface.
3. Drill 9-7/8" hole to 4000'. Run & set 4000' of 7-5/8" J-55 26.4 ST&C casing. Cement with 800 sx 35/65 Class "C" POZ + 5# Salt/sx. Tail in with 200 sx Class "C" + 2% CaCl. Circulate cement to surface.
4. Drill 6-3/4" hole to 8150'. Run & set 8150' of 4 1/2" J-55 11.6# ST&C casing. Cement in three stages: 1st stage: 500 sx Class "H" + 5% Micro Bond. 2nd stage: 400 sx Class "C" 12# Gilsonite/sx. 3rd stage: 500 sx Class "C" Halco light, tail in with 100 sx Class "C" neat. Circulate cement to surface.

IN ABOVE SPACE DESCRIBE PROPOSED PROGRAM: If proposal is to deepen, give data on present productive zone and proposed new productive zone. If proposal is to drill or deepen directionally, give pertinent data on subsurface locations and measured and true vertical depths. Give blowout prevention program, if any.

24.

SIGNED

Joe T. [Signature]

TITLE

AGENT

DATE

04/21/97

(This space for Federal or State office use)

PERMIT NO.

APPROVAL DATE

Application approval does not warrant or certify that the applicant holds legal or equitable title to those rights in the subject lease which would entitle the applicant to conduct operations thereon.

CONDITIONS OF APPROVAL, IF ANY:

APPROVED BY

TITLE

*See Instructions On Reverse Side

Title 18 U.S.C. Section 1001, makes it a crime for any person knowingly and willfully to make to



DISTRICT I

P.O. Box 1980, Hobbs, NM 88240-1980

DISTRICT II

P.O. Drawer 28, Arcoma, NM 88211-0719

DISTRICT III

1000 Rio Hondo Rd., Alamo, NM 87410

DISTRICT IV

P.O. Box 2088, Santa Fe, NM 87504-2088

State of New Mexico

Energy, Minerals and Natural Resources Department

Form C-102

Revised February 10, 1984

Submit to Appropriate District Office

State Lease - 4 Copies

Fee Lease - 3 Copies

OIL CONSERVATION DIVISION

P.O. Box 2088

Santa Fe, New Mexico 87504-2088

O AMENDED REPORT

WELL LOCATION AND ACREAGE DEDICATION PLAT

API Number	Pool Code	Pool Name
		TRIPLE "P" DELAWARE
Property Code	Property Name	Well Number
17955	LOST TANK "4" FEDERAL	7
OGRIID No.	Operator Name	Elevation
17891	POGO PRODUCING COMPANY	3463

Surface Location

UL or lot No.	Section	Township	Range	Lot Ida	Feet from the	North/South line	Feet from the	East/West line	County
H	4	22 S	31 E		1650	NORTH	430	EAST	EDDY

Bottom Hole Location if Different From Surface

UL or lot No.	Section	Township	Range	Lot Ida	Feet from the	North/South line	Feet from the	East/West line	County
Dedicated Acres	Joint or Infill	Consolidation Code	Order No.						
40									

NO ALLOWABLE WILL BE ASSIGNED TO THIS COMPLETION UNTIL ALL INTERESTS HAVE BEEN CONSOLIDATED
OR A NON-STANDARD UNIT HAS BEEN APPROVED BY THE DIVISION

LOT 4 39.97 AC.	LOT 3 39.85 AC.	LOT 2 39.75 AC.	LOT 1 39.63 AC.		OPERATOR CERTIFICATION I hereby certify the the information contained herein is true and complete to the best of my knowledge and belief. Signature <u>Joe T. Janica</u> Printed Name <u>Joe T. Janica</u> Agent Title Date <u>04/21/97</u>
					SURVEYOR CERTIFICATION I hereby certify that the well location shown on this plat was plotted from field notes of actual surveys made by me or under my supervision, and that the same is true and correct to the best of my belief. APRIL 9, 1997 Date Surveyed <u>APRIL 9, 1997</u> Signature & Seal of Professional Surveyor <u>JOHN G. EIDSON</u> State of New Mexico License No. <u>3239</u> Commission Expires <u>4-16-97</u> Certificate No. <u>97-120645</u> Certified by <u>JOHN G. EIDSON</u> 678 State of New Mexico Professional Surveyor <u>JOHN G. EIDSON</u> 3239 License No. <u>120645</u>



United States Department of the Interior

BUREAU OF LAND MANAGEMENT

New Mexico State Office
1474 Rodeo Road
P. O. Box 27115
Santa Fe, New Mexico 87502-0115

IN REPLY REFER TO:
3160(06200)
NM-0417696

RECEIVED

MAY - 6 1998

APR 30 1998

CERTIFIED--RETURN RECEIPT REQUESTED
P 144 849 400

MIDLAND

Pogo Producing Company
Attention: Richard Wright
P. O. Box 10340
Midland, TX 79702

RE: Lost Tank "4" Federal #7
NM-0417696
1650' FNL & 430' FEL, Sec. 4, T22S, R31E
Eddy County, New Mexico

Dear Mr. Wright:

Your proposed oil and gas well is located in the Secretary of the Interior's Potash Area as described by 1986 Secretarial Order. In accordance with the order, we have designated areas within the Potash Area as a Potash Enclave. The enclave contains measured potassium mineral resources of sufficient quality and quantity to be technologically and economically minable using standard mining practices.

Regrettably, your proposed well must be denied. Drilling at the proposed location would likely interfere with future potash mining and result in undue waste of known enclave reserves. In the future, it could also prove hazardous to the health and safety of potash miners.

Your copies of the application are being returned. Any party adversely affected by this decision may appeal to the Interior Board of Land Appeals in accordance with 43 CFR 3165.4 and Form 1842-1 (enclosed).

Please contact our Carlsbad Resource Area Office Solid Minerals Staff at (505) 887-6544 should you have questions regarding alternative locations or need other assistance on matters involving potash mining.

Sincerely,

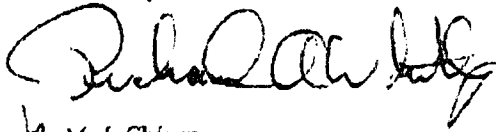
M. J. Chávez
State Director

2 Enclosures

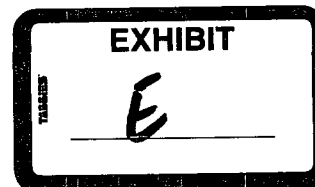

UNITED STATES
DEPARTMENT OF THE INTERIOR
BUREAU OF LAND MANAGEMENT

APPLICATION FOR PERMIT TO DRILL OR DEEPEN

1A. TYPE OF WORK

DRILL ☒DEEPEN ☐

B. TYPE OF WELL

OIL
WELL ☒GAS
WELL ☐OTHER ☐SINGLE
ZONE ☐MULTIPLE
ZONE ☐

2. NAME OF OPERATOR

POGO PRODUCING CO

(RICHARD WRIGHT)

3. ADDRESS AND TELEPHONE NO.

P.O. Box 10340 MIDLAND, TC 79702 Phone (915) 682-6822

4. LOCATION OF WELL (Report location clearly and in accordance with any State requirements.)
At surface

1330' FNL & 660' FEL SEC. 4 T22S-R31E EDDY CO. NM

At proposed prod. zone

Same

14. DISTANCE IN MILES AND DIRECTION FROM NEAREST TOWN OR POST OFFICE*

APPROXIMATELY 30 MILES EAST OF CARLSBAD, N.M.

15. DISTANCE FROM PROPOSED*
LOCATION TO NEAREST
PROPERTY OR LEASE LINE, FT.
(Also to nearest drilg. unit line, if any)

660'

16. NO. OF ACRES IN LEASE

320

17. NO. OF ACRES ASSIGNED
TO THIS WELL

40

18. DISTANCE FROM PROPOSED LOCATION*
TO NEAREST WELL, DRILLING, COMPLETED,
OR APPLIED FOR, ON THIS LEASE, FT.

875'

19. PROPOSED DEPTH

8150'

20. ROTARY OR CABLE TOOLS

ROTARY

21. ELEVATIONS (Show whether BP, RT, GR, etc.)

3461' GR.

22. APPROX. DATE WORK WILL START*

AS SOON AS APPROVED

23.

PROPOSED CASING AND CEMENTING PROGRAM

SIZE OF HOLE	GRADE, SIZE OF CASING	WEIGHT PER FOOT	SETTING DEPTH	QUANTITY OF CEMENT
25"	20" Conductor	NA	40'	Cement to surface w/Redi-Mix
14-3/4"	H-40 10-3/4"	32.7	550'	400 sx Circulate to surface
9-7/8"	J-55 7-5/8"	26.4	4000'	1000 sx " " "
6-3/4"	J-55 4-1/2"	11.6	8150'	1500 sx " " "

1. Drill 25" hole to 40'. Set 40' of 20" conductor pipe. Cement to surface with Redi-Mix.
2. Drill 14-3/4" hole to 550'. Run & set 550' of 10-3/4" H-40 32.7# ST&C casing. Cement with 250 sx of 35/65 Class "C" POZ light + 2% CaCl, tail in with 150 sx Class "C" + 2% CaCl. Circulate cement to surface.
3. Drill 9-7/8" hole to 4000'. Run & set 4000' of 7-5/8" J-55 26.4 ST&C casing. Cement with 800 sx 35/65 Class "C" POZ + 5# Salt/sx. Tail in with 200 sx Class "C" + 2% CaCl. Circulate cement to surface.
4. Drill 6-3/4" hole to 8150'. Run & set 8150' of 4 1/2" J-55 11.6# ST&C casing. Cement in three stages: 1st stage: 500 sx Class "H" + 5% Micro Bond. 2nd stage: 400 sx Class "C" 12# Gilsomite/sx. 3rd stage: 500 sx Class "C" Balco light, tail in with 100 sx Class "C" neat. Circulate cement to surface.

IN ABOVE SPACE DESCRIBE PROPOSED PROGRAM: If proposal is to deepen, give data on present productive zone and proposed new productive zone. If proposal is to drill or deepen directionally, give pertinent data on subsurface locations and measured and true vertical depths. Give blowout preventer program, if any.

SIGNED [Signature] TITLE AGENT DATE 06/25/98

(This space for Federal or State police use)

PERMIT NO. _____

APPROVAL DATE _____

Application approval does not warrant or certify that the applicant holds legal or equitable title to those rights in the subject lease which would entitle the applicant to conduct operations thereon.

CONDITIONS OF APPROVAL, IF ANY:

APPROVED BY _____

TITLE _____

*See Instructions On Reverse Side

Title 18 U.S.C. Section 1001, makes it a crime for any person knowingly and willfully to make to United States any false, fictitious or fraudulent statements or representations as to any matter with



DISTRICT I

P.O. Box 1000, Hobbs, NM 88240-1000

DISTRICT II

P.O. Drawer 333, Artesia, NM 88211-0710

DISTRICT III

1000 Rio Grande Rd., Aztec, NM 87410

DISTRICT IV

P.O. Box 2000, Santa Fe, NM 87504-2000

State of New Mexico

Energy, Minerals and Natural Resources Department

OIL CONSERVATION DIVISION

P.O. Box 2088

Santa Fe, New Mexico 87504-2088

Form C-102

Revised February 10, 1996
Submit to Appropriate District Office
State Lease - 4 Copies
Fee Lease - 3 Copies☐ AMENDED REPORT**WELL LOCATION AND ACREAGE DEDICATION PLAT**

API Number	Pool Code	Pool Name
	96582	LOST TANK DELAWARE WEST
Property Code	Property Name	Well Number
20943	LOST TANK "4" FEDERAL	7
OCRD No.	Operator Name	Elevation
17891	POGO PRODUCING COMPANY	3461

Surface Location

UL or lot No.	Section	Township	Range	Lot 1/4	Feet from the	North/South line	Feet from the	East/West line	County
H	4	22 S	31 E		1330	NORTH	660	EAST	EDDY

Bottom Hole Location If Different From Surface

UL or lot No.	Section	Township	Range	Lot 1/4	Feet from the	North/South line	Feet from the	East/West line	County
Dedicated Acres	Joint or Infill	Consolidation Code	Order No.						
40									

NO ALLOWABLE WILL BE ASSIGNED TO THIS COMPLETION UNTIL ALL INTERESTS HAVE BEEN CONSOLIDATED
OR A NON-STANDARD UNIT HAS BEEN APPROVED BY THE DIVISION

LOT 4 39.97 AC.	LOT 3 39.85 AC.	LOT 2 39.75 AC.	LOT 1 39.65 AC.	<p>1330</p> <p>1650</p> <p>3458.2'</p> <p>3487.9'</p> <p>3457.7'</p> <p>3450.1'</p> <p>230</p> <p>430</p> <p>1650</p> <p>1330</p> <p>320</p> <p>660</p> <p>430</p> <p>230</p>	<p>OPERATOR CERTIFICATION</p> <p>I hereby certify that the information contained herein is true and complete to the best of my knowledge and belief.</p> <p><i>Joe T. Janica</i></p> <p>Signature</p> <p>Joe T. Janica</p> <p>Printed Name</p> <p>Agent</p> <p>Title</p> <p>06/25/98</p> <p>Date</p> <p>SURVEYOR CERTIFICATION</p> <p>I hereby certify that the well location shown on this plat was plotted from field notes of actual surveys made by me or under my supervision and that the same is true and correct to the best of my belief.</p> <p>JUNE 15, 1998</p> <p>Date Surveyed</p> <p>Signature of State of Professional Surveyor</p> <p><i>Ronald J. Edson</i></p> <p>6-17-98</p> <p>P.O. Num 98-120908</p> <p>Certificate No. RONALD J. EDSON, 3238 CARY G. EDSON, 12041 WILLIAM J. EDSON, 12183</p>
-----------------	-----------------	-----------------	-----------------	---	--

EXHIBIT "A"

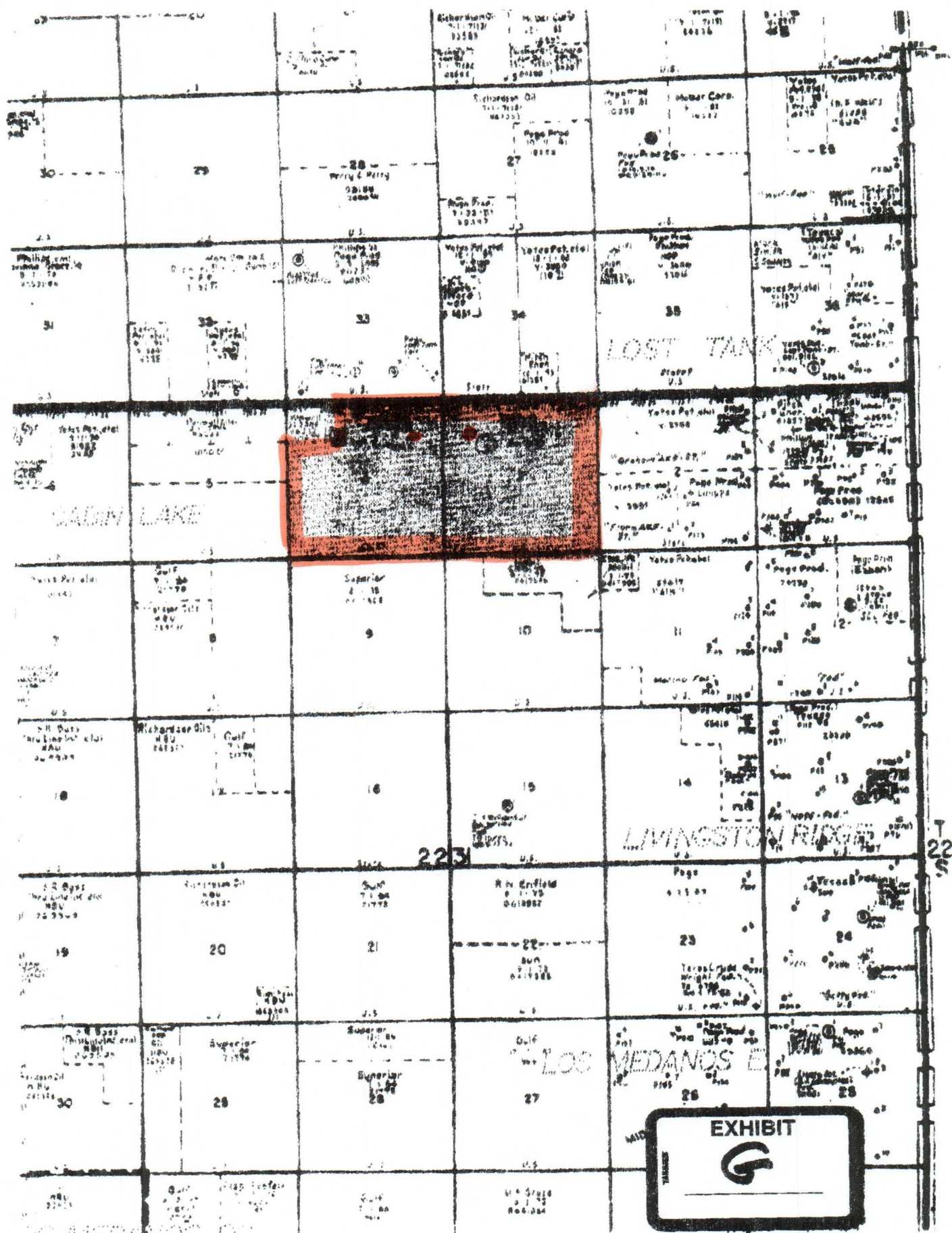

EXHIBIT
G

County Eddy Pool West Lost Tank- Delaware

TOWNSHIP 21 South Range 31 East NMPM

6	5	4	3	2	1
7	8	9	10	11	12
18	17	16	15	14	13
19	20	21	22	23	24
30	29	28	27	26	25
31	32	33	34	35	36

Description: 5/2 Sec. 33 (R-10787, 4-9-97)

Ext. NE 1/4 Sec. 33 (R-10844, 7-16-97)

County Eddy Pool West Lost Tank-Delaware

TOWNSHIP 22 South Range 31 East NMPM

6	5	4	3	2	1		
7	8	9	10	11	12		
18	17	16	15	14	13		
19	20	21	22	23	24		
30	29	28	27	26	25		
31	32	33	34	35	36		

Description: NW 1/4 Sec. 4 (R-10782, 4-9-97)

Ext: NW 1/4 Sec. 3, NE 1/4 Sec. 4 (R-10951, 2-4-98)

CMD :
OG5SECT

ONGARD
INQUIRE LAND BY SECTION

08/30/98 12:28:25
OGOIV -EMDW
PAGE NO: 1

Sec : 03 Twp : 22S Rng : 31E Section Type : NORMAL

4 39.65 Federal owned R A	3 39.78 Federal owned R A	2 39.92 Federal owned R	1 40.05 Federal owned R
E 40.00 Federal owned R	F 40.00 Federal owned R A	G 40.00 Federal owned R	H 40.00 Federal owned R

PF01 HELP
PF07 BKWD

PF02
PF08 FWD

PF03 EXIT
PF09 PRINT

PF04 GoTo
PF10 SDIV

PF05
PF11

PF06
PF12