

(SUBMIT IN TRIPLICATE)

UNITED STATES  
DEPARTMENT OF THE INTERIOR  
GEOLOGICAL SURVEY

Land Office Santa Fe  
Lease No. 078498  
Unit San Juan 28-7 Unit  
14-08-001-459

SUNDRY NOTICES AND REPORTS ON WELLS

NOTICE OF INTENTION TO DRILL	<input checked="" type="checkbox"/>	SUBSEQUENT REPORT OF WATER SHUT-OFF	
NOTICE OF INTENTION TO CHANGE PLANS		SUBSEQUENT REPORT OF SHOOTING OR ACIDIZING	
NOTICE OF INTENTION TO TEST WATER SHUT-OFF		SUBSEQUENT REPORT OF ALTERING CASING	
NOTICE OF INTENTION TO RE-DRILL OR REPAIR WELL		SUBSEQUENT REPORT OF RE-DRILLING OR REPAIR	
NOTICE OF INTENTION TO SHOOT OR ACIDIZE		SUBSEQUENT REPORT OF ABANDONMENT	
NOTICE OF INTENTION TO PULL OR ALTER CASING		SUPPLEMENTARY WELL HISTORY	
NOTICE OF INTENTION TO ABANDON WELL			

(INDICATE ABOVE BY CHECK MARK NATURE OF REPORT, NOTICE, OR OTHER DATA)

February 19, 1957

Well No. 70 is located 890 ft. from N line and 2250 ft. from W line of sec. 33  
SW/4 Sec. 33 28N 7W NM  
(1/4 Sec. and Sec. No.) (Twp.) (Range) (Meridian)  
Blanco Rio Arriba New Mexico  
(Field) (County or Subdivision) (State or Territory)

The elevation of the derrick floor above sea level is 6648 ft.

DETAILS OF WORK

(State names of and expected depths to objective sands; show sizes, weights, and lengths of proposed casings; indicate mudding jobs, cementing points, and all other important proposed work)

It is intended to drill a well with rotary tools thru the Mesa Verde formation. Mud circulation will be used thru the Pictured Cliffs and set intermediate casing. Gas circulation will be used thru the Mesa Verde and production casing will be set. Possible productive intervals will be perforated and fractured. Estimated T.D. 5580'.

Casing Program:

10 3/4" at 120' with 125 sacks cement circulated to the surface.  
7 5/8" at 3310' with 250 sacks cement.  
5 1/2" at 5580' with 300 sacks cement.

The W/2 of Section 33 is dedicated to this well.

W/2 SP 078498.

I understand that this plan of work must receive approval in writing by the Geological Survey before operations may be commenced.

Company El Paso Natural Gas Company

Address Box 997

Farmington, New Mexico

Original Signed EWELL N. WALSH  
By

Title Petroleum Engineer

## OIL CONSERVATION COMMISSION

## WELL LOCATION AND/OR GAS PRORATION PLAT

DATE **FEBRUARY 15, 1957**OPERATOR **EL PASO NATURAL GAS COMPANY** LEASE **SAN JUAN 28-7 UNIT** SF **078498**WELL NO. **70** SECTION **33** T. AND R. **28 N** RANGE **7 W** NMPA:LOCATED **890** FEET FROM **SOUTH** LINE **2250** FEET FROM **WEST** LINE**RIO ARRIBA** COUNTY, NEW MEXICO **6638**NAME OF PRODUCING FORMATION **MESA VERDE** IN OF **BLANCO** ESTIMATED ACREAGE **316 AC.**  
(1917 PLAT)

Note: All distances must be from outer boundaries of section.

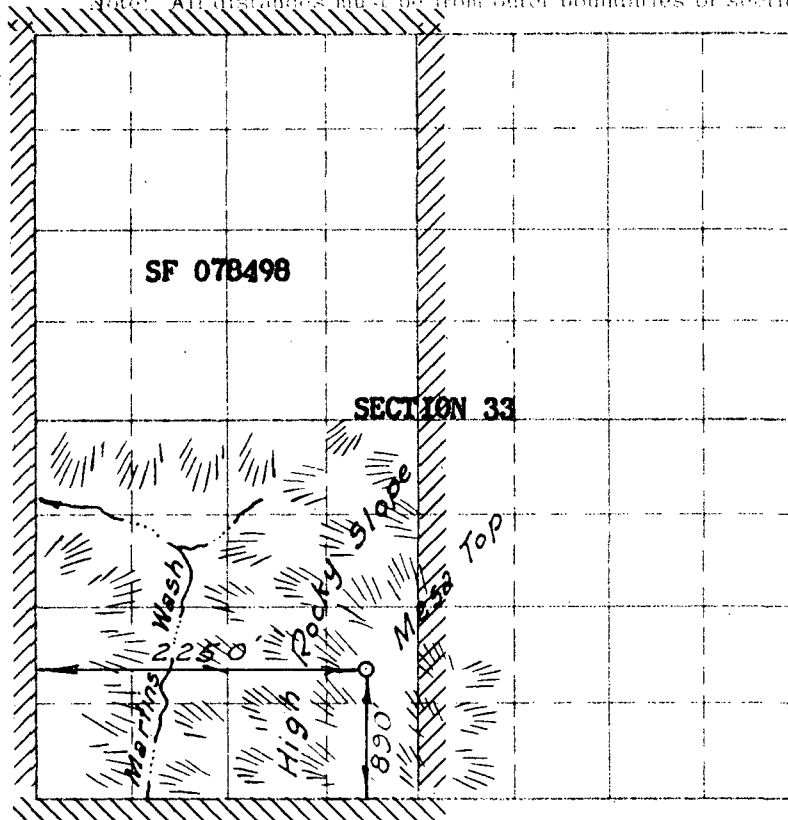

## NOTE

This section of  
form is to be used  
for gas wells only

This is to certify that the above plat was prepared from  
field notes of actual surveys made by me or under my  
supervision and that the same are true and correct to the  
best of my knowledge and belief.

Date Surveyed **FEBRUARY 12, 1957**

*E. O. Walker*  
Registered Professional Engineer and/or Land Surveyor

1. Is this well a Dual Comp.  
Yes \_\_\_\_\_ No **X**
2. If the answer to Question 1  
is yes, are there any otherdually  
completed wells within the  
dedicated acreage.  
Yes \_\_\_\_\_ No \_\_\_\_\_

Name **Original Signed EWELL N. WALSH**Position **Petroleum Engineer**Representing **El Paso Natural Gas Co.**Address **Box 997, Farmington, N.M.**

(Seal)

Farmington, New Mexico