

VAL R. REESE & ASSOCIATES, Inc.

CONSULTING GEOLOGISTS

ALBUQUERQUE, NEW MEXICO

PHONE CHAPEL 3-3569

LOBBY OF SIMMS BUILDING

May 10, 1961

1961 MAY 11 AM 8:13

*NSL
no wait
held
for later
approval*

Mr. A. L. Porter
New Mexico Oil Conservation Commission
P. O. Box 871
Santa Fe, New Mexico

Dear Mr. Porter:

As provided for in Order No. R-179-3, Rule 4B, covering the Escrito-Gallup field, ValR. Reese & Associates, Inc. request administrative approval to drill their #6-22 Lybrook well on an unorthodox location. The #6-22 Lybrook well will be a Gallup completion, located 1570 feet from the East line, and 2300 feet from the North line of Section 22, Township 24 North, Range 7 West, Escrito-Gallup Field, Rio Arriba County, New Mexico.

The unorthodox location is requested because of the extreme topographic conditions in the area north and west of the proposed location. Val R. Reese & Associates, Inc. are offset operators of all of the acreage surrounding this well.

Very truly yours,

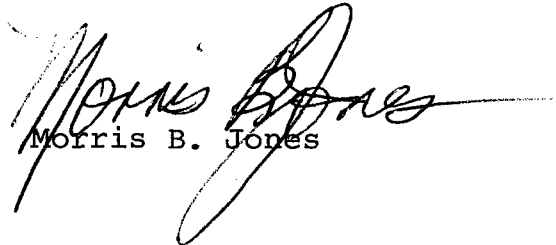
Morris B. Jones

MBJ:mm

cc: Mr. Emery Arnold
Standard Oil Co. of Texas
U.S.G.S.

NEW MEXICO OIL CONSERVATION COMMISSION

Well Location and Acreage Dedication Plat

SECTION A.

Date May 11, 1961

Operator VAL R. REESE & ASSOCIATES Lease Lybrook
 Well No. 6-22 Unit Letter G Section 22 Township 24 NORTH Range 7 WEST NMPM
 Located 2300 Feet From THE NORTH Line, 1570 Feet From THE EAST Line
 County RIO ARRIBA G. L. Elevation 6804 Dedicated Acreage 80.00 Acres
 Name of Producing Formation Gallup Pool Escrito-Gallup

1. Is the Operator the only owner* in the dedicated acreage outlined on the plat below? Yes X No
2. If the answer to question One is "No," have the interests of all the owners been consolidated by communitization agreement or otherwise? Yes No If answer is "Yes," Type of Consolidation
3. If the answer to question Two is "No," list all the owners and their respective interests below:

OWNER

LAND DESCRIPTION

SECTION B.

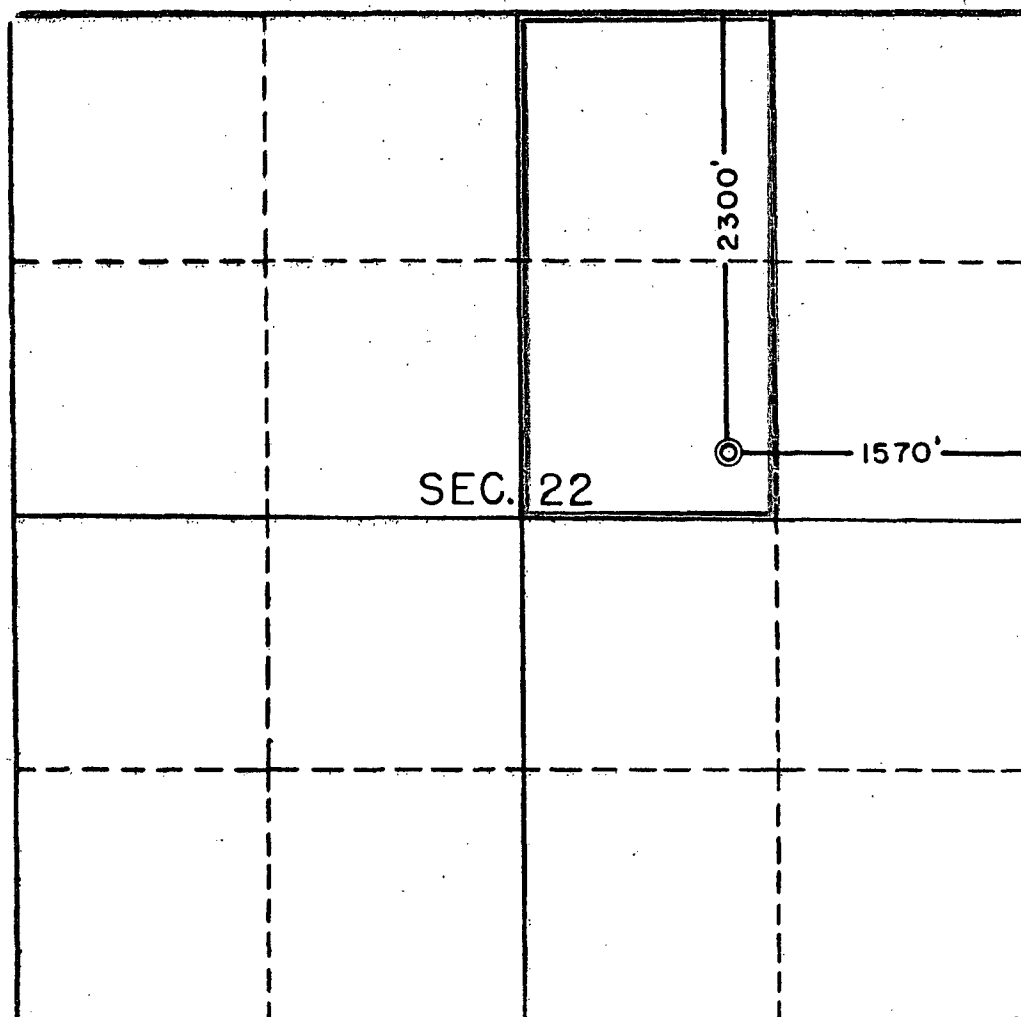

This is to certify that the information in Section A above is true and complete to the best of my knowledge and belief.

Val R. Reese & Assoc. Inc.

(OPERATOR)

Original Signed by
MORRIS B. JONES
 Morris B. Jones
 Lobby Simms Building
 Albuquerque, New Mexico
 (ADDRESS)

This is to certify that the well location shown on the plat in Section B was plotted from the notes of actual survey and that the same is true and correct to the best of my knowledge and belief.

Date Surveyed MAY 8, 1961

Four States Engineering Co.
 FARMINGTON, NEW MEXICO

Neal F. Godin
 REGISTERED ENGINEER OR
 LAND SURVEYOR

Certificate No. 2904 N.M.