

TEXACO
INC.

PETROLEUM PRODUCTS



December 29, 1964

MAIL OFFICE

65 JAN 4 AHC

DRAWER 728

HOBBS, NEW MEXICO 88240

APPLICATION OF TEXACO Inc. FOR APPROVAL
OF AN UNORTHODOX WELL LOCATION

Berry Unit Well No. 1
Undesignated Morrow Gas Pool
Lea County, New Mexico

New Mexico Oil Conservation Commission
P. O. Box 2088
Santa Fe, New Mexico

ATTENTION: Mr. A. L. Porter, Jr.

Gentlemen:

TEXACO Inc. hereby makes application for administrative approval of an unorthodox well location for its Berry Unit Well No. 1, undesignated Morrow Gas Well completion in Lea County, New Mexico and in support thereof states the following:

1. TEXACO Inc. is the operator and major interest owner of the Berry Unit Well No. 1 which is located 554 feet from the south line and 1821 feet from the west line of Section 7, T-21-S, R-34-E, Lea County, New Mexico.
2. The Berry Unit operated by TEXACO Inc. comprises 2,427.24 acres consisting of all of Section 7, the W/2 of the W/2 of Section 8, the N/2, the W/2 of the S/2, and the SW/4 of the SW/4 of Section 18, all in T-21-S, R-34-E, plus all of Section 13, the SE/4 of Section 12, the E/2 of the E/2 of Section 14, and the N/2 of the N/2 of Section 24, all in T-21-S, R-33-E, Lea County, New Mexico. The location and outline of the Berry Unit is shown in attached Plat I.
3. The TEXACO Inc. Berry Unit Well No. 1 was approved for drilling as a wildcat projected to a depth of 15,200 feet in the Devonian formation.
4. The Berry Unit Well No. 1 was spudded on October 4, 1963 and drilling was completed on March 24, 1964. The well was drilled to a total depth of 15,593 feet. The Devonian formation was found to be non-productive of oil or gas.

NSK-341
now
under 104 F
topo verified by telephone to
R 1-6-65
[Signature]

5. Commercial gas production was found in the Morrow Sand of Pennsylvanian Age and a gas completion was made through perforations at 13,908-13,918, 13,952-13,969 and 13,978-13,986 feet in the Morrow formation. On 24 hour completion test ending at 2:00 PM on June 7, 1964, the well flowed 1.22 MMCFPD of gas plus 34 barrels of condensate.
6. As provided in Commission Rule 104 (as amended by Order No. R-2707) the Berry Unit Well No. 1 is a gas well completion from a well which was originally projected as a wildcat oil well and is located accordingly, but does not conform to the applicable gas well location rule.
7. Since the Berry Unit Well No. 1 is completed in a formation of Pennsylvanian Age at a location more than one mile from the outer boundary of any defined pool or from any other well which has produced oil or gas from the Morrow formation as provided in Commission Rule 104 the standard gas proration unit size will be 320 acres more or less and as indicated on the attached plat the size and shape of the dedicated acreage conforms to standard gas proration unit requirements.
8. The location of the Berry Unit Well No. 1 does not conform to the applicable requirements of Rule 104, since it is closer than 660 feet to the nearest side boundary and closer than 1980 feet to the nearest end boundary of the dedicated acreage.
9. It was not considered desirable to drill the Berry Unit Well No. 1 at a location that would have been orthodox for a wildcat gas well because of the existence at that point of a pronounced and irregular depression in the surface of the ground. This topographical feature would have resulted in difficult and expensive operations and this wildcat well was consequently located and drilled just to the south of the surface depression.

Because of the topographical conditions which resulted in this originally projected wildcat oil well being drilled at a location which is

not orthodox for a gas completion and in view of other facts stated above, it is respectfully requested that the Commission grant an exception to well location requirements of Section B of Rule 104 without notice and hearing. As indicated on the attached plat, TEXACO Inc. as operator of the previously described Berry Unit operates all 40 acre tracts directly and diagonally offsetting the 40 acre tract upon which the unorthodox location is situated.

Your early consideration of this request will be sincerely appreciated.

Yours very truly,

TEXACO Inc.



W. B. Hubbard
District Superintendent

DMW/om

cc: Mr. Joe Ramey
Oil Conservation Commission
JMW

STATE OF NEW MEXICO)
)
COUNTY OF LEA)

Before me, the undersigned authority, on this 29th day of December, 1964, personally appeared W. B. Hubbard, known to me to be the person whose name is subscribed to this instrument, who after being by me duly sworn on oath, states that he has knowledge of all the facts stated above and that the same is a true and correct statement of the facts therein recited.

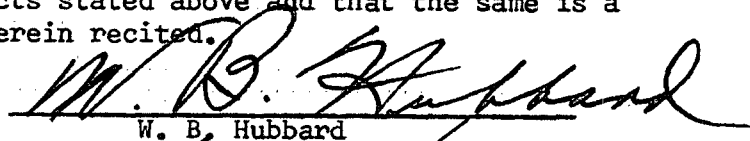

W. B. Hubbard

Subscribed and sworn to before me on this the 29th day of December, 1964.



Notary Public, Lea County, New Mexico

My commission expires June 20, 1965.

R-33-E

R-34-E

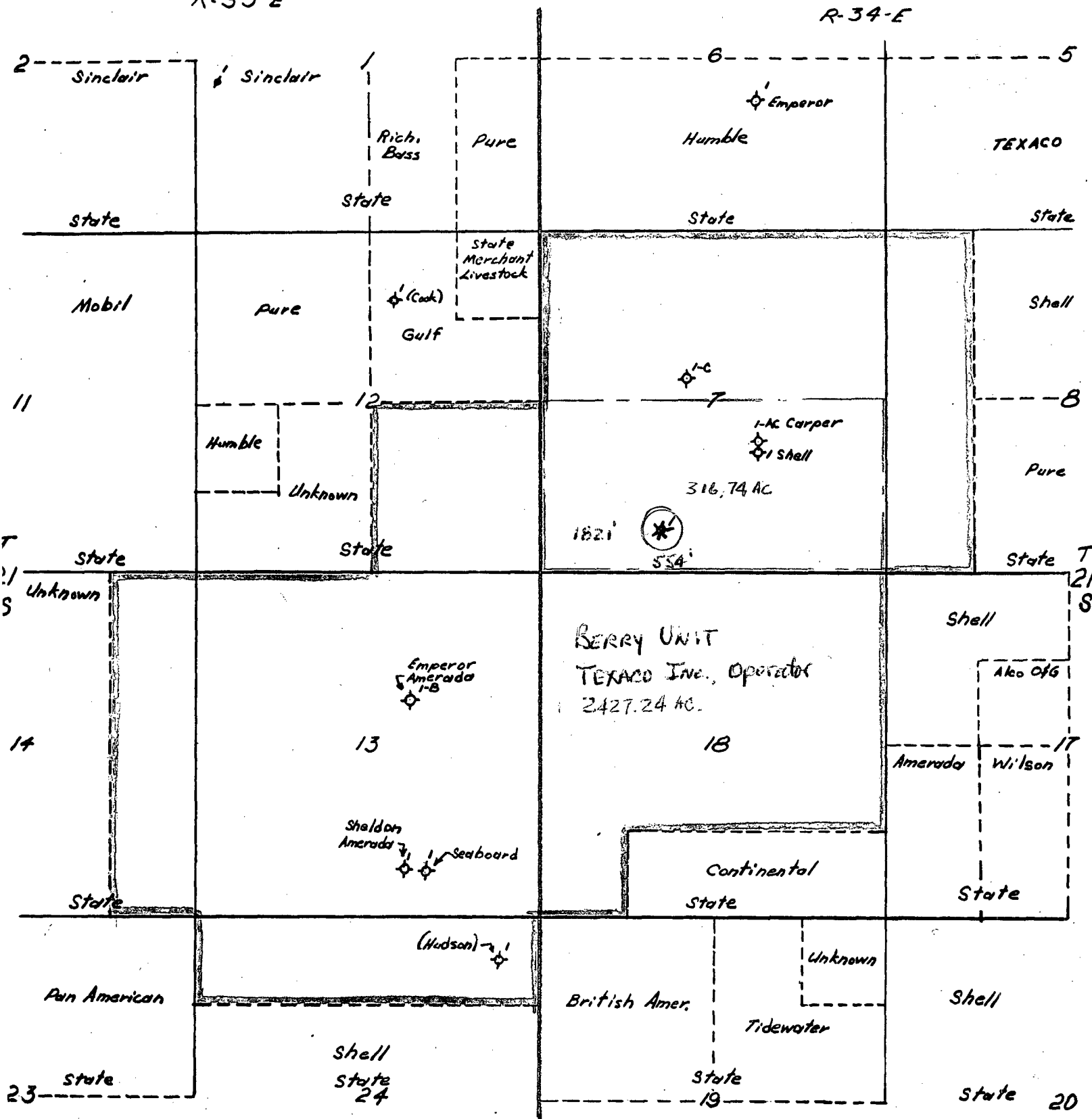

PLAT I

Berry Unit
 TEXACO Inc.-Operator
 Lea County, New Mexico
 Scale: 1" = 2000'