

Copy to Feds



POWERS ELEVATION COMPANY, INC.

OIL WELL ELEVATIONS AND LOCATIONS
CHERRY CREEK PLAZA, SUITE 1201
600 SOUTH CHERRY STREET
DENVER, COLORADO 80222
PHONE NO. 303/321-2217

November 30, 1979

*NSL-1119
Sec Form C-102
Rule 104F Immediate*

Joe D. Ramey, Director
New Mexico Oil & Gas Conservation Commission
P. O. Box 2088
Santa Fe, New Mexico 87501

RE: Amended Application for Spacing Exception
John H. Hill & Gordon L. Llewellyn
Newsom "A" #9
NW NE Sec 10 T26N R8W
605' FNL & 1705' FEL
San Juan County, New Mexico

Dear Sir:

Enclosed are duplicate copies of U.S.G.S. Sundry Form 9-331 (explaining the necessity for a spacing exception), the location and elevation plat (showing offset ownerships) and the applicable topographic map (showing location and access road).

The appropriate waivers will be sent under separate cover by Gabriel Bjerke (Landman, Supron Energy Corporation in Dallas), who confirmed this matter with me in a telephone conversation on November 28, 1979, and John Ahlm (District Landman, El Paso Exploration Company in Farmington), who confirmed this matter with me in a telephone conversation today.

Please note that this location is a farmout from Supron Energy Corporation.

Should you require any additional information in order to approve this Application for Spacing Exception, please advise. This application supersedes the one submitted on November 28, 1979.

Very truly yours,

POWERS ELEVATION

Jacqueline E. LaSasso

Jacqueline E. LaSasso

JEL/cw
Enclosures

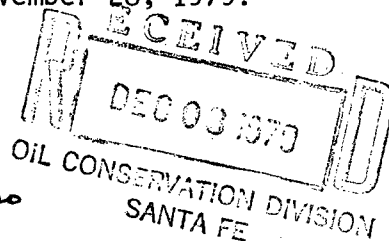

cc: (2) New Mexico Oil & Gas Conservation Commission, Aztec District Office
Gabriel Bjerke, Supron Energy Corporation, Dallas, Texas ✓
John Ahlm, El Paso Exploration Company, Farmington, New Mexico ✓
Leon Wiederkehr, Esperanza Energy Corporation, Austin, Texas
Gordon L. Llewellyn, Dallas, Texas

UNITED STATES
DEPARTMENT OF THE INTERIOR
GEOLOGICAL SURVEYSUBMIT IN TRIPPLICATE
(Other instructions on re-
verse side)Form approved,
Budget Bureau No. 42-R1424.

6. LEASE DENOMINATION AND SERIAL NO.

SF-078430

7. IF INDIAN, ALLOTTEE OR TRIBE NAME

N/A

7. UNIT AGREEMENT NAME

N/A

8. FARM OR LEASE NAME

Newsom "A"

9. WELL NO.

#9

10. FIELD AND POOL, OR WILDCAT

Wildcat

11. SEC., T., R., M., OR BLK. AND
SURVEY OR AREA

Sec. 10 T26N R8W NMPM

12. COUNTY OR PARISH

San Juan

13. STATE
New Mexico

SUNDRY NOTICES AND REPORTS ON WELLS

(Do not use this form for proposals to drill or to deepen or plug back to a different reservoir.
Use "APPLICATION FOR PERMIT—" for such proposals.)1. OIL WELL ☐ GAS WELL ☒ OTHER

2. NAME OF OPERATOR

John H. Hill & Gordon L. Llewellyn

3. ADDRESS OF OPERATOR

Suite 140 Campbell Centre, 8350 North Central
Expressway, Dallas, Texas 75206

4. LOCATION OF WELL (Report location clearly and in accordance with any State requirements.*

See also space 17 below.)
At surface

605'FNL & 1705'FEL (NW NE) - new loc.

~~1220'FNL & 1100'FEL (NE NE) - old loc.~~

14. PERMIT NO.

15. ELEVATIONS (Show whether DF, RT, CR, etc.)

6903'

16. Check Appropriate Box To Indicate Nature of Notice, Report, or Other Data

NOTICE OF INTENTION TO:

TEST WATER SHUT-OFF

FRACTURE TREAT

SHOOT OR ACIDIZE

REPAIR WELL

(Other)

PULL OR ALTER CASING

MULTIPLE COMPLETE

ABANDON*

CHANGE PLANS

X

SUBSEQUENT REPORT OF:

WATER SHUT-OFF

FRACTURE TREATMENT

SHOOTING OR ACIDIZING

(Other)

REPAIRING WELL

ALTERING CASING

ABANDONMENT*

(NOTE: Report results of multiple completion on Well
Completion or Recompletion Report and Log form.)

17. DESCRIBE PROPOSED OR COMPLETED OPERATIONS (Clearly state all pertinent details, and give pertinent dates, including estimated date of starting any proposed work. If well is directionally drilled, give subsurface locations and measured and true vertical depths for all markers and zones pertinent to this work.)*

At the request of the U.S.G.S. and B.L.M. during the pre-drill inspection on November 13, 1979, the above-referenced well location and access road thereto, have been moved. The main reason for the change was to alleviate terrain problems connected with building and drilling this location.

Attached are the new location and elevation plat (EXHIBIT "A") and the proposed new access road map (EXHIBIT "E").

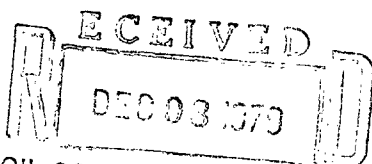

OIL CONSERVATION DIVISION

18. I hereby certify that the foregoing is true and correct

SIGNED

George Lapaseotes

TITLE

Agent Consultant for
Hill & Llewellyn

DATE November 28, 1979

(This space for Federal or State office use)

APPROVED BY

TITLE

DATE

CONDITIONS OF APPROVAL, IF ANY:

All distances must be from the outer boundaries of the Section.

Location & Elevation Plat

Well No.

Newsom "A" #9

Operator John H. Hill + Gordon L. Llewellyn			Lease SF-078430		
Unit Letter B	Section 10	Township 26 N.	Range 8 W.	County San Juan	

Actual Footage Location of Well:

605	feet from the North	line and	1705'	feet from the East	line
Ground Level Elev. 6903'	Producing Formation Pictured Cliffs	Pool Ballard Pictured Cliffs	Dedicated Acreage: 160 Acres		

1. Outline the acreage dedicated to the subject well by colored pencil or hatchure marks on the plat below.
2. If more than one lease is dedicated to the well, outline each and identify the ownership thereof (both as to working interest and royalty).
3. If more than one lease of different ownership is dedicated to the well, have the interests of all owners been consolidated by communitization, unitization, force-pooling, etc?

☐ Yes ☐ No If answer is "yes," type of consolidation _____

If answer is "no," list the owners and tract descriptions which have actually been consolidated. (Use reverse side of this form if necessary.) _____

No allowable will be assigned to the well until all interests have been consolidated (by communitization, unitization, forced-pooling, or otherwise) or until a non-standard unit, eliminating such interests, has been approved by the Division.

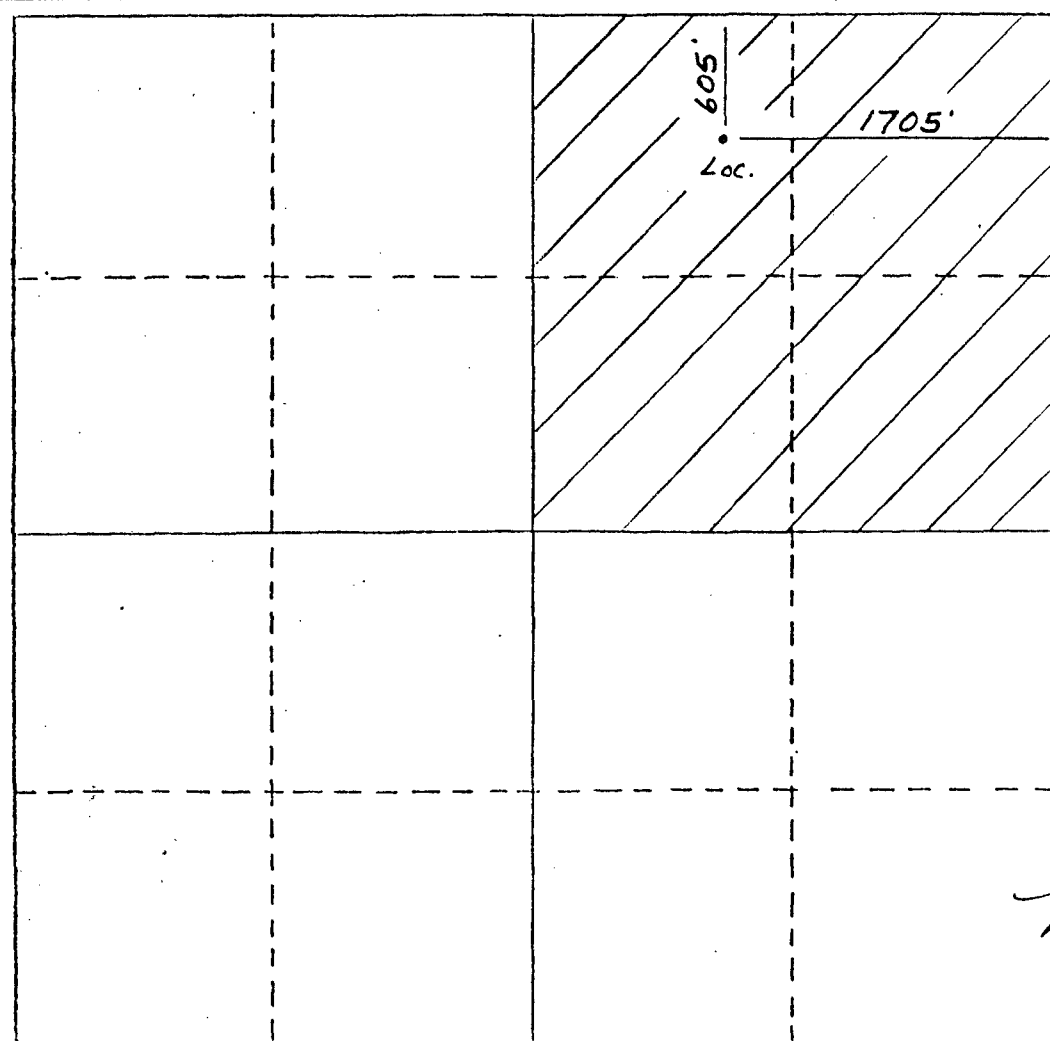

CERTIFICATION

I hereby certify that the information contained herein is true and complete to the best of my knowledge and belief.

George Lapaseotes
Name **George Lapaseotes**
V. Pres. Powers Elevation
Position **Agent Consultant for**

Company
Hill & Llewellyn
Date
November 13, 1979

I hereby certify that the location shown on the plat is correct to the best of my knowledge and belief. (6857)

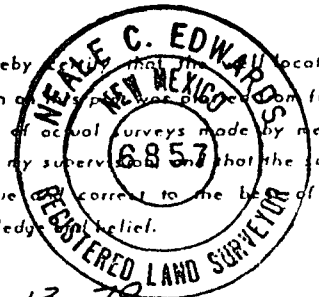

Date Surveyed **11-13-79**
Neale C. Edwards
Registered Professional Engineer
and/or Land Surveyor

6857

Certificate No.

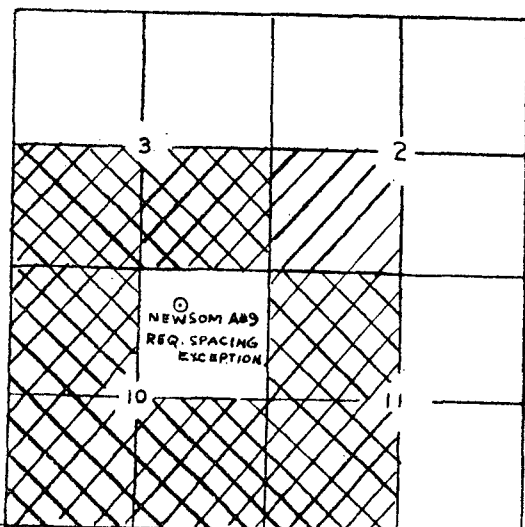

OFFSET MINERAL OWNERSHIP (TO PICTURED CLIFFS)

LEGEND

- SUPRON ENERGY CORPORATION
- EL PASO EXPLORATION COMPANY

EXHIBIT "E"
Access Road to Location

LEGEND

- County Road A-80
- Oil Field Road
- New Access Road

John H. Hill & Gordon L. Llewellyn
Newsom "A" #9
NWNE Sec. 10 T26N R8W
San Juan County, New Mexico

Closest Dwelling



POWERS ELEVATION

OIL WELL ELEVATIONS AND LOCATIONS
CHERRY CREEK PLAZA, SUITE 1201
600 SOUTH CHERRY STREET
DENVER, COLORADO 80222
PHONE NO. 303/321-2217

November 28, 1979

Joe D. Ramey, Director
New Mexico Oil & Gas Conservation Commission
P.O. Box 2088
Santa Fe, New Mexico 87501

RE: Application for Spacing Exception
John H. Hill & Gordon L. Llewellyn
Newsom "A" #9
NW NE Sec. 10 T26N R8W
605' FNL & 1705' FEL
San Juan County, New Mexico

Dear Sir:

Enclosed are duplicate copies of U.S.G.S. Sundry Form 9-331 (explaining the necessity for a spacing exception), the location and elevation plat (showing offset ownership) and the applicable topographic map (showing location and access road).

The appropriate waiver will be sent under separate cover by Gabriel Bjerke (landman, Supron Energy Corporation in Dallas), who confirmed this matter with me in a telephone conversation today. Since this location is a farmout from Supron Energy Corporation to John H. Hill and Gordon L. Llewellyn, it is a matter of clarifying the farmout agreement.

Should you require any additional information in order to approve this Application for Spacing Exception, please advise.

Very truly yours,

POWERS ELEVATION

Jacqueline E. LaSasso

Jacqueline E. LaSasso

JEL:vg
Enclosures

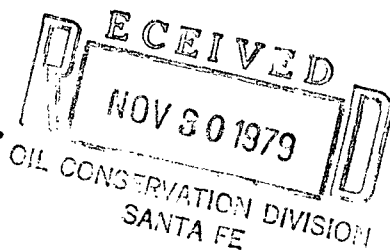

cc: (2) New Mexico Oil & Gas Conservation Commission, Aztec District Office
Gabriel Bjerke, Supron Energy Corporation, Dallas, Texas
Gordon L. Llewellyn, Dallas, Texas
Leon Wiederkehr, Esperanza Energy Corporation, Austin, Texas

OIL CONSERVATION DIVISION

STATE OF NEW MEXICO
ENERGY AND MINERALS DEPARTMENTP. O. BOX 2088
SANTA FE, NEW MEXICO 87501Form C-102
Revised 10-1-79

EXHIBIT "A"

All distances must be from the outer boundaries of the Section.

Location & Elevation Plat

Operator John H. Hill + Gordon L. Llewellyn			Lease SF-078430		Well No. Newsom "A" #9
Unit Letter B	Section 10	Township 26 N.	Range 8 W.	County San Juan	
Actual Footage Location of Well: 605 feet from the North line and 1705' feet from the East line					
Ground Level Elev. 6903'	Producing Formation Pictured Cliffs		Pool Ballard Pictured Cliffs		Dedicated Acreage: 160 Acres

1. Outline the acreage dedicated to the subject well by colored pencil or hatchure marks on the plat below.
2. If more than one lease is dedicated to the well, outline each and identify the ownership thereof (both as to working interest and royalty).
3. If more than one lease of different ownership is dedicated to the well, have the interests of all owners been consolidated by communitization, unitization, force-pooling, etc?

☐ Yes ☐ No If answer is "yes," type of consolidation _____

If answer is "no," list the owners and tract descriptions which have actually been consolidated. (Use reverse side of this form if necessary.) _____

No allowable will be assigned to the well until all interests have been consolidated (by communitization, unitization, forced-pooling, or otherwise) or until a non-standard unit, eliminating such interests, has been approved by the Division.

CERTIFICATION

I hereby certify that the information contained herein is true and complete to the best of my knowledge and belief.

George Lapaseotes
Name **George Lapaseotes**
V. Pres. Powers Elevation
Position **Agent Consultant for**

Company
Hill & Llewellyn

Date
November 13, 1979

I hereby certify that the location shown on the attached plat and field notes of actual surveys made by me or under my supervision and that the same is true and correct to the best of my knowledge and belief.

Neale C. Edwards
Date Surveyed
11-13-79
Registered Professional Engineer
and/or Land Surveyor

Certificate No. **6857**

OFFSET MINERAL OWNERSHIP

LEGEND

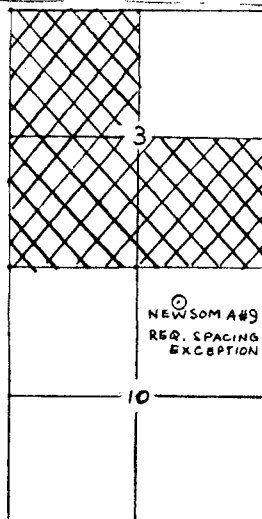

SUPRON ENERGY CORPORATION
LEASE # SF-078430

T
26
N

RRW

UNITED STATES
DEPARTMENT OF THE INTERIOR
GEOLOGICAL SURVEYSUBMIT IN TRIPLICATE*
(Other instructions on re-
verse side)Form approved,
Budget Bureau No. 42-R1424.

5. LEASE DESIGNATION AND SERIAL NO.

SF-078430

6. IF INDIAN, ALLOTTEE OR TRIBE NAME

N/A

7. UNIT AGREEMENT NAME

N/A

8. FARM OR LEASE NAME

Newsom "A"

9. WELL NO.

#9

10. FIELD AND POOL, OR WILDCAT

Wildcat

11. SEC., T., R., M., OR BLK. AND
SURVEY OR AREA

Sec. 10 T26N R8W NMPM

12. COUNTY OR PARISH 13. STATE

San Juan

New Mexico

SUNDRY NOTICES AND REPORTS ON WELLS

(Do not use this form for proposals to drill or to deepen or plug back to a different reservoir.
Use "APPLICATION FOR PERMIT—" for such proposals.)

1. OIL WELL ☐ GAS WELL ☒ OTHER
2. NAME OF OPERATOR
John H. Hill & Gordon L. Llewellyn
3. ADDRESS OF OPERATOR Suite 140 Campbell Centre, 8350 North Central
Expressway, Dallas, Texas 75206
4. LOCATION OF WELL (Report location clearly and in accordance with any State requirements.*
See also space 17 below.)
At surface 605'FNL & 1705'FEL (NW NE) - new loc.
1220'FNL & 1100'FEL (NE NE) - old loc.

14. PERMIT NO.

15. ELEVATIONS (Show whether DF, RT, CR, etc.)

6903'

16. Check Appropriate Box To Indicate Nature of Notice, Report, or Other Data

NOTICE OF INTENTION TO:

TEST WATER SHUT-OFF

☐
☐
☐
☐

PULL OR ALTER CASING

☐
☐
☐
☒

FRACTURE TREAT

MULTIPLE COMPLETION

SHOOT OR ACIDIZE

ABANDON*

REPAIR WELL

CHANGE PLANS

(Other)

SUBSEQUENT REPORT OF:

WATER SHUT-OFF

☐
☐
☐
☐

FRACTURE TREATMENT

SHOOTING OR ACIDIZING

(Other)

REPAIRING WELL

ALTERING CASING

ABANDONMENT*

☐
☐
☐
☐(NOTE: Report results of multiple completion on Well
Completion or Recompletion Report and Log form.)

17. DESCRIBE PROPOSED OR COMPLETED OPERATIONS (Clearly state all pertinent details, and give pertinent dates, including estimated date of starting any proposed work. If well is directionally drilled, give subsurface locations and measured and true vertical depths for all markers and zones pertinent to this work.)*

At the request of the U.S.G.S. and B.L.M. during the pre-drill inspection on November 13, 1979, the above-referenced well location and access road thereto, have been moved. The main reason for the change was to alleviate terrain problems connected with building and drilling this location.

Attached are the new location and elevation plat (EXHIBIT "A") and the proposed new access road map (EXHIBIT "E").

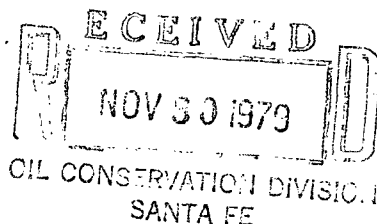

18. I hereby certify that the foregoing is true and correct

SIGNED

George Lapaseotes
George Lapaseotes

TITLE

Agent Consultant for
Hill & Llewellyn

DATE November 28, 1979

(This space for Federal or State office use)

APPROVED BY

TITLE

DATE

CONDITIONS OF APPROVAL, IF ANY:

*See Instructions on Reverse Side

EXHIBIT "E"
Access Road to Location

LEGEND

- County Road A-80
- Oil Field Road
- New Access Road

John H. Hill & Gordon L. Clewellyn
Newsom "A" #9
NW NE Sec. 10 T26N R8W
San Juan County, New Mexico

Closest Dwelling

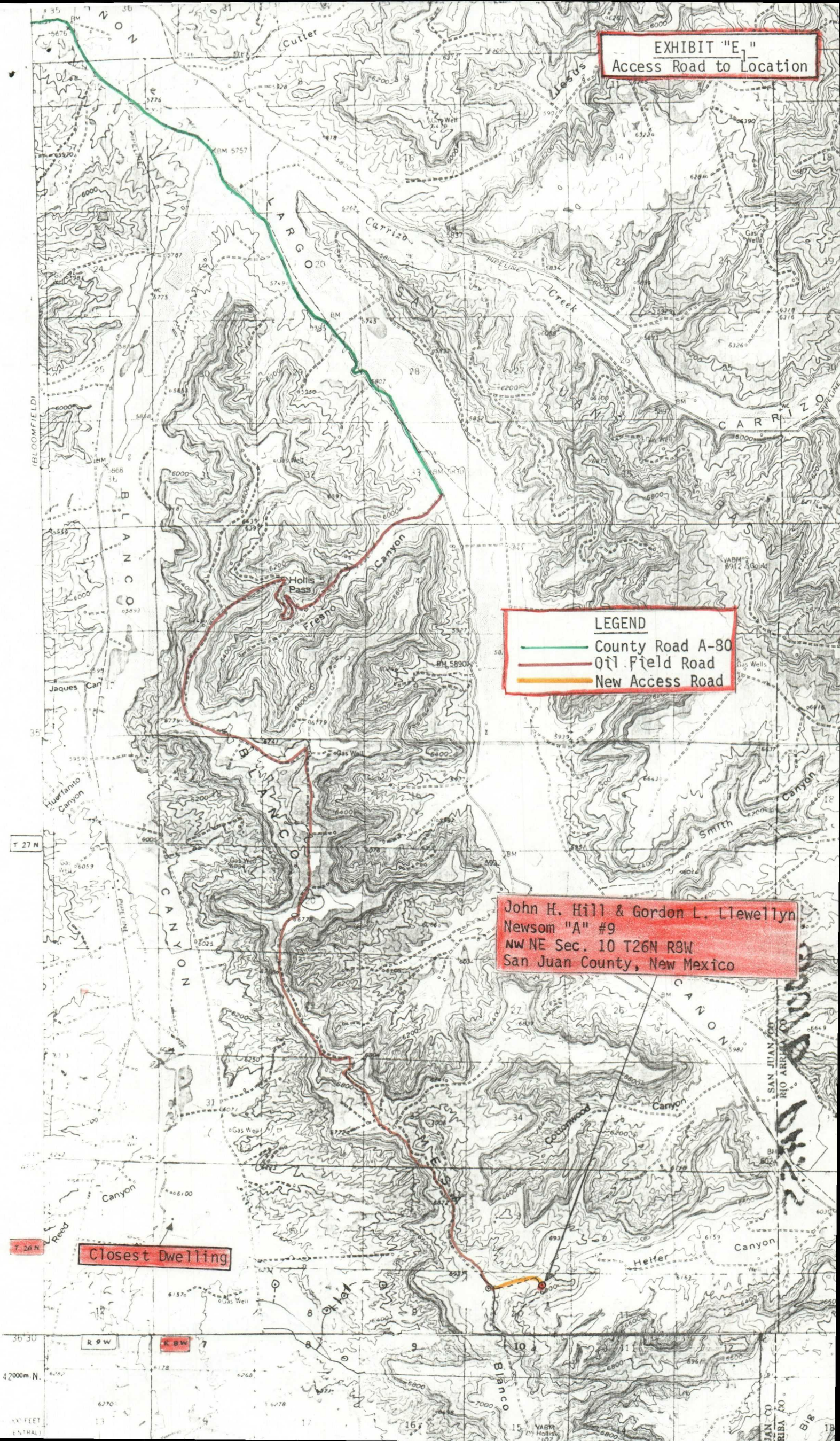



STATE OF NEW MEXICO
ENERGY AND MINERALS DEPARTMENT
OIL CONSERVATION DIVISION

BRUCE KING
GOVERNOR

LARRY KEHOE
SECRETARY

December 3, 1979

POST OFFICE BOX 2088
STATE LAND OFFICE BUILDING
SANTA FE, NEW MEXICO 87501
(505) 827-2434

Powers Elevation
Cherry Creek Plaza, Suite 1201
600 South Cherry Street
Denver, Colorado 80222

Re: Application for Non-Standard
Location: Hill & Llewellyn
Newsom "A" Well No. 9, 605' FNL
and 1705' FEL of Sec. 10, T-26-N,
R-8-W, San Juan County

We may not process the subject application for non-standard location until the required information or plats checked below (is)(are) submitted.

- ☒ A plat must be submitted clearly showing the ownership of the offsetting leases. in Sections 2 and 11.
- ☒ A statement must be submitted that offset owners have been notified of the application by certified mail. If waivers are received, this statement is not required.
- ☐ A plat must be submitted fully identifying the topography necessitating the non-standard location.
- ☐ Other:

Very truly yours

R. L. STAMETS
Technical Support Chief

RLS/dr

El Paso EXPLORATION
COMPANY

P. O. BOX 289
FARMINGTON, NEW MEXICO 87401
PHONE: 505-325-2841

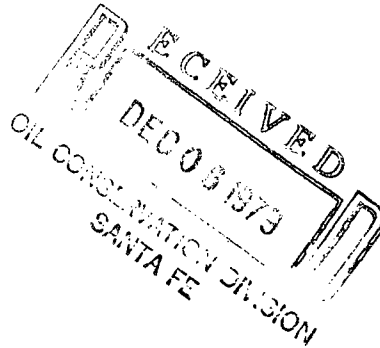

December 4, 1979

NEW MEXICO OIL AND GAS CONSERVATION COMMISSION
Attention: Mr. Joe D. Ramey, Director
Post Office Box 2088
Santa Fe, New Mexico 87501

Re: Powers Elevation Company Inc. Request
for Amended Application for Spacing
Exception, John H. Hill & Gordon L.
Llewellyn, Newsom "A" #9, Pictured Cliffs
NW NE Section 10, T26N, R8W
605' FNL, 1705' FEL
San Juan County, New Mexico

Dear Sir:

This is to advise that El Paso Exploration Company, as owner of offset acreage to the captioned well, has no objection to the proposed request for non-standard location by John H. Hill & Gordon L. Llewellyn.

Yours very truly,

A handwritten signature in cursive script that reads "John A. Ahlm".

John A. Ahlm
Regional Land Manager
Exploration-Land

JAA:ld
cc: Powers Elevation Company
NMOCC-Aztec, NM

File NSL-1119

OIL CONSERVATION COMMISSION
Wyle DISTRICT

OIL CONSERVATION COMMISSION
BOX 2088
SANTA FE, NEW MEXICO

DATE 12-4-79

RE: Proposed MC _____
Proposed DHC _____
Proposed NSL ✓ _____
Proposed SWD _____
Proposed WFX _____
Proposed PMX _____

BLL
Gentlemen:

I have examined the application dated 11-30-79
for the Hill & Hensel Newsum A #9 B-10-26N-8W
Operator Lease and Well No. Unit, S-T-R

and my recommendations are as follows:

Approve

Yours very truly,

AR Kendrick

RECEIVED
OIL CONSERVATION COMMISSION
SANTA FE
DEC 11 1979

SUPRON ENERGY CORPORATION

BLDG. V, FIFTH FLOOR
10300 NORTH CENTRAL EXPRESSWAY
DALLAS, TEXAS 75231

TELEPHONE (214) 691-9141
TWX: (910) 861-9117
SUPCO.DAL.

November 28, 1979

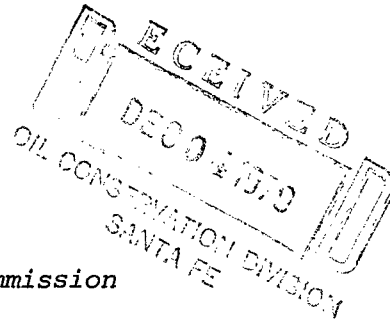

New Mexico Oil and Gas Conservation Commission
P. O. Box 2088
Santa Fe, New Mexico

Attention: Mr. Joe D. Ramey
State Petroleum Engineer
Secretary-Director

Dear Sir:

John H. Hill has filed an application for a non-Standard location to be 605' FNL and 1705' FEL of Section 10, Township 26 North, Range 8 West in San Juan County, New Mexico. Supron Energy Corporation has no objection to this non-standard location.

If you require additional information in this matter, please contact us at the above address.

Yours very truly,

Jerry L. Lee, Engineer
Drilling and Production

JLL/mc