

El Paso EXPLORATION
COMPANY

NSL-1213
Rule 3 R-1670
Waiting period over
Immediate

P. O. BOX 289
FARMINGTON, NEW MEXICO 87401
PHONE: 505-325-2841

April 23, 1980

Mr. Joe Ramey
New Mexico Oil Conservation Division
Post Office Box 2088
Santa Fe, New Mexico 87501

Dear Mr. Ramey:

This is a request for administrative approval for an unorthodox gas well location in the Basin Dakota pool.

It is intended to locate the El Paso ^{Gas} Natural Gas Company's San Juan 28-7 Unit #241E at 980' from the South line and 1840' from the East line of Section 9, T-28-N, R-7-W, Rio Arriba County, New Mexico.

Extremely rough terrain in the form of steep cliffs in the southeast corner of this section makes it impossible to build an orthodox gas well location.

El Paso operates all proration units offsetting the proposed unorthodox location.

Plats showing the proposed well location and the terrain of Section 9, along with an ownership plat, are attached.

Sincerely yours,

Don Read

D. R. Read

DRR:pb

UNITED STATES
DEPARTMENT OF THE INTERIOR
GEOLOGICAL SURVEY

APPLICATION FOR PERMIT TO DRILL, DEEPEN, OR PLUG BACK

1a. TYPE OF WORK

DRILL ☒DEEPEN ☐PLUG BACK ☐

b. TYPE OF WELL

OIL
WELL ☐GAS
WELL ☒

OTHER

SINGLE
ZONE ☒MULTIPLE
ZONE ☐

2. NAME OF OPERATOR

El Paso Natural Gas Company

3. ADDRESS OF OPERATOR

PO Box 289, Farmington, NM 87401

4. LOCATION OF WELL (Report location clearly and in accordance with any State requirements.)*

At surface

980'S, 1840'E

At proposed prod. zone

same

14. DISTANCE IN MILES AND DIRECTION FROM NEAREST TOWN OR POST OFFICE*

7 miles south of Navajo City, NM

15. DISTANCE FROM PROPOSED*

LOCATION TO NEAREST
PROPERTY OR LEASE LINE, FT.
(Also to nearest drlg. unit line, if any)

200'

16. NO. OF ACRES IN LEASE

unit

17. NO. OF ACRES ASSIGNED
TO THIS WELL

338.02

18. DISTANCE FROM PROPOSED LOCATION*

TO NEAREST WELL, DRILLING, COMPLETED,
OR APPLIED FOR, ON THIS LEASE, FT.

1/4 mile

19. PROPOSED DEPTH

7429'

20. ROTARY OR CABLE TOOLS

Rotary

21. ELEVATIONS (Show whether DF, RT, GR, etc.)

6214' GL

22. APPROX. DATE WORK WILL START*

23.

PROPOSED CASING AND CEMENTING PROGRAM

SIZE OF HOLE	SIZE OF CASING	WEIGHT PER FOOT	SETTING DEPTH	QUANTITY OF CEMENT
13 3/4"	9 5/8"	36.0#	200'	224 cu.ft. to circulate
8 3/4"	7"	20.0#	3173'	272 cu.ft. to cover Ojo Alamo
6 1/4"	4 1/2"	10.5# & 11.6#	7429'	663 cu.ft. to fill to interm.

Selectively perforate and sandwater fracture the Dakota formation.

A 3000 psi WP and 6000 psi test double gate preventer equipped with blind and pipe rams will be used for blow out prevention on this well.

This gas is dedicated.

The Lots 1,2,3 SESE/4 of Section 8 and Lots 3 & 4 SWSW/4 SW/4 SWSE/4 of Section 9 are dedicated to this well.

IN ABOVE SPACE DESCRIBE PROPOSED PROGRAM: If proposal is to deepen or plug back, give data on present productive zone and proposed new productive zone. If proposal is to drill or deepen directionally, give pertinent data on subsurface locations and measured and true vertical depths. Give blowout preventer program, if any.

24.

SIGNED

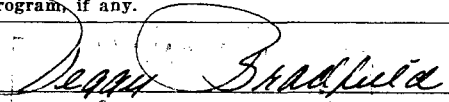

TITLE

Drilling Clerk

DATE

4-22-80

(This space for Federal or State office use)

PERMIT NO.

APPROVAL DATE

APPROVED BY

TITLE

DATE

CONDITIONS OF APPROVAL, IF ANY:

**NEW MEXICO OIL CONSERVATION COMMISSION
WELL LOCATION AND ACREAGE DEDICATION PLAT**

Form C-102
Supersedes C-128
Effective 1-1-65

All distances must be from the outer boundaries of the Section.

Operator EL PASO NATURAL GAS COMPANY			Lease SAN JUAN 28-7 UNIT (SF-078497-A)		Well No. 241-E
Unit Letter 0	Section 9	Township 28N	Range 7W	County Rio Arriba	
Actual Footage Location of Well: 980 feet from the South line and 1840 feet from the East line					
Ground Level Elev: 6214	Producing Formation Dakota	Pool Basin Dakota		Dedicated Acreage: 338.02 Acres	

1. Outline the acreage dedicated to the subject well by colored pencil or hatchure marks on the plat below.
2. If more than one lease is dedicated to the well, outline each and identify the ownership thereof (both as to working interest and royalty).
3. If more than one lease of different ownership is dedicated to the well, have the interests of all owners been consolidated by communitization, unitization, force-pooling, etc?

☐ Yes ☐ No If answer is "yes," type of consolidation Unitization

If answer is "no," list the owners and tract descriptions which have actually been consolidated. (Use reverse side of this form if necessary.) _____

No allowable will be assigned to the well until all interests have been consolidated (by communitization, unitization, forced-pooling, or otherwise) or until a non-standard unit, eliminating such interests, has been approved by the Commission.

CERTIFICATION

I hereby certify that the information contained herein is true and complete to the best of my knowledge and belief.

[Signature]
 Name
Drilling Clerk
 Position
El Paso Natural Gas Co.
 Company
April 22, 1980
 Date

I hereby certify that the well location shown on this plat was plotted from field notes of actual surveys made by me or under my supervision, and that the same is true and correct to the best of my knowledge and belief.

Date Surveyed
February 15, 1980
 Registered Professional Engineer and Land Surveyor
[Signature]
Fred B. Kerr Jr.
 Certificate No.
3950

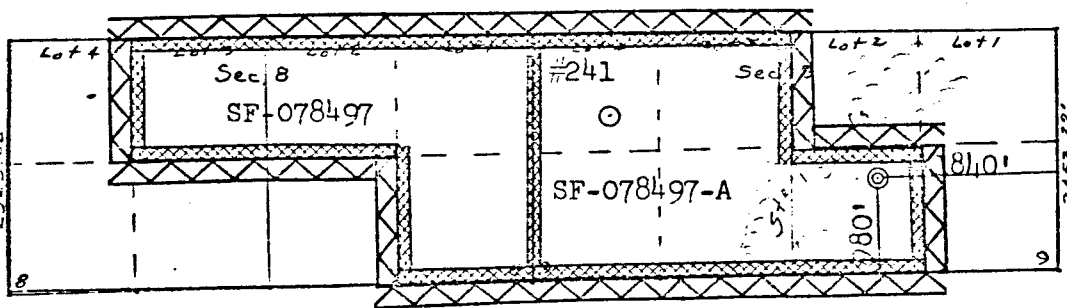

Scale: 1" = 2000'

Dedicated Acreage: Sec. 8 (Lots 1,2,3; SE/SE $\frac{1}{4}$)
 Sec. 9 (Lots 3 & 4, SW/SW $\frac{1}{4}$, SE/SW $\frac{1}{4}$, SW/SE $\frac{1}{4}$)

EL PASO NATURAL GAS COMPANY

Well Name: San Juan 28-7 Unit #241 E

Footage--- 980' FSL, 1840' FEL, BASIN DAKOTA

APPLICATION FOR UNORTHODOX LOCATION

County Rio Arriba

State New Mexico

Section 9

Township 28N

Range 7W

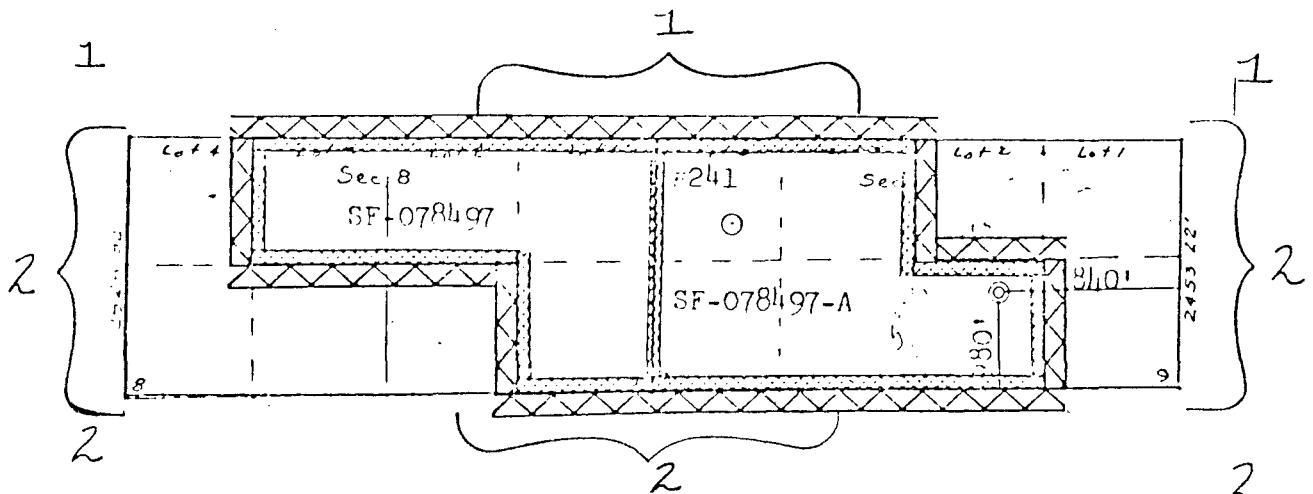

Scale: 1" = 2000'

Dedicated Acreage: Sec. 8 (Lots 1,2,3; SE/SE $\frac{1}{4}$)
Sec. 9 (Lots 3 & 4, SW/SW $\frac{1}{4}$, SE/SW $\frac{1}{4}$, SW/SE $\frac{1}{4}$)

REMARKS:

- (1) San Juan 29-7 Unit, El Paso Natural Gas Company, Operator
- (2) San Juan 28-7 Unit, El Paso Natural Gas Company, Operator

(Ed)

OIL CONSERVATION COMMISSION
By the DISTRICT

OIL CONSERVATION COMMISSION
BOX 2088
SANTA FE, NEW MEXICO

DATE April 25, 1980

RE: Proposed MC _____
Proposed DHC _____
Proposed NSL x _____
Proposed SWD _____
Proposed WFX _____
Proposed PMX _____

Gentlemen:

I have examined the application dated April 24, 1980
for the E.P.N. Co. S. J. 28-7 Unit #241E 0-9-78N-7W
Operator Lease and Well No. Unit, S-T-R

and my recommendations are as follows:

Approve

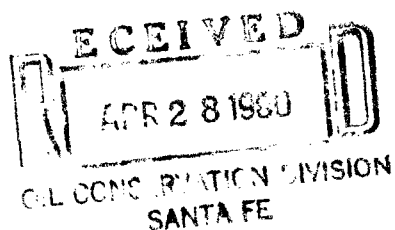

Yours very truly,

Frank S. Long