

Northwest Pipeline Corporation



PRODUCTION & DRILLING
P. O. BOX 90
FARMINGTON, NEW MEXICO 87401
5110.1-72-80

*NSL
See Form c-102
for detail
Rule 104 F
8-28-80 (supplemental data)*

July 28, 1980

Mr. Joe Ramey
N.M.O.C.C.
P.O. Box 2088
Santa Fe, New Mexico 87501

NSL-1254

Dear Mr. Ramey:

Northwest Pipeline requests permission to drill a Pictured Cliffs/Mesa Verde Dual well in an unorthodox location due to topographical and archeological reasons. The well is the San Juan 29-5 Unit #100 located in the NW/4 of Section 25, T29N, R5W. A copy of the surveyors plat and a topographical map is attached.

Thank you,

Paul C. Thompson

Paul C. Thompson
Drilling Engineer

PCT/djb
attachments

*RECEIVED
JUL 29 1980
C. C. C. & S. J. J.
SANTA FE, N.M.*

LAND CONSERVATION DIVISION

STATE OF NEW MEXICO
ENERGY AND MINERALS DEPARTMENT

P. O. BOX 2088
SANTA FE, NEW MEXICO 87501

Form C-107
Revised 10-1-78

All distances must be from the outer boundaries of the Section. JUN 3 1980

Operator NORTHWEST PIPELINE CORPORATION			Lease SAN JUAN 29-5 UNIT		Well No. 100
Unit Letter G	Section 25	Township 29N	Range 5W	County Rio Arriba	
Actual Footage Location of Well: 1840 feet from the North line and 970 feet from the East line					
Ground Level Elev. 6795	Producing Formation Pictured Cliffs/ MV	Pool Dual Gobernador PC/Elanco MV		Dedicated Acreage: 229.16 Acres	

1. Outline the acreage dedicated to the subject well by colored pencil or hachure marks on the plat below.
2. If more than one lease is dedicated to the well, outline each and identify the ownership thereof (both as to working interest and royalty).
3. If more than one lease of different ownership is dedicated to the well, have the interests of all owners been consolidated by communitization, unitization, force-pooling, etc?

☒ Yes ☐ No If answer is "yes," type of consolidation Unitization

If answer is "no," list the owners and tract descriptions which have actually been consolidated. (Use reverse side of this form if necessary.)

No allowable will be assigned to the well until all interests have been consolidated (by communitization, unitization, forced-pooling, or otherwise) or until a non-standard unit, eliminating such interests, has been approved by the Commission.

4526.94'

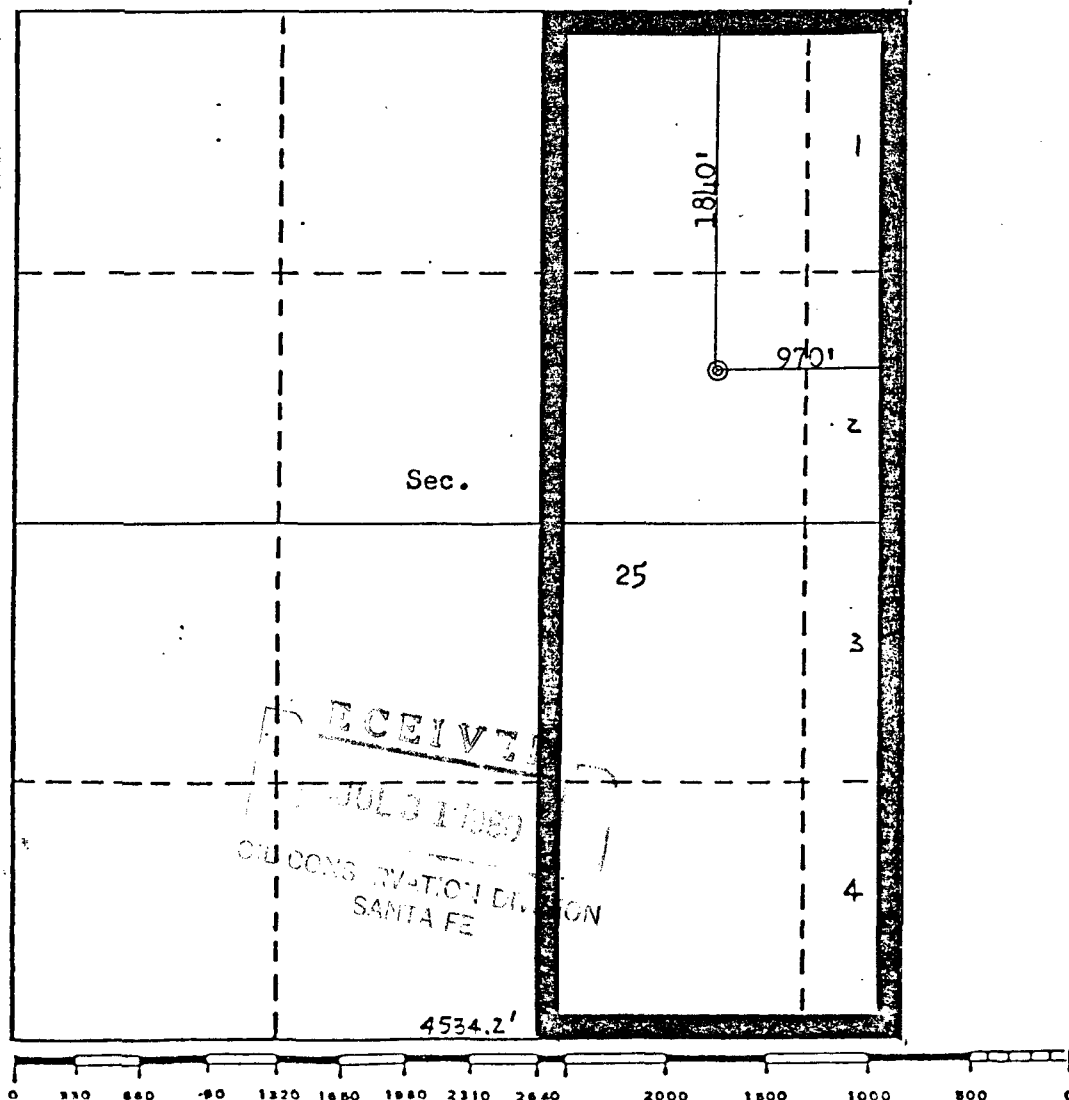

CERTIFICATION

I hereby certify that the information contained herein is true and complete to the best of my knowledge and belief.

Paul C. Thompson

Name
Paul C. Thompson

Position
Drilling Engineer

Company
Northwest Pipeline Corp

Date
June 3, 1980

I hereby certify that the well location shown on this plat was plotted from field notes of actual surveys made by me or under my supervision, and that the same is true and correct to the best of my knowledge and belief.

Date Surveyed
May 28, 1980

Registered Professional Engineer
and/or Land Surveyor

Fred B. Kern Jr.
Fred B. Kern Jr.

Certificate No.

3950

SAN JUAN 29-5 UNIT #100

23

EPNG

24

LOWESTAR / SHARK

19

CONOCO

26

NWP

25

NWP

●
#100

30

SAN JUAN UNIT 29-4
EPNG

35

NWP

36

NWP

31

EPNG



Vicinity Map for
NORTHWEST PIPELINE CORPORATION #100 SAN JUAN 29-5 UNIT
1840'FNL 970'FEL Sec. 25-T29N-R5W
RIO ARriba COUNTY, NEW MEXICO

OIL CONSERVATION COMMISSION
DISTRICT

OIL CONSERVATION COMMISSION
BOX 2088
SANTA FE, NEW MEXICO

DATE 8-7-80

RE: Proposed MC _____
Proposed DHC _____
Proposed NSL X _____
Proposed SWD _____
Proposed WFX _____
Proposed PMX _____

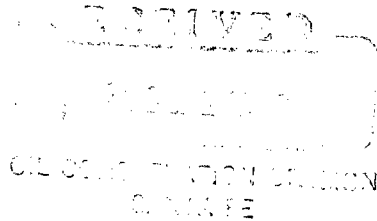

Gentlemen:

I have examined the application dated July 29, 1980
for the Northwest Pipeline Corp. San Juan 29-5 Unit # 100 G 25-29-5
Operator Lease and Well No. Unit, S-T-R

and my recommendations are as follows:

Approve

Yours very truly,

Richard H. Linnemann

Northwest Pipeline Corporation

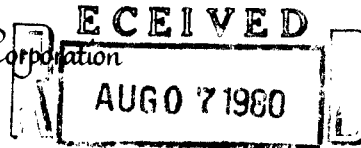

PRODUCTION & DRILLING
P. O. BOX 90
FARMINGTON, NEW MEXICO 87401

OIL CONSERVATION DIVISION
SANTA FE

5110.1-81-80

August 5, 1980

Mr. Joe Ramey
N.M.O.C.C.
P.O. Box 2088
Santa Fe, New Mexico 87501

Dear Mr. Ramey:

Northwest Pipeline requested permission to drill the San Juan 29-5 Unit #100 in an unorthodox location in a letter dated July 28, 1980. I believe that the wrong plat was inadvertently attached. Enclosed with this letter is the correct plat.

Thank you,

Paul C. Thompson

Paul C. Thompson
Drilling Engineer

PCT/djb

enclosure

RECEIVED
AUG 7 1980

All distances must be from the outer boundaries of the

Operator NORTHWEST PIPELINE CORPORATION			Lease SAN JUAN 29-5 UNIT		
Unit Letter G	Section 25	Township 29N	Range 5W	County Rio Arriba	Well No. 100
Actual Footage Location of Well: 1885 feet from the North line and 1165 feet from the East line					
Ground Level Elev: 6786	Producing Formation Pictured Cliffs/Mesa Verde		Pool Gobernador PC/Blanco MV		Dedicated Acreage: 229.16 Acres

1. Outline the acreage dedicated to the subject well by colored pencil or hachure marks on the plat below.
2. If more than one lease is dedicated to the well, outline each and identify the ownership thereof (both as to working interest and royalty).
3. If more than one lease of different ownership is dedicated to the well, have the interests of all owners been consolidated by communitization, unitization, force-pooling, etc?

☒ Yes ☐ No If answer is "yes," type of consolidation Unitization

If answer is "no," list the owners and tract descriptions which have actually been consolidated. (Use reverse side of this form if necessary.)

No allowable will be assigned to the well until all interests have been consolidated (by communitization, unitization, forced-pooling, or otherwise) or until a non-standard unit, eliminating such interests, has been approved by the Commission.

4526.94
4526.94

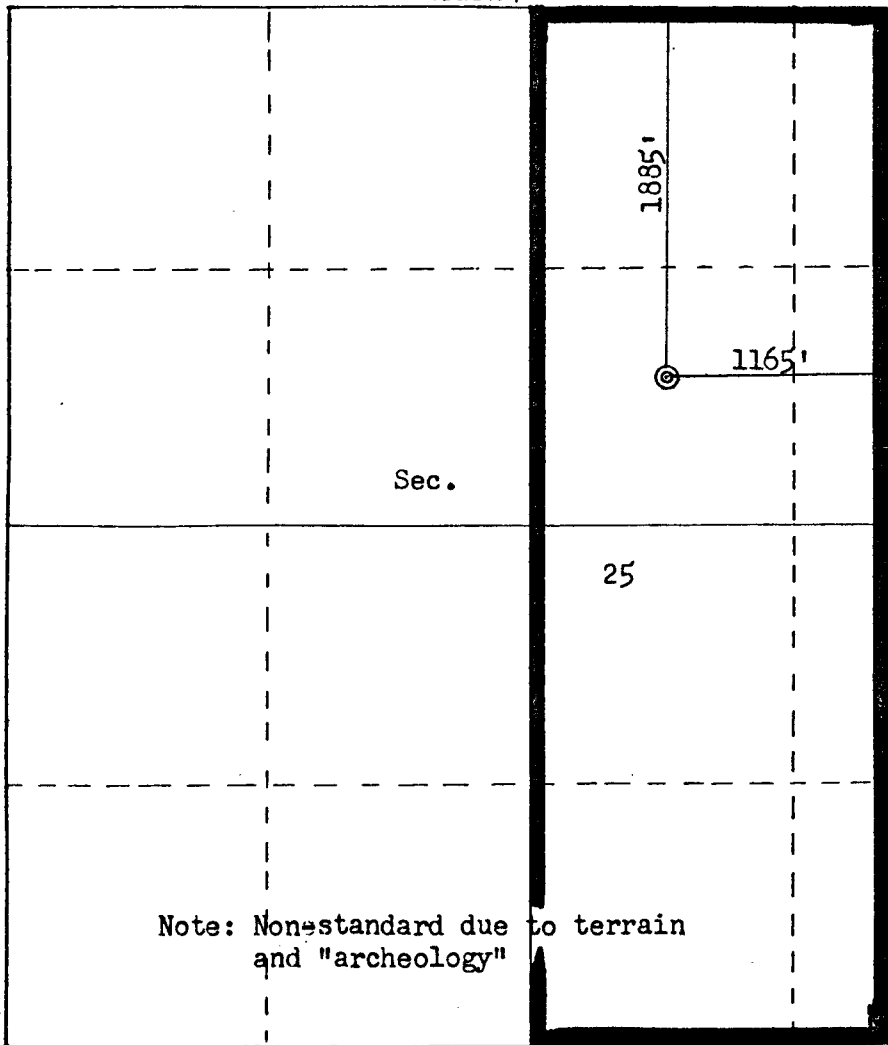

Scale: 1"=1000'

CERTIFICATION

I hereby certify that the information contained herein is true and complete to the best of my knowledge and belief.

Paul C. Thompson

Name

Paul C. Thompson

Position

Drilling Engineer

Company

Nrothwest Pipeline Corp

Date

July 23, 1980

I hereby certify that the well location shown on this plat was plotted from field notes of actual surveys made by me or under my supervision, and that the same is true and correct to the best of my knowledge and belief.

Date Surveyed

July 1, 1980

Registered Professional Engineer and Land Surveyor

Ed B. Kern

Certificate No.

3958



ENERGY AND MINERALS DEPARTMENT
OIL CONSERVATION DIVISION

August 4, 1980

POST OFFICE BOX 2088
STATE LAND OFFICE BUILDING
SANTA FE, NEW MEXICO 87501
(505) 827-2434

BRUCE KING
GOVERNOR
LARRY KEHOE
SECRETARY

Northwest Pipeline Corporation
P. O. Box 90
Farmington, New Mexico 87401

Re: Application for Non-Standard
Location: San Juan 29-5 Unit
Well No. 100, Sec. 25, T-29-N,
R-5-W

We may not process the subject application for non-standard location until the required information or plats checked below (is) (are) submitted.

- ☐ A plat must be submitted clearly showing the ownership of the offsetting leases.
- ☒ A statement must be submitted that offset owners have been notified of the application by certified mail, otherwise no approval may be granted if waivers are not received.
- ☐ A plat must be submitted fully identifying the topography necessitating the non-standard location.
- ☒ Other: There must be some demonstration as to the need for this location. There was no archeological data submitted nor any obvious superior topography shown on the map.

Very truly yours,

R. L. STAMETS
Technical Support Chief

RLS/dr

OIL CONSERVATION COMMISSION
Alfred DISTRICT

OIL CONSERVATION COMMISSION
BOX 2088
SANTA FE, NEW MEXICO

DATE

RE:

Proposed MC

Proposed DHC

Proposed NSL

Proposed SWD

Proposed WFX

Proposed PMX

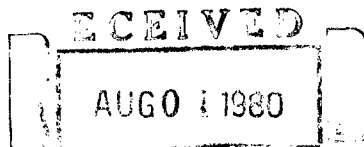

Gentlemen:

OIL CONSERVATION DIVISION
SANTA FE

I have examined the application dated July 24, 1980
for the Northwest Pipeline Corp. S. J. 29-5 Unit #100 G-25-29N-SW
Operator Lease and Well No. Unit, S-T-R

and my recommendations are as follows:

Approve

Yours very truly,

Frank S. Chang

NORTHWEST PIPELINE CORPORATION

AUG 6 1980

PRODUCTION AND DRILLING



An Archaeological Clearance Survey of
Six Proposed Well Locations & Access Roads
Conducted for Northwest Pipeline Corporation

Submitted by
L. Jean Hooton

San Juan 29-5 # 98
San Juan 29-5 #100
San Juan 29-5 #101
San Juan 29-5 #102
San Juan 29-5 #103
San Juan 29-5 #104

Report 80-SJC-228
of the
Cultural Resource Management Program
San Juan Campus
New Mexico State University

29 July 1980

Report 80-SJC-228
Permit 80-NM-004
N.M. State National
Forest

An Archaeological Clearance Survey of
Six Proposed Well Locations & Access Roads
Conducted for Northwest Pipeline Corporation

Submitted by
L. Jean Hooton
Cultural Resource Management
San Juan Campus
New Mexico State University

29 July 1980

An Archaeological Clearance Survey of
Six Proposed Well Locations & Access Roads
Conducted for Northwest Pipeline Corporation

On 9 July 1980, L. Jean Hooton from the Cultural Resource Management Program, New Mexico State University, San Juan Campus, conducted an archaeological clearance survey of six proposed well locations and access roads for Northwest Pipeline Corporation at the request of Mr. Paul Thompson.

Present during the survey were Mr. Thompson and Mr. Jack Cauthen from Northwest Pipeline Corporation, Mr. Doug Burger from the U.S. Bureau of Land Management - Farmington office, and Mr. Steve Shafran from the U.S. Geological Survey - Farmington office.

The proposed well locations and access roads are on Fee surface/Federal mineral lands, public lands administered by the U.S. Bureau of Land Management, and Carson National Forest lands, and were surveyed under Federal Antiquities permits 80-NM-004 and New Mexico State National Forest.

The most recent listings of the National Register of Historic Places have been consulted and no sites which appear on the Register and no sites which have been nominated to the Register occur on the project area. This proposal complies with the provisions of the Historic Preservation Act of 1966 and with Executive Order 11593. It is recommended that archaeological clearance be given.

METHODOLOGY

The proposed well locations were surveyed by walking parallel transect, fifty feet apart, over the 300 by 300 foot easements. The access roads were surveyed by walking in a zig-zag pattern from existing roads to the wells.

Proposed Well: NORTHWEST - SAN JUAN 29-5 #100

Land Status: Carson National Forest.

Location: The proposed well location is in the NW $\frac{1}{4}$ of the SE $\frac{1}{4}$ of the NE $\frac{1}{4}$ of Section 25, Township 29 North, Range 5 West, N.M.P.M., Rio Arriba County, New Mexico. The well will be 1750 feet from the north line and 1100 feet from the east line of Section 25. (Figure 2)

U.T.M.: Center - 13; 2,94,000 mE; 40,63,745 mN.

Access: 20 feet wide and 1300 feet long, approaching the location from the west.

Area Surveyed: 2.66 acres.

Terrain: Broken terrace with westerly drainage, alluvial surface deposits, and sandstone outcrops.

Soil: Sandy clayey loam.

Vegetation: Piñon, juniper, mock orange, mountain mahogany, bitter-brush, scrub-oak, squirreltail, indian ricegrass, narrow-leaf yucca, scarlet gilia, penstemon.

Cultural Resources: Site SJC-611 was found about eighty feet south of the original well stake. The well locations was moved to the northwest to avoid the site.

Recommendations: With the relocation of the well, archaeological clearance is recommended.

SITE SJC-611

Site SJC-611 is an early Navajo site consisting of a crib-log, ash dump and associated artifacts. The hogan is in relatively good condition with two or three logs height still intact. There were additional fallen logs from the walls and entryway.

A slab-lined bin containing ash and charcoal is located in the southeast quadrant of the hogan. The ash dump is about seven meters southwest from the south - facing entrance of the hogan. A few painted sherds were seen in the ash dump and around the hogan, and were probably Gobernador Polychrome or Frances Polychrome.

The site appears to be undisturbed and is contained in a small area no larger than twenty meters by twenty meters. Approximately five sherds were seen on the entire site and fill may be as deep as one meter.

The site is located in a small protected dished clearing on a broken terrace top on the east side of Pueblito Canyon. Large sandstone boulders border the western side of the site. There are sandstone outcrops, sandy clayey loam soil, and alluvial surface deposits.

The site was found about eighty feet south of the original well stake for the proposed San Juan 29-5 #100 well location. The well location was moved ~~northwest~~
SOUTHWEST, and the site will not be disturbed.

With the relocation of the well, archaeological clearance is recommended.



relocated well
San Juan 29-5 #100
~~1750 FNL/1100 FEL~~
1885 FNL/1165 FEL

slope

edge of
proposed location



original well
1840 FNL/ 970 FEL

boulders

crib-log hogan

bin

ash dump

slope

0 10
meters

TN

MN

Site SJC 611

C $\frac{1}{2}$, W $\frac{1}{2}$, SE $\frac{1}{4}$, NE $\frac{1}{4}$

Section 25

T 29N, R 5W

Rio Arriba County

New Mexico

Northwest Pipeline Corporation



PRODUCTION & DRILLING
P. O. BOX 90
FARMINGTON, NEW MEXICO 87401

5110.1-87-80

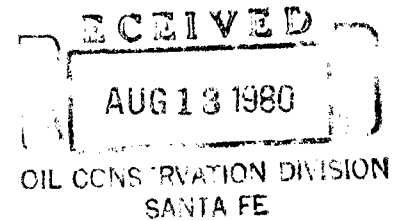

August 11, 1980

Mr. R. L. Stamets
New Mexico Oil Conservation
Division
P.O. Box 2088
Santa Fe, New Mexico 87501

Re: Application for Non-Standard Location
San Juan 29-5 Unit #100
Section 25, T29N, R5W, Rio Arriba County, New Mexico

Dear Mr. Stamets:

As requested in your letter dated August 4, 1980, Northwest Pipeline has notified the offset owners of the above captioned wells' Non-Standard location by certified mail. Copies of these letters along with a copy of the receipts for certified mail are enclosed. This well was moved to a Non-Standard location due to an archaeological discovery. The archaeological report is also included. If there is anything else you need before this request can be processed please let me know.

Thank you,

Paul C. Thompson

Paul C. Thompson
Drilling Engineer

PCT/djb

enclosure

Northwest Pipeline Corporation



PRODUCTION & DRILLING
P. O. BOX 90
FARMINGTON, NEW MEXICO 87401
5110.1-83-80

August 8, 1980

Mr. John Ahlm
P.O. Box 289
Petroleum Plaza Bldg.
Farmington, New Mexico 87401

Dear Mr. Ahlm:

Northwest Pipeline has requested permission from the New Mexico Oil Conservation Commission to drill a well in a Non-Standard location due to topography and archaeological discoveries. Our records show you are an offset owner of the well which is described below. Notify Joe Ramey, with NMOCC in Santa Fe, if you have any objections to this location within 20 days. This letter is being sent by certified mail in accordance with NMOCC regulations.

San Juan 29-5 Unit #100 - 1885' FNL & 1165' FEL - Sec 25, T29N, R5W

Sincerely,

Paul C. Thompson

Paul Thompson
Drilling Engineer

PCT/djb

Northwest Pipeline Corporation



PRODUCTION & DRILLING
P. O. BOX 90
FARMINGTON, NEW MEXICO 87401
5110.1-85-80

August 8, 1980

Mr. Keith Bennett
Conoco
555 17th Street
Denver, Colorado 80202

Dear Mr. Bennett:

Northwest Pipeline has requested permission from the New Mexico Oil Conservation Commission to drill a well in a Non-Standard location due to topography and archeological discoveries. Our records show you are an offset owner of the well which is described below. Notify Joe Ramey, with the NMOCC in Santa Fe, if you have any objections to this location within 20 days. This letter is being sent by certified mail in accordance with NMOCC regulations.

San Juan 29-5 Unit #100 - 1885' FNL & 1165' FEL - Sec 25, T29N, R5W

Sincerely,

Paul C. Thompson

Paul Thompson
Drilling Engineer

PCT/djb

Northwest Pipeline Corporation



PRODUCTION & DRILLING
P. O. BOX 90
FARMINGTON, NEW MEXICO 87401
5110.1-84-80

August 8, 1980

Mr. John Shalk
Arapahoe Drilling
200 Lomas Blvd. N.W.
Albuquerque, New Mexico 87102

Dear Mr. Shalk:

Northwest Pipeline has requested permission from the New Mexico Oil Conservation Commission to drill a well in a Non-Standard location due to topography and archaeological discoveries. Our records show you are an offset owner of the well which is described below. Notify Joe Ramey, with the NMOCC in Santa Fe, if you have any objections to this location within 20 days. This letter is being sent by certified mail in accordance with NMOCC regulations.

San Juan 29-5 Unit #100 - 1885' FNL & 1165' FEL - Sec 25, T29N, R5W

Sincerely,

Paul C Thompson

Paul Thompson
Drilling Engineer

PCT/djb

P23

RECEIPT FOR CERTIFIED MAIL

NO INSURANCE COVERAGE PROVIDED—
NOT FOR INTERNATIONAL MAIL

(See Reverse)

SENT TO	
John Alhm	
STREET AND NO.	
P.O. Box 289	
P.O. STATE AND ZIP CODE	
Farmington, N.M. 87401	
POSTAGE	\$ 1.50
CONSULT POSTMASTER FOR FEES	
OPTIONAL SERVICES	
RETURN RECEIPT SERVICE	
SPECIAL DELIVERY	
RESTRICTED DELIVERY	
SHOW TO WHOM AND DATE DELIVERED	
SHOW TO WHOM, DATE AND ADDRESS OF DELIVERY	
SHOW TO WHOM AND DATE DELIVERED WITH RESTRICTED DELIVERY	
SHOW TO WHOM, DATE AND ADDRESS OF DELIVERY WITH RESTRICTED DELIVERY	
TOTAL POSTAGE AND FEES	
\$ 95	
POSTMARK OR DATE	
AUG 8 1980	
FARMINGTON, NM	
San Juan 29-5 Unit #100	

PS Form 3800, Apr. 1976

P23 1777883

RECEIPT FOR CERTIFIED MAIL

NO INSURANCE COVERAGE PROVIDED—
NOT FOR INTERNATIONAL MAIL

(See Reverse)

SENT TO	
John Shalk-Arapahoe Drlg	
STREET AND NO.	
200 Lomas Blvd N.W.	
P.O. STATE AND ZIP CODE	
Albuquerque, N.M. 87102	
POSTAGE	\$ 1.50
CONSULT POSTMASTER FOR FEES	
OPTIONAL SERVICES	
RETURN RECEIPT SERVICE	
SPECIAL DELIVERY	
RESTRICTED DELIVERY	
SHOW TO WHOM AND DATE DELIVERED	
SHOW TO WHOM, DATE AND ADDRESS OF DELIVERY	
SHOW TO WHOM AND DATE DELIVERED WITH RESTRICTED DELIVERY	
SHOW TO WHOM, DATE AND ADDRESS OF DELIVERY WITH RESTRICTED DELIVERY	
TOTAL POSTAGE AND FEES	
\$ 95	
POSTMARK OR DATE	
AUG 8 1980	
ALBUQUERQUE, NM	
San Juan 29-5 Unit #100	

PS Form 3800, Apr. 1976

P23 1777882

RECEIPT FOR CERTIFIED MAIL

NO INSURANCE COVERAGE PROVIDED—
NOT FOR INTERNATIONAL MAIL

(See Reverse)

SENT TO	
Keith Bennett - Conoco	
STREET AND NO.	
555 17th Street	
P.O. STATE AND ZIP CODE	
Denver, Colorado 80202	
POSTAGE	\$ 1.50
CONSULT POSTMASTER FOR FEES	
OPTIONAL SERVICES	
RETURN RECEIPT SERVICE	
SPECIAL DELIVERY	
RESTRICTED DELIVERY	
SHOW TO WHOM AND DATE DELIVERED	
SHOW TO WHOM, DATE AND ADDRESS OF DELIVERY	
SHOW TO WHOM AND DATE DELIVERED WITH RESTRICTED DELIVERY	
SHOW TO WHOM, DATE AND ADDRESS OF DELIVERY WITH RESTRICTED DELIVERY	
TOTAL POSTAGE AND FEES	
\$ 95	
POSTMARK OR DATE	
AUG 8 1980	
DENVER, CO	
San Juan 29-5 Unit #100	

PS Form 3800, Apr. 1976