

hsl-1299

Manana Gas, Inc.

P. O. BOX 145

FARMINGTON, NEW MEXICO 87401

ED HARTMAN, PRES.

DEC 15 1980

TEL (505) 325-3066

OIL CONSERVATION DIVISION  
SANTA FE

December 11, 1980

Oil Conservation Division  
P. O. Box 2088  
Santa Fe, New Mexico 87501

Re: Application for Nonstandard Location  
Manana Gas, Inc.  
Ransom #1-M

Gentlemen;

Please advise us of the status of our application for a nonstandard location for our Ransom #1-M well to be located 1240'FSL and 2435'FEL of Section 24, Township 29N, Range 11W, San Juan County.

The application was mailed in the same envelope with our application for multiple completion for the same well on October 22, 1980.

We have received the MC order for the well.

If there are question please call.

Yours very truly,

*AK Kendrick*

A. R. Kendrick  
Vice President

ARK:las

NSL  
Rule 104 F  
Immediate  
check to make  
certain we did  
not do this  
one  
thru

Manana Gas, Inc.

P. O. BOX 148

FARMINGTON, NEW MEXICO 87401

ED HARTMAN, PRES.

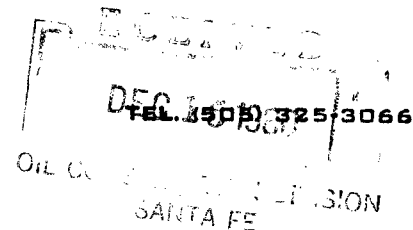

Oil Conservation Commission  
P. O. Box 2088  
Santa Fe, New Mexico 87501

RE: Application for Nonstandard Location  
Manana Gas, Inc.  
Ransom # 1M, 1240'FSL, 2435'FEL  
O-13-29N-11W, San Juan County  
Aztec Fruitland and Aztec Pictured Cliffs Pools

Gentlemen;

We hereby request a nonstandard location for a well to be drilled 1240 feet from the South line and 2435 feet from the East line of Section 13, T29N, R11W, San Juan County, due to topographical conditions.

Any standard location in the south half of the southeast quarter-section would be located in an irrigated field.

We have located the well as far south and east as we believe safe due to the location of the irrigation canal shown on the well location plat and avoid damage to the irrigated field.

Copies of this application are being sent by certified mail to all offset operators of wells which are completed in the Pictured Cliffs formation and shallower. The names and addresses of all these operators are shown on an attached sheet.

Also enclosed are the well location plat and an offset ownership plat.

If further information is needed, please contact us.

Yours very truly,

*A. R. Kendrick*  
A. R. Kendrick  
Vice President

ARK:las  
Enclosures as stated

*COPY*

OPERATORS OF WELLS COMPLETED IN THE  
PICTURED CLIFFS FORMATION AND SHALLOWER

DEC 16 1950  
OIL C. DIVISION  
SANTA FE

Getty Oil Company  
P. O. Box 3360  
Casper, Wyoming 82602

Helen Loraine Harvey  
3002 Plaza Blanca  
Santa Fe, New Mexico 87501

Horace F. McKay, Jr..  
P. O. Box 14738  
Albuquerque, New Mexico 87191

Petroleum Corporation of Texas  
P. O. Box 911  
Breckenridge, Texas 76024

Elliott A. Riggs  
P. O. Box 711  
Farmington, New Mexico 87401

D. W. Stiles  
1060 County Road 329  
Ignacio, Colorado 81137

Shallowers DEC 15 1966

Range 10 West

11	12		12	7		
14	13	Getty Oil Company	H. L. Harvey	13	18	Petroleum Corp. of Texas  Hanley #2 *  Hanley #2J *
			#3 *    * #1			
			Jones			
		D. Woodrow Stiles	Manana Gas, Inc.			
			Ransom #1 *			T 29 N
		*Gale #1	O Ransom #1M			
14	13			13	18	
23	24	Manana Gas, Inc. Clarence #1 *		24	19	Horace F. McKay, Jr.  Bearden #1A *  * Bearden #1
		H. L. Harvey * Gale #1	Elliott A. Rings Martin #1 *			

All distances must be from the outer boundaries of the Section.

Operator <b>MANANA GAS, INCORPORATED</b>			Lease <b>RANSOM</b>		Well No. <b>CEC 13131M</b>
Unit Letter <b>0</b>	Section <b>13</b>	Township <b>29N</b>	Range <b>11W</b>	County <b>San Juan</b>	
Actual Footage Location of Well: <b>1240</b> feet from the <b>South</b> line and <b>2435</b> feet from the <b>East</b> line					
Ground Level Elev. <b>5581</b>	Producing Formation <b>Fruitland/Pictured Cliffs Aztec/Aztec</b>			Dedicated Acreage <b>160/160</b> Acres	

1. Outline the acreage dedicated to the subject well by colored pencil or hachure marks on the plat below.
2. If more than one lease is dedicated to the well, outline each and identify the ownership thereof (both as to working interest and royalty).
3. If more than one lease of different ownership is dedicated to the well, have the interests of all owners been consolidated by communitization, unitization, force-pooling, etc?

☐ Yes ☐ No If answer is "yes," type of consolidation \_\_\_\_\_

If answer is "no," list the owners and tract descriptions which have actually been consolidated. (Use reverse side of this form if necessary.) \_\_\_\_\_

No allowable will be assigned to the well until all interests have been consolidated (by communitization, unitization, forced-pooling, or otherwise) or until a non-standard unit, eliminating such interests, has been approved by the Commission.

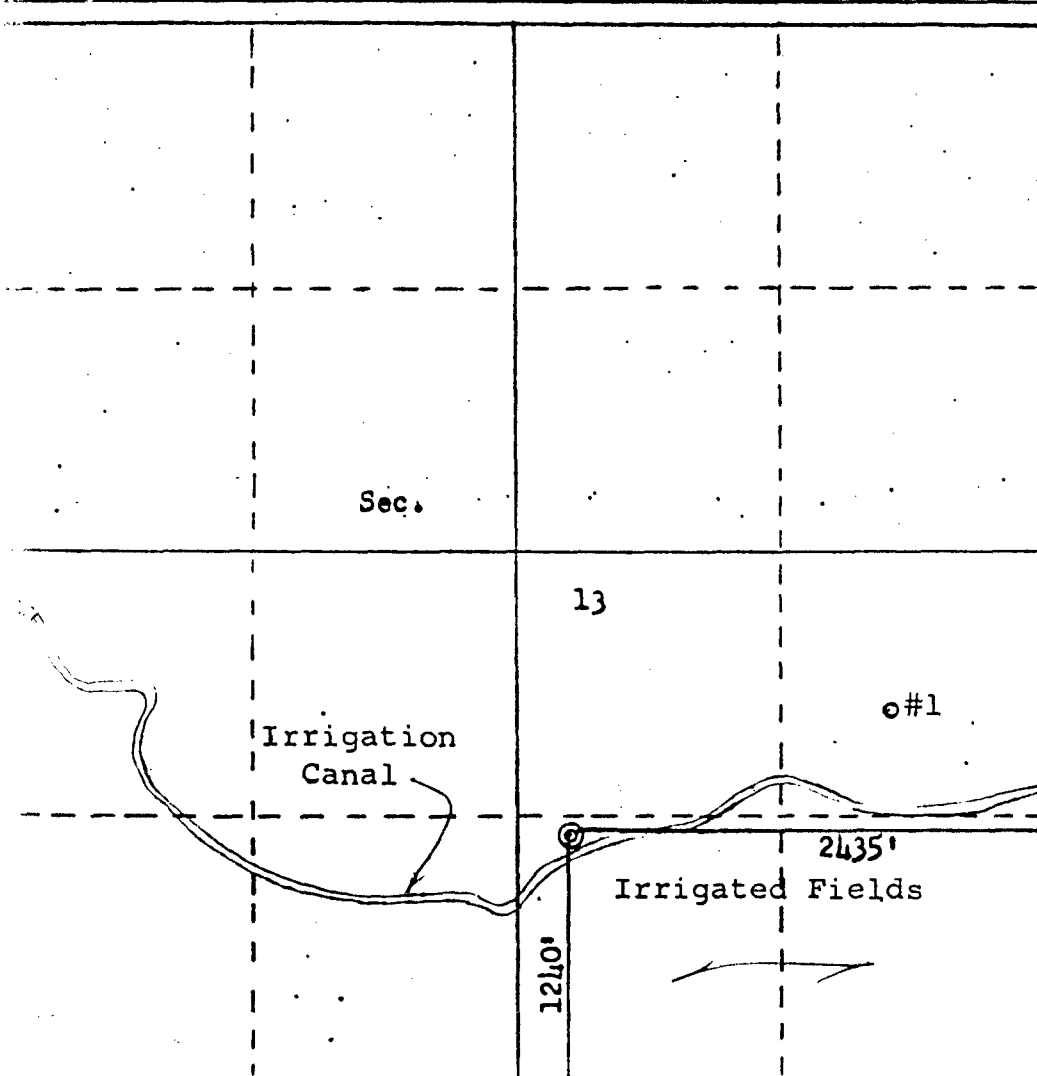

Scale: 1"=1000'

## CERTIFICATION

I hereby certify that the information contained herein is true and complete to the best of my knowledge and belief.

Name  
*W. R. Kendrick*

Position  
Vice President

Company  
Manana Gas, Inc.

Date  
10/22/80

I hereby certify that the well location shown on this plat was plotted from field notes of actual surveys made by me or under my supervision, and that the same is true and correct to the best of my knowledge and belief.

Date Surveyed  
October 15, 1980

Registered Professional Engineer  
and Land Surveyor

*Fred B. Kerr Jr.*  
Fred B. Kerr Jr.

Certificate No.  
3950

OIL CONSERVATION COMMISSION  
Alto DISTRICT

OIL CONSERVATION COMMISSION  
BOX 2088  
SANTA FE, NEW MEXICO

DATE October 28, 1980

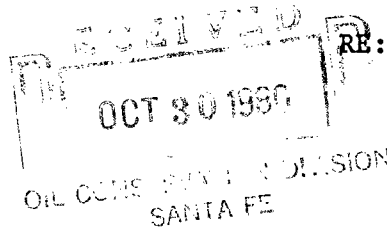

RE: Proposed MC \_\_\_\_\_  
Proposed DHC \_\_\_\_\_  
Proposed NSL α \_\_\_\_\_  
Proposed SWD \_\_\_\_\_  
Proposed WFX \_\_\_\_\_  
Proposed PMX \_\_\_\_\_

Gentlemen:

I have examined the application dated October 23, 1980  
for the Mancos Gas, Inc. Ransom #1M 0-13-29N-1W  
Operator Lease and Well No. Unit, S-T-R

and my recommendations are as follows:

Approve  
\_\_\_\_\_  
\_\_\_\_\_  
\_\_\_\_\_  
\_\_\_\_\_  
\_\_\_\_\_

Yours very truly,

Frank J. Dwyer

Manana Gas, Inc.

P. O. BOX 145

FARMINGTON, NEW MEXICO 87401

ED HARTMAN, PRES.

TEL. (505) 325-3066

Oil Conservation Commission  
P. O. Box 2088  
Santa Fe, New Mexico 87501

RE: Application for Nonstandard Location  
Manana Gas, Inc.  
Ransom # 1M, 1240'FSL, 2435'FEL  
O-13-29N-11W, San Juan County  
Aztec Fruitland and Aztec Pictured Cliffs Pools

OIL CONSERVATION COMMISSION  
SANTA FE

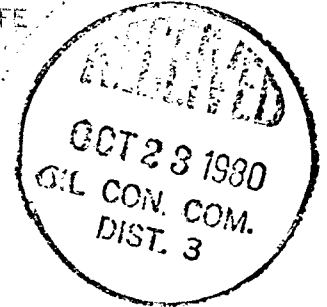

Gentlemen;

We hereby request a nonstandard location for a well to be drilled 1240 feet from the South line and 2435 feet from the East line of Section 13, T29N, R11W, San Juan County, due to topographical conditions.

Any standard location in the south half of the southeast quarter-section would be located in an irrigated field.

We have located the well as far south and east as we believe safe due to the location of the irrigation canal shown on the well location plat and avoid damage to the irrigated field.

Copies of this application are being sent by certified mail to all offset operators of wells which are completed in the Pictured Cliffs formation and shallower. The names and addresses of all these operators are shown on an attached sheet.

Also enclosed are the well location plat and an offset ownership plat.

If further information is needed, please contact us.

Yours very truly,

  
A. R. Kendrick  
Vice President

ARK:las  
Enclosures as stated

56  
Manana Gas, Inc.

P. O. BOX 148

FARMINGTON, NEW MEXICO 87401

ED HARTMAN, PRES.

744 1154-1299  
NOV 22 1980

TEL. (505) 325-3066

OIL CONSERVATION DIVISION  
SANTA FE

October 22, 1980

Helen Loraine Harvey  
3002 Plaza Blanca  
Santa Fe, New Mexico 87501

RE: Proposed Nonstandard Location  
Manana Gas, Inc.  
Ransom # 1M  
0-13-29N-11W

Gentlemen;

Enclosed is an application for nonstandard location for the subject well to be located 1240'FSL and 2435'FEL of Section 13, T29N, R11W, San Juan County, New Mexico.

Please execute one copy of the waiver below and forward it to the New Mexico Oil Conservation Division if you have no objection to this application.

If you desire further information, please contact us.

Yours very truly,

*A. R. Kendrick*

A. R. Kendrick  
Vice President

ARK:las  
Enclosure

Oil Conservation Division  
P. O. Box 2088  
Santa Fe, New Mexico 87501

We, as an offset operator, do hereby waive objection to the above application.

Operator

Helen Loraine Harvey

By

Title

Date

*Helen Loraine Harvey*  
Operator  
Oct 26, 1980



Manana Gas, Inc.

P. O. BOX 145

FARMINGTON, NEW MEXICO 87401

ED HARTMAN, PRES.

OCT 29 1980

TEL. (505) 325-3066

SANTA FE

October 22, 1980

D. W. Stiles  
1060 County Road 329  
Ignacio, Colorado 81137

RE: Proposed Nonstandard Location  
Manana Gas, Inc.  
Ransom # 1M  
0-13-29N-11W

Gentlemen;

Enclosed is an application for nonstandard location for the subject well to be located 1240'FSL and 2435'FEL of Section 13, T29N, R11W, San Juan County, New Mexico.

Please execute one copy of the waiver below and forward it to the New Mexico Oil Conservation Division if you have no objection to this application.

If you desire further information, please contact us.

Yours very truly,

*A. R. Kendrick*

A. R. Kendrick  
Vice President

ARK:las  
Enclosure

Oil Conservation Division  
P. O. Box 2088  
Santa Fe, New Mexico 87501

We, as an offset operator, do hereby waive objection to the above application.

Operator

D. W. Stiles

By

Title

Date

*D. W. Stiles*  
*Operator*  
*10-24-80*

Manana Gas, Inc.

P. O. BOX 36990

ED HARTMAN, PRES.

ALBUQUERQUE, NEW MEXICO 87176

TELE: (505) 884-4863

(505) 884-0814

November 14, 1985

RECEIVED NOV 15 1985

Oil Conservation Division  
Box 2088  
Santa Fe, New Mexico 87504-2088

Re: Application for Unorthodox Location  
Bradley H. and Margaret Keyes, Trustees  
Ransom # 1  
SE $\frac{1}{4}$  Sec. 13-29N-11W  
San Juan County, N.M.

Gentlemen:

We hereby waive objection to the subject application for the  
unorthodox location for the Ransom # 1M well.

Yours very truly

Manana Gas, Inc.

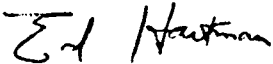

---

Ed Hartman, Pres.

EMH/nh



TONEY ANAYA  
GOVERNOR

STATE OF NEW MEXICO  
ENERGY AND MINERALS DEPARTMENT  
OIL CONSERVATION DIVISION

December 3, 1985



1935 - 1985

POST OFFICE BOX 2088  
STATE LAND OFFICE BUILDING  
SANTA FE, NEW MEXICO 87501  
(505) 827-5800

Bradley H. & Margaret N. Keyes  
P. O. Box 516  
Aztec, New Mexico 87410

Attention: Mr. A. R. Kendrick

AMENDED  
Administrative Order NSL-1299

Gentlemen:

Reference is made to your application for a non-standard location for your Ransom Well No. 1-M to be located 1240 feet from the South line and 2435 feet from the East line of Section 13, Township 29 North, Range 11 West, NMPM, Aztec Fruitland and Bloomfield Farmington Pools, San Juan County, New Mexico.

By authority granted me under the provisions of Rule 104 F, the above-described unorthodox location is hereby approved.

Sincerely,

R. L. STAMETS, DIRECTOR

RLS/DC/dr

cc: Oil Conservation Division - Aztec

REMARKS: This amended Administrative Order authorizes the completion of the above said well in the Bloomfield Farmington Pool as well as the originally approved Aztec Fruitland Pool.

**A. R. "AL" KENDRICK**

Box 516 • Aztec, New Mexico 87410 • (505) 334-2555

*Daniel  
Catanach*

November 4, 1985

Oil Conservation Division  
Box 2088  
Santa fe, New Mexico 87504-2088

Re: Application for an Unorthodox Location  
Bradley H. and Margaret N. Keyes, Trustees  
Ransom #1M, 1240' FSL 2435' FEL  
O-13-T29N-R11W, San Juan County  
Bloomfield Farmington Oil Pool

Gentlemen:

On behalf of Bradley H. and Margaret N. Keyes, Trustees, we hereby request an unorthodox location for their Ransom #1M well drilled 1240 feet from the south line and 2435 feet from the east line of section 13, T29N, R11W, San Juan County, due to topographical conditions.

The well has been completed in the Fruitland and Farmington formations.

The location of the Fruitland completion was approved by Administrative Order NSL-1299 due to topographical conditions.

The same topographical conditions exist for the Farmington formation completion.

The operator of the only offset well has been notified of this application by certified mail.

If further information is needed, please contact me.

Yours very truly,

*AK*

A. R. Kendrick

Enclosure

xc: Manana Gas, Inc., Box 36990, Albuquerque, NM 87167 — by CERTIFIED MAIL  
Bradley H. and Margaret N. Keyes, Trustees, 103 N. Main, Aztec, NM 87410  
Oil Conservation Division, 1000 Rio Brazos Road, Aztec, NM 87410

**RECEIVED**  
NOV 04 1985  
OIL CON. DIV.  
DIST. 3

# OWNERSHIP & TOPOGRAPHIC PLAT SURROUNDING SW/4SE/4 13-T29N-R11W

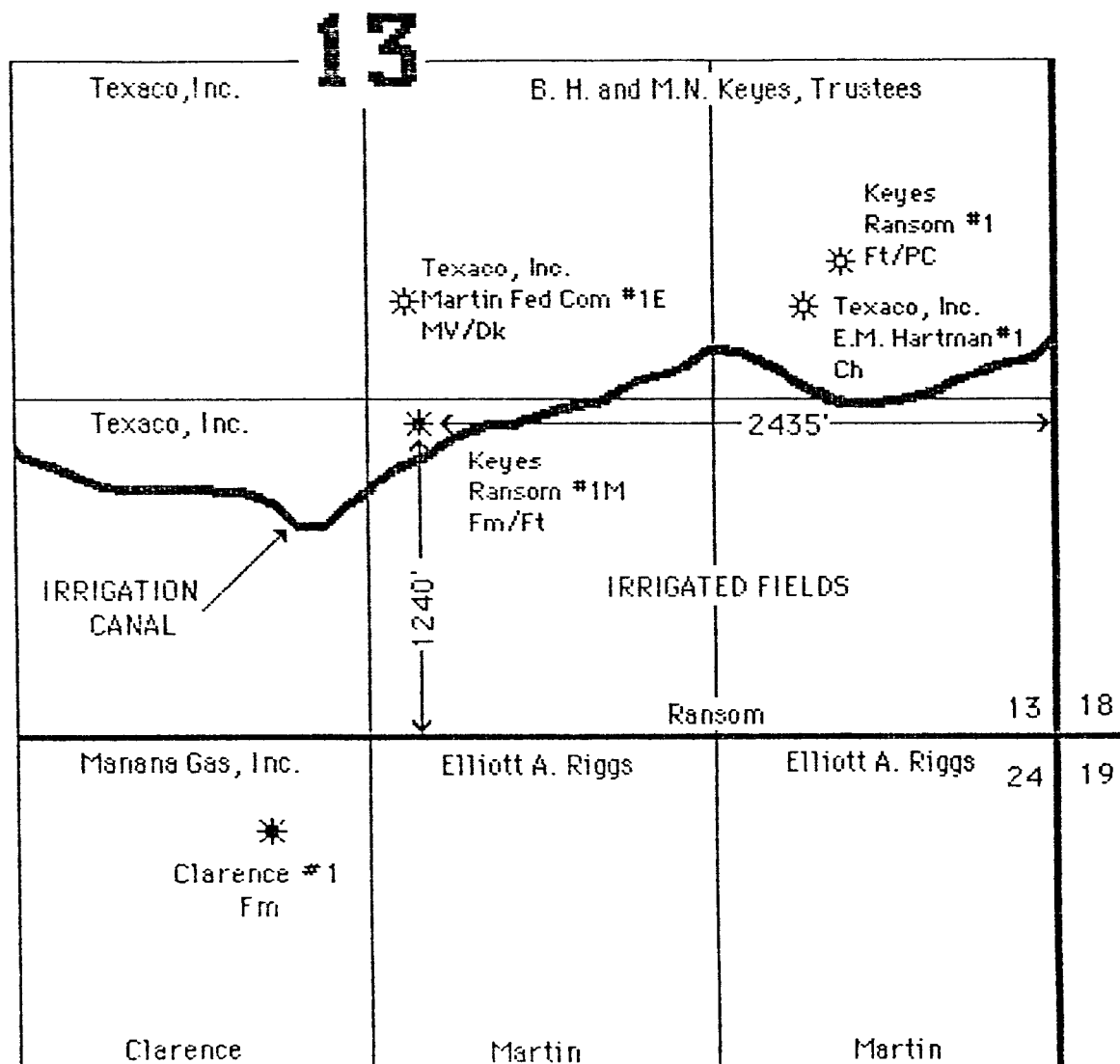

## LEGEND:

Fm = Farmington Completion  
Ft = Fruitland Completion  
PC = Pictured Cliffs Completion  
Ch = Chacra Completion  
MV = Mesaverde Completion  
Dk = Dakota Completion

RECEIVED

NOV 04 1985

OIL CON. DIV  
DIST. 3

## DATA SHEET

Operator: Bradley H. and Margaret N. Keyes, Trustees  
Well: Ransom #1M  
Location: 1240' FSL 2435' FEL 13-T29N-R11W  
Pools: (Shallow) Bloomfield Farmington Oil Pool  
(Deep) Aztec Fruitland Gas Pool  
County: San Juan

Perfs: Farmington 896 to 906 (20 holes) & 1128 to 1141 (26 holes)  
Fruitland 1615 to 1627 (24 holes) - *gas 160 Acres -*  
TOTAL 70 holes

*40 Acres  
Unit 0 dead.*

Tops: Kirtland 508'  
Fruitland 1510'  
Pictured Cliffs 1890'

I.P. Test Date = 9/20/85  
SICP = 368 psig /8 days  
SITP = 368 psig /8 days  
Choke = 0.75"  
Q = 263 Mcfpd  
AOF = 288 Mcfpd

Proposed production split:

Farmington:  $46 \div 70 = .6571$  use 65%  
Fruitland:  $24 \div 70 = .3429$  use 35%