

BEARTOOTH OIL & GAS COMPANY

P.O. BOX ~~1034~~ 2564  
BILLINGS, MONTANA 59103  
(406) 259-2451

June 4, 1981

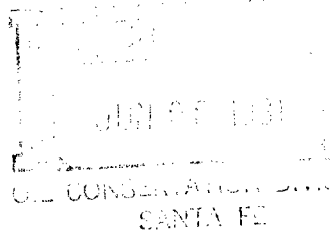

Oil Conservation Commission  
P. O. Box 2088  
Santa Fe, New Mexico 87501

Gentlemen:

This letter is to request a non-standard well location for the Minel Federal #1, SW $\frac{1}{4}$ NW $\frac{1}{4}$  Sec. 7-25N-3W, Rio Arriba County, New Mexico. This well was originally permitted and drilled as a standard location Basin Dakota well. Following completion, it has been classified as an Ojito Gallup-Dakota well and is a non-standard location for the 40 acre spacing of the Ojito Gallup-Dakota pool.

Enclosed is a plat dedicating the SW $\frac{1}{4}$ NW $\frac{1}{4}$  to the well.

The offset operators are as follows:

Minel, Inc.  
27209 Kane Lane  
Conroe, Texas 77302

Gulf Oil Corporation  
324 N. Robinson  
Oklahoma City, Oklahoma 73102

Energy Increments, Inc.  
P. O. Box 15015  
Las Vegas, Nevada 89114

Continental Oil Company  
P. O. Box 2197  
Houston, Texas 77001

These operators are being furnished a copy of this request by Certified Mail.

Yours very truly,

BEARTOOTH OIL & GAS COMPANY

*James G. Routson*  
James G. Routson  
Petroleum Engineer

JGR/gb

cc: Oil Conservation Commission - Aztec, New Mexico

NSL-1380  
1650N-995W  
Buh 104 F  
6-28-81

**NEW MEXICO OIL CONSERVATION COMMISSION  
WELL LOCATION AND ACREAGE DEDICATION PLAT**

Form C-102  
Supersedes C-128  
Effective 1-1-65

All distances must be from the outer boundaries of the Section.

Operator <b>Beartooth Oil &amp; Gas Company</b>			Lease <b>Minel-Federal</b>		Well No. <b>#1</b>
Unit Letter <b>E</b>	Section <b>6</b>	Township <b>25 North</b>	Range <b>3 West</b>	County <b>Rio Arriba</b>	
Actual Footage Location of Well: <div style="display: flex; justify-content: space-between;"> <span><b>1605</b> feet from the <b>North</b> line and</span> <span><b>995</b> feet from the <b>West</b> line</span> </div>					
Ground Level Elev. <b>7336'</b>	Producing Formation <b>Gallup-Dakota</b>	Pool <b>Ojito Gallup-Dakota</b>		Dedicated Acreage: <b>40</b> Acres	

1. Outline the acreage dedicated to the subject well by colored pencil or hachure marks on the plat below.
2. If more than one lease is dedicated to the well, outline each and identify the ownership thereof (both as to working interest and royalty).
3. If more than one lease of different ownership is dedicated to the well, have the interests of all owners been consolidated by communitization, unitization, force-pooling, etc?

☐ Yes    ☐ No    If answer is "yes," type of consolidation \_\_\_\_\_

If answer is "no," list the owners and tract descriptions which have actually been consolidated. (Use reverse side of this form if necessary.) \_\_\_\_\_

No allowable will be assigned to the well until all interests have been consolidated (by communitization, unitization, forced-pooling, or otherwise) or until a non-standard unit, eliminating such interests, has been approved by the Commission.

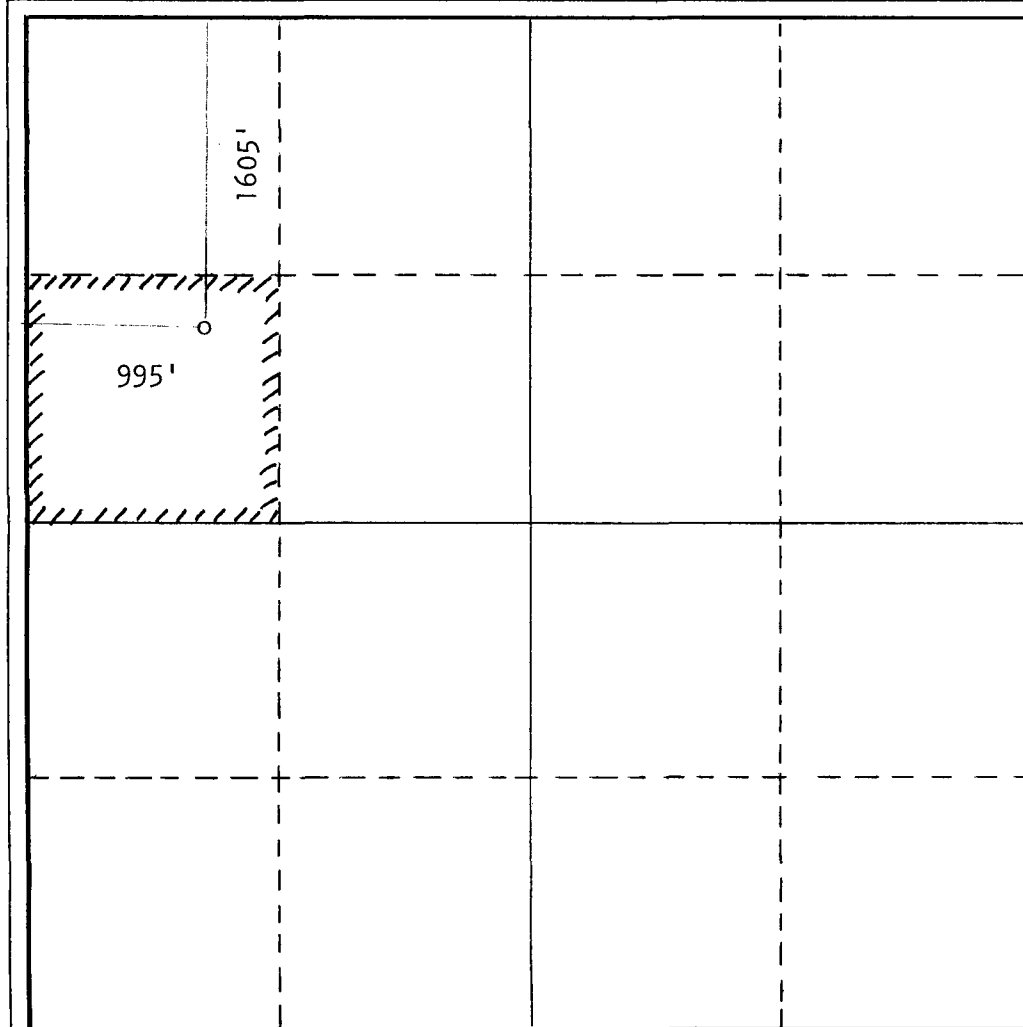

**CERTIFICATION**

*I hereby certify that the information contained herein is true and complete to the best of my knowledge and belief.*

*James G. Routson*  
Name **James G. Routson**

Position **Petroleum Engineer**

Company **Beartooth Oil & Gas Company**

Date **June 4, 1981**

*I hereby certify that the well location shown on this plat was plotted from field notes of actual surveys made by me or under my supervision, and that the same is true and correct to the best of my knowledge and belief.*

Date Surveyed \_\_\_\_\_

Registered Professional Engineer  
and/or Land Surveyor

Certificate No. \_\_\_\_\_

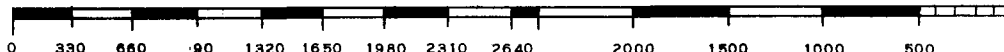



STATE OF NEW MEXICO  
ENERGY AND MINERALS DEPARTMENT

OIL CONSERVATION DIVISION  
AZTEC DISTRICT OFFICE

1000 RIO BRAZOS ROAD  
AZTEC, NEW MEXICO 87410  
(505) 334-6178

OIL CONSERVATION DIVISION  
BOX 2088  
SANTA FE, NEW MEXICO 87501

DATE JUL 20 1981

RE: Proposed MC \_\_\_\_\_  
Proposed DHC \_\_\_\_\_  
Proposed NSL \_\_\_\_\_  
Proposed SWD \_\_\_\_\_  
Proposed WFX \_\_\_\_\_  
Proposed PMX \_\_\_\_\_

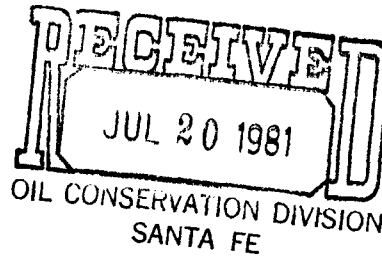

Gentlemen:

I have examined the application dated JUL 20 1981  
for the Operator Lease and Well No. Unit, S-T-R

and my recommendations are as follows:

\_\_\_\_\_  
\_\_\_\_\_  
\_\_\_\_\_  
\_\_\_\_\_  
\_\_\_\_\_

Yours truly,

[Signature]



STATE OF NEW MEXICO  
ENERGY AND MINERALS DEPARTMENT  
OIL CONSERVATION DIVISION

June 10, 1981

BRUCE KING  
GOVERNOR  
LARRY KEHOE  
SECRETARY

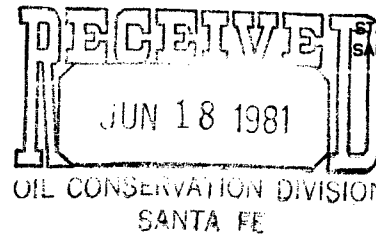

POST OFFICE BOX 2088  
STATE LAND OFFICE BUILDING  
SANTA FE, NEW MEXICO 87501  
(505) 827-2434

Beartooth Oil & Gas Company  
P. O. Box 2564  
Billings, Montana 59103

Attention: Mr. James G. Routson

Re: Application for Non-Standard  
Location: Minel Federal Well No. 1,  
Sec. 7, T-25-N, R-3-W, Rio Arriba  
County, New Mexico

We may not process the subject application for non-standard location until the required information or plats checked below (is) (are) submitted.

- ☒ A plat must be submitted clearly showing the ownership of the offsetting leases.
- ☐ A statement must be submitted that offset owners have been notified of the application by certified mail.
- ☐ A plat must be submitted fully identifying the topography necessitating the non-standard location.
- ☐ Other:

Very truly yours

R. L. STAMETS  
Technical Support Chief

RLS/dr

*Plat attached -*

*Gene E. Brown*







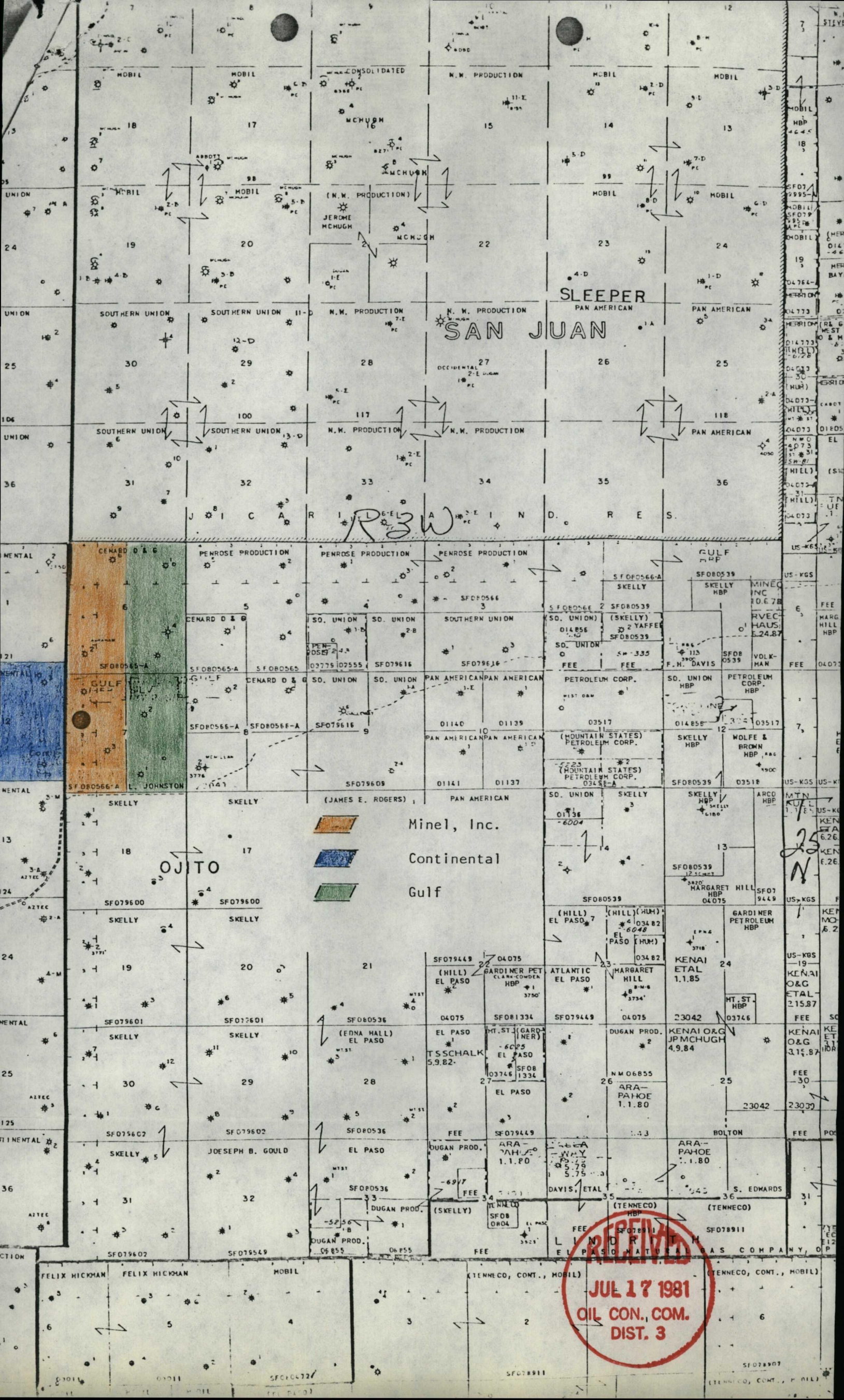

**JUL 17 1981**  
**OIL CON. COM.**  
**DIST. 3**