

CITIES SERVICE COMPANY  
ENERGY RESOURCES GROUP

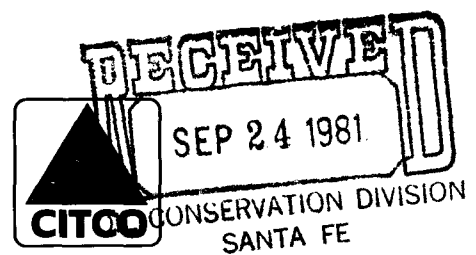

Box 1919  
Midland, Texas 79702  
(915) 685-5600  
September 22, 1981

Energy and Minerals Department  
Oil and Conservation Division  
P. O. Box 2088  
Santa Fe, New Mexico 87501

ATTENTION: Mr. Joe D. Ramey

RE: Request for Administrative  
Approval to Drill Southeast  
Maljamar Grayburg-San Andres  
Unit Tract 4 Well No. 12,  
Lea County, New Mexico

*1295 N 8 W 29-175-33E*

Gentlemen:

Cities Service, as operator of the Southeast Maljamar Grayburg-San Andres Unit, a Secondary Recovery Project, respectfully requests administrative approval as authorized by case No. 4750, order No. R-3134-A, to drill on a non-standard location, Tract 4, Well No. 12, located 1295' FNL & 1295' FWL of Section 29-T17S-R33E, Lea County, New Mexico. The estimated total depth is 4400' and the proposed casing program is as follows:

Hole Size	Csg. Size	Weight/Ft.	Setting Depth	Cmt.	Est. top of cement
12-1/4"	8-5/8"	32#	1300'	650 sx.	circ.
7-7/8"	5-1/2"	15.5#	3900'	200 sx.	2400'
4-5/8"	4" liner	9.5#	3700-4400'	75 sx.	3700'

The NW/4 NW/4, 40 acres will be dedicated to this well.

Thank you for consideration of our request.

Very truly yours,

CITIES SERVICE COMPANY

*Elmer Startz*

Elmer Startz  
Region Operations Manager-Production  
Southwest Region  
E&P Division

ES:JME:lmcb

cc: Oil Conservation Division  
P. O. Box 1980  
Hobbs, New Mexico 88240

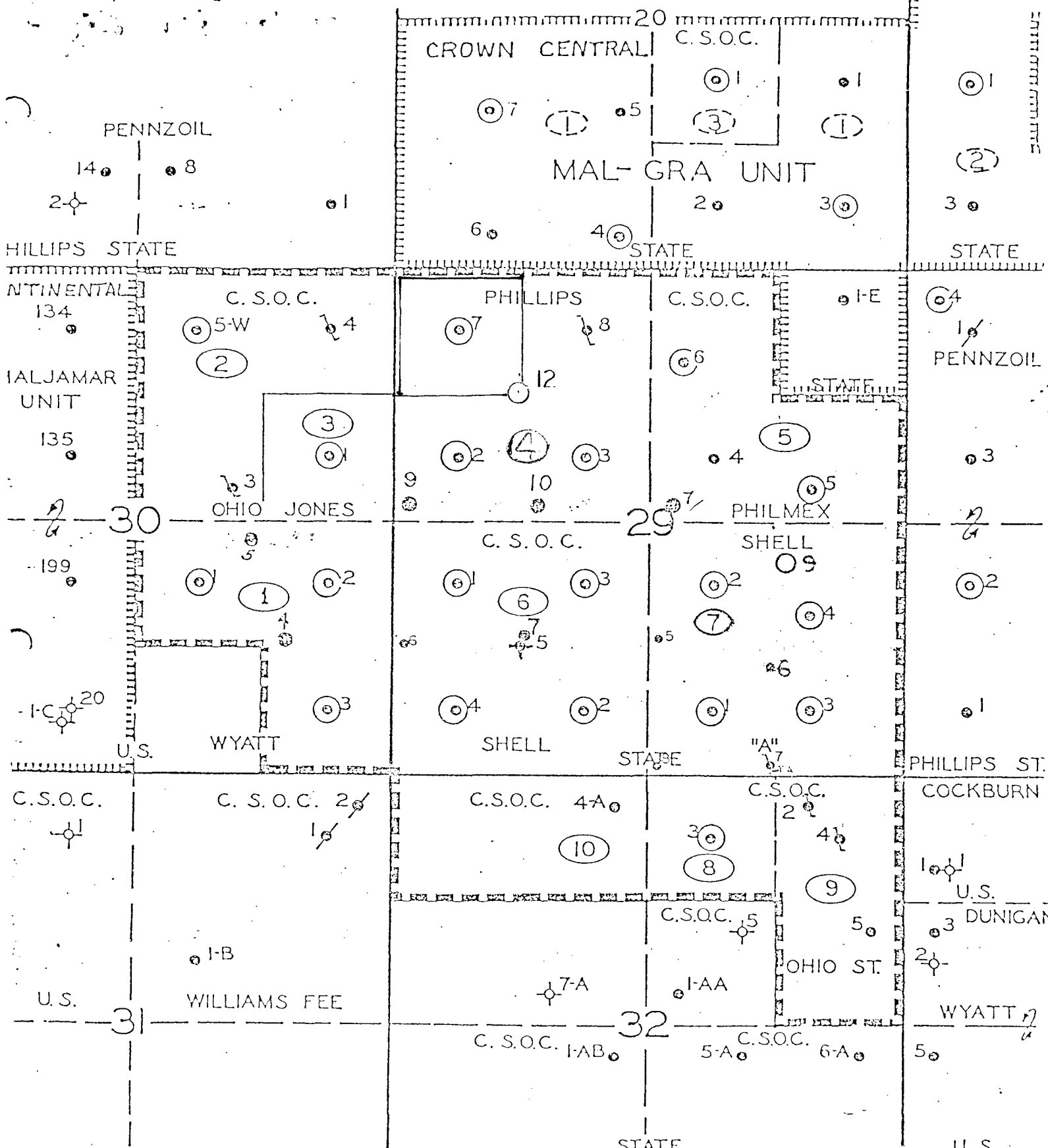

GRAYBURG — SAN ANDRES  
SOUTHEAST MALJAMAR<sup>A</sup> UNIT

LEA COUNTY, NEW MEXICO

T-17 - S. R-33 - E.  
SCALE: 4"=1 MI.

JULY, 1973

- - Oil Wells
- ⊙ - Water injection wells
- ⊗ - Abandoned wells

NO. OF COPIES RECEIVED	
DISTRIBUTION	
SANTA FE	
FILE	
U.S.G.S.	
LAND OFFICE	
OPERATOR	

NEW MEXICO OIL CONSERVATION COMMISSION

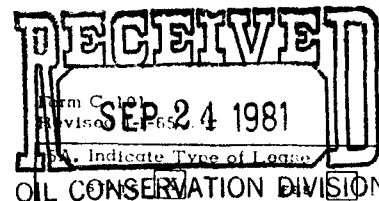

5. State of **SANTA FE**  
B-2229

APPLICATION FOR PERMIT TO DRILL, DEEPEN, OR PLUG BACK

1a. Type of Work		7. Unit Agreement Name	
b. Type of Well OIL WELL <input checked="" type="checkbox"/> GAS WELL <input type="checkbox"/> OTHER <input type="checkbox"/>		SMGSAU	
2. Name of Operator CITIES SERVICE COMPANY		8. Farm or Lease Name Tract 4	
3. Address of Operator P. O. Box 1919 Midland, Texas 79702		9. Well No. 12	
4. Location of Well UNIT LETTER <u>D</u> LOCATED <u>1295</u> FEET FROM THE <u>North</u> LINE AND <u>1295</u> FEET FROM THE <u>West</u> LINE OF SEC. <u>29</u> TWP. <u>17S</u> RGE. <u>33E</u> NMPM		10. Field and Pool, or Wildcat Maljamar (G-SA)	
		12. County Lea	
		19. Proposed Depth 4400'	
		19A. Formation Grybg-SA	
		20. Rotary or C.T. Rotary	
21. Elevations (Show whether DF, RI, etc.) 4081' GR		21A. Kind & Status Plug. Bond Required/Approved	
		21B. Drilling Contractor Cactus Drilling Co.	
		22. Approx. Date Work will start October 20, 1981	

PROPOSED CASING AND CEMENT PROGRAM

SIZE OF HOLE	SIZE OF CASING	WEIGHT PER FOOT	SETTING DEPTH	SACKS OF CEMENT	EST. TOP
12 1/4"	8-5/8"	32#	1300'	650	circulated
7-7/8"	5-1/2"	15.5#	3980'	2000	2400'
4-5/8"	4" (Liner)	9.5#	3700-4400'	75	3700'

It is proposed to drill this well to a T.D. of 4400' and complete in the Grayburg-San Andres formation. The blowout prevention program is as follows:

1. one set of blind rams
2. one set of drill pipe rams

The acreage assigned to this well is dedicated to Phillips Petroleum Company as casinghead gas purchaser.

IN ABOVE SPACE DESCRIBE PROPOSED PROGRAM: IF PROPOSAL IS TO DEEPEN OR PLUG BACK, GIVE DATA ON PRESENT PRODUCTIVE ZONE AND PROPOSED NEW PRODUCTIVE ZONE. GIVE BLOWOUT PREVENTION PROGRAM, IF ANY.

I hereby certify that the information above is true and complete to the best of my knowledge and belief.

Signed Elmer Stutz Title Reg. Operations Mgr.-Prod. Date 9-22-81

(This space for State Use)

APPROVED BY \_\_\_\_\_ TITLE \_\_\_\_\_ DATE \_\_\_\_\_

CONDITIONS OF APPROVAL, IF ANY:

NEW MEXICO OIL CONSERVATION COMMISSION  
WELL LOCATION AND ACREAGE DEDICATION PLAT

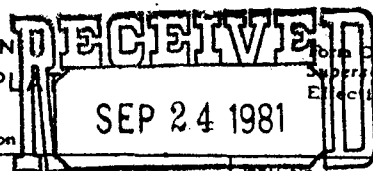

Form O-102  
Supersedes C-128  
Effective 1-1-65

All distances must be from the outer boundaries of the Section

Operator <b>CITES SERVICE CO.</b>		Lease <b>SMGSAN TRACT</b>		Oil Conservation Division <b>SANTA FE</b>	
Unit Letter <b>D</b>	Section <b>29</b>	Township <b>17 SOUTH</b>	Range <b>33 EAST</b>	County <b>LEA</b>	
Actual Footage Location of Well: <b>1295</b> feet from the <b>NORTH</b> line and <b>1295</b> feet from the <b>WEST</b> line					
Ground Level Elev. <b>4081.0</b>	Producing Formation <b>Grayburg - San Andres</b>		Pool <b>Maljamar (G-SA)</b>	Dedicated Acreage: <b>40</b> Acres	

1. Outline the acreage dedicated to the subject well by colored pencil or hachure marks on the plat below.
2. If more than one lease is dedicated to the well, outline each and identify the ownership thereof (both as to working interest and royalty).
3. If more than one lease of different ownership is dedicated to the well, have the interests of all owners been consolidated by communitization, unitization, force-pooling, etc?

☒ Yes ☐ No If answer is "yes," type of consolidation Unitization

If answer is "no," list the owners and tract descriptions which have actually been consolidated. (Use reverse side of this form if necessary.) \_\_\_\_\_

No allowable will be assigned to the well until all interests have been consolidated (by communitization, unitization, forced-pooling, or otherwise) or until a non-standard unit, eliminating such interests, has been approved by the Commission.

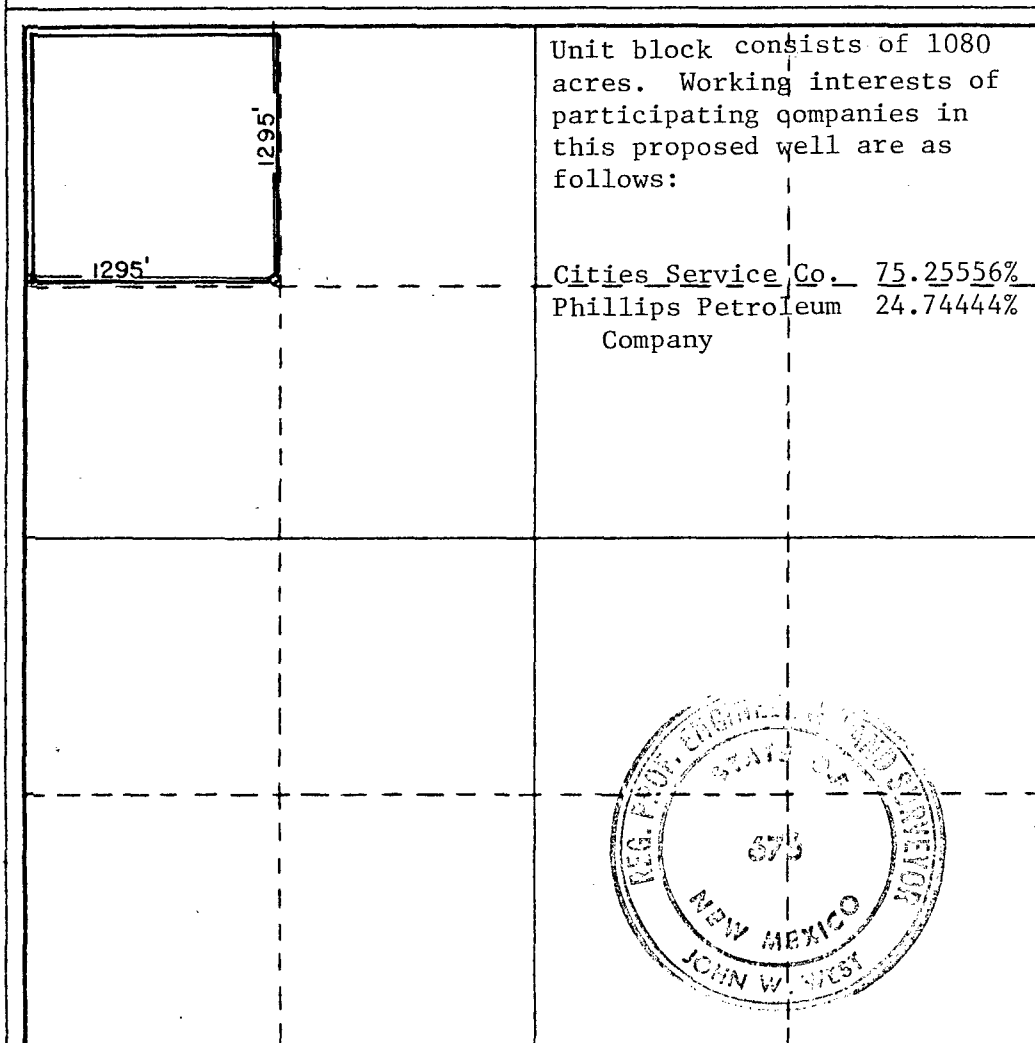

CERTIFICATION

I hereby certify that the information contained herein is true and complete to the best of my knowledge and belief.

Name  
*Elmer Stutz*  
Position  
**Region Oper. Manager-Prod.**  
Company  
**CITIES SERVICE COMPANY**  
Date  
**September 22, 1981**

I hereby certify that the well location shown on this plat was plotted from field notes of actual surveys made by me or under my supervision, and that the same is true and correct to the best of my knowledge and belief.

Date Surveyed **9-15-81**

Registered Professional Engineer and/or Land Surveyor

*John W. West*

Certificate No. **JOHN W. WEST 676**  
**PATRICK A. ROMERO 6868**  
**Ronald J. Eidson 3239**

