



April 10, 1995

Mr. William J. LeMay, Director
New Mexico Oil Conservation Division
2040 S. Pacheco Street
P.O. Box 6429
Santa Fe, NM 87505

Southern

Rockies

Business

Unit

RECEIVED

APR 17 1995

Oil Conservation Division

Application For Unorthodox Location
Storey "C" #2M Well
1890' FNL, 655' FWL, Section 35-T28N-R9W
Blanco Mesaverde and Otero Chacra Pools
San Juan County, New Mexico

Amoco Production Company hereby requests administrative approval for an unorthodox well location for the Storey "C" #2M well in the Blanco Mesaverde and Otero Chacra Pools. Amoco plans to recompleate this well to the Blanco Mesaverde and Otero Chacra formations then commingling those formations with the existing Basin Dakota formation. We have recently filed an application with the NMOCD for downhole commingling in this well following the recompletions. The spacing unit for this well is the W/2 Section 35 in the Blanco Mesaverde and the NW/4 Section 35 for the Otero Chacra. The unorthodox location for the Blanco Mesaverde and Otero Chacra formations is sought due to the well being less than the required 790' to any outer boundary.

A copy of this application will be submitted to the offset operators by certified mail with a request that they furnish your Santa Fe office with a Waiver of Objection, and return one copy to this office. Attached are plats showing the location of the well, offset operators, and all wells drilled in the area.

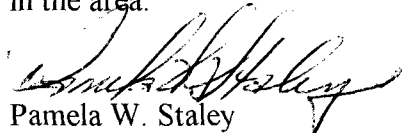
Pamela W. Staley

Attachments

cc: Frank Chavez, Supervisor Lara Kwartin, Amoco
 NMOCD District III Gail Jefferson, Amoco
 1000 Rio Brazos Road
 Aztec, NM 87410

WAIVER

_____ hereby waives objection to Amoco's application for an unorthodox well location for the Storey "C" #2M well described above.

By: _____

Date: _____

LIST OF ADDRESSES FOR OFFSET OPERATORS
Storey "C" #2M

- 1 Meridian Oil, Inc.
P.O. Box 4289
Farmington, NM 87401
- ✓ 2 Texaco E&P, Inc.
P.O. Box 2100
Denver, CO 80201
- ✓ 3 Mobil Production Texas and New Mexico, Inc.
P.O. Box 2080
Dallas, Texas 75221-2080
- 4 Northwest Pipeline Corporation
P.O. Box 58900
Salt Lake, City, UT 84158-0900
- ✓ 5 El Paso Natural Gas
614 Reilly
P.O. Box 4990
Farmington, NM 87401
- ✓ 6 Conoco, Inc.
10 Desta Drive
Midland, TX 79705

APPLICATION FOR APPROVAL OF UNORTHODOX LOCATION UNDER RULE 104-F

**Storey "C" #2M Well
1890' FNL, 655' FWL
Section 35-T28N-R9W**

ATTACHMENTS:

- 9-SECTION PLAT SHOWING LOCATION OF ALL WELLS AND OFFSET OPERATORS
- FORM C-102 FOR ORIGINAL BASIN DAKOTA WELL
- FORM C-102 FOR BLANCO MESAVERDE FORMATION
- FORM C-102 FOR OTERO CHACRA FORMATION
- LIST OF ALL OFFSET OPERATORS AND THEIR ADDRESSES

13,308,391.96 FT. N
36° 38' 25" N

107° 45'

13,308,391.96 FT. N
36° 38' 25" N

992,069.16 FT. E
107° 47' 3" W

1,007,930.84 FT. E
107° 43' 49" W

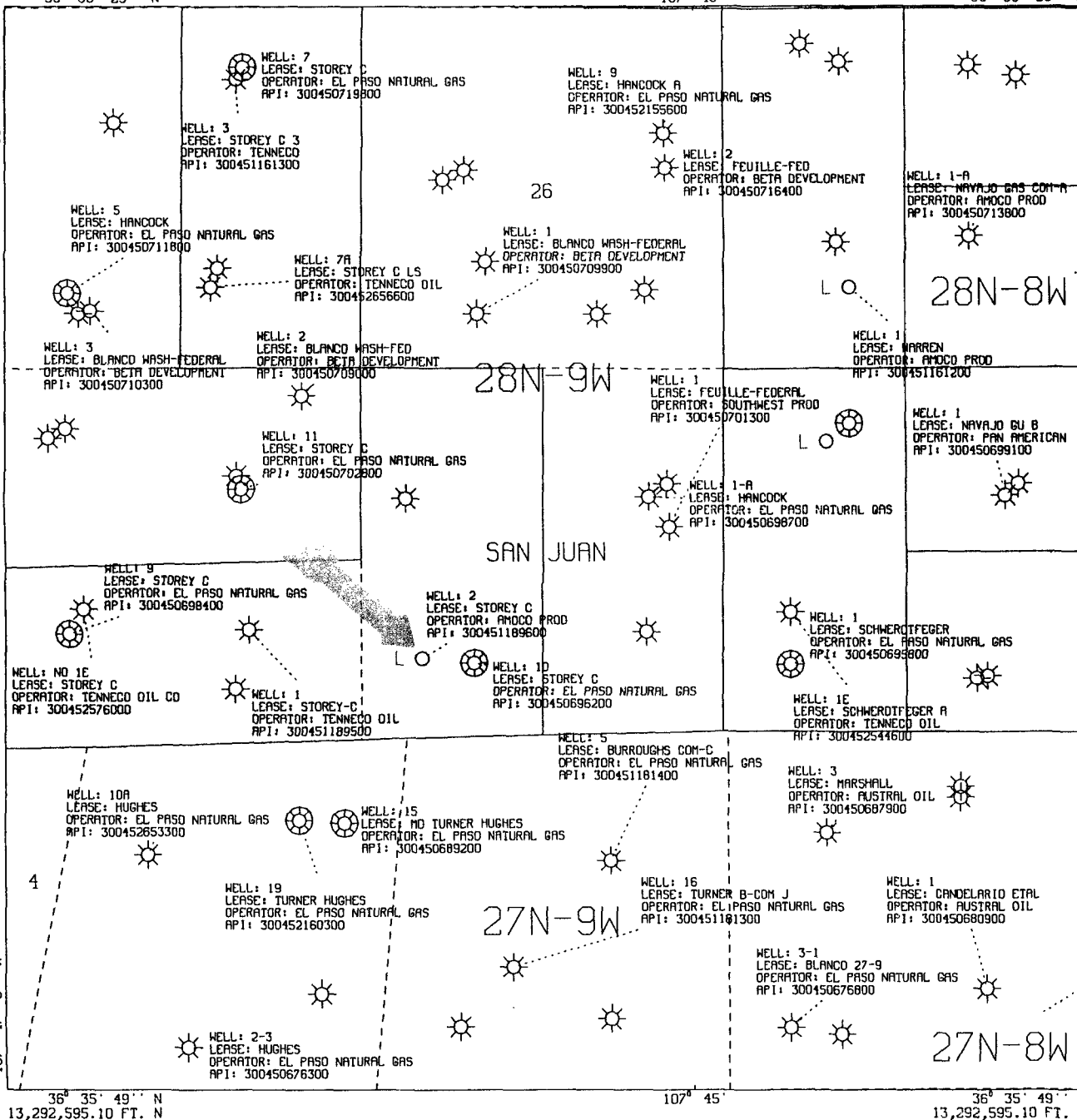

992,064.71 FT. E
107° 47' 3" W

1,007,935.29 FT. E
107° 43' 49" W

36° 35' 49" N
13,292,595.10 FT. N

107° 45'

36° 35' 49" N
13,292,595.10 FT. N

All geological and geophysical data, including the interpretation thereof, appearing on this map is the private and confidential property of Amoco Production Company. The publication or reproduction thereof without the written permission of said Company is strictly prohibited.

AMOCO PRODUCTION COMPANY PLAT MAP

POLYCONIC CENTRAL MERIDIAN - 107° 45' 26" W LON
SPHEROID - 6

STOREY C 2M (E)
DK MV CK OFFSETS
SCALE 1 IN. = 2,000 FT. JAN 11, 1995

HORIZONTAL DATUM NAD27

PLOT 1 13.26.27 WED 11 JAN, 1995 JOB-PV826502, ISSCO DISPLAY 10.0

BARO11AQ--RUN#95011131427

All distances must be from the outer boundaries of the Section.

Operator Tenneco Oil Company		Lease Storey C		Well No. 2E
Unit Letter E	Section 35	Township 28N	Range 9W	County San Juan
Actual Footage Location of Well: 1890' feet from the North line and 655' feet from the West line				
Ground Level Elev. 6778	Producing Formation Dakota	Pool Basin Dakota		Dedicated Acreage: 320 Acres

1. Outline the acreage dedicated to the subject well by colored pencil or hachure marks on the plat below.
2. If more than one lease is dedicated to the well, outline each and identify the ownership thereof (both as to working interest and royalty).
3. If more than one lease of different ownership is dedicated to the well, have the interests of all owners been consolidated by communitization, unitization, force-pooling, etc?

☐ Yes ☐ No If answer is "yes," type of consolidation _____

If answer is "no," list the owners and tract descriptions which have actually been consolidated. (Use reverse side of this form if necessary.) _____

No allowable will be assigned to the well until all interests have been consolidated (by communitization, unitization, forced-pooling, or otherwise) or until a non-standard unit, eliminating such interests, has been approved by the Commission.

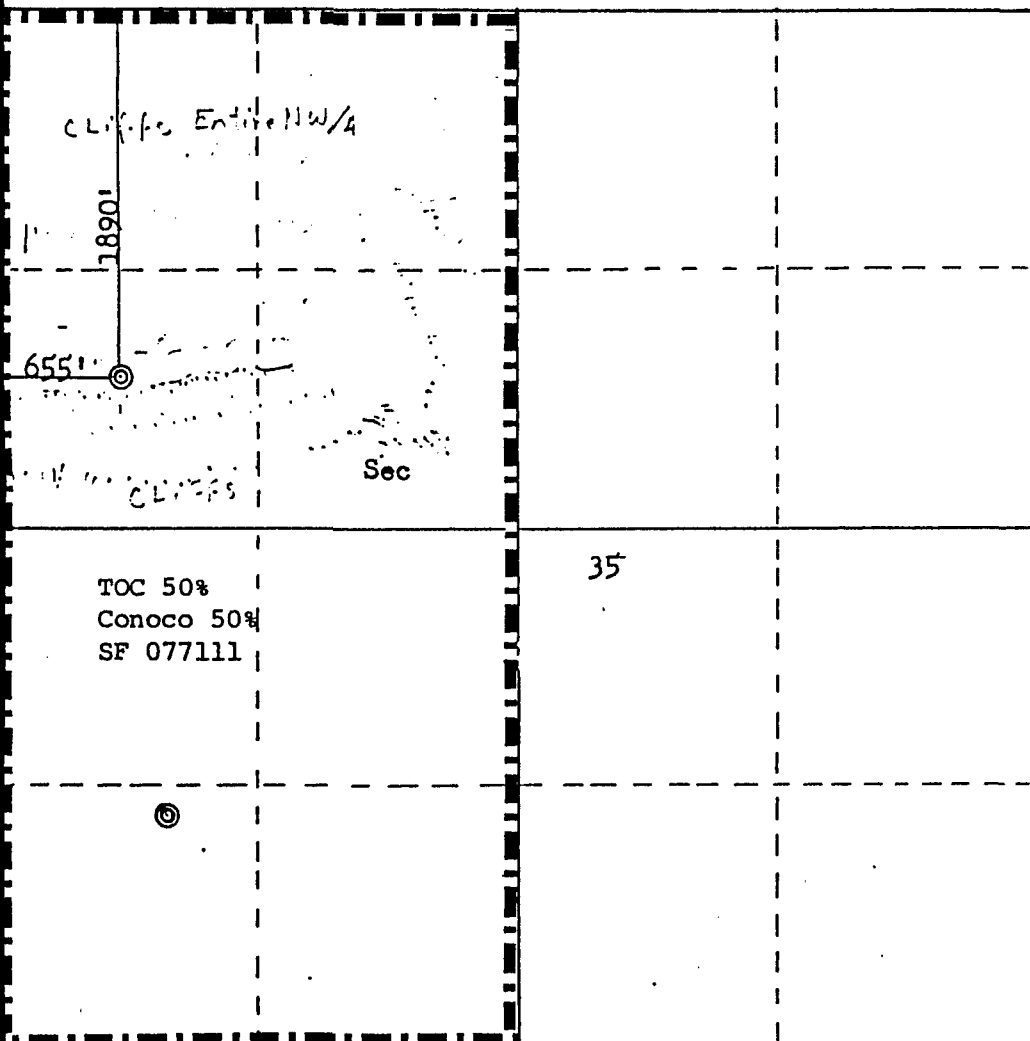

Scale: 1"=1000'

CERTIFICATION

I hereby certify that the information contained herein is true and complete to the best of my knowledge and belief.

Don H. Morrison

Name
Don H. Morrison

Position
Production Analyst

Company
Tenneco Oil Company

Date
August 26, 1981

I hereby certify that the well location shown on this plat was plotted from field notes of actual surveys made by me or under my supervision, and that the same is true and correct to the best of my knowledge and belief.

Date Surveyed: **August 13, 1981**
Registered Professional Engineer and Land Surveyor
Fred B. Kerr Jr.
Certificate No. **3950**

District I
PO Box 1980, Hobbs, NM 88241-1980
District II
PO Drawer DD, Artesia, NM 88211-0719
District III
1000 Rio Brazos Rd., Aztec, NM 87410
District IV
PO Box 2088, Santa Fe, NM 87504-2088

State of New Mexico
Energy, Minerals & Natural Resources Department

OIL CONSERVATION DIVISION
PO Box 2088
Santa Fe, NM 87504-2088

Form C-102
Revised February 21, 1994
Instructions on back
Submit to Appropriate District Office
State Lease - 4 Copies
Fee Lease - 3 Copies

☐ AMENDED REPORT

WELL LOCATION AND ACREAGE DEDICATION PLAT

API Number 30045 25322		Pool Code 72319	Pool Name Blanco MesaVerde
Property Code 0011381	Property Name Storey "C"		Well Number 2 M
OCRID No. 000778	Operator Name Amoco Production Company		Elevation 6778' GL

¹⁰ Surface Location

UL or lot no.	Section	Township	Range	Lot Idn	Feet from the	North/South line	Feet from the	East/West line	County
E	35	28 N	9 W	E	1890	North	655	West	San Juan

¹¹ Bottom Hole Location If Different From Surface

UL or lot no.	Section	Township	Range	Lot Idn	Feet from the	North/South line	Feet from the	East/West line	County

Dedicated Acres 380	Joint or Infill Hood to fill this	Consolidation Code at all times	Order No.
------------------------	--------------------------------------	------------------------------------	-----------

NO ALLOWABLE WILL BE ASSIGNED TO THIS COMPLETION UNTIL ALL INTERESTS HAVE BEEN CONSOLIDATED
OR A NON-STANDARD UNIT HAS BEEN APPROVED BY THE DIVISION

<div>16</div> <div>1890'</div> <div>655'</div>					<div>17 OPERATOR CERTIFICATION</div> <div>I hereby certify that the information contained herein is true and complete to the best of my knowledge and belief</div> <div><i>Lois Raeburn</i></div> <div>Signature</div> <div>Lois Raeburn</div> <div>Printed Name</div> <div>Business Assistant</div> <div>Title</div> <div>12 13 94</div> <div>Date</div> <div>18 SURVEYOR CERTIFICATION</div> <div>I hereby certify that the well location shown on this plat was plotted from field notes of actual surveys made by me or under my supervision, and that the same is true and correct to the best of my belief.</div> <div>Aug. 13, 1981</div> <div>Date of Survey</div> <div>Signature and Seal of Professional Surveyor:</div> <div>On File</div> <div>3950</div> <div>Certificate Number</div>

District I
PO Box 1940, Hobbs, NM 88241-1940
District II
PO Drawer D0, Artesia, NM 88211-0719
District III
1000 Rio Brazos Rd., Aztec, NM 87410
District IV
PO Box 2088, Santa Fe, NM 87504-2088

State of New Mexico
Energy, Minerals & Natural Resources Department

OIL CONSERVATION DIVISION
PO Box 2088
Santa Fe, NM 87504-2088

Form C-102
Revised February 21, 1994
Instructions on back
Submit to Appropriate District Office
State Lease - 4 Copies
Fee Lease - 3 Copies

☐ AMENDED REPORT

WELL LOCATION AND ACREAGE DEDICATION PLAT

APL Number 30045 25322		Pool Code 82329	Pool Name Otero Chacra
Property Code 001138	Property Name Storey "C"		Well Number 2 M
OCRID No. 000778	Operator Name AMOCO PRODUCTION COMPANY		Elevation 6778' GL

¹⁰ Surface Location

UL or lot no.	Section	Township	Range	Lot Ida	Feet from the	North/South line	Feet from the	East/West line	County
E	35	28 N	9 W	E	1890'	North	655'	West	San Juan

¹¹ Bottom Hole Location If Different From Surface

UL or lot no.	Section	Township	Range	Lot Ida	Feet from the	North/South line	Feet from the	East/West line	County

" Dedicated Acres 160	" Joint or Infill	" Consolidation Code	" Order No.
--------------------------	-------------------	----------------------	-------------

NO ALLOWABLE WILL BE ASSIGNED TO THIS COMPLETION UNTIL ALL INTERESTS HAVE BEEN CONSOLIDATED
OR A NON-STANDARD UNIT HAS BEEN APPROVED BY THE DIVISION

16	1890'				¹⁷ OPERATOR CERTIFICATION I hereby certify that the information contained herein is true and complete to the best of my knowledge and belief <u>Lois Raeburn</u> Signature Lois Raeburn Printed Name Business Assistant Title 2 / 08 / 95 Date
	655'				
					¹⁸ SURVEYOR CERTIFICATION I hereby certify that the well location shown on this plat was plotted from field notes of actual surveys made by me or under my supervision, and that the same is true and correct to the best of my belief. Aug 13, 1981 Date of Survey Signature and Seal of Professional Surveyor: ON FILE 3950 Certificate Number