

District I  
1625 N. French Dr., Hobbs, NM 88240  
District II  
1301 W. Grand Avenue, Artesia, NM 88210  
District III  
1000 Rio Brazos Road, Aztec, NM 87410  
District IV  
1220 S. St. Francis Dr., Santa Fe, NM 87505

State of New Mexico  
Energy Minerals and Natural Resources

Oil Conservation Division  
1220 South St. Francis Dr.  
Santa Fe, NM 87505

Form C-141  
Revised October 10, 2003

Submit 2 Copies to appropriate  
District Office in accordance  
with Rule 116 on back  
side of form

**Release Notification and Corrective Action**

**OPERATOR**

☐ Initial Report ☒ Final Report

Name of Company	Saber Resources, Inc.	Contact	Doug Keathley
Address	400 W. Illinois, Suite 950, Midland, TX 79701	Telephone No.	(432) 685-0169
Facility Name	Original Buckley A Battery <i>23</i>	Facility Type	Tank Battery
Surface Owner	Martin Woods	Mineral Owner	Ivan Ranch / William Wolf
		Lease No.	None - IRP # 1279

**LOCATION OF RELEASE**

*3005051210000*

Unit Letter	Section	Township	Range	Feet from the	North/South Line	Feet from the	East/West Line	County
M	25	14S	37E	660	South	330	West	Lea

Latitude N 33 deg. 04.250' Longitude W 103 deg. 09.57'

**NATURE OF RELEASE**

Type of Release	Oil and Water	Volume of Release	Unknown	Volume Recovered	Unknown
Source of Release	Oil Storage Tanks	Date and Hour of Occurrence	Unknown	Date and Hour of Discovery	Unknown
Was Immediate Notice Given?	<input type="checkbox"/> Yes <input checked="" type="checkbox"/> No <input type="checkbox"/> Not Required	If YES, To Whom?			
By Whom?		Date and Hour			
Was a Watercourse Reached?	<input type="checkbox"/> Yes <input checked="" type="checkbox"/> No	If YES, Volume Impacting the Watercourse.			
If a Watercourse was Impacted, Describe Fully.*					
Describe Cause of Problem and Remedial Action Taken.*					
Historical oil tank (out of service approximately 20 yrs.) was cleaned out and sludge / residue left on the ground.					
Describe Area Affected and Cleanup Action Taken.*					
A 53' x 72' area was excavated to a depth of approximately 12' bgs from the center to the east side, to a depth of approximately 14' bgs to the NW, and to a depth of approximately 27' bgs to the SW. Soil was disposed at an NMOCD approved disposal facility (Sundance) and samples were collected from the bottom of the excavation. A table summarizing the laboratory results, a figure showing the sample locations, and a copy of the laboratory reports are attached. Samples reported all TPH and chloride concentrations below the RRAIs (1,000 mg/kg and 250 mg/kg, respectively).					
I hereby certify that the information given above is true and complete to the best of my knowledge and understand that pursuant to NMOCD rules and regulations all operators are required to report and/or file certain release notifications and perform corrective actions for releases which may endanger public health or the environment. The acceptance of a C-141 report by the NMOCD marked as "Final Report" does not relieve the operator of liability should their operations have failed to adequately investigate and remediate contamination that pose a threat to ground water, surface water, human health or the environment. In addition, NMOCD acceptance of a C-141 report does not relieve the operator of responsibility for compliance with any other federal, state, or local laws and/or regulations.					
Signature: <i>Doug Keathley</i>		<b>OIL CONSERVATION DIVISION</b>			
Printed Name: Doug Keathley		Approved by District Supervisor: <i>Enrico Enge</i>			
Title: <i>VP of Operations</i>		Approval Date: <i>7.13.07</i>		Expiration Date: <i>—</i>	
E-mail Address: Doug@SaberResources.com		Conditions of Approval:		Attached <input type="checkbox"/>	
Date: 6/26/07 Phone: (432) 685-0169					

\* Attach Additional Sheets If Necessary

**Table 1: Summary of Laboratory Analysis of Soil Samples**  
**Saber Resources, Inc.**  
**Buckley A #3**  
**Unit Letter M, Section 25, Township 14 South, Range 37 East**  
**Lea County, New Mexico**

Page 1 of 1

Sample Date	Sample Number	Sample Depth	PID	Benzene (mg/kg)	BTEX (mg/kg)	GRO (C6-C10) (mg/kg)	DRO (C10-C35) (mg/kg)	Total TPH (mg/kg)	Chloride (mg/kg)
	RRAL			10	50			1,000	250
4/16/07	SW Corner	11	278	0.094	20.684	251	1,630	1,881	912
	NE Corner	10	119	<0.002	<0.012	<10.0	44.1	44.1	864
4/19/07	SW Corner	13	97	---	---	122	1,610	1,732	850
5/7/07	SW Corner	15	134	0.019	5.51	293	1,770	2,063	512
5/15/07	Center	6	---	---	---	<10.0	<10.0	<20.0	640
	SE Corner	9	---	---	---	<10.0	222	222	464
	NW Corner	10	---	---	---	<10.0	<10.0	<20.0	736
5/18/07	SW Corner	20	---	<0.002	0.059	<10.0	140	140	576
5/30/07	NE Corner	12	---	---	---	---	---	---	160
	SW Corner	22	---	---	---	---	---	---	1807
	SW Corner	24	---	---	---	---	---	---	1312
	NW Corner	12	---	---	---	---	---	---	544
	NW Corner	14	---	---	---	---	---	---	224
6/1/07	SW Corner	27	---	---	---	---	---	---	112
	Center	12	---	---	---	---	---	---	240
	SE Corner	12	---	---	---	---	---	---	192

Notes Analyses conducted by Cardinal Laboratories, Hobbs, New Mexico

1 RRAL Recommended Remediation Action Level

2. mg/kg Milligrams per kilogram

3 < Below method detection limit

4 --- No Data Available

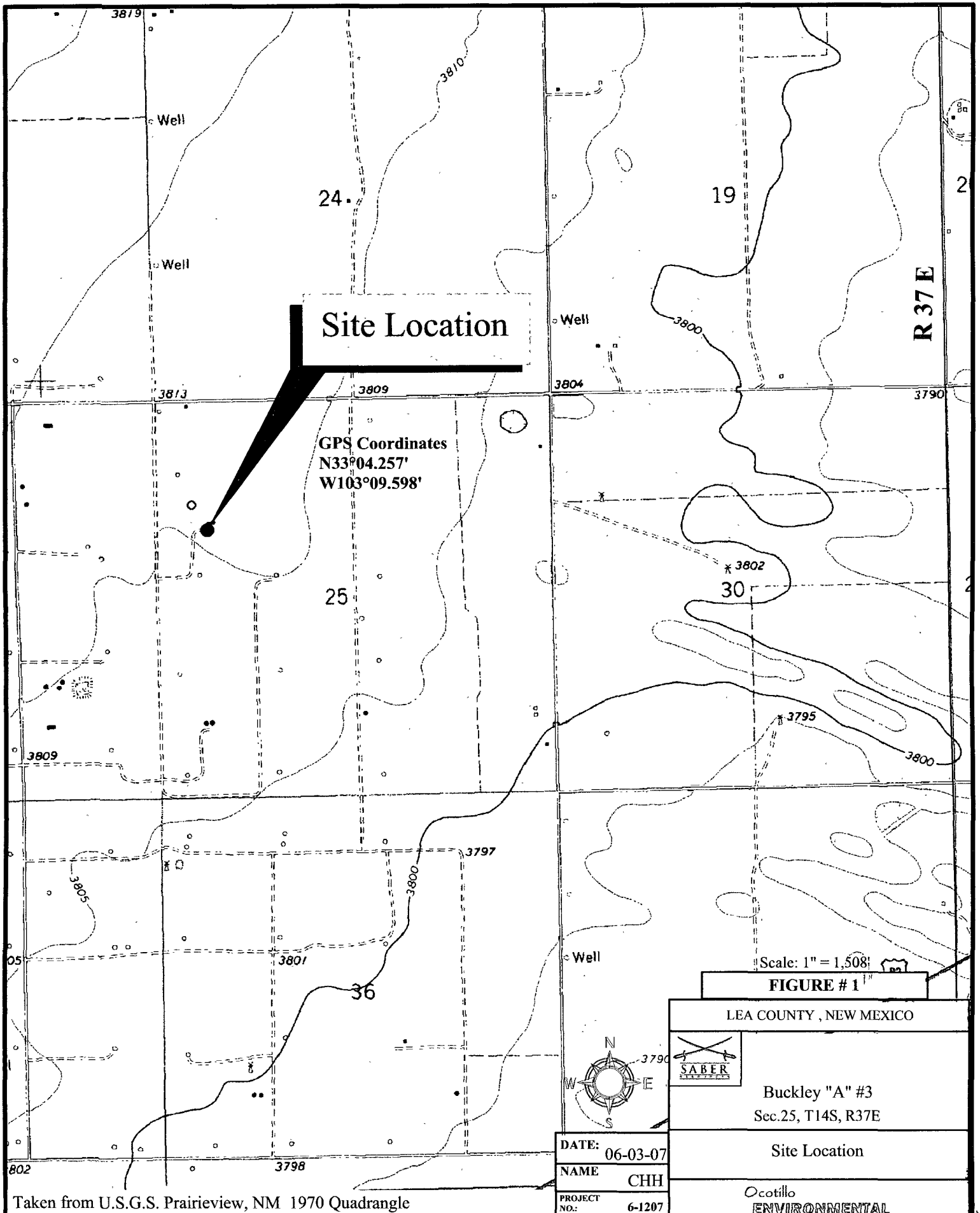

Site Location

GPS Coordinates  
N33°04.257'  
W103°09.598'

Scale: 1" = 1,508'

FIGURE # 1

LEA COUNTY, NEW MEXICO



Buckley "A" #3  
Sec.25, T14S, R37E

Site Location

DATE: 06-03-07  
NAME: CHH  
PROJECT NO.: 6-1207

Ocotillo  
ENVIRONMENTAL

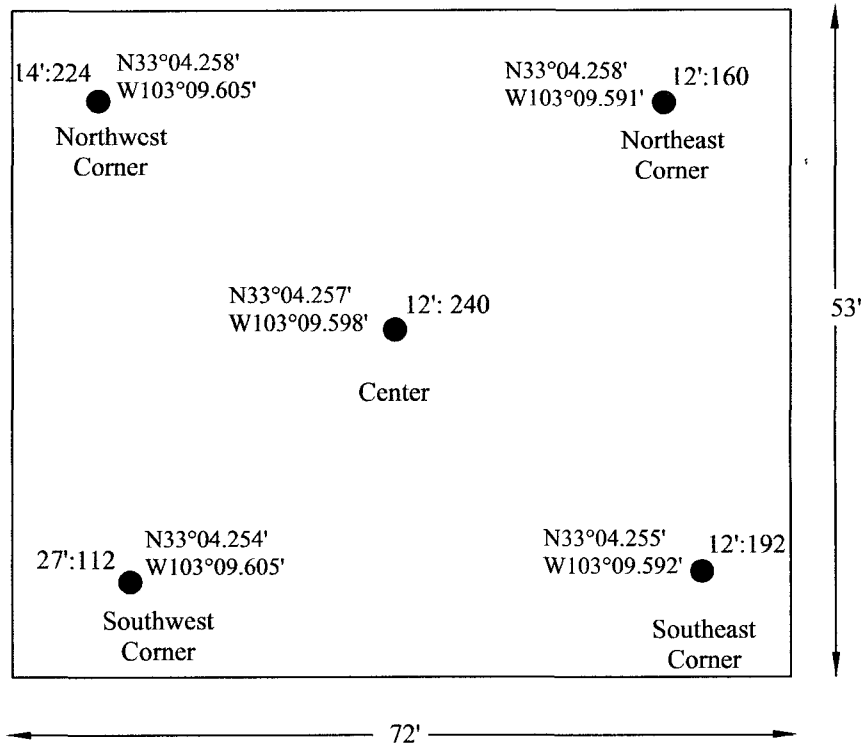

27':112  
Southwest Corner

**LEGEND**

Soil sample location taken at a depth (feet), with chloride concentration (mg/kg).

Wellhead location

N33°04.258' W103°09.605' GPS Coordinates

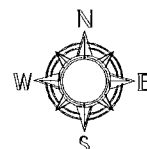

DATE: 06-25-07  
NAME: CHH  
PROJECT NO.: 6-1204

**FIGURE # 2**

LEA COUNTY, NEW MEXICO



Buckley A#3

Sec.25, T14S, R37E

**Site Drawing**

(Not to Scale)

Ocotillo  
ENVIRONMENTAL



# CARDINAL LABORATORIES

PHONE (325) 673-7001 • 2111 BEECHWOOD • ABILENE, TX 79603

PHONE (505) 393-2326 • 101 E MARLAND • HOBBS, NM 88240

ANALYTICAL RESULTS FOR  
OCOTILLO ENVIRONMENTAL  
ATTN: CINDY CRAIN  
P.O. BOX 1816  
HOBBS, NM 88241  
FAX TO: (432) 272-0304

Receiving Date: 04/17/07  
Reporting Date: 04/17/07  
Project Owner: NOT GIVEN  
Project Name: SABER-BUCKLEY A#3  
Project Location: LOVINGTON, NM

Sampling Date: 04/16/07  
Sample Type: SOIL  
Sample Condition: COOL & INTACT  
Sample Received By: BC  
Analyzed By: BC/HM

LAB NUMBER	SAMPLE ID	BENZENE (mg/Kg)	TOLUENE (mg/Kg)	ETHYL BENZENE (mg/Kg)	TOTAL XYLENES (mg/Kg)
ANALYSIS DATE		04/17/07	04/17/07	04/17/07	04/17/07
H12470-1	SW@11'	0.094	0.910	2.08	17.6
H12470-2	NE@10'	<0.002	<0.002	<0.002	<0.006
Quality Control		0.098	0.102	0.102	0.310
True Value QC		0.100	0.100	0.100	0.300
% Recovery		98.7	102	102	103
Relative Percent Difference		7.8	8.5	7.5	7.1

METHOD: EPA SW-846 8021B

  
Chemist

4/17/07  
Date



PHONE (325) 673-7001 • 2111 BEECHWOOD • ABILENE, TX 79603

PHONE (505) 393-2326 • 101 E. MARLAND • HOBBS, NM 88240

ANALYTICAL RESULTS FOR  
OCOTILLO ENVIRONMENTAL  
ATTN: CINDY CRAIN  
P.O. BOX 1816  
HOBBS, NM 88241  
FAX TO: (432) 272-0304

Receiving Date: 04/17/07  
Reporting Date: 04/17/07  
Project Owner: NOT GIVEN  
Project Name: SABER-BUCKLEY A#3  
Project Location: LOVINGTON, NM

Sampling Date: 04/16/07  
Sample Type: SOIL  
Sample Condition: COOL & INTACT  
Sample Received By: BC  
Analyzed By: BC/HM

LAB NO.	SAMPLE ID	GRO (C <sub>6</sub> -C <sub>10</sub> ) (mg/Kg)	DRO (>C <sub>10</sub> -C <sub>28</sub> ) (mg/Kg)	CI* (mg/Kg)
		04/17/07	04/17/07	04/17/07
H12470-1	SW @ 11'	251	1630	912
H12470-2	NE @ 10'	<10.0	44.1	864
	Quality Control	732	778	500
	True Value QC	800	800	500
	% Recovery	97.3	97.3	100
	Relative Percent Difference	0.6	1.2	1.0

METHODS: TPH GRO & DRO: EPA SW-846 8015 M; CI: Std. Methods 4500-CI'B

\*Analyses performed on 1:4 w:v aqueous extracts.

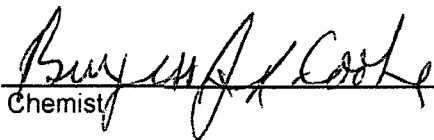
  
Chemist

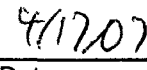
  
Date

H12470A OCO

PLEASE NOTE: Liability and Damages. Cardinal's liability and client's exclusive remedy for any claim arising, whether based in contract or tort, shall be limited to the amount paid by client for analysis. All claims, including those for negligence and any other cause whatsoever shall be deemed waived unless made in writing and received by Cardinal within thirty (30) days after completion of the applicable service. In no event shall Cardinal be liable for incidental or consequential damages, including, without limitation, business interruptions, loss of use, or loss of profits incurred by client, its subsidiaries, affiliates or successors arising out of or related to the performance of services hereunder by Cardinal, regardless of whether such claim is based upon any of the above-stated reasons or otherwise.



## CHAIN-OF-CUSTODY AND ANALYSIS REQUEST

PLEASE NOTE: Liability and Damages. Cardinal's liability and client's exclusive remedy for any claim arising whether based in contract or tort, shall be limited to the amount paid by the client for the analyses. All claims, including those for negligence and any other cause whatsoever shall be deemed waived unless made in writing and received by Cardinal within 30 days after completion of the applicable service. In no event shall Cardinal be liable for incidental or consequential damages, including without limitation, business interruptions, loss of use, or loss of profits incurred by client, its subsidiaries, affiliates or successors arising out of or related to the performance of services hereunder by Cardinal, regardless of whether such claim is based upon any of the above stated reasons or otherwise.

† Cardinal cannot accept verbal changes. Please fax written changes to 505-393-2476



PHONE (325) 673-7001 • 2111 BEECHWOOD • ABILENE, TX 79603

PHONE (505) 393-2326 • 101 E. MARLAND • HOBBS, NM 88240

ANALYTICAL RESULTS FOR  
OCOTILLO ENVIRONMENTAL  
ATTN: CINDY CRAIN  
P.O. BOX 1816  
HOBBS, NM 88241  
FAX TO: (432) 272-0304

Receiving Date: 04/19/07  
Reporting Date: 04/20/07  
Project Owner: SABER  
Project Name: SABER-BUCKLEY A#3  
Project Location: LOVINGTON, NM

Sampling Date: 04/19/07  
Sample Type: SOIL  
Sample Condition: COOL & INTACT  
Sample Received By: LB  
Analyzed By: BC/LB

LAB NUMBER	SAMPLE ID	GRO	DRO	CI*
		(C <sub>6</sub> -C <sub>10</sub> ) (mg/Kg)	(>C <sub>10</sub> -C <sub>28</sub> ) (mg/Kg)	CI* (mg/Kg)
ANALYSIS DATE		04/19/07	04/19/07	04/19/07
H12480-1	SW CORNER @ 13'	122	1610	850
Quality Control		780	791	490
True Value QC		800	800	500
% Recovery		97.5	98.9	98.0
Relative Percent Difference		4.4	0.6	0.0

METHODS: TPH GRO & DRO: EPA SW-846 8015 M; CI: Std. Methods 4500-CI B

\*Analysis performed on a 1:4 w:v aqueous extract.

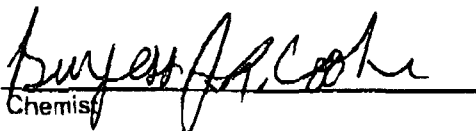
  
Cheryl A. Cook  
Chemist

4/20/07  
Date

H12480 OCO

PLEASE NOTE: Liability and Damages. Cardinal's liability and client's exclusive remedy for any claim arising, whether based in contract or tort, shall be limited to the amount paid by client for analysis. All claims, including those for negligence and any other cause whatsoever shall be deemed waived unless made in writing and received by Cardinal within thirty (30) days after completion of the applicable service. In no event shall Cardinal be liable for incidental or consequential damages, including, without limitation, business interruptions, loss of use, or loss of profits incurred by client, its subsidiaries, affiliates or successors arising out of or related to the performance of services hereunder by Cardinal, regardless of whether such claim is based upon any of the above-stated reasons or otherwise.





## CHAIN-OF-CUSTODY AND ANALYSIS REQUEST

[illegible]

† Cardinal cannot accept verbal changes. Please fax written changes to 505-393-2476



PHONE (325) 673-7001 • 2111 BEECHWOOD • ABILENE, TX 79603

PHONE (505) 393-2326 • 101 E MARLAND • HOBBS, NM 88240

ANALYTICAL RESULTS FOR  
OCOTILLO ENVIRONMENTAL  
ATTN: CINDY CRAIN  
P.O. BOX 1816  
HOBBS, NM 88241  
FAX TO: (432) 272-0304

Receiving Date: 05/07/07  
Reporting Date: 05/08/07  
Project Owner: SABER  
Project Name: BUCKLEY A#3  
Project Location: LOVINGTON, NM

Sampling Date: 05/07/07  
Sample Type: SOIL  
Sample Condition: COOL & INTACT  
Sample Received By: AB  
Analyzed By: AB

LAB NUMBER	SAMPLE ID	BENZENE (mg/Kg)	TOLUENE (mg/Kg)	ETHYL BENZENE (mg/Kg)	TOTAL XYLENES (mg/Kg)
ANALYSIS DATE		05/08/07	05/08/07	05/08/07	05/08/07
H12557-1	SW CORNER @ 15'	0.019	0.173	0.488	4.83
Quality Control		0.090	0.094	0.089	0.271
True Value QC		0.100	0.100	0.100	0.300
% Recovery		90.3	94.3	89.4	90.3
Relative Percent Difference		7.8	7.9	7.6	7.0

METHOD: EPA SW-846 8021B

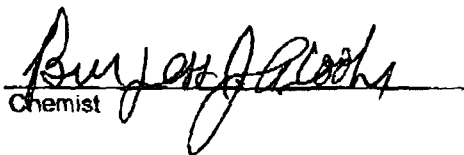
  
Chemist

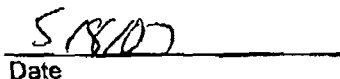
  
Date

PLEASE NOTE: Liability and Damages: Cardinal's liability and client's exclusive remedy for any claim arising, whether based in contract or tort, shall be limited to the amount paid by client for analyses. All claims, including those for negligence and any other cause whatsoever shall be deemed waived unless made in writing and received by Cardinal within thirty (30) days after completion of the applicable service. In no event shall Cardinal be liable for incidental or consequential damages, including, without limitation, business interruptions, loss of use, or loss of profits incurred by client, its subsidiaries, affiliates or successors arising out of or related to the performance of services hereunder by Cardinal, regardless of whether such claim is based upon any of the above-stated reasons or otherwise.



# ARDINAL LABORATORIES

PHONE (325) 673-7001 • 2111 BEECHWOOD • ABILENE, TX 79603

PHONE (505) 393-2326 • 101 E. MARLAND • HOBBS, NM 88240

ANALYTICAL RESULTS FOR  
OCOTILLO ENVIRONMENTAL  
ATTN: CINDY CRAIN  
P.O. BOX 1816  
HOBBS, NM 88241  
FAX TO (432) 272-0304

Receiving Date: 05/07/07  
Reporting Date: 05/08/07  
Project Owner: SABER  
Project Name: BUCKLEY A#3  
Project Location: LOVINGTON, NM

Sampling Date: 05/07/07  
Sample Type: SOIL  
Sample Condition: COOL & INTACT  
Sample Received By: AB  
Analyzed By: BC/AB

LAB NO.	SAMPLE ID	GRO (C <sub>6</sub> -C <sub>10</sub> ) (mg/Kg)	DRO (>C <sub>10</sub> -C <sub>28</sub> ) (mg/Kg)	Cl* (mg/Kg)
ANALYSIS DATE		05/07/07	05/07/07	05/07/07
H12557-1	SW CORNER @ 15'	293	1770	512
Quality Control		794	800	490
True Value QC		800	800	500
% Recovery		99.3	100	98.0
Relative Percent Difference		1.1	0.6	0.0

METHODS: TPH GRO & DRO: EPA SW-846 8015 M; Cl: Std. Methods 4500-ClB

\*Analysis performed on a 1:4 w:v aqueous extract.

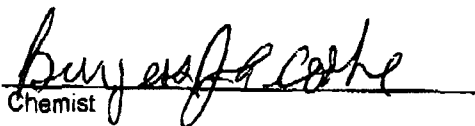
  
Chemist

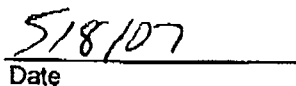
  
Date

H12557A OCO

PLEASE NOTE: Liability and Damages. Cardinal's liability and client's exclusive remedy for any claim arising, whether based in contract or tort, shall be limited to the amount paid by client for analysis. All claims, including those for negligence and any other causes whatsoever shall be deemed waived unless made in writing and received by Cardinal within thirty (30) days after completion of the applicable service. In no event shall Cardinal be liable for incidental or consequential damages, including, without limitation, business interruptions, loss of use, or loss of profits incurred by client, its subsidiaries, affiliates or successors arising out of or related to the performance of services hereunder by Cardinal, regardless of whether such claim is based upon any of the above-stated reasons or otherwise.



## CHAIN-OF-CUSTODY AND ANALYSIS REQUEST

† Cardinal cannot accept verbal changes. Please fax written changes to 505-393-2476



# ARDINAL LABORATORIES

PHONE (325) 873-7001 • 2111 BEECHWOOD • ABILENE, TX 79603

PHONE (505) 383-2326 • 101 E MARLAND • HOBBS, NM 88240

ANALYTICAL RESULTS FOR  
OCOTILLO ENVIRONMENTAL  
ATTN: CINDY CRAIN  
P.O. BOX 1816  
HOBBS, NM 88241  
FAX TO: (432) 272-0304

Receiving Date: 05/16/07  
Reporting Date: 05/17/07  
Project Owner: SABER  
Project Name: BUCKLEY A #3  
Project Location: LOVINGTON, NM

Sampling Date: 05/15/07  
Sample Type: SOIL  
Sample Condition: COOL & INTACT  
Sample Received By: LB  
Analyzed By: BC/AB

LAB NUMBER	SAMPLE ID	GRO (C <sub>6</sub> -C <sub>10</sub> ) (mg/Kg)	DRO (>C <sub>10</sub> -C <sub>28</sub> ) (mg/Kg)	Cl <sup>-</sup> (mg/Kg)
		05/16/07	05/16/07	05/16/07
H12601-1	CENTER @ 6'	<10.0	<10.0	640
H12601-2	SOUTHEAST @ 9'	<10.0	222	464
H12601-3	NORTHWEST @ 10'	<10.0	<10.0	736
Quality Control		753	790	490
True Value QC		800	800	500
% Recovery		94.1	98.8	98.0
Relative Percent Difference		1.5	3.2	0.0

METHODS: TPH GRO & DRO: EPA SW-846 8015 M; Cl<sup>-</sup>: Std. Methods 4500-Cl<sup>-</sup>B

\*Analyses performed on 1:4 w:v aqueous extracts.

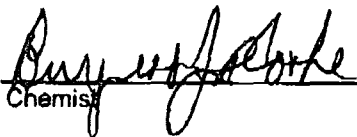
  
Chemist

5/17/07  
Date

H12601 OCO

PLEASE NOTE: Liability and Damages. Cardinal's liability and client's exclusive remedy for any claim arising, whether based in contract or tort, shall be limited to the amount paid by client for analysis. All claims, including those for negligence and any other cause whatsoever shall be deemed waived unless made in writing and received by Cardinal within thirty (30) days after completion of the applicable service. In no event shall Cardinal be liable for incidental or consequential damages, including, without limitation, business interruptions, loss of use, or loss of profits incurred by client, its subsidiaries, affiliates or successors arising out of or related to the performance of services hereunder by Cardinal, regardless of whether such claim is based upon any of the above-stated reasons or otherwise.



(505) 393-2326 FAX (505) 393-2476 (325) 673-7001 FAX (325) 673-7020

## CHAIN-OF-CUSTODY AND ANALYSIS REQUEST

**PLEASE NOTE:** Liability and Damages. Cardinal's liability and Client's providers' remedy for any claim arising whether based in contract or tort, shall be limited to the amount paid by the Client for the analyses. All claims, including those for negligence and any other cause whatsoever shall be deemed waived unless made in writing and received by Cardinal within 30 days after completion of the applicable service. In no event shall Cardinal be liable for incidental or consequential damages, including without limitation, business interruption, loss of use, or loss of profits incurred by Client, its subsidiaries, affiliates or successors, or any other third party, due to performance of services hereunder by Cardinal, regardless of whether such claim is based upon any of the above stated, stated or omitted.

Relinquished By: <u>Cassie Hoyer</u>		Date: <u>5/16/07</u>		Received By: <u>[Signature]</u>		Phone Result: <input type="checkbox"/> Yes <input type="checkbox"/> No Add'l Phone #: _____	
Relinquished By: _____		Time: <u>9:00</u>		Time: _____		Fax Result: <input type="checkbox"/> Yes <input type="checkbox"/> No Add'l Fax #: _____	
Relinquished By: _____		Date: _____		Received By: _____		REMARKS: _____	
Delivered By: (Circle One) Sampler - UPS - Bus - Other: _____		Sample Condition: Cool Intact <input checked="" type="checkbox"/> Yes <input checked="" type="checkbox"/> No <input type="checkbox"/> Yes <input type="checkbox"/> No		CHECKED BY: (Initials) <u>[Signature]</u>			

† Cardinal cannot accept verbal changes. Please fax written changes to 505-393-2476



PHONE (325) 873-7001 • 2111 BEECHWOOD • ABILENE, TX 79603  
PHONE (505) 393-2328 • 101 E. MARLAND • HOBBS, NM 88240

ANALYTICAL RESULTS FOR  
OCOTILLO ENVIRONMENTAL  
ATTN: CINDY CRAIN  
P.O. BOX 1816  
HOBBS, NM 88241  
FAX TO: (432) 272-0304

Receiving Date: 05/18/07  
Reporting Date: 05/18/07  
Project Owner: SABER  
Project Name: BUCKLEY A #3  
Project Location: LOVINGTON, NM

Sampling Date: 05/18/07  
Sample Type: SOIL  
Sample Condition: COOL & INTACT  
Sample Received By: NF  
Analyzed By: BC/AB

LAB NUMBER	SAMPLE ID	GRO (C <sub>6</sub> -C <sub>10</sub> ) (mg/Kg)	DRO (>C <sub>10</sub> -C <sub>28</sub> ) (mg/Kg)	Cl* (mg/Kg)
ANALYSIS DATE		05/18/07	05/18/07	05/18/07
H12611-1	SW CORNER @ 20'	<10.0	140	576
Quality Control		733	781	490
True Value QC		800	800	500
% Recovery		91.7	97.7	98.0
Relative Percent Difference		1.5	1.1	0.0

METHODS: TPH GRO & DRO: EPA SW-846 8015 M; Cl\*: Std. Methods 4500-Cl\*B  
\*Analysis performed on a 1:4 w:v aqueous extract.

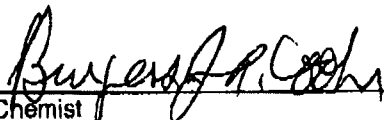
  
Chemist

  
Date

H12617A OCO

PLEASE NOTE: Liability and Damages. Cardinal's liability and client's exclusive remedy for any claim arising, whether based in contract or tort, shall be limited to the amount paid by client for analyses. All claims, including those for negligence and any other cause whatsoever shall be deemed waived unless made in writing and received by Cardinal within thirty (30) days after completion of the applicable service. In no event shall Cardinal be liable for incidental or consequential damages, including, without limitation, business interruptions, loss of use, or loss of profits incurred by client, its subsidiaries, affiliates or successors arising out of or related to the performance of services hereunder by Cardinal, regardless of whether such claim is based upon any of the above-stated reasons or otherwise.



## CHAIN-OF-CUSTODY AND ANALYSIS REQUEST

PLEASE NOTE: Liability and Damages. Cardinal's liability and client's exclusive remedy for any claim arising whether based in contract or tort, shall be limited to the amount paid by the client for the services. All claims, including those for negligence and any other cause whatsoever shall be deemed waived unless made in writing and received by Cardinal within 30 days after completion of the applicable service. In no event shall Cardinal be liable for incidental or consequential damages, including without limitation, business interruptions, loss of use, or loss of profits incurred by client, its subsidiaries, affiliates or successors arising out of or in relation to the performance of services hereunder by Cardinal, regardless of whether such claim is based upon any of the above stated theories or otherwise.

† Cardinal cannot accept verbal changes. Please fax written changes to 505-393-2476





# ARDINAL LABORATORIES

PHONE (325) 673-7001 • 2111 BEECHWOOD • ABILENE, TX 79603

PHONE (505) 393-2326 • 101 E. MARLAND • HOBBS NM 88240

ANALYTICAL RESULTS FOR  
OCOTILLO ENVIRONMENTAL  
ATTN: CINDY CRAIN  
P.O. BOX 1816  
HOBBS, NM 88241  
FAX TO: (432) 272-0304

Receiving Date: 05/18/07  
Reporting Date: 05/18/07  
Project Owner: SABER  
Project Name: BUCKLEY A #3  
Project Location: LOVINGTON, NM

Sampling Date: 05/18/07  
Sample Type: SOIL  
Sample Condition: COOL & INTACT  
Sample Received By: NF  
Analyzed By: AB

LAB NUMBER	SAMPLE ID	BENZENE (mg/Kg)	TOLUENE (mg/Kg)	ETHYL BENZENE (mg/Kg)	TOTAL XYLENES (mg/Kg)
ANALYSIS DATE		05/18/07	05/18/07	05/18/07	05/18/07
H12617-1	SW CORNER @ 20'	<0.002	<0.002	0.003	0.056
Quality Control		0.107	0.103	0.102	0.312
True Value QC		0.100	0.100	0.100	0.300
% Recovery		107.0	103	102	104.0
Relative Percent Difference		6	16.0	12.4	10.9

METHOD: EPA SW-846 8021 B

Aaron Berry  
Chemist

05/18/07  
Date

PLEASE NOTE: Liability and Damages. Cardinal's liability and client's exclusive remedy for any claim arising, whether based in contract or tort, shall be limited to the amount paid by client for analysis. All claims, including those for negligence and any other cause whatsoever shall be deemed waived unless made in writing and received by Cardinal within thirty (30) days after completion of the analytical service. In no event shall Cardinal be liable for incidental or consequential damages, including, without limitation, business interruptions, loss of use, or loss of profits incurred by client, its subsidiaries, affiliates or successors arising out of or related to the performance of services hereunder by Cardinal, regardless of whether such claim is based upon any of the above-stated reasons or otherwise.



**ANALYTICAL RESULTS FOR  
OCOTILLO ENVIRONMENTAL  
ATTN: CINDY CRAIN  
P.O. BOX 1816  
HOBBS, NM 88241  
FAX TO: (432) 272-0304**

Receiving Date: 05/30/07  
Reporting Date: 05/30/07  
Project Owner: SABER  
Project Name: BUCKLEY A #3  
Project Location: LOVINGTON, NM

Analysis Date: 05/30/07  
Sampling Date: 05/30/07  
Sample Type: SOIL  
Sample Condition: COOL & INTACT  
Sample Received By: NF  
Analyzed By: HM

LAB NUMBER	SAMPLE ID	Cr (mg/Kg)
H12661-1	NE CORNER 12'	160
H12661-2	SW CORNER 22'	1807
H12661-3	SW CORNER 24'	1312
H12661-4	NW CORNER 12'	544
H12661-5	NW CORNER 14'	224
Quality Control		500
True Value QC		500
% Recovery		100
Relative Percent Difference		0.0

METHOD: Standard Methods	4500-CIB
--------------------------	----------

Note: Analyses performed on 1:4 w:v aqueous extracts.

Chemist

25-30-07  
Date

H12661 OCO

**PLEASE NOTE** Liability and Damages. Cardinal's liability and client's exclusive remedy for any claim arising, whether based in contract or tort, shall be limited to the amount paid by client for Knottkus. All claims, including those for negligence and any other cause whatsoever shall be deemed waived unless made in writing and received by Cardinal within thirty (30) days after completion of the applicable service. In no event shall Cardinal be liable for incidental or consequential damages, including, without limitation, business interruptions, loss of use, or loss of profits incurred by client, its subsidiaries, affiliates or successors arising out of or related to the performance of services hereunder by Cardinal, regardless of whether such claim is based upon any of the above-stated reasons or otherwise.

**CARDINAL LABORATORIES**

101 East Marland, Hobbs, NM 88240 2111 Beechwood, Abilene, TX 79603  
 (505) 393-2326 FAX (505) 393-2476 (325) 673-7001 FAX (325) 673-7020

**CHAIN-OF-CUSTODY AND ANALYSIS REQUEST**

<b>Company Name:</b> Cootilo Environmental				<b>BILL TO</b>											
<b>Project Manager:</b> Cindy Crain				<b>P.O. #:</b>											
<b>Address:</b> P.O. Box 1216				<b>Company:</b> Cootilo											
<b>City:</b> Hobbs <b>State:</b> NM <b>Zip:</b> 88241				<b>Attn:</b> Cindy Crain											
<b>Phone #:</b> (505) 393-2326 <b>Fax #:</b>				<b>Address:</b>											
<b>Project #:</b> B <b>Project Owner:</b> Saber				<b>City:</b>											
<b>Project Name:</b> Buckley A #3				<b>State:</b> <b>Zip:</b>											
<b>Project Location:</b> Lovington, NM				<b>Phone #:</b>											
<b>Sampler Name:</b> Cassie Hobbs				<b>Fax #:</b>											

FOR LAB USE ONLY		MATRIX										PRESERV.			SAMPLING																
Lab I.D.	Sample I.D.	(GRAB OR (COMP.	# CONTAINERS	GROUNDWATER	WASTEWATER	SOIL	OIL	SLUDGE	OTHER	ACID/BASE	ICE / COOL	OTHER:	DATE	TIME																	
H12661-1	NE corner 12'		1			✓					✓		5/30/07	9:00	C1 24hr rush																
-2	SW corner 22'		1			✓					✓			9:05																	
-3	SW corner 24'		1			✓					✓			9:30																	
-4	NW corner 12'		1			✓					✓			9:40																	
-5	NW corner 14'		1			✓					✓			10:08																	

PLEASE NOTE: Liability and Damages. Cardinal's liability and client's exclusive remedy for any claim arising whether based in contract or tort, shall be limited to the amount paid by the client for the analyses. All claims, including those for negligence and any other cause whatsoever shall be deemed waived unless made in writing and received by Cardinal within 30 days after completion of the applicable analysis. In no event shall Cardinal be liable for incidental or consequential damages, including without limitation, business interruptions, loss of use, or loss of profits incurred by others, its subsidiaries, affiliates or successors arising out of or related to the performance of services hereunder by Cardinal, regardless of whether such claim is based upon any of the above stated remedies or otherwise.

Relinquished By: <u>Cassie Hobbs</u>		Date: <u>5/30/07</u>		Received By: <u>Mike Fullerton</u>		Time: <u>12:17</u>		Phone Result: <input type="checkbox"/> Yes <input type="checkbox"/> No Add'l Phone #:	
Relinquished By:		Date:		Received By:		Time:		Fax Result: <input type="checkbox"/> Yes <input type="checkbox"/> No Add'l Fax #:	
Delivered By: (Circle One)		Sample Condition:		CHECKED BY:		REMARKS:			
Sampler - UPS - Bus - Other:		Copr Intact <input checked="" type="checkbox"/> Yes <input checked="" type="checkbox"/> No <input type="checkbox"/> No <input type="checkbox"/> No		(Initial) <u>M.F.</u>					

† Cardinal cannot accept verbal changes. Please fax written changes to 505-393-2476



PHONE (325) 673-7001 • 2111 BEECHWOOD • ABILENE, TX 79603

PHONE (505) 393-2326 • 101 E. MARLAND • HOBBS, NM 88240

ANALYTICAL RESULTS FOR  
OCOTILLO ENVIRONMENTAL  
ATTN: CINDY CRAIN  
P.O. BOX 1816  
HOBBS, NM 88241  
FAX TO: (432) 272-0304

Receiving Date: 06/01/07  
Reporting Date: 06/01/07  
Project Owner: SABER  
Project Name: BUCKLEY A #3  
Project Location: LOVINGTON, NM

Analysis Date: 06/01/07  
Sampling Date: 06/01/07  
Sample Type: SOIL  
Sample Condition: COOL & INTACT  
Sample Received By: BC  
Analyzed By: AB

LAB NUMBER	SAMPLE ID	Cl <sup>-</sup> (mg/Kg)
H12695-1	SW @ 27'	112
H12695-2	CENTER @ 12'	240
H12695-3	SE @ 12'	192
Quality Control		480
True Value QC		500
% Recovery		96
Relative Percent Difference		0.0

METHOD: Standard Methods

4500-Cl<sup>-</sup>B

Note: Analyses performed on 1:4 w:v aqueous extracts.

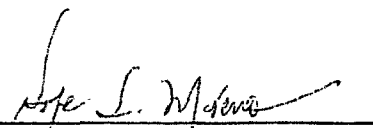
  
Chemist

06-01-07  
Date

H12695 OCO

PLEASE NOTE: Liability and Damages. Cardinal's liability and client's exclusive remedy for any claim arising, whether based in contract or tort, shall be limited to the amount paid by client for analyses. All claims, including those for negligence and any other cause whatsoever shall be deemed waived unless made in writing and received by Cardinal within thirty (30) days after completion of the applicable service. In no event shall Cardinal be liable for incidental or consequential damages, including, without limitation, business interruptions, loss of use, or loss of profits incurred by client, its subsidiaries, affiliates or successors arising out of or related to the performance of services hereunder by Cardinal, regardless of whether such claim is based upon any of the above-stated reasons or otherwise.



# CARDINAL LABORATORIES

101 East Marland, Hobbs, NM 88240 2111 Beechwood, Abilene, TX 79603  
(505) 393-2326 FAX (505) 393-2476 (325) 673-7001 FAX: (325) 673-7020

## CHAIN-OF-CUSTODY AND ANALYSIS REQUEST

Company Name: <u>Ocotillo Environmental</u>				<b>BILL TO</b>				<b>ANALYSIS REQUEST</b>																			
Project Manager: <u>Cindy Crain</u>				P.O. #:				<div style="writing-mode: vertical-rl; transform: rotate(180deg);">                 21 (24 hr rush)             </div>																			
Address:				Company: <u>Ocotillo</u>																							
City: State: Zip:				Attn:																							
Phone #: Fax #:				Address:																							
Project #: Project Owner: <u>Saber</u>				City:																							
Project Name: <u>Buckley A#3</u>				State: Zip:																							
Project Location: <u>Lovington, NM</u>				Phone #:																							
Sampler Name: <u>C. Hobbs</u>				Fax #:																							
FOR LAB USE ONLY				MATRIX				PRESERV.		SAMPLING																	
Lab I.D.	Sample I.D.	(GRAB OR C/COMP.)	# CONTAINERS	GROUNDWATER	WASTEWATER	SOIL	OIL	SLUDGE	OTHER	ACID/BASE:	ICE / COOL	OTHER:	DATE	TIME													
H12695-1	SW @ 27'		1			✓							6/1/07	12:55	✓												
-2	Center @ 12'		1			✓							↓	1:05	✓												
-3	SE @ 12'		1			✓							↓	1:00	✓												

PLEASE NOTE: Liability and Damages. Cardinal's liability and client's exclusive remedy for any claim arising whether based in contract or tort, shall be limited to the amount paid by the client for the analysis. All claims including those for negligence and any other cause whatsoever shall be deemed waived unless made in writing and received by Cardinal within 30 days after completion of the applicable service. In no event shall Cardinal be liable for incidental or consequential damages, including without limitation, business interruptions, loss of use, or loss of profits incurred by client, its subsidiaries, affiliates or successors arising out of or related to the performance of services hereunder by Cardinal, regardless of whether such claim is based upon any of the above stated reasons or otherwise.

Relinquished By: <u>C. Hobbs</u>	Date: <u>6/1/07</u> Time: <u>1:30</u>	Received By: <u>Steven Kent</u>	Phone Result: <input type="checkbox"/> Yes <input type="checkbox"/> No Add'l Phone #:
Relinquished By: <u>Don Butte</u>	Date: <u>6/1/07</u> Time: <u>1:40</u>	Received By: <u>Bruce J. Cook</u>	Fax Result: <input type="checkbox"/> Yes <input type="checkbox"/> No Add'l Fax #:
Delivered By: (Circle One) Sampler - UPS - Bus - Other:	Sample Condition Cool Intact <input checked="" type="checkbox"/> Yes <input type="checkbox"/> No <input type="checkbox"/> Yes <input type="checkbox"/> No	CHECKED BY: (Initials)	REMARKS:

† Cardinal cannot accept verbal changes. Please fax written changes to 505-393-2476